

ALAMEDA COUNTY
HEALTH CARE SERVICES

AGENCY

DAVID J. KEARS, Agency Director



RAFAT A. SHAHID, Assistant Agency Director

February 27, 1995

Alameda County CC4530
Environmental Protection Division
1131 Harbor Bay Parkway, Room 250
Alameda CA 94502-6577

STID 3061

REMEDIAL ACTION COMPLETION CERTIFICATE

Marvin Katz
Texaco Refining and Marketing, Inc.
108 Cutting Boulevard
Richmond, CA 94804

Lakeshore Financial
% Lowell & Macauley, attorney for
debtor in bankruptcy
1280 Civic Drive, Ste. 109
Walnut Creek, CA 94596
Attn: David Lowell

RE: SPEEDEE OIL CHANGE & TUNE-UP, 3940 CASTRO VALLEY BOULEVARD,
CASTRO VALLEY

Dear Messrs. Katz and Lowell:

This letter confirms the completion of site investigation and remedial action associated with the four gasoline underground storage tanks at the referenced location.

Based on the available information, and with the provision that the information provided to this agency was accurate and representative of site conditions, no further action related to the underground storage tank release is required.

This notice is issued pursuant to a regulation contained in Title 23, Division 3, Chapter 16, Section 2721(e) of the California Code of Regulations.

Please contact Scott Seery at (510) 567-6783 if you have any questions regarding this matter.

Sincerely,

Rafat A. Shahid
Director of Environmental Services

Messrs. Katz and Lowell
RE: 3940 Castro Valley Blvd., Castro Valley
February 27, 1995
Page 2 of 2

cc: Edgar B. Howell, Chief, Environmental Protection Division
Kevin Graves, RWQCB
Mike Harper, SWRCB
Ed Laudani, Alameda County Fire Department

11/13/94
11/13/94
11/13/94

CASE CLOSURE SUMMARY
Leaking Underground Fuel Storage Tank Program

CALIFORNIA REGIONAL WATER
FEB 08 1995
QUALITY CONTROL BOARD

I. AGENCY INFORMATION

Date: 12/13/94

Agency name: Alameda County-EPD Address: 1131 Harbor Bay Pkwy #250
City/State/Zip: Alameda, CA 94502 Phone: (510) 567-6700
Responsible staff person: Scott Seery Title: Sr. Haz. Materials Spec.

II. CASE INFORMATION

Site facility name: Speedee Oil Change & Tune-Up
Site facility address: 3940 Castro Valley Blvd, Castro Valley
RB LUSTIS Case No: N/A Local Case No./LOP Case No.: 3061
URF filing date: 10-30-85 SWEEPS No: N/A

| <u>Responsible Parties:</u> | <u>Addresses:</u> | <u>Phone Numbers:</u> |
|---|--|-----------------------|
| John Drake Lakeshore Financial | 21060 Redwood Rd., #250 Castro Valley, CA 94546 | |
| Marvin Katz Texaco Refining and Marketing, Inc. | 108 Cutting Blvd. Richmond, CA 94804 | 510/ 236-3611 |

| <u>Tank No:</u> | <u>Size in gal.:</u> | <u>Contents:</u> | <u>Closed in-place or removed?:</u> | <u>Date:</u> |
|-----------------|----------------------|------------------|-------------------------------------|--------------|
| 1 | 4000 | gasoline | removed | 6-2-85 |
| 2 | " | " | " | " |
| 3 | 6000 | " | " | " |
| 4 | " | " | " | " |

III. RELEASE AND SITE CHARACTERIZATION INFORMATION

Cause and type of release: UNK (over filling?)
Site characterization complete? YES
Date approved by oversight agency: 7/15/91
Monitoring Wells installed? YES Number: 9
Proper screened interval? YES
Highest GW depth below ground surface: 16.38' Lowest depth: 25.77'
Flow direction: range from NNE-N-NW-W-SW-S-SE; typically W to SW

Leaking Underground Fuel Storage Tank Program

Most sensitive current use: commercial - auto service

Are drinking water wells affected? NO Aquifer name: Castro Valley basin

Is surface water affected? NO Nearest affected SW name: NA

Off-site beneficial use impacts (addresses/locations): NA

Report(s) on file? YES Where is report(s) filed? Alameda County
1131 Harbor Bay Pkwy
Alameda CA 94502

Treatment and Disposal of Affected Material:

| <u>Material</u> | <u>Amount</u> (include units) | <u>Action (Treatment</u> <u>or Disposal w/destination)</u> | <u>Date</u> |
|-----------------|--|---|------------------|
| Tank | 2x4000; 2x6000 gal. | UNK | UNK |
| Piping | UNK | " | " |
| Free Product | NA | | |
| Soil | 350 yds ³ | UNK | UNK |
| Groundwater | 1500 ⁺ gal. (purge H ₂ O) | disposal/recycle - Gibson Oil, Redwood City | various dates |
| Barrels | NA | | |

III. RELEASE AND SITE CHARACTERIZATION INFORMATION (Continued)

Maximum Documented Contaminant Concentrations - - Before and After Cleanup

| Contaminant | Soil (ppm) | | Water (ppm) | |
|---------------------------------------|--------------|----------|-------------|--------|
| | Before | After | Before | After |
| TPH (Gas) | 6500 | (7900?)* | 9400 | ND |
| TPH (Diesel) | NA | NA | NA | NA |
| Benzene | ND | " | 220 | ND |
| Toluene | 0.95 | " | 160 | " |
| Xylene | 2.0 | " | 240 | " |
| Ethylbenzene | 0.24 | " | 68 | " |
| Oil & Grease | ND | " | NA | NA |
| Heavy metals (Pb) | ND | " | " | " |
| Other (Meth. Chloride; chloroform) | 0.025 1.9 | " " | " " | " " |

Comments (Depth of Remediation, etc.):

Four gasoline USTs were removed June 2, 1985. A single soil sample was collected @ 13' BG from below the central UST of the tank cluster. The sample reportedly had a TPH-G concentration of 6500 ppm, the only analyte sought. Although not confirmed by any technical documents, an April 10, 1989 RWQCB letter* to Lakeshore Financial informs that post-excavation samples still had up to 7900 ppm TPH-G. Other (sketchy) info from Texaco seems to suggest this excavation may have gone as deep as 15' BG.

Leaking Underground Fuel Storage Tank Program

Name: Eva Chu

Title: Haz Mat Specialist

Signature: 

Date: 4/3/95

VI. RWQCB NOTIFICATION

Date Submitted to RB: 2-3-95

RB Response:

RWQCB Staff Name: Kevin Graves

Title: San. Engineering Asso. Date:

VII. ADDITIONAL COMMENTS, DATA, ETC.

Four USTs were removed June 2, 1985. A single soil sample collected from the central UST exhibited 6500 ppm TPH-G. No other target compounds were apparently sought. Although unclear, excavation may have continued to approximately 15' BG. It is unknown whether additional samples were collected at this point, although a RWQCB letter to Texaco dated April 24, 1989 informs of a post-excavation sample exhibiting up to 7900 ppm TPH-G.

The RWQCB was the "lead agency" for this case during the investigation's early stages. A single initial well, designated "TX," was emplaced approximately NW of both the northern-most dispenser island and UST pit during December 1985 to a total depth of approximately 25' BG. GW was encountered at 22' BG, stabilizing at 20' BG. Soil collected from the 25' depth exhibited 38 ppm TPH-G. Fuel odor was noted in soil cuttings from well TX between approximately 1 and 12', and between 15 and 25' BG. It is unknown whether this well was sampled following its construction. However, a RWQCB "fuel case record" dated July 7, 1987 indicates up to 38,000 (ppb? TPH-G?) was detected at some point in water (presumably) from this well.

Groundwater Technology (GTI) advanced two (2) additional soil borings near the UST pit, and one (1) near well TX during November 1987. Borings were drilled to 35' BG. During December 1987, GTI also drilled and constructed three (3) additional wells, with total depths ranging from 35 to 45' BG. Well screens were as long as 40'.

Ground water was initially encountered between 23 and 32' BG during the drilling of the borings/wells, later stabilizing at approximately 22' BG in the completed wells. Unremarkable soil contamination was noted. However, ground water samples collected from wells MW-1, -2, and -3, as well as a grab water sample collected from boring SB-3, exhibited up to 29,000 ppb TPH-G (SB-3) and 220 ppb benzene (MW-2), among other target compounds detected. Ground water was calculated to flow towards the NW.

Leaking Underground Fuel Storage Tank Program

Name: Eva Chu

Signature: *Eva Chu*

Title: Haz Mat Specialist

Date: *4/3/95*

VI. RWQCB NOTIFICATION

Date Submitted to RB: *2-3-95*
RWQCB Staff Name: Kevin Graves

RB Response: *Approved*
Title: San. Engineering Asso. Date: *2/21/95*

VII. ADDITIONAL COMMENTS, DATA, ETC.

Four USTs were removed June 2, 1985. A single soil sample collected from the central UST exhibited 6500 ppm TPH-G. No other target compounds were apparently sought. Although unclear, excavation may have continued to approximately 15' BG. It is unknown whether additional samples were collected at this point, although a RWQCB letter to Texaco dated April 24, 1989 informs of a post-excavation sample exhibiting up to 7900 ppm TPH-G.

The RWQCB was the "lead agency" for this case during the investigation's early stages. A single initial well, designated "TX," was emplaced approximately NW of both the northern-most dispenser island and UST pit during December 1985 to a total depth of approximately 25' BG. GW was encountered at 22' BG, stabilizing at 20' BG. Soil collected from the 25' depth exhibited 38 ppm TPH-G. Fuel odor was noted in soil cuttings from well TX between approximately 1 and 12', and between 15 and 25' BG. It is unknown whether this well was sampled following its construction. However, a RWQCB "fuel case record" dated July 7, 1987 indicates up to 38,000 (ppb? TPH-G?) was detected at some point in water (presumably) from this well.

Groundwater Technology (GTI) advanced two (2) additional soil borings near the UST pit, and one (1) near well TX during November 1987. Borings were drilled to 35' BG. During December 1987, GTI also drilled and constructed three (3) additional wells, with total depths ranging from 35 to 45' BG. Well screens were as long as 40'.

Ground water was initially encountered between 23 and 32' BG during the drilling of the borings/wells, later stabilizing at approximately 22' BG in the completed wells. Unremarkable soil contamination was noted. However, ground water samples collected from wells MW-1, -2, and -3, as well as a grab water sample collected from boring SB-3, exhibited up to 29,000 ppb TPH-G (SB-3) and 220 ppb benzene (MW-2), among other target compounds detected. Ground water was calculated to flow towards the NW.

Leaking Underground Fuel Storage Tank Program

This well network was initially sampled semiannually. Well TX was not sampled at all during this period as it was reported to be "dry." Elevated HC concentrations were documented during this period in water sampled from MW-1 and -2, located east and west of the UST pit, respectively. GW flow directions varied between north and NW.

The RWQCB indicated no resistance to the construction of a new Speedee Oil Change facility provided such did not prove an impediment to continued GW and soil investigation and remediation: RWQCB requested clean-up standards for soil to be < 100 ppm TPH, and MCLs for ground water. During 1989, wells MW-2 and TX were destroyed under appropriate Zone 7 permit to make room for the Speedee facility.

ACDEH assumed case lead during May 1989 by informing Lakeshore Financial (property owner) of the need to expand the scope of the investigation. A N.O.V. was issued by ACDEH before the property owner's consultant submitted a plan for an additional two (2) wells and two (2) soil borings. Texaco's consultant then informed ACDEH that they would submit a work plan, which they eventually did, proposing two (2) wells to replace those previously destroyed.

Between February and April 1990, two new wells (MW-4 and -5) were constructed and the remaining wells sampled and monitored. Both MW-4 and -5 were drilled to 45' BG. GW was encountered @ 30-33' BG. Seventeen and 20' of well screen were used in MW-4 and -5, respectively. Of the compounds sought, only 40 ppm TPH-G was detected in soil from MW-4 at 25' BG. This well was also the only one in the network to exhibit HCs in sampled GW, with 1500 ppb TPH-G and 97 ppb benzene.

Between June 1990 and December 1991, well sampling and monitoring were reported quarterly. Wells were, for the most part, monitored and, periodically, sampled monthly during this period. Calculated GW flow direction varied from NNW to SE to west during this period. The presence of HCs was exclusively in GW sampled from MW-1 and -4.

At the request of ACDEH, additional wells were installed during January 1992 to define the plume boundaries. Two wells, MW-6 and -7, were located off-site, WNW and SW of the subject site, respectively; MW-8 was constructed on-site near the SE corner of the property. The new wells were sampled and monitored monthly through March 1991. In February 1991, MW-4 exhibited 9400 ppb TPH-G, and off-site wells MW-6 and -7, as well as on-site well MW-8, first exhibited detectable concentrations of TPH and/or aromatic compounds. GW flow was calculated to range from WSW to south.

Between June 1992 and March 1993, GW flow ranged from S to SE to SW. Low ppb range HCs were primarily found in GW sampled from wells MW-1 and -4; with periodic, similar amplitude "hits" in MW-6, -7 and -8.

Leaking Underground Fuel Storage Tank Program

Beginning December 1992, GW sampled from well MW-3, located at the western boundary of the site, first exhibited the presence of HCs. In fact, the highest benzene concentration yet recorded at the site, 220 ppb, was discovered in this well during June 1993, at a time when this was the only well with detectable HCs. Through March 1994, GW flow has been calculated to flow towards the west. The June 1994 event showed flow to be towards the north.

Since June 1993, only nondetectable (ND) or low (< 3.5) ppb range HCs discovered in sampled well water, on- or off-site. Based on historical GW flow, the current well network appears oriented appropriately to intercept any HCs transported from the site in underlying GW.

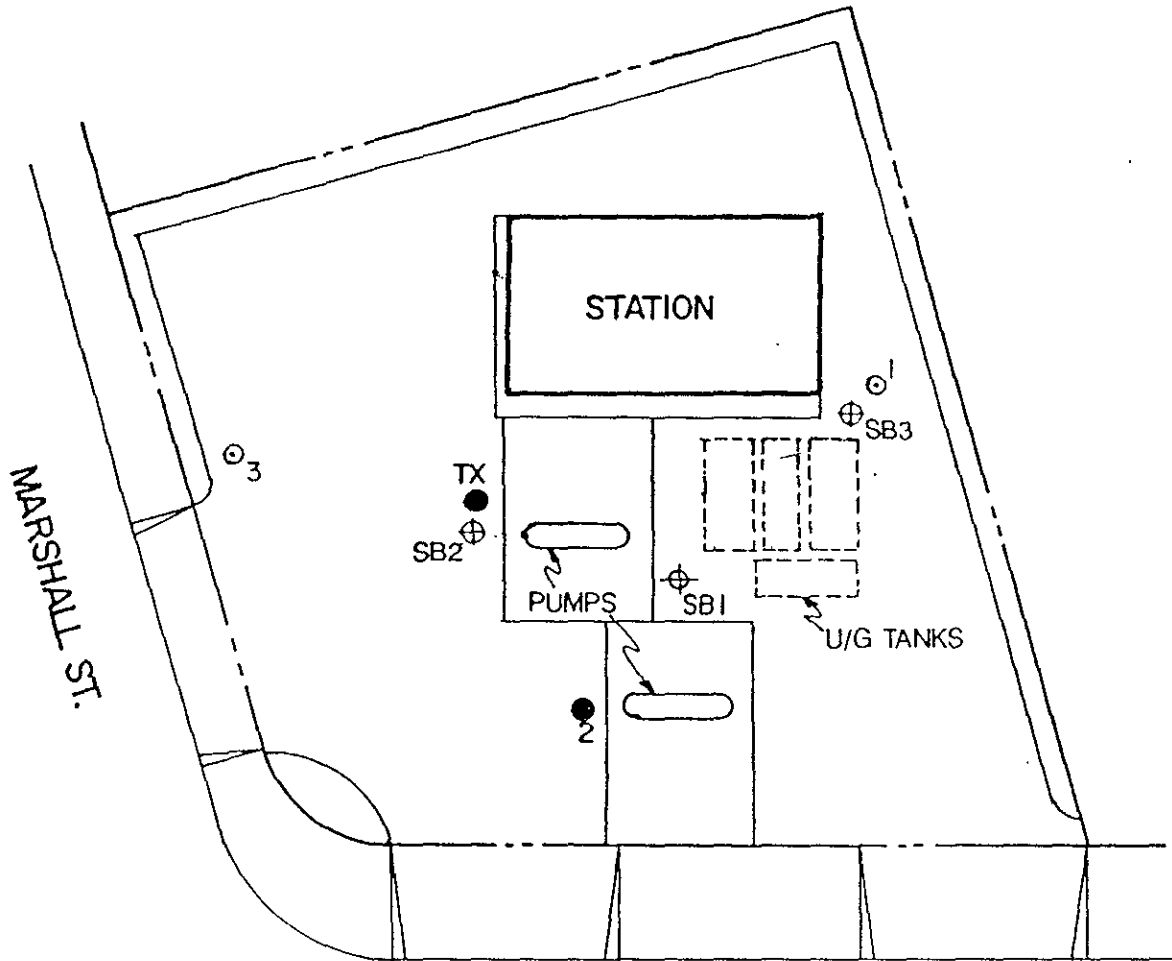

LEGEND

- ⊙ MONITORING WELL
- ⊕ SOIL BORING
- ABANDONED MONITORING WELL

FIGURE 1
OLD SITE PLAN

0 FEET 30

GROUNDWATER
TECHNOLOGY, INC.

TEXACO REFINING
& MARKETING INC.
CASTRO VALLEY, CALIFORNIA

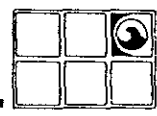

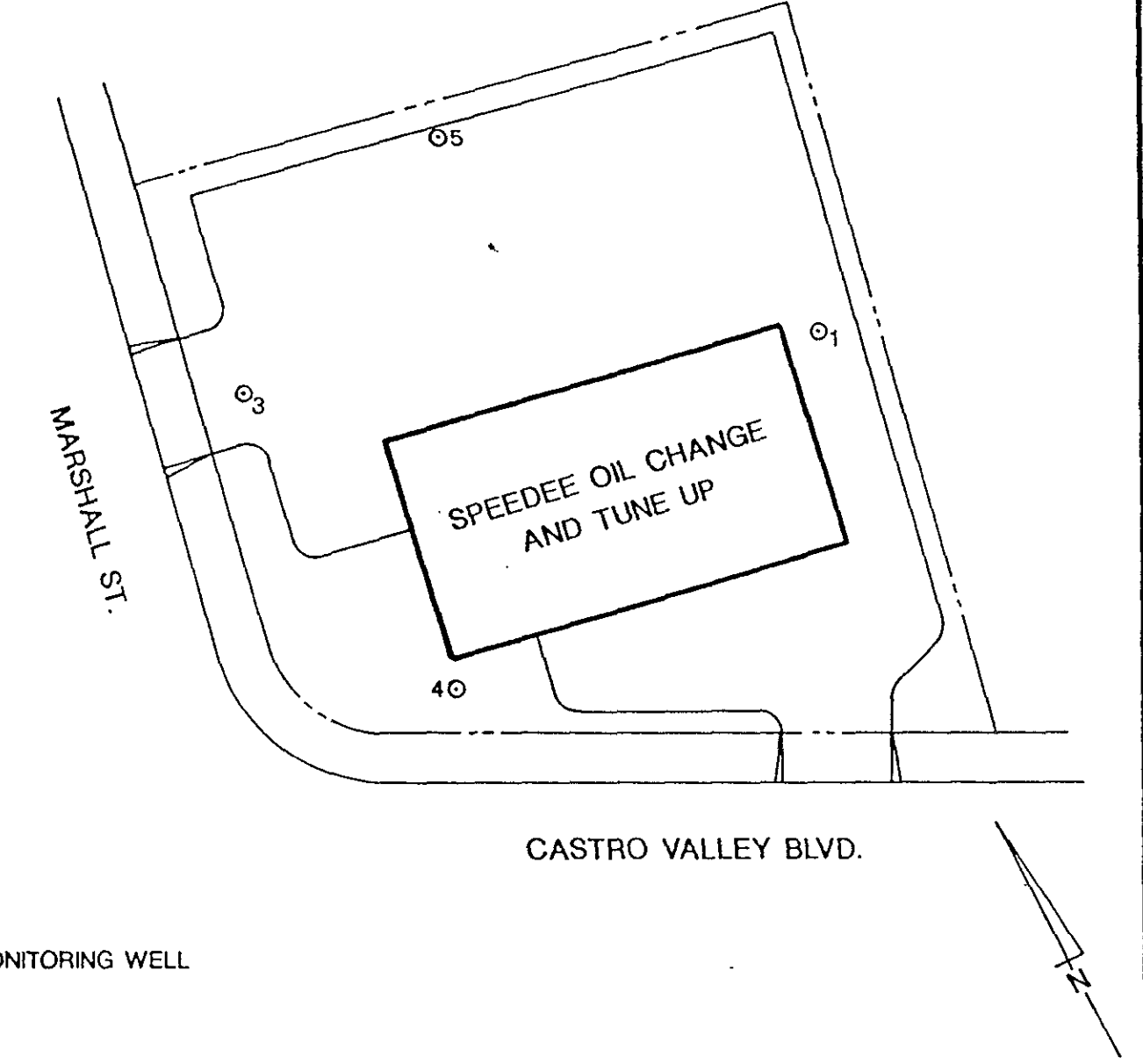

LEGEND
 ○ MONITORING WELL

FIGURE 2
 SITE PLAN

0 FEET 30

TEXACO REFINING
 & MARKETING INC.
 CASTRO VALLEY, CALIFORNIA

GROUNDWATER
 TECHNOLOGY, INC.

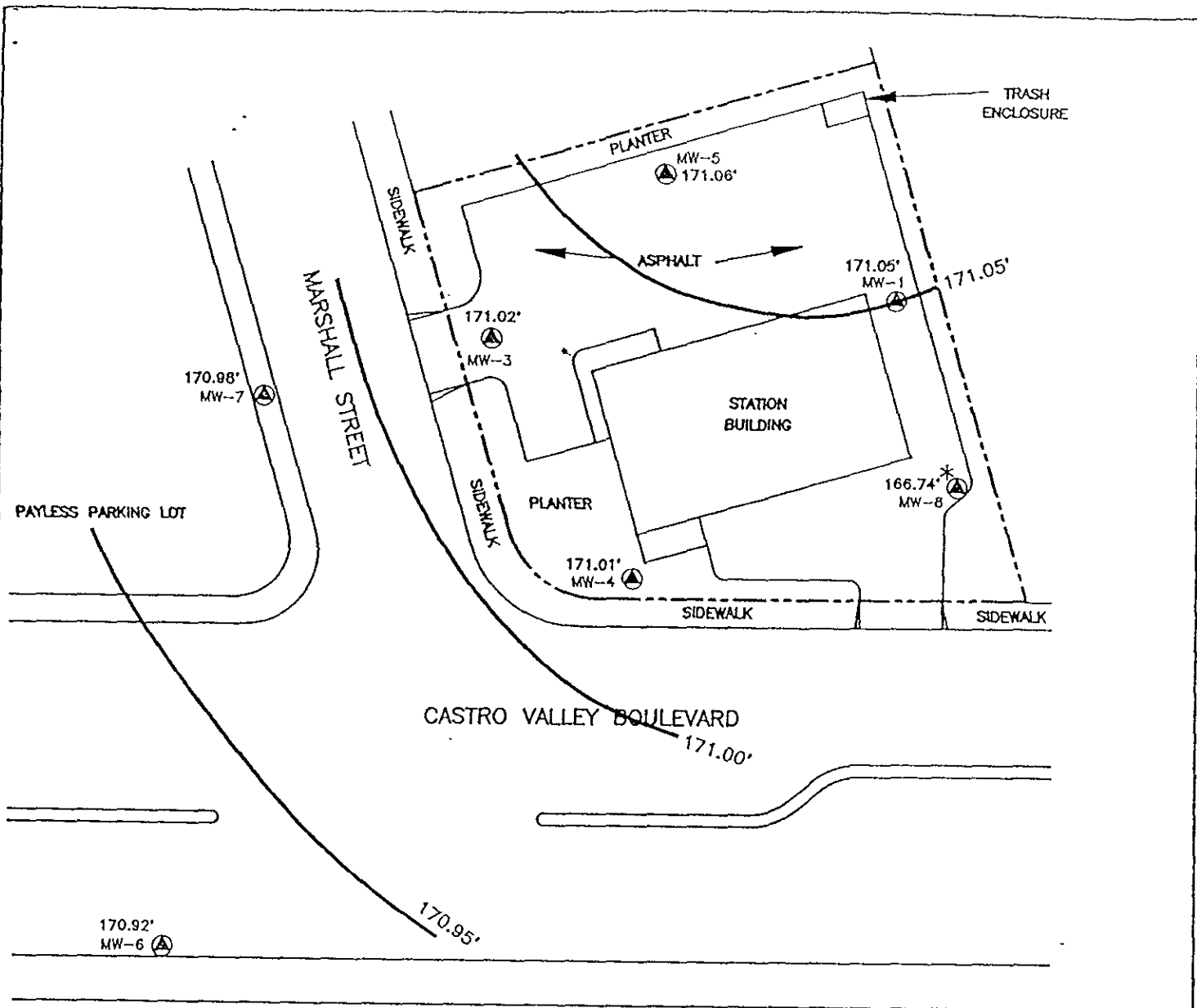

APPROXIMATE
GROUNDWATER
GRADIENT

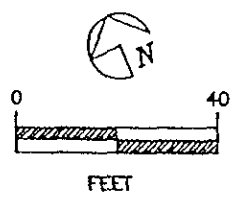

SOURCE : MODIFIED FROM
RESNA DWG.

LEGEND :

- MONITORING WELL LOCATION AND WELL NUMBER
- GROUNDWATER CONTOUR LINE
- 171.05' GROUNDWATER ELEVATION (ABOVE MSL)
- * WELL NOT USED FOR CONTOURING

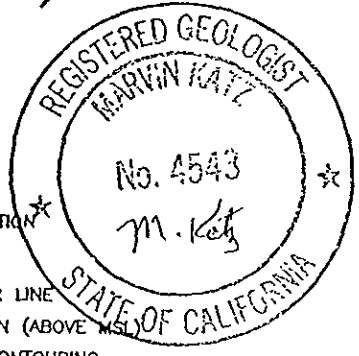

TEXACO
REFINING AND MARKETING, INC.
TEXACO ENVIRONMENTAL SERVICES

PLATE 2 : GROUNDWATER GRADIENT MAP
(03/18/1994)

TEXACO SERVICE STATION
3940 CASTRO VALLEY BLVD. / MARSHALL ST.,
CASTRO VALLEY, CALIFORNIA

| | | | |
|--|---------------|------------|-------------|
| SCALE | 1" = 40' - 0" | LOCATION # | 62-488-0089 |
| DRAWN BY | AMA | DATE | 05/01/1994 |
| CHECKED BY | TRD | DATE | 5/9/94 |
| DRAWING NO. (CASTRO VALLEY) CV-MA-CV.DWG | | | |

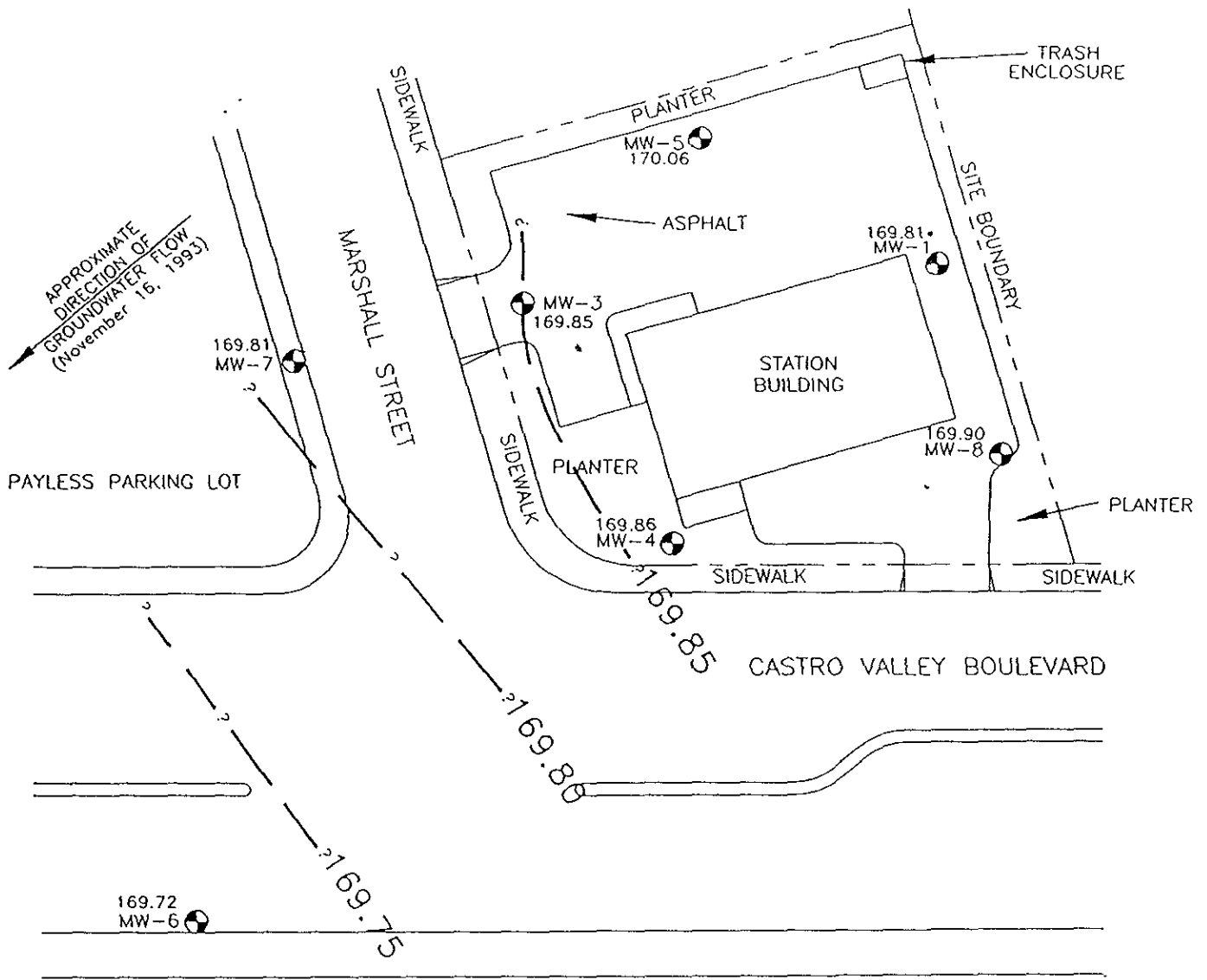

EXPLANATION

- MW-8 = Monitoring Well
- 169.85 — = Line of equal elevation of groundwater in feet above mean sea level (MSL)
- 170.06 = Elevation of groundwater in feet above MSL, November 16, 1993
- = Not used in gradient interpretation

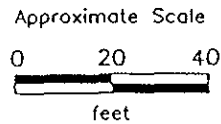

BASE MAP: SURVEYED BY RON ARCHER
CIVIL ENGINEER, INC.



GROUNDWATER GRADIENT MAP
Former Texaco Station
3940 Castro Valley Boulevard
Castro Valley, California

PLATE
2

PROJECT 62091.01

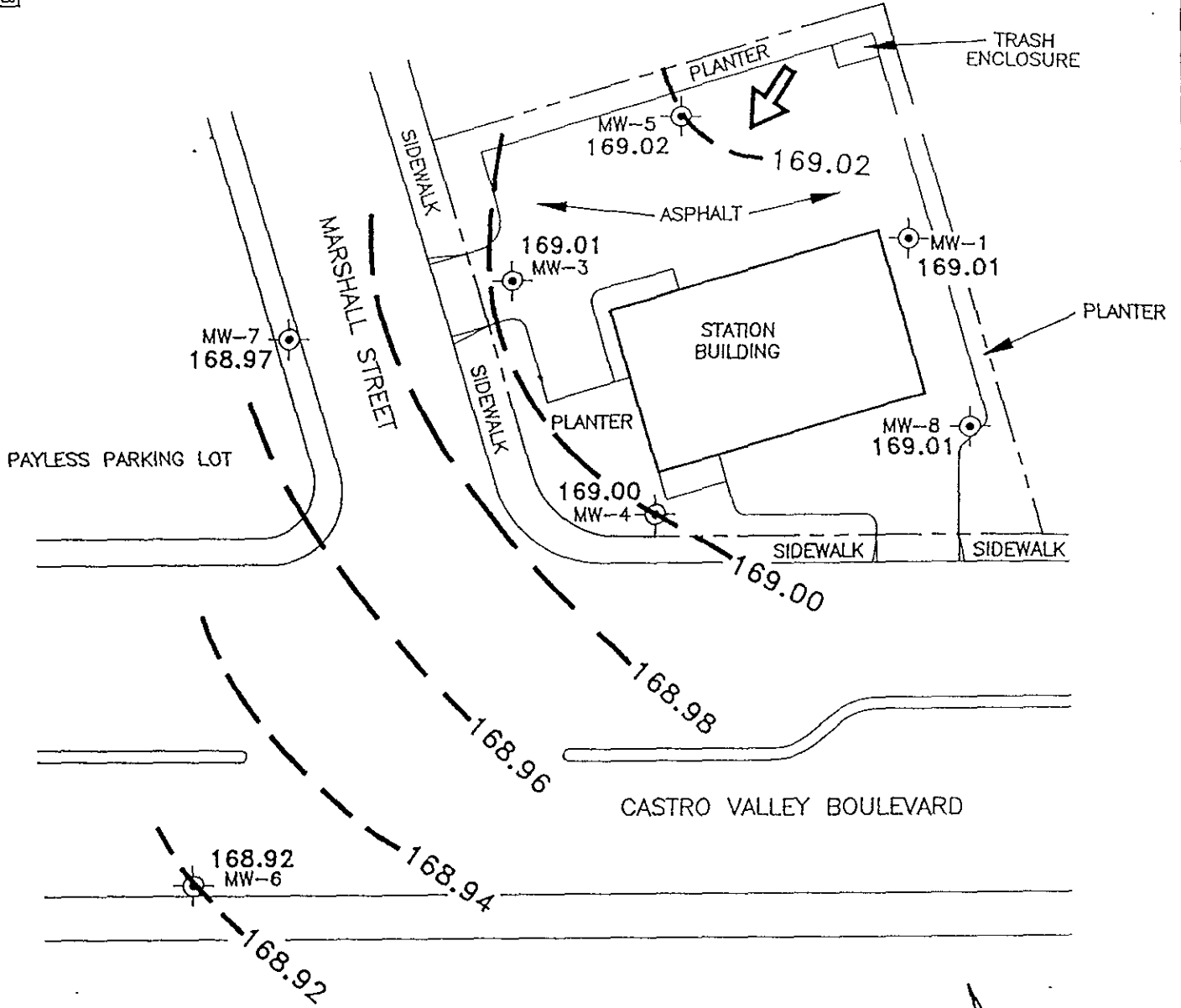

LEGEND

- MW-8 GROUNDWATER MONITORING WELL
- SITE BOUNDARY
- BUILDING
- 169.02 GROUNDWATER ELEVATION (FEET)
- 169.02 GROUNDWATER ELEVATION CONTOUR LINE
CONTOUR INTERVAL: 0.02
- APPROXIMATE DIRECTION OF GROUNDWATER FLOW

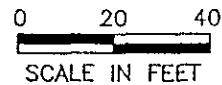

BASE MAP: SURVEYED BY RON ARCHER
CIVIL ENGINEER, INC.

NOTE: CONTOURS ARE BASED ON INTERPRETATION
OF AVAILABLE DATA, AND ARE NOT
INTENDED TO IMPLY CERTAINTY.

RESNA

GROUNDWATER ELEVATION MAP (6/30/92)

PLATE

FORMER TEXACO SERVICE STATION

3940 CASTRO VALLEY BOULEVARD



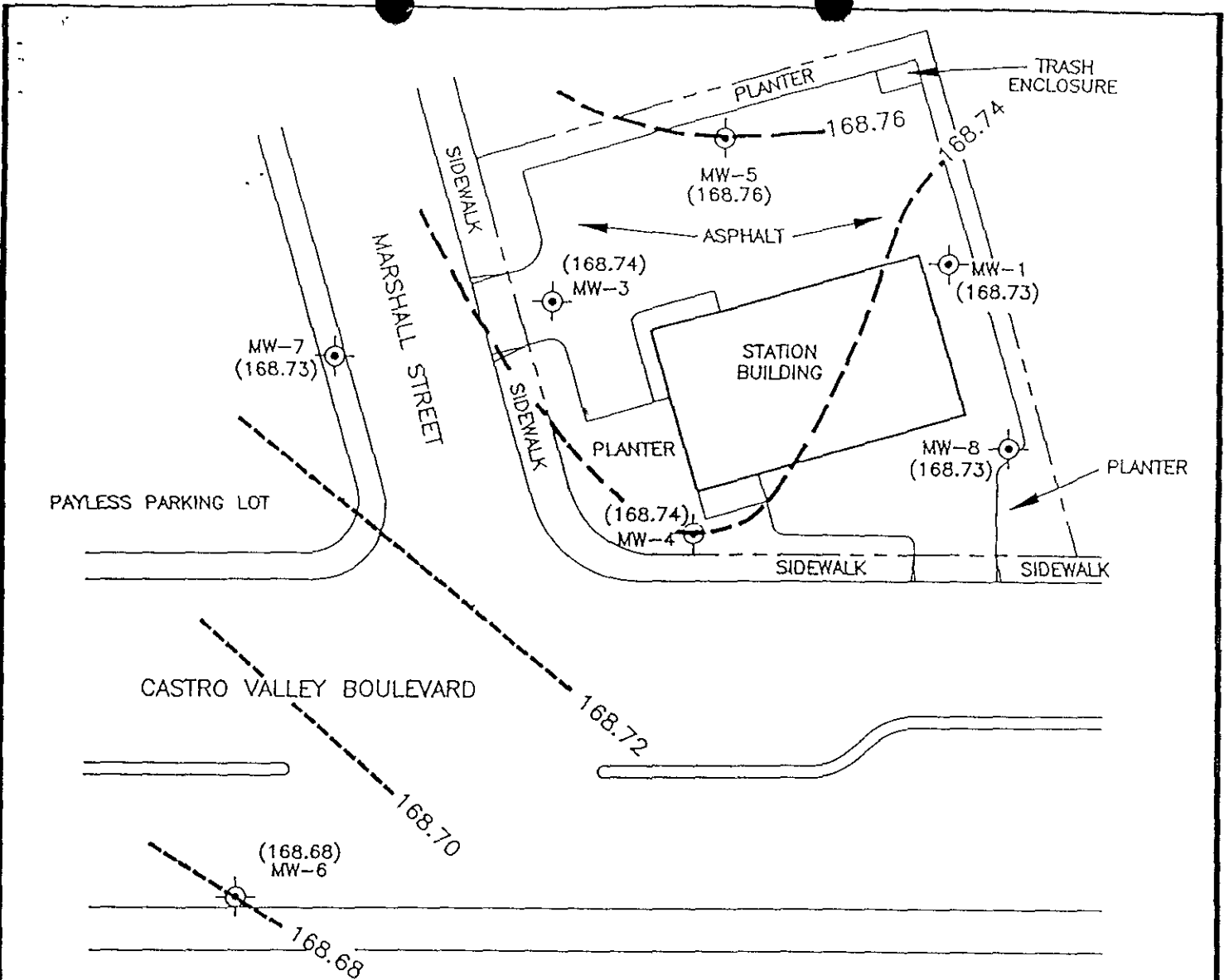

3

PROJECT NO. F3091.32

CASTRO VALLEY, CALIFORNIA





LEGEND

- MW-8  GROUNDWATER MONITORING WELL
-  SITE BOUNDARY
-  BUILDING
- (168.76) GROUNDWATER ELEVATION (FEET)
-  168.76 GROUNDWATER ELEVATION CONTOUR LINE

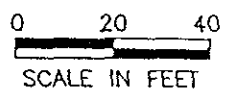
CONTOUR INTERVAL: 0.02

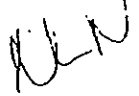

BASE MAP: SURVEYED BY RON ARCHER
CML ENGINEER, INC.

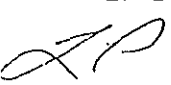
| | | | | |
|---|--|--|---|----------------------|
| REVIEWED BY:  | GROUNDWATER ELEVATION MAP (2/28/92) | |  | |
| | FORMER TEXACO SERVICE STATION | | | |
| APPROVED BY:  | 3940 CASTRO VALLEY BOULEVARD | | JOB #: 3-30091-32 | DRAWN BY: J.D.S. |
| | CASTRO VALLEY, CALIFORNIA | | DATE: 3/5/92 | DRAWING #: FIG. 4 |

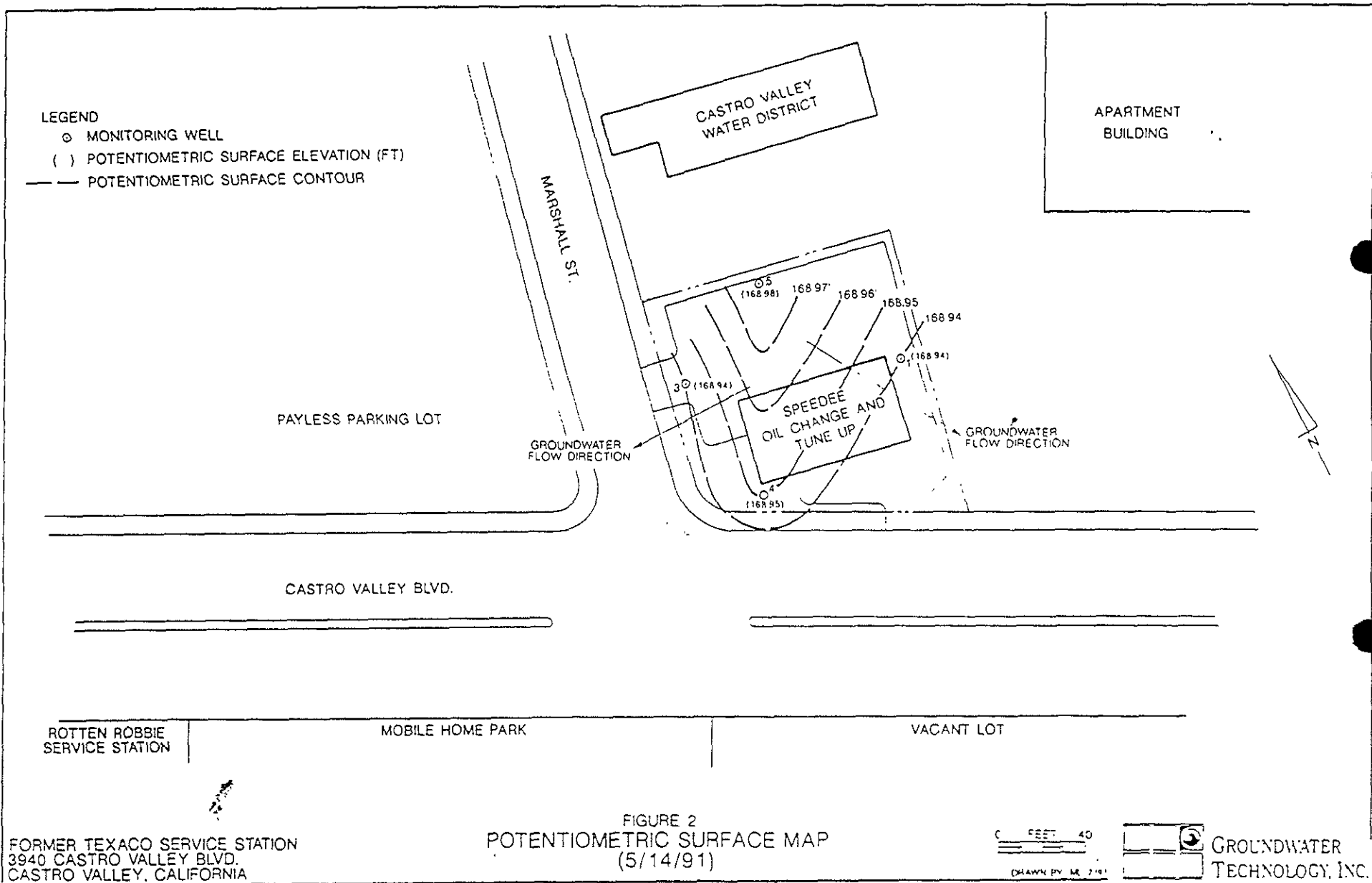

LEGEND

- ⊙ MONITORING WELL
- () GROUNDWATER ELEVATION
- GROUNDWATER CONTOUR

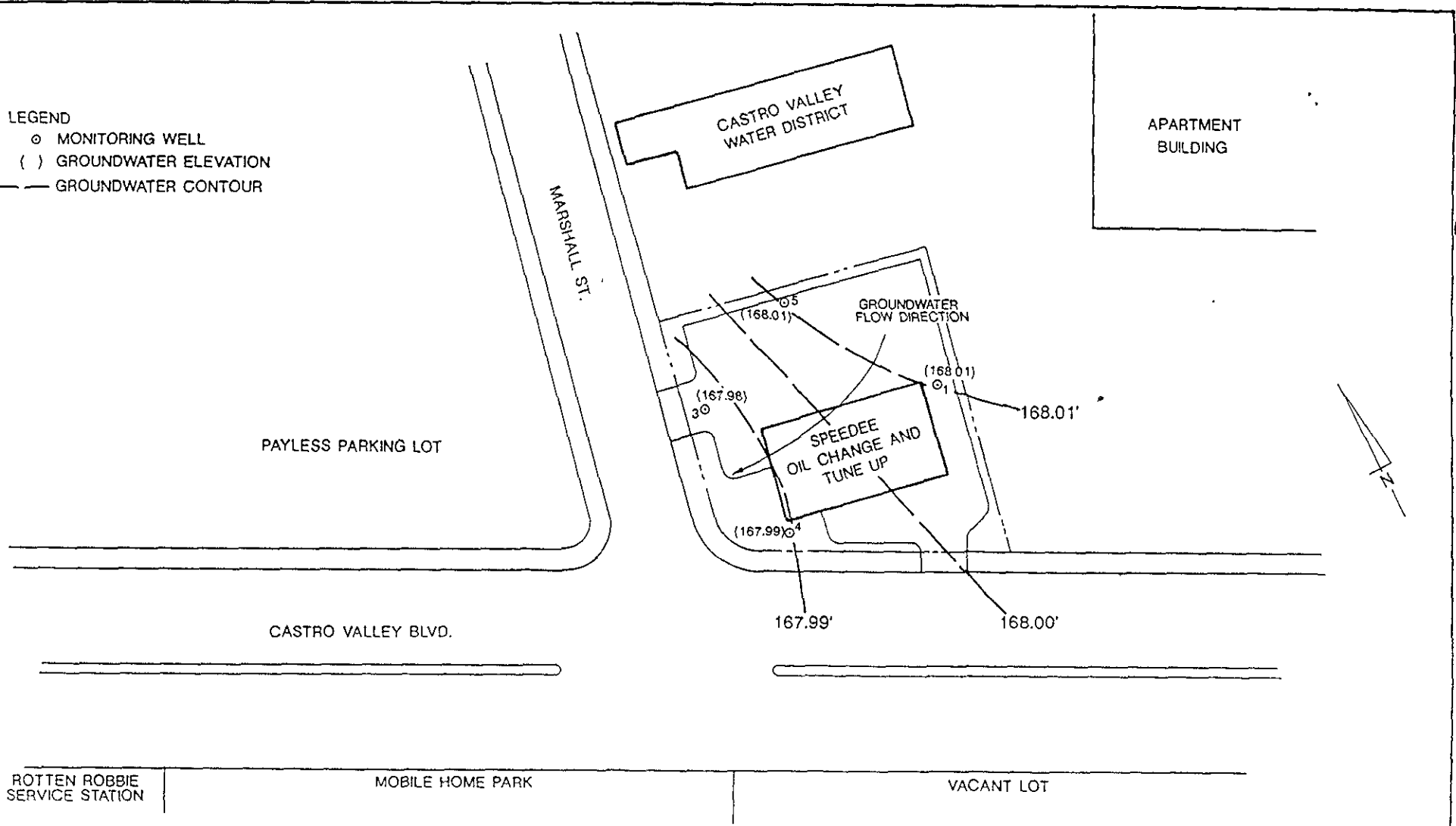
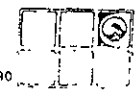

FIGURE 9
POTENTIOMETRIC SURFACE MAP
(11/15/90)

0 FEET 40



GROUNDWATER
TECHNOLOGY, INC.

MI 12/90

TEXACO REFINING
& MARKETING INC.
CASTRO VALLEY, CALIFORNIA

LEGEND

⊙ MONITORING WELL

() GROUNDWATER ELEVATION

— GROUNDWATER CONTOUR

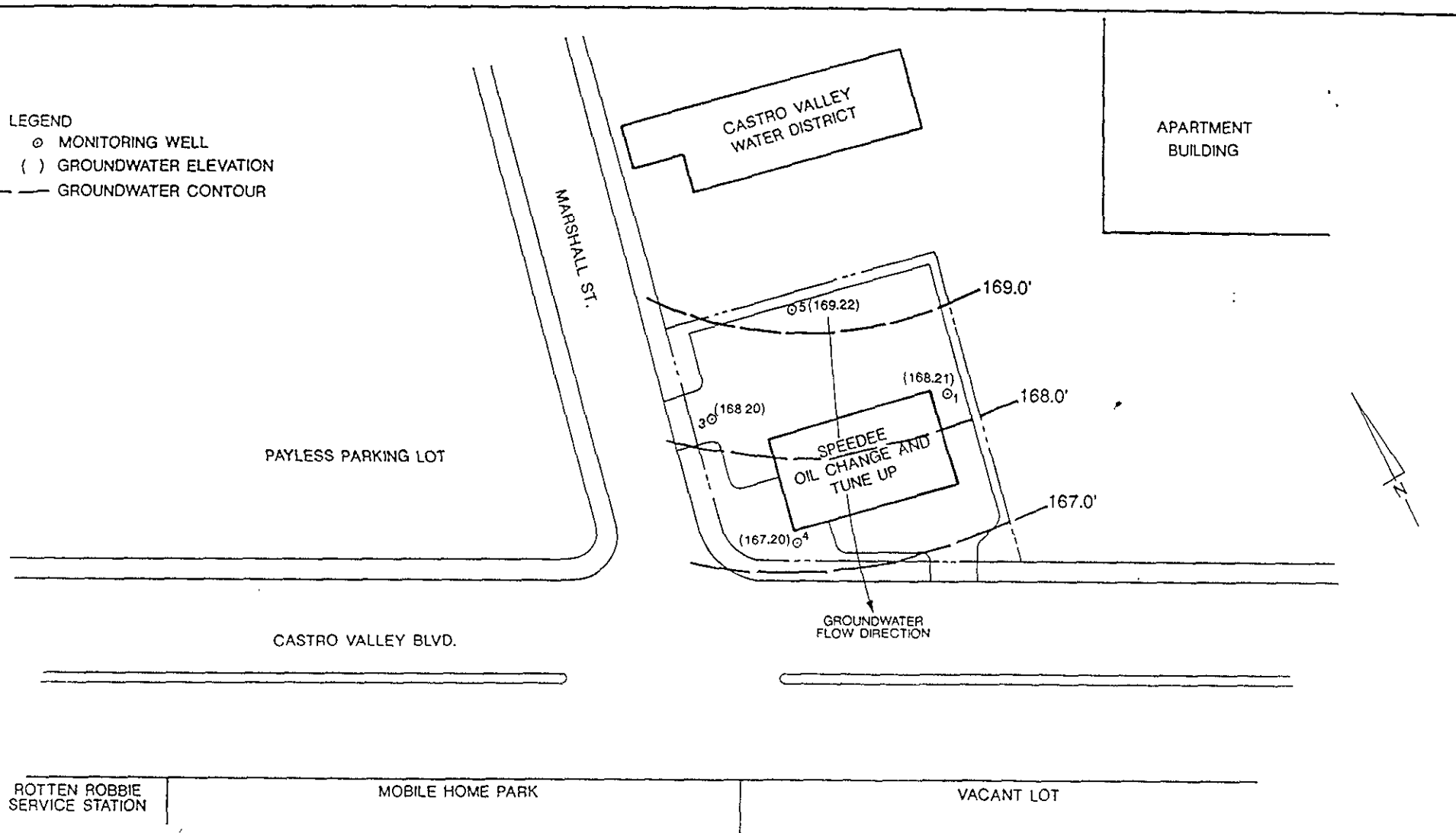

FIGURE 8
POTENTIOMETRIC SURFACE MAP
(10/10/90)

0 FEET 40



ML 12/90

GROUNDWATER
TECHNOLOGY, INC.

LEGEND

- MONITORING WELL
- () GROUNDWATER ELEVATION (FT)
- GROUNDWATER CONTOUR

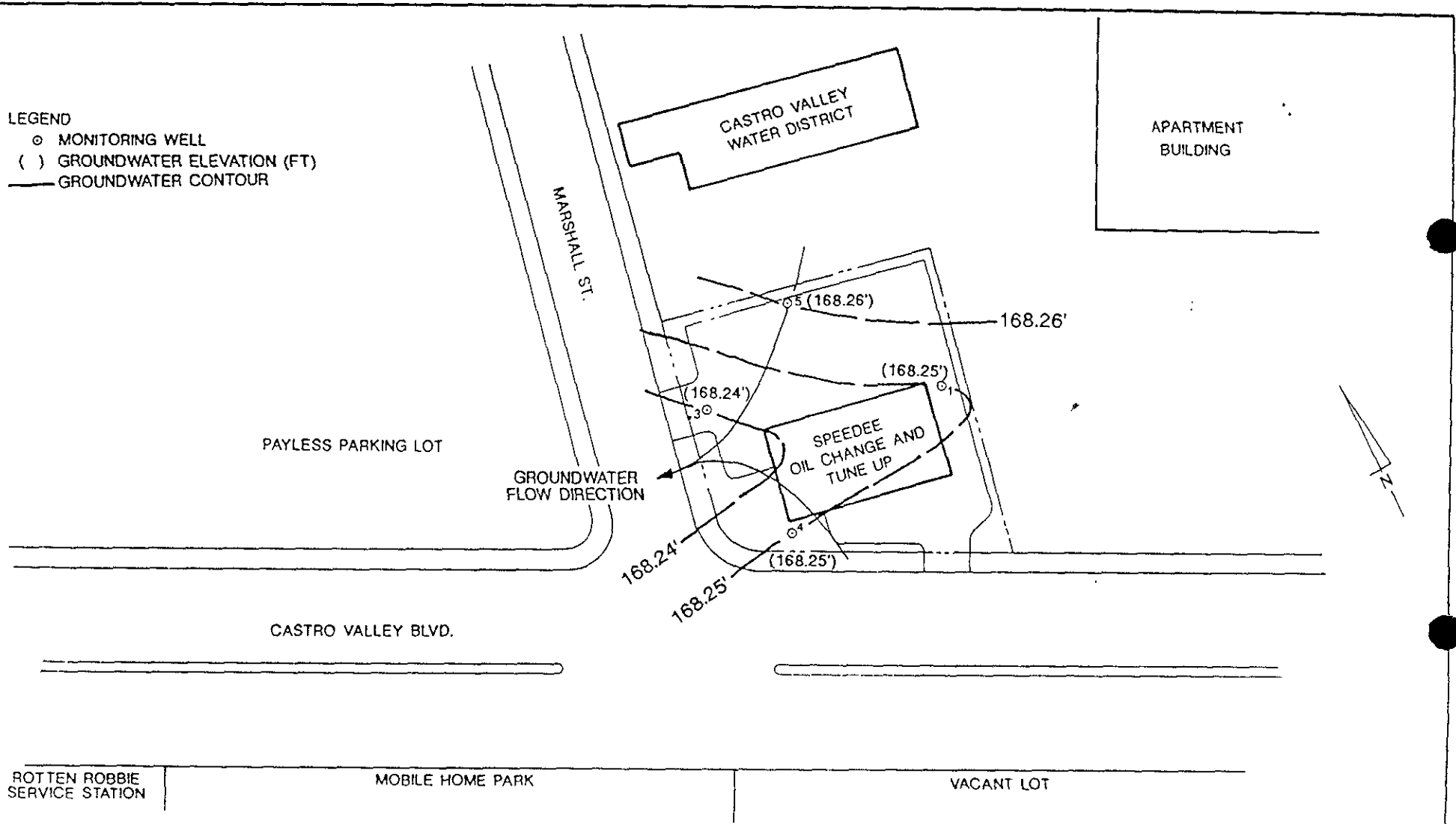
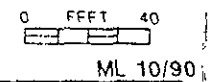
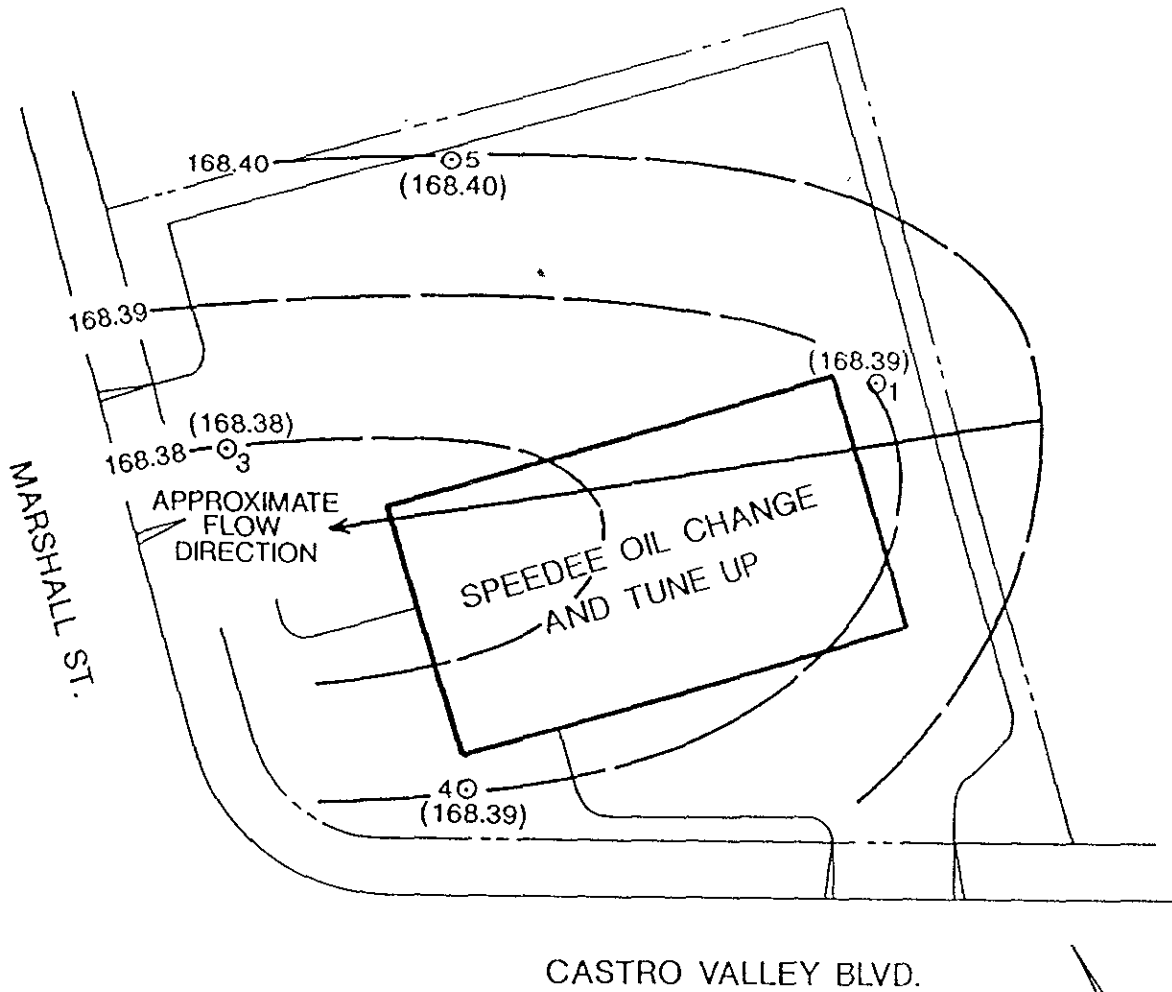

FIGURE 7
POTENTIOMETRIC SURFACE MAP
(9/27/90)

TEXACO REFINING
& MARKETING INC.
CASTRO VALLEY, CALIFORNIA



GROUNDWATER
TECHNOLOGY, INC.



LEGEND
 ⊙ MONITORING WELL
 () GROUNDWATER ELEVATION (FT.)
 - - - GROUNDWATER CONTOUR

FIGURE 6
 POTENTIOMETRIC SURFACE MAP
 (8/22/90)

0 FEET 30

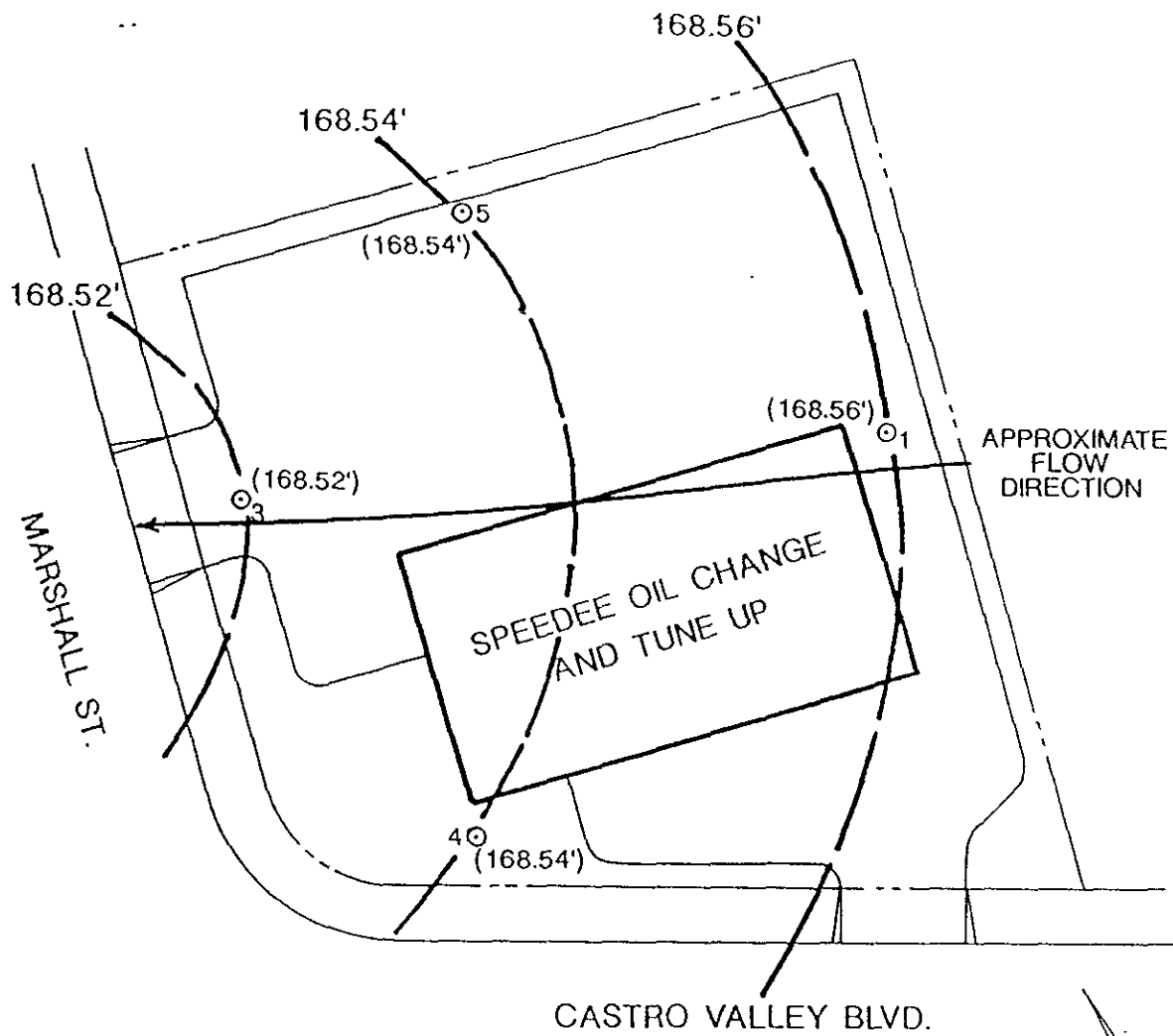
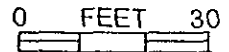

FIGURE 5
 POTENTIOMETRIC SURFACE MAP
 (7/18/90)



TEXACO REFINING
 & MARKETING INC.
 CASTRO VALLEY, CALIFORNIA

 GROUNDWATER
 TECHNOLOGY, INC.

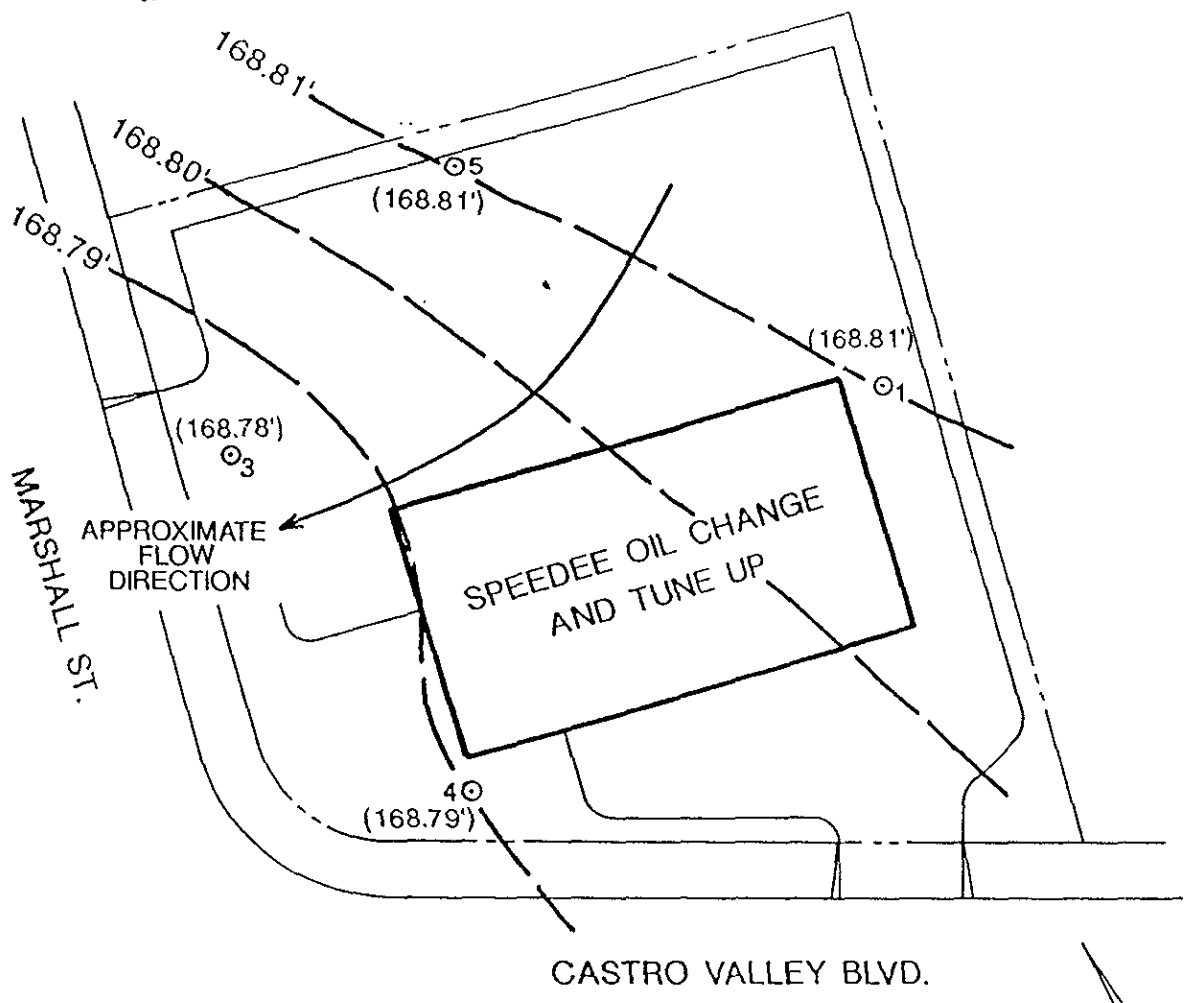
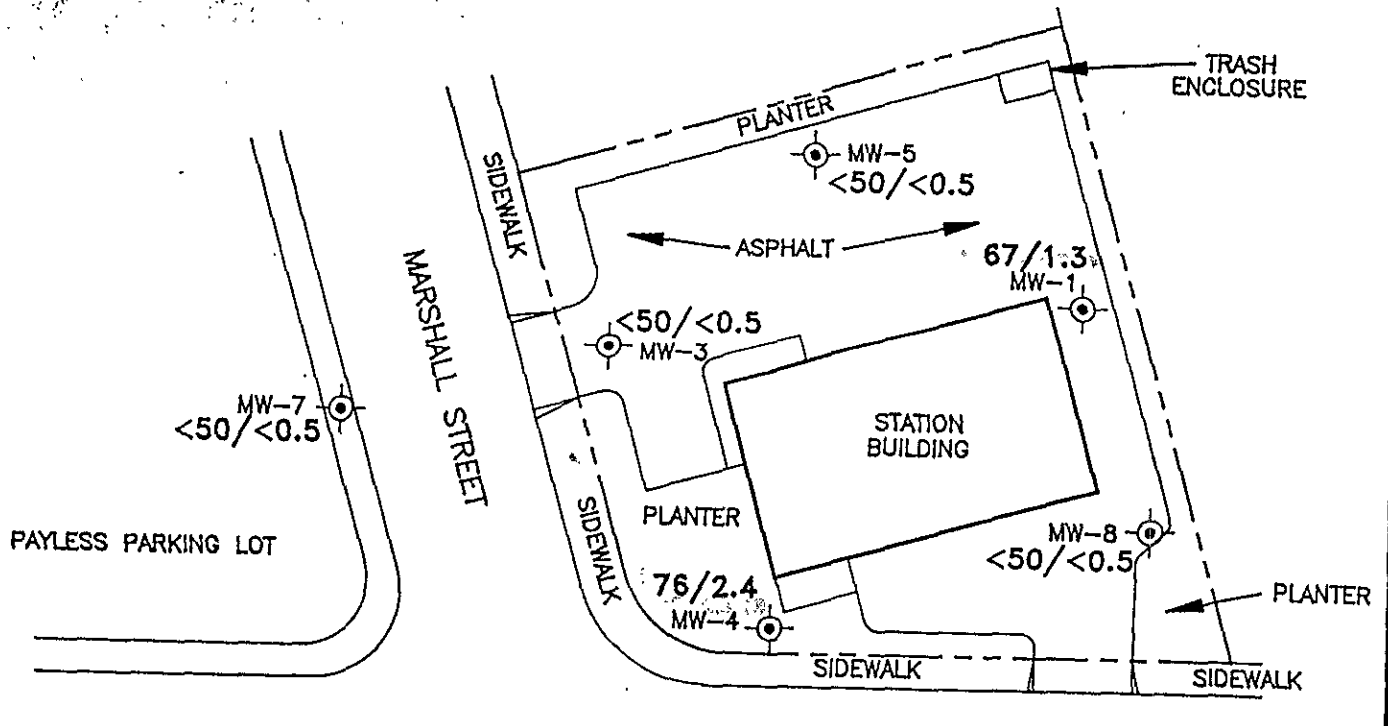

FIGURE 4
 POTENTIOMETRIC SURFACE MAP
 (4/12/90)







CASTRO VALLEY BOULEVARD

<50/<0.5
MW-6

LEGEND

- MW-8  GROUNDWATER MONITORING WELL
-  SITE BOUNDARY
-  BUILDING
- 76/2.4 TPHg/BENZENE CONCENTRATION IN GROUNDWATER IN PARTS PER BILLION
- <0.5 NOT DETECTED AT OR ABOVE LABORATORY DETECTION LIMITS



0 20 40
SCALE IN FEET

BASE MAP: SURVEYED BY RON ARCHER
CIVIL ENGINEER, INC.

RESNA

PROJECT NO. F3091.32

TPHg/BENZENE CONCENTRATIONS
IN GROUNDWATER (6/30/92)

FORMER TEXACO SERVICE STATION
3940 CASTRO VALLEY BOULEVARD
CASTRO VALLEY, CALIFORNIA

PLATE

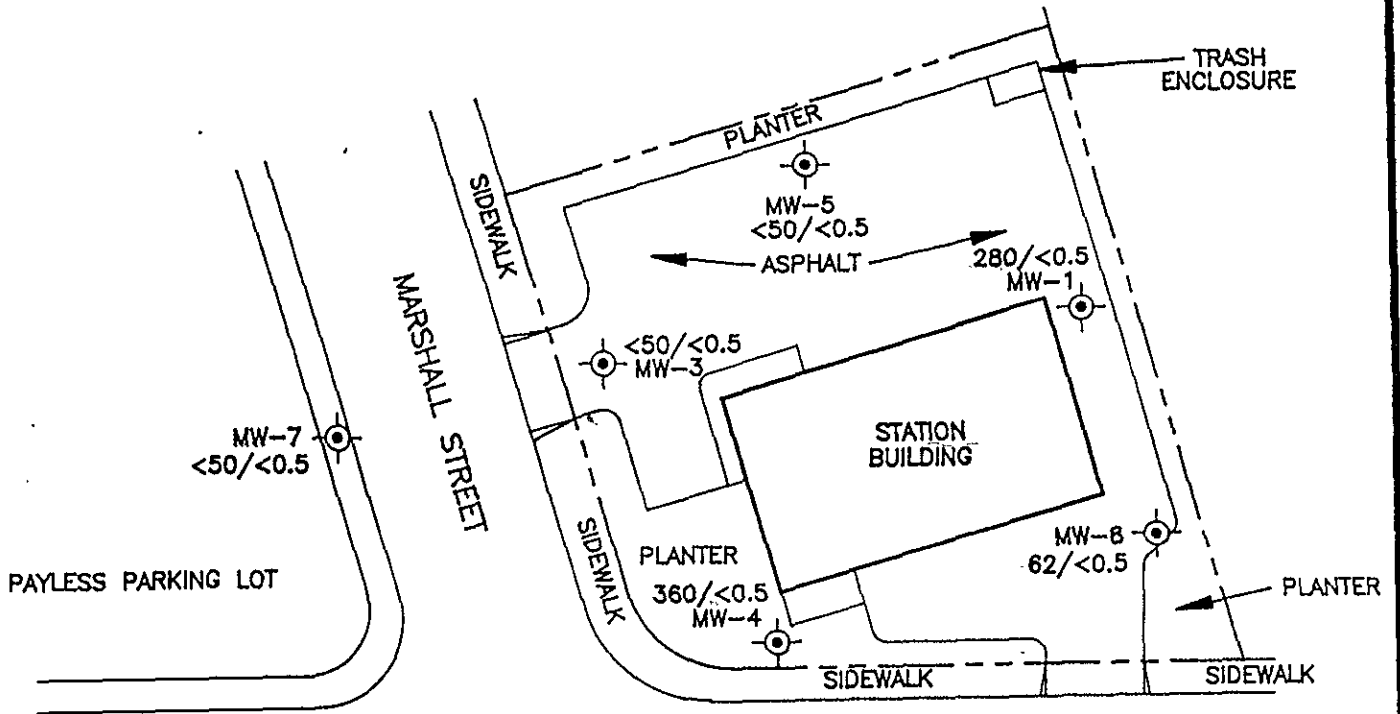

4



CASTRO VALLEY BOULEVARD

<50/<0.5
MW-6

LEGEND

- MW-8  GROUNDWATER MONITORING WELL
-  SITE BOUNDARY
-  BUILDING
- 360/<0.5 TPH_g/BENZENE CONCENTRATION IN GROUNDWATER IN PARTS PER BILLION
- <0.5 NOT DETECTED AT OR ABOVE LABORATORY DETECTION LIMITS

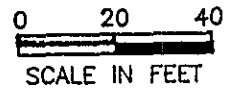

BASE MAP: SURVEYED BY RON ARCHER
CIVIL ENGINEER, INC.

REVIEWED BY:

[Handwritten signature]

**TPH_g/BENZENE CONCENTRATIONS
IN GROUNDWATER (3/30-31/92)**

FORMER TEXACO SERVICE STATION

APPROVED BY:

3940 CASTRO VALLEY BOULEVARD

CASTRO VALLEY, CALIFORNIA

RESNA

JOB #:
3-30091-32

DRAWN BY:
E.C.

DATE:
7/7/92

DRAWING #:
FIG. 5

LEGEND

- ⊙ MONITORING WELL
- () TPH-AS-GASOLINE CONCENTRATION (ppb)
- [] BENZENE CONCENTRATION [ppb]

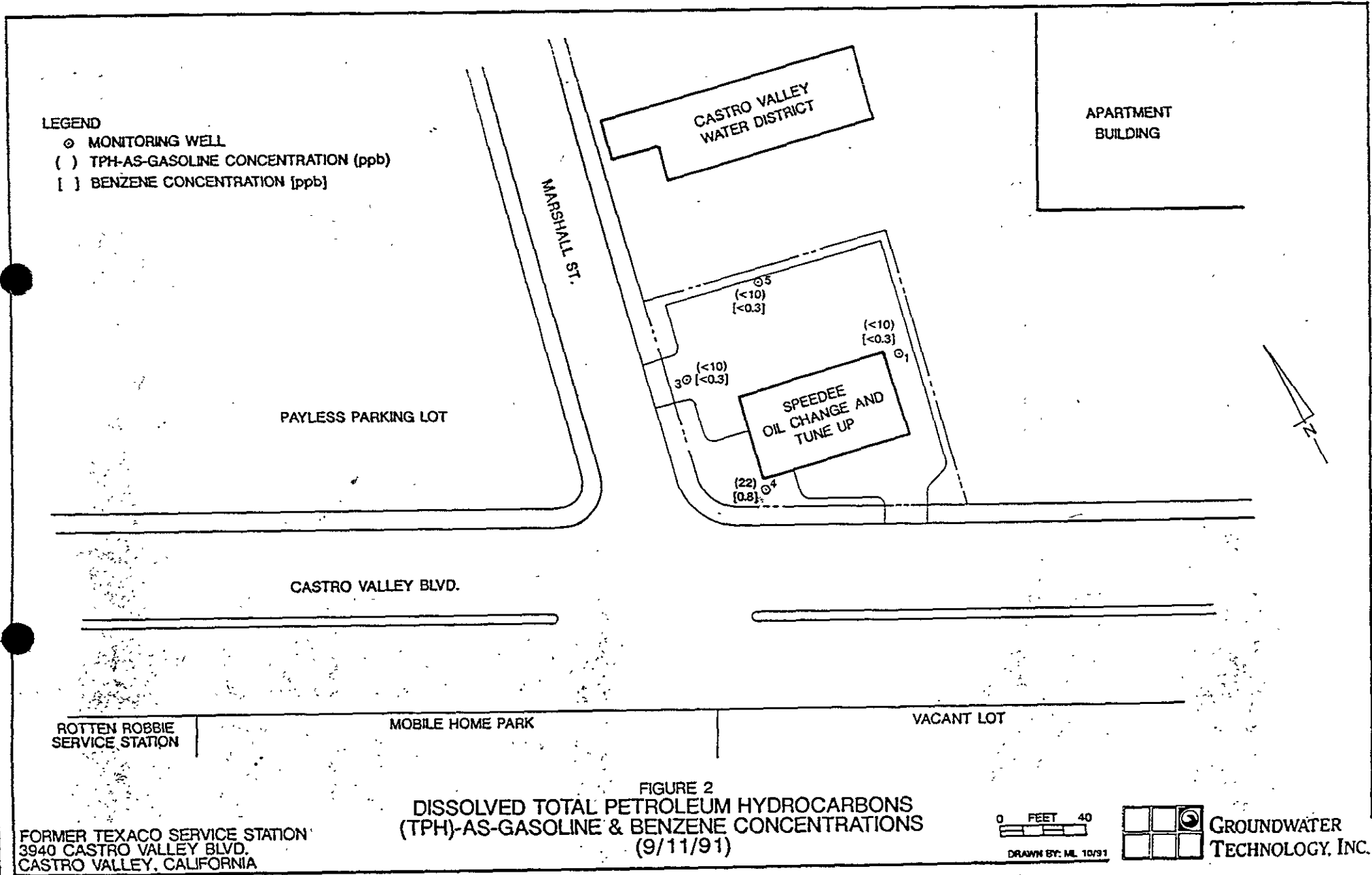

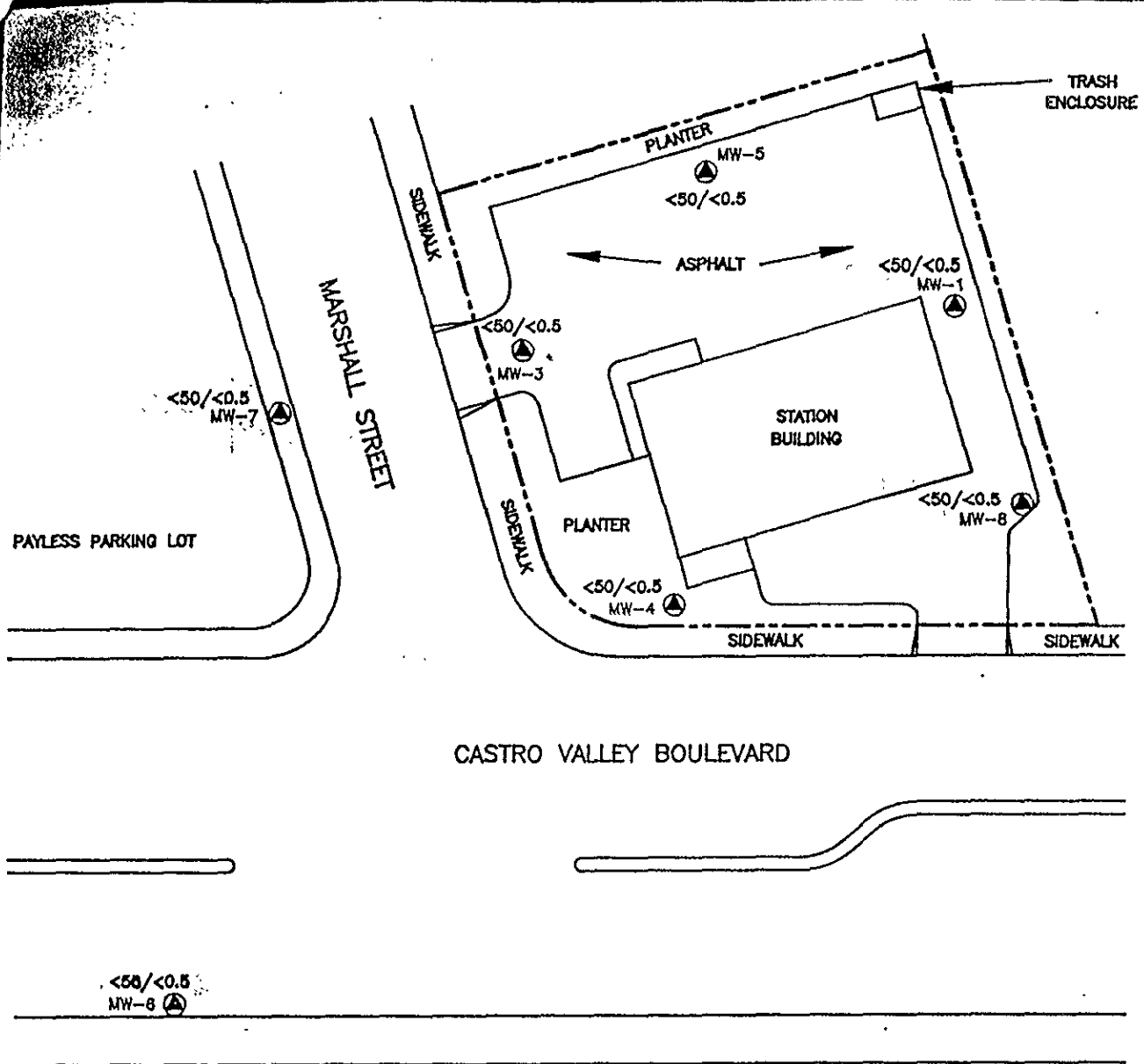

SOURCE : MODIFIED FROM
RESNA DWG.

LEGEND :

- MONITORING WELL LOCATION AND WELL NUMBER
- MW-1

<math><50/<0.5</math> TPH_a/BENZENE CONCENTRATION IN GROUNDWATER (ppb)

| | |
|---|------------------------------|
| TEXACO REFINING AND MARKETING, INC. TEXACO ENVIRONMENTAL SERVICES | |
| PLATE 3 : TPH _a /BENZENE CONCENTRATION IN GROUNDWATER (03/18/1994) | |
| TEXACO SERVICE STATION 3940 CASTRO VALLEY BLVD. / MARSHALL ST., CASTRO VALLEY, CALIFORNIA | |
| SCALE | 1" = 40'-0" |
| LOCATION # | 62-488-0089 |
| DRAWN BY | AMA |
| DATE | 05/01/1994 |
| CHECKED BY | RD |
| DATE | 5/4/94 |
| DRAWING NO. | (CASTRO VALLEY) CV-MA-CV.DWG |

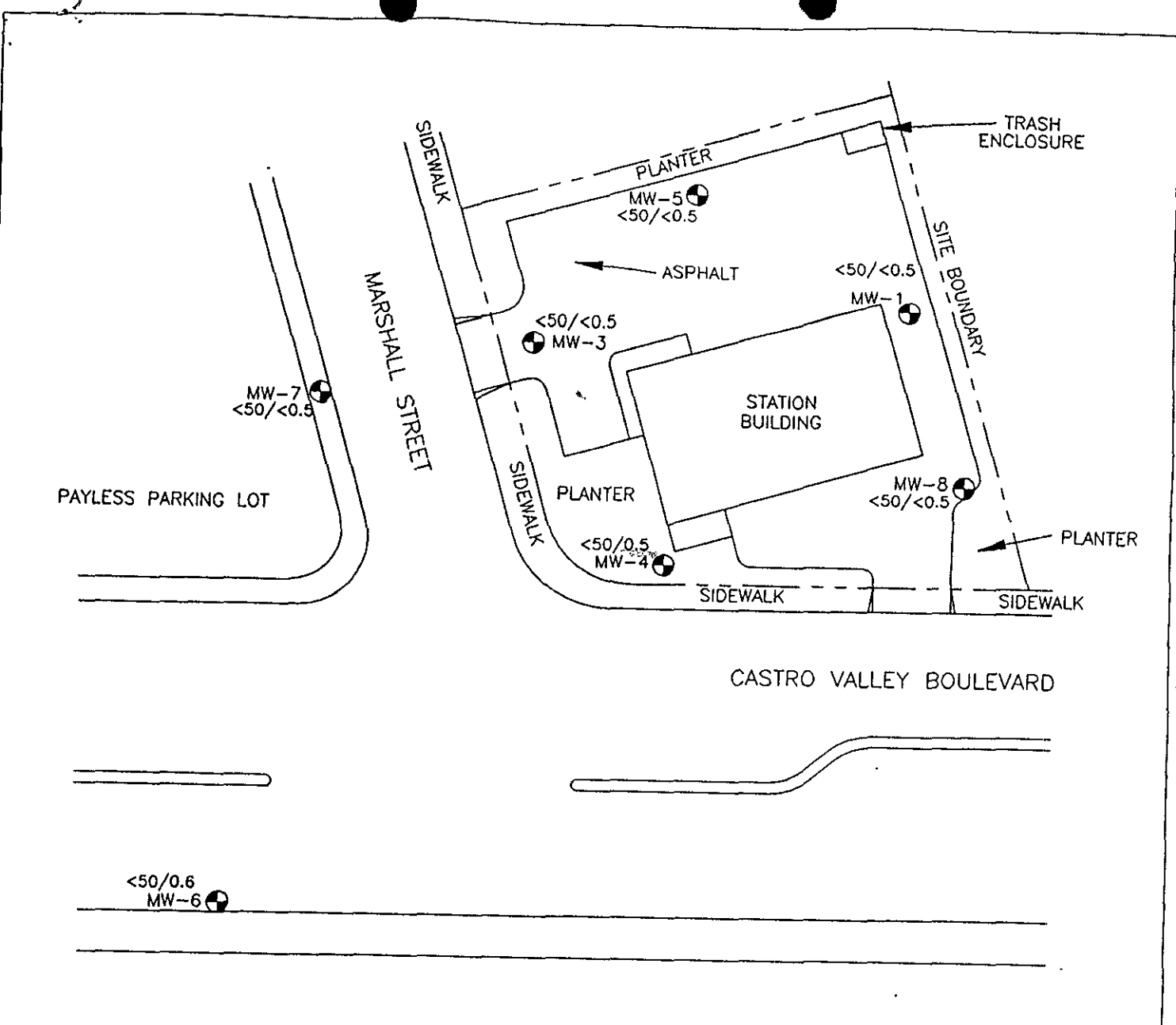

EXPLANATION

- MW-8 = Monitoring Well
- <50/<0.5 = Concentrations of TPHg/Benzene in groundwater in parts per billion, November 16 and 17, 1993

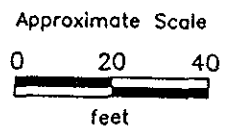

BASE MAP: SURVEYED BY RON ARCHER
CIVIL ENGINEER, INC.



PROJECT 62091.01

TPHg\BENZENE CONCENTRATIONS
IN GROUNDWATER
Former Texaco Station
3940 Castro Valley Boulevard
Castro Valley, California

PLATE
3

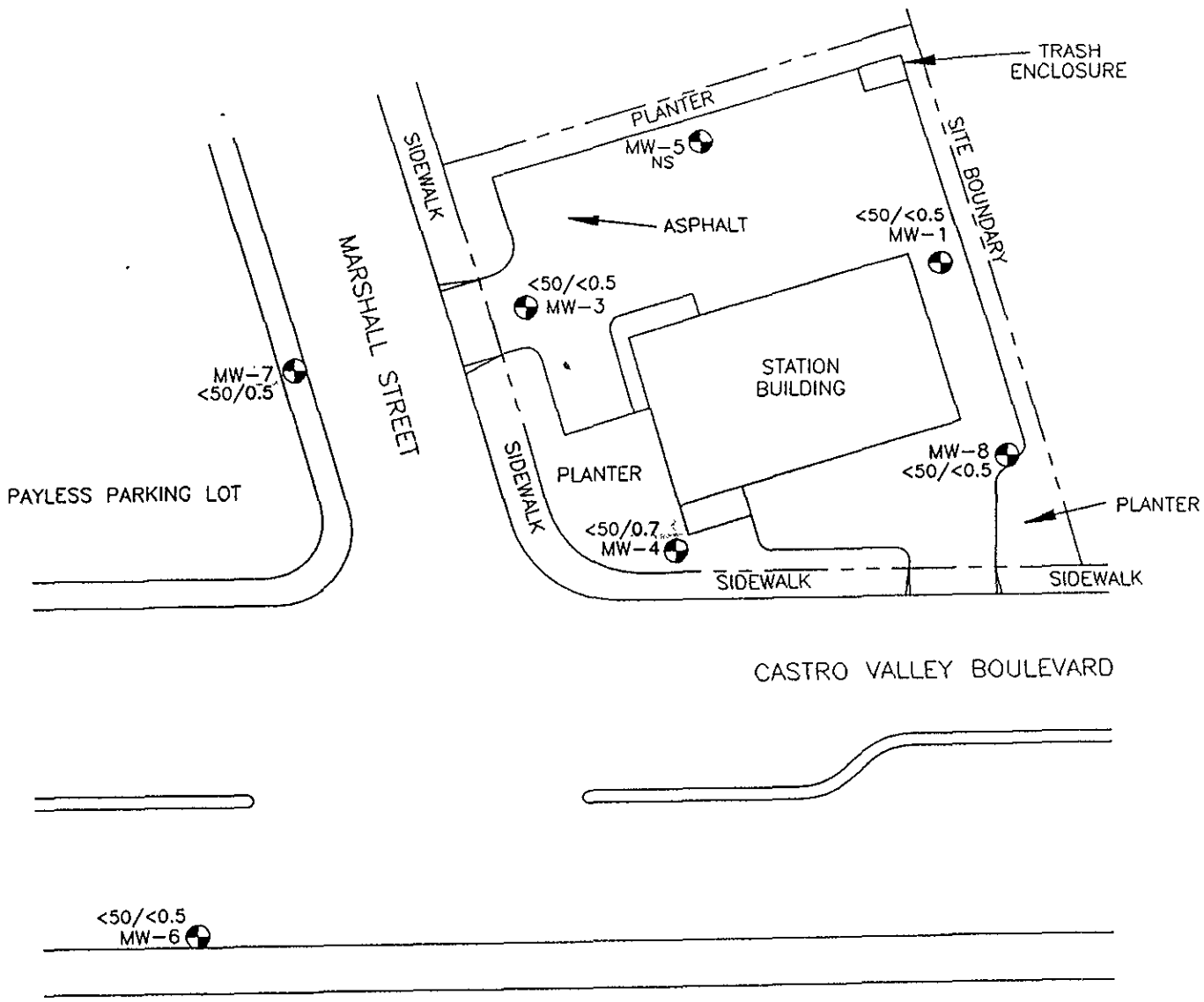

EXPLANATION

MW-8  = Monitoring Well

<50/0.7 = Concentrations of TPHg/Benzene in groundwater in parts per billion, August 24 and 25, 1993

NS = Not sampled (inaccessible)

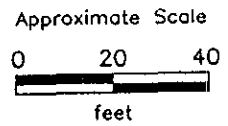

BASE MAP: SURVEYED BY RON ARCHER
CIVIL ENGINEER, INC.

| | | |
|---|--|--------------------|
|  | <p>TPHg\BENZENE CONCENTRATIONS IN GROUNDWATER Former Texaco Station 3940 Castro Valley Boulevard Castro Valley, California</p> | <p>PLATE 3</p> |
| | <p>PROJECT 62091.01</p> | |

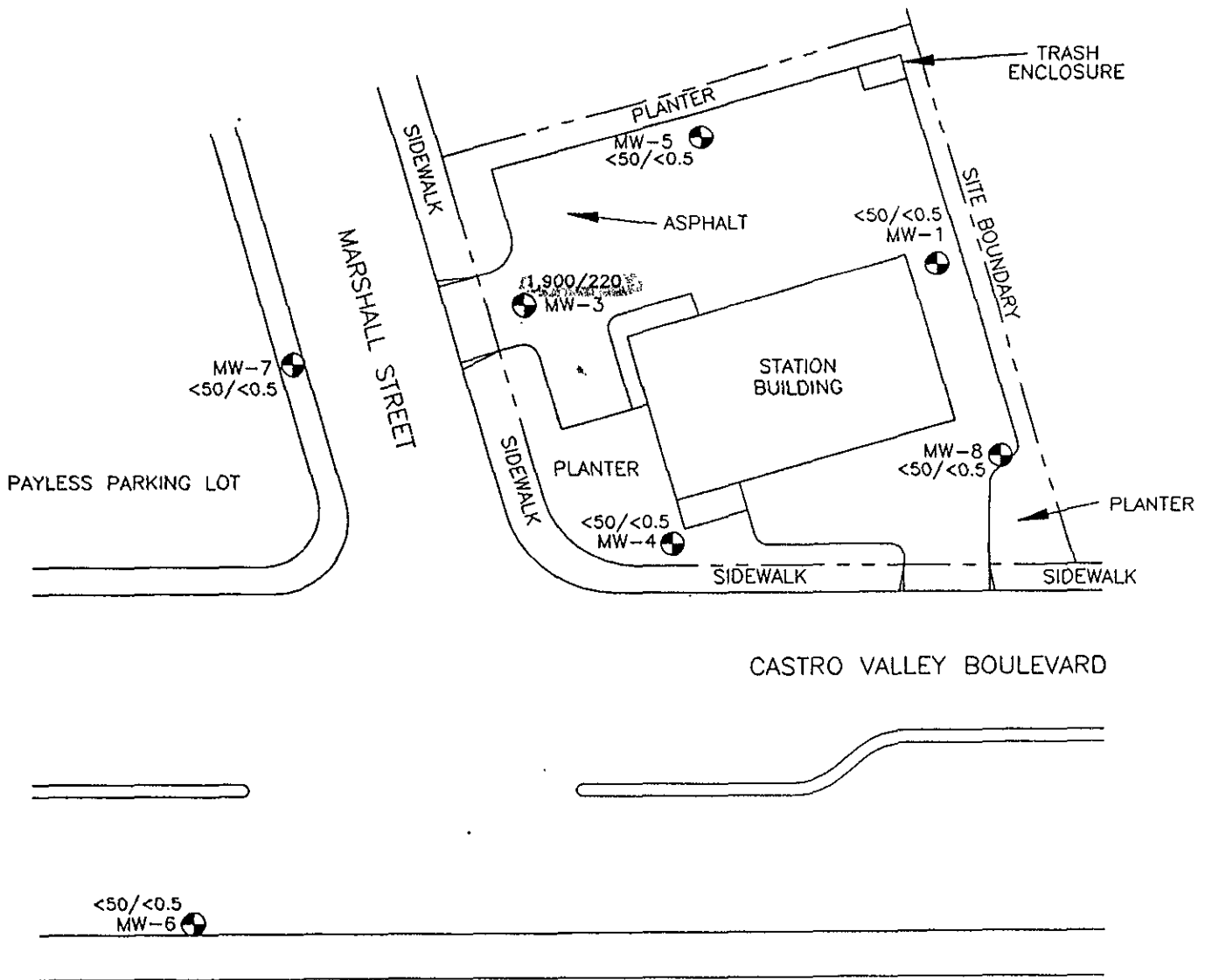

EXPLANATION

MW-8  = Monitoring Well

1,900/220 = TPHg\Benzene concentration in groundwater in parts per billion, June 22 and 23, 1993

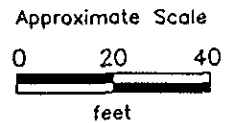

BASE MAP: SURVEYED BY RON ARCHER
CIVIL ENGINEER, INC.

RESNA
Working to Restore Nature

PROJECT 62091.01

**TPHg\BENZENE CONCENTRATIONS
IN GROUNDWATER**
Former Texaco Station
3940 Castro Valley Boulevard
Castro Valley, California

**PLATE
3**

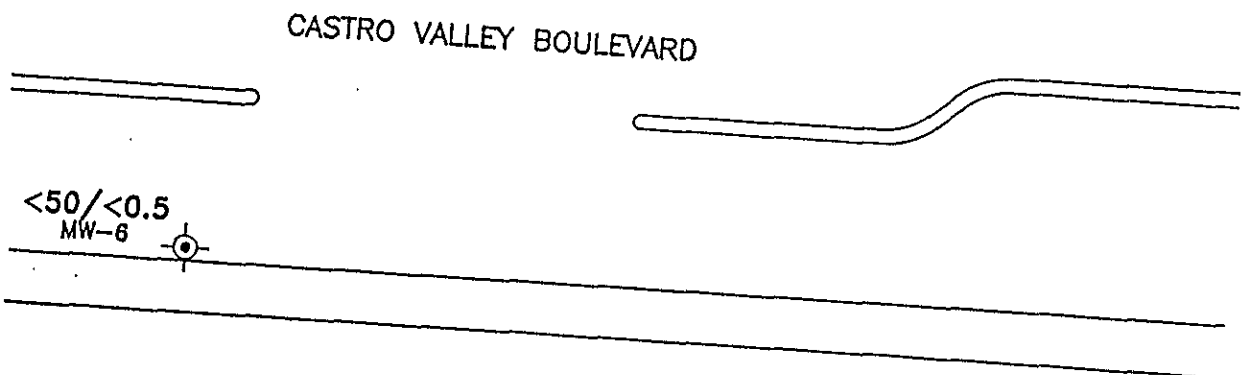
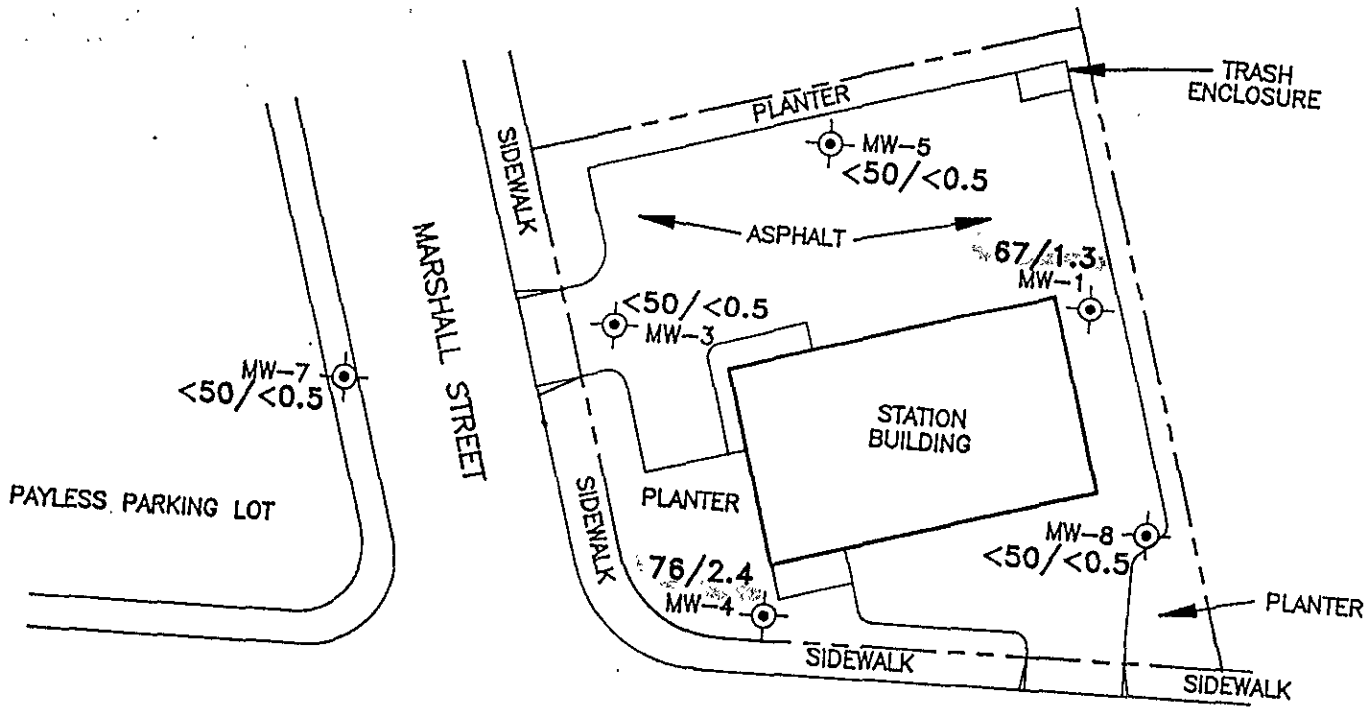

LEGEND

- MW-8 GROUNDWATER MONITORING WELL
- SITE BOUNDARY
- BUILDING
- 76/2.4 TPHg/BENZENE CONCENTRATION IN GROUNDWATER IN PARTS PER BILLION
- <0.5 NOT DETECTED AT OR ABOVE LABORATORY DETECTION LIMITS

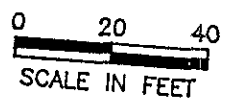

BASE MAP: SURVEYED BY RON ARCHER CIVIL ENGINEER, INC.

| | | | |
|----------------------|--|--|----------------|
| RESNA | TPHg/BENZENE CONCENTRATIONS IN GROUNDWATER (6/30/92) | | PLATE 4 |
| | FORMER TEXACO SERVICE STATION | | |
| | 3940 CASTRO VALLEY BOULEVARD | | |
| | CASTRO VALLEY, CALIFORNIA | | |
| PROJECT NO. F3091.32 | | | |

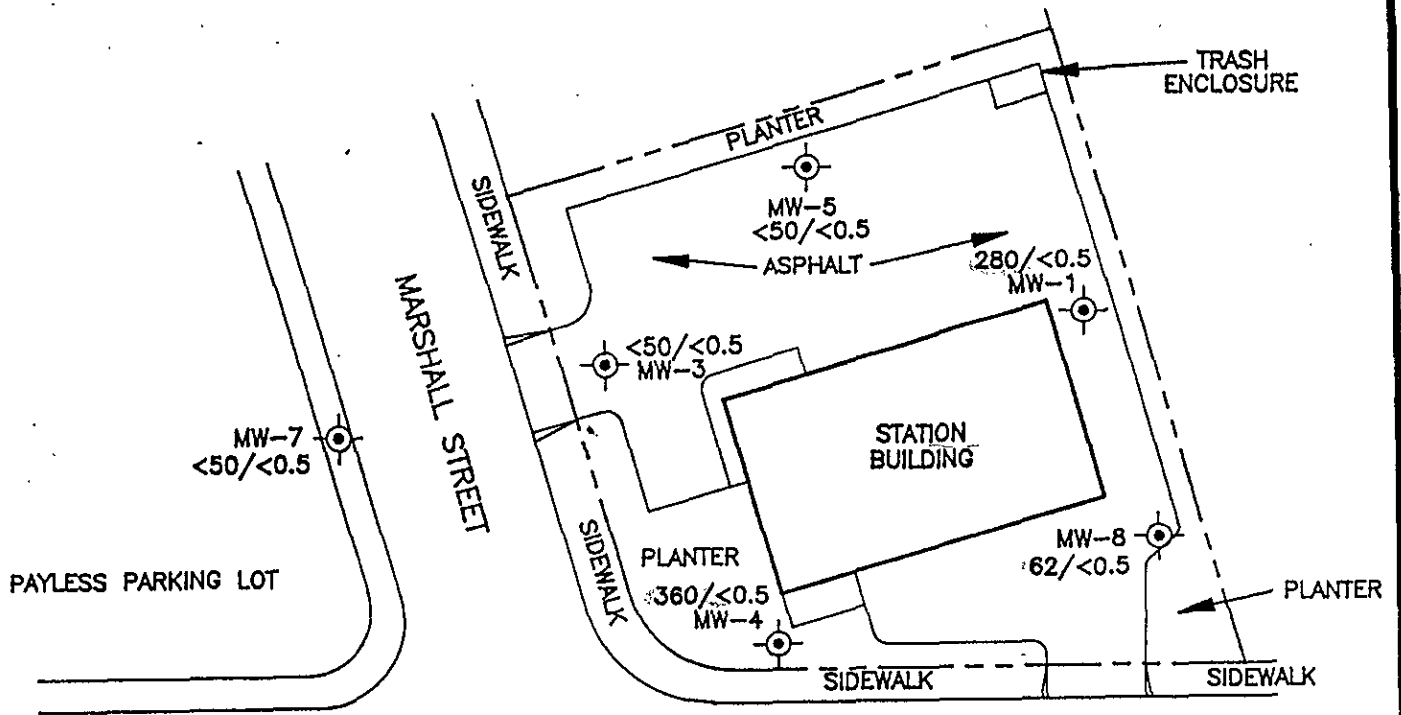

CASTRO VALLEY BOULEVARD

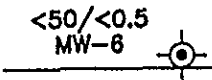

LEGEND

- MW-8 GROUNDWATER MONITORING WELL
- SITE BOUNDARY
- BUILDING
- 360/<0.5 TPHg/BENZENE CONCENTRATION IN GROUNDWATER IN PARTS PER BILLION
- <0.5 NOT DETECTED AT OR ABOVE LABORATORY DETECTION LIMITS



BASE MAP: SURVEYED BY RON ARCHER, CIVIL ENGINEER, INC.

REVIEWED BY:

[Handwritten Signature]

**TPHg/BENZENE CONCENTRATIONS
IN GROUNDWATER (3/30-31/92)**

FORMER TEXACO SERVICE STATION

RESNA

APPROVED BY:

3940 CASTRO VALLEY BOULEVARD

JOB #:
3-30091-32

DRAWN BY:
E.C.

CASTRO VALLEY, CALIFORNIA

DATE:
7/7/92

DRAWING #:
FIG. 5

LEGEND

- MONITORING WELL
- () TPH-AS-GASOLINE CONCENTRATION (ppb)
- [] BENZENE CONCENTRATION [ppb]

MARSHALL ST.

CASTRO VALLEY
WATER DISTRICT

APARTMENT
BUILDING

PAYLESS PARKING LOT

SPEEDEE
OIL CHANGE AND
TUNE UP

CASTRO VALLEY BLVD.

ROTTEN ROBBIE
SERVICE STATION

MOBILE HOME PARK

VACANT LOT

FORMER TEXACO SERVICE STATION
3940 CASTRO VALLEY BLVD.
CASTRO VALLEY, CALIFORNIA

FIGURE 2
DISSOLVED TOTAL PETROLEUM HYDROCARBONS
(TPH)-AS-GASOLINE & BENZENE CONCENTRATIONS
(9/11/91)



GROUNDWATER
TECHNOLOGY, INC.

