

ARTESIAN ENVIRONMENTAL

General Engineering Contracting License 622461: A, B, C-57, Haz., Ash.
229 Tewksbury Ave., Pt. Richmond, CA 94801

Telephone (510) 307-9943 • Facsimile (510) 232-2823 • e-mail: augerpro@aol.com

Phase I Environmental Assessments • Limited Access Drilling • Asbestos and Lead Inspections
Remediations Tank Removals • Potentially Responsible Party Studies • Subsurface Investigations • EIRs

FACSIMILE TRANSMISSION

TO: Ms. Eva Chu FAX: (510) 337-9355

DATE: 4/19/99 JOB #: 378-002-02

FROM: Paul Jones TOTAL SHEETS: 3

MESSAGE: RE: Albany High School Phase II
Groundwater Analytical Results &
Groundwater Flow Map.

As we suspected, the initial flow direction was inaccurate because more than 48 hours is required for some sampling points at this site to stabilize. It does not appear that further borings are necessary. PATTs were all ND - other sample results summarized in following spreadsheet. I will continue preparing the phase II Report. Please call w/ questions or comments. Thanks

NOTES: If you did not receive the complete transmission, please call. This fax is privileged and confidential. If you are not an intended recipient, you are notified that any disclosure, dissemination or duplication of this fax is not authorized, and no waiver of any privilege or confidentiality is intended by your receipt of this transmission

TABLE 4: GROUNDWATER SAMPLE RESULTS

Albany Unified School District
603 Key Route Boulevard
Albany, California

Sample Location	Sample Date	TOG mg/L	TPH-d µg/L	TPH-g µg/L	Benzene µg/L	Toluene µg/L	Ethylbenzene µg/L	Xylenes µg/L	MTBE µg/L
SB-1	3-31-99	ND	61	ND	ND	ND	ND	ND	ND
SB-2	3-31-99	ND	ND	ND	ND	ND	ND	ND	ND
SB-3	3-31-99	ND	810	100	ND	ND	ND	0.74	ND
SB-4	4-1-99	NA*	150	NA	ND	0.69	ND	1.20	ND
SB-5	4-1-99	ND	180	NA	ND	1.10	0.73	6.30	ND
SB-6	4-1-99	NA*	98	NA	ND	1.00	ND	2.20	ND
SB-7	4-1-99	ND	ND	NA	ND	0.95	67.00	5.60	ND

Sample Location	Sample Date	Alk mg/L	Nitrate mg/L	Sulfate mg/L	CO2 mg/L
SB-1	3-31-99	350	24	130	11
SB-2	3-31-99	290	9	69	33
SB-3	3-31-99	590	ND	17	95
SB-4	4-1-99	NA	NA	NA	NA
SB-5	4-1-99	330	9	86	31
SB-6	4-1-99	NA	NA	NA	NA
SB-7	4-1-99	350	35	143	44

NOTES:

Alk	Total Alkalinity	mg/L	milligrams per liter (ppm)
CO2	Carbon Dioxide	µg/L	micrograms per liter (ppb)
TPH-g	Total Petroleum Hydrocarbons as gasoline	ND	Not Detected (above method reporting limit)
TPH-d	Total Petroleum Hydrocarbons as diesel	NA	Not Analyzed
MTBE	Methyl Tertiary Butyl Ether	*	Location did not Produce a Sufficient Quantity of Water for this Analysis

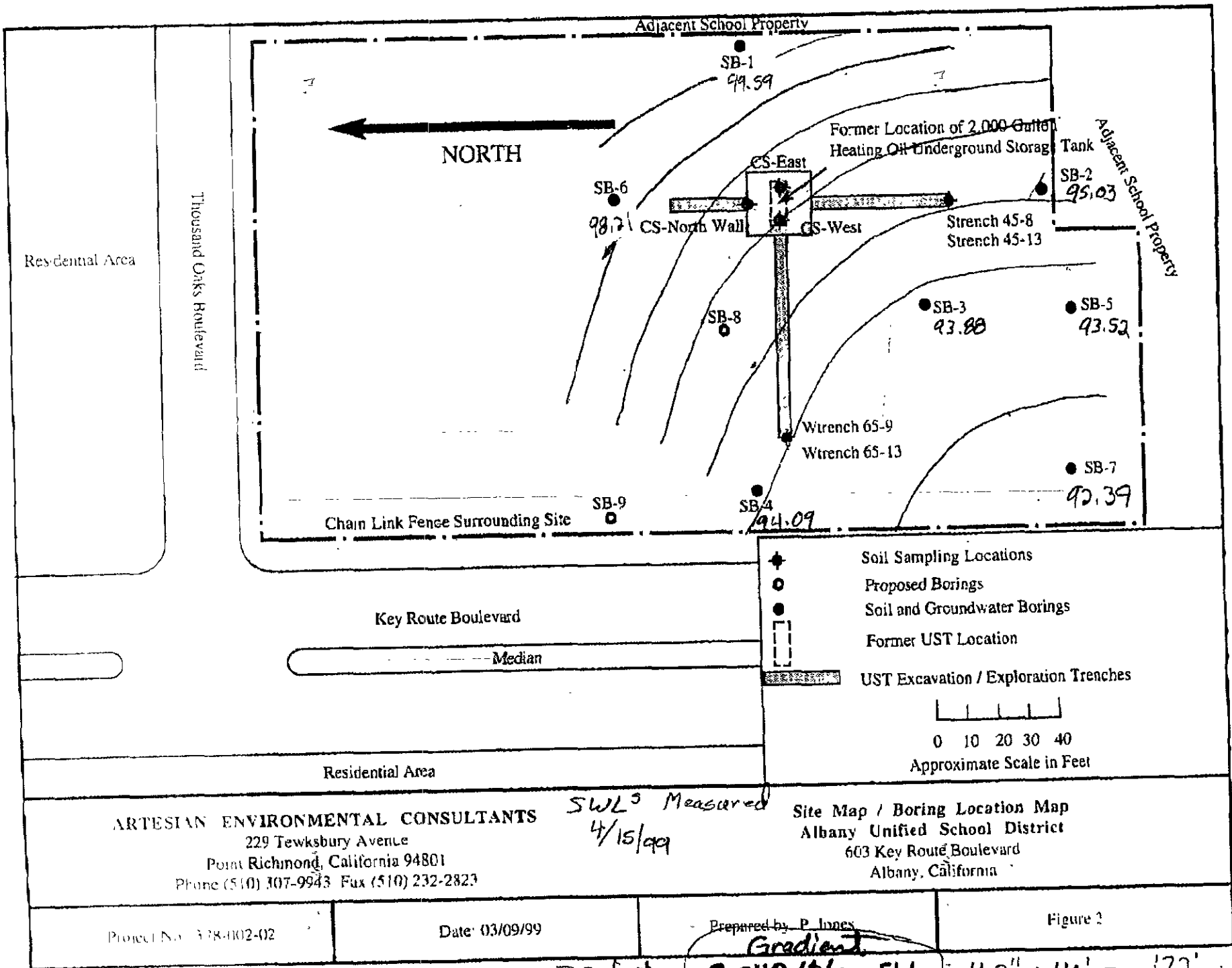

Project No. 378-002-02

Date: 03/09/99

Prepared by: P. Innes

Figure 2

SWE Difference SB-1 to SB-7 7.2 feet = 0.042 ft/ft SW 7.3" x 40' = 172'