

2-2-98

FEDERAL
POSTAL SERVICE

Dear Ms. Evansi

Enclosed is a copy of a letter from Dale Klettke after he reviewed all of our paper work and reports - where is our files? Tank #1 was closed about 5 years ago. The back property was tested and now there are homes. We are anxious to receive our final papers. It has been so long -

Sincerely

Dianne Fukushima

wak: 510-463-7962 - Pleasanton
Dianne Court.

ALAMEDA COUNTY
HEALTH CARE SERVICES

AGENCY
DAVID J. KEARS, Agency Director



January 30, 1998

Hiroshi Fukushima
1301 Hilliker Place
Livermore CA 94550

ENVIRONMENTAL HEALTH SERVICES
1431 Harbor Bay Parkway, Suite 250
Alameda, CA 94502-6577
(510) 567-6700
(510) 337-9335 (FAX)

RE: Information Needed for Case Closure
Former Hiro's Nursery, 1630 162nd Ave., San Leandro (our site # 1361)

Dear Mr. Fukushima:

I have recently been assigned responsibility for the tank closure case at the former Hiro's Nursery in San Leandro. I have a few questions about the site. I had hoped to get the information from you by telephone, but I have not been able to reach you. Your former consultant at ALFA Environmental was able to give me some information. Here are my remaining questions:

- 1) The file contains a site diagram that is not attached to or explained by any report from your consultants. This diagram contains handwritten notes listing high petroleum contaminant levels. I do not know the date or origin of this information. Can you provide information about this document? A copy of the diagram is enclosed.
- 2) What is the current use and configuration of the property? Are the residences that existed in the early 90's still onsite? Have any new residences or other buildings been constructed there? If so, where are the new buildings situated on the property? This information is especially relevant if the benzene levels described on the diagram referred to above remain at the site.
- 3) Other "tanks" besides the removed fuel tanks are shown in site diagrams in your file. I suspect that these are (or were) above ground pesticide mix or other storage tanks. A diagram is enclosed. Can you tell me more about these tanks?

I can meet with you to go over the file documents, get information from you by fax or telephone, or receive your written response by mail. Please call me at 567-6770 so that I can complete my review of your case.

Sincerely,

Pamela J. Evans
Senior Hazardous Materials Specialist

Enclosure

ALAMEDA COUNTY
HEALTH CARE SERVICES



AGENCY
DAVID J. KEARS, Agency Director

STID 1361

November 14, 1996

Mr. Hiro Fukushima
1301 Hilliker Place
Livermore, CA 94550

ENVIRONMENTAL HEALTH SERVICES
ENVIRONMENTAL PROTECTION (LOP)
1131 Harbor Bay Parkway, Suite 250
Alameda, CA 94502-6577
(510) 567-6700
FAX (510) 337-9335

RE: HIRO'S NURSERY, 1630 162ND AVENUE, SAN LEANDRO, ASN 80-63-26 LOT 15

Dear Mr. Fukushima:

I am in receipt of and have completed review of the November 6, 1996 Alpha Environmental Remediation Services (AERS) stockpiled soil and excavation pit groundwater sampling results.

Laboratory results of the soil and groundwater samples revealed non-detectable concentrations of total petroleum hydrocarbons as gasoline (TPHg) and the aromatic compounds benzene, toluene, ethyl benzene and total xylenes (BTEX), in both the soil and groundwater samples.

AERS has requested that the stockpiled soils be reintroduced as backfill into the former excavation. In addition, it is my understanding that the groundwater which has accumulated in the excavation will be pumped before the pit is backfilled.

Use of the stockpiled soils as backfill into the former excavation is approved. In addition, please provide this office with documentation for the final disposal of excavation pit water.

Please call me at 510/567-6880 should you have any questions.

Sincerely,

Dale Klettke, CHMM
Hazardous Materials Specialist

c Valentin Constantinescu, ALFA Environmental Remediation Services, P O Box 1630,
Pleasanton, CA 94566
Mike Bakaldin, San Leandro Hazardous Materials Program
Dale Klettke--files

bc
1361back.nl



PRIORITY ENVIRONMENTAL LABS

Precision Environmental Analytical Laboratory

November 01, 1996

PEL # 9610063

ALFA ENVIRONMENTAL, INC.

Attn: Valentin Constantinescu

Re: One water and one composited soil sample for Gasoline/BTEX analysis.

Project name: Hiro

Date sampled: Oct 31, 1996

Date submitted: Oct 31, 1996

Date extracted: Oct 31-Nov 01, 1996

Date analyzed: Oct 31-Nov 01, 1996

RESULTS:

SAMPLE I.D.	Gasoline (ug/L)	Benzene (ug/L)	Toluene (ug/L)	Ethyl Benzene (ug/L)	Total Xylene (ug/L)
-------------	-----------------	----------------	----------------	----------------------	---------------------

GWS Detection Limit	N.D.	N.D.	N.D.	N.D.	N.D.
Method of Analysis	50	0.5	0.5	0.5	0.5
	5030 / 8015	602	602	602	602

SAMPLE I.D.	Gasoline (mg/Kg)	Benzene (ug/Kg)	Toluene (ug/Kg)	Ethyl Benzene (ug/Kg)	Total Xylene (ug/Kg)
-------------	------------------	-----------------	-----------------	-----------------------	----------------------

S 1,2,3,4	N.D.	N.D.	N.D.	N.D.	N.D.
-----------	------	------	------	------	------

Blank Spiked Recovery	N.D.	N.D.	N.D.	N.D.	N.D.
Detection limit	87.3%	84.7%	112.6%	83.5%	87.7%
Method of Analysis	1.0	5.0	5.0	5.0	5.0
	5030 / 8015	8020	8020	8020	8020

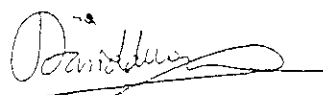
 David Duong
 Laboratory Director

NON-HAZARDOUS WASTE MANIFEST

1. Generator's US EPA ID No.

2. Page 1 of 1

3. Document Number

NH- No 43359

4. Generator's Name and Mailing Address

HIRO FUKUSHIMA
1630 162ND AVE
SAN LEANDRO, CA
Generator's Phone 510 888 1666

Profile #

5. Transporter Company Name

Clearwater Environmental Management Inc.

US EPA ID Number

CA200007013

7. Transporter Phone

510-797 8511

8. Designated Facility Name and Site Address

~~McKittick Waste Treatment Site~~
~~36533 Hwy 58, West~~
~~McKittick, CA 93251~~

9. US EPA ID Number

~~CA080636831~~

10. Facility's Phone

~~805-762-7366~~

11. Waste Shipping Name and Description

a. NON HAZARDOUS WASTE LIQUID

12. Containers

No. Type

001 TI 400

13. Total Quantity

14. Unit Wt/Vol

G

15. Special Handling Instructions and Additional Information

Wear Protective Gear
Emergency contact
510-797 8511

Handling Codes for Wastes Listed Above

11a.

11b.

16. GENERATOR'S CERTIFICATION: I certify the materials described above on this manifest are not subject to state or federal regulations for reporting proper disposal of Hazardous Waste.

Printed/Typed Name

HIRO FUKUSHIMA

Signature

Hiro Fukushima

Month Day Year

17. Transporter Acknowledgement of Receipt of Materials

Printed/Typed Name

Steven R. Stone

Signature

Steven R. Stone

Month Day Year

03 28 97

18. Discrepancy Indication Space

Alternate facility
~~Morton Recycling~~
~~830 Basic School Rd~~
~~Manopoga, CA 93252~~
~~805-767-8135~~

ALVISO Independent Oil
5002 Anchen Street
ALVISO, CA 95002
408-262-2715

19. Facility Owner or Operator: Certification of receipt of waste materials covered by this manifest except as noted in Item 18.

Printed/Typed Name

Brandon Hayward

Signature

Brandon Hayward

Month Day Year

4 8 97

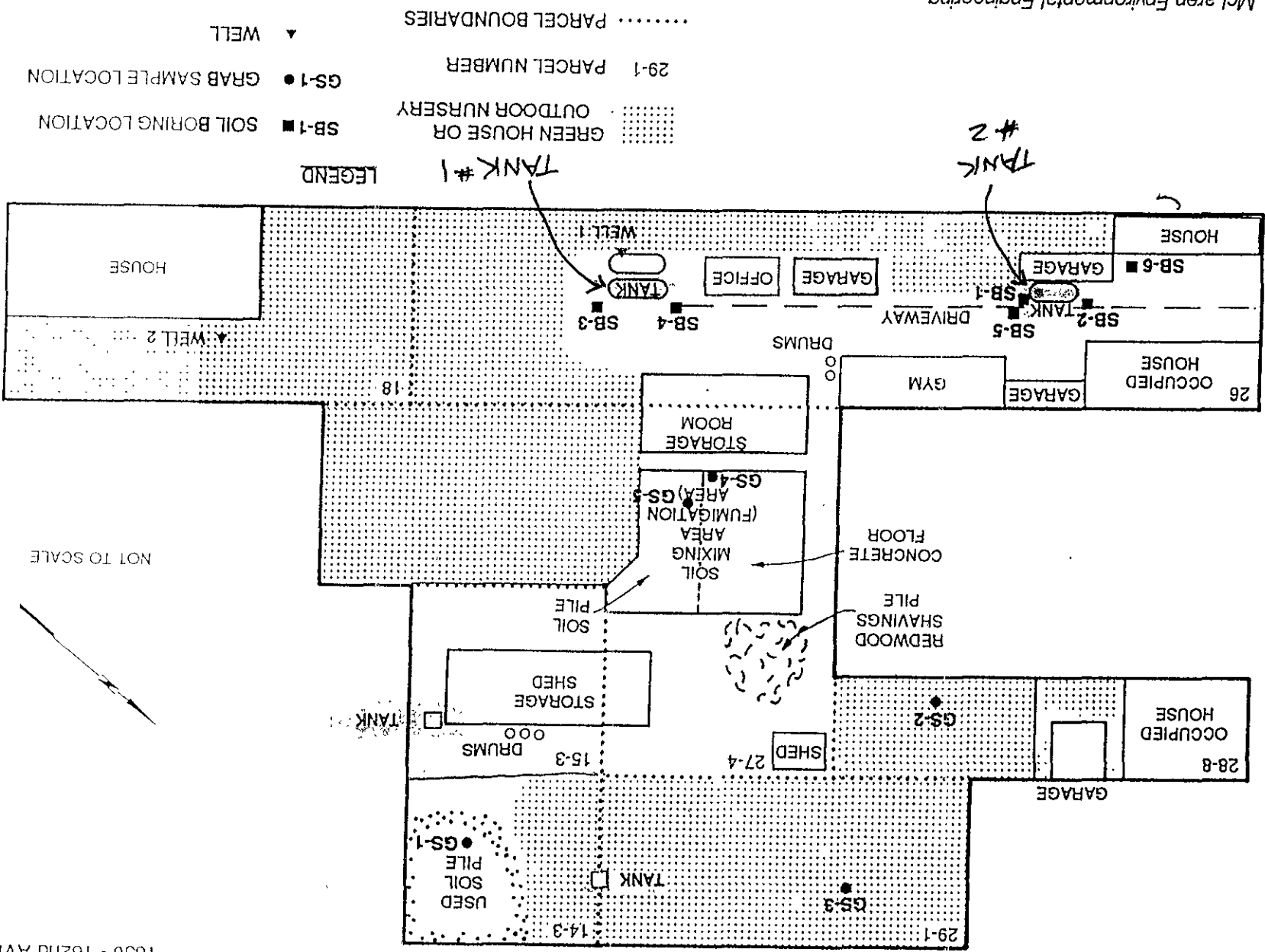

NOT TO SCALE

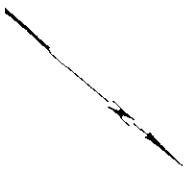

163rd AVENUE

162nd AVENUE

FIGURE 2
SOIL BORING AND
GRAB SAMPLE LOCATIONS
1630 - 162nd AVENUE

162nd Street

EXHIBIT 'A'

