

ALAMEDA COUNTY  
HEALTH CARE SERVICES

AGENCY  
DAVID J. KEARS, Agency Director



DEPARTMENT OF ENVIRONMENTAL HEALTH  
Hazardous Materials Program  
80 Swan Way, Rm. 200  
Oakland, CA 94621  
(415)

Certified Mailer #:P 062 128 183

May 11, 1990

Mr. Don Anderson  
Almar Ltd. Marina  
1150 Ballena Blvd.  
Alameda, California 94501

Re: Requirements for Obtaining 5-Year Operating Permits for  
Underground Storage Tanks at Ballena Isle Marina, 1150 Ballena  
Blvd., Alameda, CA

Dear Mr. Anderson:

The following information must be submitted to our office before we will issue five-year operating permits for underground storage tanks (both existing tanks and proposed replacement tanks) at Ballena Isle Marina. Per Section 25284 (a) of the California Health and Safety Code, no person shall operate an underground storage tank unless a permit for its operation has been issued by the local agency.

**For all tanks:**

- \* Up-dated underground storage tank permit applications. Copies of these applications are enclosed. One Part A form must be completed per facility (for each business address); one Part B form must be completed for each underground tank at each facility.

**For all existing tanks installed before 1984:**

- 1) Documentation of selection and implementation of a monitoring alternative per California Code of Regulations Title 23 Sections 2640 through 2648.

Copies of the underground storage tank rules and regulations (California Code of Regulations Title 23 and the California Health and Safety Code) may be obtained from the following office:

California State Water Resources Control Board  
P.O. Box 944212  
Sacramento, California 94244  
(916) 739-4436  
Attn: David Holtry

Page 2 of 2  
Mr. Don Anderson  
Ballena Isle Marina  
May 11, 1990

**For the proposed 12,000 gallon replacement tanks:**

- 1) Tank and piping as-builts;
- 2) A written routine tank monitoring procedure per Title 23, Section 2632 (c) and (d)(1); and
- 3) A written response plan per Title 23, Section 2632 (d)(2).

Should you have any questions, please feel free to contact me at (415) 271-4320.

Sincerely,



Katherine Chesick,  
Senior Hazardous Materials Specialist

enclosures

cc: Mr. David Cottle, Cottle Engineering  
Mr. Brian Eychler, Majors Engineering, Inc.  
Gil Jensen, Alameda County District Attorney, Consumer and  
Environmental Protection Division  
Rafat A. Shahid, Alameda County Environmental Health  
Department  
Files

PLUMBING & MECHANICAL PLANS

APPROVED ALAMEDA COUNTY HEALTH CARE SERVICES AGENCY

DEPARTMENT OF ENVIRONMENTAL HEALTH

HAZARDOUS MATERIALS DIVISION

80 SWAN WAY, ROOM 200

OAKLAND, CA 94621

PHONE NO. 415/271-4320

DATE 6-7-90

BY: Donald J. Rodriguez

Donald J. Rodriguez, Sr. Plba. & Mech. Insp.

THE DEPARTMENT DOES NOT WITHDRAW REMOVAL OF ALL UNDERGROUND TANKS AND ALAMEDA COUNTY REGULATIONS

DATE 5-17-90

ALSO REFERENCED

56885  
4-12-90  
558

ACCEPTED

DEPARTMENT OF ENVIRONMENTAL HEALTH  
470 - 27th Street, Third Floor  
Oakland, CA 94612  
Telephone: (415) 874-7237

These plans have been reviewed and found to be acceptable and essentially meet the requirements of State and local health laws. Changes to your plans indicated by this Department are to bring into compliance with State and local health laws. The project described herein is now released for issuance of a permit and building permits for construction.

These approved plans must be on the job and followed by all contractors and craftsmen involved with the removal, installation or alterations of these plans and specifications. The Department is not responsible for determining if such plans meet the requirements of State and local laws. The Department is not responsible for determining if such plans meet the requirements of State and local laws. The Department is not responsible for determining if such plans meet the requirements of State and local laws.

- Removal of Tank and Piping
- Sampling
- Final Inspection

Obtaining of a permit to operate is dependent on compliance with accepted plans and all applicable laws and regulations.

THERE IS A FINANCIAL PENALTY FOR NOT OBTAINING THESE INSPECTIONS.

K. Cherek 5/9/90

UNDERGROUND TANK CLOSURE/MODIFICATION PLANS

1. Business Name Ballena Isle Marina  
Business Owner Almar Ltd. Marina
2. Site Address 1150 Ballena Blvd.  
City Alameda Zip 94501 Phone 523-5528
3. Mailing Address 1150 Ballena Blvd.  
City Alameda Zip 94501 Phone 523-5528
4. Land Owner Almar Ltd. Marina  
Address 1150 Ballena Blvd. City, State Alameda, CA Zip 94501
5. EPA I.D. No. CAC 000270289
6. Contractor Cottle Engineering  
Address P.O. Box 163  
City Antioch Phone 754-9985  
License Type A ID# 481444
7. Consultant N/A

REC'D MAY 15 1990

CENTRAL PERMIT OFFICE CITY OF ALAMEDA

ALL WORK MUST BE INSPECTED BY THE PLUMBING/MECHANICAL DIVISION. Call 748-4563 8:30 AM to 10:00 AM 24 Hours in Advance

RECEIVED JUN 10 1990 TECH ANALYSIS, INC.

8. Contact Person for Investigation

Name Don Anderson Title project manager  
Phone 523-5528

9. Total No. of Tanks at facility 2

10. Have permit applications for all tanks been submitted to this office?  
Yes [  ] No [  ]

11. State Registered Hazardous Waste Transporters/Facilities

a) Product/Waste Tranporter

Name Hydro Tech EPA I.D. No. <sup>CAD</sup> 982411571  
Address 805 Port Chicago Hwy  
City Pittsburg State CA Zip 94565

b) Rinsate Transporter

Name Hydro Tech EPA I.D. No. <sup>CAD</sup> 982411571  
Address 805 Port Chicago Hwy  
City Pittsburg State CA Zip 94565

c) Tank Transporter

Name Hydro Tech EPA I.D. No. CAD 982411571  
Address 805 Port Chicago Hwy  
City Pittsburg State CA Zip 94565

d) Tank Disposal Site

Name H & H Ship Service EPA I.D. No. cad004771168  
Address P.O. Box 77363  
City San Francisco State CA Zip 94107

e) Contaminated Soil Transporter

Name Hydro Tech EPA I.D. No. <sup>CAD</sup> 982411571  
Address 805 Port Chicago Hwy  
City Pittsburg State CA Zip 94565

12. Sample Collector

Name \_\_\_\_\_  
 Company NET Pacific  
 Address 435 Tesconi Circle  
 City Santa Rosa State CA Zip 95401 Phone 707-526-7200

13. Sampling Information for each tank or area

Tank or Area		Material sampled	Location & Depth
Capacity	Historic Contents (past 5 years)		
1) 12,000	Gasoline Diesel	4 Soil Samples	one beneath each end of the tanks one per 20 feet of piping one water sample
2) 12,000			

14. Have tanks or pipes leaked in the past? Yes [ ] No [X]  
 If yes, describe. \_\_\_\_\_  
 \_\_\_\_\_

15. NFPA methods used for rendering tank inert? Yes [ ] No [X]  
 If yes, describe. Tanks must be inerted. A minimum of 15 lbs dry ice per 1000 gallons of tank capacity must be put into tanks.  
 An explosion proof combustible gas meter shall be used to verify tank inertness.

16. Laboratories  
 Name NET Pacific  
 Address 435 Tesconi Circle  
 City Santa Rosa State CA Zip 95401  
 State Certification No. 178

*All piping must be flushed or 3 - drained into tanks before tanks pumped and inerted. Piping must then be removed or capped.*

17. Chemical Methods to be used for Analyzing Samples

Contaminant Sought	EPA, DHS, or Other Sample Preparation Method Number	EPA, DHS, or Other Analysis Number												
<p><i>1) Gasoline, TPH</i></p> <p><i>2) Diesel, TPH</i></p> <p><i>+ 2) B, T, X, Eb</i></p>	<p><i>5030</i></p> <p><i>3550</i></p> <p><i>8020 or 8240 prep method</i></p>	<p><i>GCFID, DHS Method</i></p> <p><i>GCFID, DHS Method</i></p> <p><i>8020 or 8240</i></p> <p><i>Detection limits must meet the following RWQCB standards</i></p> <table border="1"> <thead> <tr> <th></th> <th><u>soil</u></th> <th><u>water</u></th> </tr> </thead> <tbody> <tr> <td><i>TPH G</i></td> <td><i>1.0 ppm</i></td> <td><i>50.0 ppb</i></td> </tr> <tr> <td><i>TPH D</i></td> <td><i>1.0 ppm</i></td> <td><i>50.0 ppb</i></td> </tr> <tr> <td><i>BTX+E</i></td> <td><i>0.005 ppm</i></td> <td><i>0.5 ppb</i></td> </tr> </tbody> </table>		<u>soil</u>	<u>water</u>	<i>TPH G</i>	<i>1.0 ppm</i>	<i>50.0 ppb</i>	<i>TPH D</i>	<i>1.0 ppm</i>	<i>50.0 ppb</i>	<i>BTX+E</i>	<i>0.005 ppm</i>	<i>0.5 ppb</i>
	<u>soil</u>	<u>water</u>												
<i>TPH G</i>	<i>1.0 ppm</i>	<i>50.0 ppb</i>												
<i>TPH D</i>	<i>1.0 ppm</i>	<i>50.0 ppb</i>												
<i>BTX+E</i>	<i>0.005 ppm</i>	<i>0.5 ppb</i>												

18. Submit Site Safety Plan

19. Workman's Compensation: Yes  No

Copy of Certificate enclosed? Yes  No

Name of Insurer National American Insurance Company of California

20. Plot Plan submitted? Yes  No

21. Deposit enclosed? Yes  No

22. Please forward to this office the following information within 60 days after receipt of sample results.

- a) Chain of Custody Sheets
- b) Original Signed Laboratory Reports
- c) TSD to Generator copies of wastes shipped and received
- d) Attachment A summarizing laboratory results

I declare that to the best of my knowledge and belief the statements and information provided above are correct and true. I understand that information in addition to that provided above may be needed in order to obtain an approval from the Department of Environmental Health and that no work is to begin on this project until this plan is approved.

I understand that any changes in design, materials or equipment will void this plan if prior approval is not obtained.

I understand that all work performed during this project will be done in compliance with all applicable OSHA (Occupational Safety and Health Administration) requirements concerning personnel and safety.

\* I will notify the Department of Environmental Health at least two (2) working days (48 hours) after approval of this closure plan in advance to schedule any required inspections. I understand that site and worker safety are solely the responsibility of the property owner or his agent and that this responsibility is not shared nor assumed by the County of Alameda.

Signature of Contractor

Name (please type) David E. Cottle, Sr.

Signature David E. Cottle, Sr.

Date 4/11/90

Signature of Site Owner or Operator

Name (please type) \_\_\_\_\_

Signature A. R. Green

Date 4-12-90

# CERTIFICATE OF INSURANCE

ISSUE DATE (MM/DD/YY)

3/5/90

THIS CERTIFICATE IS ISSUED AS A MATTER OF INFORMATION ONLY AND CONFERS NO RIGHTS UPON THE CERTIFICATE HOLDER. THIS CERTIFICATE DOES NOT AMEND, EXTEND OR ALTER THE COVERAGE AFFORDED BY THE POLICIES BELOW

**SIGERSETH INS. ASSOCIATES**  
 2710 GATEWAY OAKS DR.  
 SUITE 115—SO.  
 SACRAMENTO, CA 95833  
 TEL: (916) 923-1800

## COMPANIES AFFORDING COVERAGE

- COMPANY LETTER **A** HAICC
- COMPANY LETTER **B**
- COMPANY LETTER **C**
- COMPANY LETTER **D**
- COMPANY LETTER **E**

PRODUCER CODE SUB-CODE

INSURED  
 Dave Cottle  
 REA: Cottle Engineering  
 P.O. Box 163  
 Antioch, Ca. 94509

## COVERAGES

THIS IS TO CERTIFY THAT THE POLICIES OF INSURANCE LISTED BELOW HAVE BEEN ISSUED TO THE INSURED NAMED ABOVE FOR THE POLICY PERIOD INDICATED, NOTWITHSTANDING ANY REQUIREMENT, TERM OR CONDITION OF ANY CONTRACT OR OTHER DOCUMENT WITH RESPECT TO WHICH THIS CERTIFICATE MAY BE ISSUED OR MAY PERTAIN, THE INSURANCE AFFORDED BY THE POLICIES DESCRIBED HEREIN IS SUBJECT TO ALL THE TERMS, EXCLUSIONS AND CONDITIONS OF SUCH POLICIES. LIMITS SHOWN MAY HAVE BEEN REDUCED BY PAID CLAIMS.

TYPE OF INSURANCE	POLICY NUMBER	POLICY EFFECTIVE DATE (MM/DD/YY)	POLICY EXPIRATION DATE (MM/DD/YY)	ALL LIMITS IN THOUSANDS
<b>GENERAL LIABILITY</b>				GENERAL AGGREGATE \$
COMMERCIAL GENERAL LIABILITY				PRODUCTS-COMP/OPS AGGREGATE \$
CLAIMS MADE OCCUR.				PERSONAL & ADVERTISING INJURY \$
OWNER'S & CONTRACTOR'S PROT.				EACH OCCURRENCE \$
				FIRE DAMAGE (Any one fire) \$
				MEDICAL EXPENSE (Any one person) \$
<b>AUTOMOBILE LIABILITY</b>				COMBINED SINGLE LIMIT \$
ANY AUTO				BODILY INJURY (Per person) \$
ALL OWNED AUTOS				BODILY INJURY (Per accident) \$
SCHEDULED AUTOS				PROPERTY DAMAGE \$
HIRED AUTOS				
NON-OWNED AUTOS				
GARAGE LIABILITY				
<b>EXCESS LIABILITY</b>				
OTHER THAN UMBRELLA FORM				EACH OCCURRENCE \$
<b>WORKER'S COMPENSATION</b>				AGGREGATE \$
AND				
EMPLOYERS' LIABILITY	Binder #314	2-25-90	2-25-91	STATUTORY \$ 1,000, (EACH ACCIDENT)
				\$ 1,000, (DISEASE—POLICY LIMIT)
OTHER				\$ 1,000, (DISEASE—EACH EMPLOYEE)

**COPY FOR YOUR RECORDS**

DESCRIPTION OF OPERATIONS/LOCATIONS/VEHICLES/RESTRICTIONS/SPECIAL ITEMS

RE: All California Operations

## CERTIFICATE HOLDER

County of Alameda  
 Department of Environmental Health  
 90 Swan Way, Room 200  
 Oakland, Ca. 94621

## CANCELLATION

SHOULD ANY OF THE ABOVE DESCRIBED POLICIES BE CANCELLED BEFORE THE EXPIRATION DATE THEREOF, THE ISSUING COMPANY WILL ENDEAVOR TO MAIL 30 DAYS WRITTEN NOTICE TO THE CERTIFICATE HOLDER NAMED TO THE LEFT, BUT FAILURE TO MAIL SUCH NOTICE SHALL IMPOSE NO OBLIGATION OR LIABILITY OF ANY KIND UPON THE COMPANY, ITS AGENTS OR REPRESENTATIVES.

AUTHORIZED REPRESENTATIVE

*Deanna Gibson*



---

## SITE SAFETY PLAN

CA Lic. No. 481444

### Ballena Isle Marina

#### Tank Removal and Installation

1. Project site will be chain link fenced in such a manner that the public may not enter the work area.
2. Excavated area shall be barricaded with double rows of caution tape so that the public may not enter the excavated area.
3. When possible the excavated area will be covered with plywood sheeting to prevent falls into the area.
4. A minimum of two (2) fire extinguishers will be on site at all times.
5. Tanks contained gasoline and diesel fuel. Dry ice will be added to both tanks prior to the start of work to suppress vapors.
6. All OSHA safety procedures will be followed and Cal OSHA to be notified prior to start of work.

Site Safety Plan

Ballena Isle Marina  
1150 Ballena Blvd.  
Alameda

Site Emergency and Evacuation Plan in the event of fire  
or other major jobsite catastrophe.

Follow these steps immediately:

1. Discount all power cords and power tools at the jobsite. Shut off all motors or engines which may be running.
2. Evacuate any people or employees in the immediate area. All persons should be directed to leave by the nearest safe direction.
3. Call "911" and report the conditions at Ballena Isle Marina Alameda. Should anyone be trapped or in need of medical attention let the "911" dispatcher and stay on the phone to answer any questions concerning the situation.
4. Before leaving the site quickly look to assure that all others have left the jobsite area. Give assistance to anyone who may be having difficulty leaving the jobsite.
5. Attempt to extinguish any fire or contain any spill if you can do so safely. Have fire extinguishers and spill containment supplies available until additional help arrives.
6. Assist any injured persons as much as possible. Report immediately to emergency response personnel upon their arrival and provide them with any information or assistance that they may request.
7. Jobsite safety equipment shall consist of two fully charged fire extinguishers located within 50 feet of the work area. Fire extinguishers are operated by removing the safety pin, aiming at the base of fire from a safe distance and squeezing the trigger.
8. Upon evacuation of the premises employees are to meet at the South end of the Parking lot

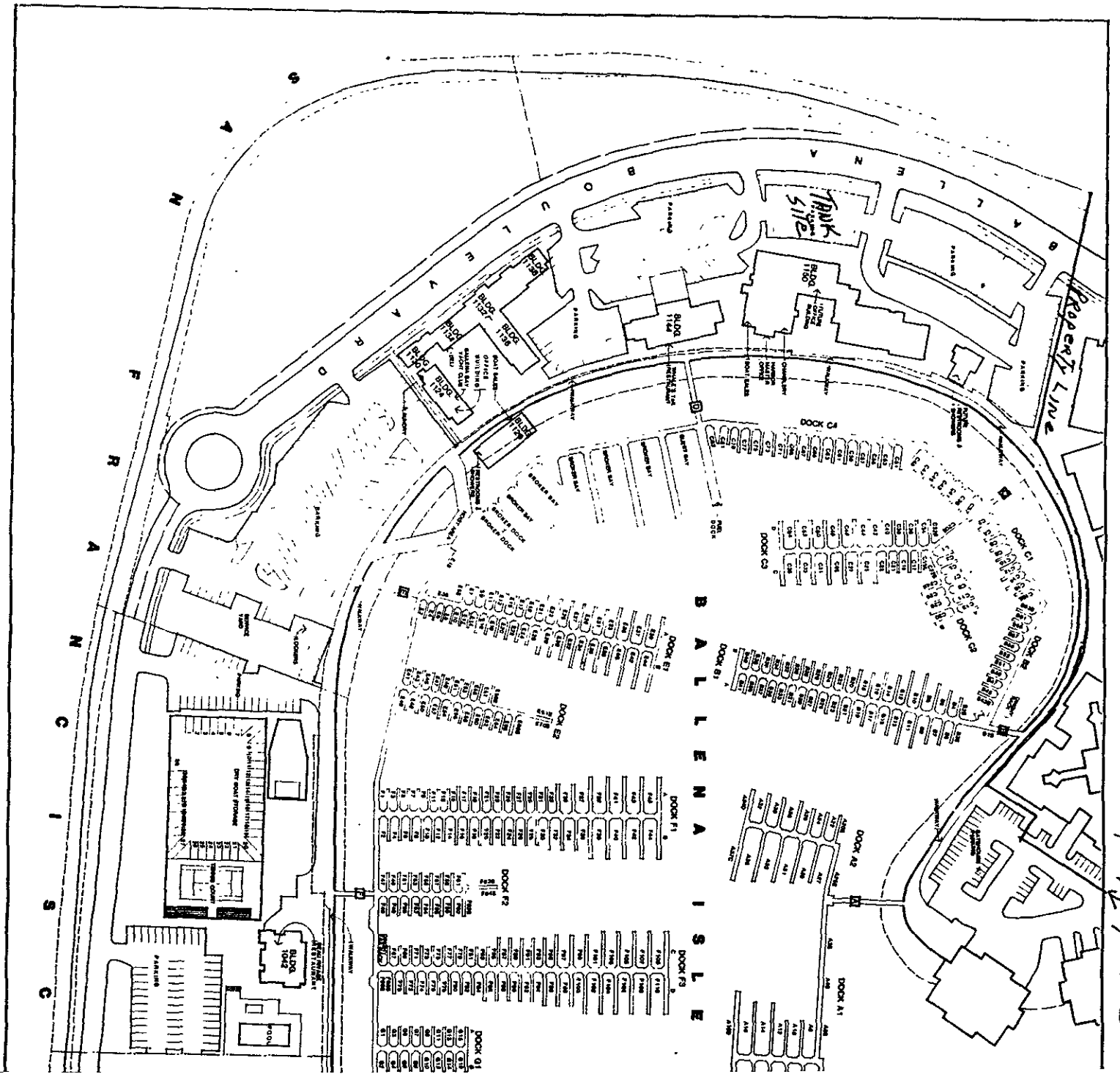

B A L L E N A I S L E

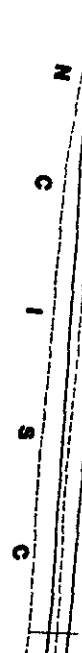
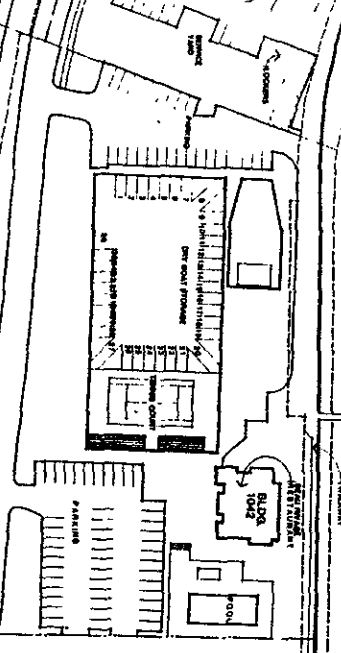
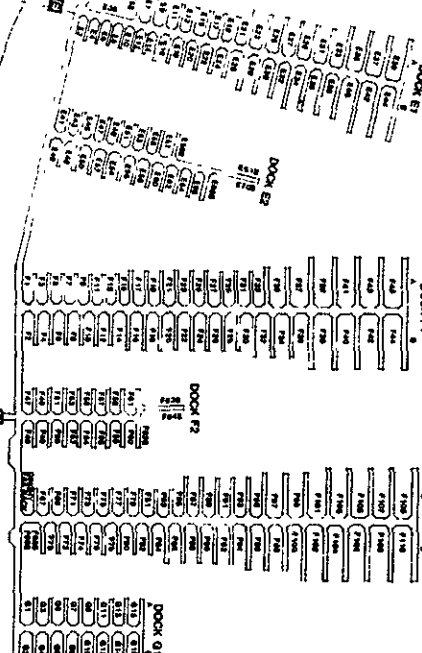
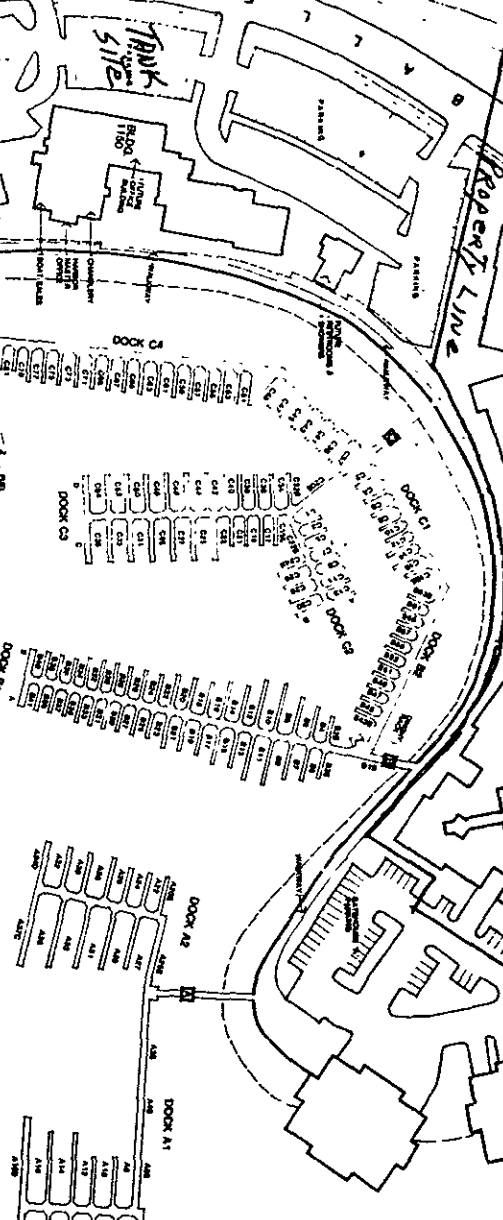

90114855  
 IN CASE OF AN EMERGENCY OR SPILL, CALL THE NATIONAL RESPONSE CENTER 1-800-424-8802; WITHIN CALIFORNIA CALL 1-800-852-7550

**UNIFORM HAZARDOUS WASTE MANIFEST**

1. Generator's US EPA ID No. **C A C 0 0 0 2 1 6 5 6 9 0 1 0 1 0 1 1**

2. Page 1 of 1  
 Manifest Document No. **90114855**  
 Information in the shaded areas is not required by Federal law.

3. Generator's Name and Mailing Address  
**BALLENA ISLE MARINA**  
**1150 Ballena Blvd., Alameda, CA 94501**

A. State Manifest Document Number  
**90114855**

4. Generator's Phone (415) 269-6207

B. State Generator's ID

5. Transporter 1 Company Name  
**H & H Ship Service Company**

C. State Transporter's ID **112360**

6. US EPA ID Number  
**C A D 0 0 1 4 7 7 1 1 1 6 1 8**

D. Transporter's Phone **(415) 543-4835**

7. Transporter 2 Company Name

E. State Transporter's ID

8. US EPA ID Number

F. Transporter's Phone

9. Designated Facility Name and Site Address  
**H & H Ship Service Company**  
**220 China Basin Street**  
**San Francisco, CA 94107**

G. State Facility's ID  
**C A D 0 0 1 4 7 7 1 1 1 6 1 8**

H. Facility's Phone  
**(415) 543-4835**

10. US EPA ID Number  
**C A D 0 0 1 4 7 7 1 1 1 6 1 8**

11. US DOT Description (Including Proper Shipping Name, Hazard Class, and ID Number)

12. Containers No. Type

13. Total Quantity

14. Unit Wt/Vol

I. Waste No.

a. **RESIDUE GASOLINE TANK**

No. **0 1 0 1 1** Type **T 1 P**

Quantity **1 1 2 1 0 1 0 1 0**

Unit **P**

Waste No. **State 512**

b. **NON-RCRA HAZARDOUS WASTE SOLID**

No. Type

Quantity

Unit

Waste No.

c.

No. Type

Quantity

Unit

Waste No.

d.

No. Type

Quantity

Unit

Waste No.

J. Additional Descriptions for Materials Listed Above  
**PUMPED OUT 12,000 gallon tank last containing gasoline. Tank inerted with dry ice for transport.**

K. Handling Codes for Wastes Listed Above  
 a. **01**

15. Special Handling Instructions and Additional Information  
**JOB #4856**  
**APPROPRIATE PROTECTIVE CLOTHING AND RESPIRATOR.**

16. **GENERATOR'S CERTIFICATION:** I hereby declare that the contents of this consignment are fully and accurately described above by proper shipping name and are classified, packed, marked, and labeled, and are in all respects in proper condition for transport by highway according to applicable international and national government regulations.

If I am a large quantity generator, I certify that I have a program in place to reduce the volume and toxicity of waste generated to the degree I have determined to be economically practicable and that I have selected the practicable method of treatment, storage, or disposal currently available to me which minimizes the present and future threat to human health and the environment; OR, if I am a small quantity generator, I have made a good faith effort to minimize my waste generation and select the best waste management method that is available to me and that I can afford.

Printed/Typed Name **Don R. Anderson** Signature **Don R. Anderson** Month Day Year **10 17 10 12 19 10**

17. Transporter 1 Acknowledgement of Receipt of Materials  
 Printed/Typed Name **NORMAN L. BERG** Signature **Norman L. Berg** Month Day Year **10 17 10 12 19 10**

18. Transporter 2 Acknowledgement of Receipt of Materials  
 Printed/Typed Name Signature Month Day Year

19. Discrepancy Indication Space

20. Facility Owner or Operator Certification of receipt of hazardous materials covered by this manifest except as noted in item 19.  
 Printed/Typed Name **Cleveland Valdez** Signature **Cleveland Valdez** Month Day Year **10 17 10 12 19 10**

Please print or type. (Form designed for use on elite (12-pitch typewriter).)

90114856

IN CASE OF AN EMERGENCY OR SPILL, CALL THE NATIONAL RESPONSE CENTER 1-800-424-8802; WITHIN CALIFORNIA CALL 1-800-852-7850

**UNIFORM HAZARDOUS WASTE MANIFEST**

1. Generator's US EPA ID No. **C A C 0 0 0 2 1 6 5 6 9 0 1 0 1 0 1 2**

2. Page 1 of 1  
Manifest Document No. **0101012**  
Information in the shaded areas is not required by Federal law.

3. Generator's Name and Mailing Address  
**BALLENA ISLE MARINA**  
**1150 Ballena Blvd., Alameda, CA 94501**

A. State Manifest Document Number  
**90114856**

4. Generator's Phone **(415) 269-6207**

B. State Generator's ID

5. Transporter 1 Company Name  
**H & H Ship Service Company**

C. State Transporter's ID **103562**

6. US EPA ID Number **C A D 0 0 4 7 7 1 1 6 8**

D. Transporter's Phone **(415) 543-4835**

7. Transporter 2 Company Name

E. State Transporter's ID

8. US EPA ID Number

F. Transporter's Phone

9. Designated Facility Name and Site Address  
**H & H Ship Service Company**  
**220 China Basin Street**  
**San Francisco, CA 94107**

G. State Facility's ID  
**C A D 0 0 4 7 7 1 1 6 8**

H. Facility's Phone  
**(415) 543-4835**

10. US EPA ID Number **C A D 0 0 4 7 7 1 1 6 8**

11. US DOT Description (Including Proper Shipping Name, Hazard Class, and ID Number)  
a. **RESIDUE DIESEL TANK**  
**NON-RCRA HAZARDOUS WASTE SOLID**

12. Containers No.	13. Total Quantity	14. Unit (Wt/Vol)	15. Waste No.
0 0 1	1 2 0 0 0	P	State 512 EPA/Other
			State EPA/Other
			State EPA/Other
			State EPA/Other
			State EPA/Other

J. Additional Descriptions for Materials Listed Above  
**PUMPED OUT 12,000 gallon tank last containing diesel. Tank inerted with dry ice for transport.**

K. Handling Codes for Wastes Listed Above  
a. **01**  
b.  
c.  
d.

15. Special Handling Instructions and Additional Information  
**JOB #4856**  
**APPROPRIATE PROTECTIVE CLOTHING AND RESPIRATOR.**

16. **GENERATOR'S CERTIFICATION:** I hereby declare that the contents of this consignment are fully and accurately described above by proper shipping name and are classified, packed, marked, and labeled, and are in all respects in proper condition for transport by highway according to applicable international and national government regulations.  
If I am a large quantity generator, I certify that I have a program in place to reduce the volume and toxicity of waste generated to the degree I have determined to be economically practicable and that I have selected the practicable method of treatment, storage, or disposal currently available to me which minimizes the present and future threat to human health and the environment; OR, if I am a small quantity generator, I have made a good faith effort to minimize my waste generation and select the best waste management method that is available to me and that I can afford.

Printed/Typed Name  
**MARTIN J. COSTELLO**

Signature  
*Martin J. Costello*  
Month Day Year  
**10 17 10 12 19 10**

17. Transporter 1 Acknowledgement of Receipt of Materials  
Printed/Typed Name  
**Don Anderson**

Signature  
*Don Anderson*  
Month Day Year  
**10 17 10 12 19 10**

18. Transporter 2 Acknowledgement of Receipt of Materials  
Printed/Typed Name  
**Don Anderson**

Signature  
*Don Anderson*  
Month Day Year  
**10 17 10 12 19 10**

18. Discrepancy Indication Space

20. Facility Owner or Operator Certification of receipt of hazardous materials covered by this manifest except as noted in Item 19.  
Printed/Typed Name  
**Cleveland Vakey**

Signature  
*Cleveland Vakey*  
Month Day Year  
**10 17 10 12 19 10**

Do Not Write Below This Line



CERTIFICATE OF DISPOSAL

JULY 05, 1990

H & H Ship Service Company hereby certifies to COTTLE ENGINEERING that:

1. The storage tank(s), size(s) TWO (2) 12,000 GALS.

removed from the BALLENA ISLE MARINA

facility at 1150 BALLENA BLVD.

ALAMEDA, CALIFORNIA

were transported to H & H Ship Service Company, 220 China Basin St., San Francisco, California 94107.

2. The following tank(s), H & H Job Number 4856

have been steamed cleaned, cut with approximately 2' X 2' holes, rendered harmless and disposed of as scrap metal.

3. Disposal site: LEVIN METALS CORPORATION, RICHMOND, CALIFORNIA.

4. The foregoing method of destruction/disposal is suitable for the materials involved, and fully complies with all applicable regulatory and permit requirements.

5. Should you require further information, please call (415) 543-4835.

Very Truly Yours,

  
Cleveland Valrey  
Operations Coordinator

220 CHINA BASIN, SAN FRANCISCO, CA 94107 • DAY AND NIGHT: 543-4835





CERTIFICATE OF DISPOSAL  
-----

JULY 05, 1990

H & H Ship Service Company hereby certifies to COTTLE ENGINEERING  
that:

1. The storage tank(s), size(s) TWO (2) 12,000 GALS.  
-----

removed from the BALLENA ISLE MARINA  
-----

facility at 1150 BALLENA BLVD.  
-----

ALAMEDA, CALIFORNIA  
-----

were transported to H & H Ship Service Company, 220 China Basin St.,  
San Francisco, California 94107.

2. The following tank(s), H & H Job Number 4856  
-----  
have been steamed cleaned, cut with approximately 2' X 2' holes,  
rendered harmless and disposed of as scrap metal.
3. Disposal site: LEVIN METALS CORPORATION, RICHMOND, CALIFORNIA.  
-----
4. The foregoing method of destruction/disposal is suitable for the  
materials involved, and fully complies with all applicable  
regulatory and permit requirements.
5. Should you require further information, please call  
(415) 543-4835.

Very Truly Yours,

  
Clevelanda Valrey  
Operations Coordinator

220 CHINA BASIN, SAN FRANCISCO, CA 94107 • DAY AND NIGHT: 543-4835



July 26, 1990  
SCI 613.001

Mr. Lester Feldman  
California Regional Water  
Quality Control Board  
San Francisco Bay Region  
1800 Harrison Street, Suite 700  
Oakland, California 94612

**Proposal**  
**Waiver of Waste Discharge Requirements**  
**Ballena Bay Marina**  
**Alameda, California**

Dear Mr. Feldman:

This letter serves as a proposal to waive waste discharge requirements under resolution 83-3 of the California Water Code governing construction dewatering. The excavation contractor proposes to pump water from a fuel tank excavation, into Baker storage tanks. The water would then be sampled and analytically tested. If contaminate concentrations are acceptable, the water will be discharged in to the storm sewer adjacent to the tank excavation. Acceptable contaminant concentrations were discussed during a telephone conversation with you on July 19, 1990 and will consist of the following: less than 50 parts per billion (ppb) of TVH or TEH, less than 5 ppb for BTXE, and less than detectable concentrations of volatile organic compounds (EPA Test Method 8240).

Details of the site history are described below. During the October, 17, 1989 Earthquake, the tanks were displaced upward by buoyant forces induced by the liquefaction of the surrounding saturated sands. As a result, the piping connections at the tank were broken. A small amount of product may have been released as a result of the pipeline break.

The two underground fuel tanks were removed from the site on July 2, 1990. Both tanks were 12,000 gallons in volume, one tank contained diesel, the other contained gasoline (Site Plan, Plate 1). The tanks were of single wall fiberglass wrapped steel construction and contained no visible signs of deterioration or leakage.

■ **Subsurface Consultants, Inc.**

171 12th Street • Suite 201 • Oakland, California 94607 • Telephone 415-268-0461 • FAX 415-268-0137



Mr. Lester Feldman  
 RWQCB  
 SCI 613.001  
 July 26, 1990  
 Page 2

Six soil samples were obtained from the tank excavation under the supervision of the Alameda County Health Care Services Agency (ACHCSA). Analytical test results indicated that five of the samples contained no detectable concentrations of total volatile hydrocarbons (TVH), benzene, toluene, xylene, ethylbenzene (BTXE) or total extractable hydrocarbons (TEH) as diesel. One soil sample located near the piping connection to the diesel tank contained 130 ppm of TEH as diesel. A water sample, W1, obtained from the excavation contained significant quantities of TVH, BTXE and EDB. The water in the excavation was resampled approximately 2 weeks later (sample W2). Analytical test reports are attached. Test results are summarized below.

Sample	TVH <sup>1</sup> (ug/L)	Benzene (ug/L)	Toluene (ug/L)	Xylene (ug/L)	Ethyl- Benzene (ug/L)	EDB <sup>2</sup> (ug/L)	TEH <sup>3</sup> (ug/L)	Organic Lead (mg/L)
W1	24,000	870	520	4,200	ND	.41	.7	ND
W2	ND <sup>4</sup>	ND	.7	ND	ND	ND	ND	

- 
- 1 TVH = Total Volatile Hydrocarbons, EPA 8015/5030  
 2 EDB = Ethylene Dibromide, EPA 504  
 3 TEH = Total Extractable Hydrocarbons, EPA 8015/3550  
 4 ND = None detected at concentrations above detection limits.  
 See test reports for detection limits.

The test results indicate that most of the contaminants volatilized from the water. Both water samples were obtained from the tank excavation and may not represent true values of contaminants in the groundwater.

Three groundwater monitoring wells will be installed around the tank excavation to assess the impacts to groundwater. The owner plans to place new double walled storage tanks in the excavation. The excavation will be shored and dewatered to accommodate the new tank installation. Significant quantities of water will be generated during excavation dewatering. This water will be stored temporarily in Baker tanks and be analytically tested. Testing will consist of TVH/BTXE, EPA Method 8015 and 8020 with purge and trap extraction; TEH, EPA 8015 with sonication extraction; EDB, EPA 504; and volatile organics, EPA 8240. We propose 1 sample per Baker Tank (approximately 20,000 gallons). We will submit the test results to you and await your approval to discharge.

Mr. Lester Feldman  
RWQCB  
SCI 613.001  
July 26, 1990  
Page 3

If you have any questions regarding this proposal, please call.

Yours very truly,

Subsurface Consultants, Inc.



Sean O. Carson  
Civil Engineer 45074 (expires 3/31/94)

SOC:RWR:nf:mb1

Attachments: Site Plan  
Laboratory Test Reports

cc: ✓ Mr. Dave Cottle  
Cottle Engineering  
P.O. Box 7  
Antioch, California 94509

Mr. Don Anderson  
Harbor Master  
Ballena Isle Marina  
1150 Ballena Boulevard  
Alameda, California 94501

SAN FRANCISCO BAY

SHORELINE

STORM SEWER  
OUTFLOW

75'

BALLENA BOULEVARD

SIDEWALK

POSSIBLE  
DISCHARGE  
LOCATION

2 @ 5 TM(ND)  
BTXE(ND)

1 @ 5 TEH(ND)  
BTXE(ND)

3 @ 5 TM(ND)  
BTXE(ND)

PREVIOUS  
GASOLINE TANK

PREVIOUS  
DIESEL TANK

6 @ 5 TEH(ND)  
BTXE(ND)

STORM SEWER  
APPROXIMATE LOCATION

WHALES TAIL  
PARKING LOT



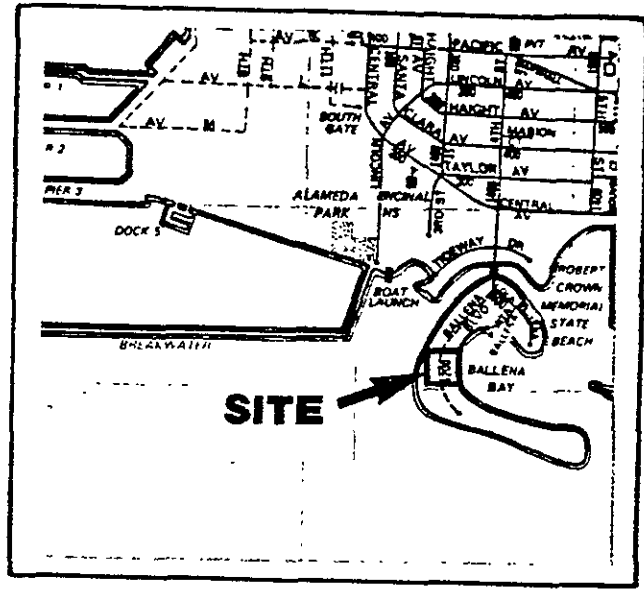
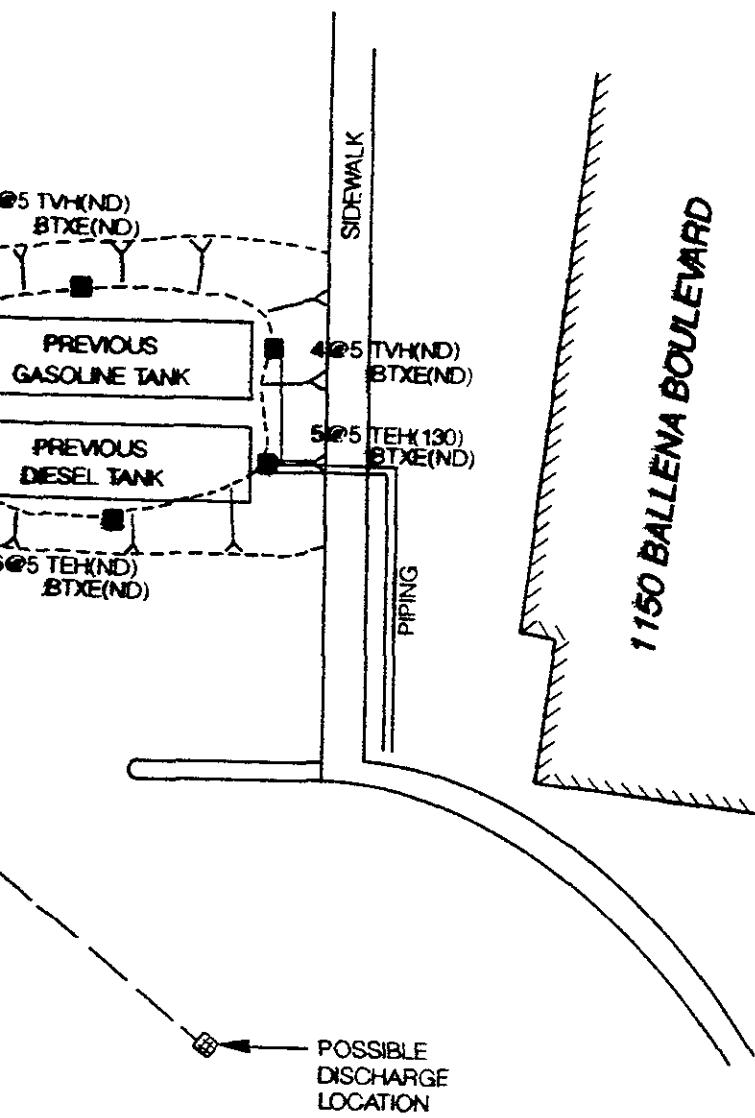

VICINITY MAP

--- STORM SEWER  
 [Symbol] STORM SEWER INLET  
 O STORM SEWER MANHOLE  
 [Symbol] EXISTING BUILDING  
 [Symbol] SOIL SAMPLE  
 2@5 TVH(ND) EPA 8015/5030  
 BTXE(ND) EPA 8020  
 TEH(130) EPA 8015/3550  
 └── CONCENTRATION (mg/kg)  
 (ND) NONE DETECTED

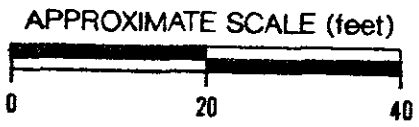

<b>SITE PLAN</b>		
BALLENA BAY MARINA - ALAMEDA, CA		
JOB NUMBER	DATE	APPROVED
613.001	7/26/90	
		PLATE <b>1</b>

Subsurface Consultants



Curtis & Tompkins, Ltd., Analytical Laboratories, Since 1878

2323 Fifth Street, Berkeley, CA 94710, Phone (415) 486-0900

DATE RECEIVED: 07/02/90

DATE REPORTED: 07/09/90

PAGE 1 OF 8

LAB NUMBER: 100950

CLIENT: SUBSURFACE CONSULTANTS

REPORT ON: 6 SOIL SAMPLES & 1 WATER SAMPLE

PROJECT #: 613.001

LOCATION: BALLENA BAY MARINA

RESULTS: SEE ATTACHED

  
-----  
QA/QC Approval

  
-----  
Firm Approval

LABORATORY NUMBER: 100950  
CLIENT: SUBSURFACE CONSULTANTS  
PROJECT #: 613.001  
LOCATION: BALLENA BAY MARINA

DATE RECEIVED: 07/02/90  
DATE ANALYZED: 07/06/90  
DATE REPORTED: 07/06/90  
PAGE 2 OF 8

=====  
ANALYSIS: ETHYLENE DIBROMIDE  
ANALYSIS METHOD: EPA 504  
=====

LAB ID	SAMPLE ID	RESULT	UNITS	REPORTING LIMIT
100950-7	W1	0.41	ug/L	0.05

QA/QC SUMMARY

=====  
RPD, % 3  
RECOVERY, % 56  
=====

LABORATORY NUMBER: 100950  
 CLIENT: SUBSURFACE CONSULTANTS  
 PROJECT #: 613.001  
 LOCATION: BALLENA BAY MARINA

DATE RECEIVED: 07/02/90  
 DATE ANALYZED: 07/03/90  
 DATE REPORTED: 07/09/90  
 PAGE 3 OF 8

=====

ANALYSIS: ORGANIC LEAD  
 METHOD: CA DHS METHOD, LUFT MANUAL OCT 1989

=====

LAB ID	CLIENT ID	RESULT	UNITS	REPORTING LIMIT
100950-7	W1	ND	mg/L	0.1

ND = Not detected at or above reporting limit.

QA/QC SUMMARY

=====

RPD, %	<1
RECOVERY, %	99

=====

LABORATORY NUMBER: 100950  
 CLIENT: SUBSURFACE CONSULTANTS  
 JOB #: 613.001  
 LOCATION: BALLENA BAY MARINA

DATE RECEIVED: 07/02/90  
 DATE EXTRACTED: 07/06/90  
 DATE ANALYZED: 07/09/90  
 DATE REPORTED: 07/09/90  
 PAGE 4 OF 8

Extractable Petroleum Hydrocarbons in Aqueous Solutions  
 California DOHS Method  
 LUFT Manual October 1989

LAB ID	CLIENT ID	KEROSENE RANGE (mg/L)	DIESEL RANGE (mg/L)	REPORTING LIMIT (mg/L)
100950-1	W1	ND	0.7	0.5

ND = Not detected at or above reporting limit.

QA/QC SUMMARY

RPD, %	13
RECOVERY, %	80



LABORATORY NUMBER: 100950  
 CLIENT: SUBSURFACE CONSULTANTS  
 JOB NUMBER: 613.001  
 JOB LOCATION: BALLENA BAY MARINA

DATE RECEIVED: 07/02/90  
 DATE ANALYZED: 07/03/90  
 DATE REPORTED: 07/09/90  
 PAGE 5 OF 8

Total Volatile Hydrocarbons with BTXE in Aqueous Solutions  
 TVH by California DOHS Method/LUFT Manual October 1989  
 BTXE by EPA 5030/8020

LAB ID	CLIENT ID	TVH AS GASOLINE (ug/L)	BENZENE (ug/L)	TOLUENE (ug/L)	ETHYL BENZENE (ug/L)	TOTAL XYLENES (ug/L)
100950-7	W1	24,000	870	520	ND(200)	4,200

ND = Not detected at or above reporting limit; Reporting limit  
 indicated in parentheses.

QA/QC SUMMARY

RPD, %	1
RECOVERY, %	115

LABORATORY NUMBER: 100950  
 CLIENT: SUBSURFACE CONSULTANTS  
 JOB #: 613.001  
 LOCATION: BALLENA BAY MARINA

DATE RECEIVED: 07/02/90  
 DATE EXTRACTED: 07/06/90  
 DATE ANALYZED: 07/06/90  
 DATE REPORTED: 07/09/90  
 PAGE 6 OF 8

Extractable Petroleum Hydrocarbons in Soils & Wastes  
 California DOHS Method  
 LUFT Manual October 1989

LAB ID	CLIENT ID	KEROSENE RANGE (mg/Kg)	DIESEL RANGE (mg/Kg)	REPORTING LIMIT (mg/Kg)
100950-1	1 @ 5'	ND	ND	10
100950-2	5 @ 5'	ND	130	10
100950-3	6 @ 5'	ND	ND	10

ND = Not Detected at or above reporting limit.

QA/QC SUMMARY

RPD, %	8
RECOVERY, %	106

LABORATORY NUMBER: 100950  
 CLIENT: SUBSURFACE CONSULTANTS  
 JOB NUMBER: 613.001  
 JOB LOCATION: BALLENA BAY MARINA

DATE RECEIVED: 07/02/90  
 DATE ANALYZED: 07/02/90  
 DATE REPORTED: 07/09/90  
 PAGE 7 OF 8

Benzene, Toluene, Ethyl Benzene, Xylenes by EPA 8020  
 Extraction by EPA 5030 Purge and Trap

LAB ID	CLIENT ID	BENZENE (ug/kg)	TOLUENE (ug/kg)	TOTAL XYLENES (ug/kg)	ETHYL BENZENE (ug/kg)	REPORTING LIMIT * (ug/kg)
100950-1	1 @ 5'	ND	ND	ND	ND	5.0
100950-2	5 @ 5'	ND	ND	ND	ND	5.0
100950-3	6 @ 5'	ND	ND	ND	ND	5.0

ND = Not detected at or above reporting limit.

\* Reporting Limit applies to all analytes.

QA/QC SUMMARY

RPD, %	1
RECOVERY, %	92

LABORATORY NUMBER: 100950  
 CLIENT: SUBSURFACE CONSULTANTS  
 JOB NUMBER: 613.001  
 JOB LOCATION: BALLENA BAY MARINA

DATE RECEIVED: 07/02/90  
 DATE ANALYZED: 07/06/90  
 DATE REPORTED: 07/06/90  
 PAGE 8 OF 8

Total Volatile Hydrocarbons with BTXE in Soils & Wastes  
 TVH by California DOHS Method/LUFT Manual October 1989  
 BTXE by EPA 5030/8020

LAB ID	CLIENT ID	TVH AS GASOLINE (mg/Kg)	BENZENE (ug/Kg)	TOLUENE (ug/Kg)	ETHYL BENZENE (ug/Kg)	TOTAL XYLENES (ug/Kg)
100950-4	2 @ 5'	ND(1.0)	ND(5.0)	ND(5.0)	ND(5.0)	ND(5.0)
100950-5	3 @ 5'	ND(1.0)	ND(5.0)	ND(5.0)	ND(5.0)	ND(5.0)
100950-6	4 @ 5'	ND(1.0)	ND(5.0)	ND(5.0)	ND(5.0)	ND(5.0)

ND = Not detected at or above reporting limit; Reporting limit indicated in parentheses.

QA/QC SUMMARY

RPD, % <1  
 RECOVERY, % 111

# Subsurface Consultants

CHAIN OF CUSTODY RECORD  
& ANALYTICAL TEST REQUEST

Project Name: Ballena Bay Marina  
 SCI Job Number: 613.001  
 Project Contact at SCI: Sean Carson  
 Sampled By: " "  
 Analytical Laboratory: Curtis + Tompkins  
 Analytical Turnaround: 48 hrs

Sample ID	Sample Type <sup>1</sup>	Container Type <sup>2</sup>	Sampling Date	Hold	Analysis	Analytical Method
<u>1e5'</u>	<u>S</u>	<u>T</u>	<u>7/2/90</u>	<u>---</u>	<u>TEH/BTXE</u>	<u>3550/8020</u>
<u>5e5'</u>	<u>S</u>	<u>T</u>	<u>7/2/90</u>	<u>---</u>	<u>TEH/BTXE</u>	<u>3550/8020</u>
<u>6e5'</u>	<u>S</u>	<u>T</u>	<u>7/2/90</u>	<u>---</u>	<u>TEH/BTXE</u>	<u>3550/8020</u>
<u>2e5'</u>	<u>S</u>	<u>T</u>	<u>7/2/90</u>	<u>---</u>	<u>TVH/BTXE</u>	<u>5030/8020</u>
<u>3e5</u>	<u>S</u>	<u>T</u>	<u>7/2/90</u>	<u>---</u>	<u>TVH/BTXE</u>	<u>5030/8020</u>
<u>4e5'</u>	<u>S</u>	<u>T</u>	<u>7/2/90</u>	<u>---</u>	<u>TVH/BTXE</u>	<u>5030/8020</u>
<u>W1</u>	<u>W</u>	<u>Vx4</u>	<u>---</u>	<u>---</u>	<u>TVH/BTXE/EDB</u>	<u>---</u>
	<u>W</u>	<u>P.1</u>	<u>---</u>	<u>---</u>	<u>TEL</u>	<u>DMS LUFT</u>
	<u>W</u>	<u>G.1</u>	<u>---</u>	<u>---</u>	<u>TEH</u>	<u>---</u>

\* \* \* \* \*

Released by: Charles P. Carson Date: 7-2-90  
 Released by Courier: \_\_\_\_\_ Date: \_\_\_\_\_  
 Received by Laboratory: Mary Pruit Date: 7/2/90  
 Relinquished by Laboratory: \_\_\_\_\_ Date: \_\_\_\_\_  
 Received by: \_\_\_\_\_ Date: \_\_\_\_\_

<sup>1</sup> Sample Type: W = water, S = soil, O = other (specify)  
<sup>2</sup> Container Type: V = VOA, P = plastic, G = glass, T = brass tube, O = other (specify)

Notes to Laboratory:  
 -Notify SCI if there are any anomalous peaks on GC or other scans  
 -Questions/clarifications...contact SCI at (415) 268-0461



Curtis & Tompkins, Ltd., Analytical Laboratories, Since 1878

2323 Fifth Street, Berkeley, CA 94710, Phone (415) 486-0900

DATE RECEIVED: 07/16/90  
DATE REPORTED: 07/17/90  
PAGE 1 OF 4

LAB NUMBER: 101073

CLIENT: SUBSURFACE CONSULTANTS

REPORT ON: 1 WATER SAMPLE

PROJECT #: 613.001  
LOCATION: BALLENA BAY MARINA

RESULTS: SEE ATTACHED

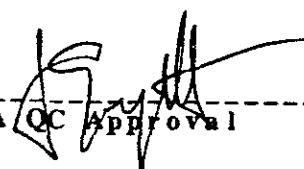
  
-----  
QA/QC Approval

  
-----  
Final Approval

LABORATORY NUMBER: 101073  
CLIENT: SUBSURFACE CONSULTANTS  
JOB #: 613.001  
LOCATION: BALLENA BAY MARINA

DATE RECEIVED: 07/16/90  
DATE EXTRACTED: 07/16/90  
DATE ANALYZED: 07/17/90  
DATE REPORTED: 07/17/90  
PAGE 2 OF 4

Extractable Petroleum Hydrocarbons in Aqueous Solutions  
California DOHS Method  
LUFT Manual October 1989

LAB ID	CLIENT ID	KEROSENE RANGE (mg/L)	DIESEL RANGE (mg/L)	REPORTING LIMIT (mg/L)
101073-1	W2	ND	ND	0.5

ND = Not detected at or above reporting limit.

LABORATORY NUMBER: 101073  
 CLIENT: SUBSURFACE CONSULTANTS  
 JOB NUMBER: 613.001  
 JOB LOCATION: BALLENA BAY MARINA

DATE RECEIVED: 07/16/90  
 DATE ANALYZED: 07/16/90  
 DATE REPORTED: 07/17/90  
 PAGE 3 OF 4

Total Volatile Hydrocarbons with BTXE in Aqueous Solutions  
 TVH by California DOHS Method/LUFT Manual October 1989  
 BTXE by EPA 5030/8020

LAB ID	CLIENT ID	TVH AS GASOLINE (ug/L)	BENZENE (ug/L)	TOLUENE (ug/L)	ETHYL BENZENE (ug/L)	TOTAL XYLENES (ug/L)
101073-1	W2	ND(50)	ND(0.5)	0.7	ND(0.5)	ND(0.5)

ND = Not detected at or above reporting limit; Reporting limit  
 indicated in parentheses.

QA/QC SUMMARY

RPD, %	<1
RECOVERY, %	106





LABORATORY NUMBER: 101073  
CLIENT: SUBSURFACE CONSULTANTS  
JOB ID: 613.001  
LOCATION: BALLENA BAY

DATE RECEIVED: 07/16/90  
DATE ANALYZED: 07/17/90  
DATE REPORTED: 07/17/90  
PAGE 4 OF 4

=====  
ANALYSIS: ETHYLENE DIBROMIDE  
ANALYSIS METHOD: EPA 504  
=====

LAB ID	SAMPLE ID	RESULT	UNITS	REPORTING LIMIT
101073-1	W2	ND	ug/L	0.05

ND = NONE DETECTED AT OR ABOVE THE REPORTING LIMIT

QA/QC SUMMARY

=====  
RPD, % 2  
RECOVERY, % 62  
=====

Project Name: Ballena Bay Marina  
 SCI Job Number: 613,001  
 Project Contact at SCI: Sean Carson  
 Sampled By: " "  
 Analytical Laboratory: Curtis + Tompkins  
 Analytical Turnaround: Rapid 24 hrs

<u>Sample ID</u>	<u>Sample Type<sup>1</sup></u>	<u>Container Type<sup>2</sup></u>	<u>Sampling Date</u>	<u>Hold</u>	<u>Analysis</u>	<u>Analytical Method</u>
<u>W2</u>	<u>W</u>	<u>Vx4</u>	<u>7/16/90</u>	<u>---</u>	<u>TVH/BTXE/EDB</u>	<u>---</u>
<u>---</u>	<u>W</u>	<u>G.1</u>	<u>7/16/90</u>	<u>---</u>	<u>TEH</u>	<u>---</u>
<u>---</u>	<u>---</u>	<u>---</u>	<u>---</u>	<u>---</u>	<u>---</u>	<u>---</u>
<u>---</u>	<u>---</u>	<u>---</u>	<u>---</u>	<u>---</u>	<u>---</u>	<u>---</u>
<u>---</u>	<u>---</u>	<u>---</u>	<u>---</u>	<u>---</u>	<u>---</u>	<u>---</u>
<u>---</u>	<u>---</u>	<u>---</u>	<u>---</u>	<u>---</u>	<u>---</u>	<u>---</u>
<u>---</u>	<u>---</u>	<u>---</u>	<u>---</u>	<u>---</u>	<u>---</u>	<u>---</u>
<u>---</u>	<u>---</u>	<u>---</u>	<u>---</u>	<u>---</u>	<u>---</u>	<u>---</u>
<u>---</u>	<u>---</u>	<u>---</u>	<u>---</u>	<u>---</u>	<u>---</u>	<u>---</u>
<u>---</u>	<u>---</u>	<u>---</u>	<u>---</u>	<u>---</u>	<u>---</u>	<u>---</u>
<u>---</u>	<u>---</u>	<u>---</u>	<u>---</u>	<u>---</u>	<u>---</u>	<u>---</u>
<u>---</u>	<u>---</u>	<u>---</u>	<u>---</u>	<u>---</u>	<u>---</u>	<u>---</u>
<u>---</u>	<u>---</u>	<u>---</u>	<u>---</u>	<u>---</u>	<u>---</u>	<u>---</u>
<u>---</u>	<u>---</u>	<u>---</u>	<u>---</u>	<u>---</u>	<u>---</u>	<u>---</u>
<u>---</u>	<u>---</u>	<u>---</u>	<u>---</u>	<u>---</u>	<u>---</u>	<u>---</u>

\* \* \* \* \*

Released by: [Signature] Date: ---  
 Released by Courier: --- Date: ---  
 Received by Laboratory: Mary Pruit Date: 7/16/90 11:00  
 Relinquished by Laboratory: --- Date: ---  
 Received by: --- Date: ---

<sup>1</sup> Sample Type: W = water, S = soil, O = other (specify)  
<sup>2</sup> Container Type: V = VOA, P = plastic, G = glass, T = brass tube,  
 O = other (specify)

Notes to Laboratory:  
 -Notify SCI if there are any anomalous peaks on GC or other scans  
 -Questions/clarifications...contact SCI at (415) 268-0461

## CALIFORNIA REGIONAL WATER QUALITY CONTROL BOARD

SAN FRANCISCO BAY REGION

1800 HARRISON STREET, SUITE 700  
OAKLAND, CA 94612Phone: Area Code 415  
484-1850September 7, 1990  
File No. 1216.00(SLL)Sean O. Carson  
Subsurface Consultants, Inc.  
171 12th Street, Suite 201  
Oakland, CA 94607

RE: SHORT-TERM DISCHARGE AT BALLENA BAY MARINA, ALAMEDA

Dear Mr. Carson:

Staff of the Regional Board have reviewed your July 26, 1990 proposal to discharge water from a fuel tank excavation at the subject property. As explained below, I hereby waive the need for waste discharge requirements for this discharge as covered by Regional Board Resolution No. 83-3, subject to a number of conditions. This Resolution allows for waivers for construction activities of short duration where no adverse impacts on beneficial uses are expected. This waiver is conditional and may be terminated at any time if significant pollution is discovered or waiver conditions are not met.

I understand that Benzene, Toluene, Xylene and other fuel constituents have impacted groundwater and an investigation including three monitoring wells has been proposed for this site. You have proposed a discharge of 200 gallons per minute of water to the storm drain system of City of Alameda. Your proposed plan to assure that the discharge does not contain pollutants is acceptable. I also understand that the local sewer system will not accept this discharge.

The waiver of waste discharge requirements for this discharge contains the following conditions:

1. The water shall be stored in a tank as proposed prior to discharge.
2. Sampling of the water in the tank is required prior to the discharge of each batch. The sample shall be analyzed for benzene, toluene, ethylbenzene and xylene, volatile organics, and metals with results reported to Board staff prior to staff approval of the discharge of each batch. Grab samples are appropriate in this instance.
3. No water shall be discharged if levels exceed the following:
  - a. Total Petroleum Hydrocarbons - 50 parts per billion
  - b. Benzene, toluene, xylene, ethylbenzene - 5 ppb per compound.

4. This waiver expires December 7, 1990 or if terminated by the Board staff for noncompliance with conditions.

Please send monitoring results, and telephone results to Steven LuQuire of my staff at (415) 464-4222.

Sincerely,

**ORIGINAL SIGNED BY**

Steven R. Ritchie,  
Executive Officer

cc: Katherine Chesick, ACHD



## ASSOCIATION FOR COMPOSITE TANKS INSTALLATION CHECK LIST & RECORD OF INSTALLATION

ACT's installation check list is based on PEI/RP100 (Recommended Practices for the Installation of Underground Liquid Storage Systems) and NFPA-30. All tank installers should have copies of these publications, and should be familiar with the requirements therein. Section numbers below refer to PEI/RP100, which should be used in conjunction with this check list. Initial and date each blank, or insert "n/a" if not applicable.

- (Section 2.1-2.3) Tank(s) removed properly from truck and set down for test: ADK. If tank(s) are to be stored, chock with wood blocks or tires and tie down if necessary: ADK.
- (Section 2.4) Visually inspect tank(s) for non-conformance with specifications or damage: ADK. Notify the manufacturer immediately if damage or non-conformance is detected.
- (Section 2.5) SINGLE WALL TANK(S): Perform preliminary above-ground test in accordance with this section: \_\_\_\_\_  
NOTE: do not exceed 5 PSI (3 PSI for 12' diameter tanks).  
(SECTION 2.6) DOUBLE WALL TANK(S): Perform preliminary above-ground test in accordance with this section: ADK. It is vital that the instructions of this section be followed exactly, as overpressurization of the annulus may cause failure of the inner tank.
- (Section 3.1 - 3.8) Excavation is prepared in accordance with this section: ADK. If a concrete hold down pad is used, pad MUST be covered with 6 to 12 inches of approved backfill material: ADK.
- Tank(s) must be lowered into the excavation using procedures outlined in Section 2.2. It is recommended that all tanks be set with a slope of 1/8" per foot with vent at high end and fill (or piping manway) at low end to facilitate removal of water bottom. Tank(s) set properly into excavation: ADK.
- (Section 4.1 - 4.10) Backfill tank(s) in accordance with this Section of the specification: ADK. Special attention shall be paid to compaction of backfill under the haunches of the tank(s) (see figure 16): ADK.
- (Section 5.1 - 5.5) In buoyant conditions, appropriate anchorage is installed in accordance with this Section: ADK. Type and number of hold-down devices used: 4 Hold Straps per tank, Furnished with Tanks
- After piping and prior to final backfill, test system per NFPA-30 and local requirements, if any: ADK.

ACT Manufacturer: STOCKTON, CA #35  
Customer P.O. No.: I-4046 Manufacturer Contract No.: 35-0042  
UL Number(s) of Tank(s): J362511  
ACT Registration Number(s) of Tank(s): 3939  
Diameter(s) & Capacity of Tank(s): 8' x 32' 12,000 Gallon  
Date Installation started: 7-30-90 Date completed: 9-26-90  
Location of Tank(s): BALLENA ISLE MARINA Owner of Tank(s): ALMAR LTD.  
1150 BALLENA BLVD. 28441 HIGHRIDGE ROAD  
ALAMEDA, CA 94501 ROLLING HILLS ESTATES, CA  
Installing Company: COTTLE ENGINEERING 90274  
P.O. BOX 163  
ANTIOCH, CA 94509

The above installation has been conducted in accordance with ACT Installation Instructions listed above and with all applicable local, state and Federal requirements.

Installation Supervisor: ALVIN KNACKSTEDT  
Signature: [Signature]  
Owner representative: DON ANDERSON  
Signature: [Signature]  
Fire Marshal/Engineer/Inspector: Captain Helms  
Signature: [Signature]



A Tough New Breed

Buffalo Tank Corporation  
P.O. Box 60309, Jacksonville, FL 32236-0309

### INSTALLATION CHECK LIST

#### LTR Tanks

Buffalo Tank's installation requirements are based on PEI/RP100 (Recommended Practices for the Installation of Underground Liquid Storage Systems) and NFPA-30. All tank installers should have copies of these publications, and should be familiar with the requirements therein. Section numbers below refer to PEI/RP100, which should be used in conjunction with this check list. Initial and date each blank, or insert "n/a" if not applicable.

1. (Section 2.12 - 2.3) Tanks removed properly from truck and set down for test: ADK. If tanks are to be stored, chock with wood blocks or tires and tie down, if necessary: ADK.
2. (Section 2.4) Visually inspect tank for non-conformance with specifications or damage: ADK. Notify the manufacturer immediately if damage or non-conformance is detected.
3. (Section 2.6) Perform preliminary above-ground test in accordance with this section: ADK. It is vital that the instruction of this section be followed exactly, as over pressurization of the annulus may cause failure of the inner tank.
4. (Section 3.1 - 3.8) Excavation is prepared in accordance with this section: ADK. If a concrete hold down pad is used, pad MUST be covered with 6 to 12 inches of approved backfill material: ADK. If no concrete hold down pad is used, bottom of excavation MUST be covered with 6 to 12 inches of approved backfill material: ADK.
5. Tanks must be lowered into the excavation using procedures outlined in Section 2.2. It is recommended that all tanks be set with a slope of 1/8" per foot with AVPM manway at low end to facilitate removal of water bottom. Tanks set properly into excavation: ADK.
6. (Section 4.1 - 4.10) Backfill tanks in accordance with this Section of the specification: ADK. Special attention shall be paid to compaction of backfill under the haunches of the tank (see figure 16): ADK.
7. (Section 5.1 - 5.5) In buoyant conditions, appropriate anchorage is installed in accordance with this Section: ADK. Type and number of hold-down devices used: STRAPS FURNISHED WITH TANK. (Wire rope and round bar are not acceptable).
8. AVPM cover should NOT be removed in the field. If cover must be removed, contractor must conduct electrical discontinuity test between cover and manway neck.  
 Cover not removed during installation ADK  
 Cover removed during installation \_\_\_\_\_  
 Electrical discontinuity test performed \_\_\_\_\_
9. After piping and prior to final backfill, test system per NFPA-30 and local requirements, if any: ADK

Buffalo Tank Contract No: 35-0042

Customer Purchase Order No: I-4046L

Date Installation Started: 7-30-90

Date Installation Completed: 9-26-90

Installing Company: COTTLE ENGINEERING  
 Address: P.O. BOX 163  
ANTIOCH, CA 94509

Installation Supervisor: ALVIN KNACKSTEDT  
 Signature: [Signature]

Owner Representative: Don R. Anderson  
 Signature: [Signature]

This check list must be filled out completely. If any lines do not apply, insert the letters "n/a". The original should be returned to Buffalo Tank Corporation so that Warranty and Zero Product Release Certification may be issued.  
REV. 1, 4/90



Buffalo Tank Corporation  
P.O. Box 2755, Baltimore, MD 21225

## ZERO PRODUCT RELEASE

### Certificate of Insurance for Double Wall Buffalo-LTR Tank

For the life of the tank, at the original point of delivery and installation, Buffalo Tank Corporation shall maintain in effect property damage insurance against failures in tank integrity in the amount of no less than \$2,000,000.00 per occurrence for each double wall Buffalo-LTR Tank. Such coverage shall indemnify the owner against consequential damages resulting from a product release from the tank due to tank failure, provided the following conditions are met:

1. The tank must be used exclusively for the storage of petroleum products.
2. Buffalo Tank Corporation installation check list must be completed, signed and returned to Buffalo Tank prior to issuance of certification of insurance.
3. The installer must meet all E.P.A., other federal, state and local licensing requirements, where applicable, and must install the tank(s) in accordance with Buffalo Tank Corporation installation check list.
4. Interstitial monitoring equipment of a type approved by Buffalo Tank Corporation must be installed and maintained in accordance with the manufacturer's instructions, and must be operating at the time of any release.

Neither Buffalo Tank Corporation nor insurer shall be liable for any damages resulting from acts of god, war, fire, flood, vandalism or negligence on the part of owner, his agent or assigns.

This certification is not to be construed as an express warranty by the manufacturer. Coverage does not include any piping, dispensers or any equipment other than the tank itself.

DATE: AUGUST 1, 1990

CONTRACT NO.: 35-0042

CUSTOMER: COTTLE ENGINEERING / BELLINA MARINA

UL NO(S) OF TANK(S) J362511

LOCATION OF INSTALLATION 1150 Ballena Blvd., Alameda, CA 94501



# BUFFALO TANK CORPORATION

P. O. Box 2755  
Baltimore, Maryland 21225

(301) 355-1300  
(800) 368-2105

TO WHOM IT MAY CONCERN:

THIS LETTER IS TO CERTIFY THAT BUFFALO TANK CORPORATION HAS  
SPARK TESTED THE TANK BEARING UNDERWRITER'S LABORATORIES INC.,  
U.L. # J362511, AT THE JOBSITE, 35,000 VOLTS, AND  
FOUND THE TANK TO BE FREE FROM VOIDS AND HOLIDAYS.

BUFFALO TANK CORPORATION

Nal Jackson  
TESTED BY:

8-1-90  
DATE:

WELDED PLATE CONSTRUCTION

FABRICATING PLANTS

BALTIMORE MD

JACKSONVILLE FL

CHARLOTTE NC

RALEIGH NC

ANN ARBOR MI

WORCESTER MA



**BUFFALO TANK CORPORATION**  
P.O. BOX 2755  
BALTIMORE, MD 21225

SHIPPER'S NO.  
**35-35**

REQ. JOB. CONTRACT NO. <b>35-0042</b>	PURCHASE ORDER DATE <b>6/28/90</b>	PURCHASE ORDER NO. <b>I-4046</b>	RELEASE
BUFFALO TANK CORPORATION 5709 E. FREMONT ST. STOCKTON, CA 95205			
S O L D T O PERKINS WELDING WORKS P.O. BOX 28639 SACRAMENTO, CA 95828		COITTE ENGINEERING C/O BELLINA MARINA  ALAMEDA, CA	

FROM <b>STOCKTON, CA</b>	ROUTE	<b>GILLIES TRUCKING</b>
DATE SHPD <b>8-1-90</b>	FOB <b>LAM ALAMEDA, CA</b>	FRT. I.P.

VEHICLE IDENTIFICATION    NO. PCS/PKGS    KIND OF PACKAGE, DESCRIPTION OF ARTICLES, SPECIAL MARKS AND EXCEPTIONS    WEIGHT (POUNDS)

- (1 OF 2)      1      12,000 Gallon, LTR-Tanks, U/L#58, 96" dia.  
X 32' long-BUFFHIDE Coating-Per U/L#1746.      16,399#
- 4      S34.96 Hold Down Straps-3/8" X 3" Epoxy Coat
- 1      SC.43FG 43" Dia. FRP Collars  
  
U/L#J362511    and    ACT #3939

GOING TO: BELLINA MARINA  
1150 BELLINA BLVD.  
ALAMEDA, CA

*D. [Signature]*  
8-1-90



**CAUTION**—TO RECOVER THROUGH SUPPLIER FOR ANY LOSS OR DAMAGE IN TRANSIT, CONSIGNEE MUST TAKE PROPER EXCEPTIONS AT TIME OF DELIVERY.

**SHIPPING NOTICE**



RE. JOB. CONTRACT NO. <b>35-0042</b>	PURCHASE ORDER DATE <b>6/23/90</b>	PURCHASE ORDER NO. <b>I-4046</b>	RELEASE
BUFFALO TANK CORPORATION 5709 S. FREDONT ST. SACRAMENTO, CA 95205			
<del>                     RECEIVED LADING WORK                      P.O. BOX 28659                      SACRAMENTO, CA 95828                 </del>		COTLER ENGINEERING C/O BELLETTA MARINA ALAMEDA, CA	

FROM <b>SACRAMENTO, CA</b>	ROUTE <b>CELESTINE</b>
DATE SHPD <b>8-1-90</b>	FOB <b>LOS ANGELES, CA</b>

VEHICLE IDENTIFICATION	NO. PCS/PKGS	KIND OF PACKAGE, DESCRIPTION OF ARTICLES, SPECIAL MARKS AND EXCEPTIONS	WEIGHT (POUNDS)
(1 OF 2)	1	12,000 Gallon, LTR-Tanks, U/L258, 98" dia. X 32' long-BUFFLIDE Coating-Per U/L#1745.	16,399#
	4	334.96 Hold Down Straps-3/8" X 3" Epoxy Coat	
	1	5C.43PC 43" Dia. FRP Collars	

RECEIVED, subject to the classifications and tariffs in effect on the date of the issue of this Bill of Lading, the property described above, in apparent good order, except as noted (contents and condition of contents of packages unknown), marked, consigned, and destined as indicated above, which said carrier (the word carrier being understood throughout this contract as meaning any person or corporation in possession of the property under the contract) agrees to carry to its usual place of delivery at said destination, if on its route, otherwise to deliver to another carrier on the route to said destination. It is mutually agreed, as to each carrier of all or of any of said property over all or any portion of said route to destination, and as to each party at any time interested in all or any of said property, that every service to be performed hereunder shall be subject to all the terms and conditions of the domestic straight bill of lading prescribed in the Uniform Freight Classification, the National Motor Freight Classification or such other classification or tariff which states the applicable bill of lading terms and conditions.

Shipper hereby certifies that he is familiar with all the terms and conditions of the said bill of lading, including those on the back thereof, set forth in the classification or tariff which governs the transportation of this shipment, and the said terms and conditions are hereby agreed to by the shipper and accepted for himself and his assigns.

† When executed by or on behalf of one other than a carrier, this document acknowledges receipt of the described property in good order.

\* If the shipment moves between two ports by a carrier by water, the law requires that the Bill of Lading shall state whether it is carrier's or shipper's weight.

† Not a part of Bill of Lading approved by Interstate Commerce Commission.

UNLESS OTHERWISE STATED HEREON, "PREPAID" FREIGHT BILLS shall be forwarded to CONTROLLER at the "FROM" location.

Pursuant to the non-recourse provision of Section 7 of the Bill of Lading, the carrier shall not make delivery of this shipment without payment of freight and all other lawful charges.

**BUFFALO TANK CORPORATION**  
 Exceptions: On shipments delivered by railroads to export, coast-wise or intercoastal movement by water on which the applicable tariff includes the requirement therefor, Buffalo Tank Corporation, when con signor, guarantees payment of all lawful charges.

If charges are to be prepaid, the word "Prepaid" will be written in the blank at the top of this form following the word "FRT."

On EXPORT Shipments the following applies:  
 These commodities licensed by U.S. for ultimate destination as noted above. Diversion contrary to U.S. law prohibited.

**CERTIFICATION OF HAZARDOUS MATERIALS, SUBSTANCES, AND WASTES**  
 This is to certify that the above-named materials are properly classified, described, packaged, marked and labeled, and are in proper condition for transportation according to the applicable regulations of the Department of Transportation and the EPA.

Per \_\_\_\_\_

† **CERTIFICATION OF COMPLIANCE**  
 I certify that shipment covered by this bill of lading was loaded by me or at my direction; that I inspected the load after it was placed and secured upon the motor vehicle; that said motor vehicle conforms with the Motor Carrier Safety Regulations and Specifications issued by the Department of Transportation and that the load was secured thereon in accordance with such regulations and specifications.

By \_\_\_\_\_  
 (Driver Signature)

Date \_\_\_\_\_

Witness \_\_\_\_\_

Agent \_\_\_\_\_

Per \_\_\_\_\_



## ASSOCIATION FOR COMPOSITE TANKS INSTALLATION CHECK LIST & RECORD OF INSTALLATION

ACT's installation check list is based on PEI/RP100 (Recommended Practices for the Installation of Underground Liquid Storage Systems) and NFPA-30. All tank installers should have copies of these publications, and should be familiar with the requirements therein. Section numbers below refer to PEI/RP100, which should be used in conjunction with this check list. Initial and date each blank, or insert "n/a" if not applicable.

1. (Section 2.1-2.3) Tank(s) removed properly from truck and set down for test: ADK. If tank(s) are to be stored, chock with wood blocks or tires and tie down if necessary: ADK.
2. (Section 2.4) Visually inspect tank(s) for non-conformance with specifications or damage: ADK. Notify the manufacturer immediately if damage or non-conformance is detected.
3. (Section 2.5) SINGLE WALL TANK(S): Perform preliminary above-ground test in accordance with this section: ADK.  
NOTE: do not exceed 5 PSI (3 PSI for 12' diameter tanks).
- (SECTION 2.6) DOUBLE WALL TANK(S): Perform preliminary above-ground test in accordance with this section: ADK. It is vital that the instructions of this section be followed exactly, as overpressurization of the annulus may cause failure of the inner tank.
4. (Section 3.1 - 3.8) Excavation is prepared in accordance with this section: ADK. If a concrete hold down pad is used, pad MUST be covered with 6 to 12 inches of approved backfill material: ADK.
5. Tank(s) must be lowered into the excavation using procedures outlined in Section 2.2. It is recommended that all tanks be set with a slope of 1/8" per foot with vent at high end and fill (or piping manway) at low end to facilitate removal of water bottom. Tank(s) set properly into excavation: ADK.
6. (Section 4.1 - 4.10) Backfill tank(s) in accordance with this Section of the specification: ADK. Special attention shall be paid to compaction of backfill under the haunches of the tank(s) (see figure 16): ADK.
7. (Section 5.1 - 5.5) In buoyant conditions, appropriate anchorage is installed in accordance with this Section: \_\_\_\_\_ Type and number of hold-down devices used: 4 HOLD DOWN STRAPS PER TANK, FURNISHED WITH TANKS.
8. After piping and prior to final backfill, test system per NFPA-30 and local requirements, if any: ADK.

ACT Manufacturer: BUFFALO TANK CORPORATION #35  
 Customer P.O. No.: I-4046 Manufacturer Contract No.: 35-0042  
 UL Number(s) of Tank(s): J362510  
 ACT Registration Number(s) of Tank(s): 3938  
 Diameter(s) & Capacity of Tank(s): 8' x 32' 12,000 Gallon  
 Date Installation started: 7-30-90 Date completed: 9-26-90  
 Location of Tank(s): BALLENA ISLE MARINA Owner of Tank(s): ALMAR LTD.  
1150 BALLENA BLVD. 28441 HIGHRIDGE RD.  
ALAMEDA, CA 94501 ROLLING HILLS ESTATES, CA  
 Installing Company: COTTLE ENGINEERING 90274  
P.O. BOX 163  
ANTIOCH, CA 94509

The above installation has been conducted in accordance with ACT Installation Instructions listed above and with all applicable local, state and Federal requirements.

Installation Supervisor: ALVIN KNACKSTEDT  
 Signature: [Signature]  
 Owner representative: DON ANDERSON  
 Signature: [Signature]  
 Fire Marshal/Engineer/Inspector: Captain Nelson  
 Signature: [Signature]



A Tough New Breed

Buffalo Tank Corporation  
P.O. Box 60309, Jacksonville, FL 32236-0309

## INSTALLATION CHECK LIST

### LTR Tanks

Buffalo Tank's installation requirements are based on PEI/RP100 (Recommended Practices for the Installation of Underground Liquid Storage Systems) and NFPA-30. All tank installers should have copies of these publications, and should be familiar with the requirements therein. Section numbers below refer to PEI/RP100, which should be used in conjunction with this check list. Initial and date each blank, or insert "n/a" if not applicable.

- (Section 2.12 - 2.3) Tanks removed properly from truck and set down for test: ADK. If tanks are to be stored, chock with wood blocks or tires and tie down if necessary: ADK.
- (Section 2.4) Visually inspect tank for non-conformance with specifications or damage: ADK. Notify the manufacturer immediately if damage or non-conformance is detected.
- (Section 2.6) Perform preliminary above-ground test in accordance with this section: ADK. It is vital that the instruction of this section be followed exactly, as over pressurization of the annulus may cause failure of the inner tank.
- (Section 3.1 - 3.8) Excavation is prepared in accordance with this section: ADK. If a concrete hold down pad is used, pad MUST be covered with 6 to 12 inches of approved backfill material: ADK. If no concrete hold down pad is used, bottom of excavation MUST be covered with 6 to 12 inches of approved backfill material: ADK.
- Tanks must be lowered into the excavation using procedures outlined in Section 2.2. It is recommended that all tanks be set with a slope of 1/8" per foot with AVPM manway at low end to facilitate removal of water bottom. Tanks set properly into excavation: ADK.
- (Section 4.1 - 4.10) Backfill tanks in accordance with this Section of the specification: ADK. Special attention shall be paid to compaction of backfill under the haunches of the tank (see figure 16): ADK.
- (Section 5.1 - 5.5) In buoyant conditions, appropriate anchorage is installed in accordance with this Section: ADK. Type and number of hold-down devices used: STRAPS FURNISHED WITH TANK. (Wire rope and round bar are not acceptable).
- AVPM cover should NOT be removed in the field. If cover must be removed, contractor must conduct electrical discontinuity test between cover and manway neck.  
Cover not removed during installation ADK  
Cover removed during installation \_\_\_\_\_  
Electrical discontinuity test performed \_\_\_\_\_
- After piping and prior to final backfill, test system per NFPA-30 and local requirements, if any: ADK

Buffalo Tank Contract No: 350042

Customer Purchase Order No: I-4046

Date Installation Started: 7-30-90

Date Installation Completed: 9-26-90

Installing Company: COTTLE ENGINEERING

Address: P.O. BOX 163

ANTIOCH, CA 94509

Installation Supervisor: ALVIN KNACKSTEDT

Signature: [Signature]

Owner Representative: DON ANDERSON

Signature: [Signature]

This check list must be filled out completely. If any lines do not apply, insert the letters "n/a". The original should be returned to Buffalo Tank Corporation so that Warranty and Zero Product Release Certification may be issued.



# BUFFALO TANK CORPORATION

P. O. Box 2755  
Baltimore, Maryland 21225

(301) 355-1300  
(800) 368-2105

TO WHOM IT MAY CONCERN:

THIS LETTER IS TO CERTIFY THAT BUFFALO TANK CORPORATION HAS  
SPARK TESTED THE TANK BEARING UNDERWRITER'S LABORATORIES INC.,  
U.L. # J362510, AT THE JOBSITE, 35,000 VOLTS, AND  
FOUND THE TANK TO BE FREE FROM VOIDS AND HOLIDAYS.

BUFFALO TANK CORPORATION

*Nal Jackson*  
TESTED BY:

8-1-90  
DATE:

WELDED PLATE CONSTRUCTION

FABRICATING PLANTS

BALTIMORE MD

JACKSONVILLE FL

CHARLOTTE NC

RALEIGH NC

POMULUS MI

WORCESTER MA



Buffalo Tank Corporation  
P.O. Box 2755, Baltimore, MD 21225

## ZERO PRODUCT RELEASE

### Certificate of Insurance for Double Wall Buffhide-LTR Tank

For the life of the tank, at the original point of delivery and installation, Buffalo Tank Corporation shall maintain in effect property damage insurance against failures in tank integrity in the amount of no less than \$2,000,000.00 per occurrence for each double wall Buffhide-LTR Tank. Such coverage shall indemnify the owner against consequential damages resulting from a product release from the tank due to tank failure, provided the following conditions are met:

1. The tank must be used exclusively for the storage of petroleum products.
2. Buffalo Tank Corporation installation check list must be completed, signed and returned to Buffalo Tank prior to issuance of certification of insurance.
3. The installer must meet all E.P.A., other federal, state and local licensing requirements, where applicable, and must install the tank(s) in accordance with Buffalo Tank Corporation installation check list.
4. Interstitial monitoring equipment of a type approved by Buffalo Tank Corporation must be installed and maintained in accordance with the manufacturer's instructions, and must be operating at the time of any release.

Neither Buffalo Tank Corporation nor insurer shall be liable for any damages resulting from acts of god, war, fire, flood, vandalism or negligence on the part of owner, his agent or assigns.

This certification is not to be construed as an express warranty by the manufacturer. Coverage does not include any piping, dispensers or any equipment other than the tank itself.

DATE: AUGUST 1, 1990 CONTRACT NO.: 35-0042

CUSTOMER: COITTE ENGINEERING / BELLINA MARINA

UL NO(S) OF TANK(S) J362510

LOCATION OF INSTALLATION 1150 Ballena Blvd., Alameda, CA 94501

**BUFFALO TANK CORPORATION**

P.O. BOX 2755  
BALTIMORE, MD 21225

SHIPPER'S NO.

35-34

REQ JOB CONTRACT NO. 35-0042	PURCHASE ORDER DATE 6/28/90	PURCHASE ORDER NO. I-4046	RELEASE
BUFFALO TANK CORPORATION 5709 W. FREMONT ST. STOCKTON, CA 95205			
S O L D T O PERKINS WELDING WORKS P.O. BOX 28639 SACRAMENTO, CA 95828		COTTE ENGINEERING C/O BELLINA MARINA  ALAMEDA, CA	
FROM STOCKTON, CA	ROUTE	GILLIES TRUCKING	
DATE SHIP 8-1-90	FOB ALAMEDA, CA	FRT F.I.P.	

VEHICLE IDENTIFICATION NO. PCS/PKGS KIND OF PACKAGE, DESCRIPTION OF ARTICLES, SPECIAL MARKS AND EXCEPTIONS WEIGHT (POUNDS)

- |          |   |   |
|----------|---|---|
| (1 OF 2) | 1 | 12,000 Gallon, LTR-Tanks, U/L#58, 96" dia.<br>X 32' long-"BUFFHIDE" Coating-Per U/L#1746. 16,399# |
|          | 4 | S34.96 Hold Down Straps-3/8" X 3" Epoxy coat  |
|          | 1 | Sc.43fg 43" Dia. FRP Collars<br><br>U/L#J362510 and ACT #3938                                     |

GOING TO: BELLINA MARINA  
1150 BELLINA BLVD.  
ALAMEDA, CA

*Wafford*  
8-1-90



CAUTION—TO RECOVER THROUGH SUPPLIER FOR ANY LOSS OR DAMAGE IN TRANSIT, CONSIGNEE MUST TAKE PROPER EXCEPTIONS AT TIME OF DELIVERY.

**SHIPPING NOTICE**



REQ. JOB CONTRACT NO. 35-0772	PURCHASE ORDER DATE 1/25/90	PURCHASE ORDER NO. I-4046	RELEASE:
BUFFALO TANK CORPORATION 5709 P. FREMONT ST. STOCKTON, CA 95205			
<del>SOLD TO PETERSON PAVING WORKS P.O. BOX 28674 SACRAMENTO, CA 95828</del>		COMTE ENGINEERING C/O DELLINA MARINA ALAMEDA, CA	

FROM WYCKOFF, CA	ROUTE ATLANTA TRUCKING
DATE SHIPD 2-1-90	FOB ATLANTA, CA
FRT F.I.P.	

VEHICLE IDENTIFICATION	NO. PCS/PKGS	KIND OF PACKAGE, DESCRIPTION OF ARTICLES, SPECIAL MARKS AND EXCEPTIONS	WEIGHT (POUNDS)
(1 of 2)	1	12,000 Gallon, LTR-Tanks, U/L#58, 56" dia. X 32' long-"BURFIDE" Coating-Per U/L#1740.	16,395#
	4	804.96 Hold Down Straps 3/8" X 3" Epoxy coat	
	1	Sc.43fg 43" Dia. FRP Collars	

RECEIVED, subject to the classifications and tariffs in effect on the date of the issue of this Bill of Lading, the property described above, in apparent good order, except as noted (contents and condition of contents of packages unknown), marked, consigned, and destined as indicated above, which said carrier (the word carrier being understood throughout this contract as meaning any person or corporation in possession of the property under the contract) agrees to carry to its usual place of delivery at said destination, if on its route, otherwise to deliver to another carrier on the route to said destination. It is mutually agreed, as to each carrier of all or any of said property over all or any portion of said route to destination, and as to each party at any time interested in all or any of said property, that every service to be performed hereunder shall be subject to all the terms and conditions of the domestic straight bill of lading prescribed in the Uniform Freight Classification, the National Motor Freight Classification or such other classification or tariff which states the applicable bill of lading terms and conditions.

Shipper hereby certifies that he is familiar with all the terms and conditions of the said bill of lading, including those on the back thereof, set forth in the classification or tariff which governs the transportation of this shipment, and the said terms and conditions are hereby agreed to by the shipper and accepted for himself and his assigns.

† When executed by or on behalf of one other than a carrier, this document acknowledges receipt of the described property in good order.

\* If the shipment moves between two ports by a carrier by water, the law requires that the Bill of Lading shall state whether it is carrier's or shipper's weight.

† Not a part of Bill of Lading approved by Interstate Commerce Commission.

UNLESS OTHERWISE STATED HEREON, "PREPAID" FREIGHT BILLS shall be forwarded to CONTROLLER at the "FROM" location.

Pursuant to the non-recourse provision of Section 7 of the Bill of Lading, the carrier shall not make delivery of this shipment without payment of freight and all other lawful charges.

**BUFFALO TANK CORPORATION**

Exceptions: On shipments delivered by railroads for export, coast-wise or intercoastal movement by water on which the applicable tariff includes the requirement therefor, Buffalo Tank Corporation, when consignor, guarantees payment of all lawful charges.

If charges are to be prepaid, the word "Prepaid" will be written in the blank at the top of this form following the word "FRT."

On EXPORT Shipments the following applies: These commodities licensed by U.S. for ultimate destination as noted above. Diversion contrary to U.S. law prohibited.

**CERTIFICATION OF HAZARDOUS MATERIALS, SUBSTANCES, AND WASTES**

This is to certify that the above-named materials are properly classified, described, packaged, marked and labeled, and are in proper condition for transportation according to the applicable regulations of the Department of Transportation and the EPA.

Per \_\_\_\_\_

† **CERTIFICATION OF COMPLIANCE**

I certify that shipment covered by this bill of lading was loaded by me or at my direction; that I inspected the load after it was placed and secured upon the motor vehicle; that said motor vehicle conforms with the Motor Carrier Safety Regulations and Specifications issued by the Department of Transportation and that the load was secured thereon in accordance with such regulations and specifications.

By \_\_\_\_\_ (Driver Signature)

Date \_\_\_\_\_

Witness \_\_\_\_\_

Agent

Per \_\_\_\_\_





### WARRANTY & CHECKOUT FORM PART II

Date of Installation 9/18/90

Is Auto-Stik system connected to a modem?  Yes  No

If Yes, what type of modem? \_\_\_\_\_ Phone number \_\_\_\_\_

Controller power supply is connected with good earth ground using a 12 AWG wire  Yes  No

Did you encounter any problems during checkout start-up?  Yes  No

If Yes, describe Could not get the system to keep and alarm any of the contacts except #1. When the Regulator came to sign off on the system, we couldn't get the system to audible. New eeprom was installed and system works good.

**Distributor:**

I hereby certify that this system has to be installed & set-up in accordance with the procedures specified in EBW Auto-Stik Site Prep. & Installation and Start-up & Operation Manuals. I have also read all the warning and certify that there are no intrinsic safety violations due to improper installation of this system.

Certification No. 1192 and 1210

Invoice No. \_\_\_\_\_

Signature \_\_\_\_\_

Date 9/26/90

Company Name Perkins Welding Inc.

Address 3162 Baumberg, Unit B

Hayward, CA 94545

Phone 415-887-8233

**Customer:**

All equipment has been installed properly and is operating correctly  Yes  No

I have been trained in the proper operation of this equipment  Yes  No

Signature H. Anderson

Date 9-26-90

TO VALIDATE WARRANTY: RETURN ONE COPY OF PART I, ONE COPY OF PART II, AND A COPY OF THE TANK SET-UP INFORMATION PRINT OUT F64, TO: EBW, 2814 McCracken Ave., Muskegon, MI 49441



2814 McCracken Ave., • Muskegon, Michigan 49441 • 616/755-1871

### WARRANTY & CHECK OUT FORM PART I

<p style="text-align: center;"><b>INSTALLATION LOCATION</b></p> <p>Date <u>9/26/90</u></p> <p>Station Name <u>Ballena Isle Marina</u></p> <p>Street <u>1150 Ballena Blvd.</u></p> <p>City <u>Alameda</u> St. <u>CA</u> Zip <u>94501</u></p> <p>Phone <u>415-523-5528</u></p> <p>Owner/Manager <u>Don Anderson</u></p>	<p style="text-align: center;"><b>INSTALLED BY</b></p> <p>Company Name <u>Cottle Engineering</u></p> <p>Street <u>PO Box 163</u></p> <p>City <u>Antioch</u> St. <u>CA</u> Zip <u>94509</u></p> <p>Installation Supervisor <u>Alvin Knackstedt</u></p> <p>Certification No. <u>1210</u></p>	<p style="text-align: center;"><b>DISTRIBUTOR</b></p> <p>Company Name <u>Perkins Welding</u></p> <p>Street <u>3162 Baumberg, Unit B</u></p> <p>City <u>Hayward</u> St. <u>CA</u> Zip <u>94545</u></p> <p>Invoice No. _____</p>
---	--	--

### TANK SET-UP INFORMATION

	1	2	3	4	5	6	7	8
PROBE SER. NO.	C030	C037						
PRODUCT LABEL	40	15						
SPEED OF WIRE	9.363	9.346						
REP. RATE	21.42	20.12						
TANK MANUFACTURE & MODEL	Buffalo LTR 12,000 gallon double walled					<b>Contacts</b>		
TANK SHELL — STEEL OR FIBERGLASS	Steel	Steel				#1-diesel	tank sump	
IF STEEL TANK — DIAMETER IN INCHES	96	96				#2-diesel	tank annular	
TANK CAPACITY — GALLONS FULL	12,126	12,126				#3-gasoline	tank sump	
IF FIBERGLASS — ¼ CAPACITY GALLONS	NA	NA				#4-gasoline	tank annular	
TANK TILT	∅	∅						
DIST. OF PROBE RISER TO CENTER OF TANK	NA	NA						
DIST. BETWEEN FILL RISER AND PROBE RISER	NA	NA						
FUEL HEIGHT AT FILL RISER	∅	∅						
FUEL HEIGHT AT PROBE RISER	NA	NA						
MANIFOLDED TANKS	NA	NA						
INITIAL WATER LEVEL	∅	∅						
INITIAL PRODUCT LEVEL	∅	∅						
HIGH LEVEL ALARM LIMIT (GALLONS)	10,500	10,500						
LOW LEVEL ALARM LIMIT (GALLONS)	1,500	1,500						
HIGH WATER ALARM	2"	2"						
THEFT GALLON LIMIT	10	10						
LEAK DETECT THRESHOLD	.2	.2						
LEAK DETECT START TIME	12:am	12:am						
LEAK DETECT STOP TIME	4:am	4:am						
RELAY #1								
RELAY #2								
RELAY #3								
RELAY #4								

TO VALIDATE WARRANTY: RETURN ONE COPY OF PART I, ONE COPY OF PART II, AND A COPY OF THE TANK SET-UP INFORMATION PRINT OUT F64. TO: EBW, 2814 McCracken Ave., Muskegon, MI 49441

\*\*\*\*\*  
\*\*\* TANK STATISTICS \*\*\*

BALLENA ISLE MARINA  
1150 BALLENA BLVD.  
ALAMEDA, CA 94501

10:19 AM 9/26/90  
SOFTWARE REVISION  
EBW 604 DATED 9/21/90  
RELAY 1: NOT PROGRAMMED  
RELAY 2: NOT PROGRAMMED  
RELAY 3: NOT PROGRAMMED  
RELAY 4: NOT PROGRAMMED  
PROBE ERROR SIGNAL: HIGH  
2 TANKS IN SERVICE

-----TANK 1-----

STEEL  
INSIDE DIAMETER 96.00IN  
TOTAL VOLUME 12126 GAL  
TILT TO CENTER 0.00IN  
TILT HIGH END 0.00IN  
TILT LOW END 0.00IN  
WIRE SPEED: 9.363 uS/IN  
REP RATE: 21.42 mS@25°C  
LINEAR SCALE 0.00  
HIGH ALARM 10500 GAL  
LOW ALARM 0 GAL  
WATER ALARM 2.00IN  
LEAK DETECT 0.20 GPH  
THEFT ALARM 10 GAL  
FUEL: DIESEL 2

-----TANK 2-----

STEEL  
INSIDE DIAMETER 96.00IN  
TOTAL VOLUME 12126 GAL  
TILT TO CENTER 0.00IN  
TILT HIGH END 0.00IN  
TILT LOW END 0.00IN  
WIRE SPEED: 9.346 uS/IN  
REP RATE: 20.12 mS@25°C  
LINEAR SCALE 0.00  
HIGH ALARM 10500 GAL  
LOW ALARM 0 GAL  
WATER ALARM 2.00IN  
LEAK DETECT 0.20 GPH  
THEFT ALARM 20 GAL  
FUEL: REGULAR LEADED

\*\*\*\*\*



2814 McCracken Ave. • Muskegon, MI 49441

2 AUTO/STIK®  
950 PROBE

SERIAL #: 8W36910030037

PART NO.: 7030-E W-076-105



2814 McCracken Ave. • Muskegon, MI 49441

4 AUTO/STIK®  
950 PROBE

SERIAL #: 8W36910030030

PART NO.: 7030-E W-076-105