



November 2, 1992

STD 1976

92 Nov 16 11:50

Jeff Sharpio
Alameda County Department
of Environmental Health
80 Swan Way, Room 200
Oakland, CA 94621-1426

Re: Shell Service Station
WIC #204-4380-0303
318 South Livermore Avenue
Livermore, California
WA Job #81-613-201

Dear Mr. Sharpio:

This letter describes recently completed and anticipated activities at the Shell service station referenced above (Figure 1). This status report satisfies the quarterly reporting requirements prescribed by California Administrative Code Title 23 Waters, Chapter 3, Subchapter 16, Article 5, Section 265.d. Included below are descriptions and results of activities performed in the third quarter 1992 and proposed work for the fourth quarter 1992.

Third Quarter 1992 Activities:

- Aegis Environmental, Inc. (Aegis) of Roseville, California measured depths to ground water and collected ground water samples from one of the four site wells. Wells MW-1, MW-2 and MW-3 were dry and were not sampled. Aegis' report describing these activities and presenting analytic results for ground water is included as Attachment A.
- Weiss Associates (WA) did not prepare a ground water elevation contour map since three of the wells were dry.

Anticipated Fourth Quarter 1992 Activities:

WA will submit a report presenting the results of the fourth quarter 1992 ground water sampling and ground water depth measurements. The report will include tabulated chemical

Jeff Sharpio
November 2, 1992

2

Weiss Associates 

analytic results and a ground water elevation contour map.

Please call if you have any questions.

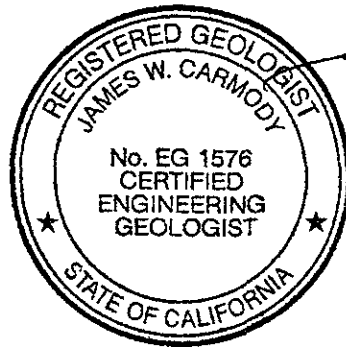

Sincerely,
Weiss Associates



J. Michael Asport
Technical Assistant

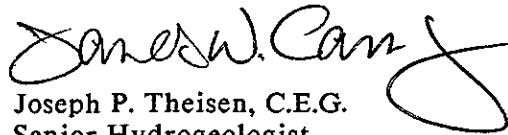

Joseph P. Theisen, C.E.G.
Senior Hydrogeologist

JMA/JPT:jma

E:\ALL\SHELL\600\613QMSE2.WP

Attachments: Figures
A - Aegis' Ground Water Monitoring Report

cc: Dan Kirk, Shell Oil Company, P.O. Box 5278, Concord, CA 94520
Tom Callaghan, Water Quality Control Board, San Francisco Bay Region, 2101 Webster
Street, Oakland, CA 94612

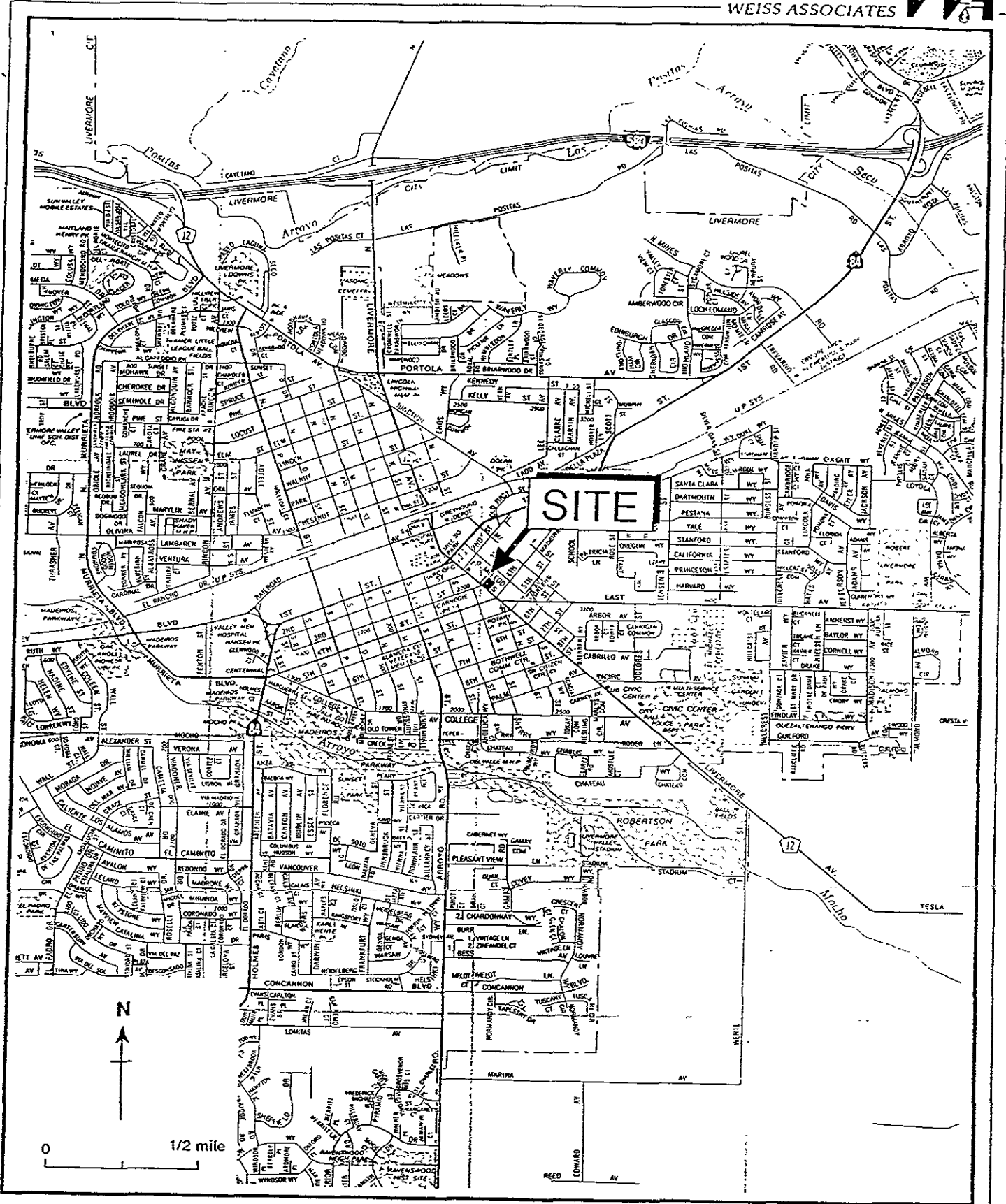

Figure 1. Site Location Map - Shell Service Station WIC #204-4380-0303, 318 South Livermore Avenue, Livermore, California

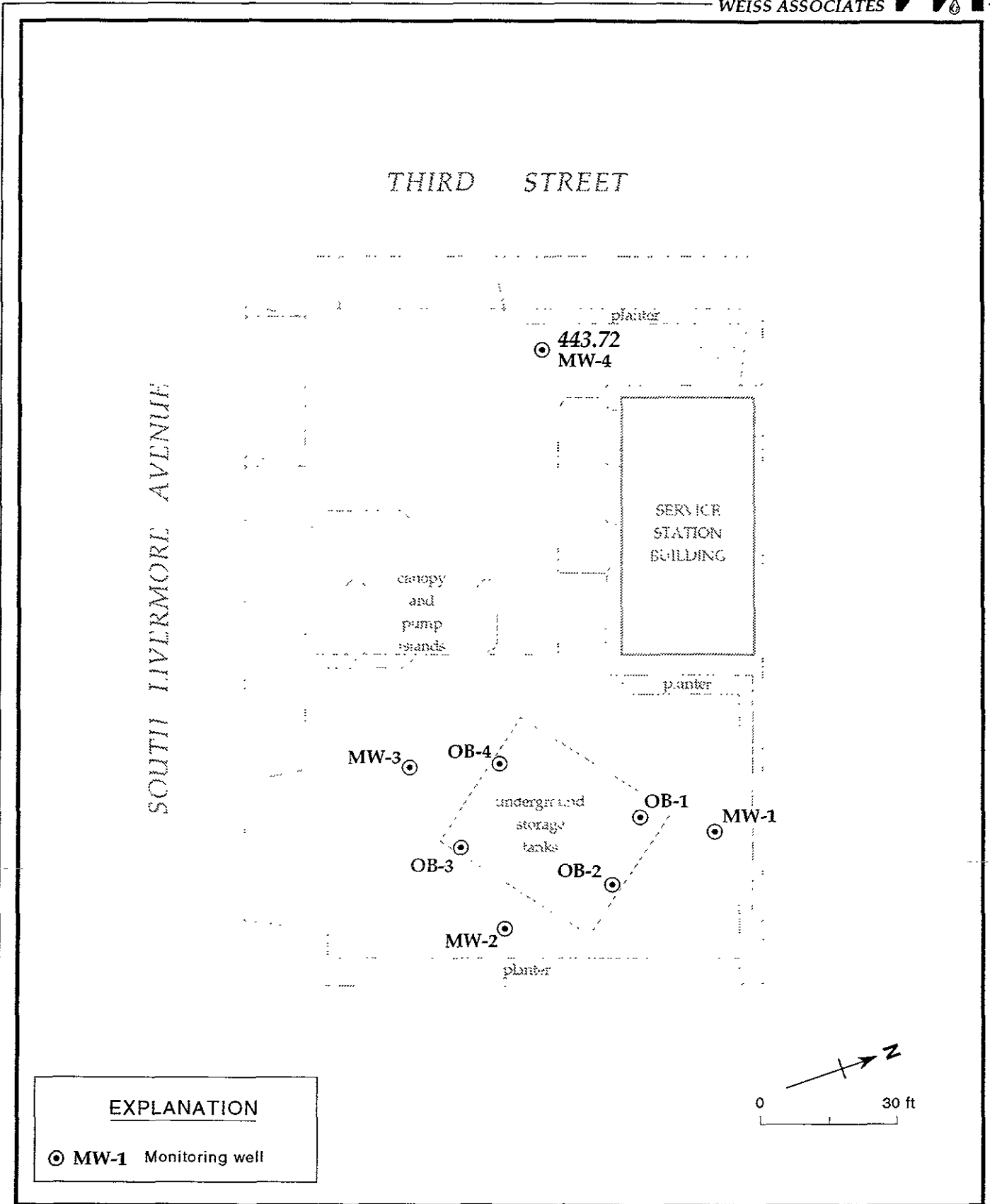

Figure 2. Monitoring Well Locations - Shell Service Station WIC #204-4380-0303, 318 South Livermore Avenue, Livermore, California

ATTACHMENT A
GROUND WATER MONITORING REPORT AND ANALYTIC REPORT



EMCON
ASSOCIATES

Consultants in Wastes
Management and
Environmental Control

September 29, 1992
Project: G67-73.01
WIC#: 204-4380-0303

Mr. David Elias
Weiss Associates
5500 Shellmound Street
Emeryville, California 94608-2411

Re: Third quarter 1992 ground-water monitoring report, Shell Oil
Company, 318 S. Livermore Avenue, Livermore, California

Dear Mr. Elias:

This letter presents the results of the third quarter 1992 ground-water monitoring event for the Shell Oil Company (Shell) site located at 318 S. Livermore Avenue, Livermore, California (figure 1). Third quarter monitoring was conducted on September 2, 1992. Wells MW-1 through MW-4 are sampled quarterly; wells OB-1 through OB-4 are not sampled.

GROUND-WATER LEVEL SURVEY

A water-level survey preceded the purging and sampling of the monitoring wells. The wells included in the survey are identified in figure 2 (supplied by Weiss Associates). During the survey, wells MW-1 through MW-4 and OB-1 through OB-4 were measured for depth to water, floating product thickness, and total depth. Depth to water and floating product thickness were measured to the nearest 0.01 foot with an oil/water interface probe. No floating product was observed in any wells. Total depth was measured to the nearest 0.1 foot. Results of the third quarter water-level survey, and available data from four previous surveys, are summarized in table 1.

SAMPLING AND ANALYSIS

Ground-water samples were collected from well MW-4 on September 2, 1992. Wells MW-1, MW-2, and MW-3 were dry and were not sampled during third quarter monitoring. Prior to sample collection, the well was purged with a polyvinyl chloride bailer. During the purging operation, ground water was monitored for pH, electrical conductivity, and temperature as a function of volume of water removed. Purging continued until these parameters were stable and a minimum of three casing volumes of ground water were removed. Field measurements from third quarter monitoring, and available measurements from four previous monitoring events, are summarized in table 1. Purge water from the monitoring well

G677301A.DOC



was contained in a 55-gallon drum. The drum was identified with a Shell-approved label and secured for on-site storage.

Ground-water samples were collected with a Teflon® bailer, labeled, placed on ice, and transported to Anametrix Inc. for analysis. Shell chain-of-custody documents accompanied all samples to the laboratory.

All equipment that was placed down a well or that came in contact with ground water was steam cleaned with deionized water prior to use at each well.

Quality control samples for third quarter monitoring included a trip blank (TB), and a field blank (FB), and a duplicate well sample (MW-4D) collected from well MW-4. All water samples collected during third quarter monitoring were analyzed for total petroleum hydrocarbons as gasoline (TPH-g), and benzene, toluene, ethylbenzene, and total xylenes (BTEX). Additional ground-water samples collected from well MW-4 were analyzed for dissolved lead by U.S. Environmental Protection Agency method 7421.

ANALYTICAL RESULTS

Analytical results for the third quarter 1992 monitoring event, and available results from four previous monitoring events, are summarized in table 2. Dissolved lead results for well MW-4 are not included in table 2 (please refer to the certified analytical report). The original certified analytical report and the final chain-of-custody document are attached.

If you have any questions, please call.

Very truly yours,

EMCON Associates



David Larsen
Environmental Sampling Coordinator



Orrin Childs
Environmental Sampling Supervisor

DL/OC:dl

Attachments: Table 1 - Monitoring well field measurement data
Table 2 - Summary of analytical results
Figure 1 - Site location map
Figure 2 - Monitoring well locations
Certified analytical report
Chain-of-custody document

Table 1
Monitoring Well Field Measurement Data
Third Quarter 1992

Shell Station: 318 South Livermore Avenue
Livermore, California
WIC #: 204-4380-0303

Date: 09/29/92
Project Number: G67-73.01

Well Designation	Water Level Field Date	TOC Elevation (ft-MSL)	Depth to Water (feet)	Ground- water Elevation (ft-MSL)	Total Well Depth (feet)	Floating Product Thickness (feet)	Water Sample Field Date	pH (std. units)	Electrical Conductivity (micromhos/cm)	Temperature (degrees F)	Turbidity (NTU)
MW-1	06/21/90	496.08	42.89	453.39	NR	NR	06/21/90	NR	NR	NR	NR
MW-1	09/28/90	496.08	44.18	451.83	54.4	NR	10/02/90	NR	NR	NR	NR
MW-1	11/06/90	496.08	45.61	450.47	54.4	NR	11/06/90	NR	NR	NR	NR
MW-1	12/07/90	496.08	45.82	450.26	NR	NR	12/07/90	NR	NR	NR	NR
MW-1	09/02/92	496.08	DRY	DRY	54.4	ND	09/02/92	DRY	DRY	DRY	DRY
MW-2	06/21/90	495.49	42.15	453.34	NR	NR	06/21/90	NR	NR	NR	NR
MW-2	09/28/90	495.49	44.18	451.31	52.3	NR	10/02/90	NR	NR	NR	NR
MW-2	11/06/90	495.49	44.98	450.51	52.3	NR	11/06/90	NR	NR	NR	NR
MW-2	12/07/90	495.49	45.32	450.17	NR	NR	12/07/90	NR	NR	NR	NR
MW-2	09/02/92	495.49	DRY	DRY	52.4	ND	09/02/92	DRY	DRY	DRY	DRY
MW-3	06/21/90	494.80	42.07	452.73	NR	NR	06/21/90	NR	NR	NR	NR
MW-3	09/28/90	494.80	44.18	450.65	51.6	NR	10/02/90	NR	NR	NR	NR
MW-3	11/06/90	494.80	44.93	449.87	51.6	NR	11/06/90	NR	NR	NR	NR
MW-3	12/07/90	494.80	45.56	449.24	NR	NR	12/07/90	NR	NR	NR	NR
MW-3	09/02/92	494.80	DRY	DRY	51.7	ND	09/02/92	DRY	DRY	DRY	DRY
MW-4	06/21/90	494.33	42.21	452.12	NR	NR	06/21/90	NR	NR	NR	NR
MW-4	09/28/90	494.33	44.18	450.06	54.7	NR	10/02/90	NR	NR	NR	NR
MW-4	11/06/90	494.33	45.12	449.21	54.7	NR	11/06/90	NR	NR	NR	NR
MW-4	12/07/90	494.33	45.97	448.36	NR	NR	12/07/90	NR	NR	NR	NR
MW-4	09/02/92	494.33	50.61	443.72	54.8	ND	09/02/92	6.61	918	69.6	>200

TOC = top of casing
ft-MSL = elevation in feet, relative to mean sea level
std. units = standard pH units
micromhos/cm = micromhos per centimeter
degrees F = degrees Fahrenheit
NTU = nephelometric turbidity units
NR = Not reported; data not available
DRY = Ground water not detected
ND = None detected

Table 1
Monitoring Well Field Measurement Data
Third Quarter 1992

Shell Station: 318 South Livermore Avenue
Livermore, California
WIC #: 204-4380-0303

Date: 09/29/92
Project Number: G67-73.01

Well Desig- nation	Water Level Field Date	TOC Elevation (ft-MSL)	Depth to Water (feet)	Ground- water Elevation (ft-MSL)	Total Well Depth (feet)	Floating Product Thickness (feet)	Water Sample Field Date	pH (std. units)	Electrical Conductivity (micromhos/cm)	Temperature (degrees F)	Turbidity (NTU)
OB-1	06/21/90	NR	NR	NR	NR	NR	06/21/90	NR	NR	NR	NR
OB-1	09/28/90	NR	NR	NR	NR	NR	10/02/90	NR	NR	NR	NR
OB-1	11/06/90	NR	NR	NR	NR	NR	11/06/90	NR	NR	NR	NR
OB-1	12/07/90	NR	NR	NR	NR	NR	12/07/90	NR	NR	NR	NR
OB-1	09/02/92	NR	12.81	NR	12.9	ND	09/02/92	NA	NA	NA	NA
OB-2	06/21/90	NR	NR	NR	NR	NR	06/21/90	NR	NR	NR	NR
OB-2	09/28/90	NR	NR	NR	NR	NR	10/02/90	NR	NR	NR	NR
OB-2	11/06/90	NR	NR	NR	NR	NR	11/06/90	NR	NR	NR	NR
OB-2	12/07/90	NR	NR	NR	NR	NR	12/07/90	NR	NR	NR	NR
OB-2	09/02/92	NR	13.74	NR	13.9	ND	09/02/92	NA	NA	NA	NA
OB-3	06/21/90	NR	NR	NR	NR	NR	06/21/90	NR	NR	NR	NR
OB-3	09/28/90	NR	NR	NR	NR	NR	10/02/90	NR	NR	NR	NR
OB-3	11/06/90	NR	NR	NR	NR	NR	11/06/90	NR	NR	NR	NR
OB-3	12/07/90	NR	NR	NR	NR	NR	12/07/90	NR	NR	NR	NR
OB-3	09/02/92	NR	12.82	NR	12.9	ND	09/02/92	NA	NA	NA	NA
OB-4	06/21/90	NR	NR	NR	NR	NR	06/21/90	NR	NR	NR	NR
OB-4	09/28/90	NR	NR	NR	NR	NR	10/02/90	NR	NR	NR	NR
OB-4	11/06/90	NR	NR	NR	NR	NR	11/06/90	NR	NR	NR	NR
OB-4	12/07/90	NR	NR	NR	NR	NR	12/07/90	NR	NR	NR	NR
OB-4	09/02/92	NR	11.75	NR	11.9	ND	09/02/92	NA	NA	NA	NA

TOC = top of casing
ft-MSL = elevation in feet, relative to mean sea level
std. units = standard pH units
micromhos/cm = micromhos per centimeter
degrees F = degrees Fahrenheit
NTU = nephelometric turbidity units
NR = Not reported; data not available
ND = None detected
NA = Not analyzed

Table 2
 Summary of Analytical Results
 Third Quarter 1992
 milligrams per liter (mg/l) or parts per million (ppm)

Shell Station: 318 South Livermore Avenue
 Livermore, California
 WIC #: 204-4380-0303

Date: 09/29/92
 Project Number: G67-73.01

Sample Designation	Water Sample Field Date	TPH-g (mg/l)	Benzene (mg/l)	Toluene (mg/l)	Ethyl-benzene (mg/l)	Total Xylenes (mg/l)	<i>Dissolved Pb</i>
MW-1	06/21/90	<0.03	<0.0003	<0.0003	<0.0003	<0.0003	
MW-1	10/02/90	<0.03	<0.0003	<0.0003	<0.0003	<0.0003	
MW-1	11/06/90	NR	NR	NR	NR	NR	
MW-1	12/07/90	NR	NR	NR	NR	NR	
MW-1	09/02/92	DRY	DRY	DRY	DRY	DRY	
MW-2	06/21/90	<0.03	<0.0003	<0.0003	<0.0003	<0.0003	
MW-2	10/02/90	<0.03	<0.0003	<0.0003	<0.0003	<0.0003	
MW-2	11/06/90	NR	NR	NR	NR	NR	
MW-2	12/07/90	NR	NR	NR	NR	NR	
MW-2	09/02/92	DRY	DRY	DRY	DRY	DRY	
MW-3	06/21/90	<0.03	<0.0003	<0.0003	<0.0003	<0.0003	
MW-3	10/02/90	<0.03	<0.0003	<0.0003	<0.0003	<0.0003	
MW-3	11/06/90	NR	NR	NR	NR	NR	
MW-3	12/07/90	NR	NR	NR	NR	NR	
MW-3	09/02/92	DRY	DRY	DRY	DRY	DRY	
MW-4	06/21/90	<0.03	<0.0003	<0.0003	<0.0003	<0.0003	
MW-4	10/02/90	<0.03	<0.0003	<0.0003	<0.0003	<0.0003	
MW-4	11/06/90	NR	NR	NR	NR	NR	
MW-4	12/07/90	NR	NR	NR	NR	NR	
MW-4	09/02/92	0.063	<0.0005	<0.0005	<0.0005	<0.0005	<i>.0033</i>
MW-4D	09/02/92	0.067	<0.0005	<0.0005	<0.0005	<0.0005	
FB	09/02/92	<0.05	<0.0005	<0.0005	<0.0005	<0.0005	

TPH-g = total petroleum hydrocarbons as gasoline
 NR = Not reported; data not available
 DRY = Ground water not detected

Table 2
Summary of Analytical Results
Third Quarter 1992
milligrams per liter (mg/L) or parts per million (ppm)

Shell Station: 318 South Livermore Avenue
Livermore, California
WIC #: 204-4380-0303

Date: 09/29/92
Project Number: G67-73.01

Sample Designation	Water Sample Field Date	TPH-g	Benzene	Toluene	Ethyl- benzene	Total Xylenes
		(mg/l)	(mg/l)	(mg/l)	(mg/l)	(mg/l)
TB	09/02/92	<0.05	<0.0005	<0.0005	<0.0005	<0.0005

TPH-g = total petroleum hydrocarbons as gasoline

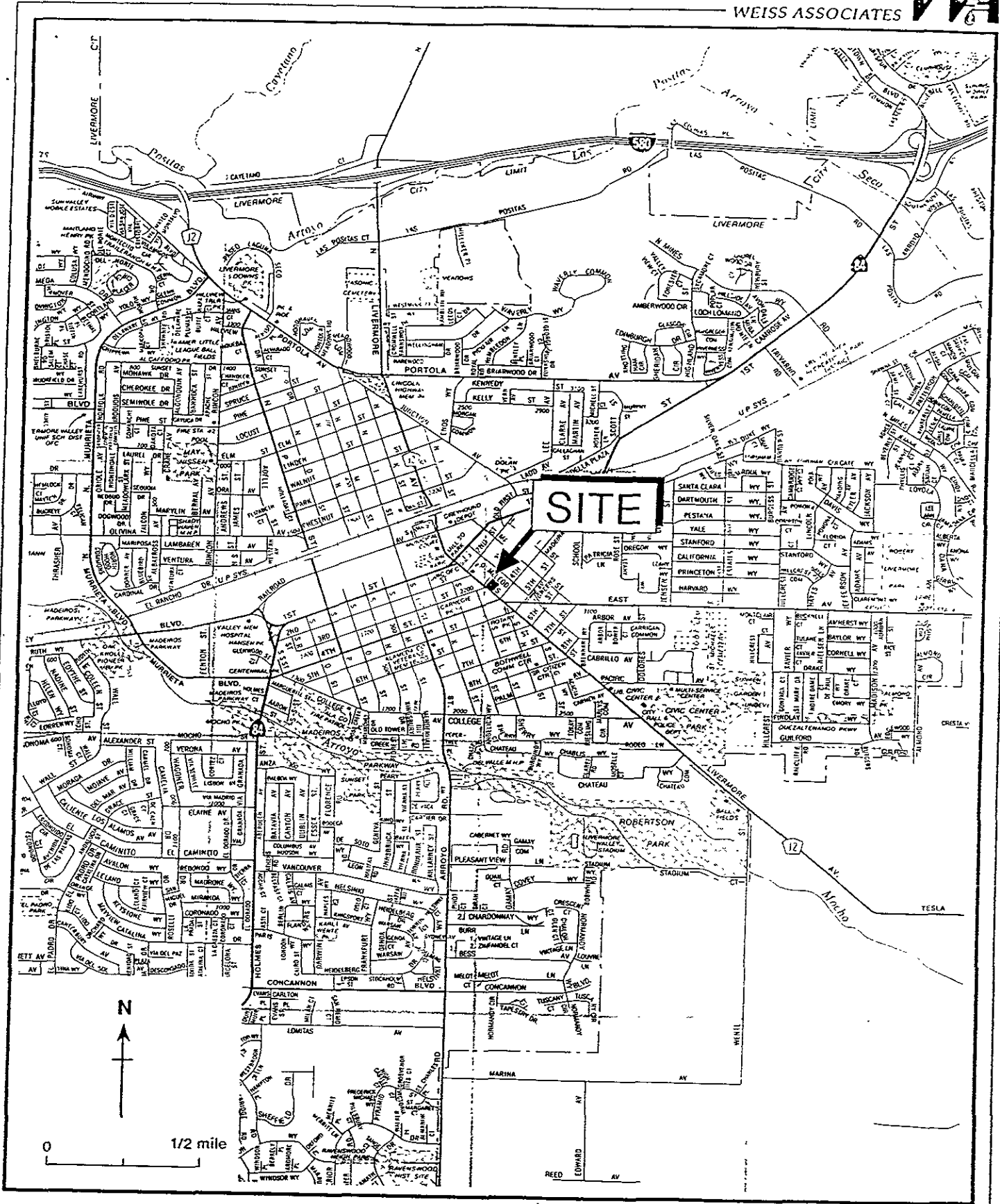

Figure 1. Site Location Map - Shell Service Station WIC #204-4380-0303, 318 South Livermore Avenue, Livermore, California

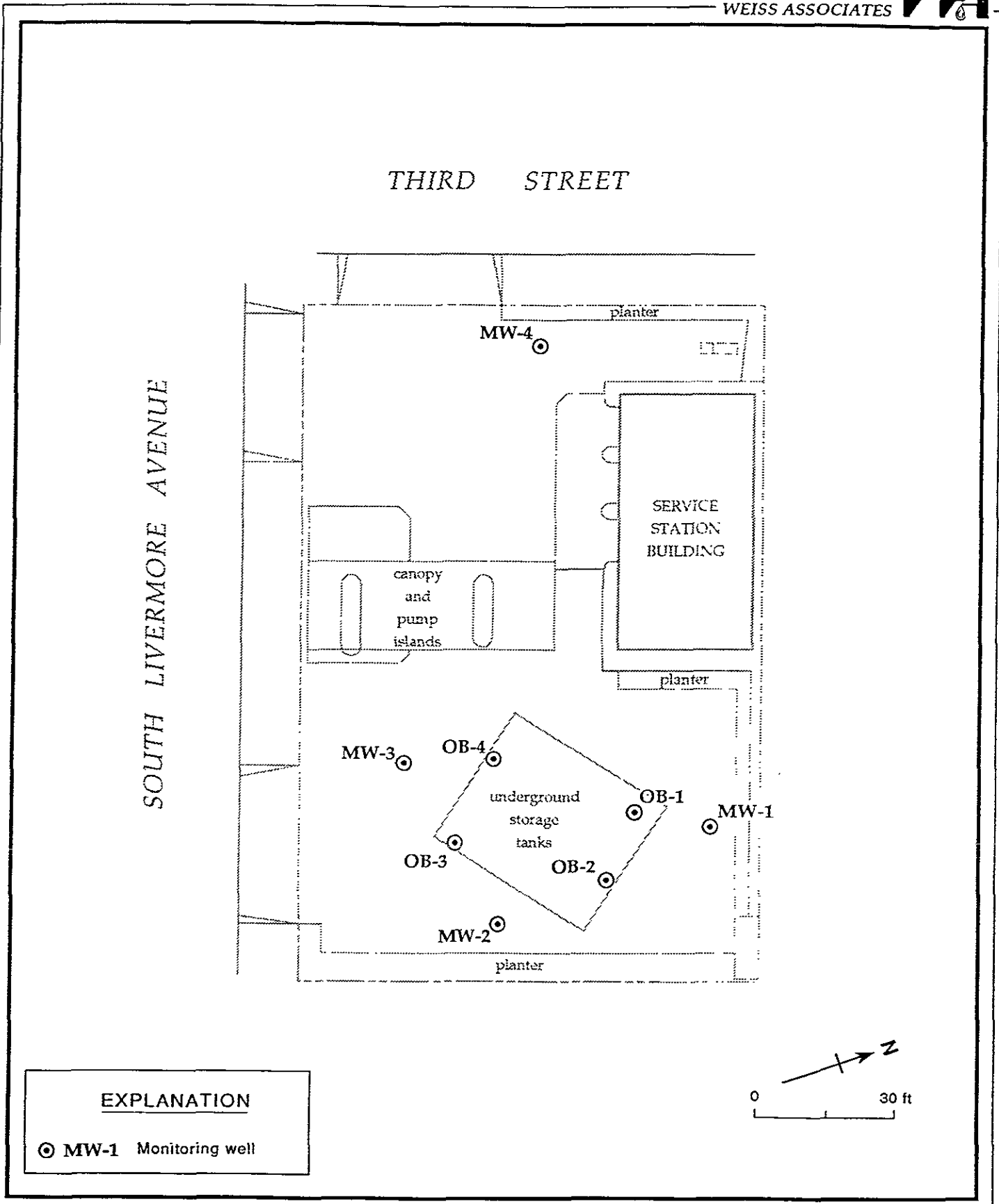

Figure 2. Monitoring Well Locations - Shell Service Station WIC #204-4380-0303, 318 South Livermore Avenue, Livermore, California

ANAMETRIX INC

Environmental & Analytical Chemistry
 1964 Concourse Drive, Suite E San Jose CA 95131
 (408) 432-8192 • Fax (408) 432-8192

**REPORT**

MR. DAVID LARSEN
 EMCON ASSOCIATES
 1938 JUNCTION AVE.
 SAN JOSE, CA 95131

Workorder # : 9209033
 Date Received : 09/02/92
 Project ID : 204-4380-0303
 Purchase Order: MOH-B813

The following samples were received at Anamatrix, Inc. for analysis :

ANAMETRIX ID	CLIENT SAMPLE ID
9209033- 1	MW-4
9209033- 2	MW-4D
9209033- 3	TB
9209033- 4	FB

This report consists of 8 pages not including the cover letter, and is organized in sections according to the specific Anamatrix laboratory group or section which performed the analysis(es) and generated the data. The Report Summary that precedes each section will help you determine which Anamatrix group is responsible for those test results, and will bear the signatures of the department supervisor and the chemist who have reviewed the analytical data. Please refer all questions to the department supervisor who signed the form.

Anamatrix is certified by the California Department of Health Services (DHS) to perform environmental testing under Certificate Number 1234. A detailed list of the approved fields of testing can be obtained by calling our office, or the DHS Environmental Laboratory Accreditation Program at (415)540-2800.

If you have any further questions or comments on this report, please give us a call as soon as possible. Thank you for using Anamatrix.

Sarah Schoen, Ph.D.
 Laboratory Director

9-21-92
 Date

EMCON ASSOCIATES

SEP 22 1992

RECEIVED

REPORT SUMMARY
ANAMETRIX, INC. (408)432-8192

MR. DAVID LARSEN
EMCON ASSOCIATES
1938 JUNCTION AVE.
SAN JOSE, CA 95131

Workorder # : 9209033
Date Received : 09/02/92
Project ID : 204-4380-0303
Purchase Order: MOH-B813
Department : GC
Sub-Department: TPH

SAMPLE INFORMATION:

ANAMETRIX SAMPLE ID	CLIENT SAMPLE ID	MATRIX	DATE SAMPLED	METHOD
9209033- 1	MW-4	WATER	09/02/92	TPHg/BTEX
9209033- 2	MW-4D	WATER	09/02/92	TPHg/BTEX
9209033- 3	TB	WATER	09/02/92	TPHg/BTEX
9209033- 4	FB	WATER	09/02/92	TPHg/BTEX

REPORT SUMMARY
ANAMETRIX, INC. (408)432-8192

MR. DAVID LARSEN
EMCON ASSOCIATES
1938 JUNCTION AVE.
SAN JOSE, CA 95131

Workorder # : 9209033
Date Received : 09/02/92
Project ID : 204-4380-0303
Purchase Order: MOH-B813
Department : GC
Sub-Department: tph

QA/QC SUMMARY :

- No QA/QC problems encountered for these samples.

Cheryl Balmer 9/18/92
Department Supervisor Date

Peggie Davison 9/18/92
Chemist Date

ANALYSIS DATA SHEET - TOTAL PETROLEUM HYDROCARBONS
(GASOLINE WITH BTEX)
ANAMETRIX, INC. - (408) 432-8192

Anametrix W.O.: 9209033
Matrix : WATER
Date Sampled : 09/02/92

Project Number : 204-4380-0303
Date Released : 09/18/92

Reporting Limit	Sample I.D.# MW-4	Sample I.D.# MW-4D	Sample I.D.# TB	Sample I.D.# FB	Sample I.D.# BS0901E2
COMPOUNDS (mg/L)	-01	-02	-03	-04	BLANK
Benzene	0.0005	ND	ND	ND	ND
Toluene	0.0005	ND	ND	ND	ND
Ethylbenzene	0.0005	ND	ND	ND	ND
Total Xylenes	0.0005	ND	ND	ND	ND
TPH as Gasoline	0.050	0.063	0.067	ND	ND
% Surrogate Recovery	98%	103%	108%	109%	104%
Instrument I.D.	HP12	HP12	HP12	HP12	HP12
Date Analyzed	09/09/92	09/09/92	09/09/92	09/09/92	09/09/92
RLMF	1	1	1	1	1

- ND - Not detected at or above the practical quantitation limit for the method.
- TPHg - Total Petroleum Hydrocarbons as gasoline is determined by GCFID using modified EPA Method 8015 following sample purge and trap by EPA Method 5030.
- BTEX - Benzene, Toluene, Ethylbenzene, and Total Xylenes are determined by modified EPA Method 8020 following sample purge and trap by EPA Method 5030.
- RLMF - Reporting Limit Multiplication Factor.

Anametrix control limits for surrogate p-Bromofluorobenzene recovery are 53-147%.

All testing procedures follow California Department of Health Services (Cal-DHS) approved methods.

Reggie Davison 9/18/92
Analyst Date

Cheyl Balma 9/18/92
Supervisor Date

REPORT SUMMARY
ANAMETRIX, INC. (408)432-8192

MR. DAVID LARSEN
EMCON ASSOCIATES
1938 JUNCTION AVE.
SAN JOSE, CA 95131

Workorder # : 9209033
Date Received : 09/02/92
Project ID : 204-4380-0303
Purchase Order: MOH-B813
Department : METALS
Sub-Department: METALS

SAMPLE INFORMATION:

ANAMETRIX SAMPLE ID	CLIENT SAMPLE ID	MATRIX	DATE SAMPLED	METHOD
9209033- 1	MW-4	WATER	09/02/92	7421

REPORT SUMMARY
ANAMETRIX, INC. (408)432-8192

MR. DAVID LARSEN
EMCON ASSOCIATES
1938 JUNCTION AVE.
SAN JOSE, CA 95131

Workorder # : 9209033
Date Received : 09/02/92
Project ID : 204-4380-0303
Purchase Order: MOH-B813
Department : METALS
Sub-Department: METALS

QA/QC SUMMARY :

- No QA/QC problems encountered for sample.

Wannyn Guyer 9/11/92
Department Supervisor Date

Mona Kamei 9/11/92
Chemist Date

ANALYSIS DATA SHEET - INDIVIDUAL METALS
 ANAMETRIX, INC. - (408) 432-8192

Anamatrix W.O.: 9209033
 Matrix : WATER
 Date Sampled : 09/02/92
 Project Number: 204-4380-0303

Date Prepared : 09/04/92
 Date Analyzed : 09/09/92
 Date Released : 09/10/92
 Instrument I.D : AA3

ANAMETRIX ID	CLIENT ID	REPORTING LIMIT (mg/L)	Lead EPA METHOD 7421 (mg/L)
9209033-01	MW-4	0.003	0.0033
MB0904W	METHOD BLANK	0.003	ND

ND : Not detected at or above the practical quantitation limit for the method.

All Metals by EPA Method 6010/7000, Test Method for Evaluating Solid Waste, SW-846 3rd Edition November 1986, and California Code of Regulations Title 22, or Method for Chemical Analysis of Water and Wastes, EPA, 3rd edition, 1983.

Wannysguy 9/21/92
 Supervisor Date

Mona Kamel 9/21/92
 Chemist Date



SHELL OIL COMPANY

RETAIL ENVIRONMENTAL ENGINEERING - WEST

CHAIN OF CUSTODY RECORD

Serial No: 924-5

Date: 9-2-92
Page 1 of 1

Site Address: 318 S. Livermore Avenue
Livermore, CA

WIC#: 204-4380-0303

Shell Engineer: Dan Kirk Phone No.: (510) 675-6168

Consultant Name & Address: 1938 Junction Avenue
EMCON Associates San Jose, CA 95131

Consultant Contact: David Larsen Phone No.: (408) 453-2269

Comments: 3-40ml WAS (HCl) for gas, BTEX
(Field Filtered: 1-500ml LPE (HNO3) for Dis. lead)

Sampled by: [Signature]
Printed Name: [Name]

Analysis Required

TPH (EPA 8015 Mod. Gas)	TPH (EPA 8015 Mod. Diesel)	BTEX (EPA 8020/602)	Volatile Organics (EPA 8240)	Test for Disposal	Combination TPH 8015 & BTEX 8020 <i>gasoline</i>	<u>Dissolved lead by 7421</u>	Asbestos	Container Size	Preparation Used	Composite Y/N

LAB: AnametriX

CHECK ONE (1) BOX ONLY	CI/DI	TURN AROUND TIME
Quarterly Monitoring <input checked="" type="checkbox"/>	6441	24 hours <input type="checkbox"/>
Site Investigation <input type="checkbox"/>	6441	48 hours <input type="checkbox"/>
Soil Classfy/Disposal <input type="checkbox"/>	6442	16 days <input checked="" type="checkbox"/> (Normal)
Water Classfy/Disposal <input type="checkbox"/>	6443	Other <input type="checkbox"/>
Soil/Air Rem. or Sys. O & M <input type="checkbox"/>	6462	
Water Rem. or Sys. O & M <input type="checkbox"/>	6463	
Other <input type="checkbox"/>		

NOTE: Notify Lab as soon as Possible of 24/48 hrs TAT.

Sample ID	Date	Sludge	Soil	Water	Air	No. of conts.	TPH (EPA 8015 Mod. Gas)	TPH (EPA 8015 Mod. Diesel)	BTEX (EPA 8020/602)	Volatile Organics (EPA 8240)	Test for Disposal	Combination TPH 8015 & BTEX 8020 <i>gasoline</i>	<u>Dissolved lead by 7421</u>	Asbestos	Container Size	Preparation Used	Composite Y/N	MATERIAL DESCRIPTION	SAMPLE CONDITION/ COMMENTS
MW-1				X		4						X	X		40 ml	HCl	NO		<u>Samples Received 9/2/92</u>
MW-2						4						X	X						
MW-3						4						X	X						
MW-4	9-2-92					4						X	X						
MW-4D						3						X							
TB						3						X							
FB						3						X							

Relinquished By (signature): <u>[Signature]</u>	Printed Name: <u>IAN GRATHAM</u>	Date: <u>9-2-92</u> Time: <u>1520</u>	Received (signature): <u>[Signature]</u>	Printed Name: <u>KATHY GAFFLE</u>	Date: <u>9-2-92</u> Time: <u>1530</u>
Relinquished By (signature): <u>[Signature]</u>	Printed Name:	Date:	Received (signature):	Printed Name:	Date:
Relinquished By (signature):	Printed Name:	Date:	Received (signature):	Printed Name:	Date:

THE LABORATORY MUST PROVIDE A COPY OF THIS CHAIN-OF-CUSTODY WITH INVOICE AND RESULTS

1
2
3
4