



June 27, 1996

Ms. Madhulla Logan  
Hazardous Materials Specialist  
Alameda County Department of Environmental Health  
1131 Harbor Bay Parkway  
Oakland, CA 94502

SUBJECT: Work Plan for Limited Soil and Groundwater Investigation at  
Staudenraus Property  
2424 Blanding Street  
Alameda, California

Dear Ms. Logan:

IT Corporation (IT) is pleased to present this work plan to complete a soil boring and collect soil and grab groundwater samples at the above referenced site. A site vicinity map is shown as Figure 1. All site work shall be performed in accordance with applicable regulatory requirements.

### SCOPE OF WORK

Task 1. Health and Safety Plan Preparation

IT will prepare a Health and Safety Plan (HASP). The HASP is an integral part of our field operating procedures. It is based on the understanding that unsafe materials may be present, and is intended to minimize exposure to IT personnel and subcontractors during field work. The HASP lists safety procedures for work to be performed, on-site safety officers, and preferred medical emergency locations.

Task 2. Underground Utility Location

Underground Service Alert (USA) will be notified to identify the location of underground utilities and potential interferences before augering.

Task 3. Soil Boring, Soil Sampling, and Grab Groundwater Sampling

One soil boring will be advanced by hand auger on the eastern side of the former UST. The boring will be angled and samples will be collected at depths of 5 fbg and from the capillary fringe above the water table using a sampling hammer lined with brass tubes. The boring location and angle direction are shown on Figure 2, site plan. Samples selected for laboratory analysis will be retained in the

Ms. Madhulla Logan  
June 27, 1996  
Page 2

brass sample collection sleeves, capped, labeled, and placed in an iced cooler for transport to an analytical laboratory under chain of custody documentation.

Boring and sampling equipment will be washed prior to use. Procedures for soil sampling will be in accordance with regulatory guidelines and IT technical procedures, under the direction of a California Registered Geologist.

Upon completion of the soil sampling, the boring will be advanced approximately 2 feet beyond groundwater. A slotted PVC casing will be placed in the boring and a groundwater sample will be collected using a disposable bailer. The sample will be placed in appropriate sample containers supplied by the laboratory. Methods for sample handling, transport and documentation will be consistent with procedures used for soil sampling.

Task 4.        Laboratory Services

Two soil samples and one groundwater sample will be analyzed for total petroleum hydrocarbons as gasoline (TPH-G) and benzene, toluene, ethyl benzene and total xylenes (BTEX) using EPA Methods 8015 (modified) and 8020.

Task 5.        Report Preparation

Upon completion of the above tasks, a letter report presenting results, findings and conclusions of the investigation will be prepared. The report will be completed under the direction of a California Registered Geologist and will include a description of work performed, field procedures, observations, analytical laboratory reports, site figure, table of analytical data and recommendations to address ACHD concerns, as necessary.

**SCHEDULE OF COMPLETION**

The above activity will be completed within 45 days of work plan approval. If you have any questions or comments, please contact me at (408) 894-1200.

Respectfully submitted,  
**IT CORPORATION**

  
Matt Hopwood, R.G.  
Geosciences Manager

cc: Dolores Staudenraus

PENDING-FI	QA/QC BY	JM	DRAWN BY
PENDING-GCD	APPROVED BY	06-26-96	
DRAWING NO			
FILE/DISK			

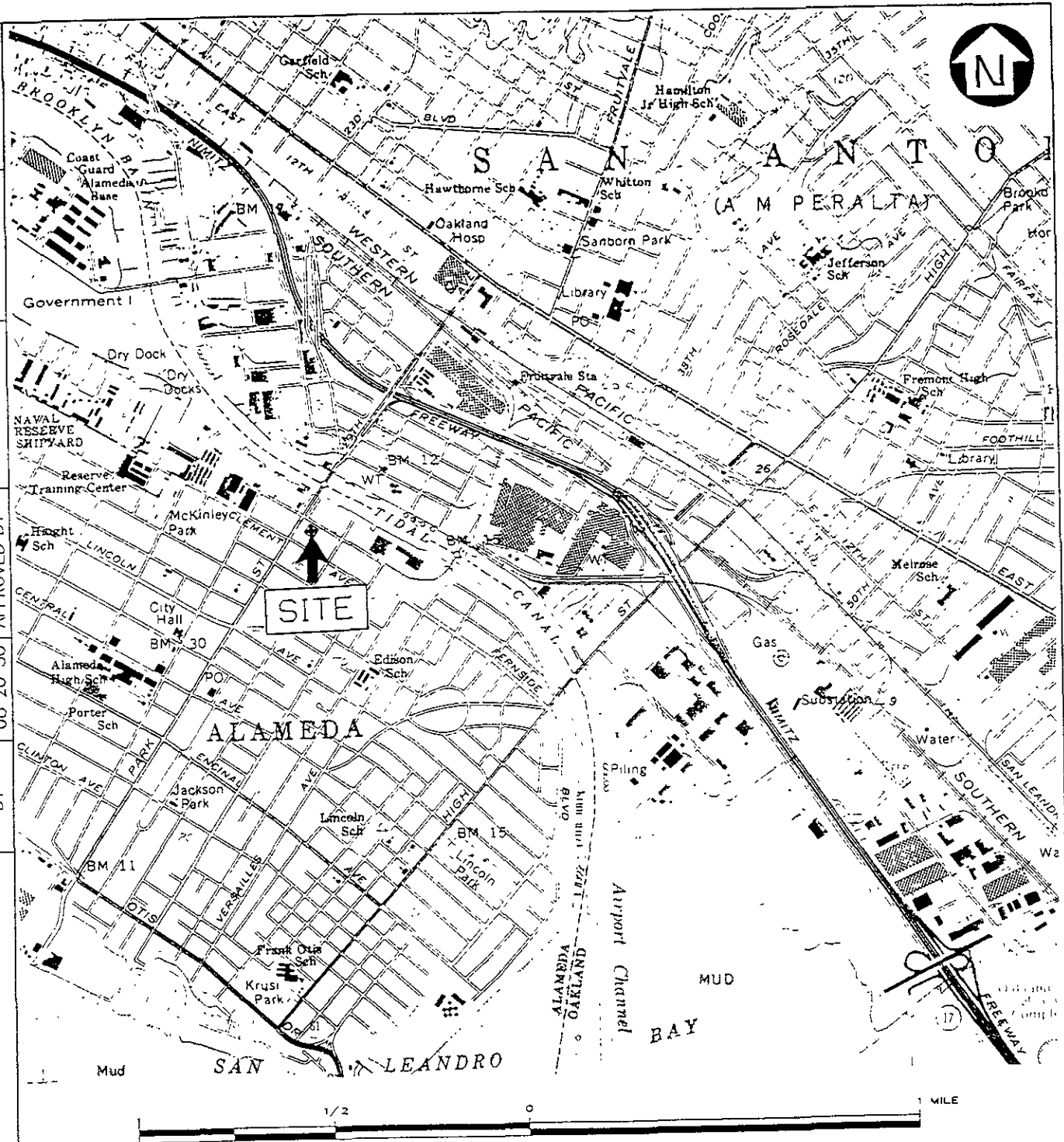

**NOTES:**

OAKLAND EAST QUADRANGLE 7 5 MINUTE  
 SERIES (TOPOGRAPHIC)  
 MAPPED, EDITED AND PUBLISHED BY THE  
 GEOLOGICAL SURVEY PHOTOREVISED 1980

**FIGURE 1  
 SITE VICINITY MAP**

STAUDENRAUS PROPERTY  
 2424 BLANDING AVE  
 ALAMEDA, CALIFORNIA  
 IT JOB NO. PENDING



DRAWN BY	JM	QA/QC BY	PENDING-F2
	06-26-96	APPROVED BY	PENDING.GCD
		FILE/DISK	

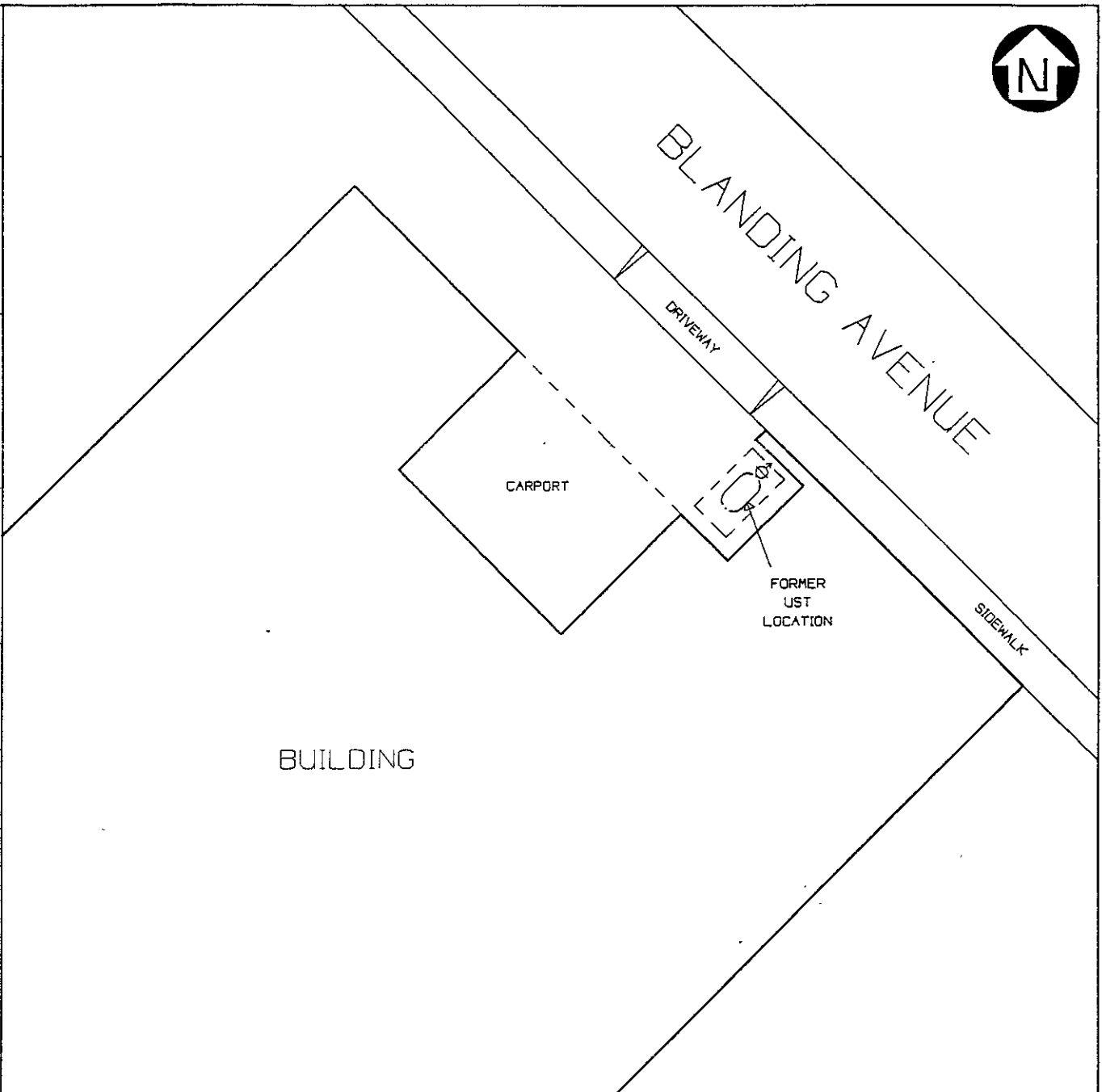

LEGEND

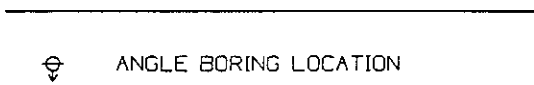

FIGURE 2  
SITE PLAN WITH  
BORING LOCATIONS

STAUDENRAUS PROPERTY  
2424 BLANDING AVE  
ALAMEDA, CALIFORNIA

IT JOB NO. PENDING

NOT TO SCALE



ENVIRONMENTAL  
PROTECTION  
96 JUN 28 PM 1:34

1996 JUN 28 1:34 PM