

ALAMEDA COUNTY  
**HEALTH CARE SERVICES**

AGENCY  
DAVID J. KEARS, Agency Director



ENVIRONMENTAL HEALTH SERVICES  
ENVIRONMENTAL PROTECTION (LOP)  
1131 Harbor Bay Parkway, Suite 250  
Alameda, CA 94502-6577  
(510) 567-6700  
FAX (510) 337-9335

**REMEDIAL ACTION COMPLETION CERTIFICATION**

October 30, 1996

Harold DeLuca  
Property Owner  
1000 N Point St, Apt 1202  
San Francisco CA 94109

Attn: John Monfredini  
Allied Food Sales  
333 Clay St  
Oakland CA 94607

Dear Messrs. DeLuca and Monfredini:

**UNDERGROUND STORAGE TANK (UST) CASE**

Allied Food Sales  
321 Clay St. (a.k.a. 333 Clay St.)  
Oakland CA 94607  
SITE NO. 5545

This letter confirms the completion of site investigation and remedial action for the underground storage tank formerly located at the above-described location. Enclosed is the Case Closure Summary for the referenced site for your records.

Based upon the available information, including the current land use, and with the provision that the information provided to this agency was accurate and representative of site conditions, no further action related to the underground storage tank release is required.

This notice is issued pursuant to a regulation contained in Title 23, California Code of Regulations, Division 3, Chapter 16, Section 2721 (e). If a change in land use, structural configuration, or site activities are proposed such that more conservative exposure scenarios should be evaluated, the owner must promptly notify this agency.

Please telephone Amy Leech at (510)567-6700 if you have any questions regarding this matter.

Sincerely,

Mee Ling Tung, Director of Environmental Health Services

**ATTACHMENT**

c: Kevin Graves, RWQCB  
Lori Casias, SWRCB w/attachment  
Acting Chief of Environmental Protection Division  
Files(ALL)

01-1174

**CASE CLOSURE SUMMARY**  
**Leaking Underground Fuel Storage Tank Program**  
**Page 1 of 3**

**I. AGENCY INFORMATION**

Date: **August 19, 1996**  
Agency name: **Alameda County-HazMat** Address: **1131 Harbor Bay Pkwy**  
Date/City/State/Zip: **Alameda, CA 94502** Phone: **(510) 567-6700**  
Responsible staff person: **Amy Leech** Title: **Hazardous Materials Spec.**

**II. CASE INFORMATION**

Site facility name: **Allied Food Sales**  
Site facility address: **321 Clay St. (a.k.a. 333 Clay St.), Oakland, CA 94607**  
RB LUSTIS Case No: **N/A** Local Case No./LOP Case No.: **5545**  
URF filing date: **01/16/92** SWEEPS No: **N/A**

<u>Responsible Parties:</u>	<u>Address:</u>	<u>Phone Numbers:</u>
Harold DeLuca	1000 N Point St, Apt 1202 San Francisco CA 94109	839-6513
Attn: John Monfredini Allied Food Sales	333 Clay St Oakland CA 94607	763-6203

<u>Tank No:</u>	<u>Size in gal.:</u>	<u>Contents:</u>	<u>Closed in-place or removed?:</u>	<u>Date:</u>
1	1,000	gasoline	removed	08/02/91

**III. RELEASE AND SITE CHARACTERIZATION INFORMATION**

Cause and type of release: **Unknown**

Site characterization complete? **Yes**  
Date approved by oversight agency: **08/19/96**

Monitoring Wells installed? **No** Number: **n/a**

Proper screened interval? **n/a**

Highest GW depth below ground surface: **n/a** Lowest depth: **n/a**

Flow direction: **Not determined. Assumed to be westerly.**

Most sensitive current use: **Commercial**

Are drinking water wells affected? **No** Aquifer name: **N/A**

Is surface water affected? **No** Nearest affected SW name: **N/A**

Off-site beneficial use impacts (addresses/locations): **Not Known**

Report(s) on file? **YES** Where is report(s) filed?  
**Alameda County, 1131 Harbor Bay Pkwy, Alameda, CA 94502**

**CASE CLOSURE SUMMARY**  
**Leaking Underground Fuel Storage Tank Program**  
**Page 2 of 3**

**III. RELEASE AND SITE CHARACTERIZATION INFORMATION (cont'd)**

**Treatment and Disposal of Affected Material:**

<u>Material</u>	<u>Amount</u> <u>(include units)</u>	<u>Action (Treatment</u> <u>or Disposal w/destination)</u>	<u>Date</u>
USTs	1- 1,000 gallon	H&H Ship Service Co. 220 China Basin St., San Francisco, CA	08/02/91
Soil	35 c.y.	BFI 4001 N Vasco Rd., Livermore, CA	01/23/96

**Maximum Documented Contaminant Concentrations - - Before and After Cleanup**

<u>Contaminant</u>	<u>Soil (ppm)</u>		<u>Water (ppb)</u>	
	<u>Before<sup>1</sup></u>	<u>After<sup>2</sup></u>	<u>Before</u>	<u>After<sup>4</sup></u>
TPH (Gasoline)	1,800	ND	NT	ND
TPH (Diesel)	NT	ND <sup>3</sup>	"	NT
Benzene	8.3	0.26	"	ND
Toluene	200	0.056	"	ND
Ethylbenzene	30	0.014	"	ND
Xylene	400	0.040	"	ND

ND=non-detect

NT=not tested

- 1 Soil sample collected from the gasoline UST pit in 8/91.
- 2 Soil sample collected from northwest corner of the former UST pit after overexcavation in 1/96.
- 3 Soil sample collected from boring TW-#1 at ~10 ft bgs located northeast of the former UST pit in 4/96.
- 4 "Grab" groundwater samples collected from borings TW-#1 (12 ft bgs) and TW-#2 (10 ft bgs) in 4/96.

**Comments (Depth of Remediation, etc.):** See comments under "Additional Comments" section.

**IV. CLOSURE**

Does completed corrective action protect existing beneficial uses per the Regional Board Basin Plan?

**Undetermined**

Does completed corrective action protect potential beneficial uses per the Regional Board Basin Plan?

**Undetermined**

Does corrective action protect public health for current land use? **YES**

Site management requirements: **N/A**

Should corrective action be reviewed if land use changes? **YES**

Monitoring wells Decommissioned: **n/a**

Number Decommissioned: **n/a**      Number Retained: **n/a**

List enforcement actions taken: **n/a**

List enforcement actions rescinded: **n/a**

## V. LOCAL AGENCY REPRESENTATIVE DATA

Name: Amy Leech

Signature: 

Title: Hazardous Materials Specialist

Date: 9-13-96

Reviewed by

Name: Jennifer Eberle

Signature: 

Title: Hazardous Materials Specialist

Date: 8-30-96

Name: Thomas Peacock

Signature: 

Title: Supervising, Hazardous Materials Spec.

Date: 9-13-96

## VI. RWQCB NOTIFICATION

Date Submitted to RB:

RWQCB Staff Name: Kevin Graves, P.E.

Title: Assoc. Water Resources Control Engineer

RB Response: 

Signature: 

Date: 10-10-96

## VII. ADDITIONAL COMMENTS

On August 1, 1991, one 1,000-gallon gasoline underground storage tank (UST) was removed from 321 Clay Street (a.k.a. 333 Clay St.) in Oakland, California. (See attachment 1 for site location.) Up to 1,800 ppm TPH-G and 8.3 ppm benzene were detected in soil samples collected beneath the UST at approximately 7-8 feet below ground surface (bgs). (See attachment 2 for sample locations and results.)

Overexcavation of contaminated soil from the former UST pit was completed down to approximately 12-15 feet bgs on January 4, 1996. An estimated 35 - 40 cubic yards of soil was removed. Confirmatory soil results were all non-detect for TPH-G and BTEX, except for trace concentrations of BTEX (0.26, 0.056, 0.014 0.040 ppm, respectively) identified in the soil sample collected from the northwest corner of the excavation at 11 ft. bgs. (See attachment 3 for sample locations and results.)

Two borings (TW-#1 and TW-#2) were emplaced northeast and southwest of the former UST pit on April 12, 1996. Depth-to-water, total depths explored, and boring logs were not provided with the report on this investigation. However, chain-of-custody documentation indicates that groundwater samples for TW-#1 and TW-#2 were collected at 12 ft. bgs and 10 ft. bgs, respectively, and soil samples were collected at ~10 ft. bgs in each boring for laboratory analysis. TPH-G and BTEX were not identified in soil or groundwater samples collected from both borings, except for trace concentrations of BTEX (0.0553, 0.0246, 0.0199, 0.575 ppm, respectively) identified in the soil sample collected from boring TW-#1 at 10 ft. bgs. (See attachment 3 for sample locations and results.)

The benzene concentrations identified in confirmatory soil samples after overexcavation of the former UST pit and in boring TW-#1 do not exceed the Tier-1 Look-up table of the ASTM ES 1739-95 Standard Guide for Risk-Based Corrective Action Applied at Petroleum Release Sites (RBCA)  $1 \times 10^{-4}$  cancer risk for a commercial exposure scenario for the following pathways: soil volatilization to outdoor air and soil-vapor intrusion from soil to buildings.

Based on this information, no further investigations are recommended for this site.

Figure 1  
Location Map 333 Clay Street

1

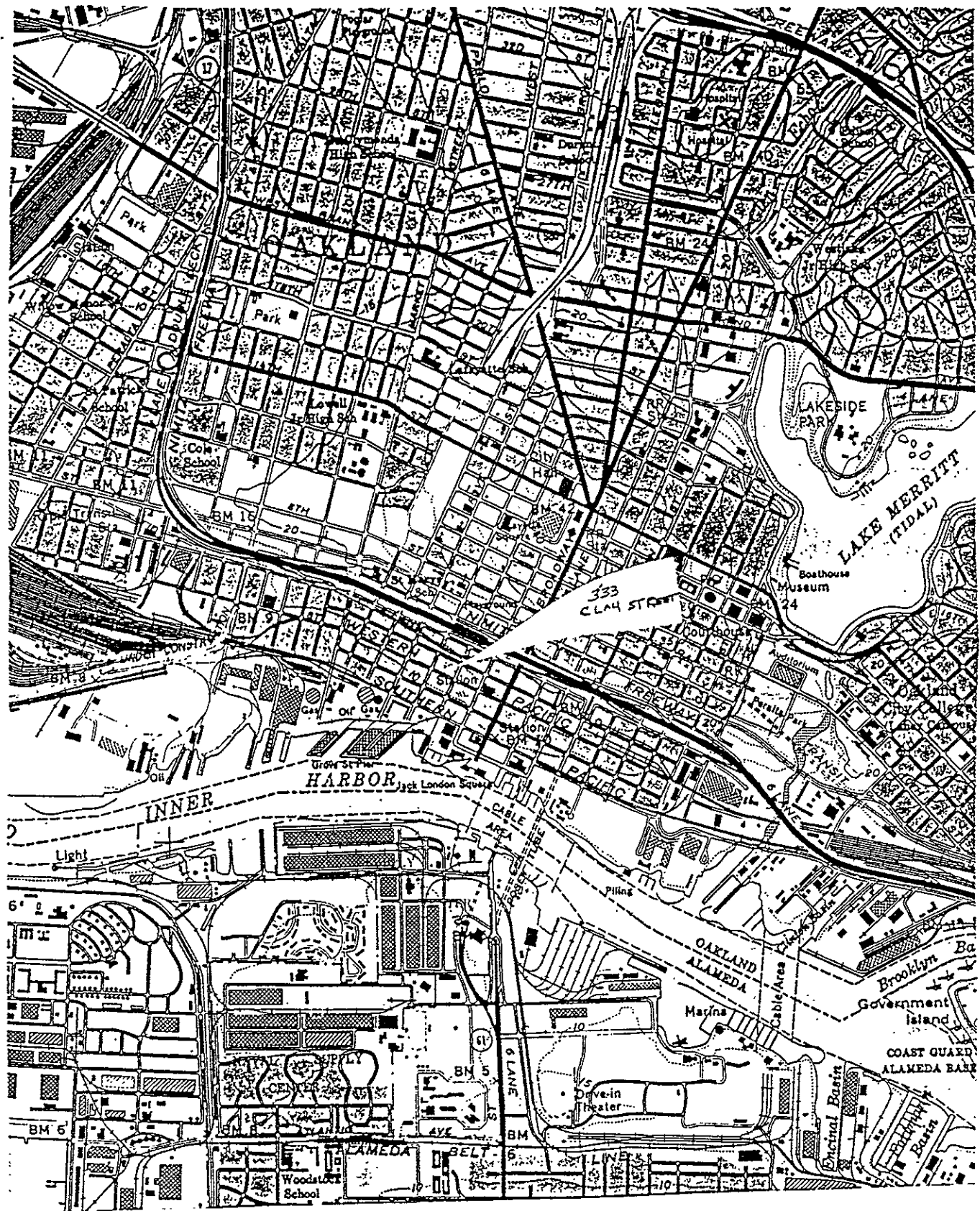

Copied from U.S. Geological Survey, Oakland-West, Ca , 1980, Scale 1:24,000

Allied Food Sales Co.  
331 Clay Street  
Oakland, CA

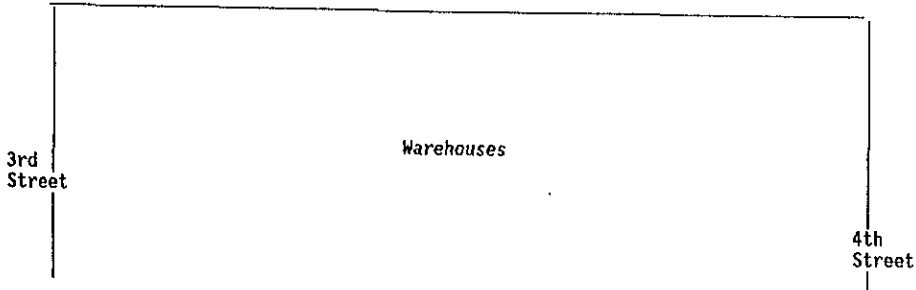
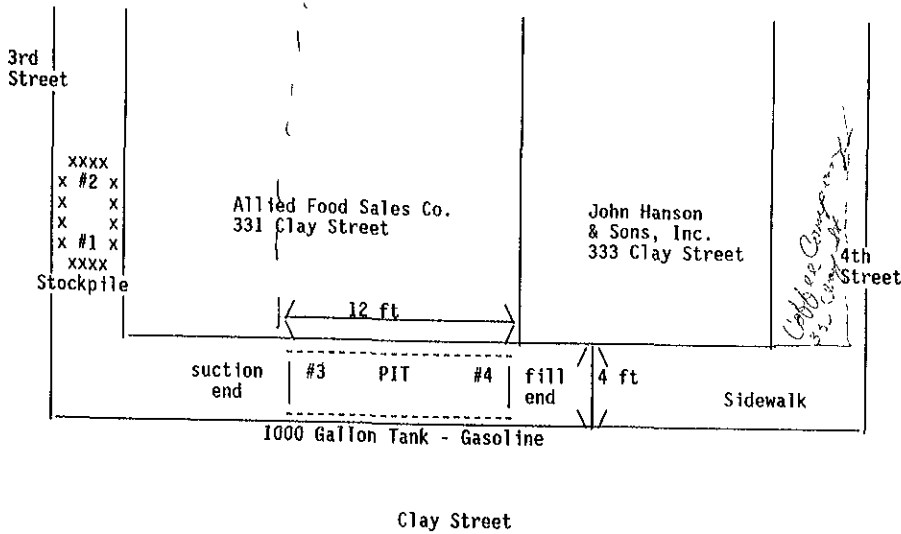

LOG # 1175

3423 Investment Boulevard, #8 • Hayward, California 94545

Telephone (415) 783-8900  
Facsimile (415) 783-1512



LOG NUMBER: 1175  
DATE SAMPLED: 8/02/91  
DATE RECEIVED: 8/02/91  
DATE EXTRACTED: 8/13/91  
DATE ANALYZED: 8/15/91  
DATE REPORTED: 8/16/91

CUSTOMER: B and B Associated Services

REQUESTER: Ernie Bernabe

PROJECT: Allied Food Sales Co.

Sample Type: Soil

Method and Constituent:	Units	#1		#2		#3	
		Concentration	Reporting Limit	Concentration	Reporting Limit	Concentration	Reporting Limit
DHS Method:							
Total Petroleum Hydrocarbons as Gasoline	mg/kg	33	0.50	32	0.95	14	0.50
Modified EPA Method 8020:							
Benzene	mg/kg	ND	0.0050	ND	0.12	ND	0.024
Toluene	mg/kg	0.016	0.0050	ND	0.14	0.034	0.027
Xylenes	mg/kg	1.4	0.015	1.5	0.37	0.26	0.074
Ethylbenzene	mg/kg	ND	0.0050	0.16	0.16	ND	0.032

Method and Constituent:	Units	#4		Method Blank	
		Concentration	Reporting Limit	Concentration	Reporting Limit
DHS Method:					
Total Petroleum Hydrocarbons as Gasoline	mg/kg	1,800	16	ND	0.50

Modified EPA Method 8020:		
Benzene	mg/kg	8.3 2.0
Toluene	mg/kg	200 2.3
Xylenes	mg/kg	400 6.2
Ethylbenzene	mg/kg	30 2.7

QC Summary:  
% Recovery: 110  
% RPD: 12

Concentrations reported as ND were not detected at or above reporting limit.

*Louis W. DuPuis*  
Louis W. DuPuis  
Quality Assurance/Quality Control Manager

Founding Member of the Association of California Testing Laboratories

2

Figure 5  
Site Plan 333 Clay Street  
Test Findings Annotated

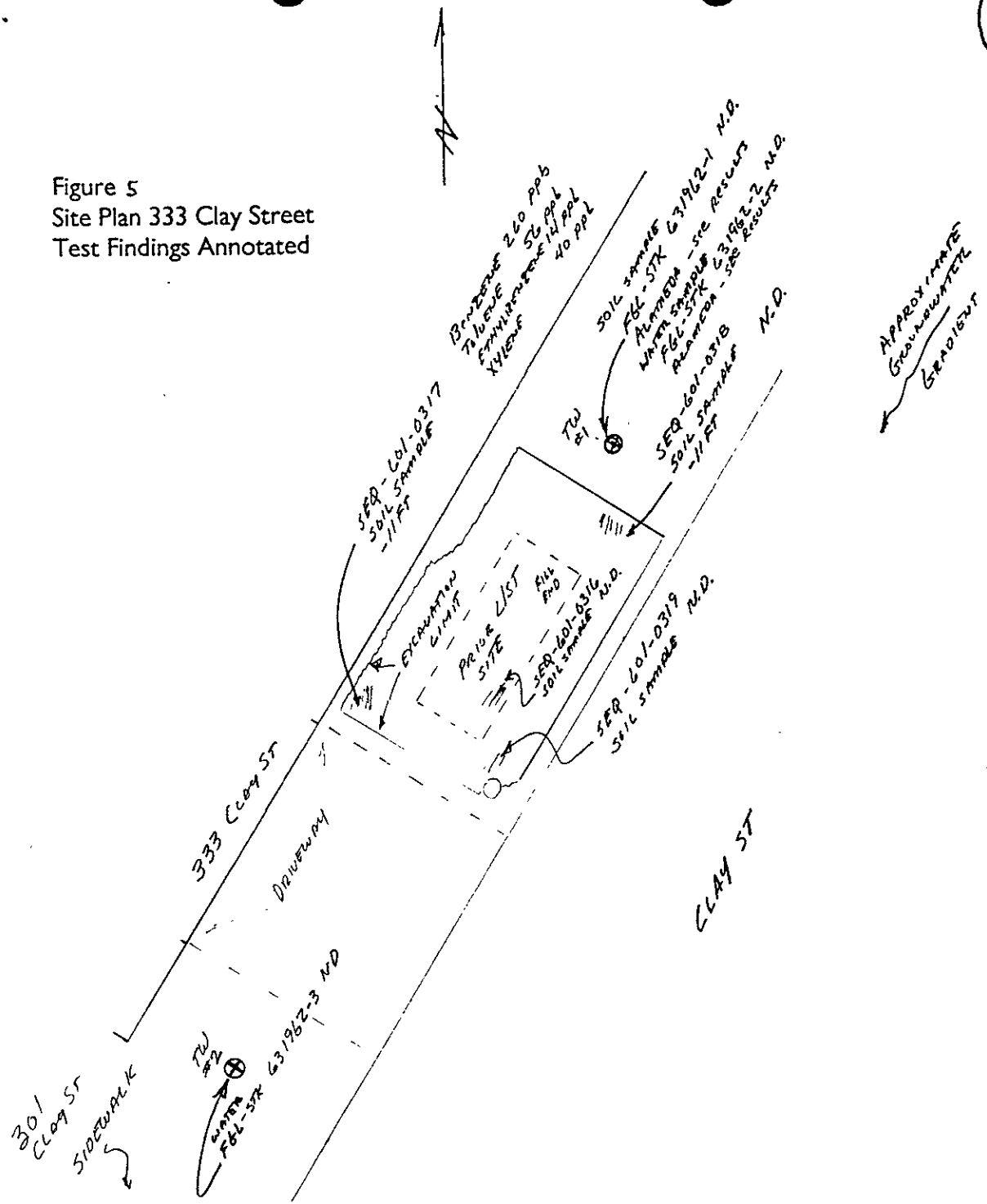

1 in. = 10 ft.  
4/29/96  
D.K.Barber

**APPENDIX K  
ANALYTICAL RESULTS  
Allied Food , UST, 333 Clay St.,Oakland**

Location	Sample Date	Lab No.	TPHg (mg/kg)	Benzene (µg/kg)	Toluene (µg/kg)	Ethylbenzene (µg/kg)	Xylene (µg/kg)
			DHS LUFT	8020	8020	8020	8020
<b>Original UST Removal</b>							
<b>Soil</b>							
Exc Soil Pile	8/2/91	TAL-1175-#1	33	< 5.0	16	< 5.0	1400
Exc Soil Pile	8/2/91	TAL-1175-#2	32	< 120	< 140	160	1500
Pit W End	8/2/91	TAL-1175-#3	14	< 24	34	< 32.0	260
Pit E End	8/2/91	TAL-1175-#4	1,800	8,300	200,000	30,000	400,000
<b>Over Excavate Pit</b>							
<b>Soil</b>							
				<b>Pb (mg/kg)</b>			
Pit Bottom - 13'	1/5/96	SEQ-601-0316	< 1.0	< 5.0	< 5.0	< 5.0	< 5.0
NW Corner-11'	1/5/96	SEQ-601-0317	< 1.0	260	56	14	40
East End - 11'	1/5/96	SEQ-601-0318	< 1.0	< 5.0	< 5.0	< 5.0	< 5.0
SE Corner	1/5/96	SEQ-601-0319	< 1.0	< 5.0	< 5.0	< 5.0	< 5.0
Over Excav Pile	1/5/96	SEQ-601-0345	21	< 2.5	770	810	870
<b>Test Wells</b>							
<b>Soil</b>							
East End (u/g)	4/11/96	FGL-STK 631962-1	< 1.0	< 0.003	< 0.003	< 0.003	< 0.003
East End (split)	4/11/96	Alameda- 96-024-3	< 10.0	55.3	24.6	19.9	575
<b>Water</b>							
				<b>MTBE (ug/kg)</b>			
East End (u/g)	4/11/96	FGL-STK 631962-2	< 0.05	< 5.0	< 0.003	< 0.003	< 0.003
East End (split)	4/11/96	Alameda- 96-024-1	< 0.50		< 0.3	< 0.43	< 0.3
West End (d/g)	4/11/96	FGL-STK 631962-3	< 0.05	< 5.0	< 0.003	< 0.003	< 0.003

Testing Laboratories: TAL=Trace Analytical Laboratory, SEQ = Sequoia Analytical,  
FGL=FGL Environmental, Alameda = Alameda County Environmental Health Dept.  
(u/g) = upgradient from pit , (d/g) = downgradient from pit