

ALAMEDA COUNTY ENVIRONMENTAL
HEALTH SERVICES

ENVIRONMENTAL PROTECTION DIVISION
1131 Harbor Bay Parkway, Suite 250
Alameda, CA 94502-6577
Telephone (510) 667-8700 Fax (510) 337-9335

FAX COVER SHEET

DATE: APRIL 15, 1998

TO: RON GERBER

City of Emeryville Redevelopment Agency

FAX# (510) 658-8095

Total number of pages including cover sheet 3

FROM: **SUSAN L. HUGO**
Hazardous Materials Specialist

NOTE:

Here is the site map for the former Standard Brands Paint Store.
All wells (3) on-site had been decommissioned. Well MW-3
on Emery St. was installed by Environ for the City & maybe
used by City for Brownfields groundwater monitoring program.

(SMILE) HAVE A NICE DAY
DO SOMETHING FOR OUR ENVIRONMENT

As we have discussed today, please send me a letter regarding
maintaining well MW-3 for future groundwater monitoring
program.

Thanks. Susan



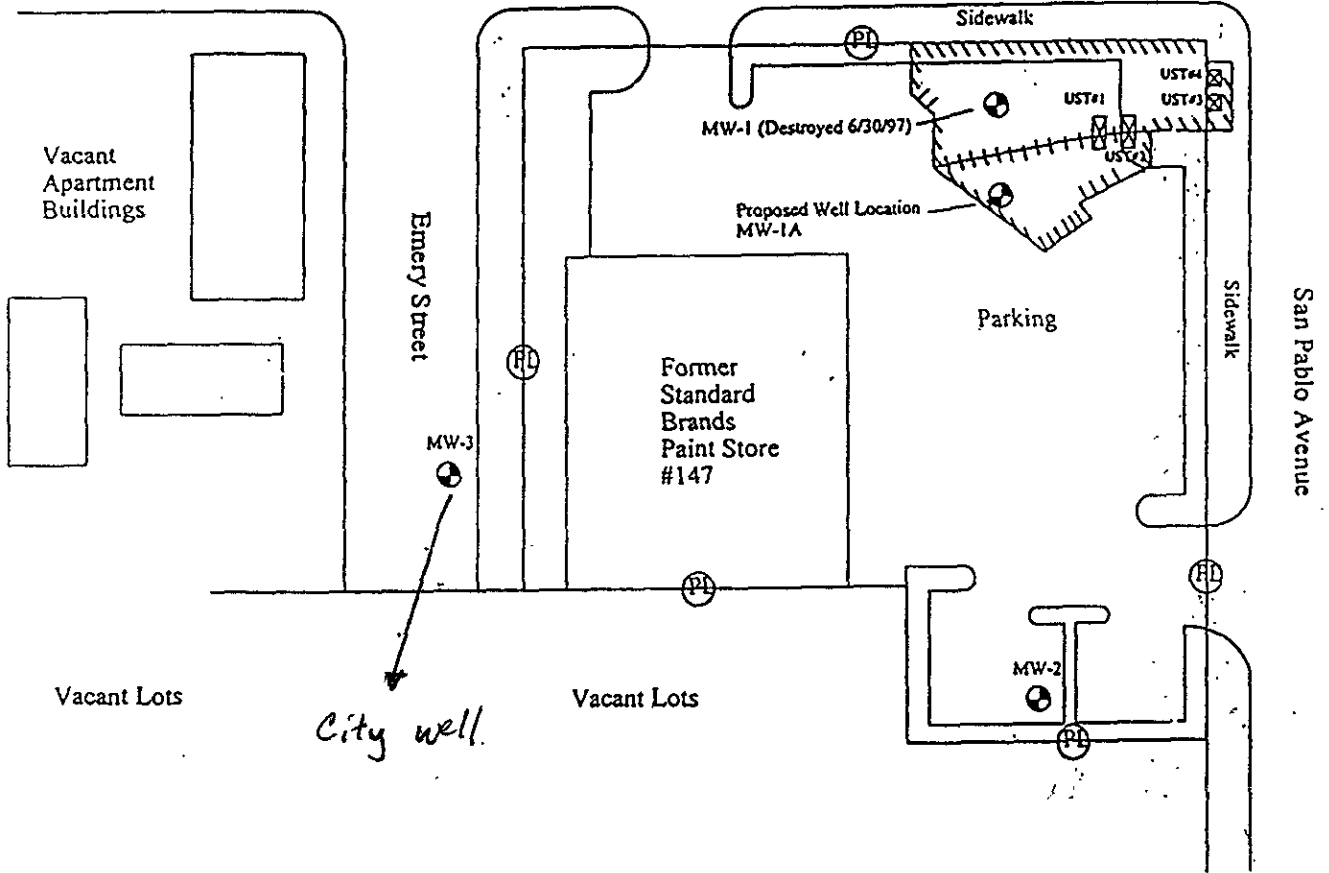

A.C. Transit

Berkeley Farms

45th Street



City well.

- Note:
-  Excavated Area
 -  Former USTs
 -  Approximate Property Lines
 -  Groundwater Barrier

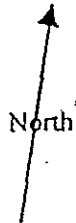

NOT TO SCALE

<p>FAST-TEK ENGINEERING SUPPORT SERVICES 247B Tewksbury Avenue Point Richmond, California 94801 Phone (510) 232-2728 Fax (510) 232-2823</p>	<p>Site Map Former Standard Brands Paint Company 4343 San Pablo Avenue Emeryville, California</p>
---	---

Project No.: 301-001-02F

Date: 9/24/97

Prepared by: E. Chan

Figure 2

Top of PVC Casing
Elevation: 38.70 ft., MSL Datum

Surface Elev. 39.21 feet MSL Datum
 Coordinates N:5847.90, E:4491.67
 Drill Date: Start 6/6/95 Finish 6/6/95
 Drill Method Mobile B-53; Hollow-Stem Auger
 Pilot Hole 6.25" O.D., 3.25" I.D., 7" bit
 Reamed Hole 10" O.D., 6.25" I.D., 11" bit
 Driller Gregg Drilling/Ted Hogan

Logged by Jake Russin
 Reviewed by Kim Joltz

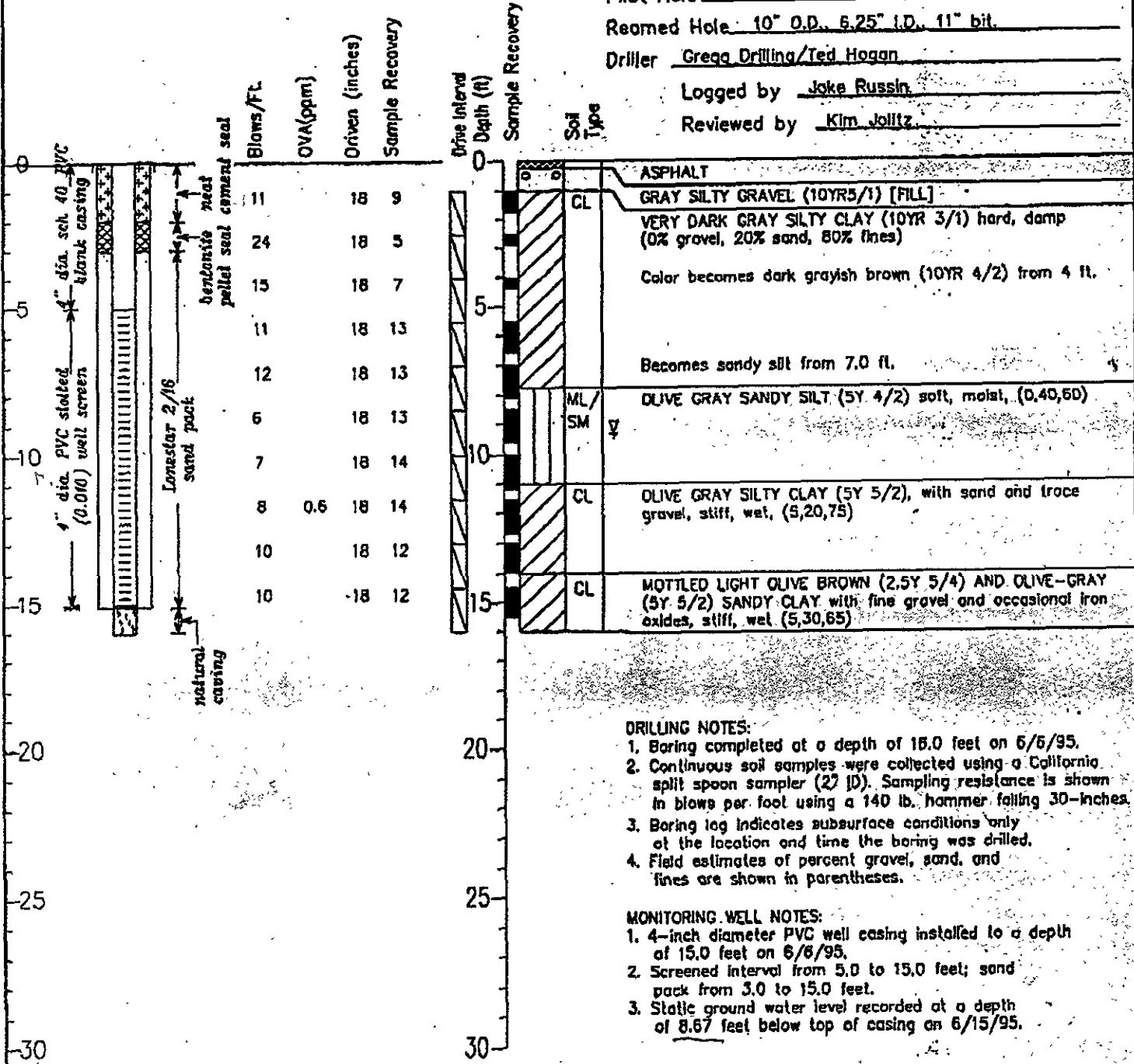

DRILLING NOTES:

- Boring completed at a depth of 18.0 feet on 6/6/95.
- Continuous soil samples were collected using a California split spoon sampler (2" ID). Sampling resistance is shown in blows per foot using a 140 lb. hammer falling 30-inches.
- Boring log indicates subsurface conditions only of the location and time the boring was drilled.
- Field estimates of percent gravel, sand, and fines are shown in parentheses.

MONITORING WELL NOTES:

- 4-inch diameter PVC well casing installed to a depth of 15.0 feet on 6/6/95.
- Screened interval from 5.0 to 15.0 feet; sand pack from 3.0 to 15.0 feet.
- Static ground water level recorded at a depth of 8.67 feet below top of casing on 6/15/95.

ENVIRON

Counsel in Health and Environmental Science

Job No.03-4603D

Approved:

8/8/95

LOG OF BORING

Standard Brands Remedial Design Investigation
 4343 San Pablo Ave.,
 Emeryville, California

Page 1 of 1

FIGURE

MW3

A-21

TPH - 5'

Continuous core

FIGURE 3
ENVIROPRO AND ENVIRON LOCATIONS

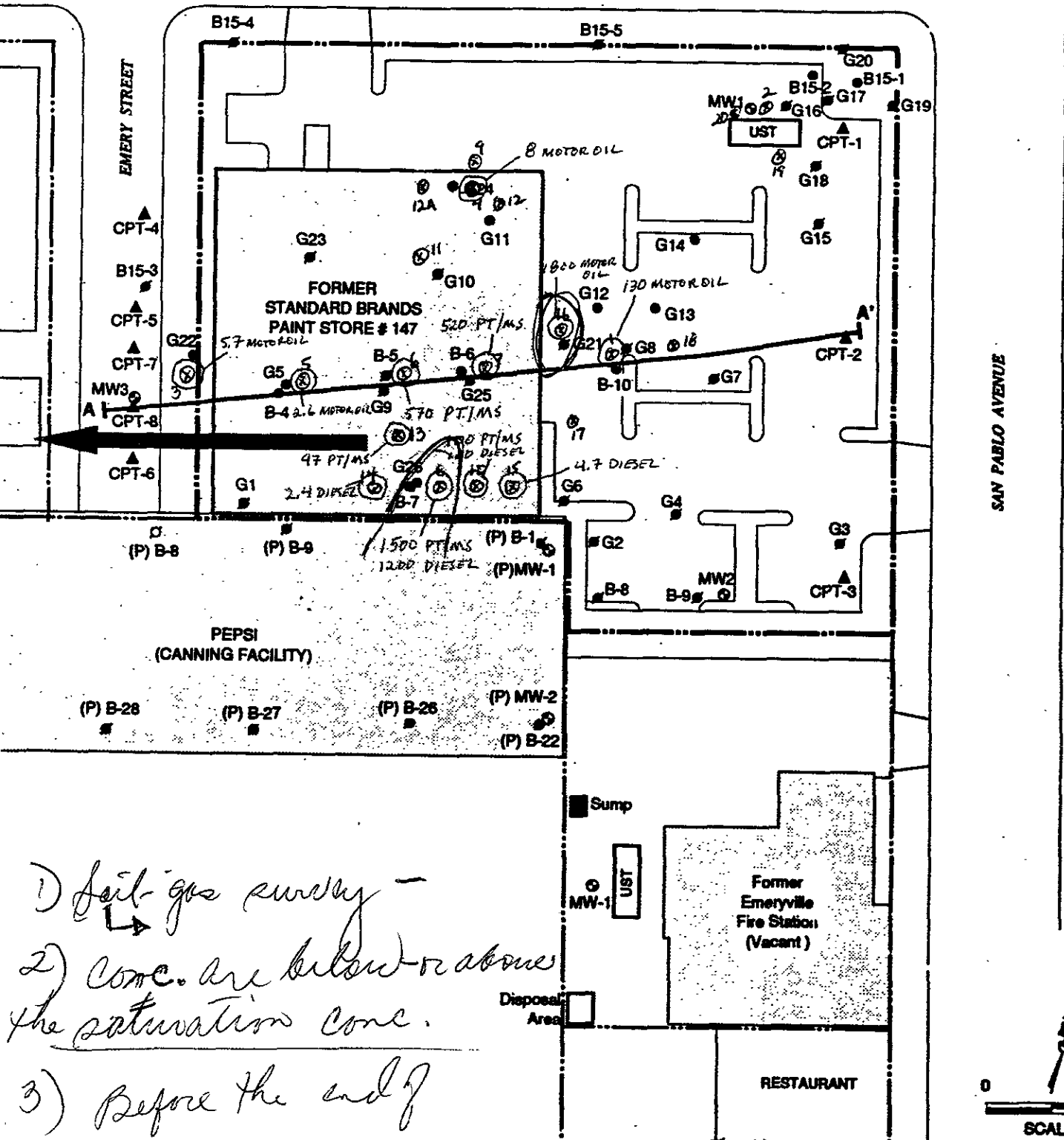

- 1) Soil-gas survey -
- 2) Conc. are below or above the saturation conc.

3) Before the end of June → appropriate depth to G groundwater - perched, 15ft in some shallower depths (9 ft) others at 25ft; look at each others at 25ft; pathway → prioritize

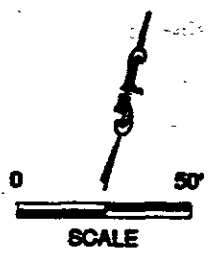

T8510041

TPH- 10'

FIGURE 3
ENVIROPRO AND ENVIRON LOCATIONS

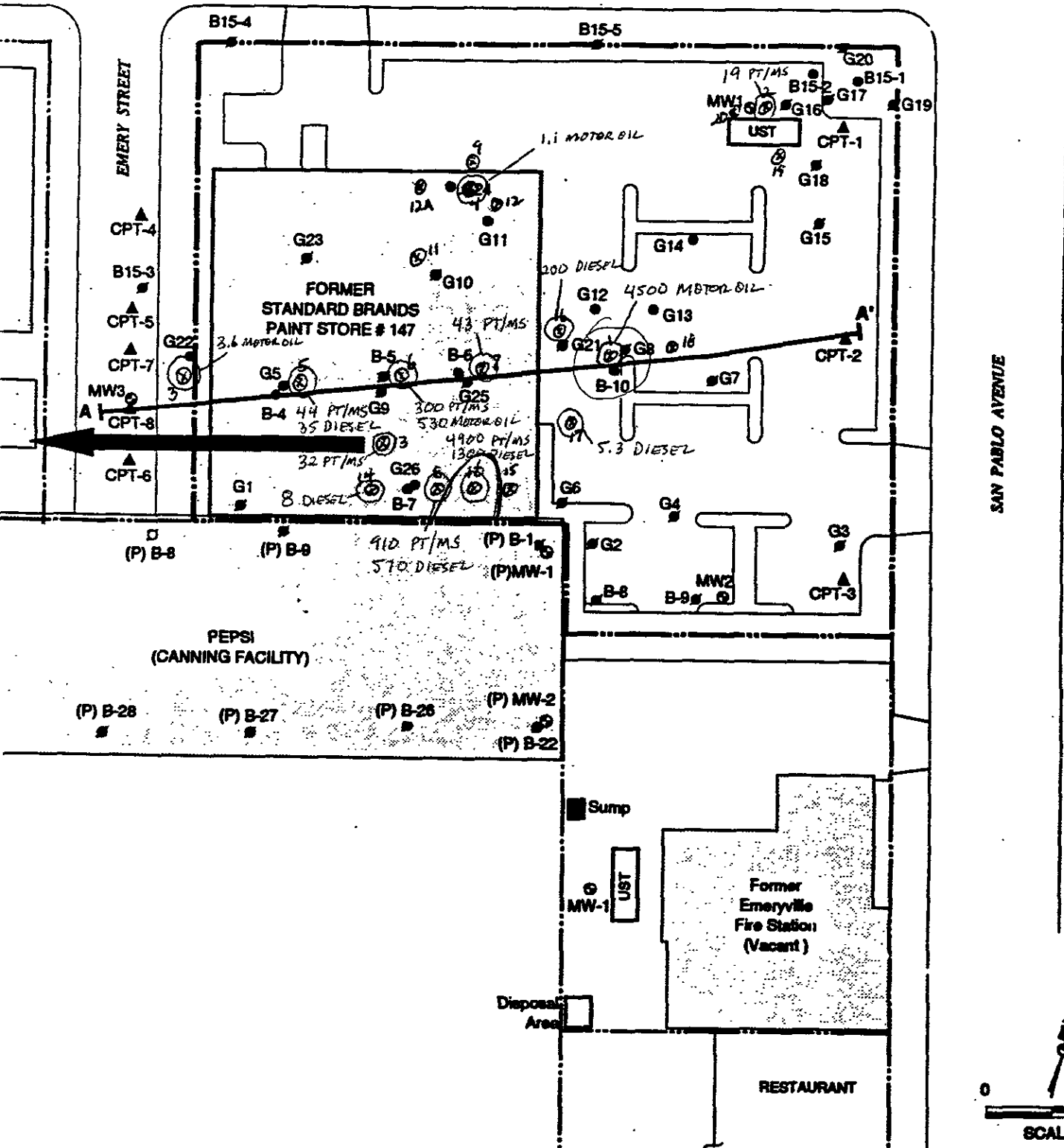

TPH - 15'

FIGURE 3
ENVIROPRO AND ENVIRON LOCATIONS

EET

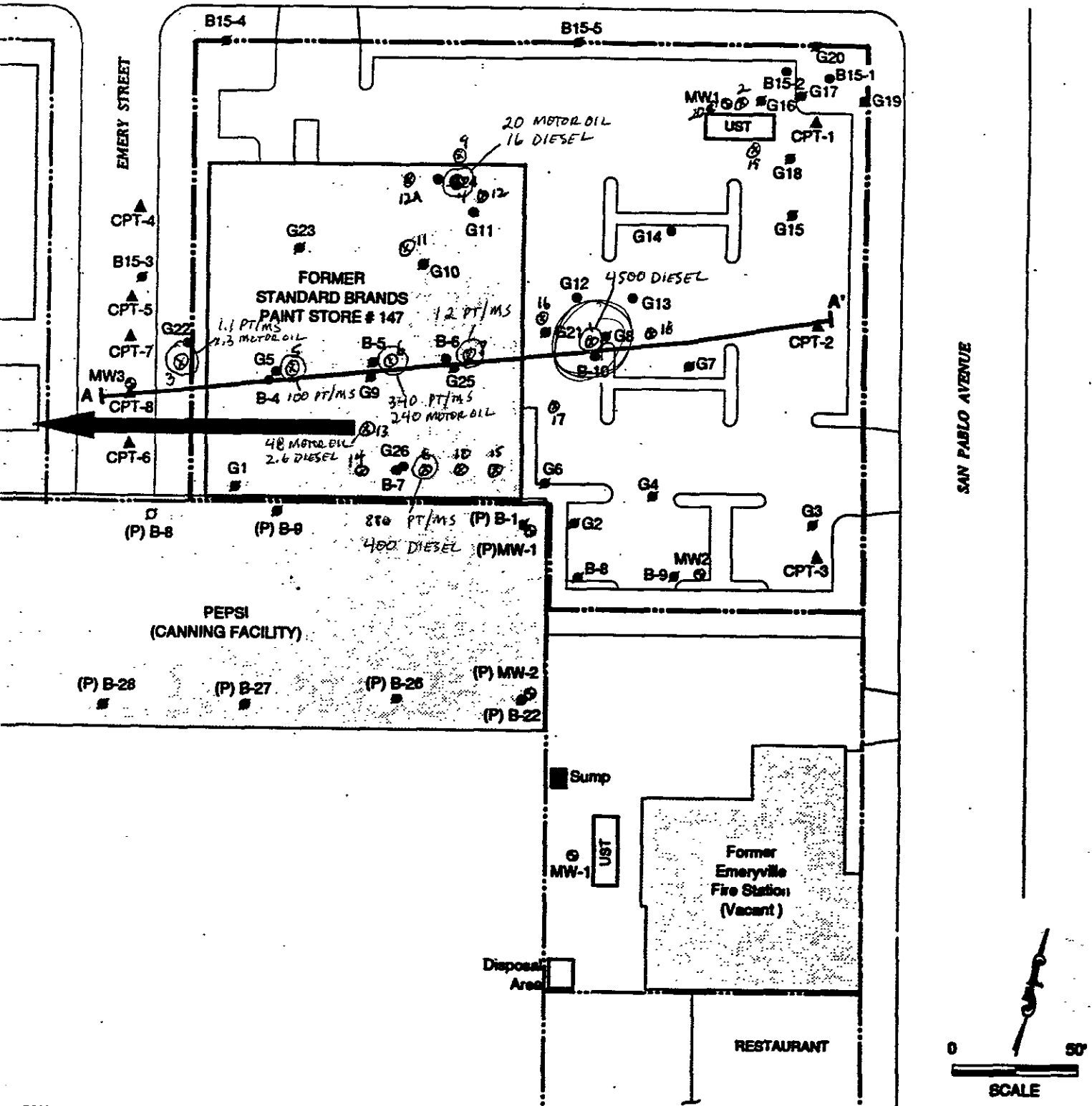

070010

7850047

TPH - 20

FIGURE 3
ENVIROPRO AND ENVIRON LOCATIONS

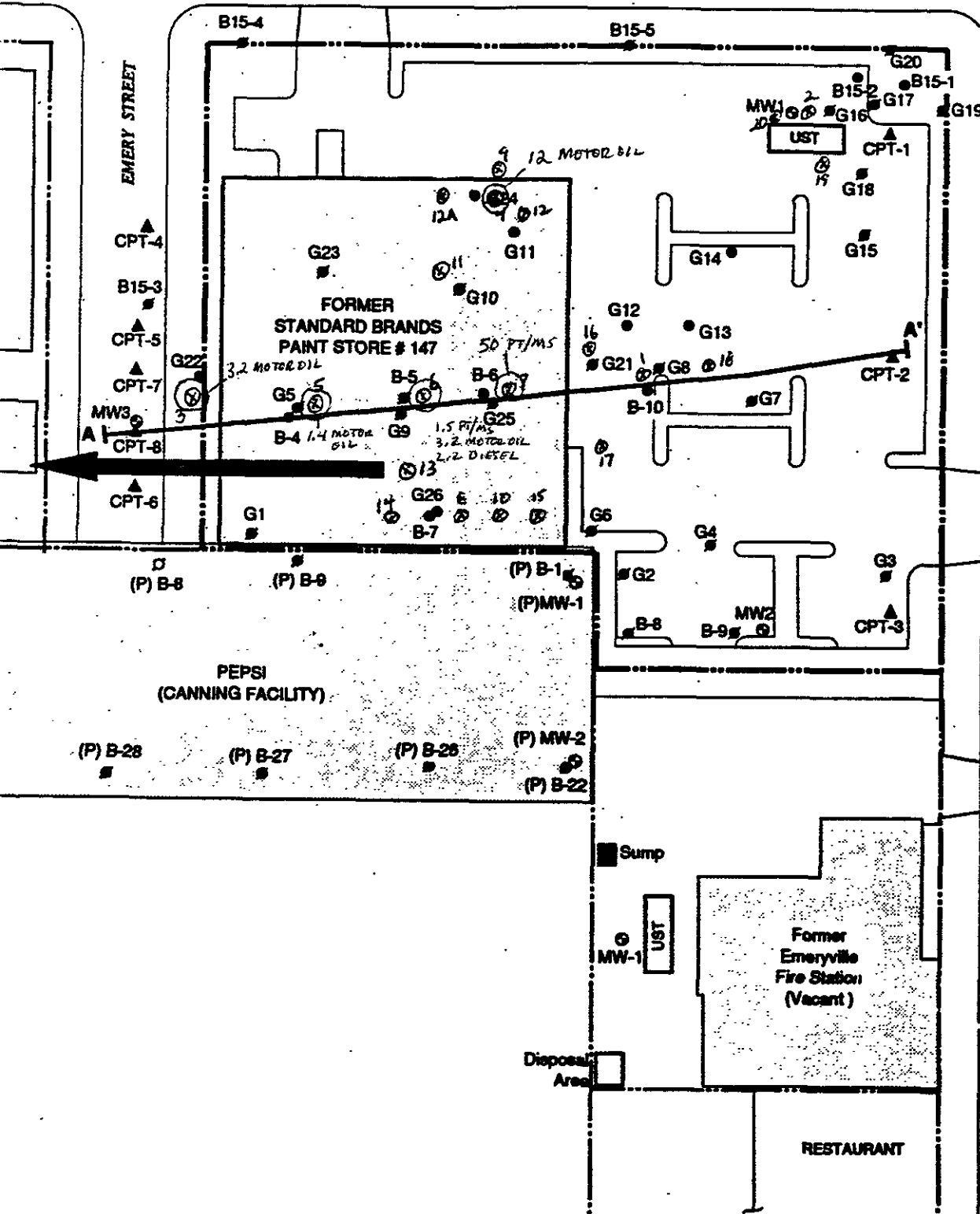

SAN PABLO AVENUE

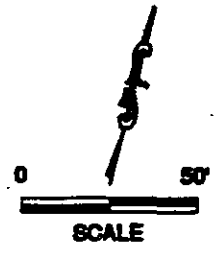

PAHs - 5'

FIGURE 3
ENVIROPRO AND ENVIRON LOCATIONS

HEET

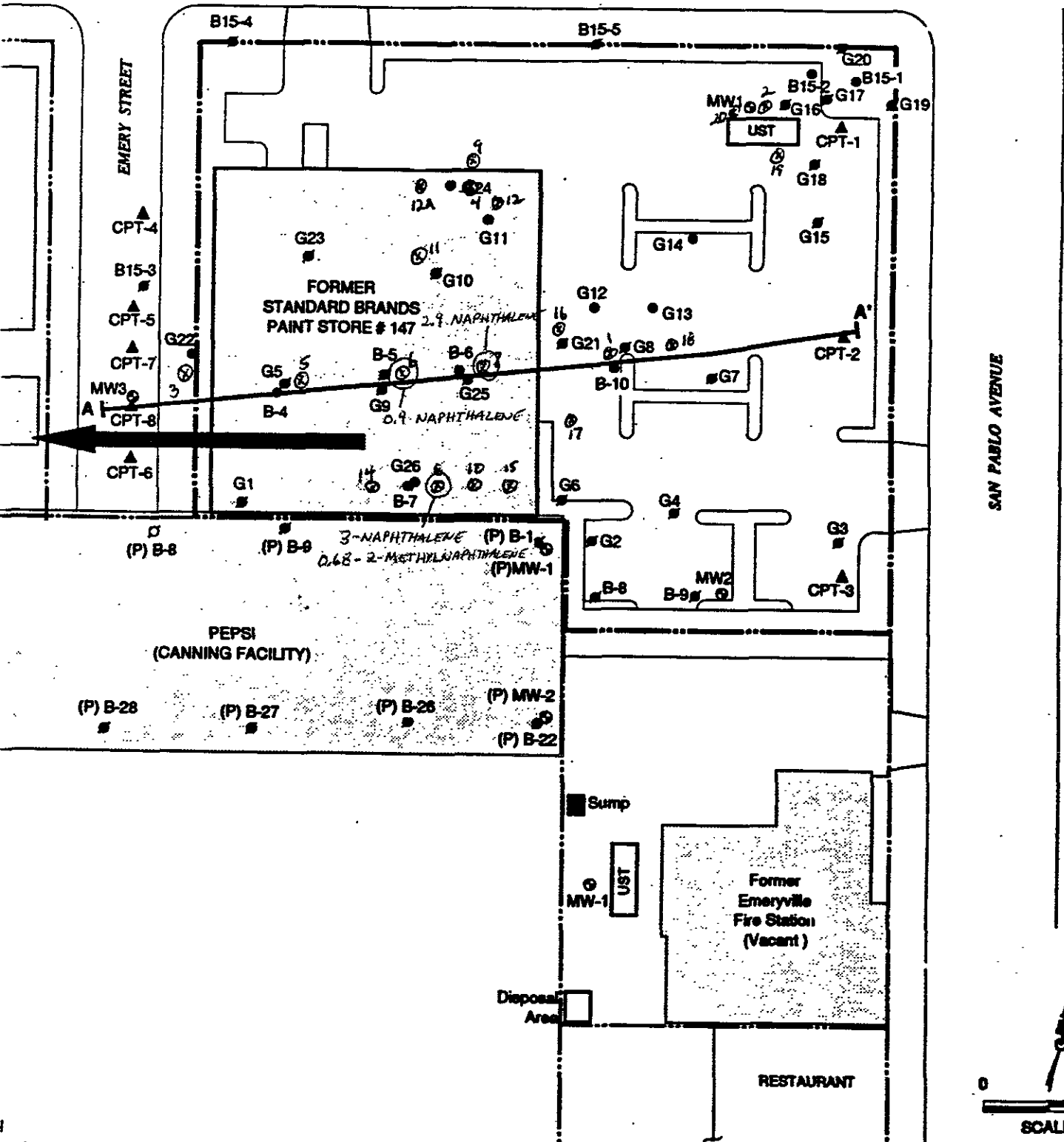

PATHS - 10'

FIGURE 3
ENVIROPRO AND ENVIRON LOCATIONS

EET

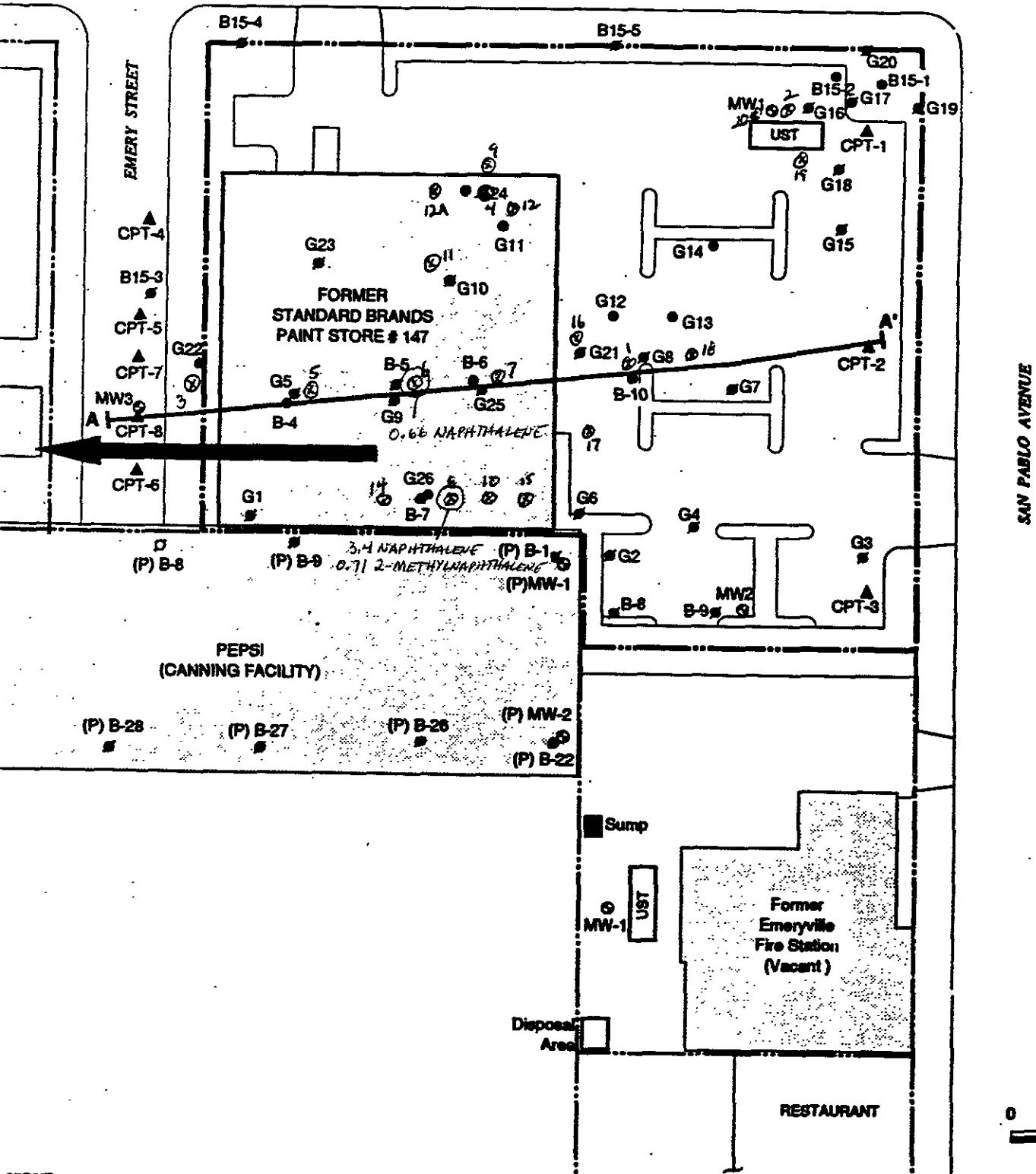

SAN PABLO AVENUE

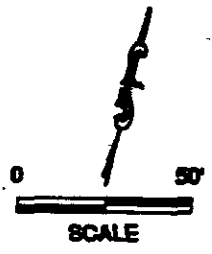

070973

T8810061

PAH'S - 15'

FIGURE 3
ENVIROPRO AND ENVIRON LOCATIONS

ET

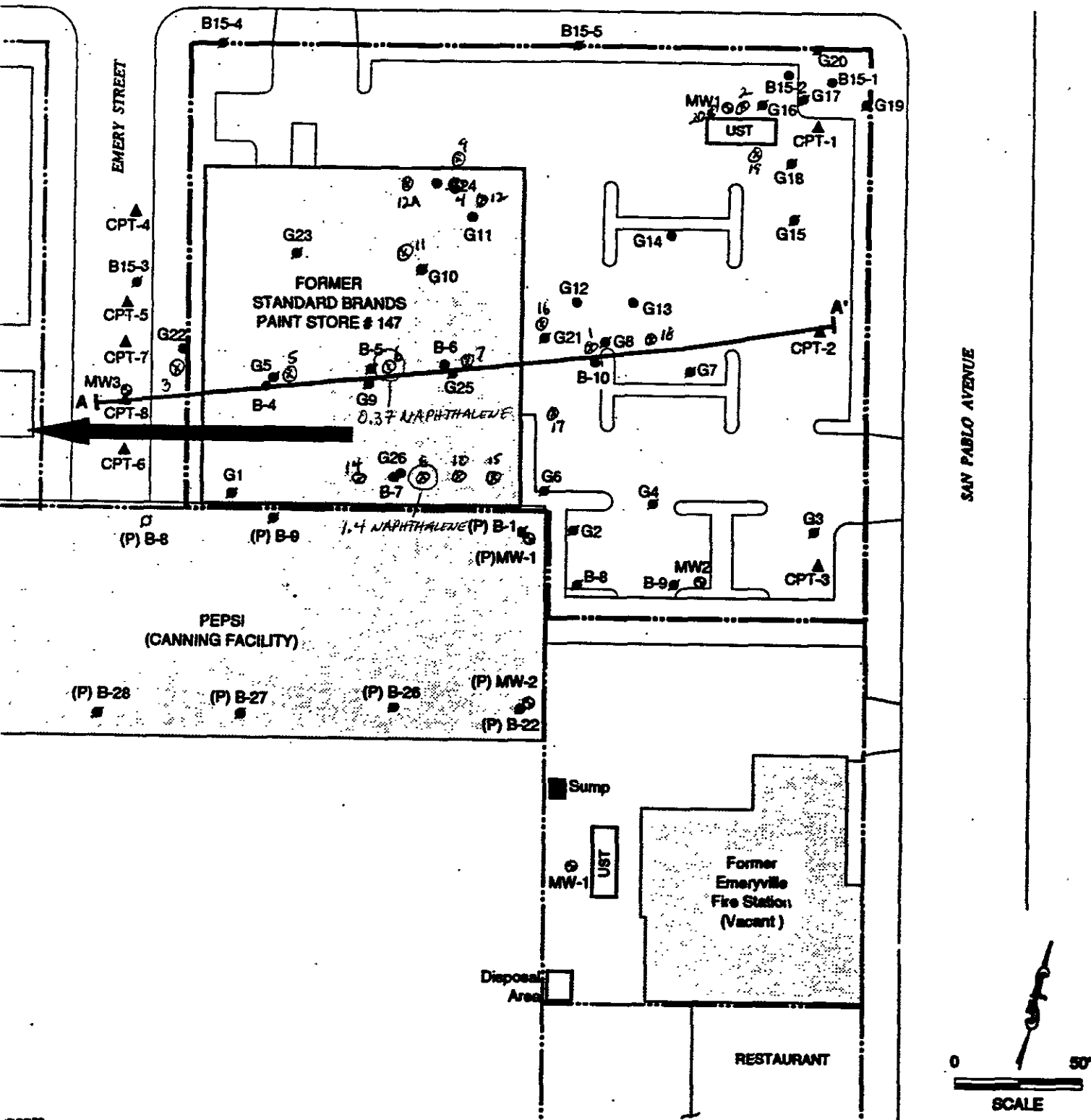

feet

TPH - GROUND WATER

FIGURE 3
ENVIROPRO AND ENVIRON LOCATIONS

EET

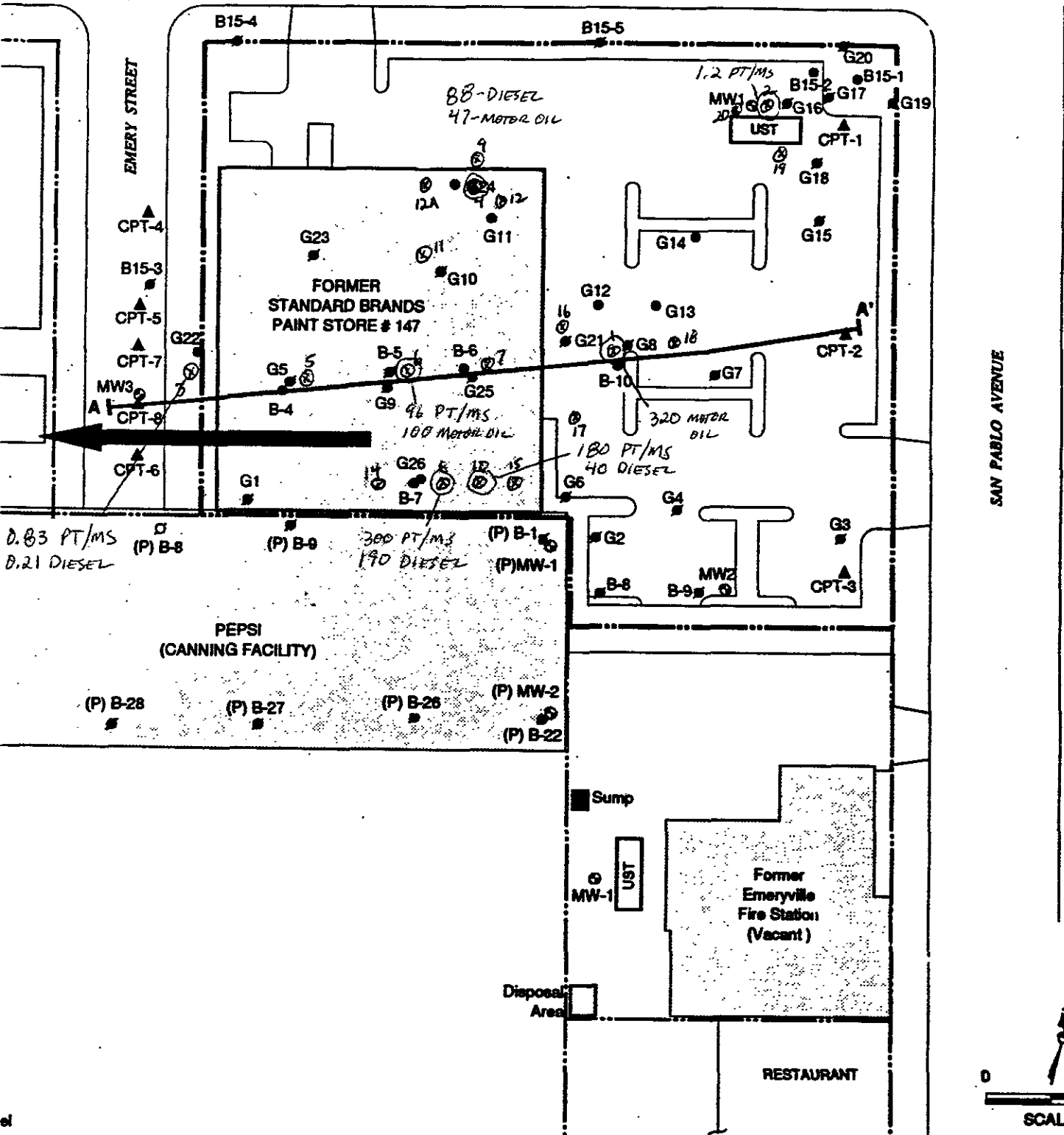

PAHS - GROUNDWATER

FIGURE 3
ENVIROPRO AND ENVIRON LOCATIONS

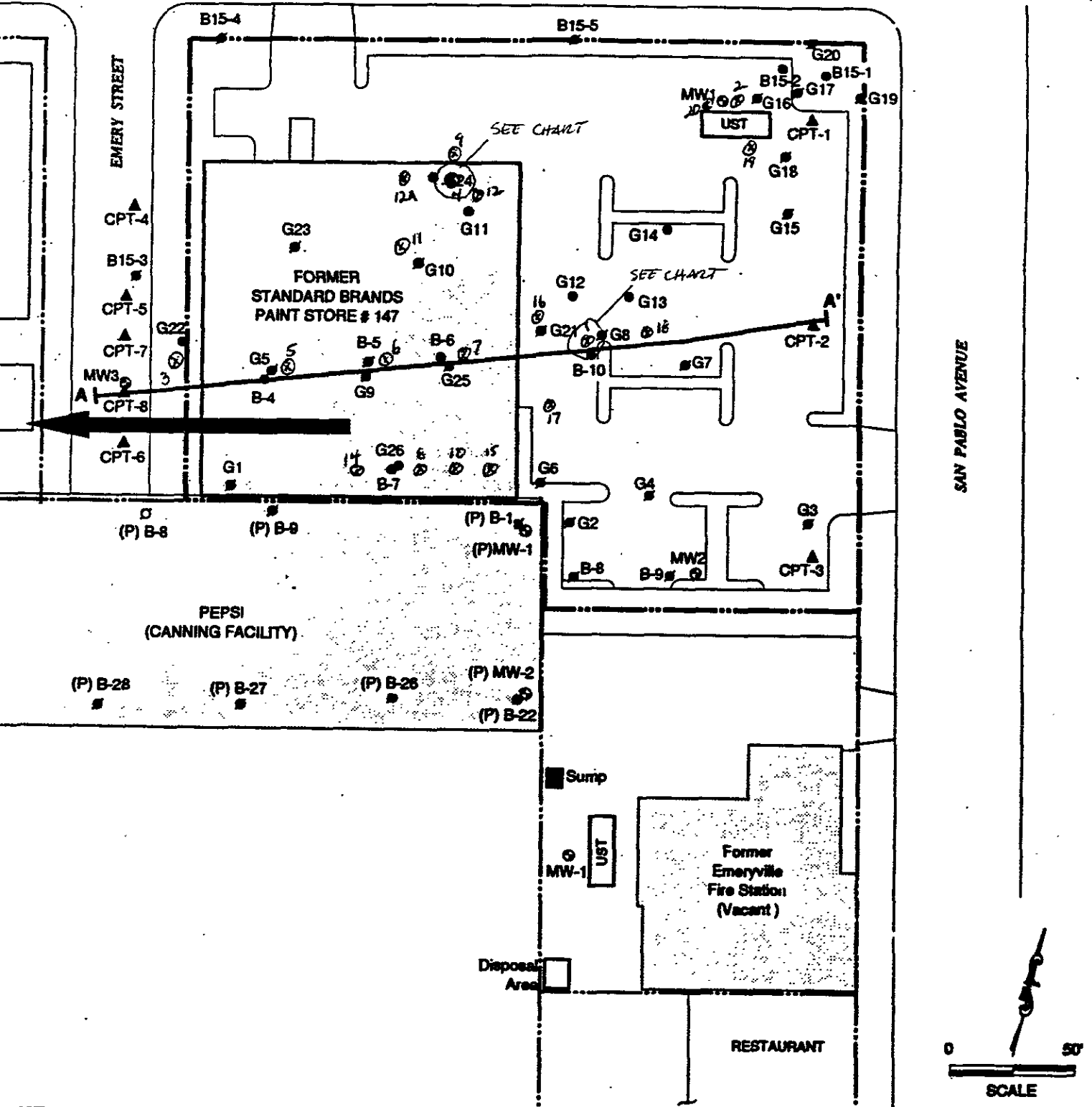

VOCs - GROUNDWATER

FIGURE 3
ENVIROPRO AND ENVIRON LOCATIONS

HEET

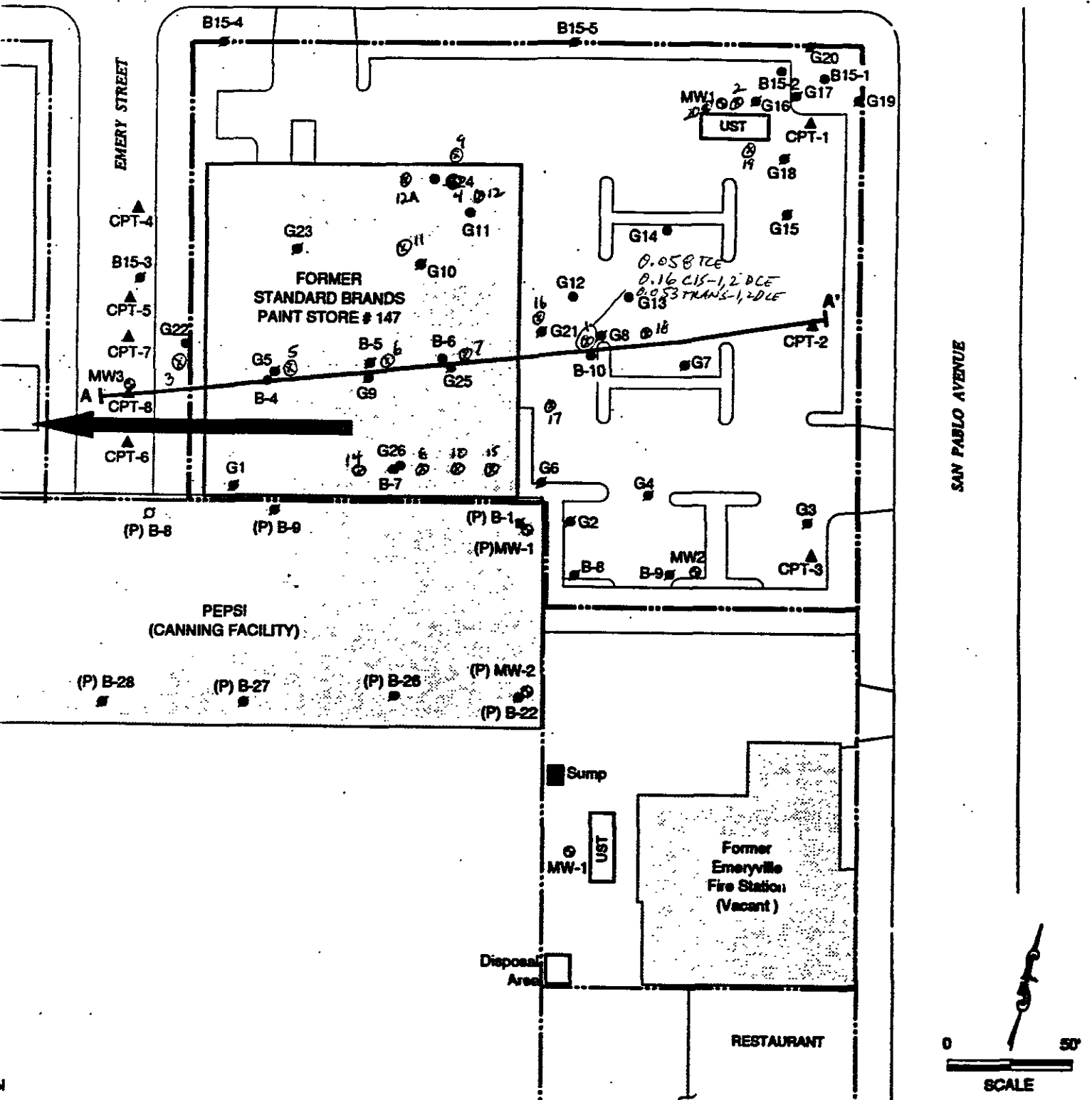



HYDRODATA

DTU = DEPTH TO WATER
 DTP = DEPTH TO PRODUCT
 TD = CASING DEPTH
 BTD = BOREHOLE DEPTH

DATE: _____

PROJECT: _____ EVENT: _____ SAMPLER: _____

NO.	WELL OR LOCATION	DATE			TIME		MEASUREMENT	CODE	COMMENTS			
		MO	DA	YR	HR	MIN			DTP	DTW	T.D.	B.T.D.
1	MH-4						0.01 ft FP		10.95	10.96	20	23
2	MH-12						0.01 ft FP		17.92	17.93	19	19
3	MH-12A						Shut (dry before)				14.5	20
4	MH-11						H ₂ O (dry before)				14	16
5	MH-6						0.02 ft FP		10.98	11.0	20.8	21
6	MH-5						H ₂ O			12.45	17.8	21
7	MH-14						H ₂ O			10.95	15.35	16
8	MH-8									10.91	14.20	16
9	MH-10									10.75	13.90	16
10	MH-15									10.62	12.50	13
11	MH-13						H ₂ O (dry before)				17.50	20
12	MH-16						Shut				15.75	16
13	MH-1						FP			8.30	14.92	16
14	MH-17											12
15	MH-18						FP (0.01 ft)				16.0	20
16	MH-19						FP (0.01 ft)			4.41	15.0	21
17	MH-20									3.91	5.5'	20
18	MH-2									7.72	14.5	16
19	MH-9									9.75	18.4	25
20	MH-3						Dry					21

CODES:

*SWL - Static Water Level (Feet)
 *IWL - Instant Water Level; Non-Static (Feet)
 *OIL - Oil Level (Feet)
 *OWI - Oil/Water Interface (Feet)
 *MTD - Measured Total Depth (Feet)
 FLO - Flow Rate (Gallons/Minute)
 CUM - Cumulative (Gallons)

HRS - Total (Hours)
 PSI - Pressure (psi)²
 pH - 1 to 14
 Ec - Conductivity (µm HOS)
 TMP - Temperature (°C)
 TRB - Turbidity (NTU)
 _____ (Additional Code)

*All levels are depth from inner casing - describe any other reference points in comments column; when in doubt, describe reference point.

Note in comments column if well is not: properly labeled, locked, or able to be locked. Describe corrective action. Note flooding of vault box, odor, access problems.

*Negative pressure (Vacuum) psi = approx $-(1/2 \times \text{mmHg})$

Physical Parameters and TOC Analysis

Analysis	MH-1			MH-5			MH-8		
	2	8	15	2	8	16	2	8	11
<i>Specific Gravity</i>	2.57	2.56	2.52	2.68	2.56	2.57	2.51	2.6	2.57
<i>Dry Unit Weight (pcf)</i>	111.8	111.1	108.1	116.2	107	108.2	105.2	104.2	107.7
<i>Water Content (%)</i>	10.6	17.3	21.5	5.9	20.6	17.8	19.4	19.9	21
<i>Porosity (%)</i>	30.3	30.5	31.3	30.6	33.1	32.5	32.9	35.9	33
<i>Total Organic Carbon</i>	24000*	5200	1000	21000	6000	2100	22000	5200	4000

* TOC concentrations in ppm

Soil Analytical Results (ppm)
Former Standard Brands Paint Store
4343 San Pablo Ave
Emeryville, CA

Analysis	MH-1						MH-2		
	2	5.5	8	10.5	15	16	5.5	10.5	15.5
TPH									
Paint Thinner/Mineral Spirits	NA	ND	NA		ND		ND	19	ND
Motor Oil	↓	130	↓	4500	↓	330	↓	ND	↓
Diesel	↓	ND	↓		↓		↓		↓
PAHs									
Naphthalene	↓	ND	↓	ND	↓		↓		↓
2-Methylnaphthalene	↓		↓		↓		↓		↓

ND = NON DETECT
NA = NOT ANALYZED FOR

Soil Analytical Results (ppm)
Former Standard Brands Paint Store
4343 San Pablo Ave
Emeryville, CA

Analysis	MH-3				MH-4			
	5.5	10.5	15.5	20.5	5.5	10.5	15.5	20.5
TPH								
Paint Thinner/Mineral Spirits	ND	ND	1.1	ND	ND	ND	ND	ND
Motor Oil	5.7	3.6	1.3	3.2	8	1.1	20	12
Diesel	ND	ND	ND	ND	ND	ND	16	ND
PAHs								
Naphthalene	↓	↓	↓	↓	ND	ND	ND	↓
2-Methylnaphthalene	↓	↓	↓	↓	↓	↓	↓	↓

Soil Analytical Results (ppm)
 Former Standard Brands Paint Store
 4343 San Pablo Ave
 Emeryville, CA
 MH-5

Analysis

	2	5.5	8	10.5	15	16	20.5
TPH							
Paint Thinner/Mineral Spirits	NA	ND	NA	44	100	NA	ND
Motor Oil	↓	2.6	↓	35	ND	↓	1.4
Diesel	↓	ND	↓	ND	↓	↓	ND
PAHs							
Naphthalene	↓	ND	↓	ND	↓	↓	↓
2-Methylnaphthalene	↓	↓	↓	↓	↓	↓	↓

Soil Analytical Results (ppm)
Former Standard Brands Paint Store
4343 San Pablo Ave
Emerville, CA

Analysis	MH-6				MH-7				
	5.5	10.5	15.5	20.5	5.5	9	15.5	19	27.5
TPH									
Paint Thinner/Mineral Spirits	570	300	340	1.5	520	43	12	50	NA
Motor Oil	ND	530	240	3.2	ND	ND	ND	ND	
Diesel	↓	ND	ND	2.2	↓	↓	↓	↓	
PAHs									
Naphthalene	0.9	0.66	0.37	ND	2.9	ND	ND	ND	
2-Methylnaphthalene	ND	ND	ND	↓	ND	↓	↓	↓	↓

Soil Analytical Results (ppm)
Former Standard Brands Paint Store
4343 San Pablo Ave
Emeryville, CA

Analysis	MH-8					MH-10			
	2	5.5	8	10.5	11	14.5	6	10	10.5
TPH									
Paint Thinner/Mineral Spirits	NA	1500	NA	910	NA	880	100	4900	NA
Motor Oil	↓	ND	↓	ND	↓	ND			↓
Diesel		1200		570		400	120	1300	
PAHs									
Naphthalene	↓	3	↓	3.4	↓	1.4	ND	ND	↓
2-Methylnaphthalene		0.68		0.71		ND	↓	↓	↓

Soil Analytical Results (ppm)
Former Standard Brands Paint Store
4343 San Pablo Ave
Emerville, CA

Analysis	MH-13				MH-14			MH-15	
	5	5.5	9.5	15.5	5.5	10	10.5	4.5	5
TPH									
Paint Thinner/Mineral Spirits	97	NA	32	48	ND	ND	NA	NA	ND
Motor Oil	ND		ND	ND	2.4	8			4.7
Diesel	↓		↓	2.6	ND	ND			ND
PAHs									
Naphthalene	NA		NA	NA	NA	NA			NA
2-Methylnaphthalene	↓		↓	↓	↓	↓			↓

Soil Analytical Results (ppm)
Former Standard Brands Paint Store
4343 San Pablo Ave
Emeryville, CA

Analysis	MH-16				MH-17		MH-18
	5	5.5	10.5	15.5	10.5	11	11.5
TPH							
Paint Thinner/Mineral Spirits	ND	NA	ND	(Hold)	ND	NA	ND
Motor Oil	1800		200		5.3		
Diesel	ND		ND		ND		
PAHs							
Naphthalene	NA		NA	NA	NA		
2-Methylnaphthalene							NA

C-8-14 (hexane)

Follows construction

Groundwater Analytical Results (ppm)
Former Standard Brands Paint Store
4343 San Pablo Ave
Emeryville, CA

A. Amul 5/02

Analysis	MW-3	MH-1	MH-2	MH-4	MH-6	MH-8	MH-10	MH-14	MH-15	MW-2	MW-1
TPH											
Paint Thinner/Mineral Spirits	0.83	ND	1.2	ND	96	300	180	12	2.8	ND	ND
Diesel	0.21	ND	ND	88	ND	190	40	ND	ND	↓	↓
Motor Oil	ND	320	↓	47	100	ND	ND	↓	↓		
VOCs											
Trichloroethene	ND	0.058	ND	ND	ND	ND	NA	NA	NA	ND	ND
cis-1,2-Dichloroethene	↓	0.16	↓	↓	↓	↓		↓	↓	↓	↓
trans-1,2-Dichloroethene	↓	0.053	↓	↓	↓	↓		↓	↓		
PAHs											
Naphthalene	NA	ND	NA	0.002	NA	NA		1.3	NA	NA	NA
Acenaphthylene				0.003				ND			
Acenaphthene				0.004							
Fluorene				0.012							
Phenanthrene				0.019							
Anthracene				0.013							
Fluoranthene				0.007							
Pyrene		0.002		0.036							
Benzo[a]anthracene		0.001		0.015							
Chrysene		ND		0.033							
Benzo(a)pyrene		↓		0.009							
Benzo(b)fluoranthene		↓		0.006							
Benzo(g,h,i)perylene		NA		0.002							
Metals											
As				0.0061							
Ba				0.34							
Ni				0.072							