



93 AUG -9 AM 11: 25

**LEVINE•FRICKE**

ENGINEERS • HYDROGEOLOGISTS & APPLIED SCIENTISTS

### Letter of Transmittal

Date August 6, 1993

From Michael Stoll

Project No. 1204

To Mr. Scott Seery  
Alameda County Health Care Services  
Agency, Department of Environmental  
Health  
80 Swan Way, Room 200  
Oakland, California 94621

Subject Polvorosa Business Park,  
San Leandro (Alameda  
County STID #4462)

The following items are:  Requested  Enclosed  Sent Separately  
via Overnight Mail

Description	No. of Copies
✓ Copies of Monthly Discharge Reports (system startup to July 31, 1993)	1
✓ Letter to Mr. Steve Chamberlin (Rouse & Assoc.) from Ted Splitter (Levine•Fricke), dated February 3, 1992	1
✓ Letter to Mr. Rob Weston (ACHCSA) from Michael Stoll (Levine•Fricke), dated March 8, 1993	1
✓ Work Plan for Quarterly Ground-Water Monitoring, Polvorosa Business Park, 1555 Doolittle Drive, San Leandro, California, dated August 6, 1993	1
✓ Letter to Mr. Scott Seery (ACHCSA) from Ted Splitter (Levine•Fricke), dated August 6, 1993	1

These data are transmitted:

At your request

For your action

For your approval

For your files

For your review

For your information

Comments

(Signed)

1900 Powell Street, 12th Floor  
Emeryville, California 94608  
(510) 652-4500  
Fax (510) 652-2246



August 6, 1993

LF 1204

Mr. Scott Seery  
Senior Hazardous Materials Specialist  
Alameda County Health Care Services Agency  
Department of Environmental Health  
80 Swan Way, Room 200  
Oakland, California 94621

Subject: Polvorosa Business Park  
1555 Doolittle Drive  
San Leandro, California  
(Alameda County STID #4462)

Dear Mr. Seery:

Please find the enclosed documents which pertain to product recovery activities at the Polvorosa Business Park, 1555 Doolittle Drive, San Leandro, California ("the Site"). We have forwarded these documents to you in response to your July 8, 1993 letter to Rouse & Associates. On behalf of Rouse & Associates, we have included for your files and review: copies of our monthly discharge reports for the product recovery system at the Site, a letter documenting analytical results for the groundwater sampling of well LF-15 in January 1992, a letter documenting the installation of one additional product extraction pump, and a Work Plan for quarterly ground-water monitoring at the Site.

A product recovery system was installed at the Site in 1989 to recover diesel product from the ground-water interface. As part of the discharge permit from the City of San Leandro for the product recovery system, we have been submitting monthly discharge reports to the Water Pollution Control Plant.

The February 3, 1992 letter documents the sampling of ground-water monitoring well LF-15. The well was sampled in response to a request from the Alameda County Health Care Services Agency (ACHCSA).

The product recovery system operated from 1989 through early 1993 with relatively few periods of down time. In response to a significant drop in the rate of recovery, an additional extraction pump was installed. The March 8, 1993 letter to the ACHCSA discusses the installation of the additional extraction pump.

P:\fpublic\mjs\1204ala.ltr

1900 Powell Street, 12th Floor  
Emeryville, California 94608  
(510) 652-4500  
Fax (510) 652-2246

## LEVINE·FRICKE

After the installation of the additional extraction pump, the product recovery system recovered product for a short time and then ceased to recover product.

Levine·Fricke recommended to Rouse & Associates that they cease pumping the product recovery system and begin ground-water monitoring. Rouse & Associates authorized Levine·Fricke to prepare the enclosed Work Plan.

The Work Plan proposes to monitor five ground-water monitoring wells at the Site on a quarterly basis for one year to assess the ground-water quality in the site area.

On behalf of Rouse & Associates, we request that you review the Work Plan. If you have any questions or comments, please feel free to contact me or Michael Stoll.

Sincerely,



Ted Splitter, P.E.  
Principal Engineer

Enclosures



August 6, 1993

LF 1204

Mr. Scott Seery  
Senior Hazardous Materials Specialist  
Alameda County Health Care Services Agency  
Department of Environmental Health  
80 Swan Way, Room 200  
Oakland, California 94621

Subject: Work Plan for Quarterly Ground Water Monitoring  
Polvorosa Business Park, 1555 Doolittle Drive  
San Leandro, California

Dear Mr. Seery:

Please find the enclosed Work Plan for Quarterly Ground-Water Monitoring at the subject property. As stated in the work plan, Levine-Fricke proposes to discontinue operation of the existing product recovery system and conduct quarterly ground-water monitoring in the area of affected soils at the Site. The results obtained during the ground water monitoring period will be evaluated and recommendations for closure or recommendations for additional environmental work will be developed.

Please review the enclosed work plan and contact us with your comments at your earliest convenience.

If you have any questions or comments, please contact either of the undersigned.

Sincerely,

  
Ted Splitter, P.E.  
Principal Engineer

  
Michael Stoll  
Project Engineer

1900 Powell Street, 12th Floor  
Emeryville, California 94608  
(510) 652-4500  
Fax (510) 652-2246

August 6, 1993

LF 1204

**WORK PLAN FOR QUARTERLY GROUND-WATER MONITORING  
POLVOROSA BUSINESS PARK, 1555 DOOLITTLE DRIVE  
SAN LEANDRO, CALIFORNIA**

**INTRODUCTION**

Based on field observations made during the remedial program to remove floating diesel product from ground water at the Polvorosa Business Park in San Leandro, California (the "Site"; see Figure 1), it appears that the product recovery system has essentially removed the accessible free product from the area. On behalf of our client, Rouse & Associates (Rouse), Levine-Fricke proposes to discontinue operation of the product recovery system and to conduct quarterly ground-water monitoring at the Site. The year long ground-water monitoring program will include the collection and analysis of one round of water samples from five existing near-by ground-water monitoring wells on a quarterly basis. Ground-water samples collected will be analyzed for Total Petroleum Hydrocarbons (TPH) as diesel (TPHd) and for the fuel constituents benzene, toluene, ethylbenzene and total xylenes (BTEX). Results of the ground-water samples will be used to assess if nearby ground water is impacted by petroleum products. Based on the results of the ground-water sampling program, Levine-Fricke will either recommend the Site for closure or recommend additional environmental work to obtain Site closure.

**Background**

The Site comprises approximately 5.5 acres on the northwest corner of Doolittle Drive and Polvorosa Avenue in San Leandro. The Site is currently occupied by an office park development. The Site was reportedly used as a truck terminal by several different owners from 1959 to 1986. The underground tanks were removed following demolition of the terminal buildings in 1986.

Samples of the ground water in the bottom of the tank removal excavations were found to contain concentrations of motor oil, diesel, and gasoline constituents. In September 1986, Blymer & Sons (B&S) and, at a later date (June 1987), Hazardous Materials Mitigation Professionals (HMMP) were retained by Rouse to assess the hydrocarbon concentrations and to assess the extent of hydrocarbon migration in the soil and ground water. Rouse then requested Levine-Fricke to review the work

# LEVINE·FRICKE

performed at the Site by B&S and HMMP to: (1) develop and conduct a program to better define the extent and amount of hydrocarbons in the soil and ground water; and (2) to develop recommendations for remediation.

Levine·Fricke installed additional wells at the Site and encountered floating diesel product in one of the wells. Upon a recommendation from Levine·Fricke and approval of the Alameda County Health Care Services Agency (ACHCSA), Rouse installed a product recovery system at the Site to extract the floating diesel product in 1989. The system design included the extraction of diesel product from one extraction well, LF-12A. In October 1992, the product recovery rate began to drop from a previous monthly average of approximately 20 liters to approximately 0 liters in April 1993. In an attempt to recover additional product at the Site, Levine·Fricke installed an additional extraction pump in a nearby observation well, LF-12, located 10 feet away from extraction well LF-12A. One foot of free product had been observed in LF-12 and well LF-12 is screened in a sand layer that is not screened in well LF-12A. The additional extraction well recovered product for a short time then ceased recovering further product.

The product recovery system is currently off-line.

## PROPOSED SCOPE OF WORK

The proposed scope of work includes activities necessary to perform quarterly ground-water monitoring at the Site and includes the following tasks:

- Task 1: Ground-Water Sample Collection
- Task 2: Laboratory Analyses
- Task 3: Data Evaluation and Letter Report Preparation.

These tasks are described below.

### Task 1: Ground-Water Sample Collection

Ground-water samples will be collected from wells MW-3, LF-12, LF-13, LF-14 and LF-15 (see Figure 1). Prior to sample collection, static water levels in each well will be measured to the nearest 0.01 foot using an electronic measuring probe.

If free product is present, the thickness of the free product will be measured to the nearest 0.1 foot using an electronic oil/water interface probe, and the free product will be

*All wells previously impacted all must be monitored*

# LEVINE·FRICKE

removed by hand bailing. Wells with free product will not be sampled.

Where free product is not encountered, five to ten well volumes of water will then be purged from each well using a gasoline-powered centrifugal pump or by hand bailing. The specific conductance, temperature, and pH of the purged water will be monitored and recorded during purging. The procedure is intended to provide ground-water samples that will be

representative of the ground water in sediments surrounding the wells.

If a well goes dry during purging, it will be sampled after the water level has recovered to 80 percent of the static water level or after two hours, whichever occurs first.

After the wells are purged, ground-water samples will be collected using a clean Teflon bailer. The samples will be placed in laboratory-supplied sample containers and stored in an ice-chilled cooler until submitted to a California state-certified laboratory for analysis. Chain-of-custody procedures will be followed during sample handling.

## **Task 2: Laboratory Analyses**

Ground-water samples will be submitted to a California state-certified laboratory for analysis of TPHd using Modified EPA Method 8015 and BTEX using EPA Method 8020.

## **Task 3: Data Evaluation and Letter Report Preparation**

Each quarter, Levine·Fricke will prepare a brief letter report after receiving analytical results for the ground-water samples. This report will summarize field methods, assess the estimated shallow ground-water flow direction and gradient, and present analytical results. The report for the fourth quarter will contain the above information and any recommendations for site closure, continued monitoring or for recommended additional work, if necessary, to obtain Site closure. All of the quarterly reports prepared will be provided to the ACHCSA.

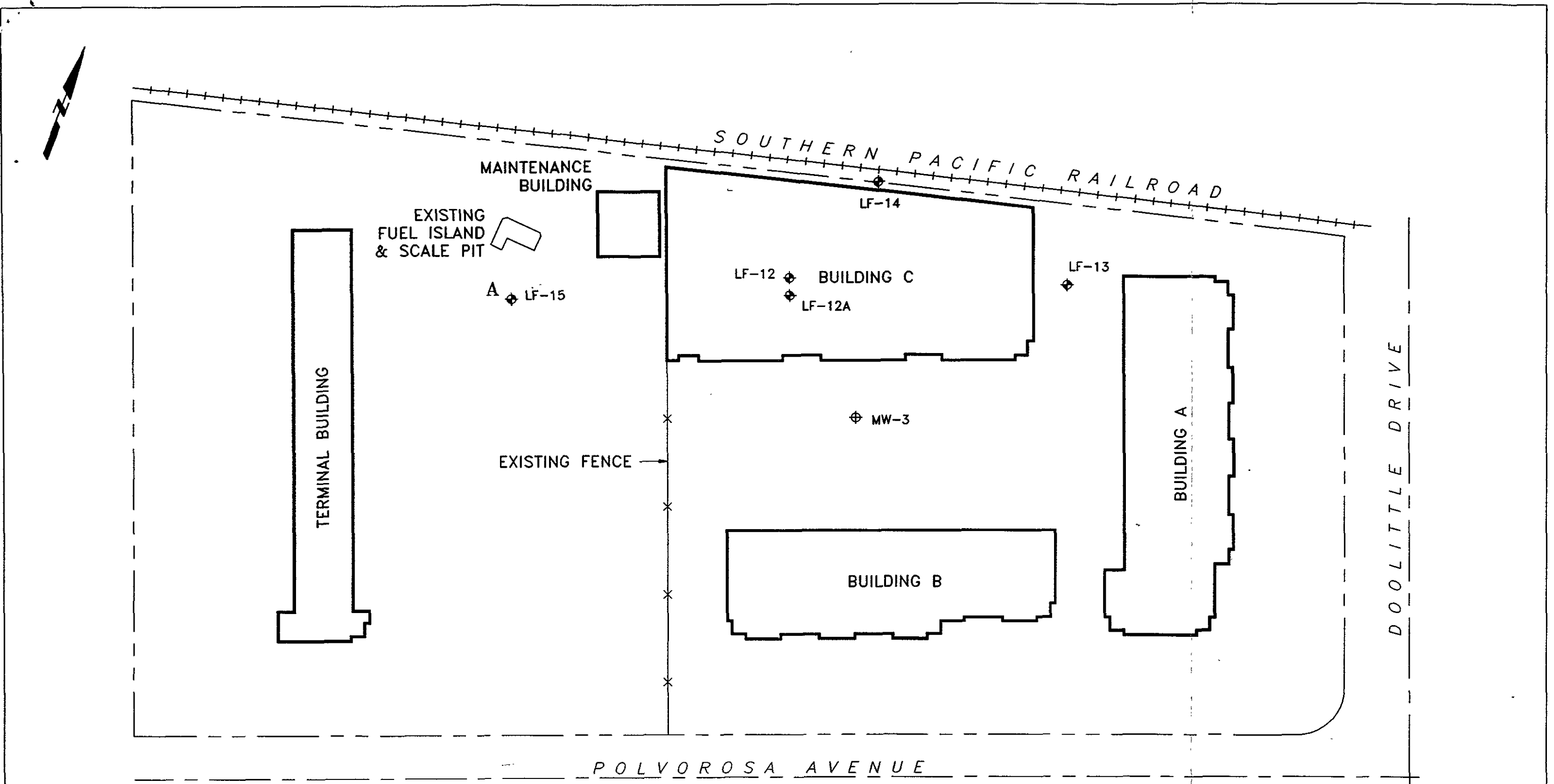

EXPLANATION

- ◆ Approximate well location (installed by Levine-Fricke)
- ⊕ Approximate well location (installed by others)

0 40 80 FEET

Figure 1 :  
SITE PLAN

Project No. 1204

**LEVINE-FRICKE**  
ENGINEERS, HYDROGEOLOGISTS, & APPLIED SCIENTISTS





**LEVINE•FRICKE**  
ENGINEERS, HYDROGEOLOGISTS & APPLIED SCIENTISTS

SEARCHED  
SERIALIZED  
MAR 27 1993

March 8, 1993

LF 1204

Mr. Rob Weston  
Alameda County Health Care Services Agency  
Division of Environmental Health  
80 Swan Way  
Oakland, California 94621

Subject: Polvorosa Business Park, 1555 Doolittle Drive  
San Leandro, California

Dear Mr. Weston:

This letter is to notify you that Levine-Fricke will be installing an additional extraction pump to the product recovery system at the Polvorosa Business Park in San Leandro, California (the "Site"). I spoke with Mr. Michael Bakaldin of the San Leandro Fire Department and with Mr. Scott Seery of Alameda County last week regarding these modifications. It was decided that Levine-Fricke should address a notification letter to you describing our planned activities. Currently, there is one extraction well recovering diesel product at the Site. The planned work will consist of installing an additional extraction pump at a nearby observation well, concrete cutting and trenching, and connecting the pipes between the wells. Our intent is to utilize both extraction wells to recover the product.

#### Background

Levine-Fricke installed a product recovery system at the Site in 1989. The system extracts diesel product from one extraction well, well LF-12A. The system recovered a monthly average of approximately 20 liters of product until November 1992. In November and December 1992, the monthly product recovery rate dropped to approximately 7 liters. In October 1992, observation well LF-12, located less than 10 feet away from the extraction well, contained approximately 1 foot of floating product.

#### Planned System Alteration

Due to the significant drop in product recovery at well LF-12A, Levine-Fricke hopes to improve the product recovery rate at the Site by converting observation well LF-12 to an

1900 Powell Street, 12th Floor  
Emeryville, California 94608  
(510) 652-4500  
Fax (510) 652-2246

## LEVINE·FRICKE

extraction well. Because well LF-12 is screened in a sand layer that is not screened in well LF-12A, converting well LF-12 to an extraction well is likely to improve the product recovery rate.

The additional pump installation is scheduled to be completed this week. If you have any questions or comments, please call me or Ted Splitter.

Sincerely,



Michael Stoll  
Project Engineer



# LEVINE·FRICKE

CONSULTING ENGINEERS AND HYDROGEOLOGISTS

February 3, 1992

LF 1204

Mr. Steve Chamberlain  
Rouse and Associates  
1555 Doolittle Drive  
San Leandro, California 94577

Subject: Laboratory Results  
Ground-Water Sampling  
Polvorosa Business Park  
San Leandro, California

*- following request from DTSC  
for HVC analyses for  
San Leandro Plume study*

Dear Steve:

Enclosed are laboratory results for ground-water samples collected during Levine-Fricke's January 20, 1992 sampling event conducted at the Polvorosa Business Park in San Leandro, California ("the Site"), in response to a request from the Alameda County Health Care Services Agency (ACHCSA). Attached Figure 1 shows the location of ground-water monitoring well LF-15 at the Site.

*copy?  
when?  
what  
requested?*

Before sampling, the well was purged of approximately three well volumes of water using a clean Teflon bailer. Specific conductance, pH, and temperature were measured and water clarity was noted during this purging process to help assess when a sufficient quantity of water had been removed from the well to obtain a representative ground-water sample. Ground-water sampling was conducted immediately following well purging.

Water samples collected from the well were poured from a clean Teflon bailer into laboratory-supplied 40-milliliter volatile organic analysis (VOA) vials. Before use, the Teflon bailer was washed with Alconox (a laboratory-grade detergent) and steam cleaned. The samples were labeled and immediately placed in a chilled cooler for transportation to Quanteq Laboratories, a state-certified laboratory. Handling of the samples was conducted under strict chain-of-custody protocol.

1900 Powell Street, 12th Floor  
Emeryville, California 94608  
(415) 652-4500  
FAX (415) 652-2246

## LEVINE·FRICKE

The sample collected (labeled LF-15) was analyzed for volatile organic compounds (VOCs) using EPA Method 624, as requested by the ACHCSA. Laboratory results indicated that VOCs were not present above detection limits.

If you have any questions, please call me or Julie Sharp.

Sincerely,

  
Ted Splitter  
Principal Engineer

Attachments

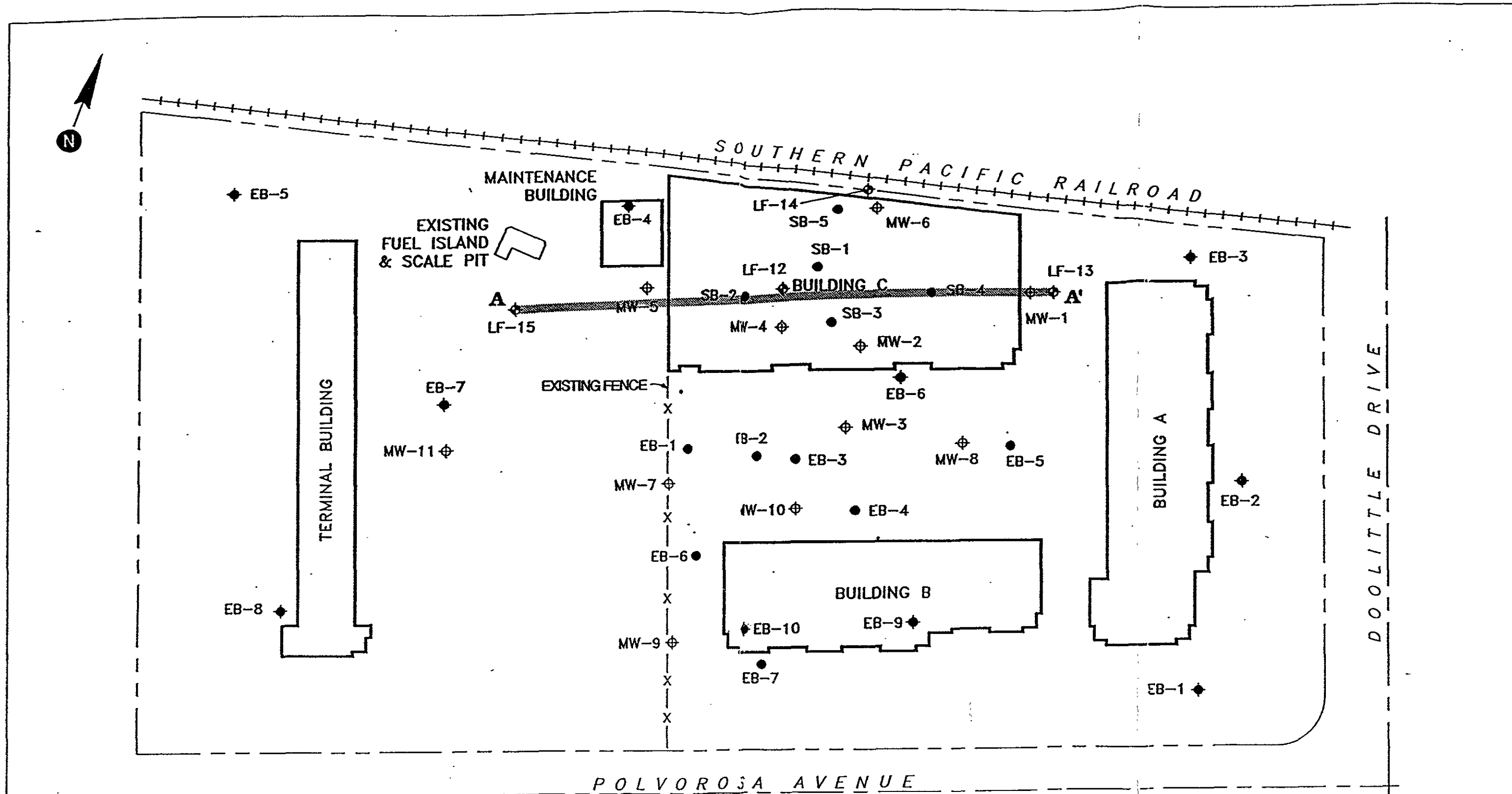

**EXPLANATION**

- ⊕ Approximate well location installed for this study
  - ⊕ Approximate well location installed and tested by others
  - ◆ Approximate soil boring location drilled by Donald E. Banta and Associates
  - Approximate soil boring location drilled by others
- A—A' Cross-section location



Figure 1:  
SITE PLAN SHOWING  
BORING LOCATION PLAN

Project No. 1204

**LEVINE • FRICKE**  
CONSULTING ENGINEERS AND HYDROGEOLOGISTS

12041504NOV88mp

DOHS CERTIFICATION NO. E772

AIHA ACCREDITATION NO. 332

LEVINE-FRICKE  
1900 POWELL STREET  
12TH FLOOR  
EMERYVILLE, CA 94608  
ATTN: JULIE SHARP

REPORT DATE: 01/28/92

DATE SAMPLED: 01/17-20/92

DATE RECEIVED: 01/20/92

CLIENT PROJECT NO: 1204  
C.O.C. NO: 10580

QUANTEQ JOB NO: 9201136

ANALYSIS OF: WATER SAMPLES

See attached for results

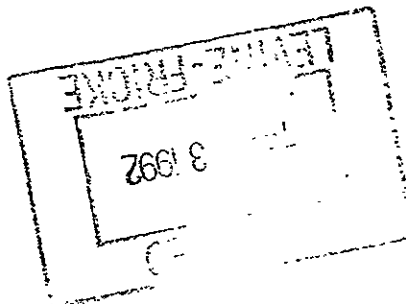

  
Andrew Bradeen, Manager  
Organic Laboratory

Results FAXed 01/23/92

LEVINE-FRICKE

CLIENT ID: LF-15  
 CLIENT PROJ. ID: 1204  
 DATE SAMPLED: 01/20/92  
 DATE RECEIVED: 01/20/92  
 REPORT DATE: 01/28/92

QUANTEQ LAB NO: 9201136-01A  
 QUANTEQ JOB NO: 9201136  
 DATE ANALYZED: 01/22/92  
 INSTRUMENT: 12

EPA METHOD 8240 (WATER MATRIX)  
 GC/MS VOLATILE ORGANIC COMPOUNDS

COMPOUND	CAS #	CONCENTRATION (ug/L)	DETECTION LIMIT (ug/L)
Acetone	67-64-1	ND	100
Benzene	71-43-2	ND	5
Bromodichloromethane	75-27-4	ND	5
Bromoform	75-25-2	ND	5
Bromomethane	74-83-9	ND	10
2-Butanone	78-93-3	ND	100
Carbon Disulfide	75-15-0	ND	10
Carbon Tetrachloride	56-23-5	ND	5
Chlorobenzene	108-90-7	ND	5
Chloroethane	75-00-3	ND	10
2-Chloroethyl Vinyl Ether	110-75-8	ND	10
Chloroform	67-66-3	ND	5
Chloromethane	74-87-3	ND	10
Dibromochloromethane	124-48-1	ND	5
1,1-Dichloroethane	75-34-3	ND	5
1,2-Dichloroethane	107-06-2	ND	5
1,1-Dichloroethene	75-35-4	ND	5
cis-1,2-Dichloroethene	156-69-9	ND	5
trans-1,2-Dichloroethene	156-60-5	ND	5
1,2-Dichloropropane	78-87-5	ND	5
cis-1,3-Dichloropropene	10061-01-5	ND	5
trans-1,3-Dichloropropene	10061-02-6	ND	5
Ethylbenzene	100-41-4	ND	5
2-Hexanone	591-78-6	ND	50
Methylene Chloride	75-09-2	ND	5
4-Methyl-2-pentanone	108-10-1	ND	50
Styrene	100-42-5	ND	5
1,1,2,2-Tetrachloroethane	79-34-5	ND	5
Tetrachloroethene	127-18-4	ND	5
Toluene	108-88-3	ND	5
1,1,1-Trichloroethane	71-55-6	ND	5
1,1,2-Trichloroethane	79-00-5	ND	5
Trichloroethene	79-01-6	ND	5
Vinyl Acetate	108-05-4	ND	50
Vinyl Chloride	75-01-4	ND	10
Xylenes, total	1330-20-7	ND	10

ND = Not Detected

LEVINE-FRICKE

CLIENT ID: TRIP BLANK  
 CLIENT PROJ. ID: 1204  
 DATE SAMPLED: 01/17/92  
 DATE RECEIVED: 01/20/92  
 REPORT DATE: 01/28/92

QUANTEQ LAB NO: 9201136-02A  
 QUANTEQ JOB NO: 9201136  
 DATE ANALYZED: 01/22/92  
 INSTRUMENT: 12

EPA METHOD 8240 (WATER MATRIX)  
 GC/MS VOLATILE ORGANIC COMPOUNDS

COMPOUND	CAS #	CONCENTRATION (ug/L)	DETECTION LIMIT (ug/L)
Acetone	67-64-1	ND	100
Benzene	71-43-2	ND	5
Bromodichloromethane	75-27-4	ND	5
Bromoform	75-25-2	ND	5
Bromomethane	74-83-9	ND	10
2-Butanone	78-93-3	ND	100
Carbon Disulfide	75-15-0	ND	10
Carbon Tetrachloride	56-23-5	ND	5
Chlorobenzene	108-90-7	ND	5
Chloroethane	75-00-3	ND	10
2-Chloroethyl Vinyl Ether	110-75-8	ND	10
Chloroform	67-66-3	ND	5
Chloromethane	74-87-3	ND	10
Dibromochloromethane	124-48-1	ND	5
1,1-Dichloroethane	75-34-3	ND	5
1,2-Dichloroethane	107-06-2	ND	5
1,1-Dichloroethene	75-35-4	ND	5
cis-1,2-Dichloroethene	156-69-9	ND	5
trans-1,2-Dichloroethene	156-60-5	ND	5
1,2-Dichloropropane	78-87-5	ND	5
cis-1,3-Dichloropropene	10061-01-5	ND	5
trans-1,3-Dichloropropene	10061-02-6	ND	5
Ethylbenzene	100-41-4	ND	5
2-Hexanone	591-78-6	ND	50
Methylene Chloride	75-09-2	ND	5
4-Methyl-2-pentanone	108-10-1	ND	50
Styrene	100-42-5	ND	5
1,1,2,2-Tetrachloroethane	79-34-5	ND	5
Tetrachloroethene	127-18-4	ND	5
Toluene	108-88-3	ND	5
1,1,1-Trichloroethane	71-55-6	ND	5
1,1,2-Trichloroethane	79-00-5	ND	5
Trichloroethene	79-01-6	ND	5
Vinyl Acetate	108-05-4	ND	50
Vinyl Chloride	75-01-4	ND	10
Xylenes, total	1330-20-7	ND	10

ND = Not Detected



QUALITY CONTROL DATA

INSTRUMENT: 12

QUANTEQ JOB NO: 9201136

CLIENT PROJ. ID: 1204

SURROGATE STANDARD RECOVERY SUMMARY

METHOD 8240  
(WATER MATRIX)

---

SAMPLE IDENTIFICATION			SURROGATE RECOVERY (PERCENT)		
Date Analyzed	Client Id.	Lab No.	1,2-Dichloroethane-d <sub>4</sub>	Toluene-d <sub>8</sub>	p-Bromofluorobenzene
01/22/92	LF-15	01A	98.3	99.0	96.8
01/22/92	TRIP BLANK	02A	104.0	99.9	99.4

---

CURRENT QC LIMITS

<u>ANALYTE</u>	<u>PERCENT RECOVERY</u>
1,2-Dichloroethane-d <sub>4</sub>	(83-127)
Toluene-d <sub>8</sub>	(90-108)
p-Bromofluorobenzene	(91-109)

QUALITY CONTROL DATA

DATE ANALYZED: 01/22/92  
SAMPLE SPIKED: 9201156-02A  
INSTRUMENT: 12

QUANTEQ JOB NO: 9201136  
CLIENT PROJ. ID: 1204

MATRIX SPIKE RECOVERY SUMMARY

METHOD 8240  
(WATER MATRIX)

ANALYTE	Spike Conc. (ug/L)	Sample Result (ug/L)	MS Result (ug/L)	MSD Result (ug/L)	Average Percent Recovery	RPD
1,1-Dichloroethene	50.0	ND	52.7	56.2	108.9	6.4
Trichloroethene	50.0	ND	51.8	53.7	105.5	3.6
Benzene	50.0	ND	52.4	52.6	105.0	0.4
Toluene	50.0	ND	51.5	54.0	105.5	4.7
Chlorobenzene	50.0	ND	53.5	53.7	107.2	0.4

CURRENT QC LIMITS (Revised 08/13/91)

<u>Analyte</u>	<u>Percent Recovery</u>	<u>RPD</u>
1,1-Dichloroethene	(65-133)	13.5
Trichloroethene	(84-120)	8.7
Benzene	(84-121)	9.4
Toluene	(89-119)	8.4
Chlorobenzene	(83-116)	7.5

MS = Matrix Spike  
MSD = Matrix Spike Duplicate  
RPD = Relative Percent Difference  
ND = Not Detected

R-3, S-2

CHAIN OF CUSTODY / ANALYSES REQUEST FORM

9201134

Project No.: 1204			Field Logbook No.:			Date: 1-20-92		Serial No.: 10580			
Project Name: POLVAROSA - VILHINS <sup>TRIMINAL</sup>						Project Location: SAN LEANDRO					
Sampler (Signature): <i>Richard D. Oring</i>						ANALYSES			Samplers: POST		
SAMPLES						EPA 601	EPA 624	EPA 8240	HOLD	RUSH	REMARKS
SAMPLE NO.	DATE	TIME	LAB SAMPLE NO.	NO. OF CON-TAINERS	SAMPLE TYPE						
LF-15	1-20	1110	01AB	2	H <sub>2</sub> O			X			
TRIP BLANK	1-17	1430	02AB	2	"			X			
										NORMAL TAT	
										RESULTS TO:	
										JULIE SHARP	
										Samples used cal	
RELINQUISHED BY: (Signature) <i>Richard D. Oring</i>				DATE	TIME	RECEIVED BY: (Signature) <i>Kym Glava</i>				DATE	TIME
RELINQUISHED BY: (Signature) <i>Kym Glava</i>				DATE	TIME	RECEIVED BY: (Signature) <i>Julia Gillespie</i>				DATE	TIME
RELINQUISHED BY: (Signature)				DATE	TIME	RECEIVED BY: (Signature)				DATE	TIME
METHOD OF SHIPMENT:				DATE	TIME	LAB COMMENTS:					
Sample Collector: LEVINE-FRICKE 1900 Powell Street, 12th Floor Emeryville, Ca 94608 (415) 652-4500					Analytical Laboratory: <i>QUANTEQ</i>						

Oct. 1989 - Aug. 1993

MONTHLY DISCHARGE REPORT OF THE POLVOROSA BUSINESS PARK  
GROUNDWATER CLEAN-UP PROJECT

This letter and enclosed documents are to serve as the Polvorosa Business Park Groundwater Clean-up Projects' Monthly Discharge to the City of San Leandro for the reporting period of Start-Up to September 30, 1989.

This report is in compliance with Section 3-11-500 of the Uniform Wastewater Discharge Requirements and Part IV-A & B of our Discharge Permit #SD-008. The information in this report is accurate and complete. For any questions or comments in this report, contact me at 652-4500.  
Phone #

Number of days discharging: 60

Flow Volume: 24,957 U.S. Gallons (option #1)

                     Hours of pumping (option #2)

                     N/A (option 3)

Signature of Certifying Official: 

Printed Name of Official: Ted Splitter

Title: Principal, Levine-Fricke Date: October 11, 1989

Attached is our oil disposal log and a brief statement summarizing the months' operations.

Two 55 gallon drums of diesel oil will be removed from the site for recycling this week.

The system was shut down approximately 3 weeks after the reporting period due to modifications to the recovery system or due to the drums being full.

**MONTHLY DISCHARGE REPORT OF THE POLVOROSA BUSINESS PARK  
GROUNDWATER CLEAN-UP PROJECT**

This letter and enclosed documents are to serve as the Polvorosa Business Park Groundwater Clean-up Projects' Monthly Discharge to the City of San Leandro for the reporting period of OCTOBER 1, 1990 to JANUARY 31, 1990.

This report is in compliance with Section 3-11-500 of the Uniform Wastewater Discharge Requirements and Part IV-A & B of our Discharge Permit #SD-008. The information in this report is accurate and complete. For any questions or comments in this report, contact me at (415) 652-4500.

Phone #

Number of days discharging: 120

Flow Volume: 22,389 U.S. Gallons (option #1)  
                                 Hours of pumping (option #2)  
                                 N/A (option #3)

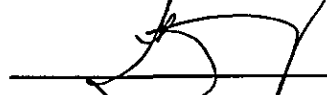
Signature of Certifying Official:  \_\_\_\_\_

Printed Name of Official: PENG LEONG

Title: PROJECT ENGINEER Date: FEBRUARY 28, 1990

Attached is our oil disposal log and a brief statement summarizing the months' operations.

\* CURRENT READING = 035879 ✓  
PREVIOUS READING = 018918 ←

$$\begin{aligned} \text{FLOW VOLUME} &= (35879 - 18918) \times 1.32 \\ &= 22.389 \text{ U.S. GALLONS} \end{aligned}$$

MONTHLY DISCHARGE REPORT OF THE POLVOROSA BUSINESS PARK  
GROUNDWATER CLEAN-UP PROJECT

This letter and enclosed documents are to serve as the Polvorosa Business Park Groundwater Clean-up Projects' Monthly Discharge to the City of San Leandro for the reporting period of January 31, 1990 to June 15, 1990.

This report is in compliance with Section 3-11-500 of the Uniform Wastewater Discharge Requirements and Part IV-A & B of our Discharge Permit #SD-008. The information in this report is accurate and complete. For any questions or comments in this report, contact me at (415) 652-4500 (X 564).  
Phone # \_\_\_\_\_

Number of days discharging: 135

Flow Volume: 69,232.7 U.S. Gallons (option #1)  
                    \_\_\_\_\_ Hours of pumping (option #2)  
                    \_\_\_\_\_ N/A (option #3)

Signature of Certifying Official: 

Printed Name of Official: Victor Kong

Title: Staff Engineer Date: June 15, 1990

Attached is our oil disposal log and a brief statement summarizing the months' operations.

\*Current Reading = 088328  
Previous Reading = 035879

Flow Volume =  $88328 - 35879 \times 1.32$   
= 69232.7 U.S. Gallons

**MONTHLY DISCHARGE REPORT OF THE POLVOROSA BUSINESS PARK**  
**GROUNDWATER CLEAN-UP PROJECT**

This letter and enclosed documents are to serve as the Polvorosa Business Park Groundwater Clean-up Projects' Monthly Discharge to the City of San Leandro for the reporting period of June 16, 1990 to August 29, 1990.

This report is in compliance with Section 3-11-500 of the Uniform Wastewater Discharge Requirements and Part IV-A & B of our Discharge Permit #SD-008. The information in this report is accurate and complete. For any questions or comments in this report, contact me at 415-652-4500.  
Phone #

Number of days discharging: 75

Flow Volume: 68599.1 U.S. Gallons (option #1)  
                                 Hours of pumping (option #2)  
                                 N/A (option #3)

Signature of Certifying Official: 

Printed Name of Official: Victor Kong

Title: Staff Engineer Date: August, 29, 1990

Attached is our oil disposal log and a brief statement summarizing the months' operations.

\*Current Reading= 140297  
Previous Reading= 088328

Flow Volume = 14029 - 088328  $\times$  1.32  
= 68599.1 U.S. Gallons





**MONTHLY DISCHARGE REPORT OF THE POLVOROSA BUSINESS PARK**  
**GROUNDWATER CLEAN-UP PROJECT**

This letter and enclosed documents are to serve as the Polvorosa Business Park Groundwater Clean-up Projects' Monthly Discharge to the City of San Leandro for the reporting period of Nov. 2, 1990 to Dec. 13, 1990.

This report is in compliance with Section 3-11-500 of the Uniform Wastewater Discharge Requirements and Part IV-A & B of our Discharge Permit #SD-008. The information in this report is accurate and complete. For any questions or comments in this report, contact me at (415) 654-4500.  
 Phone #

Number of days discharging: 41

Flow Volume: 34871.76 U.S. Gallons (option #1)

                         Hours of pumping (option #2)

                         N/A (option #3)

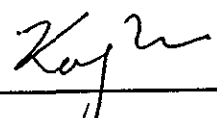
Signature of Certifying Official: 

Printed Name of Official: Victor Kong

Title: Staff Engineer Date: Dec. 13, 1990

Attached is our oil disposal log and a brief statement summarizing the months' operations.

\*Current Reading = 196350  
 Previous Reading = 169932  
 Flow Volume = (196350-169932) x 1.32  
 = 34871.76

**MONTHLY DISCHARGE REPORT OF THE POLVOROSA BUSINESS PARK  
GROUNDWATER CLEAN-UP PROJECT**

This letter and enclosed documents are to serve as the Polvorosa Business Park Groundwater Clean-up Projects' Monthly Discharge to the City of San Leandro for the reporting period of DECEMBER 13, 1990 to JANUARY 14, 1991.

This report is in compliance with Section 3-11-500 of the Uniform Wastewater Discharge Requirements and Part IV-A & B of our Discharge Permit #SD-008. The information in this report is accurate and complete. For any questions or comments in this report, contact me at (415) 652-4500.  
Phone #

Number of days discharging: 32

Flow Volume: 18243.72 U.S. Gallons (option #1)  
   Hours of pumping (option #2)  
   N/A (option #3)

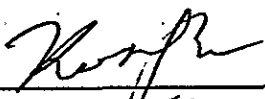
Signature of Certifying Official:   
Printed Name of Official: Victor KONG  
Title: STAFF ENGINEER Date: JANUARY 14, 1991

Attached is our oil disposal log and a brief statement summarizing the months' operations.

CURRENT READING = 210171  
PREVIOUS READING = 196350  
FLOW VOLUME = (210171-196350) X 1.3  
= 18243.72

MONTHLY DISCHARGE REPORT OF THE POLVOROSA BUSINESS PARK  
GROUNDWATER CLEAN-UP PROJECT

This letter and enclosed documents are to serve as the Polvorosa Business Park Groundwater Clean-up Projects' Monthly Discharge to the City of San Leandro for the reporting period of JANUARY 14, 1991 to APRIL 30, 1991.

This report is in compliance with Section 3-11-500 of the Uniform Wastewater Discharge Requirements and Part IV-A & B of our Discharge Permit #SD-008. The information in this report is accurate and complete. For any questions or comments in this report, contact me at (415) 652-4500.  
Phone #

Number of days discharging: 106

Flow Volume: 83870.2 U.S. Gallons (option #1)  
   Hours of pumping (option #2)  
   N/A (option #3)

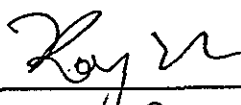
Signature of Certifying Official:   
Printed Name of Official: Victor KONG

Title: Senior Staff Engineer Date: April 30, 1991

Attached is our oil disposal log and a brief statement summarizing the months' operations.

CURRENT READING = 273709  
PREVIOUS READING = 210171  
FLOW VOLUME = (273709-210171)x1.32  
= 83870.2





MONTHLY DISCHARGE REPORT OF THE POLVOROSA BUSINESS PARK  
GROUNDWATER CLEAN-UP PROJECT

This letter and enclosed documents are to serve as the Polvorosa Business Park Groundwater Clean-up Projects' Monthly Discharge to the City of San Leandro for the reporting period of February 12, 1992 to May 1, 1992.

This report is in compliance with Section 3-11-500 of the Uniform Wastewater Discharge Requirements and Part IV-A & B of our Discharge Permit #SD-008. The information in this report is accurate and complete. For any questions or comments in this report, contact me at (415) 652-4500.  
Phone #

Number of days discharging: 44

Flow Volume: 100001.88 U.S. Gallons (option #1)

                     Hours of pumping (option #2)

                     N/A (option #3)

Signature of Certifying Official: 

Printed Name of Official: Victor Kong

Title: Senior Staff Engineer

Date: May 6, 1992

Attached is our oil disposal log and a brief statement summarizing the months' operations.

CURRENT READING = 545472

PREVIOUS READING = 469713

FLOW VOLUME =  $(545472 - 469713) \times 1.32 = 100001.88$

## Discharge Report of the Product Recovery System

Polvorosa Business Park  
Davis Street, San Leandro

Project No. 1204

Date	Time	Initial	Gallon	Flow Rate Overall (gpm)	Comments
5/1	1300	GLW	2981		
5/4	1300	GLW	5089		
5/8	1315	GLW	7739		
5/11	1400	GLW	8487		
5/15	1325	GLW	8491		
5/18	1306	GLW	8517		CLEANED METER FILTER
5/22	1020	GLW	11454		
5/27	1600	GLW	15405		
5/29	1400	GLW	16649		
5/29 TOTAL - 5/1 TOTAL =			13,668		

**Comments:**

5/1 - Sulfates (W.S.) after installation of flow meter

MONTHLY DISCHARGE REPORT OF THE POLVOROSA BUSINESS PARK  
GROUNDWATER CLEAN-UP PROJECT

This letter and enclosed documents are to serve as the Polvorosa Business Park Groundwater Clean-up Projects' Monthly Discharge to the City of San Leandro for the reporting period of May 1, 1992 to May 29, 1992.

This report is in compliance with Section 3-11-500 of the Uniform Wastewater Discharge Requirements and Part IV-A & B of our Discharge Permit #SD-008. The information in this report is accurate and complete. For any questions or comments in this report, contact me at (510) 652-4500.  
Phone #

Number of days discharging: 29

Flow Volume: 13,668 U.S. Gallons (option #1)

                     Hours of pumping (option #2)

                     N/A (option #3)

Signature of Certifying Official: Michael Stoll

Printed Name of Official: Michael Stoll

Title: Senior Staff Engineer Date: June 9, 1992

Attached is our oil disposal log and a brief statement summarizing the months' operations.





MONTHLY DISCHARGE REPORT OF THE POLVOROSA BUSINESS PARK  
GROUNDWATER CLEAN-UP PROJECT

This letter and enclosed documents are to serve as the Polvorosa Business Park Groundwater Clean-up Project's monthly discharge report to the City of San Leandro for the reporting period of May 29, 1992 to June 29, 1992.

This report is in compliance with Section 3-11-500 of the Uniform Wastewater Discharge Requirements and Part IV-A of our Discharge Permit #SD-008. The information in this report is accurate and complete. For any questions or comments in this report, contact me at (510) 652-4500.  
Phone #

Number of days discharging: 30  
Previous meter reading: 16,649 (Date: 5-29-92 )  
Current meter reading: 37,319 (Date: 6-29-92 )  
Flow Volume: 20,670 U.S. Gallons

Brief statement summarizing the month's operations (include operational changes and problems encountered) \_\_\_\_\_

System operated without incident during reporting period. Pump  
output was 0.6 gallons per stroke on June 5, 1992.

A petroleum product disposal log is attached.  yes  no

The groundwater clean-up project did not recover enough petroleum products to be disposed off during this reporting period.  yes  no

Signature of Certifying Official: Michael Stoll  
Printed Name of Official: Michael Stoll  
Title: Senior Staff Engineer Date: July 7, 1992

## Discharge Report of the Product Recovery System

Polvorosa Business Park  
Davis Street, San Leandro

Project No. 1204

Date	Time	Initial	Gallon	Flow Rate Overall (gpm)	Comments
7-2	1015	GW	39220		1 liter =
7-6	0930	GW	41591		140 <del>00</del> <sup>4.2L</sup> PRODUCT REMOVED
7-10	1330	GW	44025		3.6 L PRODUCT COLLECTED
7-13	1600	GW	45863		2.0 L PRODUCT COLLECTED
7-17	1300	GW	48121		2.0 L PRODUCT COLLECTED
7-20	0900	GW			2.4 L PRODUCT COLLECTED
7-24	1330	GW	50574		2.6 L " "
7-29	1415	GW	50574		3.6 L " "

**Comments :**

7-6 INSTALLED VALVE TO MEASURE PRODUCT COMING OUT OF SKIMMER

7-20 CHANGED OIL IN COMPRESSOR, AIR FILTER, GREASED MOTOR.

7-30 REMOVED AND CLEANED FLOW METER.

MONTHLY DISCHARGE REPORT OF THE POLVOROSA BUSINESS PARK  
GROUNDWATER CLEAN-UP PROJECT

This letter and enclosed documents are to serve as the Polvorosa Business Park Groundwater Clean-up Project's monthly discharge report to the City of San Leandro for the reporting period of June 30, 1992 to July 31, 1992.

This report is in compliance with Section 3-11-500 of the Uniform Wastewater Discharge Requirements and Part IV-A of our Discharge Permit #SD-008. The information in this report is accurate and complete. For any questions or comments in this report, contact me at (510) 652-4500.  
Phone #

Number of days discharging: 33  
Previous meter reading: 37,319 (Date: 6-29-92 )  
Current meter reading: 50,574 (Date: 7-31-92 )  
Flow Volume: 13,255 U.S. Gallons

Brief statement summarizing the month's operations (include operational changes and problems encountered) \_\_\_\_\_  
\_\_\_\_\_  
\_\_\_\_\_

A petroleum product disposal log is attached.  yes  no

The groundwater clean-up project did not recover enough petroleum products to be disposed off during this reporting period.  yes  no

Signature of Certifying Official: \_\_\_\_\_

Printed Name of Official: \_\_\_\_\_

Victor Kong

Title: Senior Staff Engineer

Date: July 31, 1992

## Discharge Report of the Product Recovery System

Polvorosa Business Park  
Davis Street, San Leandro

Project No. 1204

Date	Time	Initial	Gallon	Volume of Product Removed (Liters)	Comments
8/4	1400	GW	50574	4.8	
8/7	1415	GW	50574	2.0	
8/11	1400	GW	50574	3.3	
8/14	1330	GW	51725	2.4	
8/17	1130	GW	52952	2.0	
8/21	1345	GW	54605	2.6	
8/24	1305	GW	55727	2.3	
8/28	1245	GW	57210	3.5	
8/31	1320	GW	58319	3.2	
				<u>26.1</u>	

**Comments :**

8/11 REMOVED AND CLEANED FLOW METER, ALSO SPOKE TO CLEAN ENVIRONMENTAL RE: FILTER CHAMBER FOR FLOW METER.  
8/31 INSTALLED NEW PRE-FILTER TO PROTECT FLOW METER AND CLEANED FLOW METER.

MONTHLY DISCHARGE REPORT OF THE POLVOROSA BUSINESS PARK  
GROUNDWATER CLEAN-UP PROJECT

This letter and enclosed documents are to serve as the Polvorosa Business Park Groundwater Clean-up Project's monthly discharge report to the City of San Leandro for the reporting period of July 31, 1992 to Aug. 31, 1992.

This report is in compliance with Section 3-11-500 of the Uniform Wastewater Discharge Requirements and Part IV-A of our Discharge Permit #SD-008. The information in this report is accurate and complete. For any questions or comments in this report, contact me at (510) 652-4500.  
Phone #

Number of days discharging: 31  
Previous meter reading: 50,574 (Date: 7-31-92 )  
Current meter reading: 58,319 (Date: 8-31-92 )  
Flow Volume: 7,745 U.S. Gallons

Brief statement summarizing the month's operations (include operational changes and problems encountered) \_\_\_\_\_  
\_\_\_\_\_  
\_\_\_\_\_

A petroleum product disposal log is attached.  yes  no

The groundwater clean-up project did not recover enough petroleum products to be disposed off during this reporting period.  yes  no

Signature of Certifying Official: \_\_\_\_\_

Printed Name of Official: Victor Kong

Title: Senior Staff Engineer Date: Sept. 2, 1992

**Discharge Report of the Product Recovery System**

Polvorosa Business Park  
Davis Street, San Leandro  
Project No. 1204

Date	Time	Initial	Gallon	Volume of Product Removed (Liters)	Comments
9/8	1310	GW	61157	4.5	
9/14	1400	GW	63911	3.0	
9/24	0815	SAT	67465	9.2	
9/28	1320	GW	69270	1.6	
			Total	18.3	

**Comments :**

9/28 CLEANED METER PRE-FILTER

MONTHLY DISCHARGE REPORT OF THE POLVOROSA BUSINESS PARK  
GROUNDWATER CLEAN-UP PROJECT

This letter and enclosed documents are to serve as the Polvorosa Business Park Groundwater Clean-up Project's monthly discharge report to the City of San Leandro for the reporting period of August 31, 1992 to September 28, 1992.

This report is in compliance with Section 3-11-500 of the Uniform Wastewater Discharge Requirements and Part IV-A of our Discharge Permit #SD-008. The information in this report is accurate and complete. For any questions or comments in this report, contact me at (510) 652-4500.  
Phone #

Number of days discharging: 28  
Previous meter reading: 58,319 (Date: 8/31/92 )  
Current meter reading: 69,270 (Date: 9/28/92 )  
Flow Volume: 10,951 U.S. Gallons

Brief statement summarizing the month's operations (include operational changes and problems encountered) \_\_\_\_\_  
\_\_\_\_\_  
\_\_\_\_\_

A petroleum product disposal log is attached.  yes  no

The groundwater clean-up project did not recover enough petroleum products to be disposed off during this reporting period.  yes  no

Signature of Certifying Official: \_\_\_\_\_

Printed Name of Official: Victor Kong

Title: Senior Staff Engineer Date: October 5, 1992



## Discharge Report of the Product Recovery System

Polvorosa Business Park  
Davis Street, San Leandro

Project No. 1204

Date	Time	Initial	Gallon	Volume of Product Removed (Liters)	Comments
10/2	13:00	GW	70528	2.0	
10/5	08:00	GW	71404	2.0	
10/9	14:30	GW	72685	2.3	
10/13	09:30	GW	73694	2.0	
10/16	07:15	GW	74369	3.2	
10/19	15:10	GW	75203	2.4	CLEANED FLOW METER FILTER SCREEN
10/23	13:00	GW	76176	2.0	
10/26	11:00	GW	76743		SEE AC.
10/27	16:00	GW	76947	3.5	PRODUCT REMOVED INCLUDES PRODUCT HAND BAILED FROM LF-12
10/28	07:30	GW	76963	SEE AC. RE. LOW FLOW RATE	CLEANED FLOW METER FILTER SCREEN
10/30	10:00	GW	77711	1.2	

Comments:

44411      20.6

10/26 MEASURED PRODUCT THICKNESS IN WELL LF-12 AND MW-3. BEGAN CLEANING EXTRACTION PUMP.

10/27 CONTINUED CLEANING EXTRACTION PUMP AND EFF. HOSE. DURING INSTALLATION OF PUMP, SCALE HAD BROKE FREE FROM THE INSIDE OF THE HOSE AND PLUGGED THE HOSE. AFTER REMOVING MOST OF THE SCALE THE HOSE WAS THEN FLUSHED. BECAUSE OF THE LOW WATER LEVEL THE FILL TIME ON THE PUMP WAS INCREASED FROM 1 MIN TO 3 MIN.

10/28 FOUND COMPRESSOR OFF LINE, RESET AND RESTARTED IT. BY THE SOUND COMING FROM THE UNIT WHEN RUNNING IT MAY HAVE A BEARING GOING OUT.

10/30 DECREASED FILL TIME TO 2.5 MIN. BLOCKED OFF BUBBLER TUBE.

MONTHLY DISCHARGE REPORT OF THE POLVOROSA BUSINESS PARK  
GROUNDWATER CLEAN-UP PROJECT

This letter and enclosed documents are to serve as the Polvorosa Business Park Groundwater Clean-up Project's monthly discharge report to the City of San Leandro for the reporting period of September 28, 92 to October 30, 92.

This report is in compliance with Section 3-11-500 of the Uniform Wastewater Discharge Requirements and Part IV-A of our Discharge Permit #SD-008. The information in this report is accurate and complete. For any questions or comments in this report, contact me at (510) 652-4500 Phone #

Number of days discharging: 33  
Previous meter reading: 69,270 (Date: 9/28/92 )  
Current meter reading: 77,711 (Date: 10/30/92 )  
Flow Volume: 8,441 U.S. Gallons

Brief statement summarizing the month's operations (include operational changes and problems encountered) \_\_\_\_\_  
\_\_\_\_\_  
\_\_\_\_\_

A petroleum product disposal log is attached.  yes  no

The groundwater clean-up project did not recover enough petroleum products to be disposed off during this reporting period.  yes  no

Signature of Certifying Official: \_\_\_\_\_

Printed Name of Official: Victor Kong

Title: Senior Staff Engineer Date: November 7, 1992

## Discharge Report of the Product Recovery System

Polvorosa Business Park  
Davis Street, San Leandro

Project No. 1204

Date	Time	Initial	Gallon	Volume of Product Removed (Liters)	Comments
11/3	13:30	GW	83902	1.4	AUG. FLOW RATE 1.03 GPM ↓
11/6	12:20	GW	84859	2.3	
11/9	14:55	GW	85874	1.6	
11/13	11:45	GW	87132	1.0	
11/17	08:15	GW	88300	2.4	
11/23	14:40	GW	89945	1.8	
				10.5	

**Comments :**

11/3 LOWERED FILL TIME TO 2 MIN AND UNBLOCKED BUBBLER TUBE. LEFT EMPTY TIME @ 6 SEC.

11/6 CLEANED METER FILTER SCREEN

11/9 INCREASED EMPTY TIME FROM 6 TO 7 SEC.

11/17 DECREASED FILL TIME FROM 2 MIN. TO 1.5 MIN.

11/23 DECREASED FILL TIME ON PUMP, FROM 1.5 MIN TO 1 MIN.

MONTHLY DISCHARGE REPORT OF THE POLVOROSA BUSINESS PARK  
GROUNDWATER CLEAN-UP PROJECT

This letter and enclosed documents are to serve as the Polvorosa Business Park Groundwater Clean-up Project's monthly discharge report to the City of San Leandro for the reporting period of Oct. 30, 1992 to Nov. 23, 1992.

This report is in compliance with Section 3-11-500 of the Uniform Wastewater Discharge Requirements and Part IV-A of our Discharge Permit #SD-008. The information in this report is accurate and complete. For any questions or comments in this report, contact me at (510)652-4500.  
Phone #

Number of days discharging: 24  
Previous meter reading: 77,711 (Date: 10/30/92)  
Current meter reading: 89,945 (Date: 11/23/92)  
Flow Volume: 12,234 U.S. Gallons

Brief statement summarizing the month's operations (include operational changes and problems encountered) \_\_\_\_\_  
\_\_\_\_\_  
\_\_\_\_\_

A petroleum product disposal log is attached.  yes  no

The groundwater clean-up project did not recover enough petroleum products to be disposed off during this reporting period.  yes  no

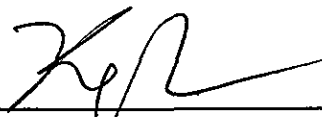
Signature of Certifying Official: 

Printed Name of Official: Victor Kong

Title: Senior Staff Engineer Date: December 7, 1992

## Discharge Report of the Product Recovery System

Polvorosa Business Park  
Davis Street, San Leandro

Project No. 1204

Date	Time	Initial	Gallon	Volume of Product Removed (Liters)	Comments
12/2	08:40	GW	92383	2.3	
12/4	14:00	GW	93094	.9	
12/7	14:00	GW	94044	.8	
12/11	13:45	GW	95145	.8	
12/15	09:10	GW	95957	1.0	
12/18	07:00	GW	96458	.5	
12/22	07:00	GW	96925	.5	
12/28	14:00	GW	96929	.1	
				6.9	

**Comments :**

12/11 CHANGED FILL TIME BACK TO 2 MIN.  
 12/28 CLEANED FLOW METER FILTER SCREEN  
 12/29 TOOK APART FLOW METER, ONE OF THE GEARS IS JAMMED.  
 DROPPED OFF FLOW METER @ CLEAN ENVIRONMENTAL  
 12/31 PICKED UP REPAIRED FLOW METER AND RE-INSTALLED IT.

MONTHLY DISCHARGE REPORT OF THE POLVOROSA BUSINESS PARK  
GROUNDWATER CLEAN-UP PROJECT

This letter and enclosed documents are to serve as the Polvorosa Business Park Groundwater Clean-up Project's monthly discharge report to the City of San Leandro for the reporting period of November 23, 1992 to December 28, 1992

This report is in compliance with Section 3-11-500 of the Uniform Wastewater Discharge Requirements and Part IV-A of our Discharge Permit #SD-008. The information in this report is accurate and complete. For any questions or comments in this report, contact me at (510) 652-4500.  
Phone #

Number of days discharging: 35  
Previous meter reading: 89945 (Date: 11/23/92 )  
Current meter reading: 96929 (Date: 12/28/92 )  
Flow Volume: 6984 U.S. Gallons

Brief statement summarizing the month's operations (include operational changes and problems encountered) \_\_\_\_\_  
\_\_\_\_\_  
\_\_\_\_\_

A petroleum product disposal log is attached.  yes  no

The groundwater clean-up project did not recover enough petroleum products to be disposed off during this reporting period.  yes  no

Signature of Certifying Official: \_\_\_\_\_

Printed Name of Official: \_\_\_\_\_

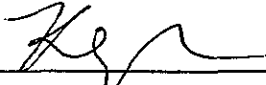
  
Victor Kong

Title: Senior Staff Engineer

Date: January 5, 1993

## Discharge Report of the Product Recovery System

Polvorosa Business Park  
Davis Street, San Leandro  
Project No. 1204

Date	Time	Initial	Gallon	Volume of Product Removed (Liters)	Comments
2/18	10:45	GDW	9863		
2/19	1300	GDW	9865		
2/23	0950	GDW	10926	.8	
2/26	1320	GDW	11946	0	

**Comments :**

2/9 - CLEANED FLOW METER FILTER, CLEANED BACTERIA OFF TOP OF OIL WATER SEPARATOR, STARTED SYSTEM AND FOUND FLOW METER NOT WORKING.

2/10 - REMOVED FLOW METER, CLEANED IT AND THE METER IS STILL NOT WORKING, DROPPED OFF METER @ CLEAN ENVIRONMENTAL

2-17 PICKED UP REPAIRED FLOW METER

2-18 INSTALLED METER

2-19 FLOW METER FILTER WAS PLUGGED

2-25 COLLECTED PUT OFF WITH THE CITY OF SAN LEANDRO

MONTHLY DISCHARGE REPORT OF THE POLVOROSA BUSINESS PARK  
GROUNDWATER CLEAN-UP PROJECT

This letter and enclosed documents are to serve as the Polvorosa Business Park Groundwater Clean-up Project's monthly discharge report to the City of San Leandro for the reporting period of January 29, 1993 to February 26, 1993.

This report is in compliance with Section 3-11-500 of the Uniform Wastewater Discharge Requirements and Part IV-A of our Discharge Permit #SD-008. The information in this report is accurate and complete. For any questions or comments in this report, contact me at (510)652-4500.

Phone #

Number of days discharging: 18  
Previous meter reading: 9,861 (Date: 1/29/93 )  
Current meter reading: 11,946 (Date: 2/26/93 )  
Flow Volume: 2,085 U.S. Gallons

Brief statement summarizing the month's operations (include operational changes and problems encountered) On 1/29/93 the system was shut down. It was not

operational(on line) again until 2/09/93. Flow meter was being repaired

from 2/10/93 until 2/18/93. On 2/25/93 split water samples were collected

with the City of San Leandro.

A petroleum product disposal log is attached.  yes  no

The groundwater clean-up project did not recover enough petroleum products to be disposed off during this reporting period.  yes  no

Signature of Certifying Official: Michael Stoll

Printed Name of Official: Michael Stoll

Title: Project Engineer Date: March 10, 1993



MONTHLY DISCHARGE REPORT OF THE POLVOROSA BUSINESS PARK  
GROUNDWATER CLEAN-UP PROJECT

This letter and enclosed documents are to serve as the Polvorosa Business Park Groundwater Clean-up Project's monthly discharge report to the City of San Leandro for the reporting period of February 26, 1993 to March 31, 1993.

This report is in compliance with Section 3-11-500 of the Uniform Wastewater Discharge Requirements and Part IV-A of our Discharge Permit #SD-008. The information in this report is accurate and complete. For any questions or comments in this report, contact me at (510) 652-4500.

Phone #

Number of days discharging: 33  
Previous meter reading: 11,946 (Date: 2/26/93 )  
Current meter reading: 16,628 (Date: 3/31/93 )  
Flow Volume: 4,682 U.S. Gallons

Brief statement summarizing the month's operations (include operational changes and problems encountered) Started up system, running new pump only. Perged a great deal of silt out of it. Cleaned flow meter. Measured product level in wells.

A petroleum product disposal log is attached.  yes  no

The groundwater clean-up project did not recover enough petroleum products to be disposed off during this reporting period.  yes  no

Signature of Certifying Official: 

Printed Name of Official: Ted Splitter

Title: Principal Geotechnical Engineer Date: April 7, 1993

MONTHLY DISCHARGE REPORT OF THE POLVOROSA BUSINESS PARK  
GROUNDWATER CLEAN-UP PROJECT

This letter and enclosed documents are to serve as the Polvorosa Business Park Groundwater Clean-up Project's monthly discharge report to the City of San Leandro for the reporting period of April 1, 1993 to April 30, 1993.

This report is in compliance with Section 3-11-500 of the Uniform Wastewater Discharge Requirements and Part IV-A of our Discharge Permit #SD-008. The information in this report is accurate and complete. For any questions or comments in this report, contact me at (510) 652-4500.  
Phone #

Number of days discharging: 0  
Previous meter reading: 16,628 (Date: 3/31/93 )  
Current meter reading: 16,628 (Date: 4/30/93 )  
Flow Volume: 0 U.S. Gallons

Brief statement summarizing the month's operations (include operational changes and problems encountered) \_\_\_\_\_

The system has been off-line for the month of April, 1993.

A petroleum product disposal log is attached.  yes  no

The groundwater clean-up project did not recover enough petroleum products to be disposed off during this reporting period.  yes  no

Signature of Certifying Official: Michael Stoll

Printed Name of Official: Michael Stoll

Title: Project Engineer Date: May 26, 1993

MONTHLY DISCHARGE REPORT OF THE POLVOROSA BUSINESS PARK  
GROUNDWATER CLEAN-UP PROJECT

This letter and enclosed documents are to serve as the Polvorosa Business Park Groundwater Clean-up Project's monthly discharge report to the City of San Leandro for the reporting period of May 1, 1993 to May 31, 1993.

This report is in compliance with Section 3-11-500 of the Uniform Wastewater Discharge Requirements and Part IV-A of our Discharge Permit #SD-008. The information in this report is accurate and complete. For any questions or comments in this report, contact me at (510) 652-4500.  
Phone #

Number of days discharging: 0  
Previous meter reading: 16,628 (Date: 4/30/93 )  
Current meter reading: 16,628 (Date: 5/31/93 )  
Flow Volume: 0 U.S. Gallons

Brief statement summarizing the month's operations (include operational changes and problems encountered) \_\_\_\_\_

The system has been off-line for the month of May, 1993.

A petroleum product disposal log is attached.     yes   X   no

The groundwater clean-up project did not recover enough petroleum products to be disposed off during this reporting period.   X   yes     no

Signature of Certifying Official: Michael Stoll

Printed Name of Official: Michael Stoll

Title: Project Engineer Date: June 9, 1993

MONTHLY DISCHARGE REPORT OF THE POLVOROSA BUSINESS PARK  
GROUNDWATER CLEAN-UP PROJECT

This letter and enclosed documents are to serve as the Polvorosa Business Park Groundwater Clean-up Project's monthly discharge report to the City of San Leandro for the reporting period of June 1, 1993 to June 30, 1993.

This report is in compliance with Section 3-11-500 of the Uniform Wastewater Discharge Requirements and Part IV-A of our Discharge Permit #SD-008. The information in this report is accurate and complete. For any questions or comments in this report, contact me at (510)652-4500.  
Phone #

Number of days discharging: 0  
Previous meter reading: 16,628 (Date: 5/31/93 )  
Current meter reading: 16,628 (Date: 6/30/93 )  
Flow Volume: 0 U.S. Gallons

Brief statement summarizing the month's operations (include operational changes and problems encountered) \_\_\_\_\_

The system has been off-line for the month of June, 1993.

A petroleum product disposal log is attached.  yes  no

The groundwater clean-up project did not recover enough petroleum products to be disposed off during this reporting period.  yes  no

Signature of Certifying Official: Michael Stoll

Printed Name of Official: Michael Stoll

Title: Project Engineer Date: July 7, 1993

MONTHLY DISCHARGE REPORT OF THE POLVOROSA BUSINESS PARK  
GROUNDWATER CLEAN-UP PROJECT

This letter and enclosed documents are to serve as the Polvorosa Business Park Groundwater Clean-up Project's monthly discharge report to the City of San Leandro for the reporting period of July 1, 1993 to July 31, 1993.

This report is in compliance with Section 3-11-500 of the Uniform Wastewater Discharge Requirements and Part IV-A of our Discharge Permit #SD-008. The information in this report is accurate and complete. For any questions or comments in this report, contact me at (510)652-4500.  
Phone #

Number of days discharging: 0  
Previous meter reading: 16,628 (Date: 6/30/93 )  
Current meter reading: 16,628 (Date: 7/31/93 )  
Flow Volume: 0 U.S. Gallons

Brief statement summarizing the month's operations (include operational changes and problems encountered) \_\_\_\_\_

The system has been off-line for the month of July, 1993.

A petroleum product disposal log is attached.  yes  no

The groundwater clean-up project did not recover enough petroleum products to be disposed off during this reporting period.  yes  no

Signature of Certifying Official: 

Printed Name of Official: Michael Stoll

Title: Project Engineer Date: August 2, 1993