

#607



June 5, 1995

**Chevron U.S.A. Products Company**  
6001 Bollinger Canyon Rd., Bldg. L  
P.O. Box 5004  
San Ramon, CA 94583-0804

**Site Assessment & Remediation Group**  
Phone (510) 842-9500

Mr. Barney Chan  
Alameda County Health Care Services  
Department of Environmental Health  
1131 Harbor Bay Parkway, Suite 250  
Alameda, CA 94502-6577

**Re: Former Signal Bulk Plant  
2001 Versailles Avenue, Alameda, CA**

Dear Mr. Chan:

Thank you for your letter of May 1, 1995, approving the Touchstone Developments (TD) work plan of March 13, 1995 pertaining to the above referenced site. Several insightful observations were made regarding information gathered during previous investigations and whether our proposed work would duplicate those efforts. Enclosed is a letter from TD dated May 19, 1995, responding to those concerns. The letter also clarifies the recommended sampling frequency for drill cuttings and the six potential source areas.

I would like to take this opportunity to directly address the last four concerns expressed in your letter.

1. It is unknown if any hazardous waste or unidentified waste materials are being stored at the site as Chevron has not had any physical involvement with the site since 1967. We will ask TD to inventory any drums or waste materials at the site during upcoming assessment activities. If any are present, a list will be compiled and presented to the property owner for proper handling. To Chevron's knowledge, the 1000 gallon underground tank found during the Kleinfelder investigation still exists at the site and will be removed during excavation activities.
2. We will ask TD to verify the number, location, and condition of ground water monitor wells present at the site during upcoming assessment activities. Following these activities, a quarterly monitoring program will begin if feasible. As you know, Chevron is eager to move forward with remediation activities in a timely fashion. Should remediation activities require the abandonment of on site wells, the value in monitoring and sampling remaining wells will be evaluated.
3. Our current plans are to begin remediation work at the site once results of the proposed investigation are obtained. While subject to change, we anticipate beginning remediation during July, 1995.

We will instruct TD to notify your office 48 hours in advance of all field work.

Please feel free to contact me at (510) 842-8134 should you have any questions or comments.

81:214 6-10-95  
7/12/95

Page 2  
June 5, 1995  
Former Signal Bulk Plant

Sincerely,  
CHEVRON U.S.A. PRODUCTS COMPANY



Mark A. Miller  
Site Assessment and Remediation Engineer

Enclosure

cc: Ms. B.C. Owen

Mr. Clifford Mapes  
14 Grass Valley Court  
Oakland, CA 94605

Exxon Company, U.S.A.  
Marketing Department  
Attn.: Distribution Manager  
800 Bell Street, Suite 2845  
Houston, TX 77002

Mr. William J. Stack  
Exxon Company, U.S.A.  
800 Bell Street, Suite 4137  
Houston, TX 77002



**Touchstone  
Developments**  
Environmental Management

May 19, 1995

Mr. Mark Miller  
Chevron  
P.O. Box 5004  
San Ramon, CA 94583

Subject: Alameda County Comments to Drilling Workplan  
Alameda Bulk Plant, 2001 Versailles Avenue, Alameda

Dear Mark:

I have reviewed the May 1, 1995 letter sent to you by Mr. Barney Chan of the Alameda County Health Care Services Agency (ACHCSA) regarding the further site investigation at the former Alameda Bulk Plant. We would like to complement ACHCSA on the thoroughness of their review and their familiarity with this complicated site. Please allow me to respond to some of Mr. Chan's comments.

Item 1 Mr. Chan mentioned that Method 8010 need not be run on samples collected from Boring Number 2 (Figure 1), stating that solvents were not detected in Kleinfelder Trench Sample 47708-11. We are pleased to hear that ACHCSA is not concerned about solvents in this area. Please note, however, that sample 47708-11 is approximately 45 feet north of proposed Boring Number 2. The rigorous sampling proposed for this boring is to exclude the western portion of the site from any active remediation. We recommend that Chevron collect the most complete data at this point to avoid any ambiguity.

Item 2. Mr. Chan noted that Boring Number 6 is near Kleinfelder Trench 8, sample 47703. Boring Number 6 is proposed to characterize manifold lines (shallow contamination). The Method 8270 result redundancy that Mr. Chan refers to is from a sample collected at 7 feet below grade surface (bgs). We propose to collect one sample at 2.5 feet bgs and one at the water interface. If EPA Method 8270 results are found to be non-detectable, then confirmatory samples from excavation - when it occurs - need not be analyzed by this method.

Item 3: Mr. Chan appears to argue that Boring Number 7 is not necessary. The redundancy of Kleinfelder sample 47712 is noted, however, the possibility of commingled plumes exist in this area. Boring number 7 is placed to assess the possible extent of excavation in this area.

Item 4: We do not intend to reuse stockpiled soil from drill cuttings on-site at the completion of site investigation. In our workplan we specified that composite samples will be collected to characterize every 100 cubic yards of soil. To clarify any confusion in this matter, let us add that soil from drilling activities will be remediated, if necessary, with excavated soil during the remediation phase of the project. Composite samples are for baseline/storage purposes only.

Item 5 The six identified source areas on-site are classified by Chevron (Figure 2) as

- \* The area at the corner of Fernside and Versailles Avenue, adjacent to a 1000 gallon underground storage tank (UST) still in place, and near Kleinfelder Trench Number 1.
- \* The former UST vault
- \* The above ground storage tank (AST) area on the north end of the site
- \* Three areas around the warehouse/office that likely are commingled plumes:
  - 1) manifold lines and sump
  - 2) oil receptacle
  - 3) warehouse and drum disposal area

We hope this letter serves to clarify any outstanding issues with Alameda County. We are currently in the process of permitting the borings for installation at your direction.

Please call with any comments or questions.

Very truly yours,



Ann Marie Dockstader  
Project Manager



- Soil Boring or Well
- Trench Sample - Kleinfelder
- - - - Property Line
- - - - Former Structures/Suspected Sources
- ⊕ Proposed Boring Locations

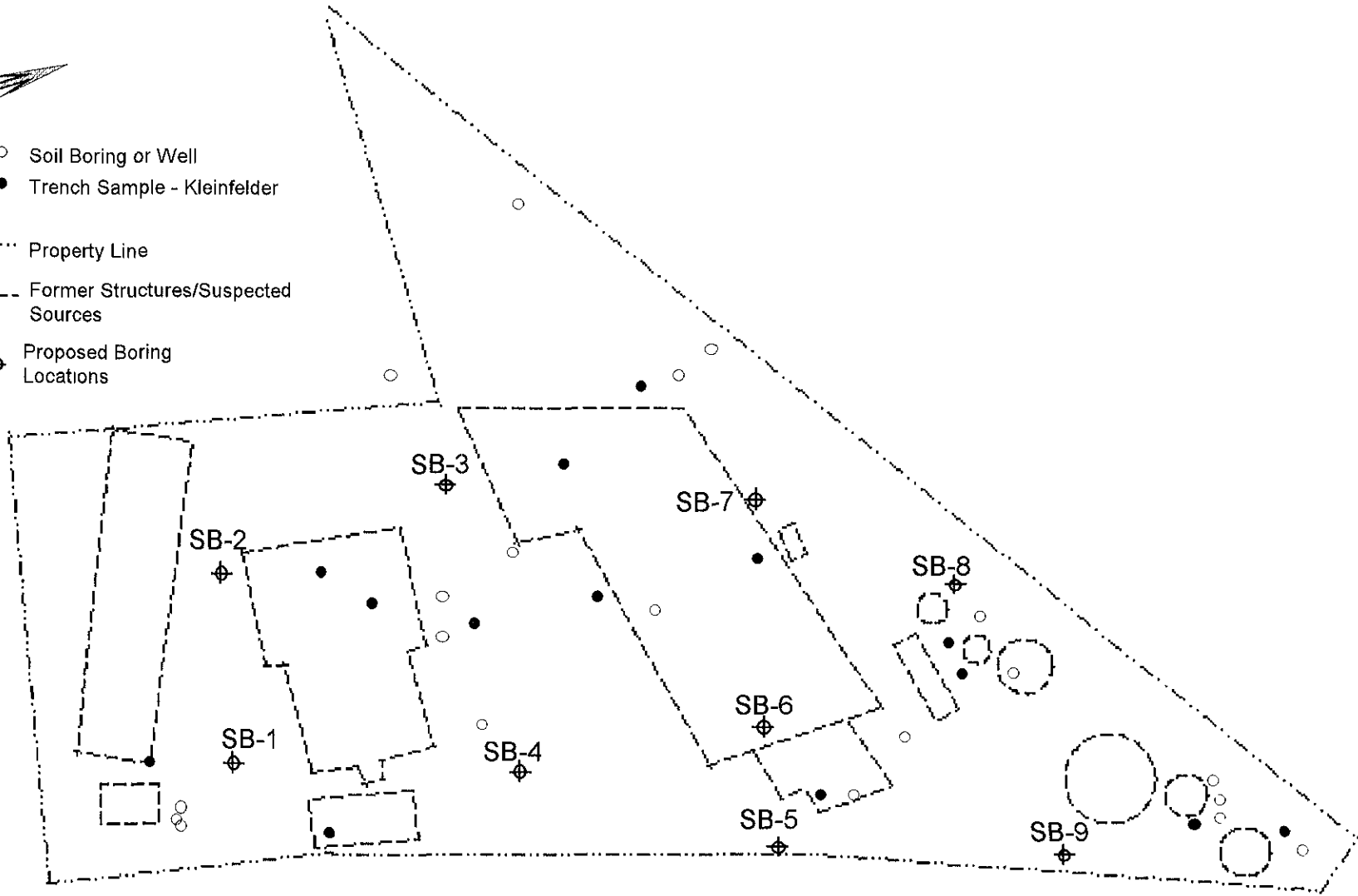

0 25 50  
Scale in feet



**PROPOSED BORING LOCATIONS**  
FORMER CHEVRON ALAMEDA BULK PLANT  
201 VERSAILLES AVENUE  
ALAMEDA, CALIFORNIA

FIGURE

1

PROJECT NO.  
chev-1

DRAWN BY:  
AMD

DATE  
1/95

BASE MAP:  
KLEINFELDER



- UST    Underground Storage Tank
- AST    Former Above Ground Storage Tank
- - - - Property Line
- - - - Former Structures/Suspected Sources (also identified by number)

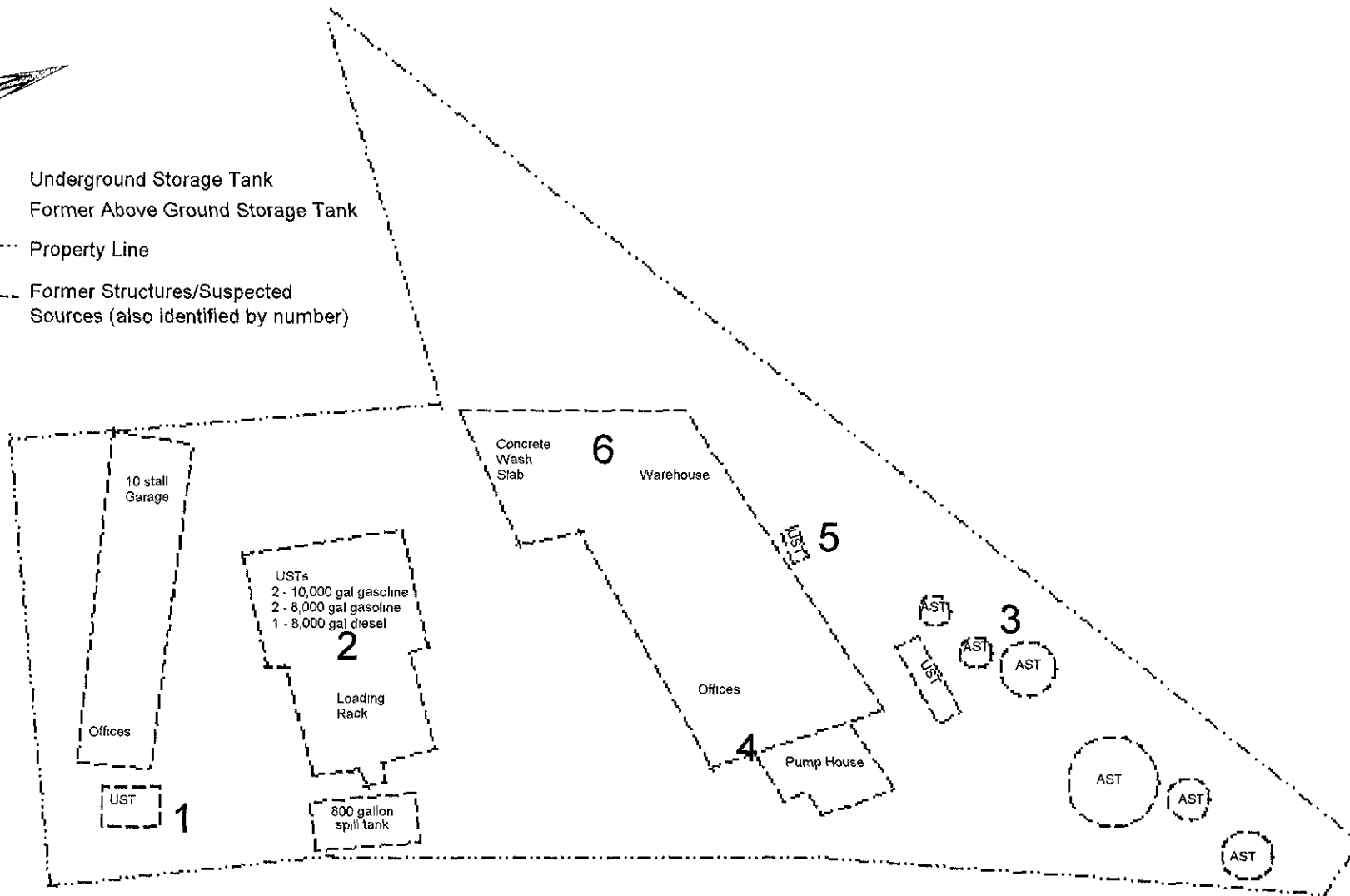

0      25      50  
Scale in feet



**SITE PLAN - POTENTIAL SOURCE AREAS**  
FORMER CHEVRON ALAMEDA BULK PLANT  
2001 VERSAILLES AVENUE  
ALAMEDA, CALIFORNIA

FIGURE  
**2**

PROJECT NO.

chev-1

DRAWN BY:

AMD

DATE

1/95

BASE MAP:

KLEINFELDER