

October 7, 1992
SCI 727.001

Mr. Dante Sambajon
Plant Engineer
Coulter Steel and Forge Company
1494 67th Street
Emeryville, California 94662-0901

Quarterly Groundwater Monitoring
Sampling Event - August 1992
Coulter Steel and Forge Company
722 Folger Avenue/Diesel Fuel Area
Emeryville, California

Dear Mr. Sambajon:

This letter records the results of the second sampling event conducted by Subsurface Consultants, Inc. (SCI) for the groundwater monitoring program at the referenced site. The program has been implemented in accordance with Regional Water Quality Control Board (RWQCB) guidelines due to the presence of petroleum hydrocarbons in the soil beneath a previous underground fuel storage tank.

In May 1992, SCI performed an investigation of the tank area by drilling 7 test borings, 4 of which were completed as monitoring wells. The previous tank area and well locations area shown on the attached Site Plan, Plate 1. Details regarding tank removal and SCI's investigation were recorded in a report dated August 7, 1992.

Groundwater Sampling

For this sampling event, all 4 on-site wells (MW-3, MW-4, MW-5 and MW-6) were sampled. Initially, the depth to groundwater and presence of free product were first checked with a steel tape and water and petroleum product sensitive pastes. Groundwater level measurements are presented in Table 1. The wells were then purged of at least three well volumes of water. Water temperature, pH and conductivity were recorded at various intervals during the purge process. Well sampling forms are attached.

The depth to water in each well was checked, following purging and before sampling, to assure that the wells had recharged to at least 80 percent of their initial volume. The wells were then sampled

■ Subsurface Consultants, Inc.

Mr. Dante Sambajon
Coulter Steel and Forge Company
SCI 727.001
October 7, 1992
Page 2

■ Subsurface Consultants, Inc.

using new disposable bailers. The samples were retained in containers pre-cleaned by the supplier in accordance with EPA protocol. The samples were placed in an ice filled cooler and transmitted to Coast to Coast Analytical Services, a State of California Department of Health Services (DHS) certified laboratory for hazardous waste and water testing.

The testing program for this event included the following analyses:

1. Total petroleum hydrocarbons as diesel (EPA 8260/5030), and
2. Benzene, toluene, ethylbenzene and xylene (BTEX) (EPA 5030/602).

The results of all analytical testing events are presented on Table 2. Analytical test reports and Chain-of-Custody documents for the current event are attached.

Conclusions

Groundwater Gradient

Based on the data presented in Table 1, it appears that the groundwater flow direction is towards the southwest under a gradient of about 3.7 percent. This data is consistent with previous findings. The groundwater flow contours and direction for this event are shown on Plate 1.

Diesel Tank Releases

In general, the analytical test data indicates that groundwater has been impacted by previous diesel releases. A dissolved product plume appears to be relatively localized, impacting areas near the previous tank. Free product has not been observed during the May or August sampling events.

Ongoing Monitoring

In accordance with the monitoring program, the next SCI sampling event will be conducted during the month of December 1992. For that event, we recommend that the wells be sampled and analyzed for total petroleum hydrocarbons as diesel, and BTEX.

Mr. Dante Sambajon
Coulter Steel and Forge Company
SCI 727.001
October 7, 1992
Page 3

■ Subsurface Consultants, Inc.

If you have any questions, please call.

Yours very truly,

Subsurface Consultants, Inc.

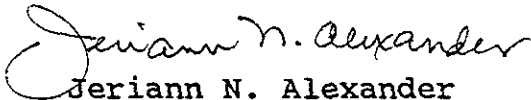

Jeriann N. Alexander
Civil Engineer 40469 (expires 3/31/95)

JW:JNA:RWR:egh

2 copies submitted

Attachments: Site Plan - Plate 1
 Table 1 - Groundwater Elevations
 Table 2 - Summary of Contaminants in Groundwater
 Analytical Test Reports
 Chain-of-Custody Documents
 Groundwater Sampling Forms

cc: Ms. Susan Hugo
 Hazardous Materials Specialty
 Alameda County Health Care Services Agency
 80 Swan Way
 Oakland, California 94612

Table 1.
Groundwater Elevation Data

<u>Boring Well Number</u>	<u>TOC Elevation¹ (feet)</u>	<u>Date</u>	<u>Groundwater Depth² (feet)</u>	<u>Groundwater Elevation (feet)</u>
MW-3	24.70	5/15/92	11.15	13.55
		7/01/92	11.60	13.10
		8/18/92	12.00	12.70
		9/11/92	12.16	
MW-4	23.92	5/15/92	10.00	13.92
		7/01/92	11.26	12.66
		8/18/92	11.58	12.34
		9/10/92	11.73	
MW-5	23.85	5/15/92	10.52	13.33
		7/01/92	9.93	13.92
		8/18/92	9.24	14.61
		9/10/92	10.46	
MW-6	22.98	5/15/92	12.46	10.52
		7/01/92	12.96	10.02
		8/18/92	13.42	9.56
		9/10/92	13.55	

¹ Reference datum is City of Berkeley Survey Monument in Folger Avenue as shown on Site Plan
² Measured below TOC

8270
(8270)

■ Subsurface Consultants, Inc.

Table 2.
Contaminants in Groundwater

<u>Boring Well/Number</u>	<u>Date</u>	<u>TEH as diesel ug/l</u>	<u>B ug/l</u>	<u>T ug/l</u>	<u>E ug/l</u>	<u>X ug/l</u>
MW-3	5/18/92	100	<0.5	<0.5	<0.5	2.5
	8/18/92	<50	<0.5	<1.0	<0.5	<0.5
	9/10/92	<50				
MW-4	5/18/92	10,000	<0.5	<0.5	<0.5	4.0
	8/18/92	300	<0.5	<1.0	<0.5	<0.5
	9/10/92	300				
MW-5	5/18/92	510	<0.5	<1.0	<0.5	<0.5
	8/18/92	<50	<0.5	<1.0	<0.5	<0.5
	9/13/92	<50				
MW-6	5/18/92	<50	<0.5	<0.5	<0.5	2.0
	8/18/92	<50	<0.5	<1.0	<0.5	<0.5
	9/10/92	<50				

ug/l = micrograms per liter, parts per billion

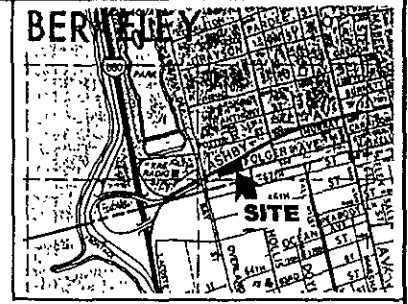

VICINITY MAP

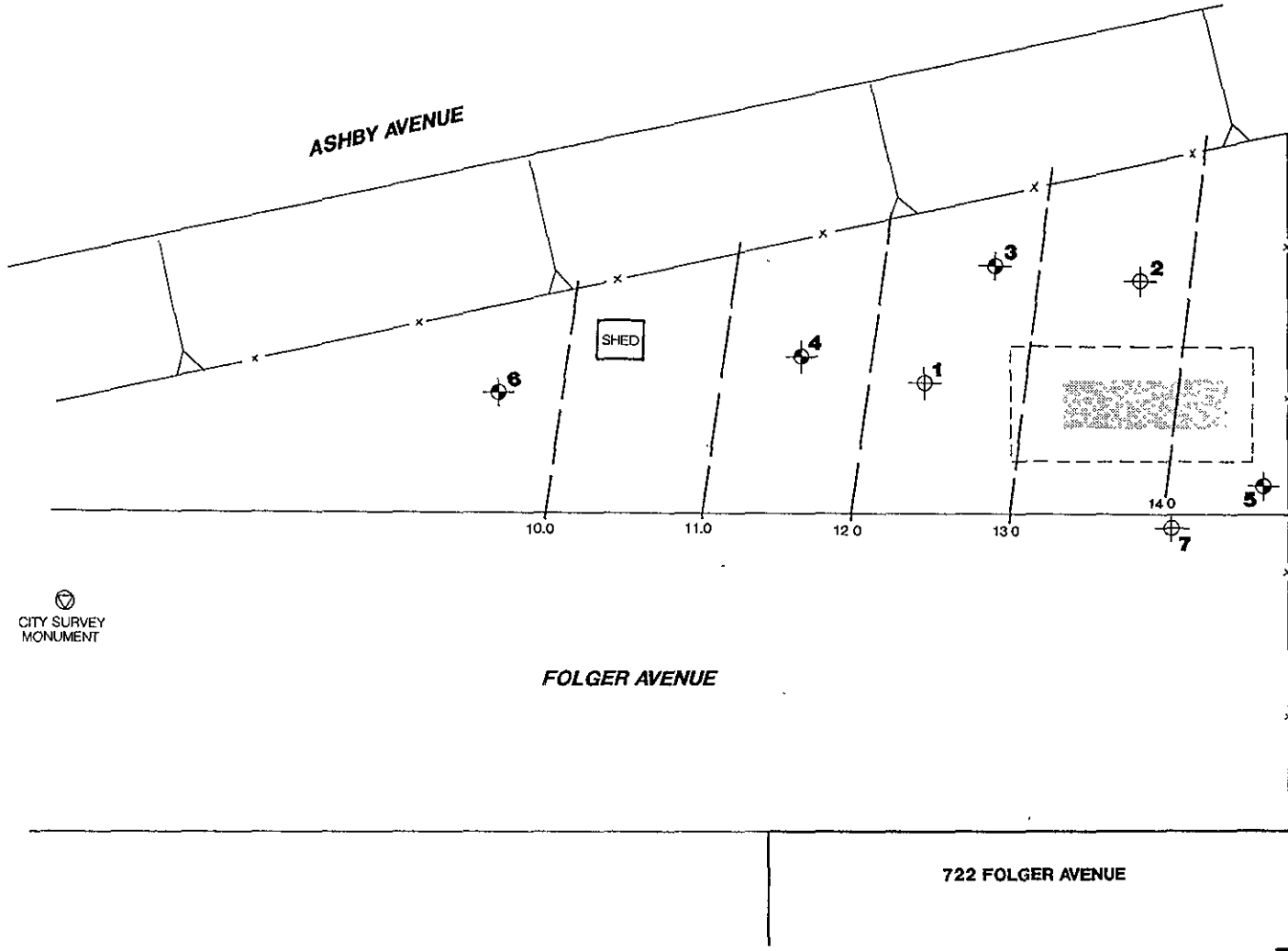

- MONITORING WELL
- TEST BORING
- EXISTING EXCAVATION
- FENCE
- PREVIOUS TANK LOCATION
- GROUNDWATER FLOW CONTOURS (feet) 9/24/92



SITE PLAN

Subsurface Consultants	722 FOLGER AVENUE - BERKELEY, CA	PLATE	1
	JOB NUMBER 727.001	DATE 10/2/92	APPROVED

WELL SAMPLING FORM

Project Name COULTER STEEL Well Number: MW. 3
 Job No.: 727.001 Well Casing Diameter: 2 inch
 Sampled By: V. BERMUDEZ Date: 8/18/92
 TOC Elevation: 24.70 Weather: Clear Sunny

Depth to Casing Bottom (below TOC) 24.00 feet
 Depth to Groundwater (below TOC) 12.00 feet
 Feet of Water in Well 12.00 feet
 Depth to Groundwater When 80% Recovered 14.4 feet
 Casing Volume (feet of water x Casing DIA² x 0.0408) 2 gallons
 Depth Measurement Method Tape & Paste / Electronic Sounder / Other
 Free Product NO PRODUCT
 Purge Method TEFLON Bailer

FIELD MEASUREMENTS

Gallons Removed	pH	Temp (°c)	Conductivity (micromhos/cm)	Salinity S%	Comments
<u>0</u>	<u>6.92</u>	<u>20.4</u>	<u>110 x 10</u>	<u>0.5</u>	<u>Water - sem clear</u>
<u>1</u>	<u>6.97</u>	<u>20.2</u>	<u>110 x 10</u>	<u>0.5</u>	
<u>2</u>	<u>6.87</u>	<u>19.9</u>	<u>110 x 10</u>	<u>0.5</u>	
<u>3</u>	<u>6.73</u>	<u>19.8</u>	<u>110 x 10</u>	<u>0.5</u>	
<u>5</u>		<u>19.8</u>	<u>110 x 10</u>	<u>0.5</u>	

Total Gallons Purged 5 gallons
 Depth to Groundwater Before Sampling (below TOC) 12.15 feet
 Sampling Method TEFLON Bailer
 Containers Used 2 40 ml 1 liter 0 pint

Subsurface Consultants

			PLATE
JOB NUMBER	DATE	APPROVED	

WELL SAMPLING FORM

Project Name COULTER STEEL Well Number: MW # 4
 Job No.: 727.001 Well Casing Diameter: 2 inch
 Sampled By: J. BARNES Date: 8/12/92
 TOC Elevation: 23.92 Weather: Clear Sunny

Depth to Casing Bottom (below TOC) 30.20 feet
 Depth to Groundwater (below TOC) 11.58 feet
 Feet of Water in Well 18.42 feet
 Depth to Groundwater When 80% Recovered 15.2 feet
 Casing Volume (feet of water x Casing DIA² x 0.0408) 3 gallons
 Depth Measurement Method Tape & Paste / Electronic Sounder / Other
 Free Product None
 Purge Method TEFLON Bailer

FIELD MEASUREMENTS

Gallons Removed	pH	Temp (°C)	Conductivity (micromhos/cm)	Salinity S%	Comments
<u>0</u>	<u>6.59</u>	<u>20.0</u>	<u>100 x10</u>	<u>0.5</u>	<u>WATER SAMPLE TAKEN</u> <u>NO OIL</u>
<u>1</u>	<u>6.57</u>	<u>19.8</u>	<u>100 x10</u>	<u>0.5</u>	
<u>2</u>	<u>6.59</u>	<u>19.8</u>	<u>100 x10</u>	<u>0.5</u>	
<u>3</u>	<u>6.58</u>	<u>19.8</u>	<u>100 x10</u>	<u>0.5</u>	
<u>5</u>	<u>6.63</u>	<u>19.4</u>	<u>100 x10</u>	<u>0.5</u>	

Total Gallons Purged 5 gallons
 Depth to Groundwater Before Sampling (below TOC) 14.31 feet
 Sampling Method TEFLON Bailer
 Containers Used 2 40 ml 1 liter 0 pint

Subsurface Consultants

		PLATE
JOB NUMBER	DATE	APPROVED

WELL SAMPLING FORM

Project Name COULTER STEEL Well Number: WIN-5

Job No.: 727.001 Well Casing Diameter: 2 inch

Sampled By: J. Serrano Date: 8/8/95

TOC Elevation: 23.85 Weather: Clear Sunny

Depth to Casing Bottom (below TOC) 19.50 feet

Depth to Groundwater (below TOC) 10.26 feet

Feet of Water in Well 9.24 feet

Depth to Groundwater When 80% Recovered 12.1 feet

Casing Volume (feet of water x Casing DIA² x 0.0408) 15 gallons

Depth Measurement Method Tape & Paste / Electronic Sounder / Other

Free Product NO

Purge Method Teflon Bailer

FIELD MEASUREMENTS

Gallons Removed	pH	Temp (°C)	Conductivity (micromhos/cm)	Salinity S%	Comments
<u>0</u>	<u>6.40</u>	<u>21.3</u>	<u>130 x10</u>	<u>0.5</u>	<u>WATER CLEAR NO OIL</u>
<u>1</u>	<u>6.47</u>	<u>21.0</u>	<u>140 x10</u>	<u>1</u>	
<u>2</u>	<u>6.49</u>	<u>20.7</u>	<u>135 x10</u>	<u>1</u>	
<u>3</u>	<u>6.52</u>	<u>20.4</u>	<u>135 x10</u>	<u>1</u>	
<u>5</u>	<u>6.63</u>	<u>19.1</u>	<u>140 x10</u>	<u>1</u>	

Total Gallons Purged 5 gallons

Depth to Groundwater Before Sampling (below TOC) 11.98 feet

Sampling Method Teflon Bailer

Containers Used 2 40 ml 1 liter 0 pint

Subsurface Consultants

JOB NUMBER	DATE	APPROVED

PLATE

WELL SAMPLING FORM

Project Name COULTER STEEL Well Number: AW 2
 Job No.: 727.001 Well Casing Diameter: 5 inch
 Sampled By: J. BERNARDEZ Date: 2/18/92
 TOC Elevation: 22.95 Weather: Clear Sunny

Depth to Casing Bottom (below TOC) 27.00 feet
 Depth to Groundwater (below TOC) 13.42 feet
 Feet of Water in Well 15.58 feet
 Depth to Groundwater When 80% Recovered 14.5 feet
 Casing Volume (feet of water x Casing DIA² x 0.0408) 2.7 gallons
 Depth Measurement Method Tape & Paste / Electronic Sounder / Other
 Free Product MDS
 Purge Method TEFLON BAILER

FIELD MEASUREMENTS

Gallons Removed	pH	Temp (°C)	Conductivity (micromhos/cm)	Salinity S%	Comments
<u>0</u>	<u>6.60</u>	<u>20.0</u>	<u>100 x 10</u>	<u>0.5</u>	<u>WATER FROM WELL</u>
<u>1</u>	<u>6.62</u>	<u>19.5</u>	<u>100 x 10</u>	<u>0.5</u>	
<u>2</u>	<u>6.68</u>	<u>19.3</u>	<u>50 x 10</u>	<u>0.5</u>	
<u>3</u>	<u>6.63</u>	<u>19.4</u>	<u>100 x 10</u>	<u>0.5</u>	
<u>5</u>	<u>6.66</u>	<u>19.3</u>	<u>100 x 10</u>	<u>0.5</u>	

Total Gallons Purged 5 gallons
 Depth to Groundwater Before Sampling (below TOC) 13.99 feet
 Sampling Method TEFLON BAILER
 Containers Used 2 40 ml 1 liter 0 pint

Subsurface Consultants

		PLATE
JOB NUMBER	DATE	APPROVED



Air, Water & Hazardous Waste Sampling, Analysis & Consultation
Certified Hazardous Waste, Chemistry, Bacteriology & Bioassay Laboratories

San Luis Obispo, CA • Goleta, CA • Benicia, CA • Camarillo, CA
Newport Beach, CA • Valparaiso, IN • Westbrook, ME

Benicia Division
6006 Egret Court, Benicia, California 94510

(707) 747-2757
FAX (707) 747-2765

CLIENT: Jeri Alexander
Subsurface Consultants
171 12th Street STE-201
Oakland, CA 94607-4411

Lab Number : ED-0519-1
Project : 727.001 Coulter Steel -
722 Folger Avenue - Emeryville
Analyzed : 08/20/92
Analyzed by: HC
Method : EPA 602

REPORT OF ANALYTICAL RESULTS

Page 1 of 1

SAMPLE DESCRIPTION	MATRIX	SAMPLED BY	SAMPLED DATE RECEIVED		
MW-3	Aqueous	Jose Bermudez	08/18/92	08/19/92	
CONSTITUENT	(CAS RN)	*PQL µg/L	RESULT µg/L	NOTE	
BTEX (PURGEABLE AROMATICS)					1
Benzene		0.5	ND		
Toluene		1.	ND		
Ethylbenzene		0.5	ND		
Xylenes (total)		0.5	ND		

Benicia Division Lab Certifications: CAELAP #1719; L.A.Co.CSD#10185

*RESULTS listed as 'ND' were not detected at or above the listed PQL (Practical Quantitation Limit)
(1) EXTRACTED by EPA 5030 (purge-and-trap)

08/25/92
INCO5 50-387
MH/trk/htc
BDH2011

Respectfully submitted,
COAST-TO-COAST ANALYTICAL SERVICES, INC.

Mary Havlicek
Mary Havlicek, Ph.D.
President



Air, Water & Hazardous Waste Sampling, Analysis & Consultation
Certified Hazardous Waste, Chemistry, Bacteriology & Bioassay Laboratories

San Luis Obispo, CA • Goleta, CA • Benicia, CA • Camarillo, CA
Newport Beach, CA • Valparaiso, IN • Westbrook, ME

Benicia Division
6006 Egret Court, Benicia, California 94510

(707) 747-2757
FAX (707)747-2765

CLIENT: Jeri Alexander
Subsurface Consultants
171 12th Street STE-201
Oakland, CA 94607-4411

Lab Number : ED-0519-1
Project : 727.001 Coulter Steel -
722 Folger Avenue - Emeryville
Analyzed : 08/24/92
Analyzed by: JK
Method : EPA 8270

REPORT OF ANALYTICAL RESULTS

Page 1 of 1

SAMPLE DESCRIPTION	MATRIX	SAMPLED BY	SAMPLED DATE RECEIVED		
MW-3	Aqueous	Jose Bermudez	08/18/92	08/19/92	
CONSTITUENT	(CAS RN)	*PQL µg/L	RESULT µg/L	NOTE	
TOTAL SEMIVOLATILE PETROLEUM HYDROCARBONS				1	
Total Petroleum Hydrocarbons		200.	ND		

Benicia Division Lab Certifications: CAELAP #1719; L.A.Co.CSD#10185

*RESULTS listed as 'ND' were not detected at or above the listed PQL (Practical Quantitation Limit)

(1) Sample Preparation on 08/20/92 by JLK using 625

08/27/92
MSD #9
MH/trk/jlk
BDH20M92

Respectfully submitted,
COAST-TO-COAST ANALYTICAL SERVICES, INC.

Mary Havlicek
Mary Havlicek, Ph.D.
President



Air, Water & Hazardous Waste Sampling, Analysis & Consultation
 Certified Hazardous Waste, Chemistry, Bacteriology & Bioassay Laboratories

San Luis Obispo, CA • Goleta, CA • Benicia, CA • Camarillo, CA
 Newport Beach, CA • Valparaiso, IN • Westbrook, ME

Benicia Division
 6006 Egret Court, Benicia, California 94510

(707) 747-2757
 FAX (707) 747-2765

CLIENT: Jeri Alexander
 Subsurface Consultants
 171 12th Street STE-201
 Oakland, CA 94607-4411

Lab Number : ED-0519-2
 Project : 727.001 Coulter Steel -
 722 Folger Avenue - Emeryville
 Analyzed : 08/20/92
 Analyzed by: HC
 Method : EPA 602

REPORT OF ANALYTICAL RESULTS

Page 1 of 1

SAMPLE DESCRIPTION	MATRIX	SAMPLED BY	SAMPLED DATE RECEIVED		
MW-4	Aqueous	Jose Bermudez	08/18/92	08/19/92	
CONSTITUENT	(CAS RN)	*PQL µg/L	RESULT µg/L	NOTE	
BTEX (PURGEABLE AROMATICS)					1
Benzene		0.5	ND		
Toluene		1.	ND		
Ethylbenzene		0.5	ND		
Xylenes (total)		0.5	ND		

Benicia Division Lab Certifications: CAELAP #1719; L.A.Co.CSD#10185

*RESULTS listed as 'ND' were not detected at or above the listed PQL (Practical Quantitation Limit)
 (1) EXTRACTED by EPA 5030 (purge-and-trap)

08/25/92
 INCOS 50-387
 MH/trk/htc
 EDH2011

Respectfully submitted,
 COAST-TO-COAST ANALYTICAL SERVICES, INC.

Mary Havlicek
 Mary Havlicek, Ph.D.
 President

**COAST - TO -
COAST
ANALYTICAL
SERVICES**

Air, Water & Hazardous Waste Sampling, Analysis & Consultation
 Certified Hazardous Waste, Chemistry, Bacteriology & Bioassay Laboratories

San Luis Obispo, CA • Goleta, CA • Benicia, CA • Camarillo, CA
 Newport Beach, CA • Valparaiso, IN • Westbrook, ME

Benicia Division
 6006 Egret Court, Benicia, California 94510

(707) 747-2757
 FAX (707) 747-2765

CLIENT: Jeri Alexander
 Subsurface Consultants
 171 12th Street STE-201
 Oakland, CA 94607-4411

Lab Number : BD-0519-2
 Project : 727.001 Coulter Steel -
 722 Folger Avenue - Emeryville
 Analyzed : 08/24/92
 Analyzed by: JK
 Method : EPA 8270

REPORT OF ANALYTICAL RESULTS

Page 1 of 1

SAMPLE DESCRIPTION	MATRIX	SAMPLED BY	SAMPLED DATE RECEIVED	
MW-4	Aqueous	Jose Bermudez	08/18/92	08/19/92
CONSTITUENT	(CAS RN)	*PQL µg/L	RESULT µg/L	NOTE
TOTAL SEMIVOLATILE PETROLEUM HYDROCARBONS				1,2
Total Petroleum Hydrocarbons (Diesel #2)		200.	200.	

Benicia Division Lab Certifications: CAELAP #1719; L.A.Co.CSD#10185

*RESULTS listed as 'ND' were not detected at or above the listed PQL (Practical Quantitation Limit)

- (1) Sample Preparation on 08/20/92 by JLK using 625
- (2) Diesel #2 as reported represents a hydrocarbon range of C8 to C16. The quantitative value is based on Diesel #2 Standard.

08/27/92
 MSD #9
 ME/trk/jlk
 BDH20M92

Respectfully submitted,
 COAST-TO-COAST ANALYTICAL SERVICES, INC.

Mary Havlicek
 Mary Havlicek, Ph.D.
 President



Air, Water & Hazardous Waste Sampling, Analysis & Consultation
Certified Hazardous Waste, Chemistry, Bacteriology & Bioassay Laboratories

San Luis Obispo, CA • Goleta, CA • Benicia, CA • Camarillo, CA
Newport Beach, CA • Valparaiso, IN • Westbrook, ME

Benicia Division
6006 Egret Court, Benicia, California 94510

(707) 747-2757
FAX (707) 747-2765

CLIENT: Jeri Alexander
Subsurface Consultants
171 12th Street STE-201
Oakland, CA 94607-4411

Lab Number : ED-0519-3
Project : 727.001 Coulter Steel -
722 Folger Avenue - Emeryville
Analyzed : 08/20/92
Analyzed by: HC
Method : EPA 602

REPORT OF ANALYTICAL RESULTS

Page 1 of 1

SAMPLE DESCRIPTION	MATRIX	SAMPLED BY	SAMPLED DATE RECEIVED	
MW-5	Aqueous	Jose Bermudez	08/18/92	08/19/92
CONSTITUENT	(CAS RN)	*PQL µg/L	RESULT µg/L	NOTE
BTEX (PURGEABLE AROMATICS)				1
Benzene		0.5	ND	
Toluene		1.	ND	
Ethylbenzene		0.5	ND	
Xylenes (total)		0.5	ND	

Benicia Division Lab Certifications: CAELAP #1719; L.A.Co.CSD#10185

*RESULTS listed as 'ND' were not detected at or above the listed PQL (Practical Quantitation Limit)

(1) EXTRACTED by EPA 5030 (purge-and-trap)

08/25/92
INCO5 50-387
ME/trk/htc
BDH2011

Respectfully submitted,
COAST-TO-COAST ANALYTICAL SERVICES, INC.

Mary Havlicek
Mary Havlicek, Ph.D.
President

**COAST - TO -
COAST
ANALYTICAL
SERVICES**

Air, Water & Hazardous Waste Sampling, Analysis & Consultation
 Certified Hazardous Waste, Chemistry, Bacteriology & Bioassay Laboratories

San Luis Obispo, CA • Goleta, CA • Benicia, CA • Camarillo, CA
 Newport Beach, CA • Valparaiso, IN • Westbrook, ME

Benicia Division
 6006 Egret Court, Benicia, California 94510

(707) 747-2757
 FAX (707) 747-2765

CLIENT: Jeri Alexander
 Subsurface Consultants
 171 12th Street STE-201
 Oakland, CA 94607-4411

Lab Number : ED-0519-3
 Project : 727.001 Coulter Steel -
 722 Folger Avenue - Emeryville
 Analyzed : 08/24/92
 Analyzed by: JK
 Method : EPA 8270

REPORT OF ANALYTICAL RESULTS

Page 1 of 1

SAMPLE DESCRIPTION	MATRIX	SAMPLED BY	SAMPLED DATE RECEIVED	
MW-5	Aqueous	Jose Bermudez	08/18/92	08/19/92
CONSTITUENT	(CAS RN)	*PQL µg/L	RESULT µg/L	NOTE
TOTAL SEMIVOLATILE PETROLEUM HYDROCARBONS				1
Total Petroleum Hydrocarbons		200.	ND	

Benicia Division Lab Certifications: CAELAP #1719; L.A.Co.CSD#10185

*RESULTS listed as 'ND' were not detected at or above the listed PQL (Practical Quantitation Limit)

(1) Sample Preparation on 08/20/92 by JLK using 625

08/27/92
 MSD #9
 MH/trk/jlk
 EDH20M92

Respectfully submitted,
 COAST-TO-COAST ANALYTICAL SERVICES, INC.

Mary Havlicek
 Mary Havlicek, Ph.D.
 President



Air, Water & Hazardous Waste Sampling, Analysis & Consultation
Certified Hazardous Waste, Chemistry, Bacteriology & Bioassay Laboratories

San Luis Obispo, CA • Goleta, CA • Benicia, CA • Camarillo, CA
Newport Beach, CA • Valparaiso, IN • Westbrook, ME

Benicia Division
6006 Egret Court, Benicia, California 94510

(707) 747-2757
FAX (707) 747-2765

CLIENT: Jeri Alexander
Subsurface Consultants
171 12th Street STE-201
Oakland, CA 94607-4411

Lab Number : ED-0519-4
Project : 727.001 Coulter Steel -
722 Folger Avenue - Emeryville
Analyzed : 08/20/92
Analyzed by: HC
Method : EPA 602

REPORT OF ANALYTICAL RESULTS

Page 1 of 1

SAMPLE DESCRIPTION	MATRIX	SAMPLED BY	SAMPLED DATE RECEIVED	
MW-6	Aqueous	Jose Bermudez	08/18/92	08/19/92
CONSTITUENT	(CAS RN)	*PQL	RESULT	NOTE
		µg/L	µg/L	
BTEX (PURGEABLE AROMATICS)				1
Benzene		0.5	ND	
Toluene		1.	ND	
Ethylbenzene		0.5	ND	
Xylenes (total)		0.5	ND	

Benicia Division Lab Certifications: CAELAP #1719; L.A.Co.CSD#10185

*RESULTS listed as 'ND' were not detected at or above the listed PQL (Practical Quantitation Limit)
(1) EXTRACTED by EPA 5030 (purge-and-trap)

08/25/92
INCOS 50-387
MH/trk/htc
BDH2011

Respectfully submitted,
COAST-TO-COAST ANALYTICAL SERVICES, INC.

Mary Havlicek
Mary Havlicek, Ph.D.
President



Air, Water & Hazardous Waste Sampling, Analysis & Consultation
Certified Hazardous Waste, Chemistry, Bacteriology & Bioassay Laboratories

San Luis Obispo, CA • Goleta, CA • Benicia, CA • Camarillo, CA
Newport Beach, CA • Valparaiso, IN • Westbrook, ME

Benicia Division
6006 Egret Court, Benicia, California 94510

(707) 747-2757
FAX (707)747-2765

QC Batch ID: BDH2011

CLIENT: Coast-to-Coast Analytical Services, Inc.

Analyzed : 08/20/92
Analyzed by: HC
Method : EPA 602

METHOD BLANK
REPORT OF ANALYTICAL RESULTS

Page 1 of 1

SAMPLE DESCRIPTION	MATRIX	SAMPLED BY	SAMPLED DATE RECEIVED		
METHOD BLANK	Aqueous				
CONSTITUENT	(CAS RN)	*PQL µg/L	RESULT µg/L	NOTE	
BTEX (PURGEABLE AROMATICS)				1	
Benzene		0.5	ND		
Toluene		1.	ND		
Ethylbenzene		0.5	ND		
Xylenes (total)		0.5	ND		

Benicia Division Lab Certifications: CAELAP #1719; L.A.Co.CSD#10185

*RESULTS listed as 'ND' were not detected at or above the listed PQL (Practical Quantitation Limit)
(1) EXTRACTED by EPA 5030 (purge-and-trap)

08/25/92
INCO5 50-387
MH/trk/htc
BD0519-4

Respectfully submitted,
COAST-TO-COAST ANALYTICAL SERVICES, INC.

Mary Havlicek
Mary Havlicek, Ph.D.
President



Air, Water & Hazardous Waste Sampling, Analysis & Consultation
Certified Hazardous Waste, Chemistry, Bacteriology & Bioassay Laboratories

San Luis Obispo, CA • Goleta, CA • Benicia, CA • Camarillo, CA
Newport Beach, CA • Valparaiso, IN • Westbrook, ME

Benicia Division
6006 Egret Court, Benicia, California 94510

(707) 747-2757
FAX (707) 747-2765

QC Batch ID: BDH2011

CLIENT: Coast-to-Coast Analytical Services, Inc.

Analyzed : 08/20/92
Analyzed by: HC
Method : EPA 602

QC SPIKE
REPORT OF ANALYTICAL RESULTS

Page 1 of 1

SAMPLE DESCRIPTION	MATRIX	SAMPLED BY		SAMPLED DATE RECEIVED	
QC SPIKE	Aqueous				
CONSTITUENT	*PQL μg/L	SPIKE AMOUNT	RESULT μg/L	%REC	NOTE
BTEX (PURGEABLE AROMATICS)					1
Benzene	0.5	170.	180.	106.	
Toluene	1.	840.	900.	107.	
Ethylbenzene	0.5	150.	150.	100.	
Xylenes (total)	0.5	780.	810.	104.	

Benicia Division Lab Certifications: CAELAP #1719; L.A.Co.CSD#10185

*RESULTS listed as 'ND' were not detected at or above the listed PQL (Practical Quantitation Limit)
(1) EXTRACTED by EPA 5030 (purge-and-trap)

08/25/92
INCO5 50-387
MH/trk/htc
BD0519-4

Respectfully submitted,
COAST-TO-COAST ANALYTICAL SERVICES, INC.

Mary Havlicek
Mary Havlicek, Ph.D.
President

**COAST - TO -
COAST
ANALYTICAL
SERVICES**

Air, Water & Hazardous Waste Sampling, Analysis & Consultation
Certified Hazardous Waste, Chemistry, Bacteriology & Bioassay Laboratories

San Luis Obispo, CA • Goleta, CA • Benicia, CA • Camarillo, CA
Newport Beach, CA • Valparaiso, IN • Westbrook, ME

Benicia Division
6006 Egret Court, Benicia, California 94510

(707) 747-2757
FAX (707)747-2765

QC Batch ID: BDH2011

CLIENT: Coast-to-Coast Analytical Services, Inc.

Analyzed : 08/20/92
Analyzed by: HC
Method : EPA 602

QC SPIKE
REPORT OF ANALYTICAL RESULTS

Page 1 of 1

SAMPLE DESCRIPTION	MATRIX	SAMPLED BY		SAMPLED DATE RECEIVED		
QC SPIKE DUPLICATE	Aqueous					
CONSTITUENT	*PQL µg/L	SPIKE AMOUNT	RESULT µg/L	%REC	%DIFF	NOTE
BTEX (PURGEABLE AROMATICS)						1
Benzene	0.5	170.	180.	106.	0.	
Toluene	1.	840.	900.	107.	0.	
Ethylbenzene	0.5	150.	150.	100.	0.	
Xylenes (total)	0.5	780.	800.	103.	1.2	

Benicia Division Lab Certifications: CAELAP #1719; L.A.Co.CSD#10185

*RESULTS listed as 'ND' were not detected at or above the listed PQL (Practical Quantitation Limit)
(1) EXTRACTED by EPA 5030 (purge-and-trap)

08/25/92
INCO5 50-387
MH/trk/htc
BD0519-4

Respectfully submitted,
COAST-TO-COAST ANALYTICAL SERVICES, INC.

Mary Havlicek
Mary Havlicek, Ph.D.
President



Benicia Division
6006 Egret Court, Benicia, California 94510

(707) 747-2757
FAX (707) 747-2765

CLIENT: Jeri Alexander
Subsurface Consultants
171 12th Street STE-201
Oakland, CA 94607-4411

Lab Number : ED-0519-4
Project : 727.001 Coulter Steel -
722 Folger Avenue - Emeryville
Analyzed : 08/24/92
Analyzed by: JK
Method : EPA 8270

REPORT OF ANALYTICAL RESULTS

Page 1 of 1

SAMPLE DESCRIPTION	MATRIX	SAMPLED BY	SAMPLED DATE RECEIVED	
MN-6	Aqueous	Jose Bermudez	08/18/92	08/19/92
CONSTITUENT	(CAS RN)	*PQL µg/L	RESULT µg/L	NOTE
TOTAL SEMIVOLATILE PETROLEUM HYDROCARBONS				1
Total Petroleum Hydrocarbons		200.	ND	

Benicia Division Lab Certifications: CAELAP #1719; L.A.Co.CSD#10185

*RESULTS listed as 'ND' were not detected at or above the listed PQL (Practical Quantitation Limit)

(1) Sample Preparation on 08/20/92 by JLK using 625

08/27/92
MSD #9
ME/trk/jlk
EDH2QM92

Respectfully submitted,
COAST-TO-COAST ANALYTICAL SERVICES, INC.

Mary Havlicek
Mary Havlicek, Ph.D.
President

**COAST - TO -
COAST
ANALYTICAL
SERVICES**

Air, Water & Hazardous Waste Sampling, Analysis & Consultation
Certified Hazardous Waste, Chemistry, Bacteriology & Bioassay Laboratories

San Luis Obispo, CA • Goleta, CA • Benicia, CA • Camarillo, CA
Newport Beach, CA • Valparaiso, IN • Westbrook, ME

Benicia Division
6006 Egret Court, Benicia, California 94510

(707) 747-2757
FAX (707) 747-2765

QC Batch ID: BDH20M92

CLIENT: Coast-to-Coast Analytical Services, Inc.

Analyzed : 08/24/92
Analyzed by: JK
Method : EPA 8270

INSTRUMENT BLANK
REPORT OF ANALYTICAL RESULTS

Page 1 of 1

SAMPLE DESCRIPTION	MATRIX	SAMPLED BY	SAMPLED DATE RECEIVED		
INSTRUMENT BLANK	Aqueous				
CONSTITUENT	(CAS RN)	*PQL µg/L	RESULT µg/L	NOTE	
TOTAL SEMIVOLATILE PETROLEUM HYDROCARBONS					
Total Petroleum Hydrocarbons		200.	ND		

Benicia Division Lab Certifications: CAELAP #1719; L.A.Co.CSD#10185

*RESULTS listed as 'ND' were not detected at or above the listed PQL (Practical Quantitation Limit)

08/27/92
MSD #9
MH/trk/jlk
ED0519-4

Respectfully submitted,
COAST-TO-COAST ANALYTICAL SERVICES, INC.

Mary Havlicek
Mary Havlicek, Ph.D.
President



Air, Water & Hazardous Waste Sampling, Analysis & Consultation
Certified Hazardous Waste, Chemistry, Bacteriology & Bioassay Laboratories

San Luis Obispo, CA • Goleta, CA • Benicia, CA • Camarillo, CA
Newport Beach, CA • Valparaiso, IN • Westbrook, ME

Benicia Division
6006 Egret Court, Benicia, California 94510

(707) 747-2757
FAX (707) 747-2765

QC Batch ID: BDH20M92

CLIENT: Coast-to-Coast Analytical Services, Inc.

Analyzed : 08/24/92
Analyzed by: JK
Method : EPA 8270

METHOD BLANK
REPORT OF ANALYTICAL RESULTS

Page 1 of 1

SAMPLE DESCRIPTION	MATRIX	SAMPLED BY	SAMPLED DATE RECEIVED		
METHOD BLANK	Aqueous				
CONSTITUENT	(CAS RN)	*PQL µg/L	RESULT µg/L	NOTE	
TOTAL SEMIVOLATILE PETROLEUM HYDROCARBONS				1	
Total Petroleum Hydrocarbons		200.	ND		

Benicia Division Lab Certifications: CAELAP #1719; L.A.Co.CSD#10185

*RESULTS listed as 'ND' were not detected at or above the listed PQL (Practical Quantitation Limit)

(1) Sample Preparation on 08/20/92 by JLK using 625

08/27/92
MSD #9
MH/trk/jlk
BD0519-4

Respectfully submitted,
COAST-TO-COAST ANALYTICAL SERVICES, INC.

Mary Havlicek
Mary Havlicek, Ph.D.
President



Benicia Division
6006 Egret Court, Benicia, California 94510

(707) 747-2757
FAX (707) 747-2765

QC Batch ID: BDH20M92

CLIENT: Coast-to-Coast Analytical Services, Inc.

Analyzed : 08/24/92
Analyzed by: JK
Method : EPA 8270

QC SPIKE
REPORT OF ANALYTICAL RESULTS

Page 1 of 1

SAMPLE DESCRIPTION	MATRIX	SAMPLED BY		SAMPLED DATE RECEIVED	
QC SPIKE	Aqueous				
CONSTITUENT	*PQL µg/L	SPIKE AMOUNT	RESULT µg/L	%REC	NOTE
TOTAL SEMIVOLATILE PETROLEUM HYDROCARBONS					1
Total Petroleum Hydrocarbons (Diesel #2)	200.	10000.	7800.	78.	

Benicia Division Lab Certifications: CAELAP #1719; L.A.Co.CSD#10185

*RESULTS listed as 'ND' were not detected at or above the listed PQL (Practical Quantitation Limit)

(1) Sample Preparation on 08/20/92 by JLK using 625

08/27/92
MSD #9
MH/trk/jlk
BD0519-4

Respectfully submitted,
COAST-TO-COAST ANALYTICAL SERVICES, INC.

Mary Havlicek
Mary Havlicek, Ph.D.
President



Air, Water & Hazardous Waste Sampling, Analysis & Consultation
Certified Hazardous Waste, Chemistry, Bacteriology & Bioassay Laboratories

San Luis Obispo, CA • Goleta, CA • Benicia, CA • Camarillo, CA
Newport Beach, CA • Valparaiso, IN • Westbrook, ME

Benicia Division
6006 Egret Court, Benicia, California 94510

(707) 747-2757
FAX (707)747-2765

QC Batch ID: BDH20M92

CLIENT: Coast-to-Coast Analytical Services, Inc.

Analyzed : 08/24/92
Analyzed by: JK
Method : EPA 8270

QC SPIKE
REPORT OF ANALYTICAL RESULTS

Page 1 of 1

SAMPLE DESCRIPTION	MATRIX	SAMPLED BY		SAMPLED DATE RECEIVED		
QC SPIKE DUPLICATE	Aqueous					
CONSTITUENT	*PQL µg/L	SPIKE AMOUNT	RESULT µg/L	%REC	%DIFF	NOTE
TOTAL SEMIVOLATILE PETROLEUM HYDROCARBONS						1
Total Petroleum Hydrocarbons (Diesel #2)	200.	10000.	7300.	73.	6.6	

Benicia Division Lab Certifications: CAELAP #1719; L.A.Co.CSD#10185

*RESULTS listed as 'ND' were not detected at or above the listed PQL (Practical Quantitation Limit)

(1) Sample Preparation on 08/20/92 by JLK using 625

08/27/92
MSD #9
MH/trk/jlk
BD0519-4

Respectfully submitted,
COAST-TO-COAST ANALYTICAL SERVICES, INC.

Mary Havlicek, Ph.D.
President

WELL SAMPLING FORM

Project Name COULTER STEEL Well Number: 3
Job No.: 727.001 Well Casing Diameter: 12 inch
Sampled By: Jose Bermudez Date: 9/10/92
TOC Elevation: 24.70 Weather: SUNNY CLEAR

Depth to Casing Bottom (below TOC) 24.00 feet
Depth to Groundwater (below TOC) 12.16 feet
Feet of Water in Well 11.84 feet
Depth to Groundwater When 80% Recovered 14.53 feet
Casing Volume (feet of water x Casing DIA² x 0.0408) 2 gallons
Depth Measurement Method Tape & Paste / Electronic Sounder / Other
Free Product NO
Purge Method bailey

FIELD MEASUREMENTS

Gallons Removed	pH	Temp (°c)	Conductivity (micromhos/cm)	Salinity S%	Comments
<u>0</u>	<u>6.58</u>	<u>20.5</u>	<u>100 x 10</u>	<u>0</u>	<u>WATER CLEAR</u>
<u>2</u>	<u>6.65</u>	<u>20.1</u>	<u>100 x 10</u>	<u>0</u>	<u>CLEAR</u>
<u>3</u>	<u>6.56</u>	<u>20.0</u>	<u>100 x 10</u>	<u>0</u>	<u>CLEAR</u>

Total Gallons Purged _____ gallons
Depth to Groundwater Before Sampling (below TOC) 14.39 feet
Sampling Method bailey
Containers Used _____ 40 ml _____ / liter _____ pint

Subsurface Consultants

722 FOLGER AVENUE - EMERYVILLE, CA

PLATE

JOB NUMBER

DATE

APPROVED

727.001

9/9/92

WELL SAMPLING FORM

Project Name COULTER STEEL Well Number: 21
 Job No.: 727.001 Well Casing Diameter: 2 inch
 Sampled By: Jose Bermudez Date: 9/10/92
 TOC Elevation: 23.92 Weather: SUNNY

Depth to Casing Bottom (below TOC) 30.00 feet
 Depth to Groundwater (below TOC) 11.73 feet
 Feet of Water in Well 18.27 feet
 Depth to Groundwater When 80% Recovered 15.38 feet
 Casing Volume (feet of water x Casing DIA² x 0.0408) 2 gallons
 Depth Measurement Method Tape & Paste Electronic Sounder / Other
 Free Product No Product
 Purge Method Teflon Bailor

FIELD MEASUREMENTS

Gallons Removed	pH	Temp (°c)	Conductivity (micromhos/cm)	Salinity S%	Comments
<u>0</u>	<u>7.20</u>	<u>21.0</u>	<u>120 x10</u>	<u>0</u>	<u>WATER CLEAR</u>
<u>1</u>	<u>7.05</u>	<u>21.3</u>	<u>125 x10</u>	<u>0</u>	<u>↓</u>
<u>3</u>	<u>6.94</u>	<u>20.3</u>	<u>125 x10</u>	<u>0</u>	<u>↓</u>

Total Gallons Purged 3 gallons
 Depth to Groundwater Before Sampling (below TOC) 14.23 feet
 Sampling Method Teflon Bailor
 Containers Used 1
 40 ml liter pint

Subsurface Consultants	722 FOLGER AVENUE - EMERYVILLE, CA		PLATE
	JOB NUMBER 727.001	DATE 9/9/92	

WELL SAMPLING FORM

Project Name COULTER STEEL Well Number: 5
 Job No.: 727.001 Well Casing Diameter: 2 inch
 Sampled By: Jose Bermudez Date: 9/10/92
 TOC Elevation: 23.85 Weather: SUNNY (HOT)

Depth to Casing Bottom (below TOC) 19.50 feet
 Depth to Groundwater (below TOC) 10.46 feet
 Feet of Water in Well 9.04 feet
 Depth to Groundwater When 80% Recovered 12.27 feet
 Casing Volume (feet of water x Casing DIA² x 0.0408) 1.5 gallons
 Depth Measurement Method Tape & Paste / Electronic Sounder / Other
 Free Product NO
 Purge Method Bailer

FIELD MEASUREMENTS

Gallons Removed	pH	Temp (°C)	Conductivity (micromhos/cm)	Salinity S%	Comments
<u>0</u>	<u>6.47</u>	<u>21.8</u>	<u>130 x 10</u>	<u>0</u>	<u>sample 1</u>
<u>2</u>	<u>6.47</u>	<u>21.6</u>	<u>130 x 10</u>	<u>0</u>	
<u>3</u>	<u>6.53</u>	<u>20.7</u>	<u>130 x 10</u>		

Total Gallons Purged 3 gallons
 Depth to Groundwater Before Sampling (below TOC) 14.82 feet
 Sampling Method Bailer
 Containers Used 1 40 ml 1 liter pint

Subsurface Consultants

722 FOLGER AVENUE - EMERYVILLE, CA

PLATE

JOB NUMBER

DATE

APPROVED

727.001

9/9/92

WELL SAMPLING FORM

Project Name COULTER STEEL Well Number: 6
 Job No.: 727.001 Well Casing Diameter: 2 inch
 Sampled By: J. Berwin Date: 9/10/92
 TOC Elevation: 22.98 Weather: SUNNY

Depth to Casing Bottom (below TOC) 29.00 feet
 Depth to Groundwater (below TOC) 13.55 feet
 Feet of Water in Well 15.45 feet
 Depth to Groundwater When 80% Recovered 16.64 feet
 Casing Volume (feet of water x Casing DIA² x 0.0408) 27 gallons
 Depth Measurement Method Tape & Paste / Electronic Sounder / Other
 Free Product NO
 Purge Method Bailer

FIELD MEASUREMENTS

Gallons Removed	pH	Temp (°C)	Conductivity (micromhos/cm)	Salinity S%	Comments
<u>0</u>	<u>6.54</u>	<u>20.0</u>	<u>100 410</u>	<u>0</u>	<u>SEMI CLEAR</u>
<u>2</u>	<u>6.56</u>	<u>19.7</u>	<u>100 410</u>	<u>0</u>	<u>TURBID LANC.</u>
<u>3</u>	<u>6.62</u>	<u>19.6</u>	<u>100 410</u>	<u>0</u>	<u>TURBID LANC.</u>

Total Gallons Purged 3 gallons
 Depth to Groundwater Before Sampling (below TOC) 15.82 feet
 Sampling Method Bailer
 Containers Used 1 40 ml 1 liter pint

Subsurface Consultants

722 FOLGER AVENUE - EMERYVILLE, CA

JOB NUMBER
727.001

DATE
9/9/92

APPROVED

PLATE

CHAIN OF CUSTODY FORM

PROJECT NAME: Coulter Steel 722 Folger Avenue, Emeryville
 JOB NUMBER: 727.001 LAB: Coast to Coast Analytical
 PROJECT CONTACT: Jaci Alexander TURNAROUND: Normal
 SAMPLED BY: Jose Bermudez REQUESTED BY: John Wolfe

ANALYSIS REQUESTED											
TPH											
Diesel											
8260											
5030											

LABORATORY I.D. NUMBER	SCI SAMPLE NUMBER	MATRIX				CONTAINERS				METHOD PRESERVED					SAMPLING DATE				NOTES	
		WATER	SOIL	WASTE	AIR	VOA	LITER	PINT	TUBE	HCL	H2SO4	HNO3	ICE	NONE	MONTH	DAY	YEAR	TIME		
	MW-3	X				2	1						X		9	10	92		X	
	MW-4	X				2	1						X		9	10	92		X	
	MW-5	X				2	1						X		9	10	92		X	
	MW-6	X				2	1						X		9	10	92		X	

COMMENTS & NOTES:
 * Analysis to be performed free of charge as agreed to in conversation with Mr. Todd Kessler, 9/9/92
 No VOA's received 9/10/92

CHAIN OF CUSTODY RECORD			
RELEASED BY: (Signature) <i>John Wolfe</i>	DATE/TIME	RECEIVED BY: (Signature) <i>Jaci Alexander</i>	DATE/TIME 9/11/92
RELEASED BY: (Signature)	DATE/TIME	RECEIVED BY: (Signature)	DATE/TIME
RELEASED BY: (Signature)	DATE/TIME	RECEIVED BY: (Signature)	DATE/TIME

Subsurface Consultants, Inc.
 171 12TH STREET, SUITE 201, OAKLAND, CALIFORNIA 94607
 (510) 268-0461 • FAX: 510-268-0137



Air, Water & Hazardous Waste Sampling, Analysis & Consultation
Certified Hazardous Waste, Chemistry, Bacteriology & Bioassay Laboratories

San Luis Obispo, CA • Benicia, CA • Camarillo, CA • Goleta, CA
Anaheim, CA • Tempe, AZ • Valparaiso, IN • Westbrook, ME • Indianapolis, IN

Benicia Division
6006 Egret Court, Benicia, California 94510

(707) 747-2757
FAX (707) 747-2765

CLIENT: Jeri Alexander
Subsurface Consultants
171 12th Street STE-201
Oakland, CA 94607-4411

Lab Number : BD-0559-1
Project : 727.001 Coulter Steel,
722 Folger Avenue, Emeryville
Analyzed : 09/13/92
Analyzed by: AZ
Method : EPA 8260

REPORT OF ANALYTICAL RESULTS

Page 1 of 1

SAMPLE DESCRIPTION	MATRIX	SAMPLED BY	SAMPLED DATE RECEIVED		
MW-3	Aqueous	Jose Bermudez	09/10/92	09/10/92	
CONSTITUENT	(CAS RN)	*PQL µg/L	RESULT µg/L	NOTE	
Total Petroleum Hydrocarbons (Diesel)		50.	ND	1	

Benicia Division Lab Certifications: CAELAP #1719; L.A.Co.CSD#10185

*RESULTS listed as 'ND' were not detected at or above the listed PQL (Practical Quantitation Limit)
(1) ANALYZED by CAL DHS DRAFT TPH (modified) and EPA 8260 (GC/MS)

09/17/92
INCOS 50-387
MH/trk/htc
BD11311

Respectfully submitted,
COAST-TO-COAST ANALYTICAL SERVICES, INC.

Mary Havlicek
Mary Havlicek, Ph.D.
President

**COAST - TO -
COAST
ANALYTICAL
SERVICES**

Air, Water & Hazardous Waste Sampling, Analysis & Consultation
 Certified Hazardous Waste, Chemistry, Bacteriology & Bioassay Laboratories

San Luis Obispo, CA • Benicia, CA • Camarillo, CA • Goleta, CA
 Anaheim, CA • Tempe, AZ • Valparaiso, IN • Westbrook, ME • Indianapolis, IN

Benicia Division
 6006 Egret Court, Benicia, California 94510

(707) 747-2757
 FAX (707) 747-2765

CLIENT: Jeri Alexander
 Subsurface Consultants
 171 12th Street STE-201
 Oakland, CA 94607-4411

Lab Number : ED-0559-2
 Project : 727.001 Coulter Steel,
 722 Folger Avenue, Emeryville
 Analyzed : 09/13/92
 Analyzed by: AZ
 Method : EPA 8260

REPORT OF ANALYTICAL RESULTS

Page 1 of 1

SAMPLE DESCRIPTION	MATRIX	SAMPLED BY	SAMPLED DATE RECEIVED		
MW-4	Aqueous	Jose Bermudez	09/10/92	09/10/92	
CONSTITUENT	(CAS RN)	*PQL μg/L	RESULT μg/L	NOTE	
Total Petroleum Hydrocarbons (Diesel)		50.	300.		1

Benicia Division Lab Certifications: CAELAP #1719; L.A.Co.CSD#10185

*RESULTS listed as 'ND' were not detected at or above the listed PQL (Practical Quantitation Limit)
 (1) ANALYZED by CAL DHS DRAFT TPH (modified) and EPA 8260 (GC/MS)

09/17/92
 INCOS 50-387
 MH/trk/htc
 ED11311

Respectfully submitted,
 COAST-TO-COAST ANALYTICAL SERVICES, INC.

Mary Havlicek
 Mary Havlicek, Ph.D.
 President



Air, Water & Hazardous Waste Sampling, Analysis & Consultation
Certified Hazardous Waste, Chemistry, Bacteriology & Bioassay Laboratories

San Luis Obispo, CA • Benicia, CA • Camarillo, CA • Goleta, CA
Anaheim, CA • Tempe, AZ • Valparaiso, IN • Westbrook, ME • Indianapolis, IN

Benicia Division
6006 Egret Court, Benicia, California 94510

(707) 747-2757
FAX (707) 747-2765

CLIENT: Jeri Alexander
Subsurface Consultants
171 12th Street STE-201
Oakland, CA 94607-4411

Lab Number : ED-0559-3
Project : 727.001 Coulter Steel,
722 Folger Avenue, Emeryville
Analyzed : 09/13/92
Analyzed by: AZ
Method : EPA 8260

REPORT OF ANALYTICAL RESULTS

Page 1 of 1

SAMPLE DESCRIPTION	MATRIX	SAMPLED BY	SAMPLED DATE RECEIVED		
MW-5	Aqueous	Jose Bermudez	09/10/92	09/10/92	
CONSTITUENT	(CAS RN)	*PQL µg/L	RESULT µg/L	NOTE	
Total Petroleum Hydrocarbons (Diesel)		50.	ND	1	

Benicia Division Lab Certifications: CAELAP #1719; L.A.Co.CSD#10185
*RESULTS listed as 'ND' were not detected at or above the listed PQL (Practical Quantitation Limit)
(1) ANALYZED by CAL DHS DRAFT TPH (modified) and EPA 8260 (GC/MS)

09/17/92
INCO5 50-387
MH/trk/htc
BD11311

Respectfully submitted,
COAST-TO-COAST ANALYTICAL SERVICES, INC.

Mary Havlicek
Mary Havlicek, Ph.D.
President

**COAST - TO -
COAST
ANALYTICAL
SERVICES**

Air, Water & Hazardous Waste Sampling, Analysis & Consultation
 Certified Hazardous Waste, Chemistry, Bacteriology & Bioassay Laboratories

San Luis Obispo, CA • Benicia, CA • Camarillo, CA • Goleta, CA
 Anaheim, CA • Tempe, AZ • Valparaiso, IN • Westbrook, ME • Indianapolis, IN

Benicia Division
 6006 Egret Court, Benicia, California 94510

(707) 747-2757
 FAX (707) 747-2765

CLIENT: Jeri Alexander
 Subsurface Consultants
 171 12th Street STE-201
 Oakland, CA 94607-4411

Lab Number : ED-0559-4
 Project : 727.001 Coulter Steel,
 722 Folger Avenue, Emeryville
 Analyzed : 09/13/92
 Analyzed by: AZ
 Method : EPA 8260

REPORT OF ANALYTICAL RESULTS

Page 1 of 1

SAMPLE DESCRIPTION	MATRIX	SAMPLED BY	SAMPLED DATE RECEIVED	
MW-6	Aqueous	Jose Bermudez	09/10/92	09/10/92
CONSTITUENT	(CAS RN)	*PQL µg/L	RESULT µg/L	NOTE
Total Petroleum Hydrocarbons (Diesel)		50.	ND	1

Benicia Division Lab Certifications: CAELAP #1719; L.A.Co.CSD#10185

*RESULTS listed as 'ND' were not detected at or above the listed PQL (Practical Quantitation Limit)

(1) ANALYZED by CAL DHS DRAFT TPH (modified) and EPA 8260 (GC/MS)

09/17/92
 INCOS 50-387
 MH/trk/htc
 BDI1311

Respectfully submitted,
 COAST-TO-COAST ANALYTICAL SERVICES, INC.

Mary Havlicek

Mary Havlicek, Ph.D.
 President



Air, Water & Hazardous Waste Sampling, Analysis & Consultation
Certified Hazardous Waste, Chemistry, Bacteriology & Bioassay Laboratories

San Luis Obispo, CA • Benicia, CA • Camarillo, CA • Goleta, CA
Anaheim, CA • Tempe, AZ • Valparaiso, IN • Westbrook, ME • Indianapolis, IN

Benicia Division
6006 Egret Court, Benicia, California 94510

(707) 747-2757
FAX (707) 747-2765

QC Batch ID: BD11311

CLIENT: Coast-to-Coast Analytical Services, Inc.

Analyzed : 09/13/92
Analyzed by: AZ
Method : EPA 8260

METHOD BLANK
REPORT OF ANALYTICAL RESULTS

Page 1 of 1

SAMPLE DESCRIPTION	MATRIX	SAMPLED BY	SAMPLED DATE RECEIVED		
METHOD BLANK	Aqueous				
CONSTITUENT	(CAS RN)	*PQL µg/L	RESULT µg/L	NOTE	
Total Petroleum Hydrocarbons (Diesel)		50.	ND	1	

Benicia Division Lab Certifications: CAELAP #1719; L.A.Co.CSD#10185

*RESULTS listed as 'ND' were not detected at or above the listed PQL (Practical Quantitation Limit)
(1) ANALYZED by CAL DHS DRAFT TPH (modified) and EPA 8260 (GC/MS)

09/18/92
INCOS 50-387
MH/trk/htc
ED0559-4

Respectfully submitted,
COAST-TO-COAST ANALYTICAL SERVICES, INC.

Mary Havlicek, Ph.D.
President

**COAST - TO -
COAST
ANALYTICAL
SERVICES**

Air, Water & Hazardous Waste Sampling, Analysis & Consultation
 Certified Hazardous Waste, Chemistry, Bacteriology & Bioassay Laboratories

San Luis Obispo, CA • Benicia, CA • Camarillo, CA • Goleta, CA
 Anaheim, CA • Tempe, AZ • Valparaiso, IN • Westbrook, ME • Indianapolis, IN

Benicia Division
 6006 Egret Court, Benicia, California 94510

(707) 747-2757
 FAX (707) 747-2765

QC Batch ID: EDI1311

CLIENT: Coast-to-Coast Analytical Services, Inc.

Analyzed : 09/13/92
 Analyzed by: AZ
 Method : EPA 8260

QC SPIKE
 REPORT OF ANALYTICAL RESULTS

Page 1 of 1

SAMPLE DESCRIPTION	MATRIX	SAMPLED BY		SAMPLED DATE RECEIVED	
QC SPIKE	Aqueous				
CONSTITUENT	*PQL μg/L	SPIKE AMOUNT	RESULT μg/L	%REC	NOTE
Total Petroleum Hydrocarbons (Diesel)	50.	44000.	34000.	77.	1

Benicia Division Lab Certifications: CAELAP #1719; L.A.Co.CSD#10185

*RESULTS listed as 'ND' were not detected at or above the listed PQL (Practical Quantitation Limit)
 (1) ANALYZED by CAL DHS DRAFT TPH (modified) and EPA 8260 (GC/MS)

09/18/92
 INCO5 50-387
 MH/trk/htc
 ED0559-4

Respectfully submitted,
 COAST-TO-COAST ANALYTICAL SERVICES, INC.

Mary Havlicek
 Mary Havlicek, Ph.D.
 President