

**Alameda County Department of Environmental Health  
Hazardous Materials Division**  
80 Swan Way, Rm. 200, Oakland, CA 94621  
Ph: 510-271-4320

**BILLING FOR SERVICES**

STID# \_\_\_\_\_

A. Site Name SEVERAL SITES IN ALAMEDA Phone \_\_\_\_\_  
 Site Address \_\_\_\_\_  
(If no address, description of area)      Number      Street      City      Zip  
 Prior Business Name \_\_\_\_\_ Prior Owner's Name \_\_\_\_\_

B. Service Requestor JOHN WOLF Weiss ASSOCIATES Phone 547-5420  
Contact Person      Company Name  
 Billing Address 5500 SHELLMOUND ST., - EMERYVILLE, CA 94608  
Number      Street      City      Zip

<b>Category of Service</b>		#Hours	x \$	/Hr	\$
<input checked="" type="checkbox"/> Site Search		<u>3</u>		<u>75</u>	<u>225</u>
<input type="checkbox"/> File Search		_____	x \$ _____	/Copy	\$ _____
<input type="checkbox"/> Other _____		_____	x \$ _____		\$ _____
<b>TOTAL CHARGE:</b>					<u>\$ 225</u>

REMARKS: ADD 30 mins. for collection of files.

\_\_\_\_\_

\_\_\_\_\_

\_\_\_\_\_

\_\_\_\_\_

**You will receive an invoice in accordance with Article 11 of Chapter 6, Title 3 of the Ordinance Code of Alameda County**

Service Requestor JOHN WOLF [Signature] Date 12-2-93  
printed name      signature  
 HazMat Specialist [Signature] Date 12-2-93  
printed name      signature

## CALIFORNIA REGIONAL WATER QUALITY CONTROL BOARD

SAN FRANCISCO BAY REGION  
2101 WEBSTER STREET, SUITE 500  
OAKLAND, CA 94612  
(510) 286-1255



Alameda Fire Station  
2401 Encinal Avenue  
Alameda, CA 94501

June 9, 1993  
File: 2198.17

Attention: Chief

RE: **Case Closure for Underground Storage Tank Site,  
2401 Encinal Avenue, Alameda, Alameda County,  
County File: STID 3948**

To Whom it may concern:

The Alameda County Department of Environmental Health (ACHD) has submitted a letter which recommends the closure for your site involving the removal of one 500 gallon gasoline tank and one 180 gallon gasoline tank. Regional Board staff have reviewed the County file for your site and concur with this recommendation. Therefore based on the available information for the above site, it appears that further investigation and cleanup of petroleum hydrocarbons are not necessary. Further work could be required if conditions change or a water quality threat is discovered at the site.

Please contact Richard Hiett from my staff at (510) 286-4359 if you have any questions regarding the contents of this letter.

Sincerely,

A handwritten signature in black ink, appearing to read "Steven R. Ritchie", is written over a horizontal line. The signature is stylized and somewhat cursive.

Steven R. Ritchie  
Executive Officer

cc: ACHD, 80 Swan Way, Suite 200, Oakland, CA 94621  
Attn: Ms. Juliet Shin

rch/ust

90481-111285

LOP - RECORD CHANGE REQUEST FORM

printed:  
06/23/93

Mark Out What Needs Changing and Hand to LOP Data Entry  
(Name/Address changes go to Annual Programs Data Entry)

AGENCY # : 10000                      SOURCE OF FUNDS: F                      SUBSTANCE: 12034  
 StID : 3948  
 SITE NAME: Alameda Fire Department                      DATE REPORTED : 08/22/90  
 ADDRESS : 2401 Encinal Ave.                      DATE CONFIRMED:  
 CITY/ZIP : Alameda 94501                      MULTIPLE RPs : N

SITE STATUS  
-----

CASE TYPE: S                      CONTRACT STATUS: 4                      EMERGENCY RESP:  
 RP SEARCH: S                      DATE COMPLETED: 04/27/92  
 PRELIMINARY ASMNT:                      DATE UNDERWAY:                      DATE COMPLETED:  
 REM INVESTIGATION:                      DATE UNDERWAY:                      DATE COMPLETED:  
 REMEDIAL ACTION:                      DATE UNDERWAY:                      DATE COMPLETED:  
 POST REMED ACT MON:                      DATE UNDERWAY:                      DATE COMPLETED:  
 ENFORCEMENT ACTION TYPE: 1                      DATE ENFORCEMENT ACTION TAKEN: 04/27/92  
 LUFT FIELD MANUAL CONSID: 2  
 CASE CLOSED:                      DATE CASE CLOSED:  
 DATE EXCAVATION STARTED : 06/04/90                      REMEDIAL ACTIONS TAKEN:

RESPONSIBLE PARTY INFORMATION  
-----

RP#1-CONTACT NAME: Richard Quarante  
 COMPANY NAME: City Of Alameda  
 ADDRESS: 1300 Park St  
 CITY/STATE: Alameda, C A 94501

INSPECTOR VERIFICATION:

NAME \_\_\_\_\_ SIGNATURE \_\_\_\_\_ DATE \_\_\_\_\_

DATA ENTRY INPUT:

Name/Address Changes Only			Case Progress Changes	
ANPNPGMS _____	LOP _____	DATE _____	LOP _____	DATE _____

ALAMEDA COUNTY  
HEALTH CARE SERVICES  
AGENCY

DAVID J. KEARS, Agency Director



RAFAT A. SHAHID, ASST. AGENCY DIRECTOR

DEPARTMENT OF ENVIRONMENTAL HEALTH  
State Water Resources Control Board  
Division of Clean Water Programs  
UST Local Oversight Program  
80 Swan Way, Rm 200  
Oakland, CA 94621  
(510) 271-4530

February 1, 1993

Richard Hiett  
RWQCB, S.F. Bay Region  
2101 Webster St., Ste 500  
Oakland, CA 94612

STID 3948

Re: Alameda Fire Department, located at 2401 Encinal Avenue,  
Alameda, California

**RECOMMENDATION FOR UST CASE CLOSURE**

Dear Mr. Hiett,

On June 4, 1990, one 180-gallon diesel underground storage tank (UST) and one 500-gallon gasoline UST were removed from the above site. According to Environmental Bio-System's report, no holes, rusting, or pitting were observed in either of the USTs.

Soil samples were collected from the tank pit in the presence of Katherine Chesick, Alameda County Hazardous Materials Specialist. One soil sample was collected from beneath each of the tanks at 10 feet below ground surface (bgs) and three sidewall soil samples were collected, one adjacent to the fill end of the 500-gallon UST at 15 feet bgs, and two collected near the non-fill end of the 500-gallon UST at 9.5 and 15 feet bgs. Additionally, one stockpile soil sample was collected.

The soil samples were analyzed for TPHg, and BTEX using method 8020. Additional analysis were conducted for lead and diesel on the stockpile soil sample and one of the tank bottom samples.

Analysis of soil samples identified 3.2 parts per million (ppm) Total Petroleum Hydrocarbons as gasoline (TPHg), 0.3 ppm toluene, and 0.4 ppm xylenes, beneath the UST, and 12 ppm TPHg, 0.2 ppm benzene, 0.6 ppm xylenes, and 0.3 ppm ethylbenzene in one of the sidewall samples. Additionally, 85 ppm TPHg, 37 ppm TPHd, 0.3 ppm benzene, 2.4 ppm toluene, 7.7 ppm xylenes, and 1.6 ppm ethylbenzene was identified in the stockpile soil sample.

According to Ms. Chesick's notes on the sampling, ground water entered the tank pit at approximately 10 feet below ground surface. It appears that the ground water in the tank pit was never sampled.

Prior to the tank removal in 1986, a monitoring well was installed to the east of the former tank in response to AB1362. This well is currently located within 2 feet of the boundary of

Rich Hiatt  
Re: 2401 Encinal Avenue  
Page 2 of 2  
February 1, 1993

the former tank excavation. This office considered having the site collect a sample from this well to determine whether or not the ground water was impacted by the releases from the UST. However, it was determined, by looking at the ground water information for the neighboring ARCO site, that this well is not downgradient (southwest) from the former tank. Even if it were, the well log for this well states that the soil type, down to 20 feet bgs, is all sand with some clayey sand, so it would seem that any ground water contaminants that may have resulted from past releases would probably have migrated southwest beneath the on-site building or off site since June 1990.

This office evaluated the possibility of requesting the placement of a boring and collection of a ground water sample southwest of the former tank. However, according to Robert Pogue at the Alameda Fire Dept., a boring would cause an integrity break-down in a special vapor/soils matting that was installed between the soil and the aggregate base for most of the site. Additionally, a building, located about 16 feet south/southwest from the former tank, limits the amount of room for other optional boring locations. Even though a boring were to be placed within the area between the former tank and the building, what are the odds that any groundwater possibly impacted in the past, would be identified within this distance, considering the sand soil type beneath the site.

Prior to the tank removal in 1986 and during the operation of the tanks, a ground water sample was collected from the on-site monitoring well. This sample was analyzed for diesel (it appears that they used method 8015 with a detection limit of 0.2 ppm). Nothing was detected.

Considering the above information, I am recommending that this site be closed. If you need any additional information or documents for your review, please let me know. Please contact me with the RWQCB's decision as to whether it is in concurrence with our recommendation. If you have any questions or comments, please contact me at (510) 271-4530.

Sincerely



Juliet Shin  
Hazardous Materials Specialist

cc: Edgar Howell-File(JS) 



90700-1 025

January 28, 1993

Juliet Shin  
Hazardous Materials Specialist  
Alameda County Health Care Services  
Department of Environmental Health  
80 Swan Way, Room 200  
Oakland, CA 94621

RE: Information You Requested As Per Our Phone Conversation On  
January 21, 1993.

Dear Ms. Shin;

Enclosed you will find the computer generated drawing relating to the tank removal site. Drawing number D-1 depicts the site plan of our property. Drawing D-2 shows the site where the fuel tanks were removed in 1990 as it relates to the buildings and planter area that we discussed. Drawing D-3 is a drawing of the planter area that is adjacent to the Headquarters office building. As you can see in drawing D-3 the area has limited access for a truck mount drill rig. As we discussed there are utilities that are present in the planter area. We have located pipe or pipes in the planter within the area of clearance. To date we have not been able to determine which utility the pipes serve, and it doesn't really matter; the pipes are present.

An alternative is to bore at the planter area next to the Park St. driveway which is seventy feet to the North, North/West of the removal site. One other option is to wait until later this year. We are tentatively planning the construction of a generator pad which will cause us to remove some asphalt and redo the vapor/soils matting in that area. The problem is that the construction site will be sixty feet to the East of the tank removal site.

We also discussed closing the project file. I have mixed feeling on this matter. I would like to call it quits, close the file and not have to jump through all the budget hoops to find funding to bore and test a sample. On the other hand I do not want this to come back to haunt us at a later date. There would be nothing worse than to revisit this issue one or even five years from now. If we can not completely put this issue to rest, we need to go ahead with some form of a compatible test procedure. As I expressed to you, I feel that the excavation cleared any problem

---

Alameda Fire Department

Headquarters  
1300 Park Street · 94501  
510.748 4601

Juliet Shin  
Hazardous Materials Specialist  
Alameda County Health Care Services  
Department of Environmental Health  
80 Swan Way, Room 200  
Oakland, CA 94621

PAGE # 2

areas that were caused by the fuel that was spilled during tank filling operations.

Please contact me regarding your decision and advice on this matter.

As per your request a copy of this letter and attachments are being sent to Mr. Richard Hiatt at the San Francisco Bay Region-Water Quality Control Board.

Thank you for your cooperation on this matter.

Sincerely,

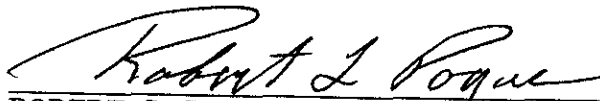
  
ROBERT L. POGUE, Deputy Fire Chief

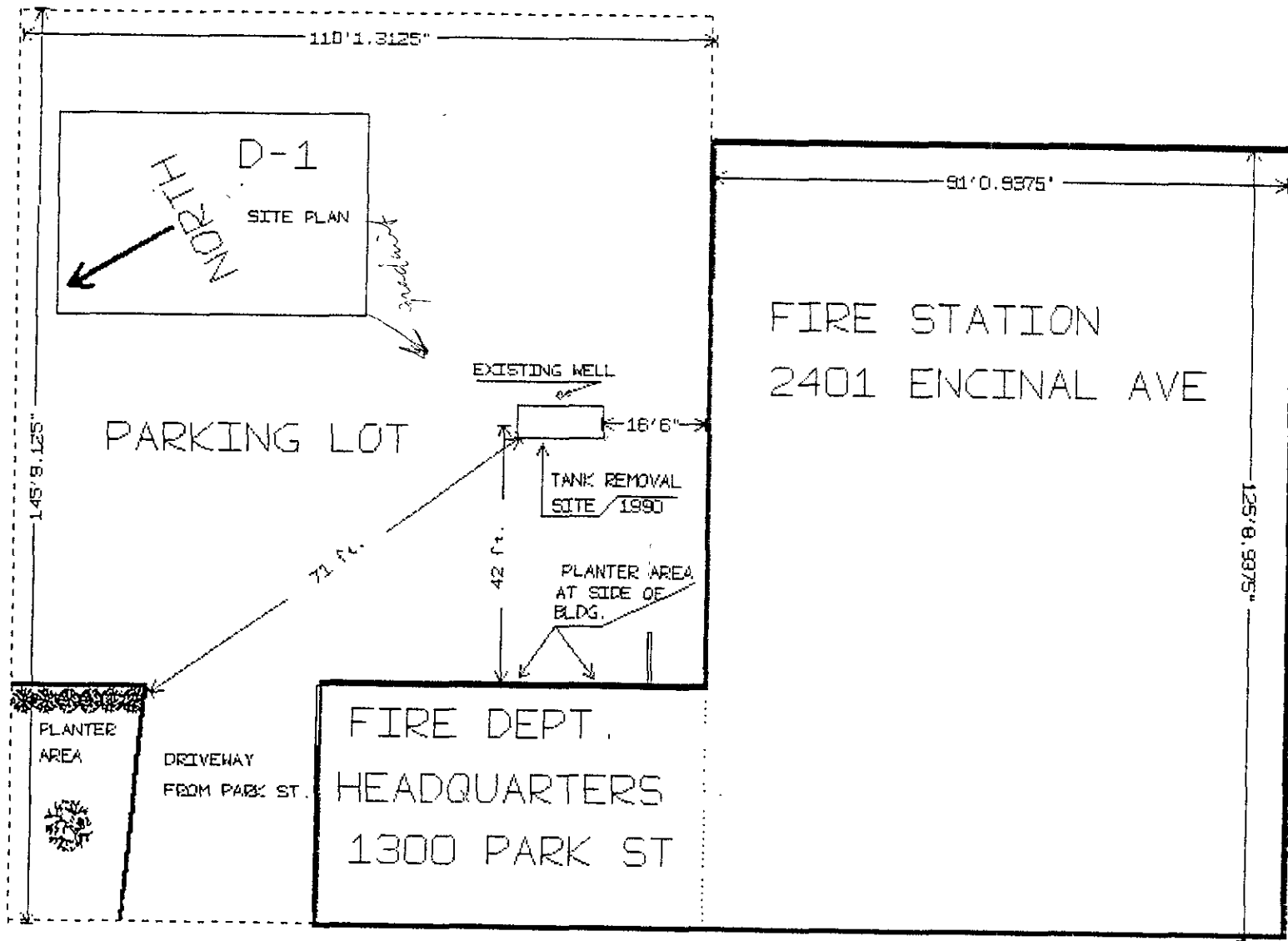

ENCINAL AVE.

PARK STREET



# PARKING LOT AREA

FIRE  
STA

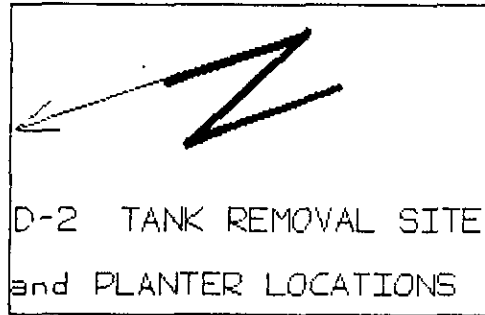

DRIVEWAY  
FROM PARK ST.

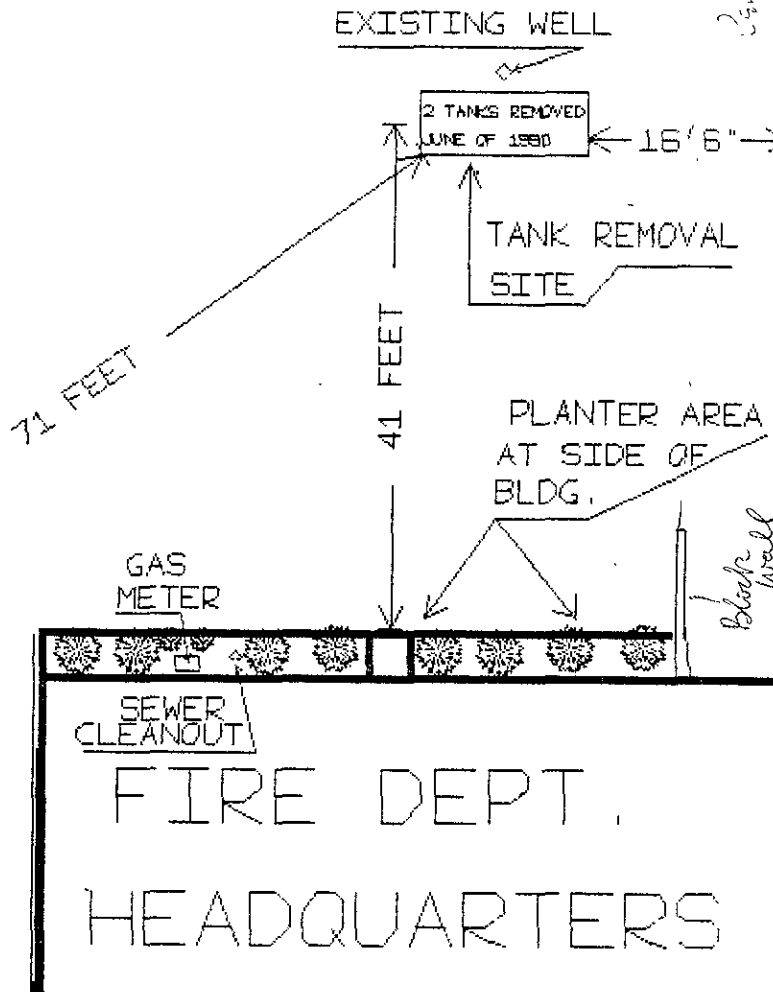

D-3 SIDE VIEW  
PLANTER AREA  
NEXT TO BLDG.

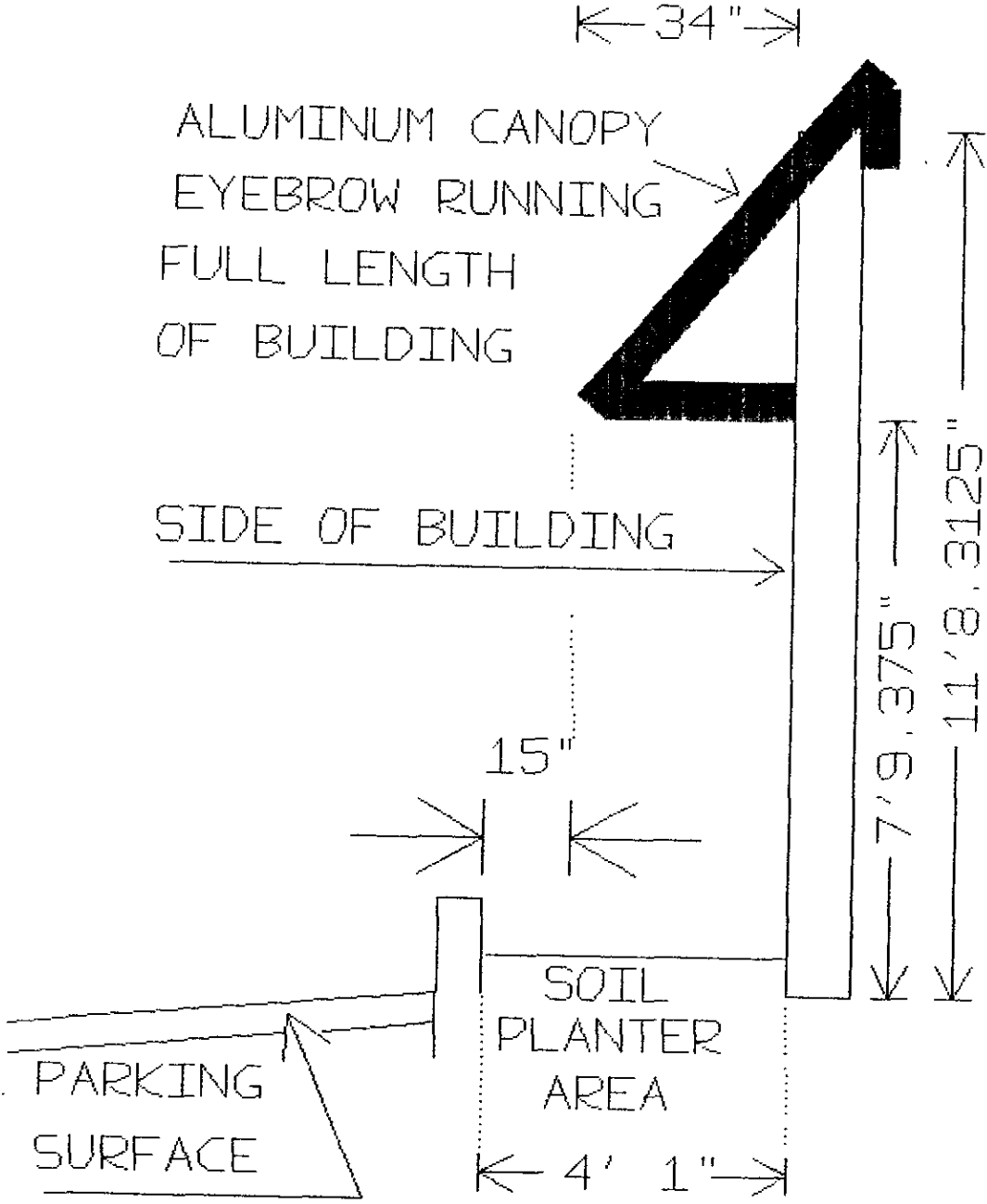

ALAMEDA COUNTY  
HEALTH CARE SERVICES  
AGENCY

DAVID J. KEARS, Agency Director



RAFAT A. SHAHID, ASST. AGENCY DIRECTOR

DEPARTMENT OF ENVIRONMENTAL HEALTH  
State Water Resources Control Board  
Division of Clean Water Programs  
UST Local Oversight Program  
80 Swan Way, Rm 200  
Oakland, CA 94621  
(510) 271-4530

November 2, 1992

Robert Pogue  
City of Alameda  
1300 Park Street  
Alameda, CA 94501

STID 3948

RE: Required ground water investigations for the site located  
at 2401 Encinal Avenue, Alameda, California

Dear Mr. Pogue,

On June 4, 1990, one 180-gallon diesel underground storage tank (UST) and one 500-gallon gasoline UST were removed from the above site. One soil sample was collected from underneath each of the USTs. Analysis of these samples identified low concentrations of Total Petroleum Hydrocarbons as gasoline (TPHg) from underneath the tank pit and from the sidewalls of the tank pit. Although low concentrations of contaminants were identified in the soil samples, this office is concerned that ground water may have been impacted due to the shallow ground water observed at the site.

Per our conversation on November 2, 1992, there is a monitoring well located within two feet of the former tank pit. Please submit any information you have on the construction of this well. If this office determines that the construction of this well is adequate for monitoring the shallow aquifer beneath the site, you will be required to collect ground water samples from this well and have them analyzed. If this well is determined to be inadequate for monitoring purposes, you will be required to install a boring or well to adequately collect ground water samples. Ground water samples shall be analyzed for TPHg, BTEX, and TPH as diesel.

You are required to submit a work plan to this office **within 60 days** of the receipt of this letter addressing ground water investigations at the site. All reports and proposals must be submitted under seal of a California-Registered Geologist, -Certified Engineering Geologist, or -Registered Civil Engineer. This Department will oversee the assessment of your site. Our oversight will include the review of and comment on work proposals and technical guidance on appropriate investigative approaches and monitoring schedules.

Please be advised that this is a formal request for technical reports pursuant to **California Water Code Section 13267 (b)**. Any

Mr. Robert Pogue  
RE: 2401 Encinal Ave.  
November 2, 1992  
Page 2 of 2

extensions of the stated deadlines, or modifications of the required tasks, must be confirmed in writing by either this agency or RWQCB.

Please be reminded to copy Richard Hiett, San Francisco Bay Region-Water Quality Control Board, on all correspondence and reports.

If you have any questions or comments, please contact me at (510) 271-4530.

Sincerely,

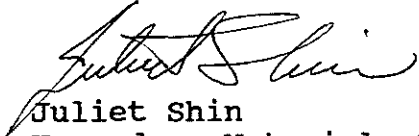

Juliet Shin  
Hazardous Materials Specialist

cc: Richard Hiett, RWQCB

Edgar Howell-File(JS)

ALAMEDA COUNTY  
HEALTH CARE SERVICES

AGENCY  
DAVID J. KEARS, Agency Director



RAFAT A. SHAHID, Assistant Agency Director

DEPARTMENT OF ENVIRONMENTAL HEALTH  
Hazardous Materials Division  
80 Swan Way, Rm. 200  
Oakland, CA 94621  
(510) 271-4320

June 10, 1992

Richard Quarante  
City of Alameda  
1300 Park Street  
Alameda, CA 94501

STID 3948

RE: Soil Contamination Associated with Removal of Underground  
Storage Tank (UST) at 2401 Encinal Ave., Alameda, California

Dear Mr. Quarante,

On June 4, 1990, one 180-gallon diesel UST and one 500-gallon gasoline UST were removed from the above site. One soil sample was collected from underneath each of the USTs. Analysis of these samples identified low concentrations of Total Petroleum Hydrocarbons as gasoline (TPHg) from underneath the gasoline tank at 3.2 parts per million (ppm) and low concentrations of TPHg at 1.7 ppm and 12 ppm from the sidewalls of the tank excavation. Although low concentrations of contaminants were identified in the soil samples, this office is concerned that ground water may have been impacted at the site due to the fact that ground water was observed flowing into the tank pit at the same depth at which the above soil samples were collected.

According to the Regional Water Quality Control Board's (RWQCB) Staff Recommendations for the Initial Evaluation and Investigation of Underground Tanks, if detectable concentrations of petroleum hydrocarbons are detected in the soil at ground water level, then further soil and ground water investigations are required. The purpose of this investigation is to determine the lateral and vertical extent, and severity, of latent soil and ground water contamination which may have resulted from the release at the site.

Such an investigation is in the form of a Preliminary Site Assessment (PSA). The information gathered by the PSA will be used to determine an appropriate course of action to remediate the site, if deemed necessary. The PSA must be conducted in accordance with the above RWQCB Recommendations. The major elements of such an investigation are summarized in the attached Appendix A. The guidelines include the requirement that a ground water monitoring well must be installed within ten feet of a former UST oriented in the verified downgradient direction relative to ground water flow.

Richard Quarante  
RE: 2401 Encinal Ave.  
June 10, 1992  
Page 2 of 3

Ground water gradient determination is required for the site and is usually achieved by installing three monitoring wells at the site.

In order to proceed with a site investigation, you should obtain professional services of a reputable environmental consultant. Your responsibility is to have the consultant submit for review a proposal outlining planned activities pertinent to meeting the criteria broadly outlined in this letter and the attached Appendix A.

This Department will oversee the assessment and remediation of your site. Our oversight will include the review of and comment on work proposals and technical guidance on appropriate investigative approaches and monitoring schedules. The issuance of well drilling permits, however, will be through the Alameda County Flood Control and Water Conservation District, Zone 7, in Pleasanton. The RWQCB may choose to take over as lead agency if it is determined following the completion of the initial assessment that there has been a substantial impact to ground water.

The Preliminary Site Assessment (PSA) proposal is **due within 45 days** of the date of this letter. Once the proposal is approved, field work, should commence within 60 days. A report must be submitted within 45 days after the completion of this phase of work at the site. Subsequent reports are to be submitted **quarterly** until this site qualifies for final RWQCB "sign-off". Such quarterly reports are due the first day of the second month of each subsequent quarter.

The referenced initial and quarterly reports must describe the status of the investigation and must include, among others, the following elements:

- o Details and results of all work performed during the designated period of time: records of field observations and data, boring and well construction logs, water level data, chain-of-custody forms, laboratory results for all samples collected and analyzed, tabulations of free product thicknesses and dissolved fractions, etc.
- o Status of ground water contamination characterization
- o Interpretation of results: water level contour maps showing gradients, free and dissolved product plume definition maps for each target component, geologic cross sections, etc.

Richard Quarante  
RE: 2401 Encinal Ave.  
June 10, 1992  
Page 3 of 3

- o Recommendations or plans for additional  
investigative work of remediation

All reports and proposals must be submitted under seal of a California-Registered Geologist, -Certified Engineering Geologist, or -Registered Civil Engineer. Please include a statement of qualifications for each lead professional involved with this project.

Please be advised that this is a formal request for technical reports pursuant to California Water Code Section 13267 (b). Any extensions of the stated deadlines, or modifications of the required tasks, must be confirmed in writing by either this agency or RWQCB.

If you have any questions or comments, please contact Juliet Shin at (510) 271-4320.

Sincerely,



Scott O. Seery, CHMM  
Senior Hazardous Materials Specialist

Attachment

cc: Richard Hiett, RWQCB

Gary Zaccor  
Zaccor Corporation  
791 Hamilton Avenue  
Menlo Park, CA 94025

File (JS)

DATE: 3/13/92

TO : Local Oversight Program

FROM: AMIR K. GHOJANI

SUBJ: Transfer of Eligible Oversight Case

Site name: ALAMEDA FIRE DEPARTMENT

Address: 2401 ENCINAL AVE City ALAMEDA Zip 94501

Closure plan attached?  Y  N DepRef remaining \$

DepRef Project # 1009 STID #(if any) 3948

Number of Tanks: 2 removed?  Y  N Date of removal 4 JUNE, 1990

Leak Report filed? Y  N Date of Discovery AUG 22, 1990

Samples received?  Y  N Contamination: YES

Petroleum  Y  N Types: Avgas Jet  leaded  unleaded  Diesel  
fuel oil waste oil kerosene solvents

Monitoring wells on site NO Monitoring schedule? Y  N

Briefly describe the following:

Preliminary Assessment TANKS REMOVED, SOIL CONTAMINATION OF TPHg & TPHf & BTX

Remedial Action NONE

Post Remedial Action Monitoring

Enforcement Action NONE

Comments:

Soil Contamination of TPHg & TPHf & BTX up to 85, 37, 12, .3, AND .6 PPM RESPECTIVELY  
SOUNDS LIKE MORE INVESTIGATION NEEDED TO  
DELIMIT EXTENT OF PLUME VERTICALLY &  
HORIZONTALLY AND WHETHER GROUNDWATER  
HAS BEEN IMPACTED.



ACCEPTED

DEPARTMENT OF ENVIRONMENTAL HEALTH  
470 - 27th Street, Third Floor  
Oakland, CA 94612  
Tel. phone: (415) 874-7237

ALAMEDA COUNTY HEALTH CARE SERVICES AGENCY  
DEPARTMENT OF ENVIRONMENTAL HEALTH  
HAZARDOUS MATERIALS DIVISION  
80 SWAN WAY, ROOM 200  
OAKLAND, CA 94621  
PHONE NO. 415/271-4320

These plans have been reviewed and found to be acceptable and are hereby accepted. The requirements of State and local health laws, codes and regulations indicated by this Department are to assure compliance with State and local laws. The project described herein is now released for issuance of any permits or other permits for construction.

One copy of these plans must be on the job and available to all contractors and craftsmen involved with the removal.

Approval of other plans or specifications may be required by this Department and to the Fire and Building Inspection Department to determine if such changes meet the requirements of State and local laws. Notify this Department at least 48 hours prior to the following required inspections:

- Removal of Tank and Piping
- Sampling
- Final Inspection

Receipt of a permit to operate is dependent on compliance with accepted plans and all applicable laws and regulations.

THERE IS A FINANCIAL PENALTY FOR NOT OBTAINING THESE INSPECTIONS.

*R. Check* 5/31/90

UNDERGROUND TANK CLOSURE/MODIFICATION PLANS

1. Business Name Alameda Fire Department  
Business Owner City of Alameda
2. Site Address 2401 Encinal Ave.  
City Alameda Zip 94501 Phone 415) 748-4601
3. Mailing Address 1300 Park Street  
City Alameda Zip 94501 Phone 415) 748-4601
4. Land Owner City of Alameda/Fire Department/ Robert Pogue  
Address 1300 Park Street, City, State CA Zip 94501  
Alameda
5. EPA I.D. No. CAC000283193
6. Contractor Zaccor Corporation  
Address 791 Hamilton Ave.  
City Menlo Park Phone 415) 363-2181  
License Type Class A ID# 478799
7. Consultant \_\_\_\_\_  
Address \_\_\_\_\_  
City \_\_\_\_\_ Phone \_\_\_\_\_

528909  
5-30-90  
#45000

8. Contact Person for Investigation

Name Gary Zaccor Title President  
Phone 363-2181

9. Total No. of Tanks at facility 2

10. Have permit applications for all tanks been submitted to this office?  
Yes [  ] No [  ]

11. State Registered Hazardous Waste Transporters/Facilities

a) Product/Waste Tranporter

Name Allied Oil and Pumping EPA I.D. No. CAT080014277  
Address P.O. Box 399  
City Alviso State CA Zip 95002

b) Rinsate Transporter

Name Allied Oil and Pumping EPA I.D. No. CAT080014277  
Address P.O. Box 399  
City Alviso State CA Zip 95002

c) Tank Transporter

Name Erickson, Inc. EPA I.D. No. CAD009466392  
Address 255 Parr Blvd.  
City Richmond State CA Zip 94801

d) Tank Disposal Site

Name Erickson, Inc. EPA I.D. No. CAD009466392  
Address 255 Parr Blvd.  
City Richmond State CA Zip 94801

e) Contaminated Soil Transporter

Name \_\_\_\_\_ EPA I.D. No. \_\_\_\_\_  
Address \_\_\_\_\_  
City \_\_\_\_\_ State \_\_\_\_\_ Zip \_\_\_\_\_

12. Sample Collector

Name Environmental Bio-Systems  
 Company Tim Babcock  
 Address 30028 Industrial Parkway, Southwest  
 City Hayward State CA Zip 94544 Phone 429-9988

13. Sampling Information for each tank or area

Tank or Area		Material sampled	Location & Depth
Capacity	Historic Contents (past 5 years)		
1-500	Gasoline	Soil	One sample to be collected beneath fill end of tank at the native soil/backfill interface " "
1-300	Diesel	Soil	
			One sample to be collected every 20 ft of piping

14. Have tanks or pipes leaked in the past? Yes  No  unknown

If yes, describe. \_\_\_\_\_  
 \_\_\_\_\_  
 \_\_\_\_\_

15. NFPA methods used for rendering tank inert? Yes  No

If yes, describe. triple rinse, hydroblast and dry ice at  
6.5 lbs per 100 gallons

An explosion proof combustible gas meter shall be used to verify tank inertness.

16. Laboratories

Name Mobile Chem Labs, Inc.  
 Address ~~1678 Reliez Valley Road~~ 733 Dartmouth Avenue  
 City ~~Lafayette~~ San Carlos State CA Zip ~~94549~~ 94070

Certified for  
8020  
TPH

State Certification No. ~~195~~ 289, valid until Oct 24, 1990

*All piping must be drained and flushed ~~into~~ into tanks before tanks inerted. Piping must then be removed or capped.*

17. Chemical Methods to be used for Analyzing Samples

Contaminant Sought	EPA, DHS, or Other Sample Preparation Method Number	EPA, DHS, or Other Analysis Number							
Diesel Fuel TPH D BTX+E	<del>Unknown</del> 3550 8020 or 8240 prep method	<del>EPA method 3550</del> 8015 GC/FID, DNS method 8020 or 8240							
Gasoline TPH G BTX+E	5030 8020 or 8240 prep method	GC/FID, DHS method 8020 or 8240							
<p>Detection limits must meet the following RWQCB levels:</p> <table style="margin-left: auto; margin-right: auto;"> <tr> <td>TPHG</td> <td>1.0 ppm</td> <td rowspan="3">} for soil</td> </tr> <tr> <td>TPH D</td> <td>1.0 ppm</td> </tr> <tr> <td>BTX E</td> <td>0.005 ppm</td> </tr> </table>			TPHG	1.0 ppm	} for soil	TPH D	1.0 ppm	BTX E	0.005 ppm
TPHG	1.0 ppm	} for soil							
TPH D	1.0 ppm								
BTX E	0.005 ppm								

18. Submit Site Safety Plan

19. Workman's Compensation: Yes [x] No [ ]

Copy of Certificate enclosed? Yes [x] No [ ]

Name of Insurer State Fund

20. Plot Plan submitted? Yes [x] No [ ]

21. Deposit enclosed? Yes [x] No [ ]

22. Please forward to this office the following information within 60 days after receipt of sample results.

- a) Chain of Custody Sheets
- b) Original Signed Laboratory Reports
- c) TSD to Generator copies of wastes shipped and received
- d) Attachment A summarizing laboratory results

I declare that to the best of my knowledge and belief the statements and information provided above are correct and true. I understand that information in addition to that provided above may be needed in order to obtain an approval from the Department of Environmental Health and that no work is to begin on this project until this plan is approved.

I understand that any changes in design, materials or equipment will void this plan if prior approval is not obtained.

I understand that all work performed during this project will be done in compliance with all applicable OSHA (Occupational Safety and Health Administration) requirements concerning personnel and safety.

\* } I will notify the Department of Environmental Health at least two (2) working days (48 hours) after approval of this closure plan in advance to schedule any required inspections. I understand that site and worker safety are solely the responsibility of the property owner or his agent and that this responsibility is not shared nor assumed by the County of Alameda.

Signature of Contractor

Name (please type) Gary A. Zaccor  
Signature Gary A. Zaccor  
Date 5/22/90

Signature of Site Owner or Operator

Name (please type) Robert Pogue  
Signature Robert L. Pogue Asst. Fire Chief  
Date May 24 1990

NOTES:

1. Any changes in this document must be approved by this Department.
2. Any leaks discovered must be submitted to this office on an underground storage tank unauthorized leak/contamination site report form within 5 days of its discovery.
3. Three (3) copies of this plan must be submitted to this Department. One copy must be at the construction site at all times.
4. After approval of plan, notification of at least two (2) working days (48 hours) must be given to this Department prior to removal of tank(s).
5. A copy of your approved plan must be sent to the landowner.
6. Triple rinse means that:
  - a) Final rinse must contain less than 100 ppm of Gasoline (EPA method 8020 for soil, or EPA method 602 for water) or Diesel (EPA method 418.1). Other methods for halogenated volatile organics (EPA method 8010 for soil, EPA method 601 for water) may be required. The composition of the final rinse must be demonstrated by an original or facsimile report from a laboratory certified for the above analyses.
  - b) Tank interior is shown to be free from deposits or residues upon a visual examination of tank interior.
  - c) Tank should be labelled as "tripled rinsed; laboratory certified analysis available upon request" with the name and address of the contractor.

If all the above requirements cannot be met, the tank must be transported as a hazardous waste.

7. Any cutting into tanks requires local fire department approval.

UNDERGROUND TANK CLOSURE/MODIFICATION PLANS

ATTACHMENT A  
SAMPLING RESULTS

Tank or Area	Contaminant	Location & Depth	Results (specify units)

## INSTRUCTIONS

### 2. SITE ADDRESS

Address at which closure or modification is taking place.

### 5. EPA I.D. NO.

This number may be obtained from the State Department of Health Services, 916/324-1781.

### 6. CONTRACTOR

Prime contractor for the project.

### 7. OTHER

List professional consultants here.

### 12. SAMPLE COLLECTOR

Persons who are collecting samples.

### 13. SAMPLING INFORMATION

Historic contents - the principal product(s) used in the last 5 years.

Material sampled - i.e., water, oil, sludge, soil, etc.

### 16. LABORATORIES

Laboratories used for chemical and geotechnical analyses.

### 17. CHEMICAL METHODS:

All sample collection methods and analyses should conform to EPA or DHS methods.

Contaminant - Specify the chemical to be analyzed.

Sample Preparation Method Number - The means used to prepare the sample prior to analyses - i.e., digestion techniques, solvent extraction, etc. Specify number of method and reference if not an EPA or DHS method.

Analysis Method Number - The means used to analyze the sample - i.e., GC, GC-MS, AA, etc. Specify number of method and reference if not a DHS or EPA method.

#### NOTE:

Method Numbers are available from certified laboratories.

### 18. SITE SAFETY PLAN

A plan outlining protective equipment and additional specialized personnel in the event that significant amount of hazardous materials are found. The plan should consider the availability of respirators, respirator cartridges, self-contained breathing apparatus (SCBA) and industrial hygienists.



19. ATTACH COPY OF WORKMAN'S COMPENSATION

20. PLOT PLAN

The plan should consists of a scaled view of the facility at which the tank(s) are located and should include the following information:

- a) Scale
- b) North Arrow
- c) Property Line
- d) Location of all Structures
- e) Location of all relevant existing equipment including tanks and piping to be removed
- f) Streets
- g) Underground conduits, sewers, water lines, utilities
- h) Existing wells (drinking, monitoring, etc.)
- i) Depth to ground water
- j) All existing tanks in addition to the ones being pulled

rev. 9/88  
mam

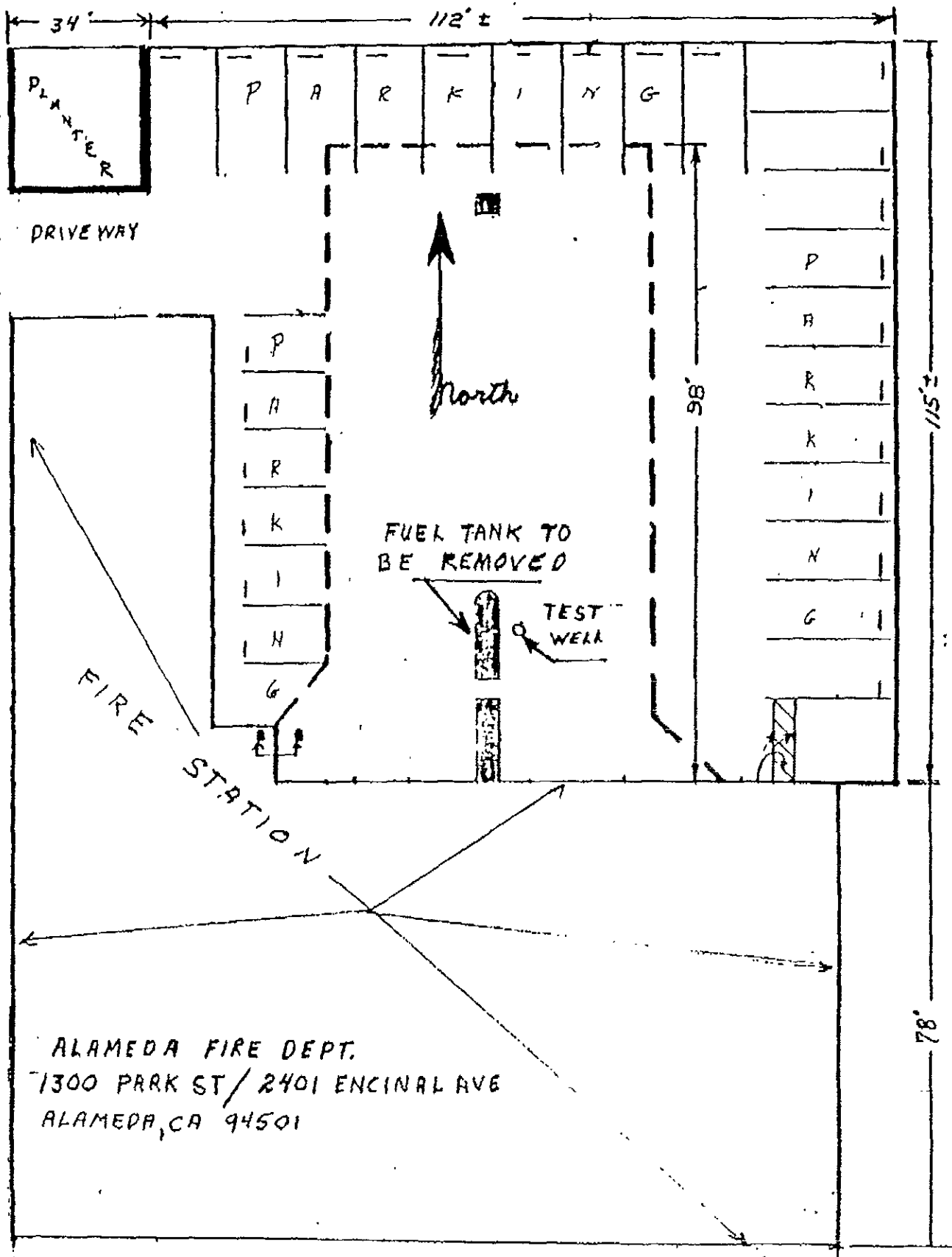

PLANKER

P A R K I N G

DRIVEWAY

North

FUEL TANK TO BE REMOVED

TEST WELL

FIRE STATION

ALAMEDA FIRE DEPT.  
1300 PARK ST / 2401 ENCINAL AVE  
ALAMEDA, CA 94501

ENCINAL AVE

PARK ST

115'

78'

98'

34'

112'

34' 112'

PLANTER

P A R K I N G

DRIVEWAY

North

98'

115'

P A R K S T

P  
A  
R  
K  
I  
N  
G

FUEL TANK TO BE REMOVED

TEST WELL

FIRE STATION

P  
A  
R  
K  
I  
N  
G

78'

ALAMEDA FIRE DEPT.  
1300 PARK ST / 2401 ENCINAL AVE  
ALAMEDA, CA 94501

ENCINAL AVE

## SITE SAFETY PLAN

1. Site to be barricaded prior to excavation and warning signs and/or tape labeled NO SMOKING UNDERGROUND TANK TEST and CAUTION OPEN TRENCH put around areas of excavation.
2. All personnel from Zaccor Corporation will have hard hats, rubber gloves, eye protection and disposable coveralls (if needed)
3. All personnel will have cartridge type respirators.
4. Gastech 1314 Vapor Meter supplied by Zaccor Corporation will be present. A second Gastech will be supplied by Environmental Bio-Systems during sampling.
5. Air Quality Control Board will be notified prior to excavation.
6. Underground Service Alert will be contacted prior to excavation for underground utilities.
7. Zaccor Corporation will supply an industrial hygienist only in the event of large scale remediation requirements.

Utter: Kuthrune

**STATE  
COMPENSATION  
INSURANCE  
FUND**

P.O. BOX 807, SAN FRANCISCO, CA 94101-0807

**CERTIFICATE OF WORKERS' COMPENSATION INSURANCE**

March 29, 1990

POLICY NUMBER: 801858-90  
CERTIFICATE EXPIRES: 03-15-91

Alameda County Environmental Health  
80 Swan Wy Rm 200  
Oakland, Ca 94621

This is to certify that we have issued a valid Workers' Compensation insurance policy in a form approved by the California Insurance Commissioner to the employer named below for the policy period indicated.

This policy is not subject to cancellation by the Fund except upon <sup>30</sup>~~ten~~ days' advance written notice to the employer.

We will also give you <sup>30</sup>~~TEN~~ days' advance notice should this policy be cancelled prior to its normal expiration.

This certificate of insurance is not an insurance policy and does not amend, extend or alter the coverage afforded by the policies listed herein. Notwithstanding any requirement, term, or condition of any contract or other document with respect to which this certificate of insurance may be issued or may pertain, the insurance afforded by the policies described herein is subject to all the terms, exclusions and conditions of such policies.

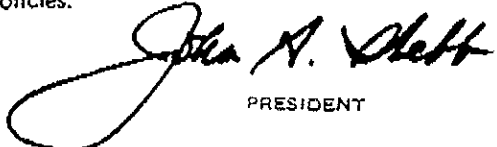
  
PRESIDENT

ENDORSEMENT #2065 ENTITLED CERTIFICATE HOLDERS' NOTICE  
EFFECTIVE 03-15-90 IS ATTACHED TO AND FORMS A PART OF THIS POLICY.

EMPLOYER

Zaccor Companies Inc  
791 Hamilton Ave  
Menlo Park, Ca 94025



THIS CERTIFICATE IS ISSUED AS A MATTER OF INFORMATION ONLY AND CONFERS NO RIGHTS UPON THE CERTIFICATE HOLDER. THIS CERTIFICATE DOES NOT AMEND, EXTEND OR ALTER THE COVERAGE AFFORDED BY THE POLICIES BELOW.

NAME AND ADDRESS OF AGENCY:

Robert B. Suhr & Co.  
 P. O. Box 448  
 Santa Clara, CA 95052  
 FAX (408)244-7981

COMPANIES AFFORDING COVERAGE:

COMPANY A: Fireman's Ins. Co. via  
 COMPANY B: Swett and Crawford  
 COMPANY C:  
 COMPANY D:  
 COMPANY E:

NAME AND ADDRESS OF INSURED:

The Zaccor Companies Inc  
 791 Hamilton Avenue  
 Menlo Park, California  
 94025

CODE: SUB CODE:

==== COVERAGES =====

THIS IS TO CERTIFY THAT POLICIES OF INSURANCE LISTED BELOW HAVE BEEN ISSUED TO THE INSURED NAMED ABOVE FOR THE PERIOD INDICATED. NOTWITHSTANDING ANY REQUIREMENT, TERM OR CONDITION OF ANY CONTRACT OR OTHER DOCUMENT WITH RESPECT TO WHICH THIS CERTIFICATE MAY BE ISSUED OR MAY PERTAIN, THE INSURANCE AFFORDED BY THE POLICIES DESCRIBED HEREIN IS SUBJECT TO ALL TERMS, EXCLUSIONS, AND CONDITIONS OF SUCH POLICIES. LIMITS SHOWN MAY HAVE BEEN REDUCED BY PAID CLAIMS.

COMP LETTER	TYPE OF INSURANCE	POLICY NUMBER	EFFECTIVE/EXPIRATION DATE	LIMITS OF LIABILITY IN THOUSANDS (000)
A	GENERAL LIABILITY	F89CF00852		
X	COMMERCIAL GENERAL LIABILITY		12/31/89 TO 12/31/90	
				GENERAL AGGREGATE: \$ 1,000
X	CLAIMS MADE OCCURRENCE			PRODUCTS COMPO OPS AGG: \$ 1,000
	OWNERS & CONTRACTORS PROTECTIVE			PERSONAL & ADVERTISING INJURY: EACH OCCURRENCE: \$ 1,000
				FIRE DAMAGE (ANY 1 FIRE): \$ 50, MEDICAL EXPENSE (ANY 1 PERSON):
	AUTOMOBILE LIABILITY			
	ANY AUTO	TO		CSL, BI: (EACH PERSON)
	ALL OWNED AUTOS			
	SCHEDULED AUTOS			
	HIRED AUTOS			
	NON-OWNED AUTOS			BI: (EACH ACCIDENT)
	GARAGE LIABILITY			PROPERTY DAMAGE:

COMP LETTER	TYPE OF INSURANCE	POLICY NUMBER	EFFECTIVE/EXPIRATION DATE	LIMITS OF LIABILITY IN THOUSANDS (000) EA. OCCUR./AGGREGATE
-------------	-------------------	---------------	---------------------------	---

EXCESS LIABILITY TO

OTHER THAN UMBRELLA FORM

WORKERS' COMPENSATION AND EMPLOYERS' LIABILITY TO \*STATUTORY\*

EACH ACCIDENT:  
DISEASE POLICY LIMIT:  
DISEASE EACH EMPLOYEE:

OTHER TO :

DESCRIPTION OF OPERATIONS/LOCATIONS/VEHICLES/SPECIAL ITEMS:

CANCELLATION

SHOULD ANY OF THE ABOVE DESCRIBED POLICIES BE CANCELLED BEFORE THE EXPIRATION DATE THEREOF, THE ISSUING COMPANY WILL ENDEAVOR TO MAIL 10 DAYS WRITTEN NOTICE TO THE BELOW NAMED CERTIFICATE HOLDER, BUT FAILURE TO MAIL SUCH NOTICE SHALL IMPOSE NO OBLIGATION OR LIABILITY OF ANY KIND UPON THE COMPANY, ITS AGENTS OR REPRESENTATIVES.

CERTIFICATE HOLDER

Alameda County  
Environmental Health  
80 Swan Way #200  
Oakland, California 94621

DATE ISSUED: 03/29/90

*M. Raymond*  
AUTHORIZED REPRESENTATIVE

RECEIVED  
MAR 30 1990