



General Services Agency

Darlene A. Smith, Director

January 11, 1995

Mr. Robert Weston
Hazardous Materials Specialist
Alameda County Health Care Services Agency
Department of Environmental Health
1131 Harbor Bay Parkway, Second Floor
Alameda, California 94502

**SUBJECT: FINAL CLOSURE REPORT FOR UNDERGROUND STORAGE TANKS,
UST-9072-2 AND UST-9072-3, JUVENILE HALL,
2200 FAIRMONT DRIVE, SAN LEANDRO, CALIFORNIA 94578**

Dear Mr. Weston:

Enclosed are two copies of the *December 30, 1994 UST Closure Report, Juvenile Hall, 2200 Fairmont Drive, San Leandro, California*. This report was prepared by Environmental Science & Engineering, Inc., the project's environmental consultant, documenting (1) the removal of one fuel oil underground storage tank, referred to as UST-9072-2, on October 11, 1994, and (2) the removal of impacted soil from the adjacent former diesel underground storage tank site referred to as UST-9072-3, also on October 11, 1994.

Please note Environmental Science & Engineering, Inc. is recommending the following:

- Since the laboratory results from the soil samples taken from the bottom of the over-excavated pit at the former UST-9072-2 and UST-9072-3 site, indicated that both TPH-D and BTEX were "non-detect", no further investigation be required for the UST-9072-2 and UST-9072-3 site.
- The installation of monitoring wells not be required to be installed, and
- Formal site closure for the UST-9072-2 and UST-9072-3 site be granted.

Mr. Robert Weston

Page 2

January 11, 1995

Thus, on behalf of Alameda County, I hereby request site closure be granted for the UST-9072-2 and UST-9072-3 site. Should you have any questions regarding this report or the Juvenile Hall project, please feel free to call me at (510) 208-9521.

I want to thank you, Mr. Tom Peacock, Ms. Jennifer Eberle, and Mr. Jeff Shapiro for allowing Alameda County to over-excavate the impacted soil at the former UST- 9072-3 location at the same time as we removed tank UST-9072-2. I appreciate the continued cooperation, flexibility demonstrated by Environmental Health, and the continued team effort to accomplish these difficult, challenging projects.

Sincerely,



Andrew B. Garcia, REA
Environmental Project Manager

enclosure

cc: Mr. Jay Carpenter, Environmental Science & Engineering, Inc. - w/o

ABG,abg.g\project\env\7076jh\eh0111
File: 947076 Bldg. 9072,
File: 937041 Bldg. 9072



Environmental
Science &
Engineering, Inc.

JAN 03 1995

December 30, 1994

7000 gal UST

Mr. Andrew B. Garcia, REA
Environmental Project Manager
County of Alameda
General Services Agency
Engineering and Environmental Management Department
1401 Lakeside Drive
Oakland, CA 94612

**SUBJECT: UST CLOSURE REPORT
JUVENILE HALL
2200 FAIRMONT DRIVE
SAN LEANDRO, CALIFORNIA
ESE PROJECT NO. 6-94-5257**

Dear Mr. Garcia:

Environmental Science and Engineering, Inc. (ESE) is pleased to provide this closure report for the underground storage tank (UST) formerly located at the subject facility. This report serves to document the removal and disposal of the UST. ESE presents this report in accordance with Alameda County Health Care Services Agency (ACHCSA) UST Closure Permit requirements. The following information is submitted in support of this UST closure.

ESE was authorized by the Alameda County General Services Agency (GSA), to effect the removal of the UST located at the subject facility (Figure 1 - Location Map) under Work Order No. 141-A-0049-00.

UST HISTORY

Located on Alameda County property was one 7,000 gallon (9-foot diameter, 14-foot long) fuel oil UST adjacent to the Juvenile Court building (Figure 2 - Site Map). The UST was constructed of single-wall, carbon-steel and coated with tar. The UST stored fuel oil for a boiler located in the Juvenile Court building.

UST CLOSURE ACTIVITIES

- Permits for the UST removal were procured by ESE from ACHCSA and the Alameda County Fire Department (ACFD). Notification was sent to Bay Area Air Quality Management District (AQMD) and the California Occupational Safety and Health

Administration (CALOSHA). Also, the State of California State Water Resources Control Board (WRCB) Forms A and B were completed and submitted. A copy of the cover sheet for the ACHCSA permit, ACFD permit, application forms A and B, AQMD, CALOSHA notification are attached in Appendix A

- On Monday, October 10, 1994, approximately 100 cubic yards of soil was excavated in an attempt to free the UST from the excavation (Figure 3). This soil was temporarily stockpiled on plastic near the excavation and in an area pre-approved by GSA. The fills, product supply, product return, and vent piping were cut at the excavation wall. 100 yds
- The UST internal atmosphere was rendered inert by the addition of 150 pounds of dry ice. In the presence of Robert Weston of ACHCSA and Deputy Fire Marshall Edward Laudani of ACFD, an effort was made to remove the UST from the excavation, but because of soil overburden underneath the existing sidewalk the UST could not be removed.

Soil samples (SP-1-10, SP-1-5, SP-2, and SP-3) were collected from approximately every 20 cubic yards of stockpile generated during the excavation. These samples were collected in a clean 2-inch diameter brass ring. The ring was driven into native soil until filled. The brass sampling ring ends were covered with Teflon sheets, plastic end caps and sealed with duct tape. These samples were placed in a cooler with ice and transported to McCampbell Analytical, Inc. a California Department of Health Services certified analytical laboratory.

- On Tuesday, October 11, 1994, an additional 50 cubic yards of soil was excavated to free the UST from the excavation (Figure 3). The UST internal atmosphere was again rendered inert by the addition of 150 pounds of dry ice. In the presence of Jennifer Eberle of ACHCSA and Deputy Fire Marshall Edward Laudani of ACFD, the UST was lifted from the excavation and loaded onto a flatbed truck. The UST was inspected and found to have perforations on the north end and top. However stained soil was not observed. The UST and associated piping were manifested as hazardous waste, and transported to Erickson, Inc. of Richmond, California, a state-licensed transportation, storage, and disposal facility (TSDF). A copy of the UST manifest and certificate of destruction indicating final acceptance and disposal, are attached in Appendix B. 50 yds
7000
gallon
fuel oil
- The final dimensions of the UST excavation was 19 feet by 14 feet by 20 feet in depth (Figure 3). The UST top was located 11 feet below ground surface (bgs). Soil within the excavation from the surface to 20 feet below grade consisted of a brown silty clay. Odors or staining of the soil surrounding the UST were not detected during field observation. No ground water was found during excavation. 19 x 14 x 20' deep

- On completion of the UST removal, three soil samples (T1-1-NE, T1-2-NE, and T2-20') were collected on October 11, 1994 by ESE personnel from the floor of the excavation. Sample collection was directed by the ACHCSA representative at the location shown on Figure 4 - Sampling Plan. The samples were collected at a depth of 22 feet bgs at the north end of the UST excavation and at 20 feet bgs at the south end of the UST excavation. A second sample was collected from the north (T1-2-NE) at the request of GSA. The soil samples were collected from the excavator bucket in a clean 2-inch diameter brass ring. The ring was driven into native soil until filled. The brass sampling ring ends were covered with Teflon sheets, plastic end caps and sealed with duct tape. These samples were placed in a cooler with ice and transported to McCampbell Analytical, Inc. a California Department of Health Services certified analytical laboratory. All samples were analyzed by the following methods:

- EPA Method 8015M for total petroleum hydrocarbons as diesel (TPH-D);
- EPA Method 8020 for benzene, toluene, ethylbenzene, and xylenes (BTEX).

- Analysis of the soil samples, T1-1-NE, T1-2-NE, and T2-20', collected from the excavation floor indicated that concentrations of TPH-D ranged non detectable at reporting limits of 10 milligrams per Kilogram (mg/Kg) to 4,800 mg/Kg in sample T1-2-NE. Benzene was non detectable at reporting limits of 0.005 mg/Kg. Toluene ranged from non detectable to 0.033 mg/Kg, ethylbenzene from non detectable to 0.45 mg/Kg and xylenes from non detectable to 0.65 mg/Kg. Copies of laboratory analyses are attached as Appendix C.

- Also on October 11, 1994 diesel impacted soil was encountered in the north side of the excavation. This soil had been impacted by a 325 gallon diesel fuel UST that was removed from the site in July 1993. An additional 100 cubic yards of soil was overexcavated from this area and stockpiled on plastic sheeting separately from previous stockpiles. Three samples were collect during overexcavation from the north end of the excavation (~~T3-N-23', T4-N-20', and T5-N-23'~~) as directed by the ACHCSA representative. Sample T4-N-20' appeared to be impacted with diesel fuel so an additional ten cubic yards of soil was removed prior to collecting sample T5-N-23'. These samples were collected in same manner as stated above.

325
gallon
diesel
(193)
100 yds

Analysis of the soil samples, T3-N-23', T4-N-20', and T5-N-23', collected from the north end of the excavation indicated that concentrations of TPH-D ranged from nondetectable in samples T3-N-23' and T5-N-23' to 1,000 mg/Kg in sample T4-N-20'. BTEX was not detected.

- One composite sample, designated SP-COMP was collected on October 11, 1994 from the remaining unsampled area of the stockpile where previous samples SP-1-10, SP-1-5, SP-2, and SP-3 were collected. Samples SPT-1-COMP, SPT-2-COMP, and SPT-3-1 to 4 were collected from the stockpile generated during overexcavation activities. All samples were collected under the direction of the ACHCSA representative with the samples being sealed in the same manner as stated above. These samples were placed in a cooler with ice and transported to McCampbell Analytical, Inc. a California Department of Health Services certified analytical laboratory. All samples were analyzed for TPH-D and BTEX.

The analysis of the four point composite sample, SP-1-10, SP-1-5, SP-2, SP-3 and SP-COMP from the soil stockpile indicated that concentrations of TPH-D ranged non detectable to 11 mg/Kg and BTEX were not detected. Copies of laboratory reports and chain of custody documentation are attached in Appendix C.

- The UST excavation was backfilled on October 12 and 13, 1994 using stockpiled soils and 3/4" crushed rock. The crushed rock was placed in the excavation to a depth of 5 feet bgs. Clean stockpiled soil was then placed in shallow lifts and mechanically compacted to grade. The area was graded to match the ground surface.
- On November 4, 1994 approximately 252 tons of soil was loaded, transported, and recycled at Post Costa Materials (PCM) located in Port Costa, California. PCM is a state licensed recycling facility. Copies of the waste manifest and bill of lading records are included in Appendix D.

RECOMMENDATIONS

Initial analytical results of soil samples collected beneath the UST indicated elevated concentrations of TPH-D and BTEX in the north end of the excavation, however soil samples collected after additional excavation (T3-N-23' and T5-N-23') was accomplished indicated that TPH-D and BTEX were not detected.

ESE recommends that further investigation not be performed involving this UST and the previous 325 gallon UST, also that the installation and monitoring of ground water not be required. A written closure of these UST should be granted by ACHCSA. Please forward two copies of this report to the ACHCSA.

Mr. Garcia/GSA
December 30, 1994
page 5

o o O o o

ESE appreciates the opportunity to perform this scope of work. Please contact Jay Carpenter at (510) 685-4053 with any questions regarding this project.

Sincerely,
ENVIRONMENTAL SCIENCE & ENGINEERING, INC.

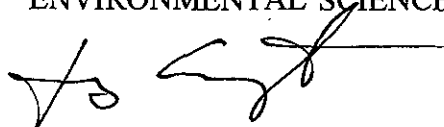

Jay Carpenter
Construction Manager

Susan S. Wickham
Susan S. Wickham R.G. 3851
Senior Geologist

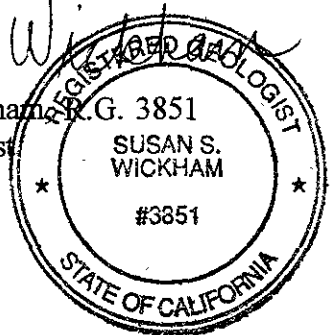

Attachments -

Figures

Appendix A - Permit Applications

Appendix B - UST Manifest and Certificate of Destruction

Appendix C - Laboratory Reports and Chain of Custody Documentation

Appendix D - Waste Manifest and Bill of Lading Records

FIGURES

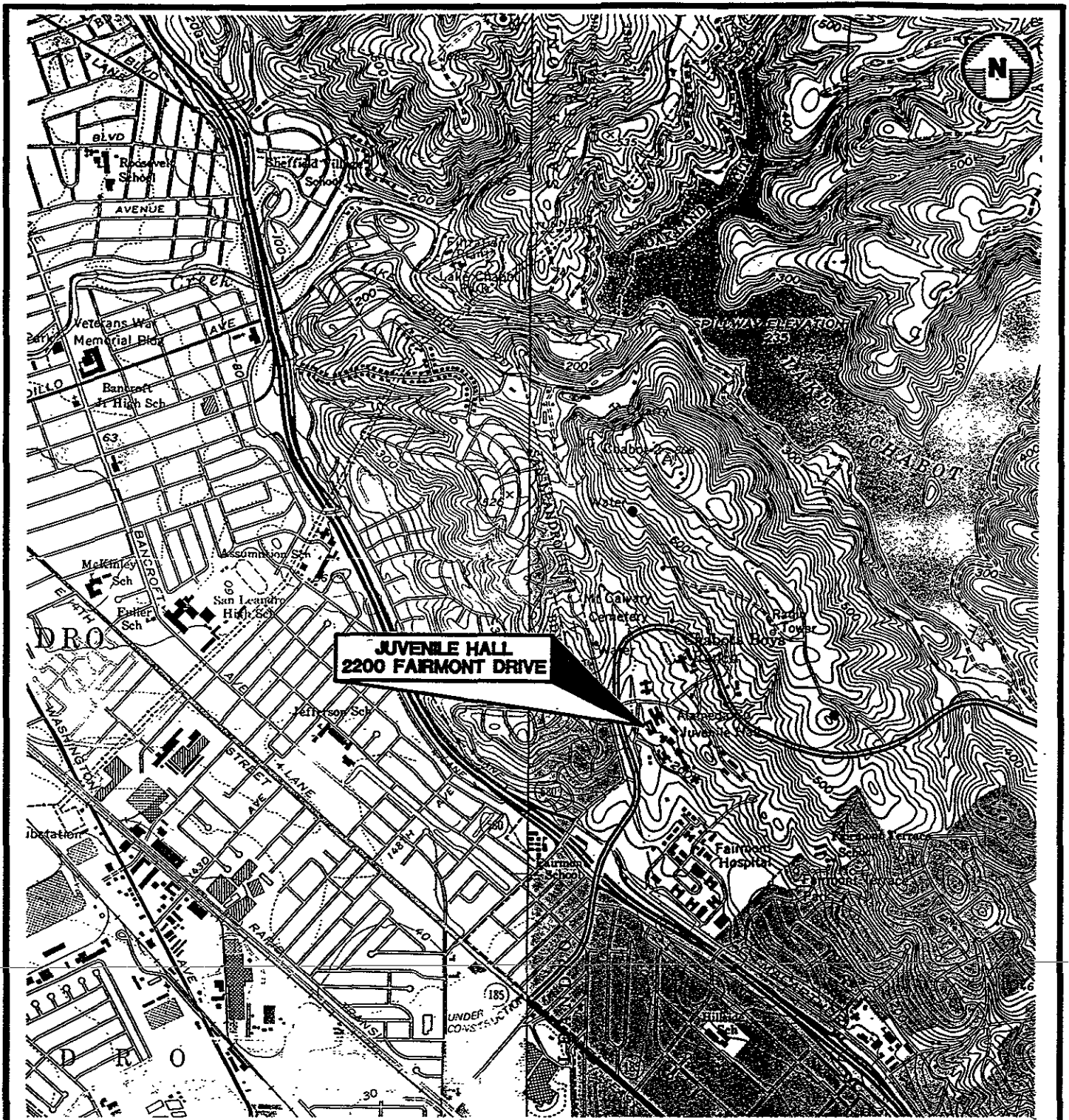

**JUVENILE HALL
2200 FARMONT DRIVE**

SCALE 1:24,000

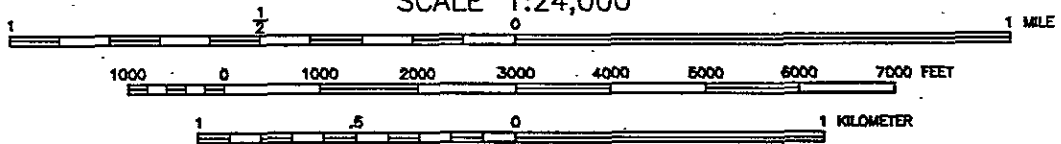

ADAPTED FROM U.S.G.S. HAYWARD AND SAN LEANDRO 7.5 MINUTE TOPOGRAPHIC QUADRANGLES, 1980.

 Environmental Science & Engineering, Inc.	DATE 11/28/94	LOCATION MAP	FIGURE NO. 1
	REVISED		PROJ. NO. 6-94-5257
4090 NELSON AVENUE, SUITE J CONCORD, CA 94520	CAD FILE 52570003	ALAMEDA COUNTY GENERAL SERVICES AGENCY ALAMEDA COUNTY JUVENILE HALL SAN LEANDRO, CALIFORNIA	

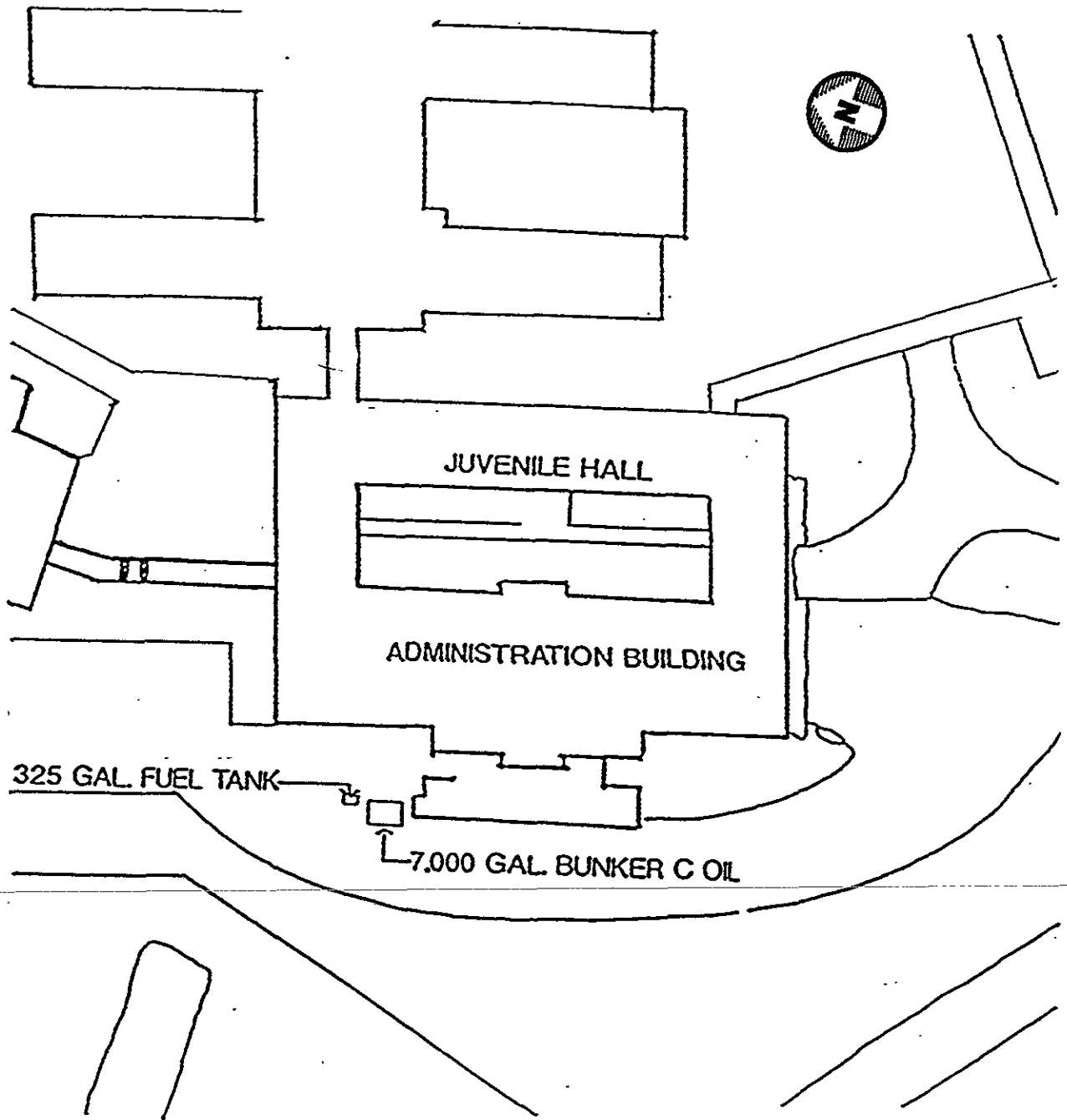

 Environmental Science & Engineering, Inc. <small>A GEACORP Company</small>	DATE 11/28/94	SITE MAP	FIGURE NO. 2
	REVISED		PROJ. NO. 6-94-5257
4090 NELSON AVENUE, SUITE J CONCORD, CA 94520	CAD FILE 52570004	ALAMEDA COUNTY GENERAL SERVICES AGENCY ALAMEDA COUNTY JUVENILE HALL SAN LEANDRO, CALIFORNIA	

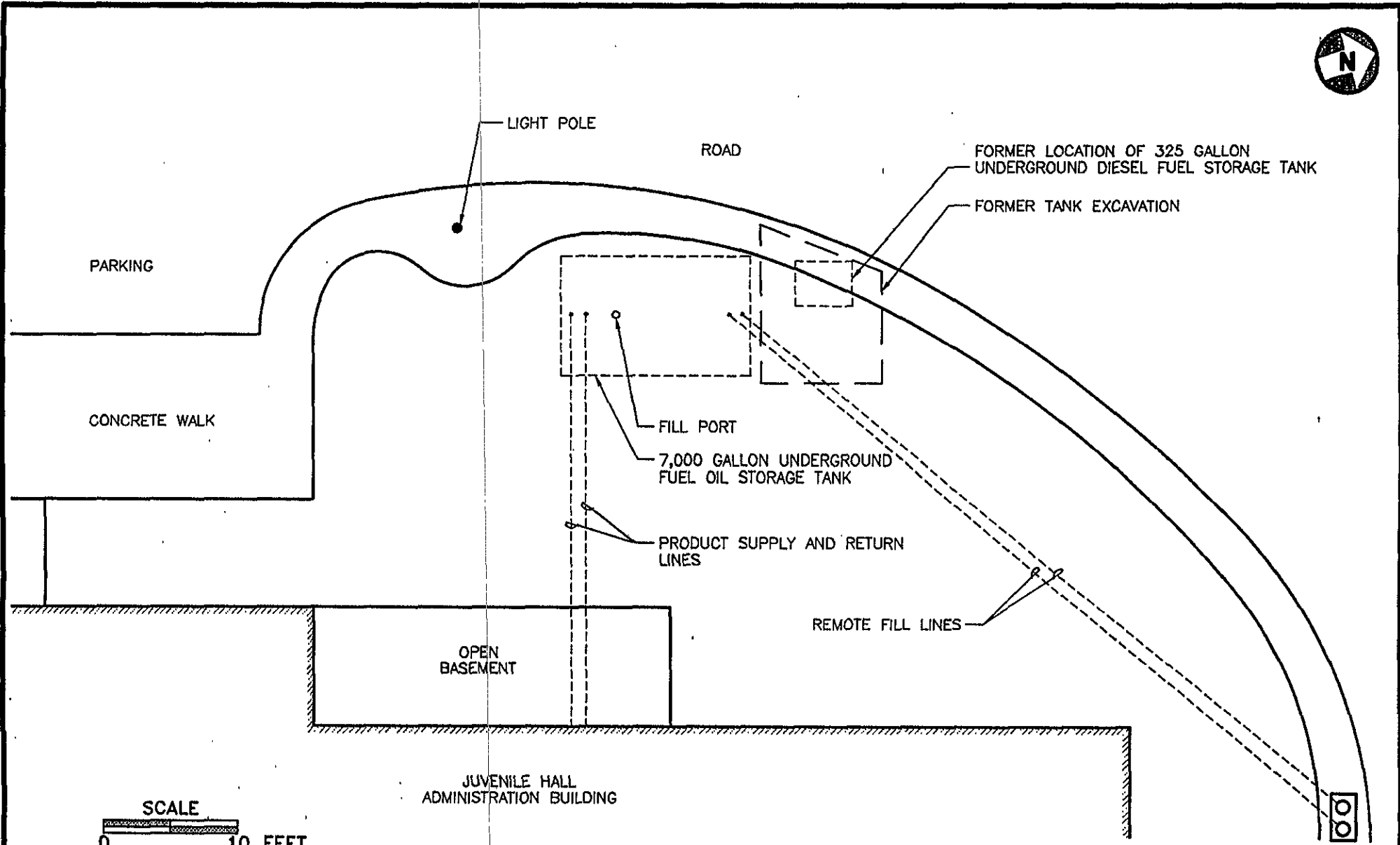

SCALE
 0 10 FEET

	Environmental Science & Engineering, Inc.	DATE 10/21/94	TANK REMOVAL PLAN	FIGURE NO. 3
	4090 NELSON AVENUE, SUITE J CONCORD, CA 94520	REVISED 10/27/94		ALAMEDA COUNTY GENERAL SERVICES AGENCY ALAMEDA COUNTY JUVENILE HALL SAN LEANDRO, CALIFORNIA

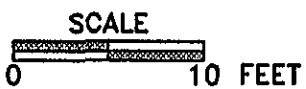
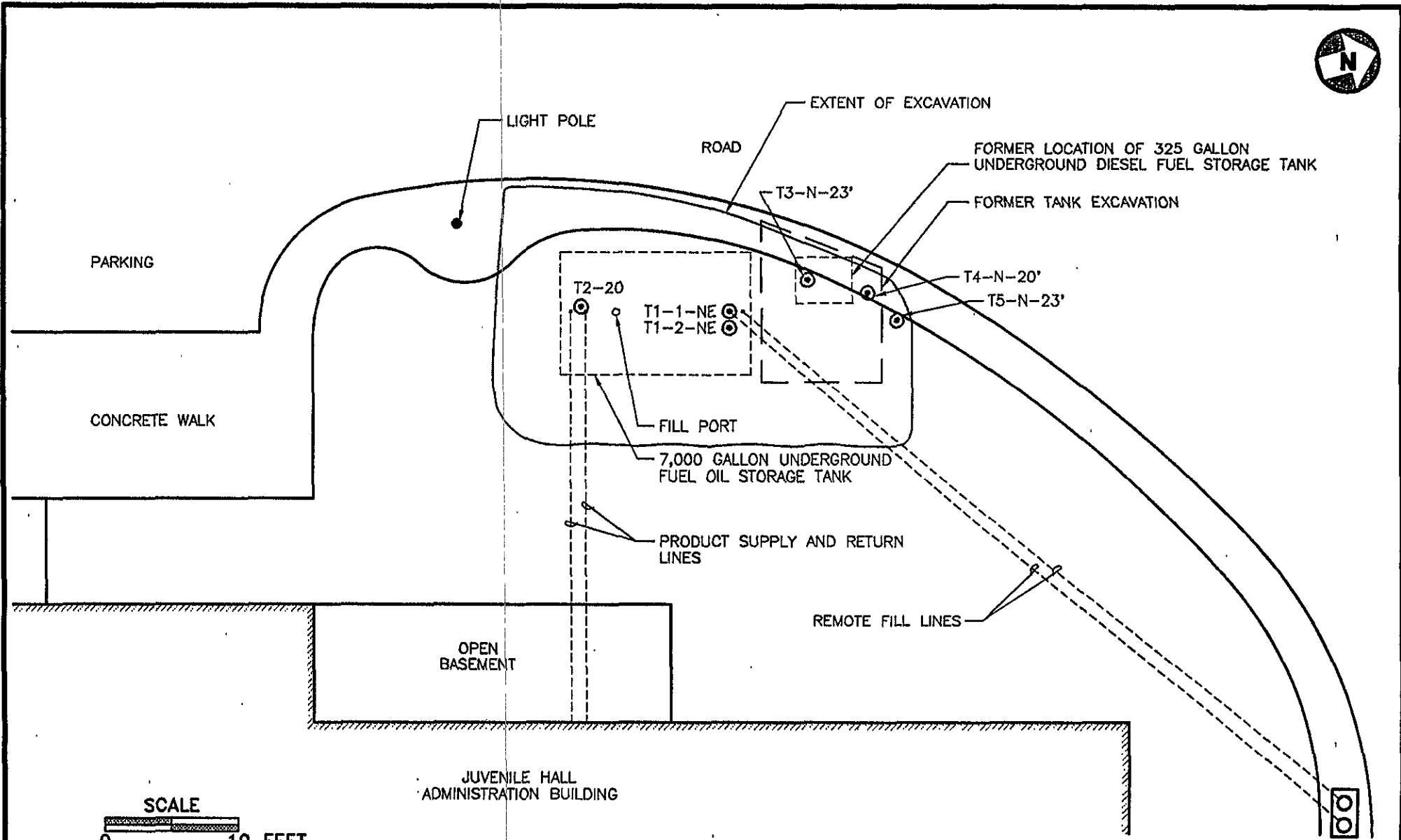

LEGEND
 ⊙ SOIL SAMPLE LOCATION

 Environmental Science & Engineering, Inc. <small>A GEACORP Company</small>	DATE 10/27/94	SAMPLING PLAN	FIGURE NO. 4
	REVISED		ALAMEDA COUNTY GENERAL SERVICES AGENCY ALAMEDA COUNTY JUVENILE HALL SAN LEANDRO, CALIFORNIA
	4090 NELSON AVENUE, SUITE J CONCORD, CA 94520	CAD FILE 52570002	

APPENDIX A
PERMIT APPLICATIONS

ALAMEDA COUNTY FIRE DEPARTMENT

APPLICATION #

94-3009
94-1071

FIRE DEPARTMENT/PLANS APPLICATION

FIRE MARSHAL'S OFFICE

1426 164th Avenue

San Leandro, CA 94578

510-670-5853 • FAX 510-276-5915

APPLICATION TYPE: Tank closureDATE REC'D: 10/6/94BY: 

CATEGORY: _____

PROJECT INFORMATION

PROJECT ADDRESS: 2200 Fairmont Dr. CROSS STREET: _____CITY: San Leandro ZIP: 94578 JOB PHONE: (510) 667-4499

APN #: _____ SDR #: _____ PM/TRACT MAP #: _____

DESCRIPTION OF WORK/ACTIVITY:

Underground Tank Removal BUILDING PERMIT #: _____

APPLICANT

NAME: Paul Marsden PHONE # (H): (510) 822-3559 (W): (510) 685-4053ADDRESS: 4090 Nelson Ave. # J Concord CA. ZIP: 94520

OWNER

NAME: Alameda County General Services Agency PHONE # (H): _____ (W): _____ADDRESS: 1401 Lakeside Dr. Oakland CA. ZIP: 94612

CONTRACTOR

NAME: Environmental Science & Eng. PHONE # (H): _____ (W): (510) 685-4053ADDRESS: 4090 Nelson Ave. ZIP: 94520CONTRACTOR'S LICENSE TYPE & NUMBER: Gen. A w/HAZ ID # 658077

APPLICANT TO FILL IN THESE SECTIONS

APPLICANT'S SIGNATURE: Paul Marsden DATE: 10/6/94

FOR OFFICE ONLY

FEES

Fees are due and payable by check or money order, made out to Alameda County Fire Department, upon submittal of plans and application. If additional fees are required, such shall be paid prior to issuance of a Certificate of Occupancy, project final, or a Fire Permit.

BASE FEE REQUIRED: \$ 800 (4221) REC'D BY:  DATE: 10/6/94

CONSULTANT'S FEE: \$ _____ REC'D BY: _____ DATE: _____

ADDITIONAL FEES: \$ _____ REC'D BY: _____ DATE: _____

APPROVALS

FIRE PERMIT #: _____ ISSUED DATE: _____ EXPIRATION DATE: _____

PERMIT ISSUED BY: _____ DATE: _____ FEE: _____

APPLICATION/PLANS APPROVAL: _____ BY: _____ DATE: _____

ALAMEDA COUNTY HEALTH CARE SERVICES AGENCY
DEPARTMENT OF ENVIRONMENTAL HEALTH
HAZARDOUS MATERIALS DIVISION

1131 HARBOR BAY PARKWAY, STE 250
ALAMEDA, CA 94502-6577
TELE: (510) 567-6700
FAX: (510) 337-9335

ACCEPTED

Underground Storage Tank Closure Permit Application

Alameda County Division of Hazardous Materials

80 Swan Way, Suite 200,
Oakland, CA 94612

Telephone (510) 271-4790

These closure/removal plans have been received and found to be acceptable and essentially meet the requirements of State and Local Health Laws. Changes to your closure plans indicated by this Department are to assure compliance with State and local laws. The project proposed herein is now released for issuance of any required building permits for construction/destruction.

One copy of the accepted plans must be on the job and available to all contractors and subcontractors involved with the removal.

Any changes or alterations of these plans and specifications must be submitted to this Department and to the Fire and Building Inspections Department to determine if such changes meet the requirements of State and local laws.

Notify this Department at least 72 hours prior to the following required inspections: *

- Removal of Tank(s) and Piping
- Sampling
- Final Inspection

Completion of a) permit to operate, b) permanent site closure, dependent on compliance with accepted plans and all applicable laws and regulations.

*THERE IS A FINANCIAL PENALTY FOR NOT OBTAINING THESE INSPECTIONS!

Contact Specialist

ROBERT WESTON

567-6781

SEE ITEMS IN PAD

UNDERGROUND TANK CLOSURE PLAN

* * * Complete according to attached instructions * * *

1. Business Name Juvenile Hall

Business Owner Alameda County General Services Agency

2. Site Address 2200 Fairmont Drive

City San Leandro Zip 94578 Phone (510) 667-4499

3. Mailing Address 1401 Lakeside Drive

City Oakland Zip 94612 Phone (510) 208-9521

4. Land Owner Alameda County General Services Agency

Address 1401 Lakeside Drive City, State Oakland, CA Zip 94612

5. Generator name under which tank will be manifested _____

Alameda County General Services Agency

EPA I.D. No. under which tank will be manifested CAL000088555

BLDG 90721

80 Swan Way, #200
Oakland, CA 94621
(415) 271-4320

ALAMEDA COUNTY, DEPARTMENT OF ENVIRONMENTAL HEALTH

Hazardous Materials Inspection Form

II, III

white - env. health
yellow - facility
pink - files

Site ID # _____ Site Name Alameda County Juvenile Hall Today's Date 10/11/94

Site Address 2200 Fairmont Dr.

City San Leandro Zip 94 Phone _____

MAX AMT stored > 500 lbs, 55 gal., 200 cft.?

Inspection Categories:

- I. Haz. Mat/Waste GENERATOR/TRANSPORTER
 - II. Business Plans, Acute Hazardous Materials
 - III. Underground Tanks
- Removal of 7K fuel oil (Bunker C) UST

Calif. Administration Code (CAC) or the Health & Safety Code (HS&C)

10:05 arrived on site
 Comments: Met Jay Carpenter of ESE. Soil is stockpiled in another area of site in 2 areas, w/ 100 yd + ~130 yd³. It's being sampled 1 per 20 yd³ for reuse. A trench box is used shoring for safety purposes. 10:45 Ed Land of AlCo Fire Dept. Trench box removed. Removal of UST: sq wall steel, one #1" diameter hole on N end (see photo); one 1" diam. hole on top. Four more sizable holes (1/2-1" diam) on N side near top. Jay thinks UST was pump ~1 yr ago. Erickson transported UST in manifest # 93480991. Tank painted # 14686. It's 18' bas to tank invert. 11:45 Took samples below UST. See attached map. Piping was also hauled by Erickson. Remove full pipe has holes. Pit will be further excavated (N end) + resampled. Left site.

II.A BUSINESS PLANS (Title 19)

- 1. Immediate Reporting 2703
- 2. Bus. Plan Sids 25503(b)
- 3. RR Cars > 30 days 25503.7
- 4. Inventory Information 25504(c)
- 5. Inventory Complete 2730
- 6. Emergency Response 25504(b)
- 7. Training 25504(c)
- 8. Deficiency 25505(a)
- 9. Modification 25505(b)

II.B ACUTELY HAZ. MATLS

- 10. Registration Form Filed 25533(a)
- 11. Form Complete 25533(b)
- 12. RMPP Contents 25534(c)
- 13. Implement Sch. Req'd? (Y/N)
- 14. OnSite Conseq. Assess. 25524(c)
- 15. Probable Risk Assessment 25534(d)
- 16. Persons Responsible 25534(a)
- 17. Certification 25534(m)
- 18. Exemption Request? (Y/N) 25536(b)
- 19. Trade Secret Requested? 25538

III. UNDERGROUND TANKS (Title 23)

- 1. Permit Application 25284 (H&S)
- 2. Pipeline Leak Detection 25292 (H&S)
- 3. Records Maintenance 2712
- 4. Release Report 2651
- 5. Closure Plans 2670
- 6. Method
 - 1) Monthly Test
 - 2) Daily Vadose
 - Semi-annual groundwater
 - One time sots
 - 3) Daily Vadose
 - One time sots
 - Annual tank test
 - 4) Monthly Gndwater
 - One time sots
 - 5) Daily Inventory
 - Annual tank testing
 - Cont pipe leak det
 - Vadose/gndwater mon.
 - 6) Daily Inventory
 - Annual tank testing
 - Cont pipe leak det
 - 7) Weekly Tank Gauge
 - Annual tank test
 - 8) Annual Tank Testing
 - Daily Inventory
 - Other
- 7. Precs Tank Test 2643
 - Date: _____
- 8. Inventory Rec. 2644
- 9. Sol Testing 2646
- 10. Ground Water 2647
- 11. Monitor Plan 2632
- 12. Access: Secure 2634
- 13. Plans Submit 2711
 - Date: _____
- 14. As Built 2635
 - Date: _____

General

Monitoring for Existing Tanks

New Tanks

Rev 6/88

Contact: ANDREW B. GARCIA Inspector: Jennifer Eberle
 Title: Environmental Project Manager
 Signature: Andrew B. Garcia Signature: J Eberle



BAY AREA AIR QUALITY MANAGEMENT DISTRICT

939 ELLIS STREET
SAN FRANCISCO, CALIFORNIA 94109
(415) 771-6000

REGULATION 8, RULE 40
Aeration of Contaminated Soil and
Removal of Underground Storage Tanks

N. Lew

NOTIFICATION FORM
 Removal or Replacement of Tanks
 Excavation of Contaminated Soil

SITE INFORMATION

SITE ADDRESS JUVENILE HALL 2200 FAIRMONT DR.
CITY, STATE SAN LEANDRO, CA ZIP 94578
OWNER NAME ALAMEDA COUNTY GENERAL SERVICES AGENCY
SPECIFIC LOCATION OF PROJECT JUVENILE COURT HOUSE

TANK REMOVAL

CONTAMINATED SOIL EXCAVATION

SCHEDULED STARTUP DATE 10/10/94

SCHEDULED STARTUP DATE _____

VAPORS REMOVED BY: FUEL OIL

STOCKPILES WILL BE COVERED? YES NO

WATER WASH

ALTERNATIVE METHOD OF AERATION (DESCRIBE BELOW):

VAPOR FREEING (CO²)

VENTILATION

(MAY REQUIRE PERMIT)

CONTRACTOR INFORMATION

NAME ENVIRONMENTAL SCIENCE & ENGINEERING, INC. CONTACT JAY CARPENTER
ADDRESS 4090 NELSON AVE, CTR J PHONE (510) 685-4053
CITY, STATE, ZIP CONCORD, CA 94520

CONSULTANT INFORMATION

(IF APPLICABLE)

NAME ENVIRONMENTAL SCIENCE & ENGINEERING, INC. CONTACT JAY CARPENTER
ADDRESS _____ PHONE (510) 685-4053
CITY, STATE, ZIP _____

FOR OFFICE USE ONLY

DATE RECEIVED FAX 9/28/94 BY OPT
(init.)
DATE POSTMARKED _____ BY _____
(init.)
CC: INSPECTOR NO. 571 DATE 9/28/94 BY OPT
(init.)
UPDATE: CONTACT NAME _____ DATE _____ BY _____
(init.)
BAAQMD N # _____ DATA ENTRY 9/28/94

• See reverse for instructions

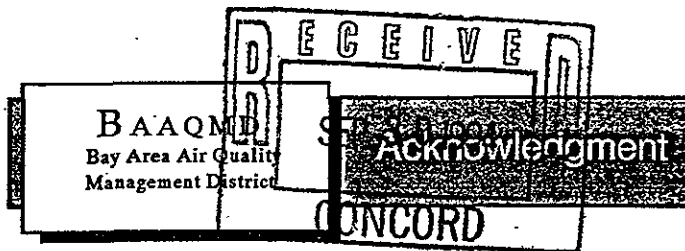

Bay Area Air Quality Management District
acknowledges receipt of your Tank
Removal/Contaminated Soil Excavation
Notification Form received on

9/28/94

DPT

ACTIVITY NOTIFICATION FORM FOR HOLDERS OF ANNUAL PERMITS Scaffolding Falsework Trenches/Excavations

8 CCR 341.1(f) REQUIRES HOLDERS OF ANNUAL PERMITS TO PROVIDE NOTIFICATION TO
THE DOSH OFFICE NEAREST THE PROJECT PRIOR TO COMMENCEMENT OF ANY WORK.
THIS FORM IS PROVIDED FOR YOUR CONVENIENCE TO USE FOR SUCH NOTIFICATION.

THIS FORM MAY BE FAXED TO THE NEAREST DOSH OFFICE TO COMPLY WITH THE ABOVE. PLEASE DO NOT
MAIL DUPLICATE NOTIFICATION TO FOLLOW-UP FAX NOTIFICATION.

ACTIVITY DATA: FAXED TO CONCORD - OAKLAND DOSH DISTRICT OFFICE ON 10/6/94

DOSH FAX NO. (510) 676-0227 510 568-7092 BY JAY CARPENTER

Company Name: ENVIRONMENTAL SCIENCE & ENG. INC Field Phone: (510) 840-9167

Annual Permit Number: 562276 Office Phone: (510) 685-4053

Region: 2 Issuing District: 2

Specific Activity Location: 2200 FAIRMONT DR Number of Employees: 3

Nearest Major Cross Street: FOOTHILL BLVD. Starting Date: 10/10/94

City: SAN LEANARDO Anticipated Completion Date: 10/12/94

County: ALAMEDA High Voltage Lines in Proximity? No Yes

INSTRUCTIONS: The appropriate item(s) must be completed and signed by a person knowledgeable about the project for each
activity covered by a permit. Please fill in or check off the blanks where appropriate.

Scaffolding: Height _____ Metal _____ Wood _____ Wood over 60 Feet _____ Metal over 125 Feet _____

Height > 125 Feet or Wood > 60 Feet requires design by California Registered Civil Engineer & Plans at Site. (See 8 CCR 1644(c)(7))

Description: _____

Falsework/Vertical Shoring: Maximum Height _____ Maximum Span _____ Material _____

Description: _____

(See 8 CCR 1717)

Trenches/Excavations: Depth Range (Min/Max) 12'-20' Width Range (Min/Max) 8'-10' Total Length 22'

Ground Protection Method: Shoring _____ Sloping _____ Trench Shield Professional Engineer _____

Underground Services Alert (USA) Number 325966 (NORTH 1-800-642-2444/SOUTH 1-800-422-4133)

Soil Analysis to be done? Yes _____ No If No, You Must Slope 1.5 to 1.

Competent Person: The holder of an Annual Permit who is notifying the District of the commencement of a Trench and/or
Excavation project shall designate a competent person in accordance with the requirements of 8 CCR
Section 1504, 1541, and 1541.1.

Description: REMOVAL OF ONE 7,000 GALLON UNDERGROUND STORAGE TANK

Ground protection methods for excavations deeper than 20 feet must be designed by a Registered Professional Engineer.
See 8 CCR 1541.1, Appendix F.

I hereby certify that to the best of my knowledge the above information and assertions are true and correct and that I/the applicant
has/have the knowledge of and will comply with the foregoing.

Signature: [Signature] Date: 10/6/94
CONSTRUCTIONS - MABA

STATE OF CALIFORNIA
STATE WATER RESOURCES CONTROL BOARD
UNDERGROUND STORAGE TANK PERMIT APPLICATION - FORM A
COMPLETE THIS FORM FOR EACH FACILITY/SITE



MARK ONLY ONE ITEM 1 NEW PERMIT 2 INTERIM PERMIT 3 RENEWAL PERMIT 4 AMENDED PERMIT 5 CHANGE OF INFORMATION 6 TEMPORARILY CLOSED SITE 7 PERMANENTLY CLOSED SITE 8 TEMPORARY SITE CLOSURE

I. FACILITY/SITE INFORMATION & ADDRESS - (MUST BE COMPLETED)

DEA OR FACILITY NAME Juvenile Hall		NAME OF OPERATOR Alameda County General Services Agency	
ADDRESS 2200 Fairmont Drive		NEAREST CROSS STREET Foothill Road	PARCEL # (OPTIONAL)
CITY NAME San Leandro,		STATE CA	ZIP CODE 94578
		SITE PHONE # WITH AREA CODE (510) 667-4499	
<input checked="" type="checkbox"/> BOX TO INDICATE <input type="checkbox"/> CORPORATION <input type="checkbox"/> INDIVIDUAL <input type="checkbox"/> PARTNERSHIP <input type="checkbox"/> LOCAL-AGENCY DISTRICTS* <input checked="" type="checkbox"/> COUNTY-AGENCY* <input type="checkbox"/> STATE-AGENCY* <input type="checkbox"/> FEDERAL-AGENCY*			
* If owner of UST is a public agency, complete the following: name of Supervisor of division, section, or office which operates the UST _____			
TYPE OF BUSINESS <input type="checkbox"/> 1 GAS STATION <input type="checkbox"/> 2 DISTRIBUTOR <input type="checkbox"/> 3 FARM <input type="checkbox"/> 4 PROCESSOR <input checked="" type="checkbox"/> 5 OTHER		<input type="checkbox"/> IF INDIAN RESERVATION OR TRUST LANDS	# OF TANKS AT SITE 2
		E. P. A. I. D. # (optional) CAL 000088555	

EMERGENCY CONTACT PERSON (PRIMARY)

EMERGENCY CONTACT PERSON (SECONDARY) - optional

DAYS: NAME (LAST, FIRST) Garcia, Andrew	PHONE # WITH AREA CODE (510) 208-9521	DAYS: NAME (LAST, FIRST) Garcia, Andrew	PHONE # WITH AREA CODE (510) 208-9521
NIGHTS: NAME (LAST, FIRST) Garcia, Andrew	PHONE # WITH AREA CODE (510) 284-3573	NIGHTS: NAME (LAST, FIRST) Garcia, Andrew	PHONE # WITH AREA CODE (510) 284-3573

II. PROPERTY OWNER INFORMATION - (MUST BE COMPLETED)

NAME Alameda County General Services Agency		CARE OF ADDRESS INFORMATION Andrew Garcia	
MAILING OR STREET ADDRESS 1401 Lakeside Drive		<input checked="" type="checkbox"/> box to indicate <input type="checkbox"/> INDIVIDUAL <input type="checkbox"/> LOCAL-AGENCY <input type="checkbox"/> STATE-AGENCY <input type="checkbox"/> CORPORATION <input type="checkbox"/> PARTNERSHIP <input checked="" type="checkbox"/> COUNTY-AGENCY <input type="checkbox"/> FEDERAL-AGENCY	
CITY NAME Oakland		STATE CA	ZIP CODE 94612
		PHONE # WITH AREA CODE (510) 208-9521	

III. TANK OWNER INFORMATION - (MUST BE COMPLETED)

NAME OF OWNER Alameda County General Services Agency		CARE OF ADDRESS INFORMATION Andrew Garcia	
MAILING OR STREET ADDRESS 1401 Lakeside Drive		<input checked="" type="checkbox"/> box to indicate <input type="checkbox"/> INDIVIDUAL <input type="checkbox"/> LOCAL-AGENCY <input type="checkbox"/> STATE-AGENCY <input type="checkbox"/> CORPORATION <input type="checkbox"/> PARTNERSHIP <input checked="" type="checkbox"/> COUNTY-AGENCY <input type="checkbox"/> FEDERAL-AGENCY	
CITY NAME Oakland,		STATE CA	ZIP CODE 94612
		PHONE # WITH AREA CODE (510) 208-9521	

IV. BOARD OF EQUALIZATION UST STORAGE FEE ACCOUNT NUMBER - Call (916) 322-9669 if questions arise.

TY-(TK) HQ **44-000324**

V. PETROLEUM UST FINANCIAL RESPONSIBILITY - (MUST BE COMPLETED) - IDENTIFY THE METHOD(S) USED

<input checked="" type="checkbox"/> box to indicate	<input checked="" type="checkbox"/> 1 SELF-INSURED	<input type="checkbox"/> 2 GUARANTEE	<input type="checkbox"/> 3 INSURANCE	<input type="checkbox"/> 4 SURETY BOND
	<input type="checkbox"/> 5 LETTER OF CREDIT	<input type="checkbox"/> 6 EXEMPTION	<input type="checkbox"/> 99 OTHER	

VI. LEGAL NOTIFICATION AND BILLING ADDRESS Legal notification and billing will be sent to the tank owner unless box I or II is checked.

CHECK ONE BOX INDICATING WHICH ABOVE ADDRESS SHOULD BE USED FOR LEGAL NOTIFICATIONS AND BILLING: I II III

THIS FORM HAS BEEN COMPLETED UNDER PENALTY OF PERJURY, AND TO THE BEST OF MY KNOWLEDGE, IS TRUE AND CORRECT

OWNER'S NAME (PRINTED & SIGNED) Andrew B. Garcia	OWNER'S TITLE Environmental Project Manager	DATE MONTH/DAY/YEAR 10/25/94
--	---	--

LOCAL AGENCY USE ONLY

COUNTY # <input type="text"/>	JURISDICTION # <input type="text"/>	FACILITY # <input type="text"/>
LOCATION CODE - OPTIONAL	CENSUS TRACT # - OPTIONAL	SUPVISOR - DISTRICT CODE - OPTIONAL

THIS FORM MUST BE ACCOMPANIED BY AT LEAST (1) OR MORE PERMIT APPLICATION - FORM B, UNLESS THIS IS A CHANGE OF SITE INFORMATION ONLY.

OWNER MUST FILE THIS FORM WITH THE LOCAL AGENCY IMPLEMENTING THE UNDERGROUND STORAGE TANK REGULATIONS

STATE OF CALIFORNIA
STATE WATER RESOURCES CONTROL BOARD
UNDERGROUND STORAGE TANK PERMIT APPLICATION - FORM B



COMPLETE A SEPARATE FORM FOR EACH TANK SYSTEM.

MARK ONLY ONE ITEM	<input type="checkbox"/> 1 NEW PERMIT	<input type="checkbox"/> 3 RENEWAL PERMIT	<input type="checkbox"/> 6 CHANGE OF INFORMATION	<input checked="" type="checkbox"/> 7 PERMANENTLY CLOSED ON SITE
	<input type="checkbox"/> 2 INTERIM PERMIT	<input type="checkbox"/> 4 AMENDED PERMIT	<input type="checkbox"/> 8 TEMPORARY TANK CLOSURE	<input type="checkbox"/> 8 TANK REMOVED

DBA OR FACILITY NAME WHERE TANK IS INSTALLED:

I. TANK DESCRIPTION COMPLETE ALL ITEMS - SPECIFY IF UNKNOWN

A. OWNER'S TANK I.D.# Alameda County, GSA, UST9072	MANUFACTURED BY: Unknown
C. DATE INSTALLED (MO/DAY/YEAR) Unknown	D. TANK CAPACITY IN GALLONS: 7,000 gallon

II. TANK CONTENTS IFA-1 IS MARKED, COMPLETE ITEM C.

A. <input type="checkbox"/> 1 MOTOR VEHICLE FUEL	4 OIL	B. <input checked="" type="checkbox"/> 1 PRODUCT	C. <input type="checkbox"/> 1a REGULAR UNLEADED	3 DIESEL	6 AVIATION GAS
<input checked="" type="checkbox"/> 2 PETROLEUM	<input type="checkbox"/> 80 EMPTY	<input type="checkbox"/> 2 WASTE	<input type="checkbox"/> 1b PREMIUM UNLEADED	<input type="checkbox"/> 4 GASAHOL	<input type="checkbox"/> 7 METHANOL
<input type="checkbox"/> 3 CHEMICAL PRODUCT	<input type="checkbox"/> 95 UNKNOWN		<input type="checkbox"/> 2 LEADED	<input type="checkbox"/> 5 JET FUEL	<input checked="" type="checkbox"/> 99 OTHER (DESCRIBE IN ITEM D. BELOW)

D. IF (A.1) IS NOT MARKED, ENTER NAME OF SUBSTANCE STORED **Heating Oil** C. A. S. #:

III. TANK CONSTRUCTION MARK ONE ITEM ONLY IN BOXES A, B, AND C, AND ALL THAT APPLIES IN BOX D AND E

A. TYPE OF SYSTEM	1 DOUBLE WALL	3 SINGLE WALL WITH EXTERIOR LINER	95 UNKNOWN
	<input checked="" type="checkbox"/> 2 SINGLE WALL	<input type="checkbox"/> 4 SECONDARY CONTAINMENT (VAULTED TANK)	<input type="checkbox"/> 99 OTHER
B. TANK MATERIAL (Primary Tank)	<input type="checkbox"/> 1 BARE STEEL	<input type="checkbox"/> 2 STAINLESS STEEL	<input type="checkbox"/> 3 FIBERGLASS
	<input type="checkbox"/> 5 CONCRETE	<input type="checkbox"/> 6 POLYVINYL CHLORIDE	<input type="checkbox"/> 7 ALUMINUM
	<input type="checkbox"/> 9 BRONZE	<input checked="" type="checkbox"/> 10 GALVANIZED STEEL	<input type="checkbox"/> 95 UNKNOWN
C. INTERIOR LINING	<input type="checkbox"/> 1 RUBBER LINED	<input type="checkbox"/> 2 ALKYD LINING	<input type="checkbox"/> 3 EPOXY LINING
	<input type="checkbox"/> 5 GLASS LINING	<input type="checkbox"/> 6 UNLINED	<input checked="" type="checkbox"/> 95 UNKNOWN
	IS LINING MATERIAL COMPATIBLE WITH 100% METHANOL? YES ___ NO ___		
D. CORROSION PROTECTION	<input type="checkbox"/> 1 POLYETHYLENE WRAP	<input type="checkbox"/> 2 COATING	<input type="checkbox"/> 3 VINYL WRAP
	<input type="checkbox"/> 5 CATHODIC PROTECTION	<input type="checkbox"/> 91 NONE	<input checked="" type="checkbox"/> 95 UNKNOWN
E. SPILL AND OVERFILL	SPILL CONTAINMENT INSTALLED (YEAR) _____		OVERFILL PREVENTION EQUIPMENT INSTALLED (YEAR) _____

IV. PIPING INFORMATION CIRCLE A IF ABOVE GROUND OR U IF UNDERGROUND, BOTH IF APPLICABLE

A. SYSTEM TYPE	A (U) 1 SUCTION	A U 2 PRESSURE	A U 3 GRAVITY	A U 99 OTHER
B. CONSTRUCTION	A (U) 1 SINGLE WALL	A U 2 DOUBLE WALL	A U 3 LINED TRENCH	A U 95 UNKNOWN
C. MATERIAL AND CORROSION PROTECTION	A (U) 1 BARE STEEL	A U 2 STAINLESS STEEL	A U 3 POLYVINYL CHLORIDE (PVC)	A U 4 FIBERGLASS PIPE
	A U 5 ALUMINUM	A U 6 CONCRETE	A U 7 STEEL W/ COATING	A U 8 100% METHANOL COMPATIBLE W/FRP
	A U 9 GALVANIZED STEEL	A U 10 CATHODIC PROTECTION	A U 95 UNKNOWN	A U 99 OTHER
D. LEAK DETECTION	<input type="checkbox"/> 1 AUTOMATIC LINE LEAK DETECTOR	<input type="checkbox"/> 2 LINE TIGHTNESS TESTING	<input type="checkbox"/> 3 INTERSTITIAL MONITORING	<input type="checkbox"/> 99 OTHER

V. TANK LEAK DETECTION

<input type="checkbox"/> 1 VISUAL CHECK	<input type="checkbox"/> 2 INVENTORY RECONCILIATION	<input type="checkbox"/> 3 VADOZE MONITORING	<input type="checkbox"/> 4 AUTOMATIC TANK GAUGING	<input type="checkbox"/> 5 GROUND WATER MONITORING
<input type="checkbox"/> 6 TANK TESTING	<input type="checkbox"/> 7 INTERSTITIAL MONITORING	<input type="checkbox"/> 91 NONE	<input checked="" type="checkbox"/> 95 UNKNOWN	<input type="checkbox"/> 99 OTHER

VI. TANK CLOSURE INFORMATION

1. ESTIMATED DATE LAST USED (MO/DAY/YR) UNKNOWN	2. ESTIMATED QUANTITY OF SUBSTANCE REMAINING 0 GALLONS	3. WAS TANK FILLED WITH INERT MATERIAL? YES <input type="checkbox"/> NO <input checked="" type="checkbox"/>
---	---	---

THIS FORM HAS BEEN COMPLETED UNDER PENALTY OF PERJURY, AND TO THE BEST OF MY KNOWLEDGE, IS TRUE AND CORRECT

APPLICANT'S NAME (PRINTED & SIGNATURE) Andrew B. Garcia	DATE 10/25/94
--	----------------------

LOCAL AGENCY USE ONLY THE STATE I.D. NUMBER IS COMPOSED OF THE FOUR NUMBERS BELOW

STATE I.D.#	COUNTY #	JURISDICTION #	FACILITY #	TANK #
PERMIT NUMBER	PERMIT APPROVED BY/DATE		PERMIT EXPIRATION DATE	

THIS FORM MUST BE ACCOMPANIED BY A PERMIT APPLICATION - FORM A, UNLESS A CURRENT FORM A HAS BEEN FILED.
FILE THIS FORM WITH THE LOCAL AGENCY IMPLEMENTING THE UNDERGROUND STORAGE TANK REGULATIONS

APPENDIX B

UST MANIFEST AND CERTIFICATE OF DESTRUCTION

TELEPHONE
10) 235-1393

CERTIFICATE

CERTIFIED SERVICES COMPANY

255 Parr Boulevard • Richmond, California 94801

NO. 08993

CUSTOMER
ENVIRONMENTAL SC
JOB NO.
86351

FOR: ERICKSON, INC. TANK NO. 14686

LOCATION: RICHMOND DATE: 94/10/18 TIME: 08:06

TEST METHOD VISUAL GASTECH/1314 SMPN LAST PRODUCT FO

This is to certify that I have personally determined that this tank is in accordance with the American Petroleum Institute and have found the condition to be in accordance with its assigned designation. This certificate is based on conditions existing at the time the inspection herein set forth was completed and is issued subject to compliance with all qualifications and instructions.

TANK SIZE 7000 GALLON TANK CONDITION SAFE FOR FIRE

REMARKS: ~~OXYGEN 20.9% LOWER EXPLOSIVE LIMIT LESS THAN 0.1%~~
~~ERICKSON, INC. HEREBY CERTIFIES THAT THE ABOVE NUMBERED TANK HAS BEEN CUT OPEN, PROCESSED, AND THEREFORE DESTROYED AT OUR PERMITTED HAZARDOUS WASTE FACILITY.~~
~~ERICKSON, INC. HAS THE APPROPRIATE PERMITS FOR, AND HAS ACCEPTED THE TANK SHIPPED TO US FOR PROCESSING.~~

In the event of any physical or atmospheric changes affecting the gas-free conditions of the above tanks, or if in any doubt, immediately stop all hot work and contact the undersigned. This permit is valid for 24 hours if no physical or atmospheric changes occur.

STANDARD SAFETY DESIGNATION

SAFE FOR MEN: Means that in the compartment or space so designated (a) The oxygen content of the atmosphere is at least 19.5 percent by volume; and that (b) Toxic materials in the atmosphere are within permissible concentrations; and (c) In the judgment of the Inspector, the residues are not capable of producing toxic materials under existing atmospheric conditions while maintained as directed on the Inspector's certificate.

SAFE FOR FIRE: Means that in the compartment so designated (a) The concentration of flammable materials in the atmosphere is below 10 percent of the lower explosive limit; and that (b) In the judgment of the Inspector, the residues are not capable of producing a higher concentration that permitted under existing atmospheric conditions in the presence of fire and while maintained as directed on the Inspector's certificate, and further, (c) All adjacent spaces have either been cleaned sufficiently to prevent the spread of fire, are satisfactorily inerted, or in the case of fuel tanks, have been treated as deemed necessary by the Inspector.

The undersigned representative acknowledges receipt of this certificate and understands the conditions and limitations under which it was issued.

Stanley Crago
REPRESENTATIVE

TITLE

Dave Sato
INSPECTOR

UNIFORM HAZARDOUS WASTE MANIFEST		1. Generator's US EPA ID No. CA L000088355	Manifest Document No. 91072	2. Page 1 of 1	Information in the shaded areas is not required by Federal law.	
3. Generator's Name and Mailing Address COUNTY OF ALAMEDA, ENGINEERING & ENVIRONMENTAL MANAGEMENT, 1401 KINGSIDE DRIVE, OAKLAND, CA 94612		<div style="background-color: #cccccc; padding: 5px;"> 93480991 10248 502301292 </div>				
4. Generator's Phone (510) 208-9525						
5. Transporter 1 Company Name Erickson, Inc.		6. US EPA ID Number CA D009466392				
7. Transporter 2 Company Name		8. US EPA ID Number				
9. Designated Facility Name and Site Address Erickson, Inc. 255 Parr Blvd. Richmond, CA. 94801		10. US EPA ID Number CAD009466392		<div style="background-color: #cccccc; padding: 5px;"> CA D009466392 (510) 208-1393 </div>		
11. US DOT Description (including Proper Shipping Name, Hazard Class, and ID Number)		12. Containers No.	12. Containers Type	13. Total Quantity	14. Unit Wt/Vol	
a. NON-RCRA Hazardous Waste Solid Waste Empty Storage Tank.		001	T P	7000	P	
b.						
c.						
d.						
15. Special Handling Instructions and Additional Information Keep away from sources of ignition. Always wear hardhats when working around U.G.S.T.'s 24 Hr. Contact Name N. GARCIA & Phone (510) 208-9521 SOURCE: JUVENILE HALL and assorted pipe		16. GENERATOR'S CERTIFICATION: I hereby declare that the contents of this consignment are fully and accurately described above by proper shipping name and are classified, packed, marked, and labeled, and are in all respects in proper condition for transport by highway according to applicable international and national government regulations. If I am a large quantity generator, I certify that I have a program in place to reduce the volume and toxicity of waste generated to the degree I have determined to be economically practicable and that I have selected the practicable method of treatment, storage, or disposal currently available to me which minimizes the present and future threat to human health and the environment; OR, if I am a small quantity generator, I have made a good faith effort to minimize my waste generation and select the best waste management method that is available to me and that I can afford.				
Printed/Typed Name ANDREW B. GARCIA		Signature <i>Andrew B. Garcia</i>		Month 10	Day 10	Year 1994
17. Transporter 1 Acknowledgement of Receipt of Materials Printed/Typed Name LOUAY ADAMS		Signature <i>Louay Adams</i>		Month 10	Day 10	Year 1994
18. Transporter 2 Acknowledgement of Receipt of Materials Printed/Typed Name		Signature		Month	Day	Year
19. Discrepancy Indication Space						
20. Facility Owner or Operator Certification of receipt of hazardous material covered by this manifest (except as noted in Item 19.) Printed/Typed Name KAREN RUFFIN		Signature <i>Karen Ruffin</i>		Month 11	Day 12	Year 1994

DO NOT WRITE BELOW THIS LINE.

IN CASE OF EMERGENCY OR SPILL, CALL THE NATIONAL RESPONSE CENTER 1-800-424-8802. WITHIN CALIFORNIA, CALL 1-800-952-7350.

APPENDIX C

LABORATORY REPORTS AND CHAIN OF CUSTODY DOCUMENTATION

Environmental Science & Eng. 4090 Nelson Avenue, Suite J Concord, CA 94520	Client Project ID: # 6-94-5257; Alameda Co. Juvenile Hall	Date Sampled: 10/10/94
	Client Contact: Jay Carpenter	Date Received: 10/10/94
	Client P.O:	Date Extracted: 10/10/94
		Date Analyzed: 10/10/94

Gasoline Range (C6-C12) Volatile Hydrocarbons as Gasoline*, with BTEX*

EPA methods 5030, modified 8015, and 8020 or 602; California RWQCB (SF Bay Region) method GCFID(5030)

Lab ID	Client ID	Matrix	TPH(g) ⁺	Benzene	Toluene	Ethylbenzene	Xylenes	% Rec. Surrogate
41498	SP-1-10	S	---	ND	ND	ND	ND	97
41499	SP-1-5	S	---	ND	ND	ND	ND	97
41500	SP-2	S	---	ND	ND	ND	ND	98
41501	SP-3	S	---	ND	ND	ND	ND	97
Detection Limit unless otherwise stated; ND means Not Detected	W	50 ug/L	0.5	0.5	0.5	0.5	0.5	
	S	1.0 mg/kg	0.005	0.005	0.005	0.005	0.005	

*water samples are reported in ug/L, soil samples in mg/kg, and all TCLP extracts in mg/L.

cluttered chromatogram; sample peak co-elutes with surrogate peak

⁺ The following descriptions of the TPH chromatogram are cursory in nature and McCampbell Analytical is not responsible for their interpretation: a) unmodified or weakly modified gasoline is significant; b) heavier gasoline range compounds are significant(aged gasoline?); c) lighter gasoline range compounds (the most mobile fraction) are significant; d) gasoline range compounds are significant; no recognizable pattern; e) TPH pattern that does not appear to be derived from gasoline (?); f) one to a few isolated peaks present; g) strongly aged gasoline or diesel range compounds are significant; h) lighter than water immiscible phase is present.

McCAMPBELL ANALYTICAL INC.

110 2nd Avenue South, #D7, Pacheco, CA 94553
 Tele: 510-798-1620 Fax: 510-798-1622

Environmental Science & Eng. 4090 Nelson Avenue, Suite J Concord, CA 94520	Client Project ID: # 6-94-5257; Alameda Co. Juvenile Hall	Date Sampled: 10/10/94
	Client Contact: Jay Carpenter	Date Received: 10/10/94
	Client P.O:	Date Extracted: 10/10/94
		Date Analyzed: 10/10/94

Diesel Range (C10-C23) Extractable Hydrocarbons as Diesel *

EPA methods modified 8015, and 3550 or 3510; California RWQCB (SF Bay Region) method GCFID(3550) or GCFID(3510)

Lab ID	Client ID	Matrix	TPH(d) ⁺	% Recovery Surrogate
41498	SP-1-10	S	ND	103
41499	SP-1-5	S	ND	101
41500	SP-2	S	ND	102
41501	SP-3	S	11,b	101
Detection Limit unless other- wise stated; ND means Not Detected	W	50 ug/L		
	S	10 mg/kg		

*water samples are reported in ug/L, soil samples in mg/kg, and all TCLP extracts in mg/L

cluttered chromatogram; surrogate and sample peaks co-elute or surrogate peak is on elevated baseline

+ The following descriptions of the TPH chromatogram are cursory in nature and McCampbell Analytical is not responsible for their interpretation: a) unmodified or weakly modified diesel is significant; b) diesel range compounds are significant; no recognizable pattern; c) modified diesel?; light(CL) or heavy(CH) diesel compounds are significant; d) gasoline range compounds are significant; e) medium boiling point pattern that does not match diesel(?); f) one to a few isolated peaks present; g) oil range compounds are significant; h) lighter than water immiscible phase is present.

McCAMPBELL ANALYTICAL INC.

110 2nd Avenue South, #D7, Pacheco, CA 94553

Tele: 510-798-1620 Fax: 510-798-1622

QC REPORT FOR HYDROCARBON ANALYSES

Date: 10/10/94

Matrix: Soil

Analyte	Concentration (mg/kg)			Amount Spiked	% Recovery		
	Sample	MS	MSD		MS	MSD	RPD
TPH (gas)	0.000	1.898	1.790	2.03	93	88	5.9
Benzene	0.000	0.166	0.174	0.2	83	87	4.7
Toluene	0.000	0.174	0.182	0.2	87	91	4.5
Ethylbenzene	0.000	0.172	0.178	0.2	86	89	3.4
Xylenes	0.000	0.538	0.558	0.6	90	93	3.6
TPH (diesel)	0	325	323	300	108	108	0.6
TRPH (oil & grease)	0.0	21.2	22.5	20.8	102	108	5.9

$$\% \text{ Rec.} = (\text{MS} - \text{Sample}) / \text{amount spiked} \times 100$$

$$\text{RPD} = (\text{MS} - \text{MSD}) / (\text{MS} + \text{MSD}) \times 2 \times 100$$

DATE Oct 10, 94 PAGE 1 OF 1

CHAIN OF CUSTODY RECORD

3030 A65E83

PROJECT NAME Judy Hall

ADDRESS San Leandro

PROJECT NO. 6-94-525-7

SAMPLED BY Paul Marsden

LAB NAME Mc Campbell

ANALYSES TO BE PERFORMED

MATRIX

MATRIX

NUMBER OF CONTAINERS



Environmental Science & Engineering, Inc.

4090 Nelson Avenue Suite J, Concord, CA 94520

Phone (510) 685-4053

Fax (510) 685-5323

REMARKS (CONTAINER, SIZE, ETC.)

SAMPLE # DATE TIME LOCATION

SP-1-N 10/10 15:25 San Leandro

SP-1S 10:20

F-1 2:11

F-2 2:11

SP-2 15:48

SP-3 15:50

IPH-D BTEX

MATRIX

Soil

2x6" Brass ring

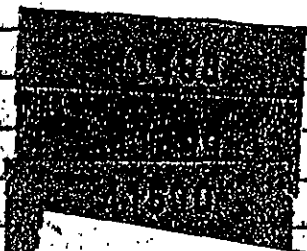

41501

RELINQUISHED BY: (signature)

RECEIVED BY: (signature)

date time

TOTAL NUMBER OF CONTAINERS

1. Paul Marsden

Paul Marsden 7:40 AM

10/10 3:59

4

2. Paul Marsden 2:40 A.F.S.

Paul Marsden

10/10 6:15 PM

REPORT RESULTS TO:

SPECIAL SHIPMENT REQUIREMENTS

3.

Jay C.

4.

5.

SAMPLE RECEIPT

INSTRUCTIONS TO LABORATORY (handling, analyses, storage, etc.):

CHAIN OF CUSTODY SEALS

24 hr Turn Around

REC'D GOOD COND'TN/COLD

CONFORMS TO RECORD

McCAMPBELL ANALYTICAL INC.

110 2nd Avenue South, #D7, Pacheco, CA 94553
 Tele: 510-798-1620 Fax: 510-798-1622

Environmental Science & Eng. 4090 Nelson Avenue, Suite J Concord, CA 94520	Client Project ID: Alameda Co. GSA-Juvenile Hall	Date Sampled: 10/11/94
	Client Contact: Jay Carpenter	Date Received: 10/11/94
	Client P.O:	Date Extracted: 10/11/94
		Date Analyzed: 10/11/94

Gasoline Range (C6-C12) Volatile Hydrocarbons as Gasoline*, with BTEX*

EPA methods 5030, modified 8015, and 8020 or 602; California RWQCB (SF Bay Region) method GCFID(5030)

Lab ID	Client ID	Matrix	TPH(g) ⁺	Benzene	Toluene	Ethylbenzene	Xylenes	% Rec. Surrogate
41516	T2-20	S	---	ND	ND	ND	ND	96
41517	T1-1-NE	S	---	ND	ND	ND	ND	92
41518	T1-2-NE	S	---	ND < 0.01	0.033	0.45	0.65	98
41519	T3-N-23'	S	---	ND	ND	ND	ND	98
41520	T4-N-20'	S	---	ND	ND	ND	ND	101
Detection Limit unless otherwise stated; ND means Not Detected	W	50 ug/L	0.5	0.5	0.5	0.5	0.5	
	S	1.0 mg/kg	0.005	0.005	0.005	0.005	0.005	

*water samples are reported in ug/L, soil samples in mg/kg, and all TCLP extracts in mg/L
 # cluttered chromatogram; sample peak co-elutes with surrogate peak
 + The following descriptions of the TPH chromatogram are cursory in nature and McCampbell Analytical is not responsible for their interpretation: a) unmodified or weakly modified gasoline is significant; b) heavier gasoline range compounds are significant(aged gasoline?); c) lighter gasoline range compounds (the most mobile fraction) are significant; d) gasoline range compounds are significant; no recognizable pattern; e) TPH pattern that does not appear to be derived from gasoline (?); f) one to a few isolated peaks present; g) strongly aged gasoline or diesel range compounds are significant; h) lighter than water immiscible phase is present.

Environmental Science & Eng. 4090 Nelson Avenue, Suite J Concord, CA 94520	Client Project ID: Alameda Co. GSA-Juvenile Hall	Date Sampled: 10/11/94
	Client Contact: Jay Carpenter	Date Received: 10/11/94
	Client P.O:	Date Extracted: 10/11/94
		Date Analyzed: 10/11/94

Diesel Range (C10-C23) Extractable Hydrocarbons as Diesel *
 EPA methods modified 8015, and 3550 or 3510; California RWQCB (SF Bay Region) method GCFID(3550) or GCFID(3510)

Lab ID	Client ID	Matrix	TPH(d) ⁺	% Recovery Surrogate
41516	T2-20	S	ND	101
41517	T1-1-NE	S	470,a	103
41518	T1-2-NE	S	4800,a	118 [#]
41519	T3-N-23'	S	ND	100
41520	T4-N-20'	S	1000,a	102
Detection Limit unless otherwise stated; ND means Not Detected	W	50 ug/L		
	S	10 mg/kg		

*water samples are reported in ug/L, soil samples in mg/kg, and all TCLP extracts in mg/L

[#] cluttered chromatogram; surrogate and sample peaks co-elute or surrogate peak is on elevated baseline

⁺ The following descriptions of the TPH chromatogram are cursory in nature and McCampbell Analytical is not responsible for their interpretation: a) unmodified or weakly modified diesel is significant; b) diesel range compounds are significant; no recognizable pattern; c) modified diesel?; light(Cl) or heavy(CR) diesel compounds are significant; d) gasoline range compounds are significant; e) medium boiling point pattern that does not match diesel(?); f) one to a few isolated peaks present; g) oil range compounds are significant; h) lighter than water immiscible phase is present.

McCAMPBELL ANALYTICAL- INC.

110 2nd Avenue South, #D7, Pacheco, CA 94553
Tele: 510-798-1620 Fax: 510-798-1622

QC REPORT FOR HYDROCARBON ANALYSES

Date: 10/11/94

Matrix: Soil

Analyte	Concentration (mg/kg)			Amount Spiked	% Recovery		
	Sample	MS	MSD		MS	MSD	RPD
TPH (gas)	0.000	1.801	1.853	2.03	89	91	2.8
Benzene	0.000	0.178	0.176	0.2	89	88	1.1
Toluene	0.000	0.180	0.182	0.2	90	91	1.1
Ethylbenzene	0.000	0.180	0.182	0.2	90	91	1.1
Xylenes	0.000	0.564	0.570	0.6	94	95	1.1
TPH (diesel)	0	317	317	300	106	106	0.0
TRPH (oil & grease)	N/A	N/A	N/A	N/A	N/A	N/A	N/A

$$\% \text{ Rec.} = (\text{MS} - \text{Sample}) / \text{amount spiked} \times 100$$

$$\text{RPD} = (\text{MS} - \text{MSD}) / (\text{MS} + \text{MSD}) \times 2 \times 100$$

DATE 10/11/94 PAGE 1 OF 1

CHAIN OF CUSTODY RECORD

3044 AESE 84

PROJECT NAME ACGSA - Juv. Hall

ADDRESS _____

San Leandro

PROJECT NO. _____

SAMPLED BY M. Foyet

LAB NAME _____

ANALYSES TO BE PERFORMED

MATRIX

CONTAINER NUMBER OF

SAMPLE #	DATE	TIME	LOCATION	TOM-D	BTEX	MATRIX	CONTAINER NUMBER OF
T2-20	10/11	11:45	San Leandro	X	X	Soil	1
T1-1-NE	10/11	12:00	"	X	X		1
T1-2-NE	10/11	12:05	"	X	X		1
T3-N-23	10/11	13:55	"	X	X		1
T4-N-20	10/11	14:00	"	X	X		1



Environmental Science & Engineering, Inc.

4090 Nelson Avenue
Suite J
Concord, CA 94520

Phone (510) 685-4053
Fax (510) 685-5323

REMARKS (CONTAINER, SIZE, ETC.)

2" brass tubes

41516
41517
41518
41519
41520

RELINQUISHED BY: (signature)
1. [Signature]
2. [Signature]
3.
4.
5.

RECEIVED BY: (signature) date time
[Signature] 10/11/94 10
[Signature] 10/11/94 15

TOTAL NUMBER OF CONTAINERS
REPORT RESULTS TO: Jay Carpenter
SPECIAL SHIPMENT REQUIREMENTS
24 hr Priority turnaround

INSTRUCTIONS TO LABORATORY (handling, analyses, storage, etc.):
ICE/ PRESERVATIVE
GOOD CONDITION APPROPRIATE
HEAD SPACE ABSENT CONTAINERS
VOLAS | O&G | METALS | OTHER

SAMPLE RECEIPT
CHAIN OF CUSTODY SEALS
REC'D GOOD COND'TN/COLD
CONFORMS TO RECORD

Environmental Science & Eng. 4090 Nelson Avenue, Suite J Concord, CA 94520	Client Project ID: # 6945257; GSA-J.H.	Date Sampled: 10/11/94
		Date Received: 10/11/94
	Client Contact: Jay Carpenter	Date Extracted: 10/11/94
	Client P.O:	Date Analyzed: 10/11/94

Gasoline Range (C6-C12) Volatile Hydrocarbons as Gasoline*, with BTEX*

EPA methods 5030, modified 8015, and 8020 or 602; California RWQCB (SF Bay Region) method GCFID(5030)

Lab ID	Client ID	Matrix	TPH(g) ⁺	Benzene	Toluene	Ethylbenzene	Xylenes	% Rec. Surrogate
41522	T5-N-23'	S	---	ND	ND	ND	ND	97
41523	SP-Comp	S	---	ND	ND	ND	ND	96
41524	SPT-1-Comp	S	---	ND	ND	ND	ND	98
41525	SPT-2-Comp	S	---	ND	ND	0.041	0.12	97
Detection Limit unless otherwise stated; ND means Not Detected	W	50 ug/L	0.5	0.5	0.5	0.5	0.5	
	S	1.0 mg/kg	0.005	0.005	0.005	0.005	0.005	

*water samples are reported in ug/L, soil samples in mg/kg, and all TCLP extracts in mg/L

cluttered chromatogram; sample peak co-elutes with surrogate peak

+ The following descriptions of the TPH chromatogram are cursory in nature and McCampbell Analytical is not responsible for their interpretation: a) unmodified or weakly modified gasoline is significant; b) heavier gasoline range compounds are significant(aged gasoline?); c) lighter gasoline range compounds (the most mobile fraction) are significant; d) gasoline range compounds are significant; no recognizable pattern; e) TPH pattern that does not appear to be derived from gasoline (?); f) one to a few isolated peaks present; g) strongly aged gasoline or diesel range compounds are significant; h) lighter than water immiscible phase is present.

McCAMPBELL ANALYTICAL

110 2nd AVENUE, # D7

(510) 798-1620

PACHECO, CA 94563

FAX (510) 798-1622

CHAIN OF CUSTODY RECORD

TURN AROUND TIME:

RUSH
 24 HOUR
 48 HOUR
 5 DAY

REPORT TO: J. CARPENTER

BILL TO: BSE

COMPANY: BSE

TELE: 685-4053

FAX #: 685-5323

PROJECT NUMBER: 6945257

PROJECT NAME: GSA-J.H

PROJECT LOCATION: JUVENILE HALL

SAMPLER SIGNATURE: *[Signature]*

SAMPLE ID	LOCATION	SAMPLING		# CONTAINERS	TYPE CONTAINERS	MATRIX					METHOD PRESERVED		ANALYSIS REQUEST	OTHER	COMMENTS	
		DATE	TIME			WATER	SOIL	AIR	SLUDGE	OTHER	HCL	HNO ₃				OTHER
T5-N-23'	EXCAVATION	10/11/94	14:20	1	RIG		X									
SP-1-3	STOCKPILE	"	"	1	"		X							41522		RUSH
SP-1-4	"	"	"	1	"		X							41523		COMPOSITE RUSH SP-COMP
SP-2-1	"	"	"	1	"		X							41524		
SP-2-2	"	"	"	1	"		X							41525		
SPT-1-1	"	"	"	1	"		X									COMPOSITE 5-DAY SPT-1-COMP
SPT-1-2	"	"	"	1	"		X									
SPT-1-3	"	"	"	1	"		X									
SPT-1-4	"	"	"	1	"		X									COMPOSITE 5-DAY SPT-2-COMP
SPT-2-1	"	"	"	1	"		X									
SPT-2-2	"	"	"	1	"		X									
SPT-2-3	"	"	"	1	"		X									
SPT-2-4	"	"	"	1	"		X									

RELINQUISHED BY: <i>[Signature]</i>	DATE: 10/11/94	TIME: 17:20	RECEIVED BY: <i>[Signature]</i>
RELINQUISHED BY:	DATE:	TIME:	RECEIVED BY:
RELINQUISHED BY:	DATE:	TIME:	RECEIVED BY LABORATORY:

REMARKS:

ICE? GOOD CONDITION HEAD SPACE ABSENT

PRESERVE/TIME APPROPRIATE CONTAINERS

VOL% U&G METALS OTHER

McCAMPBELL ANALYTICAL INC.	110 2nd Avenue South, #D7, Pacheco, CA 94553 Tele: 510-798-1620 Fax 510-798-1622
----------------------------	---

Environmental Science & Eng. 4090 Nelson Avenue, Suite J Concord, CA 94520	Client Project ID: # 6-94-5257; J.H.	Date Sampled: 10/12/94
		Date Received: 10/13/94
	Client Contact: Jay Carpenter	Date Extracted: 10/14/94
	Client P.O:	Date Analyzed: 10/16/94

Diesel Range (C10-C23) Extractable Hydrocarbons as Diesel *

EPA methods modified 8015, and 3550 or 3510; California RWOCB (SF Bay Region) method GCFID(3550) or GCFID(3510)

Lab ID	Client ID	Matrix	TPH(d) ⁺	% Recovery Surrogate
41565	SPT-3-1 to 4	S	2100,a	105
Detection Limit unless otherwise stated; ND means Not Detected	W	50 ug/L		
	S	10 mg/kg		

*water samples are reported in ug/L, soil samples in mg/kg, and all TCLP extracts in mg/L

cluttered chromatogram; surrogate and sample peaks co-elute or surrogate peak is on elevated baseline

⁺ The following descriptions of the TPH chromatogram are cursory in nature and McCampbell Analytical is not responsible for their interpretation: a) unmodified or weakly modified diesel is significant; b) diesel range compounds are significant; no recognizable pattern; c) modified diesel?; light(CL) or heavy(CH) diesel compounds are significant; d) gasoline range compounds are significant; e) medium boiling point pattern that does not match diesel(?); f) one to a few isolated peaks present; g) oil range compounds are significant; h) lighter than water immiscible phase is present.

McCAMPBELL ANALYTICAL INC.

110 2nd Avenue South, #D7, Pacheco, CA 94553
Tel: 510-798-1620 Fax: 510-798-1622

Environmental Science & Engineering 4090 Nelson Avenue, Suite J Concord, Ca. 94520	Client Project ID: # 6-94-5257; J.H.			Date Sampled: 10/12/94		
				Date Received: 10/13/94		
	Client Contact: Jay Carpenter			Date Extracted: 10/18/94		
	Client P.O:			Date Analyzed: 10/19-10/20/94		
CAM 17 METALS						
EPA methods 6010/200.7; 7470/245.1 (Hg); 7060/206.2 (As); 7140/270.2 (Se); 7341/279.2 (Tl); 239.2 (Pb, water matrix)						
Lab ID	41565			Detection Limit		
Client ID	SPT-3-1 to 4			S	W	STLC/ TCLP
Matrix	S			TTLIC	TTLIC	TCLP
Extraction	TTLIC					
Compound	Concentration*	Concentration*	Concentration*	mg/kg	mg/L	mg/L
Antimony (Sb)	ND			2.5	0.05	0.05
Arsenic (As)	14			2.5	0.005	0.25
Barium (Ba)	48			1.0	0.01	0.05
Beryllium (Be)	ND			0.5	0.01	0.01
Cadmium (Cd)	ND			0.5	0.01	0.01
Cobalt (Co)	26			2.0	0.02	0.05
Chromium (Cr)	110			0.5	0.005	0.05
Copper (Cu)	110			2.0	0.02	0.05
Lead (Pb)	3.7			3.0	0.005	0.2
Mercury (Hg)	ND			0.05	0.0008	0.0008
Molybdenum (Mo)	ND			2.0	0.02	0.05
Nickel (Ni)	84			2.0	0.02	0.05
Selenium (Se)	ND			2.5	0.005	0.25
Silver (Ag)	ND			1.0	0.01	0.05
Thallium (Tl)	ND			0.5	0.001	0.05
Vanadium (V)	36			2.0	0.02	0.05
Zinc (Zn)	32			1.0	0.01	0.05
% Recovery Surrogate	99					
Comments						
* water samples are reported in mg/L, soil samples in mg/kg and all TCLP & STLC extracts in mg/L						
o EPA extraction methods 1311(TCLP), 3010/3020(water, TTLIC), 3040(organic matrices, TTLIC), 3050(solids, TTLIC); STLC from CA Title 22						
# surrogate diluted out of range						
a) aqueous sample that contains greater than ~ 2 vol. % sediments; these sediments are extracted with the liquid, in accordance with EPA methodologies, and can significantly increase reported metal concentrations.						

DHS Certification No. 1644

Edward Hamilton, Lab Director

3058 AESE 87 AESE 87A

DATE 10/12/94 PAGE 1 OF 1

CHAIN OF CUSTODY RECORD

PROJECT NAME J. H.

ADDRESS San Leandro

PROJECT NO. 6-94-5257

SAMPLED BY Paul Marsden

LAB NAME Mc Campbell



Environmental Science & Engineering, Inc.

4090 Nelson Avenue Suite J Concord, CA 94520

Phone (510) 685-4030

Fax (510) 685-3323

ANALYSES TO BE PERFORMED

MATRIX

CONTAINERS NUMBER OF

REMARKS (CONTAINER, SIZE, ETC.)

SAMPLE # DATE TIME LOCATION

SPT-3-1 10/12 1705 San Leandro

SPT-3-2 1706

SPT-3-3 1707

SPT-3-4 1708

TPH-D
BTEX
HOLD

Cam 17
HOLD

RCI
HOLD

Composit.

MATRIX

Soil

2x6" Bras Ring

41566

OFF HOLD 10/12/94

RELINQUISHED BY: (signature) Paul Marsden

RECEIVED BY: (signature) James Mahoney

date time 10-13-94 10:135

TOTAL NUMBER OF CONTAINERS 4

1. ICE/

2. GOOD CONDITION

3. HEAD SPACE ABSENT

VOIAP D & G IN VIALS OTHER

PRESERVATIVE

APPROPRIATE CONTAINERS

REPORT RESULTS TO: Jay C.

SPECIAL SHIPMENT REQUIREMENTS

SAMPLE RECEIPT

INSTRUCTIONS TO LABORATORY (handling, analyses, storage, etc.):

5 Day Turn Around

CHAIN OF CUSTODY SEALS

REC'D GOOD CONDITN/COLD

CONFORMS TO RECORD

10-22-1994 09:57PM FROM McCampbell Analytical Inc TO

ESE P.02

APPENDIX D

WASTE MANIFEST AND BILL OF LADING RECORDS

Lot # 500

NON-HAZARDOUS MATERIALS HAULING MANIFEST

CONTRACTOR

NAME ESE

ADDRESS 4090 WILSON AVE, STE 1 PHONE NO. (510) 685-4053

CITY, STATE, ZIP CONCORD, CA 94520 FAX NO. (510) 685-5323

SITE INFO

NAME ALAMEDA CO JUVENILE HALL WASTE DESCRIPTION: SOIL

ADDRESS 2200 FAIRMONT DR GENERATING PROCESS: UST

CITY, STATE, ZIP SAN LEANDRO, CA

COMPONENTS OF WASTE DIESEL COMPONENTS OF WASTE _____

BY Andrew B. Garcia ANDREW B. GARCIA DATE 11/4/94

SIGNATURE PRINT OR TYPE FULL NAME

GENERATOR

NAME ALAMEDA CO. GENERAL SERVICES AGENCY

ADDRESS 1401 LAKE SIDE DR PHONE NO. 208-9521

CITY, STATE, ZIP OAKLAND, CA FAX NO. 208-9530

GENERATOR/OWNER CERTIFIES THIS WASTE AS DESCRIBED IS 100% NON-HAZARDOUS

BY Andrew B. Garcia ANDREW GARCIA DATE 11/4/94

SIGNATURE PRINT OR TYPE FULL NAME

HAULER

COMPANY NAME CABALLERO TRUCKING PHONE NO. (408) 729-0196

ADDRESS 2530 BERRYESSA RD, STE 527 SERVICE ORDER NO. _____

CITY, STATE, ZIP SAN JOSE, CA PICK UP DATE _____

TRUCK ID. NO. _____ TRAILER NO. _____ LOAD NO. _____ OF _____

DRIVER _____ DATE _____

SIGNATURE PRINT OR TYPE FULL NAME

PROCESSOR

PORT COSTA MATERIALS, INC.
9000 CARQUINEZ SCENIC DRIVE
PORT COSTA, CA 94569
(510) 602-1244

I hereby certify that the above material was received.

SIGNATURE DATE



DATE
11-4-94

P.O. BOX 50 • 9000 Carquinez Scenic Drive • Port Costa, CA 94569
415/228-7266

CONTRACTOR: *ESE*

TAG-BILL OF LADING No. 08740 CS

SOURCE: *Alameda Co. Juvenile Hall*

LOT # *500*

CONTAMINANT TYPE

WEIGHT	CASH SALE DATE		
	PRICE	UNIT	AMOUNT
GROSS <i>86220</i> LBS			
TARE <i>30000</i> LBS			
NET <i>56220</i> LBS			
WEIGHT PER CF			
TONS			
<i>28.11</i>			
SUB TOTAL			
% SALES TAX			
TOTAL			

TIME ON SCALE *9:33*
 TIME OFF SCALE *10:03*
Ed Caballero
 DRIVER'S NAME
C85
 TRUCK NO. TRAILER NO. TRAILER NO.
 DRIVER ON OFF GROSS & TARE

- CONTAINER
- BULK
- OTHER

SEAL # _____

CARRIER: *Caballero*
 BY: *E. Caballero*
 DATE: *11-5-94*

PORT COSTA MATERIALS, INC. WEIGHMASTER
 BY: *Anna Pennington* DEPUTY

WEIGHMASTER CERTIFICATE
 I HEREBY CERTIFY that the following described commodity was weighed, measured, or counted by a weighmaster, whose signature is on this certificate, who is duly licensed and authorized authority of accuracy, as prescribed by Chapter 7 (commencing with Section 12700) of Division 5 of the California Business and Professions Code, as amended, and registered by the Division of Measurement Standards of the California Department of Food and Agriculture.

No. 08740 CS



DATE
11-4-94

BOX 5D • 9000 Carquinez Scenic Drive • Port Costa, CA 94569
415/228-7266

CONTRACTOR: *ESE*

TAG-BILL OF LADING No. 08741 CS

SOURCE: *Alameda Co. Juvenile Hall*

LOT # *500*

CONTAMINANT TYPE	WEIGHT	PRICE	CASH SALE DATE	
			UNIT	AMOUNT
GROSS	<i>341620</i> LBS			
TARE	<i>316100</i> LBS			
NET	<i>57960</i> LBS			
WEIGHT PER CF				
TONS	<i>26.48</i>			
SUB TOTAL				
% SALES TAX				
TOTAL				

TIME ON SCALE *10:03*

TIME OFF SCALE *10:19*

Arnold Padilla
DRIVER'S NAME

B4
TRUCK NO. TRAILER NO. TRAILER NO.

DRIVER ON OFF GROSS & TARE

- CONTAINER
- BULK
- OTHER

SEAL # _____

CARRIER: *Capalero*
 BY: *[Signature]*
 DATE: *11-4-94*

PORT COSTA MATERIALS, INC. WEIGHMASTER
 BY: *[Signature]* DEPUTY

WEIGHMASTER CERTIFICATE

I HEREBY CERTIFY that the following described commodity was weighed, measured, or counted by a weighmaster, whose signature is on this certificate, who is a recognized authority of accuracy, as prescribed by Chapter 7 (commencing with Section 12700) of Division 5 of the California Business and Professions Code, administered by the Division of Measurement Standards of the California Department of Food and Agriculture.

No. 08741 CS



DATE
11-4-94

BOX 5D • 9000 Carquinez Scenic Drive • Port Costa, CA 94569
415/228-7266

CONTRACTOR: ESE
SOURCE: Alameda Co. Juvenile Hall

TAG-BILL OF LADING No. 08742 CS

LOT # 500

CONTAMINANT TYPE	WEIGHT	CASH SALE DATE		
		PRICE	UNIT	AMOUNT
GROSS	<u>95410</u> LBS			
TARE	<u>29980</u> LBS			
NET	<u>65430</u> LBS			
WEIGHT PER CF				
TONS	<u>27.74</u>			
SUB TOTAL				
% SALES TAX				
TOTAL				

TIME ON SCALE 10:33
TIME OFF SCALE _____
DRIVER'S NAME Mike Taylor
B17
TRUCK NO. TRAILER NO. TRAILER NO.
DRIVER ON OFF GROSS & TARE

- CONTAINER
- BULK
- OTHER

SEAL # _____

SIGN CARRIER: Caballero
BY: M. Taylor
DATE: 11-4-94

PORT COSTA MATERIALS, INC. WEIGHMASTER
BY: Guan Yehavitz DEPUTY

WEIGHMASTER CERTIFICATE

THIS IS TO CERTIFY that the following described commodity was weighed, measured, or counted by a weighmaster, whose signature is on this certificate, who is a recognized authority of accuracy, as prescribed by Chapter 7 (commencing with Section 12700) of Division 5 of the California Business and Professions Code, administered by the Division of Measurement Standards of the California Department of Food and Agriculture.

No. 08742 CS



**PORT
COSTA
MATERIALS**

DATE
11-4-94

BOX 5D • 9000 Carquinez Scenic Drive • Port Costa, CA 94569
415/228-7266

MANUFACTURER: **ESE**

TAG-BILL OF LADING No. **08744 CS**

ORIGIN: **Alameda Co. Juvenile
Hall**

LOT # **500**

CONTAMINANT TYPE	WEIGHT	PRICE	CASH SALE DATE	
			UNIT	AMOUNT
GROSS	93540 LBS			
TARE	30000 LBS			
NET	53540 LBS			
WEIGHT PER CF				
TONS	24.77			
SUB TOTAL				
% SALES TAX				
TOTAL				

TIME ON SCALE **12:34**
 TIME OFF SCALE _____
 DRIVER'S NAME **Ed Caballero**
C85
 TRUCK NO. _____ TRAILER NO. _____ TRAILER NO. _____
 DRIVER ON OFF GROSS & TARE

- CONTAINER
- BULK
- OTHER

SEAL # _____

CARRIER: **Caballero**
 BY: **Ed Caballero**
 DATE: **11-4-94**

PORT COSTA MATERIALS, INC. WEIGHMASTER
 BY: **[Signature]** DEPUTY

WEIGHMASTER CERTIFICATE

WEIGHMASTER TO CERTIFY that the following described commodity was weighed, measured, or counted by a weighmaster, whose signature is on this certificate, who has recognized authority of accuracy, as prescribed by Chapter 7 (commencing with Section 12700) of Division 5 of the California Business and Professions Code, administered by the Division of Measurement Standards of the California Department of Food and Agriculture.

No. **08744 CS**



**PORT
COSTA
MATERIALS**

P.O. BOX 50 • 9000 Carquinez Scenic Drive • Port Costa, CA 94569
415/228-7266

DATE
11-4-94

CONTRACTOR: **ESE**

TAG-BILL OF LADING No. **08745 CS**

SOURCE: **Alameda Co. Juvenile
Hall**

LOT # **500**

CONTAMINANT TYPE	WEIGHT	CASH SALE DATE		
		PRICE	UNIT	AMOUNT
GROSS	80140 LBS.			
TARE	31160 LBS.			
NET	48980 LBS.			
WEIGHT PER CF				
TONS	24.24			
		SUB TOTAL		
		% SALES TAX		
		TOTAL		

TIME ON SCALE **12:59**
 TIME OFF SCALE _____
 DRIVER'S NAME **Arnold Padilla**
 TRUCK NO. **B4** TRAILER NO. _____ TRAILER NO. _____
 DRIVER ON OFF GROSS & TARE

- CONTAINER
- BULK
- OTHER

SEAL # _____

CARRIER: **Caballero**
 BY: **[Signature]**
 DATE: **11-4-94**

PORT COSTA MATERIALS, INC. WEIGHMASTER
 BY: **[Signature]** DEPUTY

WEIGHMASTER CERTIFICATE

WEIGHMASTER CERTIFICATE
 I HEREBY CERTIFY that the following described commodity was weighed, measured, or counted by a weighmaster, whose signature is on this certificate, who is duly recognized authority of accuracy, as prescribed by Chapter 7 (commencing with Section 12700) of Division 5 of the California Business and Professions Code, administered by the Division of Measurement Standards of the California Department of Food and Agriculture.

No. **08745 CS**



DATE
11-4-94

PO BOX 5D • 9000 Carquinez Scenic Drive • Port Costa, CA 94569
415/228-7266

CONTRACTOR: *ESE*

TAG-BILL OF LADING No. 08746 CS

SOURCE: *Alameda Co. Juvenile Hall*

LOT # *500*

CONTAMINANT TYPE	WEIGHT	CASH SALE DATE		
		PRICE	UNIT	AMOUNT
GROSS	<i>79660 LBS</i>			
TARE	<i>39080 LBS</i>			
NET	<i>49680 LBS</i>			
WEIGHT PER CF				
TONS	<i>24.84</i>			
SUB TOTAL				
% SALES TAX				
TOTAL				

TIME ON SCALE *1:18*

TIME OFF SCALE

Mike Taylor
DRIVER'S NAME

B17
TRUCK NO. TRAILER NO. TRAILER NO.

DRIVER ON OFF GROSS & TARE

- CONTAINER
- BULK
- OTHER

SEAL # _____

CARRIER *Samuel*
 BY: *W. Taylor*
 DATE: *11-4-94*

PORT COSTA MATERIALS, INC.

WEIGHMASTER

BY: *[Signature]*
DEPUTY

WEIGHMASTER CERTIFICATE

THIS IS TO CERTIFY that the following described commodity was weighed, measured, or counted by a weighmaster, whose signature is on this certificate, who is a duly recognized authority of accuracy, as prescribed by Chapter 7 (commencing with Section 12700) of Division 5 of the California Business and Professions Code, administered by the Division of Measurement Standards of the California Department of Food and Agriculture.

No. 08746 CS



PORT COSTA MATERIALS

DATE 11-4-94

P.O. BOX 5D • 9000 Carquinez Scenic Drive • Port Costa, CA 94569 415/228-7266

CONTRACTOR: ESE

TAG-BILL OF LADING No. 08747 CS

SOURCE: Alameda County Juvenile Hall

LOT # 500

CONTAMINANT TYPE	WEIGHT	CASH SALE DATE		
		PRICE	UNIT	AMOUNT
GROSS	892.50 LBS			
TARE	300.00 LBS			
NET	592.50 LBS			
WEIGHT PER C/F				
TONS	29.64			
SUB TOTAL				
% SALES TAX				
TOTAL				

TIME ON SCALE 3:53

TIME OFF SCALE

Ed Caballero

DRIVER'S NAME

C85

TRUCK NO.

TRAILER NO.

TRAILER NO.

DRIVER ON OFF GROSS & TARE

CONTAINER

BULK

OTHER

SEAL #

CARRIER: Caballero
 BY: Ed Caballero
 DATE: 11-4-94

PORT COSTA MATERIALS, INC.

WEIGHMASTER

BY: *[Signature]*
 DEPUTY

WEIGHMASTER CERTIFICATE

WE CERTIFY that the following described commodity was weighed, measured, or counted by a weighmaster, whose signature is on this certificate, who is a recognized authority of accuracy, as prescribed by Chapter 7 (commencing with Section 12700) of Division 5 of the California Business and Professions Code, administered by the Division of Measurement Standards of the California Department of Food and Agriculture.

No. 08747 CS



**PORT
COSTA
MATERIALS**

DATE
11-4-94

PO BOX 5D • 9000 Carquinez Scenic Drive • Port Costa, CA 94569
415/228-7266

TRACTOR: **ESE**

TAG-BILL OF LADING No. **08748 CS**

SOURCE: **Alameda Co. Juvenile
Hall**

LOT # **500**

CONTAMINANT TYPE	WEIGHT	CASH SALE DATE		
		PRICE	UNIT	AMOUNT
GROSS	33480 LBS			
TARE	31460 LBS			
NET	53896 LBS			
WEIGHT PER CF				
TONS	26.91			
SUB TOTAL				
% SALES TAX				
TOTAL				

TIME ON SCALE **4:24**

TIME OFF SCALE
Arnold Padilla

DRIVER'S NAME

B4
TRUCK NO. TRAILER NO. TRAILER NO.

DRIVER ON OFF GROSS & TARE

- CONTAINER
- BULK
- OTHER

SEAL # _____

CARRIER: **Padilla**
BY: **[Signature]**
DATE: **11-4-94**

PORT COSTA MATERIALS, INC.

WEIGHMASTER

BY: **[Signature]**
DEPUTY

WEIGHMASTER CERTIFICATE

WEIGHMASTER TO CERTIFY that the following described commodity was weighed, measured, or counted by a weighmaster, whose signature is on this certificate, who is a duly recognized authority of accuracy, as prescribed by Chapter 7 (commencing with Section 12700) of Division 5 of the California Business and Professions Code, and administered by the Division of Measurement Standards of the California Department of Food and Agriculture.

No. **08748 CS**



DATE 10/7/94

P.O. BOX 50 • 9000 Carquinez Scenic Drive • Port Costa, CA 94569
415/228-7266

CONTRACTOR: ESE

TAG-BILL OF LADING No. 08749 CS

SOURCE: Alameda Co Juvenile Hall

LOT # 500

CONTAMINANT TYPE	WEIGHT	CASH SALE DATE		
		PRICE	UNIT	AMOUNT
GROSS	59,230 LBS			
TARE	3,160 LBS			
NET	56,070 LBS			
WEIGHT PER CF				
TONS	13.81			
SUB TOTAL				
% SALES TAX				
TOTAL				

TIME ON SCALE 8:00

TIME OFF SCALE

Arnold Padilla

DRIVER'S NAME

134

TRUCK NO.

TRAILER NO.

TRAILER NO.

DRIVER ON OFF GROSS & TARE

CONTAINER

BULK

OTHER

SEAL #

CARRIER: <i>Padilla</i>
BY: <i>[Signature]</i>
DATE: 10-9-94

PORT COSTA MATERIALS, INC.

WEIGHMASTER

BY *[Signature]* DEPUTY

WEIGHMASTER CERTIFICATE

WEIGHMASTER CERTIFICATE TO CERTIFY that the following described commodity was weighed, measured, or counted by a weighmaster, whose signature is on this certificate, who is a duly recognized authority of accuracy, as prescribed by Chapter 7 (commencing with Section 12700) of Division 5 of the California Business and Professions Code, administered by the Division of Measurement Standards of the California Department of Food and Agriculture.

No. 08749 CS



DATE
11/7/94

PORT BOX 5D • 9000 Carquinez Scenic Drive • Port Costa, CA 94569
415/228-7266

CONTRACTOR: *ESE*

TAG-BILL OF LADING No. 08750 CS

SOURCE: *Alameda Co. Juvenile Hall*

LOT # 500

CONTAMINANT TYPE	WEIGHT	CASH SALE DATE		
		PRICE	UNIT	AMOUNT
GROSS	<i>76540 LBS</i>			
TARE	<i>29930 LBS</i>			
NET	<i>46610 LBS</i>			
WEIGHT PER CF				
TONS	<i>23.28</i>			
SUB TOTAL				
% SALES TAX				
TOTAL				

TIME ON SCALE *8:25*

TIME OFF SCALE _____

Mike Taylor
DRIVER'S NAME

B17
TRUCK NO. TRAILER NO. TRAILER NO.

DRIVER ON OFF GROSS & TARE

- CONTAINER
- BULK
- OTHER

SEAL # _____

CARRIER: <i>J Caballero</i>
BY: <i>Michael Taylor</i>
DATE: <i>11/7/94</i>

PORT COSTA MATERIALS, INC. WEIGHMASTER
BY: *Roger J Wells* DEPUTY

WEIGHMASTER CERTIFICATE

WEIGHMASTER TO CERTIFY that the following described commodity was weighed, measured, or counted by a weighmaster, whose signature is on this certificate, who is a duly recognized authority of accuracy, as prescribed by Chapter 7 (commencing with Section 12700) of Division 5 of the California Business and Professions Code, and administered by the Division of Measurement Standards of the California Department of Food and Agriculture.

No. 08750 CS