



# General Services Agency

---

Darlene A. Smith, Director

June 1, 1999

TO: Scott Seery, Hazardous Materials Specialist, Environmental Health  
FROM: Rod Freitag, Environmental Program Manager, GSA-TSD  
SUBJECT: MTBE Data for Juvenile Hall, 2200 Fairmont Dr., San Leandro, CA

McC Campbell analytical reviewed the chromatograms for soil samples taken during remediation of soil impacted by the 325-gallon diesel tank formerly located at Juvenile Hall. According to Ed Hamilton, Laboratory Director, MTBE was included in the laboratory standard, and there was absolutely no evidence of MTBE in the samples. I've enclosed a short letter from McC Campbell documenting their findings.

Let me know if you need anything else to get this case closed. Thanks for your help.

RDF:rd\fe&em\project\env\7076jh\mtbe data

Enclosure

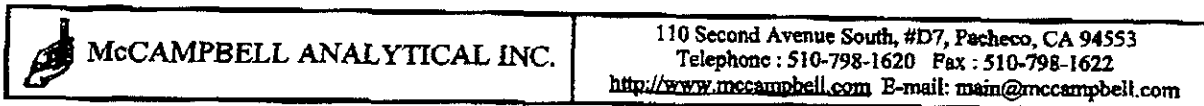

May 28, 1999

Rodman Freitag  
County of Alameda, GSA  
1401 Lakeside Dr.  
Alameda, CA 94621

Re: MTBE data for GSA-Juvenile Hall samples from 10/11/94

Dear Mr. Freitag:

The TPH(g)-BTEX chromatograms for the samples in question (lab IDs 41516-41520) showed no evidence of MTBE. We were not calibrated for MTBE on that GC at that time and can only give estimated non detect values, but these are  $ND < 0.5 \text{ mg/kg}$  for all samples.

If I can be of further assistance please do not hesitate to call.

Yours truly,



Edward Hamilton, Laboratory Director

3044 AESE84

CHAIN OF CUSTODY RECORD

DATE 10/11/94 PAGE 1 OF 1

PROJECT NAME ACGSA - Juv. Hall

ADDRESS San Leandro

PROJECT NO. \_\_\_\_\_

SAMPLED BY M. Forst

LAB NAME \_\_\_\_\_



Environmental Science & Engineering, Inc.

4190 Nelson Avenue  
Suite 7  
Concord, CA 94520

Phone (510) 685-4053  
Fax (510) 685-5323

ANALYSES TO BE PERFORMED						MATRIX	CONTAINERS NUMBER OF
TPH-D	BTEX					MATRIX	
X	X					Soil	1
X	X						1
X	X						1
X	X						1

REMARKS (CONTAINER, SIZE, ETC.)
2" brass tubes
41516
41517
41518
41519
41520

RELINQUISHED BY: (signature)  
 1. [Signature]  
 2. [Signature]  
 3.  
 4.  
 5.

RECEIVED BY: (signature)  
 [Signature]  
 [Signature]

date time  
 10/11/94 10:10  
 10/11/94 10:15

REPORT RESULTS TO:  
 Jar  
 CalPater

TOTAL NUMBER OF CONTAINERS  
 SPECIAL SHIPMENT REQUIREMENTS  
 24 hr Priority turnaround

INSTRUCTIONS TO LABORATORY (handling, analyses, storage, etc.):  
 ICE/T GOOD CONDITION HEAD SPACE ABSENT  
 PRESERVATIVE APPROPRIATE CONTAINERS  
 VOLS 0 & 6 MEAS OTHER

CHAIN OF CUSTODY SEALS	
REC'D GOOD COND'TN/COLD	✓
CONFORMS TO RECORD	✓

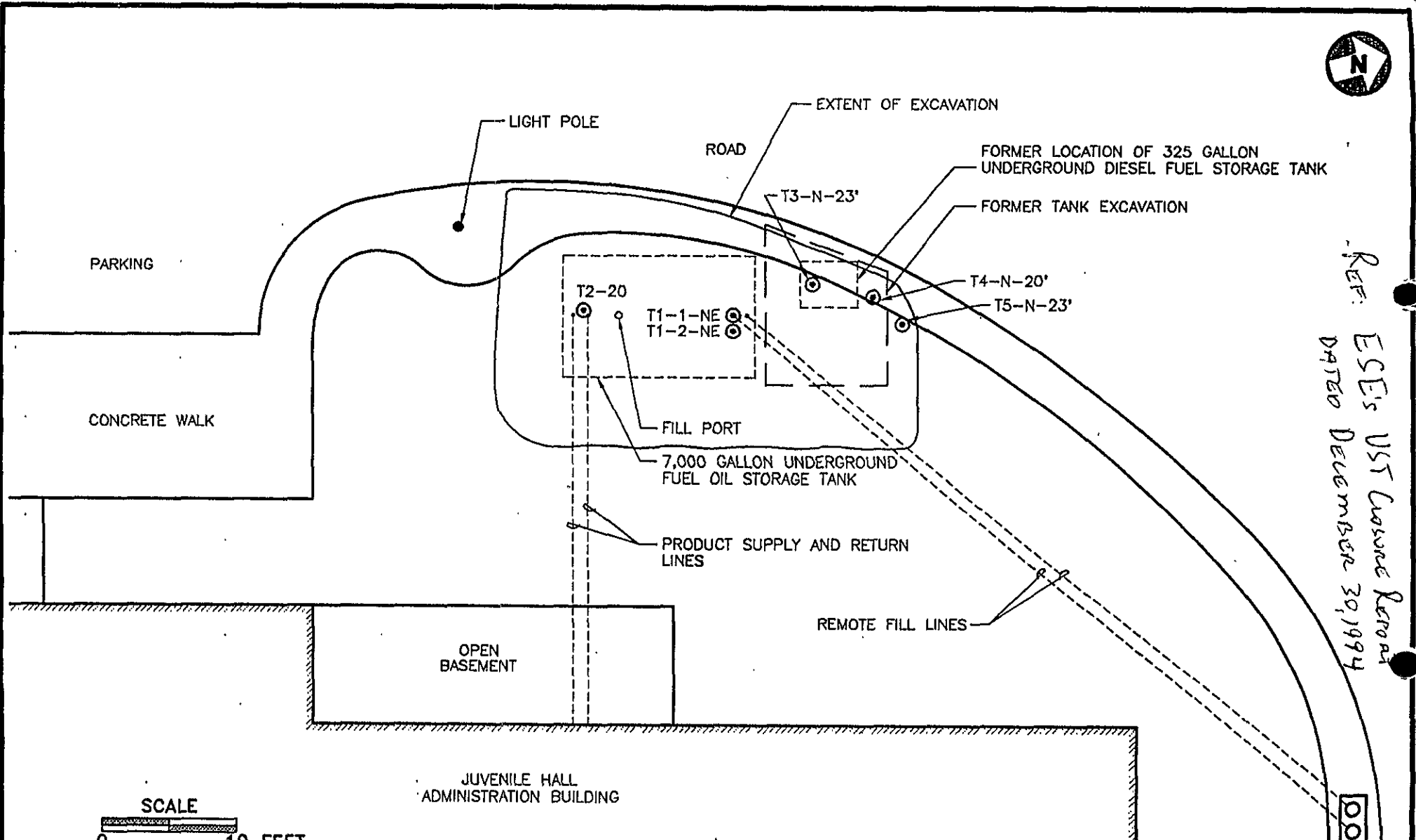

REF: ESE's UST Closure Report  
 DATE: December 30, 1994

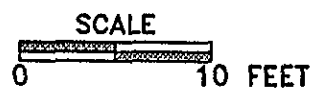

**LEGEND**  
 ⊙ SOIL SAMPLE LOCATION

 <b>Environmental Science &amp; Engineering, Inc.</b> <small>A GOLDER Company</small>	DATE 10/27/94	<b>SAMPLING PLAN</b>	FIGURE NO. <b>4</b>
	REMSED		ALAMEDA COUNTY GENERAL SERVICES AGENCY ALAMEDA COUNTY JUVENILE HALL SAN LEANDRO, CALIFORNIA
4090 NELSON AVENUE, SUITE J CONCORD, CA 94520	CAD FILE 52570002		



McCAMPBELL ANALYTICAL INC.

110 2nd Avenue South, #D7, Pacheco, CA 94553  
 Tele: 510-798-1620 Fax: 510-798-1622

Environmental Science & Eng. 4090 Nelson Avenue, Suite J Concord, CA 94520	Client Project ID: Alameda Co. GSA-Juvenile Hall	Date Sampled: 10/11/94
	Client Contact: Jay Carpenter	Date Received: 10/11/94
	Client P.O:	Date Extracted: 10/11/94
		Date Analyzed: 10/11/94

**Diesel Range (C10-C23) Extractable Hydrocarbons as Diesel \***

EPA methods modified 8015, and 3550 or 3510; California RWQCB (SF Bay Region) method GCFID(3550) or GCFID(3510)

Lab ID	Client ID	Matrix	TPH(d) <sup>+</sup>	% Recovery Surrogate
41516	T2-20	S	ND	101
41517	T1-1-NE	S	470,a	103
41518	T1-2-NE	S	4800,a	118 <sup>#</sup>
41519	T3-N-23'	S	ND	100
41520	T4-N-20'	S	1000,a	102
Detection Limit unless otherwise stated; ND means Not Detected	W		50 ug/L	
	S		10 mg/kg	

\*water samples are reported in ug/L, soil samples in mg/kg, and all TCLP extracts in mg/L  
<sup>#</sup> cluttered chromatogram; surrogate and sample peaks co-elute or surrogate peak is on elevated baseline  
<sup>+</sup> The following descriptions of the TPH chromatogram are cursory in nature and McCampbell Analytical is not responsible for their interpretation: a) unmodified or weakly modified diesel is significant; b) diesel range compounds are significant; no recognizable pattern; c) modified diesel?; light(CL) or heavy(CH) diesel compounds are significant; d) gasoline range compounds are significant; e) medium boiling point pattern that does not match diesel(?); f) one to a few isolated peaks present; g) oil range compounds are significant; h) lighter than water immiscible phase is present.

3044 AESE 84

CHAIN OF CUSTODY RECORD

DATE 10/11/94 PAGE 1 OF 1

PROJECT NAME ACGSA - Juv. Hall

ADDRESS San Leandro

PROJECT NO. \_\_\_\_\_

SAMPLED BY M. Foxt

LAB NAME \_\_\_\_\_



Environmental Science & Engineering, Inc.

4090 Nelson Avenue  
Suite J  
Concord, CA 94520

Phone (510) 685-4053

Fax (510) 685-5323

ANALYSES TO BE PERFORMED										MATRIX	CONTAINER NUMBER OF	REMARKS (CONTAINER, SIZE, ETC.)
PH-D	BTEX									MATRIX		
X	X									Soil	1	# 2" brass tubes
X	X										1	41516
X	X										1	41517
X	X										1	41518
X	X										1	41519
												41520

RELINQUISHED BY: (signature)  
 1. [Signature]  
 2. [Signature]  
 3. \_\_\_\_\_  
 4. \_\_\_\_\_  
 5. \_\_\_\_\_

RECEIVED BY: (signature)  
[Signature]  
[Signature]

date time  
10/11/94 10  
10/11/94 15

REPORT RESULTS TO:  
Jay  
Callender

TOTAL NUMBER OF CONTAINERS  
 SPECIAL SHIPMENT REQUIREMENTS  
24 hr Priority turnaround  
 SAMPLE RECEIPT

INSTRUCTIONS TO LABORATORY (handling, analyses, storage, etc.):  
 ICE/T  PRESERVATIVE APPROPRIATE CONTAINERS   
 GOOD CONDITION   
 HEAD SPACE ABSENT   
 VOLAS O&G METALS OTHER

CHAIN OF CUSTODY SEALS  
 REC'D GOOD COND'TN/COLD   
 CONFORMS TO RECORD

McCAMPBELL ANALYTICAL INC.

110 2nd Avenue South, #D7, Pacheco, CA 94553

Tele: 510-798-1620 Fax 510-798-1622

## QC REPORT FOR HYDROCARBON ANALYSES

Date: 10/11/94

Matrix: Soil

Analyte	Concentration (mg/kg)			Amount Spiked	% Recovery		
	Sample	MS	MSD		MS	MSD	RPD
TPH (gas)	0.000	1.801	1.853	2.03	89	91	2.8
Benzene	0.000	0.178	0.176	0.2	89	88	1.1
Toluene	0.000	0.180	0.182	0.2	90	91	1.1
Ethylbenzene	0.000	0.180	0.182	0.2	90	91	1.1
Xylenes	0.000	0.564	0.570	0.6	94	95	1.1
TPH (diesel)	0	317	317	300	106	106	0.0
TRPH (oil & grease)	N/A	N/A	N/A	N/A	N/A	N/A	N/A

$$\% \text{ Rec.} = (\text{MS} - \text{Sample}) / \text{amount spiked} \times 100$$

$$\text{RPD} = (\text{MS} - \text{MSD}) / (\text{MS} + \text{MSD}) \times 2 \times 100$$