



Environmental Science & Engineering, Inc.

7000 gallon fuel oil

FACSIMILE

DATE: 10/12/94 TIME: 4:47

TO: ANDY GARCIA FROM: JAY CARPENTER
ROB WESTON ESE, Inc.
4090 Nelson Avenue, Ste J
Concord, CA 94520

FAX #: 208-9530 JOB #: 6-94-5257
337-9335

SUBJECT: JUVENILE HALL ANALYTICAL

Number of Pages

(Including this Cover Sheet)

11

ADDITIONAL MESSAGE:

PLEASE CALL WITH COMMENTS

JAY

If you have any questions, please call us immediately at (510) 685-4053.

McCAMPBELL ANALYTICAL INC.	110 2nd Avenue South, #D7, Pacheco, CA 94553 Tele: 510-798-1620 Fax: 510-798-1622
----------------------------	--

Environmental Science & Eng. 4090 Nelson Avenue, Suite J Concord, CA 94520	Client Project ID: Alameda Co. GSA- Juvenile Hall	Date Sampled: 10/11/94
	Client Contact: Jay Carpenter	Date Received: 10/11/94
	Client P.O.:	Date Extracted: 10/11/94
		Date Analyzed: 10/11/94

Diesel Range (C10-C23) Extractable Hydrocarbons as Diesel *
 EPA methods modified 8015, and 3550 or 3510; California RWOCB (SF Bay Region) method GCFID(3550) or GCFID(3510)

Lab ID	Client ID	Matrix	TPH(d) ⁺	% Recovery Surrogate
41516	T2-20	S	ND	101
41517	T1-1-NE	S	470,a	103
41518	T1-2-NE	S	4800,a	118 [#]
41519	T3-N-23'	S	ND	100
41520	T4-N-20'	S	1000,a	102
Detection Limit unless otherwise stated; ND means Not Detected	W		50 ug/L	
	S		10 mg/kg	

*water samples are reported in ug/L, soil samples in mg/kg, and all TCLP extracts in mg/L

cluttered chromatogram; surrogate and sample peaks co-elute or surrogate peak is on elevated baseline

+ The following descriptions of the TPH chromatogram are cursory in nature and McCampbell Analytical is not responsible for their interpretation: a) unmodified or weakly modified diesel is significant; b) diesel range compounds are significant; no recognizable pattern; c) modified diesel?; light (CL) or heavy (CH) diesel compounds are significant; d) gasoline range compounds are significant; e) medium boiling point pattern that does not match diesel(?); f) one to a few isolated peaks present; g) oil range compounds are significant; h) lighter than water immiscible phase is present.

DATE 10/11/94 PAGE 1 OF 1

CHAIN OF CUSTODY RECORD

3044 AESE84

PROJECT NAME ACGSA - Juni Hall
 ADDRESS San Leandro

PROJECT NO. _____

SAMPLED BY M. Forest

LAB NAME _____



Environmental Science & Engineering, Inc.

4191 Nelson Avenue
 State 1
 Concord, CA 94531

Phone (510) 685-4057

Fax (510) 685-5323

SAMPLE #	DATE	TIME	LOCATION	ANALYSES TO BE PERFORMED										MATRIX	NUMBER OF CONTAINERS	REMARKS (CONTAINER, SIZE, ETC.)		
				TCH-O	BTEX													
T2-20	10/11	11:45	San Leandro	X	X													
T1-1-NE	10/11	12:00	"	X	X													
T1-2-NE	10/11	12:05	"	X	X													
T3-N-23	10/11	13:55	"	X	X													
T6-N-60	10/11	14:00	"	X	X													

REMARKS (CONTAINER, SIZE, ETC.)
2" brass tubes
41516
41517
41518
41519
41520

RELINQUISHED BY: (signature) <i>M. Forest</i>	RECEIVED BY: (signature) <i>Chicki Ricca</i>	date time 10/11/94
--	---	-----------------------

TOTAL NUMBER OF CONTAINERS	REPORT RESULTS TO: Jay Callender	SPECIAL SHIPMENT REQUIREMENTS 24 hr Priority turnaround
----------------------------	-------------------------------------	--

INSTRUCTIONS TO LABORATORY (handling, analyses, storage, etc.):
 PRESERVATIVE APPROPRIATE CONTAINERS
 VIALS U&G/NEALS/OTHER
 ICE/F
 GOOD CONDITION
 HEAD SPACE ABSENT

SAMPLE RECEIPT	CHAIN OF CUSTODY SEALS
REC'D GOOD COND'TN/COLD	<input checked="" type="checkbox"/>
CONFORMS TO RECORD	<input checked="" type="checkbox"/>

10/12/94 16:47
 10-12-1994 01:09PM FROM McCampbell Analytical Inc TO ESE, INC. CON
 510 685 5323
 ESE P.02 007/011

McCAMPBELL ANALYTICAL INC.	110 2nd Avenue South, #D7, Pacheco, CA 94553 Tele: 510-798-1620 Fax: 510-798-1622
----------------------------	--

Environmental Science & Eng 4090 Nelson Avenue, Suite J Concord, CA 94520	Client Project ID: # 6945257; GSA-J.H.	Date Sampled: 10/11/94
		Date Received: 10/11/94
	Client Contact: Jay Carpenter	Date Extracted: 10/11/94
	Client P.O:	Date Analyzed: 10/11/94

Diesel Range (C10-C23) Extractable Hydrocarbons as Diesel *
 EPA methods modified 8015, and 3550 or 3510; California RWQCB (SF Bay Region) method GCFID(3550) or GCFID(3510)

Lab ID	Client ID	Matrix	TPH(d) [†]	% Recovery Surrogate
41522	T5-N-23'	S	ND	100
41523	SP-Comp	S	ND	100
41524	SPT-1-Comp	S	ND	103
41525	SPT-2-Comp	S	1000 _a	103
Detection Limit unless otherwise stated; ND means Not Detected	W		50 ug/L	
	S		10 mg/kg	

*water samples are reported in ug/L, soil samples in mg/kg, and all TCLP extracts in mg/L.
 # cluttered chromatogram; surrogate and sample peaks co-elute or surrogate peak is on elevated baseline
 † The following descriptions of the TPH chromatogram are cursory in nature and McCampbell Analytical is not responsible for their interpretation: a) unmodified or weakly modified diesel is significant; b) diesel range compounds are significant; no recognizable pattern; c) modified diesel?; light(CL) or heavy(CH) diesel compounds are significant; d) gasoline range compounds are significant; e) medium boiling point pattern that does not match diesel(?); f) one to a few isolated peaks present; g) oil range compounds are significant; h) lighter than water immiscible phase is present.

McCAMPBELL ANALYTICAL INC. 110 2nd Avenue South, #D7, Pacheco, CA 94553
 Tele: 510-798-1620 Fax: 510-798-1622

Environmental Science & Eng. 4090 Nelson Avenue, Suite J Concord, CA 94520	Client Project ID: # 6945257; GSA-J.H.	Date Sampled: 10/11/94
		Date Received: 10/11/94
	Client Contact: Jay Carpenter	Date Extracted: 10/11/94
	Client P.O:	Date Analyzed: 10/11/94

Gasoline Range (C6-C12) Volatile Hydrocarbons as Gasoline*, with BTEX*
 EPA methods 5030, modified 8015, and 8220 or 802; California RWQCB (SF Bay Region) method GCFID(5030)

Lab ID	Client ID	Matrix	TPH(g) ⁺	Benzene	Toluene	Ethylbenzene	Xylenes	% Rec. Surrogate
41522	T5-N-23'	S	---	ND	ND	ND	ND	97
41523	SP-Comp	S	---	ND	ND	ND	ND	96
41524	SPT-1-Comp	S	---	ND	ND	ND	ND	98
41525	SPT-2-Comp	S	---	ND	ND	0.041	0.12	97
Detection Limit unless otherwise stated; ND means Not Detected	W	50 ug/L	0.5	0.5	0.5	0.5	0.5	
	S	1.0 mg/kg	0.005	0.005	0.005	0.005	0.005	

*water samples are reported in ug/L, soil samples in mg/kg, and all TCLP extracts in mg/L
 # cluttered chromatogram; sample peak co-elutes with surrogate peak
 + The following descriptions of the TPH chromatogram are cursory in nature and McCampbell Analytical is not responsible for their interpretation: a) unmodified or weakly modified gasoline is significant; b) heavier gasoline range compounds are significant(aged gasoline?); c) lighter gasoline range compounds (the most mobile fraction) are significant; d) gasoline range compounds are significant; no recognizable pattern; e) TPH pattern that does not appear to be derived from gasoline (?); f) one to a few isolated peaks present; g) strongly aged gasoline or diesel range compounds are significant; h) lighter than water immiscible phase is present.

3046 AESE 85

McCAMPBELL ANALYTICAL

110 2nd AVENUE, # D7

PACHECO, CA 94553

(510) 700-1620

FAX (510) 700-1622

CHAIN OF CUSTODY RECORD

TURN AROUND TIME:

RUSH 24 HOUR 48 HOUR 5 DAY

REPORT TO: J. CARPENTER

BILL TO: ESE

ANALYSIS REQUEST

OTHER

COMPANY: ESE

TELE: 685-4053

FAX #: 685-5323

PROJECT NUMBER: 6945257

PROJECT NAME: 66A-J.H

PROJECT LOCATION: JOURNAL HALL

SAMPLER SIGNATURE: *[Signature]*

COMMENTS

SAMPLE ID	LOCATION	SAMPLING		# CONTAINERS	TYPE CONTAINERS	MATRIX							METHOD PRESERVED	ANALYSIS REQUEST	OTHER	COMMENTS				
		DATE	TIME			WATER	SOIL	AIR	SLUDGE	OTHER	HCL	HNO ₃					OTHER			
T5-N-23	EXCAVATION	10/11/94	14:20	1	PLUG	X	X													
SP-1-3	STOCK PILE	"		1	"	X	X													
SP-1-4	"	"		1	"	X	X													
SP-2-1	"	"		1	"	X	X													
SP-2-2	"	"		1	"	X	X													
SPT-1-1	"	"		1	"	X	X													
SPT-1-2	"	"		1	"	X	X													
SPT-1-3	"	"		1	"	X	X													
SPT-1-4	"	"		1	"	X	X													
SPT-2-1	"	"		1	"	X	X													
SPT-2-2	"	"		1	"	X	X													
SPT-2-3	"	"		1	"	X	X													
SPT-2-4	"	"		1	"	X	X													

RELINQUISHED BY: <i>[Signature]</i>	DATE: 10/11/94	TIME: 17:20	RECEIVED BY: <i>[Signature]</i>
RELINQUISHED BY:	DATE:	TIME:	RECEIVED BY:
RELINQUISHED BY:	DATE:	TIME:	RECEIVED BY LABORATORY:

REMARKS:

ICE/T ✓
GOOD CONDITION ✓
HEAD SPACE ABSENT ✓

PRESERVE TIME APPROPRIATE CONTAINERS ✓

VOL% WAG METALS OTHER

10-12-1994 11:33AM FROM McCampbell Analytical Inc TO ESE P.02

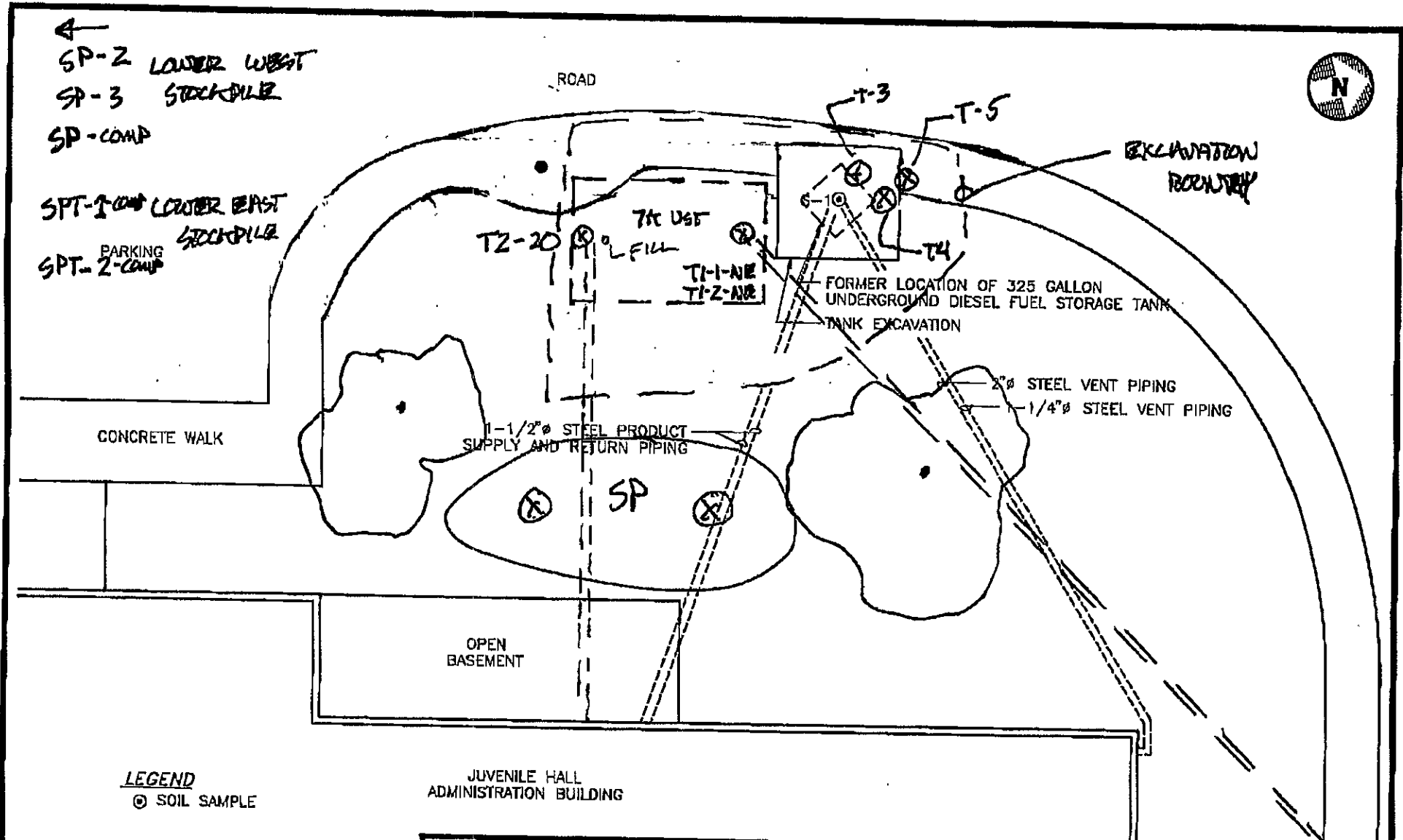

LEGEND
 ⊙ SOIL SAMPLE

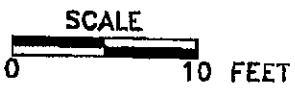

 Environmental Science & Engineering, Inc. <small>A GILCORP Company</small>	DATE 7/93	TANK PLAN	FIGURE NO. 3
	REVISED		ALAMEDA COUNTY GENERAL SERVICES AGENCY ALAMEDA COUNTY JUVENILE HALL SAN LEANDRO, CALIFORNIA
4090 NELSON AVENUE, SUITE J CONCORD, CA 94520	CAD FILE 50611003		