



WALLACE • KUHL  
& ASSOCIATES INC.

ENVIRONMENTAL  
PROTECTION  
97 JUN 18 PH 2:42

June 16, 1997

Ms. Amy Leech  
Alameda County Environmental Health Services  
1131 Harbor Bay Parkway, Suite 250  
Alameda, California 94502-6577

**WELL ABANDONMENT NOTIFICATION**  
**CALTRANS HAYWARD MAINTENANCE STATION**  
21195 Center Street  
Castro Valley, California

Dear Ms. Leech,

At your request, I have attached two copies of site maps originally provided to me by you. Locations of the three vapor wells (VW1-VW3) and the single groundwater monitoring well (MW1) are shown on the two maps and correspond with the wells destroyed. I have also attached a copy of the approved drilling permit application from Zone 7 Water Agency.

If you have any questions, please do not hesitate to contact me.

Wallace - Kuhl & Associates, Inc.

Kurt Balasek  
Senior Hydrogeologist

KMB:sdm

Copies to: Wyman Hong, Zone 7 Water Resources Management  
Mike Golden, Division of the State Architect

Geotechnical Engineering

Engineering Geology

Environmental Consulting

Remediation Services

Construction Inspection

Materials Testing

3050 Industrial Blvd.

K33474-01.112

West Sacramento

CA 95691

Fax 916.372.2565

916.372.1434



**WALLACE - KUHL  
& ASSOCIATES INC.**

June 11, 1997

Ms. Amy Leech  
Alameda County Environmental Health Services  
1131 Harbor Bay Parkway, Suite 250  
Alameda, California 94502-6577

**WELL ABANDONMENT NOTIFICATION  
CALTRANS HAYWARD MAINTENANCE STATION  
21195 Center Street  
Hayward, California**

Dear Ms. Leech,

In accordance with our telephone conversation of May 20, 1997, I am writing to inform you that we have completed the abandonment of four monitoring wells at the above referenced site.

The work was completed on Thursday, May 22, 1997 and included complete overdrill of three two-inch diameter, 35 foot deep wells, and one four-inch diameter, 40 foot deep well. Once each well was overdrilled, a tremmie system was used to fill the wells to the surface with cement grout. The tops of each well were capped with ready mix concrete to avoid trip hazards and provide strength to support traffic. All work was completed in accordance with the Alameda County Flood Control and Water Conservation District, Zone 7 Water Resource Management Department requirements.

If you have any questions, please do not hesitate to contact me.

Wallace - Kuhl & Associates, Inc.

  
Kurt Balasek  
Senior Hydrogeologist

KMB:sdm

Copies to: Wyman Hong, Zone 7 Water Resources Management  
Mike Golden, Division of the State Architect

K 3174-01 ltr

Geotechnical Engineering

Engineering Geology

Environmental Consulting

Remediation Services

Construction Inspection

Materials Testing

3050 Industrial Blvd.

West Sacramento

CA 95691

Fax 916.372.2565

916.372.1434



# ZONE 7 WATER AGENCY

5997 PARKSIDE DRIVE, PLEASANTON, CALIFORNIA 94588-6127 PHONE (510) 484-2600 X236  
FAX (510) 462-3914

## DRILLING PERMIT APPLICATION

### FOR APPLICANT TO COMPLETE

### FOR OFFICE USE

LOCATION OF PROJECT 21195 CENTER STREET  
CASTRO VALLEY HAZARD, CALIFORNIA

PERMIT NUMBER 97285  
WELL NUMBER 3S/2W 2N80 to 2N82  
APN 084C-0650-001-00

California Coordinates Source \_\_\_\_\_ ft. Accuracy ± \_\_\_\_\_ ft.  
CCN \_\_\_\_\_ ft. CCE \_\_\_\_\_ ft.  
APN 084C-0650-001-00

### PERMIT CONDITIONS

Circled Permit Requirements Apply

#### CLIENT

Name DIVISION OF THE STATE ARCHITECT  
Address 1300 T STREET Phone (916) 445-3521  
City SACRAMENTO Zip 95814

#### A. GENERAL

1. A permit application should be submitted so as to arrive Zone 7 office five days prior to proposed starting date.
2. Submit to Zone 7 within 60 days after completion of project work the original Department of Water Resources Well Drillers Report or equivalent for well projects, or drill log and location sketch for geotechnical projects.
3. Permit is void if project not begun within 90 days of start date.

#### APPLICANT

Name KURT BALABEK  
WALLACE-KUHL & ASSOC. INC. Fax (916) 372-9065  
Address 3050 INDUSTRIAL BLVD Phone (916) 372-1434  
City WEST SACRAMENTO Zip \_\_\_\_\_

#### B. WATER SUPPLY WELLS

1. Minimum surface seal thickness is two inches of cement placed by tremie.
2. Minimum seal depth is 50 feet for municipal and irrigation wells or 20 feet for domestic and irrigation wells unless lesser depth is specially approved.

#### TYPE OF PROJECT

Well Construction		Geotechnical Investigation	
Cathodic Protection	<input type="checkbox"/>	General	<input type="checkbox"/>
Water Supply	<input type="checkbox"/>	Contamination	<input type="checkbox"/>
Monitoring	<input type="checkbox"/>	Well Destruction	<input checked="" type="checkbox"/>

#### C. GROUNDWATER MONITORING WELLS INCLUDING PIEZOMETERS

1. Minimum surface seal thickness is two inches of cement placed by tremie.
2. Minimum seal depth for monitoring wells is the maximum depth practicable or 20 feet.

#### PROPOSED WATER SUPPLY WELL USE

New Domestic	<input type="checkbox"/>	Replacement Domestic	<input type="checkbox"/>
Municipal	<input type="checkbox"/>	Irrigation	<input type="checkbox"/>
Industrial	<input type="checkbox"/>	Other _____	<input type="checkbox"/>

#### D. GEOTECHNICAL. Backfill bore hole with compacted cuttings, heavy bentonite and upper two feet with compacted material in areas of known or suspected contamination, tremied grout shall be used in place of compacted cuttings.

#### DRILLING METHOD:

Mud Rotary	<input type="checkbox"/>	Air Rotary	<input type="checkbox"/>	Auger	<input checked="" type="checkbox"/>
Cable	<input type="checkbox"/>	Other	<input type="checkbox"/>		

#### E. CATHODIC. Fill hole above anode zone with concrete placed by tremie.

DRILLER'S LICENSE NO. \_\_\_\_\_

#### F. WELL DESTRUCTION. See attached. G. SPECIAL CONDITIONS

#### WELL PROJECTS

Drill Hole Diameter	<u>10</u> in.	Maximum	
Casing Diameter	<u>4</u> in.	Depth	<u>35</u> ft.
Surface Seal Depth	<u>11</u> ft.	Number	<u>3</u>

#### GEOTECHNICAL PROJECTS

Number of Borings	_____	Maximum	
Hole Diameter	_____ in.	Depth	_____ ft.

ESTIMATED STARTING DATE 0800 5-9-97  
ESTIMATED COMPLETION DATE 1300 5-7-97

Approved Wynian Hong Date 7 May

I hereby agree to comply with all requirements of this permit and Alameda County Ordinance No. 73-88.



SHED/GARAGE

ASPHALT COVERAGE

LEGEND



Lateral Extent of Contamination

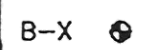

Tetra Tech, Inc. Boring Completed During

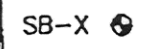

Geo/Resources Boring Completed During

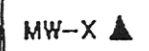

Monitoring Well Completed During



Extent of Profile

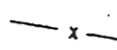

Chain Linked Fence

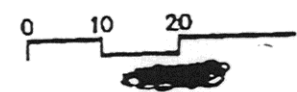

**Tt** SITE INVESTIGATION  
 HAYWARD MAINT.  
 CALTRANS  
 CASTRO VALLEY, CA

**TETRA TECH,**  
 PASADENA, CALIFORNIA

**FIGURE 2** SITE PLAN VIEW  
 BORING LOCATIONS

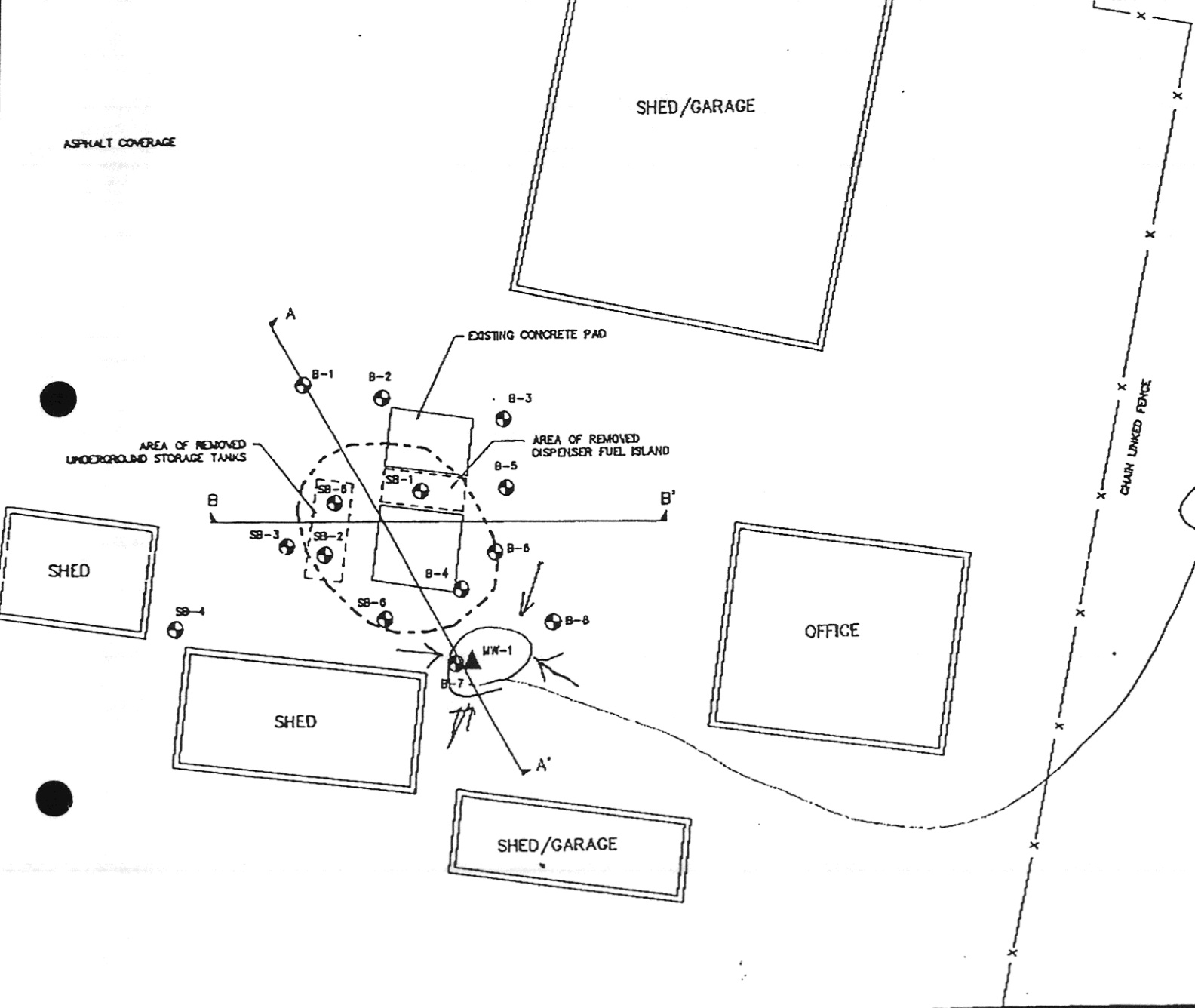



Approximate ground water flow direction at a gradient of 0.01 - 0.02 ft/ft

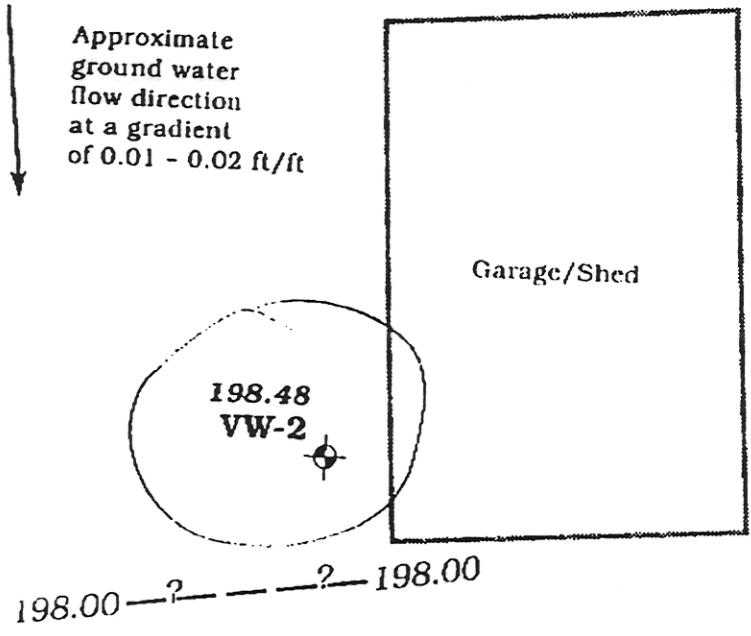

Locations of monitoring wells VM1, VM2, & VM3

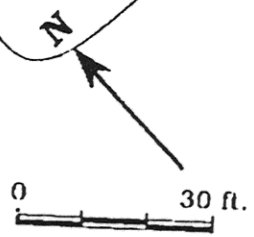
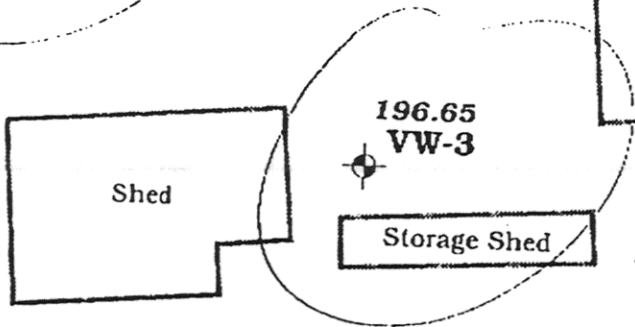
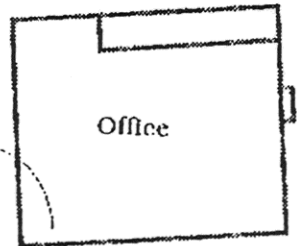
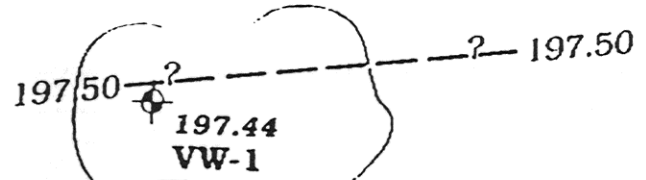

EXPLANATION	
	VW-3 Vadose well
196.65	Ground water elevation, in feet
- 198.00	Ground water elevation contour, dashed where inferred, queried where uncertain

Base map ref: Field Survey

Figure 3. Monitoring Well Location and Ground Water Elevation Contour Map - March 12, 1996 - Caltrans Maintenance Facility, 21175 Center Street, Castro Valley, California

**ALAMEDA COUNTY ENVIRONMENTAL  
HEALTH SERVICES**

**ENVIRONMENTAL PROTECTION DIVISION**

1131 Harbor Bay Parkway, Suite 250

Alameda, CA 94502-6577

Telephone (510) 567-6700

Fax (510) 337-9335

**FAX COVER SHEET**

DATE: March 25, 1994

TO: Eric Hubbard  
Wallace, Cool & Assoc.

FAX # (916) 372-9065

Total number of pages including cover sheet 7

FROM: Amy Leech  
(510) 567-6755

NOTE: Re: 21195 Center St., Castro Valley, CA 94546

See attached maps locating monitoring  
well MW-1 and VM-1, VM-2, & VM-3. Also,  
attached are borings logs for VM-1 & VM-3.

(SMILE) HAVE A NICE DAY  
DO SOMETHING FOR OUR ENVIRONMENT

JDSB0396

Boring or construction logs were not included  
w/ the installation report for MW-1;  
MW-1 was installed in Feb. 1991.

Please call if you have questions.

Sincerely Amy Leech

**ALAMEDA COUNTY ENVIRONMENTAL  
HEALTH SERVICES**

**ENVIRONMENTAL PROTECTION DIVISION  
1131 Harbor Bay Parkway, Suite 250  
Alameda, CA 94502-6577  
Telephone (510) 567-6700 Fax (510) 337-9335**

**FAX COVER SHEET**

DATE: Dec. 12, 1996

TO: David Bransley

FAX # (510) ~~337-9335~~ 370-7959

Total number of pages including cover sheet 2

FROM: Amy Heera  
(510) 567-6755

NOTE:

**PLEASE RESPOND BY FAX ONLY.**

Please find attached request for well destruction  
at 21195 Center St., Castro Valley, CA.

(SMILE) HAVE A NICE DAY  
DO SOMETHING FOR OUR ENVIRONMENT

ALAMEDA COUNTY  
HEALTH CARE SERVICES

AGENCY

DAVID J. KEARS, Agency Director



StId 3062

ENVIRONMENTAL HEALTH SERVICES  
ENVIRONMENTAL PROTECTION (LOP)  
1131 Harbor Bay Parkway, Suite 250  
Alameda, CA 94502-6577  
(510) 567-6700  
FAX (510) 337-9335

October 30, 1996

Attn: Carlos Lopez  
Dept. of Transportation  
1120 "N" St., 3rd Floor  
Sacramento CA 95814

Subject: Well destruction request for Caltrans Hayward Maintenance Station located at 21195 Center St.,  
Castro Valley ← Hayward CA

The Alameda County Department of Environmental Health, Environmental Protection Division and the San Francisco Regional Water Quality Control Board have reviewed the case closure summary for the above referenced site and concur that no further action related to the release(s) from the former underground storage tanks is required at this time.

Please be advised that if there are no plans to continue groundwater monitoring, the four groundwater monitoring wells (MW-1/unknown, VM-1, VM-2, VM-3) at the site must be properly decommissioned before our agency will issue the Remedial Action Completion Certification (closure letter). A report must be submitted to this office documenting the abandonment of the monitoring wells or a letter stating your intentions to continue groundwater monitoring at the site.

Well destruction permits may be obtained from Alameda County Flood Control and Water Conservation, Zone 7. Their telephone number is (510)484-2600. Additionally, you will need to notify this office 72 hours in advance of the well abandonment field activities.

Please call me at (510)567-6755 if you have questions.

Sincerely,

Amy Leech  
Hazardous Materials Specialist

c: Attn: David M Beardsley  
Sierra Environmental Services  
PO Box 2546  
Martinez CA 94553

Kevin Graves, RWQCB  
Gordon Coleman - File(ALL)



ALAMEDA COUNTY  
HEALTH CARE SERVICES

AGENCY

DAVID J. KEARS, Agency Director



RAFAT A. SHAHID, Assistant Agency Director

STID 3062

March 16, 1995

Ms. Mary Cooper  
Office of the State Architect  
400 P Street  
Sacramento, CA 95814

Alameda County CC4530  
Environmental Protection Division  
1131 Harbor Bay Parkway, Room 250  
Alameda CA 94502-6577

RE: HAYWARD MAINTENANCE STATION, 21195 CENTER STREET, CASTRO VALLEY

Dear Ms. Cooper:

I am in receipt of the November 15, 1994 Sierra Environmental Services (SES) report confirming the discovery and subsequent monitoring and sampling of ground water in the well network at the referenced site on October 28, 1994. You may recall that such post-remediation monitoring and sampling are the final tasks associated with the corrective action affected at the site during 1992.

Please begin adhering to a quarterly schedule of sampling and monitoring, and reporting. Please also have the well locations and elevations surveyed, and referenced to a permanent benchmark. Elevations are to be reported relative to mean sea level (MSL). All quarterly reports are to include, among other elements, depth-to-water measurements and ground water elevations, calculated gradient and flow directions (represented graphically), and sample results, including copies of laboratory reports and chain-of-custody documents.

This schedule should be implemented immediately. Please call me at 510/567-6783 should you have any questions.

Sincerely,

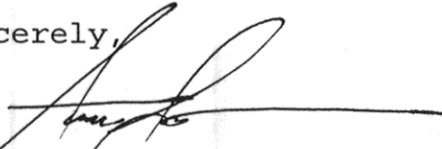
  
Scott O. Seery, CHMM  
Senior Hazardous Materials Specialist

cc: Rafat A. Shahid, Agency Director  
Ed Laudani, Alameda County Fire Department  
Michael Hilliard, CA Department of Transportation  
P.O. Box 23660, Oakland, CA 94623-0660  
Wayne S. Akiyama, Sierra Environmental Services  
P.O. Box 2546, Martinez, CA 94553

ALCO  
HAZMAT

94 OCT 28 PM 3: 10



October 26, 1994

Mr. Scott O. Seery, CHMM  
Alameda County Health Care Services Agency  
1131 Harbor Bay Parkway, Suite 250  
Alameda, CA 94502-6577

Re: Work Plan for Ground Water Sampling  
CALTRANS Hayward Maintenance Yard  
21195 Center Street  
Hayward, CA  
SES Project No. MR-903-04

Dear Mr. Seery:

Per Sierra Environmental Services (SES)'s contract with the Division of State Architects, SES has been retained to represent CALTRANS in the sampling of three monitoring wells at CALTRANS's Hayward Maintenance Yard located at 21195, Center Street, Castro Valley, California. SES understands that the monitoring wells were installed by Tetra Tech in September, 1992. Initially, these monitoring wells were dry.

If there is ground water present, SES will measure the ground water level to determine the direction and gradient of ground water flow and sample the monitoring wells for: Total Purgable Petroleum Hydrocarbons as gasoline (TPPH-G), total petroleum hydrocarbons as diesel (TPH-D), and the volatile aromatic hydrocarbons benzene, toluene, ethylbenzene and total xylenes (BTEX). The sampling methodology is outlined in the SES Standard Operating Procedure (SOP) attached.

Please do not hesitate to call if you have any questions.

Sincerely,  
Sierra Environmental Services, Inc.

A handwritten signature in cursive script, appearing to read "Wayne S. Akiyama".

Wayne S. Akiyama, R.G., R.E.A.  
Senior Hydrogeologist

WSA/lmo

Enclosure

cc: Mike Golden, Division of State Architect (with enclosure)



## **SES STANDARD OPERATING PROCEDURE**

### **GROUND WATER SAMPLING**

The following describes sampling procedures used by SES field personnel to collect and handle ground water samples. Before samples are collected, careful consideration is given to the type of analysis to be performed so that precautions are taken to prevent loss of volatile components or contamination of the sample, and to preserve the sample for subsequent analysis. Wells will be sampled no less than 24 hours after well development. Collection methods specific to ground water sampling are presented below.

Prior to sampling, each well is checked for the presence of free-phase hydrocarbons using an MMC flexi-dip interface probe. Product thickness (measured to the nearest 0.01 foot) is noted on the sampling form. Water level measurements are also made using either a water level meter or the interface probe. The water level measurements are also noted on the sampling form.

Prior to sampling, each well is purged of a minimum of four well casing volumes of water using a steam-cleaned PVC bailer, or a pre-cleaned pump. Temperature, pH and electrical conductivity are measured at least three times during purging. Purging is continued until these parameters have stabilized (i.e., changes in temperature, pH or conductivity do not exceed  $\pm 0.5^{\circ}\text{F}$ , 0.1 or 5%, respectively).

The purge water is stored temporarily on-site in 55-gallon Department of Transportation-approved drums pending analytic results. The drums are labeled with the date, contents, the SES field personnel initials and SES phone number.

Ground water samples are collected from the wells with steam-cleaned Teflon bailers. The water samples are decanted into the appropriate container for the analysis to be performed. Pre-preserved sample containers may be used or the analytic laboratory may add preservative to the sample upon arrival. Duplicate samples are collected from each well as a back-up sample and/or to provide quality control. The samples are labeled to include the project number, sample ID, date, preservative, and the field person's initials. The samples are placed in polyethylene bags and in an ice chest (maintained at  $4^{\circ}\text{C}$  with blue ice or ice) for transport under chain-of-custody to the laboratory.

LOP - RECORD CHANGE REQUEST FORM

*LOW SOS* *File*

printed:  
07/22/94

Mark Out What Needs Changing and Hand to LOP Data Entry  
(Name/Address changes go to Annual Programs Data Entry)

AGENCY # : 10000      SOURCE OF FUNDS: F      SUBSTANCE: 12034  
 StID : 3062  
 SITE NAME: Caltrans      DATE REPORTED : 02/28/89  
 ADDRESS : 21195 Center St      DATE CONFIRMED: 01/18/89  
 CITY/ZIP : Castro Valley 94546      MULTIPLE RPs : N

SITE STATUS

CASE TYPE: S      CONTRACT STATUS: 7      PRIOR CODE: 3B1      EMERGENCY RESP:  
 RP SEARCH: S      DATE COMPLETED: 06/22/92  
 PRELIMINARY ASMNT: C      DATE UNDERWAY: 01/01/90      DATE COMPLETED: 01/30/90  
 REM INVESTIGATION: C      DATE UNDERWAY: 02/06/91      DATE COMPLETED: 02/11/91  
 REMEDIAL ACTION: C      DATE UNDERWAY: 09/01/92      DATE COMPLETED: 09/30/92  
 POST REMED ACT MON: U      DATE UNDERWAY: 09/30/92      DATE COMPLETED:

ENFORCEMENT ACTION TYPE: 1      DATE ENFORCEMENT ACTION TAKEN: 06/22/92  
 LUFT FIELD MANUAL CONSID: 2HSCAW  
 CASE CLOSED:      DATE CASE CLOSED:  
 DATE EXCAVATION STARTED : 01/18/89      REMEDIAL ACTIONS TAKEN: ED

RESPONSIBLE PARTY INFORMATION

RP#1-CONTACT NAME: Ms. Mary Cooper  
 COMPANY NAME: Office Of The State Architect  
 ADDRESS: 400 - P Street, 5th Floor  
 CITY/STATE: Sacramento, Ca 95814

*This is correct*  
*Change*

INSPECTOR VERIFICATION:

NAME \_\_\_\_\_ SIGNATURE \_\_\_\_\_ DATE \_\_\_\_\_

DATA ENTRY INPUT:

Name/Address Changes Only      Case Progress Changes  
 ANNPGMS \_\_\_\_\_ LOP \_\_\_\_\_ DATE \_\_\_\_\_      LOP \_\_\_\_\_ DATE \_\_\_\_\_

*Coni says 2 NORR's  
 1 - sep 8, 92 Dept of Trans  
 Carlos Lopez*

*See attached  
 CalTrans notice.*

*& above,  
 which is correct*

*See me, [signature]*

## KEY TO ABBREVIATIONS and METHOD REFERENCES

- < : Less than; When appearing in results column indicates analyte not detected at the value following, which supercedes the listed reporting limit.
- mean : Average; sum of measurements divided by number of measurements.
- mg/Kg (ppm) : Concentration in units of milligrams of analyte per kilogram of sample, wet-weight basis (parts per million).
- mg/L : Concentration in units of milligrams of analyte per liter of sample.
- mL/L/hr : Milliliters per liter per hour.
- MPN/100 mL : Most probable number of bacteria per one hundred milliliters of sample.
- N/A : Not applicable.
- NA : Not analyzed.
- ND : Not detected; the analyte concentration is less than applicable listed reporting limit.
- NTU : Nephelometric turbidity units.
- RPD : Relative percent difference,  $100 \text{ [Value 1 - Value 2] / mean value}$ .
- SNA : Standard not available.
- ug/Kg (ppb) : Concentration in units of micrograms of analyte per kilogram of sample, wet-weight basis (parts per billion).
- ug/L : Concentration in units of micrograms of analyte per liter of sample.
- urnos/cm : Microrhos per centimeter.

### Method References

Methods 601 through 625: see "Guidelines Establishing Test Procedures for the Analysis of Pollutants" U.S. EPA, 40 CFR, Part 136, rev. 1988.

Methods 1000 through 9999: see "Test Methods for Evaluating Solid Waste", U.S. EPA SW-846, 3rd edition, 1986.

- \* Reporting Limits are a function of the dilution factor for any given sample. To obtain the actual reporting limits for this sample, multiply the stated reporting limits by the dilution factor.

## DEPARTMENT OF TRANSPORTATION

BOX 23660  
OAKLAND, CA 94623-0660  
(510) 286-4444  
TDD (510) 286-4454



July 12, 1994

320.41

Mr. Scott O. Seery  
Alameda County, Health Care Services  
Department of Environmental Health  
UST Local Oversight Program  
80 Swan Way, Room 200  
Oakland, CA 94621

Dear Mr. Seery:

RE: Caltrans Maintenance Station, 21195 Center Street,  
Castro Valley

This is a follow-up letter to the telephone conversation between yourself and Mr. Michael Hilliard, Caltrans Maintenance Superintendent, on June 6, 1994 regarding "dry" wells installed following the Underground Storage Tank Removal Project at our Castro Maintenance Facility, September 1992.

Based on our preliminary investigation of this matter in June water was detected in the wells.

We contacted both the Division of State Architect Office, and Tetra Tech as a follow-up to the data requested by your office earlier this year. We are still waiting for the preliminary and final reports.

Upon receipt of the reports, copies will be immediately forwarded to your office. Attached is the most recent correspondence received from Tetra Tech, Inc.

For further assistance in this matter, we have requested the Division of State Architect Office in Sacramento to follow-up with a contract which will sample the wells pursuant to the Regulatory Requirements and your office.

We are willing to work with the County in developing a new plan of action to mitigate the remediation and achieve well closure as our ultimate goal.

Mr. Scott O. Seery  
July 12, 1994  
Page 2

Should you required further assistance in this matter contact Ms. Margaret Gabil, Maintenance Service Branch, at (510) 286-4509 or Mr. Michael Hilliard, at (510) 286-4495.

Sincerely,

JOE BROWNE  
District Director

By

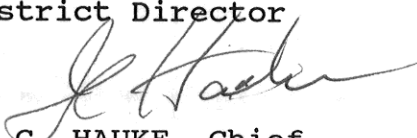
  
J. C. HAUKE, Chief  
Highway Maintenance Branch

Attachment

cc: Dan Batrack, Tetra Tech, Inc.  
670 Rosemead Boulevard  
Pasadena, CA 91107



Tetra Tech, Inc.

70 N. Rosemead Blvd.  
Pasadena, CA 91107  
818-449-6400 / fax 351-8126

July 7, 1994

Mr. Mike Hilliard  
California Department of Transportation  
21195 Center Street  
Castro Valley, CA 94546

Subject: Excavation of Contaminated Soils  
and  
Installation of Dry Monitoring Wells

Dear Mr. Hilliard:

I am forwarding an additional copy of the Final Site Remediation Report prepared by Tetra Tech documenting the excavation and removal of the contaminated soil and subsequent installation of three dry monitoring wells at the Hayward Maintenance Station. At the time of Tetra Tech's drilling programs and follow-on soil excavation at the site, no groundwater was encountered.

In order to meet groundwater monitoring requirements of the Alameda County Environmental Health Department (ACEHD), three dry groundwater monitoring wells were installed at the site. As presented in the attached Site Remediation Report;

*"The dry wells have been designed and constructed in accordance with local and State regulated guidelines for the purpose of long-term monitoring for the presence of groundwater. Preliminary monitoring indicated no groundwater had accumulated into the wells. To document the presence or absence of groundwater, monitoring will continue on a quarterly basis for a period of one year. In the event that groundwater is detected in one or more of the wells, water samples will be collected from each well analyzed for the presence of petroleum contaminants. Quarterly reports will be submitted to ACEHD to document monitoring efforts."*



Mr. Mike Hilliard  
July 7, 1994  
page 2

I have reviewed our files for any record of quarterly monitoring of the wells that may have been performed by Tetra Tech. Unfortunately, I have no record of our staff performing any quarterly monitoring of these dry wells after the date of first installation on September 28, 1992. At the time of well installations, the keys for each well were given to Mr. Joe Thomas at the maintenance station.

I have attached a copy of our standard Well Development / Groundwater Sampling Log that would typically be completed during the inspection and sampling of groundwater monitoring wells. In the event that no water is present in a given well, the field log would be so noted and signed. I anticipate that Mr. Scott Seery from the ACEHD will require these monitoring logs. In the event that the wells have not been monitored for four continuous *quarters (once every 3 months)*, future inspection of the wells may have to be conducted.

Please review the attached report and groundwater sampling log. If you have any questions regarding the past events or the requirements for monitoring the existing wells please contact me at 818-449-6400.

Sincerely



Dan Batrack  
Project Manager,  
Tetra Tech, Inc.

cc: File TC-8380-01  
Mr. M. Golden, D.S.A.  
Ken Chapin, Tt



TETRA TECH, INC.  
 830 NORTH ROSEMEAD BLVD  
 PASADENA, CA 91107-2180  
 (818) 448-4400

WELL DEVELOPMENT - GROUNDWATER SAMPLING LOG

Project CAL TRANS MAINT STATION HAYWARD Sheet 1 of 1 Date 12/17/91  
 Development Equip. - Sampling Equipment -  
 Location - Client OSA Samplers R

Well No.	Well Depth (ft)	Depth to Water (ft, TOC)	Water Column (ft)	Well Volume (gal)	Time	Q (gpm)	Volume Purged (gal)	Temp.	pH	Cond.	Remarks
VW-1											CAL TRANS TRUCK PARKED OVER WELL Unable to get to well
VW-2											CAL TRANS TRUCK parked on Well
VW-3											CAL TRANS EQUIPMENT parked over Well



TETRA TECH, INC.  
 600 NORTH ROSEMead BLVD  
 PASADENA, CA. 91107-2190  
 (818) 448-8400

**WELL DEVELOPMENT - GROUNDWATER SAMPLING LOG**

Project \_\_\_\_\_ Sheet \_\_\_\_\_ of \_\_\_\_\_ Date \_\_\_\_\_

Development Equip. \_\_\_\_\_ Sampling Equipment \_\_\_\_\_

Location \_\_\_\_\_ Client \_\_\_\_\_ Samplers \_\_\_\_\_

Well No.	Well Depth (ft)	Depth to Water (ft, TOC)	Water Column (ft)	Well Volume (gal)	Time	Q (gpm)	Volume Purged (gal)	Temp.	pH	Cond.	Remarks

SENT BY: 7-29-03 11:44 AM TEL: 626-799-3467 FAX: 626-799-3468

ALAMEDA COUNTY  
HEALTH CARE SERVICES  
AGENCY

DAVID J. KEARS, Agency Director



RAFAT A. SHAHID, ASST. AGENCY DIRECTOR

DEPARTMENT OF ENVIRONMENTAL HEALTH  
State Water Resources Control Board  
Division of Clean Water Programs  
UST Local Oversight Program  
80 Swan Way, Rm 200  
Oakland, CA 94621  
(510) 271-4530

STID 3062

February 18, 1994

Ms. Mary Cooper  
Office of the State Architect  
400 P Street, 5th Floor  
Sacramento, CA 94514

RE: HAYWARD MAINTENANCE YARD, 21195 CENTER STREET, CASTRO  
VALLEY

Dear Ms. Cooper:

This letter is sent to request an update regarding the results of post-remediation monitoring of the "dry" wells installed following the September 1992 excavation of fuel-impacted soil from the referenced site. Monthly monitoring of these wells for the presence of ground water was a condition of approval of Tetra Tech's May 30, 1992 Remedial Action Plan (RAP) for this site. This requirement was memorialized in correspondence from this office dated August 7, 1992. To date, this office has not been apprised of the results of this monitoring.

Please submit all reports generated to date after November 1992 within 30 days of the date of this letter. I may be reached at 510/271-4530 should you have any questions.

Sincerely,

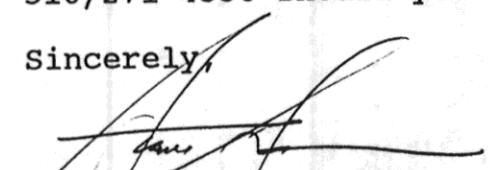
  
Scott O. Seery, CHMM  
Senior Hazardous Materials Specialist

cc: Rafat A. Shahid, Assistant Agency Director  
Gil Jensen, Alameda County District Attorney's Office  
Ed Laudani, Alameda County Fire Department  
Dan Batrack, Tetra Tech, Inc.  
670 Rosemead Blvd.  
Pasadena, CA 91107

**Alameda County Department of Environmental Health  
Hazardous Materials Division**

80 Swan Way, Rm. 200, Oakland, CA 94621  
Ph: 510-271-4320

**BILLING FOR SERVICES**

STID# 3062

A. Site Name Cal Trans Maintenance Station Phone \_\_\_\_\_  
21195  
 Site Address 3062 Center Street, Castro Valley  
(If no address, description of area) Number Street City Zip  
 Prior Business Name NA Prior Owner's Name NA

B. Service Requestor Tony Rose, Quantum Financial Inc., 530/0672  
Contact Person Company Name Phone  
 Billing Address 3544 Fruitvale Ave, Oakland 94602  
Number Street City Zip

<b>Category of Service</b>		#Hours	x \$	/Hr	\$
<input checked="" type="checkbox"/> Site Search		<u>1</u>		<u>75</u>	<u>75</u>
<input type="checkbox"/> File Search		<u>47</u>		<u>1</u>	<u>47</u>
<input type="checkbox"/> Other		_____	x \$	_____	\$ _____
					<b>TOTAL CHARGE: \$ <u>122</u></b>

REMARKS: review a case file w/ copies of pertinent documents

\_\_\_\_\_

\_\_\_\_\_

\_\_\_\_\_

\_\_\_\_\_

**You will receive an invoice in accordance with Article 11 of Chapter 6, Title 3 of the Ordinance Code of Alameda County**

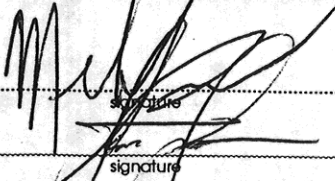
Service Requestor Mike Texas  Date 7-12-93  
printed name signature

HazMat Specialist Scott SCERY  Date 7-12-93  
printed name signature

# QUANTUM FINANCIAL INC.

3544 FRUITVALE AVE., OAKLAND, CA 94602

(510) 530-0672  
FAX (510) 530-2879

ALAMEDA COUNTY ENVIRONMENTAL HEALTH DEPT.  
HAZARDOUS MATERIALS DIV.  
80 SWAN WAY #200  
OAKLAND, CA 94621  
ATTN: SCOTT SEERY  
JULY 9, 1993

DEAR SCOTT,

THIS LETTER IS PURSUANT TO OUR CONVERSATION OF JULY 9, 1993  
REQUESTING OUR MEETING AND OUR REQUEST.

WHAT WE ARE NEEDING IS ANY INFORMATION REGARDING THE CAL-TRANS LOT  
LOCATED AT, 21196 CENTER STREET, CASTRO VALLEY CA.

WHAT EXACTLY OUR SITUATION IS , IS THAT THERE IS A SINGLE FAMILY  
PROPERTY LOCATED NEXT DOOR TO THE CAL-TRANS LOT AND IT IS CURRENTLY  
IS CONTRACT FOR SALE. WE HAVE SUBMITTED A LOAN REQUEST FOR THE  
PURCHASE OF THE PROPERTY AND HAS BEEN DENIED FOR THE REASON OF THE  
CAL-TRANS LOT HAVING A TANK LEAK.

THE LENDER HAS TOLD US THEY WOULD RECONSIDER THE LOAN REQUEST IF WE  
CAN SHOW THEM THAT THE PROPERTY (CAL TRANS LOT) HAS BEEN CLEANED OR  
THE PROBLEM HAS BEEN CORRECTED. SO WHAT WE WILL NEED IS ANY  
DOCUMENTATION SHOWING SO.

MYSELF OR MR. MIKE TEVES WILL BE MEETING YOU ON MONDAY, JULY 12,  
1993 AT 9:30 AM AT YOUR OFFICE, LOCATED AT: 80 SWAN WAY, OAKLAND.

WE ARE LOOKING FORWARD TO MEETING YOU MONDAY MORNING, IF YOU ARE  
UNABLE TO MAKE THE APPOINTMENT, PLEASE CONTACT MYSELF OR MIKE TEVES  
AND MAKE A NEW APPOINTMENT.

TONY ROSE            510 530-0672  
MIKE TEVES         510 886-7700

RESPECTFULLY,



TONY ROSE



Office  
of the  
State  
Architect

400 P Street, 5th Floor, Sacramento 95814

(916) 322-8994

92 AUG 14 PM 1:32

STID  
3062

August 11, 1992

Department of Environmental Health  
Alameda County  
80 Swan Way, Room 200  
Oakland, CA 94621

**PAYMENT FOR OVERSIGHT COSTS**  
**DEPARTMENT OF TRANSPORTATION**  
**21195 CENTER STREET**  
**CASTRO VALLEY, CA 94546**

Please change the name of the responsible party from Mary Cooper, Office of the State Architect, to the owner/operator, Department of Transportation, which should be receiving the enclosed billing costs for oversight of the Underground Storage Tank Program for the above facility. Please use the following address for the owner/operator:

Department of Transportation  
1120 N Street, Third Floor  
Sacramento, CA 95814  
ATTENTION: Carlos Lopez

Telephone: (916) 654-5077

A legal opinion to determine the authority of this office to reimburse such costs has been requested. Until such determination has been made, it is considered the responsibility of the owner/operator to pay the oversight costs.

If you have any questions, please contact me at (916) 322-8994.

Sincerely,

Michael J. Golden, Program Manager  
Underground Storage Tank Program

MJG:skf

Enclosure

cc: Carlos Lopez, Department of Transportation  
Facility File, Chron File



Office  
of the  
State  
Architect

400 P Street, 5th Floor, Sacramento 95814

(916) 322-8994

92 AUG 14 PM 1:32

STTD  
3062

August 11, 1992

Department of Environmental Health  
Alameda County  
80 Swan Way, Room 200  
Oakland, CA 94621

**PAYMENT FOR OVERSIGHT COSTS**  
**DEPARTMENT OF TRANSPORTATION**  
**21195 CENTER STREET**  
**CASTRO VALLEY, CA 94546**

Please change the name of the responsible party from Mary Cooper, Office of the State Architect, to the owner/operator, Department of Transportation, which should be receiving the enclosed billing costs for oversight of the Underground Storage Tank Program for the above facility. Please use the following address for the owner/operator:

Department of Transportation  
1120 N Street, Third Floor  
Sacramento, CA 95814  
ATTENTION: Carlos Lopez

Telephone: (916) 654-5077

A legal opinion to determine the authority of this office to reimburse such costs has been requested. Until such determination has been made, it is considered the responsibility of the owner/operator to pay the oversight costs.

If you have any questions, please contact me at (916) 322-8994.

Sincerely,

Michael J. Golden, Program Manager  
Underground Storage Tank Program

MJG:skf

Enclosure

cc: Carlos Lopez, Department of Transportation  
Facility File, Chron File



ALAMEDA COUNTY  
HEALTH CARE SERVICES  
AGENCY

DAVID J. KEARS, Agency Director



RAFAT A. SHAHID, ASST. AGENCY DIRECTOR

DEPARTMENT OF ENVIRONMENTAL HEALTH  
State Water Resources Control Board  
Division of Clean Water Programs  
UST Local Oversight Program  
80 Swan Way, Rm 200  
Oakland, CA 94621  
(510) 271-4530

August 7, 1992

Ms. Mary Cooper  
Office of the State Architect  
400 - P Street 5th Floor  
Sacramento, CA 95814

RE: HAYWARD MAINTENANCE CENTER, 21195 CENTER STREET, CASTRO  
VALLEY

Dear Ms. Cooper:

The Department has completed review of the May 30, 1992 Tetra Tech, Inc. proposed Remedial Action Plan (RAP) submitted to address the soil contamination at the referenced Cal Trans site. Our review of the RAP was performed in conjunction with the results of the earlier Tetra Tech and Geo/Resource Consultants, Inc. (GRC) investigations, the results of which are memorialized in their April 4, 1991 and May 30, 1990 reports, respectively.

The proposed RAP has been approved with the following conditions:

- 1) GRC boring SB-1 identified up to 2400 ppm of total petroleum hydrocarbons at a depth of 31 feet below grade. Qualitative field screening of Tetra Tech boring B-4 identified up to 120 ppm at a 30 foot depth; laboratory results at the 45 and 50 foot depths (bedrock) revealed detectable levels of aromatic compounds.

Hence, the excavation's extent should not be limited to a 20 foot depth, as proposed, unless field screening and subsequent confirmatory samples confirm that its limit has adequately removed the contamination.

- 2) Wells should be checked monthly for the presence of ground water.

Ms. Mary Cooper  
RE: 21195 Center Street, Castro Valley  
August 7, 1992  
Page 2 of 2

Please notify me when field activities are slated to begin. I may be reached at 510/271-4530.

Sincerely,

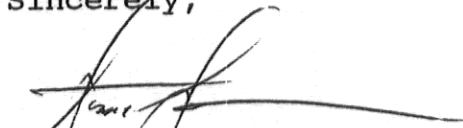
A handwritten signature in black ink, appearing to read "Scott O. Seery", with a long horizontal flourish extending to the right.

Scott O. Seery, CHMM  
Senior Hazardous Materials Specialist

cc: Rafat A. Shahid, Assistant Agency Director, Env. Health  
Gil Jensen, Alameda County District Attorney's Office  
Bob Bohman, Castro Valley Fire Department  
Dan Batrack, Tetra Tech, Inc.  
files

ALAMEDA COUNTY  
HEALTH CARE SERVICES

AGENCY

DAVID J. KEARS, Agency Director



September 20, 1991

DEPARTMENT OF ENVIRONMENTAL HEALTH  
Hazardous Materials Program  
80 Swan Way, Rm. 200  
Oakland, CA 94621  
(415)

Ms. Mary Cooper  
Office of the State Architect  
400 - P Street, 5th Floor  
Sacramento, CA 95814

RE: HAYWARD MAINTENANCE CENTER, 21195 CENTER STREET, CASTRO VALLEY,  
ALAMEDA COUNTY

Dear Ms. Cooper:

This Department has completed review of the April 4, 1991 Tetra Tech, Inc. site investigation report, as submitted under Tetra Tech cover dated May 31, 1991. The cited report documents Tetra Tech's efforts to delineate the vertical and lateral extent of hydrocarbon contamination at the referenced Cal Trans facility.

This Department concurs with the conclusion reached by your consultant that the extent of soil contamination has been adequately assessed to determine an appropriate means to remediate the site. The Department further concurs that excavation and treatment appears to be the most expedient alternative explored for effectively removing this contamination. We do not concur, however, in limiting the extent of the excavation to the 20 foot depth proposed in the report.

Previous work by Geo/Resource Consultants, Inc. (GRC) identified levels of fuel hydrocarbon contamination as high as 2,400 ppm of total petroleum hydrocarbons as diesel (TPH-D) at a depth of 31 feet below grade in GRC boring SB-1, which effectively represents the soil/weathered bedrock interface. A sample collected from this same boring at a depth of 21.5 feet below grade exhibited 790 ppm TPH-gasoline. Should excavation not be extended to these depths, some other means of remediating this contamination must be proposed. The appropriate remediation of this soil is essential to the protection of any meteoric waters migrating beneath and through the site, as the site is a zone of potential recharge. Ground water monitoring is, hence, not an alternative to proper remediation, particularly where little or no ground water is presently known to exist, but rather a means to provide additional assurance that ground water has not been impacted.

As indicated in the April 4 Tetra Tech report, please submit a Remedial Action Work Plan that will address the requirements outlined in this letter, describe the excavation techniques, sampling and treatment methodologies, and a proposal for long term monitoring.

Ms. Mary Cooper

RE: Hayward Maintenance Station, 21195 Center Street, Castro Valley

September 20, 1991

Page 2 of 2

Additionally, please be certain that future laboratory analyses follow strict practical quantitation reporting limits and target appropriate compounds as outlined in the San Francisco Bay Regional Water Quality Control Board's (RWQCB) Tri-Regional Board Staff Recommendations for Preliminary Evaluation and Investigation of Underground Tank Sites. Reporting limits for TPH-G/D analyses as presented in the cited Tetra Tech report were all higher than what is appropriate. Further, ground water sampled from MW-1 was not analyzed for TPH-G/D as required, but was analyzed for halogenated compounds, an analyses not requested by this Department.

Please submit the Remedial Action Work Plan within 45 days of the date of this letter.

Please call me at 415/271-4320 should you have any questions.

Sincerely,

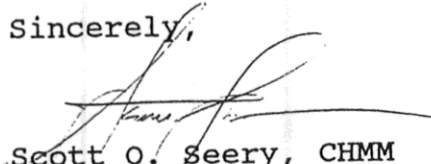
  
Scott O. Seery, CHMM  
Hazardous Materials Specialist

cc: Rafat A. Shahid, Assistant Agency Director, Environmental Health  
Edgar Howell, Chief, Hazardous Materials Division  
Gil Jensen, Alameda County District Attorney's Office  
Howard Hatayama, DHS  
Lester Feldman, RWQCB  
Bob Bohman, Castro Valley Fire Department  
Dan Batrack, Tetra Tech, Inc.  
files

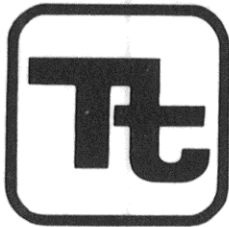

**TETRA TECH, INC.**

670 North Rosemead Boulevard  
Pasadena, CA 91107  
Telephone (818) 449-6400  
FAX (818) 351-8126

May 31, 1991

**Mr. Scott Seery**  
Alameda County - Health Care Services Agency  
Department of Environmental Health  
Hazardous Materials Program  
80 Swan Way, Room 200  
Oakland, CA 94621

Subject: Site Investigation Report for  
Caltrans Hayward Maintenance Station  
21195 Center Street  
Castro Valley, California

Dear Mr. Seery:

On behalf of the California Office of the State Architect, Tetra Tech has completed a Site Investigation of the subsurface petroleum contamination at the Caltrans Hayward Maintenance Station in Castro Valley. As directed by the Alameda County - Department of Health Services, both the vertical and lateral extent of the contamination have been delineated. As outlined in the enclosed Site Investigation Report, the Office of the State Architect, Caltrans, and Tetra Tech have screened the available remedial alternatives and have concluded that excavation of the contaminant plume will be the most expedient and effective alternative. After your review and comment on the enclosed Site Investigation Report, an overview of the proposed site remediation will be prepared in a formal Remedial Action Work Plan that will address the precise excavation technique, on-site treatment methodology, protocol, and proposal for long term monitoring.

Both the Office of the State Architect, Caltrans, and Tetra Tech are anxious to begin the remediation of the soil contamination at the Hayward Maintenance Station promptly after receiving the written approval from the Alameda County - Department of Health Services.

Page 2  
Mr. Scott Seery  
Alameda County - DHS

Please forward your direction to proceed with the proposed remediation to:

Ms. Mary Cooper  
Office of the State Architect  
400 - P Street, 5th Floor  
Sacramento, CA 95814  
(916) 323-5819

If you have any questions or require additional information regarding the Site Investigation Report please feel free to contact me at (818) 449-6400.

Sincerely,



Dan Batrack  
Program Manager  
Tetra Tech, Inc.

ENCLOSURES

cc: Mary Cooper, Office of the State Architect  
P. Jex, Tetra Tech, Inc.

ALAMEDA COUNTY  
HEALTH CARE SERVICES

AGENCY

DAVID J. KEARS, Agency Director



DEPARTMENT OF ENVIRONMENTAL HEALTH  
Hazardous Materials Program  
80 Swan Way, Rm. 200  
Oakland, CA 94621  
(415)

February 6, 1991

Mr. Larry McPeak  
Cal Trans UST Division  
P.O. Box 3611  
Walnut Creek, CA 94958

RE: HAYWARD MAINTENANCE CENTER, 21195 CENTER STREET, CASTRO VALLEY,  
ALAMEDA COUNTY

Dear Mr. McPeak;

This Department is in receipt and has completed review of the Tetra Tech, Inc. January 1991 work plan proposal, as amended February 4, 1991, depicting planned actions consistent with the continued subsurface investigation at the referenced site. This proposal, as amended, has been accepted by this Department. We understand that field activities have been scheduled to begin tomorrow, February 7.

This Department will expect to receive a report within 45 days of the completion of field activities. This report is to present, among other elements, a summary of field activities, the results of all laboratory analyses (including copies of original lab reports and chain-of-custody forms), geologic cross sections, and ground water/well data if such water is encountered, etc. Recommendations for additional work and/or remediation are to be included.

Please feel free to call me at 415/271-4320 if you should have any questions.

Sincerely,

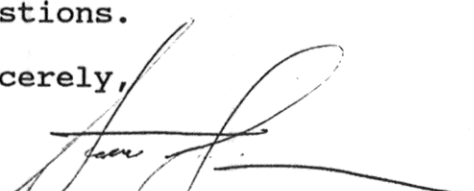
  
Scott O. Seery  
Hazardous Materials Specialist

cc: Rafat A. Shahid, Assistant Agency Director, Environmental Health  
Edgar Howell, Chief, Hazardous Materials Division  
Gil Jensen, Alameda County District Attorney's Office  
Lester Feldman, RWQCB  
Howard Hatayama, DHS  
Bob Bohman, Castro Valley Fire Department  
Dan Batrack, Tetra Tech, Inc.  
Mike Golden, OSA  
files

ALAMEDA COUNTY  
HEALTH CARE SERVICES

AGENCY

DAVID J. KEARS, Agency Director



Certified Mailer #P 062 128 096

September 21, 1990

Mr. Michael Golden  
Office of the State Architect  
Department of General Services  
400 P Street, 5th Floor  
Sacramento, CA 95814

DEPARTMENT OF ENVIRONMENTAL HEALTH  
Hazardous Materials Program  
80 Swan Way, Rm. 200  
Oakland, CA 94621  
(415)

RE: RESULTS OF PRELIMINARY SITE ASSESSMENT; DEPARTMENT OF  
TRANSPORTATION, HAYWARD MAINTENANCE STATION, 21195  
CENTER STREET, CASTRO VALLEY, ALAMEDA COUNTY

Dear Mr. Golden:

This Department is in receipt and has completed review of the March 14, 1990 Geo/Resource Consultants, Inc. (GRC) Preliminary Site Assessment (PSA) report, as submitted under OSA cover dated March 26, 1990. This report documents the results of a subsurface investigation conducted during January 1990 at the noted Cal Trans facility.

The report identifies the presence of soils contaminated by significant concentrations of total petroleum hydrocarbons, characterized as both diesel and gasoline (TPH-D/G), and the volatile constituents benzene, toluene, xylene, and ethylbenzene (BTXE) in native soils sampled in borings at depths ranging from 4.0 to 31.0 feet below grade (BG). In SB-1, for example, 790 ppm of TPH-G and 950 ppm of TPH-D were detected at a depth of 21.5 feet BG, and 2,400 ppm of TPH-D was found at 31.0 feet BG. Other significant levels of TPH-G or TPH-D found in samples from this and other borings ranged between 260 and 860 ppm.

Ground water was not encountered in any of the borings and, hence, monitoring wells were not constructed. However, boring logs indicate that soils were moist from a depth of approximately 5 feet BG to the bottom of all borings except for SB-6, where moist soils were not encountered until approximately 15 feet BG. The boring logs also identify aquifer materials (e.g., sands and gravels) in all borings from a depth of approximately 12 feet BG to bedrock, reached at 30-32 feet BG.

As is expressed by GRC in the March 14 report, the State's current drought condition has likely contributed to a substantial decline in the rate of ground water recharge in the Castro Valley subbasin. This reduction in ground water recharge, as compared to that consistent with years of normal precipitation, may explain the absence of ground water in borings advanced at this site, even though soils were comprised of aquifer-type materials. It is clear, however, that such high levels of subsurface contamination will be a continued potential source of contamination for ground water downgradient of the site.



Mr. Michael Golden  
RE: 21195 Center Street, Hayward Maintenance Station  
September 21, 1990  
Page 2 of 3

The results of this PSA clearly identify the need to assess further the extent of fuel hydrocarbon contamination in soils to the north and east of both the fuel island and the former tank pit; the present investigation is limited in its scope. Consequently, you are requested to perform additional investigative work at this site to completely define the extent of the problem. Further, once the vertical and lateral extent of contamination is known, a plan to remediate the site must be formulated.

In order to continue with the site investigation, you should obtain the services of a reputable environmental/geotechnical consultant. Your responsibility is to have the consultant submit for review a proposal outlining plans to comply with criteria broadly outlined in the San Francisco Bay Regional Water Quality Control Board (RWQCB) Staff Recommendations for the Initial Evaluation and Investigation of Underground Tanks, and State Water Resources Control Board Leaking Underground Fuel Tank (LUFT) Manual.

This proposal is due for submittal within 45 days of the date of this letter, **or by November 4, 1990**. Once this plan has been approved by this Department, work should commence no later than 30 days following the date of its approval.

A report is to be submitted within 30 days following the completion of this phase of work at this site. This report should describe in detail the results of all work performed; records of field observations and field logs; cross sections; tabulated and original laboratory reports; chain-of-custody forms; and, interpretations and recommendations for additional work, among others. Further, this report should outline viable options for the remediation of the affected soils and any ground water encountered.

All reports and proposals are to be submitted under seal of a California-Registered Geologist, -Certified Engineering Geologist, or -Registered Civil Engineer. Please include a statement of qualifications for each lead professional involved in this project.

Please be advised that this is a formal request for technical reports pursuant to California Water Code Section 13267(b). Failure to respond or a late response may result in the referral of this case to the RWQCB for enforcement, possibly subjecting the responsible party to civil penalties to a maximum of \$1,000 per day. Any extensions to stated deadlines, or modifications of the required tasks, must be confirmed in writing by either this agency or the RWQCB.

Mr. Michael Golden  
 RE: 21195 Center Street, Hayward Maintenance Station  
 September 21, 1990  
 Page 3 of 3

Should you have any questions regarding the content of this letter, please call me at 415/271-4320.

Sincerely,

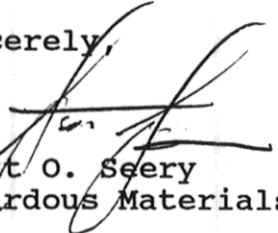
  
 Scott O. Seery  
 Hazardous Materials Specialist

cc: Rafat A. Shahid, Assistant Agency Director, Environmental Health  
 Edgar Howell, Chief, Hazardous Materials Division  
 Gil Jensen, Alameda County District Attorney's Office  
 Lester Feldman, RWQCB  
 Howard Hatayama, DHS  
 Bob Bohman, Castro Valley Fire Department  
 Eva Vanek, Geo/Resource Consultants, Inc.  
 files

55

**SENDER:** Complete items 1 and 2 when additional services are desired, and complete items 3 and 4.  
 Put your address in the "RETURN TO" Space on the reverse side. Failure to do this will prevent this card from being returned to you. The return receipt fee will provide you the name of the person delivered to and the date of delivery. For additional fees the following services are available. Consult postmaster for fees and check box(es) for additional service(s) requested.

1.  Show to whom delivered, date, and addressee's address. (Extra charge)  
 2.  Restricted Delivery (Extra charge)

3. Article Addressed to:  
 Mr. Michael Golden  
 Office of the State Architect  
 Dept. of General Svcs  
 400 P Street, 5th Floor  
 Sacramento, Ca 95814

4. Article Number  
 P062128096

Type of Service:  
 Registered  Insured  
 Certified  COD  
 Express Mail  Return Receipt for Merchandise

Always obtain signature of addressee or agent and DATE DELIVERED.

5. Signature - Address  
 X

6. Signature - Agent  
 X 

7. Date of Delivery  
 SEP 24 1990

8. Addressee's Address (ONLY if requested and fee paid)

PS Form 3811, Mar. 1988 \* U.S.G.P.O. 1988-212-865 DOMESTIC RETURN RECEIPT

P 062 128 096

**RECEIPT FOR CERTIFIED MAIL**  
 NO INSURANCE COVERAGE PROVIDED  
 NOT FOR INTERNATIONAL MAIL  
 (See Reverse)

Sent to Dept of Gen Svcs	
Street and No. 400 P St. 5th Floor	
P.O. State and ZIP Code Sacramento 95814	
Postage	\$
Certified Fee	
Special Delivery Fee	
Restricted Delivery Fee	
Return Receipt showing to whom and Date Delivered	
Return Receipt showing to whom, Date, and Address of Delivery	
TOTAL Postage and Fees	\$
Postmark or Date 9/21/90	

PS Form 3800, June 1985



400 P Street, 5th Floor, Sacramento 95814

(916) 327-0668

90 MAY 24 PM 2:02

May 16, 1990

S & E No. 4997  
Work Order No. BDH 720

County of Alameda  
Department of Environmental Health  
80 Swan Way, Room 200  
Oakland, CA 94621  
Attn: Scott Seery

Dear Sirs:

UNDERGROUND STORAGE TANK SITE EVALUATION  
DEPARTMENT OF TRANSPORTATION  
HAYWARD MAINTENANCE STATION

Enclosed is a fully executed Service and Expense Order (S & E) for the work shown above.

All written communications to the Office of the State Architect regarding this contract must show the S & E and Work Order Numbers.

Sincerely,

*Julian Smith*  
Julian Smith, Manager  
Contract Services

JS:cw

- cc: Mike Golden, Project Manager
- Controller
- OSA Payments
- Central Files
- Contract File
- Coordination
- UGST Chron

SERVICE AND EXPENSE ORDER

Department of General Services  
Office of the State Architect  
400 P Street, Fifth Floor, Lincoln Plaza  
Sacramento, CA 95814

\*\*\*\*\*

TO: County of Alameda  
Department of Environmental Health  
80 Swan Way, Room 200  
Oakland, CA 94621

S & E NUMBER: 4997

WORK ORDER NUMBER: BDH 720

CONTRACT NUMBER:

Attention: Scott Seery

DATE: May 9, 1990

\*\*\*\*\*

You are authorized to perform the following work in accordance with plans and specifications (if any) when notified to proceed by our FIELD REPRESENTATIVE. Upon completion of work, submit an ORIGINAL invoice to OFFICE OF THE STATE ARCHITECT, Attention: Mike Golden, S and E No. and Work Order No. must be shown on invoice.

\*\*\*\*\*

PROJECT: UNDERGROUND STORAGE TANK SITE EVALUATION  
CLIENT: DEPARTMENT OF TRANSPORTATION  
LOCATION: HAYWARD MAINTENANCE STATION

\*\*\*\*\*

DESCRIPTION: The contractor shall be reimbursed for oversight work conducted during the site investigation and remediation for the above referenced project.

The total cost of the contract shall not exceed \$950.00.

The work shall be done by September 1, 1990.

Lump sum payment upon completion and acceptance by the State.

Amount \$ 950.00

\*\*\*\*\*

FIELD REPRESENTATIVE: Allotment Code: GN7 8.6.02.2.60.03

Amount of this Estimate: \$ 950.00

I hereby certify upon my own personal knowledge that budgeted funds are available for the period and purpose of the expenditure stated above.

- .....
- cc: Original to Contractor
- Controller
- Payments
- Central Files
- Field Representative
- Contract Management
- Coordination
- Underground Tanks Program
- Tien

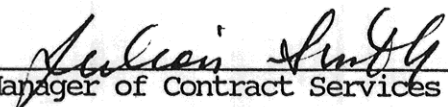
  
\_\_\_\_\_  
Manager of Contract Services

ALAMEDA COUNTY  
HEALTH CARE SERVICES

AGENCY  
DAVID J. KEARS, Director



Telephone Number: (415)

January 16, 1990

Mr. Mike Golden  
Office of the State Architect  
400 P. Street, 5th Floor  
Sacramento, CA 95801

RE: PRELIMINARY SITE ASSESSMENT PROPOSAL: DEPARTMENT OF  
TRANSPORTATION, HAYWARD MAINTENANCE STATION, 2115  
CENTER STREET, CASTRO VALLEY

Dear Mr. Golden:

We are in receipt and have completed review of the January 5 and  
12, 1990 addenda to the December 15, 1989 proposal for the  
investigation of subsurface contamination at the noted site. This  
proposal, as amended, has been accepted by the this department.

Additionally, as we discussed on the phone January 9, please remit  
a deposit totalling \$498 to help cover costs incurred during  
oversight of this project. Checks should be made payable to  
Alameda County.

Please contact this office when work is scheduled to begin at this  
site. Should you have any questions, please contact me at  
415/271-4320.

Sincerely,

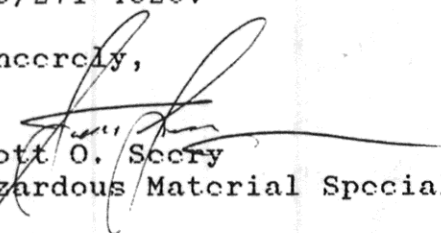
  
Scott O. Seery  
Hazardous Material Specialist

SOS:tlh

cc: Rafat A. Shahid, Assistant Agency Director, Alameda County  
Department of Environmental Health  
Gil Jensen, Alameda County District Attorney, Consumer  
and Environmental Protection Division  
Lester Feldman, RWQCB  
Howard Hatayama, DHS  
Bob Bohman, Castro Valley Fire Dept.  
Eva Vanek, Geo/Resource Consultants  
Files

ALAMEDA COUNTY  
HEALTH CARE SERVICES

AGENCY

DAVID J. KEARS, Agency Director



DEPARTMENT OF ENVIRONMENTAL HEALTH  
Hazardous Materials Program  
30 Swan Way, Rm. 200  
Oakland, CA 94621  
(415)

December 28, 1989

Ms. Eva Vanek  
Geo/Resource Consultants, Inc.  
851 Harrison Street  
San Francisco, CA 94107

RE: PRELIMINARY SITE ASSESSMENT PROPOSAL: DEPARTMENT OF  
TRANSPORTATION, HAYWARD MAINTENANCE STATION,  
2115 CENTER STREET, CASTRO VALLEY

Dear Ms. Vanek:

This letter is in response to our review of the November 3, 1989 Geo/Resource Consultants, Inc. work plan proposal for the investigation of subsurface contamination at the referenced site, as submitted under cover dated November 15, 1989. The noted workplan may be approved for this stage of site contaminant assessment provided the following issues are resolved to the satisfaction of this office:

- 1) As previously discussed during a telephone conversation on December 20, we recommend that the location of proposed monitoring well MW-3 be altered such that it is installed through the back filled tank pit, formerly the location of Tank 2. If necessary, the location of boring SB-2 may then be relocated to the former MW-3 location between the west end of the tank pit and adjacent building to the east. Please include an amended Figure 2 which illustrates any changes in boring or well locations;
- 2) Submit a schematic well construction diagram;
- 3) Provide assurance that wells will be constructed under appropriate Zone 7 permits;
- 4) Sampling of wells should occur a minimum of 24-hours after well development. It is strongly recommended that a period of 72-hours pass between development and sampling, however, so that any low-density, immiscible organics present can stabilize, facilitating the identification of any floating product;

Ms. Eva Vanek  
RE: 2115 Center St  
Castro Valley  
December 28, 1989  
Page 2 of 2

- 5) The first sentence under Section 4.1, Soil Analysis, should be modified to reflect that samples will be collected during advancement of all six borings, rather than the "four" borings indicated.

Please submit, in a timely fashion, a response to the previous list of items. This submittal may be in the form of an addendum to the November 3 proposal. Additionally, please submit copies of all reports, proposals, and addenda to the RWQCB (Attn: Lester Feldman), including the November 3 proposal.

Should you have any questions, please call the undersigned at (415) 271-4320.

Sincerely,

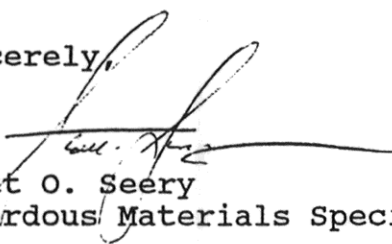

Scott O. Seery  
Hazardous Materials Specialist

SOS: tln

cc: Rafat A. Shahid, Assistant Agency Director, Alameda County  
Department of Environmental Health  
Mike Golden, Office of the State Architect  
Lester Feldman, RWQCB  
Howard Hatayama, DHS  
Bob Bohman, Castro Valley Fire Dept.  
Gil Jensen, Alameda County District Attorney, Consumer and  
Environmental Protection Division  
Files

ALAMEDA COUNTY  
HEALTH CARE SERVICES

AGENCY

DAVID J. KEARS, Agency Director



DEPARTMENT OF ENVIRONMENTAL HEALTH  
Hazardous Materials Program  
80 Swan Way, Rm. 200  
Oakland, CA 94621  
(415) 271-4320

FACSIMILE TRANSMITTAL

TO:

777-5623  
Fax Phone Number

Floor/Room # \_\_\_\_\_

Name: Peter Bailey  
Title/Section

Agency: GeoResource Consultants

Address: S.F.

Phone #: ( ) \_\_\_\_\_

FROM:

\_\_\_\_\_  
Fax Phone Number

Floor/Room # \_\_\_\_\_

Date: 8-10-89

Time Sent: 3:25

Sender: Scott Seery, Hazmat Div  
Title/Section

Phone #: ( ) \_\_\_\_\_

Number of Pages Including Transmittal Sheet: 5

Special Instructions/Comments:

Per our discussion, enclosed is the RWQCB  
App. A, "Workplan for Initial Subsurface  
Investigation" which, through MOD with the  
RWQCB, we implement at a minimum.  
S.



\*\* TX CONFIRMATION REPORT \*\*

AS OF AUG 10 '89 15:19 PAGE.01

ALCO HAZMAT

	DATE	TIME	TO/FROM	MODE	MIN/SEC	PGS	STATUS
01	8/10	15:17	7775623	G3--S	02"22	05	OK

# Memorandum

To: Ken McClellan, Chief  
Special Programs Section  
Office of State Architect  
400 P Street - Lincoln Plaza  
Sacramento, CA 95814

Date: March 10, 1989

File No.: W.O. BDH 720

Attention Hurley George  
Mike Golden  
From: **DEPARTMENT OF TRANSPORTATION**  
**DIVISION OF HIGHWAY MAINTENANCE**

Subject: Site Investigation- Hayward Maintenance Station  
21195 Center Street, Castro Valley, CA 94546

As indicated in the attached memo dated February 28, 1989, the County of Alameda has notified us of the need to conduct a site assessment at our Hayward Maintenance Station. This is the result of soil contamination indicated following removal of two underground fuel tanks by your office.

Please complete any site investigation work required for this location. As soon as this site can be rendered free of contamination, we will proceed with the installation of a new fuel facility. Ken Fitzpatrick is the OSA design contact for this project.

Please send us copies of all site investigation correspondence for our files.

If you have specific questions regarding the site location, you may contact Ging Chin of our San Francisco office at ATSS 597-3744; or you may contact Phil Jones at ATSS 485-4030 regarding this memo.

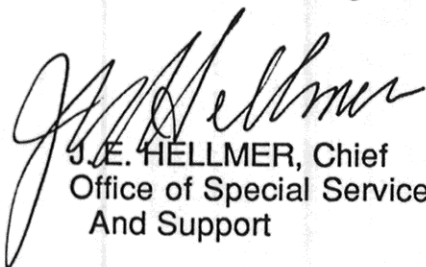
  
J.E. HELLMER, Chief  
Office of Special Services  
And Support

Attachment

PJ:lfo

cc: Rafat A. Shahid- Chief, Hazardous Materials Division-County of Alameda  
GChin-4 Maint.  
LWells-Hq. Maint.  
KFitzpatrick-OSA

ALAMEDA COUNTY  
HEALTH CARE SERVICESAGENCY  
DAVID J. KEARS, DirectorDepartment of Environmental Health  
Hazardous Materials Division  
80 Swan Way, Room 200  
Oakland, CA 94621

Telephone Number: (415) 271-4320

February 28, 1989

Mr. Jack Giolitti  
Department of Transportation  
1112 - 29th Avenue  
Oakland, CA 94601

RECEIVED

MAR 6 1989

Dept. of Transportation  
Special Assignment CrewsSUBJECT: RESULTS OF SOIL SAMPLE ANALYSES FOLLOWING TANK CLOSURES  
AT 21195 CENTER STREET, CASTRO VALLEY, CA 94546

Dear Mr. Giolitti:

Our office is in receipt of the report of analytical results submitted by Alpha Analytical Laboratories, Inc. following soil sampling performed at the referenced facility during the removal of two (2) underground storage tanks (UST) on January 18, 1989. These laboratory results indicate that soil is contaminated at this site, denoted by concentrations of total petroleum hydrocarbon as diesel (TPH-D) up to 2100 parts per million (ppm).

According to the California Regional Water Quality Control Board, San Francisco Bay Region (RWQCB) "Guidelines for Addressing Fuel Leaks," any soil containing greater than 100 ppm is considered a "confirmed release." Any soil containing greater than 1000 ppm must be excavated. Such soil may be aerated on-site to remove the contamination and then put back into the tank pit. The Bay Area Air Quality Management District (BAAQMD) must be contacted at (415) 771-6000 for specific permit requirements of such soil aeration. The soil may alternatively be removed and disposed of properly at an approved Class I disposal site.

Attached for your records is a copy of an "Underground Storage Tank Unauthorized Release Report Form" prepared by this department. Additional copies have been distributed to the required reporting agencies.

Due to the presence of TPH contamination above 100 ppm and consequent "confirmed release" status, a preliminary site assessment must be conducted at this site to determine the extent of soil and/or ground water contamination. The information gathered by this investigation will be used to determine whether additional actions are necessary at this site. The preliminary site assessment should be conducted in accordance with the RWQCB Staff Recommendations for Initial Evaluation and Investigation of Underground Tanks. The elements of such an

Tank Closure  
21195 Center St.  
Castro Valley  
February 28, 1989  
Page 2 of 2

investigation are summarized in the attached Appendix A.

In order to proceed with a preliminary site investigation, you should obtain professional services from a reputable engineering/geotechnical consulting firm. The responsibility of your consultant is to submit for review a proposal outlining planned activities pertinent to meeting criteria outlined in Appendix A, as they apply to the site. Once the preliminary assessment has been completed, a technical report summarizing site related activities and conclusions must be submitted to this office and the RWQCB. All reports and proposals must be submitted under seal of a California-Certified Engineering Geologist, California-Registered Geologist, or California-Registered Civil Engineer.

This office will oversee the preliminary site assessment for the referenced site. This oversight will include the review and comment on work proposals, and technical guidance on appropriate investigative approaches. However, the issuance of monitoring well installation permits will be through Zone 7. The RWQCB will take over as lead agency if it is determined following the preliminary assessment that there has been an impact on groundwater.

Please submit a Preliminary Site Assessment proposal within 30 days of the receipt of this letter. A copy of this proposal should also be sent to the RWQCB (Attn: Lisa McCann) for their review. Also, please submit a completed copy of the manifest used for transport of the USTs off-site following closure.

If you have any questions, please call Scott Seery, Hazardous Materials Specialist, at 415/271-4320.

Sincerely,

  
Rafat A. Shahid, Chief  
Hazardous Materials Division

RAS:SOS:mam

cc: Cody Begley, OSA  
Howard Hatayama, Department of Health Services  
Lisa McCann, RWQCB  
Bob Bohman, Castro Valley Fire Department  
Gil Jensen, Alameda County District Attorney, Consumer and  
Environmental Protection Division  
Scott Seery, Alameda County Hazardous Materials Division  
Files

# UNDERGROUND STORAGE TANK UNAUTHORIZED RELEASE (LEAK) / CONTAMINATION SITE REPORT

EMERGENCY  YES  NO HAS STATE OFFICE OF EMERGENCY SERVICES REPORT BEEN FILED?  YES  NO

FOR LOCAL AGENCY USE ONLY  
I HEREBY CERTIFY THAT I AM A DESIGNATED GOVERNMENT EMPLOYEE AND THAT I HAVE REPORTED THIS INFORMATION TO LOCAL OFFICIALS PURSUANT TO SECTION 25100.7 OF THE HEALTH AND SAFETY CODE

REPORT DATE: 02/28/89 CASE #

REPORTED BY: NAME OF INDIVIDUAL FILING REPORT: **Scott Seery** PHONE: **(415) 271-4320** SIGNATURE: \_\_\_\_\_  
 REPRESENTING:  LOCAL AGENCY  OWNER/OPERATOR  REGIONAL BOARD  OTHER COMPANY OR AGENCY NAME: **Ala Co. Environmental Health Dept.**  
 ADDRESS: **80 Swan Way, Rm 200 Oakland CA 94621**

RESPONSIBLE PARTY: NAME: **Caltrans Maintenance**  UNKNOWN CONTACT PERSON: **Jack Giolitti** PHONE: ( )  
 ADDRESS: **21195 Center Street Castro Valley CA 94546**

SITE LOCATION: FACILITY NAME (IF APPLICABLE): \_\_\_\_\_ OPERATOR: \_\_\_\_\_ PHONE: ( )  
 ADDRESS: \_\_\_\_\_  
 CROSS STREET: **unknown** TYPE OF AREA:  COMMERCIAL  INDUSTRIAL  RURAL  RESIDENTIAL  OTHER TYPE OF BUSINESS:  FARM  OTHER **Maint. Yd.**

IMPLEMENTING AGENCIES: LOCAL AGENCY: **Ala Co. Dept of Env. Health, Haz Mat's Div** AGENCY NAME: \_\_\_\_\_ CONTACT PERSON: **Rafat A. Shakhid** PHONE: **(915) 271-4320**  
 REGIONAL BOARD: **SF - Regional Water Quality Control Bd** CONTACT PERSON: **Lisa McCann** PHONE: **(415) 464-1255**

SUBSTANCES INVOLVED: (1) **diesel fuel** NAME: \_\_\_\_\_ QUANTITY LOST (GALLONS):  UNKNOWN  
 (2) **gasoline** NAME: \_\_\_\_\_ QUANTITY LOST (GALLONS):  UNKNOWN

DISCOVERY/CONTAINMENT: DATE DISCOVERED: **02/11/89** HOW DISCOVERED:  TANK TEST  TANK REMOVAL  INVENTORY CONTROL  SUBSURFACE MONITORING  NUISANCE CONDITIONS  
 DATE DISCHARGE BEGAN: \_\_\_\_\_ METHOD USED TO STOP DISCHARGE (CHECK ALL THAT APPLY):  REMOVE CONTENTS  REPLACE TANK  CLOSE TANK  
 REPAIR TANK  REPAIR PIPING  CHANGE PROCEDURE  
 OTHER HAS DISCHARGE BEEN STOPPED?  YES  NO IF YES, DATE: \_\_\_\_\_

SOURCE OF DISCHARGE:  TANK LEAK  UNKNOWN  PIPING LEAK  OTHER TANKS ONLY/CAPACITY: **2500 / 2600 GAL** MATERIAL:  FIBERGLASS  STEEL  OTHER CAUSE(S):  OVERFILL  RUPTURE/FAILURE  CORROSION  UNKNOWN  SPILL  OTHER

CASE TYPE: CHECK ONE ONLY  UNDETERMINED  SOIL ONLY  GROUNDWATER  DRINKING WATER (CHECK ONLY IF WATER WELLS HAVE ACTUALLY BEEN AFFECTED)

CURRENT STATUS: CHECK ONE ONLY  SITE INVESTIGATION IN PROGRESS (DEFINING EXTENT OF PROBLEM)  CLEANUP IN PROGRESS  SIGNED OFF (CLEANUP COMPLETED OR UNNECESSARY)  
 NO ACTION TAKEN  POST CLEANUP MONITORING IN PROGRESS  NO FUNDS AVAILABLE TO PROCEED  EVALUATING CLEANUP ALTERNATIVES

REMEDIAL ACTION: CHECK APPROPRIATE ACTION(S) (SEE BACK FOR DETAILS)  
 CAP SITE (CC)  EXCAVATE & DISPOSE (ED)  REMOVE FREE PRODUCT (FP)  ENHANCED BIO DEGRADATION (IT)  
 CONTAINMENT BARRIER (CB)  EXCAVATE & TREAT (ET)  PUMP & TREAT GROUNDWATER (GT)  REPLACE SUPPLY (RS)  
 TREATMENT AT HOOKUP (HL)  NO ACTION REQUIRED (NA)  OTHER (OT)

COMMENTS: **Laboratory results indicate TPH-D as high as 2100 ppm in soil. Requesting a submittal of a Preliminary Site Assessment from Caltrans to evaluate extent of contamination. No remediation yet decided upon.**

## Appendix A

### Workplan for Initial Subsurface Investigation

There are a large number of initial site investigations related to unauthorized releases of fuel products. The number of workplans and reports to be reviewed and approved require that these documents have uniform organization and content. The purpose of this appendix is to present an outline to be followed by professional engineering or geologic consultants in preparing workplans to be submitted for approval to the Regional Board and local agencies.

A statement of qualifications and registration number for the California registered engineer and/or registered geologist responsible for the project will need to be included with the submitted workplan and reports.

This appendix should be referred to in context with the "Regional Board Staff Recommendations for Initial Evaluation and Investigation of Underground Tanks".

### PROPOSAL FORMAT

#### I. Introduction

- A. Statement of Scope of Work
- B. Site location
- C. Background
- D. Site History

1. Brief description of the type of business and associated activities that take place at the site, including the number and capacity of operating tanks.
2. Description of previous businesses at the site.
3. Complete description of tank activities, tank contents, and tank removal.
  - a. Number of underground tanks, uses, etc. (include the volume of each tank, construction material, and tank condition)
  - b. Date of tank removal and condition of tank.
  - c. Description of all waste removal, including copies of all manifests.
  - d. Filing status and copy of unauthorized release form, if not previously submitted.
  - e. Previous tank testing results and date. Include discussion of inventory reconciliation methods and results for previous three years.

- f. Estimate of the total quantity of product lost.
4. Other spill, leak and accident history at the site, including any previously removed tanks.
5. Describe any previous subsurface work at the site or adjacent sites.

## II. Site Description

- A. Vicinity description and hydrogeologic setting.
- B. Vicinity map (including wells located on-site or on adjoining lots, as well as any nearby streams).
- C. Site map to include:
  1. Adjacent streets.
  2. Site building locations.
  3. Tank locations.
  4. Island locations and piping to pumps from tanks.
  5. Any known subsurface conduits, underground utilities, etc.
- D. Existing soil contamination and excavation results.
  1. Provide sampling procedures used.
  2. Indicate depth to groundwater, if encountered.
  3. Describe soil strata encountered in excavation.
  4. Provide results in tabular form and location of all soil sampling ( and water sampling, if appropriate). The date sampled, the identity of the sampler, and signed laboratory data sheets need to be included.
  5. Identify underground utilities
  6. Describe any unusual problems encountered.
  7. Completely describe methods for storing and disposal of all contaminated soil.
  8. Reference all required permits, including those issued by the Air Quality Management District and local underground tank permitting agency.

## III. Plan for determining extent of soil contamination on site.

- A. Describe method/technique for determining extent of contamination within the excavation.

- B. Describe sampling methods and procedures to be used.
1. If a soil gas survey is planned, then:
    - a. Identify number of boreholes, location, sampling depth, etc.
    - b. Identify subcontractors, if any
    - c. Identify methods or techniques used for analysis
    - d. Provide quality assurance plan for field testing
  2. If soil borings are to be used to determine the extent of soil contamination, then:
    - a. Identify number and location (mapped) of proposed borings.
    - b. Describe depth of borings
    - c. Describe soil classification system, soil sampling method and rationale
    - d. Describe boring drilling method, including decontamination procedures.
    - e. Describe boring abandonment method
- C. Describe method and criteria for screening clean versus contaminated soil, including a complete description of procedures to be used for storing and disposal of any excavated soil. If on-site soil aeration is to be utilized, then a complete description of the treatment method is required:
1. Volume and rate of aeration/turning.
  2. Method of containment and cover
  3. Wet weather contingency plans.

Other on-site treatments (such as bioremediation) requires permits issued by the Regional Board. Off-site storage or treatment also requires permits issued by the Regional Board.

- D. Security measures planned for excavated hole and contaminated soil (i.e., six foot fence around hole, ripped up piping, m spoil piles, etc.)

#### IV. Plan for determining groundwater contamination.

Construction and placement of wells should adhere to the requirements of the "Regional Board Staff Recommendations for Initial Evaluation and Investigation of Underground Tanks". If the verified down gradient location has been established, then a complete description of the rationale must be provided.



- A. Placement and rationale for location of monitoring wells, including a map to scale.
- B. Drilling method for construction of monitoring wells, including decontamination procedures.
  - 1. Expected depth and diameter of monitoring wells
  - 2. Date of expected drilling.
  - 3. Method and location of soil sampling of borings. .
  - 4. Casing type, diameter, screen interval, and pack and slot sizing technique.
  - 5. Depth and type of seal.
  - 6. Construction diagram for wells.
  - 7. Development method and criteria for determination of adequacy of development.
  - 8. Plans for disposal of cuttings and development water.
  - 9. Surveying plans for wells (requirements include surveying to established benchmark to 0.01 foot)
- C. Groundwater sampling plans (include plans for sampling and on-site domestic wells)
  - 1. Water level measurement procedure
  - 2. Methods for free product measurement, observation of sheen and odor.
  - 3. Well purging procedures.
  - 4. Well purge water disposal plans.
  - 5. Sample collection procedures.
  - 6. Sample analyses to be used
  - 7. Quality assurance plan
  - 8. Chain of custody procedures
- V. Include a site safety plan

A report will need to be submitted following collection of the information proposed and approved in the workplan. The report should set out the collected information in an orderly fashion and include any recommendations for additional needed work.

# UNDERGROUND STORAGE TANK UNAUTHORIZED RELEASE (LEAK) / CONTAMINATION SITE REPORT

EMERGENCY <input type="checkbox"/> YES <input checked="" type="checkbox"/> NO		HAS STATE OFFICE OF EMERGENCY SERVICES REPORT BEEN FILED? <input type="checkbox"/> YES <input checked="" type="checkbox"/> NO		<b>FOR LOCAL AGENCY USE ONLY</b> I HEREBY CERTIFY THAT I AM A DESIGNATED GOVERNMENT EMPLOYEE AND THAT I HAVE REPORTED THIS INFORMATION TO LOCAL OFFICIALS PURSUANT TO SECTION 25180.7 OF THE HEALTH AND SAFETY CODE. SIGNED: <i>[Signature]</i> DATE: 02-28-89	
REPORT DATE 02 M 28 D 88 Y 9		CASE #			
REPORTED BY	NAME OF INDIVIDUAL FILING REPORT Scott Seeny		PHONE (415) 271-4320		SIGNATURE <i>[Signature]</i>
	REPRESENTING <input checked="" type="checkbox"/> LOCAL AGENCY <input type="checkbox"/> OWNER/OPERATOR <input type="checkbox"/> REGIONAL BOARD <input type="checkbox"/> OTHER		COMPANY OR AGENCY NAME Alameda Co. Env. Health Dept.,		
	ADDRESS 80 Swan Way, Rm. 200 Oakland CA 94621				
RESPONSIBLE PARTY	NAME Cal Trans Maintenance <input type="checkbox"/> UNKNOWN		CONTACT PERSON Jack Giolitti		PHONE ( )
	ADDRESS 21195 Center Street Castro Valley CA 94546				
SITE LOCATION	FACILITY NAME (IF APPLICABLE) Same as above		OPERATOR		PHONE ( )
	ADDRESS STREET CITY STATE ZIP				
	CROSS STREET unknown		TYPE OF AREA <input checked="" type="checkbox"/> COMMERCIAL <input type="checkbox"/> INDUSTRIAL <input type="checkbox"/> RURAL <input type="checkbox"/> RESIDENTIAL <input type="checkbox"/> OTHER	TYPE OF BUSINESS <input type="checkbox"/> RETAIL FUEL STATION <input type="checkbox"/> FARM <input checked="" type="checkbox"/> OTHER maintenance yd.	
IMPLEMENTING AGENCIES	LOCAL AGENCY Al. Co. Dept. of Env. Health, Hazmat Div.		AGENCY NAME CONTACT PERSON Rafat A. Shahid		PHONE (415) 271-4320
	REGIONAL BOARD SF - RWQCI3		CONTACT PERSON Lisa McCann		PHONE (415) 464-1255
SUBSTANCES INVOLVED	(1) diesel fuel		NAME		QUANTITY LOST (GALLONS) <input type="checkbox"/> UNKNOWN
	(2) gasoline				<input checked="" type="checkbox"/> UNKNOWN
DISCOVERY/ABATEMENT	DATE DISCOVERED 01 M 18 D 88 Y 9		HOW DISCOVERED <input type="checkbox"/> INVENTORY CONTROL <input type="checkbox"/> SUBSURFACE MONITORING <input type="checkbox"/> TANK TEST <input checked="" type="checkbox"/> TANK REMOVAL <input type="checkbox"/> OTHER		
	DATE DISCHARGE BEGAN <input checked="" type="checkbox"/> UNKNOWN		METHOD USED TO STOP DISCHARGE (CHECK ALL THAT APPLY) <input type="checkbox"/> REMOVE CONTENTS <input type="checkbox"/> REPLACE TANK <input checked="" type="checkbox"/> CLOSE TANK <input type="checkbox"/> REPAIR TANK <input type="checkbox"/> REPAIR PIPING <input type="checkbox"/> CHANGE PROCEDURE <input type="checkbox"/> OTHER		
	HAS DISCHARGE BEEN STOPPED? <input checked="" type="checkbox"/> YES <input type="checkbox"/> NO IF YES, DATE 01 M 18 D 88 Y 9				
SOURCE/CAUSE	SOURCE OF DISCHARGE <input type="checkbox"/> TANK LEAK <input checked="" type="checkbox"/> UNKNOWN <input type="checkbox"/> PIPING LEAK <input type="checkbox"/> OTHER		TANKS ONLY CAPACITY 2500 / 260 GAL. AGE 20+ YRS <input type="checkbox"/> UNKNOWN		MATERIAL <input type="checkbox"/> FIBERGLASS <input checked="" type="checkbox"/> STEEL <input type="checkbox"/> OTHER
	CAUSE(S) <input type="checkbox"/> OVERFILL <input type="checkbox"/> RUPTURE/FAILURE <input type="checkbox"/> CORROSION <input checked="" type="checkbox"/> UNKNOWN <input type="checkbox"/> SPILL <input type="checkbox"/> OTHER				
CASE TYPE	CHECK ONE ONLY <input checked="" type="checkbox"/> UNDETERMINED <input type="checkbox"/> SOIL ONLY <input type="checkbox"/> GROUNDWATER <input type="checkbox"/> DRINKING WATER - (CHECK ONLY IF WATER WELLS HAVE ACTUALLY BEEN AFFECTED)				
CURRENT STATUS	CHECK ONE ONLY <input type="checkbox"/> SITE INVESTIGATION IN PROGRESS (DEFINING EXTENT OF PROBLEM) <input type="checkbox"/> CLEANUP IN PROGRESS <input type="checkbox"/> SIGNED OFF (CLEANUP COMPLETED OR UNNECESSARY) <input type="checkbox"/> NO ACTION TAKEN <input type="checkbox"/> POST CLEANUP MONITORING IN PROGRESS <input type="checkbox"/> NO FUNDS AVAILABLE TO PROCEED <input checked="" type="checkbox"/> EVALUATING CLEANUP ALTERNATIVES				
REMEDIAL ACTION	CHECK APPROPRIATE ACTION(S) (SEE BACK FOR DETAILS) <input type="checkbox"/> CAP SITE (CD) <input type="checkbox"/> EXCAVATE & DISPOSE (ED) <input type="checkbox"/> REMOVE FREE PRODUCT (FP) <input type="checkbox"/> ENHANCED BIO DEGRADATION (IT) <input type="checkbox"/> CONTAINMENT BARRIER (CB) <input type="checkbox"/> EXCAVATE & TREAT (ET) <input type="checkbox"/> PUMP & TREAT GROUNDWATER (GT) <input type="checkbox"/> REPLACE SUPPLY (RS) <input type="checkbox"/> TREATMENT AT HOOKUP (HU) <input type="checkbox"/> NO ACTION REQUIRED (NA) <input checked="" type="checkbox"/> OTHER (OT) under review				
COMMENTS	Laboratory results indicate TPH-D as high as 2100 ppm in soil. Requesting a submittal of a Preliminary Site Assessment from CalTrans to evaluate extent of contamination. No remediation yet decided upon.				

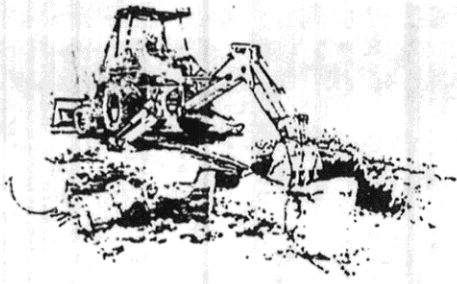

# Placer Tractor Service

7200 Wells Avenue  
Loomis, California 95650  
(916) 652-5535



Contractors License #440591

EPA #CAD 982040206  
A - General Engineering  
B - 1 General Building

DOH Hauler #2350  
C - 2 Insulation  
C - 10 Electrical

PUC #1526



## PLACER TRACTOR SERVICE SITE SAFETY AND HEALTH PLAN

PROJECT: Hayward Maintenance Station

DATE PREPARED: January 6, 1989

PROJECT MANAGER: Al Oesterling

PRINCIPAL-IN-CHARGE: Al Oesterling

CONTRACTOR: Rodger Thomas for Placer Tractor Service

### SECTIONS:

- I. Project Description and Risk Analysis
- II. Task Risk Analyses and Safety & Health Plans
  - 1. Underground tank removal
  - 2. Confined space entry (tank)
- III. Contractor Certification
- IV. Emergency Response Plan

**RECEIVED**  
 JAN 17 1989  
 HAZARDOUS MATERIALS/  
 WASTE PROGRAM

SECTION I: PROJECT DESCRIPTION AND RISH ANALYSIS

A. SITE DESCRIPTION (refer to plot plan from architect)

Date of Project: Approximately January 10, 1989  
Location : 21195 Center St., Castro Valley, CA.  
Project Description: CAL TRANS Underground Fuel Tank Removal

Surrounding Community Castro Valley  
Description:

Topography: Flat

B. ENTRY OBJECTIVES:

The objective of the initial entry to the possibly contaminated area is to excavate and removal of 2 underground fuel tanks. Upon removing the tanks the dirt below will be observed for possible contamination. Soil samples will be taken to determine the condition of the area beneath the tank

C. ONSITE ORGANIZATION AND PERSONNEL:

The following personnel are designated to carry out job functions as needed on site. They all have been certified in respirator training.

Lee Duncan

Albert Oesterling

Ken Bolton

Robert Graham

Dennis Anderson

D. LOCAL AGENCIES:

Alameda County Environmental Health  
470 27th St., Rm. 322  
Oakland, CA. 94612  
415-874-7237

Calif. Regional Water Quality Control  
San Francisco Bay Region  
Oakland, CA.  
(415) 464-1255

## E. RISK ANALYSIS

### 1. Tasks Planned:

- a. Underground Tank Removal - excavation
- b. Possible confined space entries
- c. Soil sampling

### 2. Hazardous Materials Anticipated:

- a. Benzene
- b. Xylenes
- c. Gasoline, diesel and waste oil
- d. TCE

## F. CONTROL MEASURES

### 1. Personnel Protection Equipment

- A. Appropriate skin protection/clothing
- B. Air purifying respirator
- C. Hard hat and safety glasses
- D. Gloves
- E. Hearing protection
- F. Eye wash and First Aid kits in trucks

### 2. Site Control:

- A. 6' cyclone fencing will be installed around excavated area that is found to be contaminated or if large hole is left from excavation.

## G. HAZARDOUS WASTE MANAGEMENT

1. This project will generate hazardous wastes which will be transported for recycling (all hazardous waste will require a manifest).

2. If an accident should occur, employees should first call 911 if it is an emergency. If it is not of emergency nature then the employee shall be brought to the nearest hospital, Fairmont Hospital in Castro Valley. (See map below)



ALAMEDA COUNTY HEALTH CARE SERVICES AGENCY  
 DEPARTMENT OF ENVIRONMENTAL HEALTH  
 HAZARDOUS MATERIALS DIVISION

470 - 27TH ST., RM. 322  
 OAKLAND, CA 94612  
 PHONE NO. 415/874-7237

1/13/89

C.S.

ACCEPTED

DEPARTMENT OF ENVIRONMENTAL HEALTH  
 470 - 27th Street, Third Floor  
 Oakland, CA 94612  
 Telephone: (415) 874-7237

These plans have been reviewed and found to be acceptable and essentially meet the requirements of State and local health laws. Changes to your plans indicated by this Department are to assure compliance with State and local laws. The project proposed herein is now released for issuance of any required building permits for construction.

One copy of these accepted plans must be on the job and available to all contractors and craftsmen involved with the removal.

Any change or alterations of these plans and specifications must be submitted to this Department and to the Fire and Building Inspection Department to determine if such changes meet the requirements of State and local laws. Notify this Department at least 48 hours prior to the following required inspections:

- C.S. 1-18-89 Removal of Tank and Pipings
- C.S. 1-18-89 Sampling

Final Inspection

Issuance of a permit to operate is dependent compliance with accepted plans and all applicable laws and regulations.

THERE IS A FINANCIAL PENALTY FOR NOT OBTAINING THESE INSPECTIONS.

Project # 328775  
 Fee Paid \$450.00  
 Date 12/14/88

UNDERGROUND TANK CLOSURE/MODIFICATION PLANS

1. Business Name Dayward Dept. of Transportation  
 Business Owner California
2. Site Address 21195 Center Street  
 City Castro Valley, CA Zip 94546 Phone \_\_\_\_\_
3. Mailing Address same as above  
 City \_\_\_\_\_ Zip \_\_\_\_\_ Phone \_\_\_\_\_
4. Land Owner same as above  
 Address \_\_\_\_\_ City, State \_\_\_\_\_ Zip \_\_\_\_\_
5. EPA I.D. No. CAC000130653
6. Contractor Placer Tractor Service  
 Address 7500 Wells Ave.  
 City Loomis, CA 95650 Phone 916-652-5535  
 License Type A ID# 440591
7. Other (Specify) \_\_\_\_\_  
 Address \_\_\_\_\_  
 City \_\_\_\_\_ Phone \_\_\_\_\_

8. Contact Person for Investigation

Name Rudger Thomas Title owner  
Phone 916-652-5535

9. Total No. of Tanks at facility 2

10. Have permit applications for all tanks been submitted to this office? Yes [ ] No [ ] unknown

11. State Registered Hazardous Waste Transporters/Facilities

a) Product/Waste Tranporter

Name Placer Tractor Service EPA I.D. No. CAD982040206  
Address 7200 Wells Ave  
City Loomis State CA Zip 95650

b) Rinsate Transporter

Name same as above EPA I.D. No. \_\_\_\_\_  
Address \_\_\_\_\_  
City \_\_\_\_\_ State \_\_\_\_\_ Zip \_\_\_\_\_

c) Tank Transporter

Name same as above EPA I.D. No. \_\_\_\_\_  
Address \_\_\_\_\_  
City \_\_\_\_\_ State \_\_\_\_\_ Zip \_\_\_\_\_

d) Contaminated Soil Transporter

Name same as above EPA I.D. No. a Hauler # 2350  
Address \_\_\_\_\_  
City \_\_\_\_\_ State \_\_\_\_\_ Zip \_\_\_\_\_

12. Sample Collector

Name Lori Thomas  
Company Alpha Lab  
Address 860 Waugh Lane. H-1 "cert. # 124"  
City Ukiah State CA Zip 95482 Phone 707-468-0401



13. Sampling Information for each tank or area

Tank or Area		Material sampled	Location & Depth
Capacity 1-2500	Historic Contents (past 5 years)	unleaded gas	
260		diesel	

14. Have tanks or pipes leaked in the past? Yes [ ] No [ ] *unknown*

If yes, describe. \_\_\_\_\_

15. NFPA methods used for rendering tank inert? Yes [X] No [ ]

If yes, describe. *Pump product - steam clean + pump  
15#/1,000 gal  
tank dry - dry ice - cap holes in all  
openings. pull tanks + load on P.T.S. truck*

16. Laboratories

Name *Alpha Lab.*

Address *860 Waugh Lane H1*

city *Ukiah* State *CA* Zip *95482*

State Certification No. *#124*

17. Chemical Methods to be used for Analyzing Samples

Contaminant Sought	EPA, DHS, or Other Sample Preparation Method Number	EPA, DHS, or Other Analysis Number
gas (unleaded)  diesel	TPH G BTX+E 80200 or 8240  TPHD BTX+E 80200 or 8240	

18. Site Safety Plan submitted? Yes  No [ ]

19. Workman's Compensation: Yes  No [ ]

Copy of Certificate enclosed? Yes  No [ ]

Name of Insurer RCM-Ins.

20. Plot Plan submitted? Yes  No [ ]

21. Deposit enclosed? Yes  No [ ]

22. Please forward to this office the following information within 60 days after receipt of sample results.

- a) Chain of Custody Sheets
- b) Original Signed Laboratory Reports
- c) TSD to Generator copies of wastes shipped and received
- d) Attachment A summarizing laboratory results

I declare that to the best of my knowledge and belief the statements and information provided above are correct and true. I understand that information in addition to that provided above may be needed in order to obtain an approval from the Department of Environmental Health and that no work is to begin on this project until this plan is approved.

I understand that any changes in design, materials or equipment will void this plan if prior approval is not obtained.

I will notify the Department of Environmental Health at least two (2) working days (48 hours) in advance to schedule any required inspections. I understand that site and worker safety are solely the responsibility of the property owner or his agent and that this responsibility is not shared nor assumed by the County of Alameda.

Signature of Contractor

Name (please type) Rodger Thomas

Signature R Thomas

Date 11-28-88

Signature of Site Owner or Operator

Name (please type) George Wong

Signature George Wong / cf

Date 11-29-88

NOTES:

1. Any changes in this document must be approved by this Department.
2. Any leaks discovered must be submitted to this office on an underground storage tank unauthorized leak/contamination site report form within 5 days of its discovery.
3. Three (3) copies of this plan must be submitted to this Department. One copy must be at the construction site at all times.
4. A copy of your approved plan must be sent to the landowner.

5. Triple rinse means that:

- a) final rinse must contain less than 100 ppm of Gasoline (EPA method 8020 for soil, or EPA method 602 for water) or Diesel (EPA method 418.1) Other methods for halogenated volatile organics (EPA method 8010 for soil, EPA method 601 for water) may be required. The composition of the final rinse must demonstrated by an original or facsimile report from a laboratory certified for the above analyses.
- b) tank interior is shown to be free from deposits or residues upon a visual examination of tank interior.
- c) tank should be labelled as "tripled rinsed; laboratory certified analysis available upon request" with the name and address of the contractor.

If all the above requirements cannot be met, the tank must be transported as a hazardous waste.

6. Any cutting into tanks requires local fire department approval.

UNDERGROUND TANK CLOSURE/MODIFICATION PLANS

ATTACHMENT A

SAMPLING RESULTS

Tank or Area	Contaminant	Location & Depth	Results (specify units)

## INSTRUCTIONS

### 2. SITE ADDRESS

Address at which closure or modification is taking place.

### 5. EPA I.D. NO.

This number may be obtained from the State Department of Health Services, 916/324-1781.

### 6. CONTRACTOR

Prime contractor for the project.

### 7. OTHER

List professional consultants here.

### 12. SAMPLE COLLECTOR

Persons who are collecting samples.

### 13. SAMPLING INFORMATION

Historic contents - the principal product(s) used in the last 5 years.

Material sampled - i.e., water, oil, sludge, soil, etc.

### 16. LABORATORIES

Laboratories used for chemical and geotechnical analyses.

### 17. CHEMICAL METHODS:

All sample collection methods and analyses should conform to EPA or DHS methods.

Contaminant - Specify the chemical to be analyzed.

Sample Preparation Method Number - The means used to prepare the sample prior to analyses - i.e., digestion techniques, solvent extraction, etc. Specify number of method and reference if not an EPA or DHS method.

Analysis Method Number - The means used to analyze the sample - i.e., GC, GC-MS, AA, etc. Specify number of method and reference if not a DHS or EPA method.

#### NOTE:

Method Numbers are available from certified laboratories.

### 18. SITE SAFETY PLAN

A plan outlining protective equipment and additional specialized personnel in the event that significant amount of hazardous materials are found. The plan should consider the availability of respirators, respirator cartridges, self-contained breathing apparatus (SCBA) and industrial hygienists.

19. ATTACH COPY OF WORKMAN'S COMPENSATION

20. PLOT PLAN

The plan should consists of a scaled view of the facility at which the tank(s) are located and should include the following information:

- a) Scale
- b) North Arrow
- c) Property Line
- d) Location of all Structures
- e) Location of all relevant existing equipment including tanks and piping to be removed
- f) Streets
- g) Underground conduits, sewers, water lines, utilities
- h) Existing wells (drinking, monitoring, etc.)
- i) Depth to ground water
- j) All existing tanks in addition to the ones being pulled



# CERTIFICATE OF INSURANCE

ISSUE DATE (MM/DD/YY)

10-17-88

PRODUCER

RCM Insurance Services  
3460 Robin Lane  
Cameron Park, CA 95682

THIS CERTIFICATE IS ISSUED AS A MATTER OF INFORMATION ONLY AND CONFERS NO RIGHTS UPON THE CERTIFICATE HOLDER. THIS CERTIFICATE DOES NOT AMEND, EXTEND OR ALTER THE COVERAGE AFFORDED BY THE POLICIES BELOW.

## COMPANIES AFFORDING COVERAGE

COMPANY LETTER **A** **USFLG**

COMPANY LETTER **B** **FIC**

COMPANY LETTER **C**

COMPANY LETTER **D**

COMPANY LETTER **E**

INSURED

Placer Tractor  
7200 Wells Ave.  
Loomis, CA 95650

## COVERAGES

THIS IS TO CERTIFY THAT POLICIES OF INSURANCE LISTED BELOW HAVE BEEN ISSUED TO THE INSURED NAMED ABOVE FOR THE POLICY PERIOD INDICATED, NOTWITHSTANDING ANY REQUIREMENT, TERM OR CONDITION OF ANY CONTRACT OR OTHER DOCUMENT WITH RESPECT TO WHICH THIS CERTIFICATE MAY BE ISSUED OR MAY PERTAIN, THE INSURANCE AFFORDED BY THE POLICIES DESCRIBED HEREIN IS SUBJECT TO ALL THE TERMS, EXCLUSIONS, AND CONDITIONS OF SUCH POLICIES.

CO LTR	TYPE OF INSURANCE	POLICY NUMBER	POLICY EFFECTIVE DATE (MM/DD/YY)	POLICY EXPIRATION DATE (MM/DD/YY)	ALL LIMITS IN THOUSANDS	
A	<b>GENERAL LIABILITY</b> <input checked="" type="checkbox"/> COMMERCIAL GENERAL LIABILITY <input type="checkbox"/> CLAIMS MADE <input checked="" type="checkbox"/> OCCURRENCE <input type="checkbox"/> OWNER'S & CONTRACTORS PROTECTIVE	CIP 092232008	6-9-88	6-9-89	GENERAL AGGREGATE	\$1,000
	PRODUCTS-COMP/OPS AGGREGATE				\$1,000	
	PERSONAL & ADVERTISING INJURY				\$1,000	
	EACH OCCURRENCE				\$1,000	
					FIRE DAMAGE (ANY ONE FIRE)	\$ 50
					MEDICAL EXPENSE (ANY ONE PERSON)	\$ 5
B	<b>AUTOMOBILE LIABILITY</b> <input type="checkbox"/> ANY AUTO <input type="checkbox"/> ALL OWNED AUTOS <input checked="" type="checkbox"/> SCHEDULED AUTOS <input type="checkbox"/> HIRED AUTOS <input type="checkbox"/> NON-OWNED AUTOS <input type="checkbox"/> GARAGE LIABILITY	C 3751686	8-29-88	8-29-89	CSL	\$
	BODILY INJURY (PER PERSON)				\$ 100,000	
	BODILY INJURY (PER ACCIDENT)				\$300,000	
	PROPERTY DAMAGE				\$ 50,000	
	<b>EXCESS LIABILITY</b> <input type="checkbox"/> OTHER THAN UMBRELLA FORM				EACH OCCURRENCE	\$
					AGGREGATE	\$
A	<b>WORKERS' COMPENSATION AND EMPLOYERS' LIABILITY</b>	74 0563877	6-9-88	6-9-89	STATUTORY	
					\$ (EACH ACCIDENT)	
					\$ (DISEASE-POLICY LIMIT)	
					\$ (DISEASE-EACH EMPLOYEE)	
	<b>OTHER</b> The officers, employees, and servants of the State of California are named as additional insureds with respects to liability insurance only.					

DESCRIPTION OF OPERATIONS/LOCATIONS/VEHICLES/RESTRICTIONS/SPECIAL ITEMS

All California Operations

## CERTIFICATE HOLDER

California Department of Transportation  
Hayward Maintenance Station  
21195 E. Center Street  
Castro Valley, CA 94546

## CANCELLATION

SHOULD ANY OF THE ABOVE DESCRIBED POLICIES BE CANCELLED BEFORE THE EXPIRATION DATE THEREOF, THE ISSUING COMPANY WILL ENDEAVOR TO MAIL 30 DAYS WRITTEN NOTICE TO THE CERTIFICATE HOLDER NAMED TO THE LEFT, BUT FAILURE TO MAIL SUCH NOTICE SHALL IMPOSE NO OBLIGATION OR LIABILITY OF ANY KIND UPON THE COMPANY, ITS AGENTS OR REPRESENTATIVES.



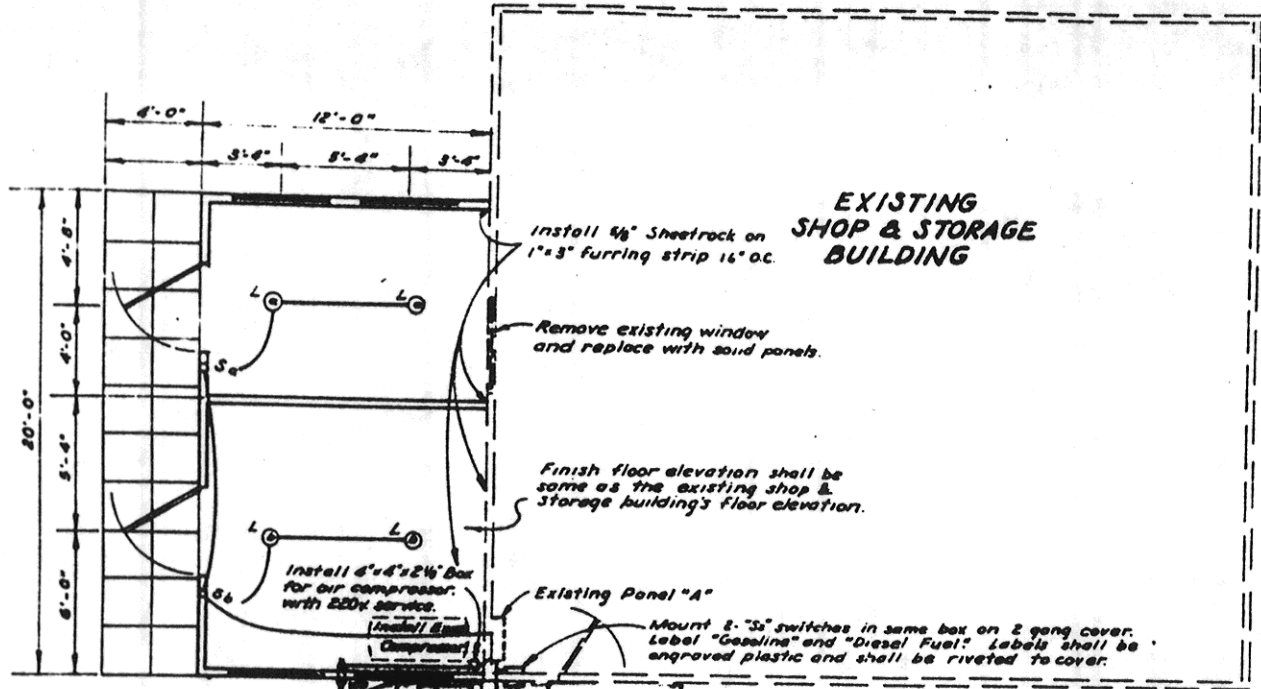

Remove Existing Riser  
Install 1/2" Water Line

Install 1/2" Compressed Air Line

Remove Existing Corrugated  
Iron Gas House, Fuel Pumps  
including Concrete Floor Slab

Remove Existing Vent Pipe  
and install new Vent Pipe with  
riser attached to building

Remove Existing Cast Iron Box  
and Cover and install New Box.

Existing Diesel Tank

1 1/2" Vent Pipe  
to Riser

2" Fill Pipe & Cover

Exist's Water Line

Remove existing riser  
install 1/2" Water Line

Order Oil  
Pump No. 1  
1/2" Fuel Line  
1/2" Fuel Line

Install 2500 Gal  
Gasoline Tank

1 1/2" Fuel Line

Remove Existing 250 Gal  
Gas Tanks

to be  
removed  
per Cathy,  
Place Tractor,  
1-13-89

Air line  
to equipment  
shed

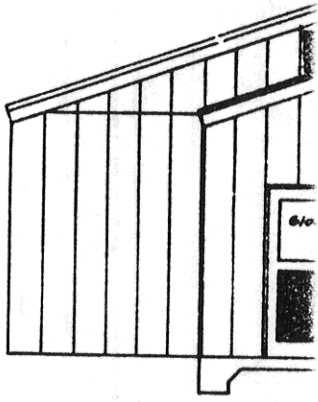

EAST E  
Scale :

PLAN  
Scale: 1/4" = 1'-0"

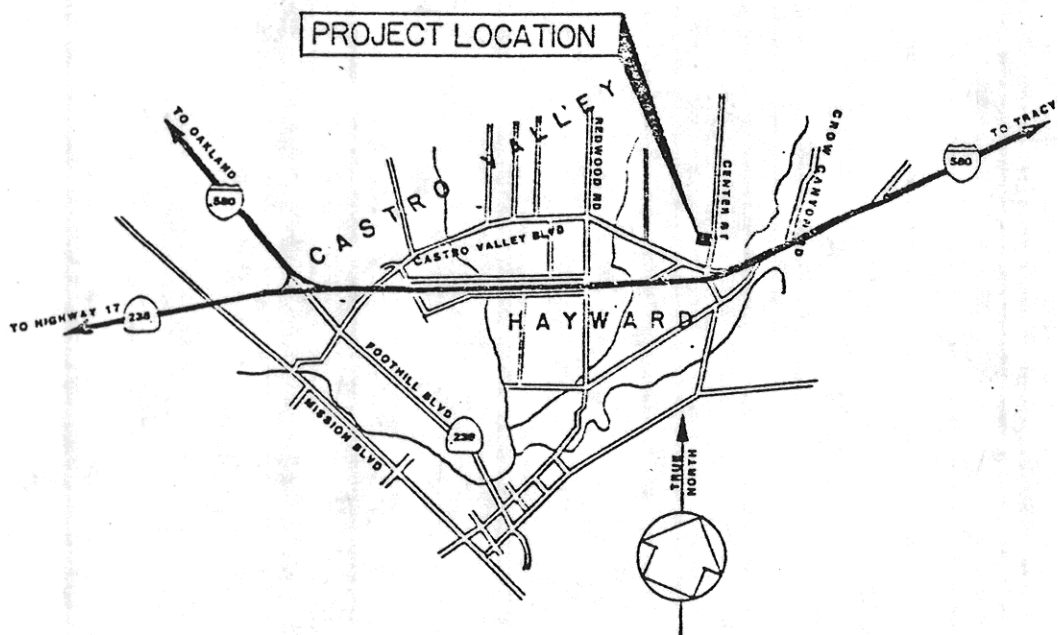
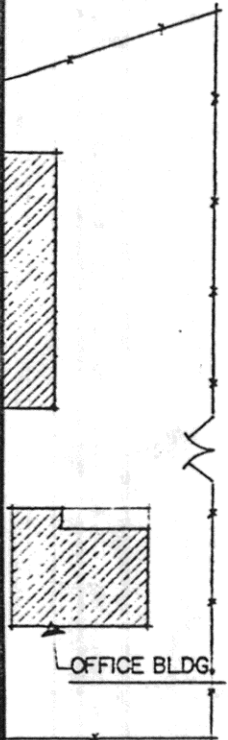

CENTER STREET

LOCATION MAP  
 SCALE IN FEET  
 0 1000 2000 3000 4000 5000

GLYSHER  
 EAST CORNER

**RECEIVED**  
 JAN 13 1989  
 HAZARDOUS MATERIALS/  
 WASTE PROGRAM

STATE OF CALIFORNIA  
 DEPARTMENT OF TRANSPORTATION  
 PROJECT PLAN FOR BUILDING CONSTRUCTION  
 IN ALAMEDA COUNTY  
 AT  
 THE HAYWARD MAINTENANCE STATION  
 21195 CENTER STREET

THE CONTRACTOR SHALL VERIFY ALL CONTROLLING FIELD DIMENSIONS AND CONDITIONS BEFORE ORDERING OR FABRICATING ANY MATERIAL.

Contract No. \_\_\_\_\_

State of CALIFORNIA  
 DEPARTMENT OF TRANSPORTATION

STRUCTURES ARCHITECTURAL DESIGN  
 PROJECT MANAGER  
*Paul E. Harris*

BRIDGE NO.  
 33M5711  
 POST MILE

HAYWARD MAINTENANCE STATION  
 PAINT BUILDINGS  
 INDEX, SITE PLAN, FINISH NOTES ETC.

SHEET  
**AI**

# INDEX TO BUILDING WORK

SHEET No.	SHEET TITLE
1	A1 INDEX, SITE PLAN, FINISH NOTES ETC
2	A2 FLOOR PLAN & ELEVATIONS STORAGE BUILDING No. 1 & 2
3	A3 FLOOR PLAN, ELEVATIONS & NOTES OFFICE AND STORAGE BUILDING No. 3
4	A4 ROOF PLAN, ELEVATIONS & NOTES EQUIPMENT BUILDING

- INDICATES BUILDINGS TO BE PAINTED

## FINISH NOTES

1. ALL FINISHES SHALL BE AS NOTED OR SIMILAR IN COLOR AND QUALITY SUBJECT TO ENGINEER'S APPROVAL.
2. PAINT MANUFACTURERS DESIGNATIONS ARE USED TO INDICATE COLOR AND QUALITY ONLY AND ARE NOT INTENDED TO SHOW A PREFERENCE FOR A PARTICULAR BRAND.
3. FINISHES ARE SELECTED FROM SHERWIN WILLIAMS, "BEAU MONDE" COLOR SYSTEM.

<p><u>FINISH NO. 1</u></p> <p><u>FINISH NO. 2</u></p> <p><u>FINISH NO. 3</u></p> <p><u>FINISH NO. 4</u></p> <p><u>FINISH NO. 5</u></p> <p><u>FINISH NO. 6</u></p>	<p>COLOR NO. BM 8-10</p> <p>COLOR NO. BM 1-1</p> <p>COLOR NO. EX-BM 2-9</p> <p>COLOR NO. EX-BM 2-6</p> <p>ONE COAT GALVANIZED METAL PRIMER NO. B-50A1, TWO COATS "SILVER-BRITE" ALUMINUM PAINT OR EQUAL.</p> <p>ONE COAT "GALVANIZED METAL PRIMER" NO. B-50A1, TWO COATS "PRO MAR" ALKYD SEMI-GLOSS ENAMEL (COLOR NO. EX-BM 2-9), OR EQUAL.</p>
---	---

### 4 INTERIOR FINISHES:

- a. FINISH NO. 1.....AT INTERIOR OFFICE BLDG. AND CREW ROOM ONLY: INTERIOR GYPSUM BOARD WALLS, PLASTERED WALLS, WOOD WALLS, INTERIOR WINDOW FRAMES, DOOR FRAMES, WOOD BASE, WOOD WALL TRIM, INTERIOR OF WOOD DOORS (EXCEPT WHERE NOTED OTHERWISE), AND ALL WOOD STORAGE CABINETS.
- b. FINISH NO. 2.....AT INTERIOR OF OFFICE BUILDING AND CREW ROOM ONLY: INTERIOR GYPSUM BOARD CEILINGS, PLASTERED CEILINGS & ACOUSTICAL TILED CEILINGS.

### 5 EXTERIOR FINISHES:

- a. FINISH NO. 3.....AT EXTERIOR OF ALL BUILDINGS ON SITE, METAL SIDING, WOOD FASCIAS, WOOD CORNER TRIM, EXPOSED PLUMBING VENTS AND PIPES, EXPOSED ELECTRICAL CONDUITS, WOOD POSTS, WOOD SOFFITS AND EXPOSED CONCRETE FOUNDATION WALLS, GALVANIZED METAL GUTTERS AND DOWNSPOOTS, MISCELLANEOUS GALVANIZED METAL ROOF EDGE TRIM, METAL FLASHINGS AND METAL DOOR TRACK HOUSING.
- b. FINISH NO. 4.....AT EXTERIOR OF ALL BUILDINGS ON SITE  
EXTERIOR WINDOW TRIM, METAL SLIDING DOORS, (EXTERIOR ONLY), METAL PEDESTRIAN DOORS, (EXTERIOR ONLY), METAL ROOFING AND OTHER MATERIALS INDICATED ON PLANS.
- c. FINISH NO. 5.....EXISTING GALVANIZED METAL VALLEY GUTTER AT EQUIPMENT BUILDING.
- d. FINISH NO. 6.....EXISTING GALVANIZED METAL GUTTERS, DOWNSPOOTS, MISCELLANEOUS GALVANIZED METAL ROOF EDGE TRIM AND METAL FLASHINGS WHERE OCCURS.

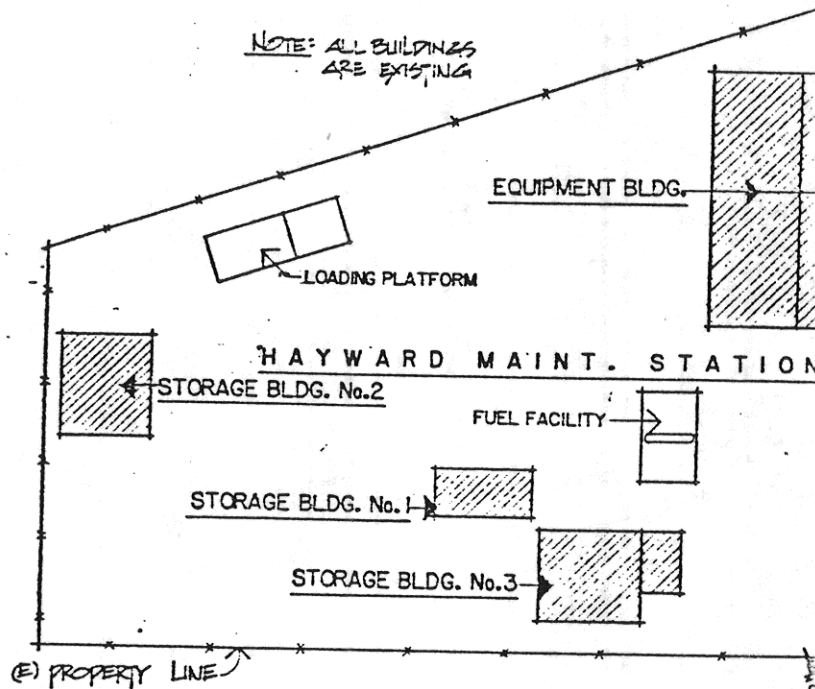

## SITE PLAN

1" = 30'-0"

## GENERAL NOTES

- 1- EXISTING RED PAINTED AREAS AT ALL FIRE EX LOCATIONS SHALL NOT BE PAINTED OVER
- 2- EXISTING CREW ROOM IS LOCATED AT THE SW. OF EQUIPMENT BUILDING.

THE BUILDING WORK ON THIS PROJECT HAS BEEN DESIGNED TO CONFORM TO TITLE 24 OF THE CALIFORNIA ADMINISTRATIVE CODE.

DESIGNED BY  GARY E. HARRIS	CHECKED BY  JIM OKAMURA	SHEET LEGEND A-1 ARCHITECTURAL    M-1 MECHANICAL S-1 STRUCTURAL        E-1 ELECTRICAL C-1 CIVIL                    L-1 LANDSCAPE
REGISTRATION NUMBER C-4496	DATE MARCH 3, 1968	
DRAWN BY GARY E. HARRIS	SPECIFICATIONS Jim Okamura 6-2-68	

ORIGINAL SCALE IN INCHES  
FOR REDUCED PLANS

**ADDITION TO  
PANEL "A"**

Cir. No.	Poles	Amp Rating	To Serve
3	1	20	Fuel Pumps
4	1	15	Gas and Oil House (Lighting)
5	1	20	Gas and Oil House (Outlets)

**ELECTRICAL LEGEND**

Q	Duplex locking device receptacle, 3 wire grounded, polarized, 15amp/125 volt, specification grade.
L	Lighting Fixture, RLM dome type, with removable porcelain reflector and pendant type hood, with 150 watt silvered-bowl lamp. Mount from 4"x4" box.
S	Flush tumbler switch, single pole, 20 amp, 125 volt "T" rated, specification grade, mounted in a 4"x4"x2 1/2" Box and fitted with Flush Cover.
Q-WP	Single locking device, porcelain receptacle, 3 wire grounded, polarized, mounted in "FS" conduit box with gasketed spring door cover, specification grade.
—	1/2" Conduit with 2 #12 Conductors
Sa	Same as S except double pole.

DATE COUNTY  
IV Ale Hayward Maint. Sta.  
*L. R. Reynolds*  
January 26, 1967  
*J. R. Bester*  
REGISTERED ENGINEER  
CIVIL ENGINEER LICENSE

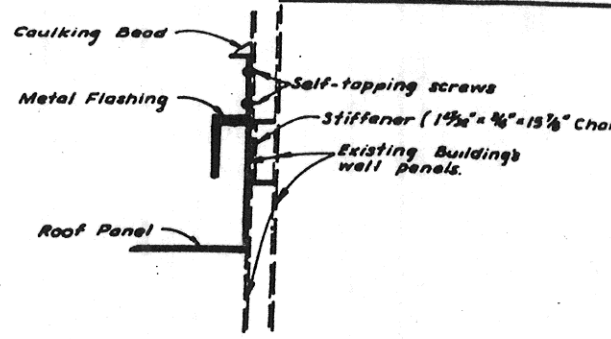

**ROOF FLASHING DETAIL**  
Not to Scale

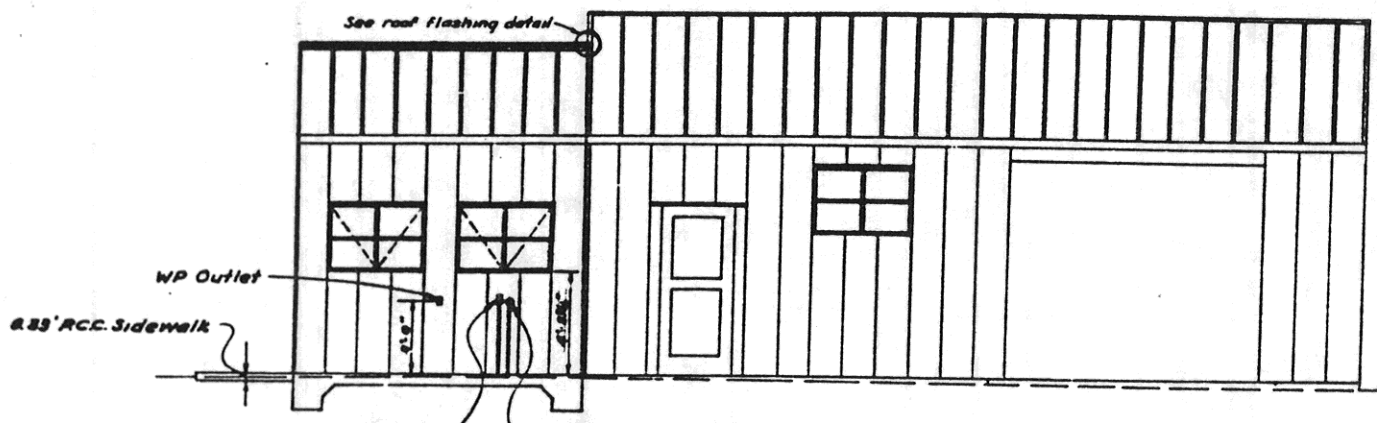

**NORTH ELEVATION**  
Scale: 1/4" = 1'-0"

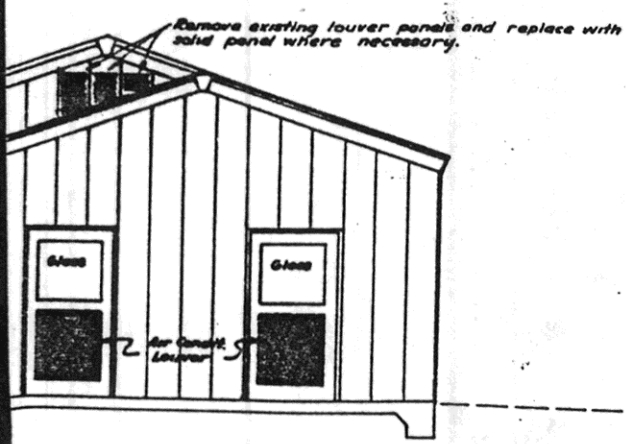

**ELEVATION**  
Scale: 1/4" = 1'-0"

**AS BUILT PLANS**  
Contract No. 61-4440.e.1  
Date Completed \_\_\_\_\_  
Document No. 4000/687

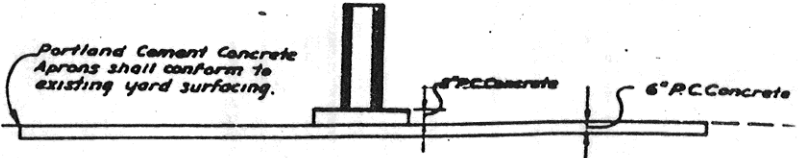

**P.C.C. PUMP APRONS & ISLAND**  
Scale: 1/4" = 1'-0"

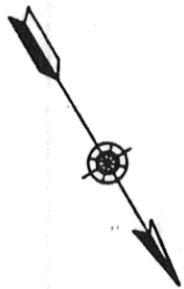

### EXISTING SHOP & STORAGE BUILDING

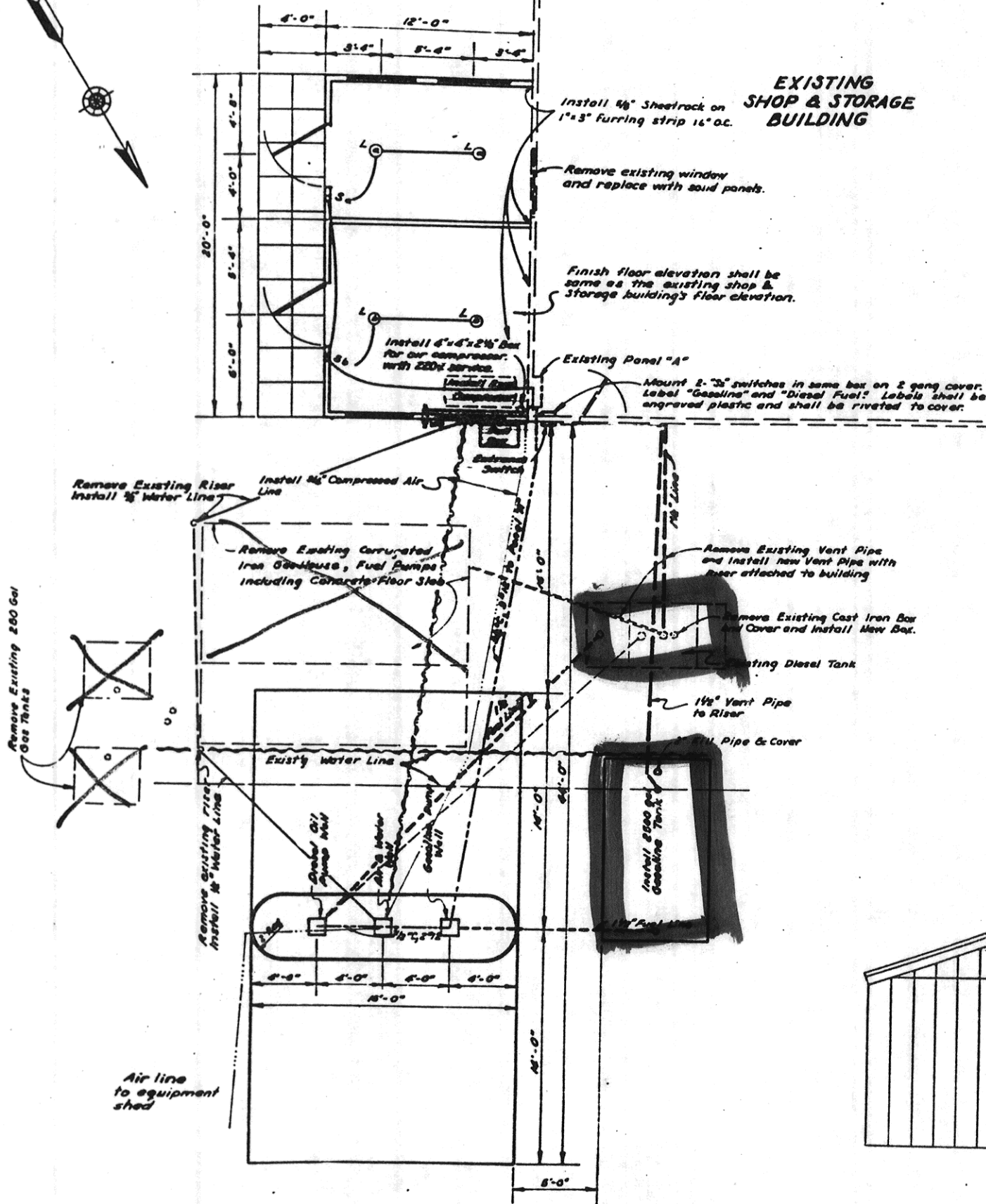

Install  $\frac{1}{2}$ " Sheetrock on 1" x 3" furring strip 16" o.c.

Remove existing window and replace with solid panels.

Finish floor elevation shall be same as the existing shop & storage building's floor elevation.

Install 4" x 4" x 2 1/2" Box for air compressor with 220v service.

Existing Panel "A"

Mount 2 "30" switches in same box on 2 gang cover. Label "Gasoline" and "Diesel Fuel". Labels shall be engraved plastic and shall be riveted to cover.

Remove Existing Riser  
Install  $\frac{1}{2}$ " Water Line

Install  $\frac{1}{2}$ " Compressed Air Line

Remove Existing Corrugated Iron Gas House, Fuel Pumps including Concrete Floor Slab

Remove Existing Vent Pipe and install new Vent Pipe with Riser attached to building

Remove Existing 250 Gal Gas Tanks

Remove Existing Cast Iron Box Cover and install New Box

Existing Diesel Tank

1 1/2" Vent Pipe to Riser

Remove existing pipe  
Install  $\frac{1}{2}$ " Water Line

Existing Water Line

1 1/2" Pipe & Cover

Install 250 Gal Gasoline Tank

Air line to equipment shed

### PLAN

Scale: 1/4" = 1'-0"