



Geo/Resource Consultants, Inc.
GEOLOGISTS/ENGINEERS/ENVIRONMENTAL SCIENTISTS

851 Harrison Street
San Francisco, California 94107

FACSIMILE MESSAGE COVER SHEET

Date: 1/12/90 Job Number: _____
 To: Scott Sperry Facsimile Number: () _____
 Location: Alameda County _____
 From: Gu Lunck Location: GHC San Francisco Office

Total number of pages sent: 2 (including this cover sheet).
If you do not receive all pages, please call back as soon as possible

Facsimile Operator: (415) 777-3177
Facsimile Number: (415) 777-5623

Comments:

*Revised site plan for
Hayward Maintenance Station*

CORPORATE HEADQUARTERS
SAN FRANCISCO, CALIFORNIA

REGIONAL OFFICES

WASHINGTON, D.C. TUCSON PHOENIX SEATTLE

MW-3 ⊕ Proposed Monitoring Well Location

NOT TO SCALE

 <p>Geo/Resource Consultants, Inc. GEOLOGISTS / ENGINEERS / ENVIRONMENTAL SCIENTISTS 851 HARRISON STREET, SAN FRANCISCO, CALIFORNIA 94107</p> <p>1516-000 Date: 11/14/89</p>	<p>SITE PLAN HAYWARD MAINTENANCE STATION CASTRO VALLEY, CALIFORNIA</p>	<p>FIGURE 2</p>
------------------------------------------------------------------------------------------------------------------------------------------------------------------------------------------------------------------------------------------------------------------------------------	---------------------------------------------------------------------------------------	-----------------------------------

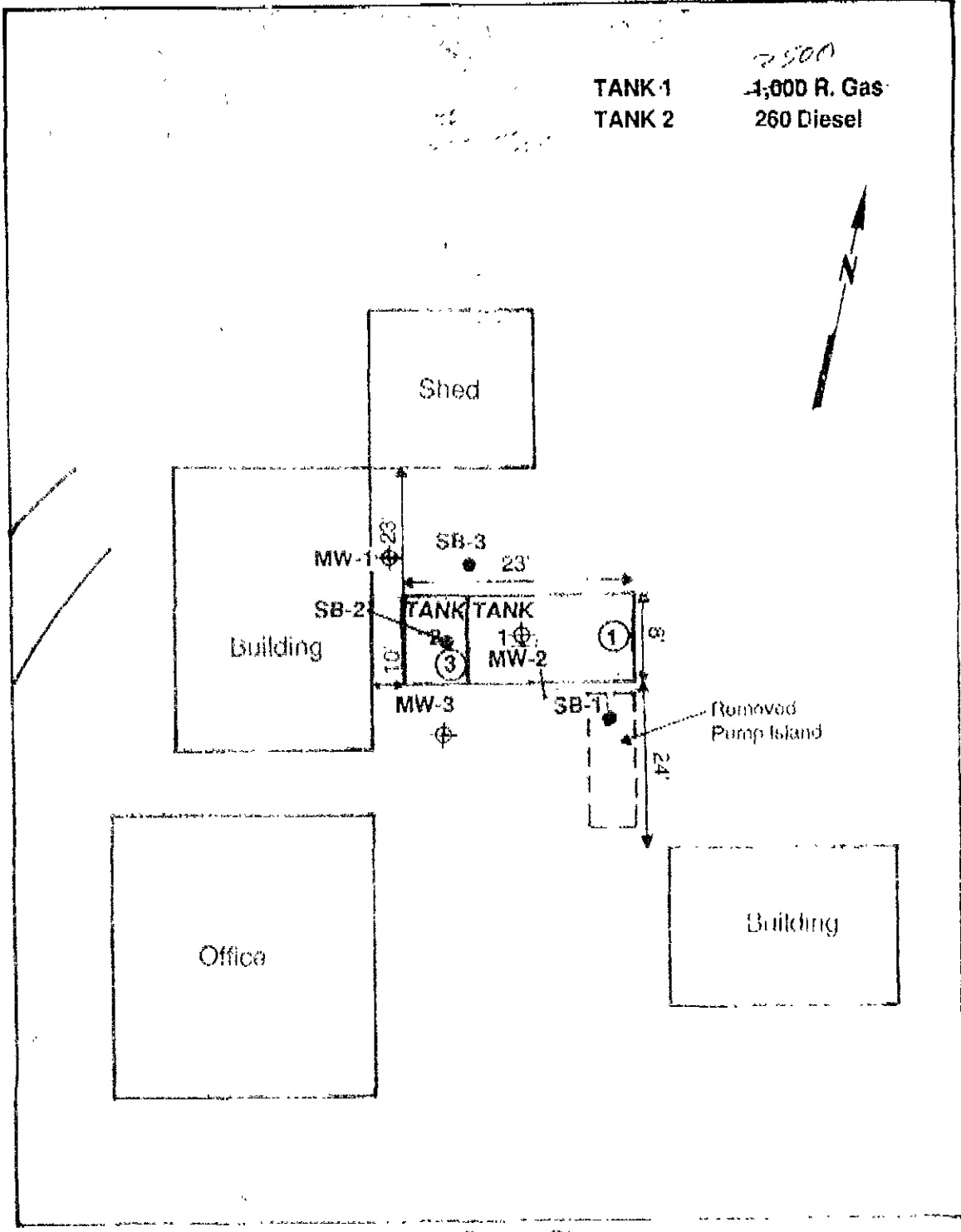

TANK 1 7500
4,000 R. Gas
TANK 2 260 Diesel

LEGEND:

- ① Previous Soil Sample
- SB-2 ● Proposed Boring Location
- MW-3 ⊕ Proposed Monitoring Well Location

Reference: Adapted from a sketch provided by the Office of State Architect, 1989
not to scale



Geo/Resource Consultants, Inc.
GEOLOGISTS / ENGINEERS / ENVIRONMENTAL SCIENTISTS
851 HARRISON STREET, SAN FRANCISCO, CALIFORNIA 94107

SITE PLAN
HAYWARD MAINTENANCE STATION
CASTRO VALLEY, CALIFORNIA

FIGURE

2

Job No. 1516-000 Appr. *[Signature]* Date 11/14/89

DATAPRINT N09994