

PAVLAK & Associates

GEOTECHNICAL / ENVIRONMENTAL CONSULTANTS

Project No. 87-1052-M
January 29, 1988

Mrs. Erma DeLucchi
77 Selborne Drive
Piedmont, CA 94611

Subject: Automotive Auto Repair
2425 Central Avenue
Alameda, California
GROUNDWATER MONITORING
WELL INSTALLATION

Gentlemen:

At your request, Pavlak & Associates has developed a proposal for the installation of one groundwater monitoring well at the subject site. The purpose of this investigation is to determine whether gasoline leaking from a former underground storage tank at the subject site has contaminated the underlying groundwater.

As shown on the Site Plan provided by Blaine Tech Services, a cluster of two underground gasoline storage tanks was excavated near the northeastern property boundary. These tanks were removed from the site on October 15, 1987. Samples of soils collected in the tank excavation were analyzed for the presence of total petroleum hydrocarbons (TPH) as gasoline. High concentrations of TPH were revealed in the soil samples and remedial soil excavation work was performed there. Subsequent soil sampling and analysis found TPH as gasoline at 68, 110, and 410 parts per million (ppm). Since two of these samples contained TPH at concentrations in excess of 100 ppm but below 1000 ppm, the Regional Water Quality Control Board requires the groundwater to be monitored at this site. In response to these requirements, we propose to construct one groundwater monitoring well in the approximate center of the backfilled, form tank excavation. The monitoring well will extend ten feet below groundwater or will terminate when a suitable aquitard is encountered underlying the aquifer.

Well Construction Details

The well boring will be drilled with a truck-mounted drill rig utilizing 8-inch diameter, hollow-stem augers. A 2-inch diameter schedule 40 PVC casing with threaded couplings will be placed in the boring. The casing will be perforated from the bottom of the well to at least two feet above groundwater level. Aquarium sand will be placed around the perforated section of the casing and a concrete seal will be poured to the ground surface. A locking well cap and concrete vault box will then be installed.

Soil Sampling

Soil samples will be collected at five-foot depth intervals commencing at the bottom of the excavation backfill until groundwater is encountered. It is anticipated, however, that groundwater levels are higher than the bottom of the excavation.

Project No. 87-1052-M
January 29, 1988

Laboratory Analysis

If soil samples are submitted for analysis, they will be analyzed for the presence of total petroleum hydrocarbons as gasoline. The analysis will be performed by Anatec Laboratories, Inc. of Santa Rosa, California, utilizing EPA Method 5020.

If you have any questions or require additional information, please contact our office at your convenience.

Yours truly,

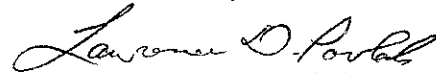
Lawrence D. Pavlak, C.E.G.
Pavlak & Associates

LDP/np

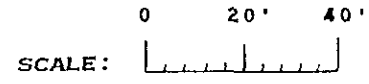
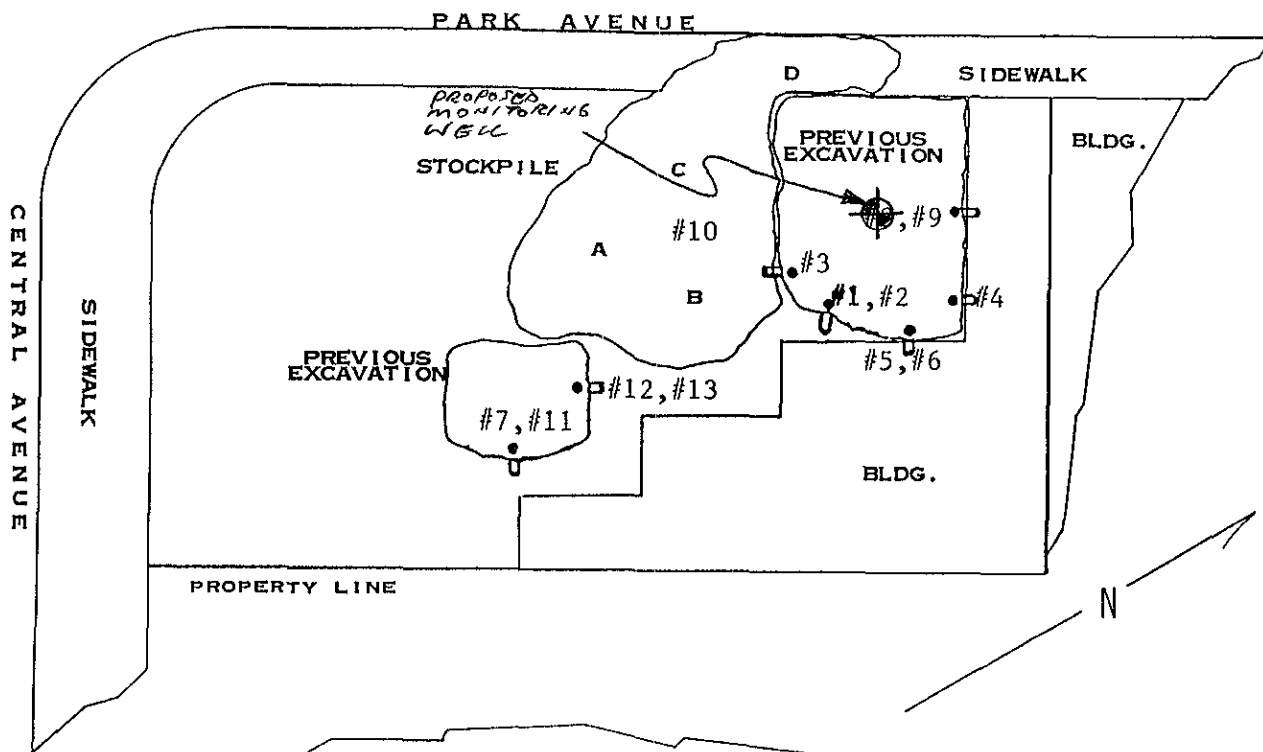

MAP REF: THOMAS BROS.
ALAMEDA COUNTY
P.11 D-5

SAMPLING PERFORMED BY STEPHEN CARTER
DIAGRAM PREPARED BY BRENT ADAMS

