



Clark & Witham, Inc.

ALCO
HAZMAT
94 SEP 21 PM 4:50

Phone:
(510) 659-1805
Fax:
(510) 659-6344

3499 Edison Way, Fremont, CA. 94538

Consulting Engineering Geologists

September 6, 1994
CHO002-C

Ms. Eva Chu
Alameda County Department of Environmental Health
Hazardous Materials Division
80 Swan Way, Room 200
Oakland, California 94621

Subject: Former Aboveground Storage Tank Located at the Former Okada Property,
16109 Ashland Avenue, San Lorenzo, California.

Ms. Chu:

This letter provides further information on Uniform Hazardous Waste Manifests and certificates for storage tanks submitted to you via Clark & Witham, Inc.'s letter dated August 3, 1994. The certificates reference 4,000- and 6,000-gallon fuel oil tanks and a 250-gallon gasoline tank. The 4,000-gallon fuel oil tank was an underground storage tank located in the north central portion of the property. Previous reports indicated the capacity of this tank was 3,000 gallons. The 250-gallon gasoline tank was also an underground storage tank located in the northeastern portion of the property. Mr. Hideo Okada has indicated to representatives of Citation Homes that the 6,000-gallon tank was an aboveground storage tank used to store fuel oil. The approximate location of this tank is marked on the attached map. The manifest information indicates the three tanks were removed from the site at the same time. Below is Mr. Okada's signature indicating the accuracy of the above information on the 6,000-gallon aboveground tank. Please call if you have any questions.

Sincerely,
Clark & Witham, Inc.

Rodger C. Witham
Project Manager

Mr. Hideo Okada

Attachment: Site Plan - Northeast Portion

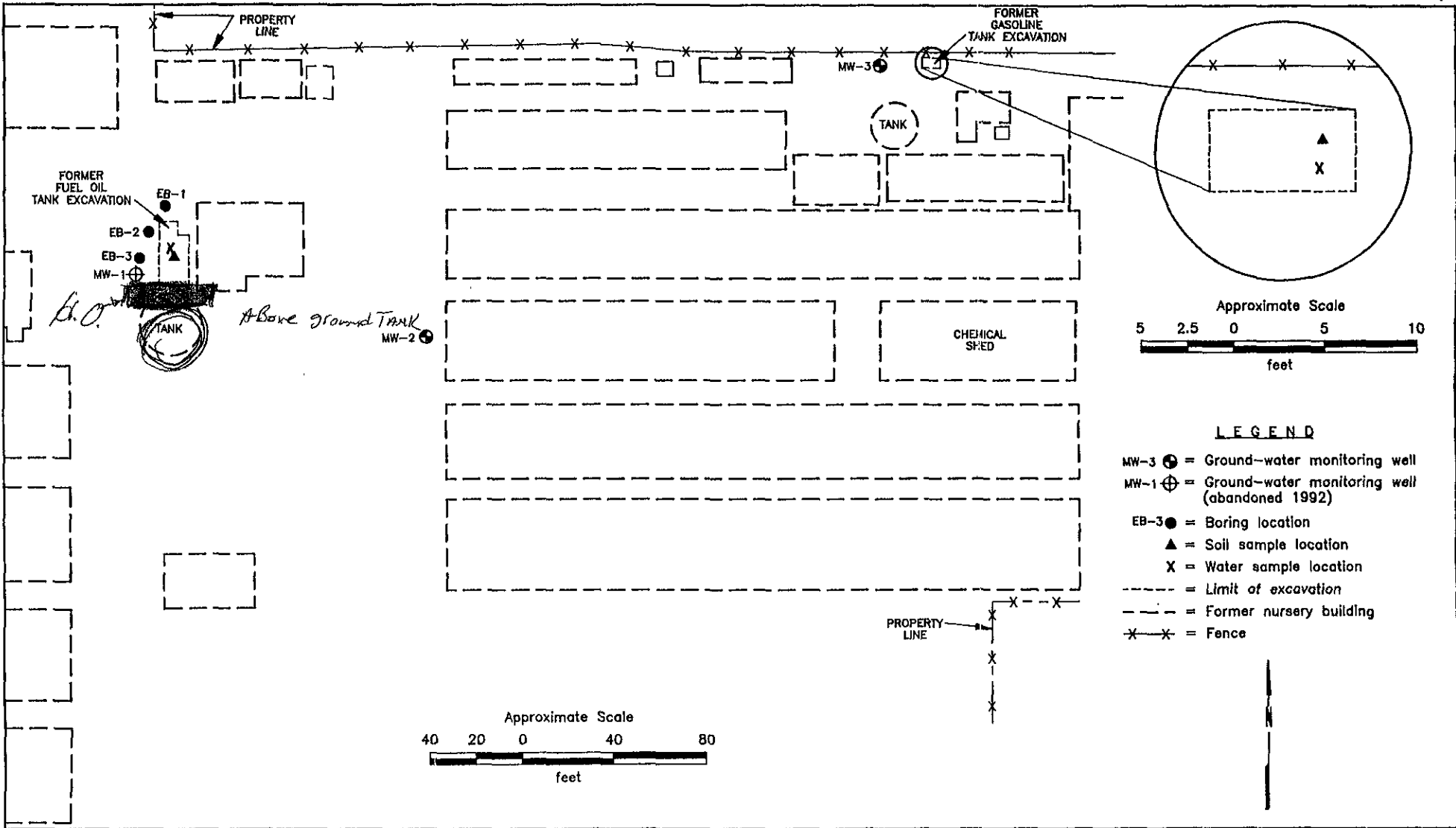

**CLARK &
WITHAM, INC.**

PROJECT NO. CH0002-B

SITE PLAN - NORTHEAST PORTION
Former Okada Property
16109 Ashland Avenue
San Lorenzo, California

PLATE 3

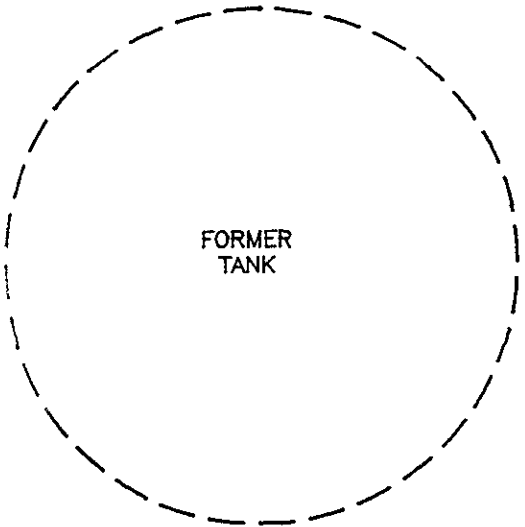
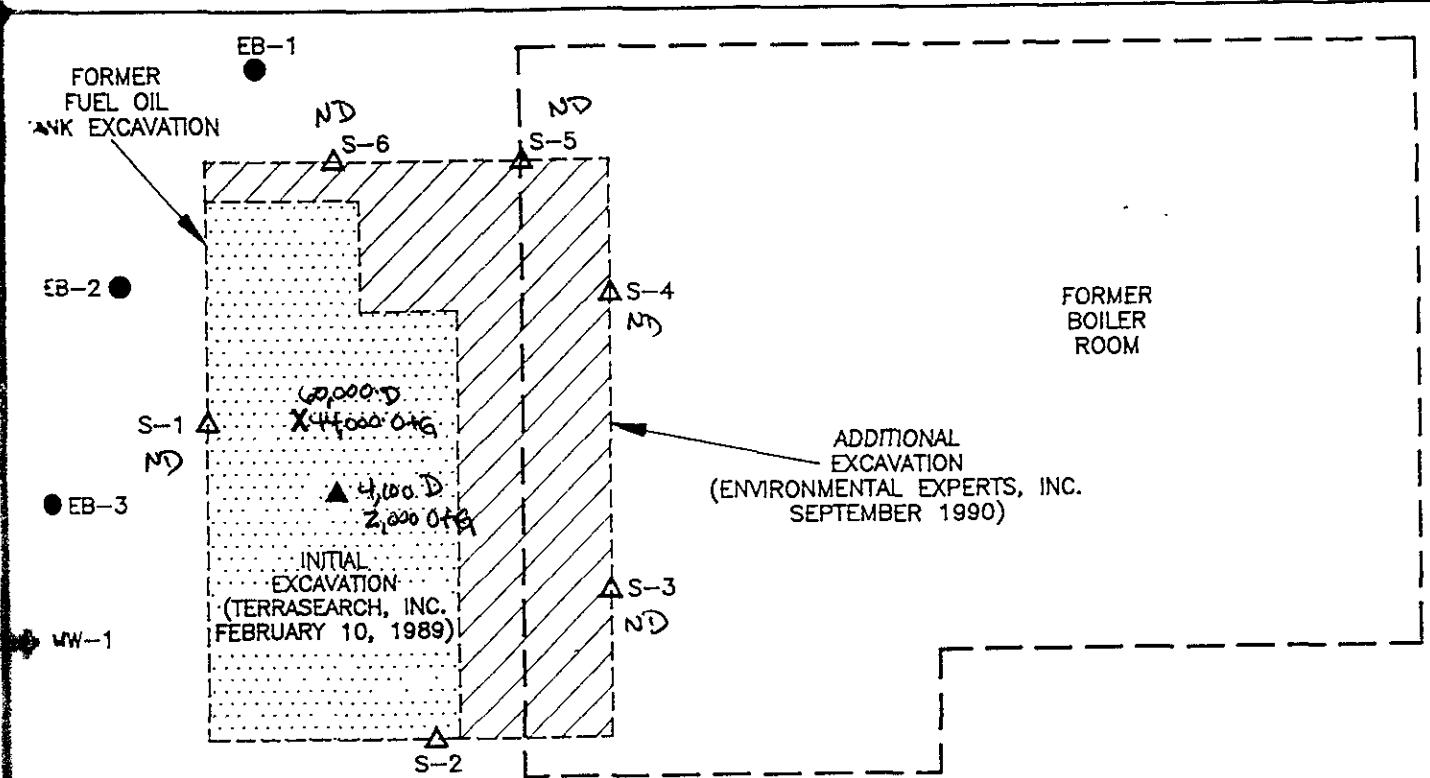

LEGEND

- 1 ⊕ = Ground-water monitoring well (abandoned 1992)
- EB-3 = Boring location MAR 1989
- ▲ = Soil sample location (TERRARESEARCH, INC.) ppm
- △ S-6 = Soil sample location AUG 1990 (Environmental Experts, Inc.)
- X = Water sample location ppb

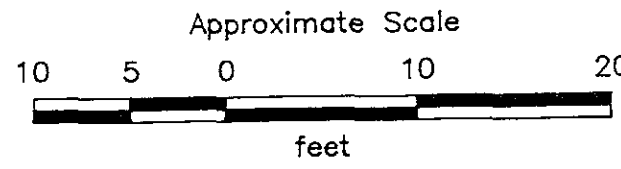

CLARK & WITHAM, INC.

FUEL-OIL TANK EXCAVATION
Former Okada Property
16109 Ashland Avenue
San Lorenzo, California

PLATE 4

PROJECT NO. CH0002-B

8/29/90

Citizen Homes

