

C A M B R I A

October 11, 2001

Mr. Don Hwang
Alameda County Department of
Environmental Health
UST Local Oversight Program
1131 Harbor Bay Parkway, 2nd Floor
Alameda, CA 94502

OCT 18 2001

Re: **Groundwater Monitoring and System Progress Report
Third Quarter 2001**
Hooshi's Auto Service
1499 MacArthur Blvd.
Oakland, California 94602
Cambria Project No. 129-0741



Dear Mr. Hwang:

On behalf of Ms. Naomi Gatzke, Cambria Environmental Technology, Inc. (Cambria) has prepared this groundwater monitoring and remediation system progress report for the above-referenced site. Presented in the report are the third quarter 2001 activities and the anticipated fourth quarter 2001 activities.

If you have any questions or comments regarding this report, please call me at (510) 450-1983.

Sincerely,
Cambria Environmental Technology, Inc.

Ron Scheele, RG
Senior Geologist

Attachments: Groundwater Monitoring and System Progress Report, Third Quarter 2001

Oakland, CA
San Ramon, CA
Sonoma, CA

cc: Mr. Robert Cave, BAAQMD, Permit Services Division, 939 Ellis Street, San Francisco, California 94109
Ms. Naomi Gatzke, 1545 Scenic View Dr., San Leandro, CA 94577

**Cambria
Environmental
Technology, Inc.**

1144 65th Street
Suite B
Oakland, CA 94608
Tel (510) 420-0700
Fax (510) 420-9170

C A M B R I A

GROUNDWATER MONITORING AND SYSTEM PROGRESS REPORT

THIRD QUARTER 2001

Hooshi's Auto Service
1499 MacArthur Blvd.
Oakland, California 94602
Cambria Project No. 129-0741

October 11, 2001



Prepared for:

Ms. Naomi Gatzke
1545 Scenic View Drive
San Leandro, California 94577

Prepared by:

Cambria Environmental Technology, Inc.
6262 Hollis Street
Emeryville, California 94608

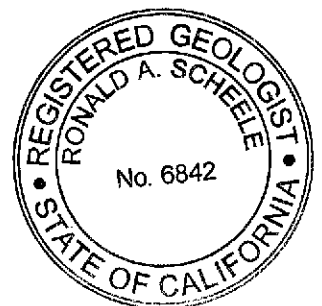

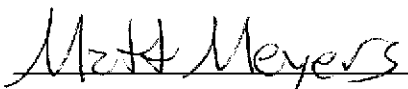
Matthew A. Meyers
Staff Geologist

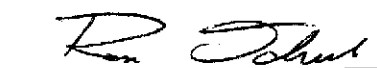
Ron Scheele, RG
Senior Geologist

GROUNDWATER MONITORING AND SYSTEM PROGRESS REPORT

THIRD QUARTER 2001

Hooshi's Auto Service
1499 MacArthur Blvd.
Oakland, California 94602
Cambria Project No. 129-0741

October 11, 2001

INTRODUCTION

On behalf of Ms. Naomi Gatzke, Cambria Environmental Technology, Inc. (Cambria) has prepared this Groundwater Monitoring and System Progress Report for the above-referenced site (see Figure 1). Presented in the report are the third quarter 2001 groundwater monitoring and corrective action activities and the anticipated fourth quarter 2001 activities.

THIRD QUARTER 2001 ACTIVITIES

Monitoring Activities

Field Activities: On August 6, 2001, Cambria gauged water levels and inspected for separate phase hydrocarbons (SPH) in groundwater monitoring wells MW-1 through MW-6. On August 6, groundwater samples were obtained from monitoring wells that did not contain SPH. Field data sheets are presented as Appendix A.

Sample Analyses: Groundwater samples were analyzed for total petroleum hydrocarbons as gasoline (TPHg) by modified EPA Method 8015, benzene, toluene, ethylbenzene, and xylenes (BTEX), and methyl tertiary butyl ether (MTBE) by EPA Method 8020. When MTBE was detected by EPA Method 8020, the result was confirmed by EPA Method 8260. The groundwater analytical results are summarized in Table 1. The laboratory analytical report is included as Appendix B.

Monitoring Results

Groundwater Flow Direction: Based on field measurements collect on August 6, 2001, groundwater beneath the site flows towards the southwest at a gradient of 0.225 ft/ft (Figure 1). This is consistent with the historic groundwater flow direction and gradient. Depth to water and groundwater elevation data are presented in Table 1.

Hydrocarbon Distribution in Groundwater: No SPH were detected this quarter. TPHg concentrations ranged from 59 to 54,000 micrograms per liter ($\mu\text{g/L}$), with the maximum TPHg concentration detected in well MW-2. The maximum concentration of benzene was detected in well MW-2, at 680 $\mu\text{g/L}$. MTBE was detected only in well MW-1 and MW-2, at 4.0 $\mu\text{g/L}$ (as confirmed by EPA 8260). Table 1 summarizes the groundwater analytical results.

Corrective Action Activities

SVE System Status: The SVE system was removed from the site in the second quarter. Additional site remediation may be performed in the future pending the preparation and agency approval of an Interim Remedial Action Plan.

ANTICIPATED FOURTH QUARTER 2001 ACTIVITIES

Monitoring Activities

Cambria will gauge the site wells, check the wells for SPH, and collect groundwater samples from all wells not containing SPH. Groundwater samples will be analyzed for TPHg by Modified EPA Method 8015 and BTEX and MTBE by EPA Method 8020. Any samples containing MTBE will be confirmed by EPA Method 8260. Cambria will prepare a groundwater monitoring report summarizing the monitoring activities and results.

Corrective Action Activities:

Cambria plans to revise the remediation system after preparation and agency approval of an Interim Remedial Action Plan.

ATTACHMENTS

- Figure 1 – Groundwater Elevation Contour and Hydrocarbon Concentration Map
- Table 1 – Groundwater Elevation and Analytical Data
- Appendix A – Groundwater Monitoring Field Data Sheets
- Appendix B – Analytical Results for Groundwater Sampling

Hooshi's Auto Service
 1499 MacArthur Boulevard
 Oakland, California

C A M B R I A



**Groundwater Elevation Contour
 and Hydrocarbon Concentration Map**

August 6, 2001

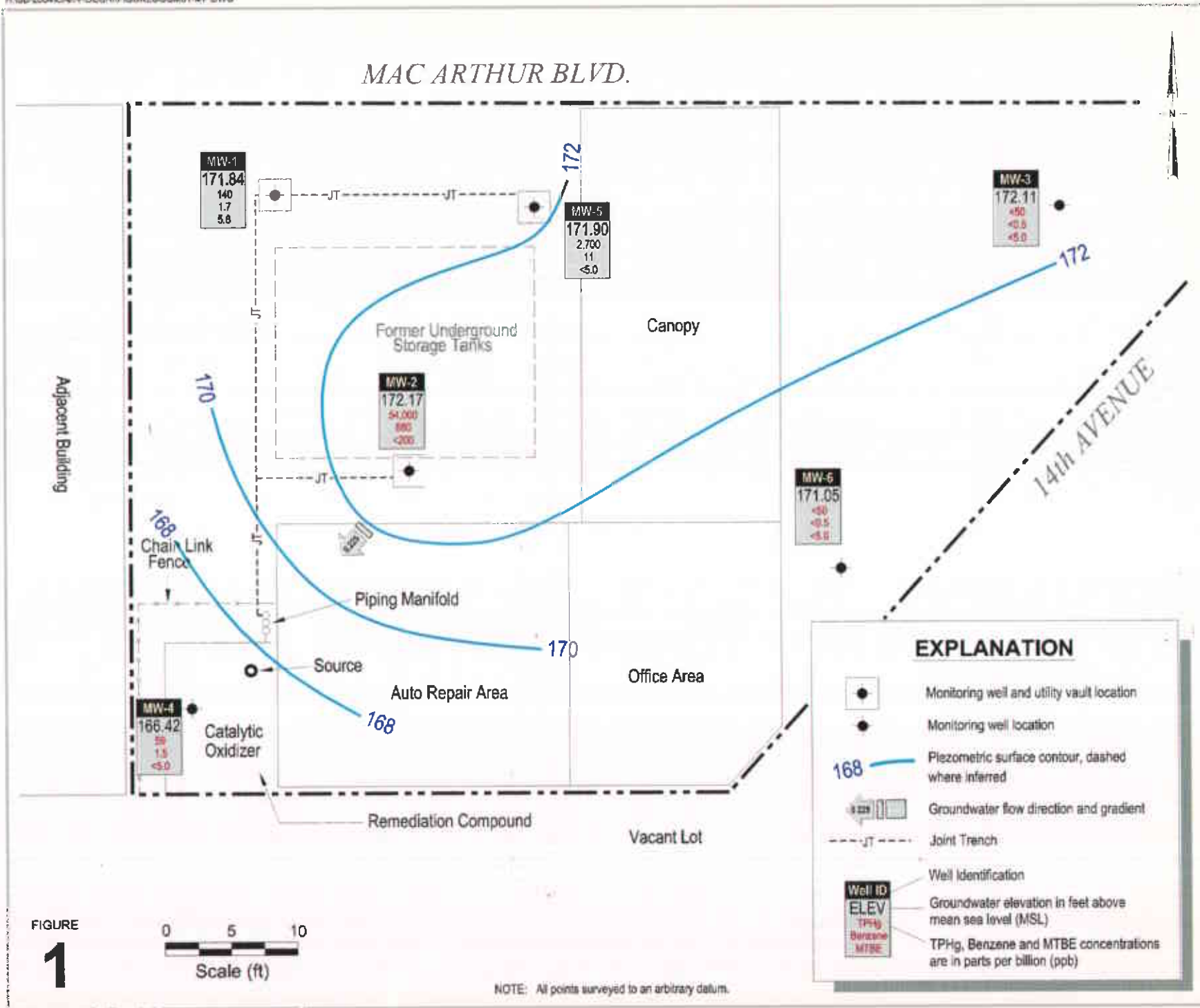

FIGURE
1

CAMBRIA

Table 1. Groundwater Elevation and Analytical Data - Hooshi's Auto Service, 1499 MacArthur Boulevard, Oakland, California

| Well ID TOC (ft*) | Date | Depth to Groundwater (ft) | Groundwater Elevation (ft**) | Separate Phase Hydrocarbons (ft) | TPHg ← | Benzene | Toluene | Ethylbenzene → | | | Xylenes | MTBE | Notes |
|----------------------|----------|---------------------------------|------------------------------------|--|-----------|---------|---------|----------------|--------|-----------|---------|------|-------|
| | | | | | | | | (µg/L) | | | | | |
| MW-1 181.00 | 1/4/93 | -- | -- | -- | 539 | 130 | 12 | 22 | 13 | -- | | | |
| | 4/22/93 | -- | -- | -- | 1,130 | 75 | 8.0 | 38 | 11 | -- | | | |
| | 12/27/94 | -- | -- | -- | 770 | 22 | 6.6 | 14 | 21 | -- | | | |
| | 6/27/96 | 14.11 | 166.89 | -- | 3,300 | 260 | 34 | 59 | 170 | 80 | | | |
| | 12/10/96 | 13.71 | 167.29 | -- | 1,500 | 84 | 11 | 22 | 32 | 34 | | | |
| | 5/8/98 | 13.85 | 167.15 | -- | 3,200 | 300 | 12 | 62 | 36 | <120 | | a | |
| | 8/17/98 | 14.11 | 166.89 | -- | 1,700 | 160 | 18 | 32 | 27 | 39 | | a | |
| | 11/4/98 | 14.28 | 166.72 | -- | 1,100 | 11 | 4.3 | 3.6 | 6.5 | <50 | | a | |
| | 2/17/99 | 13.41 | 167.59 | -- | 320 | 200 | 47 | 72 | 75 | 57 | | a | |
| | 5/27/99 | 14.16 | 166.84 | -- | 2,500 | 81 | 12 | 29 | 41 | <80 | | a | |
| | 8/19/99 | 14.18 | 166.82 | -- | 780 | 19 | <0.5 | 5.7 | 4.5 | 28 | | a | |
| | 180.83 | 11/23/99 | 14.43 | 166.40 | -- | 1,300 | 24 | 0.64 | 1.8 | 3.3 | <100 | | a |
| | | 2/17/00 | 13.85 | 166.98 | -- | 1,300 | 60 | 9.1 | 22 | 19 | 22 (16) | | a,b |
| | | 5/9/00 | 14.01 | 166.82 | -- | 2,700 | 55 | 13 | 19 | 25 | 34 (29) | | a |
| 8/15/00 | | 14.24 | 166.59 | -- | -- | -- | -- | -- | -- | -- | | | |
| 180.63 | 12/1/00 | 8.75 | 172.08 | -- | 480 | 6.4 | 5.9 | 1.1 | 3.9 | 18 (21) | | a | |
| | 2/8/01 | 8.49 | 172.14 | -- | 64 | <0.5 | <0.5 | <0.5 | <0.5 | 6.1 (5.6) | | a,c | |
| | 4/9/01 | 8.71 | 171.92 | -- | -- | -- | -- | -- | -- | -- | | | |
| | 4/24/01 | 7.90 | 172.73 | -- | 77 | <0.5 | <0.5 | <0.5 | <0.5 | 5.6 (3.7) | | c | |
| | 8/6/01 | 8.83 | 171.80 | -- | 140 | 1.7 | 0.55 | <0.5 | 0.63 | 5.8 (4.0) | | a | |
| MW-2 180.45 | 1/4/93 | -- | -- | -- | 149,000 | 21,700 | 25,000 | ND | 7,760 | -- | | | |
| | 4/22/93 | -- | -- | -- | 136,300 | 9,900 | 15,870 | 15,300 | 2,190 | -- | | | |
| | 12/27/94 | -- | -- | -- | 94,000 | 11,000 | 18,000 | 2,700 | 16,000 | -- | | | |
| | 6/27/96 | 12.61 | 168.64 | 1.00 | -- | -- | -- | -- | -- | -- | | | |
| | 12/10/99 | 11.10 | 169.55 | 0.25 | -- | -- | -- | -- | -- | -- | | | |
| | 5/8/98 | 10.81 | 169.66 | 0.03 | -- | -- | -- | -- | -- | -- | | | |
| | 8/17/98 | 12.16 | 168.31 | 0.02 | -- | -- | -- | -- | -- | -- | | | |
| | 11/4/98 | 12.61 | 167.86 | 0.02 | -- | -- | -- | -- | -- | -- | | | |
| | 2/17/99 | 9.82 | 170.66 | 0.04 | -- | -- | -- | -- | -- | -- | | | |
| | 5/27/99 | 11.07 | 169.48 | 0.13 | -- | -- | -- | -- | -- | -- | | | |
| | 8/19/99 | 12.79 | 167.68 | 0.02 | -- | -- | -- | -- | -- | -- | | | |
| | 180.24 | 11/23/99 | 12.14 | 168.20 | 0.12 | -- | -- | -- | -- | -- | -- | | |
| | | 2/17/00 | 10.01 | 170.37 | 0.18 | -- | -- | -- | -- | -- | -- | | |
| | | 5/9/00 | 10.88 | 169.38 | 0.03 | -- | -- | -- | -- | -- | -- | | |

CAMBRIA

Table 1. Groundwater Elevation and Analytical Data - Hooshi's Auto Service, 1499 MacArthur Boulevard, Oakland, California

| Well ID | Date | Depth to Groundwater (ft) | Groundwater Elevation (ft**) | Separate Phase Hydrocarbons (ft) | TPHg | Benzene | Toluene | Ethylbenzene | Xylenes | MTBE | Notes |
|---------|----------|---------------------------|------------------------------|----------------------------------|---------|---------|---------|--------------|---------|------------|-------|
| | | | | | | (µg/L) | | | | | |
| | 8/15/00 | 12.28 | 167.97 | 0.01 | — | — | — | — | — | — | |
| | 12/1/00 | 8.03 | 172.21 | -- | 260,000 | 1,100 | 5,000 | 1,900 | 17,000 | <100 | a |
| | 2/8/01 | 7.86 | 172.38 | -- | 2,900 | 1.7 | 14 | 5.0 | 140 | <5.0 | c,d |
| | 4/9/01 | 7.95 | 172.29 | -- | — | — | — | — | — | — | |
| | 4/24/01 | 6.90 | 173.34 | -- | 56,000 | 360 | 980 | 1,000 | 4,700 | <5.0 | a,b |
| | 8/6/01 | 8.15 | 172.09 | -- | 54,000 | 680 | 1,900 | 1,500 | 7,800 | <200 (<10) | a,h,j |
| MW-3 | 1/4/93 | -- | -- | -- | 1,610 | 772 | 14 | 11 | ND | -- | |
| 179.94 | 4/22/93 | -- | -- | -- | 3,040 | 980 | 34 | 19 | 16 | | |
| | 12/27/94 | -- | -- | -- | 2,600 | 180 | 9.0 | 7.2 | 13 | | |
| | 6/27/96 | 13.20 | 166.74 | -- | 2,000 | 22 | 2.9 | 11 | 7.4 | 56 | |
| | 12/10/96 | 13.13 | 166.81 | -- | 970 | <0.5 | <0.5 | <0.5 | <0.5 | 24 | |
| | 5/8/98 | 13.03 | 166.91 | -- | 780 | 3.7 | 2.1 | 1.1 | 2.4 | <32 | a |
| | 8/17/98 | 13.22 | 166.72 | -- | 870 | 2.8 | <0.5 | <0.5 | 3.7 | <5.0 | b,c |
| | 11/4/98 | 13.31 | 166.63 | -- | 770 | 1.6 | 4.4 | 2.0 | 6.9 | <30 | c |
| | 2/17/99 | 12.89 | 167.05 | -- | 650 | 6.2 | 3.4 | 1.5 | 2.6 | <5.0 | b,c |
| | 5/27/99 | 12.32 | 167.62 | -- | 570 | 1.5 | 1.2 | 0.72 | 1.1 | <20 | a |
| | 8/19/99 | 13.19 | 166.75 | -- | 830 | <0.5 | 1.9 | <0.5 | 1.3 | <20 | c,d |
| 179.55 | 11/23/99 | 13.26 | 166.29 | -- | 900 | <0.5 | 1.8 | 0.56 | 1.4 | <20 | c,d |
| | 2/17/00 | 12.78 | 166.77 | -- | 250 | <0.5 | 1.5 | <0.5 | 0.62 | <5.0 | d |
| | 5/9/00 | 12.92 | 166.63 | -- | 690 | <0.5 | 2.1 | 0.85 | 1.6 | <5.0 | a |
| | 8/15/00 | 13.19 | 166.36 | -- | 610 | <0.5 | 2.3 | 0.75 | 1.2 | <5.0 | c,d |
| | 12/1/00 | 7.50 | 172.05 | -- | 120 | <0.5 | 0.90 | 0.65 | 0.62 | <5.0 | c,d |
| | 2/8/01 | 7.20 | 172.35 | -- | 87 | <0.5 | <0.5 | <0.5 | <0.5 | <5.0 | c,d |
| | 4/9/01 | 7.33 | 172.22 | -- | <50 | <0.5 | <0.5 | <0.5 | <0.5 | <5.0 | |
| | 8/6/01 | 7.61 | 171.94 | -- | <50 | <0.5 | <0.5 | <0.5 | <0.5 | <5.0 | |

CAMBRIA

Table 1. Groundwater Elevation and Analytical Data - Hooshi's Auto Service, 1499 MacArthur Boulevard, Oakland, California

| Well ID <i>TOC (ft*)</i> | Date | Depth to Groundwater (ft) | Groundwater Elevation (ft**) | Separate Phase Hydrocarbons (ft) | TPHg ← | Benzene | Toluene | Ethylbenzene → | | | Xylenes | MTBE | Notes |
|-----------------------------|----------|---------------------------------|------------------------------------|--|-----------|---------|---------|----------------|-------|------|---------|------|-------|
| | | | | | | | | (µg/L) | | | | | |
| MW-4 | 6/27/96 | 17.03 | 163.51 | -- | 720 | 2 | 0.5 | 2.5 | 23 | 3.2 | | | |
| 180.54 | 12/10/96 | 8.50 | 172.04 | -- | 80 | 2.4 | <0.5 | <0.5 | 6.6 | <2.0 | | | |
| | 5/8/98 | 11.46 | 169.08 | -- | <50 | 0.60 | <0.5 | <0.5 | <0.5 | <5.0 | | | |
| | 8/17/98 | 13.98 | 166.56 | -- | <50 | <0.5 | <0.5 | <0.5 | 0.5 | <5.0 | | | |
| | 11/4/98 | 14.36 | 166.18 | -- | 96 | 9.7 | 8.1 | 4.8 | 18 | <5.0 | | a | |
| | 2/17/99 | 8.39 | 172.15 | -- | <50 | <0.5 | <0.5 | <0.5 | 0.5 | <5.0 | | | |
| | 5/27/99 | 12.80 | 167.74 | -- | <50 | <0.5 | 1.0 | <0.5 | 2.9 | <5.0 | | | |
| 180.12 | 8/19/99 | 14.42 | 166.12 | -- | <50 | <0.5 | <0.5 | <0.5 | <0.5 | <5.0 | | | |
| | 11/23/99 | 14.63 | 165.49 | -- | <50 | <0.5 | <0.5 | <0.5 | <0.5 | <5.0 | | | |
| | 2/17/00 | 8.15 | 171.97 | -- | <50 | <0.5 | <0.5 | <0.5 | <0.5 | <5.0 | | | |
| | 5/9/00 | 12.81 | 167.31 | -- | <50 | <0.5 | <0.5 | <0.5 | <0.5 | <5.0 | | | |
| | 8/15/00 | 14.29 | 165.83 | -- | <50 | 2.1 | <0.5 | <0.5 | <0.5 | <5.0 | | | |
| | 12/1/00 | 12.80 | 167.32 | -- | 81 | 6.0 | 8.4 | 1.0 | 5.6 | <5.0 | | a | |
| | 2/8/01 | 12.57 | 167.55 | -- | <50 | <0.5 | <0.5 | <0.5 | <0.5 | <5.0 | | | |
| | 4/9/01 | 12.50 | 167.62 | -- | <50 | <0.5 | <0.5 | <0.5 | <0.5 | <5.0 | | | |
| | 8/6/01 | 14.00 | 166.12 | -- | 59 | 1.5 | <0.5 | <0.5 | <0.5 | <5.0 | | a | |
| MW-5 | 6/27/96 | 13.62 | 166.74 | 0.16 | -- | -- | -- | -- | -- | -- | | | |
| 180.23 | 12/10/96 | 13.26 | 167.77 | 1.00 | -- | -- | -- | -- | -- | -- | | | |
| | 5/8/98 | 13.15 | 167.11 | 0.04 | -- | -- | -- | -- | -- | -- | | | |
| | 8/17/98 | 13.36 | 166.89 | 0.02 | -- | -- | -- | -- | -- | -- | | | |
| | 11/4/98 | 13.52 | 166.73 | 0.02 | -- | -- | -- | -- | -- | -- | | | |
| | 2/17/99 | 13.02 | 167.23 | 0.02 | -- | -- | -- | -- | -- | -- | | | |
| | 5/27/99 | 13.80 | 166.71 | 0.35 | -- | -- | -- | -- | -- | -- | | | |
| 180.09 | 8/19/99 | 13.45 | 166.86 | 0.10 | -- | -- | -- | -- | -- | -- | | | |
| | 11/23/99 | 14.03 | 166.35 | 0.36 | -- | -- | -- | -- | -- | -- | | | |
| | 2/17/00 | 13.28 | 167.02 | 0.26 | -- | -- | -- | -- | -- | -- | | | |
| | 5/9/00 | 13.55 | 166.77 | 0.29 | -- | -- | -- | -- | -- | -- | | | |
| 180.04 | 8/15/00 | 13.58 | 166.54 | 0.04 | -- | -- | -- | -- | -- | -- | | | |
| | 12/1/00 | 8.00 | 172.09 | 0.00 | 54,000 | 240 | 1,700 | 870 | 1,000 | <300 | | c,d | |
| | 2/8/01 | 7.88 | 172.16 | 0.00 | 33,000 | 63 | 420 | 120 | 4,500 | <50 | | a,b | |
| | 4/9/01 | 7.97 | 172.07 | 0.00 | -- | -- | -- | -- | -- | -- | | | |
| | 4/24/01 | 7.00 | 173.04 | 0.00 | 3,200 | <1.0 | 11 | 7 | 260 | <5.0 | | c,d | |
| | 8/6/01 | 8.17 | 171.87 | -- | 2,700 | 11 | 40 | 21 | 240 | <5.0 | | a | |

CAMBRIA

Table 1. Groundwater Elevation and Analytical Data - Hooshi's Auto Service, 1499 MacArthur Boulevard, Oakland, California

| Well ID <i>TOC (ft*)</i> | Date | Depth to Groundwater (ft) | Groundwater Elevation (ft)** | Separate Phase Hydrocarbons (ft) | ←----- (µg/L) -----→ | | | | | | Notes |
|-----------------------------|------------|---------------------------------|------------------------------------|--|----------------------|---------|---------|--------------|---------|------|-------|
| | | | | | TPHg | Benzene | Toluene | Ethylbenzene | Xylenes | MTBE | |
| MW-6 | 6/27/96 | 18.55 | 161.48 | -- | ND | ND | ND | ND | ND | -- | |
| 180.03 | 12/10/99 | 11.79 | 168.24 | -- | <0.5 | <0.5 | <0.5 | <0.5 | <0.5 | <2.0 | |
| | 5/8/98 | 11.62 | 168.41 | -- | <50 | <0.5 | <0.5 | <0.5 | <0.5 | <5.0 | |
| | 8/17/98 | 12.66 | 167.37 | -- | <50 | <0.5 | <0.5 | <0.5 | <0.5 | <5.0 | |
| | 11/4/98 | 13.56 | 166.47 | -- | 68 | 3.8 | 3.7 | 2.8 | 11 | <5.0 | a |
| | 2/17/99 | 12.91 | 167.12 | -- | <50 | <0.5 | <0.5 | <0.5 | <0.5 | <5.0 | |
| | 5/27/99 | 13.03 | 167.00 | -- | <50 | 1.0 | 1.7 | 0.82 | 4.9 | <5.0 | |
| 179.63 | 8/19/99 | 13.10 | 166.93 | -- | <50 | <0.5 | <0.5 | <0.5 | <0.5 | <5.0 | |
| | 11/23/99 | 13.58 | 166.05 | -- | <50 | <0.5 | <0.5 | <0.5 | <0.5 | <5.0 | |
| | 2/17/00 | 10.72 | 168.91 | -- | <50 | <0.5 | <0.5 | <0.5 | <0.5 | <5.0 | |
| | 5/9/00 | 11.71 | 167.92 | -- | <50 | <0.5 | <0.5 | <0.5 | <0.5 | <5.0 | |
| | 8/15/00 | 12.49 | 167.14 | -- | <50 | <0.5 | <0.5 | <0.5 | <0.5 | <5.0 | |
| | 12/1/00 | 8.64 | 170.99 | -- | <50 | <0.5 | <0.5 | <0.5 | <0.5 | <5.0 | |
| | 2/8/01 | 8.20 | 171.43 | -- | <50 | <0.5 | <0.5 | <0.5 | <0.5 | <5.0 | |
| | 4/9/01 | 8.53 | 171.10 | -- | <50 | <0.5 | <0.5 | <0.5 | <0.5 | <5.0 | |
| | 8/6/01 | 8.69 | 170.94 | -- | <50 | <0.5 | <0.5 | <0.5 | <0.5 | <5.0 | |
| | Trip Blank | 5/8/98 | -- | -- | -- | <50 | <0.5 | <0.5 | <0.5 | <0.5 | <5.0 |
| 11/4/98 | | -- | -- | -- | <50 | <0.5 | <0.5 | <0.5 | <0.5 | <5.0 | |
| 5/27/99 | | -- | -- | -- | <50 | <0.5 | <0.5 | <0.5 | <0.5 | <5.0 | |
| 11/23/99 | | -- | -- | -- | <50 | <0.5 | <0.5 | <0.5 | <0.5 | <5.0 | |
| 12/1/00 | | -- | -- | -- | <50 | <0.5 | <0.5 | <0.5 | <0.5 | <5.0 | |

CAMBRIA

Table 1. Groundwater Elevation and Analytical Data - Hooshi's Auto Service, 1499 MacArthur Boulevard, Oakland, California

| Well ID | Date | Depth to Groundwater | Groundwater Elevation | Separate Phase Hydrocarbons | TPHg | Benzene | Toluene | Ethylbenzene | Xylenes | MTBE | Notes |
|-----------|------|----------------------|-----------------------|-----------------------------|------------|---------|---------|--------------|---------|------|-------|
| TOC (ft*) | | (ft) | (ft**) | (ft) | ← (µg/L) → | | | | | | |

Abbreviations and Methods:

TPHg = Total petroleum hydrocarbons as gasoline by modified EPA Method 8015
 Benzene, toluene, ethylbenzene, and xylenes by EPA Method 8020
 MTBE = Methyl tertiary butyl ether by EPA Method 8020
 (concentration in parentheses confirmed by EPA Method 8260)
 µg/L = Micrograms per liter
 TOC = Top of casing elevation
 * = wells surveyed to an arbitrary datum
 ** = Calculated groundwater elevation corrected for SPH by the relation:
 $\text{Groundwater Elevation} = \text{Well Elevation} - \text{Depth to Water} + (0.8 \times \text{SPH thickness (ft)})$
 *** = Due to the air sparge system running during sampling, samples collected on 4/9/01 were anomalous. Well was resampled on 4/24/01 with the air sparge system off.
 -- = not sampled.

Abbreviations and Methods (Cont'd):

MCLs = California primary maximum contaminant levels for drinking water (22 CCR 64444)
 NE = MCLs not established
 ND = Compound not detected, detection limit unknown

Notes:

- a - The analytical laboratory noted that unmodified or weakly modified gasoline is significant.
- b - The analytical laboratory noted that lighter than water immiscible sheen is present.
- c - The analytical laboratory noted no recognizable pattern.
- d - The analytical laboratory noted heavier gasoline range compounds are significant (aged gasoline?).
- h - The analytical laboratory noted lighter than water immiscible sheen is present
- j - The analytical laboratory noted sample diluted due to high organic content.

APPENDIX A

Groundwater Monitoring Field Data Sheets

WELL DEPTH MEASUREMENTS

| Well ID | Time | Product Depth | Water Depth | Product Thickness | Well Depth | Comments |
|---------|-------|---------------|-------------|-------------------|------------|----------|
| MW-1 | 10:20 | | 8.83 | | 19.90 | |
| MW-2 | 10:25 | | 8.15 | | 19.80 | |
| MW-3 | 10:10 | | 7.61 | | 19.78 | |
| MW-4 | 10:15 | | 14.00 | | 19.72 | |
| MW-5 | 10:30 | | 8.17 | | 14.50 | |
| MW-6 | 10:00 | | 8.69 | | 20.00 | |
| | | | | | | |
| | | | | | | |
| | | | | | | |
| | | | | | | |
| | | | | | | |
| | | | | | | |
| | | | | | | |
| | | | | | | |
| | | | | | | |
| | | | | | | |
| | | | | | | |
| | | | | | | |
| | | | | | | |
| | | | | | | |
| | | | | | | |

Project Name: Hooski's

Project Number: 129-0741

Measured By: R. Hill

Date: 8-6-01

WELL SAMPLING FORM

| | | |
|--|--|-----------------------------------|
| Project Name: Hooshi's | Cambria Mgr: RS | Well ID: MW-1 |
| Project Number: 129-0741 | Date: 8-6-01 | Well Yield: |
| Site Address: 1499 MacArthur Boulevard Oakland, California | Sampling Method: Disposable bailer | Well Diameter: 2 " pvc |
| | | Technician(s): SG |
| Initial Depth to Water: 3.83 | Total Well Depth: 19.90 | Water Column Height: 11.07 |
| Volume/ft: 0.16 | 1 Casing Volume: 1.77 | 3 Casing Volumes: 5.31 |
| Purging Device: disposable bailer | Did Well Dewater?: no | Total Gallons Purged: 5 |
| Start Purge Time: 12:10 | Stop Purge Time: 12:16 | Total Time: 6mins |

1 Casing Volume = Water column height x Volume/ ft.

| Well Diam. | Volume/ft (gallons) |
|------------|---------------------|
| 2" | 0.16 |
| 4" | 0.65 |
| 6" | 1.47 |

| Time | Casing Volume | Temp. | pH | Cond. | Comments |
|--------------|---------------|-------------|-------------|------------|----------|
| 12:12 | 1.5 | 17.4 | 7.35 | 720 | |
| 12:14 | 3 | 18.9 | 7.30 | 729 | |
| 12:17 | 5 | 19.1 | 7.39 | 747 | |
| | | | | | |
| | | | | | |
| | | | | | |
| | | | | | |
| | | | | | |

| Sample ID | Date | Time | Container Type | Preservative | Analytes | Analytic Method |
|-------------|---------------|--------------|----------------|--------------|-----------------------------|----------------------|
| MW-1 | 8-6-01 | 12:22 | 4 voa's | HCL | TPHg, BTEX, MTBE | 8020 8015 |
| | | | | | | |
| | | | | | | |

WELL SAMPLING FORM

| | | |
|--|--|-----------------------------------|
| Project Name: Hooshi's | Cambria Mgr: RS | Well ID: MW-2 |
| Project Number: 129-0741 | Date: 8-6-01 | Well Yield: |
| Site Address: 1499 MacArthur Boulevard Oakland, California | Sampling Method: Disposable bailer | Well Diameter: 2 " pvc |
| | | Technician(s): SG |
| Initial Depth to Water: 8.15 | Total Well Depth: 19.80 | Water Column Height: 11.65 |
| Volume/ft: 0.16 | 1 Casing Volume: 1.86 | 3 Casing Volumes: 5.59 |
| Purging Device: disposable bailer | Did Well Dewater?: no | Total Gallons Purged: 5.5 |
| Start Purge Time: 12:55 | Stop Purge Time: 13:01 | Total Time: 6mins |

1 Casing Volume = Water column height x Volume/ ft.

| Well Diam. | Volume/ft (gallons) |
|------------|---------------------|
| 2" | 0.16 |
| 4" | 0.65 |
| 6" | 1.47 |

| Time | Casing Volume | Temp. | pH | Cond. | Comments |
|--------------|---------------|-------------|-------------|-------------|--------------|
| 12:57 | 1.5 | 18.4 | 7.63 | 1270 | Sheen |
| 13:00 | 3.5 | 18.9 | 7.52 | 913 | |
| 13:02 | 5.5 | 18.7 | 7.50 | 954 | |
| | | | | | |
| | | | | | |
| | | | | | |
| | | | | | |
| | | | | | |

| Sample ID | Date | Time | Container Type | Preservative | Analytes | Analytic Method |
|-------------|---------------|--------------|----------------|--------------|-----------------------------|----------------------|
| MW-2 | 8-6-01 | 13:07 | 4 voa's | HCL | TPHg, BTEX, MTBE | 8020 8015 |
| | | | | | | |
| | | | | | | |

WELL SAMPLING FORM

| | | |
|--|--|-----------------------------------|
| Project Name: Hooshi's | Cambria Mgr: RS | Well ID: MW-3 |
| Project Number: 129-0741 | Date: 8-6-01 | Well Yield: |
| Site Address: 1499 MacArthur Boulevard Oakland, California | Sampling Method: Disposable bailer | Well Diameter: 2 " pvc |
| | | Technician(s): SC |
| Initial Depth to Water: 7.61 | Total Well Depth: 19.78 | Water Column Height: 12.71 |
| Volume/ft: 0.16 | 1 Casing Volume: 1.94 | 3 Casing Volumes: 5.84 |
| Purging Device: disposable bailer | Did Well Dewater?: no | Total Gallons Purged: 6 |
| Start Purge Time: 11:30 | Stop Purge Time: 11:29 | Total Time: 9mins |

1 Casing Volume = Water column height x Volume/ ft.

| Well Diam. | Volume/ft (gallons) |
|------------|---------------------|
| 2" | 0.16 |
| 4" | 0.65 |
| 6" | 1.47 |

| Time | Casing Volume | Temp. | pH | Cond. | Comments |
|--------------|---------------|-------------|-------------|------------|----------|
| 11:22 | 2 | 18.2 | 7.55 | 821 | |
| 11:25 | 4 | 18.1 | 7.51 | 892 | |
| 11:30 | 6 | 18.5 | 7.59 | 890 | |
| | | | | | |
| | | | | | |
| | | | | | |
| | | | | | |
| | | | | | |

| Sample ID | Date | Time | Container Type | Preservative | Analytes | Analytic Method |
|-------------|---------------|--------------|----------------|--------------|-----------------------------|----------------------|
| MW-3 | 8-6-01 | 11:35 | 4 voa's | HCL | TPHg, BTEX, MTBE | 8020 8015 |
| | | | | | | |
| | | | | | | |

WELL SAMPLING FORM

| | | |
|--|--|----------------------------------|
| Project Name: Hooshi's | Cambria Mgr: RS | Well ID: MW-4 |
| Project Number: 129-0741 | Date: 8-6-01 | Well Yield: |
| Site Address: 1499 MacArthur Boulevard Oakland, California | Sampling Method: Disposable bailer | Well Diameter: 2 " pvc |
| | | Technician(s): SG |
| Initial Depth to Water: 14.00 | Total Well Depth: 14.72 | Water Column Height: 5.72 |
| Volume/ft: 0.16 | 1 Casing Volume: 0.91 | 3 Casing Volumes: 273 |
| Purging Device: disposable bailer | Did Well Dewater?: no | Total Gallons Purged: 3 |
| Start Purge Time: 11:45 | Stop Purge Time: 11:49 | Total Time: 4 mins |

1 Casing Volume = Water column height x Volume/ ft.

| Well Diam. | Volume/ft (gallons) |
|------------|---------------------|
| 2" | 0.16 |
| 4" | 0.65 |
| 6" | 1.47 |

| Time | Casing Volume | Temp. | pH | Cond. | Comments |
|--------------|---------------|-------------|-------------|------------|----------|
| 11:47 | 1 | 18.7 | 7.27 | 754 | |
| 11:48 | 2 | 18.5 | 7.09 | 890 | |
| 11:50 | 3 | 18.1 | 7.15 | 871 | |
| | | | | | |
| | | | | | |
| | | | | | |
| | | | | | |
| | | | | | |

| Sample ID | Date | Time | Container Type | Preservative | Analytes | Analytic Method |
|-------------|---------------|--------------|----------------|--------------|-----------------------------|----------------------|
| MW-4 | 8-6-01 | 11:55 | 4 voa's | HCL | TPHg, BTEX, MTBE | 8020 8015 |
| | | | | | | |
| | | | | | | |

WELL SAMPLING FORM

| | | |
|--|--|----------------------------------|
| Project Name: Hooshi's | Cambria Mgr: RS | Well ID: MW-5 |
| Project Number: 129-0741 | Date: 8-6-01 | Well Yield: |
| Site Address: 1499 MacArthur Boulevard Oakland, California | Sampling Method: Disposable bailer | Well Diameter: 2 " pvc |
| | | Technician(s): SG |
| Initial Depth to Water: 8.17 | Total Well Depth: 14.50 | Water Column Height: 6.33 |
| Volume/ft: 0.16 | 1 Casing Volume: 1.01 | 3 Casing Volumes: 3.03 |
| Purging Device: disposable bailer | Did Well Dewater?: NO | Total Gallons Purged: 3 |
| Start Purge Time: 12:35 | Stop Purge Time: 12:39 | Total Time: 4 mins |

1 Casing Volume = Water column height x Volume/ ft.

| Well Diam. | Volume/ft (gallons) |
|------------|---------------------|
| 2" | 0.16 |
| 4" | 0.65 |
| 6" | 1.47 |

| Time | Casing Volume | Temp. | pH | Cond. | Comments |
|--------------|---------------|-------------|-------------|------------|-------------|
| 12:37 | 1 | 18.4 | 7.35 | 790 | odes |
| 12:38 | 2 | 18.9 | 7.32 | 859 | |
| 12:40 | 3 | 18.9 | 7.24 | 870 | |
| | | | | | |
| | | | | | |
| | | | | | |
| | | | | | |
| | | | | | |

| Sample ID | Date | Time | Container Type | Preservative | Analytes | Analytic Method |
|-------------|---------------|--------------|----------------|--------------|-----------------------------|----------------------|
| MW-5 | 8-6-01 | 12:45 | 4 voa's | HCL | TPHg, BTEX, MTBE | 8020 8015 |
| | | | | | | |
| | | | | | | |

WELL SAMPLING FORM

| | | |
|--|--|-----------------------------------|
| Project Name: Hooshi's | Cambria Mgr: RS | Well ID: MW-6 |
| Project Number: 129-0741 | Date: 8-6-01 | Well Yield: |
| Site Address: 1499 MacArthur Boulevard Oakland, California | Sampling Method: Disposable bailer | Well Diameter: 2 " pvc |
| | | Technician(s): SG |
| Initial Depth to Water: 8.69 | Total Well Depth: 20.00 | Water Column Height: 11.31 |
| Volume/ft: 0.16 | 1 Casing Volume: 1.80 | 3 Casing Volumes: 5.42 |
| Purging Device: disposable bailer | Did Well Dewater?: no | Total Gallons Purged: 5 |
| Start Purge Time: 10:55 | Stop Purge Time: 11:04 | Total Time: 9 mins |

1 Casing Volume = Water column height x Volume/ ft.

| Well Diam. | Volume/ft (gallons) |
|------------|---------------------|
| 2" | 0.16 |
| 4" | 0.65 |
| 6" | 1.47 |

| Time | Casing Volume | Temp. | pH | Cond. | Comments |
|--------------|---------------|-------------|-------------|-------------|----------|
| 10:57 | 1.5 | 18.7 | 7.58 | 1170 | |
| 11:00 | 3 | 18.7 | 7.30 | 920 | |
| 11:05 | 5 | 18.7 | 7.42 | 959 | |
| | | | | | |
| | | | | | |
| | | | | | |
| | | | | | |
| | | | | | |

| Sample ID | Date | Time | Container Type | Preservative | Analytes | Analytic Method |
|-------------|---------------|--------------|----------------|--------------|-----------------------------|----------------------|
| MW-6 | 8-6-01 | 11:10 | 4 voa's | HCL | TPHg, BTEX, MTBE | 8020 8015 |
| | | | | | | |
| | | | | | | |

APPENDIX B

Analytical Results for Groundwater Sampling



McCAMPBELL ANALYTICAL INC.

110 2nd Avenue South, #D7, Pacheco, CA 94553-5560
Telephone : 925-798-1620 Fax : 925-798-1622
<http://www.mccampbell.com> E-mail: main@mccampbell.com

| | | |
|--|---|--------------------------|
| Cambria Environmental Technology 6262 Hollis Street Emeryville, CA 94608 | Client Project ID: #129-0741; Hooshi's | Date Sampled: 08/06/01 |
| | | Date Received: 08/09/01 |
| | Client Contact: Ron Scheele | Date Extracted: 08/09/01 |
| | Client P.O: | Date Analyzed: 08/09/01 |

08/16/01

Dear Ron:

Enclosed are:

- 1). the results of 6 samples from your #129-0741; Hooshi's project,
- 2). a QC report for the above samples
- 3). a copy of the chain of custody, and
- 4). a bill for analytical services.

All analyses were completed satisfactorily and all QC samples were found to be within our control limits. If you have any questions please contact me. McCampbell Analytical Laboratories strives for excellence in quality, service and cost. Thank you for your business and I look forward to working with you again.

Yours truly,

Edward Hamilton, Lab Director



McCAMPBELL ANALYTICAL INC.

110 2nd Avenue South, #D7, Pacheco, CA 94553-5560
Telephone : 925-798-1620 Fax : 925-798-1622
<http://www.mccampbell.com> E-mail: main@mccampbell.com

| | | |
|--|---|--------------------------------|
| Cambria Environmental Technology 6262 Hollis Street Emeryville, CA 94608 | Client Project ID: #129-0741; Hooshi's | Date Sampled: 08/06/01 |
| | Client Contact: Ron Scheele | Date Received: 08/09/01 |
| | Client P.O: | Date Extracted: 08/09-08/13/01 |
| | | Date Analyzed: 08/09-08/13/01 |

Gasoline Range (C6-C12) Volatile Hydrocarbons as Gasoline*, with Methyl tert-Butyl Ether* & BTEX*

EPA methods 5030, modified 8015, and 8020 or 602; California RWQCB (SF Bay Region) method GCFID(5030)

| Lab ID | Client ID | Matrix | TPH(g)* | MTBE | Benzene | Toluene | Ethyl- benzene | Xylenes | % Recovery Surrogate |
|---|-----------|--------|------------|--------|---------|---------|-------------------|---------|-------------------------|
| 74476 | MW-1 | W | 140,a | 5.8 | 1.7 | 0.55 | ND | 0.63 | 109 |
| 74477 | MW-2 | W | 54,000,a,h | ND<200 | 680 | 1900 | 1500 | 7800 | 100 |
| 74478 | MW-3 | W | ND | ND | ND | ND | ND | ND | 102 |
| 74479 | MW-4 | W | 59,a | ND | 1.5 | ND | ND | ND | 95 |
| 74480 | MW-5 | W | 2700,a | ND | 11 | 40 | 21 | 240 | 100 |
| 74481 | MW-6 | W | ND | ND | ND | ND | ND | ND | 96 |
| | | | | | | | | | |
| | | | | | | | | | |
| | | | | | | | | | |
| | | | | | | | | | |
| | | | | | | | | | |
| | | | | | | | | | |
| | | | | | | | | | |
| | | | | | | | | | |
| | | | | | | | | | |
| | | | | | | | | | |
| | | | | | | | | | |
| | | | | | | | | | |
| | | | | | | | | | |
| | | | | | | | | | |
| | | | | | | | | | |
| Reporting Limit unless otherwise stated; ND means not detected above the reporting limit | W | | 50 ug/L | 5.0 | 0.5 | 0.5 | 0.5 | 0.5 | |
| | S | | 1.0 mg/kg | 0.05 | 0.005 | 0.005 | 0.005 | 0.005 | |

* water and vapor samples are reported in ug/L, wipe samples in ug/wipe, soil and sludge samples in mg/kg, and all TCLP and SPLP extracts in ug/L

cluttered chromatogram; sample peak coelutes with surrogate peak

*The following descriptions of the TPH chromatogram are cursory in nature and McCampbell Analytical is not responsible for their interpretation: a) unmodified or weakly modified gasoline is significant; b) heavier gasoline range compounds are significant(aged gasoline?); c) lighter gasoline range compounds (the most mobile fraction) are significant; d) gasoline range compounds having broad chromatographic peaks are significant; biologically altered gasoline?; e) TPH pattern that does not appear to be derived from gasoline (?); f) one to a few isolated peaks present; g) strongly aged gasoline or diesel range compounds are significant; h) lighter than water immiscible sheen is present; i) liquid sample that contains greater than ~5 vol. % sediment; j) no recognizable pattern.



McCAMPBELL ANALYTICAL INC.

110 2nd Avenue South, #D7, Pacheco, CA 94553-5560
 Telephone : 925-798-1620 Fax : 925-798-1622
<http://www.mccampbell.com> E-mail: main@mccampbell.com

| | | |
|--|---|--------------------------|
| Cambria Environmental Technology 6262 Hollis Street Emeryville, CA 94608 | Client Project ID: #129-0741; Hooshi's | Date Sampled: 08/06/01 |
| | Client Contact: Ron Scheele | Date Received: 08/09/01 |
| | Client P.O: | Date Extracted: 08/13/01 |
| | | Date Analyzed: 08/13/01 |

Methyl tert-Butyl Ether *

EPA method 8260 modified

| Lab ID | Client ID | Matrix | MTBE* | % Recovery Surrogate |
|--|-----------|--------|-----------|----------------------|
| 74476 | MW-1 | W | 4.0 | 106 |
| 74477 | MW-2 | W | ND<10,j,h | 106 |
| | | | | |
| | | | | |
| | | | | |
| | | | | |
| | | | | |
| | | | | |
| | | | | |
| | | | | |
| | | | | |
| | | | | |
| | | | | |
| | | | | |
| | | | | |
| Reporting Limit unless otherwise stated; ND means not detected above the reporting limit | W | | 1.0 ug/L | |
| | S | | 5.0 ug/kg | |

* water samples are reported in ug/L, soil and sludge samples in ug/kg, wipe samples in ug/wipe and all TCLP / STLC / SPLP extracts in ug/L

h) lighter than water immiscible sheen is present; i) liquid sample that contains greater than ~5 vol. % sediment; j) sample diluted due to high organic content.



McCAMPBELL ANALYTICAL INC.

110 2nd Ave. South, #D7, Pacheco, CA 94553-5560
 Telephone : 925-798-1620 Fax : 925-798-1622
<http://www.mccampbell.com> E-mail: main@mccampbell.com

QC REPORT

EPA 8015m + 8020

Date: 08/09/01

Extraction: TTLC

Matrix: Water

| Compound | Concentration: ug/L | | | %Recovery | | RPD |
|----------|---------------------|----|-----|-----------|-----|-----|
| | Sample | MS | MSD | MS | MSD | |

SampleID: 80301

Instrument: GC-3

| | | | | | | | |
|--------------|----|------|------|--------|----|----|-----|
| Surrogate1 | ND | 96.0 | 98.0 | 100.00 | 96 | 98 | 2.1 |
| Xylenes | ND | 26.3 | 26.0 | 30.00 | 88 | 87 | 1.1 |
| Ethylbenzene | ND | 8.6 | 8.6 | 10.00 | 86 | 86 | 0.0 |
| Toluene | ND | 9.0 | 8.9 | 10.00 | 90 | 89 | 1.1 |
| Benzene | ND | 9.6 | 9.3 | 10.00 | 96 | 93 | 3.2 |
| MTBE | ND | 9.7 | 9.7 | 10.00 | 97 | 97 | 0.0 |
| TPH (gas) | ND | 82.2 | 82.6 | 100.00 | 82 | 83 | 0.5 |

$$\% \text{ Recovery} = \frac{(MS - \text{Sample})}{\text{Amount Spiked}} \cdot 100$$

$$RPD = \frac{(MS - MSD)}{(MS + MSD)} \cdot 2 \cdot 100$$

RPD means Relative Percent Deviation



McCAMPBELL ANALYTICAL INC.

110 2nd Ave. South, #D7, Pacheco, CA 94553-5560
 Telephone : 925-798-1620 Fax : 925-798-1622
<http://www.mccampbell.com> E-mail: main@mccampbell.com

QC REPORT

VOCs (EPA 8240/8260)

Date: 08/13/01-08/14/01

Extraction: N/A

Matrix: Water

| Compound | Concentration: ug/L | | | %Recovery | | RPD | |
|-------------------------|---------------------|-------|-------|-------------------------|-----|-----|-----|
| | Sample | MS | MSD | Amount Spiked | MS | | MSD |
| <u>SampleID:</u> 81001 | | | | <u>Instrument:</u> GC-4 | | | |
| Surrogate | ND | 101.0 | 105.0 | 100.00 | 101 | 105 | 3.9 |
| Methyl tert-Butyl Ether | ND | 9.2 | 8.7 | 10.00 | 92 | 87 | 5.6 |

$$\% \text{ Recovery} = \frac{(MS - \text{Sample})}{\text{Amount Spiked}} \cdot 100$$

$$RPD = \frac{(MS - MSD)}{(MS + MSD)} \cdot 2 \cdot 100$$

RPD means Relative Percent Deviation

2720 ZC 447

McCAMPBELL ANALYTICAL INC.

110 2nd AVENUE SOUTH, #D7
PACHECO, CA 94553

Telephone: (925) 798-1620

Fax: (925) 798-1622

CHAIN OF CUSTODY RECORD

TURN AROUND TIME
RUSH 24 HOUR 48 HOUR 5 DAY

Report To: Ron Scheele Bill To: Cambria Env. Tech.

Company: Cambria Environmental Technology

6262 Hollis Street
Emeryville, CA 94608

Tele: (510) 450-1983

Fax: (510) 450-8295

Project #: 129-0741

Project Name: Hooshi's

Project Location: 1499 MacArthur Blvd. Oakland, Ca

Sampler Signature: S. Hill

Analysis Request Other Comments

| | | | | | | | | | | | | | | | | | |
|---|----------------------|--|--------------------------------------|----------------|----------------------------|----------------|---------------------------|-----------------------|----------------|--|---------------|---------------|-----------------------------|-----|--|--|--|
| BTEX & TPH as Gas (602/8020 + 8015) MITBE | TPH as Diesel (8015) | Total Petroleum Oil & Grease (5520 E&F/13&F) | Total Petroleum Hydrocarbons (418.1) | EPA 601 / 8010 | BTEX ONLY (EPA 602 / 8020) | EPA 608 / 8080 | EPA 608 / 8080 PCB's ONLY | EPA 624 / 8240 / 8260 | EPA 625 / 8270 | PAH's / PNA's by EPA 625 / 8270 / 8310 | CAM-17 Metals | LUFT 5 Metals | Lead (7240/7421/239.2/6010) | RCI | | | |
| | | | | | | | | | | | | | | | | | |

| SAMPLE ID | LOCATION | SAMPLING | | # Containers | Type Containers | MATRIX | | | | | METHOD PRESERVED | | | | | | | |
|-----------|----------|----------|-------|--------------|-----------------|--------|------|-----|--------|-------|------------------|-----|------------------|-------|--|--|--|--|
| | | Date | Time | | | Water | Soil | Air | Sludge | Other | Ice | HCl | HNO ₃ | Other | | | | |
| MW-1 | | 8-6-01 | 12:22 | 4 | Van | X | | | | | X | X | | | | | | |
| MW-2 | | 8-6-01 | 13:07 | 4 | Van | X | | | | | X | X | | | | | | |
| MW-3 | | 8-6-01 | 10:35 | 4 | Van | X | | | | | X | X | | | | | | |
| MW-4 | | 8-6-01 | 11:55 | 4 | Van | X | | | | | X | X | | | | | | |
| MW-5 | | 8-6-01 | 12:45 | 4 | Van | X | | | | | X | X | | | | | | |
| MW-6 | | 8-6-01 | 11:10 | 4 | Van | X | | | | | X | X | | | | | | |

Confirm all MITBE hits by 8260

74476
74477
74478
74479
74480
74481

Relinquished By: S. Hill

Date: 8-7-01

Time: 7:00

Received By: secure place

Remarks:

ICE
GOOD CONDITION
HEAD SPACE ABSENT

PRESERVATION
APPROPRIATE
CONTAINERS

Relinquished By: [Signature]

Date: 8/29/01

Time: 11:08

Received By: [Signature]

Relinquished By: [Signature]

Date: 8/29/01

Time: 1:00

Received By: Lmw A Butler

VOLATILES METALS OTHER