

HAGEMAN-AGUIAR, INC.

Underground Contamination Investigations, Groundwater Consultants, Environmental Engineering

ALCO
HAZMAT
94 FEB 16 AM 11:47

REPORT OF
QUARTERLY GROUNDWATER SAMPLING

(sampled January 28, 1994)

PACIFIC CRYOGENIC COMPANY
2311 Magnolia Street
Oakland, CA

February 3, 1994

TABLE OF CONTENTS

I. INTRODUCTION	1
II. FIELD WORK	5
Monitoring Well Sampling	5
Wastewater Generation	6
III. RESULTS OF WATER LEVEL MEASUREMENTS	7
Shallow Groundwater Flow Direction	7
Shallow Water Table Hydraulic Gradient	7
Historical Water Level Measurements	7
IV. SHALLOW GROUNDWATER SAMPLING RESULTS	11
Laboratory Analysis	11
Results of Groundwater Sampling	11
Chemical Concentration Contours	16

ATTACHMENT A -- Well Sampling Logs

ATTACHMENT B -- Analytical Results: Groundwater

I. INTRODUCTION

The subject site is the historical location of Pacific Cryogenic Company at 2311 Magnolia Street, Oakland, California. The location of the site is shown on Figure 1 (site location map).

On June 30 and July 12, 1989, Geo-Environmental Technology removed three underground storage tanks from the subject site: one 8,000-gallon underground Diesel tank, one 1,000-gallon underground Gasoline tank, and one 550-gallon underground Waste Oil tank.

Due to the detection of subsurface contamination in the vicinity of the Gasoline and Waste Oil tanks, shallow groundwater monitoring well MW-1 was installed by Geo-Environmental Technology at the previous tank locations (see Figure 2). The results of shallow groundwater sampling on October 26, 1990, indicated the presence of Diesel at a concentration of 5,400 $\mu\text{g/L}$, and Benzene, Toluene, Ethylbenzene, and Total Xylenes at concentrations of 1,200 $\mu\text{g/L}$, 18 $\mu\text{g/L}$, 7.1 $\mu\text{g/L}$, and 37 $\mu\text{g/L}$, respectively.

Subsequent to the installation and sampling of monitoring well MW-1, two additional shallow groundwater monitoring wells were installed on the subject site (wells MW-2 and MW-3). No data regarding these well installations appear to be available at the present time.

On November 12, 1992, the underground piping running between the previous Gasoline and Waste Oil underground tanks and the previous dispenser pedestal were removed by Hageman-Aguilar,

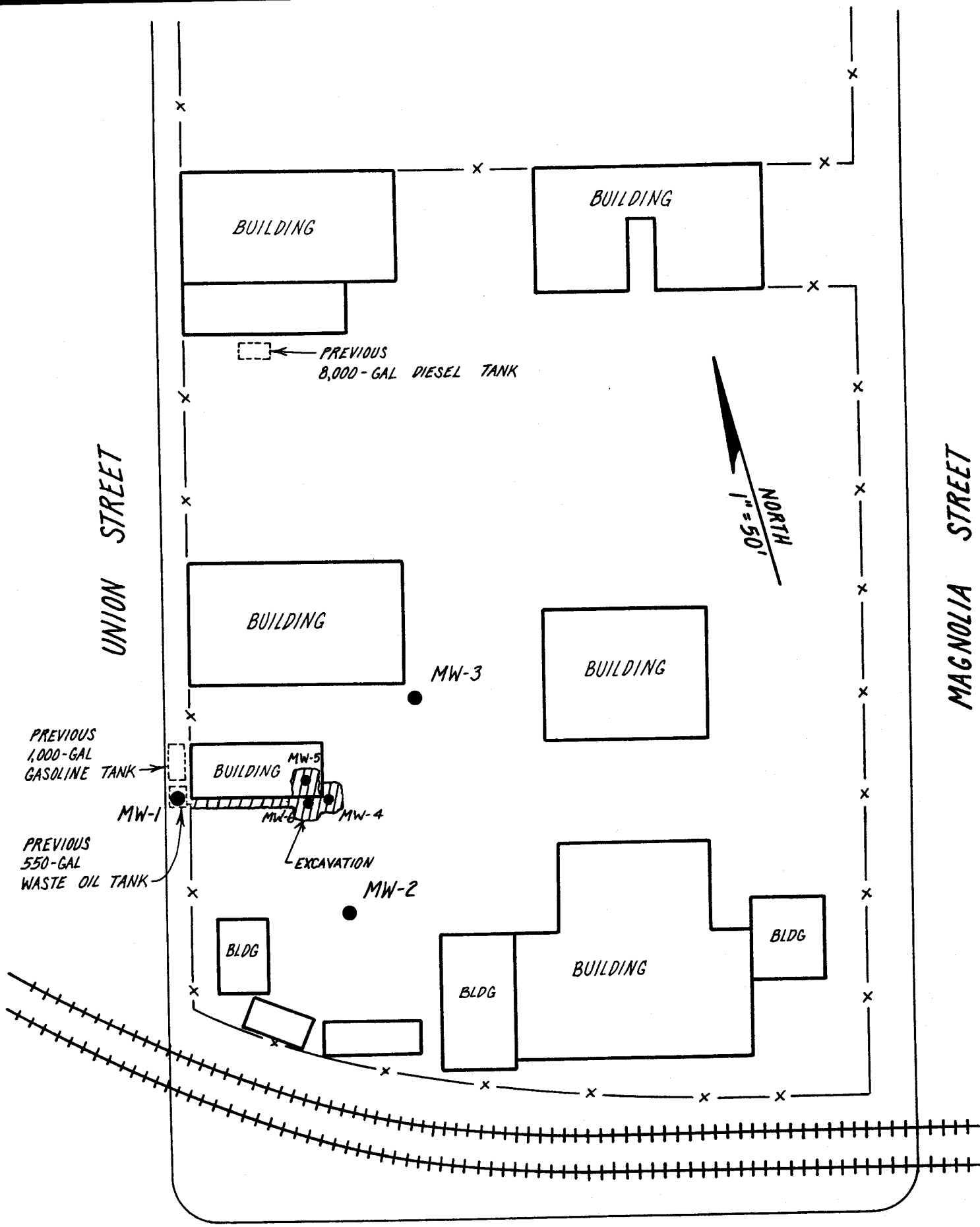

WEST GRAND AVENUE

FIGURE 2.
Site Map.

Inc. (see Figure 2). During the removal process, several holes were noted in both the waste oil and the gasoline underground pipelines. At one location, significant gasoline contamination was apparent in the soil (based upon odor and color).

Subsequent to the piping removal, additional excavation was conducted on November 18, 1992. The excavation extended to a depth of approximately 15 feet below ground surface and was conducted in order to mitigate the apparent subsurface gasoline contamination. Upon completion of the soil excavation on November 18, 1992, three excavation backfill wells were installed. The locations of these monitoring wells MW-4, MW-5 and MW-6 are shown in Figure 2.

On January 28, 1994, all on-site monitoring wells MW-1, MW-2 MW-3 and MW-4 were sampled for the laboratory analysis for dissolved petroleum constituents.

II. FIELD WORK

Monitoring Well Sampling

On January 28, 1994, groundwater samples were collected from monitoring wells MW-1, MW-2, MW-3, and MW-4. Prior to groundwater sampling, each well was purged by bailing approximately 5 to 10 casing volumes of water. Field conductivity, temperature, and pH meters were present on-site during the monitoring well sampling. As the purging process proceeded, the three parameters were monitored. Purging continued until readings appeared to have reasonably stabilized. After the water level in the well had attained 80% or more of the original static water level, a groundwater sample was collected using a clean teflon bailer. The water sample was placed inside appropriate 40 mL VOA vials and 1-liter amber bottles free of any headspace. The samples were immediately placed on crushed ice, then transported under chain-of-custody to the laboratory at the end of the work day.

At the time each monitoring well was sampled, the following information was recorded in the field: 1) depth-to-water prior to purging, using an electrical well sounding tape, 2) identification of any floating product, sheen, or odor prior to purging, using a clear teflon bailer, 3) sample pH, 4) sample temperature, and 5) specific conductance of the sample.

Copies of the well sampling logs are included as Attachment A.

Wastewater Generation

All water removed from the wells during purging and sampling was drummed and stored on-site until the results of laboratory analyses were obtained. Based upon these results, the water should be transported as a hazardous liquid waste under proper manifest to an appropriate TSD facility for treatment and disposal. The disposal of wastewater is the responsibility of the property owner (waste generator), and is beyond the scope of work as described in this report.

III. RESULTS OF WATER LEVEL MEASUREMENTS

Shallow Groundwater Flow Direction.

Shallow water table elevations were measured on February 2, 1994. These measurements are shown in Table 1. Figure 3 presents a contour map for the shallow groundwater table beneath the site. As shown in this figure, the data from the three monitoring wells indicate that the shallow groundwater flow was in the easterly direction during this round of groundwater sampling.

Shallow Water Table Hydraulic Gradient

Figure 3 presents the contour map for the shallow groundwater table beneath the site. As shown in this figure, the shallow groundwater table beneath the site appears to have a calculated hydraulic gradient of $dH/dL = 0.3'/25' = 0.012$.

Historical Water Level Measurements

Table 2 presents the results of all water level measurements collected between April 3, 1992, and the present time.

TABLE 1.

**Shallow Water Table Elevations
February 2, 1994**

Well	Top of Casing Elevation (feet)	Depth to Water (feet)	Water Table Elevation (feet)
MW-1	99.27	4.85	94.42
MW-2	100.00	7.45	92.55
MW-3	100.02	7.81	92.21
MW-4	99.95	7.28	92.67

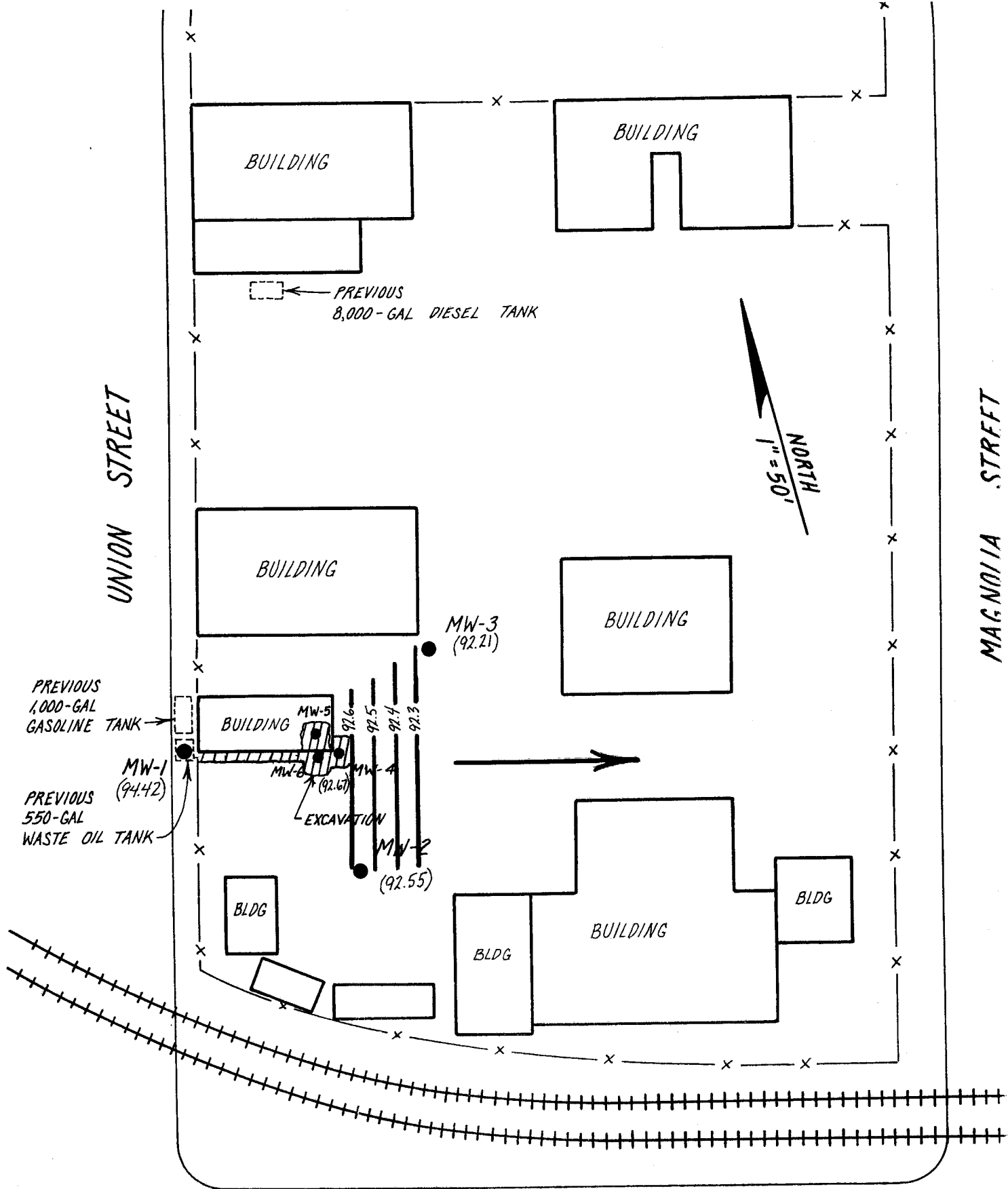

WEST GRAND AVENUE

FIGURE 3. Shallow Groundwater Table Contour Map. (2-2-94)

TABLE 2.

**Historical Water Table Elevations
(feet)**

Well	Date of Measurement								
	4-3-92	6-16-92	10-8-92	1-7-93	4-23-93	7-16-93	11-8-93	2-2-94	
MW-1	95.58	92.01	91.11	97.17	95.17	92.07	91.78	94.42	
MW-2	93.25	91.60	90.83	94.24	92.69	91.46	91.04	92.55	
MW-3	92.52	91.87	90.65	94.43	92.64	91.21	91.14	92.21	
MW-4	---	---	---	---	---	91.48	91.16	92.67	
Flow Direction	SE	SE	E	SE	SE	E	SE	E	

IV. SHALLOW GROUNDWATER SAMPLING RESULTS

Laboratory Analysis

All analyses were conducted by a California State DOHS certified laboratory in accordance with EPA recommended procedures (Priority Environmental Labs, Milpitas, CA). All Groundwater samples were analyzed for Total Petroleum Hydrocarbons as Gasoline (EPA method 8015), Benzene, Toluene, Ethylbenzene, and Total Xylenes (EPA method 602) and Total Petroleum Hydrocarbons as Diesel, Kerosene, Motor Oil and Mineral Spirits (EPA method 8015).

Results of Groundwater Sampling

Tables 3 and 4 presents the results of the laboratory analysis of the groundwater samples collected from monitoring wells MW-1, MW-2, MW-3 and MW-4.

As shown in Table 3, for this round of sampling, Total Petroleum Hydrocarbons as Gasoline were detected in the groundwater samples collected from wells MW-1, MW-3 and MW-4 at concentrations of 190 $\mu\text{g/L}$ (ppb), 7,500 $\mu\text{g/L}$ (ppb) and 830 $\mu\text{g/L}$ (ppb), respectively. In addition, Benzene was detected in the groundwater samples collected from wells MW-1, MW-3 and MW-4 at concentrations of 5.7 $\mu\text{g/L}$ (ppb), 8.5 $\mu\text{g/L}$ (ppb) and 8.5 $\mu\text{g/L}$ (ppb), respectively.

As shown in Table 4, for this round of sampling, Total Petroleum Hydrocarbons as Diesel were detected in the groundwater samples collected from well MW-3 and MW-4 at concentrations of 310 $\mu\text{g/L}$ (ppb) and 160 $\mu\text{g/L}$ (ppb),

**TABLE 3.
Shallow Groundwater Sampling Results**

Well	Date	TPH as Gasoline (ug/L)	Benzene (ug/L)	Toluene (ug/L)	Ethylbenzene (ug/L)	Total Xylenes (ug/L)
MW-1	10-26-90	---	1,200	18	7.1	37
	03-04-92	460	120	9.0	16	44
	04-03-92	300	21	6.0	15	36
	06-16-92	220	54	17	29	73
	10-09-92	ND	ND	ND	ND	ND
	01-07-93	210	0.7	3.7	4.4	9.6
	04-23-93	280	0.9	1.3	2.9	6.2
	07-16-93	110	ND	ND	0.5	1.1
	11-08-93	ND	ND	ND	ND	ND
	01-28-94	100	5.7	4.9	6.7	21
MW-2	03-04-92	ND	ND	ND	ND	ND
	04-03-92	ND	ND	ND	ND	ND
	06-16-92	ND	ND	ND	ND	ND
	10-09-92	ND	ND	ND	ND	ND
	01-07-93	ND	ND	ND	ND	ND
	04-23-93	ND	ND	ND	ND	ND
	07-16-93	ND	ND	ND	ND	ND
	11-08-93	ND	ND	ND	ND	ND
	01-28-94	ND	ND	ND	ND	ND
Detection Limit		50	0.5	0.5	0.5	0.5

ND = Not Detected

**TABLE 3. (continued)
Shallow Groundwater Sampling Results**

Well	Date	TPH as Gasoline (ug/L)	Benzene (ug/L)	Toluene (ug/L)	Ethyl-benzene (ug/L)	Total Xylenes (ug/L)
MW-3	03-04-92	14,000	6,200	60	110	740
	04-03-92	5,200	120	32	57	180
	06-16-92	6,000	180	45	82	190
	10-09-92	11,000	87	49	94	200
	01-07-93	4,200	3.3	13	44	92
	04-23-93	21,000	23	43	49	130
	07-16-93	16,000	19	21	25	78
	11-08-93	10,000	4.3	5.7	7.9	35
	01-28-94	7,500	8.5	10	50	95
MW-4	01-07-93	4,800	6.4	25	60	110
	04-23-93	2,700	8.3	11	31	59
	07-16-93	3,000	3.7	4.2	4.9	15
	11-08-93	1,400	0.6	0.8	1.1	4.8
	01-28-94	830	8.5	10	12	27
Detection Limit		50	0.5	0.5	0.5	0.5

ND = Not Detected

TABLE 4.

Shallow Groundwater Sampling Results

Well	Date	TPH as Kerosene (ug/L)	TPH as Diesel (ug/L)	TPH as Mineral Spirits (ug/L)	TPH as Motor Oil (ug/L)
MW-1	10-26-90	---	5,400	---	---
	03-04-92	---	590	---	---
	04-03-92	ND	ND	---	ND
	06-16-92	---	730	---	---
	10-09-92	ND	ND	---	ND
	01-07-93	ND	ND	---	ND
	04-23-93	---	ND	---	---
	07-16-93	---	59	---	---
	11-08-93	---	ND	---	---
	01-28-94	ND	ND	ND	ND
MW-2	03-04-92	---	ND	---	---
	04-03-92	ND	ND	---	ND
	06-16-92	---	ND	---	---
	10-09-92	ND	ND	---	ND
	01-07-93	ND	ND	---	ND
	04-23-93	---	ND	---	---
	07-16-93	---	ND	---	---
	11-08-93	---	ND	---	---
	01-28-94	ND	ND	ND	ND
Detection Limit		50	50	50	50

ND = Not Detected

TABLE 4. (continued)

Shallow Groundwater Sampling Results

Well	Date	TPH as Kerosene (ug/L)	TPH as Diesel (ug/L)	TPH as Mineral Spirits (ug/L)	TPH as Motor Oil (ug/L)
MW-3	03-04-92	--	360	--	--
	04-03-92	ND	ND	--	ND
	06-16-92	--	ND	--	--
	10-09-92	ND	ND	--	ND
	01-07-93	ND	ND	--	ND
	04-23-93	--	ND	--	--
	07-16-93	--	ND	--	--
	11-08-93	--	ND	--	--
01-28-94	ND	310	370	ND	
MW-4	01-07-93	ND	ND	--	ND
	04-23-93	--	ND	--	--
	07-16-93	--	ND	--	--
	11-08-93	--	ND	--	--
	01-28-94	ND	160	160	ND
Detection Limit		50	50	50	50

ND = Not Detected

respectively. Mineral Spirits were also detected for the first time in the groundwater samples collected from well MW-3 and MW-4 at concentrations of 370 $\mu\text{g/L}$ (ppb) and 180 $\mu\text{g/L}$ (ppb), respectively.

A copy of the laboratory certificate for the water sample analysis is included in Attachment B.

Chemical Concentration Contours.

Figures 4, 5 and 6 show lines of equal concentration for Gasoline, Diesel and Mineral Spirits in the shallow groundwater. Since these lines have been drawn based upon relatively limited data (four data points), the plot represents only a small portion of the respective concentration plume. The plot does suggest, however, that the dissolved concentrations are now centered somewhere around the area of monitoring well MW-3.

The shift in the location of the center of the concentration plume appears to coincide with the removal of the subsurface contamination source (contaminated soil beneath piping leak). The elevated petroleum hydrocarbons concentrations detected in well MW-3 are representative of residual concentrations that have migrated down-gradient of this location. With continued shallow groundwater movement beneath the site, future shallow groundwater sampling results are likely to reflect continued attenuation of concentrations due to hydrodynamic dispersion.

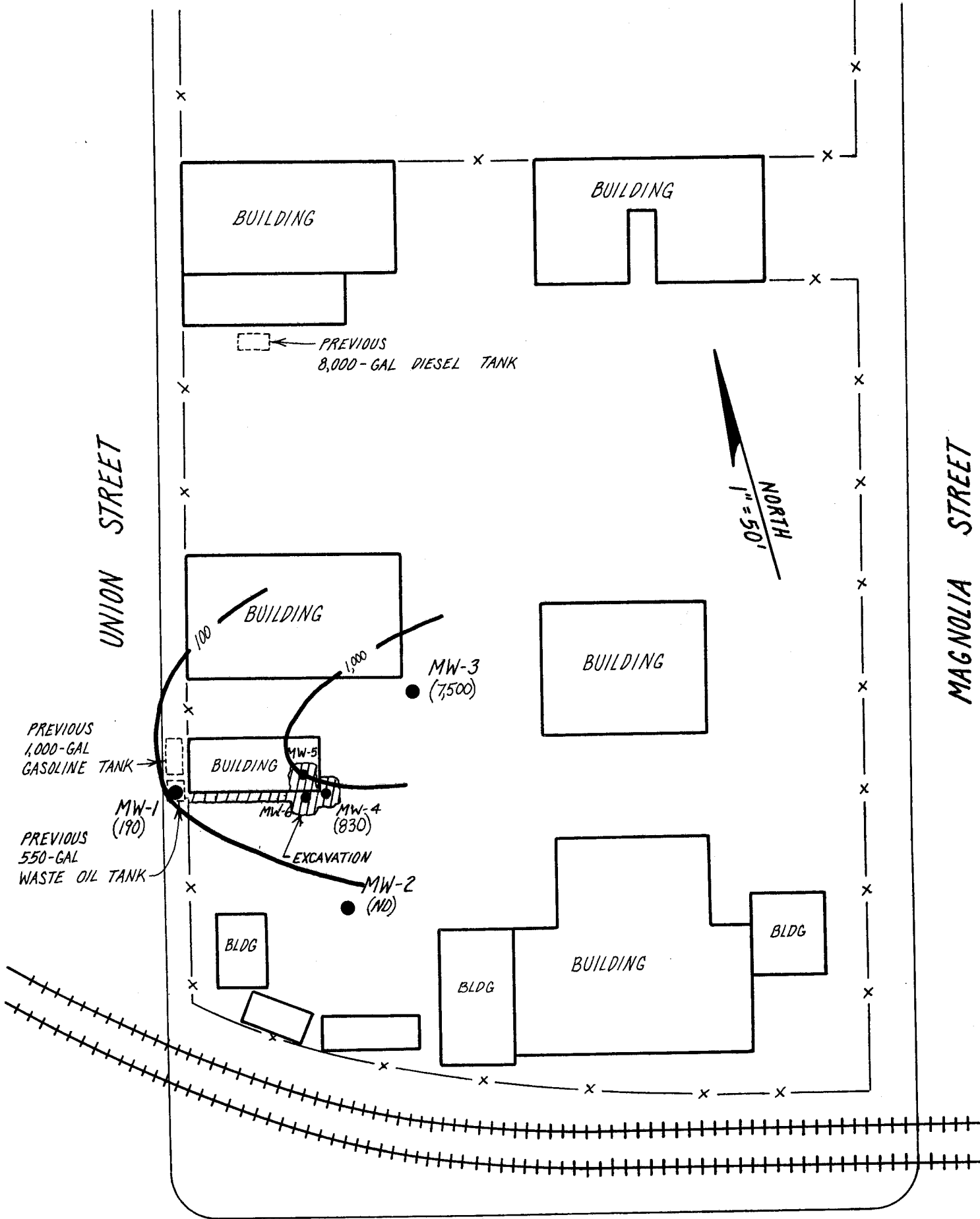

WEST GRAND AVENUE

FIGURE 4. Lines of Equal Concentration of Gasoline in ug/L (ppb) in the Shallow

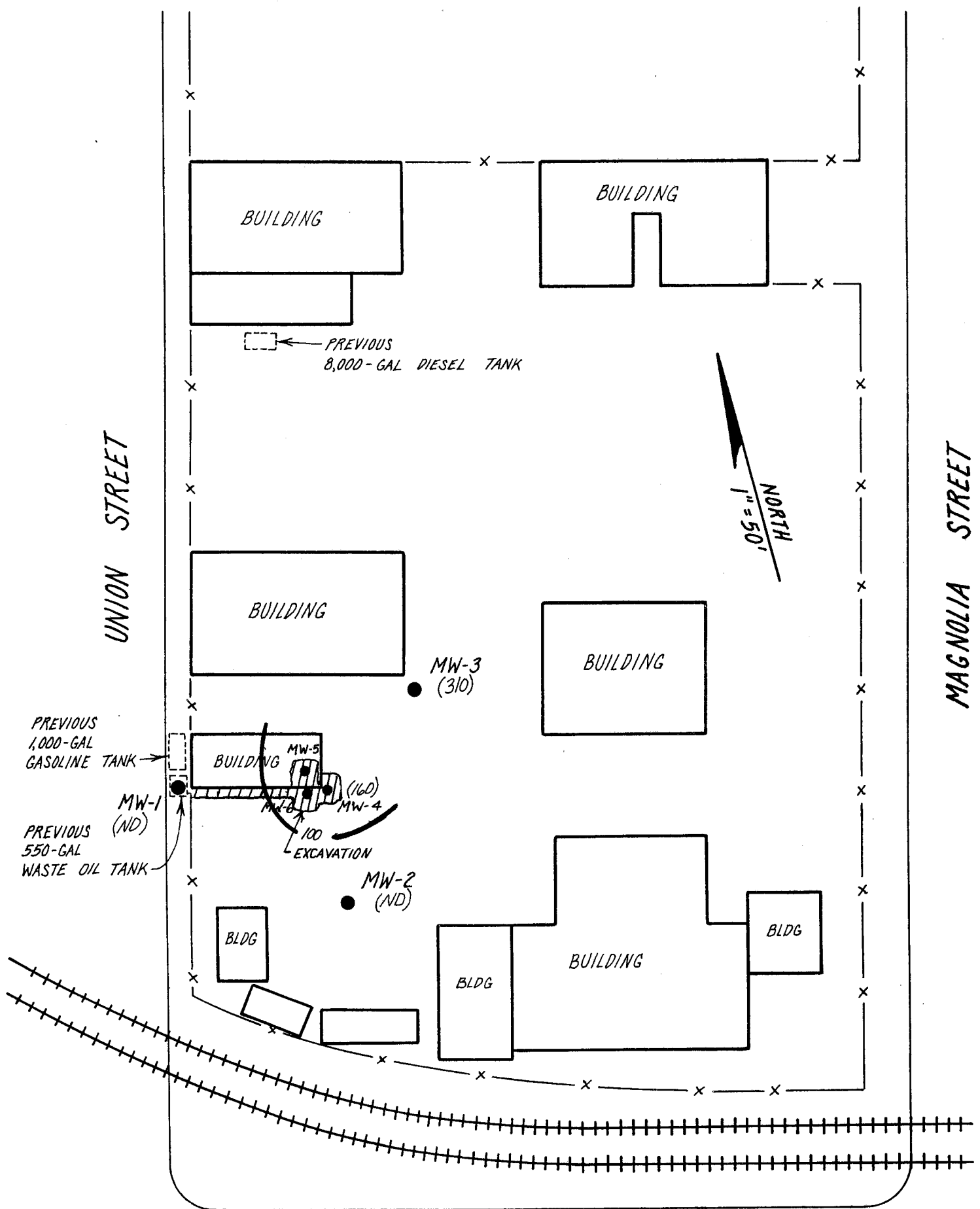

WEST GRAND AVENUE

FIGURE 5. Lines of Equal Concentration of Diesel in ug/L (ppb) in the Shallow Groundwater (1-28-94).

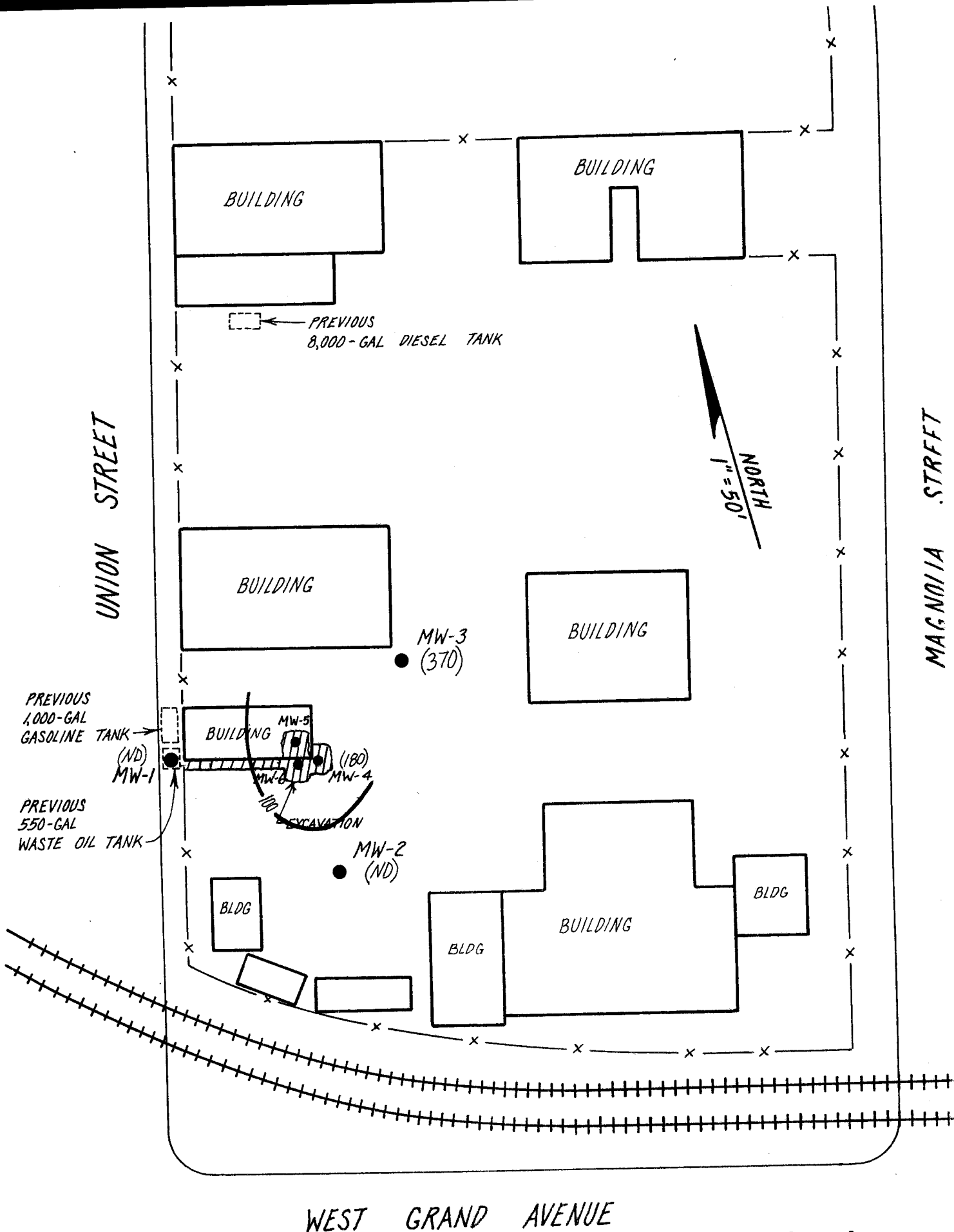
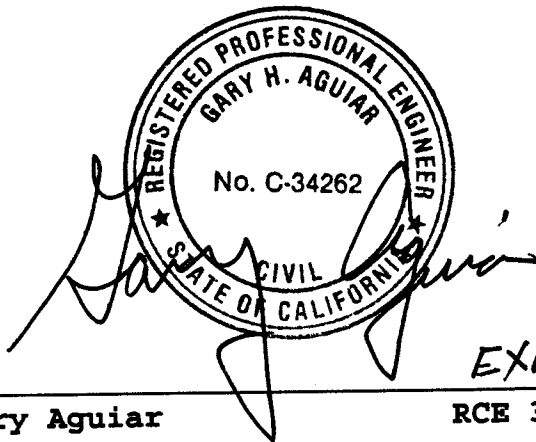

FIGURE 6. Lines of Equal Concentration of Mineral Spirits in ug/l (ppb) in the Shallow

QUARTERLY GROUNDWATER SAMPLING REPORT
PACIFIC CRYOGENIC COMPANY
2311 Magnolia Street, Oakland, CA

February 3, 1994



Gary Aguiar

EXP. 9-30-95
RCE 34262

Gerard F. Aarons 2-3-94
Gerard F. Aarons Geologist

ATTACHMENT A

WELL SAMPLING LOGS

WELL SAMPLING LOG

Project/No. PACIFIC OXYGEN Page 1 of 4
Site Location OAKLAND Date 1/27/94
Well No. MW 1 Time Began 1003
Weather CLEAR/60°F Completed 1040

EVACUATION DATA

Description of Measuring Point (MP) WELL BOX AT GRADE
Total Sounded Depth of Well Below MP 19.50
- Depth to Water Below MP 3.46 Diameter of Casing 2"
= Water Column in Well 16.04
Gallons in Casing 2.6 + Annular Space (x10) = Total Gallons 26
(30% porosity)
Gallons Pumped Prior to Sampling 26
Evacuation Method PVC BAILER

SAMPLING DATA / FIELD PARAMETERS

Inspection for Free Product: NONE DETECTED
(thickness to 0.1 inch, if any)

Time	<u>1003</u>	<u>1010</u>	<u>1023</u>	<u>1031</u>
Gals Removed	<u>0</u>	<u>10</u>	<u>18</u>	<u>26</u>
°C Temperature	<u>19.5</u>	<u>19.9</u>	<u>20.1</u>	<u>19.5</u>
Conductivity	<u>350</u>	<u>360</u>	<u>380</u>	<u>380</u>
pH	<u>6.8</u>	<u>6.7</u>	<u>6.4</u>	<u>6.4</u>
Color / Odor	<u>CLR/ACC</u>	<u>GRY/ACC</u>	<u>GRY/ACC</u>	<u>GRY/ACC</u>
Turbidity	<u>LOW</u>	<u>HIGH</u>	<u>HIGH</u>	<u>HIGH</u>

Comments: NONE

WELL SAMPLING LOG

Project/No. PACIFIC OXYGEN Page 2 of 4
 Site Location OAKLAND * 1/28/94
 Well No. MW 2 Date 1/27/94
 Weather CLEAR/60°F Time Began 1120
 Completed 1015

EVACUATION DATA

Description of Measuring Point (MP) WELL BOX AT GRADE
 Total Sounded Depth of Well Below MP 23.24
 - Depth to Water Below MP 6.74 Diameter of Casing 2"
 = Water Column in Well 16.50
 Gallons in Casing 2.6 + Annular Space (x 10) = Total Gallons 26
(30% porosity)
 Gallons Pumped Prior to Sampling 26
 Evacuation Method PVC BAILER

SAMPLING DATA / FIELD PARAMETERS

Inspection for Free Product: NONE DETECTED
(thickness to 0.1 inch, if any)

	<u>1120</u>	<u>1127</u>	<u>1135</u>	<u>1015</u>
Time	<u>1120</u>	<u>1127</u>	<u>1135</u>	<u>1015</u>
Gals Removed	<u>0</u>	<u>10</u>	<u>18</u>	<u>26</u>
Temp	<u>16.4</u>	<u>17.9</u>	<u>18.6</u>	<u>17.5</u>
Conductivity	<u>550</u>	<u>600</u>	<u>700</u>	<u>650</u>
pH	<u>6.8</u>	<u>6.8</u>	<u>6.8</u>	<u>6.9</u>
Color / Odor	<u>CLR/ORG</u>	<u>BEN/ORG</u>	<u>BEN/ORG</u>	<u>BEN/ORG</u>
Turbidity	<u>LOW</u>	<u>HIGH</u>	<u>HIGH</u>	<u>HIGH</u>

Comments: NONE * DENATERED

1-28-94

WELL SAMPLING LOG

Project/No. PACIFIC OXYGEN Page 3 of 4
 Site Location OAKLAND 1/27/94
 Well No. MW 3 * 1/28/94
 Weather CLEAR / 60°F Time Began 0932
 Completed 1035

EVACUATION DATA

Description of Measuring Point (MP) WELL BOX AT GRADE
 Total Sounded Depth of Well Below MP 22.96
 - Depth to Water Below MP 7.15 Diameter of Casing 2"
 = Water Column in Well 15.81
 Gallons in Casing 2.5 + Annular Space (x10) = Total Gallons 25
 (30% porosity)
 Gallons Pumped Prior to Sampling 7
 Evacuation Method PVC BAILER

SAMPLING DATA / FIELD PARAMETERS

Inspection for Free Product: NONE DETECTED
 (thickness to 0.1 inch, if any)

	<u>0932</u>	<u>0938</u>	<u>1005</u>	<u>1035</u>
Time	<u>0932</u>	<u>0938</u>	<u>1005</u>	<u>1035</u>
Gals Removed	<u>0</u>	<u>4</u>	<u>7</u>	<u>(46-82)</u>
Temp	<u>19.8</u>	<u>21.1</u>	<u>20.2</u>	<u>(46-82)</u>
Conductivity	<u>550</u>	<u>550</u>	<u>550</u>	<u>(46-82)</u>
pH	<u>6.4</u>	<u>6.4</u>	<u>6.7</u>	<u>(46-82)</u>
Color / Odor	<u>CLR/HC</u>	<u>GRY/HC</u>	<u>GRY/HC</u>	<u>(46-82)</u>
Turbidity	<u>LOW</u>	<u>HIGH</u>	<u>HIGH</u>	<u>(46-82)</u>

* 1-28-94

Comments: * DENATERED

WELL SAMPLING LOG

Project/No. PACIFIC OXYGEN

Page 4 of 4

Site Location OAKLAND

Date 1/27/94

Well No. MW 4

Time Began 1055

Weather CLEAR / 60°F

Completed 1140

EVACUATION DATA

Description of Measuring Point (MP) WELL BOX AT GRADE

Total Sounded Depth of Well Below MP 14.30

- Depth to Water Below MP 7.72

Diameter of Casing 4"

= Water Column in Well 6.58

Gallons in Casing 4.2 + Annular Space (NONE) = Total Gallons 4.2
(30% porosity)

Gallons Pumped Prior to Sampling 15

Evacuation Method PVC BAILER

SAMPLING DATA / FIELD PARAMETERS

Inspection for Free Product: NONE DETECTED
(thickness to 0.1 inch, if any)

Time	<u>1055</u>	<u>1059</u>	<u>1104</u>	<u>1110</u>
Gals Removed	<u>0</u>	<u>5</u>	<u>10</u>	<u>15</u>
C° Temperature	<u>19.5</u>	<u>19.9</u>	<u>20.1</u>	<u>19.5</u>
Conductivity	<u>350</u>	<u>360</u>	<u>380</u>	<u>380</u>
pH	<u>6.8</u>	<u>6.7</u>	<u>6.4</u>	<u>6.4</u>
Color / Odor	<u>CLR/ORG</u>	<u>GRY/ORG</u>	<u>GRY/ORG</u>	<u>GRY/ORG</u>
Turbidity	<u>LOW</u>	<u>HIGH</u>	<u>HIGH</u>	<u>HIGH</u>

Comments: NONE



HAGEMAN-AGUIAR, INC.

Underground Contamination Investigations, Groundwater Consultants, Environmental Engineering

Project: PACIFIC OXYGEN

Date: 2-2-94

WELL #	ELEVATION	DTW	PRODUCT	COMMENTS
1		4.85		
2		7.45		
3		7.81		
4		7.28		

ATTACHMENT B

ANALYTICAL RESULTS: GROUNDWATER



PRIORITY ENVIRONMENTAL LABS

Precision Environmental Analytical Laboratory

January 29, 1994

PEL # 9401093

HAGEMAN - AGUIAR, INC.

Attn: Jeffrey Roth

Re: Four water samples for Gasoline/BTEX and Diesel analyses.

Project name: Pacific Oxygen

Project location: Union St., - Oakland, CA.

Date sampled: Jan 27-28, 1994

Date submitted: Jan 28, 1994

Date extracted: Jan 28-29, 1994

Date analyzed: Jan 28-29, 1994

RESULTS:

SAMPLE I.D.	Gasoline	Diesel	Benzene	Toluene	Ethyl Benzene	Total Xylenes
	(ug/L)	(ug/L)	(ug/L)	(ug/L)	(ug/L)	(ug/L)
MW 1	190	N.D.	5.7	4.9	6.7	21
MW 2	N.D.	N.D.	N.D.	N.D.	N.D.	N.D.
MW 3	7500	310	18	25	50	95
MW 4	830	160	8.5	10	12	27
Blank	N.D.	N.D.	N.D.	N.D.	N.D.	N.D.
Spiked Recovery	84.3%	94.4%	94.6%	99.3%	88.4%	105.1%
Duplicate Spiked Recovery	102.4%	107.9%	102.7%	109.8%	106.6%	101.4%
Detection limit	50	50	0.5	0.5	0.5	0.5
Method of Analysis	5030 / 8015	3510 / 8015	602	602	602	602

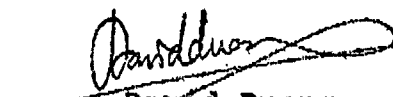
David Duong
Laboratory Director



PRIORITY ENVIRONMENTAL LABS

Precision Environmental Analytical Laboratory

January 29, 1994

PEL # 9401093

HAGEMAN - AGUIAR, INC.

Attn: Jeffrey Roth

Re: Four water samples for Gasoline/BTEX and TEPH analyses.

Project name: Pacific Oxygen

Project location: Union St., - Oakland, CA.

Date sampled: Jan 27-28, 1994

Date submitted: Jan 28, 1994

Date extracted: Jan 28-29, 1994

Date analyzed: Jan 28-29, 1994

RESULTS:

SAMPLE I.D.	Kerosene (ug/L)	Gasoline (ug/L)	Diesel (ug/L)	Benzene (ug/L)	Toluene (ug/L)	Ethyl Benzene (ug/L)	Total Motor Benzene Xylenes (ug/L)	Oil (mg/L)	Mineral Spirit (ug/L)
MW 1	N.D.	190	N.D.	5.7	4.9	6.7	21	N.D.	N.D.
MW 2	N.D.	N.D.	N.D.	N.D.	N.D.	N.D.	N.D.	N.D.	N.D.
MW 3	N.D.	7500	310	18	25	50	95	N.D.	370
MW 4	N.D.	830	160	8.5	10	12	27	N.D.	180
Blank	N.D.	N.D.	N.D.	N.D.	N.D.	N.D.	N.D.	N.D.	N.D.
Spiked Recovery	83.1%	84.3%	94.4%	94.6%	99.3%	88.4%	105.1%	---	91.2
Duplicate Spiked Recovery	---	102.4%	107.9%	102.7%	109.8%	106.6%	101.4%	---	---
Detection limit	50	50	50	0.5	0.5	0.5	0.5	0.5	50
Method of Analysis	3510 / 8015	5030 / 8015	3510 / 8015	602	602	602	602	3510 / 8015	3510 / 801

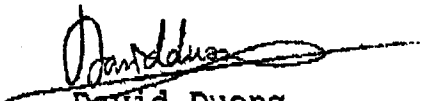
 David Duong
 Laboratory Director

9401093

PEL #

CHAIN OF CUSTODY RECORD

INV # 24437

PROJECT NAME AND ADDRESS: <u>PACIFIC OXYGEN</u> <u>UNION ST</u> <u>OAKLAND, CA</u>					SAMPLER: (Signature) <i>[Signature]</i>					ANALYSIS REQUESTED <i>TPH GAS / TPH DIESEL</i>									
					HAGEMAN - AGUIAR, INC. 3732 Mt. Diablo Blvd., Suite 372 Lafayette, CA 94549 (415)284-1661 (415)284-1664 (FAX)														
CROSS REFERENCE NUMBER	DATE	TIME	SOIL	WATER	STATION LOCATION					REMARKS									
MW 1	1-27-94	1035		X	MONITOR WELL # 1					X	X					NORM TAT			
MW 2	1-27-94	1200		X	↓ # 2					X	X								
MW 3	1-28-94	1035		X	↓ # 3					X	X								
MW 4	1-27-94	1140		X	↓ # 4					X	X								
RELINQUISHED BY: (Signature) <i>[Signature]</i>					DATE <u>1-28-94</u>					RECEIVED BY: (Signature)					DATE				
					TIME <u>1125</u>										TIME				
RELINQUISHED BY: (Signature)					DATE					RECEIVED BY: (Signature)					DATE				
					TIME										TIME				
RELINQUISHED BY: (Signature)					DATE					RECEIVED BY: (Signature)					DATE				
					TIME										TIME				
RELINQUISHED BY: (Signature)					DATE					RECEIVED FOR LABORATORY BY: (Signature) <i>Victor Rung PEL</i>					DATE <u>1-28-94</u>				
					TIME										TIME <u>1125</u>				