

**ALAMEDA COUNTY ENVIRONMENTAL  
HEALTH SERVICES**

**ENVIRONMENTAL PROTECTION DIVISION  
1131 Harbor Bay Parkway, Suite 250  
Alameda, CA 94502-6577  
Telephone (510) 567-6700 Fax (510) 337-9335**

**FAX COVER SHEET**

DATE: Jan 12, 1998, 19    

TO: Tom Masher 1800-285-3037 x11796  
Shell (Environmental Claims)  
Shell Oil Co.  
Po Box 2099  
Houston 77252

FAX # (713) 241-6926

Att Tom Masher

Total number of pages including cover sheet 14

FROM: eva chw  
510/567-6762

NOTE:

~~PLEASE RESPOND BY FAX ONLY.~~

There will be some oversight costs involved, which I haven't  
mentioned. However, if we open the case, I assume Alex  
Perez would handle additional environmental assessment. I'll

keep you posted on everything.  
(SMILE) HAVE A NICE DAY  
DO SOMETHING FOR OUR ENVIRONMENT

*[Signature]*



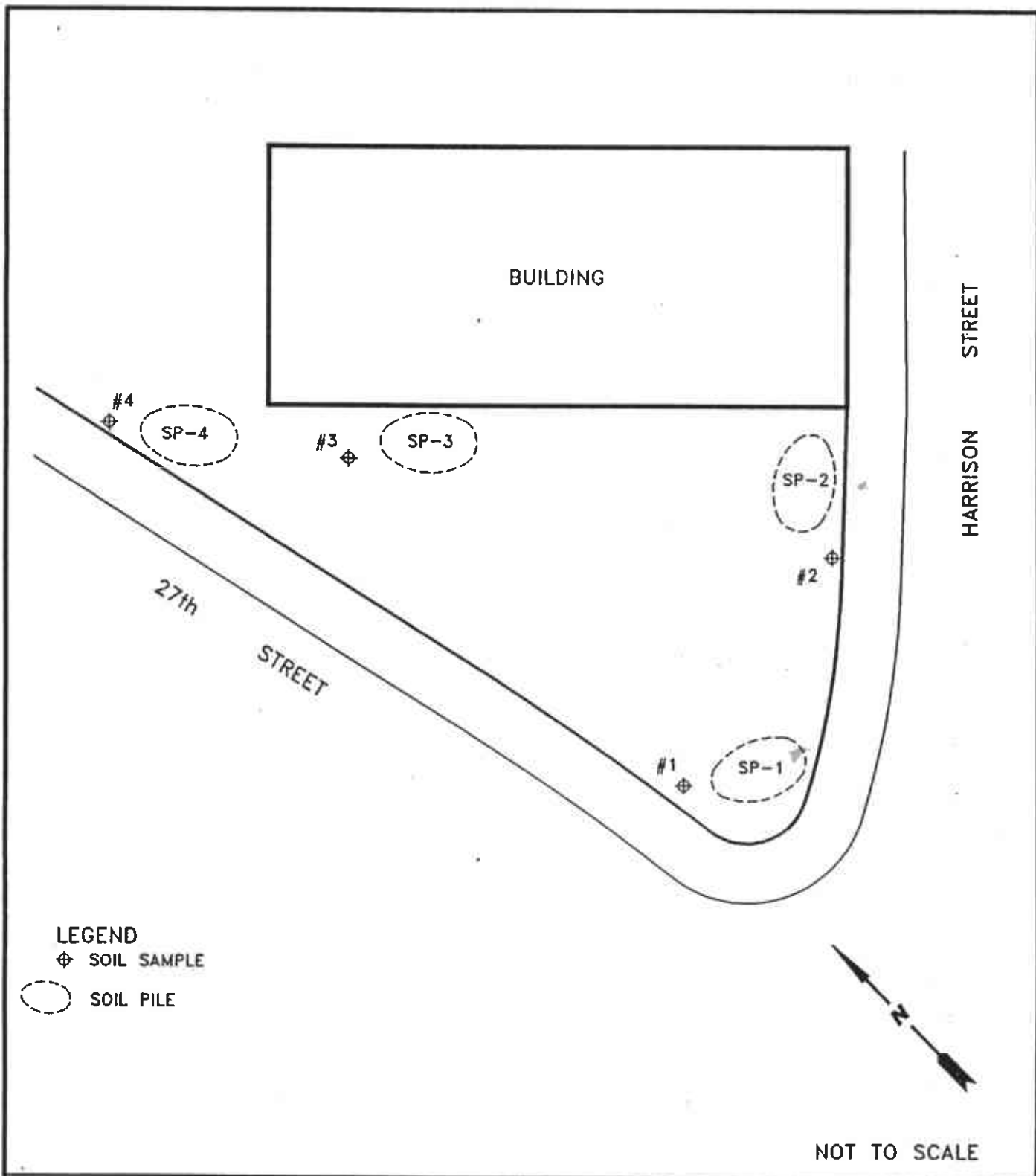

 <b>GROUNDWATER TECHNOLOGY</b>		4057 PORT CHICAGO HWY. CONCORD, CA 94520 (510) 671-2387		<b>SOIL SAMPLE LOCATION MAP</b>			
<b>CLIENT:</b> BURGE DEVELOPEMENT COMPANY			<b>LOCATION:</b> 2350 HARRISON STREET OAKLAND, CALIFORNIA		<b>REV. NO.:</b> 0	<b>DATE:</b> 4/12/93	
<b>PM</b>	<b>PE/RG</b>	<b>DESIGNED</b> SL	<b>DETAILED</b> CY	<b>ACAD FILE:</b> SSLM493	<b>PROJECT NO.:</b> 020203768	<b>FIGURE:</b> 1	



# GTEL

ENVIRONMENTAL  
LABORATORIES, INC.

Client Number: 020203325  
Project ID: 2350 Harrison St.  
Oakland, CA  
Work Order Number: C2-11-055

**Northwest Region**

4080-C Pike Lane  
Concord, CA 94520  
(510) 685-7852  
(800) 544-3422 from inside California  
(800) 423-7143 from outside California  
(510) 825-0720 (FAX)

December 15, 1992

Tim Watchers/Sandra Lindsey  
Groundwater Technology, Inc.  
4057 Port Chicago Hwy.  
Concord, CA 94520

Enclosed please find the analytical results for samples received by GTEL Environmental Laboratories, Inc. on 11/04/92, under chain of custody record 25994.

A formal Quality Assurance/Quality Control (QA/QC) program is maintained by GTEL, which is designed to meet or exceed the EPA requirements. Analytical work for this project met QA/QC criteria, unless otherwise stated in the footnotes.

GTEL is certified by the California State Department of Health Services to perform analyses for drinking water, wastewater, and hazardous waste materials according to EPA protocols.

If you have any questions concerning this analysis or if we can be of further assistance, please call our Customer Service Representative.

Sincerely,

GTEL Environmental Laboratories, Inc.

Eileen F. Bullen  
Laboratory Director

**Table 1**  
**ANALYTICAL RESULTS**  
 Aromatic Volatile Organics and  
 Total Petroleum Hydrocarbons as Gasoline in Soil  
 EPA Methods 5030, 8020, and Modified 8015<sup>a</sup>

GTEL Sample Number		01	02		
Client Identification		SOIL PILE 1	SOIL PILE 2		
Date Sampled		11/02/92	11/02/92		
Date Extracted		11/04/92	11/04/92		
Date Analyzed		11/05/92	11/05/92		
Analyte	Detection Limit, mg/Kg	Concentration, mg/Kg			
Benzene	0.005	<0.005	0.24		
Toluene	0.005	<0.005	0.31		
Ethylbenzene	0.005	<0.005	0.22		
Xylene, total	0.015	<0.015	2		
BTEX, total	--	--	3		
Gasoline	1	<1	89*		
Detection Limit Multiplier		1	1		
Percent solids		84	54		

- a. Test Methods for Evaluating Solid Waste, SW-846, Third Edition, Revision 0, US EPA November 1986. Modification for TPH as gasoline as per California State Water Resources Control Board LUFT Manual protocols, May 1988 revision. Results reported on a wet weight basis.
- \* Hydrocarbon pattern found is not characteristic of fresh gasoline possibly weathered gasoline.

**Table 1**

**ANALYTICAL RESULTS**

**Total Oil and Grease in Soil  
 by Infrared Spectrometry**

EPA 3550<sup>1</sup> (Mod.)/EPA 413.2<sup>2</sup>(SM 5520 C<sup>3</sup>)

GTEL Sample Number		01*	02*		
Client Identification		SOIL PILE 1	SOIL PILE 2		
Date Sampled		11/02/92	11/02/92		
Date Prepared		11/05/92	11/05/92		
Date Analyzed		11/05/92	11/05/92		
Analyte	Detection Limit, mg/Kg	Concentration, mg/Kg			
Total oil and grease	5	34	35		
Quantitation Limit Multiplier		1	1		

1. Test Methods for Evaluating Solid Waste, SW-846.
  2. Methods for Chemical Analysis of Water and Wastes, EPA 600/4-79-020, Revised March 1983, U.S. Environmental Protection Agency.
  3. Standard Methods for the Examination of Water and Wastewater, 17th ed., 1898, American Public Health Association.
- \* Although attempts were made to homogenize the samples, the analyst experienced inconsistencies in the results due to lumps of clay present non-uniformly in the samples.

Client Number: 020203325  
 Project ID: 2350 Harrison St.  
 Oakland, CA  
 Work Order Number: C2-11-054

**Table 1**  
**ANALYTICAL RESULTS**  
**Hydrocarbons in Soil**  
**Method: GC-FID<sup>a</sup>**

GTEL Sample Number		01	02		
Client Identification		SOIL PILE 1	SOIL PILE 2		
Date Sampled		11/02/92	11/02/92		
Date Extracted		11/05/92	11/05/92		
Date Analyzed		11/05/92	11/06/92		
Analyte	Detection Limit, mg/Kg	Concentration, mg/Kg			
Gasoline	10	<10	10*		
Mineral spirits	10	<10	<10		
Kerosine	10	<10	<10		
Jet fuel	10	<10	<10		
Diesel	10	<10	<10		
Fuel oil #6	10	<10	<10		
Lubricating oil	100	3200	<100		
Quantitation Limit Multiplier		1	1		
Percent solids		84	54		

- a. "Test Methods for Evaluating Solid Waste, SW-846, 3rd edition, Rev. O, U.S. EPA, November, 1986". Results reported on a wet weight basis.  
 \* Hydrocarbons in the range of gasoline, possibly degraded. As requested, additional analysis is being done to confirm.







Client Number: 0201  
Project ID: 2350 Harrison St., Oakland  
Work Order Number: C3-03-0114

**Northwest Region**

4080-C Pike Lane  
Concord, CA 94520  
(510) 685-7852  
(800) 544-3422 from inside California  
(800) 423-7143 from outside California  
(510) 825-0720 (FAX)

March 24, 1993

Sandra Lindsey  
Groundwater Technology, Inc.  
4057 Port Chicago Hwy.  
Concord, CA 94520

Enclosed please find the analytical results for samples received by GTEL Environmental Laboratories, Inc. on 03/04/93, under chain of custody record 26100.

A formal Quality Assurance/Quality Control (QA/QC) program is maintained by GTEL, which is designed to meet or exceed the EPA requirements. Analytical work for this project met QA/QC criteria, unless otherwise stated in the footnotes.

GTEL is certified by the California State Department of Health Services, Laboratory certificate numbers 194 and 1075, to perform analyses for drinking water, wastewater, and hazardous waste materials according to EPA protocols.

If you have any questions concerning this analysis or if we can be of further assistance, please call our Customer Service Representative.

Sincerely,  
GTEL Environmental Laboratories, Inc.

A handwritten signature in cursive script that reads 'Eileen F. Bullen' followed by a stylized flourish.

Eileen F. Bullen  
Laboratory Director

**Table 1**  
**ANALYTICAL RESULTS**  
 Hydrocarbons in Soil  
 Method: GC-FID<sup>a</sup>

GTEL Sample Number		01	02	03	04
Client Identification		SP #3	SP #4	#4	#3
Date Sampled		03/04/93	03/04/93	03/04/93	03/04/93
Date Extracted		03/10/93	03/10/93	03/10/93	03/10/93
Date Analyzed		03/17/93	03/17/93	03/18/93	03/17/93
Analyte	Detection Limit, mg/Kg	Concentration, mg/Kg			
TPH as gasoline	10	[REDACTED]	140	620	[REDACTED]
TPH as mineral spirits	10	540	<10	<100	<10
TPH as kerosene	10	<10	<10	<100	<10
TPH as diesel fuel	10	<10	<10	<100	<10
TPH as lubricating oil	100	<100	670	7900	<100
Detection Limit Multiplier		1	1	25*	1
Percent solids		68.3	72.9	68.6	61.2

a. \*Test Methods for Evaluating Solid Waste, SW-846, 3rd edition, Rev. O, U.S. EPA, November, 1986.  
 \* Detection limit raised due to high levels of target compound.

*Total Petli Hydro*

**Table 1 (Continued)**

**ANALYTICAL RESULTS**

**Total Oil and Grease in Soil  
 by Infrared Spectrometry**

EPA 3550<sup>1</sup> (Mod.)/EPA 413.2<sup>2</sup>(SM 5520 C<sup>3</sup>)

GTEL Sample Number		05	06		
Client Identification		#2	#1		
Date Sampled		03/04/93	03/04/93		
Date Prepared		03/15/93	03/15/93		
Date Analyzed		03/15/93	03/15/93		
	Detection Limit, mg/Kg	Concentration, mg/Kg			
Analyte					
Total Oil and Grease	5	22	10		
Detection Limit Multiplier		1	1		
Percent solids		80.4	76.2		

1. Test Methods for Evaluating Solid Waste, SW-846, 3rd edition, Rev. O, U.S. EPA, November, 1986.
2. Methods for Chemical Analysis of Water and Wastes, EPA 600/4-79-020, Revised March 1983, U.S. Environmental Protection Agency.
3. Standard Methods for the Examination of Water and Wastewater, 17th ed., 1989, American Public Health Association.

**Table 1**

**ANALYTICAL RESULTS**

Total Oil and Grease in Soil  
 by Infrared Spectrometry

EPA 3550<sup>1</sup> (Mod.)/EPA 413.2<sup>2</sup>(SM 5520 C<sup>3</sup>)

GTEL Sample Number		01	02	03	04
Client Identification		SP #3	SP #4	#4	#3
Date Sampled		03/04/93	03/04/93	03/04/93	03/04/93
Date Prepared		03/15/93	03/15/93	03/15/93	03/15/93
Date Analyzed		03/15/93	03/15/93	03/15/93	03/15/93
Analyte	Detection Limit, mg/Kg	Concentration, mg/Kg			
Total Oil and Grease	5	41	440	5000	64
Detection Limit Multiplier		1	1	1	1
Percent solids					61.2

1. Test Methods for Evaluating Solid Waste, SW-846, 3rd edition, Rev. O, U.S. EPA, November, 1986.
2. Methods for Chemical Analysis of Water and Wastes, EPA 600/4-79-020, Revised March 1983, U.S. Environmental Protection Agency.
3. Standard Methods for the Examination of Water and Wastewater, 17th ed., 1989, American Public Health Association.

**Table 1 (Continued)**  
**ANALYTICAL RESULTS**  
 Hydrocarbons in Soil  
 Method: GC-FID<sup>a</sup>

GTEL Sample Number		05	06		
Client Identification		#2	#1		
Date Sampled		03/04/93	03/04/93		
Date Extracted		03/10/93	03/10/93		
Date Analyzed		03/17/93	3/17/93		
Analyte	Detection Limit, mg/Kg	Concentration, mg/Kg			
TPH as gasoline	10		<10		
TPH as mineral spirits	10	<10	<10		
TPH as kerosene	10	<10	<10		
TPH as diesel fuel	10	<10	<10		
TPH as lubricating oil	100	<100	<100		
Detection Limit Multiplier		1	1		
Percent solids		80.4	76.2		

a. \*Test Methods for Evaluating Solid Waste, SW-846, 3rd edition, Rev. O, U.S. EPA, November, 1986.\*

Company Name: Groundwater Technology Phone #: 510-671-2387  
 Company Address: 2350 Harrison St. Oakland FAX #: 510-671-2387  
657 Port Chicago Hwy (Concord)  
 Project Manager: Sandra Lindsey Client Project ID: (#) Station # (Site #) 20009  
0201  
 (NAME) STHL / Harrison  
 Test that the proper field sampling procedures were used during the collection of these samples. Sampler Name (Print): CHIP HURLEY  
S. Lindsey

Field Sample ID	GTEL Lab # (Lab use only)	# Containers	Matrix						Method Preserved				Sampling				
			WATER	SOIL	AIR	SLUDGE	PRODUCT	OTHER	HCl	HNO <sub>3</sub>	H <sub>2</sub> SO <sub>4</sub>	ICE	UNPRESERVED	OTHER (SPECIFY)	DATE	TIME	
#3	1		X								X						
#4	2																
#3	3																
#2	5																
#1	10																

BTEX/602  8020  with MTBE

BTEX/Gas Hydrocarbons PID/FID  with MTBE  0/2

Hydrocarbons GC/FID Gas  Diesel  Screen  0/2

Hydrocarbon Profile (SIMDIS)

Oil and Grease 413.1  413.2  SM 503  5550

TPH/IR 418.1  SM 503

EDB by 504  DBCP by 504

EPA 503.1  EPA 502.2

EPA 601  EPA 8010

EPA 602  EPA 8020

EPA 608  8080  PCB only

EPA 624/PPL  8240/TAL  NBS (+15)

EPA 625/PPL  8270/TAL  NBS (+25)

EPA 610  8310

EP TOX Metals  Pesticides  Herbicides

TCLP Metals  VOA  Semi-VOA  Pest  Herb

EPA Metals - Priority Pollutant  TAL  RCRA

CAM Metals  TLCL  STLC

Lead 239.2  200.7  7420  7421  6010

Organic Lead

Corrosivity  Flash Point  Reactivity

TAT

Priority (24 hr)

Expedited (48 hr)

7 Business Days

Other STP

Business Days

Special Handling

GTEL Contact \_\_\_\_\_

Quote/Contract # \_\_\_\_\_

Confirmation # \_\_\_\_\_

PO # \_\_\_\_\_

QA / QC LEVEL

BLUE  CLP  OTHER \_\_\_\_\_

SPECIAL DETECTION LIMITS

Please Report lowest Detection Limits.

SPECIAL REPORTING REQUIREMENTS

FAX

REMARKS

TOG 413.2

HYD SCREEN BY GC/FID

Lab Use Only Lot # \_\_\_\_\_

Storage Location: \_\_\_\_\_

Work Order # \_\_\_\_\_

**CUSTODY RECORD**

Relinquished by Sampler:	<u>S. Lindsey</u>	Date	Time	Received by:	
Relinquished by:		3-4-13	14:50	Received by:	
Relinquished by:		3/4/03	14:50	Received by Laboratory:	<u>Corinne Belskey</u>

THIS PORTION OF EXISTING REAR WALL TO REMAIN  
CLOSE OPENINGS WITH 12" TILE  
120.34'

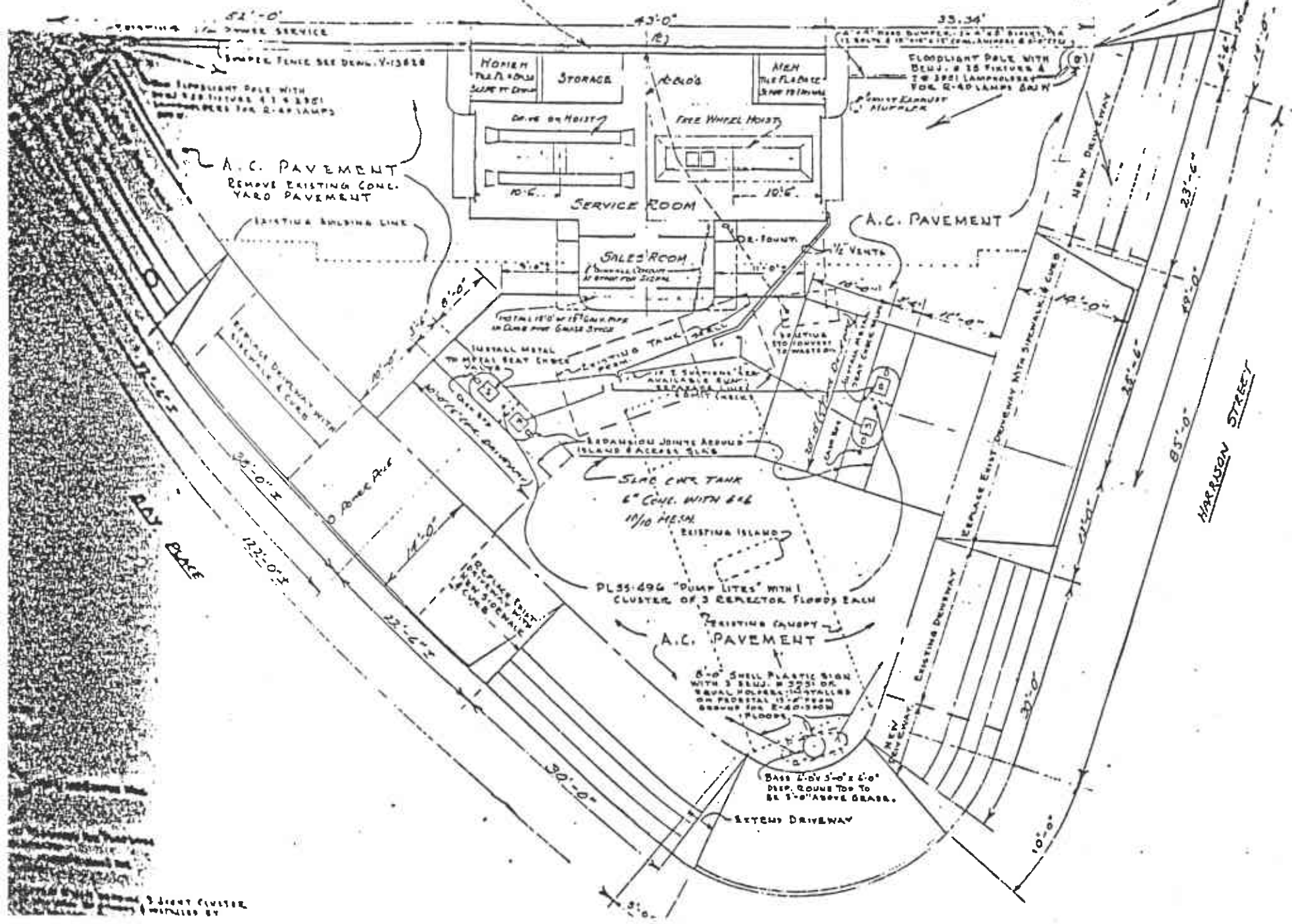

51'-0"

43'-0"

35'-34"

A.C. PAVEMENT  
REMOVE EXISTING CONG.  
YARD PAVEMENT

A.C. PAVEMENT

SALES ROOM

SERVICE ROOM

MOTOR TRUCK ROOM  
SLIP-PROOF FLOOR

STORAGE

REAR

MEN TRUCK FLOR  
SLIP-PROOF FLOOR

FREE WHEEL HOIST

DRIVE ON HOIST

10'-6"

10'-6"

DR. TOWNY

1/2 VENTS

9'-0"

9'-0"

11'-0"

11'-0"

10'-0"

10'-0"

10'-0"

10'-0"

10'-0"

10'-0"

10'-0"

10'-0"

10'-0"

10'-0"

10'-0"

10'-0"

10'-0"

10'-0"

10'-0"

10'-0"

10'-0"

10'-0"

10'-0"

10'-0"

10'-0"

10'-0"

10'-0"

10'-0"

10'-0"

10'-0"

10'-0"

10'-0"

10'-0"

10'-0"

10'-0"

10'-0"

10'-0"

10'-0"

10'-0"

10'-0"

10'-0"

10'-0"

10'-0"

10'-0"

10'-0"

10'-0"

10'-0"

10'-0"

10'-0"

10'-0"

10'-0"

10'-0"

10'-0"

10'-0"

10'-0"

10'-0"

10'-0"

10'-0"

10'-0"

10'-0"

10'-0"

10'-0"

10'-0"

10'-0"

HARRISON STREET

RAY  
BASE

25'-0" X

22'-0" X

22'-0" X

22'-0" X

30'-0"

10'-0"

25'-0" X

14'-0"

14'-0"

14'-0"

14'-0"

14'-0"

8'-0"

8'-0"

8'-0"

8'-0"

8'-0"

8'-0"

8'-0"

8'-0"

8'-0"

8'-0"

8'-0"

8'-0"

8'-0"

8'-0"

8'-0"

8'-0"

8'-0"

8'-0"

8'-0"

8'-0"

8'-0"

8'-0"

8'-0"

8'-0"

8'-0"

8'-0"

8'-0"

8'-0"

8'-0"

8'-0"

8'-0"

8'-0"

8'-0"

8'-0"

8'-0"

8'-0"

8'-0"

8'-0"

8'-0"

8'-0"

8'-0"

8'-0"

8'-0"

8'-0"

8'-0"

8'-0"

8'-0"

8'-0"

8'-0"

8'-0"

8'-0"

8'-0"

8'-0"

8'-0"

8'-0"

8'-0"

8'-0"

8'-0"

8'-0"

8'-0"

8'-0"

8'-0"

8'-0"

8'-0"

8'-0"

8'-0"

8'-0"

8'-0"

8'-0"

8'-0"

8'-0"

8'-0"

8'-0"

8'-0"

8'-0"

8'-0"

8'-0"

8'-0"

8'-0"

8'-0"

8'-0"

8'-0"

8'-0"

8'-0"

8'-0"

8'-0"

8'-0"

8'-0"

8'-0"

8'-0"

8'-0"

8'-0"

8'-0"

8'-0"

8'-0"

8'-0"

8'-0"

8'-0"

8'-0"

8'-0"

8'-0"

8'-0"

8'-0"

8'-0"

8'-0"

8'-0"

8'-0"

8'-0"

8'-0"

8'-0"

8'-0"

8'-0"

8'-0"

8'-0"

8'-0"

8'-0"

8'-0"

8'-0"

8'-0"

8'-0"

8'-0"

8'-0"

8'-0"

8'-0"

8'-0"

8'-0"

8'-0"

8'-0"

8'-0"

8'-0"

8'-0"

8'-0"

8'-0"

8'-0"

8'-0"

8'-0"

8'-0"

8'-0"

8'-0"

8'-0"

8'-0"

8'-0"

8'-0"

8'-0"

8'-0"

8'-0"

8'-0"

8'-0"

8'-0"

8'-0"

8'-0"

8'-0"

8'-0"

8'-0"

8'-0"

8'-0"

8'-0"

8'-0"

8'-0"

8'-0"

8'-0"

8'-0"

8'-0"

8'-0"

8'-0"

8'-0"

8'-0"

8'-0"

8'-0"

8'-0"

8'-0"

8'-0"

8'-0"

8'-0"

8'-0"

8'-0"

8'-0"

8'-0"

8'-0"

8'-0"

8'-0"

8'-0"

8'-0"

8'-0"

8'-0"

8'-0"

8'-0"

8'-0"

8'-0"

8'-0"

8'-0"

8'-0"

8'-0"

8'-0"

8'-0"

8'-0"

8'-0"

8'-0"

8'-0"

8'-0"

8'-0"

8'-0"

8'-0"

8'-0"

8'-0"

8'-0"