



**Northwest Region**

4080-C Pike Lane  
Concord, CA 94520  
(510) 685-7852  
(800) 544-3422 *from inside California*  
(800) 423-7143 *from outside California*  
(510) 825-0720 (FAX)

Client Number: 020203325  
Project ID: 2350 Harrison St.  
Oakland, CA  
Work Order Number: C2-11-055

December 15, 1992

Tim Watchers/Sandra Lindsey  
Groundwater Technology, Inc.  
4057 Port Chicago Hwy.  
Concord, CA 94520

Enclosed please find the analytical results for samples received by GTEL Environmental Laboratories, Inc. on 11/04/92, under chain of custody record 25994.

A formal Quality Assurance/Quality Control (QA/QC) program is maintained by GTEL, which is designed to meet or exceed the EPA requirements. Analytical work for this project met QA/QC criteria, unless otherwise stated in the footnotes.

GTEL is certified by the California State Department of Health Services to perform analyses for drinking water, wastewater, and hazardous waste materials according to EPA protocols.

If you have any questions concerning this analysis or if we can be of further assistance, please call our Customer Service Representative.

Sincerely,

GTEL Environmental Laboratories, Inc.

Eileen F. Bullen  
Laboratory Director

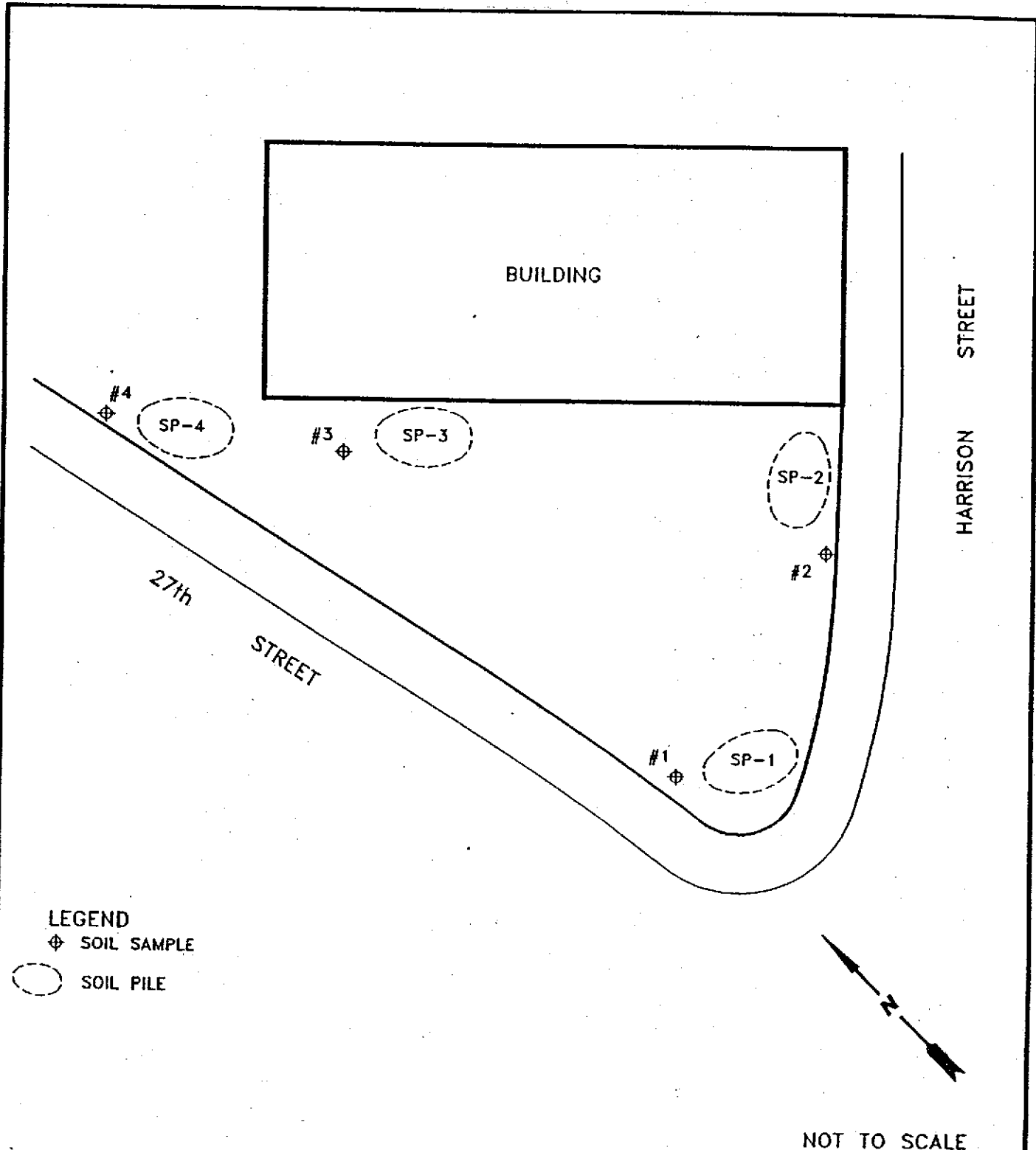

NOT TO SCALE

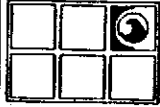

**GROUNDWATER TECHNOLOGY**  
 4057 PORT CHICAGO HWY.  
 CONCORD, CA 94520  
 (510) 671-2387

**SOIL SAMPLE LOCATION MAP**

CLIENT: <b>BURGE DEVELOPEMENT COMPANY</b>			LOCATION: <b>2350 HARRISON STREET OAKLAND, CALIFORNIA</b>		REV. NO.: <b>0</b>	DATE: <b>4/12/93</b>
PM	PE/RG	DESIGNED SL	DETAILED CY	ACAD FILE: <b>SSLM493</b>	PROJECT NO.: <b>020203768</b>	FIGURE: <b>1</b>

Client Number: 020203325  
 Project ID: 2350 Harrison St.  
 Oakland, CA  
 Work Order Number: C2-11-053

**Table 1**  
**ANALYTICAL RESULTS**  
 Aromatic Volatile Organics and  
 Total Petroleum Hydrocarbons as Gasoline in Soil  
 EPA Methods 5030, 8020, and Modified 8015<sup>a</sup>

GTEL Sample Number		01	02		
Client Identification		SOIL PILE 1	SOIL PILE 2		
Date Sampled		11/02/92	11/02/92		
Date Extracted		11/04/92	11/04/92		
Date Analyzed		11/05/92	11/05/92		
Analyte	Detection Limit, mg/Kg	Concentration, mg/Kg			
Benzene	0.005	<0.005	0.24		
Toluene	0.005	<0.005	0.31		
Ethylbenzene	0.005	<0.005	0.22		
Xylene, total	0.015	<0.015	2		
BTEX, total	--	--	3		
Gasoline	1	<1	89*		
Detection Limit Multiplier		1	1		
Percent solids		84	54		

- a. Test Methods for Evaluating Solid Waste, SW-846, Third Edition, Revision 0, US EPA November 1986. Modification for TPH as gasoline as per California State Water Resources Control Board LUFT Manual protocols, May 1988 revision. Results reported on a wet weight basis.
- \* Hydrocarbon pattern found is not characteristic of fresh gasoline possibly weathered gasoline.

Client Number: 020203325  
 Project ID: 2350 Harrison St.  
 Oakland, CA  
 Work Order Number: C2-11-055

Table 1

ANALYTICAL RESULTS

Total Oil and Grease in Soil  
 by Infrared Spectrometry

EPA 3550<sup>1</sup> (Mod.)/EPA 413.2<sup>2</sup>(SM 5520 C<sup>3</sup>)

GTEL Sample Number		01*	02*		
Client Identification		SOIL PILE 1	SOIL PILE 2		
Date Sampled		11/02/92	11/02/92		
Date Prepared		11/05/92	11/05/92		
Date Analyzed		11/05/92	11/05/92		
Analyte	Detection Limit, mg/Kg	Concentration, mg/Kg			
Total oil and grease	5	34	35		
Quantitation Limit Multiplier		1	1		

1. Test Methods for Evaluating Solid Waste, SW-846.
  2. Methods for Chemical Analysis of Water and Wastes, EPA 600/4-79-020, Revised March 1983, U.S. Environmental Protection Agency.
  3. Standard Methods for the Examination of Water and Wastewater, 17th ed., 1898, American Public Health Association.
- \* Although attempts were made to homogenize the samples, the analyst experienced inconsistencies in the results due to lumps of clay present non-uniformly in the samples.

Client Number: 020203325  
 Project ID: 2350 Harrison St.  
 Oakland, CA  
 Work Order Number: C2-11-054

**Table 1**  
**ANALYTICAL RESULTS**  
**Hydrocarbons in Soil**  
**Method: GC-FID<sup>a</sup>**

GTEL Sample Number		01	02		
Client Identification		SOIL PILE 1	SOIL PILE 2		
Date Sampled		11/02/92	11/02/92		
Date Extracted		11/05/92	11/05/92		
Date Analyzed		11/05/92	11/06/92		
Analyte	Detection Limit, mg/Kg	Concentration, mg/Kg			
Gasoline	10	<10	10*		
Mineral spirits	10	<10	<10		
Kerosine	10	<10	<10		
Jet fuel	10	<10	<10		
Diesel	10	<10	<10		
Fuel oil #6	10	<10	<10		
Lubricating oil	100	3200	<100		
Quantitation Limit Multiplier		1	1		
Percent solids		84	54		

- a. "Test Methods for Evaluating Solid Waste, SW-846, 3rd edition, Rev. O, U.S. EPA, November, 1986". Results reported on a wet weight basis.  
 \* Hydrocarbons in the range of gasoline, possibly degraded. As requested, additional analysis is being done to confirm.



4080 PIKE LANE, SUITE C  
CONCORD, CA 94520  
(510) 685-7852  
(800) 423-7143

CHAIN-OF-CUSTODY RECORD  
AND ANALYSIS REQUEST **25994**

ANALYSIS REQUEST

OTHER

Company Name: Groundwater Tech Phone #: 671-2387  
FAX #:  
Company Address: 1057 Point Chicago Hwy Site location: 2350 Harrison St., Oakland  
Project Manager: Tim Watcher/Sandra Lindsey Client Project ID: (#) (NAME) 020203325  
Attest that the proper field sampling procedures were used during the collection of these samples. Sampler Name (Print): Tim Watchers

Field Sample ID	GTEL Lab # (Lab use only)	# Containers	Matrix							Method Preserved							Sampling		BTEX/602 <input type="checkbox"/> 8020 <input type="checkbox"/> with MTBE <input type="checkbox"/>	BTEX/Gas Hydrocarbons PID/FID <input checked="" type="checkbox"/> with MTBE <input type="checkbox"/>	Hydrocarbons GC/FID Gas <input type="checkbox"/> Diesel <input checked="" type="checkbox"/> Screen <input checked="" type="checkbox"/>	Hydrocarbon Profile (SIMDIS) <input type="checkbox"/>	Oil and Grease 413.1 <input type="checkbox"/> 413.2 <input checked="" type="checkbox"/> SM 503 <input type="checkbox"/>	TPHIR 418.1 <input type="checkbox"/> SM 503 <input type="checkbox"/>	EDB by 504 <input type="checkbox"/> DBCP by 504 <input type="checkbox"/>	EPA 503.1 <input type="checkbox"/> EPA 502.2 <input type="checkbox"/>	EPA 601 <input type="checkbox"/> EPA 8010 <input type="checkbox"/>	EPA 602 <input type="checkbox"/> EPA 8020 <input type="checkbox"/>	EPA 608 <input type="checkbox"/> 8080 <input type="checkbox"/> PCB only <input type="checkbox"/>	EPA 624/PPL <input type="checkbox"/> 8240/TAL <input type="checkbox"/> NBS (+15) <input type="checkbox"/>	EPA 625/PPL <input type="checkbox"/> 8270/TAL <input type="checkbox"/> NBS (+25) <input type="checkbox"/>	EPA 610 <input type="checkbox"/> 8310 <input type="checkbox"/>	EP TOX Metals <input type="checkbox"/> Pesticides <input type="checkbox"/> Herbicides <input type="checkbox"/>	TCLP Metals <input type="checkbox"/> VOA <input type="checkbox"/> Semi-VOA <input type="checkbox"/> Pest <input type="checkbox"/> Herb <input type="checkbox"/>	EPA Metals - Priority Pollutant <input type="checkbox"/> TAL <input type="checkbox"/> RCRA <input type="checkbox"/>	CAM Metals TLIC <input type="checkbox"/> STLC <input type="checkbox"/>	Lead 239.2 <input type="checkbox"/> 200.7 <input type="checkbox"/> 7420 <input type="checkbox"/> 7421 <input type="checkbox"/> 6010 <input type="checkbox"/>	Organic Lead <input type="checkbox"/>	Corrosivity <input type="checkbox"/> Flash Point <input type="checkbox"/> Reactivity <input type="checkbox"/>										
			WATER	SOIL	AIR	SLUDGE	PRODUCT	OTHER	HCl	HNO <sub>3</sub>	H <sub>2</sub> SO <sub>4</sub>	ICE	UNPRESERVED	OTHER SPECIFY	DATE	TIME																																	
			<u>Soil pile 1</u>		1	<input checked="" type="checkbox"/>	<input type="checkbox"/>	<input type="checkbox"/>	<input checked="" type="checkbox"/>	<input type="checkbox"/>	<input type="checkbox"/>	<input type="checkbox"/>	<input type="checkbox"/>	<input type="checkbox"/>	<input type="checkbox"/>	<input type="checkbox"/>	<input type="checkbox"/>	<input type="checkbox"/>																						<input type="checkbox"/>	<input type="checkbox"/>	<input type="checkbox"/>	<input type="checkbox"/>	<input type="checkbox"/>	<input type="checkbox"/>	<input type="checkbox"/>	<input type="checkbox"/>	<input type="checkbox"/>	<input type="checkbox"/>
<u>Soil pile 2</u>		1	<input checked="" type="checkbox"/>	<input type="checkbox"/>	<input type="checkbox"/>	<input type="checkbox"/>	<input type="checkbox"/>	<input type="checkbox"/>	<input type="checkbox"/>	<input type="checkbox"/>	<input type="checkbox"/>	<input checked="" type="checkbox"/>	<input type="checkbox"/>	<input type="checkbox"/>	<input type="checkbox"/>	<input type="checkbox"/>	<input type="checkbox"/>	<input type="checkbox"/>	<input type="checkbox"/>	<input type="checkbox"/>	<input type="checkbox"/>	<input type="checkbox"/>	<input type="checkbox"/>	<input type="checkbox"/>	<input type="checkbox"/>	<input type="checkbox"/>	<input type="checkbox"/>	<input type="checkbox"/>	<input type="checkbox"/>	<input type="checkbox"/>	<input type="checkbox"/>	<input type="checkbox"/>	<input type="checkbox"/>	<input type="checkbox"/>	<input type="checkbox"/>	<input type="checkbox"/>	<input type="checkbox"/>	<input type="checkbox"/>	<input type="checkbox"/>	<input type="checkbox"/>	<input type="checkbox"/>	<input type="checkbox"/>	<input type="checkbox"/>	<input type="checkbox"/>	<input type="checkbox"/>	<input type="checkbox"/>	<input type="checkbox"/>	<input type="checkbox"/>	<input type="checkbox"/>

TAT  
Priority (24 hr)   
Expedited (48 hr)   
Business Days   
Other   
Business Days   
Special Handling  
GTEL Contact \_\_\_\_\_  
Quote/Contract # \_\_\_\_\_  
Confirmation # \_\_\_\_\_  
PO # \_\_\_\_\_  
QA / QC LEVEL  
BLUE  CLP  OTHER \_\_\_\_\_  
FAX

SPECIAL DETECTION LIMITS  
SPECIAL REPORTING REQUIREMENTS  
24 hr.

REMARKS  
24hr turnaround  
Lab Use Only Lot # \_\_\_\_\_ Storage Location: \_\_\_\_\_  
Work Order # \_\_\_\_\_

CUSTODY RECORD

Relinquished by Sampler: <u>L. Watcher</u>	Date <u>4/20/02</u>	Time <u>2:00 PM</u>	Received by:
Relinquished by:	Date	Time	Received by:
Relinquished by:	Date <u>4/20/02</u>	Time	Received by Laboratory: <u>Kathryn Blawie</u>