



Chevron

June 4, 1993

Chevron U.S.A. Products Company
2410 Camino Ramon
San Ramon, CA 94583

Marketing Department
Phone 510 842 9500

Mr. Edgar Howell
Alameda County Health Care Services
Department of Environmental Health
80 Swan Way, Room 200
Oakland, CA 94621

**Re: Former Chevron Service Station #9-1026
3701 Broadway, Oakland, CA**

Dear Mr. Howell:

Enclosed is the Groundwater Monitoring and Sampling Report dated April 20, 1993, prepared by our consultant Groundwater Technology, Inc. for the above referenced site. As indicated in the report, ground water samples collected were analyzed for total petroleum hydrocarbons as gasoline (TPH-G) and BTEX. Benzene was detected only in monitor wells A, B-1, B-2, and B-4 at concentrations of 820, 23, 28000, and 15000 ppb, respectively. Depth to ground water was measured at approximately 10.0 feet to 15.0 feet below grade and the direction of flow is to the south-southwest.

Separate phase hydrocarbons were observed in monitor wells B and B-3 at measured thicknesses of 0.03 feet and 1.08 feet, respectively. The appearance of separate phase hydrocarbons in these wells may be associated with rising ground water coming into contact with hydrocarbons trapped in the soil matrix. A weekly bailing program will be initiated to remove separate phase hydrocarbons from these wells.

We are currently re-evaluating remedial options for this site. As mentioned in correspondence from Chevron, we feel it would be beneficial to schedule a meeting with the assigned Hazardous Materials Specialist (formerly Gil Wistar) to discuss appropriate site specific corrective actions and establish mutual cleanup goals for the site. At this time we do not feel that ground water remediation is an appropriate corrective action to implement based on known upgradient sources of hydrocarbons in the ground water. Implementing remedial measures to address the contamination present in the ground water beneath the referenced site will not address the impacts from the upgradient sources as it is undetermined what extent has migrated beneath the Chevron site.

Chevron will continue to monitor and sample all wells at this site on a quarterly basis and begin weekly bailing of free phase product from monitor wells B and B-3.

If you have any questions or comments, please do not hesitate to contact me at (510) 842-8134.

Very truly yours,
CHEVRON U.S.A. PRODUCTS COMPANY

Mark A. Miller
Site Assessment and Remediation Engineer

Enclosure

cc: Mr. Rich Hiatt, RWQCB - Bay Area
Ms. B.C. Owen
File (9-1026 QM1)

Mr. W. Bruce Bercovich
Kay & Merkel
100 The Embarcadero, 3rd Floor
San Francisco, CA 94105

APR 22 '93 J.M.M.



GROUNDWATER TECHNOLOGY, INC.

4057 Port Chicago Highway, Concord, CA 94520 (415) 671-2387

FAX: (415) 685-9148

April 20, 1993

Project No. 020302539

Mr. Mark Miller
Chevron U.S.A. Products Company
PO Box 5004
San Ramon, CA 94583-0804

SUBJECT: Groundwater Monitoring and Sampling Report
Chevron Service Station No. 9-1026
3701 Broadway, Oakland, California

Dear Mr. Miller:

Groundwater Technology, Inc. presents the attached quarterly groundwater monitoring and sampling data collected on March 19, 1993. The 10 groundwater monitoring wells at this site were gauged to measure depth to groundwater (DTW) and to check for the presence of separate-phase hydrocarbons. Separate-phase hydrocarbons were detected in monitoring wells B and B-3. A potentiometric surface map (Figure 1) and a summary of groundwater monitoring data (Table 1) are presented in Attachments 1 and 2, respectively. After the DTW was measured, each monitoring well was purged and sampled except wells B and B-3. The groundwater samples were analyzed for benzene, toluene, ethylbenzene, and xylenes and total petroleum hydrocarbons-as-gasoline. Results of the chemical analyses are summarized in Table 1. The laboratory report and chain-of-custody record are included in Attachment 3. Monitoring well purge water was transported by Groundwater Technology, Inc. to the Chevron Terminal in Richmond, California for recycling.

Groundwater Technology, Inc. is pleased to assist Chevron on this project. If you have any questions or comments, please call our Concord office.

Sincerely,
Groundwater Technology, Inc.
Written/Submitted by

Groundwater Technology, Inc.
Reviewed/Approved by



Tim Watchers
Project Geologist



David R. Kleesattel
Registered Geologist
No. 5136

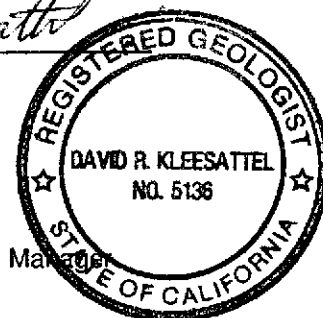

Attachment 1 Figure
Attachment 2 Table
Attachment 3 Laboratory Report

For:
John S. Gaines
Vice President, General Manager
West Region

LR2539A1.NM

ATTACHMENT 1

FIGURE

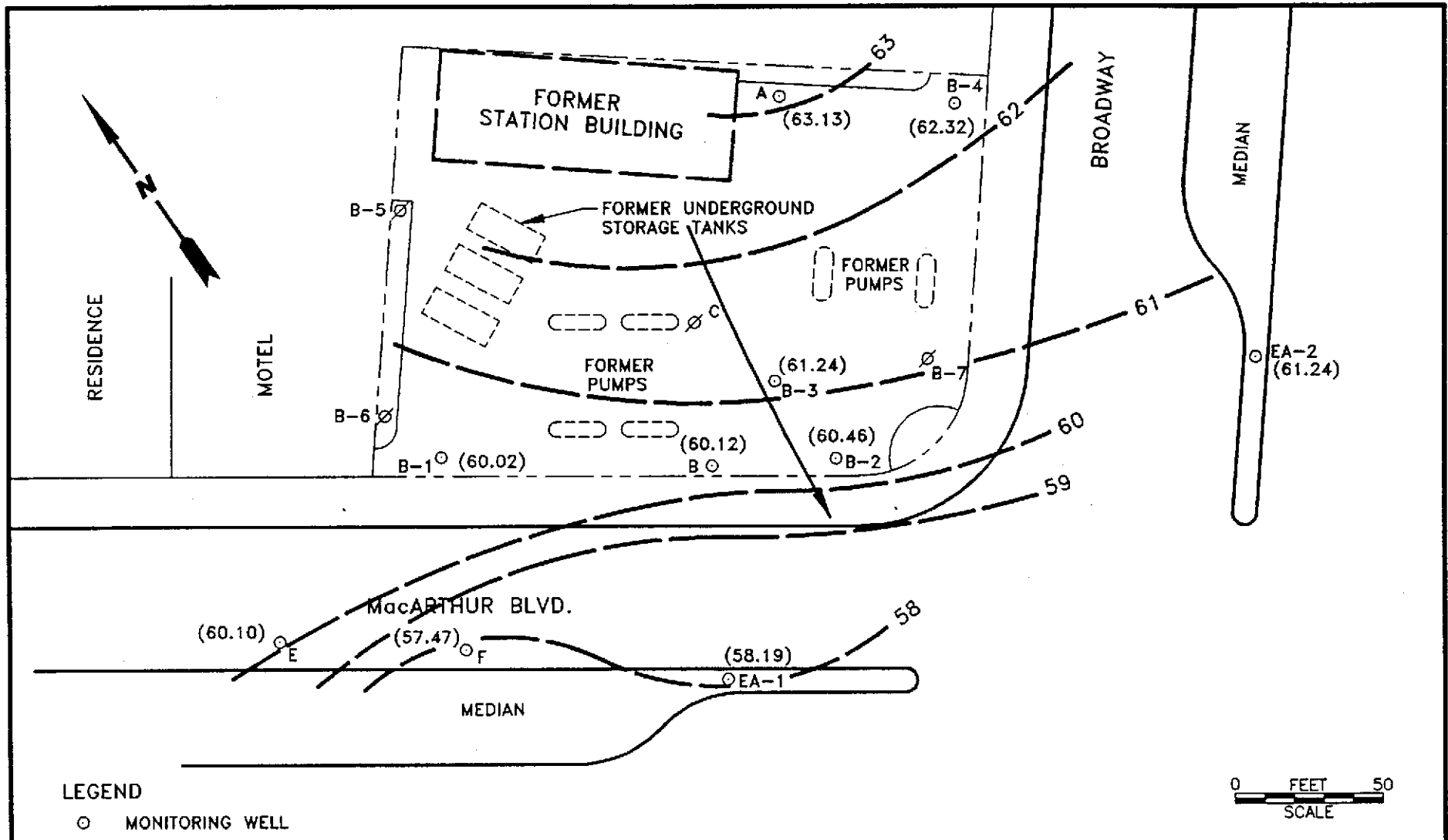

LEGEND

- MONITORING WELL
- ⊘ ABANDONED WELL
- () POTENTIOMETRIC SURFACE ELEVATION
- POTENTIOMETRIC SURFACE CONTOUR
- GROUNDWATER FLOW DIRECTION



GROUNDWATER TECHNOLOGY
 4057 PORT CHICAGO HWY
 CONCORD, CA 94520
 (510) 671-2387

**POTENTIOMETRIC SURFACE MAP
 (3/19/93)**

CLIENT:
CHEVRON U.S.A. PRODUCTS CO.
 SERVICE STATION No. 9-1026

LOCATION:
 3701 BROADWAY
 OAKLAND, CALIFORNIA

REV. NO.: 1
 DATE: 4/15/93

PM <i>faw</i>	PE/RG <i>DRK</i>	DESIGNED TW	DETAILED CY
------------------	---------------------	----------------	----------------

ACAD FILE:
 PSM493

PROJECT NO.:
 020202782

FIGURE:
 1

ATTACHMENT 2

TABLE

TABLE 1
HISTORICAL GROUNDWATER ANALYTICAL RESULTS AND MONITORING DATA
Chevron Service Station No. 9-1026
3701 Broadway, Oakland, California

Well ID/ Elev	Date	TPH-as- Gasoline	Benzene	Toluene	Ethyl- benzene	Xylenes	DTW (ft)	SPT (ft)	WTE (ft)
A 75.28	05/09/89	11,000	260	<2	94	230	13.92	0.00	61.36
	08/09/89	12,000	370	<1.5	100	240	15.62	0.00	59.66
	11/09/89	16,000	690	10	180	350	15.95	0.00	59.33
	02/08/90	14,000	600	7	120	270	14.73	0.00	60.55
	05/10/90	16,000	840	4.8	140	340	15.48	0.00	59.80
	08/09/90	17,000	510	40.0	170	280	15.66	0.00	59.62
	11/13/90	9,000	570	3.1	86	170	16.48	0.00	58.80
	03/27/91	8,000	660	<5	110	250	---	---	---
	04/05/91	---	---	---	---	---	13.22	0.00	62.06
	06/19/91	8,900	740	<3	120	280	15.37	0.00	59.91
	08/21/91	6,800	620	23	85	200	15.99	0.00	59.29
	11/08/91	4,000	640	<5	77	160	16.15	0.00	59.13
	02/13/92	8,000	860	<5	120	390	14.58	0.00	60.70
	05/01/92	13,000	870	19	220	780	14.26	0.00	61.02
75.29	11/18/92	12,000	1,500	83	360	530	16.38	0.00	58.91
	03/19/93	14,000	820	6.1	180	420	12.16	0.00	63.13
B 73.39	05/09/89	---	---	---	---	---	13.97	0.20	59.58
	08/09/89	---	---	---	---	---	15.69	0.20	57.86
	11/09/89	---	---	---	---	---	15.29	0.08	58.16
	02/08/90	---	---	---	---	---	14.46	0.00	58.93
	05/10/90	---	---	---	---	---	15.07	0.00	58.32
	08/09/90	---	---	---	---	---	15.12	0.00	58.27
	11/13/90	---	---	---	---	---	15.76	0.00	57.63
	04/05/91	---	---	---	---	---	13.38	0.00	60.01
	06/19/91	26,000	7,100	370	430	1,000	15.14	0.00	58.25
	08/21/91	16,000	4,900	270	390	640	15.58	0.00	57.81
	11/08/91	11,000	2,400	48	280	160	15.71	0.00	57.68
	02/13/92	6,800	2,400	60	220	140	14.66	0.00	58.73
	05/01/92	16,000	6,000	180	370	460	14.50	Sheen	58.89
	11/18/92	28,000	2,200	150	920	4,300	15.60	0.00	57.79
03/19/93	---	---	---	---	---	13.29	0.03	60.12	
B-1 71.77	05/09/89	16,000	2,300	260	81	740	12.58	0.00	59.19
	08/09/89	12,000	2,600	340	100	870	14.09	0.00	57.68
	11/09/89	17,000	340	140	110	760	14.06	0.00	57.71
	02/08/90	5,500	70	19	17	150	12.65	0.00	59.12
	05/10/90	18,000	770	110	73	600	13.62	0.00	58.15
	08/09/90	82,000	750	66	95	980	13.87	0.00	57.90
	11/13/90	43,000	1,300	120	74	760	14.38	0.00	57.39
	03/27/91	18,000	580	92	94	770	---	---	---
	04/05/91	---	---	---	---	---	11.73	0.00	60.04
	06/19/91	21,000	910	56	96	810	13.56	0.00	58.21
	08/21/91	50,000	2,400	610	300	1,800	13.90	0.00	57.87
	11/08/91	540,000	3,600	1,500	1,900	5,900	14.05	0.00	57.72
	02/13/92	20,000	500	100	150	920	12.68	0.00	59.09
	05/01/92	27,000	2,800	200	310	1,900	12.92	Sheen	58.85
72.30	11/18/92	300	9.7	3.4	2.3	21	14.30	0.00	58.00
	03/19/93	130	23	0.9	<0.5	5.6	12.28	0.00	60.02

TABLE 1
HISTORICAL GROUNDWATER ANALYTICAL RESULTS AND MONITORING DATA
Chevron Service Station No. 9-1026
3701 Broadway, Oakland, California

Well ID/ Elev	Date	TPH-as- Gasoline	Benzene	Toluene	Ethyl- benzene	Xylenes	DTW (ft)	SPT (ft)	WTE (ft)
B-2 74.51	05/09/89	170,000	30,000	8,400	2,300	12,000	14.58	0.00	59.93
	08/09/89	60,000	29,000	8,700	2,400	12,000	16.06	0.00	58.45
	11/09/89	110,000	32,000	5,500	2,800	12,000	16.95	0.00	57.56
	02/08/90	67,000	28,000	5,900	2,300	11,000	15.56	0.00	58.95
	05/10/90	69,000	24,000	4,800	2,000	11,000	15.94	0.00	58.57
	08/09/90	100,000	33,000	4,000	2,100	12,000	15.97	0.00	58.54
	11/13/90	110,000	33,000	4,300	2,900	13,000	16.70	0.00	57.81
	03/27/91	160,000	26,000	3,200	2,600	15,000	—	—	—
	04/05/91	—	—	—	—	—	14.20	0.00	60.31
	06/19/91	100,000	22,000	2,500	2,000	11,000	15.83	0.00	58.68
	08/21/91	80,000	28,000	2,800	2,400	12,000	16.31	0.00	58.20
	11/08/91	94,000	29,000	1,900	2,200	11,000	16.60	0.00	57.91
	02/13/92	280,000	34,000	2,500	4,600	23,000	15.93	0.00	58.58
	05/01/92	29,000	1,700	300	1,100	4,300	14.94	Sheen	59.57
74.52	11/18/92	26,000	11,000	170	870	950	16.71	0.00	57.81
	03/19/93	110,000	28,000	1,200	2,200	12,000	14.06	0.00	60.46
B-3 74.12	05/09/89	70,000	12,000	9,500	1,400	8,900	14.02	0.00	60.01
	08/09/89	—	—	—	—	—	15.38	0.00	58.74
	11/09/89	—	—	—	—	—	15.55	0.05	58.61
	02/08/90	—	—	—	—	—	14.68	<0.01	59.44
	05/10/90	—	—	—	—	—	15.15	0.02	58.99
	08/09/90	—	—	—	—	—	15.27	<0.01	58.85
	11/13/90	—	—	—	—	—	16.04	0.06	58.13
	04/05/91	—	—	—	—	—	13.30	<0.01	60.82
	06/19/91	260,000	20,000	9,000	2,200	16,000	15.16	0.00	58.96
	08/21/91	70,000	28,000	11,000	1,800	11,000	15.61	0.00	58.51
	11/08/91	150,000	29,000	9,700	2,200	13,000	15.77	0.00	58.35
	02/13/92	100,000	27,000	9,906	2,000	11,000	14.88	0.00	59.24
	05/01/92	—	—	—	—	—	14.20	0.01	59.93
	74.13	11/18/92	—	—	—	—	—	15.68	0.03
03/19/93		—	—	—	—	—	13.75	1.08	61.24
B-4 76.43	05/09/89	3,600	840	34	120	200	14.93	0.00	61.50
	08/09/89	<500	4,200	130	370	260	16.65	0.00	59.78
	11/09/89	5,000	4,200	83	400	250	—	—	—
	02/08/90	14,000	6,000	70	530	300	16.99	0.00	59.44
	05/10/90	12,000	5,400	130	460	320	16.05	0.00	60.38
	08/09/90	16,000	7,400	120	530	350	16.49	0.00	59.94
	11/13/90	21,000	7,000	100	550	320	16.64	0.00	59.79
	03/27/91	17,000	8,500	120	500	300	17.42	0.00	59.01
	04/05/91	14,000	7,700	75	610	210	14.66	0.00	61.77
	06/19/91	16,000	7,800	110	550	340	16.48	0.00	59.95
	08/21/91	18,000	11,000	110	450	340	17.00	0.00	59.43
	11/08/91	18,000	6,800	98	500	620	17.38	0.00	59.05
	02/13/92	15,000	9,100	86	570	350	16.42	0.00	60.01
	05/01/92	36,000	16,000	180	990	690	15.50	0.00	60.93
	03/19/93	26,000	15,000	150	900	790	14.11	0.00	62.32

TABLE 1
HISTORICAL GROUNDWATER ANALYTICAL RESULTS AND MONITORING DATA
Chevron Service Station No. 9-1026
3701 Broadway, Oakland, California

Well ID/ Elev	Date	TPH-as- Gasoline	Benzene	Toluene	Ethyl- benzene	Xylenes	DTW (ft)	SPT (ft)	WTE (ft)
B-6 72.66	05/09/89	26,000	120	110	250	1,300	12.11	0.00	60.55
	08/09/89	19,000	470	150	440	1,400	14.72	0.00	57.94
	11/09/89	13,000	70	36	36	440	13.85	0.00	58.81
	02/08/90	2,900	16	5	10	58	7.73	0.00	64.93
	05/10/90	---	---	---	---	---	---	---	---
	08/09/90	14,000	55	3	130	500	14.51	0.00	58.15
	11/13/90	---	---	---	---	---	14.86	0.00	57.80
	04/05/91	---	---	---	---	---	10.43	0.00	62.23
	06/19/91	Abandoned	---	---	---	---	---	---	---
B-7 75.40	05/09/89	210,000	13,000	19,000	2,000	20,000	14.73	0.00	60.67
	08/09/89	672,000	8,700	17,000	2,700	30,000	16.36	0.00	59.04
	11/09/89	150,000	7,000	12,000	1,800	16,000	16.64	0.00	58.76
	02/08/90	41,000	2,500	6,900	1,100	11,000	15.69	0.00	59.71
	05/10/90	---	---	---	---	---	---	---	---
	08/09/90	50,000	1,100	3,900	640	7,200	16.31	0.00	59.09
	11/13/90	---	---	---	---	---	17.09	0.00	58.31
	04/05/91	---	---	---	---	---	14.36	0.00	61.04
	06/19/91	Abandoned	---	---	---	---	---	---	---
E 70.07	11/18/92	280	2.7	2.4	3.0	12	12.20	0.00	57.87
	03/19/93	<50	<0.5	<0.5	<0.5	<1.5	9.97	0.00	60.10
EA-1 73.94	05/09/89	<500	<0.5	<0.5	<0.5	<0.5	14.56	0.00	59.38
	08/09/89	<500	<0.5	<0.5	<0.5	<0.5	16.09	0.00	57.85
	11/09/89	<500	<0.5	<0.5	<0.5	<0.5	15.84	0.00	58.10
	02/08/90	<50	<0.3	<0.3	<0.3	<0.6	15.05	0.00	58.89
	05/10/90	<50	1	<0.3	<0.3	<0.6	15.65	0.00	58.29
	08/09/90	<50	<0.3	<0.3	<0.3	<0.6	15.67	0.00	58.27
	11/13/90	<50	<0.4	<0.3	<0.3	<0.4	16.32	0.00	57.62
	03/27/91	<50	0.7	<0.5	<0.5	<0.5	---	---	---
	04/05/91	---	---	---	---	---	14.03	0.00	59.91
	06/19/91	<50	<0.5	<0.5	<0.5	<0.5	15.56	0.00	58.38
	08/21/91	<50	<0.4	<0.3	<0.3	<0.4	15.99	0.00	57.95
	11/08/91	<50	<0.5	<0.5	<0.5	<0.5	16.13	0.00	57.81
	02/13/92	<50	<0.5	<0.5	<0.5	<0.5	15.10	0.00	58.84
	05/01/92	<50	2.7	<0.5	<0.5	<0.5	18.80	0.00	55.14
11/18/92	<10	<0.3	<0.3	<0.3	<0.5	15.97	0.00	55.88	
03/19/93	<50	<0.5	<0.5	<0.5	<1.5	13.66	0.00	58.19	
EA-2 75.24	05/09/89	760	<0.5	<0.5	1.1	<0.5	15.95	0.00	59.29
	08/09/89	<500	<0.5	<0.5	<0.5	<0.5	17.45	0.00	57.79
	11/09/89	<500	<0.5	1	<0.5	<0.5	17.41	0.00	57.83
	02/08/90	190	<0.3	<0.3	<0.3	<0.6	16.57	0.00	58.67
	05/10/90	<50	<0.3	<0.3	<0.3	<0.6	17.12	0.00	58.12
	08/09/90	120	<0.3	<0.3	<0.3	<0.6	17.20	0.00	58.04
	11/13/90	160	<0.4	1.0	<0.3	<0.4	17.88	0.00	57.36
	03/27/91	110	<0.5	<0.5	<0.5	<0.5	---	---	---
	04/05/91	---	---	---	---	---	15.54	0.00	59.70
	06/19/91	<50	<0.5	<0.5	<0.5	<0.5	17.07	0.00	58.17
	08/21/91	70	0.8	1.4	<0.3	<0.4	17.46	0.00	57.78
	11/08/91	<50	<0.5	0.7	<0.5	<0.5	17.58	0.00	57.66
	02/13/92	<50	<0.5	<0.5	<0.5	<0.5	16.69	0.00	58.55
	05/01/92	340	<0.5	2.6	0.7	<0.5	16.16	0.00	59.08
	11/18/92	450	<0.5	3.3	<0.5	0.8	17.61	0.00	58.63
	03/19/93	450	<0.5	2.3	0.6	<1.5	15.00	0.00	61.24

TABLE 1
HISTORICAL GROUNDWATER ANALYTICAL RESULTS AND MONITORING DATA
Chevron Service Station No. 9-1026
3701 Broadway, Oakland, California

Well ID/ Elev	Date	TPH-as- Gasoline	Benzene	Toluene	Ethyl- benzene	Xylenes	DTW (ft)	SPT (ft)	WTE (ft)
F 72.01	05/09/89	<500	<0.5	<0.5	0.6	1.0	18.70	0.00	53.31
	08/09/89	---	---	---	---	---	19.03	0.00	52.98
	11/09/89	---	---	---	---	---	19.02	0.00	52.99
	02/08/90	<50	0.4	<0.3	0.3	<0.6	18.70	0.00	53.31
	05/10/90	---	---	---	---	---	18.98	0.00	53.03
	08/09/90	---	---	---	---	---	18.95	0.00	53.06
	11/13/90	---	---	---	---	---	19.10	0.00	52.91
	03/27/91	64	<0.5	<0.5	<0.5	1	---	---	---
	06/19/91	---	---	---	---	---	18.95	0.00	53.06
	08/21/91	---	---	---	---	---	>19.94	0.00	<52.07
	11/08/91	---	---	---	---	---	>19.94	0.00	<52.07
	02/13/92	<50	<0.5	<0.5	<0.5	<0.5	18.60	0.00	53.41
	05/01/92	---	---	---	---	---	Dry	---	---
71.72	11/18/92	<50	<0.5	<0.5	<0.5	<0.5	14.85	0.00	56.87
	03/19/93	<50	<0.5	<0.5	<0.5	<1.5	14.25	0.00	57.47
Travel Blank	05/09/89	<500	<0.5	<0.5	<0.5	<0.5	---	---	---
	08/09/89	<500	<0.5	<0.5	<0.5	<0.5	---	---	---
	11/09/89	<500	<0.5	<0.5	<0.5	<0.5	---	---	---
	02/08/90	<50	<0.3	<0.3	<0.3	<0.6	---	---	---
	05/10/90	<50	<0.3	<0.3	<0.3	<0.6	---	---	---
	08/09/90	<50	<0.3	<0.3	<0.3	<0.6	---	---	---
	11/13/90	<50	<0.4	<0.3	<0.3	<0.4	---	---	---
	03/27/91	<50	<0.5	<0.5	<0.5	<0.5	---	---	---
	06/19/91	<50	<0.5	<0.5	<0.5	<0.5	---	---	---
	08/21/91	<50	<0.4	<0.3	<0.3	<0.4	---	---	---
	11/08/91	<50	<0.5	<0.5	<0.5	<0.5	---	---	---
	02/13/92	<50	<0.5	<0.5	<0.5	<0.5	---	---	---
	05/01/92	<50	<0.5	<0.5	<0.5	<0.5	---	---	---
	11/18/92	<50	<0.5	<0.5	<0.5	<0.5	---	---	---
03/19/93	<50	<0.5	<0.5	<0.5	<1.5	---	---	---	

--- = Not applicable, not sampled, not measured
 TPH = Total petroleum hydrocarbons
 DTW = Depth to groundwater
 SPT = Separate-phase hydrocarbon thickness
 WTE = Water-table elevation

Data from May 9, 1989, through February 13, 1992, taken from First Quarter 1992 Groundwater Monitoring Report, dated February 28, 1992 (Weiss Associates).
 All elevations are given as feet above mean sea level.
 Concentrations shown in parts per billion.

ATTACHMENT 3
LABORATORY REPORT

LR2539A1.NM



Superior Precision Analytical, Inc.

825 Arnold Drive, Suite 114 • Martinez, California 94553 • (510) 229-1512 / fax (510) 229-1526

GROUNDWATER TECHNOLOGY, INC.
Attn: Sandra Lindsey

Project 020302539.061004
Reported 03/26/93

TOTAL PETROLEUM HYDROCARBONS

Lab #	Sample Identification	Sampled	Analyzed Matrix
88116- 1	TB-LB	03/19/93	03/25/93 Soil
88116- 2	RBEA-1	03/19/93	03/24/93 Water
88116- 3	EA-1	03/19/93	03/24/93 Water
88116- 5	F	03/19/93	03/23/93 Water
88116- 7	E	03/19/93	03/23/93 Water
88116- 9	B1	03/19/93	03/24/93 Water
88116-11	EA2	03/19/93	03/23/93 Water
88116-13	A	03/19/93	03/24/93 Water
88116-15	B-2	03/19/93	03/25/93 Water
88116-17	B-4	03/19/93	03/25/93 Water

RESULTS OF ANALYSIS

Laboratory Number: 88116- 1 88116- 2 88116- 3 88116- 5 88116- 7

Gasoline:	ND<50	ND<50	ND<50	ND<50	ND<50
Benzene:	ND<0.5	ND<0.5	ND<0.5	ND<0.5	ND<0.5
Toluene:	ND<0.5	ND<0.5	ND<0.5	ND<0.5	ND<0.5
Ethyl Benzene:	ND<0.5	ND<0.5	ND<0.5	ND<0.5	ND<0.5
Xylenes:	ND<1.5	ND<1.5	ND<1.5	ND<1.5	ND<1.5

Concentration: ug/L ug/L ug/L ug/L ug/L

Laboratory Number: 88116- 9 88116-11 88116-13 88116-15 88116-17

Gasoline:	130	450	14000	110000	26000
Benzene:	23	ND<0.5	820	28000	15000
Toluene:	0.9	2.3	6.1	1200	150
Ethyl Benzene:	ND<0.5	0.6	180	2200	900
Xylenes:	5.6	ND<1.5	420	12000	790

Concentration: ug/L ug/L ug/L ug/L ug/L



Superior Precision Analytical, Inc.

825 Arnold Drive, Suite 114 • Martinez, California 94553 • (510) 229-1512 / fax (510) 229-1526

C E R T I F I C A T E O F A N A L Y S I S

ANALYSIS FOR TOTAL PETROLEUM HYDROCARBONS

Page 2 of 2
QA/QC INFORMATION
SET: 88116

NA = ANALYSIS NOT REQUESTED
ND = ANALYSIS NOT DETECTED ABOVE QUANTITATION LIMIT
ug/L = parts per billion (ppb)

OIL AND GREASE ANALYSIS By Standard Methods Method 5520F:
Minimum Detection Limit in Water: 5000ug/L

Modified EPA SW-846 Method 8015 for Extractable Hydrocarbons:
Minimum Quantitation Limit for Diesel in Water: 50ug/L

EPA SW-846 Method 8015/5030 Total Purgable Petroleum Hydrocarbons:
Minimum Quantitation Limit for Gasoline in Water: 50ug/L

EPA SW-846 Method 8020/BTXE
Minimum Quantitation Limit in Water: 0.5ug/L

ANALYTE	MS/MSD RECOVERY	RPD	CONTROL LIMIT
Gasoline:	107/117	9%	70-130
Benzene:	100/102	2%	70-130
Toluene:	97/101	4%	70-130
Ethyl Benzene:	101/106	5%	70-130
Xylenes:	101/105	4%	70-130

Richard Srna, Ph.D.

Atsouch. Salinas
Laboratory Director

Fax copy of Lab Report and COC to Chevron Contact: Yes No

87116

Chain-of-Custody-Record

Chevron U.S.A. Inc.
P.O. BOX 5004
San Ramon, CA 94583
FAX (415)842-9591

Chevron Facility Number 9-1026
Facility Address 3701 Broadway, Oakland
Consultant Project Number 020302539.061004
Consultant Name Groundwater Technology, Inc.
Address 4057 Port Chicago Hwy, Concord, CA
Project Contact (Name) Ms. Sandra L. Lindsey
(Phone) 671-2387 (Fax Number) 685-9148

Chevron Contact (Name) Ms. Nancy Vukelich
(Phone) 510-842-9581
Laboratory Name Superior Analytical
Laboratory Release Number 495-0430
Samples Collected by (Name) Hector Merino
Collection Date 3/19/93
Signature [Signature]

Sample Number	Lab Sample Number	Number of Containers	Matrix S = Soil W = Water A = Air C = Charcoal	Type G = Grab C = Composite D = Discrete	Time	Sample Preservation	Iced (Yes or No)	Analyses To Be Performed										Remarks	
								BTEX + TPH GAS (8020 + 8015)	TPH Diesel (8015)	Oil and Grease (5520)	Purgeable Halocarbons (8010)	Purgeable Aromatics (8020)	Purgeable Organics (8240)	Extractable Organics (8270)	Metals Cd, Cr, Pb, Zn, Ni (ICAP or AA)				
FB-LB	1	1	W	G			Yes	X											
BEA-1	2	1			12:30			X											
EA-1	3	3			12:30			X											
BE	4	1			12:40														
E	5	3			12:40			X											
BE	6	1			12:50														
E	7	3			12:50			X											
BE-B1	8	1			2:45														
B1	9	3			2:45			X											
BEA-2	10	1			2:55														
EA-2	11	3			2:55			X											
BEA	12	1			3:05														
A	13	3			3:05			X											

Please initial: _____
 Samples Stored in Ice: _____
 Appropriate containers: _____
 Samples preserved: _____
 VOA's without headspace: _____
 Comments: _____

Relinquished By (Signature) <u>[Signature]</u>	Organization <u>GTI</u>	Date/Time <u>3/19/93</u>	Received By (Signature) <u>[Signature]</u>	Organization <u>[Blank]</u>	Date/Time <u>[Blank]</u>	Turn Around Time (Circle Choice) 24 Hrs. 48 Hrs. 6 Days 10 Days <u>As Contracted</u>
Relinquished By (Signature)	Organization	Date/Time	Received By (Signature)	Organization	Date/Time	
Relinquished By (Signature)	Organization	Date/Time	Released For Laboratory By (Signature) <u>[Signature]</u>		Date/Time <u>3-19 4:45 pm</u>	

