

January 14, 2004

Scott Seery
Alameda County Health Care Services Agency
1131 Harbor Bay Parkway, Suite 250
Alameda, California 94502-6577

Subject: Shell-branded Service Station
29 Wildwood Avenue
Piedmont, California

Dear Mr. Seery:

Attached for your review and comment is a copy of the *Fourth Quarter 2003 Monitoring Report* for the above referenced site. Upon information and belief, I declare, under penalty of perjury, that the information contained in the attached document is true and correct.

As always, please feel free to contact me directly at (559) 645-9306 with any questions or concerns.

Sincerely,

Shell Oil Products US



Karen Petryna
Sr. Environmental Engineer

January 14, 2004

Scott Seery
Alameda County Health Care Services Agency
1131 Harbor Bay Parkway, Suite 250
Alameda, California 94502-6577

Re: **Fourth Quarter 2003 Monitoring Report**
Shell-branded Service Station
29 Wildwood Avenue
Piedmont, California
Incident #98995822
Cambria Project# 246-0687-002



Dear Mr. Seery:

On behalf of Equilon Enterprises LLC dba Shell Oil Products US (Shell), Cambria Environmental Technology, Inc. (Cambria) is submitting this groundwater monitoring report in accordance with the reporting requirements of 23 CCR 2652d.

FOURTH QUARTER 2003 ACTIVITIES

Groundwater Monitoring: Blaine Tech Services, Inc. (Blaine) of San Jose, California measured dissolved oxygen (DO) concentrations, gauged and sampled all site wells, calculated groundwater elevations, and compiled the analytical data. Cambria prepared a vicinity map that includes previously submitted well survey information (Figure 1) and a groundwater elevation contour map (Figure 2). Blaine's report, presenting the laboratory report and supporting field documents, is included as Attachment A.

May 16, 2003 Agency Letter: The Alameda County Health Care Services Agency's May 16, 2003 letter directed Shell to continue analyzing all groundwater monitoring samples for the fuel oxygenates methyl tertiary butyl ether (MTBE), tert amyl methyl ether (TAME), ethyl tert butyl ether (ETBE), di-isopropyl ether (DIPE), and tert butyl alcohol (TBA) by EPA Method 8260 until further notice. During this quarter, samples from all wells were analyzed for these target analytes. Cambria has tabulated all historical oxygenate analytical data (Table 1). Results of all oxygenate analyses to date indicate that TAME was previously detected only in the October 2002 sample from well MW-3 at a concentration of 7.4 parts per billion (ppb). TBA has previously been detected in only MW-2 and MW-3. The current results indicate TBA is not present in any site wells above the reporting limits.

**Cambria
Environmental
Technology, Inc.**

5900 Hollis Street
Suite A
Emeryville, CA 94608
Tel (510) 420-0700
Fax (510) 420-9170

The October 2001 and July 2003 samples from wells MW-2 and MW-3 were also analyzed for ethanol, and ethanol was previously detected only in MW-2. The MW-2 ethanol results were 150,000 ppb in October 2001 and 7,000 ppb in July 2003. The current samples from MW-2 and MW-3 were analyzed for ethanol, and it was not detected above the reporting limits. The October 2002 samples from all wells were analyzed for the lead scavengers 1,2-dichloroethane (1,2-DCA) and ethylene dibromide (EDB). 1,2-DCA and EDB were below reporting limits for all samples.

The laboratory results of the sample from well MW-5 contained "discrete peaks" on the sample chromatogram. The laboratory identified the chemicals as tetrachloroethene, trichloroethene, and cis-1,2-dichloroethene. These chemicals have been previously detected in samples from MW-4 and MW-5, as reported in prior monitoring reports.

August 2003 Well Survey and Site Conceptual Model Report: Cambria submitted the agency-requested well survey and site conceptual model report on August 14, 2003. To date, no response or comments on the report have been received.

ANTICIPATED FIRST QUARTER 2004 ACTIVITIES

Groundwater Monitoring: Blaine will measure DO, gauge and sample all site wells, and tabulate the data. Cambria will submit a monitoring report by April 15, 2004.

Additional Oxygenate Analysis: Groundwater samples from all monitoring wells will be analyzed for four additional oxygenates (TAME, ETBE, DIPE, TBA) in addition to the regular analysis for total petroleum hydrocarbons as gasoline, benzene, toluene, ethylbenzene, total xylenes, and MTBE. Samples from wells MW-2 and MW-3 will also be analyzed for ethanol. The results will be included in the monitoring report.

CLOSING

We appreciate the opportunity to work with you on this project. Please call Matt Derby at (510) 420-3332 if you have any questions or comments.

Sincerely,
Cambria Environmental Technology, Inc



Anni Kreml
Senior Staff Scientist

Matthew W. Derby, P.E.
Senior Project Manager



Figures: 1 - Vicinity/Area Well Survey Map
2 - Groundwater Elevation Contour Map

Table: 1 - Groundwater Analytical Data - Oxygenates

Attachment: A - Blaine Groundwater Monitoring Report and Field Notes

cc: Karen Petryna, Shell Oil Products US, 20945 South Wilmington, Carson, CA 90810

G:\Piedmont 29 Wildwood\QM\4q03\4q03qm.doc

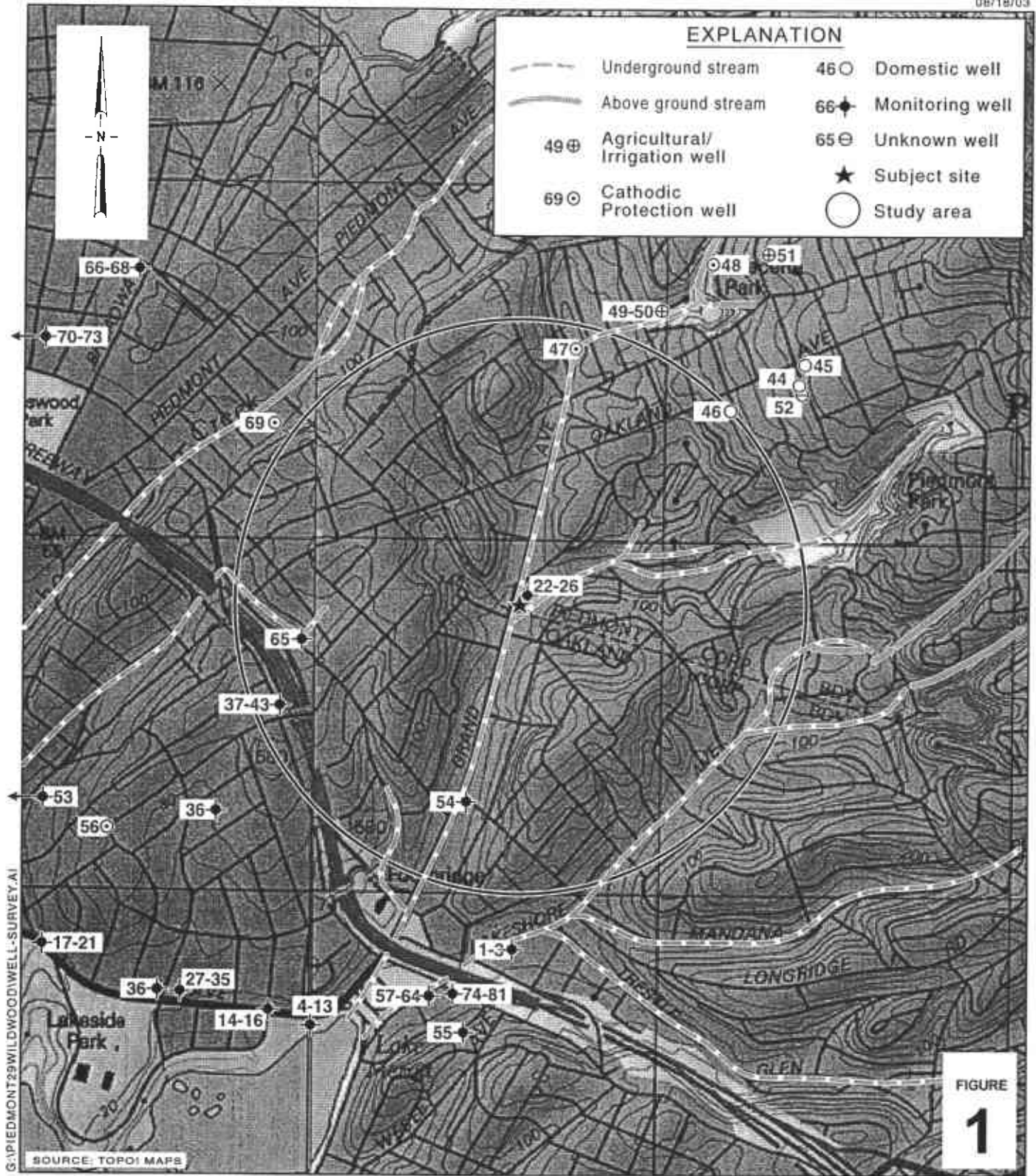

Shell-branded Service Station

29 Wildwood Avenue
Piedmont, California
Incident #98995822



C A M B R I A

Vicinity/Area Well Survey Map

1/2 Mile Radius

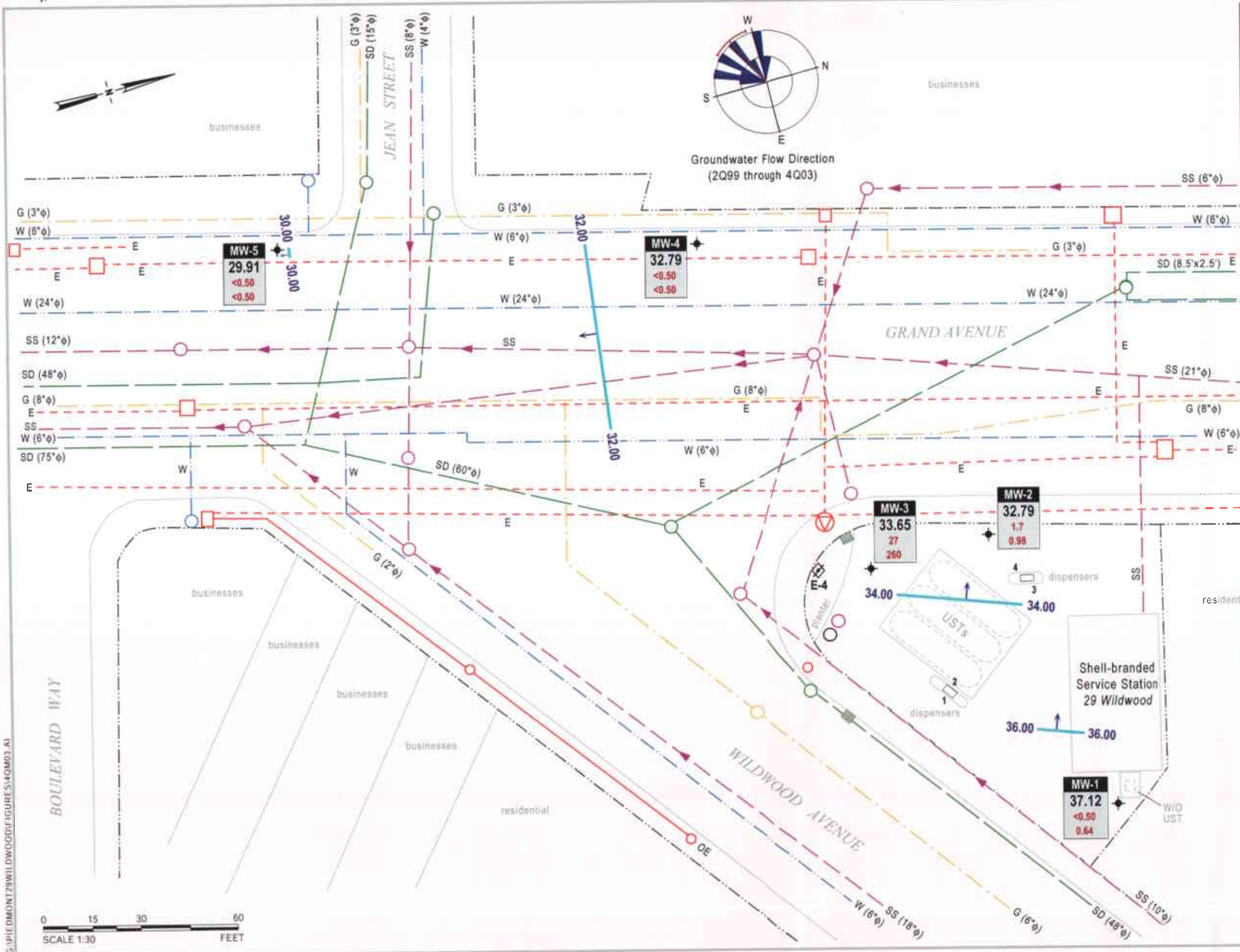

EXPLANATION

- MW-1 Monitoring well
- E-4 Destroyed flowing artesian monitoring well
- Groundwater flow direction
- XX.XX Groundwater elevation contour, in feet above mean sea level (msl), approximately located; dashed where inferred

Well

- ELEV Groundwater elevation, in feet above msl
- Benzene Benzene and MTBE concentrations are in parts per billion and are analyzed by EPA Method 8260.
- MTBE

- Storm drain line (SD)
- Storm drain line (SD) (boxed culvert)
- Sanitary sewer line (SS)
- Water line (W)
- Gas line (G)
- Electrical line (E)
- Overhead electrical line (OE)
- Telephone, TV cable (T)
- Utility pole
- Electrical vault
- Electrical transformer
- Manhole
- Flow direction
- Storm drain inlet

G:\PIEDMONT\29WILDWOOD\FIGURES\14QM03.A1

SCALE 1:30
0 15 30 60
FEET

FIGURE 2

Groundwater Elevation Contour Map

October 23, 2003



C A M B R I A

Shell-branded Service Station
29 Wildwood Avenue
Piedmont, California
Incident #98995822

Table 1. Groundwater Analytical Data - Oxygenates - Former Shell Service Station, Incident #98995822, 29 Wildwood Avenue, Piedmont, California

Sample ID	Date Sampled	MTBE	DIPE	ETBE	TAME	TBA	Ethanol	1,2-DCA	EDB
(Concentrations in ppb)									
MW-1	10/23/02	<0.50	<2.0	<2.0	<2.0	<50	--	<2.0	<2.0
	07/14/03	1.4	<2.0	<2.0	<2.0	<5.0	--	--	--
	10/23/03	0.64	<2.0	<2.0	<2.0	<5.0	--	--	--
MW-2	10/31/01	<100	<100	<100	<100	<1,000	150,000	--	--
	10/23/02	140	<2.0	<2.0	<2.0	<50	--	<2.0	<2.0
	07/14/03	60	<2.0	<2.0	<2.0	8.6	7,000	--	--
	10/23/03	0.98	<2.0	<2.0	<2.0	<5.0	<50	--	--
MW-3	10/31/01	31	<2.0	<2.0	<2.0	<50	<500	--	--
	10/23/02	1,400	<5.0	<5.0	7.4	300	--	<5.0	<5.0
	07/14/03	360	<10	<10	<10	72	<250	--	--
	10/23/03	260	<20	<20	<20	<50	<500	--	--
MW-4	10/23/02	<0.50	<2.0	<2.0	<2.0	<50	--	<2.0	<2.0
	07/14/03	<0.50	<2.0	<2.0	<2.0	<5.0	--	--	--
	10/23/03	<0.50	<2.0	<2.0	<2.0	<5.0	--	--	--
MW-5	10/23/02	<0.50	<2.0	<2.0	<2.0	<50	--	<2.0	<2.0
	07/14/03	<0.50	<2.0	<2.0	<2.0	<5.0	--	--	--
	10/23/03	<0.50	<2.0	<2.0	<2.0	<5.0	--	--	--

Table 1. Groundwater Analytical Data - Oxygenates - Former Shell Service Station, Incident #98995822, 29 Wildwood Avenue, Piedmont, California

Sample ID	Date Sampled	MTBE	DIPE	ETBE	TAME	TBA	Ethanol	1,2-DCA	EDB
-----------	--------------	------	------	------	------	-----	---------	---------	-----

(Concentrations in ppb)

Abbreviations & Notes:

MTBE = Methyl tert-butyl ether, analyzed by EPA Method 8260
 DIPE = Di-isopropyl ether, analyzed by EPA Method 8260
 ETBE = Ethyl tert-butyl ether, analyzed by EPA Method 8260
 TAME = Tert-amyl methyl ether, analyzed by EPA Method 8260
 TBA = Tert-butyl alcohol, analyzed by EPA Method 8260
 Ethanol analyzed by EPA Method 8260
 1,2-DCA = 1,2-Dichloroethane, analyzed by EPA Method 8260
 EDB = 1,2-Dibromoethane, analyzed by EPA Method 8260
 ppb = Parts per billion

ATTACHMENT A
Blaine Groundwater Monitoring Report
and Field Notes

BLAINE
TECH SERVICES, INC.

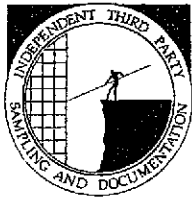

1680 ROGERS AVENUE
SAN JOSE, CA 95112-1105
(408) 573-7771 FAX
(408) 573-0555 PHONE
CONTRACTOR'S LICENSE #746684
www.blainetech.com

November 26, 2003

Karen Petryna
Shell Oil Products US
P.O. Box 7869
Burbank, CA 91510-7869

Fourth Quarter 2003 Groundwater Monitoring at
Shell-branded Service Station
29 Wildwood Avenue
Piedmont, CA

Monitoring performed on October 23, 2003

Groundwater Monitoring Report 031023-BA-1

This report covers the routine monitoring of groundwater wells at this Shell-branded facility. In accordance with standard procedures that conform to Regional Water Quality Control Board requirements, routine field data collection includes depth to water, total well depth, thickness of any separate immiscible layer, water column volume, calculated purge volume (if applicable), elapsed evacuation time (if applicable), total volume of water removed (if applicable), and standard water parameter instrument readings. Sample material is collected, contained, stored, and transported to the laboratory in conformance with EPA standards. Purgewater (if applicable) is, likewise, collected and transported to the Martinez Refining Company.

Basic field information is presented alongside analytical values excerpted from the laboratory report in the cumulative table of **WELL CONCENTRATIONS**. The full analytical report for the most recent samples and the field data sheets are attached to this report.

At a minimum, Blaine Tech Services, Inc. field personnel are certified on completion of a forty-hour Hazardous Materials and Emergency Response training course per 29 CFR 1910.120. Field personnel are also enrolled in annual eight-hour refresher courses.

Blaine Tech Services, Inc. conducts sampling and documentation assignments of this type as an independent third party. Our activities at this site consisted of objective data and sample collection only. No interpretation of analytical results, defining of hydrological conditions or formulation of recommendations was performed.

Please call if you have any questions.

Yours truly,

Leon Gearhart
Project Coordinator

LG/jt

attachments: Cumulative Table of WELL CONCENTRATIONS
Certified Analytical Report
Field Data Sheets

cc: Anni Kreml
Cambria Environmental Technology, Inc.
5900 Hollis Street, Suite A
Oakland, CA 94608

WELL CONCENTRATIONS
Shell-branded Service Station
29 Wildwood Avenue
Piedmont, CA

Well ID	Date	TPPH (ug/L)	B (ug/L)	T (ug/L)	E (ug/L)	X (ug/L)	MTBE 8020 (ug/L)	MTBE 8260 (ug/L)	TOC (MSL)	Depth to Water (ft.)	GW Elevation (MSL)	DO Reading (ppm)
MW-1	07/12/1989	<50	<0.5	<1	<1	<3	NA	NA	37.96	2.76	35.20	NA
MW-1	01/30/1990	<50	<0.5	<0.5	<0.5	<0.5	NA	NA	37.96	3.10	34.86	NA
MW-1	04/27/1990	<50	<0.5	<0.5	<0.5	<0.5	NA	NA	37.96	3.24	34.72	NA
MW-1	07/31/1990	<50	<0.5	<0.5	<0.5	<0.5	NA	NA	37.96	4.26	33.70	NA
MW-1	10/30/1990	<50	<0.5	<0.5	<0.5	<0.5	NA	NA	37.96	4.25	33.71	NA
MW-1	01/31/1991	<50	<0.5	<0.5	<0.5	<0.5	NA	NA	37.96	3.66	34.30	NA
MW-1	04/30/1991	<50	0.8	<0.5	0.6	1.2	NA	NA	37.96	3.46	34.50	NA
MW-1	07/30/1991	<50	<0.5	<0.5	<0.5	<0.5	NA	NA	37.96	4.14	33.82	NA
MW-1	10/29/1991	<50	<0.5	<0.5	<0.5	<0.5	NA	NA	37.96	3.96	34.00	NA
MW-1	01/20/1992	<30	<0.3	<0.3	<0.3	<0.3	NA	NA	37.96	3.59	34.37	NA
MW-1	04/14/1992	<50	<0.5	<0.5	<0.5	<0.5	NA	NA	37.96	3.18	31.71	NA
MW-1	07/21/1992	<50	<0.5	<0.5	<0.5	<0.5	NA	NA	37.96	4.17	33.79	NA
MW-1	10/02/1992	<50	<0.5	<0.5	<0.5	<0.5	NA	NA	37.96	4.29	33.67	NA
MW-1	01/20/1993	<50	<0.5	<0.5	<0.5	<0.5	NA	NA	37.96	2.32	35.64	NA
MW-1	05/03/1993	<50	<0.5	<0.5	<0.5	<0.5	NA	NA	37.96	3.50	34.46	1.9
MW-1	06/28/1993	NA	NA	NA	NA	NA	NA	NA	37.96	3.76	34.20	NA
MW-1	07/21/1993	<50	<0.5	<0.5	<0.5	<0.5	NA	NA	37.96	4.09	33.87	4.6
MW-1	10/19/1993	50	<0.5	<0.5	<0.5	<0.5	NA	NA	37.96	3.58	34.38	4.3
MW-1	01/20/1994	Well inaccessible		NA	NA	NA	NA	NA	37.96	NA	NA	NA
MW-1	04/12/1994	<50	<0.5	<0.5	<0.5	<0.5	NA	NA	37.96	3.60	34.36	7.5
MW-1	07/20/1994	<50	<0.5	<0.5	<0.5	<0.5	NA	NA	37.96	4.10	33.86	3.2
MW-1	10/06/1994	<50	<0.5	<0.5	<0.5	<0.5	NA	NA	37.96	4.30	33.66	3.2
MW-1	01/20/1995	<50	<0.5	<0.5	<0.5	<0.5	NA	NA	37.96	2.94	35.02	10.6
MW-1	07/06/1995	<50	<0.5	<0.5	<0.5	<0.5	NA	NA	37.96	3.68	34.28	NA
MW-1	01/24/1996	<50	<0.5	<0.5	<0.5	<0.5	NA	NA	37.96	2.12	35.84	NA
MW-1	07/12/1996	<50	<0.5	<0.5	<0.5	<0.5	<2.5	NA	37.96	3.58	34.38	2.7

WELL CONCENTRATIONS
Shell-branded Service Station
29 Wildwood Avenue
Piedmont, CA

Well ID	Date	TPPH (ug/L)	B (ug/L)	T (ug/L)	E (ug/L)	X (ug/L)	MTBE 8020 (ug/L)	MTBE 8260 (ug/L)	TOC (MSL)	Depth to Water (ft.)	GW Elevation (MSL)	DO Reading (ppm)
---------	------	----------------	-------------	-------------	-------------	-------------	------------------------	------------------------	--------------	----------------------------	--------------------------	------------------------

MW-1	01/16/1997	120	14	10	3.6	14	<2.5	NA	37.96	2.30	35.66	3
MW-1	10/24/1997	<50	<0.50	<0.50	<0.50	<0.50	8.6	NA	37.96	3.66	34.30	4.5
MW-1	05/13/1998	<50	<0.50	<0.50	<0.50	<0.50	<2.5	NA	37.96	2.81	35.15	5.1
MW-1	10/01/1998	<50	<0.50c	<0.50c	<0.50c	<0.50c	<2.5c	NA	37.96	3.75	34.21	5.0
MW-1	04/29/1999	<50	<0.50	<0.50	<0.50	<0.50	<2.5	NA	37.96	3.52	34.44	4.1
MW-1	11/01/1999	<50.0	<0.500	<0.500	<0.500	<0.500	5.03	NA	37.96	4.05	33.91	3.6
MW-1	04/05/2000	<50.0	<0.500	<0.500	<0.500	<0.500	3.22	NA	37.96	3.74	34.22	4.2
MW-1	10/30/2000	<50.0	<0.500	<0.500	<0.500	<0.500	<2.50	NA	37.96	2.19	35.77	4.1
MW-1	04/27/2001	<50.0	<0.500	<0.500	<0.500	<0.500	<2.50	NA	37.96	4.43	33.53	1.9
MW-1	10/31/2001	<50	<0.50	<0.50	<0.50	<0.50	NA	<5.0	37.96	4.34	33.62	2.4
MW-1	05/09/2002	Well inaccessible		NA	NA	NA	NA	NA	37.96	NA	NA	NA
MW-1	07/25/2002	<50	<0.50	<0.50	<0.50	<0.50	NA	<5.0	37.96	3.53	34.43	1.2
MW-1	10/23/2002	<50	<0.50	<0.50	<0.50	<0.50	NA	<0.50	40.94	3.68	37.26	3.5
MW-1	01/22/2003	Well inaccessible		NA	NA	NA	NA	NA	40.94	NA	NA	NA
MW-1	01/29/2003	<50	<0.50	<0.50	<0.50	<0.50	NA	<5.0	40.94	3.25	37.69	3.7
MW-1	04/30/2003	<50	<0.50	<0.50	<0.50	<1.0	NA	<5.0	40.94	2.76	38.18	3.6
MW-1	07/14/2003	<50	<0.50	<0.50	<0.50	<1.0	NA	<1.4	40.94	3.15	37.79	0.5
MW-1	10/23/2003	<50	<0.50	<0.50	<0.50	<1.0	NA	0.64	40.94	3.82	37.12	3.9

MW-2	07/12/1989	60	2.7	<1	<1	<3	NA	NA	34.89	3.66	31.23	NA
MW-2	01/30/1990	<50	6.6	<0.5	0.54	0.93	NA	NA	34.89	3.49	31.40	NA
MW-2	04/27/1990	60	2.1	<0.5	<0.5	<0.5	NA	NA	34.89	3.79	31.10	NA
MW-2	07/31/1990	70	1.5	<0.5	<0.5	<0.5	NA	NA	34.89	4.03	30.86	NA
MW-2	10/30/1990	70	<0.5	0.7	<0.5	1.6	NA	NA	34.89	4.21	30.68	NA
MW-2	01/31/1991	80	<0.5	<0.5	0.9	1.9	NA	NA	34.89	4.09	30.80	NA
MW-2	04/30/1991	100	5.9	0.6	0.7	2	NA	NA	34.89	3.95	30.94	NA
MW-2	07/30/1991	<50	<0.5	<0.7	<0.5	<0.5	NA	NA	34.89	4.07	30.82	NA

WELL CONCENTRATIONS
Shell-branded Service Station
29 Wildwood Avenue
Piedmont, CA

Well ID	Date	TPPH (ug/L)	B (ug/L)	T (ug/L)	E (ug/L)	X (ug/L)	MTBE 8020 (ug/L)	MTBE 8260 (ug/L)	TOC (MSL)	Depth to Water (ft.)	GW Elevation (MSL)	DO Reading (ppm)
MW-2	10/29/1991	<50	<0.5	<0.5	<0.5	<0.5	NA	NA	34.89	4.11	30.78	NA
MW-2	01/20/1992	<30	0.84	<0.3	<0.41	<0.48	NA	NA	34.89	3.86	31.03	NA
MW-2	04/14/1992	70	16	<0.5	3.1	2.1	NA	NA	34.89	3.66	34.30	NA
MW-2	07/21/1992	<50	<0.5	<0.5	<0.5	<0.5	NA	NA	34.89	3.92	30.97	NA
MW-2	10/02/1992	<50	<0.5	<0.5	<0.5	<0.5	NA	NA	34.89	4.45	30.44	NA
MW-2	01/20/1993	<50	3.8	<0.5	0.52	<0.5	NA	NA	34.89	3.74	31.15	NA
MW-2	05/03/1993	680a	2.8	<0.5	<0.5	<0.5	NA	NA	34.89	3.77	31.12	0.9
MW-2	06/28/1993	NA	NA	NA	NA	NA	NA	NA	34.89	3.96	30.93	NA
MW-2	07/21/1993	<50	8	1.2	1.8	7.9	NA	NA	34.89	4.39	30.50	5.9
MW-2	10/19/1993	<50	<0.5	<0.5	<0.5	<0.5	NA	NA	34.89	3.92	30.97	5.7
MW-2	01/20/1994	<50	1.5	<0.5	<0.5	<0.5	NA	NA	34.89	4.45	30.44	3.2
MW-2	04/12/1994	<50	2.9	<0.5	<0.5	<0.5	NA	NA	34.89	4.72	30.17	11.4
MW-2	07/20/1994	<50	<0.5	<0.5	<0.5	<0.5	NA	NA	34.89	5.32	29.57	2.4
MW-2	10/06/1994	<50	<0.5	<0.5	<0.5	<0.5	NA	NA	34.89	4.03	30.86	2.9
MW-2	01/20/1995	290	28	<0.5	<0.5	<0.5	NA	NA	34.89	3.89	31.00	4.6
MW-2	07/06/1995	120	3	<0.5	<0.5	<0.5	NA	NA	34.89	8.84	26.05	NA
MW-2	01/24/1996	70	3.1	<0.5	0.8	1.5	NA	NA	34.89	3.80	31.09	NA
MW-2 (D)	01/24/1996	70	3.2	0.5	0.7	1.5	NA	NA	34.89	NA	NA	NA
MW-2	07/12/1996	<50	0.68	<0.5	<0.5	<0.5	270	NA	34.89	3.85	31.04	3.8
MW-2	01/16/1997	230	34	1.6	1.6	4.2	460	NA	34.89	3.84	31.05	NA
MW-2	10/24/1997	<50	<0.50	<0.50	<0.50	<0.50	54	NA	34.89	3.75	31.14	2.9
MW-2	05/13/1998	NA	NA	NA	NA	NA	NA	NA	34.89	3.78	31.11	NA
MW-2	10/01/1998	<50	<0.50c	<0.50c	<0.50c	<0.50c	100	NA	34.89	4.90	29.99	3.0
MW-2	04/29/1999	NA	NA	NA	NA	NA	NA	NA	34.89	4.69	30.20	NA
MW-2	11/01/1999	<50.0	<0.500	1.29	0.669	4.52	7.21	NA	34.89	5.24	29.65	2.9
MW-2	04/05/2000	376d	68.1d	3.10d	2.88d	5.35d	729d	NA	34.89	3.43	31.46	3.6
MW-2	10/30/2000	5,790	59.2	315	162	1320	346	NA	34.89	2.35	32.54	2.8

WELL CONCENTRATIONS
Shell-branded Service Station
29 Wildwood Avenue
Piedmont, CA

Well ID	Date	TPPH (ug/L)	B (ug/L)	T (ug/L)	E (ug/L)	X (ug/L)	MTBE 8020 (ug/L)	MTBE 8260 (ug/L)	TOC (MSL)	Depth to Water (ft.)	GW Elevation (MSL)	DO Reading (ppm)
---------	------	----------------	-------------	-------------	-------------	-------------	------------------------	------------------------	--------------	----------------------------	--------------------------	------------------------

MW-2	04/27/2001	2,720	90.8	22.8	18.1	165	512	578	34.89	4.67	30.22	0.9
MW-2	10/31/2001	<10,000	<100	<100	<100	<100	NA	<100	34.89	3.68	31.21	1.3
MW-2	05/09/2002	490	1.5	7.8	2.1	14	NA	200	34.89	3.18	31.71	1.1
MW-2	07/25/2002	1,200	1.0	3.3	1.3	8.3	NA	45	34.89	3.30	31.59	0.4
MW-2	10/23/2002	1,100	0.85	3.8	1.3	7.9	NA	140	37.87	3.87	34.00	0.8
MW-2	01/22/2003	730	<0.50	100	0.96	5.4	NA	230	37.87	2.68	35.19	1.5
MW-2	04/30/2003	<500	<5.0	23	<5.0	<10	NA	410	37.87	3.42	34.45	0.1
MW-2	07/14/2003	<800	1.2	59	1.4	9.8	NA	60	37.87	3.50	34.37	1.1
MW-2	10/23/2003	2,000	1.7	0.88	1.5	<1.0	NA	0.98	37.87	5.08	32.79	0.8

MW-3	07/12/1989	3,900	380	41	99	30	NA	NA	35.00	3.83	31.17	NA
MW-3	01/30/1990	5,500	440	35	79	130	NA	NA	35.00	3.24	31.76	NA
MW-3	04/27/1990	4,500	310	26	37	110	NA	NA	35.00	4.02	30.98	NA
MW-3	07/31/1990	3,500	210	17	8.4	62	NA	NA	35.00	4.31	30.69	NA
MW-3	10/30/1990	2,300	610	<0.5	<0.5	28	NA	NA	35.00	4.52	30.48	NA
MW-3	01/31/1991	4,100	300	20	19	81	NA	NA	35.00	4.33	30.67	NA
MW-3	04/30/1991	3,800	370	19	8.6	60	NA	NA	35.00	3.79	31.21	NA
MW-3	07/30/1991	3,300	160	13	15	87	NA	NA	35.00	4.37	30.63	NA
MW-3	10/29/1991	1,000	35	2.8	2.9	8.1	NA	NA	35.00	4.00	31.00	NA
MW-3	01/20/1992	6,900	380	18	47	48	NA	NA	35.00	3.87	31.13	NA
MW-3	04/14/1992	6,000	480	38	41	55	NA	NA	35.00	3.15	31.85	NA
MW-3	07/21/1992	3,700	330	13	30	23	NA	NA	35.00	4.17	30.83	NA
MW-3	10/02/1992	4,200	260	10	13	12	NA	NA	35.00	4.43	30.57	NA
MW-3	01/20/1993	4,200	360	15	32	26	NA	NA	35.00	2.20	32.80	NA
MW-3 (D)	01/20/1993	3,900	370	15	32	26	NA	NA	35.00	NA	NA	NA
MW-3	05/03/1993	12,000	290	520	120	620	NA	NA	35.00	3.50	31.50	0.6
MW-3	06/28/1993	NA	NA	NA	NA	NA	NA	NA	35.00	4.08	30.92	NA

WELL CONCENTRATIONS
Shell-branded Service Station
29 Wildwood Avenue
Piedmont, CA

Well ID	Date	TPPH (ug/L)	B (ug/L)	T (ug/L)	E (ug/L)	X (ug/L)	MTBE 8020 (ug/L)	MTBE 8260 (ug/L)	TOC (MSL)	Depth to Water (ft.)	GW Elevation (MSL)	DO Reading (ppm)
MW-3	07/21/1993	2,000	170	12	<10	11	NA	NA	35.00	4.12	30.88	4.3
MW-3 (D)	07/21/1993	2,000	170	10	<10	14	NA	NA	35.00	NA	NA	NA
MW-3	10/19/1993	2,000	240	<0.5	<0.5	<0.5	NA	NA	35.00	4.20	30.80	5.7
MW-3	01/20/1994	4,200	280	<10	<10	<10	NA	NA	35.00	4.08	30.92	4.1
MW-3 (D)	01/20/1994	3,800	250	<10	<10	<10	NA	NA	35.00	NA	NA	4.1
MW-3	04/12/1994	4,700	380	<10	<10	<10	NA	NA	35.00	3.70	31.30	10.6
MW-3 (D)	04/12/1994	3,400	370	<25	<25	<25	NA	NA	35.00	NA	NA	NA
MW-3	07/20/1994	5,100	320	77	15	34	NA	NA	35.00	4.26	30.74	2.3
MW-3 (D)	07/20/1994	4,400	250	14	13	32	NA	NA	35.00	NA	NA	NA
MW-3	10/06/1994	4,300	280	9.7	4	15	NA	NA	35.00	4.31	30.69	2.3
MW-3	01/20/1995	4,600	180	18	16	10	NA	NA	35.00	3.00	32.00	11.1
MW-3 (D)	01/20/1995	4,300	170	12	15	7.2	NA	NA	35.00	NA	NA	NA
MW-3	07/06/1995	3,900	310	<0.5	7.6	13	NA	NA	35.00	3.75	31.25	NA
MW-3 (D)	07/06/1995	4,100	330	<0.5	7.9	2.4	NA	NA	35.00	NA	NA	NA
MW-3	01/24/1996	5,000	210	14	14	12	NA	NA	35.00	3.26	31.74	NA
MW-3	07/12/1996	2,700	210	<0.5	<0.5	<0.5	3,600	NA	35.00	3.77	31.23	2.4
MW-3 (D)	07/12/1996	2,800	210	<0.5	<0.5	<0.5	3,400	NA	35.00	NA	NA	2.4
MW-3	01/16/1997	4,200	130	19	10	34	4,400	4,600	35.00	2.38	32.62	2.3
MW-3	10/24/1997	4,100	270	9	5.1	8.8	2,000	NA	35.00	4.12	30.88	1.9
MW-3 (D)	10/24/1997	1,700	220	<5.0	<5.0	<5.0	1,500	NA	35.00	NA	NA	1.9
MW-3	05/13/1998	NA	NA	NA	NA	NA	NA	NA	35.00	3.22	31.78	NA
MW-3	10/01/1998	1,400	84c	<5.0c	<5.0c	<5.0c	2,300	NA	35.00	4.15	30.85	2.0
MW-3 (D)	10/01/1998	2,100	100c	<10c	<10c	<10c	2,600	NA	35.00	NA	NA	2.0
MW-3	04/29/1999	NA	NA	NA	NA	NA	NA	NA	35.00	4.27	30.73	NA
MW-3	11/01/1999	1,850	94.3	6.09	<5.00	6.67	4,140	NA	35.00	4.65	30.35	2.2
MW-3	04/05/2000	3,070	96.9	12.1	<10.0	<10.0	1,050	NA	35.00	3.50	31.50	2.7
MW-3	10/30/2000	1,570	56.8	1.91	1.39	3.06	572	524	35.00	3.40	31.60	3.1

WELL CONCENTRATIONS
Shell-branded Service Station
29 Wildwood Avenue
Piedmont, CA

Well ID	Date	TPPH (ug/L)	B (ug/L)	T (ug/L)	E (ug/L)	X (ug/L)	MTBE 8020 (ug/L)	MTBE 8260 (ug/L)	TOC (MSL)	Depth to Water (ft.)	GW Elevation (MSL)	DO Reading (ppm)
---------	------	----------------	-------------	-------------	-------------	-------------	------------------------	------------------------	--------------	----------------------------	--------------------------	------------------------

MW-3	04/27/2001	2,420	103	12.6	<5.00	15.6	314	NA	35.00	3.67	31.33	0.9
MW-3	10/31/2001	<50	0.71	<0.50	<0.50	<0.50	NA	31	35.00	3.79	31.21	1.6
MW-3	05/09/2002	2,000	52	<10	<10	<10	NA	4,100	35.00	3.76	31.24	0.9
MW-3	07/25/2002	1,800	50	<5.0	<5.0	<5.0	NA	1,900	35.00	4.17	30.83	3.7
MW-3	10/23/2002	1,700	27	<5.0	<5.0	<5.0	NA	1,400	37.97	4.36	33.61	1.6
MW-3	01/22/2003	1,800	38	2.4	1.5	2.4	NA	390	37.97	3.09	34.88	1.3
MW-3	04/30/2003	3,300	56	5.2	<5.0	<10	NA	540	37.97	3.39	34.58	1.5
MW-3	07/14/2003	1,000	20	2.7	<2.5	<5.0	NA	360	37.97	4.05	33.92	1.5
MW-3	10/23/2003	2,100	27	<5.0	<5.0	<10	NA	260	37.97	4.32	33.65	1.0

MW-4	01/30/1990	<50	<0.5	<0.5	<0.5	<0.5	NA	NA	33.73	4.50	29.23	NA
MW-4	04/27/1990	130a	<0.5	<0.5	<0.5	<0.5	NA	NA	33.73	3.62	30.11	NA
MW-4	07/31/1990	<50	<0.5	<0.5	<0.5	<0.5	NA	NA	33.73	4.19	29.54	NA
MW-4	10/30/1990	<50	<0.5	<0.5	<0.5	<0.5	NA	NA	33.73	4.19	29.54	NA
MW-4	01/31/1991	50a	<0.5	<0.5	<0.5	<0.5	NA	NA	33.73	4.49	29.24	NA
MW-4	04/30/1991	<50	<0.5	<0.5	<0.5	<0.5	NA	NA	33.73	4.02	29.71	NA
MW-4	07/30/1991	<50	<0.5	<0.5	<0.5	<0.5	NA	NA	33.73	4.39	29.34	NA
MW-4	10/29/1991	<50	<0.5	<0.5	<0.5	<0.5	NA	NA	33.73	3.75	29.98	NA
MW-4	01/20/1992	<30	<0.3	<0.3	<0.3	<0.3	NA	NA	33.73	3.94	29.79	NA
MW-4	04/14/1992	<50	<0.5	<0.5	<0.5	<0.5	NA	NA	33.73	3.71	30.02	NA
MW-4	07/21/1992	<50	<0.5	<0.5	<0.5	<0.5	NA	NA	33.73	4.02	29.71	NA
MW-4	10/02/1992	<50	<0.5	<0.5	<0.5	<0.5	NA	NA	33.73	4.13	29.60	NA
MW-4	01/20/1993	<50	<0.5	<0.5	<0.5	<0.5	NA	NA	33.73	3.10	30.63	NA
MW-4	05/03/1993	<50	<0.5	<0.5	<0.5	<0.5	NA	NA	33.73	3.70	30.03	1.7
MW-4	06/28/1993	NA	NA	NA	NA	NA	NA	NA	33.73	3.81	29.92	NA
MW-4	07/21/1993	<50	0.56	<0.5	<0.5	<0.5	NA	NA	33.73	3.81	29.92	4.5
MW-4	10/19/1993	<50	<0.5	<0.5	<0.5	<0.5	NA	NA	33.73	3.94	29.79	5.8

WELL CONCENTRATIONS
Shell-branded Service Station
29 Wildwood Avenue
Piedmont, CA

Well ID	Date	TPPH (ug/L)	B (ug/L)	T (ug/L)	E (ug/L)	X (ug/L)	MTBE 8020 (ug/L)	MTBE 8260 (ug/L)	TOC (MSL)	Depth to Water (ft.)	GW Elevation (MSL)	DO Reading (ppm)
MW-4	01/20/1994	<50	0.71	<0.5	<0.5	<0.5	NA	NA	33.73	4.00	29.73	4.4
MW-4	04/12/1994	<50	<0.5	<0.5	<0.5	<0.5	NA	NA	33.73	4.01	29.72	7.3
MW-4	07/20/1994	160	<0.5	<0.5	<0.5	<0.5	NA	NA	33.73	3.91	29.82	6.4
MW-4	10/06/1994	410	<0.5	<0.5	<0.5	<0.5	NA	NA	33.73	3.99	29.74	5.0
MW-4	01/20/1995	<50	<0.5	<0.5	<0.5	<0.5	NA	NA	33.73	3.56	30.17	4.9
MW-4	07/06/1995	<50	<0.5	<0.5	<0.5	<0.5	NA	NA	33.73	3.85	29.88	NA
MW-4	01/24/1996	<50	<0.5	<0.5	0.6	1.8	NA	NA	33.73	2.56	31.17	NA
MW-4	07/12/1996	<50	<0.5	<0.5	<0.5	<0.5	b	NA	33.73	3.36	30.37	2.7
MW-4	01/16/1997	Well inaccessible		NA	NA	NA	NA	NA	33.73	NA	NA	NA
MW-4	10/24/1997	Well inaccessible		NA	NA	NA	NA	NA	33.73	NA	NA	NA
MW-4	05/13/1998	Well inaccessible		NA	NA	NA	NA	NA	33.73	NA	NA	NA
MW-4	10/01/1998	<50	<0.50c	<0.50c	<0.50c	0.74c	8.1	NA	33.73	3.90	29.83	2.5
MW-4	04/29/1999	<50	<0.50	<0.50	<0.50	<0.50	5.7	NA	33.73	3.97	29.76	2.1
MW-4	11/01/1999	Well inaccessible		NA	NA	NA	NA	NA	33.73	NA	NA	NA
MW-4	04/05/2000	<50.0	<0.500	<0.500	<0.500	<0.500	3.64	NA	33.73	3.63	30.10	2.1
MW-4	10/30/2000	<50.0	<0.500	<0.500	<0.500	<0.500	<2.50	NA	33.73	3.33	30.40	3.0
MW-4	04/27/2001	<50.0	<0.500	<0.500	<0.500	<0.500	<2.50	NA	33.73	3.48	30.25	2.2
MW-4	10/31/2001	<50	<0.50	<0.50	<0.50	<0.50	NA	<5.0	33.73	3.58	30.15	2.8
MW-4	05/09/2002	<50	<0.50	<0.50	<0.50	<0.50	NA	<5.0	33.73	3.74	29.99	2.0
MW-4	07/25/2002	<50	<0.50	<0.50	<0.50	<0.50	NA	<5.0	33.73	3.71	30.02	1.3
MW-4	10/23/2002	<50	<0.50	<0.50	<0.50	<0.50	NA	<0.50	36.72	3.93	32.79	2.6
MW-4	01/22/2003	<50	<0.50	<0.50	<0.50	<0.50	NA	<5.0	36.72	3.67	33.05	3.1
MW-4	04/30/2003	<50	<0.50	<0.50	<0.50	<1.0	NA	<5.0	36.72	3.46	33.26	2.8
MW-4	07/14/2003	56 a	<0.50	<0.50	<0.50	<1.0	NA	<0.50	36.72	3.75	32.97	2.4
MW-4	10/23/2003	<50	<0.50	<0.50	<0.50	<1.0	NA	<0.50	36.72	3.93	32.79	2.0
MW-5	01/30/1990	<50	<0.5	<0.5	<0.5	<0.5	NA	NA	31.38	7.12	24.26	NA

WELL CONCENTRATIONS
Shell-branded Service Station
29 Wildwood Avenue
Piedmont, CA

Well ID	Date	TPPH (ug/L)	B (ug/L)	T (ug/L)	E (ug/L)	X (ug/L)	MTBE 8020 (ug/L)	MTBE 8260 (ug/L)	TOC (MSL)	Depth to Water (ft.)	GW Elevation (MSL)	DO Reading (ppm)
MW-5	04/27/1990	210a	<0.5	<0.5	<0.5	<0.5	NA	NA	31.38	4.19	27.19	NA
MW-5	07/31/1990	90	<0.5	<0.5	<0.5	<0.5	NA	NA	31.38	4.09	27.29	NA
MW-5	10/30/1990	100	0.8	0.7	0.6	1.4	NA	NA	31.38	4.39	26.99	NA
MW-5	01/31/1991	80a	<0.5	<0.5	<0.5	<0.5	NA	NA	31.38	4.49	26.89	NA
MW-5	04/30/1991	90	<0.5	<0.5	<0.5	<0.5	NA	NA	31.38	4.27	27.11	NA
MW-5	07/30/1991	90	<0.5	<0.5	<0.5	<0.5	NA	NA	31.38	4.32	27.06	NA
MW-5	10/29/1991	<50	<0.5	<0.5	<0.5	<0.5	NA	NA	31.38	3.79	27.59	NA
MW-5	01/20/1992	<30	<0.3	<0.3	<0.3	<0.3	NA	NA	31.38	4.09	27.29	NA
MW-5	04/14/1992	<50a	<0.5	<0.5	<0.5	<0.5	NA	NA	31.38	4.12	27.26	NA
MW-5	07/21/1992	74a	<0.5	<0.5	<0.5	<0.5	NA	NA	31.38	4.13	27.25	NA
MW-5	10/02/1992	76a	<0.5	<0.5	<0.5	<0.5	NA	NA	31.38	4.30	27.08	NA
MW-5	01/20/1993	72a	<0.5	<0.5	<0.5	<0.5	NA	NA	31.38	3.12	28.26	NA
MW-5	05/03/1993	70a	<0.5	<0.5	<0.5	<0.5	NA	NA	31.38	4.07	27.31	1.6
MW-5 (D)	05/04/1993	80a	<0.5	<0.5	<0.5	<0.5	NA	NA	31.38	NA	NA	NA
MW-5	06/28/1993	NA	NA	NA	NA	NA	NA	NA	31.38	4.08	27.30	NA
MW-5	07/21/1993	<50	<0.5	<0.5	<0.5	<0.5	NA	NA	31.38	4.05	27.33	3.5
MW-5	10/19/1993	51	<0.5	<0.5	<0.5	<0.5	NA	NA	31.38	4.20	27.18	3.8
MW-5	01/20/1994	90	<0.5	<0.5	<0.5	<0.5	NA	NA	31.38	4.40	26.98	4.2
MW-5	04/12/1994	67	<0.5	<0.5	<0.5	<0.5	NA	NA	31.38	4.18	27.20	NA
MW-5	07/20/1994	<50	<0.5	<0.5	<0.5	<0.5	NA	NA	31.38	4.06	27.32	3.2
MW-5	10/06/1994	80	<0.5	<0.5	<0.5	<0.5	NA	NA	31.38	4.01	27.37	2.1
MW-5 (D)	10/06/1994	60	<0.5	<0.5	<0.5	<0.5	NA	NA	31.38	NA	NA	NA
MW-5	01/20/1995	<50	<0.5	<0.5	<0.5	<0.5	NA	NA	31.38	3.49	27.89	3.2
MW-5	07/06/1995	<50	<0.5	<0.5	<0.5	<0.5	NA	NA	31.38	4.06	27.32	NA
MW-5	01/24/1996	70	<0.5	<0.5	0.8	2.9	NA	NA	31.38	2.90	28.48	NA
MW-5	07/12/1996	62	<0.5	<0.5	<0.5	<0.5	b	NA	31.38	4.02	27.36	1.9
MW-5	01/16/1997	66	0.91	0.89	<0.50	1.7	<2.5	NA	31.38	2.59	28.79	2.2

WELL CONCENTRATIONS
Shell-branded Service Station
29 Wildwood Avenue
Piedmont, CA

Well ID	Date	TPPH (ug/L)	B (ug/L)	T (ug/L)	E (ug/L)	X (ug/L)	MTBE 8020 (ug/L)	MTBE 8260 (ug/L)	TOC (MSL)	Depth to Water (ft)	GW Elevation (MSL)	DO Reading (ppm)
MW-5 (D)	01/16/1997	<50	0.7	0.78	<0.50	1.3	<2.5	NA	31.38	NA	NA	2.2
MW-5	10/24/1997	59	<0.50	<0.50	<0.50	<0.50	17	NA	31.38	4.15	27.23	4.6
MW-5	05/13/1998	72	<0.50	<0.50	<0.50	<0.50	<2.5	NA	31.38	3.64	27.74	2.1
MW-5 (D)	05/13/1998	70	<0.50	<0.50	<0.50	<0.50	<2.5	NA	31.38	NA	NA	2.1
MW-5	10/01/1998	57	<0.50c	<0.50c	<0.50c	0.62c	20	NA	31.38	4.25	27.13	2.2
MW-5	04/29/1999	<50	<0.50	<0.50	<0.50	<0.50	16	NA	31.38	4.56	26.82	2.0
MW-5	11/01/1999	<50.0	<0.500	<0.500	<0.500	<0.500	3.06	NA	31.38	4.19	27.19	2.2
MW-5	04/05/2000	<50.0	<0.500	<0.500	<0.500	<0.500	22.5	NA	31.38	4.34	27.04	2.2
MW-5	10/30/2000	<50.0	<0.500	<0.500	<0.500	<0.500	19.3	NA	31.38	3.25	28.13	4.0
MW-5	04/27/2001	51.5	<0.500	<0.500	<0.500	<0.500	4.29	NA	31.38	4.07	27.31	1.0
MW-5	10/31/2001	210	<0.50	<0.50	<0.50	<0.50	NA	<5.0	31.38	4.02	27.36	1.5
MW-5	05/09/2002	280	0.71	<0.50	<0.50	<0.50	NA	<5.0	31.38	4.31	27.07	1.7
MW-5	07/25/2002	410	<0.50	<0.50	<0.50	<0.50	NA	<5.0	31.38	4.32	27.06	0.7
MW-5	10/23/2002	290	<0.50	<0.50	<0.50	<0.50	NA	<0.50	34.36	4.37	29.99	2.3
MW-5	01/22/2003	260	<0.50	<0.50	<0.50	<0.50	NA	<5.0	34.36	4.12	30.24	2.4
MW-5	04/30/2003	90 e	<0.50	<0.50	<0.50	<1.0	NA	<5.0	34.36	3.88	30.48	1.5
MW-5	07/14/2003	72 a	<0.50	<0.50	<0.50	<1.0	NA	<0.50	34.36	4.57	29.79	1.0
MW-5	10/23/2003	120 f	<0.50	<0.50	<0.50	<1.0	NA	<0.50	34.36	4.45	29.91	1.8

E-4	07/12/1989	<50	<0.5	<1	<1	<3	NA	NA	34.63	NA	>39.13	NA
E-4	01/30/1990	<50	<0.5	<0.5	<0.5	<0.5	NA	NA	34.63	NA	>34.63	NA
E-4	04/27/1990	120a	<0.5	<0.5	<0.5	<0.5	NA	NA	34.63	NA	>34.63	NA
E-4	07/31/1990	<50	<0.5	<0.5	<0.5	<0.5	NA	NA	34.63	NA	>34.63	NA
E-4	10/30/1990	<50	<0.5	<0.5	<0.5	<0.5	NA	NA	34.63	NA	>34.63	NA
E-4	01/31/1991	<50	<0.5	<0.5	<0.5	<0.5	NA	NA	34.63	NA	>34.63	NA
E-4	04/30/1991	<50	<0.5	<0.5	<0.5	<0.5	NA	NA	34.63	NA	>34.63	NA
E-4	07/30/1991	<50	<0.5	0.6	<0.5	<0.5	NA	NA	34.63	NA	>34.63	NA

WELL CONCENTRATIONS
Shell-branded Service Station
29 Wildwood Avenue
Piedmont, CA

Well ID	Date	TPPH (ug/L)	B (ug/L)	T (ug/L)	E (ug/L)	X (ug/L)	MTBE 8020 (ug/L)	MTBE 8260 (ug/L)	TOC (MSL)	Depth to Water (ft.)	GW Elevation (MSL)	DO Reading (ppm)
E-4	10/29/1991	<50	<0.5	<0.5	<0.5	<0.5	NA	NA	34.63	NA	>34.63	NA
E-4	01/20/1992	<30	<0.3	<0.3	<0.3	<0.3	NA	NA	34.63	NA	>34.63	NA
E-4	04/14/1992	<50	<0.5	<0.5	<0.5	<0.5	NA	NA	34.63	NA	>34.63	NA
E-4	07/21/1992	<50	<0.5	<0.5	<0.5	<0.5	NA	NA	34.63	NA	>34.63	NA
E-4	10/02/1992	<50	<0.5	<0.5	<0.5	<0.5	NA	NA	34.63	NA	>34.63	NA
E-4	01/20/1993	<50	<0.5	<0.5	<0.5	<0.5	NA	NA	34.63	NA	>34.63	NA
E-4	05/03/1993	<50	<0.5	<0.5	<0.5	<0.5	NA	NA	34.63	NA	>34.63	0.6
E-4	06/28/1993	NA	NA	NA	NA	NA	NA	NA	34.63	NA	>34.63	NA
E-4	07/21/1993	<50	5.4	0.72	1	4.4	NA	NA	34.63	NA	>34.63	5.4
E-4	10/19/1993	<50	<0.5	<0.5	<0.5	<0.5	NA	NA	34.63	NA	>34.63	5.6
E-4	01/20/1994	<50	<0.5	<0.5	<0.5	<0.5	NA	NA	34.63	NA	>34.63	NA
E-4	04/12/1994	<50	<0.5	<0.5	<0.5	<0.5	NA	NA	34.63	NA	>34.63	9.4
E-4	07/20/1994	<50	<0.5	<0.5	<0.5	<0.5	NA	NA	34.63	NA	>34.63	2.0
E-4	10/06/1994	<50	<0.5	<0.5	<0.5	<0.5	NA	NA	34.63	NA	>34.63	1.3
E-4	01/20/1995	<50	<0.5	<0.5	<0.5	<0.5	NA	NA	34.63	NA	>34.63	3.7
E-4	05/16/1995	Well abandoned		NA	NA	NA	NA	NA	NA	NA	NA	NA

WELL CONCENTRATIONS
Shell-branded Service Station
29 Wildwood Avenue
Piedmont, CA

Well ID	Date	TPPH (ug/L)	B (ug/L)	T (ug/L)	E (ug/L)	X (ug/L)	MTBE 8020 (ug/L)	MTBE 8260 (ug/L)	TOC (MSL)	Depth to Water (ft.)	GW Elevation (MSL)	DO Reading (ppm)
---------	------	----------------	-------------	-------------	-------------	-------------	------------------------	------------------------	--------------	----------------------------	--------------------------	------------------------

Abbreviations:

TPPH = Total petroleum hydrocarbons as gasoline by EPA Method 8260B; prior to October 31, 2001, analyzed by EPA Method 8015.

BTEX = Benzene, toluene, ethylbenzene, xylenes by EPA Method 8260B; prior to October 31, 2001, analyzed by EPA Method 8020.

MTBE = Methyl-tertiary-butyl ether

TOC = Top of Casing Elevation

SPH = Separate-Phase Hydrocarbons

GW = Groundwater

DO = Dissolved Oxygen

ug/L = Parts per billion

ppm = Parts per million

MSL = Mean sea level

ft = Feet

<n = Below detection limit

D = Duplicate sample

NA = Not applicable

Notes:

a = Chromatogram pattern indicated an unidentified hydrocarbon/ hydrocarbon reported does not match pattern of laboratory's standard.

b = Due to coelution with early eluters, no result could be determined for MTBE

c = Laboratory reported 1.3 ug/L benzene, 11 ug/L toluene, 0.98 ug/L ethyl benzene, and 6.5 ug/L total xylenes in the equipment blank.

d = Result reported was generated out of hold time.

e = Hydrocarbon reported does not match laboratory's gasoline standard.

f = Sample contains discrete peaks which are Chlorinated solvents, in addition to gasoline.

Well E-4 is a flowing artesian well; potentiometric surface above top-of-casing elevation.

Site surveyed March 5, 2002, by Virgil Chavez Land Surveying of Vallejo, California.

Blaine Tech Services, Inc.

November 06, 2003

1680 Rogers Avenue
San Jose, CA 95112-1105

Attn.: Leon Gearhart

Project#: 031023-BA1

Project: 98995822

Site: 29 Wildwood Ave., Piedmont

Dear Mr. Gearhart,

Attached is our report for your samples received on 10/24/2003 18:19

This report has been reviewed and approved for release. Reproduction of this report is permitted only in its entirety.

The report contains a Case Narrative detailing sample receipt and analysis.

Please note that any unused portion of the samples will be discarded after 12/08/2003 unless you have requested otherwise.

We appreciate the opportunity to be of service to you. If you have any questions, please call me at (925) 484-1919.

You can also contact me via email. My email address is: vvancil@stl-inc.com

Sincerely,



Vincent Vancil
Project Manager

Severn Trent Laboratories, Inc.

STL San Francisco * 1220 Quarry Lane, Pleasanton, CA 94566

Tel 925 484 1919 Fax 925 484 1096 * www.stl-inc.com * CA DHS ELAP# 2496

Blaine Tech Services, Inc.

November 06, 2003

1680 Rogers Avenue
San Jose, CA 95112-1105

Attn.: Leon Gearhart

Project#: 031023-BA1

Project: 98995822

Site: 29 Wildwood Ave., Piedmont

Case Narrative

General and Sample Comments

We (STL San Francisco) received 5 Water samples , on Friday, October 24, 2003 6:19 PM.

The discrete peaks which were found in the gasoline range are Chlorinated solvents. We have identified the presence of Tetrachloroethene , Trichloroethene , and cis-1,2-Dichloroethene.

Analysis Comments and Flags by QC Batch

Selectable Gas/BTEX Fuel Oxygenates by 8260B	Water	QC Batch#: 2003/10/31-01.65
--	-------	-----------------------------

MW-3 2003-10-0912-003

Analysis Flag(s)

o Reporting limits were raised due to high level of analyte present in the sample.

Selectable Gas/BTEX Fuel Oxygenates by 8260B	Water	QC Batch#: 200311032A62
--	-------	-------------------------

MW-5 2003-10-0912-005

Compound Flag(s)

dp Sample contains discrete peak in addition to gasoline.

Severn Trent Laboratories, Inc.

STL San Francisco * 1220 Quarry Lane, Pleasanton, CA 94566

Tel 925 484 1919 Fax 925 484 1096 * www.stl-inc.com * CA DHS ELAP# 2496



STL

Submission #: 2003-10-0912

Gas/BTEX Fuel Oxygenates by 8260B (C6-C12)

Blaine Tech Services, Inc.

Attn.: Leon Gearhart

1680 Rogers Avenue

San Jose, CA 95112-1105

Phone: (408) 573-0555 Fax: (408) 573-7771

Project: 031023-BA1

98995822

Received: 10/24/2003 18:19

Site: 29 Wildwood Ave., Piedmont

Samples Reported

Sample Name	Date Sampled	Matrix	Lab #
MW-1	10/23/2003 10:50	Water	1
MW-2	10/23/2003 11:00	Water	2
MW-3	10/23/2003 11:20	Water	3
MW-4	10/23/2003 09:20	Water	4
MW-5	10/23/2003 09:45	Water	5

Severn Trent Laboratories, Inc.

STL San Francisco * 1220 Quarry Lane, Pleasanton, CA 94566

Tel 925 484 1919 Fax 925 484 1096 * www.stl-inc.com * CA DHS ELAP# 2496

11/24/2003 15:41

Gas/BTEX Fuel Oxygenates by 8260B (C6-C12)

Blaine Tech Services, Inc.

Attn.: Leon Gearhart

1680 Rogers Avenue
San Jose, CA 95112-1105
Phone: (408) 573-0555 Fax: (408) 573-7771

Project: 031023-BA1
98995822

Received: 10/24/2003 18:19

Site: 29 Wildwood Ave., Piedmont

Prep(s):	5030B	Test(s):	8260B
Sample ID:	MW-1	Lab ID:	2003-10-0912 - 1
Sampled:	10/23/2003 10:50	Extracted:	10/31/2003 13:06
Matrix:	Water	QC Batch#:	2003/10/31-01.65

Compound	Conc.	RL	Unit	Dilution	Analyzed	Flag
Gasoline	ND	50	ug/L	1.00	10/31/2003 13:06	
Benzene	ND	0.50	ug/L	1.00	10/31/2003 13:06	
Toluene	ND	0.50	ug/L	1.00	10/31/2003 13:06	
Ethylbenzene	ND	0.50	ug/L	1.00	10/31/2003 13:06	
Total xylenes	ND	1.0	ug/L	1.00	10/31/2003 13:06	
tert-Butyl alcohol (TBA)	ND	5.0	ug/L	1.00	10/31/2003 13:06	
Methyl tert-butyl ether (MTBE)	0.64	0.50	ug/L	1.00	10/31/2003 13:06	
Di-isopropyl Ether (DIPE)	ND	2.0	ug/L	1.00	10/31/2003 13:06	
Ethyl tert-butyl ether (ETBE)	ND	2.0	ug/L	1.00	10/31/2003 13:06	
tert-Amyl methyl ether (TAME)	ND	2.0	ug/L	1.00	10/31/2003 13:06	
Surrogate(s)						
1,2-Dichloroethane-d4	91.1	76	%	1.00	10/31/2003 13:06	
Toluene-d8	93.9	78	%	1.00	10/31/2003 13:06	

Gas/BTEX Fuel Oxygenates by 8260B (C6-C12)

Blaine Tech Services, Inc.

Attn.: Leon Gearhart

1680 Rogers Avenue
San Jose, CA 95112-1105
Phone: (408) 573-0555 Fax: (408) 573-7771

Project: 031023-BA1
98995822

Received: 10/24/2003 18:19

Site: 29 Wildwood Ave., Piedmont

Prep(s):	5030B	Test(s):	8260B
Sample ID:	MW-2	Lab ID:	2003-10-0912 - 2
Sampled:	10/23/2003 11:00	Extracted:	10/31/2003 23:22
Matrix:	Water	QC Batch#:	2003/10/31-01 65

Compound	Conc.	RL	Unit	Dilution	Analyzed	Flag
Gasoline	2000	50	ug/L	1.00	10/31/2003 23:22	
Benzene	1.7	0.50	ug/L	1.00	10/31/2003 23:22	
Toluene	0.88	0.50	ug/L	1.00	10/31/2003 23:22	
Ethylbenzene	1.5	0.50	ug/L	1.00	10/31/2003 23:22	
Total xylenes	ND	1.0	ug/L	1.00	10/31/2003 23:22	
tert-Butyl alcohol (TBA)	ND	5.0	ug/L	1.00	10/31/2003 23:22	
Methyl tert-butyl ether (MTBE)	0.98	0.50	ug/L	1.00	10/31/2003 23:22	
Di-isopropyl Ether (DIPE)	ND	2.0	ug/L	1.00	10/31/2003 23:22	
Ethyl tert-butyl ether (ETBE)	ND	2.0	ug/L	1.00	10/31/2003 23:22	
tert-Amyl methyl ether (TAME)	ND	2.0	ug/L	1.00	10/31/2003 23:22	
Ethanol	ND	50	ug/L	1.00	10/31/2003 23:22	
Surrogate(s)						
1,2-Dichloroethane-d4	78.2	76	%	1.00	10/31/2003 23:22	
Toluene-d8	98.7	78	%	1.00	10/31/2003 23:22	

Gas/BTEX Fuel Oxygenates by 8260B (C6-C12)

Blaine Tech Services, Inc.

Attn.: Leon Gearhart

1680 Rogers Avenue
San Jose, CA 95112-1105
Phone: (408) 573-0555 Fax: (408) 573-7771

Project: 031023-BA1
98995822

Received: 10/24/2003 18:19

Site: 29 Wildwood Ave., Piedmont

Prep(s):	5030B	Test(s):	8260B
Sample ID:	MW-3	Lab ID:	2003-10-0912 - 3
Sampled:	10/23/2003 11:20	Extracted:	10/31/2003 13:52
Matrix:	Water	QC Batch#:	2003/10/31-01-65
Analysis Flag: 0 (See Legend and Note Section)			

Compound	Conc.	RL	Unit	Dilution	Analyzed	Flag
Gasoline	2100	500	ug/L	10.00	10/31/2003 13:52	
Benzene	27	5.0	ug/L	10.00	10/31/2003 13:52	
Toluene	ND	5.0	ug/L	10.00	10/31/2003 13:52	
Ethylbenzene	ND	5.0	ug/L	10.00	10/31/2003 13:52	
Total xylenes	ND	10	ug/L	10.00	10/31/2003 13:52	
tert-Butyl alcohol (TBA)	ND	50	ug/L	10.00	10/31/2003 13:52	
Methyl tert-butyl ether (MTBE)	260	5.0	ug/L	10.00	10/31/2003 13:52	
Di-isopropyl Ether (DIPE)	ND	20	ug/L	10.00	10/31/2003 13:52	
Ethyl tert-butyl ether (ETBE)	ND	20	ug/L	10.00	10/31/2003 13:52	
tert-Amyl methyl ether (TAME)	ND	20	ug/L	10.00	10/31/2003 13:52	
Ethanol	ND	500	ug/L	10.00	10/31/2003 13:52	
Surrogate(s)						
1,2-Dichloroethane-d4	97.8	76	%	10.00	10/31/2003 13:52	
Toluene-d8	98.1	78	%	10.00	10/31/2003 13:52	

Gas/BTEX Fuel Oxygenates by 8260B (C6-C12)

Blaine Tech Services, Inc.

Attn.: Leon Gearhart

1680 Rogers Avenue
San Jose, CA 95112-1105
Phone: (408) 573-0555 Fax: (408) 573-7771

Project: 031023-BA1
98995822

Received: 10/24/2003 18:19

Site: 29 Wildwood Ave., Piedmont

Prep(s):	5030B	Test(s):	8260B
Sample ID:	MW-4	Lab ID:	2003-10-0912 - 4
Sampled:	10/23/2003 09:20	Extracted:	10/31/2003 14:14
Matrix:	Water	QC Batch#:	2003/10/31-01.65

Compound	Conc.	RL	Unit	Dilution	Analyzed	Flag
Gasoline	ND	50	ug/L	1.00	10/31/2003 14:14	
Benzene	ND	0.50	ug/L	1.00	10/31/2003 14:14	
Toluene	ND	0.50	ug/L	1.00	10/31/2003 14:14	
Ethylbenzene	ND	0.50	ug/L	1.00	10/31/2003 14:14	
Total xylenes	ND	1.0	ug/L	1.00	10/31/2003 14:14	
tert-Butyl alcohol (TBA)	ND	5.0	ug/L	1.00	10/31/2003 14:14	
Methyl tert-butyl ether (MTBE)	ND	0.50	ug/L	1.00	10/31/2003 14:14	
Di-isopropyl Ether (DIPE)	ND	2.0	ug/L	1.00	10/31/2003 14:14	
Ethyl tert-butyl ether (ETBE)	ND	2.0	ug/L	1.00	10/31/2003 14:14	
tert-Amyl methyl ether (TAME)	ND	2.0	ug/L	1.00	10/31/2003 14:14	
Surrogate(s)						
1,2-Dichloroethane-d4	87.1	76	%	1.00	10/31/2003 14:14	
Toluene-d8	92.1	78	%	1.00	10/31/2003 14:14	

Gas/BTEX Fuel Oxygenates by 8260B (C6-C12)

Blaine Tech Services, Inc.

Attn.: Leon Gearhart

1680 Rogers Avenue
San Jose, CA 95112-1105
Phone: (408) 573-0555 Fax: (408) 573-7771

Project: 031023-BA1
98995822

Received: 10/24/2003 18:19

Site: 29 Wildwood Ave., Piedmont

Prep(s):	5030B	Test(s):	8260B
Sample ID:	MW-5	Lab ID:	2003-10-0912-5
Sampled:	10/23/2003 09:45	Extracted:	11/4/2003 01:50
Matrix:	Water	QC Batch#:	2003/11/03-2A.62

Compound	Conc.	RL	Unit	Dilution	Analyzed	Flag
Gasoline	120	50	ug/L	1.00	11/04/2003 01:50	dp
Benzene	ND	0.50	ug/L	1.00	11/04/2003 01:50	
Toluene	ND	0.50	ug/L	1.00	11/04/2003 01:50	
Ethylbenzene	ND	0.50	ug/L	1.00	11/04/2003 01:50	
Total xylenes	ND	1.0	ug/L	1.00	11/04/2003 01:50	
tert-Butyl alcohol (TBA)	ND	5.0	ug/L	1.00	11/04/2003 01:50	
Methyl tert-butyl ether (MTBE)	ND	0.50	ug/L	1.00	11/04/2003 01:50	
Di-isopropyl Ether (DIPE)	ND	2.0	ug/L	1.00	11/04/2003 01:50	
Ethyl tert-butyl ether (ETBE)	ND	2.0	ug/L	1.00	11/04/2003 01:50	
tert-Amyl methyl ether (TAME)	ND	2.0	ug/L	1.00	11/04/2003 01:50	
Surrogate(s)						
1,2-Dichloroethane-d4	102.2	76	%	1.00	11/04/2003 01:50	
Toluene-d8	98.6	78	%	1.00	11/04/2003 01:50	

Gas/BTEX Fuel Oxygenates by 8260B (C6-C12)

Blaine Tech Services, Inc.

Attn.: Leon Gearhart

1680 Rogers Avenue
San Jose, CA 95112-1105
Phone: (408) 573-0555 Fax: (408) 573-7771

Project: 031023-BA1
98995822

Received: 10/24/2003 18:19

Site: 29 Wildwood Ave., Piedmont

Batch QC Report			
Prep(s): 5030B			Test(s): 8260B
Method: Blank		Water	QC Batch # 2003/10/31-01.65
MB: 2003/10/31-01.65-022			Date Extracted: 10/31/2003 10:22

Compound	Conc.	RL	Unit	Analyzed	Flag
Gasoline	ND	50	ug/L	10/31/2003 10:22	
Benzene	ND	0.5	ug/L	10/31/2003 10:22	
Toluene	ND	0.5	ug/L	10/31/2003 10:22	
Ethylbenzene	ND	0.5	ug/L	10/31/2003 10:22	
Total xylenes	ND	1.0	ug/L	10/31/2003 10:22	
tert-Butyl alcohol (TBA)	ND	5.0	ug/L	10/31/2003 10:22	
Methyl tert-butyl ether (MTBE)	ND	0.5	ug/L	10/31/2003 10:22	
Di-isopropyl Ether (DIPE)	ND	2.0	ug/L	10/31/2003 10:22	
Ethyl tert-butyl ether (ETBE)	ND	2.0	ug/L	10/31/2003 10:22	
tert-Amyl methyl ether (TAME)	ND	2.0	ug/L	10/31/2003 10:22	
Ethanol	ND	50	ug/L	10/31/2003 10:22	
Surrogates(s)					
1,2-Dichloroethane-d4	88.1	76-130	%	10/31/2003 10:22	
Toluene-d8	97.5	78-115	%	10/31/2003 10:22	

Gas/BTEX Fuel Oxygenates by 8260B (C6-C12)

Blaine Tech Services, Inc.

Attn.: Leon Gearhart

1680 Rogers Avenue

San Jose, CA 95112-1105

Phone: (408) 573-0555 Fax: (408) 573-7771

Project: 031023-BA1

98995822

Received: 10/24/2003 18:19

Site: 29 Wildwood Ave., Piedmont

Batch QC Report		
Prep(s): 5030B		Test(s): 8260B
Method Blank	Water	QC Batch # 2003/11/03-2A.62
MB: 2003/11/03-2A 62-037		Date Extracted: 11/03/2003 23:37

Compound	Conc.	RL	Unit	Analyzed	Flag
Gasoline	ND	50	ug/L	11/03/2003 23:37	
tert-Butyl alcohol (TBA)	ND	5.0	ug/L	11/03/2003 23:37	
Methyl tert-butyl ether (MTBE)	ND	0.5	ug/L	11/03/2003 23:37	
Di-isopropyl Ether (DIPE)	ND	2.0	ug/L	11/03/2003 23:37	
Ethyl tert-butyl ether (ETBE)	ND	2.0	ug/L	11/03/2003 23:37	
tert-Amyl methyl ether (TAME)	ND	2.0	ug/L	11/03/2003 23:37	
Benzene	ND	0.5	ug/L	11/03/2003 23:37	
Toluene	ND	0.5	ug/L	11/03/2003 23:37	
Ethylbenzene	ND	0.5	ug/L	11/03/2003 23:37	
Total xylenes	ND	1.0	ug/L	11/03/2003 23:37	
Ethanol	ND	50	ug/L	11/03/2003 23:37	
Surrogates(s)					
1,2-Dichloroethane-d4	96.0	76-130	%	11/03/2003 23:37	
Toluene-d8	95.6	78-115	%	11/03/2003 23:37	

Gas/BTEX Fuel Oxygenates by 8260B (C6-C12)

Blaine Tech Services, Inc.
Attn.: Leon Gearhart

1680 Rogers Avenue
San Jose, CA 95112-1105
Phone: (408) 573-0555 Fax: (408) 573-7771

Project: 031023-BA1
98995822

Received: 10/24/2003 18:19

Site: 29 Wildwood Ave., Piedmont

Batch QC Report										
Prep(s): 5030B						Test(s): 8260B				
Laboratory Control Spike			Water			QC Batch # 2003/10/31-01.65				
LCS	2003/10/31-01.65-038		Extracted: 10/31/2003			Analyzed: 10/31/2003 09:38				
LCSD	2003/10/31-01.65-000		Extracted: 10/31/2003			Analyzed: 10/31/2003 10:00				
Compound	Conc. ug/L		Exp.Conc.	Recovery %		RPD	Ctrl.Limits %		Flags	
	LCS	LCSD		LCS	LCSD		%	Rec.	RPD	LCS
Benzene	23.5	24.3	25.0	94.0	97.2	3.3	69-129	20		
Toluene	25.6	24.5	25.0	102.4	98.0	4.4	70-130	20		
Methyl tert-butyl ether (MTBE)	22.3	21.6	25.0	89.2	86.4	3.2	65-165	20		
Surrogates(s)										
1,2-Dichloroethane-d4	439	437	500	87.8	87.4		76-130			
Toluene-d8	520	508	500	104.0	101.6		78-115			

Gas/BTEX Fuel Oxygenates by 8260B (C6-C12)

Blaine Tech Services, Inc.

Attn.: Leon Gearhart

1680 Rogers Avenue
San Jose, CA 95112-1105
Phone: (408) 573-0555 Fax: (408) 573-7771

Project: 031023-BA1
98995822

Received: 10/24/2003 18:19

Site: 29 Wildwood Ave., Piedmont

Batch QC Report										
Prep(s): 5030B						Test(s): 8260B				
Laboratory Control Spike				Water			QC Batch # 2003/11/03-2A.62			
LCS	2003/11/03-2A.62-053			Extracted: 11/03/2003			Analyzed: 11/03/2003 22:53			
LCSD	2003/11/03-2A.62-015			Extracted: 11/03/2003			Analyzed: 11/03/2003 23:15			
Compound	Conc. ug/L		Exp.Conc.	Recovery %		RPD	Ctrl.Limits %		Flags	
	LCS	LCSD		LCS	LCSD		%	Rec.	RPD	LCS
Methyl tert-butyl ether (MTBE)	20.8	24.7	25	83.2	98.8	17.1	65-165	20		
Benzene	25.1	23.2	25	100.4	92.8	7.9	69-129	20		
Toluene	25.5	25.1	25	102.0	100.4	1.6	70-130	20		
Surrogates(s)										
1,2-Dichloroethane-d4	444	541	500	88.8	108.2		76-130			
Toluene-d8	498	515	500	99.6	103.0		78-115			



STL

Submission #: 2003-10-0912

Gas/BTEX Fuel Oxygenates by 8260B (C6-C12)

Blaine Tech Services, Inc.

Attn.: Leon Gearhart

1680 Rogers Avenue

San Jose, CA 95112-1105

Phone: (408) 573-0555 Fax: (408) 573-7771

Project: 031023-BA1

98995822

Received: 10/24/2003 18:19

Site: 29 Wildwood Ave., Piedmont

Legend and Notes

Analysis Flag

o

Reporting limits were raised due to high level of analyte present in the sample.

Result Flag

dp

Sample contains discrete peak in addition to gasoline.

Severn Trent Laboratories, Inc.

STL San Francisco * 1220 Quarry Lane, Pleasanton, CA 94566

Tel 925 484 1919 Fax 925 484 1096 * www.stl-inc.com * CA DHS ELAP# 2496

11/24/2003 15:41

LAB: STL

SHELL Chain Of Custody Record

79542

Lab Identification (if necessary)

Address

City, State, Zip

Shell Project Manager to be Invoiced:

- SCIENCE & ENGINEERING
- TECHNICAL SERVICES
- CRMT REQUEST

Karen Petryna

2003-10-0912

INCIDENT NUMBER (S&E ONLY)

9 8 9 9 5 8 2 2

SAP or CRMT NUMBER (TS/CRMT)

DATE: 10/23/03

PAGE: 1 of 1

BLAINE TECH SERVICES ADDRESS: 1680 ROGERS AVENUE, SAN JOSE, CA 95112	LOG CODE: BTSS	SITE ADDRESS (Street and City): 29 Wildwood Avenue, Piedmont	BLAINE ID NO: T0600101246
PROJECT CONTACT (Party or Project Manager): Leon Gearhart	TEL: 408-573-0555 FAX: 408-573-7771 EMAIL: lgearhart@blainetech.com	PHONE NO: 510-420-3335	GENERAL PROJECT NO: 031023-BA
TURNAROUND TIME (BUSINESS DAYS): <input checked="" type="checkbox"/> 10 DAYS <input type="checkbox"/> 5 DAYS <input type="checkbox"/> 72 HOURS <input type="checkbox"/> 48 HOURS <input type="checkbox"/> 24 HOURS <input type="checkbox"/> LESS THAN 24 HOURS		REQUESTED ANALYSIS	





LA - RWQCB REPORT FORMAT LIST AGENCY: _____
 GC/MS MTBE CONFIRMATION: HIGHEST _____ HIGHEST per BORING _____ ALL _____
 SPECIAL INSTRUCTIONS OR NOTES: CHECK BOX IF EDD IS NOT NEEDED

FIELD NOTES:
Container/Preservative
or PID Readings
or Laboratory Notes

4.7

TEMPERATURE ON RECEIPT C°

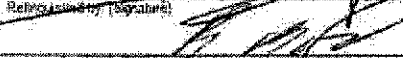
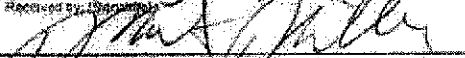
LAB USE ONLY	Field Sample Identification		MATRIX	NO. OF CONT.	TPH - Gas, Furgable	BTEX	MTBE (#218 - Spill RL)	MTBE (#248 - 0 Spill RL)	Oxygenates (5) by (#250B)	Ethanol (#250B)	Methanol	1,2-DCA (#260B)	EDB (#260B)	TPH - Diesel, Extractable (#015m)
	DATE	TIME												
	MW-1	10/23/03	W	3	X	X			X					
	MW-2	1100			X	X			X					
	MW-3	1120			X	X			X					
	MW-4	0920			X	X			X					
	MW-5	0945			X	X			X					

Released by (Signature): 	Received by (Signature): 	Date: 10/24/03	Time: 1805
Released by (Signature): 	Received by (Signature): 	Date: 10/24/03	Time: 1819
Released by (Signature): 	Received by (Signature): 	Date:	Time:

CSC Graphic (714) 838-8702

WELL GAUGING DATA

Project # 031023-BA1 Date 10/23/03 Client Shell

Site 29 Wildwood, Piedmont

Well ID	Well Size (in.)	Sheen / Odor	Depth to Immiscible Liquid (ft.)	Thickness of Immiscible Liquid (ft.)	Volume of Immiscibles Removed (ml)	Depth to water (ft.)	Depth to well bottom (ft.)	Survey Point: TOB or TOC
MW-1	4					3.82	13.07	TOC
MW-2	4					5.08	11.40	↓
MW-3	4					4.32	8.95	
MW-4	4					3.93	13.08	
MW-5	4					4.45	15.98	

SHELL WELL MONITORING DATA SHEET

BTS #: 031023-BA1	Site: 29 WILDWOOD AVE, PIEDMONT
Sampler: BRIAN ALCORN	Date: 10/23/03
Well I.D.: MW-3	Well Diameter: 2 3 (4) 6 8
Total Well Depth (TD): 8.95	Depth to Water (DTW): 4.32
Depth to Free Product:	Thickness of Free Product (feet):
Referenced to: (PVC) Grade	D.O. Meter (if req'd): (YSI) HACH
DTW with 80% Recharge [(Height of Water Column x 0.20) + DTW]: 5.25	

Purge Method: Bailer Waterra Sampling Method: Bailer
 Disposable Bailer Peristaltic Disposable Bailer
 Positive Air Displacement Extraction Pump Extraction Port
 Electric Submersible Other _____ Dedicated Tubing

$\frac{3.0 \text{ (Gals.)} \times 3}{1 \text{ Case Volume}} = 9.0 \text{ Gals.}$ Specified Volumes Calculated Volume	<table border="1" style="width: 100%; border-collapse: collapse;"> <thead> <tr> <th>Well Diameter</th> <th>Multiplier</th> <th>Well Diameter</th> <th>Multiplier</th> </tr> </thead> <tbody> <tr> <td>1"</td> <td>0.04</td> <td>4"</td> <td>0.65</td> </tr> <tr> <td>2"</td> <td>0.16</td> <td>6"</td> <td>1.47</td> </tr> <tr> <td>3"</td> <td>0.37</td> <td>Other</td> <td>radius² * 0.163</td> </tr> </tbody> </table>	Well Diameter	Multiplier	Well Diameter	Multiplier	1"	0.04	4"	0.65	2"	0.16	6"	1.47	3"	0.37	Other	radius ² * 0.163
Well Diameter	Multiplier	Well Diameter	Multiplier														
1"	0.04	4"	0.65														
2"	0.16	6"	1.47														
3"	0.37	Other	radius ² * 0.163														

Time	Temp (°F)	pH	Cond. (mS or (µS))	Turbidity (NTUs)	Gals. Removed	Observations
1011	73.6	7.7	1,131	140	3.0	clear, mild odor
1012	74.4	7.8	1,090	81	6.0	"
1012	Well Dewatered @ 6 gallons					DTW 6.73
1120	72.5	7.5	1,057	42	6.0	" DTW 4.32
Replaced O.R.C.s						

Did well dewater? Yes No Gallons actually evacuated: 6

Sampling Date: 10/23/03 Sampling Time: 1120 Depth to Water: 4.32

Sample I.D.: MW-3 Laboratory: (STL) Other _____

Analyzed for: (TPH-G BTEX) MTBE TPH-D Other: Oxyg All by 8260

EB I.D. (if applicable): @ _____ Duplicate I.D. (if applicable):

Analyzed for: TPH-G BTEX MTBE TPH-D Other:

D.O. (if req'd):	Pre-purge:	mg/L	(Post-purge):	1.0	mg/L
O.R.P. (if req'd):	Pre-purge:	mV	Post-purge:		mV

