



93 JAN 19 PM 4:11

1107

January 7, 1993

Jennifer Eberle
Alameda County Department
of Environmental Health
Hazardous Materials Division
80 Swan Way, Room 200
Oakland, CA 94621-1426

Re: Shell Service Station
WIC #204-6001-0109
29 Wildwood Avenue
Piedmont, California
WA Job #81-463-201

Dear Mr. Smith:

This letter describes recently completed and anticipated activities at the Shell service station referenced above (Figure 1). This status report satisfies the quarterly reporting requirements prescribed by California Administrative Code Title 23 Waters, Chapter 3, Subchapter 16, Article 5, Section 265.d. Included below are descriptions and results of activities performed in the fourth quarter 1992 and proposed work for the first quarter 1993.

Fourth Quarter 1992 Activities:

- EMCON Associates of San Jose, California measured ground water depths in five of the six wells and collected water samples from all six wells. The ground water depth was not measured in well E-4 since it is a flowing artesian well. EMCON's report describing these activities and presenting analytic results for ground water are included as Attachment A. ✓
- Weiss Associates (WA) used EMCON's ground water elevation calculations to prepare a ground water elevation contour map (Figure 2). ✓
- WA Project Geologist Scott MacLeod and Shell Environmental Engineer Dan Kirk met with Jennifer Eberle and Susan Hugo of the Alameda County Department of Environmental Health (ACDEH) to discuss the need for additional investigation. Based on this discussion, WA has tentatively identified a location for a third downgradient well along the eastern side of Grand Avenue south of Wildwood Avenue. The placement of this well will be based on traffic patterns and the locations of buried utilities. ✓

Jennifer Eberle
January 7, 1993

2

Weiss Associates



- Sequoia Analytical of Sacramento, California verified in a telephone conversation with WA geologist Tom Fojut that the TPH-G chromatogram for the July 21, 1992 water sample from well MW-5 displayed a few discrete peaks. Mike Giles at Sequoia said that the peaks were probably not petroleum hydrocarbons. ?

Anticipated First Quarter 1993 Activities:

- WA will submit a report presenting the results of first quarter 1993 ground water sampling and ground water depth measurements. The report will include tabulated chemical analytic results and a ground water elevation contour map. ✓
- WA will install an additional downgradient ground water monitoring well on the east side of Grand Avenue to further define the extent and migration of dissolved hydrocarbons in ground water. WA will also arrange for ground water from all the wells to be analyzed for dissolved oxygen to assess the potential for natural biodegradation of the dissolved hydrocarbons. ✓

Please call if you have any questions.



Sincerely,
Weiss Associates

J. Michael Asport
Technical Assistant

Joseph P. Theisen, C.E.G.
Senior Hydrogeologist

JMA/JPT:jma

E:\ALL\SHELL\450\463QMNO2.WP

Attachments: Figures
A - EMCON's Ground Water Monitoring Report

cc: Kurt Miller, Shell Oil Company, P.O. Box 5278, Concord, California 94520-9998
Lester Feldman, Regional Water Quality Control Board - San Francisco Bay, 2101 Webster Street, Suite 500, Oakland, California 94612

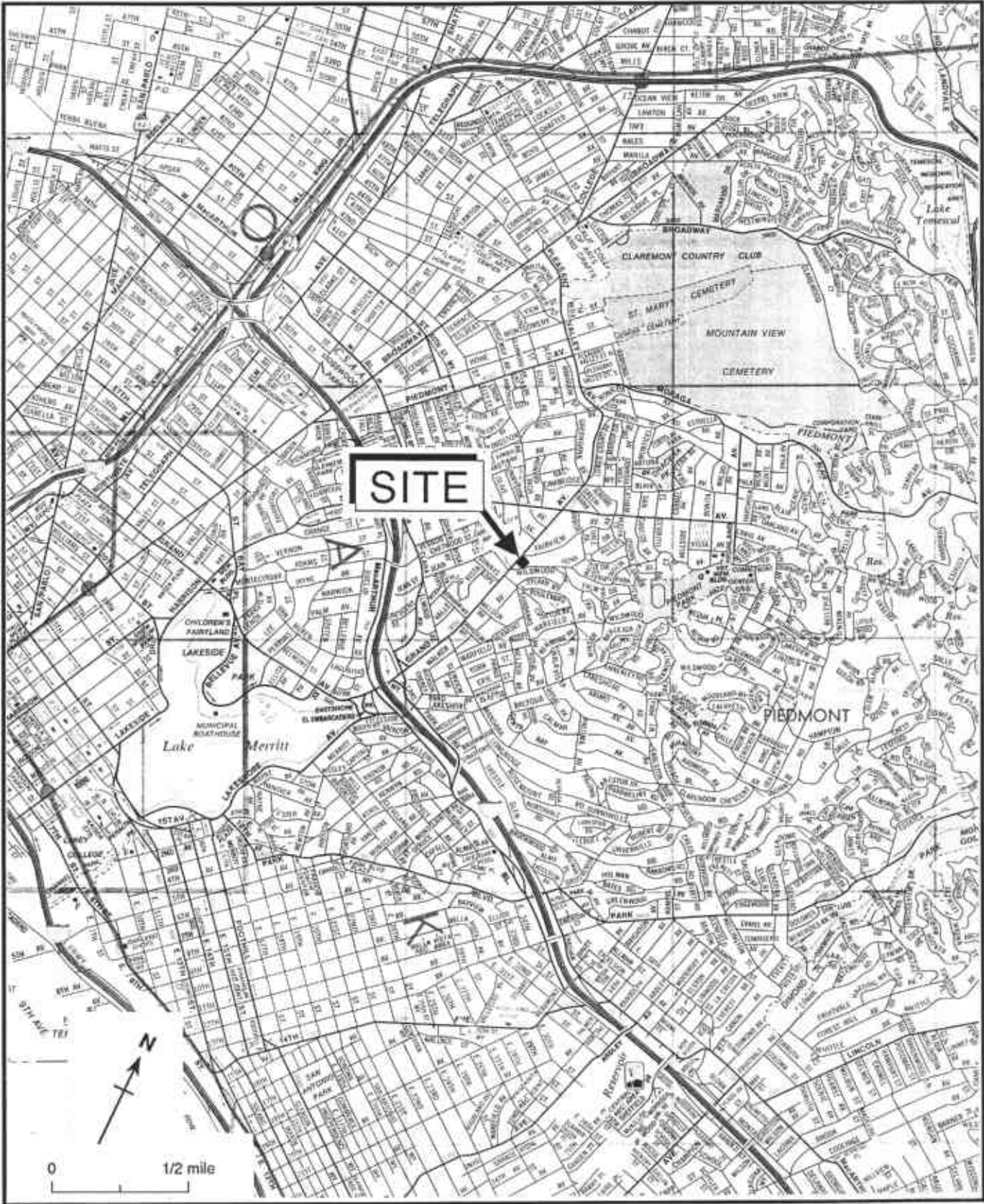

Figure 1. Site Location Map - Shell Service Station WIC #204-6001-0109, 29 Wildwood Avenue, Piedmont, California

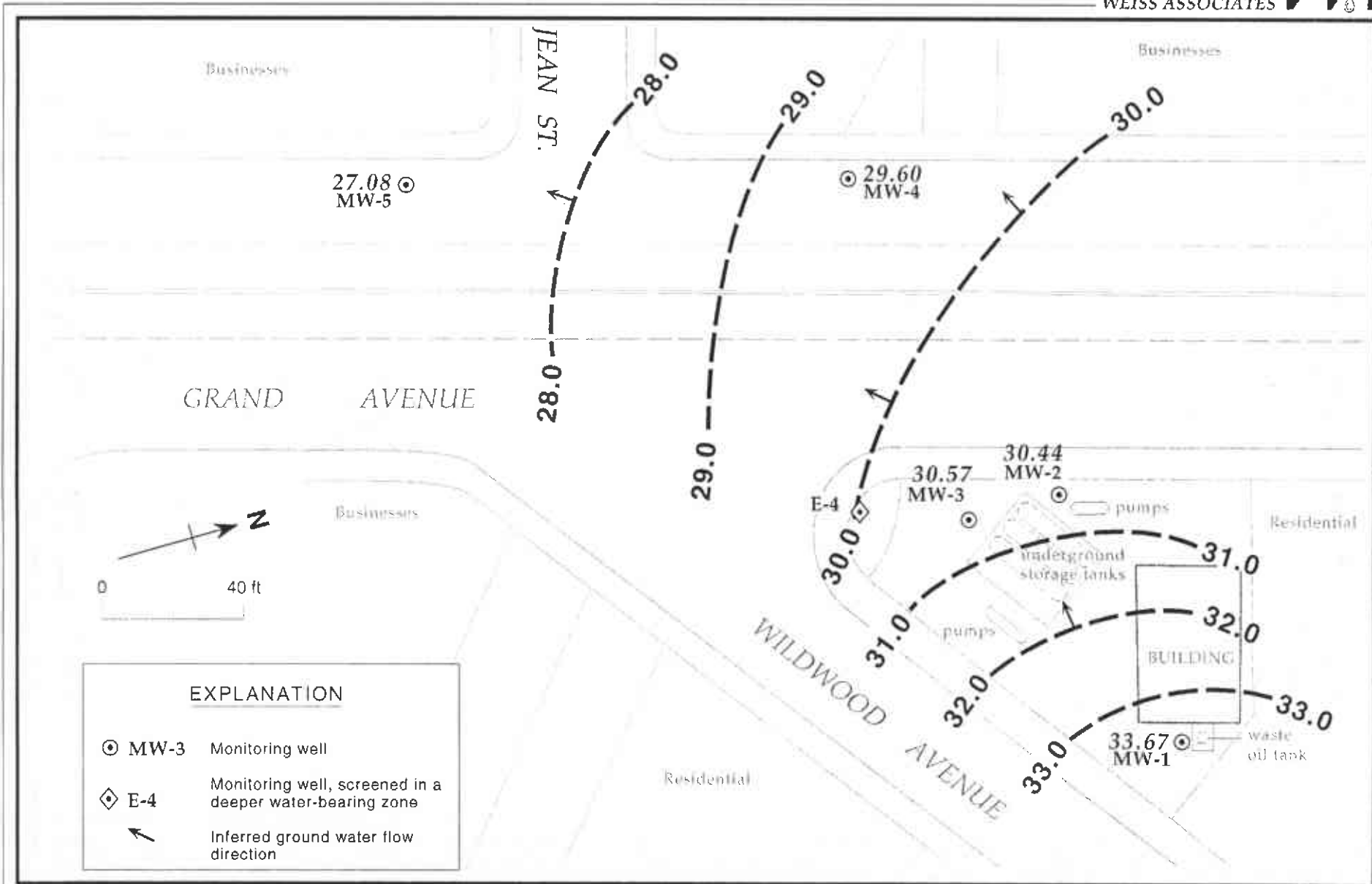

Figure 2. Monitoring Well Locations and Ground Water Elevation Contours - October 2, 1992 - Shell Service Station, WIC #204-6001-0109, 29 Wildwood Avenue, Piedmont, California.

ATTACHMENT A
EMCON'S GROUND WATER MONITORING REPORT



October 19, 1992
Project 0G67-001.01

Mr. David Elias
Weiss Associates
5500 Shellmound Street
Emeryville, California 94608-2411

Re: Fourth Quarter 1992 Ground-water Monitoring Report, 29 Wildwood
Avenue, Piedmont, WIC# 204-6001-0109

Dear Mr. Elias:

This letter presents the results of the fourth quarter 1992 ground-water monitoring event for the Shell Oil Company (Shell) service station at 29 Wildwood Avenue, Piedmont. Monitoring at this site is conducted on a quarterly basis.

GROUND-WATER ELEVATION SURVEY

On October 2, 1992, static water levels were measured in all site wells before purging and sampling. Water levels were measured to 0.01 foot from the top of the well casing using an oil/water interface probe. A summary of the monitoring well field measurement data including water-level measurements and ground-water elevations from this quarter's event and four previous monitoring events is presented Table 1

SAMPLING AND ANALYSIS

Ground-water samples were collected on October 2, 1992 from monitoring wells MW-1 through MW-5, and E-4. A site map, including the monitoring well locations, is attached, as provided by Weiss Associates. Ground-water monitoring wells were purged before sampling using a polyvinyl chloride bailer, a centrifugal pump, a low-flow submersible pump, or a Teflon® bailer. Samples were collected using a Teflon bailer. The procedures used to purge and sample ground-water monitoring wells were detailed in our November 14, 1991 Proposal to Conduct Ground-water Monitoring for Shell Oil Company, and were included in our first quarter 1992 report. Wells MW-2, MW-3, MW-4, and E-4 were evacuated to dryness after the removal of fewer than three casing volumes. These wells were allowed to recharge for up to 24 hours. Samples were collected as soon as the wells had recharged to a level sufficient for sample collection.

Quality Control samples for third quarter 1992 monitoring included a trip blank, field blank and a duplicate well sample. The duplicate sample was collected from monitoring well E-4.

Samples were cooled with ice packs and delivered, under chain-of-custody control, to Sequoia Analytical laboratory for analysis.

ANALYTICAL RESULTS

Samples were analyzed for total purgeable petroleum hydrocarbons, benzene, toluene, total xylenes and ethylbenzene. Analytical results for this quarter's event and four previous monitoring events are summarized in Table 2. Certified analytical reports and chain-of-custody records for this quarter's event are included as attachments to this letter.

If you have any questions, please call.

Very truly yours,

EMCON Associates

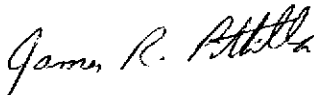

James R. Pittilla
Environmental Sampling Coordinator



Phillip R. Graham
Environmental Sampling Supervisor

JRP/PRG:jrp

Attachments: Table 1 Monitoring Well Field Measurement Data
Table 2 Summary of Analytical Results
Site Map, Certified Analytical Reports and
Chain-of-Custody Records, Water Level;
Floating Product Survey,
Water Sample Field Data Sheets.

cc. Dan Kirk, Shell Oil Company

TABLE 1
MONITORING WELL FIELD MEASUREMENT DATA
SHELL OIL COMPANY
29 Wildwood Avenue, Piedmont, California

Well Designation	Water Level Measurement Date	Top of Casing Elevation (ft/MSL)	Depth to Ground-water (ft)	Ground-water Elevation (ft/MSL)	Floating Product Thickness (ft/MSL)	Total Depth (ft)	Sampling Date	pH (std. units)	Electrical Conductivity (µmhos/cm)	Temperature (degrees F)	Turbidity (NTU)
MW-1	10/29/91	37.96	3.96	34.00	--	--	--	--	--	--	--
	1/20/92		3.59	34.37	--	13.1	01/20/92	6.86	931	61.2	60.3
	4/14/92		3.18	31.71	--	13.1	4/14/92	6.77	994	63.2	8.0
	7/21/92		4.17	33.79	--	13.1	07/21/92	7.19	1018	67.2	21.9
	10/2/92		4.29	33.67	--	13.2	10/02/92	7.05	1036	67.9	>200
MW-2	10/29/91	34.89	4.11	30.78	--	--	--	--	--	--	--
	1/20/92		3.86	31.03	--	11.5	1/20/92	6.87	678	63.6	7.8
	4/14/92		3.66	34.30	--	11.5	04/14/92	6.55	736	66.5	5.9
	7/21/92		3.92	30.97	--	11.5	7/21/92	6.98	676	72.3	5.0
	10/2/92		4.45	30.44	--	11.6	10/2/92	7.21	689	71.3	49.8
MW-3	10/29/91	35.00	4.00	31.00	--	--	--	--	--	--	--
	1/20/92		3.87	31.13	--	9.0	1/20/92	7.07	1,007	58.6	>200
	4/14/92		3.15	31.85	--	9.1	4/14/92	6.98	847	66.0	17.5
	7/21/92		4.17	30.83	--	9.0	7/21/92	7.19	933	73.4	24.2
	10/2/92		4.43	30.57	--	9.1	10/2/92	7.38	1,026	72.4	61.7
MW-4	10/29/91	33.73	3.75	29.98	--	--	--	--	--	--	--
	1/20/92		3.94	29.79	--	12.3	1/20/92	6.89	753	61.2	69.2
	4/14/92		3.71	30.02	--	12.3	4/14/92	6.72	720	64.3	65.2
	7/21/92		4.02	29.71	--	12.4	7/21/92	6.91	759	71.3	30.9
	10/2/92		4.13	29.60	--	12.5	10/2/92	7.12	905	73.2	157.1

TABLE 1
 MONITORING WELL FIELD MEASUREMENT DATA
 SHELL OIL COMPANY
 29 Wildwood Avenue, Piedmont, California

Well Designation	Water Level Measurement Date	Top of Casing Elevation (ft/MSL)	Depth to Ground-water (ft)	Ground-water Elevation (ft/MSL)	Floating Product Thickness (ft/MSL)	Total Depth (ft)	Sampling Date	pH (std. units)	Electrical Conductivity (µmhos/cm)	Temperature (degrees F)	Turbidity (NTU)
MW-5	10/29/91	31.38	3.79	27.59	--	--	--	--	--	--	--
	1/20/92		4.09	27.29	--	16.0	1/20/92	6.85	870	62.4	24.3
	4/14/92		4.12	27.26	--	16.1	4/14/92	6.66	919	65.1	17.7
	7/21/92		4.13	27.25	--	16.0	7/21/92	6.87	938	70.2	14.3
	10/2/92		4.30	27.08	--	16.1	10/2/92	6.97	1,041	71.8	10.7
E-4 *	10/29/91	34.63	**	>34.63**	--	--	--	--	--	--	--
	1/20/92		**	>34.63**	--	34.2	1/20/92	7.61	1,234	61.9	34.0
	4/14/92		**	>34.63**	--	34.3	4/14/92	7.42	1,231	68.6	39.8
	7/21/92		**	>34.63**	--	34.2	7/21/92	7.48	1,277	68.4	52.0
	10/2/92		**	>34.63**	--	34.2	10/2/92	7.81	1,337	67.3	>200

ft/MSL = elevation in feet, relative to mean sea level

NTU = nephelometric turbidity units

* = Well E-4 is a flowing artesian well.

** = Well E-4 potentiometric surface was higher than the top of well casing.

TABLE 2
SUMMARY OF ANALYTICAL RESULTS
SHELL OIL COMPANY
29 Wildwood Avenue, Piedmont, California

Sample Type: Water
Units: mg/l (ppm), unless otherwise noted

Sample Designation	Sample Date	TPH as Gasoline* <i>ppb</i>	Benzene <i>ppb</i>	Toluene	Ethyl-benzene	Total Xylenes
MW-1	10/29/91	ND	ND	ND	ND	ND
	01/20/92	ND	ND	ND	ND	ND
	04/14/92	ND	ND	ND	ND	ND
	07/21/92	ND	ND	ND	ND	ND
	10/02/92	ND	ND	ND	ND	ND
MW-2	10/29/91	ND	ND	ND	ND	ND
	01/20/92	ND	0.00084	ND	0.00041	0.00048
	04/14/92	0.07	0.016	ND	0.0031	0.0021
	07/21/92	ND	ND	ND	ND	ND
	10/02/92	ND	ND	ND	ND	ND
MW-3	10/29/91	1.0	0.035	0.0028	0.0029	0.0081
	01/20/92	6.9	0.38	0.018	0.047	0.048
	04/14/92	6.0	0.48	0.038	0.041	0.055
	07/21/92	3.7	0.33	0.013	0.03	0.023
	10/02/92	4.2 <i>4,200</i>	0.26 <i>260</i>	0.010 <i>10</i>	0.013 <i>13</i>	0.012 <i>12</i>
MW-4	10/29/91	ND	ND	ND	ND	ND
	01/20/92	ND	ND	ND	ND	ND
	04/14/92	ND	ND	ND	ND	ND
	07/21/92	ND	ND	ND	ND	ND
	10/02/92	ND	ND	ND	ND	ND

Whose the pre-1991 data??

TABLE 2
SUMMARY OF ANALYTICAL RESULTS
SHELL OIL COMPANY
29 Wildwood Avenue, Piedmont, California

Sample Type: Water

Units: mg/l (ppm), unless otherwise noted

Sample Designation	Sample Date	TPH as Gasoline*	Benzene	Toluene	Ethylbenzene	Total Xylenes
MW-5	10/29/91	ND	ND	ND	ND	ND
	01/20/92	ND	ND	ND	ND	ND
	04/14/92	ND**	ND	ND	ND	ND
	07/21/92	0.074	ND	ND	ND	ND
	10/02/92	0.076*** 76	ND	ND	ND	ND
E-4	10/29/91	ND	ND	ND	ND	ND
	01/20/92	ND	ND	ND	ND	ND
	04/14/92	ND	ND	ND	ND	ND
	07/21/92	ND	ND	ND	ND	ND
	10/02/92	ND	ND	ND	ND	ND
Trip Blank	10/02/92	ND	ND	ND	ND	ND
Field Blank	10/02/92	ND	ND	ND	ND	ND
X-Dup (E-4)	10/02/92	ND	ND	ND	ND	ND

ND=Not detected.

*=Total Purgeable Petroleum Hydrocarbons

**=The analysis Petroleum Hydrocarbons as Gasoline shows several unknown peaks.

***=The purgeable hydrocarbon concentration in sample MW-5 represents five discrete peaks and does not appear to contain gasoline.

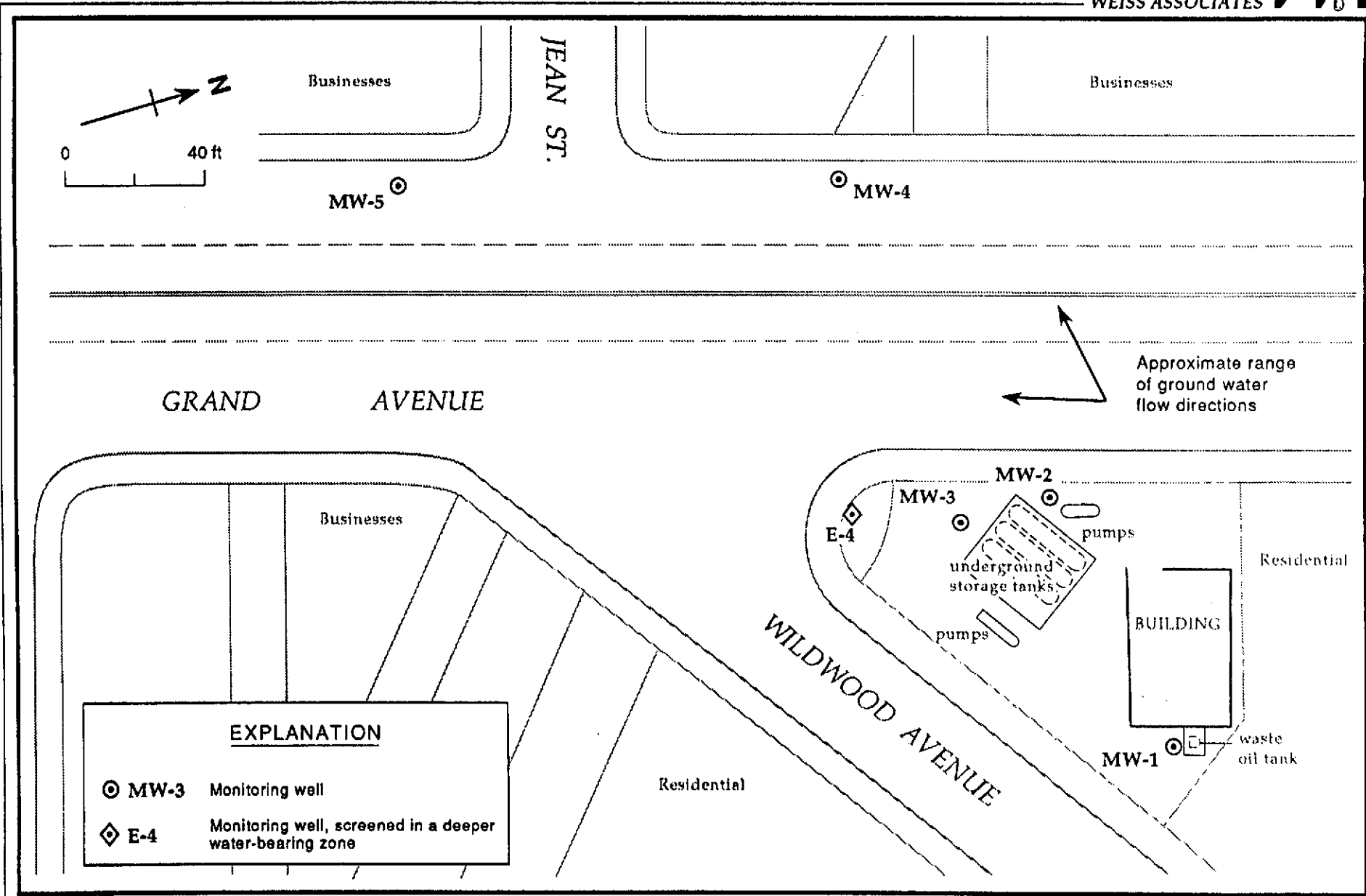

Figure 2. Monitoring Well Locations - Shell Service Station, WIC #204-6001-0109, 29 Wildwood Avenue, Piedmont, California



SEQUOIA ANALYTICAL

819 Striker Avenue, Suite 8 • Sacramento, CA 95834
(916) 921-9600 • FAX (916) 921-0100

RECEIVED
OCT 4 1992
EMCON

EMCON Associates
1433 N. Market Blvd.
Sacramento, CA 95834
Attention: Jim Pittilla

Project: Shell, 29 Wildwood Ave., Piedmont

Enclosed are the results from 10 water samples received at Sequoia Analytical on October 5, 1992. The requested analyses are listed below:

SAMPLE #	SAMPLE DESCRIPTION	DATE OF COLLECTION	TEST METHOD
2100056	Water, MW-1	10/2/92	EPA 5030/8015/8020
2100057	Water, MW-2	10/2/92	EPA 5030/8015/8020
2100058	Water, MW-3	10/2/92	EPA 5030/8015/8020
2100059	Water, MW-4	10/2/92	EPA 5030/8015/8020
2100060	Water, MW-5	10/2/92	EPA 5030/8015/8020
2100061	Water, E-4	10/2/92	EPA 5030/8015/8020
2100062	Trip Blank	10/2/92	EPA 5030/8015/8020
2100063	Field Blank	10/2/92	EPA 5030/8015/8020
2100064	X-Dup	10/2/92	EPA 5030/8015/8020

Please contact me if you have any questions. In the meantime, thank you for the opportunity to work with you on this project.

Very truly yours,

SEQUOIA ANALYTICAL

Michael R. Giles
Laboratory Director



SEQUOIA ANALYTICAL

819 Striker Avenue, Suite 8 • Sacramento, CA 95834
(916) 921-9600 • FAX (916) 921-0100

EMCON Associates
1433 N. Market Blvd.
Sacramento, CA 95834
Attention: Jim Pittilla

Client Project ID: Shell, 29 Wildwood Ave., Piedmont
Sample Matrix: Water
Analysis Method: EPA 5030/8015/8020
First Sample #: 210-0056

Sampled: Oct 2, 1992
Received: Oct 5, 1992
Reported: Oct 12, 1992

TOTAL PURGEABLE PETROLEUM HYDROCARBONS with BTEX DISTINCTION

Analyte	Reporting Limit ppm	Sample I.D. 210-0056 MW-1	Sample I.D. 210-0057 MW-2	Sample I.D. 210-0058 MW-3	Sample I.D. 210-0059 MW-4	Sample I.D. 210-0060 MW-5	Sample I.D. 210-0061 E-4
Purgeable Hydrocarbons	0.050	N.D.	N.D.	4.2	N.D.	0.076	N.D.
Benzene	0.00050	N.D.	N.D.	0.26	N.D.	N.D.	N.D.
Toluene	0.00050	N.D.	N.D.	0.010	N.D.	N.D.	N.D.
Ethyl Benzene	0.00050	N.D.	N.D.	0.013	N.D.	N.D.	N.D.
Total Xylenes	0.00050	N.D.	N.D.	0.012	N.D.	N.D.	N.D.
Chromatogram Pattern:		--	--	Gas	--	Discrete peak	--

Quality Control Data

Report Limit Multiplication Factor:	1.0	1.0	20	1.0	1.0	1.0
Date Analyzed:	10/8/92	10/8/92	10/8/92	10/8/92	10/8/92	10/8/92
Instrument Identification:	HP-2	HP-2	HP-2	HP-2	HP-2	HP-2
Surrogate Recovery, %: (QC Limits = 70-130%)	98	100	115	96	98	96

Purgeable Hydrocarbons are quantitated against a fresh gasoline standard.
Analytes reported as N.D. were not detected above the stated reporting limit.

SEQUOIA ANALYTICAL

Michael R. Giles
Laboratory Director



SEQUOIA ANALYTICAL

819 Striker Avenue, Suite 8 • Sacramento, CA 95834
(916) 921-9600 • FAX (916) 921-0100

EMCON Associates	Client Project ID:	Shell, 29 Wildwood Ave., Piedmont	Sampled:	Oct 2, 1992
1433 N. Market Blvd.	Sample Matrix:	Water	Received:	Oct 5, 1992
Sacramento, CA 95834	Analysis Method:	EPA 5030/8015/8020	Reported:	Oct 12, 1992
Attention: Jim Pittilla	First Sample #:	210-0062		

TOTAL PURGEABLE PETROLEUM HYDROCARBONS with BTEX DISTINCTION

Analyte	Reporting Limit ppm	Sample I.D. 210-0062 Trip Blank	Sample I.D. 210-0063 Field Blank	Sample I.D. 210-0064 X-Dup
Purgeable Hydrocarbons	0.050	N.D.	N.D.	N.D.
Benzene	0.00050	N.D.	N.D.	N.D.
Toluene	0.00050	N.D.	N.D.	N.D.
Ethyl Benzene	0.00050	N.D.	N.D.	N.D.
Total Xylenes	0.00050	N.D.	N.D.	N.D.
Chromatogram Pattern:		--	--	--

Quality Control Data

Report Limit Multiplication Factor:	1.0	1.0	1.0
Date Analyzed:	10/8/92	10/8/92	10/8/92
Instrument Identification:	HP-2	HP-2	HP-2
Surrogate Recovery, %: (QC Limits = 70-130%)	92	93	93

Purgeable Hydrocarbons are quantitated against a fresh gasoline standard.
Analytes reported as N.D. were not detected above the stated reporting limit.

SEQUOIA ANALYTICAL

Michael R. Giles
Laboratory Director



SEQUOIA ANALYTICAL

819 Striker Avenue, Suite 8 • Sacramento, CA 95834
(916) 921-9600 • FAX (916) 921-0100

EMCON Associates
1433 N. Market Blvd.
Sacramento, CA 95834
Attention: Jim Pittilla

Client Project ID: Shell, 29 Wildwood Ave., Piedmont

QC Sample Group: 2100056-64

Reported: Oct 12, 1992

QUALITY CONTROL DATA REPORT

ANALYTE	Benzene	Toluene	Ethylbenzene	Xylenes
Method:	EPA 602	EPA 602	EPA 602	EPA 602
Analyst:	Chiaravalloti	Chiaravalloti	Chiaravalloti	Chiaravalloti
Reporting Units:	ppm	ppm	ppm	ppm
Date Analyzed:	Oct 8, 1992	Oct 8, 1992	Oct 8, 1992	Oct 8, 1992
QC Sample #:	210-0056	210-0056	210-0056	210-0056
Sample Conc.:	N.D.	N.D.	N.D.	N.D.
Spike Conc. Added:	0.010	0.010	0.010	0.020
Conc. Matrix Spike:	0.0078	0.0081	0.0083	0.016
Matrix Spike % Recovery:	78	81	83	80
Conc. Matrix Spike Dup.:	0.0089	0.0088	0.0089	0.017
Matrix Spike Duplicate % Recovery:	89	88	89	85
Relative % Difference:	13	8.3	7.0	6.1

SEQUOIA ANALYTICAL

Michael R. Giles
Michael R. Giles
Laboratory Director

% Recovery:	$\frac{\text{Conc. of M.S.} - \text{Conc. of Sample}}{\text{Spike Conc. Added}} \times 100$
Relative % Difference:	$\frac{\text{Conc. of M.S.} - \text{Conc. of M.S.D.}}{(\text{Conc. of M.S.} + \text{Conc. of M.S.D.}) / 2} \times 100$



SHELL OIL COMPANY
RETAIL ENVIRONMENTAL ENGINEERING - WEST

CHAIN OF CUSTODY RECORD

Serial No: _____

Date: _____

Page 1 of 2

Site Address: 29 WILLOWOOD AVE, PIEDMONT

WIC#: 204-6001-0109

Shell Engineer: DAN KIRK Phone No. (510) 675-6168
 Fax #: 675-6172

Consultant Name & Address: BYRON ASSOCIATES

Consultant Contact: JIM PITTILA/PHIL GRAHAM Phone No.: 916 928-3300
 Fax #: 928-3341

Comments: GG7-01.01
TRI-REGIONAL DETECTION LIMITS
REPORT IN APM, PLEASE!

Sampled by: _____

Printed Name: _____

Analysis Required

TPH (EPA 8015 Mod. Gas)	TPH (EPA 8015 Mod. Diesel)	BTEX (EPA 8020/602)	Volatile Organics (EPA 8240)	Test for Disposal	Combination TPH 8015 & BTEX 8020	Asbestos	Container Size	Preparation Used	Composite Y/N
X		X					4oz WA	HCL	N

LAB: SEEDWIA

CHECK ONE (1) BOX ONLY	CT/DI	TURN AROUND TIME
Quarterly Monitoring <input checked="" type="checkbox"/>	6441	24 hours <input type="checkbox"/>
Site Investigation <input type="checkbox"/>	6441	48 hours <input type="checkbox"/>
Soil Classify/Disposal <input type="checkbox"/>	6442	16 days <input checked="" type="checkbox"/> (Normal)
Water Classify/Disposal <input type="checkbox"/>	6443	Other <input type="checkbox"/>
Soil/Air Rem. or Sys. O & M <input type="checkbox"/>	6482	NOTE: Notify Lab as soon as Possible of 24/48 hr. LAT.
Water Rem. or Sys. O & M <input type="checkbox"/>	6483	
Other <input type="checkbox"/>		

Sample ID	Date	Sludge	Soil	Water	Air	No. of conds.	TPH (EPA 8015 Mod. Gas)	TPH (EPA 8015 Mod. Diesel)	BTEX (EPA 8020/602)	Volatile Organics (EPA 8240)	Test for Disposal	Combination TPH 8015 & BTEX 8020	Asbestos	Container Size	Preparation Used	Composite Y/N	MATERIAL DESCRIPTION	SAMPLE CONDITION/ COMMENTS	
MW-1	10/2/92			X		2	X		X					4oz WA	HCL	N	S2100056A-B		
MW-2																		57	
MW-3																		58	
MW-4																		59	
MW-5																		60	
E-4																		61	
TRIP BLANK																		62	
FIELD BLANK																		63	

Relinquished By (signature): <u>J.R. Pittila</u>	Printed Name: <u>J.R. PITTILA</u>	Date: <u>10/5/92</u>	Time: <u>0910</u>	Received (signature): <u>Sheldon Fung</u>	Printed Name: <u>Sheldon Fung</u>	Date: <u>10/5/92</u>	Time: <u>0510</u>
Relinquished By (signature): _____	Printed Name: _____	Date: _____	Time: _____	Received (signature): _____	Printed Name: _____	Date: _____	Time: _____
Relinquished By (signature): _____	Printed Name: _____	Date: _____	Time: _____	Received (signature): _____	Printed Name: _____	Date: _____	Time: _____

THE LABORATORY MUST PROVIDE A COPY OF THIS CHAIN-OF-CUSTODY WITH INVOICE AND RESULTS



SHELL OIL COMPANY
RETAIL ENVIRONMENTAL ENGINEERING - WEST

CHAIN OF CUSTODY RECORD

Serial No: _____

Date: _____

Page 2 of 2

Site Address: 29 WILDWOOD AVE, PIEDMONT, CA

WIC#: 204-6001-0709

Shell Engineer:
DAN KIRK

Phone No.: (510) 675-6168
Fax #: 675-6172

Consultant Name & Address: EMCON ASSOCIATES
1433 N. MARKET, BLDG, SACRAMENTO, CA 95834

Consultant Contact:
JIM PITTILLA/PHIL GRAHAM

Phone No.: (916) 928-3308
Fax #: 928-3341

Comments: 0667-001.01
TRI-REGIONAL DETECTION LIMITS. PLEASE REPORT IN PPM.

Sampled by:

Printed Name:

Analysis Required

TPH (EPA 8015 Mod. Gas)	TPH (EPA 8015 Mod. Diesel)	BTEX (EPA 8020/602)	Volatile Organics (EPA 8240)	Test for Disposal	Combination TPH 6015 & BTEX 6020	Asbestos	Container Size	Preparation Used	Composite Y/N
X	X	X					4 to 20 L	Yes	N

LAB: SE00001A

CHECK ONE (1) BOX ONLY	CI/DI	TURN AROUND TIME
Quarterly Monitoring <input checked="" type="checkbox"/>	6461	24 hours <input type="checkbox"/>
Site Investigation <input type="checkbox"/>	6441	48 hours <input type="checkbox"/>
Soil Classify/Disposal <input type="checkbox"/>	6442	15 days <input checked="" type="checkbox"/> (Normal)
Water Classify/Disposal <input type="checkbox"/>	6443	Other <input type="checkbox"/>
Soil/Air Rem. or Sys. O & M <input type="checkbox"/>	6452	
Water Rem. or Sys. O & M <input type="checkbox"/>	6453	
Other <input type="checkbox"/>		

NOTE: Notify Lab as soon as possible of 24/48 hr. TAT.

Sample ID	Date	Sludge	Soil	Water	Air	No. of conts.	TPH (EPA 8015 Mod. Gas)	TPH (EPA 8015 Mod. Diesel)	BTEX (EPA 8020/602)	Volatile Organics (EPA 8240)	Test for Disposal	Combination TPH 6015 & BTEX 6020	Asbestos	Container Size	Preparation Used	Composite Y/N	MATERIAL DESCRIPTION	SAMPLE CONDITION/ COMMENTS
X-DUP	10/2/92			X		2	X	X	X					4 to 20 L	Yes	N	SZ100064 A-B	

Relinquished By (signature): <i>J.R. Pittilla</i>	Printed Name: J.R. PITTILLA	Date: 10/5/92	Received (signature): <i>Sheldon Fung</i>	Printed Name: Sheldon Fung	Date: 10/5/92
Relinquished By (signature):	Printed Name:	Time: 0910	Received (signature):	Printed Name:	Time: 0910
Relinquished By (signature):	Printed Name:	Date:	Received (signature):	Printed Name:	Date:
		Time:			Time:

THE LABORATORY MUST PROVIDE A COPY OF THIS CHAIN-OF-CUSTODY WITH INVOICE AND RESULTS