



ENVIRONMENTAL HEALTH SERVICES
ENVIRONMENTAL PROTECTION
1131 Harbor Bay Parkway, Suite 250
Alameda, CA 94502-6577
(510) 567-6700
FAX (510) 337-9335

PUBLIC NOTIFICATION OF POTENTIAL CASE CLOSURE
SHELL #13-5765
March 31, 2010

Site Location: 29 Wildwood Avenue, Piedmont, CA 94610
Fuel Leak Case RO0000495 and Geotracker Global ID T0600101246

Summary – This fact sheet has been prepared to inform community members and other interested parties of potential case closure for a fuel leak case at 29 Wildwood Avenue in Piedmont, California (see attached map on back). Site investigation and cleanup activities have been completed and it does not appear that the fuel release presents a risk to human health for nearby residents or site workers based upon current land use. Case closure will be granted for commercial land use only. Site investigation activities, which have been conducted at various times since 1988, have defined the extent of petroleum hydrocarbons in soil and groundwater beneath the site. Groundwater monitoring has been conducted since July 1989 using 5 groundwater monitoring wells at the site. The groundwater monitoring data indicate that the concentrations of petroleum hydrocarbons in groundwater have decreased since 1988 and that water quality is expected to be restored to water quality objectives through natural attenuation processes within a reasonable period of time. During the most recent groundwater sampling event in August 2009, the maximum concentration of methyl tert-butyl ether (MTBE) detected in groundwater beneath the site was 17 micrograms per liter (parts per billion). Groundwater contamination from the site will not affect the nearest water supply well which is located approximately 2,500 feet northeast of the site.

Background –. The site, which is located at the corner of Grand Avenue and Wildwood Avenue in Piedmont, California (see attached map on back), has operated as a gasoline service station for more than 25 years. A release of gasoline from the fueling system was discovered following tank removal and replacement operations in 1984. Groundwater monitoring wells were installed in 1989. Fuel system components consisting of the dispensers and product piping were upgraded in March 1998 and April 2005. Site investigation activities consisting of soil and groundwater sampling were conducted at the site at various times between 1988 and 2009.

Next Step – The public is invited to review and comment on the potential closure of the fuel leak case. The entire case file can be viewed over the Internet on the ACEH website (<http://www.acgov.org/aceh/lop/ust.htm>) or the State of California Water Resources Control Board Geotracker website (<http://geotracker.swrcb.ca.gov>). Please send written comments to Jerry Wickham at the address below; all comments will be forwarded to the responsible parties. **Comments received by May 6, 2010** will be considered and responded to prior to a final determination on the proposed case closure.

Additional information: Contact Jerry Wickham of the Alameda County Department of Environmental Health, 1131 Harbor Bay Parkway, Alameda, CA 94502 at 510-567-6791 or by email at jerry.wickham@acgov.org

I:\Shell\6-chars\2406--240687-Piedmont 29 Wildwood\240687-FIGURES\240687 SITE PLAN.DWG

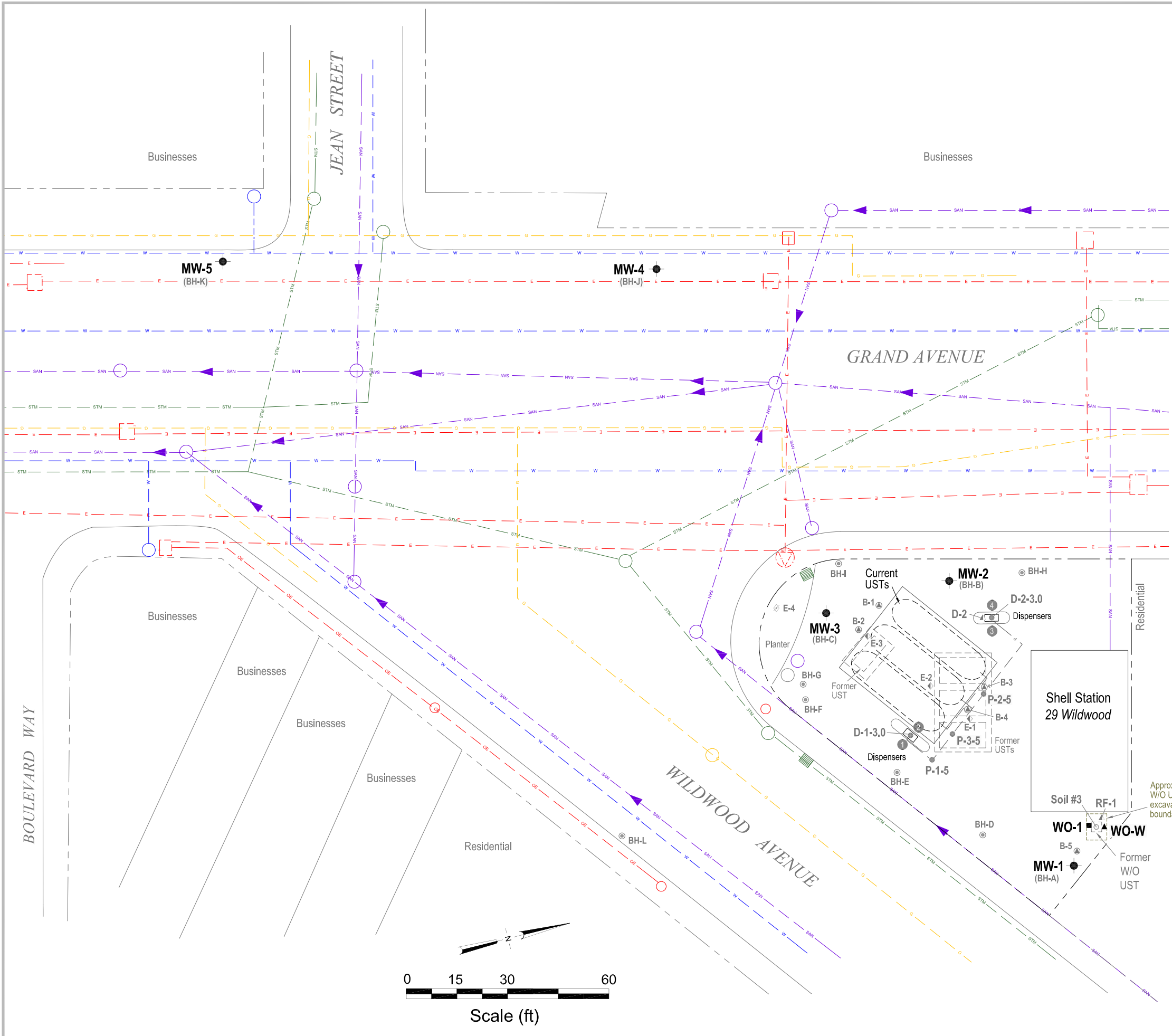

EXPLANATION

- WO-1** ■ Soil sample location (CRA, 5/09/07)
- WO-W** ▲ Grab groundwater sample location (CRA, 5/09/07)
- MW-1** ● Monitoring well location
- E-4** ⋄ Destroyed flowing artesian monitoring well
- D-1-3.0** ● Soil sample location (Cambria, 4/5/05)
- P-1-5** ● Soil sample location (Cambria, 4/29/05)
- D-2** ▲ Soil sample location (Cambria, 3/3/98)
- BH-J** ⊙ Soil boring location (Weiss, 1/23/90)
- BH-A** ⊙ Soil boring location (Weiss, 7/5/89)
- B-1** ⊙ Soil boring location (ENSCO, 8/9/88)
- Soil #3** ○ Soil sample location (Blaine, 6/16/87)
- E-1** ⋄ Soil boring location (EMCON, 8/15/84)
- STM --- Storm drain line (SD)
- STM --- Storm drain line (SD) (boxed culvert)
- SAN --- Sanitary sewer line (SS)
- W --- Water line (W)
- G --- Gas line (G)
- E --- Electrical line (E)
- OE --- Overhead electrical line (OE)
- Utility pole
- Electrical vault
- ⊗ Electrical transformer
- Manhole
- ▲ Flow direction
- Storm drain inlet
- ① Product dispenser number

Notes:
UST = Underground storage tank
W/O = Waste oil

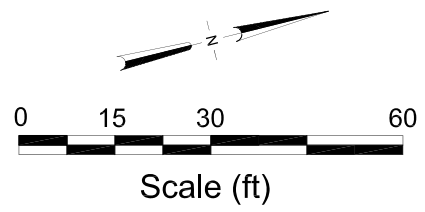

FIGURE 2

Site Plan



Shell-branded Service Station

29 Wildwood Avenue
Piedmont, California

ADAMS MARNA E TR
Parcel #: 11-854-7-1
523 BOULEVARD WAY
PIEDMONT CA 94610

~~ADAMS MARNA E TR
Parcel #: 50-854-20
523 BOULEVARD WAY
PIEDMONT CA 94610~~

ANN MARTIN CHILDRENS
Parcel #: 51-4638-15-1
1250 GRAND AVE
PIEDMONT CA 94610

~~ANN MARTIN FOUNDATION
Parcel #: 51-4638-16-1
1250 GRAND AVE
PIEDMONT CA 94610~~

BLOCK FAMILY LLC ETAL
Parcel #: 50-4557-15-1
710 NW WINCHESTER TER
PORTLAND OR 97210

BOTTO RICHARD D &
Parcel #: 10-833-37
339 PERSHING DR
OAKLAND CA 94611

BRISLAWN FERDINAND L &
Parcel #: 51-4638-18
8 FAIRVIEW AVE
PIEDMONT CA 94610

BROWN FRANCES G ETAL TR
Parcel #: 11-854-11
317 VASSAR AVE
KENSINGTON CA 94708

~~BROWN FRANCES G ETAL TR
Parcel #: 11-854-10
317 VASSAR AVE
KENSINGTON CA 94708~~

COLEMAN CHARLES A &
Parcel #: 11-854-12
5036 SW DOGWOOD DR
LAKE OSWEGO OR 97035

DAHMS LISE & LEE KEVIN
Parcel #: 11-854-19
16 WILDWOOD AVE
PIEDMONT CA 94610

~~DAHMS LISE & LEE KEVIN
Parcel #: 11-854-20
16 WILDWOOD AVE
PIEDMONT CA 94610~~

DARE DONALD R & MAYFORD
Parcel #: 51-4638-13
31 WILDWOOD AVE
PIEDMONT CA 94610

~~EQUILON ENTERPRISES LLC
Parcel #: 51-4638-14
P. O. BOX 4369
HOUSTON TX 77210~~

GRAND LAKE ACE
Parcel #: 10-833-2
1221 GRAND AVE
PIEDMONT CA 94610

~~GRAND LAKE ACE
Parcel #: 50-4557-16
1221 GRAND AVE
PIEDMONT CA 94610~~

KAY KANGSIK & JUNGHEE
Parcel #: 11-854-9
227 MAGNOLIA AVE
PIEDMONT CA 94610

KEATING TAMMI C &
Parcel #: 51-4638-12
35 WILDWOOD AVE
PIEDMONT CA 94610

KIM MYEONG H
Parcel #: 51-4638-11
39 WILDWOOD AVE
PIEDMONT CA 94610

MCKEAN KRISTINE H TR
Parcel #: 50-854-19
24 SYLVAN WAY
PIEDMONT CA 94610

NELSON DEBRA C & ZAHEDI
Parcel #: 50-4557-10
633 GRIZZLY PEAK BLVD
BERKELEY CA 94708

NEMECHEK JAMES G &
Parcel #: 50-854-22-1
214 LINDA AVE
PIEDMONT CA 94611

RASCO MEREDITH A &
Parcel #: 51-4638-17
4 FAIRVIEW AVE
PIEDMONT CA 94610

REOM HARRY E & CAROL M
Parcel #: 10-833-3-3
1221 GRAND AVE
PIEDMONT CA 94610

RESIDENT
Parcel #: 10-833-2
4011 GRAND AVE
OAKLAND CA 94610

RESIDENT
Parcel #: 10-833-3-3
4001 GRAND AVE
OAKLAND CA 94610

RESIDENT
Parcel #: 50-4557-16
1201 GRAND AVE
PIEDMONT CA 94610

RESIDENT
Parcel #: 11-854-11
6 WILDWOOD AVE
OAKLAND CA 94610

RESIDENT
Parcel #: 11-854-9
460 BOULEVARD WAY
OAKLAND CA 94610

RESIDENT
Parcel #: 11-854-7-1
SYLVAN WAY
OAKLAND CA 94610

RESIDENT
Parcel #: 50-4557-10
1235 GRAND AVE
PIEDMONT CA 94610

RESIDENT
Parcel #: 11-854-12
8 WILDWOOD AVE
OAKLAND CA 94610

RESIDENT
Parcel #: 50-854-22-1
32 WILDWOOD AVE
PIEDMONT CA 94610

RESIDENT
Parcel #: 50-4557-15-1
1221 GRAND AVE
PIEDMONT CA 94610

RESIDENT
Parcel #: 11-854-13
12 WILDWOOD AVE
OAKLAND CA 94610

RESIDENT
Parcel #: 51-4638-15-1
1246 GRAND AVE
PIEDMONT CA 94610

RESIDENT
Parcel #: 50-854-23-1
36 WILDWOOD AVE
PIEDMONT CA 94610

RESIDENT
Parcel #: 51-4638-14
29 WILDWOOD AVE
PIEDMONT CA 94610

RESIDENT
Parcel #: 11-854-10
3900 GRAND AVE
OAKLAND CA 94610

RESIDENT
Parcel #: 50-854-20
20 WILDWOOD AVE
PIEDMONT CA 94610

RESIDENT
Parcel #: 50-854-23-5
26 SYLVAN WAY
PIEDMONT CA 94610

RESIDENT
Parcel #: 10-833-37
3931 GRAND AVE
OAKLAND CA 94610

TALCOTT MALCOLM D &
Parcel #: 50-854-21
22 WILDWOOD AVE
PIEDMONT CA 94610

TOM WILBUR TR
Parcel #: 50-854-23-5
2411 ROYAL OAKS DR
ALAMO CA 94507

TWELVE WILDWOOD LLC
Parcel #: 11-854-13
5830 ROSS ST
OAKLAND CA 94618

WINN ANDREW M & MIRNA H
Parcel #: 50-854-23-1
1806 LAUREL LN
LAKE CLARKE FL 33406