



**Delta**  
Environmental  
Consultants, Inc.

February 2, 2001

Mr. Karl Busche  
City of San Leandro  
Environmental Services Division  
835 East 14<sup>th</sup> Street  
San Leandro, CA 94577

Subject: *Tank Basin, Product Line and Dispenser Island Sampling Results*  
ARCO Station No. 2111  
1156 Davis Street  
San Leandro, California  
Delta Project No. D000-306

Dear Mr. Busche:

Delta Environmental Consultants, Inc. (Delta) has been authorized by ARCO Products Company to conduct soil sampling during the removal and replacement of underground storage tanks (USTs), product distribution lines and product dispenser islands at ARCO Service Station No. 2111, located at 1156 Davis Street, San Leandro, California (Figure 1). Site details are illustrated in Figure 2. This report summarizes the sampling activities and analytical results for samples collected during the UST, product line and dispenser removal and upgrade activities. Field activities were performed in accordance with Delta's field methods and procedures outlined in Enclosure A.

**Underground Storage Tank Removal**

On October 17, 2000, three 12,000-gallon underground storage tanks were excavated and inspected upon removal. Petcon Technologies, Inc. was contracted by ARCO to obtain all necessary tank removal permits, make all required preliminary notifications, and to clean, remove and dispose of the removed USTs. Ecology Control Industries transported the tanks to their facility in Richmond, California under a uniform hazardous waste manifest. Pertinent information concerning the UST removal activities is summarized below:

- Lead Agency: City of San Leandro, Environmental Services Division
- Agency Contact Name: Karl Busche
- Agency Phone Number: (510) 577-3401
- UST Cleaning Contractor: Petcon Technologies, Inc., 390 Amapola Avenue, Unit 3, Torrance, CA 90501
  
- Final Disposition of Rinseate: DeMenno Kerdoon, 2000 North Alameda Street, Compton, CA 90222 (Uniform Hazardous Waste Manifest included in Enclosure B)
  
- Final Disposition of USTs: Pacheco Pass Landfill, 3675 Pacheco Pass, Gilroy, California (Uniform Hazardous Waste Manifest and Certificate of Disposal included in Enclosure B)

*ALAMEDA 7<sup>th</sup> & N COP SITE  
MONEY SPENT  
INDOIL DISPENSER ISLAND*

*STOP  
744*

*Verdugo  
1/22/2001  
(Signature)*

3164 Gold Camp Drive  
Suite 200  
Rancho Cordova, CA 95670-6021  
U.S.A.  
916/638-2085  
FAX: 916/638-8385

00-223-6 PM 2:58  
ENVIRONMENTAL  
PROTECTION

### **Soil Sampling Beneath Product Lines and Dispenser Island**

A Delta representative was on-site October 17, 2000 to conduct soil sampling during product line and dispenser removal and upgrade activities. A representative from the City of San Leandro Health Services Department was on-site to observe the sampling. Soil samples were collected beneath the dispensers following their removal. Dispenser soil samples DP-1 through DP-8 were collected at depths ranging from 4.0 to 8.0 feet below surface grade (bsg). Product line soil samples PL-1 through PL-4 were collected within the product line trench at depths ranging from 4.0 to 6.0 feet bsg. The soil sample locations are shown in Figure 3. All dispenser pump and product line soil samples were collected directly from the backhoe, using brass tubes, as outlined in Enclosure A.

Following collection, the soil sample tubes were capped with Teflon tape and plastic caps and stored on ice until the time the samples were received at the laboratory. Samples were submitted to Kiff Analytical Laboratory (Kiff) in Davis, California for analysis of benzene, toluene, ethylbenzene, total xylenes (BTEX), methyl tertiary butyl ether (MTBE), and total petroleum hydrocarbons (TPH) as gasoline using EPA Method 8260 Modified, and total lead using EPA Method 6010. Soil sample analytical results are summarized in Table 1.

In soil samples collected during the October 17, 2000 sampling event, the laboratory reported detectable concentrations of benzene ranging from 0.0056 milligrams per kilogram (mg/kg) in soil sample DP-4 to 2.0 mg/kg in soil sample DP-1. The laboratory reported detectable concentrations of TPH as gasoline ranging from 1.3 mg/kg in PL-4 to 2,100 mg/kg in DP-1. The laboratory reported detectable concentrations of MTBE ranging from 0.17 mg/kg in PL-3 to 13 mg/kg in DP-1. Analytical results for lead ranged from 11 mg/kg in PL-4 to 25 mg/kg in DP-6. A copy of the October 17, 2000 laboratory analytical report with chain-of-custody documentation is included in Enclosure C.

### **Soil Sampling Beneath Underground Storage Tanks**

A Delta representative was on-site October 19, 2000 to conduct soil sampling following the removal of three 12,000-gallon underground storage tanks. A representative from the City of San Leandro Health Services Department was on-site to observe the sampling. Soil samples were collected from the North and South ends of the three USTs following their removal. An additional soil sample was taken from the middle of the second UST. Tank samples T1-N, T1-S, T2-N, T2-M, T2-S, T3-N and T3-S were collected at depths ranging from 16.0 to 17.0 feet bsg. The soil sample locations are shown in Figure 3. Tank basin soil samples were collected using a hand auger and impact sampler equipped with brass liners, as outlined in Enclosure A.

Following collection, the soil sample tubes were capped with Teflon tape and plastic caps and stored on ice until the time the samples were received at the laboratory. Samples were submitted to Kiff for analysis of BTEX, MTBE and TPH as gasoline using EPA Method 8260, and total lead using EPA Method 6010. Soil sample analytical results are summarized in Table 1.

In the tank basin soil samples collected during the October 19, 2000 sampling event, the laboratory reported detectable concentrations of benzene ranging from 0.21 mg/kg in soil sample T1-S to 7.7 mg/kg in soil sample T2-N. The laboratory reported detectable concentrations of TPH as gasoline ranging from 110 mg/kg in T1-S to 4,400 mg/kg in T2-N. The laboratory reported detectable concentrations of MTBE ranging from 6.5 mg/kg in T3-S to 89 mg/kg in T1-N. Analytical results for lead ranged from 8.1 mg/kg in

Mr. Karl Busche  
City of San Leandro  
Environmental Services Division  
February 2, 2001  
Page 3

T2-S to 13 mg/kg in T2-N. A copy of the October 19, 2000 laboratory analytical report with chain-of-custody documentation is included in Enclosure C.

### **Overexcavation Sampling Analytical Results**

A Delta representative was on-site October 26, 2000 to conduct soil sampling following the overexcavation of soil around dispenser pumps DP-1 and DP-2. A representative from the City of San Leandro Health Services Department was on-site to direct the overexcavation and observe the sampling. Following the removal of approximately 23 cubic yards of soil, two soil samples were taken from the bottom of the excavation. Overexcavation samples OX-1 and OX-2 were collected at depths ranging from 10.0 to 9.5 feet bsg, respectively. The soil sample locations are shown in Figure 3. Overexcavation soil samples were collected directly from the backhoe using brass tubes as outlined in Enclosure A.

Following collection, the soil sample tubes were capped with Teflon tape and plastic caps and stored on ice until the time the samples were received at the laboratory. Samples were submitted to Kiff for analyses of BTEX, MTBE and TPH as gasoline using EPA Method 8260, and total lead using EPA Method 6010. Soil sample analytical results are summarized in Table 1.

In the overexcavation soil samples collected during the October 26, 2000 sampling event, the laboratory reported detectable concentrations of benzene at 0.18 mg/kg (OX-2) and 0.4 mg/kg (OX-1). The laboratory reported detectable concentrations of TPH as gasoline at 2.7 mg/kg (OX-1) and 19 mg/kg (OX-2). The laboratory reported detectable concentrations of MTBE at 1.5 mg/kg (OX-1) and 7.7 mg/kg (OX-2). Analytical results for lead were reported at 9.7 mg/kg (OX-1) and 11 mg/kg (OX-2). A copy of the October 26, 2000 laboratory analytical report with chain-of-custody documentation is included in Enclosure C.

### **Soil Management and Stockpile Sampling**

A total of approximately 1,376.32 tons (930 cubic yards) of overburden was excavated from the gasoline UST basin, dispensers and lines prior to removing the three tanks. Due to limited space on site, the soil was direct loaded for transport by Dillard Trucking, Inc. (Dillard) to Forward Landfill located in Manteca, California on October 16, October 17, October 19, October 20, November 10 and November 28, 2000. Based on the soil profile obtained from the UST basin, lines and dispenser soil sample results, the soil was disposed of appropriately.

A total of approximately 170.17 tons (115 cubic yards) of overexcavated soil was stockpiled onsite for disposal profile analysis. Four point composite soil samples from the stockpiles were collected in brass tubes for each approximate 50 cubic yards of soil and delivered to the laboratory for analysis. Soil samples were analyzed by Kiff for BTEX, TPH as gasoline and lead to ensure results met waste acceptance guidelines at Forward Landfill in Manteca, California. Soil stockpile analytical results are presented in Table 1. A copy of the soil stockpile laboratory analytical report with chain-of-custody documentation is included in Enclosure D. The stockpiled soil was removed from the site on December 10 and December 12, 2000 by Dillard and transported to Forward Landfill. A copy of the completion letter for all of the soil removed from the site is included in Enclosure E.

Mr. Karl Busche  
City of San Leandro  
Environmental Services Division  
February 2, 2001  
Page 4

**Remarks/Signatures**

The interpretations contained in this document represent our professional opinions and are based, in part, on information supplied by the client. These opinions are based on currently available information and are arrived at in accordance with currently accepted hydro-geologic and engineering practices at this time and location. Other than this, no warranty is implied or intended.

If you have any questions regarding this project, please contact Steve Meeks at (916) 536-2613.

**DELTA ENVIRONMENTAL CONSULTANTS, INC.**

  
Trevor L. Atkinson  
Project Engineer

  
Steven W. Meeks, P.E.  
Project Manager  
California Registered Civil Engineer No. C057461



TLA (LRP004.306.doc)  
Enclosures

cc: Mr. Paul Supple – Atlantic Richfield Company  
Mr. Amir Gholami – Alameda County Health Care Services Agency  
Mr. Mike Bakaldin - San Leandro Fire Department, HazMat Program

TABLE 1

## SOIL SAMPLE LABORATORY ANALYTICAL RESULTS

ARCO Service Station No. 2111  
1156 Davis Street  
San Leandro California

Sample ID	Date	Depth (ft)	Benzene (mg/kg)	Toluene (mg/kg)	Ethyl-benzene (mg/kg)	Total Xylenes (mg/kg)	TPH as Gasoline (mg/kg)	MTBE (mg/kg)	Lead (mg/kg)
<b>Dispenser Island Samples</b>									
DP-1	10/17/00	5.0	2	20	30	170	2,100	13	15
DP-2	10/17/00	8.0	0.77	0.84	7.4	32	440	4.4	13
DP-3	10/17/00	4.0	0.014	0.12	0.26	1.9	31	2.2	15
DP-4	10/17/00	4.5	0.0056	0.059	0.1	0.68	9.4	0.9	12
DP-5	10/17/00	4.0	0.0061	<0.005	<0.005	<0.005	<1.0	1.5	14
DP-6	10/17/00	4.0	<0.005	<0.005	<0.005	<0.005	<1.0	0.2	25
DP-7	10/17/00	5.0	<0.005	<0.005	<0.005	<0.005	2.2	2.4	13
DP-8	10/17/00	5.0	<0.005	<0.005	<0.005	0.092	<1.0	0.35	13
<b>Product Line Samples</b>									
PL-1	10/17/00	4.0	0.16	<0.05	2.1	3.6	430	0.36	14
PL-2	10/17/00	6.0	<0.005	0.02	0.0077	0.6	14	4.7	12
PL-3	10/17/00	5.0	<0.005	<0.005	<0.005	<0.005	<1.0	0.17	12
PL-4	10/17/00	5.0	<0.005	<0.005	<0.005	0.043	1.3	0.86	11
<b>Tank Basin Samples</b>									
T1-S	10/19/00	17.0	0.21	2.1	1.6	8.5	110	33	8.9
T1-N	10/19/00	16.0	4.7	79	30	170	1,900	89	10
T2-S	10/19/00	16.0	1.1	26	14	77	1,100	18	8.1
T2-M	10/19/00	16.0	1.9	38	11	59	800	59	8.3
T2-N	10/19/00	17.0	7.7	190	58	300	4,400	76	13
T3-S	10/19/00	16.0	1.3	8.4	29	120	340	6.5	12
T3-N	10/19/00	16.0	5.0	76	28	140	1,800	83	12
<b>Soil Overexcavation Samples</b>									
OX-1	10/26/00	10.0	0.4	<0.005	<0.005	0.0091	2.7	1.5	9.7
OX-2	10/26/00	9.5	0.18	0.81	0.42	2.6	19	7.7	11
<b>Soil Stockpile Results</b>									
STK-1	10/19/00	Composite	0.019	0.017	0.052	0.27	8	NA	11
STK-2	10/26/00	Composite	0.054	0.48	0.64	3.8	86	0.91	9.6

TPH = Total petroleum hydrocarbons.

MTBE = Methyl tertiary butyl ether (analyzed by EPA Method 8260)

NA = Not Analyzed



R.3 W.

\\Sacramento\CAD Files\ARCO\21112111-1A.dwg

GENERAL NOTES:  
 BASE MAP FROM U.S.G.S.  
 SAN LEANDRO, CA.  
 7.5 MINUTE TOPOGRAPHIC  
 PHOTOREVISED 1980



QUADRANGLE LOCATION



SCALE 1:24,000

FIGURE 1  
 SITE TOPOGRAPHIC MAP  
 ARCO STATION NO. 2111  
 1156 DAVIS STREET  
 SAN LEANDRO, CA

PROJECT NO. D000-306	DRAWN BY TLA 11/03/00
FILE NO. 2111-1A	PREPARED BY TLA
REVISION NO.	REVIEWED BY



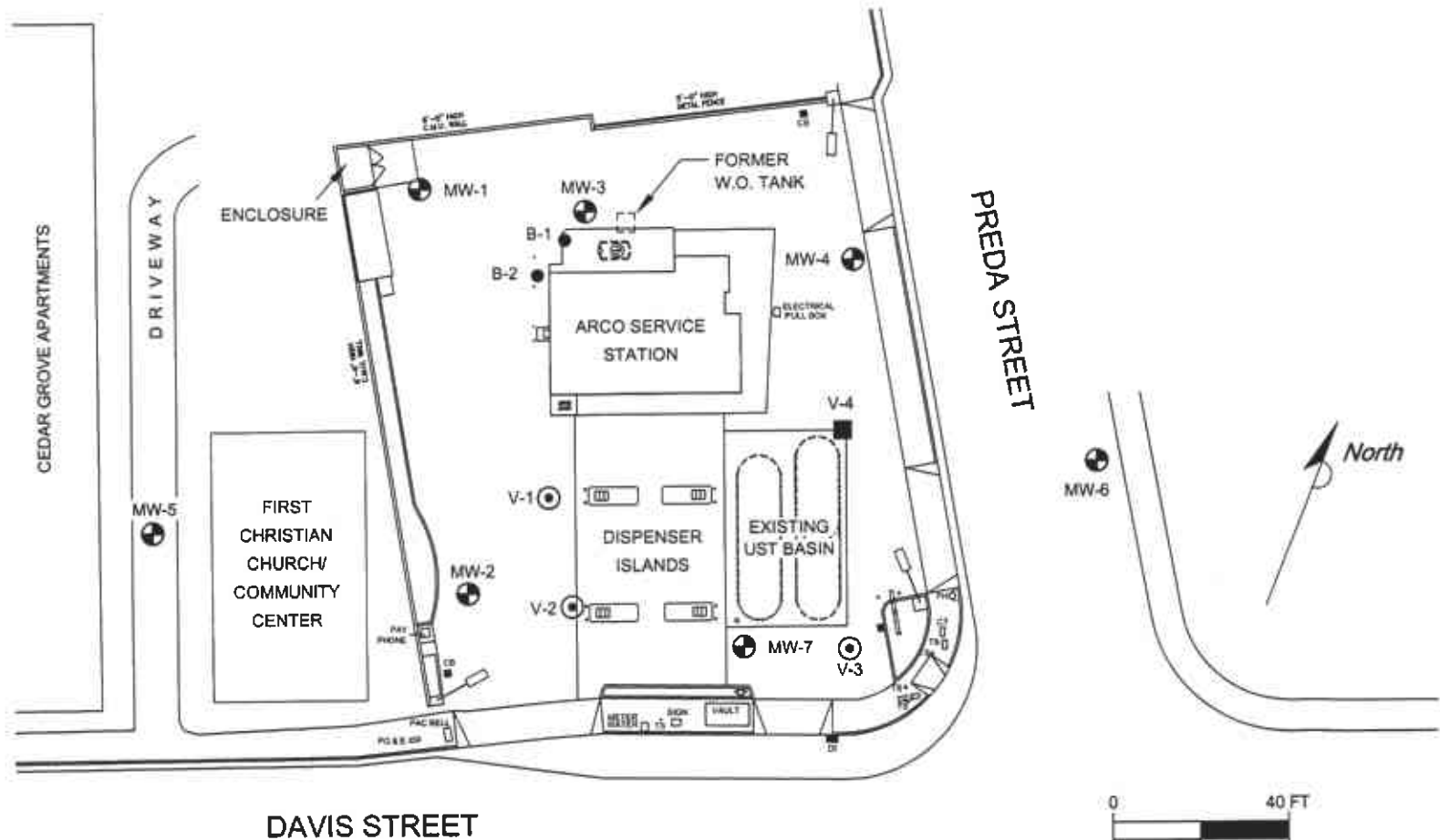

**LEGEND:**

- MW-1 MONITORING WELL LOCATION
- ⊙ V-1 VAPOR EXTRACTION WELL LOCATION
- B-1 SOIL BORING LOCATION
- V-4 DESTROYED WELL LOCATION

**FIGURE 2  
SITE MAP**  
**ARCO SERVICE STATION NO. 2111**  
**1156 DAVIS STREET**  
**SAN LEANDRO, CALIFORNIA**

PROJECT NO. D000-306	DRAWN BY TLA 8/31/00
FILE NO.	PREPARED BY TLA
REVISION NO. 1	REVIEWED BY



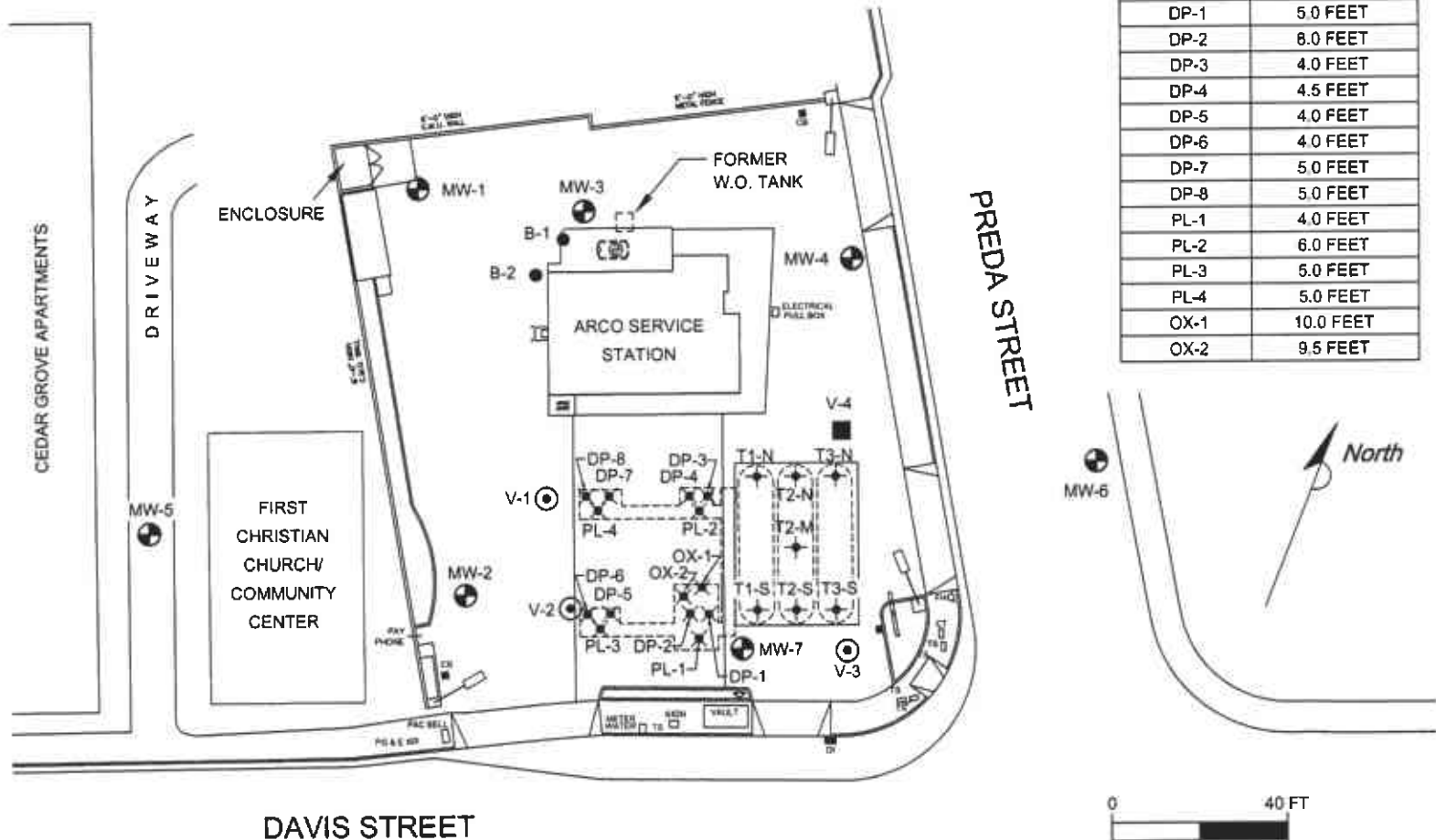

DISPENSER PUMP & PRODUCT LINES

SAMPLE I.D.	SAMPLE DEPTH
DP-1	5.0 FEET
DP-2	8.0 FEET
DP-3	4.0 FEET
DP-4	4.5 FEET
DP-5	4.0 FEET
DP-6	4.0 FEET
DP-7	5.0 FEET
DP-8	5.0 FEET
PL-1	4.0 FEET
PL-2	6.0 FEET
PL-3	5.0 FEET
PL-4	5.0 FEET
OX-1	10.0 FEET
OX-2	9.5 FEET

LEGEND:

- MW-1 MONITORING WELL LOCATION
- ⊙ V-1 VAPOR EXTRACTION WELL LOCATION
- B-1 SOIL BORING LOCATION
- V-4 DESTROYED WELL LOCATION
- ✦ T-1-N TANK BASIN SOIL SAMPLE LOCATIONS
- ✕ PL-1 FORMER PRODUCT LINE/ DISPENSER PUMP SOIL SAMPLE LOCATIONS

FORMER TANK BASIN

SAMPLE I.D.	SAMPLE DEPTH
T1-N	17 FEET
T2-N	17 FEET
T3-N	16 FEET
T2-M	18 FEET
T1-S	18 FEET
T2-S	16 FEET
T3-S	16 FEET

FIGURE 3  
SOIL SAMPLE LOCATION MAP  
ARCO SERVICE STATION NO. 2111  
1156 DAVIS STREET  
SAN LEANDRO, CALIFORNIA

PROJECT NO. D000-306	DRAWN BY TLA 11/03/00
FILE NO.	PREPARED BY TLA
REVISION NO. 1	REVIEWED BY





## **FIELD METHODS AND PROCEDURES**

ARCO Station No. 2111  
1156 Davis Street, San Leandro, California

### **1.1 Health and Safety Plan**

Delta personnel performed fieldwork in accordance with a Health and Safety Plan developed for the site. This plan described the basic safety requirements for the subsurface investigation at the site. The Health and Safety Plan was applicable to personnel and subcontractors of Delta. Personnel at the site were informed of the contents of the Health and Safety Plan prior to beginning work. A copy of the Health and Safety Plan was kept at the work site and was available for reference by appropriate parties during the work. The Delta geologist acted as the Site Safety Officer.

### **1.2 Soil Sampling and Contamination Reduction**

Soil sampling was performed under the direction of Delta geologists. To reduce the chances of cross-contamination between samples, all sampling equipment was either steam-cleaned or washed with a non-phosphatic detergent between each sample location. To reduce cross-contamination between samples, the sampler was washed in a soap solution and double-rinsed between each sampling event.

### **1.3 Soil Sample Collection**

Soil at the sample location was excavated to a depth of approximately 6 inches above the sampling depth. At this depth, a hand operated impact sampler lined with a 6-inch clean brass sampling tube was used to collect the soil sample. Soil cuttings collected immediately above the soil sample were placed into a Ziploc<sup>®</sup> bag and sealed for later screening with a PID. That part of the soil sample collected in the brass tube within the impact sampler was sealed with Teflon<sup>®</sup> sheeting and plastic caps, labeled and stored on ice at approximately 4° C for transport to the laboratory.

### **1.4 Soil Sample Screening/hNu Portable Photoionization Detector Method**

After the soil sample Ziploc<sup>®</sup> bags had been brought to ambient temperature, the headspace vapors of the soil sample in the bag were screened with a PID equipped with a 10.2 eV lamp. The corner of the sample bag was opened and the detector probe immediately placed within the headspace. The highest observed reading was recorded. Field instruments such as the PID are useful for indicating relative levels of hydrocarbon vapors, but do not detect concentrations with the same precision as laboratory analyses.

### **1.5 Product Distribution Lines and Dispenser Sampling**

Soil samples were collected following the removal of the product distribution lines and dispensers. Samples were collected approximately 1 foot below the backfill/native soil interface within the product line trench. If groundwater was encountered above the base of the excavation, soil samples were collected from the sidewalls of the excavations immediately above the groundwater. Following removal of the dispensers, one soil sample was collected approximately 2 feet below the backfill/native soil interface beneath each dispenser.

### **1.6 Soil Stockpile Sampling**

Four soil samples will be collected from each 50 cubic yards of stockpiled soil, with each set of four samples to be composited in the laboratory prior to analyses. Soil samples will be collected in 2-inch diameter brass tubes that will be sealed with Teflon sheeting and plastic caps. The samples will be labeled, stored in an ice chest and cooled to approximately 4°C for transport to the laboratory.

## **2.0 ANALYTICAL PROCEDURES**

Selected soil samples submitted to the laboratory were analyzed for BTEX, TPH as gasoline and MTBE using EPA Method 8260 and total lead using EPA Method 6010.

## **3.0 QUALITY ASSURANCE PLAN**

This section describes the field and analytical procedures followed throughout the investigation.

### **3.1 General Sample Collection and Handling Procedures**

Proper collection and handling are essential to ensure the quality of a sample. Each sample was collected in a suitable container, preserved correctly for the intended analysis, and stored prior to analysis for no longer than the maximum allowable holding time. Details on the procedures for collection and handling of soil samples used on this project can be found in Section 1.0 (Methods).

### **3.2 Sample Identification and Chain-of-Custody Procedures**

Sample identification and chain-of-custody procedures ensure sample integrity and document sample possession from the time of collection to its ultimate disposal. Each sample container submitted for analysis had a label affixed to identify the job number, sampler, date and time of sample collection, and a sample number unique to that sample. This information, in addition to a description of the sample, field measurements made, sampling methodology, names of on-site personnel, and any other pertinent field observations, was recorded on the borehole log or in the field records. A California-certified laboratory analyzed samples.

A chain-of-custody form was used to record possession of the sample from time of collection to its arrival at the laboratory. When the samples were shipped, the person in custody of them relinquished the samples by signing the chain-of-custody form and noting the time. The sample-control officer at the laboratory verified sample integrity and confirmed that the samples were collected in the proper container, preserved correctly, and that there was an adequate volume for analysis.

If these conditions were met, the sample was assigned a unique log number for identification throughout analysis and reporting. The log number was recorded on the chain-of-custody form and in the legally-required logbook maintained by the laboratory in the laboratory. The sample description, date received, client's name, and other relevant information was also recorded.

**ENCLOSURE B**

General Permits, Uniform Hazardous Waste Manifests and Certificates of Disposal

DEVELOPMENT SERVICES



Building Regulations

**City of San Leandro  
BUILDING PERMIT**

**Job Site Copy**

Permit No.: **BLD2000-00772**  
Address: 1156 Davis St  
Contact: PETCON TECH. INC.  
925-931-0136

**JOB SITE INSPECTION RECORD -- APPLICANT SHALL POST ON JOB SITE**

INSPECTION	CODE	DATE	INSP.
<b>ALL MISCELLANEOUS INSPECTIONS 0009 (SEE BACK SIDE OF CARD)</b>			
<b>VERIFY SOILS ENGINEERING:</b>			
COMPACTION, EXCAVATION, GRADING, OBSERVATION REPORT, ETC.	0010		
<b>REQUIRED PRIOR TO FOUNDATION INSPECTION</b>			
<b>UNDERGROUND INSPECTIONS--SITE:</b>			
SEWER	0210		
WATER	0220		
PLUMBING	0240	11/15/00	JR
ELECTRICAL	0250		
<b>DO NOT BACK FILL UNTIL ABOVE IS APPROVED</b>			
<b>UNDER OR IN SLAB INSPECTIONS:</b>			
PLUMBING	0310	12/20/00	JR
MECHANICAL	0320		
ELECTRICAL	0330		
REINFORCEMENT	0340		
<b>DO NOT BACK FILL UNTIL ABOVE IS APPROVED</b>			
<b>FOUNDATION INSPECTIONS</b>			
SETBACKS	0410		
FOOTINGS	0420		
PIERS/CASSONS	0430		
HOLD DOWNS	0440		
UFER GROUND	0450		
VERIFY SPECIAL INSPECTION	0460		
<b>DO NOT PLACE CONCRETE UNTIL ABOVE IS APPROVED</b>			
<b>UNDERFLOOR INSPECTIONS:</b>			
PLUMBING	0510		
MECHANICAL	0520		
ELECTRICAL	0530		
FRAMING	0540		
INSULATION	0550		
<b>DO NOT INSTALL SUBFLOOR UNTIL ABOVE IS APPROVED</b>			
<b>SHEAR NAILING:</b>			
WALLS -- INTERIOR	0610		
EXTERIOR	0620		
ROOF	0630		
FLOOR	0640		
<b>CONNECTIONS</b>			
COLLECTORS/DIAG STRUTS	0650		
HOLD DOWNS	0660		
FRAME	0670		
<b>FRAME/TOP OUT INSPECTIONS:</b>			
FRAME	0680		
PLUMBING	0690		
SHOWER PAN/HOT MOP	0700		
MULTI-STORY WASTE	0710		
GAS PIPING	0720		
MECHANICAL	0730		
MECHANICAL - FIRE DAMPER	0740		
ELECTRICAL	0750		
MFG. FIREPLACE	0760		
<b>MASONRY FIREPLACE:</b>			
THROAT DAMPER	0770		
ANCHORAGE	0780		
VERIFY SPECIAL INSPECTIONS	0790		
<b>CONCRETE/MASONRY WALLS:</b>			
REINFORCEMENT	0810		
VERIFY SPECIAL INSPECTION	0820		
<b>DO NOT COVER WORK UNTIL ABOVE IS APPROVED</b>			
<b>INSULATION:</b>			
WALLS	0910		
CEILING	0920		
<b>DO NOT COVER UNTIL ABOVE IS APPROVED</b>			

INSPECTION	CODE	DATE	INSP.
<b>SPECIAL INSPECTION LETTERS:</b>			
TESTING AGENCY (Final Compliance Form)	1010		
STRUCTURAL OBSERVATIONS	1020		
<b>DO NOT FINAL PROJECT UNTIL THE ABOVE IS APPROVED IF REQUIRED</b>			
<b>SHEETROCK:</b>			
NAIL/SCREW	1110	11/17/00	JR
FIRE WALL -- 1ST LAYER	1120		
2ND LAYER	1130		
TUB/SHOWER WALLBOARD	1140		
<b>DO NOT TAPE UNTIL ABOVE IS APPROVED</b>			
<b>LATH AND PLASTER:</b>			
INTERIOR	1210		
EXTERIOR - SCRATCH	1230		
BROWN	1240		
EXTERIOR VENEER	1310		
PRE-INSPECTION	1350		
<b>"T" BAR INSPECTION:</b>			
MECHANICAL	1410		
ELECTRICAL	1420		
BUILDING	1430		
<b>RE-ROOFS:</b>			
PRE-ROOF	1510		
STRUCTURAL	1520		
ROOF NAIL	1530		
<b>FINAL</b>			
<b>SWIMMING POOLS:</b>			
LOCATION (ON SITE)	1610		
STEEL & BOND	1620		
UNDERGROUND ELECTRICAL	1630		
SEWER REROLTE	1640		
GAS LINES	1650		
PREDECK	1660		
FILLER LINES	1670		
CIRCULATING LINES (PRESSURE TEST)	1680		
PRE PLASTER/FENCING	1690		
ROUGH ELECTRICAL	1700		
VERIFY SPECIAL INSPECTION	1710		
FINAL	1720		
<b>FINAL REQUIRED - POOL NOT TO BE FILLED UNTIL BARRIER IS IN PLACE:</b>			
<b>RESIDENTIAL SEISMIC WORK:</b>			
PRECONSTRUCTION	1810		
SILL PLATE BOLTING	1820		
SHEAR PANEL INSTALLTION	1830		
FLOOR CONNECTORS	1840		
FINAL	1850		
<b>SIGN INSPECTIONS:</b>			
BUILDING CONNECTION	1910		
ELECTRICAL	1920		
FINAL	1930		

<b>FINAL APPROVALS</b>			
PLUMBING	2010		
MECHANICAL	2020		
ELECTRICAL	2030		
FIREPLACE	2040		
ELECTRICAL SERVICE RELEASE	2050		
GAS SERVICE RELEASE	2060		
TEMPORARY POWER POLE	2070		
ENERGY REGULATION	2080		
BUILDING PERMIT	2090		
FIRE DEPARTMENT	2100		
FIRE INSPECTION	2110		

This permit shall become void and work shall be considered abandoned if an inspection has not been requested and approved within the 24-Hour Inspection Request: 518.577.3426

DEVELOPMENT SERVICES



# City of San Leandro BUILDING PERMIT Job Site Copy

Building Regulations

Permit No.: **BLD2000-00772**  
Address: 1156 Davis St  
Contact: **PETCON TECH. INC.**  
925/931-0136

### JOB SITE INSPECTION RECORD -- APPLICANT SHALL POST ON JOB SITE.

INSPECTION	CODE	DATE	INSP.	INSPECTION	CODE	DATE	INSP.
<b>ALL MISCELLANEOUS INSPECTIONS</b> 0009 (SEE BACK SIDE OF CARD)				<b>SPECIAL INSPECTION LETTERS:</b>			
<b>VERIFY SOILS ENGINEERING:</b>				TESTING AGENCY (Final Compliance Form) 1010			
COMPACTON, EXCAVATION, GRADING,				STRUCTURAL OBSERVATIONS 1020			
OBSERVATION REPORT, ETC. 0010				<b>DO NOT FINAL PROJECT UNTIL THE ABOVE IS APPROVED IF REQUIRED</b>			
<b>REQUIRED PRIOR TO FOUNDATION INSPECTION</b>				<b>SHEETROCK:</b>			
<b>UNDERGROUND INSPECTIONS--SITE:</b>				NAIL/SCREW 1110 <i>11/17/00</i>			
SEWER	0210			FIRE WALL - 1ST LAYER 1120			
WATER	0220			2ND LAYER 1120			
PLUMBING	0240	<i>11/5/00</i>	<i>[Signature]</i>	TUB/SHOWER WALLBOARD 1140			
ELECTRICAL	0250			<b>DO NOT TAPE UNTIL ABOVE IS APPROVED</b>			
<b>DO NOT BACK FILL UNTIL ABOVE IS APPROVED</b>				<b>LATH AND PLASTER:</b>			
<b>UNDER OR IN SLAB INSPECTIONS:</b>				INTERIOR 1210			
PLUMBING	0310	<i>12/20/00</i>	<i>[Signature]</i>	EXTERIOR - SCRATCH 1230			
MECHANICAL	0320			BROWN 1240			
ELECTRICAL	0330			EXTERIOR VENEER 1310			
REINFORCEMENT	0340			PRE-INSPECTION 1350			
<b>DO NOT BACK FILL UNTIL ABOVE IS APPROVED</b>				<b>"T" BAR INSPECTION:</b>			
<b>FOUNDATION INSPECTIONS</b>				MECHANICAL 1410			
SETBACKS	0410			ELECTRICAL 1420			
FOOTINGS	0420			BUILDING 1430			
PIERS/CASSONS	0430			<b>RE-ROOFS:</b>			
HOLD DOWNS	0440			PRE-ROOF 1510			
UFER GROUND	0450			STRUCTURAL 1520			
VERIFY SPECIAL INSPECTION	0460			ROOF NAIL 1530			
<b>DO NOT PLACE CONCRETE UNTIL ABOVE IS APPROVED</b>				<b>FINAL</b>			
<b>UNDERFLOOR INSPECTIONS:</b>				<b>SWIMMING POOLS:</b>			
PLUMBING	0510			LOCATION (ON SITE) 1610			
MECHANICAL	0520			STEEL & BOND 1620			
ELECTRICAL	0530			UNDERGROUND ELECTRICAL 1630			
FRAMING	0540			SEWER REROUTE 1640			
INSULATION	0550			GAS LINES 1650			
<b>DO NOT INSTALL SUBFLOOR UNTIL ABOVE IS APPROVED</b>				PREDECK 1660			
<b>SHEAR NAILING:</b>				FILLER LINES 1670			
WALLS -- INTERIOR	0610			CIRCULATING LINES (PRESSURE TEST) 1680			
EXTERIOR	0620			PRE PLASTER/FENCING 1690			
ROOF	0630			ROUGH ELECTRICAL 1700			
FLOOR	0640			VERIFY SPECIAL INSPECTION 1710			
<b>CONNECTIONS</b>				<b>FINAL</b> 1720			
COLLECTORS/DIAG STRUTS	0650			<b>FINAL REQUIRED - POOL NOT TO BE FILLED UNTIL BARRIER IS IN PLACE:</b>			
HOLD DOWNS	0660			<b>RESIDENTIAL SEISMIC WORK:</b>			
FRAME	0670			PRECONSTRUCTION 1810			
<b>FRAME/TOP OUT INSPECTIONS:</b>				SILL PLATE BOLTING 1820			
FRAME	0680			SHEAR PANEL INSTALLTION 1830			
PLUMBING	0690			FLOOR CONNECTORS 1840			
SHOWER PAN/HOT MOP	0700			<b>FINAL</b> 1850			
MULTI-STORY WASTE	0710			<b>SIGN INSPECTIONS:</b>			
GAS PIPING	0720			BUILDING CONNECTION 1910			
MECHANICAL	0730			ELECTRICAL 1920			
MECHANICAL - FIRE DAMPER	0740			<b>FINAL</b> 1930			
ELECTRICAL	0750						
MFG. FIREPLACE	0760						
<b>MASONRY FIREPLACE:</b>				<b>FINAL APPROVALS</b>			
THROAT DAMPER	0770			PLUMBING 2010			
ANCHORAGE	0780			MECHANICAL 2020			
VERIFY SPECIAL INSPECTIONS	0790			ELECTRICAL 2030			
<b>CONCRETE/MASONRY WALLS:</b>				FIREPLACE 2040			
REINFORCEMENT	0810			ELECTRICAL INSPECTION CASE 2050			
VERIFY SPECIAL INSPECTION	0820			GAS 2060			
<b>DO NOT COVER WORK UNTIL ABOVE IS APPROVED</b>							
<b>INSULATION:</b>							
WALLS	0910						
CEILING	0920						
<b>DO NOT COVER UNTIL ABOVE APPROVED</b>							



City of San Leandro 835 E. 14th Street San Leandro, CA 94577
Development Services Department - Building Division
PH:(510) 577-3406 FAX:(510) 577-6007
24-HOUR INSPECTION REQUEST: (510) 577-3426
CONSTRUCTION & INSTALLATION PERMIT

Permit No.: BLD2000-00772 Project Address: 1156 Davis St

10/6/2000

Project Name: Applied: 4/13/2000
Type of Work: OTH Type Const: Occupancy: Issued: 10/6/2000
Permit To Do: REPLACE UST & ENTIRE PETROL SYSTEM, REPLACE DISPENSERS
Expire Date:
Final:

Owner's ATLANTIC R
PO Box 512485
Los Angeles CA 90051-0485

Assessor's Parcel Number:
075 0121 011 05

Valuation: \$2,000.00

Contractor: PETCON TECH, INC.
1872 DEL AMO BLVD, STE A
TORRANCE CA 90501
925/931-0136

Architect: TAIT & ASSOCIATES, INC.
1001 GALAXY WY, STE 304
CONCORD CA 94520
925-680-6800

Engineer:

Designer:

\*\*\*\*\* Fees Required \*\*\*\*\*

Fees: \$0.00
Total Payments
Balance Due

\*\*\*\*\*

Table with 2 columns: Fee Description, Fee Amount. Rows include Electric Circuits, Business License, Motors, Plan Check Fee, Microfilming, Base Electric Permit, Insp of Alter & Changes ea., Engineering & Transportation, Elec. Permit - Automation Fee, Electrical Issuing Fee, Planning Dept Misc. Fees, Environ. Services Fees, Total Fees: \$957.75

# ADAMS SERVICES, INC.

406 E. Alondra Blvd., Gardena, CA 90248-2902  
(310) 523-4430 Δ FAX (310) 523-1518

---

## CERTIFICATE OF DISPOSAL

**This certifies that the following tanks from the site listed below were delivered to Pacheco Pass Landfill, 3675 Pacheco Pass, Gilroy, CA, for destruction (see Receiving Tickets 67876 & 67877, attached).**

**Date: Oct. 17, 2000**

**Site: ARCO  
1156 Davis Street  
San Leandro, CA**

**Tanks: 3 - 12,000 gallon fiberglass tanks**

Dispatcher: PACHECO PASS LANDFILL  
Signed @ 3675 PACHECO PASS  
GILROY, CA 95020

TICKET NO.: 67876  
DATE: 10/17/00 In: 15:52 Out: 15:51  
Price/Unit: 136.80  
Commodity: DEMOLITION DEBRIS

Account: ASH-ACCOUNT /42325  
675 PACHECO PASS  
GILROY, CA 95020

Total Charge:  
Tendered:  
Change:

Source: OTHER Route:

Truck No.: 7 Lic:

Inbound Weight: 35200 lbs.

SCALE A 35200 (M) Gross Weight lbs.  
28750 Tare Weight lbs.  
6440 Net Weight lbs.

C. O. D.

*Special Handl*

CONNIE MUNOZ

P1

P.O.#: ADAMS SERVICES Job #: B/L #:

Dispatcher: PACHECO PASS LANDFILL  
Signed @ 3675 PACHECO PASS  
GILROY, CA 95020

TICKET NO.: 67877  
DATE: 10/17/00 In: 15:25 Out: 16:00  
Price/Unit: 126.80  
Commodity: DEMOLITION DEBRIS

Account: ASH-ACCOUNT /42325  
675 PACHECO PASS  
GILROY, CA 95020

Total Charge:  
Tendered:  
Change:

Source: OTHER Route:

Truck No.: 14 Lic:

Inbound Weight: 32160 lbs.

SCALE A 32160 (M) Gross Weight lbs.  
27900 Tare Weight lbs.  
4260 Net Weight lbs.

C. O. D.

*Special Handl*

CONNIE MUNOZ

P1

P.O.#: ADAMS SERVICES Job #: B/L #:

*John*



State of California—Environmental Protection Agency  
Form Approved OMB No. 2050-0039 (Expires 9-30-99)  
Please print or type. Form designed for use on slite (12-pitch) typewriter.

See Instructions on back of page 6.

Department of Toxic Substances Control  
Sacramento, California

IN CASE OF EMERGENCY OR SPILL, CALL THE NATIONAL RESPONSE CENTER 1-800-424-8802; WITHIN CALIFORNIA, CALL 1-800-852-7550

GENERATOR

FACILITY

<b>UNIFORM HAZARDOUS WASTE MANIFEST</b>		1. Generator's US EPA ID No. CAL00008305700001		Manifest Document No. 1		2. Page 1		Information in the shaded areas is not required by Federal law.			
3. Generator's Name and Mailing Address ARCO PRODUCTS CO. 4. Center Pointe Dr. La Palma CA 91123						A. State Manifest Document Number 99789422					
4. Generator's Phone (714) 670-5405						B. State Generator's ID					
5. Transporter 1 Company Name ADAMS SERVICES, INC.			6. US EPA ID Number CAL922125668			C. State Transporter's ID (Reserved)					
7. Transporter 2 Company Name						D. Transporter's Phone 310-523-4430					
8. US EPA ID Number						E. State Transporter's ID (Reserved)					
9. Designated Facility Name and Site Address Domenno/Kerdoon 2000 N. ALAMEDA ST. COMPTON, CA 90222						F. Transporter's Phone					
10. US EPA ID Number CAT080013352						G. State Facility's ID CAT080013352					
H. Facility's Phone 310-537-7100						12. Containers		13. Total Quantity		14. Unit Wt/Vol	
11. US DOT Description (Including Proper Shipping Name, Hazard Class, and ID Number) a. (OIL & WATER, NON-R.C.R.A. HAZARDOUS WASTE LIQUID						No. Type 001 T T		Quantity 41510		I. Waste Number State 261 EPA/Other NONE	
b.										State EPA/Other	
c.										State EPA/Other	
d.										State EPA/Other	
1. Additional Descriptions for Materials Listed Above 99% WATER 1% OIL						K. Handling Codes for Wastes Listed Above a. 01					
13. Special Handling Instructions and Additional Information DON PROPER PROTECTIVE GEAR NO SMOKING; E.R.G. #27 EMERGENCY #: ARCO 2111 1156 Davis San Dimas CA.											
16. GENERATOR'S CERTIFICATION: I hereby declare that the contents of this consignment are fully and accurately described above by proper shipping name and are classified, packed, marked, and labeled, and are in all respects in proper condition for transport by highway according to applicable international and national government regulations. If I am a large quantity generator, I certify that I have a program in place to reduce the volume and toxicity of waste generated to the degree I have determined to be economically practicable and that I have selected the practicable method of treatment, storage, or disposal currently available to me which minimizes the present and future threat to human health and the environment; OR, if I am a small quantity generator, I have made a good faith effort to minimize my waste generation and select the best waste management method that is available to me and that I am satisfied with.											
17. Transporter 1 Acknowledgement of Receipt of Materials Printed/Typed Name AL CASTELLON						Signature AL CASTELLON			Month Day Year 11 01 70		
18. Transporter 2 Acknowledgement of Receipt of Materials Printed/Typed Name						Signature			Month Day Year		
19. Discrepancy Indication Space											
20. Facility Owner or Operator Certification of receipt of hazardous materials covered by this manifest except as noted in Item 19 Printed/Typed Name JOHN BERSON						Signature JOHN BERSON			Month Day Year 12 11 80		

DO NOT WRITE BELOW THIS LINE.

State of California—Environmental Protection Agency  
EPA Approved OMB No. 2050-0039 (Expires 9-30-99)  
Please print or type. Form designed for use on elite (12-pitch) typewriter

See Instructions on back of page 6.

Department of Toxic Substances Control  
Sacramento, California

<b>UNIFORM HAZARDOUS WASTE MANIFEST</b>		1. Generator's US EPA ID No. CA1100000236151	Manifest Document No. 3101581	2. Page 1 of 1	Information in the shaded areas is not required by Federal law	
3. Generator's Name and Mailing Address ARCO PRODUCTS CO. 4 CENTERPOINTE DR. LA BAINA, CA. 90623			A. State Manifest Document Number 99630581		B. State Generator's ID	
4. Generator's Phone (714) 620-5405		6. US EPA ID Number CA1100000236151		C. State Transporter's ID [Reserved]		
5. Transporter 1 Company Name		7. Transporter 2 Company Name		D. Transporter's Phone 510-239-1313		
9. Designated Facility Name and Site Address		10. US EPA ID Number		E. State Transporter's ID [Reserved]		
				F. Transporter's Phone		
				G. State Facility's ID		
				H. Facility's Phone 510-239-1313		
11. US DOT Description (including Proper Shipping Name, Hazard Class, and ID Number)				12. Containers No. Type	13. Total Quantity	14. Unit Wt/Vol
a. <i>28535</i>				1	1	1
b.						
c.						
d.						
J. Additional Descriptions for Materials Listed Above				K. Handling Codes for Wastes Listed Above		
a. <i>28535</i>				b.		
c.				d.		
15. Special Handling Instructions and Additional Information Weights and volumes are approximate 24 hours emergency telephone number: 323-499-0673 TRINIDAD DOT FROM 173						
16. GENERATOR'S CERTIFICATION: I hereby declare that the contents of this consignment are fully and accurately described above by proper shipping name and are classified, packed, marked, and labeled, and are in all respects in proper condition for transport by highway according to applicable international and national government regulations.  If I am a large quantity generator, I certify that I have a program in place to reduce the volume and toxicity of waste generated to the degree I have determined to be economically practicable and that I have selected the practicable method of treatment, storage, or disposal currently available to me which minimizes the present and future threat to human health and the environment. OR, if I am a small quantity generator, I have made a good faith effort to minimize my waste generation and select the best waste management method that is available to me and that I can afford.						
Printed/Typed Name		Signature		Month Day Year		
STEPHEN C. SULLIVAN		<i>Stephen C. Sullivan</i>		01/13/10		
17. Transporter 1 Acknowledgement of Receipt of Materials		Signature		Month Day Year		
STEPHEN C. SULLIVAN		<i>Stephen C. Sullivan</i>		01/13/10		
18. Transporter 2 Acknowledgement of Receipt of Materials		Signature		Month Day Year		
19. Discrepancy Indication Space						
20. Facility Owner or Operator Certification of receipt of hazardous materials covered by this manifest except as noted in Item 19						
Printed/Typed Name		Signature		Month Day Year		

IN CASE OF EMERGENCY OR SPILL, CALL THE NATIONAL RESPONSE CENTER 1-800-424-6002. GENERATOR

DO NOT WRITE BELOW THIS LINE.

of California—Environmental Protection Agency  
Approved OMB No. 2050-0039 (Expires 9-30-99)  
se print or type. Form designed for use on elite (12 pitch) typewriter.

See Instructions on back of page 6.

Department of Toxic Substances Control  
Sacramento, California

IN CASE OF EMERGENCY OR SPILL, CALL THE NATIONAL RESPONSE CENTER 1-800-424-8802. WITHIN CALIFORNIA, CALL 1-800-544-6333

GENERATOR FACILITY

<b>UNIFORM HAZARDOUS WASTE MANIFEST</b>		Generator's US EPA ID No.	Manifest Document No.	2. Page 1 of 1	Information in the shaded areas is not required by Federal law.	
3. Generator's Name and Mailing Address			A. State Manifest Document Number		98383930	
4. Generator's Phone ( )			B. State Generator's ID			
5. Transporter 1 Company Name		6. US EPA ID Number	C. State Transporter's ID			
7. Transporter 2 Company Name		B. US EPA ID Number	D. Transporter's Phone		510-235-1393	
9. Designated Facility Name and Site Address		O US EPA ID Number	E. State Transporter's ID			
			F. Transporter's Phone			
			G. State Facility's ID			
			H. Facility's Phone		510-235-1393	
11. US DOT Description (including Proper Shipping Name, Hazard Class, and ID Number)		12. Containers No.	Type	13. Total Quantity	14. Unit Wt/Vol	I. Waste Number
WASTE MATERIALS FROM TANKS			03		P	State 512
						EPA/Other NONE
						State
						EPA/Other
						State
						EPA/Other
J. Additional Descriptions for Materials Listed Above		K. Handling Codes for Wastes Listed Above				
		a.		b.		
		c.		d.		
15. Special Handling Instructions and Additional Information Wear proper protective equipment while handling. Weights or volumes are approximate 24 hour emergency telephone number: DOT ERG# 171 24 Hour emergency contact:						
16. GENERATOR'S CERTIFICATION: I hereby declare that the contents of this consignment are fully and accurately described above by proper shipping name and are classified, packed, marked, and labeled, and are in all respects in proper condition for transport by highway according to applicable international and national government regulations.  If I am a large quantity generator, I certify that I have a program in place to reduce the volume and toxicity of waste generated to the degree I have determined to be economically practicable and that I have selected the practicable method of treatment, storage, or disposal currently available to me which minimizes the present and future threat to human health and the environment; OR, if I am a small quantity generator, I have made a good faith effort to minimize my waste generation and select the best waste management method that is available to me and that I can afford.						
Printed/Typed Name		Signature		Month	Day	Year
17. Transporter 1 Acknowledgement of Receipt of Materials		Signature		Month	Day	Year
Printed/Typed Name		Signature		Month	Day	Year
18. Transporter 2 Acknowledgement of Receipt of Materials		Signature		Month	Day	Year
Printed/Typed Name		Signature		Month	Day	Year
19. Discrepancy Indication Space						
20. Facility Owner or Operator Certification of receipt of hazardous materials covered by this manifest except as noted in item 19		Signature		Month	Day	Year
Printed/Typed Name		Signature		Month	Day	Year

DO NOT WRITE BELOW THIS LINE.

State of California—Environmental Protection Agency  
Form Approved OMB Nos. 2050-0039 (Expires 9-30-99)  
Please print or type. Form designed for use on elite (12-pitch) typewriter.

See Instructions on back of page 6.

Department of Toxic Substances Control  
Sacramento, California

GENERATOR

<b>UNIFORM HAZARDOUS WASTE MANIFEST</b>		1. Generator's US EPA ID No. <b>CAK0000830570000</b>		Manifest Document No. <b>00001</b>		2. Page 1 of 1		Information in the shaded areas is not required by Federal law.			
3. Generator's Name and Mailing Address <b>ARCO PRODUCTS CO. 4. CENTER POINTE DR. LA PALMA CA 91223</b>						A. State Manifest Document Number <b>99789422</b>					
4. Generator's Phone <b>914 670-5405</b>						B. State Generator's ID					
5. Transporter 1 Company Name <b>ADAMS SERVICES, INC.</b>			6. US EPA ID Number <b>CAIL922125668</b>			C. State Transporter's ID [Reserved.]					
7. Transporter 2 Company Name						D. Transporter's Phone <b>310-523-4430</b>					
8. US EPA ID Number						E. State Transporter's ID [Reserved.]					
9. Designated Facility Name and Site Address <b>DOMENNO/KERDOON 2000 N. ALAMEDA ST. COMPTON, CA 90222</b>						G. State Facility's ID <b>CAT080013352</b>					
10. US EPA ID Number <b>CAT080013352</b>						H. Facility's Phone <b>310-537-7100</b>					
11. US DOT Description (including Proper Shipping Name, Hazard Class, and ID Number)						12. Containers No. Type		13. Total Quantity		14. Unit Wt/Vol	
a. <b>(OIL &amp; WATER, NON-R.C.R.A. HAZARDOUS WASTE LIQUID</b>						0 0 1 T T		A 451510		G	
b.										I. Waste Number State <b>241</b> EPA/Other <b>NONE</b>	
c.										State EPA/Other	
d.										State EPA/Other	
J. Additional Descriptions for Materials Listed Above <b>99% WATER 1% OIL</b>						K. Handling Codes for Wastes Listed Above a. <b>01</b> b. c. d.					
15. Special Handling Instructions and Additional Information <b>DON PROPER PROTECTIVE GEAR NO SMOKING; E.R.G. #27 EMERGENCY #:</b>						<b>ARCO 2111 1156 DAVIS SAN LEANDRO CA.</b>					
16. GENERATOR'S CERTIFICATION: I hereby declare that the contents of this consignment are fully and accurately described above by proper shipping name and are classified, packed, marked, and labeled, and are in all respects in proper condition for transport by highway according to applicable international and national government regulations.  If I am a large quantity generator, I certify that I have a program in place to reduce the volume and toxicity of waste generated to the degree I have determined to be economically practicable and that I have selected the practicable method of treatment, storage, or disposal currently available to me which minimizes the present and future threat to human health and the environment; OR, if I am a small quantity generator, I have made a good faith effort to minimize my waste generation and select the best waste management method that is available to me and that I can afford.											
Printed/Typed Name <b>AL CASTELLON</b>				Signature <i>[Signature]</i>				Month Day Year <b>10 17 00</b>			
17. Transporter 1 Acknowledgement of Receipt of Materials Printed/Typed Name <b>AL CASTELLON</b>				Signature <i>[Signature]</i>				Month Day Year <b>10 17 00</b>			
18. Transporter 2 Acknowledgement of Receipt of Materials Printed/Typed Name				Signature				Month Day Year			
19. Discrepancy Indication Space											
20. Facility Owner or Operator Certification of receipt of hazardous materials covered by this manifest except as noted in item 19. Printed/Typed Name				Signature				Month Day Year			

DO NOT WRITE BELOW THIS LINE.

DAY OR NIGHT  
TELEPHONE  
(510) 235-1393

# CERTIFICATE CERTIFIED SERVICES COMPANY

265 Parr Boulevard • Richmond, California 94801

## NO. 36181

CUSTOMER
JOB NO. 5241362
PETCON TECH

FOR: ECOLOGY CONTROL INDUST TANK NO. 28711

LOCATION: RICHMOND, CA DATE: 12/8/2000 TIME: 9:43:51

TEST METHOD VISUAL GASTECH/1314 SMPN LAST PRODUCT UG

This is to certify that I have personally determined that this tank is in accordance with the American Petroleum Institute and have found the condition to be in accordance with its assigned designation. This certificate is based on conditions existing at the time the inspection herein set forth was completed and is issued subject to compliance with all qualifications and instructions.

TANK SIZE 1,822LF/242 Gal CONDITION SAFE FOR FIRE

REMARKS: OXYGEN 20.9% LOWER EXPLOSIVE LIMIT LESS THAN 0.1% ECOLOGY CONTROL INDUSTRIES  
HERBY CERTIFIES THAT THE ABOVE NUMBERED TANK HAS BEEN CUT OPEN, PROCESSED,  
AND THEREFORE DESTROYED AT OUR PERMITTED HAZARDOUS WASTE FACILITY.  
ECOLOGY CONTROL INDUSTRIES HAS THE APROPRIATE PERMITS FOR, AND HAS ACCEPTED  
THE TANK SHIPPED TO UG FOR PROCESSING.

In the event of any physical or atmospheric changes affecting the gas-free conditions of the above tanks, or if in any doubt, immediately stop all hot work and contact the undersigned. This permit is valid for 24 hours if no physical or atmospheric changes occur.

### STANDARD SAFETY DESIGNATION

**SAFE FOR MEN:** Means that in the compartment or space so designated (a) The oxygen content of the atmosphere is at least 19.5 percent by volume; and that (b) Toxic materials in the atmosphere are within permissible concentrations; and (c) In the judgment of the inspector, the residues are not capable of producing toxic materials under existing atmospheric conditions while maintained as directed on the Inspector's certificate.

**SAFE FOR FIRE:** Means that in the compartment so designated (a) The concentration of flammable materials in the atmosphere is below 10 percent of the lower explosive limit; and that (b) In the judgment of the inspector, the residues are not capable of producing a higher concentration that permitted under existing atmospheric conditions in the presence of fire and while maintained as directed on the Inspector's certificate, and further, (c) All adjacent spaces have either been cleaned sufficiently to prevent the spread of fire, are satisfactorily inerted, or in the case of fuel tanks, have been treated as deemed necessary by the inspector.

The undersigned representative acknowledges receipt of this certificate and understands the conditions and limitations under which it was issued.

*Kevin McCreesh*  
REPRESENTATIVE

TITLE

*DAVE SATO*  
INSPECTOR

**ENCLOSURE C**  
Soil Sample Laboratory Analytical Reports

Steve Meeks  
Delta Environmental Consultants, Inc.  
3164 Gold Camp Drive, Suite 200  
Rancho Cordova, CA 95670

Subject : 7 Soil Samples  
Project Name : ARCO 2111  
Project Number :

Dear Mr. Meeks,

Chemical analysis of the samples referenced above has been completed. Summaries of the data are contained on the following pages. Sample(s) were received under documented chain-of-custody. US EPA protocols for sample storage and preservation were followed.

Kiff Analytical is certified by the State of California (# 2236). If you have any questions regarding procedures or results, please call me at 530-297-4800.

Sincerely,



Joel Kiff



Report Number : 18105

Date : 10/25/2000

Project Name : ARCO 2111

Project Number :

Sample : T1-S-16.0

Matrix : Soil

Lab Number : 18105-01

Sample Date :10/19/2000

Parameter	Measured Value	Method Reporting Limit	Units	Analysis Method	Date Analyzed
Benzene	0.21	0.020	mg/Kg	EPA 8260B	10/21/2000
Toluene	2.1	0.020	mg/Kg	EPA 8260B	10/21/2000
Ethylbenzene	1.6	0.020	mg/Kg	EPA 8260B	10/21/2000
Total Xylenes	8.5	0.020	mg/Kg	EPA 8260B	10/21/2000
Methyl-t-butyl ether (MTBE)	33	0.050	mg/Kg	EPA 8260B	10/22/2000
TPH as Gasoline	110	5.0	mg/Kg	EPA 8260B	10/21/2000
Toluene - d8 (Surr)	98.3		% Recovery	EPA 8260B	10/21/2000
4-Bromofluorobenzene (Surr)	99.1		% Recovery	EPA 8260B	10/21/2000

Sample : T1-N-17.0

Matrix : Soil

Lab Number : 18105-02

Sample Date :10/19/2000

Parameter	Measured Value	Method Reporting Limit	Units	Analysis Method	Date Analyzed
Benzene	4.7	0.20	mg/Kg	EPA 8260B	10/21/2000
Toluene	79	0.20	mg/Kg	EPA 8260B	10/21/2000
Ethylbenzene	30	0.20	mg/Kg	EPA 8260B	10/21/2000
Total Xylenes	170	0.20	mg/Kg	EPA 8260B	10/21/2000
Methyl-t-butyl ether (MTBE)	89	0.20	mg/Kg	EPA 8260B	10/21/2000
TPH as Gasoline	1900	20	mg/Kg	EPA 8260B	10/21/2000
Toluene - d8 (Surr)	98.3		% Recovery	EPA 8260B	10/21/2000
4-Bromofluorobenzene (Surr)	101		% Recovery	EPA 8260B	10/21/2000

Approved By:  Joel Kiff





Report Number : 18105

Date : 10/25/2000

Project Name : ARCO 2111

Project Number :

Sample : T2-S-16.0

Matrix : Soil

Lab Number : 18105-03

Sample Date :10/19/2000

Parameter	Measured Value	Method Reporting Limit	Units	Analysis Method	Date Analyzed
Benzene	1.1	0.20	mg/Kg	EPA 8260B	10/21/2000
Toluene	26	0.20	mg/Kg	EPA 8260B	10/21/2000
Ethylbenzene	14	0.20	mg/Kg	EPA 8260B	10/21/2000
Total Xylenes	77	0.20	mg/Kg	EPA 8260B	10/21/2000
Methyl-t-butyl ether (MTBE)	18	0.20	mg/Kg	EPA 8260B	10/21/2000
TPH as Gasoline	1100	20	mg/Kg	EPA 8260B	10/21/2000
Toluene - d8 (Surr)	99.2		% Recovery	EPA 8260B	10/21/2000
4-Bromofluorobenzene (Surr)	99.3		% Recovery	EPA 8260B	10/21/2000

Sample : T2-M-16.0

Matrix : Soil

Lab Number : 18105-04

Sample Date :10/19/2000

Parameter	Measured Value	Method Reporting Limit	Units	Analysis Method	Date Analyzed
Benzene	1.9	0.050	mg/Kg	EPA 8260B	10/21/2000
Toluene	38	0.20	mg/Kg	EPA 8260B	10/22/2000
Ethylbenzene	11	0.050	mg/Kg	EPA 8260B	10/21/2000
Total Xylenes	59	0.050	mg/Kg	EPA 8260B	10/21/2000
Methyl-t-butyl ether (MTBE)	59	0.050	mg/Kg	EPA 8260B	10/21/2000
TPH as Gasoline	800	20	mg/Kg	EPA 8260B	10/22/2000
Toluene - d8 (Surr)	97.7		% Recovery	EPA 8260B	10/21/2000
4-Bromofluorobenzene (Surr)	100		% Recovery	EPA 8260B	10/21/2000

Approved By:  Joel Kiff



Report Number : 18105

Date : 10/25/2000

Project Name : ARCO 2111

Project Number :

Sample : T2-N-17.0

Matrix : Soil

Lab Number : 18105-05

Sample Date :10/19/2000

Parameter	Measured Value	Method Reporting Limit	Units	Analysis Method	Date Analyzed
Benzene	7.7	0.20	mg/Kg	EPA 8260B	10/21/2000
Toluene	190	0.50	mg/Kg	EPA 8260B	10/22/2000
Ethylbenzene	58	0.20	mg/Kg	EPA 8260B	10/21/2000
Total Xylenes	300	0.20	mg/Kg	EPA 8260B	10/21/2000
Methyl-t-butyl ether (MTBE)	76	0.20	mg/Kg	EPA 8260B	10/21/2000
TPH as Gasoline	4400	50	mg/Kg	EPA 8260B	10/22/2000
Toluene - d8 (Surr)	97.8		% Recovery	EPA 8260B	10/21/2000
4-Bromofluorobenzene (Surr)	101		% Recovery	EPA 8260B	10/21/2000

Sample : T3-S-16.0

Matrix : Soil

Lab Number : 18105-06

Sample Date :10/19/2000

Parameter	Measured Value	Method Reporting Limit	Units	Analysis Method	Date Analyzed
Benzene	1.3	0.050	mg/Kg	EPA 8260B	10/21/2000
Toluene	8.4	0.050	mg/Kg	EPA 8260B	10/21/2000
Ethylbenzene	29	0.20	mg/Kg	EPA 8260B	10/22/2000
Total Xylenes	120	0.20	mg/Kg	EPA 8260B	10/22/2000
Methyl-t-butyl ether (MTBE)	6.5	0.050	mg/Kg	EPA 8260B	10/21/2000
TPH as Gasoline	340	50	mg/Kg	EPA 8260B	10/23/2000
Toluene - d8 (Surr)	88.8		% Recovery	EPA 8260B	10/21/2000
4-Bromofluorobenzene (Surr)	101		% Recovery	EPA 8260B	10/21/2000

Approved By:  Joel Kiff



Report Number : 18105

Date : 10/25/2000

Project Name : ARCO 2111

Project Number :

Sample : T3-N-16.0

Matrix : Soil

Lab Number : 18105-07

Sample Date :10/19/2000

Parameter	Measured Value	Method Reporting Limit	Units	Analysis Method	Date Analyzed
<b>Benzene</b>	<b>5.0</b>	0.20	mg/Kg	EPA 8260B	10/21/2000
<b>Toluene</b>	<b>76</b>	0.20	mg/Kg	EPA 8260B	10/21/2000
<b>Ethylbenzene</b>	<b>28</b>	0.20	mg/Kg	EPA 8260B	10/21/2000
<b>Total Xylenes</b>	<b>140</b>	0.20	mg/Kg	EPA 8260B	10/21/2000
<b>Methyl-t-butyl ether (MTBE)</b>	<b>83</b>	0.20	mg/Kg	EPA 8260B	10/21/2000
<b>TPH as Gasoline</b>	<b>1800</b>	20	mg/Kg	EPA 8260B	10/21/2000
Toluene - d8 (Surr)	96.4		% Recovery	EPA 8260B	10/21/2000
4-Bromofluorobenzene (Surr)	96.0		% Recovery	EPA 8260B	10/21/2000

Approved By:  Joel Kiff

# CLS Labs

Joel Kiff  
720 Olive Drive,  
Suite D  
Davis, CA 95616

10/26/2000

Attention: Joel Kiff

Reference: Analytical Results

---

Project Name: ARCO 2111  
Project No.:  
Date Received: 10/20/2000  
Chain Of Custody: 18105

CLS ID No.: S3564  
CLS Job No.: 833564

The following analyses were performed on the above referenced project:

<u>No. of Samples</u>	<u>Turnaround Time</u>	<u>Analysis Description</u>
7	4 Days	Lead by EPA Method 6010

These samples were received by CLS Labs in a chilled, intact state and accompanied by a valid chain of custody document.

Calibrations for analytical testing have been performed in accordance to and pass the EPA's criteria for acceptability.

Analytical results are attached to this letter. Please call if we can provide additional assistance.

Sincerely,

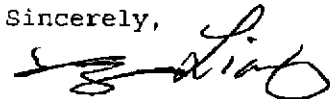

James Liang, Ph.D.  
Laboratory Director

# CLS LABS

## Analysis Report: Lead, EPA Method 6010

Client: Joel Kiff  
720 Olive Drive,  
Suite D  
Davis, CA 95616

Project No.:  
Contact: Joel Kiff  
Phone: (530)297-4800

Project: ARCO 2111

Date Sampled: 10/19/2000  
Date Received: 10/20/2000  
Date Extracted: 10/24/2000  
Date Analyzed: 10/24/2000  
Date Reported: 10/25/2000

Lab Contact: James Liang  
Lab ID No.: 83564  
Job No.: 833564  
COC Log No.: 18105  
Batch No.: M2K1024B  
Instrument ID: IP004  
Analyst ID: PONGC  
Matrix: SO

### ANALYTICAL RESULTS

Lab / Client ID Analyte	CAS No.	Results (mg/kg)	Rep. Limit (mg/kg)	Dilution (factor)
1A / T2-S-16.0 Pb (Lead)	7439921	8.1	2.5	1.0
2A / T1-S-16.0 Pb (Lead)	7439921	8.9	2.5	1.0
3A / T1-N-17.0 Pb (Lead)	7439921	10	2.5	1.0
4A / T2-M-16.0 Pb (Lead)	7439921	8.3	2.5	1.0
5A / T3-N-16.0 Pb (Lead)	7439921	12	2.5	1.0
6A / T2-N-17.0 Pb (Lead)	7439921	13	2.5	1.0
7A / T3-S-16.0 Pb (Lead)	7439921	12	2.5	1.0

ND = Not detected at or above indicated Reporting Limit

18105

83504

**KIFF ANALYTICAL SUBCONTRACT FORM**

Subcontract Lab: **CLS Labs**  
**3249 Fitzgerald Rd.**  
**Rancho, Cordova, CA 95742**

Please mail results to : Please fax to :

JOEL KIFF  
KIFF ANALYTICAL  
720 OLIVE DRIVE, SUITE D  
DAVIS, CA 95616

916-638-7301

Account No. :

**PROJECT NAME : ARCO 2111**

**PROJECT NUMBER:**

Sample	Matrix	Sampled	Tests	Due	Container
✓ T2-S-16.0	SO	10/19/2000	Lead - ICAP	10/26/2000	
✓ T1-S-16.0	SO	10/19/2000	Lead - ICAP	10/26/2000	
✓ T1-N-17.0	SO	10/19/2000	Lead - ICAP	10/26/2000	
✓ T2-M-16.0	SO	10/19/2000	Lead - ICAP	10/26/2000	
✓ T3-N-16.0	SO	10/19/2000	Lead - ICAP	10/26/2000	
✓ T2-N-17.0	SO	10/19/2000	Lead - ICAP	10/26/2000	
✓ T3-S-16.0	SO	10/19/2000	Lead - ICAP	10/26/2000	

Relinquished by : Mark J. Kiff Analytical

Date/Time: 10/20/00 1102

Received by: [Signature]

Relinquished by : \_\_\_\_\_

Date/Time: \_\_\_\_\_

Received by: \_\_\_\_\_

Relinquished by : \_\_\_\_\_

Date/Time: \_\_\_\_\_

Received by: \_\_\_\_\_

ARCO Facility no. **Z111** City (Facility) **SAN LEANDRO** Project manager (Consultant) **STEVE WEEKS**  
 ARCO engineer **PAUL SUPPLE** Telephone no. (ARCO) **925 295 8891** Telephone no. (Consultant) **916 5362613** Fax no. (Consultant) **916 638-8385**  
 Consultant name **DELTA ENVIRONMENTAL** Address (Consultant) **3164 GOLD CAMP DR #200, RAYNO CALIFORNIA, CA**

Laboratory name **KIFF**  
 Contract number

Sample I.D.	Lab no.	Container no.	Matrix			Preservation		Sampling date	Sampling time	BTEX EPA 802/EPA 8020	BTEX/TPH EPA 8020/8020/8015	TPH Modified 8015 Gas <input type="checkbox"/> Diesel <input type="checkbox"/>	Oil and Grease 413.1 <input type="checkbox"/> 413.2 <input type="checkbox"/>	TPH EPA 418.1/SMS50E	EPA 801/8010	EPA 824/8240	EPA 825/8270	TCLP Metals <input type="checkbox"/> VOC <input type="checkbox"/> VOA <input type="checkbox"/>	Semi VOC <input type="checkbox"/> VOA <input type="checkbox"/>	CWM Metals EPA 801/7000 TLC <input type="checkbox"/> STLC <input type="checkbox"/>	Lead Org./DHS <input type="checkbox"/> Lead EPA 74307/421 <input type="checkbox"/>	TPH/STX MTBE/BZLO	TOTAL Pb
			Soil	Water	Other	Ice	Acid																
T1-S-160-01		1	X				X	10/19/00	1030													X	X
T1-N-170-02		1	X				X		1420													X	X
T2-S-160-03		1	X				X		1040													X	X
T2-M-160-04		1	X				X		1100													X	X
T2-N-170-05		1	X				X		1400													X	X
T3-S-160-06		1	X				X		1050													X	X
T3-N-160-07		1	X				X		1450													X	X

Method of shipment  
**HAND DELIV.**

Special detection Limit/reporting

Special QA/QC

Remarks

Lab number

Turnaround time

Priority Rush 1 Business Day   
 Rush 2 Business Days   
 Expedited 5 Business Days   
 Standard 10 Business Days

Condition of sample: Relinquished by sampler **[Signature] / DELTA** Date **10/19/00** Time **1715** Temperature received:  
 Relinquished by \_\_\_\_\_ Date \_\_\_\_\_ Time \_\_\_\_\_ Received by \_\_\_\_\_  
 Relinquished by \_\_\_\_\_ Date \_\_\_\_\_ Time \_\_\_\_\_ Received by laboratory **Michelle Woodworth** Date **10/19/00** Time **1715**

Steve Meeks  
Delta Environmental Consultants, Inc.  
3164 Gold Camp Drive, Suite 200  
Rancho Cordova, CA 95670

Subject : 13 Soil Samples  
Project Name : ARCO 2111  
Project Number :

Dear Mr. Meeks,

Chemical analysis of the samples referenced above has been completed. Summaries of the data are contained on the following pages. Sample(s) were received under documented chain-of-custody. US EPA protocols for sample storage and preservation were followed.

Kiff Analytical is certified by the State of California (# 2236). If you have any questions regarding procedures or results, please call me at 530-297-4800.

Sincerely,



Joel Kiff





Report Number : 18107

Date : 10/20/2000

Project Name : ARCO 2111

Project Number :

Sample : DP-1-5.0

Matrix : Soil

Lab Number : 18107-01

Sample Date :10/17/2000

Parameter	Measured Value	Method Reporting Limit	Units	Analysis Method	Date Analyzed
Benzene	2.0	1.0	mg/Kg	EPA 8260B	10/20/2000
Toluene	20	1.0	mg/Kg	EPA 8260B	10/20/2000
Ethylbenzene	30	1.0	mg/Kg	EPA 8260B	10/20/2000
Total Xylenes	170	1.0	mg/Kg	EPA 8260B	10/20/2000
Methyl-t-butyl ether (MTBE)	13	1.0	mg/Kg	EPA 8260B	10/20/2000
TPH as Gasoline	2100	200	mg/Kg	EPA 8260B	10/20/2000
Toluene - d8 (Surr)	101		% Recovery	EPA 8260B	10/20/2000
4-Bromofluorobenzene (Surr)	98.5		% Recovery	EPA 8260B	10/20/2000

Sample : DP-2-8.0

Matrix : Soil

Lab Number : 18107-02

Sample Date :10/17/2000

Parameter	Measured Value	Method Reporting Limit	Units	Analysis Method	Date Analyzed
Benzene	0.77	0.050	mg/Kg	EPA 8260B	10/20/2000
Toluene	0.84	0.050	mg/Kg	EPA 8260B	10/20/2000
Ethylbenzene	7.4	0.050	mg/Kg	EPA 8260B	10/20/2000
Total Xylenes	32	0.050	mg/Kg	EPA 8260B	10/20/2000
Methyl-t-butyl ether (MTBE)	4.4	0.050	mg/Kg	EPA 8260B	10/20/2000
TPH as Gasoline	440	200	mg/Kg	EPA 8260B	10/20/2000
Toluene - d8 (Surr)	100		% Recovery	EPA 8260B	10/20/2000
4-Bromofluorobenzene (Surr)	102		% Recovery	EPA 8260B	10/20/2000

Approved By:  Joel Kiff



Report Number : 18107

Date : 10/20/2000

Project Name : ARCO 2111

Project Number :

Sample : DP-3-4.0

Matrix : Soil

Lab Number : 18107-03

Sample Date :10/17/2000

Parameter	Measured Value	Method Reporting Limit	Units	Analysis Method	Date Analyzed
Benzene	0.014	0.0050	mg/Kg	EPA 8260B	10/20/2000
Toluene	0.12	0.0050	mg/Kg	EPA 8260B	10/20/2000
Ethylbenzene	0.26	0.0050	mg/Kg	EPA 8260B	10/20/2000
Total Xylenes	1.9	0.0050	mg/Kg	EPA 8260B	10/20/2000
Methyl-t-butyl ether (MTBE)	2.2	0.0050	mg/Kg	EPA 8260B	10/20/2000
TPH as Gasoline	31	1.0	mg/Kg	EPA 8260B	10/20/2000
Toluene - d8 (Surr)	98.3		% Recovery	EPA 8260B	10/20/2000
4-Bromofluorobenzene (Surr)	100		% Recovery	EPA 8260B	10/20/2000

Sample : DP-4-4.5

Matrix : Soil

Lab Number : 18107-04

Sample Date :10/17/2000

Parameter	Measured Value	Method Reporting Limit	Units	Analysis Method	Date Analyzed
Benzene	0.0056	0.0050	mg/Kg	EPA 8260B	10/20/2000
Toluene	0.059	0.0050	mg/Kg	EPA 8260B	10/20/2000
Ethylbenzene	0.10	0.0050	mg/Kg	EPA 8260B	10/20/2000
Total Xylenes	0.68	0.0050	mg/Kg	EPA 8260B	10/20/2000
Methyl-t-butyl ether (MTBE)	0.90	0.20	mg/Kg	EPA 8260B	10/20/2000
TPH as Gasoline	9.4	1.0	mg/Kg	EPA 8260B	10/20/2000
Toluene - d8 (Surr)	99.8		% Recovery	EPA 8260B	10/20/2000
4-Bromofluorobenzene (Surr)	98.2		% Recovery	EPA 8260B	10/20/2000

Approved By:  Joel Kiff



Report Number : 18107

Date : 10/20/2000

Project Name : ARCO 2111

Project Number :

Sample : DP-5-4.0

Matrix : Soil

Lab Number : 18107-05

Sample Date :10/17/2000

Parameter	Measured Value	Method Reporting Limit	Units	Analysis Method	Date Analyzed
Benzene	0.0061	0.0050	mg/Kg	EPA 8260B	10/20/2000
Toluene	< 0.0050	0.0050	mg/Kg	EPA 8260B	10/20/2000
Ethylbenzene	< 0.0050	0.0050	mg/Kg	EPA 8260B	10/20/2000
Total Xylenes	< 0.0050	0.0050	mg/Kg	EPA 8260B	10/20/2000
Methyl-t-butyl ether (MTBE)	1.5	0.0050	mg/Kg	EPA 8260B	10/20/2000
TPH as Gasoline	< 1.0	1.0	mg/Kg	EPA 8260B	10/20/2000
Toluene - d8 (Surr)	101		% Recovery	EPA 8260B	10/20/2000
4-Bromofluorobenzene (Surr)	97.6		% Recovery	EPA 8260B	10/20/2000

Sample : DP-6-4.0

Matrix : Soil

Lab Number : 18107-06

Sample Date :10/17/2000

Parameter	Measured Value	Method Reporting Limit	Units	Analysis Method	Date Analyzed
Benzene	< 0.0050	0.0050	mg/Kg	EPA 8260B	10/20/2000
Toluene	< 0.0050	0.0050	mg/Kg	EPA 8260B	10/20/2000
Ethylbenzene	< 0.0050	0.0050	mg/Kg	EPA 8260B	10/20/2000
Total Xylenes	< 0.0050	0.0050	mg/Kg	EPA 8260B	10/20/2000
Methyl-t-butyl ether (MTBE)	0.20	0.0050	mg/Kg	EPA 8260B	10/20/2000
TPH as Gasoline	< 1.0	1.0	mg/Kg	EPA 8260B	10/20/2000
Toluene - d8 (Surr)	96.3		% Recovery	EPA 8260B	10/20/2000
4-Bromofluorobenzene (Surr)	94.6		% Recovery	EPA 8260B	10/20/2000

Approved By:  Joel Kiff



Report Number : 18107

Date : 10/20/2000

Project Name : ARCO 2111

Project Number :

Sample : DP-7-5.0

Matrix : Soil

Lab Number : 18107-07

Sample Date :10/17/2000

Parameter	Measured Value	Method Reporting Limit	Units	Analysis Method	Date Analyzed
Benzene	< 0.0050	0.0050	mg/Kg	EPA 8260B	10/20/2000
Toluene	< 0.0050	0.0050	mg/Kg	EPA 8260B	10/20/2000
Ethylbenzene	< 0.0050	0.0050	mg/Kg	EPA 8260B	10/20/2000
Total Xylenes	< 0.0050	0.0050	mg/Kg	EPA 8260B	10/20/2000
Methyl-t-butyl ether (MTBE)	2.4	0.0050	mg/Kg	EPA 8260B	10/20/2000
TPH as Gasoline	2.2	1.0	mg/Kg	EPA 8260B	10/20/2000
Toluene - d8 (Surr)	100		% Recovery	EPA 8260B	10/20/2000
4-Bromofluorobenzene (Surr)	97.7		% Recovery	EPA 8260B	10/20/2000

Sample : DP-8-5.0

Matrix : Soil

Lab Number : 18107-08

Sample Date :10/17/2000

Parameter	Measured Value	Method Reporting Limit	Units	Analysis Method	Date Analyzed
Benzene	< 0.0050	0.0050	mg/Kg	EPA 8260B	10/20/2000
Toluene	< 0.0050	0.0050	mg/Kg	EPA 8260B	10/20/2000
Ethylbenzene	< 0.0050	0.0050	mg/Kg	EPA 8260B	10/20/2000
Total Xylenes	0.0092	0.0050	mg/Kg	EPA 8260B	10/20/2000
Methyl-t-butyl ether (MTBE)	0.35	0.0050	mg/Kg	EPA 8260B	10/20/2000
TPH as Gasoline	< 1.0	1.0	mg/Kg	EPA 8260B	10/20/2000
Toluene - d8 (Surr)	98.3		% Recovery	EPA 8260B	10/20/2000
4-Bromofluorobenzene (Surr)	98.5		% Recovery	EPA 8260B	10/20/2000

Approved By:  Joel Kiff



Report Number : 18107

Date : 10/20/2000

Project Name : ARCO 2111

Project Number :

Sample : PL-1-4.0

Matrix : Soil

Lab Number : 18107-09

Sample Date :10/17/2000

Parameter	Measured Value	Method Reporting Limit	Units	Analysis Method	Date Analyzed
Benzene	0.16	0.050	mg/Kg	EPA 8260B	10/20/2000
Toluene	< 0.050	0.050	mg/Kg	EPA 8260B	10/20/2000
Ethylbenzene	2.1	0.050	mg/Kg	EPA 8260B	10/20/2000
Total Xylenes	3.6	0.050	mg/Kg	EPA 8260B	10/20/2000
Methyl-t-butyl ether (MTBE)	0.36	0.050	mg/Kg	EPA 8260B	10/20/2000
TPH as Gasoline	430	200	mg/Kg	EPA 8260B	10/20/2000
Toluene - d8 (Surr)	98.6		% Recovery	EPA 8260B	10/20/2000
4-Bromofluorobenzene (Surr)	99.3		% Recovery	EPA 8260B	10/20/2000

Sample : PL-2-6.0

Matrix : Soil

Lab Number : 18107-10

Sample Date :10/17/2000

Parameter	Measured Value	Method Reporting Limit	Units	Analysis Method	Date Analyzed
Benzene	< 0.0050	0.0050	mg/Kg	EPA 8260B	10/20/2000
Toluene	0.020	0.0050	mg/Kg	EPA 8260B	10/20/2000
Ethylbenzene	0.0077	0.0050	mg/Kg	EPA 8260B	10/20/2000
Total Xylenes	0.60	0.0050	mg/Kg	EPA 8260B	10/20/2000
Methyl-t-butyl ether (MTBE)	4.7	0.0050	mg/Kg	EPA 8260B	10/20/2000
TPH as Gasoline	14	1.0	mg/Kg	EPA 8260B	10/20/2000
Toluene - d8 (Surr)	101		% Recovery	EPA 8260B	10/20/2000
4-Bromofluorobenzene (Surr)	100		% Recovery	EPA 8260B	10/20/2000

Approved By:  Joel Kiff



Report Number : 18107

Date : 10/20/2000

Project Name : ARCO 2111

Project Number :

Sample : PL-3-5.0

Matrix : Soil

Lab Number : 18107-11

Sample Date :10/17/2000

Parameter	Measured Value	Method Reporting Limit	Units	Analysis Method	Date Analyzed
<b>Benzene</b>	< 0.0050	0.0050	mg/Kg	EPA 8260B	10/20/2000
<b>Toluene</b>	< 0.0050	0.0050	mg/Kg	EPA 8260B	10/20/2000
<b>Ethylbenzene</b>	< 0.0050	0.0050	mg/Kg	EPA 8260B	10/20/2000
<b>Total Xylenes</b>	< 0.0050	0.0050	mg/Kg	EPA 8260B	10/20/2000
<b>Methyl-t-butyl ether (MTBE)</b>	0.17	0.0050	mg/Kg	EPA 8260B	10/20/2000
<b>TPH as Gasoline</b>	< 1.0	1.0	mg/Kg	EPA 8260B	10/20/2000
Toluene - d8 (Surr)	101		% Recovery	EPA 8260B	10/20/2000
4-Bromofluorobenzene (Surr)	99.5		% Recovery	EPA 8260B	10/20/2000

Sample : PL-4-5.0

Matrix : Soil

Lab Number : 18107-12

Sample Date :10/17/2000

Parameter	Measured Value	Method Reporting Limit	Units	Analysis Method	Date Analyzed
<b>Benzene</b>	< 0.0050	0.0050	mg/Kg	EPA 8260B	10/20/2000
<b>Toluene</b>	< 0.0050	0.0050	mg/Kg	EPA 8260B	10/20/2000
<b>Ethylbenzene</b>	< 0.0050	0.0050	mg/Kg	EPA 8260B	10/20/2000
<b>Total Xylenes</b>	0.043	0.0050	mg/Kg	EPA 8260B	10/20/2000
<b>Methyl-t-butyl ether (MTBE)</b>	0.86	0.0050	mg/Kg	EPA 8260B	10/20/2000
<b>TPH as Gasoline</b>	1.3	1.0	mg/Kg	EPA 8260B	10/20/2000
Toluene - d8 (Surr)	100		% Recovery	EPA 8260B	10/20/2000
4-Bromofluorobenzene (Surr)	98.8		% Recovery	EPA 8260B	10/20/2000

Approved By:  Joel Kiff

# CLS Labs

10/25/2000

Joel Kiff  
720 Olive Drive,  
Suite D  
Davis, CA 95616

Attention: Joel Kiff

Reference: Analytical Results

---

Project Name: 1156 Davis St., San Leandro  
Project No.: 2111  
Date Received: 10/20/2000  
Chain Of Custody: 18107

CLS ID No.: 83566  
CLS Job No.: 833566

The following analyses were performed on the above referenced project:

<u>No. of Samples</u>	<u>Turnaround Time</u>	<u>Analysis Description</u>
12	1 Day	Lead by EPA Method 6010

These samples were received by CLS Labs in a chilled, intact state and accompanied by a valid chain of custody document.

Calibrations for analytical testing have been performed in accordance to and pass the EPA's criteria for acceptability.

Analytical results are attached to this letter. Please call if we can provide additional assistance.

Sincerely,

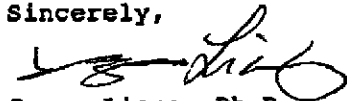

James Liang, Ph.D.  
Laboratory Director

# CLS Labs

## Analysis Report: Lead, EPA Method 6010

Client: Joel Kiff  
720 Olive Drive,  
Suite D  
Davis, CA 95616

Project No.: 2111  
Contact: Joel Kiff  
Phone: (530)297-4800

Project: 1156 Davis St., San Leandro

Date Sampled: 10/17/2000  
Date Received: 10/20/2000  
Date Extracted: 10/20/2000  
Date Analyzed: 10/20/2000  
Date Reported: 10/25/2000

Lab Contact: James Liang  
Lab ID No.: 83566  
Job No.: 833566  
COC Log No.: 18107  
Batch No.: M2K1020A  
Instrument ID: IP004  
Analyst ID: JEFPO  
Matrix: SOIL

### ANALYTICAL RESULTS

Lab / Client ID Analyte	CAS No.	Results (mg/kg)	Rep. Limit (mg/kg)	Dilution (factor)
1A / DP-1-5.0 Pb (Lead)	7439921	11	2.5	1.0
2A / DP-2-8.0 Pb (Lead)	7439921	10	2.5	1.0
3A / DP-3-4.0 Pb (Lead)	7439921	9.9	2.5	1.0
4A / DP-4-4.5 Pb (Lead)	7439921	9.0	2.5	1.0
5A / DP-5-4.0 Pb (Lead)	7439921	23	2.5	1.0
6A / DP-6-4.0 Pb (Lead)	7439921	10	2.5	1.0
7A / DP-7-5.0 Pb (Lead)	7439921	10	2.5	1.0
8A / DP-8-5.0 Pb (Lead)	7439921	11	2.5	1.0
9A / PL-1-4.0 Pb (Lead)	7439921	8.9	2.5	1.0
10A / PL-2-6.0 Pb (Lead)	7439921	11	2.5	1.0
11A / PL-3-5.0 Pb (Lead)	7439921	10	2.5	1.0
12A / PL-4-5.0 Pb (Lead)	7439921	11	2.5	1.0

ND = Not detected at or above indicated Reporting Limit





720 Olive Drive, Suite D  
 Davis, CA 95616  
 Lab: 530.297.4800  
 Fax: 530.297.4803

Lab No. 18107 Page 1 of 2

S35C60

Project Manager:  
Joel Kiff

Phone No.:

**Chain-of-Custody Record and Analysis Request**

Company/Address:  
Kiff Analytical

FAX No.:

**Analysis Request**

Project Number:  
2111

P.O. No.:  
18107

Email Address:  
 .pdf  .xls  .doc  other

Project Name/Location:  
1156 Davis St., San Leandro

Sampler Signature:

Sample Designation	Sampling		Container (Type/Amount)				Method Preserved				Matrix	BTEX (8021B)	BTEX/TPH Gas/MTBE (8021B/M8015)	TPH as Diesel (M8015)	TPH as Motor Oil (M8015)	TPH Gas/BTEX/MTBE (8260B)	5 Oxygenates/TPH Gas/BTEX (8260B)	7 Oxygenates/TPH Gas/BTEX (8260B)	5 Oxygenates (8260B)	7 Oxygenates (8260B)	Lead Scav. (1,2 DCA & 1,2 EDB - 8260B)	EPA 8260B (Full List)	Volatile Halocarbons (EPA 8260B)	Lead (7421/239.2) TOTAL (X)	W.E.T. (X)	TAT	For Lab Use Only										
	Date	Time	40 ml VOA	SLEEVE	4 0.2.6 L	HCl	HNO <sub>3</sub>	ICE	NONE	WATER SOIL																											
✓ DP-1-5.0	10/17/00	1335		X						X																											
✓ DP-2-8.0	10/17/00	1510		X						X																											
✓ DP-3-4.0	10/17/00	1600		X						X																											
✓ DP-4-4.5	10/17/00	1605		X						X																											
✓ DP-5-4.0	10/17/00	1625		X						X																											
✓ DP-6-4.0	10/17/00	1635		X						X																											
✓ DP-7-5.0	10/17/00	1645		X						X																											
✓ DP-8-5.0	10/17/00	1650		X						X																											
✓ PL-1-4.0	10/17/00	1530		X						X																											
✓ PL-2-6.0	10/17/00	1545		X						X																											

Relinquished by:  
Mark Kiff / KIFF Analytical

Date: 10/20/00  
 Time: 1100

Received by:

Remarks:  
Due by 5 p.m. 10/20/00

Relinquished by:

Date: 10/20/00  
 Time: 11:00

Received by:

Relinquished by:

Date: 10/20/00  
 Time: 11:00

Received by Laboratory:  
James [Signature]

Bill to:



720 Olive Drive, Suite D  
 Davis, CA 95616  
 Lab: 530.297.4800  
 Fax: 530.297.4803

Lab No. 18107

Page 2 of 2

Project Manager:  
Joel Kiff

Company/Address:  
Kiff Analytical

Project Number:  
2111

P.O. No.:  
18107

Project Name/Location:  
1156 Davis St., San Leandro

Phone No.:

FAX No.:

Email Address:  
 pdf  xls  doc  other

Sampler Signature:

**Chain-of-Custody Record and Analysis Request**

Sample Designation	Sampling		Container (Type/Amount)			Method Preserved				Matrix	Analysis Request											TAT	For Lab Use Only												
	Date	Time	40 ml VOA	SLEEVE	<u>4 oz Gas</u>	HCl	HNO <sub>3</sub>	ICE	NONE	WATER/SOIL	BTEX (8021B)	BTEX/TPH Gas/MTBE (8021B/M8015)	TPH as Diesel (M8015)	TPH as Motor Oil (M8015)	TPH Gas/BTEX/MTBE (8260B)	5 Oxygenates/TPH Gas/BTEX (8260B)	7 Oxygenates/TPH Gas/BTEX (8260B)	5 Oxygenates (8260B)	7 Oxygenates (8260B)	Lead Scav. (1,2 DCA & 1,2 EDB - 8260B)	EPA 8260B (Full List)	Volatile Halocarbons (EPA 8260B)	Lead (7421/239.2)	TOTAL (X) W.E.I. (X)	12 hr 24 hr 48 hr 72 hr	Results by 9 a.m. of the next bus. day	Results by 5 p.m. of the next bus. day	Results by 5 p.m. of the 2nd bus. day	Results by 5 p.m. of the 3rd bus. day	Results by 5 a.m. of the 5th bus. day					
PL-3-5.0	10/17/00	1620			X					X														X	X	X									
PL-4-5.0	10/17/00	1700			X					X														X	X	X									

Relinquished by: <u>Mark H Kiff Analytical</u>	Date <u>10/20/00</u>	Time <u>1101</u>	Received by:	Remarks: <u>Due by 5 p.m. 10/20/00</u>
Relinquished by:	Date	Time	Received by:	
Relinquished by:	Date <u>10/20/00</u>	Time <u>11:00</u>	Received by Laboratory: <u>[Signature]</u>	Bill to:

ARCO Facility no. 2111	City (Facility) 1156 DAVIS ST, SAN LAMAR	Project manager (Consultant) STEVE WEEKS	Laboratory name KIFF
ARCO engineer PAUL SUPPLE	Telephone no. (ARCO) 925 299-6891	Telephone no. (Consultant) 916 536-2613	Contract number
Consultant name DELTA ENVIRONMENTAL		Address (Consultant) 3164 GOLD CAMP DR # 200, RAYCHO LOMA, CA	Fax no. (Consultant) 916 638 8385

Sample I.D.	Lab no.	Container no.	Matrix			Preservation		Sampling date	Sampling time	BTEX 602/EPA 8020	BTEX/TPH EPA 1632/6020/8015	TPH Modified 8015 Gas <input type="checkbox"/> Diesel <input type="checkbox"/>	Oil and Grease 413.1 <input type="checkbox"/> 413.2 <input type="checkbox"/>	TPH EPA 418.1/SM503E	EPA 801/8010	EPA 824/8240	EPA 825/8270	TCLP Metals <input type="checkbox"/> VOC <input type="checkbox"/> VOA <input type="checkbox"/>	Semi Metals <input type="checkbox"/> VOA <input type="checkbox"/> VOA <input type="checkbox"/>	CMI Metals EPA 801/7000 TLC <input type="checkbox"/> STLC <input type="checkbox"/>	Lead Org. DMAS <input type="checkbox"/> Lead EPA 7480/421 <input type="checkbox"/>	BTEX/TPH MTAC 8260	TOTAL Pb
			Soil	Water	Other	Ice	Acid																
-01	DP-1-50	1	X			X		10/17/00	1335													X	X
-02	DP-2-80	1	X			X			1510													X	X
-03	DP-3-40	1	X			X			1600													X	X
-04	DP-4-45	1	X			X			1605													X	X
-05	DP-5-40	1	X			X			1625													X	X
-06	DP-6-40	1	X			X			1635													X	X
-07	DP-7-50	1	X			X			1645													X	X
-08	DP-8-50	1	X			X			1650													X	X
-09	PL-1-40	1	X			X			1530													X	X
-10	PL-2-60	1	X			X			1545													X	X
-11	PL-3-50	1	X			X			1620													X	X
-12	PL-4-50	1	X			X			1700													X	X
-13	TZ-5-160	1	X			X		10/17/00	1500														

Method of shipment  
FEDEX COURIER

Special detection Limit/reporting

Special QA/QC

Remarks

Lab number

Turnaround time

Priority Rush 1 Business Day

Rush 2 Business Days

Expedited 5 Business Days

Standard 10 Business Days

Condition of sample:	Temperature received:
Relinquished by sampler C. C. / DELTA	Received by
Date 10/19/00	Time 1711
Relinquished by	Received by
Date	Time
Relinquished by	Received by laboratory Osama Albolami
Date	Date 10/19/00
Time	Time 1711

**ENCLOSURE D**

Soil Stockpile Samples  
Laboratory Analytical Reports



Report Number : 18106

Date : 10/25/2000

Steve Meeks  
Delta Environmental Consultants, Inc.  
3164 Gold Camp Drive, Suite 200  
Rancho Cordova, CA 95670

Subject : 1 Soil Sample  
Project Name : ARCO 2111  
Project Number : 2111

Dear Mr. Meeks,

Chemical analysis of the samples referenced above has been completed. Summaries of the data are contained on the following pages. Sample(s) were received under documented chain-of-custody. US EPA protocols for sample storage and preservation were followed.

Kiff Analytical is certified by the State of California (# 2236). If you have any questions regarding procedures or results, please call me at 530-297-4800.

Sincerely,

A handwritten signature in black ink that reads "Joel Kiff". The signature is written in a cursive style with a large initial "J".

Joel Kiff



Report Number : 18106

Date : 10/25/2000

Project Name : ARCO 2111

Project Number : 2111

Sample : STK-A, STK-B, STK-C, STK-D

Matrix : Soil

Lab Number : 18106-01

Sample Date :10/19/2000

Parameter	Measured Value	Method Reporting Limit	Units	Analysis Method	Date Analyzed
Benzene	0.019	0.0050	mg/Kg	EPA 8260B	10/22/2000
Toluene	0.017	0.0050	mg/Kg	EPA 8260B	10/22/2000
Ethylbenzene	0.052	0.0050	mg/Kg	EPA 8260B	10/22/2000
Total Xylenes	0.27	0.0050	mg/Kg	EPA 8260B	10/22/2000
TPH as Gasoline	8.4	1.0	mg/Kg	EPA 8260B	10/22/2000
Toluene - d8 (Surr)	99.7		% Recovery	EPA 8260B	10/22/2000
4-Bromofluorobenzene (Surr)	90.6		% Recovery	EPA 8260B	10/22/2000

Approved By:  Joel Kiff

# CLS Labs

Joel Kiff  
720 Olive Drive,  
Suite D  
Davis, CA 95616

10/26/2000

Attention: Joel Kiff

Reference: Analytical Results

---

Project Name: ARCO 2111  
Project No.: 2111  
Date Received: 10/20/2000  
Chain Of Custody: 18106

CLS ID No.: S3563  
CLS Job No.: 833563

The following analyses were performed on the above referenced project:

<u>No. of Samples</u>	<u>Turnaround Time</u>	<u>Analysis Description</u>
1	4 Days	Lead by EPA Method 6010

These samples were received by CLS Labs in a chilled, intact state and accompanied by a valid chain of custody document.

Calibrations for analytical testing have been performed in accordance to and pass the EPA's criteria for acceptability.

Analytical results are attached to this letter. Please call if we can provide additional assistance.

Sincerely,

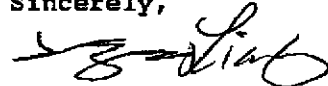

James Liang, Ph.D.  
Laboratory Director

# CLS LABS

Analysis Report: Lead, EPA Method 6010

Client: Joel Kiff  
720 Olive Drive,  
Suite D  
Davis, CA 95616

Project No.: 2111  
Contact: Joel Kiff  
Phone: (530) 297-4800

Project: ARCO 2111

Date Sampled: 10/19/2000  
Date Received: 10/20/2000  
Date Extracted: 10/24/2000  
Date Analyzed: 10/24/2000  
Date Reported: 11/07/2000

Lab Contact: James Liang  
Lab ID No.: S3563  
Job No.: 833563  
COC Log No.: 18106  
Batch No.: M2K1024B  
Instrument ID: IP004  
Analyst ID: PONGC  
Matrix: SO

## ANALYTICAL RESULTS

Lab / Client ID Analyte	CAS No.	Results (mg/kg)	Rep. Limit (mg/kg)	Dilution (factor)
1A / STK-A, STK-B, STK-C, STK-D Pb (Lead)	7439921	11	2.5	1.0

ND = Not detected at or above indicated Reporting Limit



18106

**KIFF ANALYTICAL SUBCONTRACT FORM**

Please mail results to :

Please fax to :

JOEL KIFF  
KIFF ANALYTICAL  
720 OLIVE DRIVE, SUITE D  
DAVIS, CA 95616

530-297-4803

Subcontract Lab:

**CLS Labs**

**3249 Fitzgerald Rd.**

**Rancho, Cordova, CA 95742**

916-638-7301

*S3503*

Account No. :

**PROJECT NAME : ARCO 2111**

**PROJECT NUMBER: 2111**

Sample	Matrix	Sampled	Tests	Due	Container
STK-A, STK-B,	SO	10/19/2000	Lead - ICAP	10/26/2000	

Relinquished by : *Martin Jha / KIFF Analytical*

Date/Time: *10/27/00 1101*

Received by: *[Signature]*

Relinquished by : \_\_\_\_\_

Date/Time: \_\_\_\_\_

Received by: \_\_\_\_\_

Relinquished by : \_\_\_\_\_

Date/Time: \_\_\_\_\_

Received by: \_\_\_\_\_

ARCO Facility no. <b>2111</b>	City (Facility) <b>SAN LEANDRO, CA</b>	Project manager (Consultant) <b>STEVE MEEKS</b>	Laboratory name <b>KIFF</b>
ARCO engineer <b>PAUL SUPPLE</b>	Telephone no. (ARCO) <b>925-277-8891</b>	Telephone no. (Consultant) <b>916 536-2613</b>	Contract number
Consultant name <b>DELTA ENVIRONMENTAL</b>		Fax no. (Consultant) <b>916 638-8385</b>	
Address (Consultant) <b>3164 GOLD CAMP #200, RANCHO CORDOVA, CA</b>			

Sample I.D.	Lab no.	Container no.	Matrix			Preservation		Sampling date	Sampling time	BTEX EPA 8020	BTEX/TPH EPA 8620/8020/8015	TPH Modified 8015 Gas Diesel	Oil and Grease 413.1 413.2	TPH EPA 418.1/SM508E	EPA 801/8010	EPA 824/8240	EPA 825/8270	TCJP Metals VOA VOA	Cadm Metals EPA 801/8020 TTLC STLC	Lead Org/DHS Lead EPA 7420/7421	LEAD (TLL)	Method of shipment	
			Soil	Water	Other	Ice	Acid																
STK-A		1	X			X		10/19/00	1330	X												X	HAND DELIVERED.
STK-B		1	X			X			1331	X												X	
STK-C		1	X			X			1332	X												X	
STK-D		1	X			X			1333	X												X	

COMPOSITE

Condition of sample:	Temperature received:	Priority Rush 1 Business Day	<input type="checkbox"/>
Relinquished by sampler <b>[Signature] / DELTA</b>	Date <b>10/19/00</b> Time <b>1723</b>	Rush 2 Business Days	<input type="checkbox"/>
Relinquished by	Date	Expedited 5 Business Days	<input type="checkbox"/>
Relinquished by	Date	Standard 10 Business Days	<input checked="" type="checkbox"/>
Relinquished by	Date	Received by laboratory <b>Michelle Woodcock / Kiff Analytical</b>	Date <b>10/19/00</b> Time <b>1723</b>

Steve Meeks  
Delta Environmental Consultants, Inc.  
3164 Gold Camp Drive, Suite 200  
Rancho Cordova, CA 95670

Subject : 1 Soil Sample  
Project Name : ARCO 2111  
Project Number : D000-306

Dear Mr. Meeks,

Chemical analysis of the samples referenced above has been completed. Summaries of the data are contained on the following pages. Sample(s) were received under documented chain-of-custody. US EPA protocols for sample storage and preservation were followed.

Kiff Analytical is certified by the State of California (# 2236). If you have any questions regarding procedures or results, please call me at 530-297-4800.

Sincerely,

  
Joel Kiff



Report Number : 18159

Date : 11/2/00

Project Name : ARCO 2111

Project Number : D000-306

Sample : STK-2

Matrix : Soil

Lab Number : 18159-01

Sample Date : 10/26/00

Parameter	Measured Value	Method Reporting Limit	Units	Analysis Method	Date Analyzed
<b>Benzene</b>	<b>0.054</b>	0.0050	mg/Kg	EPA 8260B	10/27/00
<b>Toluene</b>	<b>0.48</b>	0.0050	mg/Kg	EPA 8260B	10/27/00
<b>Ethylbenzene</b>	<b>0.64</b>	0.0050	mg/Kg	EPA 8260B	10/27/00
<b>Total Xylenes</b>	<b>3.8</b>	0.0050	mg/Kg	EPA 8260B	10/27/00
<b>Methyl-t-butyl ether</b>	<b>0.91</b>	0.0050	mg/Kg	EPA 8260B	10/27/00
<b>TPH as Gasoline</b>	<b>86</b>	5.0	mg/Kg	EPA 8260B	10/27/00
Toluene - d8 (Surr)	96.0		% Recovery	EPA 8260B	10/27/00
4-Bromofluorobenzene (Surr)	93.5		% Recovery	EPA 8260B	10/27/00

Approved By:  Joel Kiff

# CLS Labs

Analysis Report: Lead, EPA Method 6010

Client: Joel Kiff  
720 Olive Drive,  
Suite D  
Davis, CA 95616

Project No.: D000-306  
Contact: Joel Kiff  
Phone: (530)297-4800

Project: ARCO 2111

Date Sampled: 10/26/2000  
Date Received: 10/27/2000  
Date Extracted: 10/27/2000  
Date Analyzed: 10/30/2000  
Date Reported: 10/31/2000

Lab Contact: James Liang  
Lab ID No.: S3736  
Job No.: 833736  
COC Log No.: 18159  
Batch No.: M2K1027A  
Instrument ID: IP004  
Analyst ID: PONGC  
Matrix: SOIL

## ANALYTICAL RESULTS

Lab / Client ID Analyte	CAS No.	Results (mg/kg)	Rep. Limit (mg/kg)	Dilution (factor)
1A / STK-2 Pb (Lead)	7439921	9.6	2.5	1.0

ND = Not detected at or above indicated Reporting Limit

78159

S 3736

**KIFF ANALYTICAL SUBCONTRACT FORM**

Subcontract Lab:

**CLS Labs**

**3249 Fitzgerald Rd.**

**Rancho, Cordova, CA 95742**

Please mail results to :

Please fax to :

JOEL KIFF  
KIFF ANALYTICAL  
720 OLIVE DRIVE, SUITE D  
DAVIS, CA 95616

530-297-4803

916-638-7301

Account No. :

**PROJECT NAME : ARCO 2111**

**PROJECT NUMBER: D000-306**

Sample	Matrix	Sampled	Tests	Due	Container
STK-2	SO	10/26/2000	Lead - ICAP	11/02/2000	

Relinquished by :

Mary Berninger Kiff Analytical

Date/Time:

10/26/00 1845

Received by:

Jan Gunnar 10/27/00 8:20

Relinquished by :

\_\_\_\_\_

Date/Time:

\_\_\_\_\_

Received by:

\_\_\_\_\_

Relinquished by :

\_\_\_\_\_

Date/Time:

\_\_\_\_\_

Received by:

\_\_\_\_\_



720 Olive Drive, Suite D  
 Davis, CA 95616  
 Lab: 530.297.4800  
 Fax: 530.297.4803

Lab No. 18159 Page      of     

Project Manager: STEVEN MEERS Phone No.: 916 536-2613  
 Company/Address: DELTA ENVIRONMENTAL FAX No.: 916 638 9385  
 Project Number: D000-306 P.O. No.: \_\_\_\_\_ Email Address: \_\_\_\_\_  
 Project Name/Location: ARCO 2111 Sampler Signature:

### Chain-of-Custody Record and Analysis Request

Sample Designation	Sampling		Container (Type/Amount)		Method Preserved				Matrix	Analysis Request										TAT	For Lab Use Only						
	Date	Time	40 ml VOA	SLEEVE	HCl	HNO <sub>3</sub>	ICE	NONE	WATER/SOIL	BTEX (8021B)	BTEX/TPH Gas/MTBE (8021B/M8015)	TPH as Diesel (M8015)	TPH as Motor Oil (M8015)	TPH Gas/BTEX/MTBE (8260B)	5 Oxygenates/TPH Gas/BTEX (8260B)	7 Oxygenates/TPH Gas/BTEX (8260B)	5 Oxygenates (8260B)	7 Oxygenates (8260B)	Lead Scav. (1,2 DCA & 1,2 EDB - 8260B)	EPA 8260B (Full List)	Volatile Halocarbons (EPA 8260B)	Lead (7421/239.2) TOTAL (X) W.E.T. (X)	LEAD TTLC	12 hr/24 hr/48 hr/72 hr (wk)			
STK-2	10/24/00	1330	X				X		X	X												X		X	101		

Relinquished by: Date: 10/24/00 Time: 1540 Received by: \_\_\_\_\_  
 Relinquished by: \_\_\_\_\_ Date: \_\_\_\_\_ Time: \_\_\_\_\_ Received by: \_\_\_\_\_  
 Relinquished by: \_\_\_\_\_ Date: 10/26/00 Time: 1540 Received by Laboratory: Michelle Woodworth / Kiff Analytical Bill to: \_\_\_\_\_

**ENCLOSURE E**

Completion Letter for Soil Removed



Dillard Trucking, Inc. dba  
*Dillard Environmental Services*

P. O. Box 579 · Byron, CA 94514  
Phone (925) 634-6850 -- Fax (925) 634-0569  
EPA #CAD982523433 · D.T.S.C. #1715 · CA LIC #624665-A HAZ

Via Fax (916) 638-8385

January 29, 2001

Attn: Steve Meeks  
Delta Environmental Consultants, Inc.  
3164 Gold Camp Dr., Suite 200  
Ranch Cordova, CA 95670

**RE: ARCO #02111**  
1156 Davis Street  
San Leandro, CA

Dear Mr. Meeks:

Please be advised that a total of 1,546.49 tons of non-hazardous soil from the referenced site has been removed. The soil was transported for disposal to Forward Landfill in Manteca, California. The soil was transported on the following dates:

- 1,376.32 tons on 10/16/00, 10/17/00, 10/19/00, 10/20/00, 10/24/00, 11/10/00, 11/28/00
- 90.63 tons on 12/01/00
- 79.54 tons on 12/12/00

Should you have any questions, please do not hesitate to call.

Sincerely,

Dillard Trucking, Inc. dba,  
DILLARD ENVIRONMENTAL SERVICES

Lynette Smith  
Lynette Smith