



2201 Broadway, Suite 101
Oakland, CA 94612-3023
Tel. 510.740.5800
Fax. 510.663.3315

September 22, 1999
Project 791655

Reverend Sura D. Phoenix
First Christian Church
1190 Davis Street
San Leandro, CA 94577

Re: Quarterly Groundwater Monitoring Report, Second Quarter 1999,
First Christian Church, Located at 1190 Davis Street, San Leandro, California

Dear Reverend Phoenix:

Pinnacle Environmental Solutions, a member of The IT Group (Pinnacle), is submitting the attached copy of the laboratory analytical results for the groundwater sample collected from well MW-5 during the second quarter of 1999. This well is located at the First Christian Church, 1190 Davis Street, San Leandro, California. The groundwater sample was collected during quarterly sampling of the ARCO Products Company (ARCO) Service Station No. 2111, located at 1156 Davis Street, San Leandro, California.

Please call if you have questions.

Sincerely,

Pinnacle

Glen VanderVeen
Project Manager

Attachments: Figure 1 - Generalized Site Plan
Appendix A - Copy of Certified Analytical Report and Chain-of-Custody
Documentation

cc: Amir Gholami, ACHCSA
Paul Supple, ARCO Products Company
File

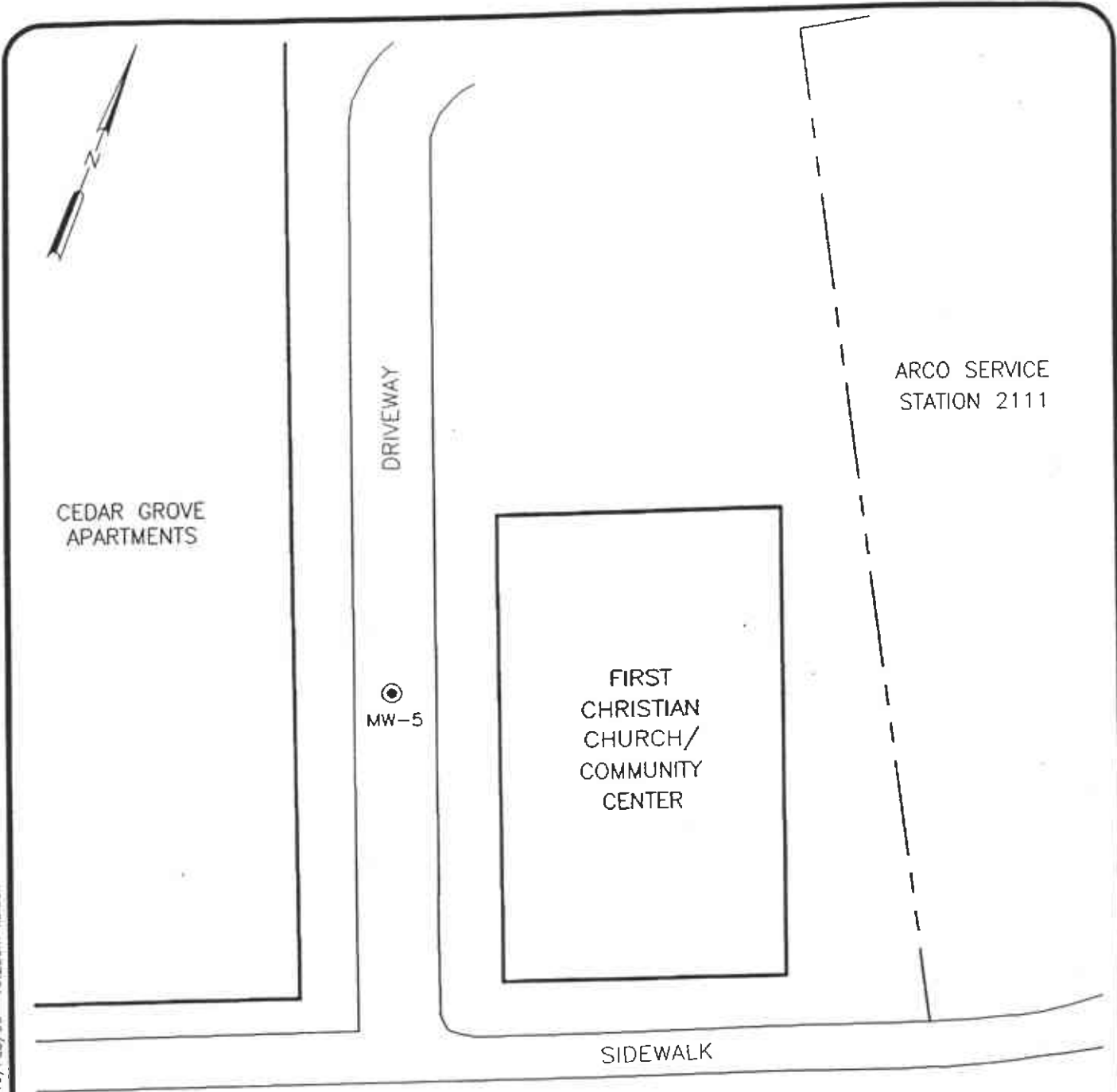
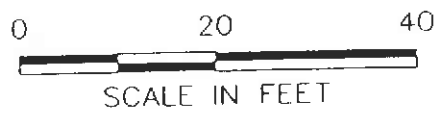

IMAGE Files: <No Images>
 XREF Files: <No Xrefs>
 Dimstyle: 20 Ltscale: 20 Psttscale: 0
 SANJOSE/CADD: N:\DWG\PINACL\2111\SJCHURCH.DWG Fri, 19/Feb/99 10:22am kblack

DAVIS STREET

EXPLANATION

- Groundwater monitoring well



Pinnacle
 ENVIRONMENTAL SOLUTIONS
 A DIVISION OF EMCON

DATE FEB. 1999
 DWN KAB
 APP _____
 REV _____
 PROJECT NO.
 20805-127 006

FIGURE 1
 FIRST CHRISTIAN CHURCH
 1190 DAVIS STREET
 SAN LEANDRO, CALIFORNIA
SITE PLAN

APPENDIX A

**COPY OF CERTIFIED ANALYTICAL REPORT,
AND CHAIN-OF-CUSTODY DOCUMENTATION**



September 22, 1999

Service Request No.: S9901960

Mr. Glen Vanderveen
EMCON-Pinnacle
2201 Broadway, Suite 101
Oakland, CA 94612

RE: TO#24118.00/RAT#8/2111 SAN LEANDRO

Dear Mr. Vanderveen:

Enclosed are the results of the sample(s) submitted to our laboratory on June 29, 1999. All analyses were performed in accordance with our laboratory's quality assurance program. Results are intended to be considered in their entirety and apply to the sample(s) analyzed. Columbia Analytical Services is not responsible for use of less than the complete report. Signature of this CAS Analytical Report confirms that pages 2 through 9, following, have been thoroughly reviewed and approved for release.

Columbia Analytical Services is certified for environmental analyses by the California Department of Health Services (certificate number: 1496, expiration: January 31, 2001).

If you have any question, please call me at (408) 748-9700.

Respectfully submitted,

Columbia Analytical Services, Inc.

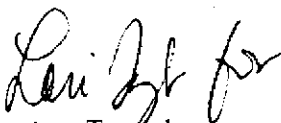
Bernadette Trombales
Project Chemist

Greg Jordan
Laboratory Director

COLUMBIA ANALYTICAL SERVICES, Inc.

Acronyms

A2LA	American Association for Laboratory Accreditation
ASTM	American Society for Testing and Materials
BOD	Biochemical Oxygen Demand
BTEX	Benzene, Toluene, Ethylbenzene, Xylenes
CAM	California Assessment Metals
CARB	California Air Resources Board
CAS Number	Chemical Abstract Service registry Number
CFC	Chlorofluorocarbon
CFU	Colony-Forming Unit
COD	Chemical Oxygen Demand
DEC	Department of Environmental Conservation
DEQ	Department of Environmental Quality
DHS	Department of Health Services
DLCS	Duplicate Laboratory Control Sample
DMS	Duplicate Matrix Spike
DOE	Department of Ecology
DOH	Department of Health
EPA	U. S. Environmental Protection Agency
ELAP	Environmental Laboratory Accreditation Program
GC	Gas Chromatography
GC/MS	Gas Chromatography/Mass Spectrometry
IC	Ion Chromatography
ICB	Initial Calibration Blank sample
ICP	Inductively Coupled Plasma atomic emission spectrometry
ICV	Initial Calibration Verification sample
J	Estimated concentration. The value is less than the MRL, but greater than or equal to the MDL. If the value is equal to the MRL, the result is actually <MRL before rounding.
LCS	Laboratory Control Sample
LUFT	Leaking Underground Fuel Tank
M	Modified
MBAS	Methylene Blue Active Substances
MCL	Maximum Contaminant Level. The highest permissible concentration of a substance allowed in drinking water as established by the U. S. EPA.
MDL	Method Detection Limit
MPN	Most Probable Number
MRL	Method Reporting Limit
MS	Matrix Spike
MTBE	Methyl tert-Butyl Ether
NA	Not Applicable
NAN	Not Analyzed
NC	Not Calculated
NCASI	National Council of the paper industry for Air and Stream Improvement
ND	Not Detected at or above the method reporting/detection limit (MRL/MDL)
NIOSH	National Institute for Occupational Safety and Health
NTU	Nephelometric Turbidity Units
ppb	Parts Per Billion
ppm	Parts Per Million
PQL	Practical Quantitation Limit
QA/QC	Quality Assurance/Quality Control
RCRA	Resource Conservation and Recovery Act
RPD	Relative Percent Difference
SIM	Selected Ion Monitoring
SM	Standard Methods for the Examination of Water and Wastewater, 18th Ed., 1992
STLC	Solubility Threshold Limit Concentration
SW	Test Methods for Evaluating Solid Waste, Physical/Chemical Methods, SW-846, 3rd Ed., 1986 and as amended by Updates I, II, IIA, and IIB.
TCLP	Toxicity Characteristic Leaching Procedure
TDS	Total Dissolved Solids
TPH	Total Petroleum Hydrocarbons
tr	Trace level. The concentration of an analyte that is less than the PQL but greater than or equal to the MDL. If the value is equal to the PQL, the result is actually <PQL before rounding.
TRPH	Total Recoverable Petroleum Hydrocarbons
TSS	Total Suspended Solids
TTLC	Total Threshold Limit Concentration
VOA	Volatile Organic Analyte(s)

ACRONLST.DOC 7/14/95

COLUMBIA ANALYTICAL SERVICES, INC.

Analytical Report

Client: ARCO Products Company
 Project: TO#24118.00/RAT#8/2111 SAN LEANDRO
 Sample Matrix: Water

Service Request: S9901960
 Date Collected: 6/25/99
 Date Received: 6/29/99

BTEX, MTBE and TPH as Gasoline

Sample Name: MW-5(21)
 Lab Code: S9901960-007
 Test Notes:

Units: ug/L (ppb)
 Basis: NA

Analyte	Prep Method	Analysis Method	MRL	Dilution Factor	Date Extracted	Date Analyzed	Result	Result Notes
TPH as Gasoline	EPA 5030	CA/LUFT	50	1	NA	7/8/99	ND	
Benzene	EPA 5030	8020	0.5	1	NA	7/8/99	ND	
Toluene	EPA 5030	8020	0.5	1	NA	7/8/99	ND	
Ethylbenzene	EPA 5030	8020	0.5	1	NA	7/8/99	ND	
Xylenes, Total	EPA 5030	8020	0.5	1	NA	7/8/99	ND	
Methyl tert-Butyl Ether	EPA 5030	8020	3	20	NA	7/8/99	1300	

Approved By: _____

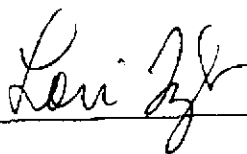

Date: _____

9-22-99

COLUMBIA ANALYTICAL SERVICES, INC.

Analytical Report

Client: ARCO Products Company
 Project: TO#24118.00/RAT#8/2111 SAN LEANDRO
 Sample Matrix: Water

Service Request: S9901960
 Date Collected: NA
 Date Received: NA

BTEX, MTBE and TPH as Gasoline

Sample Name: Method Blank
 Lab Code: S990707-WB1
 Test Notes:

Units: ug/L (ppb)
 Basis: NA

Analyte	Prep Method	Analysis Method	MRL	Dilution Factor	Date Extracted	Date Analyzed	Result	Result Notes
TPH as Gasoline	EPA 5030	CALUFT	50	1	NA	7/7/99	ND	
Benzene	EPA 5030	8020	0.5	1	NA	7/7/99	ND	
Toluene	EPA 5030	8020	0.5	1	NA	7/7/99	ND	
Ethylbenzene	EPA 5030	8020	0.5	1	NA	7/7/99	ND	
Xylenes, Total	EPA 5030	8020	0.5	1	NA	7/7/99	ND	
Methyl tert-Butyl Ether	EPA 5030	8020	3	1	NA	7/7/99	ND	

Approved By: _____

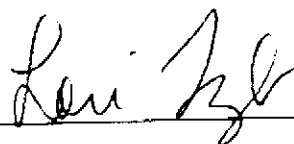

Date: _____

9-22-99

COLUMBIA ANALYTICAL SERVICES, INC.

Analytical Report

Client: ARCO Products Company
 Project: TO#24118.00/RAT#8/2111 SAN LEANDRO
 Sample Matrix: Water

Service Request: S9901960
 Date Collected: NA
 Date Received: NA

BTEX, MTBE and TPH as Gasoline

Sample Name: Method Blank
 Lab Code: S990708-WB1
 Test Notes:

Units: ug/L (ppb)
 Basis: NA

Analyte	Prep Method	Analysis Method	MRL	Dilution Factor	Date Extracted	Date Analyzed	Result	Result Notes
TPH as Gasoline	EPA 5030	CA/LUFT	50	1	NA	7/8/99	ND	
Benzene	EPA 5030	8020	0.5	1	NA	7/8/99	ND	
Toluene	EPA 5030	8020	0.5	1	NA	7/8/99	ND	
Ethylbenzene	EPA 5030	8020	0.5	1	NA	7/8/99	ND	
Xylenes, Total	EPA 5030	8020	0.5	1	NA	7/8/99	ND	
Methyl <i>tert</i> -Butyl Ether	EPA 5030	8020	3	1	NA	7/8/99	ND	

Approved By:

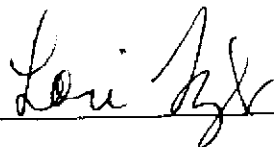

Date:

9-22-99

COLUMBIA ANALYTICAL SERVICES, INC.

QA/QC Report

Client: ARCO Products Company
Project: TO#24118 00/RAT#8/2111 SAN LEANDRO
Sample Matrix: Water

Service Request: S9901960
Date Collected: NA
Date Received: NA
Date Extracted: NA
Date Analyzed: NA

**Surrogate Recovery Summary
 BTEX, MTBE and TPH as Gasoline**

Prep Method: EPA 5030
Analysis Method: 8020 CA/LUFT

Units: PERCENT
Basis: NA

Sample Name	Lab Code	Test Notes	Percent Recovery	
			4-Bromofluorobenzene	a,a,a-Trifluorotoluene
MW-5(21)	S9901960-007		99	92
BATCH QC	S9901958-001MS		98	111
BATCH QC	S9901958-001DMS		99	107
BATCH QC	S9901958-003MS		102	101
BATCH QC	S9901958-003DMS		99	111
Method Blank	S990707-WB1		99	102
Method Blank	S990708-WB1		100	101

CAS Acceptance Limits: 69-116 69-116

Approved By: Ken Zyl Date: 9-22-99

SUR2/020397p

COLUMBIA ANALYTICAL SERVICES, INC.

QA/QC Report

Client: ARCO Products Company
 Project: TO#24118.00/RAT#8/2111 SAN LEANDRO
 Sample Matrix: Water

Service Request: S9901960
 Date Collected: NA
 Date Received: NA
 Date Extracted: NA
 Date Analyzed: 7/7/99

Matrix Spike/Duplicate Matrix Spike Summary
 BTE

Sample Name: BATCH QC
 Lab Code: S9901958-001MS, S9901958-001DMS
 Test Notes:

Units: ug/L (ppb)
 Basis: NA

Analyte	Prep Method	Analysis Method	Percent Recovery								Relative Percent Difference	
			Spike Level		Sample Result	Spike Result		CAS Acceptance Limits				
			MRL	MS		DMS	MS	DMS	MS	DMS		
Benzene	EPA 5030	8020	0.5	25	25	ND	24	23	96	92	75-135	4
Toluene	EPA 5030	8020	0.5	25	25	ND	25	25	100	100	73-136	<1
Ethylbenzene	EPA 5030	8020	0.5	25	25	ND	25	23	100	92	69-142	8

Approved By: *Lou Byle* Date: 9-22-99

COLUMBIA ANALYTICAL SERVICES, INC.

QA/QC Report

Client: ARCO Products Company
Project: TO#24118.00/RA1#8/2111 SAN LEANDRO
Sample Matrix: Water

Service Request: S9901960
Date Collected: NA
Date Received: NA
Date Extracted: NA
Date Analyzed: 7/7/99

Matrix Spike/Duplicate Matrix Spike Summary
TPH as Gasoline

Sample Name: BATCH QC
Lab Code: S9901958-001MS, S9901958-001DMS
Test Notes:

Units: ug/L (ppb)
Basis: NA

Analyte	Prep Method	Analysis Method	Spike Level		Sample Result	Percent Recovery				CAS Acceptance Limits	Relative Percent Difference	Result Notes
			MRL	MS DMS		MS	DMS	MS	DMS			
Gasoline	EPA 5030	CA/LUFT	50	250 250	ND	250	270	100	108	75-135	8	

Approved By: *[Signature]* Date: 9-22-99

COLUMBIA ANALYTICAL SERVICES, INC.

QA/QC Report

Client: ARCO Products Company
Project: TO#24118.00/RAT#8/2111 SAN LEANDRO

Service Request: S9901960
Date Analyzed: 7/8/99

Initial Calibration Verification (ICV) Summary
BTEX, MTBE and TPH as Gasoline

Sample Name: ICV
Lab Code: ICV1
Test Notes:

Units: ug/L (ppb)
Basis: NA

Table with 8 columns: Analyte, Prep Method, Analysis Method, True Value, Result, CAS Percent Recovery Acceptance Limits, Percent Recovery, Result Notes. Rows include TPH as Gasoline, Benzene, Toluene, Ethylbenzene, Xylenes, Total, and Methyl tert-Butyl Ethol.

Approved By: [Signature] Date: 9-22-99

ICV832196

