

Exxon Company, U.S.A.
QUARTERLY STATUS REPORT
 October - December 1994
 Date: January 10, 1995
 (Page 1 of 2)

RAS # 7-3006
 720 High Street
 Oakland, California
 ERI No. 2010

Work Performed During This Quarter

October - December 1994

- Performed monthly depth to water measurements on October 25, November 30, and December 27, 1994.
- Performed Quarterly Groundwater Monitoring for fourth quarter 1994 on October 25 and 26, 1994.
- Submitted quarterly groundwater monitoring report for third quarter 1994 to Exxon on November 10, 1994.
- Completed construction of groundwater remediation system.

Quarterly Groundwater Sampling (10/25 and 26/94) Results (ug/L)

<u>Well No.</u>	<u>TPHg</u>	<u>B</u>	<u>T</u>	<u>E</u>	<u>X</u>	<u>TPHd</u>	<u>Trend</u>
MW1	<50	<0.5	<0.5	<0.5	<0.5	<50	Unchanged
MW2	Sheen						
MW3	Sheen						
MW4	Sheen						
MW5	Well Destroyed						
MW6	Sheen						
MW7	1,400	51	1.5	24	6.8	89*	Decreased
MW8	Sheen						
MW9	<50	<0.5	<0.5	<0.5	<0.5	<50	Unchanged
MW10	<50	<0.5	<0.5	<0.5	<0.5	<50	Unchanged
MW11	<50	<0.5	<0.5	<0.5	<0.5	<50	Unchanged
MW12	Sheen						
MW13	Sheen						Decreased
MW14	200	<0.5	<0.5	0.8	<0.5	210*	Decreased
MW15	Sheen						Increased

Exxon Company, U.S.A.
QUARTERLY STATUS REPORT
October - December 1994
Date: January 10, 1995
(Page 2 of 2)

RAS # 7-3006
720 High Street
Oakland, California
ERI No. 2010

Separate Phase Product Recovery

Not Applicable

Work to be Performed Next Quarter

Estimated Completion Date: 03/31/95

- Perform start-up of groundwater remediation system.
- Prepare quarterly groundwater monitoring report for fourth quarter 1994 and submit to Exxon.
- Perform quarterly groundwater monitoring for first quarter 1995 and submit report to Exxon.
- Perform biweekly operation and maintenance of groundwater remediation system.

Work to be Performed Next 12 Months

Estimated Completion Date: 12/31/95

- Perform groundwater monitoring and sampling program to evaluate the trends of gasoline hydrocarbons and groundwater flow direction and gradient.
- Continue operation and maintenance of remediation system and submit quarterly remediation status reports.

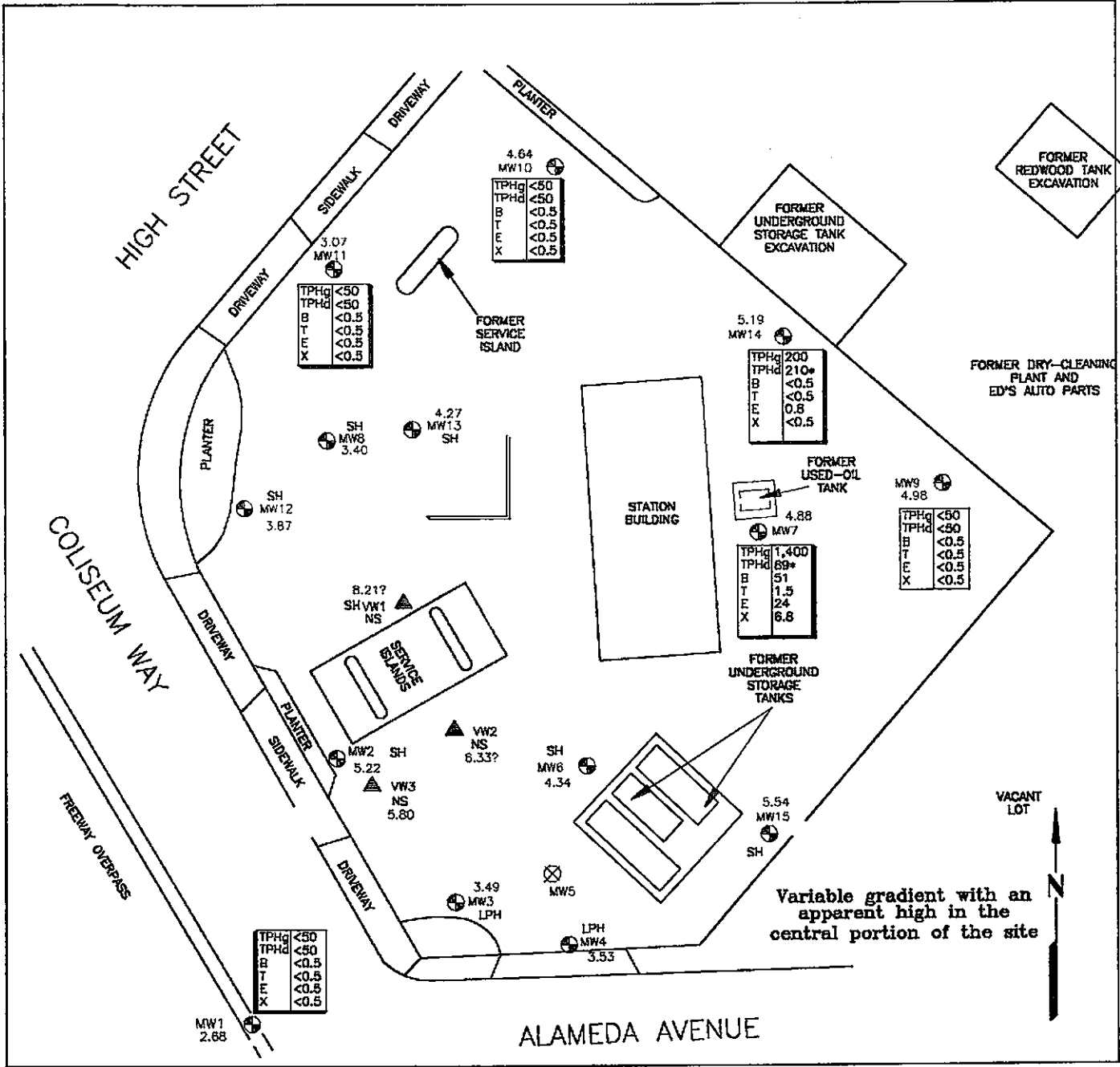

FN 20100002

EXPLANATION

- MW15 ⊕ = Monitoring well (RESNA)
- MW5 ⊗ = Monitoring well (destroyed) (RESNA)
- VW3 ▲ = Vapor well (RESNA, 1993)
- NS = Not sampled
- SH = Sheen
- LPH = Liquid Phase Petroleum Hydrocarbons present

TPHg	1,400
TPHd	210
B	51
T	1.5
E	2.4
X	6.8

= Concentrations of Petroleum Hydrocarbons in groundwater in parts per billion, October 25 and 26, 1994

6.63 = Elevation of groundwater in feet above mean sea level, (October 25, 1994)

• = Sample chromatogram does not match diesel standard.

APPROXIMATE SCALE

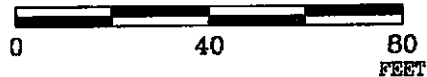

SOURCE:
Modified from a map provided by EXXON U.S.A.



GENERALIZED SITE PLAN

FORMER EXXON STATION 7-3006
720 High Street
Oakland, California

PROJECT NO.

2010

PLATE

2

DATE: 11/09/94