

ExxonMobil Refining & Supply Company
Global Remediation – US Retail
4096 Piedmont Avenue #194
Oakland, California 94611
510.547.8196
510.547.8706 Fax
jennifer.c.sedlachek@exxonmobil.com

Jennifer C. Sedlachek
Project Manager

RECEIVED

By dehloptoxic at 1:55 pm, Jan 03, 2007

ExxonMobil
Refining & Supply

December 14, 2006

Mr. Steven Plunkett
Alameda County Health Care Services Agency
Department of Environmental Health
1131 Harbor Bay Parkway, Room 250
Alameda, California 94502-6577

RE: Former Exxon RAS #7-3006/720 High Street, Oakland, California.

Dear Mr. Plunkett:

Attached for your review and comment is a copy of the letter report entitled *Groundwater Monitoring Report, Fourth Quarter 2006*, dated December 14, 2006, for the above-referenced site. The report was prepared by Environmental Resolutions, Inc. (ERI) of Petaluma, California, and details groundwater monitoring and sampling activities for the subject site.

I declare, under penalty of perjury, that the information and/or recommendations contained in the attached document or report is true and correct to the best of my knowledge.

If you have any questions or comments, please contact me at 510.547.8196.

Sincerely,



Jennifer C. Sedlachek
Project Manager

Attachment: ERI's Groundwater Monitoring Report, Fourth Quarter 2006, dated December 14, 2006.

cc: w/ attachment
Mr. Chuck Headlee, California Regional Water Quality Control Board, San Francisco Bay Region
Mr. Mansour Sepehr, Ph.D., P.E., SOMA Environmental Engineering, Incorporated

w/o attachment
Ms. Paula Sime, Environmental Resolutions, Inc.

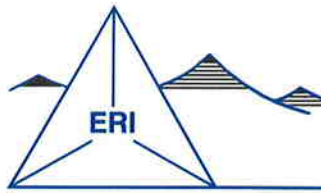

December 14, 2006
ERI 201013.Q064

Ms. Jennifer C. Sedlachek
ExxonMobil Refining & Supply - Global Remediation
4096 Piedmont Avenue #194
Oakland, California 94611

SUBJECT Groundwater Monitoring Report, Fourth Quarter 2006
Former Exxon Service Station 7-3006
720 High Street, Oakland, California

INTRODUCTION

At the request of Exxon Mobil Corporation (Exxon Mobil), Environmental Resolutions, Inc. (ERI) performed fourth quarter 2006 groundwater monitoring and sampling activities at the subject site. Relevant tables, plates, and attachments are included at the end of this report. Currently, the site operates as a service station.

GROUNDWATER MONITORING AND SAMPLING SUMMARY

Gauging and sampling date:	10/06/06
Wells gauged and sampled:	MW1, MW2, MW3, MW6, and MW14
Presence of NAPL:	Not observed
Laboratory:	TestAmerica Analytical Testing Corporation Morgan Hill, California
Analyses performed:	EPA 8015B TPHd, TPHg EPA 8021B BTEX EPA 8260B MTBE, ETBE, TAME, TBA, EDB, 1,2-DCA, DIPE EPA 8260B Ethanol (select samples)
Waste disposal:	197 gallons purge and decon water delivered to Romic Environmental Technologies Corporation on 10/09/06

REMEDIAL SYSTEM SUMMARY

Exxon Mobil's remedial efforts at the site have included excavation, product bailing, groundwater extraction, vapor extraction, air sparging, and biosparging.

In 1989, approximately 27 gallons of liquid-phase hydrocarbons (LPHs) were removed from on-site wells. In 1993, petrotraps were installed in wells MW2, MW4, and MW6; and 6.3 gallons of LPHs were removed. The groundwater extraction and treatment system (GET) system operated from January 1995 to December 1998, the air sparge/soil vapor extraction (AS/SVE) system operated from August 1996 to July 1999, and a bio-sparge system operated from July 2001 to June 2003.

Groundwater Extraction and Treatment System

The GET system was designed to treat separate-phase and dissolved-phase petroleum hydrocarbons in groundwater extracted from the interceptor trench beneath the site. Pneumatic pumps were installed in extraction wells RW2 and RW5 to recover groundwater from the interceptor trench. Subsurface and aboveground collection piping were used to transfer extracted groundwater to a holding tank. A transfer pump and polyvinyl chloride piping were used to direct the water stream from the holding tank through water filters, an air stripper, and subsequently through liquid-phase granular activated carbon canisters connected in series. The treated groundwater was discharged to the sanitary sewer regulated by East Bay Municipal Utilities District. The GET system operated from January 1995 to December 1998 and removed approximately 10 pounds of total petroleum hydrocarbons as gasoline (TPHg) and 3 pounds of benzene. The GET system was shut down when influent concentrations decreased.

Air Sparge/ Soil Vapor Extraction System

The AS/SVE system consisted of six AS wells (AS1 through AS6) for air injection and three vadose wells (VW1 through VW3) for vapor extraction within an on-site interceptor trench, a water knock-out tank, a Thermtech VAC-25 thermal/oxidizer, a Gast air compressor, and a propane tank for supplemental fuel. The AS/SVE system operated from August 1996 to July 1999 and removed approximately 5,144 pounds of TPHg and 61 pounds of benzene. The AS/SVE system was shut down when influent TPHg concentrations decreased to near the laboratory reporting limits and TPHg removal rates reached asymptotic conditions.

The bio-sparge system operated from July 2001 to June 2003 and used an air compressor to inject air into the on-site groundwater interceptor trench to enhance biodegradation. The bio-sparge system was discontinued when it was deemed ineffective.

DOCUMENT DISTRIBUTION

ERI recommends forwarding copies of this report to:

Mr. Steven Plunkett
Alameda County Health Care Services Agency
Department of Environmental Health
1131 Harbor Bay Parkway, Suite 250
Alameda, California 94502-6577

Mr. Chuck Headlee
California Regional Water Quality Control Board
San Francisco Bay Region
1515 Clay Street, Suite 1400
Oakland, California 94612

Mr. Mansour Sepehr, Ph.D., P.E.
SOMA Environmental Engineering, Incorporated
6620 Owens Drive, Suite A
Pleasanton, California 94588

LIMITATIONS

This report was prepared in accordance with generally accepted standards of environmental practice in California at the time this investigation was performed. This report has been prepared for Exxon Mobil, and any reliance on this report by third parties shall be at such party's sole risk.

Please call Ms. Paula Sime, ERI's project manager for this site, at (707) 766-2000 with any questions regarding this report.

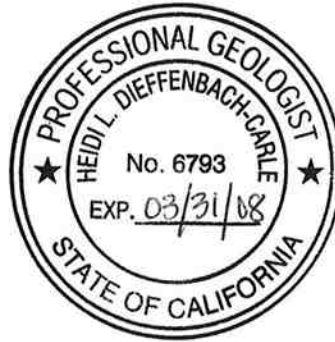

Sincerely,
Environmental Resolutions, Inc

Karen Navarro
Karen L. Navarro
Technical Writer

Heidi Dieffenbach-Carle
Heidi Dieffenbach-Carle
P.G. 6793

- Attachments: Table 1A: Cumulative Groundwater Monitoring and Sampling Data
- Table 1B: Additional Cumulative Groundwater Monitoring and Sampling Data
- Table 2: Well Construction Details

- Plate 1: Site Vicinity Map
- Plate 2: Select Analytical Results
- Plate 3: Groundwater Elevation Map

- Attachment A: Groundwater Sampling Protocol
- Attachment B: Historical Cumulative Groundwater Monitoring and Sampling Data
- Attachment C: Laboratory Analytical Report and Chain-of-Custody Record
- Attachment D: Waste Disposal Documentation

TABLE 1A
CUMULATIVE GROUNDWATER MONITORING AND SAMPLING DATA
Former Exxon Service Station 7-3006
720 High Street
Oakland, California
(Page 1 of 14)

Well ID	Sampling Date	TOC (feet)	DTW (feet)	GW Elev. (feet)	SUBJ	TPHd (µg/L)	TPHg (µg/L)	MTBE 8021B (µg/L)	MTBE 8260B (µg/L)	B (µg/L)	T (µg/L)	E (µg/L)	X (µg/L)
MW1	01/20/94	12.87	9.25	3.62	NLPH	---	---	---	---	---	---	---	---
MW1	02/02/94	12.87	8.60	4.27	NLPH	70	<50	---	---	---	---	---	---
MW1	03/10/94	12.87	8.31	4.56	NLPH	---	---	---	---	<0.5	<0.5	<0.5	0.7
MW1	04/22/94	12.87	7.95	4.92	NLPH	---	---	---	---	---	---	---	---
MW1	05/10/94	12.87	7.48	5.39	NLPH	100	<50	---	---	---	---	---	---
MW1	06/27/94	12.87	7.65	5.22	NLPH	---	---	---	---	<0.5	<0.5	<0.5	1.6
MW1	08/31/94	12.87	9.39	3.48	NLPH	---	---	---	---	---	---	---	---
MW1	09/29/94	12.87	9.83	3.04	NLPH	<50	<50	---	---	---	---	---	---
MW1	10/25/94	12.87	10.19	2.68	NLPH	---	<50	---	---	<0.5	<0.5	<0.5	<0.5
MW1	11/30/94	12.87	8.97	3.90	NLPH	---	---	<50	---	<0.5	<0.5	<0.5	<0.5
MW1	12/27/94	12.87	7.44	5.43	NLPH	---	---	---	---	---	---	---	---
MW1	02/06/95	12.87	5.71	7.16	NLPH	---	<50	---	---	---	---	---	---
MW1	06/07/95	12.87	7.62	5.25	NLPH	81	<50	3.5	---	0.52	<0.5	<0.5	<0.5
MW1	09/18/95	12.87	10.02	2.85	NLPH	82	<50	6	---	<0.5	<0.5	<0.5	<0.5
MW1	11/01/95	12.87	10.74	2.13	NLPH	160	<50	8.9	---	<0.5	<0.5	<0.5	<0.5
MW1	02/14/96	12.87	7.81	5.06	NLPH	100	<50	7.8	---	<0.5	<0.5	<0.5	<0.5
MW1	06/19/96	12.87	7.47	5.40	NLPH	93	<50	7.1	---	<0.5	<0.5	<0.5	<0.5
MW1	09/24/96	12.87	10.42	2.45	NLPH	83	<50	9.5	---	<0.5	<0.5	<0.5	<0.5
MW1	12/11/96	12.87	8.50	4.37	NLPH	81	<50	7.2	---	<0.5	<0.5	<0.5	<0.5
MW1	03/19/97	12.87	9.14	3.73	NLPH	78	<50	6.4	---	<0.5	<0.5	<0.5	<0.5
MW1	06/04/97	12.87	9.82	3.05	NLPH	58	<50	6.0	---	<0.5	<0.5	<0.5	<0.5
MW1	09/02/97	12.87	10.26	2.61	NLPH	150	<50	5.4	---	<0.5	<0.5	<0.5	<0.5
MW1	12/02/97	12.87	9.32	3.55	NLPH	88	<50	5.1	---	<0.5	<0.5	<0.5	<0.5
MW1	03/24/98	12.87	6.44	6.43	NLPH	58	<50	5.6	---	<0.5	<0.5	<0.5	<0.5
MW1	06/23/98	12.87	9.23	3.64	NLPH	84	<50	3.8	---	<0.5	<0.5	<0.5	<0.5
MW1	09/29/98	12.87	9.91	2.96	NLPH	61	<50	2.6	---	<0.5	<0.5	<0.5	<0.5
MW1	12/30/98	12.87	9.21	3.66	NLPH	80	<50	4.1	---	<0.5	<0.5	<0.5	<0.5
MW1	03/24/99	12.87	5.53	7.34	NLPH	64.3	<50	4.95	---	<0.5	<0.5	<0.5	<0.5
MW1	06/22/99	12.87	7.39	5.48	NLPH	83.5	<50	3.70	---	<0.5	<0.5	<0.5	<0.5
MW1	09/29/99	12.87	8.90	3.97	NLPH	52.9	<50	4.81	---	<0.5	<0.5	<0.5	<0.5
MW1	12/21/99	12.87	8.94	3.93	NLPH	60	<50	10	---	<0.5	<0.5	<0.5	<0.5
MW1	03/21/00	12.87	5.34	7.53	NLPH	---	<50	4.5	---	<0.5	<0.5	<0.5	<0.5
MW1	03/30/01	12.87	5.29	7.58	NLPH	79	<50	---	---	<0.5	<0.5	<0.5	<0.5
MW1	11/01/01	12.79	Well surveyed in compliance with AB 2886 requirements.					---	---	<0.5	<0.5	<0.5	<0.5
MW1	03/11/02 k	12.79	5.39	7.40	NLPH	<50.0	116	110	160	1.10	<0.50	<0.50	<0.50
MW1	03/11/03	12.79	6.63	6.16	NLPH	<50	153	188	179	<0.5	<0.5	<0.5	<0.5
MW1	03/26/04	12.79	6.18	6.61	NLPH	74g	<50.0	---	171	<0.50	0.5	<0.5	<0.5
MW1	11/02/04	12.79	6.44	6.35	NLPH	75g	145	---	137	0.50	<0.5	<0.5	<0.5
MW1	02/04/05	12.79	5.01	7.78	NLPH	158g	132	---	120	<0.50	<0.5	<0.5	<0.5
MW1	05/02/05	12.79	4.66	8.13	NLPH	386g	131	---	138	<0.50	<0.5	<0.5	<0.5
MW1	08/01/05	12.79	5.51	7.28	NLPH	129g	89.8	---	98.4	0.70	<0.5	<0.5	<0.5
MW1	10/25/05	12.79	5.54	7.25	NLPH	<50.0	67.2	---	84.1	<0.50	<0.50	<0.50	<0.50

TABLE 1A
CUMULATIVE GROUNDWATER MONITORING AND SAMPLING DATA
Former Exxon Service Station 7-3006
720 High Street
Oakland, California
(Page 2 of 14)

Well ID	Sampling Date	TOC (feet)	DTW (feet)	GW Elev. (feet)	SUBJ	TPHd (µg/L)	TPHg (µg/L)	MTBE 8021B (µg/L)	MTBE 8260B (µg/L)	B (µg/L)	T (µg/L)	E (µg/L)	X (µg/L)
MW1	01/24/06	12.79	4.07	8.72	NLPH	<50	71	---	91	<0.50	<0.50	<0.50	<0.50
MW1	04/28/06	12.79	4.01	8.78	NLPH	<47	80 l	---	92n	<0.50n	<0.50	<0.50	<0.50
MW1	08/04/06	12.79	4.78	8.01	NLPH	159	70.9	---	71.0	<0.50	<0.50	<0.50	<0.50
MW1	10/06/06	12.79	7.02	5.77	NLPH	<47	70 l	---	98	<0.50	<0.50	<0.50	<0.50
MW2	01/20/94	12.98	---	---	---	---	---	---	---	---	---	---	---
MW2	02/02/94	12.98	---	---	---	---	---	---	---	---	---	---	---
MW2	03/10/94	12.98	6.96	6.02	[8 c.]	---	---	---	---	---	---	---	---
MW2	04/22/94	12.98	---	---	[10 c.]	---	---	---	---	---	---	---	---
MW2	05/10/94	12.98	---	---	[5 c.]	---	---	---	---	---	---	---	---
MW2	06/27/94	12.98	7.10	5.88	Sheen	---	---	---	---	---	---	---	---
MW2	08/31/94	12.98	8.58	4.40	Sheen	---	---	---	---	---	---	---	---
MW2	09/29/94	12.98	9.11	3.87	Sheen	---	---	---	---	---	---	---	---
MW2	10/25/94	12.98	7.76	5.22	Sheen	---	---	---	---	---	---	---	---
MW2	11/30/94	12.98	7.33	5.65	---	---	---	---	---	---	---	---	---
MW2	12/27/94	12.98	6.77	6.21	Sheen	---	---	---	---	---	---	---	---
MW2	02/06/95	12.98	5.00	7.98	Sheen	---	---	---	---	---	---	---	---
MW2	06/07/95	12.98	7.14	5.84	Sheen	---	---	---	---	---	---	---	---
MW2	09/18/95	12.98	10.82	2.16	Sheen	---	---	---	---	---	---	---	---
MW2	11/01/95	12.98	11.65	1.33	Sheen	---	---	---	---	---	---	---	---
MW2	02/14/96	12.98	8.39	4.59	Sheen	---	---	---	---	---	---	---	---
MW2	06/19/96	12.98	6.55	6.43	Sheen	---	---	---	---	---	---	---	---
MW2	09/24/96	12.98	11.56	1.42	Sheen	---	---	---	---	---	---	---	---
MW2	12/11/96	12.98	8.02	4.96	Sheen	---	---	---	---	---	---	---	---
MW2	03/19/97	12.98	8.63	4.35	Sheen	---	---	---	---	---	---	---	---
MW2	06/04/97	12.98	10.57	2.41	Sheen	---	---	---	---	---	---	---	---
MW2	09/02/97	12.98	11.51	1.47	Sheen	---	---	---	---	---	---	---	---
MW2	12/02/97	12.98	11.24	1.74	NLPH	820	1,400	57	---	15	2.8	8.6	<2.5
MW2	03/27/98	12.98	6.06	6.92	NLPH	2,000	7,400	<50	---	1,400	350	490	1,500
MW2	06/23/98	12.98	11.06	1.92	Sheen	2,900	180	9.5	---	3.2	0.55	0.92	1.3
MW2	09/29/98	12.98	10.51	2.47	NLPH	180	290	9.3	---	<0.50	0.65	1.5	1.5
MW2	12/30/98	12.98	9.83	3.15	NLPH	700	520	16	---	17	0.96	2.6	3.5
MW2	03/24/99	12.98	4.47	8.51	NLPH	1,440	14,000	<40	---	1,300	336	786	3,420
MW2	06/22/99	12.98	6.42	6.56	NLPH	2,310	1,080	25.2	---	54.3	14.9	38.8	107
MW2	09/29/99	12.98	8.00	4.98	NLPH	2,720e	517	15.4	---	37.5	7.48	12.9	15.2
MW2	12/21/99	12.98	8.10	4.88	NLPH	6,300	3,200	<2	---	360	5.5	120	106
MW2	03/21/00 h	12.98	---	---	---	---	---	---	---	---	---	---	---
MW2	03/30/01	12.98	3.09	9.89	NLPH	510	200	---	110	7.2	<0.5	2.4	2.1
MW2	11/01/01	13.06	Well surveyed in compliance with AB 2886 requirements.										
MW2	03/11/02 k	13.06	3.78	9.28	NLPH	293	<1,000	62.0	30	<10.0	<10.0	<10.0	<10.0
MW2	03/11/03	13.06	5.49	7.57	NLPH	422	1,490	325	428	279	3.0	9.8	18.9
MW2	03/27/04	13.06	4.65	8.41	NLPH	184g	254	---	131	6.80	0.5	<0.5	1.2
MW2	11/02/04	13.06	4.43	8.63	NLPH	96	52.0	---	8.00	1.40	<0.5	<0.5	<0.5

TABLE 1A
CUMULATIVE GROUNDWATER MONITORING AND SAMPLING DATA
Former Exxon Service Station 7-3006
720 High Street
Oakland, California
(Page 3 of 14)

Well ID	Sampling Date	TOC (feet)	DTW (feet)	GW Elev. (feet)	SUBJ	TPHd (µg/L)	TPHg (µg/L)	MTBE 8021B (µg/L)	MTBE 8260B (µg/L)	B (µg/L)	T (µg/L)	E (µg/L)	X (µg/L)
MW2	02/04/05	13.06	3.32	9.74	NLPH	372g	66.0	---	8.30	<0.50	<0.5	<0.5	<0.5
MW2	05/02/05	13.06	2.74	10.32	NLPH	195g	84.2	---	5.30	<0.50	<0.5	<0.5	<0.5
MW2	08/01/05	13.06	2.99	10.07	NLPH	344g	<50.0	---	1.70	0.60	<0.5	<0.5	<0.5
MW2	10/25/05	13.06	2.08	10.98	NLPH	55.3g	<50.0	---	1.22	<0.50	<0.50	<0.50	<0.50
MW2	01/24/06	13.06	2.77	10.29	NLPH	170g	<50	---	1.6	<0.50	<0.50	<0.50	<0.50
MW2	04/28/06	13.06	1.46	11.60	NLPH	6,900m	<50	---	1.4n	0.99n	<0.50	<0.50	<0.50
MW2	08/04/06	13.06	1.52	11.54	NLPH	145	<50.0	---	0.820	<0.50	<0.50	<0.50	<0.50
MW2	10/06/06	13.06	5.55	7.51	NLPH	90g	<50	---	2.1	0.78	<0.50	<0.50	<0.50
MW3	01/20/94	12.92	8.24	4.68	Sheen	---	---	---	---	---	---	---	---
MW3	02/02/94	12.92	7.68	5.24	Sheen	---	---	---	---	---	---	---	---
MW3	03/10/94	12.92	7.24	5.68	Sheen	---	---	---	---	---	---	---	---
MW3	04/22/94	12.92	6.79	6.13	Sheen	---	---	---	---	---	---	---	---
MW3	05/10/94	12.92	6.43	6.49	Sheen	---	---	---	---	---	---	---	---
MW3	06/27/94	12.92	6.97	5.95	0.01	---	---	---	---	---	---	---	---
MW3	08/31/94	12.92	8.41	4.51	Sheen	---	---	---	---	---	---	---	---
MW3	09/29/94	12.92	8.97	3.95	Sheen	---	---	---	---	---	---	---	---
MW3	10/25/94	12.92	9.43	3.49	Sheen	---	---	---	---	---	---	---	---
MW3	11/28/94	12.92	7.19	5.73	---	---	---	---	---	---	---	---	---
MW3	12/27/94	12.92	6.64	6.28	Sheen	---	---	---	---	---	---	---	---
MW3	02/06/95	12.92	4.87	8.05	Sheen	---	---	---	---	---	---	---	---
MW3	06/07/95	12.92	7.05	5.87	Sheen	---	---	---	---	---	---	---	---
MW3	09/18/95	12.92	10.61	2.31	Sheen	---	---	---	---	---	---	---	---
MW3	11/01/95	12.92	11.58	1.34	Sheen	---	---	---	---	---	---	---	---
MW3	02/14/96	12.92	8.34	4.58	Sheen	---	---	---	---	---	---	---	---
MW3	06/19/96	12.92	6.35	6.57	Sheen	---	---	---	---	---	---	---	---
MW3	09/24/96	12.92	11.45	1.47	Sheen	---	---	---	---	---	---	---	---
MW3	12/11/96	12.92	7.89	5.03	NLPH	17,000	4,800	30	---	340	<5.0	8.2	20
MW3	03/19/97	12.92	9.83	3.09	NLPH	3,000	1,900	80	---	160	11	5.6	10
MW3	06/04/97	12.92	10.43	2.49	NLPH	8,000	920	11	---	15	2.8	2.4	<2.0
MW3	09/02/97	12.92	12.45	0.47	Sheen	---	---	---	---	---	---	---	---
MW3	12/02/97	12.92	11.21	1.71	NLPH	6,700	920	21	---	10	2.1	<1.0	2.7
MW3	03/24/98	12.92	5.93	6.99	NLPH	4,600	1,500	25	---	5,500	<5.0	<5.0	<5.0
MW3	06/23/98	12.92	11.13	1.79	NLPH	39,000	1,300	9.4	---	53	<1.0	<1.0	<1.0
MW3	09/29/98	12.92	10.46	2.46	Sheen	2,600	540	<5.0	---	6.8	1.9	1.4	2.3
MW3	12/30/98	12.92	9.72	3.20	NLPH	11,000	4,000	<50	---	74	<10	<10	<10
MW3	03/24/99	12.92	4.36	8.56	Sheen	3,850	2,330	<20	---	<5.0	<5.0	<5.0	<5.0
MW3	06/22/99	12.92	6.22	6.70	NLPH	6,860	1,470	<10	---	492	<2.5	<2.5	<2.5
MW3	09/29/99	12.92	8.10	4.82	NLPH	2,290e	315	<5.0	---	11.5	3.07	<1.0	2.54
MW3	12/21/99	12.92	7.99	4.93	NLPH	37,000	6,600	4	---	22	5	5.1	31.4
MW3	01/26/00	12.92	5.48	7.44	NLPH	2,600g	---	---	---	---	---	---	---
MW3	03/21/00 h	12.92	---	---	---	---	---	---	---	---	---	---	---
MW3	03/30/01	12.92	4.02	8.90	NLPH	2,000	880	---	300	130	<0.5	1.2	2.4

TABLE 1A
CUMULATIVE GROUNDWATER MONITORING AND SAMPLING DATA
Former Exxon Service Station 7-3006
720 High Street
Oakland, California
(Page 4 of 14)

Well ID	Sampling Date	TOC (feet)	DTW (feet)	GW Elev. (feet)	SUBJ	TPHd (µg/L)	TPHg (µg/L)	MTBE 8021B (µg/L)	MTBE 8260B (µg/L)	B (µg/L)	T (µg/L)	E (µg/L)	X (µg/L)
MW3	11/01/01	13.71	Well surveyed in compliance with AB 2886 requirements.										
MW3	03/11/02 k	13.71	4.72	8.99	NLPH	19,100	<2,500	130	175	165	<25.0	<25.0	<25.0
MW3	03/11/03	13.71	6.23	7.48	NLPH	1,190	887	122	119	71.9	0.8	1.1	2.0
MW3	03/26/04	13.71	5.47	8.24	NLPH	16,500g	1,350	---	98.4	30.8	1.6	<0.5	3.8
MW3	11/02/04	13.71	5.30	8.41	NLPH	3,620g	466	---	30.8	32.4	<0.5	<0.5	4.7
MW3	02/04/05	13.71	4.14	9.57	NLPH	2,850g	531	---	22.7	19.3	<0.5	0.6	1.6
MW3	05/02/05	13.71	3.41	10.30	NLPH	3940g	586	---	29.5	36.3	3.1	0.8	4.3
MW3	08/01/05	13.71	3.88	9.83	NLPH	1,550	815	---	18.1	36.6	0.6	1.1	2.4
MW3	10/25/05	13.71	3.11	10.60	NLPH	4,010g	379	---	3.47	<0.50	<0.50	<0.50	1.01
MW3	01/24/06	13.71	2.69	11.02	NLPH	2,200g	510	---	13	35	<1.0	2.1	<1.0
MW3	04/28/06	13.71	2.44	11.27	NLPH	100g	330	---	13n	3.8n	<1.0	<1.0	<1.0
MW3	08/04/06	13.71	2.51	11.20	NLPH	3,890	441	---	10.1	14.7	0.57	1.44	4.23
MW3	10/06/06	13.71	6.33	7.38	NLPH	5,300]	360	---	9.7	3.8	<1.0	<1.0	<1.0
MW4	01/20/94	12.77	---	---	---	---	---	---	---	---	---	---	---
MW4	02/02/94	12.77	---	---	[1 c.]	---	---	---	---	---	---	---	---
MW4	03/10/94	12.77	7.12	5.65	[8 c.]	---	---	---	---	---	---	---	---
MW4	04/22/94	12.77	---	---	[10 c.]	---	---	---	---	---	---	---	---
MW4	05/10/94	12.77	---	---	[5 c.]	---	---	---	---	---	---	---	---
MW4	06/27/94	12.77	6.50	6.27	0.01	---	---	---	---	---	---	---	---
MW4	08/31/94	12.77	7.84	4.93	0.02	---	---	---	---	---	---	---	---
MW4	09/29/94	12.77	8.43	4.34	0.03	---	---	---	---	---	---	---	---
MW4	10/25/94	12.77	9.24	3.53	Sheen	---	---	---	---	---	---	---	---
MW4	11/30/94	12.77	6.77	6.00	---	---	---	---	---	---	---	---	---
MW4	12/27/94	12.77	6.14	6.63	Sheen	---	---	---	---	---	---	---	---
MW4	02/06/95	12.77	4.87	7.90	Sheen	---	---	---	---	---	---	---	---
MW4	06/07/95	12.77	6.91	5.86	Sheen	---	---	---	---	---	---	---	---
MW4	09/18/95	12.77	9.59	3.18	Sheen	---	---	---	---	---	---	---	---
MW4	11/01/95	12.77	11.52	1.25	Sheen	---	---	---	---	---	---	---	---
MW4	02/14/96	12.77	8.56	4.21	Sheen	---	---	---	---	---	---	---	---
MW4	06/19/96	12.77	6.09	6.68	Sheen	---	---	---	---	---	---	---	---
MW4	09/24/96	12.77	10.20	2.57	Sheen	---	---	---	---	---	---	---	---
MW4	12/11/96	12.77	7.78	4.99	Sheen	---	---	---	---	---	---	---	---
MW4	03/19/97	12.77	8.56	4.21	Sheen	---	---	---	---	---	---	---	---
MW4	06/04/97	12.77	9.31	3.46	Sheen	---	---	---	---	---	---	---	---
MW4	09/02/97	12.77	10.00	2.77	Sheen	---	---	---	---	---	---	---	---
MW4	12/02/97	12.77	8.72	4.05	NLPH	15,000	1,500	50	---	<2.5	9.7	3.0	10
MW4	03/24/98	12.77	5.79	6.98	NLPH	6,400	540	38	---	<0.5	4.4	1.6	5.4
MW4	06/23/98	12.77	8.50	4.27	Sheen	7,500	1,000	25	---	3.3	<2.0	<2.0	<2.0
MW4	09/29/98	12.77	9.77	3.00	Sheen	65,000	7,300	<50	---	<10	<10	<10	<10
MW4	12/30/98	12.77	8.54	4.23	Sheen	12,000	1,000	170	---	3.8	5.1	<2.5	4.1
MW4	03/24/99	12.77	4.41	8.36	Sheen	20,500	1,300	4.40	---	2.64	<1.0	<1.0	<1.0
MW4	06/22/99	12.77	5.71	7.06	NLPH	9,760	1,470	<10	---	404	<2.5	<2.5	<2.5

TABLE 1A
CUMULATIVE GROUNDWATER MONITORING AND SAMPLING DATA
Former Exxon Service Station 7-3006
720 High Street
Oakland, California
(Page 5 of 14)

Well ID	Sampling Date	TOC (feet)	DTW (feet)	GW Elev. (feet)	SUBJ	TPHd (µg/L)	TPHg (µg/L)	MTBE 8021B (µg/L)	MTBE 8260B (µg/L)	B (µg/L)	T (µg/L)	E (µg/L)	X (µg/L)
MW4	09/29/99	12.77	7.32	5.45	NLPH	2,470f	589c	8.12	---	12.6	<1.0	<1.0	<1.0
MW4	12/21/99	12.77	7.58	5.19	NLPH	230,000	2,000	<2	---	<0.5	0.56	1.9	18.6
MW4	01/26/00	12.77	5.85	6.92	NLPH	3,200g	---	---	---	---	---	---	---
MW4	03/21/00	12.77	3.58	9.19	NLPH	5,900	270	13	---	6.8	0.83	<0.5	3.6
MW4	03/30/01 - Present: Well covered by asphalt.												
MW5	07/18/89	Well Destroyed.											
MW6	01/20/94	14.27	---	---	---	---	---	---	---	---	---	---	---
MW6	02/02/94	14.27	---	---	---	---	---	---	---	---	---	---	---
MW6	03/10/94	14.27	7.82	6.45	[¼ c.]	---	---	---	---	---	---	---	---
MW6	04/22/94	14.27	---	---	[10 c.]	---	---	---	---	---	---	---	---
MW6	05/10/94	14.27	---	---	[3 c.]	---	---	---	---	---	---	---	---
MW6	06/27/94	14.27	7.77	6.50	Sheen	---	---	---	---	---	---	---	---
MW6	08/31/94	14.27	9.02	5.25	Sheen	---	---	---	---	---	---	---	---
MW6	09/29/94	14.27	9.51	4.76	Sheen	---	---	---	---	---	---	---	---
MW6	10/25/94	14.27	9.93	4.34	Sheen	---	---	---	---	---	---	---	---
MW6	11/30/94	14.27	8.05	6.22	---	---	---	---	---	---	---	---	---
MW6	12/27/94	14.27	7.54	6.73	---	---	---	---	---	---	---	---	---
MW6	02/06/95	14.27	5.86	8.41	Sheen	---	---	---	---	---	---	---	---
MW6	06/07/95	14.27	8.07	6.20	Sheen	---	---	---	---	---	---	---	---
MW6	09/18/95	14.27	10.54	3.73	Sheen	---	---	---	---	---	---	---	---
MW6	11/01/95	14.27	11.41	2.86	Sheen	---	---	---	---	---	---	---	---
MW6	02/14/96	14.27	9.17	5.10	Sheen	---	---	---	---	---	---	---	---
MW6	06/19/96	14.27	7.13	7.14	Sheen	---	---	---	---	---	---	---	---
MW6	09/24/96	14.27	11.24	3.03	Sheen	---	---	---	---	---	---	---	---
MW6	12/11/96	14.27	9.20	5.07	NLPH	2,900	9,100	<100	---	2,100	22	160	260
MW6	03/19/97	14.27	10.14	4.13	NLPH	3,800	24,000	250	---	5,800	91	1,300	1,900
MW6	06/04/97	14.27	10.58	3.69	NLPH	3,300	20,000	270	---	4,400	<50	540	480
MW6	09/02/97	14.27	11.02	3.25	NLPH	2,100	8,100	<25	---	1,800	<25	140	170
MW6	12/02/97	14.27	10.45	3.82	NLPH	2,300	6,800	<100	---	1,100	<20	77	74
MW6	03/24/98	14.27	7.09	7.18	NLPH	3,800	20,000	<250	---	4,300	<50	2,200	1,500
MW6	06/23/98	14.27	9.79	4.48	Sheen	4,100	19,000	<500	---	3,400	<100	1,800	1,100
MW6	09/29/98	14.27	10.56	3.71	NLPH	2,300	8,600	<100	---	2,100	25	300	260
MW6	12/30/98	14.27	9.97	4.30	NLPH	2,700	6,800	<125	---	1,600	<25	84	200
MW6	03/24/99	14.27	5.02	9.25	Sheen	2,670	12,600	<20	---	3,380	16.5	221	190
MW6	06/22/99	14.27	6.91	7.36	NLPH	5,670	6,720	<40	---	2,400	<10	767	14.4
MW6	09/29/99	14.27	8.66	5.61	NLPH	1,370f	6,310d	<250	---	<25	<25	133	<25
MW6	12/21/99	14.27	8.57	5.70	NLPH	2,300	3,800	12	---	890	3.3	94	95
MW6	03/21/00 h	14.27	---	---	---	---	---	---	---	---	---	---	---
MW6	03/30/01	14.27	3.66	10.61	NLPH	2,000	9,200	---	<5	3,100	9.1	130	31
MW6	11/01/01	14.23	Well surveyed in compliance with AB 2886 requirements.										
MW6	03/11/02 k	14.23	4.55	9.68	NLPH	1,460	7,660	45.0	<5.0	2,200	25.0 j	410	285

TABLE 1A
CUMULATIVE GROUNDWATER MONITORING AND SAMPLING DATA
Former Exxon Service Station 7-3006
720 High Street
Oakland, California
(Page 6 of 14)

Well ID	Sampling Date	TOC (feet)	DTW (feet)	GW Elev. (feet)	SUBJ	TPHd (µg/L)	TPHg (µg/L)	MTBE 8021B (µg/L)	MTBE 8260B (µg/L)	B (µg/L)	T (µg/L)	E (µg/L)	X (µg/L)
MW6	03/11/03	14.23	5.79	8.44	NLPH	1,100	5,120	15.7	1.80	920	3.2	36	19.4
MW6	03/26/04	14.23	5.22	9.01	NLPH	596g	5,090	---	0.70	1,130	14.7	164	62.9
MW6	11/02/04	14.23	4.84	9.39	NLPH	1,000g	4,320	---	<0.50	793	3.6	178	53.0
MW6	02/04/05	14.23	3.83	10.40	NLPH	1,410g	3,950	---	<0.50	1,210	9.4	110	22.6
MW6	05/02/05	14.23	3.18	11.05	NLPH	852g	4,900	---	<0.50	755	6.6	189	20.9
MW6	08/01/05	14.23	3.92	10.31	NLPH	1,290g	3,320	---	1.20	597	5.1	64.7	47.5
MW6	10/25/05	14.23	3.93	10.30	NLPH	861g	2,870	---	1.48	496	4.24	63.5	35.9
MW6	01/24/06	14.23	2.81	11.42	NLPH	570g	4,000	---	<5.0	590	<25	51	<25
MW6	04/28/06	14.23	2.68	11.55	NLPH	400g	3,600	---	2.3n	600n	<12	60	<12
MW6	08/04/06	14.23	3.07	11.16	NLPH	899	4,070	---	0.920	294	4.42	74.1	19.9
MW6	10/06/06	14.23	5.64	8.59	NLPH	430g,j	1,900	---	<0.50	140	<12	24	<12
MW7	01/20/94	14.84	8.67	6.17	NLPH	---	---	---	---	---	---	---	---
MW7	02/02/94	14.84	8.47	6.37	NLPH	---	---	---	---	---	---	---	---
MW7	02/03/94	14.84	---	---	---	1,300	2,900	---	---	79	5	8.2	21
MW7	03/10/94	14.84	8.24	6.60	NLPH	---	---	---	---	---	---	---	---
MW7	04/22/94	14.84	7.95	6.89	NLPH	---	---	---	---	---	---	---	---
MW7	05/10/94	14.84	7.53	7.31	NLPH	---	---	---	---	---	---	---	---
MW7	05/11/94	14.84	---	---	---	1,300	2,400	---	---	---	---	---	---
MW7	06/27/94	14.84	8.01	6.83	NLPH	---	---	---	---	88	5.6	5.2	15
MW7	08/31/94	14.84	9.19	5.65	NLPH	---	---	---	---	---	---	---	---
MW7	09/29/94	14.84	9.65	5.19	NLPH	56	1,900	---	---	71	3.1	3.5	7.8
MW7	10/25/94	14.84	9.96	4.88	NLPH	89	1,400	---	---	51	1.5	24	6.8
MW7	11/30/94	14.84	7.78	7.06	---	---	---	---	---	---	---	---	---
MW7	12/27/94	14.84	7.51	7.33	---	---	---	---	---	---	---	---	---
MW7	02/06/95	14.84	5.79	9.05	NLPH	1,300	2,500	---	---	130	<10	<10	<10
MW7	06/07/95	14.84	7.73	7.11	NLPH	1,200	2,400	39	---	91	5	7.6	14
MW7	09/18/95	14.84	9.81	5.03	NLPH	1,100	1,800	<25	---	17	<5.0	<5.0	<5.0
MW7	11/01/95	14.84	10.56	4.28	NLPH	1,700	3,000	<13	---	2.7	11	25	<2.5
MW7	02/14/96	14.84	8.04	6.80	NLPH	1,200	1,900	<25	---	59	<5.0	<5.0	<5.0
MW7	06/19/96	14.84	7.33	7.51	NLPH	1,400	2,000	<25	---	96	<5.0	<5.0	5.6
MW7	09/24/96	14.84	10.10	4.74	NLPH	1,100	950	<25	---	6.8	<5.0	<5.0	<5.0
MW7	12/11/96	14.84	8.50	6.34	NLPH	1,600	2,500	<10	---	50	<2.0	6.4	30
MW7	03/19/97	14.84	8.88	5.96	NLPH	840	2,700	<25	---	61	8.0	21	68
MW7	06/04/97	14.84	9.38	5.46	NLPH	1,000	1,900	<2.5	---	45	<2.0	5.3	13
MW7	09/02/97	14.84	9.69	5.15	NLPH	790	1,700	<2.5	---	28	2.2	<2.0	5.9
MW7	12/02/97	14.84	8.65	6.19	NLPH	1,100	2,000	14	---	33	2.2	2.0	5.8
MW7	03/24/98	14.84	6.40	8.44	NLPH	950	2,300	<25	---	73	<5.0	<5.0	22
MW7	06/23/98	14.84	8.34	6.50	NLPH	1,600	4,700	140	---	50	<5.0	12	20
MW7	09/29/98	14.84	9.76	5.08	NLPH	630	700	<5.0	---	2.7	1.3	2.4	5.3
MW7	12/30/98	14.84	8.86	5.98	NLPH	1,700	1,400	<5.0	---	17	7.7	2.8	16
MW7	03/24/99	14.84	5.48	9.36	Sheen	860	1,740	6.73	---	59.2	2.76	4.33	15.1
MW7	06/22/99	14.84	6.54	8.30	NLPH	5,330	3,250	<4.0	---	59.5	3.96	2.89	6.38

TABLE 1A
CUMULATIVE GROUNDWATER MONITORING AND SAMPLING DATA
Former Exxon Service Station 7-3006
720 High Street
Oakland, California
(Page 9 of 14)

Well ID	Sampling Date	TOC (feet)	DTW (feet)	GW Elev. (feet)	SUBJ	TPHd (µg/L)	TPHg (µg/L)	MTBE 8021B (µg/L)	MTBE 8260B (µg/L)	B (µg/L)	T (µg/L)	E (µg/L)	X (µg/L)
MW10	02/06/95	14.05	5.60	8.45	NLPH	---	<50	<50	---	<0.5	<0.5	<0.5	<0.5
MW10	06/07/95	14.05	7.12	6.93	NLPH	<50	<50	<2.5	---	<0.5	<0.5	<0.5	<0.5
MW10	09/18/95	14.05	8.54	5.51	NLPH	<50	<50	<2.5	---	<0.5	<0.5	<0.5	<0.5
MW10	11/01/95	14.05	9.44	4.61	NLPH	<50	<50	<2.5	---	<0.5	<0.5	<0.5	<0.5
MW10	02/14/96	14.05	9.36	4.69	NLPH	64	<50	<2.5	---	<0.5	<0.5	<0.5	<0.5
MW10	06/19/96	14.05	7.32	6.73	NLPH	<50	<50	<2.5	---	<0.5	<0.5	<0.5	<0.5
MW10	09/24/96	14.05	9.07	4.98	NLPH	<50	<50	<2.5	---	<0.5	<0.5	<0.5	<0.5
MW10	12/11/96	14.05	7.73	6.32	NLPH	67	<50	<2.5	---	<0.5	<0.5	<0.5	<0.5
MW10	03/19/97	14.05	7.62	6.43	NLPH	51	<50	<2.5	---	<0.5	<0.5	<0.5	<0.5
MW10	06/04/97	14.05	8.38	5.67	NLPH	<50	<50	<2.5	---	<0.5	<0.5	<0.5	<0.5
MW10	09/02/97	14.05	8.64	5.41	NLPH	120	<50	<2.5	---	<0.5	<0.5	<0.5	<0.5
MW10	12/02/97	14.05	7.22	6.83	NLPH	<50	<50	<2.5	---	<0.5	<0.5	<0.5	<0.5
MW10	03/24/98	14.05	5.71	8.34	NLPH	<50	<50	<2.5	---	<0.5	<0.5	<0.5	<0.5
MW10	06/23/98	14.05	7.23	6.82	NLPH	90	<50	<2.5	---	<0.5	<0.5	<0.5	<0.5
MW10	09/29/98	14.05	8.39	5.66	NLPH	<50	<50	<2.5	---	<0.5	<0.5	<0.5	<0.5
MW10	12/30/98	14.05	7.74	6.31	NLPH	58	<50	<2.5	---	<0.5	<0.5	<0.5	<0.5
MW10	03/24/99	14.05	4.74	9.31	NLPH	<50	<50	<2.0	---	<0.5	<0.5	<0.5	<0.5
MW10	06/22/99	14.05	---	---	---	---	---	---	---	<0.5	<0.5	<0.5	<0.5
MW10	09/29/99	14.05	8.17	5.88	NLPH	---	---	---	---	---	---	---	---
MW10	12/21/99	14.05	7.87	6.18	NLPH	---	---	---	---	---	---	---	---
MW10	12/21/00	Well destroyed.											
MW11	01/20/94	13.55	9.61	3.94	NLPH	---	---	---	---	---	---	---	---
MW11	02/02/94	13.55	9.56	3.99	NLPH	---	---	---	---	---	---	---	---
MW11	02/03/94	13.55	---	---	---	160	<50	---	---	---	---	---	---
MW11	03/10/94	13.55	8.59	4.96	NLPH	---	---	---	---	<0.5	1	<0.5	0.9
MW11	04/22/94	13.55	8.47	5.08	NLPH	---	---	---	---	---	---	---	---
MW11	05/10/94	13.55	8.12	5.43	NLPH	1002	<50	---	---	<0.53	<0.5	<0.5	3.2
MW11	06/27/94	13.55	8.65	4.90	NLPH	---	---	---	---	---	---	---	---
MW11	08/31/94	13.55	9.80	3.75	NLPH	---	---	---	---	---	---	---	---
MW11	09/29/94	13.55	10.16	3.39	NLPH	<50	<50	---	---	<0.5	<0.5	<0.5	<0.5
MW11	10/25/94	13.55	10.48	3.07	NLPH	<50	<50	---	---	<0.5	<0.5	<0.5	<0.5
MW11	11/30/94	13.55	8.55	5.00	---	---	---	---	---	<0.5	<0.5	<0.5	<0.5
MW11	12/27/94	13.55	7.98	5.57	NLPH	---	---	---	---	---	---	---	---
MW11	02/06/95	13.55	6.49	7.06	NLPH	160	<50	---	---	<0.5	<0.5	<0.5	<0.5
MW11	06/07/95	13.55	7.98	5.57	NLPH	50	<50	42	---	<0.5	<0.5	<0.5	<0.5
MW11	09/18/95	13.55	10.12	3.43	NLPH	56	<50	32	---	<0.5	<0.5	<0.5	<0.5
MW11	11/01/95	13.55	10.75	2.80	NLPH	170	<50	35	---	<0.5	<0.5	<0.5	<0.5
MW11	02/14/96	13.55	8.03	5.52	NLPH	76	<50	37	---	<0.5	<0.5	<0.5	<0.5
MW11	06/19/96	13.55	7.85	5.70	NLPH	92	<50	33	---	<0.5	<0.5	<0.5	<0.5
MW11	09/24/96	13.55	10.45	3.10	NLPH	58	<50	40	---	<0.5	<0.5	<0.5	<0.5
MW11	12/11/96	13.55	9.02	4.53	NLPH	110	<50	10	---	<0.5	<0.5	<0.5	<0.5
MW11	03/19/97	13.55	9.16	4.39	NLPH	100	<50	6.9	---	<0.5	<0.5	<0.5	<0.5

TABLE 1A
CUMULATIVE GROUNDWATER MONITORING AND SAMPLING DATA
Former Exxon Service Station 7-3006
720 High Street
Oakland, California
(Page 10 of 14)

Well ID	Sampling Date	TOC (feet)	DTW (feet)	GW Elev. (feet)	SUBJ	TPHd (µg/L)	TPHg (µg/L)	MTBE 8021B (µg/L)	MTBE 8260B (µg/L)	B (µg/L)	T (µg/L)	E (µg/L)	X (µg/L)
MW11	06/04/97	13.55	9.91	3.64	NLPH	<50	<50	5.6	---	<0.5	<0.5	<0.5	<0.5
MW11	09/02/97	13.55	10.25	3.30	NLPH	150	<50	4.5	---	<0.5	<0.5	<0.5	<0.5
MW11	12/02/97	13.55	9.33	4.22	NLPH	70	<50	5.8	---	<0.5	<0.5	<0.5	<0.5
MW11	03/24/98	13.55	6.77	6.78	NLPH	<50	<50	4.1	---	<0.5	<0.5	<0.5	<0.5
MW11	06/23/98	13.55	8.99	4.56	NLPH	70	<50	<2.5	---	<0.5	<0.5	<0.5	<0.5
MW11	09/29/98	13.55	9.89	3.66	NLPH	76	<50	7.7	---	<0.5	<0.5	<0.5	<0.5
MW11	12/30/98	13.55	9.17	4.38	NLPH	71	<50	3.5	---	<0.5	<0.5	<0.5	<0.5
MW11	03/24/99	13.55	5.79	7.76	NLPH	58.2	<50	4.51	---	<0.5	1.20	<0.5	<0.5
MW11	06/22/99	13.55	---	---	---	---	---	---	---	<0.5	1.20	<0.5	<0.5
MW11	09/29/99	13.55	9.14	4.41	NLPH	---	---	---	---	---	---	---	---
MW11	12/21/99	13.55	9.01	4.54	NLPH	---	---	---	---	---	---	---	---
MW11	03/21/00	13.55	5.68	7.87	NLPH	---	---	---	---	---	---	---	---
MW11	12/21/00	Well destroyed.											
MW12	01/20/94	12.61	7.81	4.80	NLPH	---	---	---	---	---	---	---	---
MW12	02/02/94	12.61	7.22	5.39	NLPH	---	---	---	---	---	---	---	---
MW12	03/10/94	12.61	6.16	6.45	NLPH	18,000	48,000	---	---	4,000	2,700	2,900	9,900
MW12	04/22/94	12.61	6.31	6.30	NLPH	---	---	---	---	---	---	---	---
MW12	05/10/94	12.61	6.16	6.45	NLPH	---	---	---	---	---	---	---	---
MW12	05/11/94	12.61	---	---	---	8,200	46,000	---	---	---	---	---	---
MW12	06/27/94	12.61	6.55	6.06	NLPH	---	---	---	---	30,003	1,600	2,900	9,100
MW12	08/31/94	12.61	7.97	4.64	NLPH	---	---	---	---	---	---	---	---
MW12	09/29/94	12.61	8.52	4.09	Sheen	---	---	---	---	---	---	---	---
MW12	10/25/94	12.61	8.74	3.87	Sheen	---	---	---	---	---	---	---	---
MW12	11/30/94	12.61	8.73	3.88	---	---	---	---	---	---	---	---	---
MW12	12/30/94	12.61	6.17	6.44	NLPH	---	---	---	---	---	---	---	---
MW12	02/06/95	12.61	4.44	8.17	Sheen	---	---	---	---	---	---	---	---
MW12	06/07/95	12.61	6.59	6.02	Sheen	---	---	---	---	---	---	---	---
MW12	09/18/95	12.61	8.96	3.65	Sheen	---	---	---	---	---	---	---	---
MW12	11/01/95	12.61	10.75	1.86	Sheen	---	---	---	---	---	---	---	---
MW12	02/14/96	12.61	7.73	4.88	Sheen	---	---	---	---	---	---	---	---
MW12	06/19/96	12.61	5.80	6.81	Sheen	---	---	---	---	---	---	---	---
MW12	09/24/96	12.61	9.14	3.47	Sheen	---	---	---	---	---	---	---	---
MW12	12/11/96	12.61	7.31	5.30	Sheen	---	---	---	---	---	---	---	---
MW12	03/19/97	12.61	9.96	2.65	Sheen	---	---	---	---	---	---	---	---
MW12	06/04/97	12.61	8.81	3.80	Sheen	---	---	---	---	---	---	---	---
MW12	09/02/97	12.61	8.93	3.68	Sheen	---	---	---	---	---	---	---	---
MW12	12/02/97	12.61	8.41	4.20	NLPH	3,900	45,000	<250	---	1,800	560	3,100	8,700
MW12	03/24/98	12.61	5.37	7.24	NLPH	8,800	42,000	<250	---	820	280	2,800	6,800
MW12	06/23/98	12.61	8.43	4.18	Sheen	7,800	39,000	560	---	1,000	200	2,300	4,900
MW12	09/29/98	12.61	8.94	3.67	Sheen	21,000	40,000	<500	---	1,100	150	2,200	3,100
MW12	12/30/98	12.61	8.47	4.14	Sheen	49,000	79,000	<500	---	1,400	400	3,300	8,500
MW12	03/24/99	12.61	3.71	8.90	Sheen	5,070	40,600	<20	---	328	182	1,690	3,930

TABLE 1A
CUMULATIVE GROUNDWATER MONITORING AND SAMPLING DATA
Former Exxon Service Station 7-3006
720 High Street
Oakland, California
(Page 12 of 14)

Well ID	Sampling Date	TOC (feet)	DTW (feet)	GW Elev. (feet)	SUBJ	TPHd (µg/L)	TPHg (µg/L)	MTBE 8021B (µg/L)	MTBE 8260B (µg/L)	B (µg/L)	T (µg/L)	E (µg/L)	X (µg/L)
MW14	02/02/94 h	15.18	---	---	---	---	---	---	---	---	---	---	---
MW14	03/10/94	15.18	7.84	7.34	NLPH	---	---	---	---	---	---	---	---
MW14	04/22/94	15.18	8.00	7.18	NLPH	---	---	---	---	---	---	---	---
MW14	05/10/94	15.18	7.93	7.25	NLPH	---	---	---	---	---	---	---	---
MW14	05/11/94	15.18	---	---	---	11,002	300	---	---	2.7	7.9	2	27
MW14	06/27/94	15.18	8.19	6.99	NLPH	---	---	---	---	---	---	---	---
MW14	08/31/94	15.18	9.44	5.74	NLPH	---	---	---	---	---	---	---	---
MW14	09/29/94	15.18	9.82	5.36	NLPH	---	300	1,600	---	<0.5	<0.5	0.9	1.3
MW14	10/25/94	15.18	9.99	5.19	NLPH	---	200	210	---	<0.5	<0.5	0.8	<0.5
MW14	11/30/94	15.18	8.16	7.02	---	---	---	---	---	---	---	---	---
MW14	12/27/94	15.18	8.15	7.03	Sheen	---	---	---	---	---	---	---	---
MW14	02/06/95	15.18	7.18	8.00	NLPH	1,200	360	---	---	<1.0	<1.0	<1.0	<1.0
MW14	06/07/95	15.18	7.70	7.48	NLPH	1,100	670	<2.5	---	<0.5	<0.5	3.6	<0.5
MW14	09/18/95	15.18	9.88	5.30	NLPH	1,900	1,300	<10	---	<2.0	<2.0	<2.0	3
MW14	11/01/95	15.18	10.56	4.62	NLPH	2,700	1,100	<13	---	<2.5	<2.5	3.2	3.1
MW14	02/14/96	15.18	9.08	6.10	NLPH	1,500	470	<2.5	---	<0.5	<0.5	1.3	<0.5
MW14	06/19/96	15.18	8.50	6.68	NLPH	2,000	610	<12	---	<2.5	<2.5	<2.5	<2.5
MW14	09/24/96	15.18	10.23	4.95	NLPH	5,100	1,000	<25	---	<5.0	<5.0	<5.0	<5.0
MW14	12/11/96	15.18	9.09	6.09	NLPH	2,100 i	1,100	<10	---	<2.0	<2.0	<2.0	3.3
MW14	03/19/97	15.18	7.99	7.19	NLPH	1,400	690	<2.5	---	0.65	1.7	2.5	8.3
MW14	06/04/97	15.18	9.30	5.88	NLPH	1,500	730	<2.5	---	<1.2	<1.2	3.5	5.3
MW14	09/02/97	15.18	9.92	5.26	NLPH	1,900	910	<5.0	---	<5.0	<5.0	<5.0	5.9
MW14	12/02/97	15.18	9.13	6.05	NLPH	1,200	570	<2.5	---	0.85	<0.5	<0.5	1.7
MW14	03/24/98	15.18	8.52	6.66	NLPH	1,300	650	5.7	---	1.7	<1.0	<1.0	2.3
MW14	06/23/98	15.18	8.69	6.49	NLPH	1,100	470	<2.5	---	<0.5	1.5	1.1	3.0
MW14	09/29/98	15.18	9.41	5.77	NLPH	930	570	<2.5	---	<0.50	<0.50	2.5	3.5
MW14	12/30/98	15.18	9.31	5.87	NLPH	2,000	420	<2.5	---	<0.5	<0.5	<0.5	2.8
MW14	03/24/99	15.18	4.23	10.95	NLPH	936	456	<2.0	---	<0.5	<0.5	0.685	<0.5
MW14	06/22/99	15.18	7.24	7.94	NLPH	1,720	403	<2.0	---	<0.5	<0.5	<0.5	<0.5
MW14	09/29/99	15.18	9.41	5.77	NLPH	927f	388	<2.5	---	1.31	<0.5	0.864	2.07
MW14	12/21/99	15.18	8.93	6.25	NLPH	1,400	420	<2	---	0.61	<0.5	<0.5	6.3
MW14	03/21/00	15.18	5.76	9.42	NLPH	---	390	<2	---	1.4	<0.5	0.82	4.5
MW14	03/30/01	15.18	4.21	10.97	NLPH	980	330	---	<5	<0.5	<0.5	1.3	3.03
MW14	11/01/01	15.14	Well surveyed in compliance with AB 2886 requirements.										
MW14	03/11/02 k	15.14	4.87	10.27	NLPH	954	146	1.40	0.6	<0.50	<0.50	0.90	5.70
MW14	03/11/03	15.14	6.99	8.15	NLPH	1,020	331	<0.5	---	<0.50	<0.5	<0.5	<0.5
MW14	03/26/04	15.14	7.82	7.32	NLPH	586g	235	---	<0.50	1.20	0.8	0.6	1.4
MW14	11/02/04	15.14	7.06	8.08	NLPH	1,110g	282	---	<0.50	0.90	<0.5	1.6	7.2
MW14	02/04/05	15.14	6.15	8.99	NLPH	2,880g	327	---	<0.50	0.60	<0.5	0.8	1.8
MW14	05/02/05	15.14	4.97	10.17	NLPH	2,590g	363	---	<0.50	1.20	0.5	1.4	2.5
MW14	08/01/05	15.14	5.31	9.83	NLPH	2,690g	280	---	<0.50	0.90	<0.5	0.9	1.8
MW14	10/25/05	15.14	5.16	9.98	NLPH	5,410g	342	---	<0.500	0.82	<0.50	<0.50	1.98
MW14	01/24/06	15.14	5.40	9.74	NLPH	440g	290	---	<0.50	1.4	<0.50	1.9	<0.50

TABLE 1A
CUMULATIVE GROUNDWATER MONITORING AND SAMPLING DATA
Former Exxon Service Station 7-3006
720 High Street
Oakland, California
(Page 13 of 14)

Well ID	Sampling Date	TOC (feet)	DTW (feet)	GW Elev. (feet)	SUBJ	TPHd (µg/L)	TPHg (µg/L)	MTBE 8021B (µg/L)	MTBE 8260B (µg/L)	B (µg/L)	T (µg/L)	E (µg/L)	X (µg/L)
MW14	04/28/06	15.14	4.06	11.08	NLPH	190g	370	---	<0.50n	1.9n	<0.50	4.2	<0.50
MW14	08/04/06	15.14	4.77	10.37	NLPH	1,290	347	---	<0.500	1.14	<0.50	<0.50	0.61
MW14	10/06/06	15.14	6.97	8.17	NLPH	160g,j	290	---	<0.50	1.3	1.4	3.7	3.0
MW15	01/20/94	13.73	7.48	6.25	NLPH	---	---	---	---	---	---	---	---
MW15	02/02/94	13.73	7.30	6.43	NLPH	---	---	---	---	---	---	---	---
MW15	02/03/94	13.73	---	---	---	---	---	---	---	---	---	---	---
MW15	03/10/94	13.73	7.32	6.41	NLPH	1,200	4,300	---	---	24	6.7	170	26
MW15	04/22/94	13.73	6.67	7.06	NLPH	---	---	---	---	---	---	---	---
MW15	05/10/94	13.73	5.81	7.92	NLPH	---	---	---	---	---	---	---	---
MW15	05/11/94	13.73	---	---	---	1,400	3,900	---	---	---	---	---	---
MW15	06/27/94	13.73	6.14	7.59	NLPH	---	---	---	---	16	<0.5	150	13
MW15	08/31/94	13.73	7.20	6.53	NLPH	---	---	---	---	---	---	---	---
MW15	09/29/94	13.73	7.76	5.97	NLPH	420	2,500	---	---	---	---	---	---
MW15	10/25/94	13.73	8.19	5.54	Sheen	---	---	---	---	51	15	48	3.6
MW15	11/30/94	13.73	8.57	5.16	---	---	---	---	---	---	---	---	---
MW15	12/27/94	13.73	6.49	7.24	NLPH	---	---	---	---	---	---	---	---
MW15	02/06/95	13.73	4.97	8.76	Sheen	---	---	---	---	---	---	---	---
MW15	06/07/95	13.73	7.14	6.59	Sheen	---	---	---	---	---	---	---	---
MW15	09/18/95	13.73	9.00	4.73	Sheen	---	---	---	---	---	---	---	---
MW15	11/01/95	13.73	10.67	3.06	Sheen	---	---	---	---	---	---	---	---
MW15	02/14/96	13.73	7.27	6.46	Sheen	---	---	---	---	---	---	---	---
MW15	06/19/96	13.73	6.65	7.08	Sheen	---	---	---	---	---	---	---	---
MW15	09/24/96	13.73	9.45	4.28	Sheen	---	---	---	---	---	---	---	---
MW15	12/11/96	13.73	7.77	5.96	Sheen	---	---	---	---	---	---	---	---
MW15	03/19/97	13.73	8.15	5.58	Sheen	---	---	---	---	---	---	---	---
MW15	06/04/97	13.73	8.62	5.11	Sheen	---	---	---	---	---	---	---	---
MW15	09/02/97	13.73	9.04	4.69	NLPH	480	1,100	23	---	19	<2.0	11	4.9
MW15	12/02/97	13.73	8.43	5.30	NLPH	600	1,700	58	---	20	<5.0	11	<5.0
MW15	03/24/98	13.73	6.35	7.38	NLPH	450	2,100	<100	---	570	<20	<20	<20
MW15	06/23/98	13.73	7.79	5.94	NLPH	570	2,300	<25	---	440	<5.0	30	<5.0
MW15	09/29/98 h	13.73	---	---	---	---	---	---	---	---	---	---	---
MW15	12/30/98	13.73	8.42	5.31	NLPH	510	900	14	---	6.2	1.5	5.8	3.4
MW15	03/24/99	13.73	4.69	9.04	NLPH	346	1,480	12.7	---	181	1.15	29.8	<1.0
MW15	06/22/99	13.73	5.42	8.31	NLPH	558	864	6.49	---	12.7	<0.5	3.28	1.38
MW15	09/29/99	13.73	7.08	6.65	NLPH	306 f	316	<5.0	---	1.44	7.51	1.60	3.21
MW15	12/21/99	13.73	7.51	6.22	NLPH	300	1,500	21	---	21	1.6	0.67	5.9
MW15	03/21/00	13.73	3.61	10.12	NLPH	220	680	<2	---	10	<0.5	<0.5	4.5
MW15	12/21/00	Well destroyed.											

TABLE 1A
CUMULATIVE GROUNDWATER MONITORING AND SAMPLING DATA
Former Exxon Service Station 7-3006
720 High Street
Oakland, California
(Page 14 of 14)

Notes:	
SUBJ	= Results of subjective evaluation, liquid-phase hydrocarbon thickness in feet.
NLPH	= No liquid-phase hydrocarbons present in well.
TOC	= Top of well casing elevation; datum is mean sea level.
DTW	= Depth to water.
GW Elev.	= Groundwater elevation; datum is mean sea level. If liquid-phase hydrocarbons present, elevation adjusted using TOC - [DTW - (PT x 0.8)].
[]	= Amount recovered in cups.
TPHd	= Total petroleum hydrocarbons as diesel analyzed using EPA Method 3510/8015 (modified).
TPHg	= Total petroleum hydrocarbons as gasoline analyzed using EPA Method 5030/8015 (modified).
MTBE 8021B	= Methyl tertiary butyl ether analyzed using EPA Method 8021B.
MTBE 8260B	= Methyl tertiary butyl ether analyzed using EPA Method 8260B.
BTEX	= Benzene, toluene, ethylbenzene, and total xylenes analyzed using EPA Method 8021B.
TOG	= Total oil and grease analyzed using Standard Method 5520.
EHCss	= Extractable hydrocarbons as Stoddard Solvent analyzed using EPA Method 8015.
EDB	= 1,2-dibromoethane analyzed using EPA Method 8260B.
1,2-DCA	= 1,2-dichloroethane analyzed using EPA Method 8260B.
TAME	= Tertiary amyl methyl ether analyzed using EPA Method 8260B.
TBA	= Tertiary butyl alcohol analyzed using EPA Method 8260B.
ETBE	= Ethyl tertiary butyl ether analyzed using EPA Method 8260B.
DIPE	= Di-isopropyl ether analyzed using EPA Method 8260B.
Ethanol	= Ethanol analyzed using EPA Method 8260B.
µg/L	= Micrograms per liter.
--	= Not measured/Not sampled/Not analyzed.
<	= Less than the indicated reporting limit shown by the laboratory.
a	= A peak eluting earlier than benzene, suspected to be MTBE, was present.
b	= Sample containers broken in transit.
c	= Chromatogram pattern: unidentified hydrocarbons C6 - C12.
d	= Chromatogram pattern: weathered gasoline C6 - C12.
e	= Chromatogram pattern: weathered diesel C9 - C24 and unidentified hydrocarbons C9 - C36.
f	= Chromatogram pattern: unidentified hydrocarbons C9 - C24.
g	= Diesel result is not consistent with diesel fuel.
h	= Well inaccessible.
i	= TPHd note: Analyst notes samples resemble paint thinner more than Stoddard Solvent.
j	= Analyte detected in trip blank, method blank, and/or bailer blank; result is suspect.
k	= Higher reported TPH concentrations in groundwater may be due to different laboratory quantitation procedures.
l	= Elevated result due to single analyte peak in quantitation range.
m	= Surrogate recovery above control limits; this may result in a high bias.
n	= Laboratory QA/QC issue(s); ERI considers the result to be usable. Please refer to laboratory report for details.

TABLE 1B
ADDITIONAL CUMULATIVE GROUNDWATER MONITORING AND SAMPLING DATA
Former Exxon Service Station 7-3006
720 High Street
Oakland, California
(Page 1 of 4)

Well ID	Sampling Date	ETBE (µg/L)	TAME (µg/L)	TBA (µg/L)	EDB (µg/L)	1,2-DCA (µg/L)	DIPE (µg/L)	Ethanol (µg/L)	EHCss (µg/L)	TOG (µg/L)
MW1	01/20/94 - 06/19/96:	Not analyzed for these analytes.								
MW1	06/19/96	---	---	---	---	---	---	---	---	---
MW1	06/19/96 - 03/11/03:	Not analyzed for these analytes.								
MW1	03/26/04	<0.50	<0.50	<10.0	<0.50	1.60	<0.50	---	<50	---
MW1	11/02/04	<0.50	<0.50	<10.0	<0.50	1.80	<0.50	---	---	---
MW1	02/04/05	<0.50	<0.50	<10.0	<0.50	1.90	<0.50	---	---	---
MW1	05/02/05	<0.50	<0.50	<10.0	<0.50	2.10	<0.50	<100	---	---
MW1	08/01/05	<0.50	<0.50	<10.0	<0.50	2.00	<0.50	<100	---	---
MW1	10/25/05	<0.500	<0.500	22.6	<0.500	1.61	<0.500	---	---	---
MW1	01/24/06	<2.5	<2.5	<100	<2.5	<2.5	<2.5	---	---	---
MW1	04/28/06	<0.50	<0.50	5.0n	<0.50	1.6	<0.50	<500	---	---
MW1	08/04/06	<0.500	<0.500	<10.0	<0.500	1.63	<0.500	---	---	---
MW1	10/06/06	<0.50	<0.50	<5.0	<0.50	2.3	<0.50	---	---	---
MW2	01/20/94 - 03/27/04:	Not analyzed for these analytes.								
MW2	03/27/04	<0.50	2.90	<10.0	<0.50	<0.50	<0.50	---	---	---
MW2	11/02/04	<0.50	<0.50	<10.0	<0.50	<0.50	<0.50	---	---	---
MW2	02/04/05	<0.50	<0.50	<10.0	<0.50	<0.50	<0.50	---	---	---
MW2	05/02/05	<0.50	<0.50	<10.0	<0.50	<0.50	<0.50	---	---	---
MW2	08/01/05	<0.50	<0.50	<10.0	<0.50	<0.50	<0.50	<100	---	---
MW2	10/25/05	<0.500	<0.500	<10.0	<0.500	2.00	<0.50	<100	---	---
MW2	01/24/06	<0.50	<0.50	20	<0.50	<0.500	<0.500	---	---	---
MW2	04/28/06	<0.50	<0.50	<5.0n	<0.50	<0.50	<0.50	<100	---	---
MW2	08/04/06	<0.500	<0.500	<10.0	<0.500	1.34	<0.500	<100	---	---
MW2	10/06/06	<0.50	<0.50	<5.0	<0.50	<0.50	<0.50	<100	---	---
MW3	01/20/94 - 03/26/04:	Not analyzed for these analytes.								
MW3	03/26/04	<0.50	2.60	<10.0	<0.50	<0.50	0.60	---	---	---
MW3	11/02/04	<0.50	<0.50	<10.0	<0.50	<0.50	1.60	---	---	---
MW3	02/04/05	<0.50	<0.50	<10.0	<0.50	<0.50	<0.50	---	---	---
MW3	05/02/05	<0.50	<0.50	<10.0	<0.50	<0.50	<0.50	---	---	---
MW3	08/01/05	<0.50	<0.50	<10.0	<0.50	<0.50	<0.50	<100	---	---
MW3	10/25/05	<0.500	<0.500	<10.0	<0.500	<0.500	<0.500	<100	---	---
MW3	01/24/06	<1.0	<1.0	<40	<1.0	<1.0	<1.0	---	---	---
MW3	04/28/06	<0.50	<0.50	7.8n	<0.50	<0.50	<0.50	<200	---	---
MW3	08/04/06	<0.500	<0.500	<10.0	<0.500	1.45	<0.500	---	---	---
MW3	10/06/06	<0.50	<0.50	<5.0	<0.50	<0.50	<0.50	---	---	---
MW4	01/20/94 - 03/26/04:	Not analyzed for these analytes.								
MW4	03/30/01 - Present:	Well covered by asphalt.								

TABLE 1B
ADDITIONAL CUMULATIVE GROUNDWATER MONITORING AND SAMPLING DATA
Former Exxon Service Station 7-3006
720 High Street
Oakland, California
(Page 2 of 4)

Well ID	Sampling Date	ETBE (µg/L)	TAME (µg/L)	TBA (µg/L)	EDB (µg/L)	1,2-DCA (µg/L)	DIPE (µg/L)	Ethanol (µg/L)	EHCss (µg/L)	TOG (µg/L)
MW5	07/18/89	Well destroyed.								
MW6	01/20/94 - 03/26/04: Not analyzed for these analytes.									
MW6	03/26/04	<0.50	<0.50	11.7	<0.50	34.0	<0.50	---	---	---
MW6	11/02/04	<0.50	<0.50	<10.0	<0.50	<0.50	<0.50	---	---	---
MW6	02/04/05	<0.50	<0.50	54.3	<0.50	<0.50	<0.50	---	---	---
MW6	05/02/05	<0.50	<0.50	<10.0	<0.50	<0.50	<0.50	<100	---	---
MW6	08/01/05	<0.50	<0.50	29.2	<0.50	15.3	<0.50	<100	---	---
MW6	10/25/05	<0.500	<0.500	20.6	<0.500	<0.500	<0.500	---	---	---
MW6	01/24/06	<5.0	<5.0	<200	<5.0	<5.0	<5.0	<1,000	---	---
MW6	04/28/06	<0.50	12	41n	<0.50	<0.50	<0.50	<100	---	---
MW6	08/04/06	<0.500	<0.500	<10.0	0.940	8.28	<0.500	<50.0	---	---
MW6	10/06/06	<0.50	<0.50	14	<0.50	<0.50	<0.50	<100	---	---
MW7	01/20/94	---	---	---	---	---	---	---	---	---
MW7	02/03/94	---	---	---	---	---	---	---	---	---
MW7	03/10/94	---	---	---	---	---	---	---	---	470
MW7	04/22/94	---	---	---	---	---	---	---	---	---
MW7	05/10-11/94	---	---	---	---	---	---	---	---	---
MW7	11/94 - 02/06/95: Not analyzed for these analytes.									
MW7	02/06/95	---	---	---	---	---	---	---	---	1,400
MW7	06/07/95	---	---	---	---	---	---	---	1,100	---
MW7	09/18/95	---	---	---	---	---	---	---	1,000	---
MW7	11/01/95	---	---	---	---	---	---	---	---	870
MW7	02/14/96	---	---	---	---	---	---	---	1,400	---
MW7	06/19/96	---	---	---	---	---	---	---	940	---
MW7	09/24/96	---	---	---	---	---	---	---	1,000	---
MW7	12/11/96	---	---	---	---	---	---	---	910	---
MW7	03/19/97	---	---	---	---	---	---	---	1,100	---
MW7	06/04/97	---	---	---	---	---	---	---	580	---
MW7	09/02/97	---	---	---	---	---	---	---	780	---
MW7	12/21/00	Well destroyed.								
MW8	01/20/94 - 03/21/00 Not analyzed for these analytes.									
MW8	12/21/00	Well destroyed.								
MW9	01/20/94 - 06/19/96: Not analyzed for these analytes.									
MW9	06/19/96	---	---	---	---	---	---	---	<50	---
MW9	06/19/96 - 12/21/00: Not analyzed for these analytes.									
MW9	12/21/00	Well destroyed.								

TABLE 1B
ADDITIONAL CUMULATIVE GROUNDWATER MONITORING AND SAMPLING DATA
Former Exxon Service Station 7-3006
720 High Street
Oakland, California
(Page 3 of 4)

Well ID	Sampling Date	ETBE (µg/L)	TAME (µg/L)	TBA (µg/L)	EDB (µg/L)	1,2-DCA (µg/L)	DIPE (µg/L)	Ethanol (µg/L)	EHCss (µg/L)	TOG (µg/L)
MW10	01/20/94 - 06/19/96:	Not analyzed for these analytes.								
MW10	06/19/96	---	---	---	---	---	---	---	---	---
MW10	06/19/96 - 12/21/00:	Not analyzed for these analytes.								
MW10	12/21/00	Well destroyed.								
MW11	01/20/94 - 06/19/96:	Not analyzed for these analytes.								
MW11	06/19/96	---	---	---	---	---	---	---	---	---
MW11	06/19/96 - 12/21/00:	Not analyzed for these analytes.								
MW11	12/21/00	Well destroyed.								
MW12	01/20/94 - 11/02/04:	Not analyzed for these analytes.								
MW12	03/30/01 - Present:	Well covered by asphalt.								
MW13	01/20/94 - 12/21/00:	Not analyzed for these analytes.								
MW13	12/21/00	Well destroyed.								
MW14	01/20/94 - 02/06/95:	Not analyzed for these analytes.								
MW14	02/06/95	---	---	---	---	---	---	---	---	---
MW14	06/07/95	---	---	---	---	---	---	---	---	400
MW14	09/18/95	---	---	---	---	---	---	---	450	---
MW14	11/01/95	---	---	---	---	---	---	---	1,200	---
MW14	02/14/96	---	---	---	---	---	---	---	1,600	---
MW14	06/19/96	---	---	---	---	---	---	---	680	---
MW14	09/24/96	---	---	---	---	---	---	---	670	---
MW14	12/11/96	---	---	---	---	---	---	---	4,500	---
MW14	03/19/97	---	---	---	---	---	---	---	750	---
MW14	06/04/97	---	---	---	---	---	---	---	470	---
MW14	09/02/97	---	---	---	---	---	---	---	590	---
MW14	09/02/97 - 03/26/04:	Not analyzed for these analytes.								
MW14	03/26/04	<0.50	<0.50	<10.0	<0.50	<0.50	<0.50	---	---	---
MW14	11/02/04	<0.50	<0.50	<10.0	<0.50	<0.50	<0.50	---	---	---
MW14	02/04/05	<0.50	<0.50	<10.0	<0.50	<0.50	<0.50	---	---	---
MW14	05/02/05	<0.50	<0.50	<10.0	<0.50	<0.50	<0.50	<100	---	---
MW14	08/01/05	<0.50	<0.50	<10.0	<0.50	1.90	<0.50	<100	---	---
MW14	10/25/05	<0.500	<0.500	<10.0	<0.500	<0.500	<0.500	---	---	---
MW14	01/24/06	<0.50	<0.50	<20	<0.50	<0.50	<0.50	<100	---	---
MW14	04/28/06	<0.50	<0.50	<20n	<0.50	<0.50	<0.50	<100	---	---
MW14	08/04/06	<0.500	<0.500	<10.0	<0.500	<0.50	<0.50	<100	---	---
MW14	10/06/06	<0.50	<0.50	<5.0	<0.50	<0.50	<0.50	<100	---	---

TABLE 1B
ADDITIONAL CUMULATIVE GROUNDWATER MONITORING AND SAMPLING DATA
Former Exxon Service Station 7-3006
720 High Street
Oakland, California
(Page 4 of 4)

Well ID	Sampling Date	ETBE (µg/L)	TAME (µg/L)	TBA (µg/L)	EDB (µg/L)	1,2-DCA (µg/L)	DIPE (µg/L)	Ethanol (µg/L)	EHCss (µg/L)	TOG (µg/L)
MW15	01/20/94 - 12/21/00:	Not analyzed for these analytes.								
MW15	12/21/00	Well destroyed.								

Notes:		
SUBJ	=	Results of subjective evaluation, liquid-phase hydrocarbon thickness in feet.
NLPH	=	No liquid-phase hydrocarbons present in well.
TOC	=	Top of well casing elevation; datum is mean sea level.
DTW	=	Depth to water.
GW Elev.	=	Groundwater elevation; datum is mean sea level. If liquid-phase hydrocarbons present, elevation adjusted using TOC - [DTW - (PT x 0.8)].
[]	=	Amount recovered in cups.
TPHd	=	Total petroleum hydrocarbons as diesel analyzed using EPA Method 3510/8015 (modified).
TPHg	=	Total petroleum hydrocarbons as gasoline analyzed using EPA Method 5030/8015 (modified).
MTBE 8021B	=	Methyl tertiary butyl ether analyzed using EPA Method 8021B.
MTBE 8260B	=	Methyl tertiary butyl ether analyzed using EPA Method 8260B.
BTEX	=	Benzene, toluene, ethylbenzene, and total xylenes analyzed using EPA Method 8021B.
TOG	=	Total oil and grease analyzed using Standard Method 5520.
EHCss	=	Extractable hydrocarbons as Stoddard Solvent analyzed using EPA Method 8015.
EDB	=	1,2-dibromoethane analyzed using EPA Method 8260B.
1,2-DCA	=	1,2-dichloroethane analyzed using EPA Method 8260B.
TAME	=	Tertiary amyl methyl ether analyzed using EPA Method 8260B.
TBA	=	Tertiary butyl alcohol analyzed using EPA Method 8260B.
ETBE	=	Ethyl tertiary butyl ether analyzed using EPA Method 8260B.
DIPE	=	Di-isopropyl ether analyzed using EPA Method 8260B.
Ethanol	=	Ethanol analyzed using EPA Method 8260B.
µg/L	=	Micrograms per liter.
---	=	Not measured/Not sampled/Not analyzed.
<	=	Less than the indicated reporting limit shown by the laboratory.
a	=	A peak eluting earlier than benzene, suspected to be MTBE, was present.
b	=	Sample containers broken in transit.
c	=	Chromatogram pattern: unidentified hydrocarbons C6 - C12.
d	=	Chromatogram pattern: weathered gasoline C6 - C12.
e	=	Chromatogram pattern: weathered diesel C9 - C24 and unidentified hydrocarbons C9 - C36.
f	=	Chromatogram pattern: unidentified hydrocarbons C9 - C24.
g	=	Diesel result is not consistent with diesel fuel.
h	=	Well inaccessible.
i	=	TPHd note: Analyst notes samples resemble paint thinner more than Stoddard Solvent.
j	=	Analyte detected in trip blank, method blank, and/or bailer blank; result is suspect.
k	=	Higher reported TPH concentrations in groundwater may be due to different laboratory quantitation procedures.
l	=	Elevated result due to single analyte peak in quantitation range.
m	=	Surrogate recovery above control limits; this may result in a high bias.
n	=	Laboratory QA/QC issue(s); ERI considers the result to be usable. Please refer to laboratory report for details.

TABLE 2
WELL CONSTRUCTION DETAILS
Former Exxon Service Station 7-3006
720 High Street
Oakland, California
(Page 1 of 2)

Well ID	Date Well Installed	TOC Elevation (feet)	Borehole Diameter (inches)	Total Depth of Boring (fbgs)	Well Depth (fbgs)	Well Casing Diameter (inches)	Well Casing Material	Screened Interval (fbgs)	Slot Size (inches)	Filter Pack Interval (fbgs)	Filter Pack Material
MW1	05/21/88	12.79	NS	29.0	29.0	4	NS	4.0-29.0	NS	2-29	NS
MW2	09/10/87	13.06	NS	36.0	35.0	4	NS	10.0-35.0	NS	8-36	NS
MW3	09/10/87	13.71	NS	36.0	35.0	4	NS	10.0-35.0	NS	8-36	NS
MW4	09/10/87	12.77	NS	36.0	35.0	4	NS	10.0-35.0	NS	8-36	NS
MW5	Well destroyed on 07/18/89.										
MW6	09/10/87	14.23	NS	36.0	35.0	4	NS	10.0-35.0	NS	8-36	NS
MW7	Well destroyed on 12/21/00.										
MW8	Well destroyed on 12/21/00.										
MW9	Well destroyed on 12/21/00.										
MW10	Well destroyed on 12/21/00.										
MW11	Well destroyed on 12/21/00.										
MW12	11/27/89	12.61	10	15.5	15.5	4	PVC	5.0-15.0	0.010	4-15.5	NS
MW13	Well destroyed on 12/21/00.										
MW14	10/31/90	15.14	10	18.5	17.0	4	PVC	7.0-17.0	0.010	5.5-17	NS
MW15	Well destroyed on 12/21/00.										
VW1	Well destroyed.										
VW2	Well destroyed.										
VW3	Well destroyed.										

TABLE 2
WELL CONSTRUCTION DETAILS
Former Exxon Service Station 7-3006
720 High Street
Oakland, California
(Page 2 of 2)

Well ID	Date Well Installed	TOC Elevation (feet)	Borehole Diameter (inches)	Total Depth of Boring (fbgs)	Well Depth (fbgs)	Well Casing Diameter (inches)	Well Casing Material	Screened Interval (fbgs)	Slot Size (inches)	Filter Pack Interval (fbgs)	Filter Pack Material
AS1	Information not available.										
AS2	Information not available.										
AS3	Information not available.										
AS4	Information not available.										
AS5	Information not available.										
AS6	Information not available.										
RW1	April 1994	NS	NS	16.88	NS	6	NS	---	NS	NS	NS
RW2	April 1994	NS	NS	16.82	NS	6	NS	---	NS	NS	NS
RW3	April 1994	NS	NS	16.72	NS	6	NS	---	NS	NS	NS
RW4	April 1994	NS	NS	17.18	NS	6	NS	---	NS	NS	NS
RW5	Well destroyed.										
RW6	Well destroyed.										
RW7	Well destroyed.										

Notes:

- TOC = Top of well casing elevation; datum is mean sea level.
- fbgs = Feet below ground surface.
- NS = Not specified.
- PVC = Polyvinyl chloride.

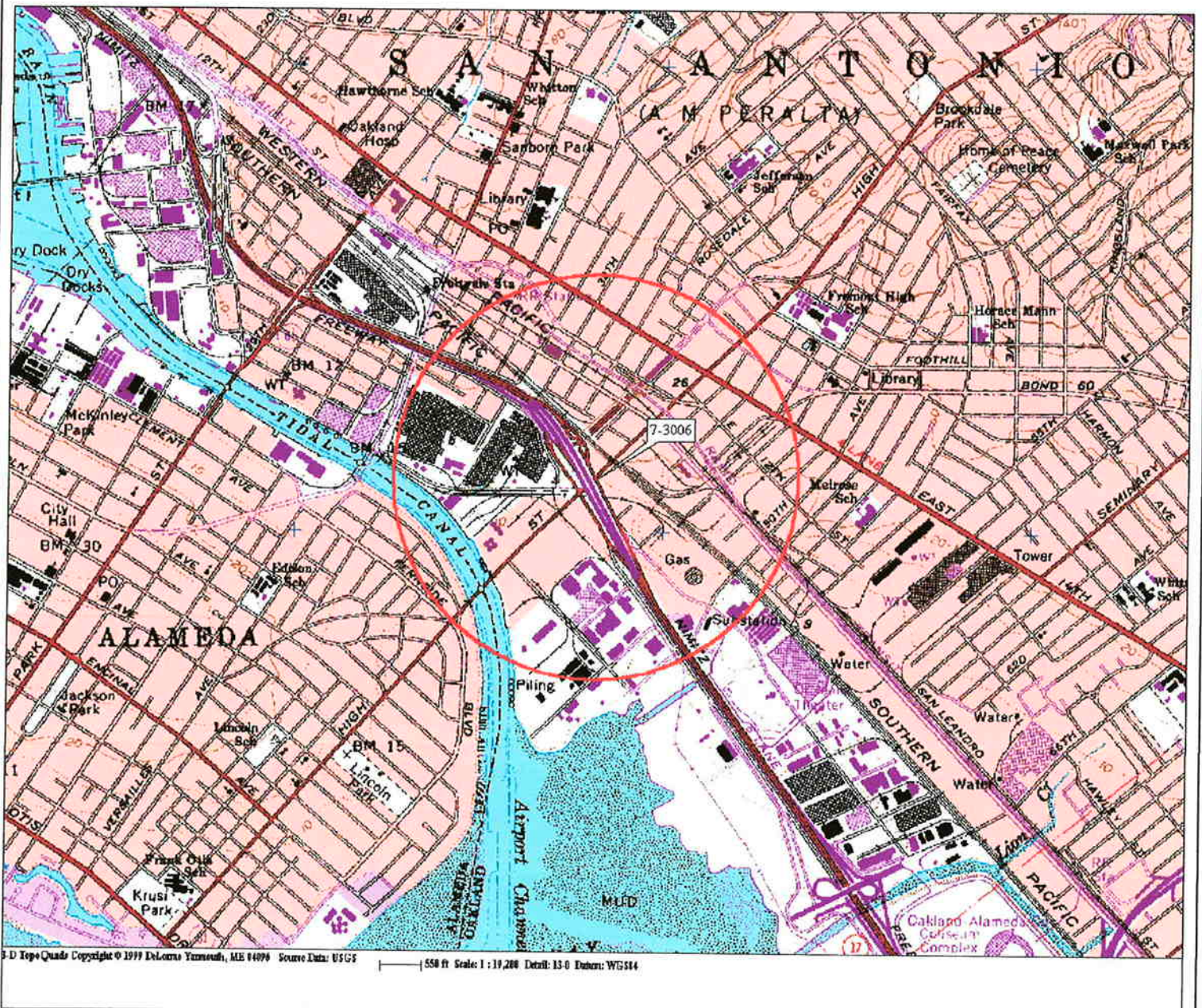

FN 2010

EXPLANATION

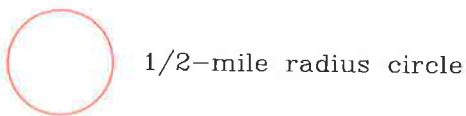

APPROXIMATE SCALE

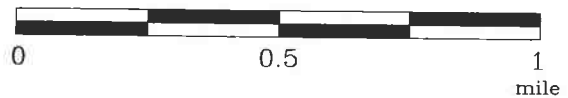

SOURCE:
 Modified from a map
 provided by
 DeLorme 3-D TopoQuads

SITE VICINITY MAP

FORMER EXXON SERVICE STATION 7-3006
 720 High Street
 Oakland, California

PROJECT NO.

2010

PLATE

1



Analyte Concentrations in ug/L
 Sampled October 6, 2006

1,900 Total Petroleum Hydrocarbons
 as gasoline
 140 Benzene
 <0.50 Methyl Tertiary Butyl Ether
 (EPA Method 8260B)

< Less Than the Stated Laboratory
 Reporting Limit

ug/L Micrograms per Liter

h Well inaccessible.

l Elevated result due to single analyte
 peak in quantitation range.

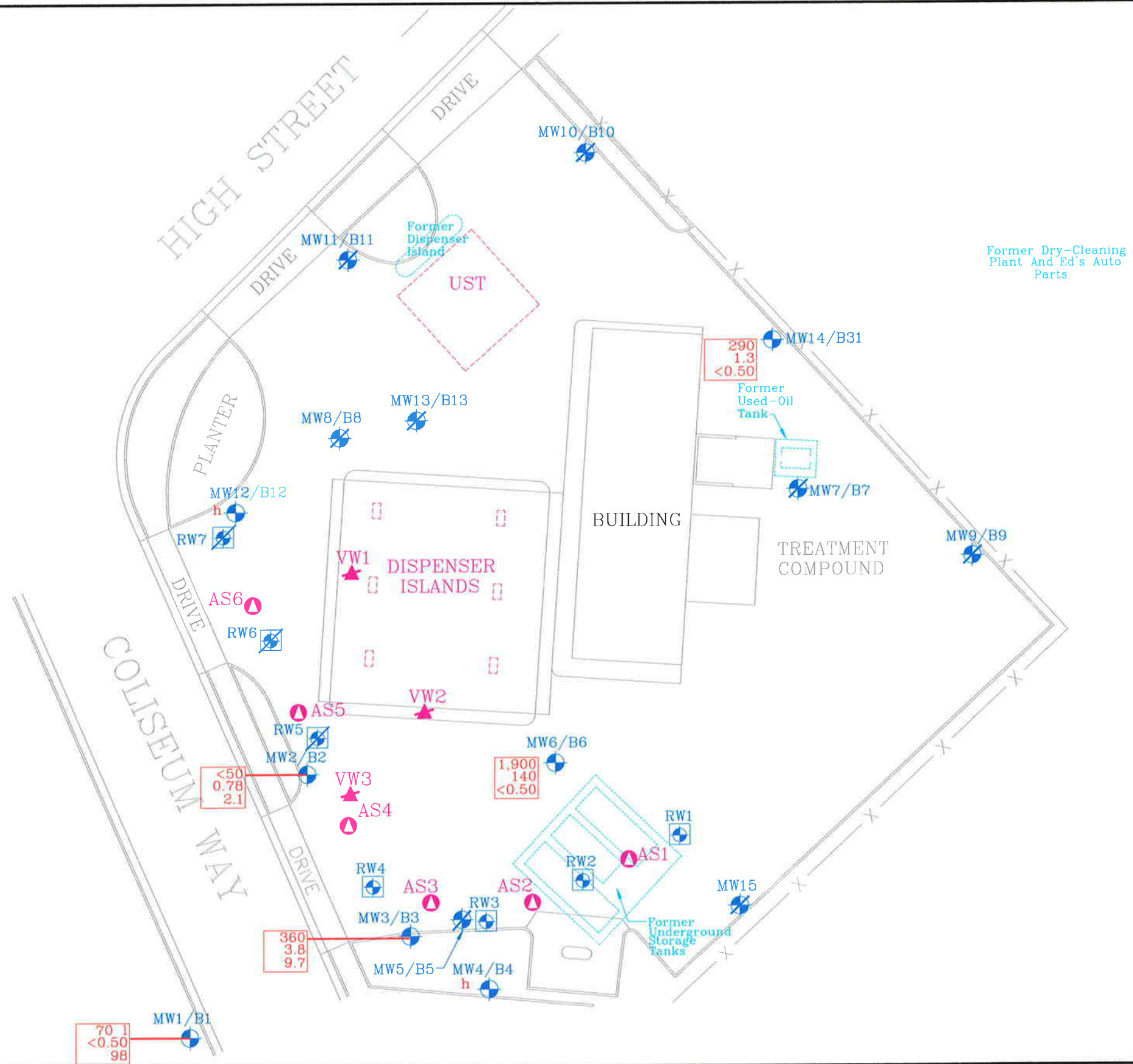

APPROXIMATE SCALE

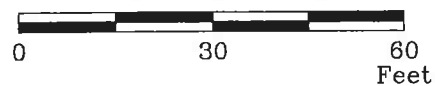

FN 20100004_QM

SOURCE:
 Modified from a map
 provided by
 Morrow Surveying



SELECT ANALYTICAL RESULTS
October 6, 2006
 FORMER
 EXXON SERVICE STATION 7-3006
 720 High Street
 Oakland, California

EXPLANATION

- MW14
 Groundwater Monitoring Well
- RW4
 Recovery Well
- AS6
 Air Sparge Well

- VW3
 Destroyed Soil Vapor
 Extraction Well
- RW7
 Destroyed Recovery Well
- MW15
 Destroyed Groundwater
 Monitoring Well

PROJECT NO.
 2010

PLATE
 2

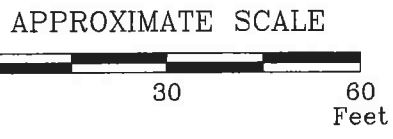
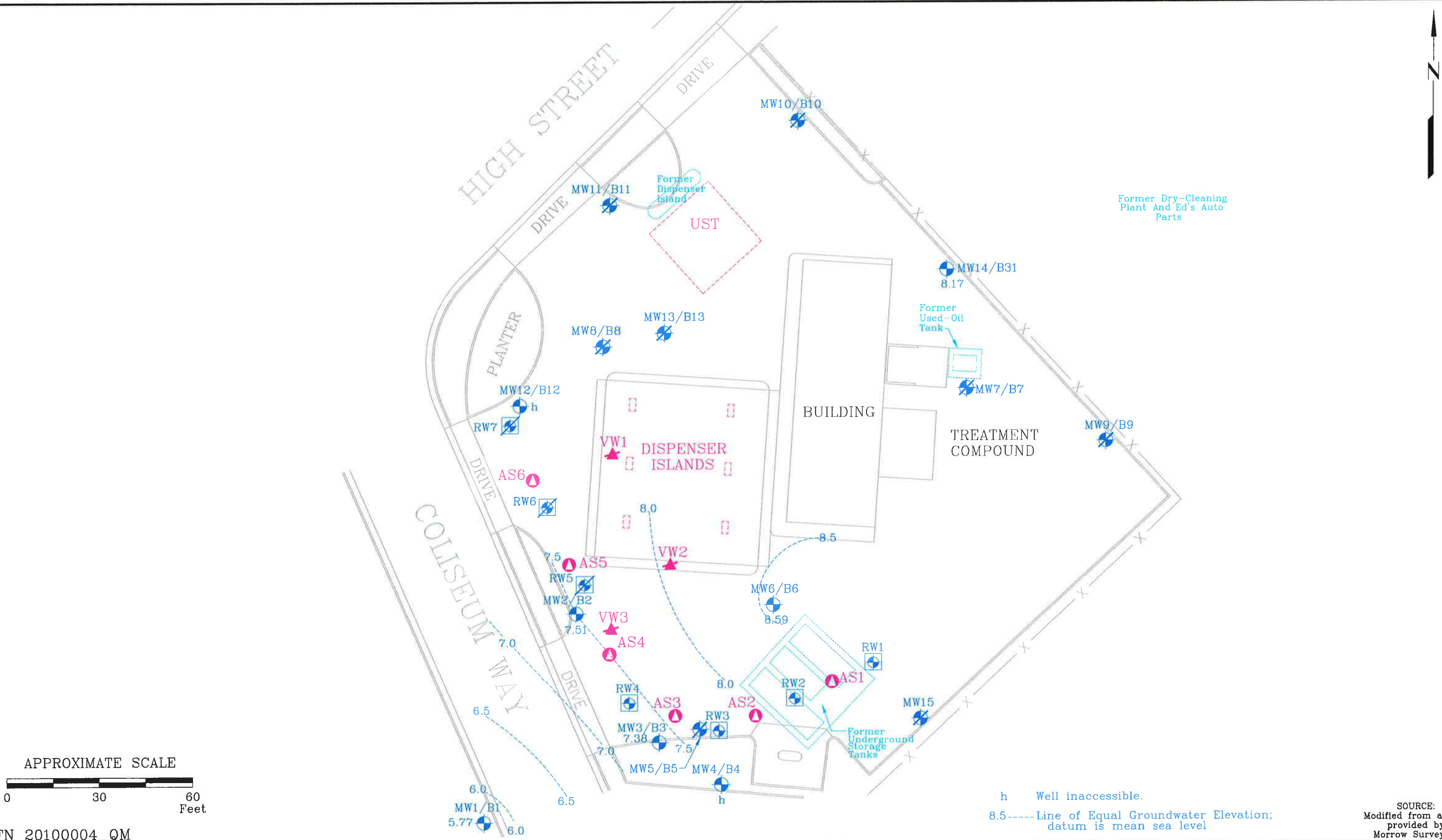

FN 20100004_QM

h Well inaccessible.
 8.5-----Line of Equal Groundwater Elevation;
 datum is mean sea level

SOURCE:
 Modified from a map
 provided by
 Morrow Surveying



GROUNDWATER ELEVATION MAP
 October 6, 2006
 FORMER
 EXXON SERVICE STATION 7-3006
 720 High Street
 Oakland, California

EXPLANATION
 MW14
 Groundwater Monitoring Well
 8.17 Groundwater elevation in feet;
 datum is mean sea level
 RW4
 Recovery Well
 AS6
 Air Sparge Well

VW3
 Destroyed Soil Vapor
 Extraction Well
 RW7
 Destroyed Recovery Well
 MW15
 Destroyed Groundwater
 Monitoring Well

PROJECT NO.
 2010
PLATE
 3

ATTACHMENT A
GROUNDWATER SAMPLING PROTOCOL

GROUNDWATER SAMPLING PROTOCOL

The static water level and separate-phase product level, if present, in each well that contained water and/or separate-phase product are measured with an ORS Interface Probe, which is accurate to the nearest 0.01 foot. To calculate groundwater elevations and evaluate groundwater gradient, depth to water (DTW) levels are subtracted from top of casing elevations.

Groundwater samples collected for subjective evaluation are collected by gently lowering approximately half the length of a clean Teflon® or polypropylene bailer past the air-water interface (if possible) and collecting a sample from near the surface of the water in the well. The samples are checked for measurable free-phase hydrocarbons or sheen. If appropriate, free-phase hydrocarbons are removed from the well.

Before water samples are collected from the groundwater monitoring wells, the wells are purged until a minimum of three well casing volumes is purged and stabilization of the temperature, pH, and conductivity is obtained. Water samples from the wells that do not obtain stability of the temperature, pH, and conductivity are considered to be "grab samples." The quantity of water purged from each well is calculated as follows:

1 well casing volume = $\pi r^2 h (7.48)$ where:

r	=	radius of the well casing in feet.
h	=	column of water in the well in feet (depth to bottom - depth to water)
7.48	=	conversion constant from cubic feet to gallons
π	=	ratio of the circumference of a circle to its diameter

Gallons of water purged/gallons in 1 well casing volume = well casing volumes removed.

After purging, each well is allowed to recharge to at least 80% of the initial water level. Water samples from wells that do not recover at least 80% (due to slow recharging of the well) between purging and sampling are considered to be "grab samples." Water samples are collected with a new, disposable Teflon® or polypropylene bailer. The groundwater is carefully poured into selected sample containers (40-milliliter [ml] glass vials, 1,000-ml glass amber bottles, etc.), which are filled so as to produce a positive meniscus.

Depending on the required analysis, each sample container is preserved with hydrochloric acid, nitric acid, etc., or it is preservative free. The type of preservative used for each sample is specified on the Chain-of-Custody form.

Each vial and glass amber bottle is sealed with a cap containing a Teflon® septum, and subsequently examined for air bubbles to avoid headspace, which would allow volatilization to occur. The samples are promptly transported in iced storage in a thermally-insulated ice chest, accompanied by a Chain-of-Custody record, to a California state-certified laboratory.

ATTACHMENT B
**HISTORICAL CUMULATIVE GROUNDWATER
MONITORING AND SAMPLING DATA**

TABLE 1
 CUMULATIVE GROUNDWATER MONITORING AND SAMPLING DATA
 Former Exxon Service Station 7-3006
 720 High Street, Oakland, California
 (Page 1 of 31)

Well ID # (TOC)	Sampling Date	SUBJ < >	DTW feet	Elev. < >	TPHg < >	B	T	E	X	TEPHd	VOCs	TOG < >
								parts per billion				
MW1 (12.87)	05/88	NM	NM	---	240	90	5	15	25	NA	ND	NA
	04/25/89	NLPH	7.55	5.32#								
	04/27/89	Sheen	10.16	2.71#								
	09/06/89	Sheen	10.88	1.99#								
	09/22/89	NLPH	11.06	1.81#								
	11/01/89	NLPH	10.82	2.05#								
	11/15/89	NLPH	11.07	1.80#								
	12/06/89	NLPH	10.33	2.54	630	12	5.6	3.7	25	240	NA	NA
	02/20/90	NLPH	8.81	4.06#								
	04/19/90	NLPH	9.33	3.54	<20	<0.5	<0.5	<0.5	<0.5	<100	NA	NA
	07/03/90	NLPH	8.44	4.43	130	6	<0.5	<0.5	<0.5	160	NA	NA
	07/26/90	NLPH	8.99	3.88#								
	08/20/90	NLPH	9.50	3.37#								
	09/19/90	NLPH	9.99	2.88#								
	11/27/90	NLPH	10.62	2.25	<50	0.7	<0.5	<0.5	<0.5	<100	NA	NA
	01/17/91	NLPH	10.31	2.56#								
	03/26/91	NLPH	7.79	5.08	<50	<0.5	<0.5	<0.5	<0.5	<100	NA	NA
	05/02/91	NLPH	8.88	3.99#								
	06/20/91	NLPH	9.62	3.25	<50	<0.5	<0.5	<0.5	<0.5	<100	NA	NA
	08/07/91	NLPH	10.20	2.67#								
	09/17/91	NLPH	10.40	2.47	<50	<0.5	<0.5	<0.5	<0.5	NA	NA	NA
	11/13/91	NLPH	10.20	2.67#								
	12/10/91	NLPH	10.23	2.64	<50	<0.5	<0.5	<0.5	<0.5	<50	NA	NA
	01/21/92	NLPH	9.32	3.55#								
	03/25/92	NLPH	9.30	3.57	<50	1.5	<0.5	<0.5	<0.5	<50	NA	NA

See Notes on page 31 of 31

TABLE 1
 CUMULATIVE GROUNDWATER MONITORING AND SAMPLING DATA
 Former Exxon Service Station 7-3006
 720 High Street, Oakland, California
 (Page 2 of 31)

Well ID # (TOC)	Sampling Date	SUBJ < >	DTW feet	Elev. > <	TPHg < >	B	T	E	X	TEPHd	VOCs	TOG
									parts per billion			
MWI cont. (12.87)	06/22/92	NLPH	8.46	4.41	110	4.9	7.9	3.7	21	75	NA	NA
	09/24/92	NLPH	9.61	3.26	<50	<0.5	0.6	<0.5	<0.5	<50	NA	NA
	10/14/92	NLPH	9.85	3.02#								
	11/16/92	NLPH	9.65	3.22#								
	12/08/92	NLPH	9.30	3.57	170	10	<0.5	<0.5	0.6	51	NA	NA
	01/27/93	NLPH	6.13	6.74#								
	02/18/93	NLPH	6.07	6.80#								
	03/10/93	NLPH	6.12	6.75	<50	<0.5	<0.5	<0.5	<0.5	140	NA	NA
	04/06/93	NLPH	5.84	7.03#								
	05/28/93	NLPH	7.27	5.60#								
	06/10/93	NLPH	7.40	5.47	<50	<0.5	<0.5	<0.5	<0.5	<50	NA	NA
	07/17/93	NLPH	8.08	4.79#								
	08/11/93	NLPH	8.54	4.33	<50	<0.5	<0.5	<0.5	<0.5	NA	ND	NA
	09/01/93	NLPH	8.80	4.07#	NA	<5*	<5*	<5*	<5*	<50*	ND	NA
	10/26/93	NLPH	9.41	3.46	<50	<0.5	<0.5	<0.5	<0.5	<50	NA	NA
	11/12/93	NLPH	9.48	3.39#								
	12/27/93	NLPH	8.62	4.25#								
	01/20/94	NLPH	9.25	3.62#								
	02/02-03/94	NLPH	8.60	4.27	<50	<0.5	<0.5	<0.5	0.7	70	NA	NA
	03/10/94	NLPH	8.31	4.56#								
04/22/94	NLPH	7.95	4.92#									
05/10-11/94	NLPH	7.48	5.39	<50	<0.5	<0.5	<0.5	1.6	100	NA	NA	
06/27/94	NLPH	7.65	5.22#									
08/31/94	NLPH	9.39	3.48#									
09/29/94	NLPH	9.83	3.04	<50	<0.5	<0.5	<0.5	<0.5	<50	NA	NA	

See Notes on page 31 of 31

TABLE 1
 CUMULATIVE GROUNDWATER MONITORING AND SAMPLING DATA
 Former Exxon Service Station 7-3006
 720 High Street, Oakland, California
 (Page 3 of 31)

Well ID # (TOC)	Sampling Date	SUBJ < >	DTW feet	Elev. > <	TPHg < >	B	T	E	X	TEPHd parts per billion	VOCs	TOG >
MW1 cont. (12.87)	10/25/94	NLPH	10.19	2.68	<50	<0.5	<0.5	<0.5	<0.5	<50	NA	NA
	11/30/94	NLPH	8.97	3.90#								
	12/27/94	NLPH	7.44	5.43#								
	02/06/95	NLPH	5.71	7.16	<50	0.52	<0.5	<0.5	<0.5	100	NA	NA
MW2 (12.98)	09/87	NM	NM	—	1,445	233	810	56	209	NA	NA	NA
	05/88	LPH	NM	—								
	04/25/89	2.16[NR]	9.27	5.44#								
	07/19/89	1.56[NR]	10.81	3.42#								
	07/27/89	0.13[NR]	10.18	2.90#								
	09/06/89	0.09[NR]	10.89	2.16#								
	09/22/89	0.56[NR]	11.56	1.87#								
	11/01/89	0.09[NR]	10.85	2.20#								
	11/15/89	0.07[NR]	11.05	1.99#								
	12/06/89	0.13[NR]	10.23	2.85#								
	02/20/90	0.29 [NR]	8.86	4.35#								
	04/19/90	0.10 [NR]	9.09	3.97#								
	07/03/90	0.05 [NR]	8.75	4.27#								
	07/26/90	0.10 [NR]	8.71	4.35#								
	08/20/90	0.02 [NR]	9.25	3.75#								
	09/19/90	0.02 [NR]	9.79	3.21#								
	11/27/90	0.07 [NR]	10.40	2.64#								
	01/17/91	0.05 [NR]	10.03	2.99#								
	03/26/91	0.08 [NR]	8.98	4.06#								
	05/02/91	0.02 [NR]	8.73	4.27#								
06/20/91	0.02 [NR]	9.11	3.89#									
08/07/91	0.04 [NR]	10.00	3.01#									

See Notes on page 31 of 31

TABLE 1
 CUMULATIVE GROUNDWATER MONITORING AND SAMPLING DATA
 Former Exxon Service Station 7-3006
 720 High Street, Oakland, California
 (Page 4 of 31)

Well ID # (TOC)	Sampling Date	SUBJ < >	DTW feet	Elev.	TPHg < >	B	T	E	X	TEPHd	VOCs	TOG >
								parts per billion				
MW2 cont. (12.98)	09/17/91	0.02 [NR]	10.11	2.89#								
	11/13/91	0.02 [NR]	9.88	3.12#								
	12/10/91	0.03 [NR]	9.02	3.98#								
	01/21/92	0.03 [NR]	9.08	3.92#								
	03/25/92	0.03 [NR]	6.00	7.00#								
	06/22/92	0.01 [½ c.]	8.46	4.53#								
	09/24/92	Sheen [NR]	9.08	3.90#								
	10/14/92	0.02 [½ c.]	9.34	3.66#								
	11/16/92	0.02 [½ c.]	9.16	3.84#								
	12/08/92	0.02 [½ c.]	8.93	4.07#								
	01/27/93	Sheen	5.76	7.22#								
	02/18/93	0.01 [NR]	4.21	8.78#								
	03/10/93	Sheen	6.75	6.23#								
	04/06/93	Sheen	5.37	7.61#								
	05/28/93	NM [2 c.]	NM	---								
	06/10/93	NM [½ c.]	NM	---								
	07/17/93	NM [2 c.]	NM	---								
	08/11/93	NM [½ c.]	NM	---								
	09/01/93	NM [½ c.]	NM	---								
	10/26/93	Sheen	NM	---								
	11/12/93	NM [NR]	NM	---								
	12/27/93	NM [NR]	NM	---								
	01/20/94	NM [NR]	NM	---								
	02/02-03/94	NM [NR]	NM	---								
	03/10/94	[8 c.]	6.96	6.29#								
	04/22/94	[10 c.]	NM	---								
	05/10-11/94	[5 c.]	NM	---								
	06/27/94	Sheen	7.10	5.88#								

See Notes on page 31 of 31

**TABLE 1
CUMULATIVE GROUNDWATER MONITORING AND SAMPLING DATA**

Former Exxon Service Station 7-3006
720 High Street, Oakland, California
(Page 5 of 31)

Well ID # (TOC)	Sampling Date	SUBJ < >	DTW feet	Elev. > <	TPHg < >	B	T	E	X	TEPHd	VOCs	TOG >
								parts per billion				
MW2 cont. (12.98)	08/31/94	Sheen	8.58	4.40#								
	09/29/94	Sheen	9.11	3.87#								
	10/25/94	Sheen	7.76	5.22#								
	11/30/94	NM	7.33	5.65#								
	12/27/94	Sheen	6.77	6.21#								
	02/06/95	Sheen	5.00	7.98								
MW3 (12.92)	09/87	NM [NR]	NM	--	2,101	360	1,062	68	298	660	NA	NA
	05/88	NM [NR]	NM	--	8,700	3,980	280	240	600	NA	NA	NA
	04/25/89	0.08 [NR]	7.57	5.43#								
	07/19/89	0.66 [NR]	10.33	3.14#								
	07/27/89	Not Accessible										
	09/06/89	0.07 [NR]	11.22	1.78#								
	09/22/89	0.28 [NR]	11.38	1.78#								
	11/01/89	0.01 [NR]	10.90	2.05#								
	11/15/89	0.11 [NR]	11.18	1.85#								
	12/06/89	Sheen	10.29	2.65#								
	02/20/90	0.04 [NR]	8.73	4.24#								
	04/19/90	0.09 [NR]	9.20	3.81#								
	07/03/90	0.03 [NR]	8.50	4.46#								
	07/26/90	0.04 [NR]	8.58	4.39#								
	08/20/90	0.01 [NR]	9.21	3.74#								
	09/19/90	0.35 [NR]	10.02	3.20#								
	11/27/90	0.42 [NR]	10.72	2.56#								
	01/17/91	0.10 [NR]	10.05	2.97#								
	03/26/91	0.10 [NR]	7.65	5.37#								
	05/02/91	0.03 [NR]	8.54	4.42#								

See Notes on page 31 of 31

TABLE 1
 CUMULATIVE GROUNDWATER MONITORING AND SAMPLING DATA
 Former Exxon Service Station 7-3006
 720 High Street, Oakland, California
 (Page 6 of 31)

Well ID # (TOC)	Sampling Date	SUBJ < >	DTW feet	Elev. > <	TPHg < >	B	T	E	X	TEPHd parts per billion	VOCs	TOG >	
MW3 cont. (12.92)	06/20/91	0.03 [NR]	8.89	4.07#									
	08/07/91	0.03 [NR]	9.99	2.97#									
	09/17/91	0.22 [NR]	10.32	2.80#									
	11/13/91	0.24 [NR]	10.14	2.99#									
	12/10/91	0.11 [NR]	10.10	2.93#									
	01/21/92	0.06 [NR]	9.07	3.92#									
	03/25/92	0.04 [NR]	5.96	7.01#									
	06/22/92	0.02 [½ c.]	8.07	4.89#									
	09/24/92	Sheen	9.29	3.65#									
	10/14/92	0.02 [½ c.]	9.49	3.47#									
	11/16/92	0.02 [½ c.]	9.29	3.67#									
	12/08/92	0.02 [½ c.]	9.08	3.88#									
	01/27/93	Sheen	5.65	7.29#									
	02/18/93	Sheen	4.63	8.31#									
	03/10/93	Sheen	5.53	7.41#									
	04/06/93	Sheen	5.10	7.84#									
	05/28/93	Sheen	6.50	6.44#									
	06/10/93	Sheen	6.65	6.29#									
	07/17/93	Sheen	7.03	5.91#									
	08/11/93	Sheen	7.56	5.38		5,100	1,300 2,000*	12 <2.5*	87 160*	47 60*	3,200 140 ^d	ND	NA
	09/01/93	0.01 [NR]	8.20	4.75#									
	10/26/93	Sheen	8.88	4.06#									
	11/12/93	Sheen	8.96	3.98#									
	12/27/93	Sheen	9.03	3.91#									
	01/20/94	Sheen	8.24	4.70#									
	02/02-03/94	Sheen	7.68	5.26#									
	03/10/94	Sheen	7.24	5.68#									

See Notes on page 31 of 31

TABLE 1
 CUMULATIVE GROUNDWATER MONITORING AND SAMPLING DATA
 Former Exxon Service Station 7-3006
 720 High Street, Oakland, California
 (Page 7 of 31)

Well ID # (TOC)	Sampling Date	SUBJ < >	DTW feet >	Elev. >	TPHg < >	B	T	E	X	TEPHd	VOCs	TOG >
								parts per billion				
MW3 cont (12.92)	04/22/94	Sheen	6.79	6.13#								
	05/10-11/94	Sheen	6.43	6.49#								
	06/27/94	0.01 [NR]	6.97	5.95#								
	08/31/94	Sheen	8.41	4.51#								
	09/29/94	Sheen	8.97	3.95#								
	10/25/94	Sheen	9.43	3.49#								
	11/28/94	NM	7.19	5.73#								
	12/27/94	Sheen	6.64	6.28#								
	02/06/95	Sheen	4.87	8.05								
MW4 (12.77)	09/87	NM [NR]	NM	---	92,500	70	7	10	16	740	NA	NA
	05/88	LPH	NM	---								
	04/23/89	0.16 [NR]	7.26	5.64#								
	07/19/89	0.72 [NR]	10.32	3.03#								
	07/27/89	Not Accessible										
	09/06/89	0.07 [NR]	11.40	1.43#								
	09/22/89	0.19 [NR]	11.64	1.28#								
	11/01/89	Sheen	11.00	1.77#								
	11/15/89	0.10 [NR]	11.18	1.67#								
	12/06/89	Sheen	10.25	2.52#								
	02/20/90	NLPH	8.40	4.37#								
	04/19/90	0.03 [NR]	9.04	3.75#								
	07/03/90	Sheen	8.00	4.77#								
	07/26/90	0.04 [NR]	8.57	4.23#								
	08/20/90	0.01 [NR]	9.08	3.70#								
09/19/90	0.03 [NR]	9.76	3.03#									
11/27/90	0.09 [NR]	10.83	2.01#									

See Notes on page 31 of 31

TABLE 1
 CUMULATIVE GROUNDWATER MONITORING AND SAMPLING DATA
 Former Exxon Service Station 7-3006
 720 High Street, Oakland, California
 (Page 8 of 31)

Well ID # (TOC)	Sampling Date	SUBJ < >	DTW feet	Elev. < >	TPHg < >	B	T	E	X	TEPHd	VOCs	TOG >
					parts per billion							
MW4 cont.	01/17/91	0.20 [NR]	9.96	2.97#								
(12.77)	03/26/91	0.09 [NR]	6.20	6.64#								
	05/02/91	0.04 [NR]	7.50	5.30#								
	06/20/91	0.04 [NR]	7.79	5.01#								
	08/07/91	0.05 [NR]	9.81	3.00#								
	09/17/91	0.10[NR]	10.02	2.83#								
	11/13/91	0.12[NR]	9.90	2.97#								
	12/10/91	0.10[NR]	9.92	2.93#								
	01/21/92	0.08[NR]	9.50	3.33#								
	03/25/92	0.03[NR]	5.01	7.78#								
	06/22/92	0.02 [½ c.]	7.34	5.45#								
	09/24/92	Sheen	9.03	3.74#								
	10/14/92	0.02 [½ c.]	9.27	3.52#								
	11/16/92	0.02 [½ c.]	9.09	3.70#								
	12/08/92	0.02 [½ c.]	10.24	2.55#								
	01/27/93	0.04 [NR]	4.95	7.85#								
	02/18/93	0.01 [NR]	4.89	7.89#								
	03/10/93	Sheen	6.40	6.37#								
	04/06/93	Sheen	4.36	8.41#								
	05/28/93	NM [2 c.]	NM	---								
	06/10/93	NM [2 c.]	NM	---								
	07/17/93	NM [2/5 gal.]	NM	---								
	08/11/93	NM [¼ gal.]	NM	---								
	09/01/93	NM [¼ gal.]	NM	---								
	10/26/93	NM [NR]	NM	---								
	11/12/93	NM [NR]	NM	---								
	12/27/93	NM [NR]	NM	---								
	01/20/94	NM [NR]	NM	---								

See Notes on page 31 of 31

TABLE 1
 CUMULATIVE GROUNDWATER MONITORING AND SAMPLING DATA
 Former Exxon Service Station 7-3006
 720 High Street, Oakland, California
 (Page 9 of 31)

Well ID # (TOC)	Sampling Date	SUBJ < >	DTW feet	Elev. > <	TPHg < >	B	T	E	X	TEPHd	VOCs	TOG
								parts per billion				
MW4 cont. (12.77)	02/02-03/94	NM [1 c.]	NM	---								
	03/10/94	[8 c.]	7.12	5.65#								
	04/22/94	[10 c.]	NM	---								
	05/10-11/94	[5 c.]	NM	---								
	06/27/94	0.01 [NR]	6.50	6.27#								
	08/31/94	0.02 [NR]	7.84	4.93#								
	09/29/94	0.03 [NR]	8.43	4.37#								
	10/25/94	Sheen	9.24	3.53#								
	11/30/94	NM	6.77	6.00#								
	12/27/94	Sheen	6.14	6.63#								
	02/06/95	Sheen	4.87	7.90								
MW5 (8.38)	09/87	NM	NM	---	26,660	560	1,710	1,580	7,150	37,220	NA	NA
	05/88	LPH	NM	---								
	04/25/89	NLPH	8.06	0.32#								
	07/18/89	Well Destroyed										
MW6 (14.27)	05/88	NM	NM	---	29,300	12,820	550	1,440	5,500	NA	NA	NA
	04/25/89	NLPH	8.02	6.25#								
	09/06/89	0.08 [NR]	13.64	0.69#								
	09/22/89	0.07 [NR]	13.79	0.54#								
	11/01/89	Sheen	12.78	1.49#								
	11/15/89	Sheen	12.91	1.36#								
	12/06/89	NLPH	11.84	2.43	9,000	370	13	2.6	430	4,800	NA	NA
	02/20/90	NLPH	9.08	5.19#								
	04/19/90	NLPH	9.72	4.55	27,000	3,000	120	490	2,100	26,000	NA	NA

See Notes on page 31 of 31

TABLE 1
CUMULATIVE GROUNDWATER MONITORING AND SAMPLING DATA
Former Exxon Service Station 7-3006
720 High Street, Oakland, California
(Page 10 of 31)

Well ID # (TOC)	Sampling Date	SUBJ <	DTW feet	Elev. >	TPHg					TEPHd	VOCs	TOG		
					B	T	E	X	parts per billion					
MW6 cont. (14.27)	07/03/90	NLPH	8.00	6.27	30,000	5,500	1,400	1,200	3,100	13,000	NA	NA		
	07/26/90	NLPH	8.70	5.57#										
	08/20/90	NLPH	9.62	4.65#	15,000	4,400	120	800	2,300	7,600	NA	NA		
	09/19/90	Sheen	10.25	4.02#										
	11/27/90	Sheen	10.82	3.45	55,000	10,000	380	1,600	6,900	<100	NA	NA		
	01/17/91	NLPH	9.93	4.34#										
	03/26/91	NLPH	8.45	5.82	17,000	4,500	160	890	3,100	NA	NA	NA		
	05/02/91	NLPH	8.90	5.37#										
	06/20/91	Sheen	9.47	4.80#	32,000	6,000	290	1,400	4,700	1,200	NA	NA		
	08/07/91	Sheen	10.10	4.17#										
	09/17/91	Sheen	10.21	4.06	21,000	8,000	250	1,700	5,000	2,700	NA	NA		
	11/13/91	Sheen	9.62	4.65#										
	12/10/91	Sheen	9.59	4.68	43,000	11,000	150	2,100	5,000	1,700	NA	NA		
	01/21/92	Sheen	9.25	5.02#										
	03/25/92	NLPH	6.88	7.39	45,000	9,800	270	1,700	3,600	2,000	NA	NA		
	06/22/92	NLPH	7.38	6.89										
	09/24/92	NLPH	8.70	5.57	0.10 [1/8 c.]	4.90	9.45#	0.05 [1/4 c.]	6.07	8.24#	4.98	9.29#	NM	---
	10/14/92	Sheen	8.91	5.36#										
	11/16/92	NLPH	8.75	5.52#	130,000	9,800	650	5,100	12,000	38,000	NA	23,000		
	12/08/92	Sheen	8.51	5.76#										
	01/27/93	NLPH	5.69	8.58#	NM	---	---	---	---	---	---	---		
	02/18/93	0.10 [1/8 c.]	4.90	9.45#										
	03/10/93	0.05 [1/4 c.]	6.07	8.24#	NM	---	---	---	---	---	---	---		
04/06/93	Sheen	4.98	9.29#											
05/28/93	NM [3 c.]	NM	---	130,000	9,800	650	5,100	12,000	38,000	NA	23,000			
06/10/93	NM [3 c.]	NM	---											
07/17/93	NM [NR]	NM	---	NM	---	---	---	---	---	---	---			
08/11/93	NM [NR]	NM	---											

See Notes on page 31 of 31

TABLE 1
CUMULATIVE GROUNDWATER MONITORING AND SAMPLING DATA
Former Exxon Service Station 7-3006
720 High Street, Oakland, California
(Page 11 of 31)

Well ID # (TOC)	Sampling Date	SUBJ <	DTW feet	Elev. >	TPHg <	B	T	E	X	TEPHd	VOCs	TOG >
								parts per billion				
MW6 cont (14.27)	09/01/93	NM [½ c.]	NM	---								
	10/26/93	NM [NR]	NM	---								
	11/12/93	NM [NR]	NM	---								
	12/27/93	NM [NR]	NM	---								
	01/20/94	NM [NR]	NM	---								
	02/02-03/94	NM [NR]	NM	---								
	03/10/94	[¼ c.]	7.82	6.45#								
	04/22/94	[10 c.]	NM	---								
	05/10-11/94	[3 c.]	NM	---								
	06/27/94	Sheen	7.77	6.50#								
	08/31/94	Sheen	9.02	5.25#								
	09/29/94	Sheen	9.51	4.76#								
	10/25/94	Sheen	9.93	4.34#								
	11/30/94	NM	8.05	6.22#								
	12/27/94	NM	7.54	6.73#								
02/06/95	Sheen	5.86	8.41									
MW7 (14.84)	09/87	NM	NM	---	1,531	258	2	<2	42	2,790	ND	NA
	05/88	NM	NM	---	NA	300*	<10*	<10*	<10*	19	ND	NA
	04/25/89	NLPH	8.66	6.18#								
	09/06/89	Sheen	11.72	3.12#								
	09/22/89	NLPH	11.89	2.95#								
	12/06/89	NLPH	10.46	4.38	1,700	220	5.3	5	8.6	2,500	ND	<5,000
	02/20/90	NLPH	8.44	6.40#								
	04/19/90	NLPH	9.54	5.30	2,700	220	8.6	7	20	3,500	ND	NA
	07/03/90	NLPH	7.45	7.39	2,500	380	13	16	35	910	ND	NA
	07/26/90	NLPH	8.08	6.76#								

See Notes on page 31 of 31

TABLE 1
 CUMULATIVE GROUNDWATER MONITORING AND SAMPLING DATA
 Former Exxon Service Station 7-3006
 720 High Street, Oakland, California
 (Page 12 of 31)

Well ID # (TOC)	Sampling Date	SUBJ <	DTW feet	Elev. >	TPHg <	B	T	E	X	TEPHd	VOCs	TOG >
								parts per billion				
MW7 cont. (14.84)	08/20/90	NLPH	8.82	6.02#								
	09/19/90	NLPH	9.01	5.83#								
	11/27/90	NLPH	9.54	5.30	2,300	630	16	32	29	1,300	2.4'	NA
	01/17/91	NLPH	8.50	6.34#								
	03/26/91	NLPH	5.92	8.92	3,500	420	18	17	27	<100	ND	NA
	05/02/91	NLPH	7.72	7.12#								
	06/20/91	NLPH	8.19	6.65	3,100	270	8.8	33	19	<100	NA	NA
	08/07/91	NLPH	8.70	6.14#								
	09/17/91	NLPH	8.77	6.07	2,400	390	10	15	18	NA	NA	NA
	11/13/91	NLPH	8.51	6.33#								
	12/10/91	NLPH	8.58	6.26	1,700	290	5.3	7.1	<0.5	530	NA	NA
	01/21/92	NLPH	8.32	6.52#								
	03/25/92	NLPH	9.27	5.57	1,500	320	7.2	16	19	760	NA	NA
	06/22/92	NLPH	6.97	7.87	3,100	260	5.8	21	27	830	NA	NA
	09/24/92	NLPH	8.00	6.84	3,900	160	4.6	3.7	13	660	NA	NA
	10/14/92	NLPH	8.15	6.69#								
	11/16/92	NLPH	7.92	6.92#								
	12/08/92	NLPH	7.75	7.09	17,000	1,100	35	77	46	540	NA	NA
	01/27/93	NLPH	5.09	9.75#								
	02/18/93	NLPH	4.51	10.33#								
	03/10/93	NLPH	4.78	10.06	3,500	160	6.2	22	19	640	***	<5000
	04/06/93	NLPH	4.48	10.36#								
	05/28/93	NLPH	5.44	9.40#								
	06/10/93	NLPH	5.60	9.24	1,600	140	6.5	22	61	570	NA	NA
	07/17/93	NLPH	6.33	8.51#								
	08/11/93	NLPH	6.87	7.97	2,700	130	1.3	13	12	370	ND	NA
						140'	5'	12'	10'	2,000'		
	09/01/93	NLPH	7.12	7.72#								

See Notes on page 31 of 31

TABLE 1
CUMULATIVE GROUNDWATER MONITORING AND SAMPLING DATA
Former Exxon Service Station 7-3006
720 High Street, Oakland, California
(Page 13 of 31)

Well ID # (TOC)	Sampling Date	SUBJ < >	DTW feet	Elev. > <	TPHg < >	B	T	E	X	TEPHd	VOCs	TOG >
								parts per billion				
MW7 cont. (14.84)	10/26/93	NLPH	7.67	7.17	2,500	90	4.7	6.6	15	1,000	NA	NA
	11/12/93	NLPH	7.69	7.15#								
	12/27/93	NLPH	7.42	7.42#								
	01/20/94	NLPH	8.67	6.17#								
	02/02-03/94	NLPH	8.47	6.37	2,900	79	5.0	8.2	21	1300	NA	NA 470 ²
	03/10/94	NLPH	8.24	6.60#								
	04/22/94	NLPH	7.95	6.89#								
	05/10-11/94	NLPH	7.53	7.31#	2,400	88	5.6	5.2	15	1,300	NA	NA 1,400 ²
	06/27/94	NLPH	8.01	6.83#								
	08/31/94	NLPH	9.19	5.65#								
	09/29/94	NLPH	9.65	5.19	1,900	71	3.1	3.5	7.8	56	NA	NA
	10/25/94	NLPH	9.96	4.88	1,400	51	1.5	24	6.8	89 ²	NA	NA
	11/30/94	NM	7.78	7.06#								
	12/27/94	NM	7.51	7.33#								
	02/06/95	NLPH	5.79	9.05	2,500	130	<10	<10	<10	1,300	ND	1,100 ²
MW8 (13.45)	09/87	NM	NM	---	1,325	81	74	42	182	NA	NA	NA
	05/88	LPH	NM	---								
	04/25/89	0.66 [NR]	8.31	5.67#								
	07/19/89	1.25 [NR]	10.97	3.48#								
	07/27/89	0.08 [NR]	10.34	3.17#								
	09/06/89	0.17 [NR]	11.09	2.50#								
	09/22/89	0.36 [NR]	11.58	2.16#								
	11/01/89	NLPH	11.03	2.42#								
	11/15/89	0.01 [NR]	11.25	2.21#								

See Notes on page 31 of 31

TABLE 1
CUMULATIVE GROUNDWATER MONITORING AND SAMPLING DATA
Former Exxon Service Station 7-3006
720 High Street, Oakland, California
(Page 14 of 31)

Well ID # (TOC)	Sampling Date	SUBJ <	DTW feet	Elev. >	TPHg <	B	T	E	X	TEPHd	VOCs	TOG >
					parts per billion							
MW8 cont. (13.45)	12/06/89	Sheen	10.30	3.15	42,000	2,600	630	210	3,700	34,000	NA	NA
	02/20/90	0.01 [NR]	8.00	5.46#								
	04/19/90	NLPH	8.50	4.95	49,000	2,100	820	1,100	4,800	53,000	NA	NA
	07/03/90	NLPH	7.55	5.90	44,000	4,000	1,500	2,000	6,300	32,000	NA	NA
	07/26/90	NLPH	7.86	5.59#								
	08/20/90	NLPH	8.92	4.53#								
	09/19/90	NLPH	9.55	3.90#								
	11/27/90	0.01 [NR]	10.29	3.17#								
	01/17/91	Sheen	9.97	3.48#								
	03/26/91	Sheen	8.45	5.00#								
	05/02/91	Sheen	8.85	4.60#								
	06/20/91	Sheen	9.45	4.00#								
	08/07/91	Sheen	10.00	3.45#								
	09/17/91	Sheen	10.11	3.34	57,000	14,000	7,800	3,100	12,000	NA	NA	NA
	11/13/91	Sheen	9.63	3.82#								
	12/10/91	Sheen	9.66	3.79	66,000	9,500	5,000	3,100	12,000	1,400	NA	NA
	01/21/92	Sheen	9.35	4.10#								
	03/25/92	Sheen	8.02	5.43#								
	06/22/92	Sheen	7.01	6.44#								
	09/24/92	Sheen	8.33	5.12#								
	10/14/92	Sheen	8.65	4.80#								
	11/16/92	Sheen	8.27	5.18#								
	12/08/92	Sheen	8.25	5.20#								
	01/27/93	Sheen	5.22	8.23#								
	02/18/93	Sheen	4.27	9.18#								
	03/10/93	Sheen	5.30	8.15#								
	04/06/93	Sheen	4.56	8.89#								
	05/28/93	Sheen	5.62	7.83#								

See Notes on page 31 of 31

TABLE 1
CUMULATIVE GROUNDWATER MONITORING AND SAMPLING DATA
Former Exxon Service Station 7-3006
720 High Street, Oakland, California
(Page 15 of 31)

Well ID # (TOC)	Sampling Date	SUBJ < >	DTW feet	Elev. > <	parts per billion					TEPHd	VOCs	TOG
					TPHg	B	T	E	X			
MW8 cont. (13.45)	06/10/93	Sheen	5.75	7.70#								
	07/17/93	Sheen	6.43	7.02#								
	08/11/93	Sheen	6.99	6.46	53,000	4,200	1,300	2,600	7,200	2,600	ND	NA
						4,900*	1,600*	3,300*	8,200*	370*		
	09/01/93	Sheen	7.33	6.12#								
	10/26/93	Sheen	7.98	5.47#								
	11/12/93	Sheen	8.07	5.38#								
	12/27/93	NM	NM	---								
	01/20/94	Sheen	8.90	4.55#								
	02/02-03/94	Sheen	8.58	4.87#								
	03/10/94	NLPH	7.16	6.29#								
	04/22/94	Sheen	7.34	6.11#								
	05/10-11/94	Sheen	7.04	6.41#								
	06/27/94	Sheen	6.01	7.44#								
	08/31/94	Sheen	9.26	4.19#								
	09/29/94	Sheen	9.76	3.72#								
	10/25/94	Sheen	10.05	3.40								
11/30/94	NM	7.68	5.77#									
12/27/94	Sheen	7.11	6.34#									
02/06/95	Sheen	5.39	8.06									
MW9 (14.64)	05/88	NM	NM	---	<50	<0.5	1	<1	<1	NA	ND	NA
	04/25/89	NLPH	8.25	6.39#								
	09/06/89	Not Accessible										
	09/22/89	Not Accessible										
	12/06/89	NLPH	10.12	4.52	100	1.8	3.7	1.4	8.8	110	ND	<5000
	02/20/90	NLPH	9.38	5.26#								

See Notes on page 31 of 31

TABLE I
 CUMULATIVE GROUNDWATER MONITORING AND SAMPLING DATA
 Former Exxon Service Station 7-3006
 720 High Street, Oakland, California
 (Page 16 of 31)

Well ID # (TOC)	Sampling Date	SUBJ < >	DTW feet	Elev. > <	TPHg < >	B	T	E	X	TEPHd	VOCs	TOG >
									parts per billion			
MW9 cont. (14.64)	04/19/90	NLPH	9.40	5.25	<20	<0.5	<0.5	<0.5	<0.5	<100	ND	NA
	07/03/90	NLPH	8.79	5.85	<20	<0.5	<0.5	<0.5	<0.5	<100	ND	NA
	07/26/90	NLPH	8.70	5.94#								
	08/20/90	NLPH	9.09	5.55#								
	09/19/90	NLPH	9.52	5.12#								
	11/27/90	NLPH	9.89	4.75	<50	<0.5	<0.5	<0.5	<0.5	<100	ND	NA
	01/17/91	Not Accessible										
	03/26/91	Not Accessible										
	05/02/91	NLPH	9.10	5.54#								
	06/20/91	NLPH	8.76	5.88	<50	<0.5	<0.5	<0.5	<0.5	<100	NA	NA
	08/07/91	NLPH	9.37	5.27#								
	09/17/91	NLPH	9.57	5.07	<50	<0.5	<0.5	<0.5	<0.5	NA	NA	NA
	11/13/91	NLPH	9.46	5.18#								
	12/10/91	NLPH	9.30	5.34	<50	<0.5	<0.5	<0.5	<0.5	52	NA	NA
	01/21/92	NLPH	9.68	4.96#								
	03/25/92	NLPH	8.93	5.71	<50	<0.5	<0.5	<0.5	<0.5	<50	NA	NA
	06/22/92	NLPH	7.45	7.19	<50	<0.5	<0.5	<0.5	<0.5	<50	NA	NA
	09/24/92	NLPH	8.69	5.95	<50	<0.5	<0.5	<0.5	<0.5	<50	NA	NA
	10/14/92	NLPH	8.83	5.81#								
	11/16/92	NLPH	8.80	5.84#								
	12/08/92	NLPH	8.70	5.94	<50	<0.5	<0.5	<0.5	<0.5	<50	NA	NA
	01/27/93	NM	NM	---								
	02/18/93	NLPH	9.22	5.42#								
	03/10/93	NLPH	5.25	9.39	<50	<0.5	<0.5	<0.5	<0.5	<50	NA	NA
	04/06/93	NLPH	5.07	9.57#								
	05/28/93	NLPH	6.08	8.56#								
	06/10/93	NLPH	6.27	8.37	<50	<0.5	<0.5	<0.5	<0.5	<50	NA	NA
	07/17/93	NLPH	7.09	7.55#								

See Notes on page 31 of 31

TABLE 1
 CUMULATIVE GROUNDWATER MONITORING AND SAMPLING DATA
 Former Exxon Service Station 7-3006
 720 High Street, Oakland, California
 (Page 17 of 31)

Well ID # (TOC)	Sampling Date	SUBJ < >	DTW feet	Elev. > <	TPHg <	B	T	E	X	TEPHd parts per billion	VOCs	TOG >
MW9 cont. (14.64)	08/11/93	NLPH	7.60	7.04	<50	<0.5 <5'	<0.5 <5'	<0.5 <5'	<0.5 <5'	<50 <50 ^a	ND	NA
	09/01/93	NLPH	7.95	6.69#								
	10/26/93	NLPH	8.44	6.20	<50	<0.5	<0.5	<0.5	<0.5	<50	NA	NA
	11/12/93	NLPH	8.44	6.20#								
	12/27/93	NLPH	8.37	6.27#								
	01/20/94	NM	NM	---								
	02/02-03/94	NM	NM	---								
	03/10/94	NLPH	6.90	7.74#								
	04/22/94	NLPH	7.38	7.26#								
	05/10-11/94	NLPH	6.96	7.68#								
	06/27/94	NLPH	7.65	6.99#								
	08/31/94	NLPH	8.87	5.77#								
	09/29/94	NLPH	9.19	5.45	<50	<0.5	<0.5	<0.5	<0.5	<50	NA	NA
	10/25/94	NLPH	9.66	4.98	<50	<.05	<0.5	<0.5	<0.5	<50	NA	NA
	11/30/94	NM	8.38	6.26#								
	12/27/94	NLPH	7.29	7.35#								
02/06/95	NLPH	5.74	8.90	<50	<0.5	<0.5	<0.5	<0.5	56	NA	NA	
MW10 (14.05)	12/06/89	NLPH	10.46	3.59	320	3.7	14	5.6	32	<100	NA	NA
	02/20/90	NLPH	8.12	5.93#								
	04/19/90	NLPH	8.54	5.51	<20	<0.5	<0.5	<0.5	<0.5	<100	ND	NA
	07/03/90	NLPH	7.88	6.17	<20	<0.5	<0.5	<0.5	<0.5	<100	NA	NA
	07/26/90	NLPH	8.19	5.86#								
	08/20/90	NLPH	10.33	3.72#								
	09/19/90	NLPH	9.49	4.56#								
	11/27/90	NLPH	9.89	4.16	<50	<0.5	<0.5	<0.5	<0.5	<100	NA	NA

See Notes on page 31 of 31

TABLE 1
 CUMULATIVE GROUNDWATER MONITORING AND SAMPLING DATA
 Former Exxon Service Station 7-3006
 720 High Street, Oakland, California
 (Page 18 of 31)

Well ID # (TOC)	Sampling Date	SUBJ <	DTW feet	Elev. >	TPHg <	B	T	E	X	TEPHd	VOCs	TOG	parts per billion >		
MW10 cont. (14.05)	01/17/91	NLPH	9.19	4.86#											
	03/26/91	NLPH	7.48	6.57	<50	<0.5	<0.5	<0.5	<0.5	<100	NA	NA			
	05/02/91	NLPH	8.16	5.89#											
	06/20/91	NLPH	8.75	5.30	<50	<0.5	<0.5	<0.5	<0.5	<100	NA	NA			
	08/07/91	NLPH	9.53	4.52#											
	09/17/91	NLPH	9.72	4.33	<50	<0.5	<0.5	<0.5	<0.5	<100	NA	NA			
	11/13/91	NLPH	10.02	4.03#											
	12/10/91	NLPH	9.12	4.93	<50	<0.5	<0.5	<0.5	<0.5	<50	NA	NA			
	01/21/92	NLPH	8.31	5.74#											
	03/25/92	NLPH	5.70	8.35	<50	<0.5	<0.5	<0.5	<0.5	<50	NA	NA			
	06/22/92	NLPH	7.50	6.55	<50	<0.5	0.6	<0.5	<0.5	<50	NA	NA			
	09/24/92	NLPH	8.68	5.37	<50	<0.5	<0.5	<0.5	0.8	<50	NA	NA			
	10/14/92	NLPH	8.88	5.17#					<0.5	<50	NA	NA			
	11/16/92	NLPH	8.70	5.35#											
	12/08/92	NLPH	8.31	5.74	<50	<0.5	<0.5	<0.5	<0.5	<50	NA	NA			
	01/27/93	NLPH	5.49	8.56#					0.9	<50	NA	NA			
	02/18/93	NLPH	4.26	9.79#											
	03/10/93	NLPH	5.40	8.65	<50	<0.5	<0.5	<0.5	<0.5	<50	NA	NA			
	04/06/93	NLPH	5.28	8.77#											
	05/28/93	NLPH	6.22	7.83#											
	06/10/93	NLPH	6.49	7.56	<50	<0.5	0.6	0.7	1.2	<50	NA	NA			
	07/17/93	NLPH	6.79	7.26#											
	08/11/93	NLPH	7.20	6.85	<50	<0.5	<0.5	0.5	1.4	<50	ND	NA			
					<5'	<5'	<5'	<5'	<50 ²						
09/01/93	NLPH	8.03	6.02#												
10/26/93	NLPH	8.38	5.67	<50	<0.5	<0.5	<0.5	<0.5	<50	NA	NA				
11/12/93	NLPH	8.49	5.56#												
12/27/93	NLPH	8.22	5.83#												

See Notes on page 31 of 31

TABLE 1
 CUMULATIVE GROUNDWATER MONITORING AND SAMPLING DATA
 Former Exxon Service Station 7-3006
 720 High Street, Oakland, California
 (Page 19 of 31)

Well ID # (TOC)	Sampling Date	SUBJ < >	DTW feet	Elev. < >	TPHg < >	B	T	E	X	TEPHd	VOCs	TOG >
									parts per billion			
MW10 cont. (14.05)	01/20/94	NLPH	8.40	5.65#								
	02/02-03/94	NLPH	8.00	6.05	<50	<0.5	1.0	<0.5	1.8	<50	NA	NA
	03/10/94	NLPH	7.56	6.49#								
	04/22/94	NLPH	7.35	6.70#								
	05/10-11/94	NLPH	7.06	6.99	<50	<0.5	<0.5	<0.5	<0.5	<50	NA	NA
	06/27/94	NLPH	7.59	6.46#								
	08/31/94	NLPH	8.73	5.32#								
	09/29/94	NLPH	9.07	4.98	<50	<0.5	<0.5	<0.5	<0.5	<50	NA	NA
	10/25/94	NLPH	9.41	4.64	<50	<0.5	<0.5	<0.5	<0.5	<50	NA	NA
	11/30/94	NM	7.62	6.43#								
	12/27/94	NLPH	7.01	7.04#								
	02/06/95	NLPH	5.60	8.45	<50	<0.5	<0.5	<0.5	<0.5	<50	NA	NA
MW11 (13.55)	12/06/89	NLPH	10.62	2.93	78	5.9	6.3	<0.5	48,000	<100	NA	NA
	02/20/90	NLPH	9.20	4.35#								
	04/19/90	NLPH	9.80	3.75	<20	<0.5	<0.5	<0.5	<0.5	<100	NA	NA
	07/03/90	NLPH	8.90	4.65	<20	<0.5	<0.5	<0.5	<0.5	<100	NA	NA
	07/26/90	NLPH	9.36	4.19#								
	08/20/90	NLPH	9.90	3.65#								
	09/19/90	NLPH	10.39	3.16#								
	11/27/90	NLPH	10.97	2.58	<50	<0.5	<0.5	<0.5	<0.5	<100	NA	NA
	01/17/91	NLPH	10.76	2.79#								
	03/26/91	NLPH	8.80	4.75	<50	<0.5	<0.5	<0.5	<0.5	<100	NA	NA
	05/02/91	NLPH	9.38	4.17#								
	06/20/91	NLPH	10.16	3.39	<50	<0.5	<0.5	<0.5	<0.5	<100	NA	NA
	08/07/91	NLPH	10.69	2.86#								
	09/17/91	NLPH	10.80	2.75	<50	<0.5	0.7	<0.5	<0.5	NA	NA	NA

See Notes on page 31 of 31

TABLE 1
CUMULATIVE GROUNDWATER MONITORING AND SAMPLING DATA
Former Exxon Service Station 7-3006
720 High Street, Oakland, California
(Page 20 of 31)

Well ID # (TOC)	Sampling Date	SUBJ < >	DTW feet	Elev. > <	TPHg < >	B	T	E	X	TEPHd parts per billion	VOCs	TOG > <
MW11 cont. (13.55)	11/13/91	NLPH	10.44	3.11#								
	12/10/91	NLPH	10.48	3.07	<50	0.7	<0.5	<0.5	<0.5	<50	NA	NA
	01/21/92	NLPH	10.10	3.45#								
	03/25/92	NLPH	7.30	6.25	<50	<0.5	<0.5	<0.5	<0.5	<50	NA	NA
	06/22/92	NLPH	9.02	4.53	84	1.5	3.1	1.4	9.6	57	NA	NA
	09/24/92	NLPH	9.91	3.64	<50	<0.5	<0.5	<0.5	<0.5	<50	NA	NA
	10/14/92	NLPH	10.11	3.44#								
	11/16/92	NLPH	9.79	3.76#								
	12/08/92	NLPH	9.77	3.78	<50	<0.5	<0.5	<0.5	<0.5	310	NA	NA
	01/27/93	NLPH	5.67	7.88#								
	02/18/93	NLPH	5.06	8.49#								
	03/10/93	NLPH	6.40	7.15	<50	<0.5	<0.5	<0.5	<0.5	240	NA	NA
	04/06/93	NLPH	6.42	7.13#								
	05/28/93	NLPH	7.65	5.90#								
	06/10/93	NLPH	7.80	5.75	<50	<0.5	<0.5	<0.5	<0.5	<50	NA	NA
	07/17/93	NLPH	8.42	5.13#								
	08/11/93	NLPH	8.87	4.68	<50	0.5 <5*	0.7 <5*	1.2 <5*	2.7 <5*	<50 <50 ²	ND	NA
	09/01/93	NLPH	9.09	4.46#								
	10/26/93	NLPH	9.70	3.85	<50	<0.5	<0.5	<0.5	<0.5	80	NA	NA
	11/12/93	NLPH	9.72	3.83#								
	12/27/93	NLPH	9.56	3.99#								
	01/20/94	NLPH	9.61	3.94#								
	02/02-03/94	NLPH	9.56	3.99	<50	<0.5	1.0	<0.5	0.9	160	NA	NA
	03/10/94	NLPH	8.59	4.96#								
	04/22/94	NLPH	8.47	5.08#								
	05/10-11/94	NLPH	8.12	5.43	<50	<0.5 ¹	<0.5	<0.5	3.2	100 ²	NA	NA
	06/27/94	NLPH	8.65	4.90#								

See Notes on page 31 of 31

TABLE 1
 CUMULATIVE GROUNDWATER MONITORING AND SAMPLING DATA
 Former Exxon Service Station 7-3006
 720 High Street, Oakland, California
 (Page 21 of 31)

Well ID # (TOC)	Sampling Date	SUBJ < >	DTW feet	Elev. > <	TPHg < >	B	T	E	X	TEPHd parts per billion	VOCs	TOG >
MW11 cont (13.55)	08/31/94	NLPH	9.80	3.75#								
	09/29/94	NLPH	10.16	3.39	<50	<0.5	<0.5	<0.5	<0.5	<50	NA	NA
	10/25/94	NLPH	10.48	3.07	<50	<0.5	<0.5	<0.5	<0.5	<50	NA	NA
	11/30/94	NM	8.55	5.00#								
	12/27/94	NLPH	7.98	5.57#								
	02/06/95	NLPH	6.49	7.06	<50	<0.5	<0.5	<0.5	<0.5	160	NA	NA
MW12 (12.61)	12/06/89	NLPH	8.00	4.61	85,000	6,700	6,300	1,800	7,800	4,000	NA	NA
	02/20/90	NLPH	6.33	6.28#								
	04/19/90	NLPH	7.18	5.43	110,000	6,600	7,400	1,800	11,000	97,000	NA	NA
	07/03/90	NLPH	7.41	5.20	92,000	11,000	11,000	3,100	13,000	50,000	NA	NA
	07/26/90	NLPH	6.54	6.07#								
	08/20/90	NLPH	7.23	5.38#								
	09/19/90	NLPH	7.77	4.84#								
	11/27/90	NLPH	8.15	4.46	69,000	11,000	10,000	3,100	12,000	NA	NA	
	01/17/91	NLPH	8.06	4.55#								
	03/26/91	NLPH	7.21	5.40	100,000	15,000	16,000	2,400	11,000	<100	NA	NA
	05/02/91	Sheen	7.60	5.01#								
	06/20/91	Sheen	8.02	4.59#								
	08/07/91	Sheen	8.25	4.36#								
	09/17/91	Sheen	8.20	4.41	82,000	22,000	18,000	3,900	16,000	NA	NA	NA
	11/13/91	Sheen	7.77	4.84#								
	12/10/91	Sheen	7.75	4.86	99,000	18,000	16,000	3,000	11,000	1,700	NA	NA
	01/21/92	Sheen	7.08	5.53#								
03/25/92	Sheen	4.93	7.68#									
06/22/92	Sheen	6.04	6.57#									
	09/24/92	NLPH	6.94	5.67	570,000	62,000	46,000	15,000	57,000	3,100	NA	NA

See Notes on page 31 of 31

TABLE 1
CUMULATIVE GROUNDWATER MONITORING AND SAMPLING DATA
Former Exxon Service Station 7-3006
720 High Street, Oakland, California
(Page 22 of 31)

Well ID # (TOC)	Sampling Date	SUBJ < >	DTW feet	Elev. > <	TPHg < >	B	T	E	X	TEPHd	VOCs	TOG >
										parts per billion		
MW12 cont. (12.61)	10/14/92	Sheen	7.21	5.40#								
	11/16/92	Sheen	7.00	5.61#								
	12/08/92	Sheen	6.70	5.91#								
	01/27/93	Sheen	4.16	8.45#								
	02/18/93	Sheen	4.01	8.60#								
	03/10/93	Sheen	3.94	8.67#								
	04/06/93	Sheen	3.69	8.92#								
	05/28/93	Sheen	4.66	7.95#								
	06/10/93	Sheen	4.78	7.83#								
	07/17/93	Sheen	5.42	7.19#								
	08/11/93	Sheen	5.83	6.78	94,000	10,000	8,300	2,800	13,000	2,400	ND	NA
	09/01/93	Sheen	6.22	6.39#								
	10/26/93	NLPH	6.82	5.79	68,000	11,000	8,500	3,400	13,000	17,000	NA	NA
	11/12/93	NLPH	6.88	5.73#								
	12/27/93	NLPH	8.04	4.57#								
	01/20/94	NLPH	7.81	4.80#								
	02/02-03/94	NLPH	7.22	5.39	48,000	4,000	2,700	2,900	9,900	18,000	NA	NA
	03/10/94	NLPH	6.16	6.45#								
	04/22/94	NLPH	6.31	6.30#								
	05/10-11/94	NLPH	6.16	6.45	46,000	3,000 ^a	1,600	2,900	9,100	8,200	NA	NA
	06/27/94	NLPH	6.55	6.06#								
	08/31/94	NLPH	7.97	4.64#								
	09/29/94	Sheen	8.52	4.09#								
	10/25/94	Sheen	8.74	3.87#								
11/30/94	NM	8.73	3.88#									
12/30/94	NLPH	6.17	6.44#									
02/06/95	Sheen	4.44	8.17									

See Notes on page 31 of 31

TABLE 1
 CUMULATIVE GROUNDWATER MONITORING AND SAMPLING DATA
 Former Exxon Service Station 7-3006
 720 High Street, Oakland, California
 (Page 23 of 31)

Well ID # (TOC)	Sampling Date	SUBJ <	DTW feet	Elev. >	TPHg					TEPHd	VOCs	TOG
					B	T	E	X	parts per billion			
MW13 (14.20)	12/06/89	NLPH	9.35	4.85	52,000	2,100	2,000	1,400	6,100	31,000	NA	NA
	02/20/90	NLPH	7.73	6.47#								
	04/19/90	NLPH	8.68	5.52	59,000	1,800	1,500	1,400	7,200	54,000	NA	NA
	07/03/90	NLPH	8.00	6.20	53,000	4,500	3,100	2,200	7,800	26,000	NA	NA
	07/26/90	NLPH	7.95	6.25#								
	08/20/90	NLPH	8.66	5.54#								
	09/19/90	NLPH	9.13	5.07#								
	11/27/90	NLPH	9.49	4.71	20,000	4,500	1,100	880	3,300	1,600	NA	NA
	01/17/91	NLPH	9.61	4.59#								
	03/26/91	NLPH	9.25	4.95	72,000	10,000	8,300	1,700	6,900	<100	NA	NA
	05/02/91	NLPH	9.31	4.89#								
	06/20/91	NLPH	9.73	4.47	44,000	5,600	3,100	750	2,600	<100	NA	NA
	08/07/91				Not Accessible							
	09/17/91	NLPH	9.72	4.48	40,000	11,000	6,500	2,400	8,100	NA	NA	NA
	11/13/91	NLPH	9.06	5.14#								
	12/10/91	NLPH	9.04	5.16	72,000	11,000	7,400	2,500	9,400	3,700	NA	NA
	01/21/92	NLPH	8.41	5.79#								
	03/25/92	Sheen	5.72	8.48#								
	06/22/92	Sheen	7.31	6.89#								
	09/24/92	NLPH	8.30	5.90	86,000	9,500	6,100	2,400	10,000	2,900	NA	NA
	10/14/92	Sheen	8.56	5.64#								
	11/16/92	Sheen	8.36	5.84#								
	12/08/92	Sheen	8.10	6.10#								
	01/27/93	NM	NM	---								
	02/18/93	Sheen	4.89	9.31#								
	03/10/93	Sheen	5.32	8.88#								
	04/06/93	Sheen	5.10	9.10#								

See Notes on page 31 of 31

TABLE 1
 CUMULATIVE GROUNDWATER MONITORING AND SAMPLING DATA
 Former Exxon Service Station 7-3006
 720 High Street, Oakland, California
 (Page 24 of 31)

Well ID # (TOC)	Sampling Date	SUBJ < >	DTW feet	Elev. >	TPHg < >	B	T	E	X	TEPHd	VOCs	TOG >
									parts per billion			
MW13 cont (14.20)	05/28/93	Sheen	6.00	8.20#								
	06/10/93	Sheen	6.15	8.05#								
	07/17/93	Sheen	6.82	7.38#								
	08/11/93	Sheen	7.31	6.89	62,000	5,600 7,700*	2,700 3,700*	2,300 3,500*	11,000 14,000*	2,500 360*	NA	ND
	09/01/93	Sheen	7.62	6.58#								
	10/26/93	NLPH	8.22	5.98	46,000	5,200	3,200	2,500	11,000	15,000	NA	NA
	11/12/93	NLPH	8.29	5.91#								
	12/27/93	NM	NM	---								
	01/20/94	NLPH	9.08	5.12#								
	02/02-03/94	NLPH	8.75	5.45	41,000	3,800	1,500	2,700	9,500	8,100	NA	NA
	03/10/94	Sheen	7.46	6.74#								
	04/22/94	Sheen	7.78	6.42#								
	05/10-11/94	NLPH	7.61	6.59	39,000	3,400	930	2,400	8,900	15,000	NA	NA
	06/27/94	NLPH	7.97	6.23								
	08/31/94	NLPH	9.21	4.99								
	09/29/94	NLPH	9.61	4.59	57,000	2,100	470	2,600	8,100	320	NA	NA
	10/25/94	Sheen	9.93	4.27								
	11/30/94	NM	8.16	6.04#								
	12/27/94	NM	7.61	6.59#								
02/06/95	Sheen	5.89	8.31									
MW14 (15.18)	11/27/90	NLPH	9.88	5.30	390	<0.5	<0.5	3.6	3.7	120	NA	NA
	01/17/91	NLPH	9.13	6.05#								
	03/26/91	NLPH	8.51	6.67	200	<0.5	1.5	0.8	3.6	<100	NA	NA
	05/02/91	NLPH	8.45	6.73#								
	06/20/91	NLPH	8.38	6.80	110	<0.5	<0.5	<0.5	<0.5	<100	NA	NA

See Notes on page 31 of 31

TABLE 1
 CUMULATIVE GROUNDWATER MONITORING AND SAMPLING DATA
 Former Exxon Service Station 7-3006
 720 High Street, Oakland, California
 (Page 25 of 31)

Well ID # (TOC)	Sampling Date	SUBJ < >	DTW feet	Elev. > <	TPHg < >	parts per billion				TEPHd	VOCs	TOG >
						B	T	E	X			
MW14 cont. (15.18)	09/17/91	NLPH	9.14	6.04	450	<0.5	<0.5	3.2	2.3	NA	NA	NA
	11/13/91	NLPH	8.83	6.35#								
	12/10/91	NLPH	8.90	6.28	71	0.5	<0.5	<0.5	<0.5	280	NA	NA
	01/21/92	NLPH	8.58	6.60#								
	03/25/92	NLPH	6.15	9.03	61	<0.5	<0.5	1.1	<0.5	640	NA	NA
	06/22/92	NLPH	7.70	7.48	140	<0.5	<0.5	0.6	2	350	NA	NA
	09/24/92	NLPH	9.34	5.84	75	<0.5	<0.5	<0.5	<0.5	300	NA	NA
	10/14/92	NLPH	9.40	5.78#								
	11/16/92	NLPH	9.17	6.01#								
	12/08/92	NLPH	8.89	6.29	350	2.5	1.0	1.5	8.1	220	NA	NA
	01/27/93	NLPH	8.54	6.64#								
	02/18/93	NM	NM	---								
	03/10/93	NLPH	5.55	9.63	410	<0.5	<0.5	0.9	1.6	<250 ^a	NA	NA
	04/06/93	NLPH	5.34	9.84#								
	05/28/93	NLPH	6.07	9.11#								
	06/10/93	NLPH	6.30	8.88	180	<0.5	<0.5	0.8	1.9 <500 ^a	180	NA	NA
	07/17/93	NLPH	7.77	7.41#								
	08/11/93	NLPH	7.62	7.56	180	0.6 <5 ^a	<0.5 <5 ^a	1.6 <5 ^a	3.7 <5 ^a	180 140 ^b	ND	NA
	09/01/93	NLPH	8.09	7.09#								
	10/26/93	NLPH	8.18	7.00	260	<0.5	<0.5	<0.5	3.6	200	NA	NA
	11/12/93	NLPH	8.16	7.02#								
	12/27/93	NLPH	7.95	7.23#								
	01/20/94	NM	NM	---								
02/02-03/94					Not Accessible							
03/10/94	NLPH	7.84	7.34#									
04/22/94	NLPH	8.00	7.18#									

See Notes on page 31 of 31

TABLE 1
 CUMULATIVE GROUNDWATER MONITORING AND SAMPLING DATA
 Former Exxon Service Station 7-3006
 720 High Street, Oakland, California
 (Page 26 of 31)

Well ID # (TOC)	Sampling Date	SUBJ < >	DTW feet	Elev. > <	TPHg					TEPHd	VOCs	TOG
					B	T	E	X	parts per billion			
MW14 cont. (15.18)	05/10-11/94	NLPH	7.93	7.25	300	2.7	7.9	2.0	27	1,100 ^r	NA	NA 210 ^r
	06/27/94	NLPH	8.19	6.99#								
	08/31/94	NLPH	9.44	5.74#								
	09/29/94	NLPH	9.82	5.36	300	<0.5	<0.5	0.9	1.3	1,600 ^r	NA	NA
	10/25/94	NLPH	9.99	5.19	200	<0.5	<0.5	0.8	<0.5	210 ^r	NA	NA
	11/30/94	NM	8.16	6.61#								
	12/27/94	Sheen	8.15	7.03#								
	02/06/95	NLPH	7.18	8.00	360	<1.0	<1.0	<1.0	<1.0	1,200	ND	400 ^r
MW15 (13.73)	11/27/90	NLPH	8.67	5.06	2,700	210	5.5	600	250	340	NA	NA
	01/17/91	NLPH	8.03	5.70#								
	03/26/91				Not Accessible							
	05/02/91	NLPH	7.09	6.64#								
	06/20/91	NLPH	7.06	6.67	380	<0.5	<0.5	<0.5	1.3	<100	NA	NA
	08/07/91	NLPH	7.59	6.14#								
	09/17/91	NLPH	7.89	5.84	490	2.9	1.7	33	1.3	NA	NA	NA
	11/13/91	NLPH	9.07	4.66#								
	12/10/91	NLPH	8.60	5.13	1,600	14	1.1	66	9.8	300	NA	NA
	01/21/92	NLPH	9.15	4.58#								
	03/25/92	NLPH	8.10	5.63	3,400	150	13	690	250	1,400	NA	NA
	06/22/92	NLPH	5.80	7.93	6,600	99	<0.5	670	180	860	NA	NA
	09/24/92	NLPH	7.21	6.52	3,600	120	7	480	47	740	NA	NA
	10/14/92	NLPH	7.40	6.33#								
	11/16/92	NLPH	7.55	6.18#								
	12/08/92	NLPH	7.42	6.31	1,600	43	1.6	170	23	430	NA	NA
	01/27/93	NLPH	4.37	9.36#								

See Notes on page 31 of 31

TABLE 1
 CUMULATIVE GROUNDWATER MONITORING AND SAMPLING DATA
 Former Exxon Service Station 7-3006
 720 High Street, Oakland, California
 (Page 27 of 31)

Well ID # (TOC)	Sampling Date	SUBJ < >	DTW feet	Elev. > <	TPHg < >	B	T	E	X	TEPHd parts per billion	VOCs	TOG >
MW15 cont. (13.73)	02/18/93	Sheen	4.14	9.59#								
	03/10/93	Not Accessible										
	04/06/93	Sheen	3.16	10.57#								
	05/28/93	NLPH	4.47	9.26#								
	06/10/93	Sheen	4.59	9.14#								
	07/17/93	NLPH	5.51	8.22#								
	08/11/93	Sheen	6.13	7.60	4,800	49	<2.5	410	34	710	ND	NA
						70'	<5'	640'	26'	300'		
	09/01/93	Sheen	6.45	7.28#								
	10/26/93	NLPH	7.16	6.57	3,400	79	<2.5	115	32	970	NA	NA
	11/12/93	NLPH	7.82	5.91#								
	12/27/93	NLPH	7.50	6.23#								
	01/20/94	NLPH	7.48	6.25#								
	02/02-03/94	NLPH	7.30	6.43	4,300	24	6.7	170	26	1,200	NA	NA
	03/10/94	NLPH	7.32	6.41#								
	04/22/94	NLPH	6.67	7.06#								
	05/10-11/94	NLPH	5.81	7.92	3,900	16	<0.5	150	13	1,400	NA	NA
	06/27/94	NLPH	6.14	7.59#								
	08/31/94	NLPH	7.20	6.53#								
	09/29/94	NLPH	7.76	5.97	2,500	51	15	48	3.6	420	NA	NA
10/25/94	Sheen	8.19	5.54#									
11/30/94	NM	8.57	5.16#									
12/27/94	NLPH	6.49	7.24#									
02/06/95	Sheen	4.97	8.76									

See Notes on page 31 of 31

TABLE 1
 CUMULATIVE GROUNDWATER MONITORING AND SAMPLING DATA
 Former Exxon Service Station 7-3006
 720 High Street, Oakland, California
 (Page 28 of 31)

Well ID # (TOC)	Sampling Date	SUBJ < >	DTW feet	Elev. > <	TPHg < >	B	T	E	X	TEPHd	VOCs	TOG >
								parts per billion				
VW1 (14.01)	02/18/93	NLPH	4.52	9.49#								
	03/10/93	NLPH	5.25	8.76#								
	04/06/93	NLPH	5.06	8.95#								
	05/28/93	NLPH	5.52	8.49#								
	06/10/93	NLPH	5.62	8.39#								
	07/17/93	NLPH	6.23	7.78#								
	08/11/93	Dry										
	09/01/93	Dry										
	10/26/93	Dry										
	11/12/93	Dry										
	12/27/93	NM	NM	---								
	01/20/94	Dry										
	02/02-03/94	NLPH	5.58	8.43#								
	03/10/94	NLPH	6.19	7.82#								
	04/22/94	NLPH	5.96	8.05#								
	05/10-11/94	NLPH	5.66	8.35#								
	06/27/94	NLPH	5.99	8.02#								
	08/31/94	NLPH	3.92	10.09#								
	09/29/94	NM	NM	---								
	10/25/94	Sheen	5.80	8.21								
	11/30/94	NM	6.21	7.80								
	12/27/94	NM	NM	---								
	02/06/95	NM	NM	---								

See Notes on page 31 of 31

TABLE 1
 CUMULATIVE GROUNDWATER MONITORING AND SAMPLING DATA
 Former Exxon Service Station 7-3006
 720 High Street, Oakland, California
 (Page 29 of 31)

Well ID # (TOC)	Sampling Date	SUBJ <	DTW feet	Elev. >	TPHg <	B	T	E	X	TEPHd parts per billion	VOCs .	TOG >
VW2 (14.09)	02/18/93	NLPH	4.41	9.68#								
	03/10/93	NLPH	5.17	8.92#								
	04/06/93	NLPH	5.04	9.05#								
	05/28/93	NLPH	5.46	8.63#								
	06/10/93	NLPH	5.60	8.49#								
	07/17/93	NLPH	6.38	7.71#								
	08/11/93	NLPH	7.90	6.19#								
	09/01/93	0.01	7.31	6.79#								
	10/26/93	Dry										
	11/12/93	Dry										
	12/27/93	Dry										
	01/20/94	NLPH	7.75	6.34#								
	02/02-03/94	Dry										
	03/10/94	NLPH	6.85	7.24#								
	04/22/94	NLPH	7.30	6.79#								
	05/10-11/94	NLPH	7.20	6.89#								
	06/27/94	NLPH	7.29	6.80#								
	08/31/94	NLPH	7.75	6.34#								
	09/29/94	NM	NM	--								
	10/25/94	NLPH	7.76	6.33								
	11/30/94	NM	7.77	6.32								
	12/27/94	NM	NM	--								
	02/06/95	NM	NM									

See Notes on page 31 of 31

TABLE 1
CUMULATIVE GROUNDWATER MONITORING AND SAMPLING DATA
 Former Exxon Service Station 7-3006
 720 High Street, Oakland, California
 (Page 30 of 31)

Well ID # (TOC)	Sampling Date	SUBJ < >	DTW feet >	Elev. >	TPHg < >	B	T	E	X	TEPHd	VOCs	TOG >
								parts per billion				
VW3 (13.37)	02/18/93	NLPH	4.62	8.69#								
	03/10/93	NLPH	4.41	8.90#								
	04/06/93	NLPH	4.10	9.21#								
	05/28/93	NLPH	4.98	8.33#								
	06/10/93	NLPH	4.98	8.33#								
	07/17/93	NLPH	5.57	7.74#								
	08/11/93	NLPH	7.69	5.62#								
	09/01/93	0.01	6.78	6.54#								
	10/26/93	Dry										
	11/12/93	Dry										
	12/27/93	NLPH	7.24	6.13#								
	01/20/93	NLPH	7.49	5.88#								
	02/02-03/94	NLPH	7.15	6.22#								
	03/10/94	NLPH	6.21	7.16#								
	04/22/94	NLPH	6.34	7.03#								
	05/10-11/94	NLPH	5.92	7.45#								
	06/27/94	NLPH	6.66	6.71#								
	08/31/94	NLPH	7.55	5.82#								
	09/29/94	NM	NM	---								
	10/25/94	NLPH	7.57	5.80								
	11/30/94	NM	6.97	6.40								
	12/27/94	NM	NM	---								
	02/06/95	NM	NM									

See Notes on page 31 of 31

TABLE 1
CUMULATIVE GROUNDWATER MONITORING AND SAMPLING DATA
 Former Exxon Service Station 7-3006
 720 High Street, Oakland, California
 (Page 31 of 31)

Notes:			
SUBJ	= Results of subjective evaluation, liquid-phase hydrocarbon thickness (HT) in feet	NA	= Not Analyzed
LPH	= Liquid-phase hydrocarbons present, thickness not measured	---	= Not Applicable
NLPH	= No liquid phase hydrocarbons present in well	<	= Less than the indicated detection limit shown by the laboratory
TOC	= Elevation of top of well casing; relative to mean sea level	#	= Well monitored but not sampled
DTW	= Depth to water	1	= Chloromethane
Elev.	= Elevation of groundwater. If liquid-phase hydrocarbons present, elevation adjusted using TOC - [DTW - (PT x 0.8)].	2	= Analyzed for Stoddard Solvent using EPA method 5030/8015.
[]	= amount recovered	3	= Additional Analysis on MW1 - Fecal Coliform Most Probable Number (MPN)/100 ml.
gal.	= gallons	4	= VOCs Detected using EPA Method 624 - 16,000 ppb Benzene, 480 ppb Toluene, 4,500 ppb Ethylbenzene, 9,900 ppb total Xylenes.
c.	= cups		VOCs Detected using EPA Method 625 - 1,800 ppb Naphthalene, 600 ppb 2-Methylnaphthalene, Bis(2-ethylhexyl) phthalate
TPHg	= Total petroleum hydrocarbons as gasoline analyzed using modified EPA method 5030/8015.	5	= Stoddard Solution detected in the sample at approximately 320 ppb
BTEX	= Benzene, Toluene, Ethylbenzene, and total Xylenes analyzed using modified EPA method 5030/8020.	6	= Analyzed for Stoddard Solvent using modified EPA method 5030/8015. Sample chromatogram was not representative of a Stoddard Solvent pattern. Pattern was representative of the heavier hydrocarbons found in a gasoline pattern.
TEPHd	= Total extractable petroleum hydrocarbons as diesel analyzed using EPA method 3510/8015.		= Department of Health Services, State of California, October 1990
VOCs	= Volatile organic compounds analyzed using EPA method 601.	DHS	= Not diesel standard pattern/Discrete peaks/Non-diesel mix
TOG	= Total oil and grease analyzed using Standard Method 5520.	7	= A peak eluting earlier than benzene and suspected to be methyl tert-butyl ether was present
*	= Analyzed using EPA method 624 (volatile organic compounds).	8	
NR	= No liquid-phase hydrocarbons removed from well		
NM	= Not Measured		
ND	= Not Detectable		

ATTACHMENT C

**LABORATORY ANALYTICAL REPORT
AND CHAIN-OF-CUSTODY RECORD**

25 October, 2006

Paula Sime
Environmental Resolutions (Exxon)
601 North McDowell Blvd.
Petaluma, CA 94954

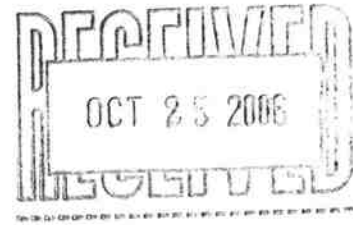

RE: Exxon 7-3006
Work Order: MPJ0413

Enclosed are the results of analyses for samples received by the laboratory on 10/06/06 18:45. The samples arrived at a temperature of 3° C. If you have any questions concerning this report, please feel free to contact me.

Sincerely,

Christina Woodcock
Project Manager

CA ELAP Certificate #1210

Environmental Resolutions (Exxon)
601 North McDowell Blvd.
Petaluma CA, 94954

Project: Exxon 7-3006
Project Number: 7-3006
Project Manager: Paula Sime

MPJ0413
Reported:
10/25/06 11:10

ANALYTICAL REPORT FOR SAMPLES

Sample ID	Laboratory ID	Matrix	Date Sampled	Date Received
MW1	MPJ0413-01	Water	10/06/06 08:00	10/06/06 18:45
MW2	MPJ0413-02	Water	10/06/06 10:15	10/06/06 18:45
MW3	MPJ0413-03	Water	10/06/06 10:30	10/06/06 18:45
MW6	MPJ0413-04	Water	10/06/06 10:45	10/06/06 18:45
MW14	MPJ0413-05	Water	10/06/06 10:00	10/06/06 18:45

Environmental Resolutions (Exxon)
601 North McDowell Blvd.
Petaluma CA, 94954

Project: Exxon 7-3006
Project Number: 7-3006
Project Manager: Paula Sime

MPJ0413
Reported:
10/25/06 11:10

MW1 (MPJ0413-01) Water Sampled: 10/06/06 08:00 Received: 10/06/06 18:45

Purgeable Hydrocarbons and BTEX by EPA 8015B/8021B

TestAmerica - Morgan Hill, CA

Analyte	Result	Reporting Limit	Units	Dilution	Batch	Prepared	Analyzed	Method	Notes
Gasoline Range Organics (C4-C12)	70	50	ug/l	1	6J13002	10/13/06	10/13/06	EPA 8015B/8021B	HC-11
Benzene	ND	0.50	"	"	"	"	"	"	"
Toluene	ND	0.50	"	"	"	"	"	"	"
Ethylbenzene	ND	0.50	"	"	"	"	"	"	"
Xylenes (total)	ND	0.50	"	"	"	"	"	"	"
<i>Surrogate: a,a,a-Trifluorotoluene</i>		106 %	85-120	"	"	"	"	"	"
<i>Surrogate: 4-Bromofluorobenzene</i>		103 %	75-125	"	"	"	"	"	"

Extractable Hydrocarbons with Silica Gel cleanup by EPA 8015B

TestAmerica - Morgan Hill, CA

Analyte	Result	Reporting Limit	Units	Dilution	Batch	Prepared	Analyzed	Method	Notes
Diesel Range Organics (C10-C28)	ND	47	ug/l	1	6J12035	10/12/06	10/20/06	EPA 8015B-SVOA	
<i>Surrogate: n-Octacosane</i>		88 %	30-115	"	"	"	"	"	"

Volatile Organic Compounds by EPA Method 8260B

TestAmerica - Morgan Hill, CA

Analyte	Result	Reporting Limit	Units	Dilution	Batch	Prepared	Analyzed	Method	Notes
tert-Amyl methyl ether	ND	0.50	ug/l	1	6J15003	10/15/06	10/15/06	EPA 8260B	
tert-Butyl alcohol	ND	5.0	"	"	"	"	"	"	
Di-isopropyl ether	ND	0.50	"	"	"	"	"	"	
1,2-Dibromoethane (EDB)	ND	0.50	"	"	"	"	"	"	
1,2-Dichloroethane	2.3	0.50	"	"	"	"	"	"	
Ethyl tert-butyl ether	ND	0.50	"	"	"	"	"	"	
Methyl tert-butyl ether	98	0.50	"	"	"	"	"	"	
<i>Surrogate: 1,2-Dichloroethane-d4</i>		115 %	60-145	"	"	"	"	"	
<i>Surrogate: 4-Bromofluorobenzene</i>		76 %	60-120	"	"	"	"	"	
<i>Surrogate: Dibromofluoromethane</i>		110 %	75-130	"	"	"	"	"	
<i>Surrogate: Toluene-d8</i>		96 %	70-130	"	"	"	"	"	

Environmental Resolutions (Exxon) 601 North McDowell Blvd. Petaluma CA, 94954	Project: Exxon 7-3006 Project Number: 7-3006 Project Manager: Paula Sime	MPJ0413 Reported: 10/25/06 11:10
---	--	--

MW2 (MPJ0413-02) Water Sampled: 10/06/06 10:15 Received: 10/06/06 18:45

Purgeable Hydrocarbons and BTEX by EPA 8015B/8021B
TestAmerica - Morgan Hill, CA

Analyte	Result	Reporting Limit	Units	Dilution	Batch	Prepared	Analyzed	Method	Notes
Gasoline Range Organics (C4-C12)	ND	50	ug/l	1	6J13002	10/13/06	10/13/06	EPA 8015B/8021B	
Benzene	0.78	0.50	"	"	"	"	"	"	
Toluene	ND	0.50	"	"	"	"	"	"	
Ethylbenzene	ND	0.50	"	"	"	"	"	"	
Xylenes (total)	ND	0.50	"	"	"	"	"	"	
<i>Surrogate: a,a,a-Trifluorotoluene</i>		106 %		85-120	"	"	"	"	
<i>Surrogate: 4-Bromofluorobenzene</i>		106 %		75-125	"	"	"	"	

Extractable Hydrocarbons with Silica Gel cleanup by EPA 8015B
TestAmerica - Morgan Hill, CA

Analyte	Result	Reporting Limit	Units	Dilution	Batch	Prepared	Analyzed	Method	Notes
Diesel Range Organics (C10-C28)	90	47	ug/l	1	6J12035	10/12/06	10/20/06	EPA 8015B-SVOA	HC-12
<i>Surrogate: n-Octacosane</i>		85 %		30-115	"	"	"	"	

Volatile Organic Compounds by EPA Method 8260B
TestAmerica - Morgan Hill, CA

Analyte	Result	Reporting Limit	Units	Dilution	Batch	Prepared	Analyzed	Method	Notes
tert-Amyl methyl ether	ND	0.50	ug/l	1	6J15003	10/15/06	10/15/06	EPA 8260B	
tert-Butyl alcohol	ND	5.0	"	"	"	"	"	"	
Di-isopropyl ether	ND	0.50	"	"	"	"	"	"	
1,2-Dibromoethane (EDB)	ND	0.50	"	"	"	"	"	"	
1,2-Dichloroethane	ND	0.50	"	"	"	"	"	"	
Ethanol	ND	100	"	"	"	"	"	"	CC01
Ethyl tert-butyl ether	ND	0.50	"	"	"	"	"	"	
Methyl tert-butyl ether	2.1	0.50	"	"	"	"	"	"	
<i>Surrogate: 1,2-Dichloroethane-d4</i>		116 %		60-145	"	"	"	"	
<i>Surrogate: 4-Bromofluorobenzene</i>		83 %		60-120	"	"	"	"	
<i>Surrogate: Dibromofluoromethane</i>		110 %		75-130	"	"	"	"	
<i>Surrogate: Toluene-d8</i>		97 %		70-130	"	"	"	"	

Environmental Resolutions (Exxon)
601 North McDowell Blvd.
Petaluma CA, 94954

Project: Exxon 7-3006
Project Number: 7-3006
Project Manager: Paula Sime

MPJ0413
Reported:
10/25/06 11:10

MW3 (MPJ0413-03) Water Sampled: 10/06/06 10:30 Received: 10/06/06 18:45

Purgeable Hydrocarbons and BTEX by EPA 8015B/8021B
TestAmerica - Morgan Hill, CA

Analyte	Result	Reporting Limit	Units	Dilution	Batch	Prepared	Analyzed	Method	Notes
Gasoline Range Organics (C4-C12)	360	100	ug/l	2	6J13002	10/13/06	10/13/06	EPA 8015B/8021B	
Benzene	3.8	1.0	"	"	"	"	"	"	
Toluene	ND	1.0	"	"	"	"	"	"	
Ethylbenzene	ND	1.0	"	"	"	"	"	"	
Xylenes (total)	ND	1.0	"	"	"	"	"	"	
<i>Surrogate: a,a,a-Trifluorotoluene</i>		109 %	85-120	"	"	"	"	"	
<i>Surrogate: 4-Bromofluorobenzene</i>		106 %	75-125	"	"	"	"	"	

Extractable Hydrocarbons with Silica Gel cleanup by EPA 8015B
TestAmerica - Morgan Hill, CA

Analyte	Result	Reporting Limit	Units	Dilution	Batch	Prepared	Analyzed	Method	Notes
Diesel Range Organics (C10-C28)	5300	240	ug/l	5	6J12035	10/12/06	10/23/06	EPA 8015B-SVOA	HC-17
<i>Surrogate: n-Octacosane</i>		111 %	30-115	"	"	"	"	"	

Volatile Organic Compounds by EPA Method 8260B
TestAmerica - Morgan Hill, CA

Analyte	Result	Reporting Limit	Units	Dilution	Batch	Prepared	Analyzed	Method	Notes
tert-Amyl methyl ether	ND	0.50	ug/l	1	6J15003	10/15/06	10/15/06	EPA 8260B	
tert-Butyl alcohol	ND	5.0	"	"	"	"	"	"	
Di-isopropyl ether	ND	0.50	"	"	"	"	"	"	
1,2-Dibromoethane (EDB)	ND	0.50	"	"	"	"	"	"	
1,2-Dichloroethane	ND	0.50	"	"	"	"	"	"	
Ethyl tert-butyl ether	ND	0.50	"	"	"	"	"	"	
Methyl tert-butyl ether	9.7	0.50	"	"	"	"	"	"	
<i>Surrogate: 1,2-Dichloroethane-d4</i>		121 %	60-145	"	"	"	"	"	
<i>Surrogate: 4-Bromofluorobenzene</i>		102 %	60-120	"	"	"	"	"	
<i>Surrogate: Dibromofluoromethane</i>		106 %	75-130	"	"	"	"	"	
<i>Surrogate: Toluene-d8</i>		112 %	70-130	"	"	"	"	"	

Environmental Resolutions (Exxon)
601 North McDowell Blvd.
Petaluma CA, 94954

Project: Exxon 7-3006
Project Number: 7-3006
Project Manager: Paula Sime

MPJ0413
Reported:
10/25/06 11:10

MW6 (MPJ0413-04) Water Sampled: 10/06/06 10:45 Received: 10/06/06 18:45

Purgeable Hydrocarbons and BTEX by EPA 8015B/8021B
TestAmerica - Morgan Hill, CA

Analyte	Result	Reporting Limit	Units	Dilution	Batch	Prepared	Analyzed	Method	Notes
Gasoline Range Organics (C4-C12)	1900	1200	ug/l	25	6J13002	10/13/06	10/13/06	EPA 8015B/8021B	
Benzene	140	12	"	"	"	"	"	"	
Toluene	ND	12	"	"	"	"	"	"	
Ethylbenzene	24	12	"	"	"	"	"	"	
Xylenes (total)	ND	12	"	"	"	"	"	"	
<i>Surrogate: a,a,a-Trifluorotoluene</i>		108 %	85-120	"	"	"	"	"	
<i>Surrogate: 4-Bromofluorobenzene</i>		103 %	75-125	"	"	"	"	"	

Extractable Hydrocarbons with Silica Gel cleanup by EPA 8015B
TestAmerica - Morgan Hill, CA

Analyte	Result	Reporting Limit	Units	Dilution	Batch	Prepared	Analyzed	Method	Notes
Diesel Range Organics (C10-C28)	430	47	ug/l	1	6J12035	10/12/06	10/21/06	EPA 8015B-SVOA	HC-12
<i>Surrogate: n-Octacosane</i>		85 %	30-115	"	"	"	"	"	

Volatile Organic Compounds by EPA Method 8260B
TestAmerica - Morgan Hill, CA

Analyte	Result	Reporting Limit	Units	Dilution	Batch	Prepared	Analyzed	Method	Notes
tert-Amyl methyl ether	ND	0.50	ug/l	1	6J15003	10/15/06	10/15/06	EPA 8260B	
tert-Butyl alcohol	14	5.0	"	"	"	"	"	"	
Di-isopropyl ether	ND	0.50	"	"	"	"	"	"	
1,2-Dibromoethane (EDB)	ND	0.50	"	"	"	"	"	"	
1,2-Dichloroethane	ND	0.50	"	"	"	"	"	"	
Ethanol	ND	100	"	"	"	"	"	"	CC01
Ethyl tert-butyl ether	ND	0.50	"	"	"	"	"	"	
Methyl tert-butyl ether	ND	0.50	"	"	"	"	"	"	
<i>Surrogate: 1,2-Dichloroethane-d4</i>		121 %	60-145	"	"	"	"	"	
<i>Surrogate: 4-Bromofluorobenzene</i>		117 %	60-120	"	"	"	"	"	
<i>Surrogate: Dibromofluoromethane</i>		104 %	75-130	"	"	"	"	"	
<i>Surrogate: Toluene-d8</i>		115 %	70-130	"	"	"	"	"	

Environmental Resolutions (Exxon) 601 North McDowell Blvd. Petaluma CA, 94954	Project: Exxon 7-3006 Project Number: 7-3006 Project Manager: Paula Sime	MPJ0413 Reported: 10/25/06 11:10
---	--	--

MW14 (MPJ0413-05) Water Sampled: 10/06/06 10:00 Received: 10/06/06 18:45

Purgeable Hydrocarbons and BTEX by EPA 8015B/8021B
TestAmerica - Morgan Hill, CA

Analyte	Result	Reporting Limit	Units	Dilution	Batch	Prepared	Analyzed	Method	Notes
Gasoline Range Organics (C4-C12)	290	50	ug/l	1	6J13002	10/13/06	10/13/06	EPA 8015B/8021B	
Benzene	1.3	0.50	"	"	"	"	"	"	CF1
Toluene	1.4	0.50	"	"	"	"	"	"	
Ethylbenzene	3.7	0.50	"	"	"	"	"	"	CF1
Xylenes (total)	3.0	0.50	"	"	"	"	"	"	CF1
<i>Surrogate: a,a,a-Trifluorotoluene</i>		104 %		85-120	"	"	"	"	
<i>Surrogate: 4-Bromofluorobenzene</i>		118 %		75-125	"	"	"	"	

Extractable Hydrocarbons with Silica Gel cleanup by EPA 8015B
TestAmerica - Morgan Hill, CA

Analyte	Result	Reporting Limit	Units	Dilution	Batch	Prepared	Analyzed	Method	Notes
Diesel Range Organics (C10-C28)	160	47	ug/l	1	6J12035	10/12/06	10/21/06	EPA 8015B-SVOA	HC-12
<i>Surrogate: n-Octacosane</i>		74 %		30-115	"	"	"	"	

Volatile Organic Compounds by EPA Method 8260B
TestAmerica - Morgan Hill, CA

Analyte	Result	Reporting Limit	Units	Dilution	Batch	Prepared	Analyzed	Method	Notes
tert-Amyl methyl ether	ND	0.50	ug/l	1	6J15003	10/15/06	10/15/06	EPA 8260B	
tert-Butyl alcohol	ND	5.0	"	"	"	"	"	"	
Di-isopropyl ether	ND	0.50	"	"	"	"	"	"	
1,2-Dibromoethane (EDB)	ND	0.50	"	"	"	"	"	"	
1,2-Dichloroethane	ND	0.50	"	"	"	"	"	"	
Ethanol	ND	100	"	"	"	"	"	"	CC01
Ethyl tert-butyl ether	ND	0.50	"	"	"	"	"	"	
Methyl tert-butyl ether	ND	0.50	"	"	"	"	"	"	
<i>Surrogate: 1,2-Dichloroethane-d4</i>		110 %		60-145	"	"	"	"	
<i>Surrogate: 4-Bromofluorobenzene</i>		107 %		60-120	"	"	"	"	
<i>Surrogate: Dibromofluoromethane</i>		104 %		75-130	"	"	"	"	
<i>Surrogate: Toluene-d8</i>		111 %		70-130	"	"	"	"	

Environmental Resolutions (Exxon)
601 North McDowell Blvd.
Petaluma CA, 94954

Project: Exxon 7-3006
Project Number: 7-3006
Project Manager: Paula Sime

MPJ0413
Reported:
10/25/06 11:10

Purgeable Hydrocarbons and BTEX by EPA 8015B/8021B - Quality Control
TestAmerica - Morgan Hill, CA

Analyte	Result	Evaluation Limit	Units	Spike Level	Source Result	%REC	%REC Limits	RPD	RPD Limit	Notes
---------	--------	------------------	-------	-------------	---------------	------	-------------	-----	-----------	-------

Batch 6J13002 - EPA 5030B [P/T]

Blank (6J13002-BLK1)

Prepared & Analyzed: 10/13/06

Gasoline Range Organics (C4-C12)	ND	25	ug/l							
Benzene	ND	0.25	"							
Toluene	ND	0.29	"							
Ethylbenzene	ND	0.34	"							
Xylenes (total)	ND	0.35	"							
<i>Surrogate: a,a,a-Trifluorotoluene</i>	88.0		"	80.0		110	85-120			
<i>Surrogate: 4-Bromofluorobenzene</i>	81.0		"	80.0		101	75-125			

LCS (6J13002-BS1)

Prepared & Analyzed: 10/13/06

Gasoline Range Organics (C4-C12)	206	50	ug/l	275		75	60-115			
Benzene	4.03	0.50	"	4.85		83	45-150			
Toluene	20.8	0.50	"	23.5		89	70-115			
Ethylbenzene	4.01	0.50	"	4.70		85	65-115			
Xylenes (total)	23.3	0.50	"	26.5		88	70-115			
<i>Surrogate: a,a,a-Trifluorotoluene</i>	78.2		"	80.0		98	85-120			
<i>Surrogate: 4-Bromofluorobenzene</i>	82.9		"	80.0		104	75-125			

Matrix Spike (6J13002-MS1)

Source: MPJ0413-02

Prepared & Analyzed: 10/13/06

Gasoline Range Organics (C4-C12)	249	50	ug/l	275	34	78	60-115			
Benzene	5.18	0.50	"	4.85	0.78	91	45-150			
Toluene	23.2	0.50	"	23.5	ND	99	70-115			
Ethylbenzene	4.66	0.50	"	4.70	ND	99	65-115			
Xylenes (total)	25.9	0.50	"	26.5	ND	98	70-115			
<i>Surrogate: a,a,a-Trifluorotoluene</i>	85.2		"	80.0		106	85-120			
<i>Surrogate: 4-Bromofluorobenzene</i>	85.7		"	80.0		107	75-125			

Matrix Spike Dup (6J13002-MSD1)

Source: MPJ0413-02

Prepared & Analyzed: 10/13/06

Gasoline Range Organics (C4-C12)	230	50	ug/l	275	34	71	60-115	8	20	
Benzene	4.41	0.50	"	4.85	0.78	75	45-150	16	25	
Toluene	19.7	0.50	"	23.5	ND	84	70-115	16	20	
Ethylbenzene	3.89	0.50	"	4.70	ND	83	65-115	18	25	
Xylenes (total)	22.2	0.50	"	26.5	ND	84	70-115	15	25	

TestAmerica - Morgan Hill, CA

The results in this report apply to the samples analyzed in accordance with the chain of custody document. Unless otherwise stated, results are reported on a wet weight basis. This analytical report must be reproduced in its entirety.

Environmental Resolutions (Exxon)
601 North McDowell Blvd.
Petaluma CA, 94954

Project: Exxon 7-3006
Project Number: 7-3006
Project Manager: Paula Sime

MPJ0413
Reported:
10/25/06 11:10

Purgeable Hydrocarbons and BTEX by EPA 8015B/8021B - Quality Control
TestAmerica - Morgan Hill, CA

Analyte	Result	Evaluation Limit	Units	Spike Level	Source Result	%REC	%REC Limits	RPD	RPD Limit	Notes
---------	--------	---------------------	-------	----------------	------------------	------	----------------	-----	--------------	-------

Batch 6J13002 - EPA 5030B [P/T]

Matrix Spike Dup (6J13002-MSD1)

Source: MPJ0413-02

Prepared & Analyzed: 10/13/06

Surrogate: <i>a,a,a</i> -Trifluorotoluene	75.0		ug/l	80.0		94	85-120			
Surrogate: 4-Bromofluorobenzene	82.5		"	80.0		103	75-125			

Environmental Resolutions (Exxon)
601 North McDowell Blvd.
Petaluma CA, 94954

Project: Exxon 7-3006
Project Number: 7-3006
Project Manager: Paula Sime

MPJ0413
Reported:
10/25/06 11:10

**Extractable Hydrocarbons with Silica Gel cleanup by EPA 8015B - Quality Control
TestAmerica - Morgan Hill, CA**

Analyte	Result	Evaluation Limit	Units	Spike Level	Source Result	%REC	%REC Limits	RPD	RPD Limit	Notes
Batch 6J12035 - EPA 3510C										
Blank (6J12035-BLK1)										
Prepared: 10/12/06 Analyzed: 10/20/06										
Diesel Range Organics (C10-C28)	26.7	25	ug/l							
Surrogate: n-Octacosane	31.1		"	50.0		62	30-115			
LCS (6J12035-BS1)										
Prepared: 10/12/06 Analyzed: 10/20/06										
Diesel Range Organics (C10-C28)	236	50	ug/l	500		47	40-140			
Surrogate: n-Octacosane	34.1		"	50.0		68	30-115			
LCS Dup (6J12035-BSD1)										
Prepared: 10/12/06 Analyzed: 10/20/06										
Diesel Range Organics (C10-C28)	238	50	ug/l	500		48	40-140	0.8	35	
Surrogate: n-Octacosane	37.0		"	50.0		74	30-115			

Environmental Resolutions (Exxon)
601 North McDowell Blvd.
Petaluma CA, 94954

Project: Exxon 7-3006
Project Number: 7-3006
Project Manager: Paula Sime

MPJ0413
Reported:
10/25/06 11:10

Volatile Organic Compounds by EPA Method 8260B - Quality Control
TestAmerica - Morgan Hill, CA

Analyte	Result	Evaluation Limit	Units	Spike Level	Source Result	%REC	%REC Limits	RPD	RPD Limit	Notes
---------	--------	---------------------	-------	----------------	------------------	------	----------------	-----	--------------	-------

Batch 6J15003 - EPA 5030B P/T

Blank (6J15003-BLK1)

Prepared & Analyzed: 10/15/06

tert-Amyl methyl ether	ND	0.30	ug/l							
tert-Butyl alcohol	ND	4.9	"							
Di-isopropyl ether	ND	0.25	"							
1,2-Dibromoethane (EDB)	ND	0.25	"							
1,2-Dichloroethane	ND	0.25	"							
Ethanol	ND	50	"							
Ethyl tert-butyl ether	ND	0.40	"							
Methyl tert-butyl ether	ND	0.31	"							
<i>Surrogate: 1,2-Dichloroethane-d4</i>	2.85		"	2.50		114	60-145			
<i>Surrogate: 4-Bromofluorobenzene</i>	1.91		"	2.50		76	60-120			
<i>Surrogate: Dibromofluoromethane</i>	2.74		"	2.50		110	75-130			
<i>Surrogate: Toluene-d8</i>	2.41		"	2.50		96	70-130			

LCS (6J15003-BS1)

Prepared & Analyzed: 10/15/06

tert-Amyl methyl ether	53.3	0.50	ug/l	50.0		107	65-135			
tert-Butyl alcohol	1100	20	"	1000		110	60-135			
Di-isopropyl ether	55.8	0.50	"	50.0		112	70-130			
1,2-Dibromoethane (EDB)	9.80	0.50	"	10.0		98	80-125			
1,2-Dichloroethane	10.6	0.50	"	10.0		106	75-125			
Ethanol	1510	100	"	1000		151	15-150			QC01
Ethyl tert-butyl ether	56.5	0.50	"	50.0		113	65-130			
Methyl tert-butyl ether	52.0	0.50	"	50.0		104	50-140			
<i>Surrogate: 1,2-Dichloroethane-d4</i>	2.64		"	2.50		106	60-145			
<i>Surrogate: 4-Bromofluorobenzene</i>	2.25		"	2.50		90	60-120			
<i>Surrogate: Dibromofluoromethane</i>	2.60		"	2.50		104	75-130			
<i>Surrogate: Toluene-d8</i>	2.53		"	2.50		101	70-130			

Matrix Spike (6J15003-MS1)

Source: MPJ0413-01

Prepared & Analyzed: 10/15/06

tert-Amyl methyl ether	54.9	0.50	ug/l	50.0	ND	110	65-135			
tert-Butyl alcohol	1070	20	"	1000	ND	107	60-135			
Di-isopropyl ether	57.4	0.50	"	50.0	ND	115	70-130			
1,2-Dibromoethane (EDB)	10.1	0.50	"	10.0	ND	101	80-125			

Environmental Resolutions (Exxon)
601 North McDowell Blvd.
Petaluma CA, 94954

Project: Exxon 7-3006
Project Number: 7-3006
Project Manager: Paula Sime

MPJ0413
Reported:
10/25/06 11:10

Volatile Organic Compounds by EPA Method 8260B - Quality Control
TestAmerica - Morgan Hill, CA

Analyte	Result	Evaluation Limit	Units	Spike Level	Source Result	%REC	%REC Limits	RPD	RPD Limit	Notes
---------	--------	------------------	-------	-------------	---------------	------	-------------	-----	-----------	-------

Batch 6J15003 - EPA 5030B P/T

Matrix Spike (6J15003-MS1)

Source: MPJ0413-01

Prepared & Analyzed: 10/15/06

1,2-Dichloroethane	12.6	0.50	ug/l	10.0	2.3	103	75-125			
Ethanol	1430	100	"	1000	ND	143	15-150			
Ethyl tert-butyl ether	57.5	0.50	"	50.0	ND	115	65-130			
Methyl tert-butyl ether	139	0.50	"	50.0	98	82	50-140			
<i>Surrogate: 1,2-Dichloroethane-d4</i>	2.62		"	2.50		105	60-145			
<i>Surrogate: 4-Bromofluorobenzene</i>	2.20		"	2.50		88	60-120			
<i>Surrogate: Dibromofluoromethane</i>	2.62		"	2.50		105	75-130			
<i>Surrogate: Toluene-d8</i>	2.55		"	2.50		102	70-130			

Matrix Spike Dup (6J15003-MSD1)

Source: MPJ0413-01

Prepared & Analyzed: 10/15/06

tert-Amyl methyl ether	55.5	0.50	ug/l	50.0	ND	111	65-135	1	25	
tert-Butyl alcohol	1110	20	"	1000	ND	111	60-135	4	35	
Di-isopropyl ether	56.8	0.50	"	50.0	ND	114	70-130	1	35	
1,2-Dibromoethane (EDB)	10.0	0.50	"	10.0	ND	100	80-125	1	15	
1,2-Dichloroethane	12.5	0.50	"	10.0	2.3	102	75-125	0.8	10	
Ethanol	1500	100	"	1000	ND	150	15-150	5	35	
Ethyl tert-butyl ether	57.4	0.50	"	50.0	ND	115	65-130	0.2	35	
Methyl tert-butyl ether	139	0.50	"	50.0	98	82	50-140	0	25	
<i>Surrogate: 1,2-Dichloroethane-d4</i>	2.64		"	2.50		106	60-145			
<i>Surrogate: 4-Bromofluorobenzene</i>	2.26		"	2.50		90	60-120			
<i>Surrogate: Dibromofluoromethane</i>	2.66		"	2.50		106	75-130			
<i>Surrogate: Toluene-d8</i>	2.52		"	2.50		101	70-130			

Environmental Resolutions (Exxon)
601 North McDowell Blvd.
Petaluma CA, 94954

Project: Exxon 7-3006
Project Number: 7-3006
Project Manager: Paula Sime

MPJ0413
Reported:
10/25/06 11:10

Notes and Definitions

- QC01 The percent recovery was above the control limits.
- HC-17 Chromatogram Pattern: Diesel C10-C28
- HC-12 Hydrocarbon pattern is present in the requested fuel quantitation range but does not resemble the pattern of the requested fuel.
- HC-11 The result for this hydrocarbon is elevated due to the presence of single analyte peak(s) in the quantitation range.
- CF1 Primary and confirmation results varied by greater than 40% RPD.
- CC01 The result was reported with a possible high bias due to the continuing calibration verification falling outside acceptance criteria.
- DET Analyte DETECTED
- ND Analyte NOT DETECTED at or above the reporting limit
- NR Not Reported
- dry Sample results reported on a dry weight basis
- RPD Relative Percent Difference

TEST AMERICA SAMPLE RECEIPT LOG

CLIENT NAME: ERI / EXXON
REC. BY (PRINT) PH / EH
WORKORDER: MPJ0413

DATE REC'D AT LAB: 10/6/06
TIME REC'D AT LAB: 1845
DATE LOGGED IN: 10/9/06

For Regulatory Purposes?
DRINKING WATER YES / NO
WASTE WATER YES / NO

CIRCLE THE APPROPRIATE RESPONSE	LAB SAMPLE #	CLIENT ID	CONTAINER DESCRIPTION	PRESERVATIVE	pH	SAMPLE MATRIX	DATE SAMPLED	REMARKS: CONDITION (ETC.)
1. Custody Seal(s) Present / <input checked="" type="radio"/> Absent Intact / Broken*								<div style="transform: rotate(-45deg); font-size: 2em; font-weight: bold;"> SEE COC 10/7/06 PH/EH </div>
2. Chain-of-Custody <input checked="" type="radio"/> Present / Absent*								
3. Traffic Reports or Packing List: Present / <input checked="" type="radio"/> Absent								
4. Airbill: Airbill / Sticker Present / <input checked="" type="radio"/> Absent								
5. Airbill #:								
6. Sample Labels: <input checked="" type="radio"/> Present / Absent								
7. Sample IDs: <input checked="" type="radio"/> Listed / Not Listed on Chain-of-Custody								
8. Sample Condition: <input checked="" type="radio"/> Intact / Broken* / Leaking*								
9. Does information on chain-of-custody, traffic reports and sample labels agree? <input checked="" type="radio"/> Yes / No*								
10. Sample received within hold time? <input checked="" type="radio"/> Yes / No*								
11. Adequate sample volume received? <input checked="" type="radio"/> Yes / No*								
12. Proper preservatives used? <input checked="" type="radio"/> Yes / No*								
13. Trip Blank / Temp Blank Received? (circle which, if yes) Yes / <input checked="" type="radio"/> No*								
14. Read Temp: <u>3.1</u> Corrected Temp: <u>3.1</u> Is corrected temp 4 +/- 2°C? <input checked="" type="radio"/> Yes / No** <small>(Acceptance range for samples requiring thermal pres.)</small>								

**Exception (if any): METALS / DFF ON ICE
 or Problem COC

*IF CIRCLED, CONTACT PROJECT MANAGER AND ATTACH RECORD OF RESOLUTION.

ATTACHMENT D
WASTE DISPOSAL DOCUMENTATION

2010 13X

SHIPPER NO. **B** 023433

STRAIGHT BILL OF LADING—SHORT FORM—Original—Not Negotiable

CARRIER NO. _____

DATE: 10-6-06

ENVIRONMENTAL RESOLUTIONS

(SCAC)

CONSIGNEE ROMIC ENVIRONMENTAL TECHN. CORP. 2081 BAY ROAD EAST PALO ALTO, CA. 94303	FROM SHIPPER EXXON MOBIL CORPORATION C/O ERI 601 N. MCDOWELL BOULEVARD PETALUMA, CA. 94954	
ORIGIN	STATE	ZIP

DATE: _____ **U.S. DOT Hazmat Reg. No.** _____ **VEHICLE NUMBER** _____

Cap 981411085

NO. SHIPPING UNIT	HM UNIT	Description of articles, special marks, and exceptions	*WEIGHT (Subject to correction)	Class or Rate	CHARGES (For carrier use only)	Check column
		GROUNDWATER MONITORING WELL PURGE WATER PROFILE: 301580 HANDLING CODE: <u>H20</u> RECEIVED BY: <u>Andy Ly 10/9/06</u> PLACARDS TENDERED: YES _____ NO <input checked="" type="checkbox"/> PO# _____ EWR# _____ STORE NAME: <u>F-3006</u> STORE ADDRESS: <u>720 High St.</u> <u>Oakland, CA.</u>				

REMIT C.O.D. TO:	COD AMT: \$	C.O.D. Fee:
ADDRESS:		PREPAID <input type="checkbox"/>
CITY: _____ STATE _____ ZIP _____		COLLECT <input type="checkbox"/> \$

Note. - where the rate is dependent on value, shippers are required to state specifically in writing the agreed or declared value of the property.

The agreed or declared value of the property is hereby specifically stated by the shipper to be not exceeding _____ per _____

NOTE: Liability Limitation for loss or damage in this shipment may be applicable. See 49 U.S.C. 14706(c)(1)(A) and (B).

Subject to Section 7 of conditions of applicable bill of lading, if this shipment is to be delivered to the consignee without recourse on the consignor, the consignor shall sign the following statement:
The carrier shall not make delivery of this shipment without payment of freight and all other lawful charges.

(Signature of Consignor)

TOTAL CHARGES: \$

FREIGHT CHARGES

Freight Prepaid except when box at right is checked

Check box if charges to be collect

RECEIVED, subject to individually determined rates or contracts that have been agreed upon in writing between the carrier and shipper, if applicable, otherwise to the rates, classifications and rules that have been established by the carrier and are available to the shipper, on request; and all applicable state and federal regulations; the Property described below, in apparent good order, except as noted (contents and condition of contents of packages unknown), marked, consigned, and destined as indicated below which said company (the word company being understood throughout this contract as meaning any person or corporation in possession of the property under the contract) agrees to carry to delivery at said destination, if on its route, or otherwise deliver to another carrier on the route to said destination. It is mutually agreed as to each carrier of all or any portion of said route to destination and as to each party at any time interested in all or any of said Property that every service to be performed hereunder shall be subject to all the conditions not prohibited by law, whether printed or written, herein contained, including the conditions on the back hereof, which are hereby agreed to by the shipper and accepted for him and his assigns.

This is to certify that the above-named materials are properly classified, described, packaged, marked, and labeled, and are in proper condition for transportation according to the applicable regulations of the Department of Transportation PER:

SHIPPER: EXXON MOBIL REFINING & SUPPLIES	CARRIER: ENVIRONMENTAL RESOLUTIONS
PER: <u>on behalf of Exxon Mobil</u> <u>Don A. Nth.</u>	PER: <u>Don A. Nth.</u>
	DATE: <u>10-9-06</u>

EMERGENCY RESPONSE TELEPHONE NUMBER: () () ()

MONITORED AT ALL TIMES THE HAZARDOUS MATERIAL IS IN TRANSPORTATION INCLUDING STORAGE INCIDENTS TO TRANSPORTATION. (172.604)