



BP OIL

BP Oil Company  
16400 Southcenter Parkway, Suite 301  
Tukwila, Washington 98188  
(206) 575-4077

October 25, 1993

Alameda County Health Care Services Agency  
Division of Hazardous Materials  
Attention Ms. Juliet Shin  
80 Swan Way, Room 200  
Oakland, CA 94621

RE: BP Oil Site No. 11107  
18501 Hesperian Avenue  
San Lorenzo, CA

Dear Ms. Shin:

I am writing in response to your October 12, 1993 letter regarding the above-captioned site. You should note that we are experiencing difficulties in executing an appropriate off-site access agreement, and this has delayed the implementation of the workplan that you previously approved. We will keep you updated as developments warrant. Should you have any questions or concerns in the meantime, I hope that you will give me a call. I can be reached at (206) 394-5243.

Sincerely,

Scott T. Hooton  
Environmental Resources Management

attachment

cc: site file  
B. Nagle - ALISTO

**Ted Moise February 23, 1994 (Wednesday) 3:56pm**  
Project Number: 10-060

I called Juliet Shin, Her number is 271-4530 with the  
Alameda County Health Care Services Agency, Division of Hazardous Materials  
Department of Environmental Health  
80 Swan Way, Room 200, Oakland, California 94621

As per Scott Hooton's directions, I asked if she could help with offsite access from:

Owned by: Gehrke L. C. & Ronald & Conrad Iva J (trust)  
Kwik Mi Lady Cleaners  
16709 Cowell Street  
San Leandro, CA 94578

Phone number out of information is for a Mark Gehrke in San Leandro (276-2668), wrong guy.  
Juliet said she would look at the file, see if the well is needed, and get back to me for more info  
on Ronald and write a letter to him.

**Ted Moise March 1, 1994 (Tuesday) 9:16am**

I returned Juliet's call concerning the access, I gave her the Gehrke name, and said that I had  
not spoken to him, The BP lawyers handled it.

**Ted Moise March 1, 1994 (Tuesday) 11:25am**

I called Juliet Shin 271-4530 to return her call, She called Ron, Ron said he would talk with our  
attorney. Ron said he was treated better by Juliet than our attorney.

She sent a letter to Ron and we received a copy of the letter.

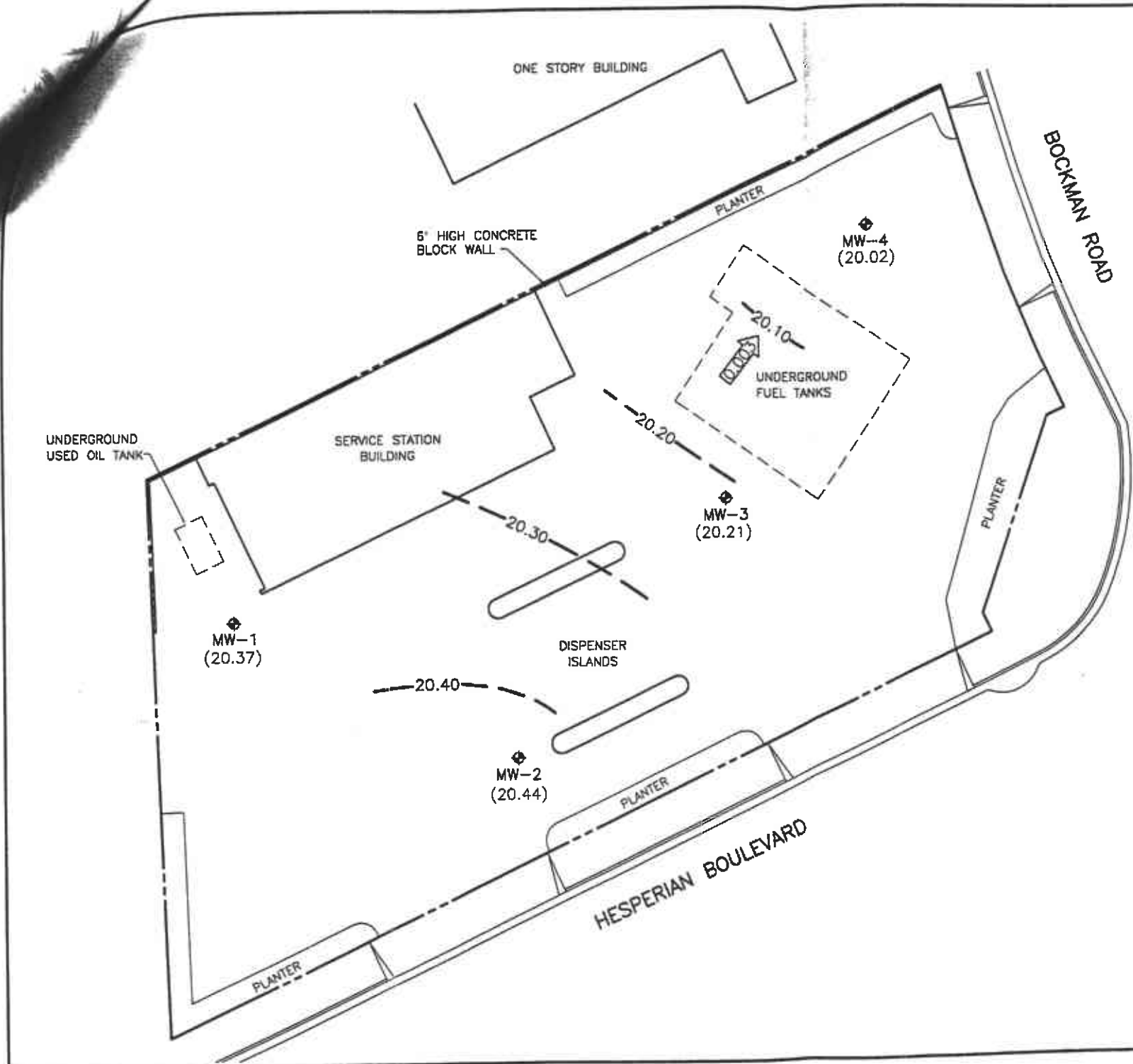

- LEGEND**
- ◆ GROUNDWATER MONITORING WELL
  - (20.02) GROUNDWATER ELEVATION IN FEET ABOVE MEAN SEA LEVEL
  - 20.10 - GROUNDWATER ELEVATION CONTOUR IN FEET ABOVE MEAN SEA LEVEL (CONTOUR INTERVAL - 0.10 FOOT)
  - ← 0.003 ← CALCULATED GROUNDWATER GRADIENT DIRECTION AND MAGNITUDE IN FOOT PER FOOT

**FIGURE 2**  
**POTENTIOMETRIC GROUNDWATER ELEVATION CONTOUR MAP**  
 FEBRUARY 24, 1994  
 BP OIL SERVICE STATION NO. 11107  
 18501 HESPERIAN BOULEVARD  
 SAN LORENZO, CALIFORNIA  
 PROJECT NO. 10-C60

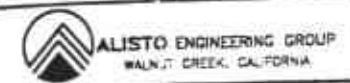

1000001-1002 3-11-94 0404 14-22

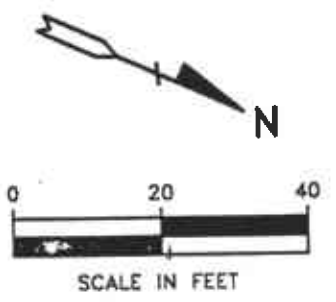
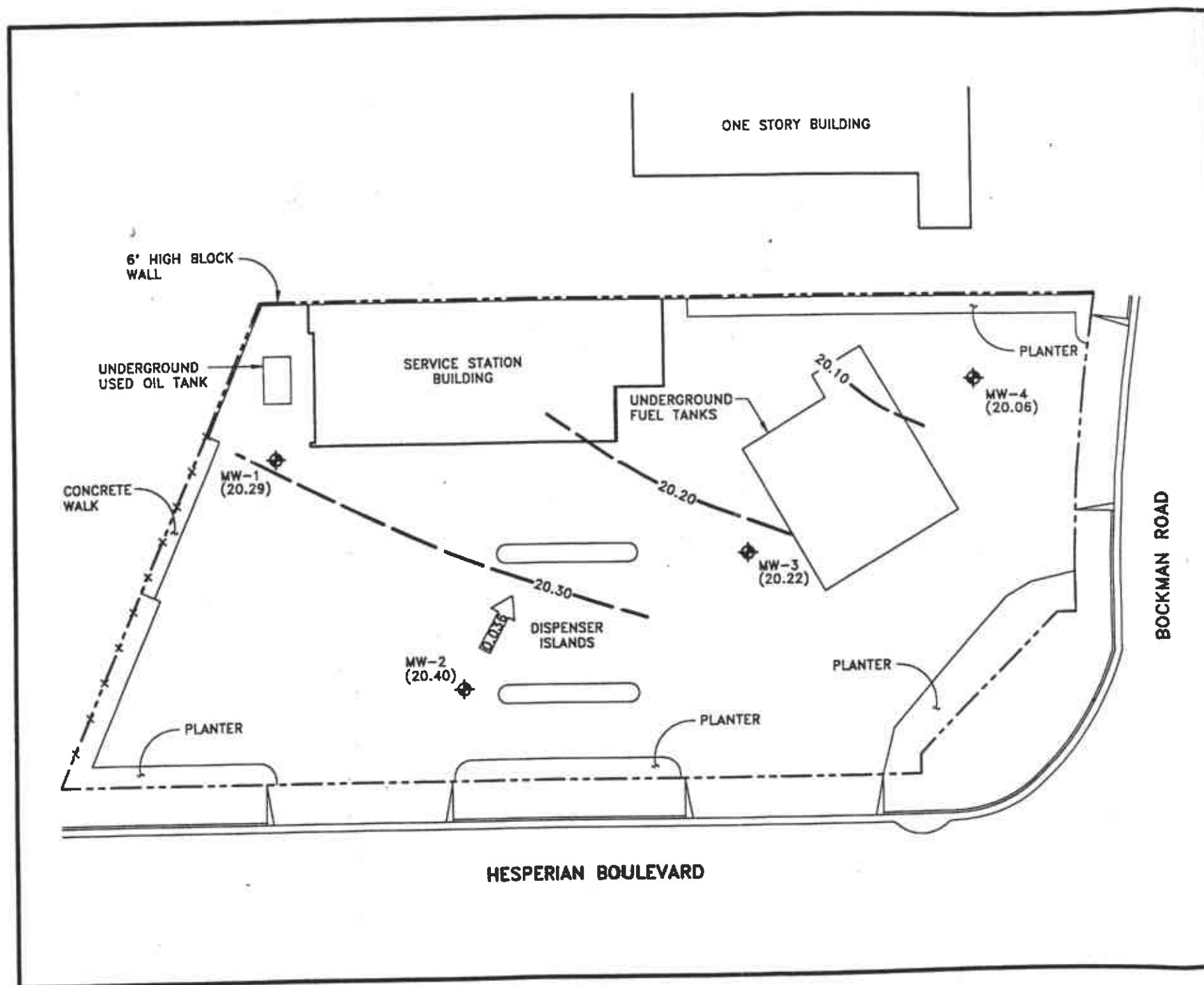

- LEGEND:**
- ◆ GROUNDWATER MONITORING WELL
  - (20.29) GROUNDWATER ELEVATION IN FEET ABOVE MEAN SEA LEVEL
  - 20.30 GROUNDWATER ELEVATION CONTOUR IN FEET ABOVE MEAN SEA LEVEL (CONTOUR INTERVAL - 0.10 FOOT)
  - 0.036 → CALCULATED GROUNDWATER GRADIENT DIRECTION AND MAGNITUDE

**FIGURE 2**  
**POTENTIOMETRIC GROUNDWATER ELEVATION CONTOUR MAP (NOVEMBER 4, 1992)**

BP OIL SERVICE STATION NO. 11107  
 18501 HESPERIAN BOULEVARD  
 SAN LORENZO, CALIFORNIA

PROJECT NO. 10-060

11-21-92 208 1x20