



94 JUL -7 PM 5:00

June 29, 1994

Juliet Shin
Alameda Health Care Services
Department of Environmental Health
80 Swan Way, Room 200
Oakland, CA 94621

Re: Shell Service Station
WIC #204-5510-0600
4255 MacArthur Blvd.
Oakland, California
WA Job #81-757-104

Dear Ms. Shin:

This letter describes recently completed and anticipated activities at the Shell service station referenced above (Figure 1). This status report satisfies the quarterly reporting requirements prescribed by California Administrative Code Title 23 Waters, Chapter 3, Subchapter 16, Article 5, Section 265.d. Included below are descriptions and results of activities performed in the second quarter 1994 and proposed work for the third quarter 1994.

Second Quarter 1994 Activities:

- On May 19, 1994, Weiss Associates (WA) submitted a workplan to the Alameda County Department of Environmental Health for additional investigation at the site. The workplan was approved on June 1, 1994.
- Blaine Tech Services, Inc. (BTS) of San Jose, California measured depths to ground water and collected ground water samples from the site wells. BTS' report describing these activities is included as Attachment A.
- WA compiled the ground water elevation and analytic data (Tables 1 and 2, respectively) and prepared a ground water elevation contour map (Figure 2).

Juliet Shin
June 29, 1994

Anticipated Third Quarter 1994 Activities:

WA will begin the field work and offsite survey according to the approved workplan.

WA will also submit a report presenting the results of the third quarter 1994 ground water sampling and ground water depth measurements. The report will include tabulated chemical analytic results and a ground water elevation contour map.

Please call if you have any questions.

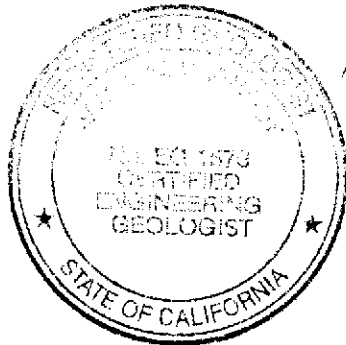

Sincerely,
Weiss Associates

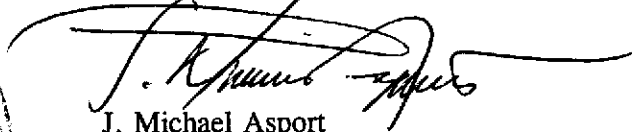

J. Michael Asport
Technical Assistant

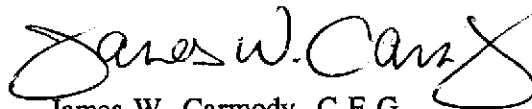

James W. Carmody, C.E.G.
Senior Project Hydrogeologist

JMA/JWC:mb

J:\SHELL\750\757QMJU4.WP

Attachments: A - BTS' Ground Water Monitoring Report

cc: Dan Kirk, Shell Oil Company, P.O.Box 5278, Concord, CA 94520
Lester Feldman, Regional Water Quality Control Board, San Francisco Bay Region
2101 Webster Street, Suite 500, Oakland, CA 94612

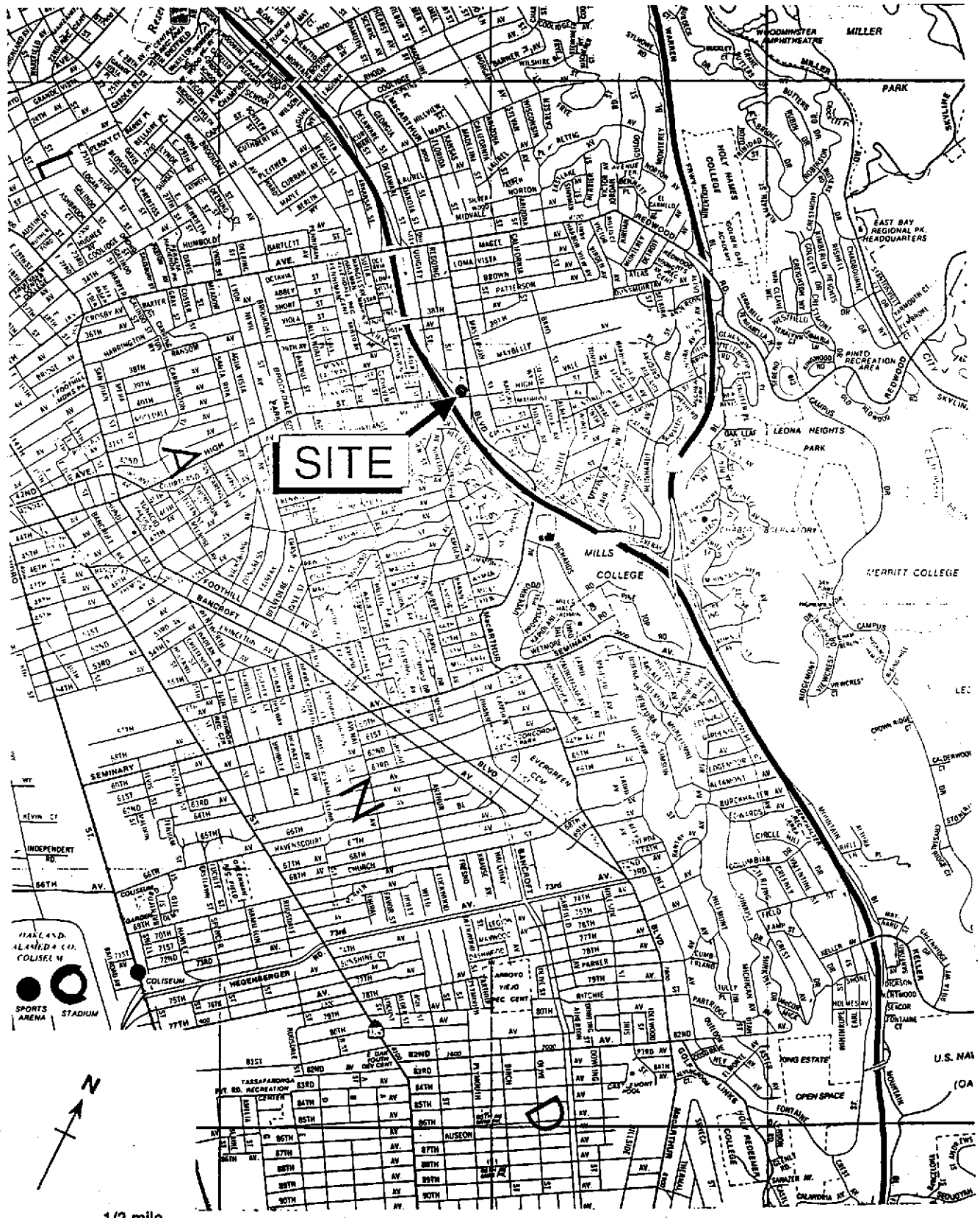

Figure 1. Site Location Map - Shell Service Station WIC# 204-5510-0600, 4255 MacArthur Boulevard, Oakland, California

EXPLANATION

- ⊙ MW-1 Monitoring well
- 168.16 Ground water elevation, feet above mean sea level (msl)
- 168 Ground water elevation contour, feet above msl, approximately located, dashed where inferred
- ← Inferred ground water flow direction

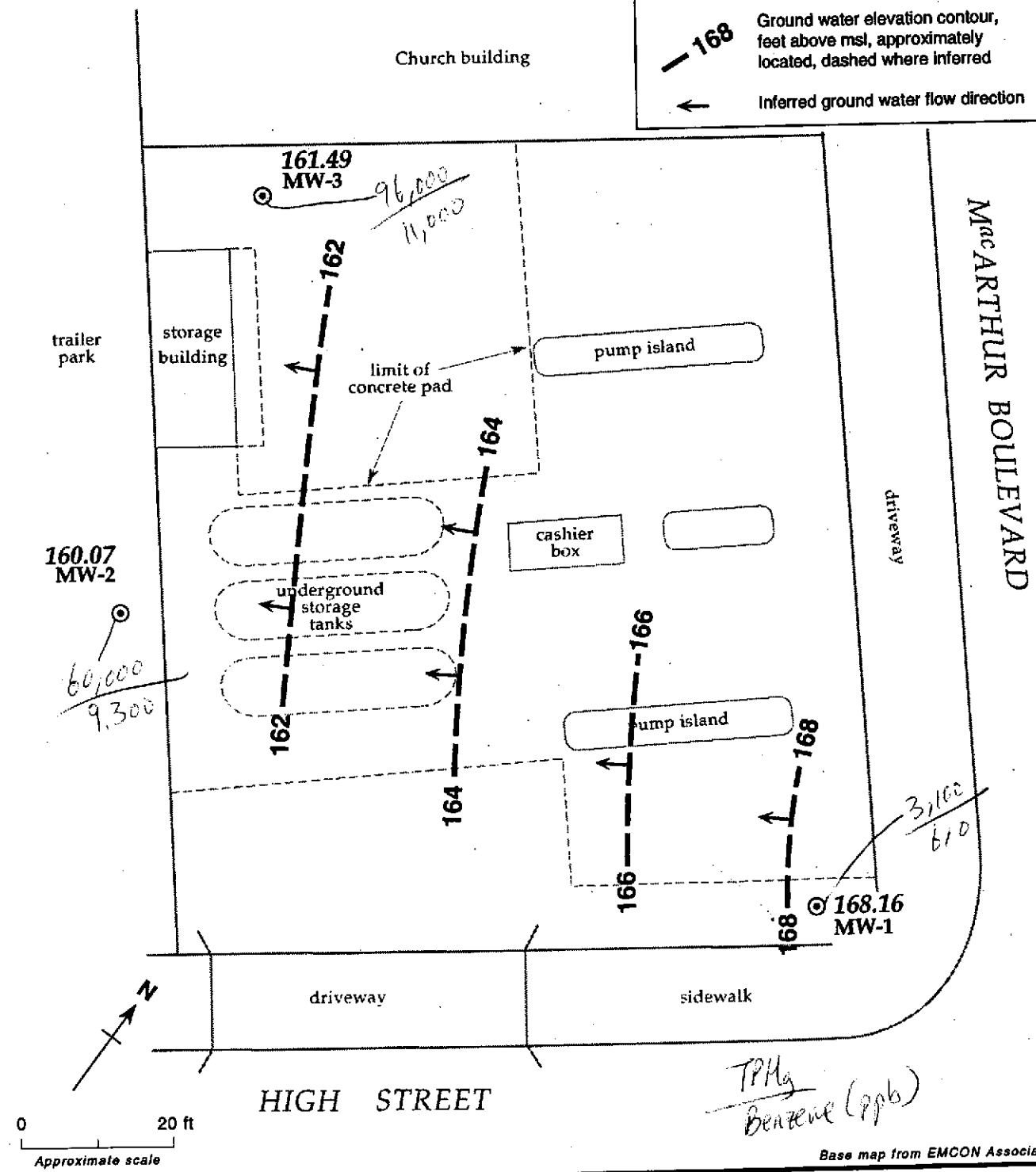

Figure 2. Monitoring Well Locations and Ground Water Elevation Contours - April 25, 1994
 Shell Service Station WIC #204-5510-0600, 4255 MacArthur Boulevard, Oakland, California

Table 1. Ground Water Elevations - Shell Service Station WIC #204-5510-0600, 4255 MacArthur Blvd., Oakland, California

Well ID	Date	Top-of-Casing Elevation (ft above msl)	Depth to Water (ft)	Ground Water Elevation (ft above msl)
MW-1	11/17/93	175.79	8.59	167.20
	01/20/94		8.22	167.57
	04/25/94		7.63	168.16
MW-2	11/17/93	170.91	12.31	158.60
	01/20/94		11.48	159.43
	04/25/94		10.84	160.07
MW-3	11/17/93	174.61	15.40	159.21
	01/20/94		14.61	160.00
	04/25/94		13.12	161.49

Odor observed in all 3 wells by Blaine