



COUNTY OF ALAMEDA
Assessor's Office
Property Value System

[Help](#)

[New Query](#)

[History](#)

[Value](#)

[Transfer](#)

[Map](#)

[Glossary](#)

Parcel Number: **30-1981-133** Inactive: **N** Lien Date: **01/01/2013** Owner: **PHUA HOI L & LINLI TRS**
 Property Address: **4255 MACARTHUR BLVD, OAKLAND, CA 94619**

Mailing Name		Historical Mailing Address	Document Date	Document Number	Value From Trans Tax	Parcel Count	Use
PHUA HOI L & LINLI TRS	List Owners	141 WOODLAND WAY , PIEDMONT, CA 94611-3839	03/21/2013	2013-104877		<u>2</u>	<u>3000</u>
PHUA HOI L & LEE LINLI	List Owners	141 WOODLAND WAY , PIEDMONT, CA 94611	03/21/2013	2013-104876		<u>2</u>	<u>3000</u>
PHUA HOI L	List Owners	141 WOODLAND WAY , PIEDMONT, CA 94611	03/11/2013	2013-92266		<u>2</u>	<u>3000</u>
PARRISH ERIC TR	List Owners	1359 NAPA VALLEY LN , EUGENE, OR 97404-3878	04/23/2012	2012-131792		<u>2</u>	<u>3000</u>
MALONE ROLAND C JR TR ETAL	List Owners	20997 REDWOOD RD , CASTRO VALLEY, CA 94546	03/07/2012	TRAN-267556		<u>1</u>	<u>3000</u>
MALONE ROLAND C JR TR	List Owners	1200 RUSSELL WAY # 319, HAYWARD, CA 94541-2893	01/03/2012	2012-299		<u>1</u>	<u>3000</u>
MALONE ROLAND C JR c/o SHELL OIL WSTRN TAX	List Owners	PO BOX 2099 , HOUSTON, TX 77252	09/30/1983	1983-183463		<u>1</u>	<u>8500</u>
MALONE ROLAND C JR	List Owners	4255 MACARTHUR BLVD , OAKLAND, CA 94619-1907	08/18/1976	1976-137812		<u>4</u>	<u>8500</u>
MALONE R C	List Owners	4255 MACARTHUR BLVD , OAKLAND, CA 94619-1907	03/01/1969	TRAN-32272		<u>1</u>	<u>8500</u>

All information on this site is to be assumed accurate for property assessment purposes only, and is based upon the

ASSESSOR'S MAP 30

Code Area Nos. 17-001

FREMONT TRACT (Bk. 26 Pg. 14) LOCKE TRACT (Bk. 24 Pg. 77) KEY ROUTE HEIGHTS (Bk. 25 Pg. 17)
POTTERS ADDITION TO VALLEY VIEW (Bk. 25 Pg. 20) SUTER TRACT (Bk. 13 Pg. 51)
QUIGLEY-SUBDIVISION OF PORTION (Bk. 4 Pg. 36) P.M. 3407 125/97

1981

Scale: 1"=100'

Drawn: 3-20-70 H.N. Revised: 3-26-80 B.M. 1-27-10 H.N.
5-26-85 B.S. L.R.
5-7-92 J.T.
3-15-08 C.C.

Formerly: Bk. 30 - Bks. 1916, 1918 Bk. 31 - Bks. 1951, 1994, 1996, 1996, 1997, 1999, 2005, 2006 (Part)

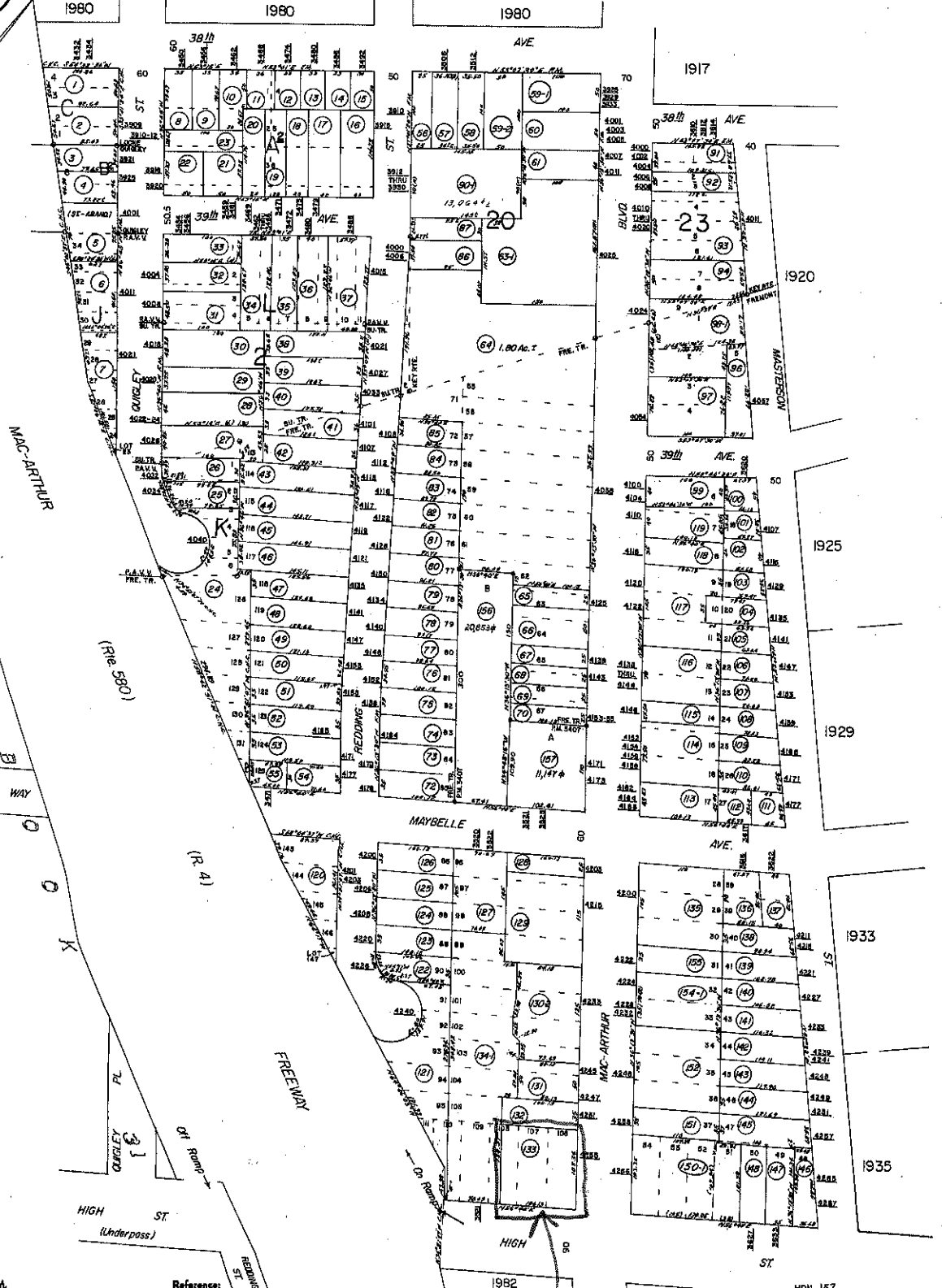

A.C.M.

Reference:

Site

HPN 157