

Wickham, Jerry, Env. Health

From: Wickham, Jerry, Env. Health
Sent: Monday, October 08, 2012 9:33 AM
To: Schaefer, Peter
Cc: denis.l.brown@shell.com; Cool, Aubrey; Project Email Hold; Lewis, Scott
Subject: RE: RO0486-4255 MacArthur Blvd., Oakland - proposed SV probe locations ~COR-240524~
Attachments: RO409WP_ADEND_R_2012-08-27.pdf

Peter,

These locations appear to be acceptable. I am attaching a Work Plan Addendum for the Unocal site across MacArthur that includes historic Sanborn maps for the area. You may want to review these locations for historic features.

Regards,
Jerry Wickham
Alameda County Environmental Health

From: Schaefer, Peter [pschaefer@croworld.com]
Sent: Friday, October 05, 2012 6:59 AM
To: Wickham, Jerry, Env. Health
Cc: denis.l.brown@shell.com; Cool, Aubrey; Project Email Hold; Lewis, Scott
Subject: RO0486-4255 MacArthur Blvd., Oakland - proposed SV probe locations ~COR-240524~

Jerry,

Per our telephone conversation on September 25, 2012, here is a draft figure showing 4 additional proposed nested soil vapor probe locations in the southern portion of the site. If the locations are acceptable, I will submit a short addendum to CRA's May 25, 2012 *Subsurface Investigation Work Plan* formalizing the proposal. We would like to include installing and sampling the additional on-site probes in our upcoming soil vapor investigation at the adjacent off-site properties.

Regards,

Peter Schaefer, CEG, CHG
Conestoga-Rovers & Associates
5900 Hollis Avenue, Suite A
Emeryville, California 94608-2008
Telephone: (510) 420-3319
Fax: (510) 420-9170
pschaefer@croworld.com

Think before you print

Perform every task the safe way, the right way, every time!



EXPLANATION

- SVP-16 Proposed sub-slab soil vapor probe location
- SVP-13 Proposed soil vapor probe location
- SVP-9 Temporary soil vapor probe location
- SB-9 Soil boring location (Shell)
- SVP-1 Soil vapor probe location (Shell)
- MW-1 Monitoring well location (Shell)
- MW-1B Monitoring well location (ConocoPhillips)
- SVW-1 Soil vapor well location (ConocoPhillips)
- TB-1 Destroyed well location

- Storm drain line (STM)
- Sanitary sewer line (SAN)
- Water line (W)

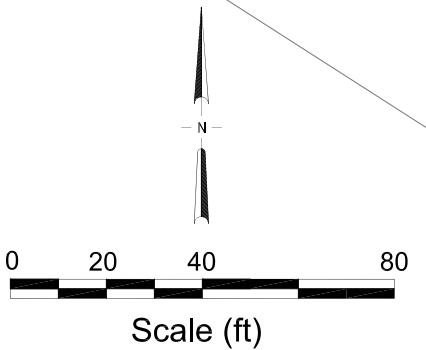
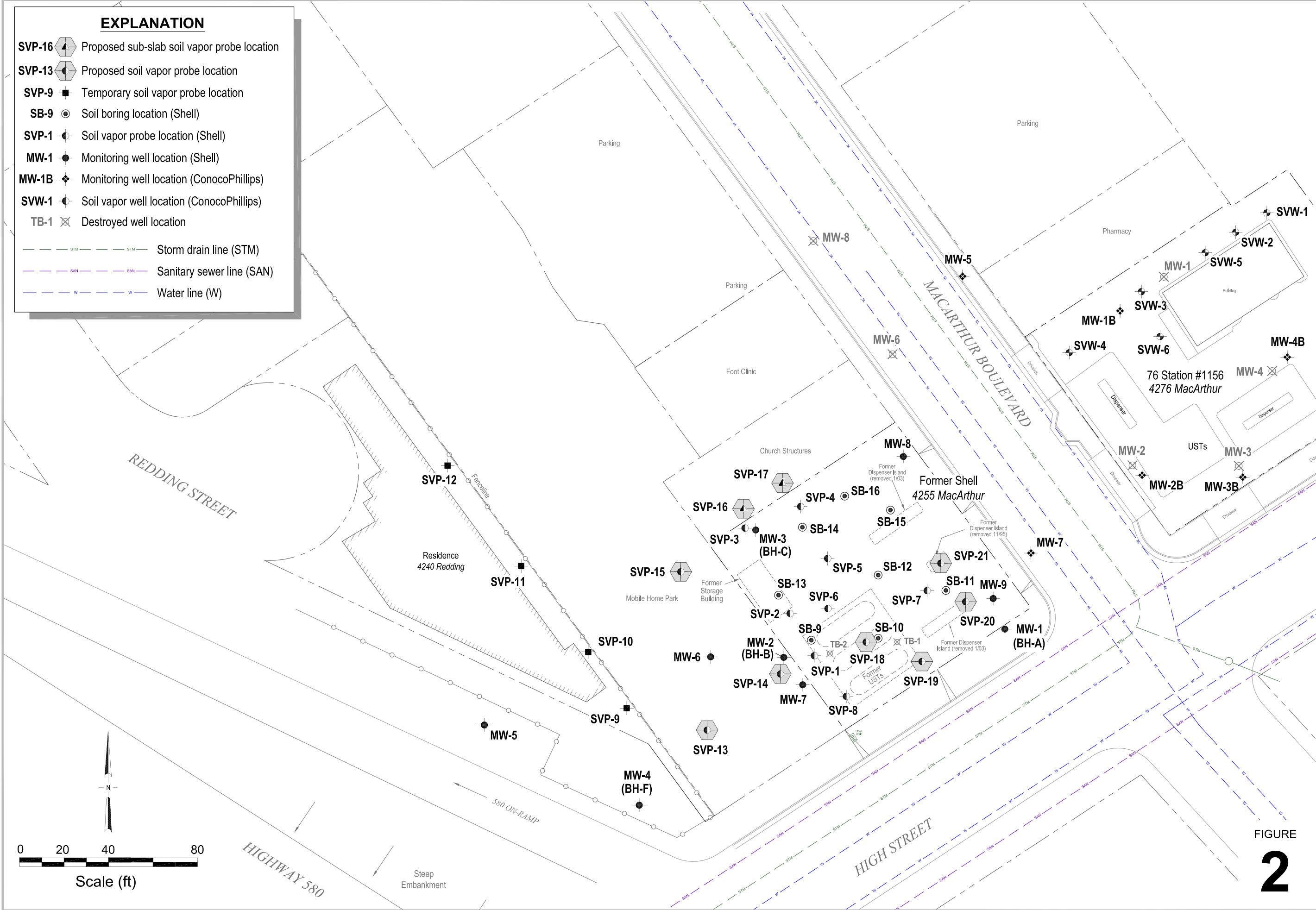

FIGURE
2

I:\Shell\6-chars\2405-1\240524-Oakland 4255 MacArthur\240524-FIGURES\240524 SITE PLAN.DWG