

91 FEB -8 AM 10: 59

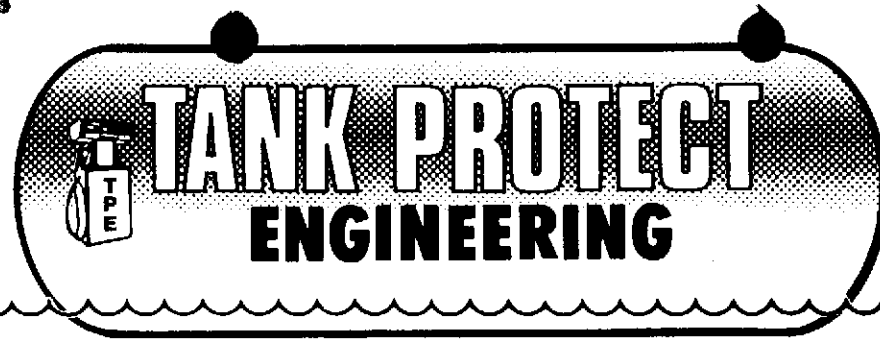

(415) 429-8088
(800) 523-8088
FAX (415) 429-8089

Of Northern California

February 7, 1991

*Called Mr. Smith & spoke w/ Mr. Bin
about the investigation
left message with her, he will call
me*

Mr. Paul Smith
Alameda County Health Care Services Agency
Department of Environmental Health
Hazardous Materials Division
80 Swan Way, Room 200
Oakland, CA 94621

Re: Laboratory Analytical Results, Oakland Auto Parts & Tires,
706 Harrison Street, Oakland, CA 94612.

Dear Mr. Smith:

Enclosed please find copies of laboratory analytical results,
Chain-of-Custody documentation, Underground Storage Tank
Unauthorized Release(Leak)/Contamination Site Report for the
subject site, and a copy of site plan.

If you have any questions with regard to this report, please feel
free to contact us at your convenience.

Sincerely,

TANK PROTECT ENGINEERING

UNDERGROUND STORAGE TANK UNAUTHORIZED RELEASE (LEAK) / CONTAMINATION SITE REPORT

EMERGENCY <input type="checkbox"/> YES <input checked="" type="checkbox"/> NO		HAS STATE OFFICE OF EMERGENCY SERVICES REPORT BEEN FILED? <input type="checkbox"/> YES <input checked="" type="checkbox"/> NO		FOR LOCAL AGENCY USE ONLY I HEREBY CERTIFY THAT I AM A DESIGNATED GOVERNMENT EMPLOYEE AND THAT I HAVE REPORTED THIS INFORMATION TO LOCAL OFFICIALS PURSUANT TO SECTION 25180.7 OF THE HEALTH AND SAFETY CODE. SIGNED: <u>Paul M. Smith</u> DATE: <u>2/17/91</u>	
REPORT DATE 0 m 2 m 0 d 6 d 9 y 1 y		CASE # _____			
REPORTED BY	NAME OF INDIVIDUAL FILING REPORT Marc Zomorodi		PHONE (415) 429-8088		SIGNATURE 
	REPRESENTING <input type="checkbox"/> LOCAL AGENCY <input checked="" type="checkbox"/> OWNER/OPERATOR <input type="checkbox"/> REGIONAL BOARD		COMPANY OR AGENCY NAME Tank Protect Engineering of Northern Calif.		
	ADDRESS 2821 Whipple Road Union City CA 94587				
RESPONSIBLE PARTY	NAME Oakland Auto Parts & Tires <input type="checkbox"/> UNKNOWN		CONTACT PERSON Bo Gin		PHONE (415) 763-2096
	ADDRESS 288-11th Street Oakland CA 94612				
SITE LOCATION	FACILITY NAME (IF APPLICABLE) Oakland Auto Parts & Tires		OPERATOR Bo Gin		PHONE (415) 763-2096
	ADDRESS 706 Harrison Street Oakland CA 94612				
	CROSS STREET 7th Street				
IMPLEMENTING AGENCIES	LOCAL AGENCY Alameda County Health Agency		CONTACT PERSON Paul Smith		PHONE (415) 271-4320
	REGIONAL BOARD S.F. Bay Region		PHONE (415) 454-1255		
SUBSTANCES INVOLVED	(1) NAME QUANTITY LOST (GALLONS) Petroleum Hydrocarbons - See below _____ <input type="checkbox"/> UNKNOWN				
	(2) _____ <input type="checkbox"/> UNKNOWN				
DISCOVERY/ABATEMENT	DATE DISCOVERED 0 m 1 m 10 d 7 d 9 y 1 y		HOW DISCOVERED <input type="checkbox"/> INVENTORY CONTROL <input type="checkbox"/> SUBSURFACE MONITORING <input type="checkbox"/> NUISANCE CONDITIONS <input type="checkbox"/> TANK TEST <input checked="" type="checkbox"/> TANK REMOVAL <input type="checkbox"/> OTHER _____		
	DATE DISCHARGE BEGAN _____ <input checked="" type="checkbox"/> UNKNOWN		METHOD USED TO STOP DISCHARGE (CHECK ALL THAT APPLY) <input checked="" type="checkbox"/> REMOVE CONTENTS <input type="checkbox"/> REPLACE TANK <input type="checkbox"/> CLOSE TANK <input type="checkbox"/> REPAIR TANK <input type="checkbox"/> REPAIR PIPING <input type="checkbox"/> CHANGE PROCEDURE <input checked="" type="checkbox"/> OTHER Remove tank(s)		
	HAS DISCHARGE BEEN STOPPED? <input type="checkbox"/> YES <input type="checkbox"/> NO IF YES, DATE _____				
SOURCE/CAUSE	SOURCE OF DISCHARGE <input type="checkbox"/> TANK LEAK <input checked="" type="checkbox"/> UNKNOWN <input type="checkbox"/> PIPING LEAK <input type="checkbox"/> OTHER _____		CAUSE(S) <input type="checkbox"/> OVERFILL <input type="checkbox"/> RUPTURE/FAILURE <input type="checkbox"/> SPILL <input type="checkbox"/> CORROSION <input type="checkbox"/> UNKNOWN <input type="checkbox"/> OTHER _____		
	CHECK ONE ONLY <input checked="" type="checkbox"/> UNDETERMINED <input type="checkbox"/> SOIL ONLY <input type="checkbox"/> GROUNDWATER <input type="checkbox"/> DRINKING WATER - (CHECK ONLY IF WATER WELLS HAVE ACTUALLY BEEN AFFECTED)				
CURRENT STATUS	CHECK ONE ONLY <input checked="" type="checkbox"/> NO ACTION TAKEN <input type="checkbox"/> PRELIMINARY SITE ASSESSMENT WORKPLAN SUBMITTED <input type="checkbox"/> POLLUTION CHARACTERIZATION <input type="checkbox"/> LEAK BEING CONFIRMED <input type="checkbox"/> PRELIMINARY SITE ASSESSMENT UNDERWAY <input type="checkbox"/> POST CLEANUP MONITORING IN PROGRESS <input type="checkbox"/> REMEDIATION PLAN <input type="checkbox"/> CASE CLOSED (CLEANUP COMPLETED OR UNNECESSARY) <input type="checkbox"/> CLEANUP UNDERWAY				
	CHECK APPROPRIATE ACTION(S) (SEE BACK FOR DETAILS)				
	<input type="checkbox"/> EXCAVATE & DISPOSE (ED) <input type="checkbox"/> REMOVE FREE PRODUCT (FP) <input type="checkbox"/> ENHANCED BIO DEGRADATION (IT) <input type="checkbox"/> CAP SITE (CD) <input type="checkbox"/> EXCAVATE & TREAT (ET) <input type="checkbox"/> PUMP & TREAT GROUNDWATER (GT) <input type="checkbox"/> REPLACE SUPPLY (RS) <input type="checkbox"/> CONTAINMENT BARRIER (CB) <input type="checkbox"/> NO ACTION REQUIRED (NA) <input type="checkbox"/> TREATMENT AT HOOKUP (HU) <input type="checkbox"/> VENT SOIL (VS) <input type="checkbox"/> VACUUM EXTRACT (VE) <input type="checkbox"/> OTHER (OT) _____				
COMMENTS	Four 1,000 gallon gasoline, 2 - 6,000 gallon gasoline and 1 - 150 gallon waste oil tanks were removed.				

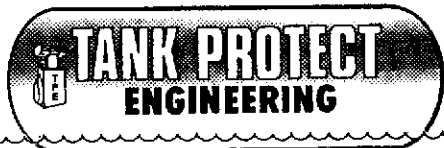

2821 Whipple Road
Union City, California

x = 200 ppm 016

values in ppm

(415) 429-8088
(800) 523-8088
FAX (415) 429-8089

DATE _____

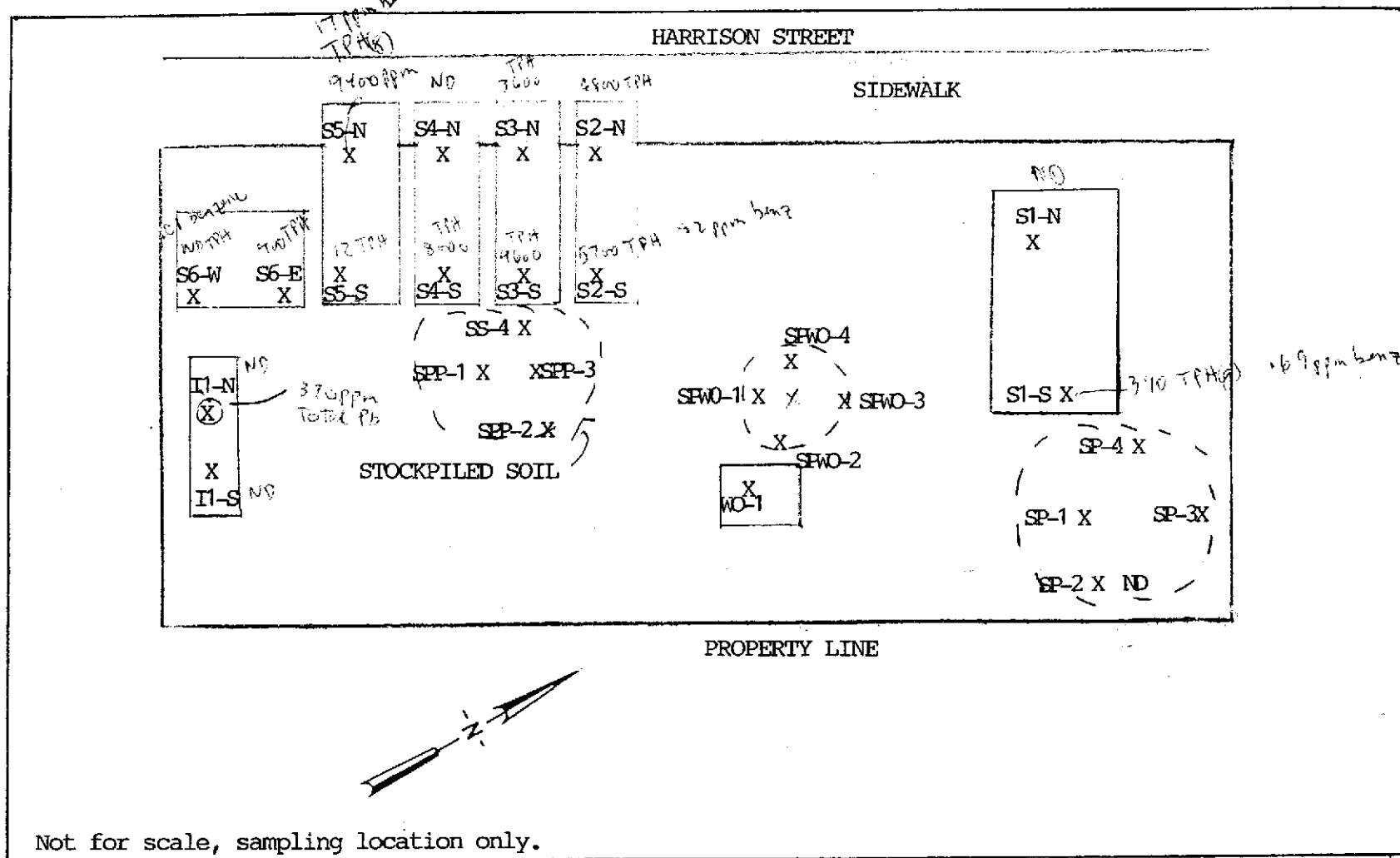

ADDITIONAL INFORMATION:

PLOT PLAN

CLIENT: NAME, ADDRESS AND PHONE

706 Harrison Street
Oakland, CA



SEQUOIA ANALYTICAL

1900 Bates Avenue • Suite LM • Concord, California 94520
(415) 686-9600 • FAX (415) 686-9689

Tank Protect Engineering of N. Calif Client Project ID: #123A-011791-2	Matrix Descript: Soil	Sampled: [REDACTED]
2821 Whipple Road	Analysis Method: EPA 5030/8015/8020	Received: Jan 22, 1991
Union City, CA 94587	First Sample #: 101-0544 A-D	Analyzed: Jan 28, 1991
Attention: John Mrakovich		Reported: Feb 1, 1991

TOTAL PETROLEUM FUEL HYDROCARBONS with BTEX DISTINCTION (EPA 8015/8020)

Sample Number	Sample Description	Low/Medium B.P.	Benzene	Toluene	Ethyl	Xylenes
		Hydrocarbons			Benzene	
		mg/kg (ppm)	mg/kg (ppm)	mg/kg (ppm)	mg/kg (ppm)	mg/kg (ppm)
1010544 A-D	SP1-4	N.D.	N.D.	N.D.	N.D.	0.014
1010545 A-D	SPW01-4	N.D.	0.016	0.016	N.D.	0.022
1010546 A-D	SPP1-4	30	0.0094	0.012	0.15	1.3

Detection Limits:	1.0	0.0050	0.0050	0.0050	0.0050
-------------------	-----	--------	--------	--------	--------

Low to Medium Boiling Point Hydrocarbons are quantitated against a gasoline standard.
Analytes reported as N.D. were not present above the stated limit of detection.

SEQUOIA ANALYTICAL

Belinda C. Vega
Belinda C. Vega
Laboratory Director



SEQUOIA ANALYTICAL

1900 Bates Avenue • Suite LM • Concord, California 94520
(415) 686-9600 • FAX (415) 686-9689

Tank Protect Engineering of N. Calif Client Project ID: #123A-011791-2	Matrix Descript: Soil	Sampled: Jan 17, 1991
2821 Whipple Road	Analysis Method: EPA 3550/8015	Received: Jan 22, 1991
Union City, CA 94587	First Sample #: 101-0545 A-D	Extracted: Jan 29, 1991
Attention: John Mrakovich		Analyzed: Jan 31, 1991
		Reported: Feb 1, 1991

TOTAL PETROLEUM FUEL HYDROCARBONS (EPA 8015)

Sample Number	Sample Description	High B.P. Hydrocarbons mg/kg (ppm)
1010545 A-D	SPW01-4	3.2

Detection Limits:

1.0

High Boiling Point Hydrocarbons are quantitated against a diesel fuel standard.
Analytes reported as N.D. were not present above the stated limit of detection.

SEQUOIA ANALYTICAL

Belinda C. Vega
Laboratory Director

1010544.TPE <2>



SEQUOIA ANALYTICAL

1900 Bates Avenue • Suite LM • Concord, California 94520
(415) 686-9600 • FAX (415) 686-9689

Tank Protect Engineering of N. Calif Client Project ID: #123A-011791-2
2821 Whipple Road Matrix Descript: Soil
Union City, CA 94587 Analysis Method: SM 5620 E&F (Gravimetric)
Attention: John Mrakovich First Sample #: 101-0545 A-D

Sampled: Jan 17, 1991
Received: Jan 22, 1991
Extracted: Jan 25, 1991
Analyzed: Jan 28, 1991
Reported: Feb 1, 1991

TOTAL RECOVERABLE PETROLEUM OIL

Sample Number	Sample Description	Oil & Grease mg/kg (ppm)
---------------	--------------------	--------------------------------

1010545 A-D	SPWO1-4	200
-------------	---------	-----

Detection Limits:

30

Analytes reported as N.D. were not present above the stated limit of detection.

SEQUOIA ANALYTICAL

Belinda C. Vega
Laboratory Director

1010544.TPE <3>



SEQUOIA ANALYTICAL

1900 Bates Avenue • Suite LM • Concord, California 94520
(415) 686-9600 • FAX (415) 686-9689

Tank Protect Engineering of N. Calif	Client Project ID: #123A-011791-2	Sampled: Jan 17, 1991
2821 Whipple Road	Sample Descript: Soil SPW01-4	Received: Jan 22, 1991
Union City, CA 94587	Analysis Method: EPA 5030/8010	Analyzed: Jan 23, 1991
Attention: John Mrakovich	Lab Number: 101-0545 A-D	Reported: Feb 1, 1991

HALOGENATED VOLATILE ORGANICS (EPA 8010)

Analyte	Detection Limit µg/kg	Sample Results µg/kg
Bromodichloromethane.....	5.0	N.D.
Bromoform.....	5.0	N.D.
Bromomethane.....	5.0	N.D.
Carbon tetrachloride.....	5.0	N.D.
Chlorobenzene.....	5.0	N.D.
Chloroethane.....	25	N.D.
2-Chloroethylvinyl ether.....	5.0	N.D.
Chloroform.....	5.0	N.D.
Chloromethane.....	5.0	N.D.
Dibromochloromethane.....	5.0	N.D.
1,2-Dichlorobenzene.....	10	N.D.
1,3-Dichlorobenzene.....	10	N.D.
1,4-Dichlorobenzene.....	10	N.D.
1,1-Dichloroethane.....	5.0	N.D.
1,2-Dichloroethane.....	5.0	N.D.
1,1-Dichloroethene.....	5.0	N.D.
Total 1,2-Dichloroethene.....	5.0	N.D.
1,2-Dichloropropane.....	5.0	N.D.
cis-1,3-Dichloropropene.....	5.0	N.D.
trans-1,3-Dichloropropene.....	5.0	N.D.
Methylene chloride.....	10	N.D.
1,1,2,2-Tetrachloroethane.....	5.0	N.D.
Tetrachloroethene.....	5.0	N.D.
1,1,1-Trichloroethane.....	5.0	N.D.
1,1,2-Trichloroethane.....	5.0	N.D.
Trichloroethene.....	5.0	N.D.
Trichlorofluoromethane.....	5.0	N.D.
Vinyl chloride.....	10	N.D.

Analytes reported as N.D. were not present above the stated limit of detection.

SEQUOIA ANALYTICAL

Belinda C. Vega
 Belinda C. Vega
 Laboratory Director



SEQUOIA ANALYTICAL

1900 Bates Avenue • Suite LM • Concord, California 94520
(415) 886-9600 • FAX (415) 886-9689

Tank Protect Engineering of N. Calif Client Project ID: #123A-011791-2
2821 Whipple Road Sample Descript: Soil
Union City, CA 94587 Analysis for: Total Lead
Attention: John Mrakovich First Sample #: 101-0544 A-D

Sampled: Jan 17, 1991
Received: Jan 22, 1991
Extracted: Jan 25, 1991
Analyzed: Jan 30, 1991
Reported: Feb 1, 1991

LABORATORY ANALYSIS FOR: Total Lead

Sample Number	Sample Description	Detection Limit mg/kg	Sample Result mg/kg
1010544 A-D	SP1-4	0.50	31
1010545 A-D	SPWO1-4	5.0	430 <i>TTLC</i>

Analytes reported as N.D. were not present above the stated limit of detection.

SEQUOIA ANALYTICAL

Belinda C. Vega
Belinda C. Vega
Laboratory Director



SEQUOIA ANALYTICAL

1900 Bates Avenue • Suite LM • Concord, California 94520
(415) 686-9600 • FAX (415) 686-9689

Tank Protect Engineering of N. Calif Client Project ID: #123A-011791-2	Sampled: Jan 17, 1991
2821 Whipple Road	Received: Jan 22, 1991
Union City, CA 94587	Extracted: Jan 25, 1991
Attention: John Mrakovich	Analyzed: 1/29-2/1/91
Sample Descript: Soil SPWO1-4	Reported: Feb 1, 1991
Lab Number: 101-0545 A-D	

LABORATORY ANALYSIS

Analyte	Detection Limit mg/kg	Sample Results mg/kg
Cadmium	0.50	N.D.
Chromium	2.5	5.5
Nickel	2.5	14
Zinc	50	380

Analytes reported as N.D. were not present above the stated limit of detection.

SEQUOIA ANALYTICAL

Belinda C. Vega
Laboratory Director



TANK PROTECT ENGINEERING

2021 WHIPPLE ROAD
 UNION CITY, CA 94587
 (415) 429-8088
 (800) 523-8080
 FAX (415) 429-8089

CHAIN OF CUSTODY

Page 1 OF 2

PROJECT NO.		SITE NAME & ADDRESS				(1) TYPE OF CONTAINER	ANALYTES REQUESTED							REMARKS
SAMPLER NAME, ADDRESS AND TELEPHONE NUMBER		SAMPLING LOCATION					TOTAL LIGHT BC	AROMATIC BC	TOTAL HEAVY BC	OIL & GREASE	PCB SCAN (624.9)	OTHER		
ID NO.	DATE	TIME	SOIL	WATER	SAMPLING LOCATION									
123A-011791-2 BOGIN		706 Harrison St. Oakland, Ca.												
TPE 2821 Whipple Rd. Union City, Ca. 94587														
SP-1	1/17/91	4:45	✓		Stock pile other tank							1010544 A-D Composite TPHE & BTEX & Total Lead (AA)		
SP-2	"	4:48	✓		" "									
SP-3	"	4:52	✓		" "									
SP-4	"	4:56	✓		" "									
SPWO-1	"	5:06	✓		Waste oil/stock pile							Composite All required analyses by Tri-Regional Lab. for waste oil 1010545 A-D gas/btex; diesel; TOG; 8010; Cd, Cr, Pb; Ni;		
SPWO-2	"	5:08	✓		"									
SPWO-3	"	5:11	✓		"									
SPWO-4	"	5:15	✓		"									
See next page														
Relinquished by: (Signature)		Date / Time		Received by: (Signature)		Relinquished by: (Signature)		Date / Time		Received by: (Signature)				
<i>[Signature]</i>		1-22-91 12:20 PM		<i>Patrick Hook</i>										
Relinquished by: (Signature)		Date / Time		Received by: (Signature)		Relinquished by: (Signature)		Date / Time		Received by: (Signature)				
<i>Patrick Hook</i>		1-22-91 11:10 AM		<i>[Signature]</i>										
Relinquished by: (Signature)		Date / Time		Received for laboratory by: (Signature)		Date / Time		Remarks						
				<i>[Signature]</i>		1/22 11:10 AM								

DATE: _____



TANK PROTECT ENGINEERING

2821 WHIPPLE ROAD
 UNION CITY, CA 94507
 (415) 429-8088
 (800) 523-8088
 FAX (415) 429-8089

CHAIN OF CUSTODY

Page 2 OF 2

PROJECT NO.		SITE NAME & ADDRESS				(1) TYPE OF CONTAINER	ANALYTES REQUESTED						REMARKS
SAMPLER NAME, ADDRESS AND TELEPHONE NUMBER		SAMPLING LOCATION					TOTAL LIGHT HC	AROMATIC HC	TOTAL HEAVY HC	OIL & GREASE	VOC SOLUB (624-2)	OTHER	
ID NO.	DATE	TIME	SOIL	WATER									
3A-01791-2 BD Gin		706 Harrison St. Oakland, Ca											
TPE 2821 Whipple Rd. Union City, Ca 94587		Stockpile b/t #1										Composite 1010546 D-D TPH G & BTEX	
SPP-1	1/7/91	5:20	✓										
SPP-2	"	5:22	✓										
SPP-3	"	5:23	✓										
SPP-4	"	5:25	✓										
Relinquished by: (Signature)		Date / Time		Received by: (Signature)		Relinquished by: (Signature)		Date / Time		Received by: (Signature)			
<i>[Signature]</i>		1-22-91/12:20 PM		<i>[Signature]</i>									
Relinquished by: (Signature)		Date / Time		Received by: (Signature)		Relinquished by: (Signature)		Date / Time		Received by: (Signature)			
<i>[Signature]</i>		1-22-91/1:15 PM											
Relinquished by: (Signature)		Date / Time		Received for Laboratory by: (Signature)		Date / Time		Remarks					

DATE: _____



SEQUOIA ANALYTICAL

1900 Bates Avenue • Suite LM • Concord, California 94520
(415) 686-9600 • FAX (415) 686-9689

Tank Protect Engineering of N. Calif	Client Project ID: #123A-011791-1	Sampled: [REDACTED]
2821 Whipple Road	Matrix Descript: Soil	Received: Jan 22, 1991
Union City, CA 94587	Analysis Method: EPA 5030/8015/8020	Analyzed: 1/29-1/30/91
Attention: Josie	First Sample #: 101-0527	Reported: Feb 5, 1991

TOTAL PETROLEUM FUEL HYDROCARBONS with BTEX DISTINCTION (EPA 8015/8020)

Sample Number	Sample Description	Low/Medium B.P. Hydrocarbons	Benzene	Toluene	Ethyl Benzene	Xylenes
		mg/kg (ppm)	mg/kg (ppm)	mg/kg (ppm)	mg/kg (ppm)	mg/kg (ppm)
101-0527	S1-S	390	0.69	0.56	3.1	8.7

Detection Limits:	5.0	0.025	0.025	0.025	0.025
--------------------------	------------	--------------	--------------	--------------	--------------

Low to Medium Boiling Point Hydrocarbons are quantitated against a gasoline standard. Analytes reported as N.D. were not present above the stated limit of detection. Because matrix effects and/or other factors required additional sample dilution, detection limits for this sample have been raised.

SEQUOIA ANALYTICAL

Belinda C. Vega
Belinda C. Vega
Laboratory Director



SEQUOIA ANALYTICAL

1900 Bates Avenue • Suite LM • Concord, California 94520
(415) 686-9600 • FAX (415) 686-9689

Tank Protect Engineering of N. Calif	Client Project ID: #123A-011791-1	Sampled: Jan 17, 1991
2821 Whipple Road	Matrix Descript: Soil	Received: Jan 22, 1991
Union City, CA 94587	Analysis Method: EPA 5030/8015/8020	Analyzed: 1/29-1/30/91
Attention: Josie	First Sample #: 101-0528	Reported: Feb 5, 1991

TOTAL PETROLEUM FUEL HYDROCARBONS with BTEX DISTINCTION (EPA 8015/8020)

Sample Number	Sample Description	Low/Medium B.P.	Benzene		Ethyl	Xylenes
		Hydrocarbons	mg/kg	Toluene	Benzene	
		mg/kg	(ppm)	mg/kg	mg/kg	mg/kg
		(ppm)	(ppm)	(ppm)	(ppm)	(ppm)
101-0528	S1-N	N.D.	0.070	0.063	0.013	0.054
101-0530	S3-S	4,600	30	210	78	470
101-0531	S2-N	6,800	75	290	98	540
101-0532	S3-N	3,600	19	100	53	280
101-0533	S6-S	12	0.023	0.016	0.053	0.19
101-0534	S4-S	8,000	7.9	56	84	450
101-0535	S5-N	9,400	17	160	97	650
101-0536	S4-N	N.D.	0.013	0.010	N.D.	0.026
101-0537	S6-W	N.D.	0.010	0.010	N.D.	0.030
101-0538	S6-E	400	0.21	0.57	5.0	9.8

Detection Limits:	1.0	0.0050	0.0050	0.0050	0.0050
-------------------	-----	--------	--------	--------	--------

Low to Medium Boiling Point Hydrocarbons are quantitated against a gasoline standard.
Analytes reported as N.D. were not present above the stated limit of detection.

SEQUOIA ANALYTICAL

Belinda C. Vega
Laboratory Director



SEQUOIA ANALYTICAL

1900 Bates Avenue • Suite LM • Concord, California 94520
(415) 686-9600 • FAX (415) 686-9689

Tank Protect Engineering of N. Calif	Client Project ID: #123A-011791-1	Sampled: Jan 17, 1991
2821 Whipple Road	Matrix Descript: Soil	Received: Jan 22, 1991
Union City, CA 94587	Analysis Method: EPA 5030/8015/8020	Analyzed: Jan 30, 1991
Attention: Josie	First Sample #: 101-0539	Reported: Feb 5, 1991

TOTAL PETROLEUM FUEL HYDROCARBONS with BTEX DISTINCTION (EPA 8015/8020)

Sample Number	Sample Description	Low/Medium B.P. Hydrocarbons		Toluene mg/kg (ppm)	Ethyl Benzene mg/kg (ppm)	Xylenes mg/kg (ppm)
		mg/kg (ppm)	Benzene mg/kg (ppm)			
101-0539	11-N	N.D.	N.D.	0.0088	N.D.	0.022
101-0540	11-S	N.D.	0.0050	0.012	0.0092	0.050

Detection Limits:	1.0	0.0050	0.0050	0.0050	0.0050
-------------------	-----	--------	--------	--------	--------

Low to Medium Boiling Point Hydrocarbons are quantitated against a gasoline standard.
Analytes reported as N.D. were not present above the stated limit of detection.

SEQUOIA ANALYTICAL

Belinda C. Vega
Laboratory Director



SEQUOIA ANALYTICAL

1900 Bates Avenue • Suite LM • Concord, California 94520
(415) 688-9600 • FAX (415) 686-9689

Tank Protect Engineering of N. Calif Client Project ID: #123A-011791-1	Matrix Descript: Soil	Sampled: Jan 17, 1991
2821 Whipple Road	Analysis Method: EPA 5030/8015/8020	Received: Jan 22, 1991
Union City, CA 94587	First Sample #: 101-0529	Analyzed: 1/29-1/30/91
Attention: Josie		Reported: Feb 5, 1991

TOTAL PETROLEUM FUEL HYDROCARBONS with BTEX DISTINCTION (EPA 8015/8020)

Sample Number	Sample Description	Low/Medium B.P. Hydrocarbons		Ethyl Benzene Xylenes		
		mg/kg (ppm)	Benzene mg/kg (ppm)	Toluene mg/kg (ppm)	mg/kg (ppm)	mg/kg (ppm)
101-0529	S2-S	5,700	82	280	85	460

Detection Limits:	50	0.25	0.25	0.25	0.25
-------------------	----	------	------	------	------

Low to Medium Boiling Point Hydrocarbons are quantitated against a gasoline standard. Analytes reported as N.D. were not present above the stated limit of detection. Because matrix effects and/or other factors required additional sample dilution, detection limits for this sample have been raised.

SEQUOIA ANALYTICAL

Belinda C. Vega
Laboratory Director



SEQUOIA ANALYTICAL

1900 Bates Avenue • Suite LM • Concord, California 94520
(415) 886-9600 • FAX (415) 886-9689

Tank Protect Engineering of N. Calif Client Project ID: #123A-011791-1
2821 Whipple Road Sample Descript: Soil
Union City, CA 94587 Analysis for: Total Lead by AA
Attention: Josie First Sample #: 101-0527

Sampled: Jan 17, 1991
Received: Jan 22, 1991
Extracted: Jan 25, 1991
Analyzed: Jan 30, 1991
Reported: Feb 5, 1991

LABORATORY ANALYSIS FOR: Total Lead by AA

Sample Number	Sample Description	Detection Limit mg/kg	Sample Result mg/kg
101-0527	S1-S	0.50	N.D.
101-0528	S1-N	0.50	N.D.
101-0529	S2-S	0.50	5.5
101-0530	S3-S	0.50	N.D.
101-0531	S2-N	0.50	N.D.
101-0532	S3-N	0.50	N.D.
101-0533	S5-S	0.50	3.3
101-0534	S4-S	0.50	N.D.
101-0535	S5-N	0.50	4.7
101-0536	S4-N	0.50	N.D.
101-0537	S6-W	0.50	N.D.

Analytes reported as N.D. were not present above the stated limit of detection.

SEQUOIA ANALYTICAL

Belinda C. Vega
Belinda C. Vega
Laboratory Director



SEQUOIA ANALYTICAL

1900 Bates Avenue • Suite LM • Concord, California 94520
(415) 686-9600 • FAX (415) 686-9689

Tank Protect Engineering of N. Calif Client Project ID: #123A-011791-1
2821 Whipple Road
Union City, CA 94587
Attention: Josie

Sample Descript: Soil
Analysis for: Total Lead by AA
First Sample #: 101-0538

Sampled: Jan 17, 1991
Received: Jan 22, 1991
Extracted: Jan 25, 1991
Analyzed: Jan 30, 1991
Reported: Feb 5, 1991

LABORATORY ANALYSIS FOR: Total Lead by AA

Sample Number	Sample Description	Detection Limit mg/kg	Sample Result mg/kg
101-0538	S6-E	0.50	4.3
101-0539	I1-N	5.0	370
101-0540	I1-S	0.50	45

Analytes reported as N.D. were not present above the stated limit of detection.

SEQUOIA ANALYTICAL

Belinda C. Vega
Belinda C. Vega
Laboratory Director



SEQUOIA ANALYTICAL

1900 Bates Avenue • Suite LM • Concord, California 94520
 (415) 686-9600 • FAX (415) 686-9689

Tank Protect Engineering of N. Calif Client Project ID: #123A-011791-1	Sampled: Jan 17, 1991
2821 Whipple Road	Received: Jan 22, 1991
Union City, CA 94587	Analyzed: Feb 1, 1991
Attention: Josie	Reported: Feb 5, 1991
Sample Descript.: Soil, WO1	
Analysis Method: EPA 5030/8015/8020	
Lab Number: 101-0526	

TOTAL PETROLEUM FUEL HYDROCARBONS WITH BTEX DISTINCTION (EPA 8015/8020)

Analyte	Detection Limit mg/kg (ppm)	Sample Results mg/kg (ppm)
Low to Medium Boiling Point Hydrocarbons.....	1.0	N.D.
Benzene.....	0.0050	N.D.
Toluene.....	0.0050	N.D.
Ethyl Benzene.....	0.0050	N.D.
Xylenes.....	0.0050	N.D.

Low to Medium Boiling Point Hydrocarbons are quantitated against a gasoline standard.
 Analytes reported as N.D. were not present above the stated limit of detection.

SEQUOIA ANALYTICAL

Belinda C. Vega
 Belinda C. Vega
 Laboratory Director



SEQUOIA ANALYTICAL

1900 Bates Avenue • Suite LM • Concord, California 94520
(415) 886-9600 • FAX (415) 886-9699

Tank Protect Engineering of N. Calif	Client Project ID: #123A-011791-1	Sampled: Jan 17, 1991
2821 Whipple Road	Matrix Descript: Soil	Received: Jan 22, 1991
Union City, CA 94587	Analysis Method: EPA 3550/8015	Extracted: Jan 29, 1991
Attention: Josie	First Sample #: 101-0526	Analyzed: Jan 30, 1991
		Reported: Feb 5, 1991

TOTAL PETROLEUM FUEL HYDROCARBONS (EPA 8015)

Sample Number	Sample Description	High B.P. Hydrocarbons mg/kg (ppm)
101-0526	WO1	N.D.

Detection Limits:

1.0

High Boiling Point Hydrocarbons are quantitated against a diesel fuel standard.
Analytes reported as N.D. were not present above the stated limit of detection.

SEQUOIA ANALYTICAL

B. C. Vega
Belinda C. Vega
Laboratory Director



SEQUOIA ANALYTICAL

1900 Bates Avenue • Suite LM • Concord, California 94520
(415) 686-9600 • FAX (415) 686-9689

Tank Protect Engineering of N. Calif	Client Project ID: #123A-011791-1	Sampled: Jan 17, 1991
2821 Whipple Road	Matrix Descript: Soil, WO1	Received: Jan 22, 1991
Union City, CA 94587	Analysis Method: SM 5520 E&F (Gravimetric)	Extracted: Jan 25, 1991
Attention: Josie	First Sample #: 101-0526	Analyzed: Jan 25, 1991
		Reported: Feb 5, 1991

TOTAL RECOVERABLE PETROLEUM OIL

Sample Number	Sample Description	Oil & Grease mg/kg (ppm)
101-0526	WO1	N.D.

Detection Limits:

30

Analytes reported as N.D. were not present above the stated limit of detection.

SEQUOIA ANALYTICAL

Belinda Vega
Belinda C. Vega
Laboratory Director



SEQUOIA ANALYTICAL

1900 Bates Avenue • Suite LM • Concord, California 94520
(415) 686-9600 • FAX (415) 686-9689

Tank Protect Engineering of N. Calif Client Project ID: #123A-011791-1
2821 Whipple Road Sample Descript: Soil WO1
Union City, CA 94587 Lab Number: 101-0526
Attention: Josie

Sampled: Jan 17, 1991
Received: Jan 22, 1991
Extracted: Jan 24, 1991
Analyzed: 1/25-1/31/91
Reported: Feb 5, 1991

LABORATORY ANALYSIS

Analyte	Detection Limit mg/kg	Sample Results mg/kg
Cadmium.....	0.50	N.D.
Chromium.....	0.25	33
Lead.....	0.25	28
Nickel.....	2.5	26
Zinc.....	0.50	710

250
250
220
250

Analytes reported as N.D. were not present above the stated limit of detection.

SEQUOIA ANALYTICAL

Belinda C. Vega
Belinda C. Vega
Laboratory Director



SEQUOIA ANALYTICAL

1900 Bates Avenue • Suite LM • Concord, California 94520
(415) 686-9600 • FAX (415) 686-9689

Tank Protect Engineering of N. Calif Client Project ID: #123A-011791-1	Sampled: Jan 17, 1991
2821 Whipple Road	Received: Jan 22, 1991
Union City, CA 94587	Analyzed: Jan 30, 1991
Attention: Josie	Reported: Feb 5, 1991
Sample Descript: Soil (WO1)	
Analysis Method: EPA 5030/8010	
Lab Number: 101-0526	

HALOGENATED VOLATILE ORGANICS (EPA 8010)

Analyte	Detection Limit µg/kg	Sample Results µg/kg
Bromodichloromethane.....	5.0	N.D.
Bromoform.....	5.0	N.D.
Bromomethane.....	5.0	N.D.
Carbon tetrachloride.....	5.0	N.D.
Chlorobenzene.....	5.0	N.D.
Chloroethane.....	25	N.D.
2-Chloroethylvinyl ether.....	5.0	N.D.
Chloroform.....	5.0	N.D.
Chloromethane.....	5.0	N.D.
Dibromochloromethane.....	5.0	N.D.
1,2-Dichlorobenzene.....	10	N.D.
1,3-Dichlorobenzene.....	10	N.D.
1,4-Dichlorobenzene.....	10	N.D.
1,1-Dichloroethane.....	5.0	N.D.
1,2-Dichloroethane.....	5.0	N.D.
1,1-Dichloroethene.....	5.0	N.D.
Total 1,2-Dichloroethene.....	5.0	N.D.
1,2-Dichloropropane.....	5.0	N.D.
cis-1,3-Dichloropropene.....	5.0	N.D.
trans-1,3-Dichloropropene.....	5.0	N.D.
Methylene chloride.....	10	N.D.
1,1,2,2-Tetrachloroethane.....	5.0	N.D.
Tetrachloroethene.....	5.0	N.D.
1,1,1-Trichloroethane.....	5.0	N.D.
1,1,2-Trichloroethane.....	5.0	N.D.
Trichloroethene.....	5.0	N.D.
Trichlorofluoromethane.....	5.0	N.D.
Vinyl chloride.....	10	N.D.

Analytes reported as N.D. were not present above the stated limit of detection.

SEQUOIA ANALYTICAL

Belinda C. Vega
Laboratory Director



SEQUOIA ANALYTICAL

1900 Bates Avenue • Suite LM • Concord, California 94520
(415) 686-9600 • FAX (415) 686-9689

Tank Protect Engineering of N. Calif Client Project ID: #123A-011791-1
2821 Whipple Road Sample Descript: Soil, WOI
Union City, CA 94587 Analysis Method: EPA 8270
Attention: Josie Lab Number: 101-0526

Sampled: Jan 17, 1991
Received: Jan 22, 1991
Extracted: Jan 23, 1991
Analyzed: Feb 5, 1991
Reported: Feb 5, 1991

SEMI-VOLATILE ORGANICS by GC/MS (EPA 8270)

Analyte	Detection Limit µg/kg	Sample Results µg/kg
Acenaphthene.....	100	N.D.
Acenaphthylene.....	100	N.D.
Aniline.....	100	N.D.
Anthracene.....	100	N.D.
Benzidine.....	2,500	N.D.
Benzoic Acid.....	500	N.D.
Benzo(a)anthracene.....	100	N.D.
Benzo(b)fluoranthene.....	100	N.D.
Benzo(k)fluoranthene.....	100	N.D.
Benzo(g,h,i)perylene.....	100	N.D.
Benzo(a)pyrene.....	100	100
Benzyl alcohol.....	100	N.D.
Bis(2-chloroethoxy)methane.....	100	N.D.
Bis(2-chloroethyl)ether.....	100	N.D.
Bis(2-chloroisopropyl)ether.....	100	N.D.
Bis(2-ethylhexyl)phthalate.....	500	N.D.
4-Bromophenyl phenyl ether.....	100	N.D.
Butyl benzyl phthalate.....	100	N.D.
4-Chloroaniline.....	100	N.D.
2-Chloronaphthalene.....	100	N.D.
4-Chloro-3-methylphenol.....	100	N.D.
2-Chlorophenol.....	100	N.D.
4-Chlorophenyl phenyl ether.....	100	N.D.
Chrysene.....	100	N.D.
Dibenz(a,h)anthracene.....	100	N.D.
Dibenzofuran.....	100	N.D.
Di-N-butyl phthalate.....	500	N.D.
1,3-Dichlorobenzene.....	100	N.D.
1,4-Dichlorobenzene.....	100	N.D.
1,2-Dichlorobenzene.....	100	N.D.
3,3-Dichlorobenzidine.....	500	N.D.
2,4-Dichlorophenol.....	100	N.D.
Diethyl phthalate.....	100	N.D.
2,4-Dimethylphenol.....	100	N.D.
Dimethyl phthalate.....	100	N.D.
4,6-Dinitro-2-methylphenol.....	500	N.D.
2,4-Dinitrophenol.....	500	N.D.



SEQUOIA ANALYTICAL

1900 Bates Avenue • Suite LM • Concord, California 94520
(415) 886-9600 • FAX (415) 886-9689

Tank Protect Engineering of N. Calif Client Project ID: #123A-011791-1
2821 Whipple Road Sample Descript: Soil, WO1
Union City, CA 94587 Analysis Method: EPA 8270
Attention: Josie Lab Number: 101-0526

Sampled: Jan 17, 1991
Received: Jan 22, 1991
Extracted: Jan 23, 1991
Analyzed: Feb 5, 1991
Reported: Feb 5, 1991

SEMI-VOLATILE ORGANICS by GC/MS (EPA 8270)

Analyte	Detection Limit µg/kg	Sample Results µg/kg
2,4-Dinitrotoluene.....	100	N.D.
2,6-Dinitrotoluene.....	100	N.D.
Di-N-octyl phthalate.....	100	N.D.
Fluoranthene.....	100	110
Fluorene.....	100	N.D.
Hexachlorobenzene.....	100	N.D.
Hexachlorobutadiene.....	100	N.D.
Hexachlorocyclopentadiene.....	100	N.D.
Hexachloroethane.....	100	N.D.
Indeno(1,2,3-cd)pyrene.....	100	N.D.
Isophorone.....	100	N.D.
2-Methylnaphthalene.....	100	N.D.
2-Methylphenol.....	100	N.D.
4-Methylphenol.....	100	N.D.
Naphthalene.....	100	N.D.
2-Nitroaniline.....	500	N.D.
3-Nitroaniline.....	500	N.D.
4-Nitroaniline.....	500	N.D.
Nitrobenzene.....	100	N.D.
2-Nitrophenol.....	100	N.D.
4-Nitrophenol.....	500	N.D.
N-Nitrosodiphenylamine.....	100	N.D.
N-Nitroso-di-N-propylamine.....	100	N.D.
Pentachlorophenol.....	500	N.D.
Phenanthrene.....	100	N.D.
Phenol.....	100	N.D.
Pyrene.....	100	150
1,2,4-Trichlorobenzene.....	100	N.D.
2,4,5-Trichlorophenol.....	500	N.D.
2,4,6-Trichlorophenol.....	100	N.D.

Analytes reported as N.D. were not present above the stated limit of detection.

SEQUOIA ANALYTICAL

Belinda C. Vega
Belinda C. Vega
Laboratory Director



SEQUOIA ANALYTICAL

1900 Bates Avenue • Suite LM • Concord, California 94520
(415) 686-9600 • FAX (415) 686-9689

Tank Protect Engineering of N. Calif Client Project ID: #123A-011791-1
2821 Whipple Road Sample Descript: Soil
Union City, CA 94587 Analysis Method: EPA 8270 & "Open Scan"
Attention: Josie Lab Number:

Sampled:
Received: Jan 22, 1991
Extracted:
Analyzed:
Reported:

SEMI-VOLATILE ORGANICS by GC/MS, TENTATIVELY IDENTIFIED COMPOUNDS

Analyte	Detection Limit $\mu\text{g}/\text{kg}$	Sample Results $\mu\text{g}/\text{kg}$
---------	--	---

No additional peaks > 250 $\mu\text{g}/\text{kg}$ were identified by the Mass Spectral Library.

SEQUOIA ANALYTICAL

Belinda C. Vega
Belinda C. Vega
Laboratory Director

Please Note:

All identifications are tentative and concentrations are estimates based upon spectral comparison to the EPA NIST library. Positive identification or specification between isomers cannot be made without retention time standards.



TANK PROTECT ENGINEERING

2821 WHIPPLE ROAD
 UNION CITY, CA 94587
 (415) 429-8088
 (800) 523-8088
 FAX (415) 429-8089

CHAIN OF CUSTODY

PROJECT NO.		SITE NAME & ADDRESS					(1) TYPE OF CONTAINER	ANALYTES REQUESTED						REMARKS
23A-011791-1 RD 614		706 Harrison St. Oakland, Ca.						TOTAL LIGHT HC	AROMATIC HC	TOTAL HEAVY HC	OLE & GREASE	PCB SCAN (24' S)	OTHER	
SAMPLER NAME, ADDRESS AND TELEPHONE NUMBER														
ID NO.	DATE	TIME	SOIL	WATER	SAMPLING LOCATION									
W0-1	1/17/91	3:05	✓		1010526								gas/diesel; TDG; SO10; Cd, Cr, Ni, Pb, Zn; etc	
S1-S	"	3:20	✓		527								All required analyses by TRI - Regional Guidelines for waste oil	
S1-N	"	3:28	✓		526								TPH G & BTEX & Total Lead (AA)	
S2-S	"	3:40	✓		529								"	
S3-S	"	3:45	✓		530								"	
S2-N	"	3:52	✓		531								"	
S3-N	"	3:58	✓		532								"	
S5-S	"	4:05	✓		533								"	
S4-S	"	4:20	✓		534								"	

Relinquished by: (Signature) <i>[Signature]</i>	Date / Time 1-22-91/11:20 AM	Received by: (Signature) <i>[Signature]</i>	Relinquished by: (Signature)	Date / Time	Received by: (Signature)
Relinquished by: (Signature) <i>[Signature]</i>	Date / Time 1-22-91/11:20 AM	Received by: (Signature)	Relinquished by: (Signature)	Date / Time	Received by: (Signature)
Relinquished by: (Signature)	Date / Time	Received for Laboratory by: (Signature) <i>[Signature]</i>	Date / Time 1/22 11:15 AM	Remarks	

DATE: _____



TANK PROTECT ENGINEERING

2021 WHIPPLE ROAD
 UNION CITY, CA 94587
 (415) 429-8089
 (800) 523-8088
 FAX (415) 429-8089

CHAIN OF CUSTODY

Page 2 of 2

PROJECT NO.		SITE NAME & ADDRESS					(1) TYPE OF CONTAINER	ANALYTES REQUESTED						REMARKS	
123A-011791-1 BCC in		706 Harrison St. Oakland, Ca 94587						TOTAL LIGHT HC	AROMATIC HC	TOTAL HEAVY HC	OIL & GREASE	VOC SCAN (24's)	OTHER		
SAMPLER NAME, ADDRESS AND TELEPHONE NUMBER															
Tank Protect Engineering 2821 Whipple Rd. Union City, Ca 94587															
ID NO.	DATE	TIME	SOIL	WATER	SAMPLING LOCATION										
S5-N	1/17/91	4:25	✓		1010535								TPHE & BTEX & Total Lead (AA)		
S4-N	"	4:28	✓		536								" "		
S6-W	"	4:50	✓		537								" "		
S6-E	"	4:54	✓		538								" "		
I1-N		5:00	✓		Island 539 (th)								" "		
I1-S		5:03	✓		" 540 (th)								" "		
Relinquished by : (Signature)							Date / Time	Received by : (Signature)			Relinquished by : (Signature)		Date / Time	Received by : (Signature)	
<i>[Signature]</i>							1-22-91 / 1:52 PM	<i>[Signature]</i>							
Relinquished by : (Signature)							Date / Time	Received by : (Signature)			Relinquished by : (Signature)		Date / Time	Received by : (Signature)	
<i>[Signature]</i>							1-22-91 / 1:52 PM	<i>[Signature]</i>							
Relinquished by : (Signature)							Date / Time	Received for Laboratory by: (Signature)			Date / Time	Remarks			

DATE: _____