



GETTLER-RYAN INC.

TRANSMITTAL
Alameda County

March 4, 2003
G-R #180022

MAR 24 2003

TO: Mr. David B. De Witt
ConocoPhillips
2000 Crow Canyon Place, Suite 400
San Ramon, California 94583

Environmental Health Mr. Paul Blank
ERI, Inc.
73 Digital Drive, Suite 100
Novato, California 94949

FROM: Deanna L. Harding
Project Coordinator
Gettler-Ryan Inc.
6747 Sierra Court, Suite J
Dublin, California 94568

RE: **Tosco(Unocal) Service Station**
#7176
7850 Amador Valley Boulevard
Dublin, California

WE HAVE ENCLOSED THE FOLLOWING:

COPIES	DATED	DESCRIPTION
1	February 28, 2003	Groundwater Monitoring and Sampling Report First Semi-Annual - Event of January 24, 2003

COMMENTS:

This report is being sent to you for your review/comment, prior to being distributed on your behalf. If no comments are received by **March 18, 2003**, this report will be distributed to the following:

cc: Mr. Amir K. Gholami, REHS, Alameda County Health Care Services, 1131 Harbor Bay Pkwy., Alameda, CA 94502

Enclosure



GETTLER-RYAN INC.

February 28, 2003
G-R Job #180022

Mr. David B. De Witt
ConocoPhillips
2000 Crow Canyon Place, Suite 400
San Ramon, California 94583

RE: First Semi-Annual Event of January 24, 2003
Groundwater Monitoring & Sampling Report
Tosco (Unocal) Service Station #7176
7850 Amador Valley Boulevard
Dublin, California

Dear Mr. De Witt:

This report documents the most recent groundwater monitoring and sampling event performed by Gettler-Ryan Inc. (G-R) at the referenced site. All field work was conducted in accordance with G-R Standard Operating Procedure - Groundwater Sampling (attached).

Static groundwater levels were measured and all wells were checked for the presence of separate-phase hydrocarbons. Separate-phase hydrocarbons were not present in the wells. Static water level data and groundwater elevations are summarized in Table 1. Dissolved Oxygen Concentrations are summarized in Table 3. A Potentiometric Map is included as Figure 1.

Groundwater samples were collected from the monitoring wells and submitted to a state certified laboratory for analyses. The field data sheets for this event are attached. Analytical results are presented in the table(s) listed below. A Concentration Map is included as Figure 2. The chain of custody document and laboratory analytical reports are also attached.

Sincerely,

Deanna L. Harding
Project Coordinator

Robert C. Mallory
Registered Geologist No. 7285

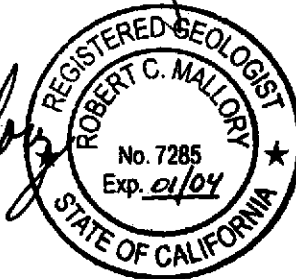

Figure 1: Potentiometric Map
Figure 2: Concentration Map
Table 1: Groundwater Monitoring Data and Analytical Results
Table 2: Groundwater Analytical Results - Oxygenate Compounds
Table 3: Dissolved Oxygen Concentrations
Attachments: Standard Operating Procedure - Groundwater Sampling
Field Data Sheets
Chain of Custody Document and Laboratory Analytical Reports

7176.qml

AMADOR VALLEY BOULEVARD

EXPLANATION

- ◆ Groundwater monitoring well
- ⊙ Conductor casing
- 99.99 Groundwater elevation in feet referenced to Mean Sea Level
- 99.99--- Groundwater elevation contour, dashed where inferred

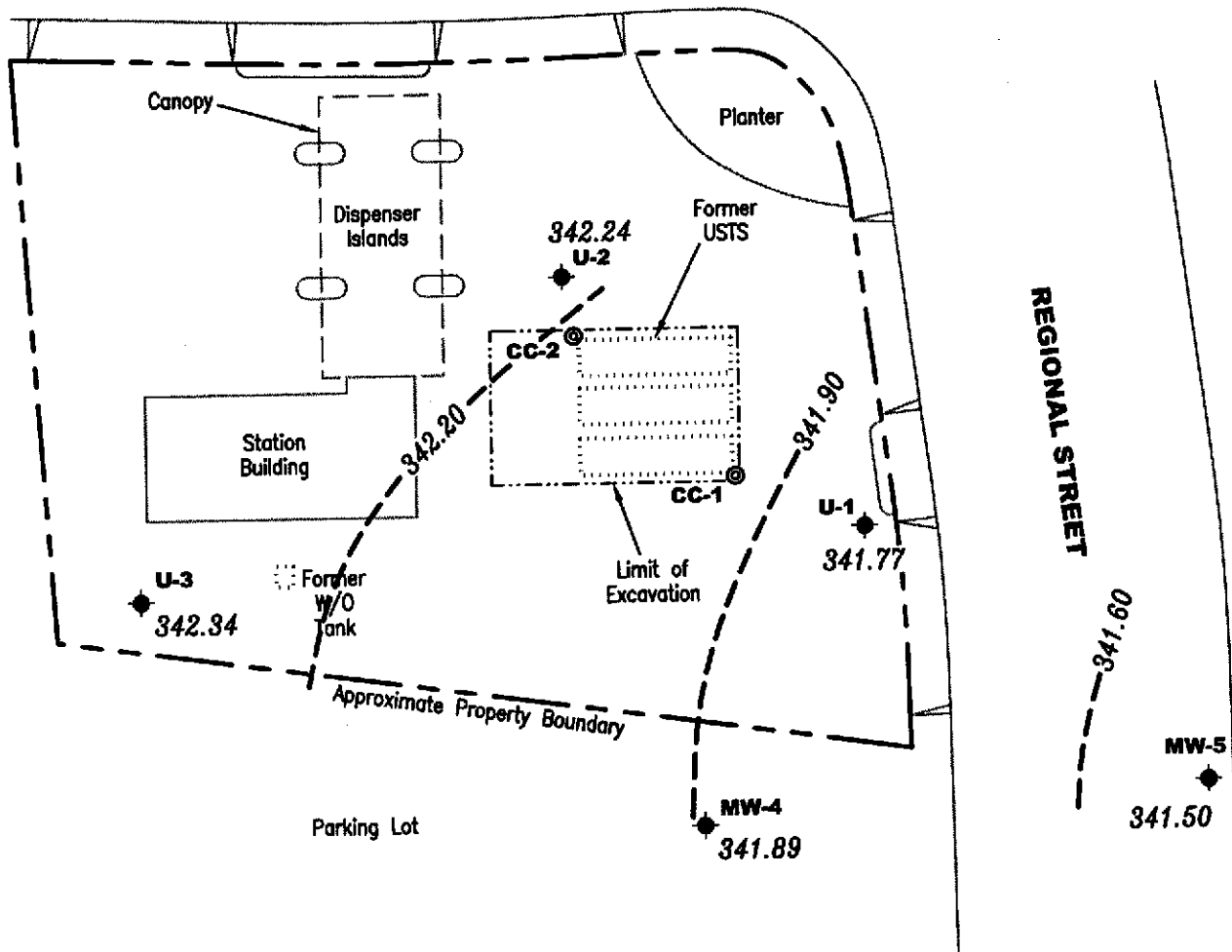

Approximate groundwater flow direction at a gradient of 0.003 to 0.005 Ft./Ft.

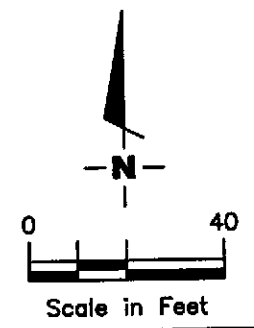

Source: Figure modified from drawing provided by MPDS Services, Inc.

GETTLER - RYAN INC.
 6747 Sierra Ct., Suite J
 Dublin, CA 94568 (925) 551-7555

POTENTIOMETRIC MAP
 Tosco (Unocal) Service Station #7176
 7850 Amador Valley Boulevard
 Dublin, California

FIGURE
1

PROJECT NUMBER
180022

REVIEWED BY

DATE
 January 24, 2003

REVISED DATE

FILE NAME: P:\ENVIRO\TOSCO\7176\Q03-7176.DWG | Layout Tab: Pot1

AMADOR VALLEY BOULEVARD

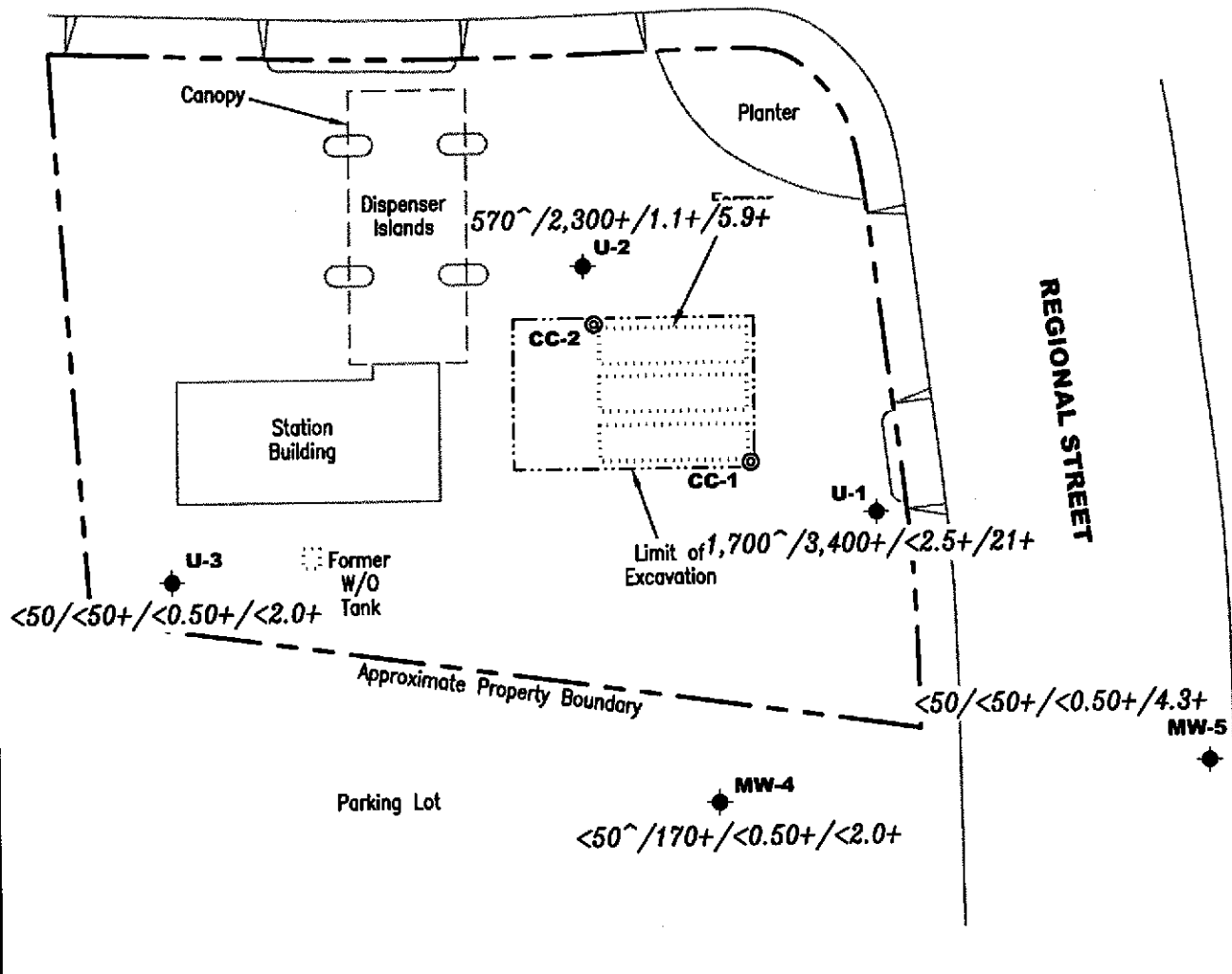

EXPLANATION

- ◆ Groundwater monitoring well
- ⊙ Conductor casing
- A/B/C/D Total Petroleum Hydrocarbons (TPH) as Diesel/TPH as Gasoline/Benzene/MTBE concentrations in ppb
- ~ w/silica gel cleanup
- + Analyses by EPA Method 8260

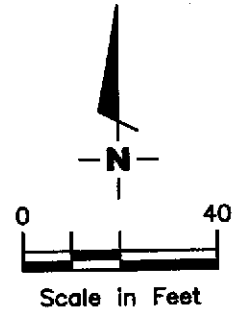

Source: Figure modified from drawing provided by MPDS Services, Inc.

GETTLER - RYAN INC.
 6747 Sierra Ct., Suite J
 Dublin, CA 94568 (925) 551-7555

CONCENTRATION MAP
 Tosco (Unocal) Service Station #7176
 7850 Amador Valley Boulevard
 Dublin, California

FIGURE

2

PROJECT NUMBER
 180022

REVIEWED BY

DATE
 January 24, 2003

REVISED DATE

Table 1
Groundwater Monitoring Data and Analytical Results
 Tosco (Unocal) Service Station #7176
 7850 Amador Valley Boulevard
 Dublin, California

WELL ID/ TOC*(ft.)	DATE	DTW (ft.)	S.I. (ft.bgs)	GWE (msl)	TPH-D◆ (ppb)	TPH-G (ppb)	B (ppb)	T (ppb)	E (ppb)	X (ppb)	MTBE (ppb)
U-1											
355.62	07/08/95	12.59	10.0-30.0	343.03	³ 9,400/--	39,000	1,500	19	1,600	5,200	--
	10/12/95	15.38		340.24	⁵ 4,200/--	33,000	1,400	ND	1,400	3,100	-- ⁷
	01/11/96 ¹	16.33		339.29	⁵ 8,200/--	8,300	690	11	680	1,500	-- ⁸
	04/11/96 ²	12.20		343.42	⁵ 630/--	3,200	110	ND	180	290	790
	07/10/96	13.84		341.78	⁵ 2,200/--	2,600	81	4.4	210	230	510
	10/30/96	15.85		339.77	⁵ 560/--	2,200	67	19	140	150	360
	01/27/97	12.20		343.42	⁵ 2,300/--	4,600	98	ND	360	290	150
	04/08/97	13.46		342.16	⁵ 1,300/--	2,800	50	ND	220	140	ND
	07/17/97	15.30		340.32	⁶ 460/--	2,300	30	4.5	140	94	190
	10/17/97	16.33		339.29	⁶ 510/--	1,500	31	6.7	110	88	220
	01/19/98	14.34		341.28	¹⁰ 1,900/1,300 ¹⁰	3,100	46	3.4	310	200	170
355.59	NP 04/23/98	11.16		344.43	--/1,700 ¹¹	3,400	72	3.8	470	350	280
	NP 07/08/98	12.67		342.92	¹⁴ 2,000/--	4,500	51	ND ¹²	590	430	190
	10/05/98	14.57		341.02	--/2,500 ¹⁰	7,500 ¹⁶	53	ND ¹²	680	350	190/180 ¹⁷
	01/04/99	15.35		340.24	¹¹ 2,700/2,500 ¹¹	10,000 ¹⁹	ND ¹²	ND ¹²	1,200	540	ND ¹²
	04/05/99	13.64		341.95	¹⁰ 920/570 ¹⁰	4,900	34	ND ¹²	350	150	150/55 ¹⁷
	07/01/99	14.39		341.20	¹⁰ 2,700/3,600 ²⁶	10,000	45	ND ¹²	850	420	260/110 ¹⁷
	09/30/99	15.32		340.27	¹⁰ 2,360/1,680 ¹⁰	7,150 ²⁷	ND ¹²	ND ¹²	415	84.4	¹² ND/195 ¹⁷
	01/03/00	16.51		339.08	²⁶ 2,000/1,700 ²⁶	5,400 ²⁷	28	8.4	180	33	160/120 ¹⁷
	04/04/00	12.89		342.70	²⁶ 990/1,400 ²⁶	4,800 ²⁷	30	ND ¹²	210	93	170/160 ¹⁷
	07/14/00	14.56		341.03	²⁶ 2,800/1,200 ²⁶	6,200 ²⁷	41	16	170	32	170/120 ¹⁷
	10/27/00	15.96		339.63	²⁶ 1,400/1,300 ²⁶	3,830 ¹⁶	16.8	ND ¹²	68.6	7.99	55.2/38 ¹⁷
	01/08/01	15.72		339.87	--/873 ²⁹	2,410 ¹⁶	14.7	4.30	30.5	5.04	34.5/9.33 ¹⁷
	04/03/01	14.46		341.13	²⁶ 1,500/830 ²⁶	3,330 ¹⁶	15.8	5.96	74.8	7.06	¹² ND/13.3 ¹⁷
	07/06/01	15.65		339.94	¹⁰ 1,600/1,200 ^{10,30}	4,300 ¹⁶	23	6.4	57	6.8	58/36 ¹⁷
	10/05/01	16.45		339.14	¹⁰ 2,500/2,300 ¹⁰	3,800 ¹⁶	19	<5.0	19	<5.0	64/36 ¹⁷
	01/03/02	14.18		341.41	³¹ 2,200/2,200 ³¹	4,500 ¹⁶	25	<10	24	<10	<100/23 ¹⁷
	04/01/02	13.72		341.87	³¹ 1,800/1,200 ³¹	5,300 ¹⁶	36	6.7	48	12	93/59 ¹⁷
	07/01/02 ³²	14.61		340.98	²⁹ 2,100/2,100 ²⁹	3,900	<0.50	<0.50	<0.50	3.9	23
	01/24/03 ³²	13.82		341.77	²⁹ 2,100/1,700 ²⁹	3,400	<2.5	<2.5	37	<5.0	21

Table 1
Groundwater Monitoring Data and Analytical Results
 Tosco (Unocal) Service Station #7176
 7850 Amador Valley Boulevard
 Dublin, California

WELL ID/ TOC* (ft.)	DATE	DTW (ft.)	S.I. (ft.bgs)	GWE (msl)	TPH-D \blacklozenge (ppb)	TPH-G (ppb)	B (ppb)	T (ppb)	E (ppb)	X (ppb)	MTBE (ppb)
U-2											
356.59	07/08/95	12.68	10.0-30.0	343.91	³ 4,700/--	17,000	430	ND	2,200	590	--
	10/12/95	16.01		340.58	⁵ 3,600/--	24,000	310	60	1,900	190	-- ⁷
	01/11/96 ¹	17.06		339.53	⁵ 8,600/--	10,000	210	55	1,400	240	-- ⁸
	04/11/96 ²	12.75		343.84	⁵ 1,900/--	7,700	130	27	1,100	110	340
	07/10/96	14.42		342.17	⁵ 2,300/--	5,600	59	15	610	42	250
	10/30/96	16.82		339.77	⁵ 1,800/--	7,700	67	35	1,000	54	260
	01/27/97	12.91		343.68	⁵ 660/--	1,600	14	ND	130	7.0	100
	04/08/97	14.07		342.52	⁵ 2,000/--	4,300	35	ND	400	16	ND
	07/17/97	15.96		340.63	⁶ 1,300/--	6,200	17	22	410	ND	130
	10/17/97	17.03		339.56	⁶ 1,400/--	7,100	71	26	520	50	ND
	01/19/98	15.10		341.49	¹⁰ 2,100/1,500 ¹⁰	5,300	46	11	350	16	110
356.55	NP 04/23/98	11.74		344.81	--/1,200 ¹¹	3,200	23	11	210	38	160
	NP 07/08/98	13.27		343.28	¹⁴ 1,100/--	1,600	34	8.5	100	7.4	190
		10/05/98		341.65	--/1,300 ¹⁰	2,900 ¹⁸	37	8.4	110	7.3	78
		01/04/99		340.61	¹¹ 670/250 ²⁰	2,200 ²¹	35	ND ¹²	17	ND ¹²	86
		04/05/99		342.36	¹⁰ 660/490 ¹⁰	4,900	21	77	130	310	100/6.9 ¹⁷
		07/01/99		341.57	²⁴ 210/440 ²⁶	1,500 ²⁵	7.6	ND ¹²	ND ¹²	ND ¹²	¹² ND/35 ¹⁷
		09/30/99		340.55	¹⁰ 483/340 ¹⁰	256 ²⁷	1.85	ND ¹²	2.42	ND ¹²	26.3/29.8 ¹⁷
		01/03/00		339.35	²⁶ 2,400/1,900 ²⁶	3,400 ²⁷	23	13	ND ¹²	44	46/14 ¹⁷
		04/04/00		343.05	²⁶ 1,000/1,000 ²⁶	3,600 ²⁷	34	17	56	ND ¹²	59/25 ¹⁷
		07/14/00		341.32	²⁶ 1,000/350 ²⁶	3,100 ²⁷	16	13	15	10	100/19 ¹⁷
		10/27/00		339.81	²⁶ 2,000/1,900 ²⁶	4,180 ¹⁶	30.4	10.2	14.6	ND ¹²	55.5/15 ¹⁷
		01/08/01		339.87	--/624 ²⁹	3,300 ¹⁶	33.5	7.32	3.49	ND ¹²	66.7/7.49 ¹⁷
		04/03/01		341.43	²⁶ 1,500/830 ²⁶	4,290 ¹⁶	32.4	9.91	20.1	ND ¹²	66.6/18.1 ¹⁷
		07/06/01		340.23	¹⁰ 1,400/1,100 ^{10,30}	4,700 ¹⁶	35	11	12	5.3	62/19 ¹⁷
		10/05/01		339.40	¹⁰ 3,200/1,900 ¹⁰	3,600 ¹⁶	31	9.6	8.7	6.9	62/13 ¹⁷
		01/03/02		341.65	³¹ 2,300/2,100 ³¹	4,600 ¹⁶	34	11	15	5.8	62/7.5 ¹⁷
		04/01/02		342.17	³¹ 1,400/470 ³¹	3,500 ¹⁶	38	9.3	10	6.5	87/18 ¹⁷
		07/01/02 ³²		341.31	<50/--	4,500	<0.50	<0.50	5.0	1.7	<0.50
		01/24/03 ³²		342.24	²⁹ 860/570 ²⁹	2,300	1.1	1.5	6.9	2.4	5.9

Table 1
Groundwater Monitoring Data and Analytical Results
 Tosco (Unocal) Service Station #7176
 7850 Amador Valley Boulevard
 Dublin, California

WELL ID/ TOC*(ft.)	DATE	DTW (ft.)	S.I. (ft.bgs)	GWE (msl)	TPH-D [◆] (ppb)	TPH-G (ppb)	B (ppb)	T (ppb)	E (ppb)	X (ppb)	MTBE (ppb)
U-3											
358.13	07/08/95	14.58	10.0-30.0	343.55	³ 710/--	1,100 ⁴	0.57	2.1	1.7	2.4	--
	10/12/95	17.60		340.53	⁶ 470/--	560	ND	0.87	0.7	1.1	--
	01/11/96 ¹	18.65		339.48	⁶ 260/--	230	0.62	0.91	0.97	1.9	--
	04/11/96	13.20		344.93	ND/--	68 ⁹	ND	ND	ND	ND	ND
	07/10/96	15.98		342.15	ND/--	ND	ND	ND	ND	ND	ND
	10/30/96	18.24		339.89	ND/--	70	ND	ND	ND	ND	ND
	01/27/97	14.41		343.72	ND/--	ND	ND	ND	ND	ND	ND
	04/08/97	15.73		342.40	ND/--	ND	ND	ND	ND	ND	ND
	07/17/97	17.54		340.59	ND/--	ND	ND	ND	ND	ND	ND
	10/17/97	18.64		339.49	⁶ 63/--	ND	ND	ND	ND	ND	ND
	01/19/98	16.67		341.46	¹⁰ 68/ND	ND	ND	ND	ND	ND	ND
358.09	NP 04/23/98	13.28		344.81	--/ND	ND	ND	ND	ND	ND	ND
	NP 07/08/98	14.90		343.19	¹³ 80/--	ND	ND	ND	ND	ND	ND
		10/05/98		341.59	--/ND	ND	ND	ND	ND	ND	ND
		01/04/99		340.39	ND/--	ND	ND	ND	ND	ND	ND
		04/05/99		342.42	ND/--	ND	ND	ND	ND	ND	ND/ND ¹⁷
		07/01/99		341.30	ND/--	ND	ND	ND	ND	ND	ND/ND ¹⁷
		09/30/99		340.49	ND/--	ND	ND	ND	ND	ND	ND/ND ¹⁷
		01/03/00		339.23	ND/--	ND	ND	ND	ND	ND	ND/ND ¹⁷
		04/04/00		342.99	ND/--	ND	ND	ND	ND	ND	ND/ND ¹⁷
		07/14/00		341.24	ND/--	ND	ND	ND	ND	ND	ND/ND ¹⁷
		10/27/00		339.74	ND/--	ND	ND	ND	ND	ND	ND/ND ¹⁷
		01/08/01		339.78	--/ND	ND	ND	ND	ND	ND	ND/ND ¹⁷
		04/03/01		341.39	ND/--	ND	ND	ND	ND	ND	ND/ND ¹⁷
		07/06/01		340.19	ND/--	ND	ND	ND	ND	ND	ND/ND ¹⁷
		10/05/01		339.38	<50/--	<50	<0.50	<0.50	<0.50	<0.50	<5.0/<2.0 ¹⁷
		01/03/02		341.68	<52/--	<50	<0.50	<0.50	<0.50	<0.50	<5.0/<1.0 ¹⁷
		04/01/02		342.22	<50/--	<50	<0.50	1.1	<0.50	1.2	<5.0/<2.0 ¹⁷
	07/01/02 ³²	16.77		341.32	²⁹ 1,500/<59	<50	<0.50	<0.50	<0.50	<1.0	<0.50
	01/24/03 ³²	15.75		342.34	<50/--	<50	<0.50	<0.50	<0.50	<1.0	<2.0

Table 1
Groundwater Monitoring Data and Analytical Results
Tosco (Unocal) Service Station #7176
7850 Amador Valley Boulevard
Dublin, California

WELL ID/ TOC* (ft.)	DATE	DTW (ft.)	S.I. (ft.bgs)	GWE (msl)	TPH-D [◆] (ppb)	TPH-G (ppb)	B (ppb)	T (ppb)	E (ppb)	X (ppb)	MTBE (ppb)
MW-4 356.41	04/23/98	12.11	10.0-25.0	344.30	--/1,400 ¹¹	2,500	5.9	6.4	16	31	ND ¹²
	07/08/98	13.70		342.71	¹¹ 1,400/--	1,000 ¹³	ND ¹²	ND ¹²	ND ¹²	ND ¹²	ND ¹²
	10/05/98	15.18		341.23	--/230 ¹⁰	890 ¹⁶	ND ¹²	ND ¹²	ND ¹²	14	ND ¹²
	01/04/99	16.39		340.02	¹⁰ 71/71 ¹⁰	230 ²²	0.56	1.3	1.4	1.8	10
	04/05/99	14.61		341.80	¹⁰ 340/210 ¹⁰	620 ²³	ND ¹²	1.8	2.1	ND ¹²	6.0/9.3 ¹⁷
	07/01/99	15.43		340.98	²⁴ 260/310 ²⁶	700 ¹⁹	2.1	ND ¹²	1.9	2.4	¹² ND/21 ¹⁷
	09/30/99	16.27		340.14	¹⁰ 420/220 ¹⁰	582 ²⁷	2.60	1.30	1.98	ND ¹²	23.1/22.5 ¹⁷
	01/03/00	17.50		338.91	²⁶ 250/260 ²⁶	800 ²⁷	4.2	4.6	3.3	11	31/17 ¹⁷
	04/04/00	13.91		342.50	^{10,15} 460/340 ²⁶	710 ²⁷	2.0	1.3	4.4	2.0	21/22 ¹⁷
	07/14/00	15.58		340.83	²⁶ 220/76 ²⁶	490 ²⁸	0.89	1.3	0.85	1.8	21/12 ¹⁷
	10/27/00	16.96		339.45	²⁶ 160/120 ²⁶	598 ²¹	ND	1.56	4.65	ND	15.4/14 ¹⁷
	01/08/01	16.64		339.77	--/202 ²⁹	522 ²⁷	4.09	1.69	2.53	1.26	17.2/14.3 ¹⁷
	04/03/01	15.46		340.95	²⁶ 180/ND	575 ²¹	ND ¹²	ND ¹²	ND ¹²	ND ¹²	14.0/11.6 ¹⁷
	07/06/01	16.63		339.78	¹⁰ 230/200 ^{10,30}	720 ¹⁶	4.7	1.5	2.5	0.74	10/7.1 ¹⁷
	10/05/01	17.38		339.03	¹⁰ 180/140 ¹⁰	650 ²⁷	4.3	1.2	1.1	1.8	5.9/5.4 ¹⁷
	01/03/02	15.10		341.31	³¹ 390/360 ³¹	340 ¹⁶	2.9	1.4	1.7	<1.0	<10/3.1 ¹⁷
	04/01/02	14.85		341.56	³¹ 160/100 ³¹	340 ²¹	<0.50	2.7	<0.50	0.66	<5.0/2.2 ¹⁷
07/01/02 ³²	15.53		340.88	²⁹ 130/97 ²⁹	280	<0.50	<0.50	<0.50	<1.0	0.58	
01/24/03 ³²	14.52		341.89	²⁹ 52/<50	170 ²⁹	<0.50	<0.50	<0.50	<1.0	<2.0	
MW-5 355.03	04/23/98	11.15	10.0-25.0	343.88	--/100 ¹¹	120	0.53	0.90	1.0	3.8	13
	07/08/98	12.63		342.40	¹⁰ 170/--	ND	ND	ND	ND	ND	12
	10/05/98	14.00		341.03	--/100 ¹⁰	ND	ND	ND	ND	ND	12
	01/04/99	15.21		339.82	ND/--	ND	ND	ND	ND	ND	ND
	04/05/99	13.76		341.27	ND/--	ND	ND	ND	ND	ND	ND/ND ¹⁷
	07/01/99	14.48		340.55	ND/--	ND	ND	ND	ND	ND	¹² ND/2.3 ¹⁷
	09/30/99	15.15		339.88	¹⁰ 60.4/ND	50.8 ²⁷	ND	ND	ND	ND	ND/ND ¹⁷
	01/03/00	16.34		338.69	ND/--	ND	ND	ND	ND	ND	ND/ND ¹⁷
	04/04/00	12.90		342.13	¹⁵ 69/ND	ND	ND	ND	ND	ND	ND/ND ¹⁷
	07/14/00	14.48		340.55	ND/--	ND	ND	ND	ND	ND	ND/ND ¹⁷

Table 1
Groundwater Monitoring Data and Analytical Results
 Tosco (Unocal) Service Station #7176
 7850 Amador Valley Boulevard
 Dublin, California

WELL ID/ TOC* (ft.)	DATE	DTW (ft.)	S.I. (ft.bgs)	GWE (msl)	TPH-D♦ (ppb)	TPH-G (ppb)	B (ppb)	T (ppb)	E (ppb)	X (ppb)	MTBE (ppb)
MW-5 (cont)	10/27/00	15.75	10.0-25.0	339.28	ND/--	ND	ND	ND	ND	ND	ND/ND ¹⁷
	01/08/01	15.25		339.78	--/ND	ND	ND	ND	ND	ND	ND/ND ¹⁷
	04/03/01	14.41		340.62	ND/--	ND	ND	ND	ND	ND	ND/ND ¹⁷
	07/06/01	15.52		339.51	ND/--	ND	ND	ND	ND	ND	ND/ND ¹⁷
	10/05/01	16.28		338.75	<50/--	<50	<0.50	<0.50	<0.50	<0.50	<5.0/<2.0 ¹⁷
	01/03/02	14.01		341.02	<51/--	<50	<0.50	<0.50	<0.50	<0.50	<5.0/1.6 ¹⁷
	04/01/02	13.64		341.39	<50/--	<50	<0.50	<0.50	<0.50	<0.50	<5.0/3.5 ¹⁷
	07/01/02 ³²	14.51		340.52	<60/--	<50	<0.50	<0.50	<0.50	<1.0	2.3
	01/24/03 ³²	13.53		341.50	<50/--	<50	<0.50	<0.50	<0.50	<1.0	4.3
Trip Blank											
TB-LB	01/19/98	--	--	--	--	ND	ND	ND	ND	ND	ND
	04/23/98	--	--	--	--	ND	ND	ND	ND	ND	ND
	07/08/98	--	--	--	--	ND	ND	ND	ND	ND	ND
	10/05/98	--	--	--	--	ND	ND	0.70	ND	0.71	ND
	01/04/99	--	--	--	--	ND	ND	0.74	ND	0.92	ND
	04/05/99	--	--	--	--	ND	ND	ND	ND	ND	ND
	07/01/99	--	--	--	--	ND	ND	ND	ND	ND	ND
	09/30/99	--	--	--	--	ND	ND	ND	ND	ND	ND
	01/03/00	--	--	--	--	ND	ND	ND	ND	ND	ND
	04/04/00	--	--	--	--	ND	ND	ND	ND	ND	ND
	07/14/00	--	--	--	--	ND	ND	ND	ND	ND	ND
	10/27/00	--	--	--	--	ND	ND	ND	ND	ND	ND
	01/08/01	--	--	--	--	ND	ND	ND	ND	ND	ND
	04/03/01	--	--	--	--	ND	ND	ND	ND	ND	ND
	07/06/01	--	--	--	--	ND	ND	ND	ND	ND	ND
	10/05/01	--	--	--	--	<50	<0.50	<0.50	<0.50	<0.50	<5.0
	01/03/02	--	--	--	--	<50	<0.50	<0.50	<0.50	<0.50	<5.0
	04/01/02	--	--	--	--	<50	<0.50	<0.50	<0.50	<0.50	<5.0

Table 1
Groundwater Monitoring Data and Analytical Results
 Tosco (Unocal) Service Station #7176
 7850 Amador Valley Boulevard
 Dublin, California

WELL ID/ TOC*(ft.)	DATE	DTW (ft.)	S.I. (ft.bgs)	GWE (msl)	TPH-D♦ (ppb)	TPH-G (ppb)	B (ppb)	T (ppb)	E (ppb)	X (ppb)	MTBE (ppb)
QA	07/01/02 ³²	--	--	--	--	<50	<0.50	<0.50	<0.50	<1.0	<0.50
	01/24/03 ³²	--	--	--	--	<50	<0.50	<0.50	<0.50	<1.0	<2.0

Table 1
Groundwater Monitoring Data and Analytical Results
 Tosco (Unocal) Service Station #7176
 7850 Amador Valley Boulevard
 Dublin, California

EXPLANATIONS:

Groundwater monitoring data and laboratory analytical results prior to January 19, 1998, were compiled from reports prepared by MPDS Services, Inc.

TOC = Top of Casing (ft.) = Feet	TPH-D = Total Petroleum Hydrocarbons as Diesel	(ppb) = Parts per billion
DTW = Depth to Water	TPH-G = Total Petroleum Hydrocarbons as Gasoline	ND = Not Detected
S.I. = Screen Interval	B = Benzene	-- = Not Measured/Not Analyzed
(ft.bgs) = Feet Below Ground Surface	T = Toluene	NP = No purge
GWE = Groundwater Elevation	E = Ethylbenzene	QA = Quality Assurance/Trip Blank
(msl) = Mean sea level	X = Xylenes	
	MTBE = Methyl tertiary butyl ether	

* TOC elevations were surveyed relative to msl, per the Benchmark AM-STW1977 located at the easterly return at the most easterly corner of intersection at Amador Valley Boulevard and Starward Street, (Elevation = 344.17 feet, msl).

◆ Analytical results reported as follows: TPH-D/TPH-D with silica gel cleanup.

- 1 Polynuclear Aromatic Hydrocarbons (PNAs) compound naphthalene was detected in well U-1 at a concentration of 320 ppb and at a concentration of 310 ppb in well U-2. All other PNAs compounds were ND in both wells.
- 2 PNAs compounds were ND.
- 3 Laboratory report indicates unidentified hydrocarbons C9-C26.
- 4 Laboratory report indicates gasoline and unidentified hydrocarbons >C12.
- 5 Laboratory report indicates the hydrocarbons detected appeared to be a diesel and non-diesel mixture.
- 6 Laboratory report indicates the hydrocarbons detected did not appear to be diesel.
- 7 Laboratory has potentially identified the presence of MTBE at reportable levels in the groundwater sample collected from this well.
- 8 Laboratory has identified the presence of MTBE at a level above or equal to the taste and odor threshold of 40 ppb in the sample collected from this well.
- 9 Laboratory report indicates the hydrocarbons detected did not appear to be gasoline.
- 10 Laboratory report indicates unidentified hydrocarbons C9-C24.
- 11 Laboratory report indicates diesel and unidentified hydrocarbons <C14.
- 12 Detection limit raised. Refer to analytical reports.
- 13 Laboratory report indicates unidentified hydrocarbons >C8.
- 14 Laboratory report indicates unidentified hydrocarbons <C14.
- 15 Laboratory report indicates discrete peaks.
- 16 Laboratory report indicates weathered gasoline C6-C12.
- 17 MTBE by EPA Method 8260.
- 18 Laboratory report indicates unidentified hydrocarbons <C8.
- 19 Laboratory report indicates gasoline and unidentified hydrocarbons C6-C12.
- 20 Laboratory report indicates diesel and unidentified hydrocarbons <C16.

Table 1
Groundwater Monitoring Data and Analytical Results
Tosco (Unocal) Service Station #7176
7850 Amador Valley Boulevard
Dublin, California

EXPLANATIONS: (cont)

- 21 Laboratory report indicates unidentified hydrocarbons C6-C12.
- 22 Laboratory report indicates gasoline and unidentified hydrocarbons >C10.
- 23 Laboratory report indicates gasoline and unidentified hydrocarbons <C7.
- 24 Laboratory report indicates unidentified hydrocarbons C10-C24.
- 25 Laboratory report indicates gasoline and unidentified hydrocarbons <C6.
- 26 Laboratory report indicates unidentified hydrocarbons <C16.
- 27 Laboratory report indicates gasoline C6-C12.
- 28 Laboratory report indicates gasoline C6-C12 + unidentified hydrocarbons C6-C12.
- 29 Laboratory report indicates hydrocarbon pattern is present in the requested fuel quantitation range but does not resemble the pattern of the requested fuel.
- 30 Laboratory report indicates sample was generated out of hold time. The sample was originally run within hold time, but needed to be re-analyzed.
- 31 Laboratory report indicates unidentified hydrocarbons C10-C28.
- 32 TPH-G, BTEX and MTBE by EPA Method 8260.

Table 2
Groundwater Analytical Results - Oxygenate Compounds
 Tosco (Unocal) Service Station #7176
 7850 Amador Valley Boulevard
 Dublin, California

WELL ID	DATE	ETHANOL (ppb)	TBA (ppb)	MTBE (ppb)	DIPE (ppb)	ETBE (ppb)	TAME (ppb)	1,2-DCA (ppb)	EDB (ppb)
U-1	04/05/99	ND ¹	ND ¹	55	ND ¹	ND ¹	ND ¹	ND ¹	ND ¹
	07/01/99	ND	ND	110	ND	ND	ND	ND	ND
	09/30/99	ND ¹	ND ¹	195	ND ¹	ND ¹	ND ¹	ND ¹	ND ¹
	01/03/00	ND	ND	120	ND	ND	ND	ND	ND
	04/04/00	ND ¹	ND ¹	160	ND ¹	ND ¹	ND ¹	ND ¹	ND ¹
	07/14/00	ND ¹	ND ¹	120	ND ¹	ND ¹	ND ¹	ND ¹	ND ¹
	10/27/00	ND	ND	38	ND	ND	ND	ND	ND
	01/08/01	ND ¹	ND ¹	9.33	ND ¹	ND ¹	ND ¹	ND ¹	ND ¹
	04/03/01	ND ¹	ND ¹	13.3	ND ¹	ND ¹	ND ¹	ND ¹	ND ¹
	07/06/01	ND	ND	36	ND	ND	ND	ND	ND
	10/05/01	<1,000	<100	36	<2.0	<2.0	<2.0	<2.0	<2.0
	01/03/02	<2,500	<100	23	<5.0	<5.0	<5.0	<5.0	<5.0
	04/01/02	<2,500	<500	59	<10	<10	<10	<10	<10
	07/01/02	<25	<5.0	23	<1.0	<0.50	<0.50	<0.50	<0.50
01/24/03	<2,500	<500	21	<10	<10	<10	<10	<10	
U-2	04/05/99	ND ¹	ND ¹	6.9	ND ¹	ND ¹	ND ¹	ND ¹	ND ¹
	07/01/99	ND	ND	35	ND	ND	ND	ND	ND
	09/30/99	ND	ND	29.8	ND	ND	ND	ND	ND
	01/03/00	ND	ND	14	ND	ND	ND	ND	ND
	04/04/00	ND ¹	ND ¹	25	ND ¹	ND ¹	ND ¹	ND ¹	ND ¹
	07/14/00	ND	ND	19	ND	ND	ND	ND	ND
	10/27/00	ND	ND	15	ND	ND	ND	ND	ND
	01/08/01	ND ¹	ND ¹	7.49	ND ¹	ND ¹	ND ¹	ND ¹	ND ¹
	04/03/01	ND	ND	18.1	ND	ND	ND	ND	ND
	07/06/01	ND	ND	19	ND	ND	ND	ND	ND
	10/05/01	<1,000	<100	13	<2.0	<2.0	<2.0	<2.0	<2.0
	01/03/02	<2,500	<100	7.5	<5.0	<5.0	<5.0	<5.0	<5.0
	04/01/02	<1,000	<200	18	<4.0	<4.0	<4.0	<4.0	<4.0
	07/01/02	<25	<5.0	<0.50	<1.0	<0.50	<0.50	<0.50	<0.50
01/24/03	<1,000	<200	5.9	<4.0	<4.0	<4.0	<4.0	<4.0	

Table 2
Groundwater Analytical Results - Oxygenate Compounds
 Tosco (Unocal) Service Station #7176
 7850 Amador Valley Boulevard
 Dublin, California

WELL ID	DATE	ETHANOL (ppb)	TBA (ppb)	MTBE (ppb)	DIPE (ppb)	ETBE (ppb)	TAME (ppb)	1,2-DCA (ppb)	EDB (ppb)
U-3	04/05/99	ND	ND	ND	ND	ND	ND	ND	ND
	07/01/99	ND	ND	ND	ND	ND	ND	ND	ND
	09/30/99	ND	ND	ND	ND	ND	ND	ND	ND
	01/03/00	ND	ND	ND	ND	ND	ND	ND	ND
	04/04/00	ND	ND	ND	ND	ND	ND	ND	ND
	07/14/00	ND	ND	ND	ND	ND	ND	ND	ND
	10/27/00	ND	ND	ND	ND	ND	ND	ND	ND
	01/08/01	ND	ND	ND	ND	ND	ND	ND	ND
	04/03/01	ND	ND	ND	ND	ND	ND	ND	ND
	07/06/01	ND	ND	ND	ND	ND	ND	ND	ND
	10/05/01	<1,000	<100	<2.0	<2.0	<2.0	<2.0	<2.0	<2.0
	01/03/02	<500	<20	<1.0	<1.0	<1.0	<1.0	<1.0	<1.0
	04/01/02	<500	<100	<2.0	<2.0	<2.0	<2.0	<2.0	<2.0
	07/01/02	<25	<5.0	<0.50	<1.0	<0.50	<0.50	<0.50	<0.50
01/24/03	<500	<100	<2.0	<2.0	<2.0	<2.0	<2.0	<2.0	
MW-4	04/05/99	ND	ND	9.3	ND	ND	ND	ND	ND
	07/01/99	ND	ND	21	ND	ND	ND	ND	ND
	09/30/99	ND	ND	22.5	ND	ND	ND	ND	ND
	01/03/00	ND	ND	17	ND	ND	ND	ND	ND
	04/04/00	ND	ND	22	ND	ND	ND	ND	ND
	07/14/00	ND	ND	12	ND	ND	ND	ND	ND
	10/27/00	ND	ND	14	ND	ND	ND	ND	ND
	01/08/01	ND	ND	14.3	ND	ND	ND	ND	ND
	04/03/01	ND	ND	11.6	ND	ND	ND	ND	ND
	07/06/01	ND	ND	7.1	ND	ND	ND	ND	ND
	10/05/01	<1,000	<100	5.4	<2.0	<2.0	<2.0	<2.0	<2.0
	01/03/02	<500	<20	3.1	<1.0	<1.0	<1.0	<1.0	<1.0
	04/01/02	<500	<100	2.2	<2.0	<2.0	<2.0	<2.0	<2.0
	07/01/02	<25	<5.0	0.58	<1.0	<0.50	<0.50	<0.50	<0.50
01/24/03	<500	<100	<2.0	<2.0	<2.0	<2.0	<2.0	<2.0	

Table 2
Groundwater Analytical Results - Oxygenate Compounds
 Tosco (Unocal) Service Station #7176
 7850 Amador Valley Boulevard
 Dublin, California

WELL ID	DATE	ETHANOL (ppb)	TBA (ppb)	MTBE (ppb)	DIPE (ppb)	ETBE (ppb)	TAME (ppb)	1,2-DCA (ppb)	EDB (ppb)
MW-5	04/05/99	ND	ND	ND	ND	ND	ND	ND	ND
	07/01/99	ND	ND	2.3	ND	ND	ND	ND	ND
	09/30/99	ND	ND	ND	ND	ND	ND	ND	ND
	01/03/00	ND	ND	ND	ND	ND	ND	ND	ND
	04/04/00	ND	ND	ND	ND	ND	ND	ND	ND
	07/14/00	ND	ND	ND	ND	ND	ND	ND	ND
	10/27/00	ND	ND	ND	ND	ND	ND	ND	ND
	01/08/01	ND	ND	ND	ND	ND	ND	ND	ND
	04/03/01	ND	ND	ND	ND	ND	ND	ND	ND
	07/06/01	ND	ND	ND	ND	ND	ND	ND	ND
	10/05/01	<1,000	<100	<2.0	<2.0	<2.0	<2.0	<2.0	<2.0
	01/03/02	<500	<20	1.6	<1.0	<1.0	<1.0	<1.0	<1.0
	04/01/02	<500	<100	3.5	<2.0	<2.0	<2.0	<2.0	<2.0
	07/01/02	<25	<5.0	2.3	<1.0	<0.50	<0.50	<0.50	<0.50
	01/24/03	<500	<100	4.3	<2.0	<2.0	<2.0	<2.0	<2.0

Table 2
Groundwater Analytical Results - Oxygenate Compounds
Tosco (Unocal) Service Station #7176
7850 Amador Valley Boulevard
Dublin, California

EXPLANATIONS:

TBA = Tertiary butyl alcohol
MTBE = Methyl tertiary butyl ether
DIPE = Di-isopropyl ether
ETBE = Ethyl tertiary butyl ether
TAME = Tertiary amyl methyl ether
1,2-DCA = 1,2-Dichloroethane
EDB = 1,2-Dibromomethane
(ppb) = Parts per billion
ND = Not Detected
-- = Not Analyzed

¹ Detection limit raised. Refer to analytical reports.

ANALYTICAL METHOD:

EPA Method 8260 for Oxygenate Compounds

Table 3
Dissolved Oxygen Concentrations
Tosco (Unocal) Service Station #7176
7850 Amador Valley Boulevard
Dublin, California

WELL ID	DATE	Before Purging (mg/L)	After Purging (mg/L)
U-1	01/11/96	--	3.41
	04/11/96	3.77	3.78
	07/10/96 ¹	1.22	--
	10/30/96 ¹	1.41	--
	01/27/97 ¹	1.34	--
	04/08/97 ¹	2.09	--
	07/17/97 ¹	2.00	--
	10/17/97 ¹	1.86	--
	01/19/98 ¹	2.91	--
	04/23/98 ¹	0.59	--
	07/08/98 ¹	1.10	--
U-2	01/11/96	--	3.99
	04/11/96	3.32	3.41
	07/10/96 ¹	1.01	--
	10/30/96 ¹	1.42	--
	01/27/97 ¹	1.29	--
	04/08/97 ¹	1.69	--
	07/17/97 ¹	2.08	--
	10/17/97 ¹	1.80	--
	01/19/98 ¹	2.95	--
	04/23/98 ¹	0.55	--
	07/08/98 ¹	1.36	--
U-3	01/11/96	--	5.05
	04/11/96	5.16	4.96
	07/10/96 ¹	3.44	--
	10/30/96 ¹	2.18	--
	01/27/97 ¹	2.61	--
	04/08/97 ¹	3.73	--
	07/17/97 ¹	2.65	--
	10/17/97 ¹	2.44	--
	01/19/98 ¹	6.51	--
	04/23/98 ¹	4.72	--
	07/08/98 ¹	4.35	--
CC-1	10/02/95	2.83	--

EXPLANATIONS:

Dissolved oxygen concentrations prior to January 19, 1998, were compiled from reports prepared by MPDS Services, Inc.

(mg/L) = Milligrams per liter

-- = Not Measured

CC-1 = Conductor casing in the underground storage tank backfill

¹ The wells were not purged on this date.

STANDARD OPERATING PROCEDURE - GROUNDWATER SAMPLING

Gettler-Ryan Inc. field personnel adhere to the following procedures for the collection and handling of groundwater samples prior to analysis by the analytical laboratory. Prior to sample collection, the type of analysis to be performed is determined. Loss prevention of volatile compounds is controlled and sample preservation for subsequent analysis is maintained.

Prior to sampling, the presence or absence of free-phase hydrocarbons is determined using an interface probe. Product thickness, if present, is measured to the nearest 0.01 foot and is noted in the field notes. In addition, all depth to water level measurements are collected with a static water level indicator and are also recorded in the field notes, prior to purging and sampling any wells.

After water levels are collected and prior to sampling, if purging is to occur, each well is purged a minimum of three well casing volumes of water using pre-cleaned pumps (stack, suction, Grundfos), or disposable bailers. Temperature, pH and electrical conductivity are measured a minimum of three times during the purging. Purging continues until these parameters stabilize.

Groundwater samples are collected using disposable bailers. The water samples are transferred from the bailer into appropriate containers. Pre-preserved containers, supplied by analytical laboratories, are used when possible. When pre-preserved containers are not available, the laboratory is instructed to preserve the sample as appropriate. Duplicate samples are collected for the laboratory to use in maintaining quality assurance/quality control standards. The samples are labeled to include the job number, sample identification, collection date and time, analysis, preservation (if any), and the sample collector's initials. The water samples are placed in a cooler, maintained at 4°C for transport to the laboratory. Once collected in the field, all samples are maintained under chain of custody until delivered to the laboratory.

The chain of custody document includes the job number, type of preservation, if any, analysis requested, sample identification, date and time collected, and the sample collector's name. The chain of custody is signed and dated (including time of transfer) by each person who receives or surrenders the samples, beginning with the field personnel and ending with the laboratory personnel.

A laboratory supplied trip blank accompanies each sampling set and is labeled QA. For sampling sets greater than 20 samples, 5% trip blanks are included. The trip blank is analyzed for some or all of the same compounds as the groundwater samples.

As requested by Unocal Corporation, the purge water and decontamination water generated during sampling activities is transported to Tosco - San Francisco Area Refinery, located in Rodeo, California.



GETTLER-RYAN INC.

WELL MONITORING/SAMPLING FIELD DATA SHEET

Client/Facility #: Tosco #7176 Job Number: 180022
 Site Address: 7850 Amador Valley Blvd. Event Date: 1/24/03 (inclusive)
 City: Dublin, CA Sampler: C.R.

Well ID: U-1 Date Monitored: 1/24/03 Well Condition: OK
 Well Diameter: 2 in.
 Total Depth: 27.75 ft.
 Depth to Water: 13.82 ft.
13.93 xVF 0.17 = 2.37 x3 (case volume) = Estimated Purge Volume: 7 gal.

Volume	3/4" = 0.02	1" = 0.04	2" = 0.17	3" = 0.38
Factor (VF)	4" = 0.66	5" = 1.02	6" = 1.50	12" = 5.80

Purge Equipment:
 Disposable Bailer
 Stainless Steel Bailer _____
 Stack Pump _____
 Suction Pump _____
 Grundfos _____
 Other: _____

Sampling Equipment:
 Disposable Bailer
 Pressure Bailer _____
 Discrete Bailer _____
 Other: _____

Time Started: _____ (2400 hrs)
 Time Bailed: _____ (2400 hrs)
 Depth to Product: _____ ft
 Depth to Water: _____ ft
 Hydrocarbon Thickness: 0 ft
 Visual Confirmation/Description: _____
 Skimmer / Absorbant Sock (circle one)
 Amt Removed from Skimmer: _____ gal
 Amt Removed from Well: _____ gal
 Product Transferred to: _____

Start Time (purge): 1305 Weather Conditions: Partly Cloudy
 Sample Time/Date: 1330 1/24/03 Water Color: grey Odor: yes
 Purging Flow Rate: _____ gpm. Sediment Description: _____
 Did well de-water? No If yes, Time: _____ Volume: _____ gal.

Time (2400 hr.)	Volume (gal.)	pH	Conductivity (umhos/cm)	Temperature (C/F)	D.O. (mg/L)	ORP (mV)
<u>1312</u>	<u>2</u>	<u>6.71</u>	<u>551</u>	<u>22.8</u>	_____	_____
<u>1316</u>	<u>4</u>	<u>6.63</u>	<u>541</u>	<u>22.8</u>	_____	_____
<u>1320</u>	<u>7</u>	<u>6.64</u>	<u>543</u>	<u>22.8</u>	_____	_____
_____	_____	_____	_____	_____	_____	_____

LABORATORY INFORMATION

SAMPLE ID	(#) CONTAINER	REFRIG.	PRESERV. TYPE	LABORATORY	ANALYSES
<u>U-1</u>	<u>3</u> x vva vial	<u>YES</u>	<u>HCL</u>	<u>STL Pleasanton</u>	<u>TPH-G/BTEX/MTBE/8 Oxy's(8260)</u>
<u>U-1</u>	<u>1</u> x 500ml Amber	<u>YES</u>	<u>NP</u>	<u>STL Pleasanton</u>	<u>TPH-D</u>
_____	_____	_____	_____	_____	_____

COMMENTS: _____

Add/Replaced Lock: _____ Add/Replaced Plug: _____ Size: _____



GETTLER-RYAN INC.

WELL MONITORING/SAMPLING FIELD DATA SHEET

Client/Facility #: Tosco #7176 Job Number: 180022
 Site Address: 7850 Amador Valley Blvd. Event Date: 1/24/03 (inclusive)
 City: Dublin, CA Sampler: GR

Well ID: U-2 Date Monitored: 1/24/03 Well Condition: OK
 Well Diameter: 2 in.
 Total Depth: 26.95 ft.
 Depth to Water: 14.31 ft.
12.14 xVF 0.17 = 2.06 x3 (case volume) = Estimated Purge Volume: 6 gal.

Volume	3/4"= 0.02	1"= 0.04	2"= 0.17	3"= 0.38
Factor (VF)	4"= 0.66	5"= 1.02	6"= 1.50	12"= 5.80

Purge Equipment:
 Disposable Bailer
 Stainless Steel Bailer _____
 Stack Pump _____
 Suction Pump _____
 Grundfos _____
 Other: _____

Sampling Equipment:
 Disposable Bailer
 Pressure Bailer _____
 Discrete Bailer _____
 Other: _____

Time Started: _____ (2400 hrs)
 Time Bailed: _____ (2400 hrs)
 Depth to Product: _____ ft
 Depth to Water: _____ ft
 Hydrocarbon Thickness: 0 ft
 Visual Confirmation/Description:
 Skimmer / Absorbant Sock (circle one)
 Amt Removed from Skimmer: _____ gal
 Amt Removed from Well: _____ gal
 Product Transferred to: _____

Start Time (purge): 1235 Weather Conditions: Overcast
 Sample Time/Date: 1300 / 1/24/03 Water Color: Clear Odor: Yes
 Purging Flow Rate: — gpm. Sediment Description: _____
 Did well de-water? NO If yes, Time: _____ Volume: _____ gal.

Time (2400 hr.)	Volume (gal.)	pH	Conductivity (u/mhos/cm)	Temperature (°F)	D.O. (mg/L)	ORP (mV)
<u>1243</u>	<u>2</u>	<u>6.79</u>	<u>628</u>	<u>22.6</u>	_____	_____
<u>1247</u>	<u>4</u>	<u>6.73</u>	<u>619</u>	<u>22.6</u>	_____	_____
<u>1250</u>	<u>6</u>	<u>6.75</u>	<u>620</u>	<u>22.5</u>	_____	_____
_____	_____	_____	_____	_____	_____	_____

LABORATORY INFORMATION

SAMPLE ID	(#) CONTAINER	REFRIG.	PRESERV. TYPE	LABORATORY	ANALYSES
<u>U-2</u>	<u>3</u> x vov vial	YES	HCL	STL Pleasanton	TPH-G/BTEX/MTBE/8 Oxy's(8260)
<u>U-2</u>	<u>1</u> x 500ml Amber	YES	NP	STL Pleasanton	TPH-D
_____	_____	_____	_____	_____	_____
_____	_____	_____	_____	_____	_____

COMMENTS: _____

Add/Replaced Lock: _____ Add/Replaced Plug: _____ Size: _____



GETTLER-RYAN INC.

WELL MONITORING/SAMPLING FIELD DATA SHEET

Client/Facility #: Tosco #7176 Job Number: 180022
 Site Address: 7850 Amador Valley Blvd. Event Date: 1/24/03 (inclusive)
 City: Dublin, CA Sampler: G.R.

Well ID: U-3 Date Monitored: 1/24/03 Well Condition: OK
 Well Diameter: 2 in.
 Total Depth: 28.35 ft.
 Depth to Water: 15.75 ft.
12.6 xVF 0.17 = 2.14 x3 (case volume) = Estimated Purge Volume: 6.5 gal.

Volume	3/4"= 0.02	1"= 0.04	2"= 0.17	3"= 0.38
Factor (VF)	4"= 0.66	5"= 1.02	6"= 1.50	12"= 5.80

Purge Equipment:
 Disposable Bailer
 Stainless Steel Bailer _____
 Stack Pump _____
 Suction Pump _____
 Grundfos _____
 Other: _____

Sampling Equipment:
 Disposable Bailer
 Pressure Bailer _____
 Discrete Bailer _____
 Other: _____

Time Started: _____ (2400 hrs)
 Time Bailed: _____ (2400 hrs)
 Depth to Product: _____ ft
 Depth to Water: _____ ft
 Hydrocarbon Thickness: 0 ft
 Visual Confirmation/Description:
 Skimmer / Absorbant Sock (circle one)
 Amt Removed from Skimmer: _____ gal
 Amt Removed from Well: _____ gal
 Product Transferred to: _____

Start Time (purge): 1045 Weather Conditions: overcast
 Sample Time/Date: 1/20/1/24/03 Water Color: Clear Odor: No
 Purging Flow Rate: _____ gpm. Sediment Description: _____
 Did well de-water? No If yes, Time: _____ Volume: _____ gal.

Time (2400 hr.)	Volume (gal.)	pH	Conductivity (umhos/cm)	Temperature (C/F)	D.O. (mg/L)	ORP (mV)
<u>1049</u>	<u>2</u>	<u>6.40</u>	<u>648</u>	<u>24.2</u>	_____	_____
<u>1054</u>	<u>4</u>	<u>6.38</u>	<u>638</u>	<u>24.2</u>	_____	_____
<u>1102</u>	<u>6.5</u>	<u>6.38</u>	<u>636</u>	<u>24.3</u>	_____	_____
_____	_____	_____	_____	_____	_____	_____

LABORATORY INFORMATION

SAMPLE ID	(#) CONTAINER	REFRIG.	PRESERV. TYPE	LABORATORY	ANALYSES
<u>U-3</u>	<u>3</u> x vov vial	YES	HCL	STL Pleasanton	TPH-G/BTEX/MTBE/8 Oxy's(8260)
<u>U-2</u>	<u>1</u> x 500ml Amber	YES	NP	STL Pleasanton	TPH-D
_____	_____	_____	_____	_____	_____
_____	_____	_____	_____	_____	_____

COMMENTS: _____

Add/Replaced Lock: _____ Add/Replaced Plug: _____ Size: _____



GETTLER-RYAN INC.

WELL MONITORING/SAMPLING FIELD DATA SHEET

Client/Facility #: Tosco #7176 Job Number: 180022
 Site Address: 7850 Amador Valley Blvd. Event Date: 1/24/03 (inclusive)
 City: Dublin, CA Sampler: G.R.

Well ID: MW-4 Date Monitored: 1/24/03 Well Condition: OK

Well Diameter: 2 in.

Total Depth: 25.45 ft.

Depth to Water: 14.52 ft.

Volume	3/4"= 0.02	1"= 0.04	2"= 0.17	3"= 0.38
Factor (VF)	4"= 0.66	5"= 1.02	6"= 1.50	12"= 5.80

10.93 xVF 0.17 = 1.86 x3 (case volume) = Estimated Purge Volume: 5.5 gal.

Purge Equipment:

Disposable Bailer
 Stainless Steel Bailer _____
 Stack Pump _____
 Suction Pump _____
 Grundfos _____
 Other: _____

Sampling Equipment:

Disposable Bailer
 Pressure Bailer _____
 Discrete Bailer _____
 Other: _____

Time Started:	_____ (2400 hrs)
Time Bailed:	_____ (2400 hrs)
Depth to Product:	_____ ft
Depth to Water:	_____ ft
Hydrocarbon Thickness:	<u>0</u> ft
Visual Confirmation/Description:	_____
Skimmer / Absorbent Sock (circle one)	_____
Amt Removed from Skimmer:	_____ gal
Amt Removed from Well:	_____ gal
Product Transferred to:	_____

Start Time (purge): 1200 Weather Conditions: overcast
 Sample Time/Date: 1230 1/24/03 Water Color: clear Odor: slight
 Purging Flow Rate: — gpm. Sediment Description: _____
 Did well de-water? NO If yes, Time: _____ Volume: _____ gal.

Time (2400 hr.)	Volume (gal.)	pH	Conductivity (u mhos/cm)	Temperature (C/F)	D.O. (mg/L)	ORP (mV)
<u>1210</u>	<u>2</u>	<u>6.44</u>	<u>633</u>	<u>22.6</u>	_____	_____
<u>1213</u>	<u>4</u>	<u>6.38</u>	<u>624</u>	<u>22.6</u>	_____	_____
<u>1218</u>	<u>5.5</u>	<u>6.35</u>	<u>628</u>	<u>22.5</u>	_____	_____
_____	_____	_____	_____	_____	_____	_____

LABORATORY INFORMATION

SAMPLE ID	(#) CONTAINER	REFRIG.	PRESERV. TYPE	LABORATORY	ANALYSES
<u>MW-4</u>	<u>3</u> x voa vial	<u>YES</u>	<u>HCL</u>	<u>STL Pleasanton</u>	<u>TPH-G/BTEX/MTBE/8 Oxy's(8260)</u>
<u>MW-4</u>	<u>1</u> x 500ml Amber	<u>YES</u>	<u>NP</u>	<u>STL Pleasanton</u>	<u>TPH-D</u>
_____	_____	_____	_____	_____	_____
_____	_____	_____	_____	_____	_____

COMMENTS:

Add/Replaced Lock: _____

Add/Replaced Plug: _____ Size: _____



GETTLER - RYAN INC.

WELL MONITORING/SAMPLING FIELD DATA SHEET

Client/Facility #: Tosco #7176 Job Number: 180022
 Site Address: 7850 Amador Valley Blvd. Event Date: 1/24/03 (inclusive)
 City: Dublin, CA Sampler: G.R.

Well ID: MW-5 Date Monitored: 1/24/03 Well Condition: X
 Well Diameter: 2 in.
 Total Depth: 24.80 ft.
 Depth to Water: 13.53 ft.
 $11.27 \times VF \ 0.17 = 1.92 \times 3 \text{ (case volume)} = \text{Estimated Purge Volume: } 5.5 \text{ gal.}$

Volume	3/4"= 0.02	1"= 0.04	2"= 0.17	3"= 0.38
Factor (VF)	4"= 0.66	5"= 1.02	6"= 1.50	12"= 5.80

Purge Equipment:
 Disposable Bailer
 Stainless Steel Bailer _____
 Stack Pump _____
 Suction Pump _____
 Grundfos _____
 Other: _____

Sampling Equipment:
 Disposable Bailer
 Pressure Bailer _____
 Discrete Bailer _____
 Other: _____

Time Started: _____ (2400 hrs)
 Time Bailed: _____ (2400 hrs)
 Depth to Product: _____ ft
 Depth to Water: _____ ft
 Hydrocarbon Thickness: 0 ft
 Visual Confirmation/Description: _____
 Skimmer / Absorbant Sock (circle one)
 Amt Removed from Skimmer: _____ gal
 Amt Removed from Well: _____ gal
 Product Transferred to: _____

Start Time (purge): 1125 Weather Conditions: Overcast
 Sample Time/Date: 1155 1/24/03 Water Color: Clear Odor: NO
 Purging Flow Rate: _____ gpm. Sediment Description: _____
 Did well de-water? NO If yes, Time: _____ Volume: _____ gal.

Time (2400 hr.)	Volume (gal.)	pH	Conductivity (u mhos/cm)	Temperature (°F)	D.O. (mg/L)	ORP (mV)
1131	2	6.72	626	22.4		
1134	4	6.70	623	22.6		
1142	5.5	6.64	625	22.5		

LABORATORY INFORMATION

SAMPLE ID	(#) CONTAINER	REFRIG.	PRESERV. TYPE	LABORATORY	ANALYSES
MW-5	3 x vov vial	YES	HCL	STL Pleasanton	TPH-G/BTEX/MTBE/8 Oxy's(8260)
	1 x 500ml Amber	YES	NP	STL Pleasanton	TPH-D

COMMENTS: * Lid missing from vault - Had to dig out packed mud to allow access to casing well casing is not damaged yet
 Add/Replaced Lock: _____ Add/Replaced Plug: _____ Size: _____

2003-01-0461

Gettler-Ryan Inc., Chain-of-Custody

Feb 17 03 04:38p

st10n site

9256003002

P.1

71620

Toaco Corp./
Phillips 66 Co.
100 Crow Canyon Place
Suite 400
San Ramon, CA 94583

Facility Number 77176
 Facility Address 7850 AMADOR VALLEY BLVD., DUBLIN, CA
 Global ID T0600101883 Project 180022.80
 Client Contact MR. DAVID B. DEWITT
 Phone (925) 277-2384

Laboratory Name STL - PLEASANTON, CA
 Consultant GETTLER-RYAN, INC. DEANNA L. HARDING
 Address 6747 SIERRA CT., SUITE J, DUBLIN CA 94568
 Phone (925) 551-7555 Fax (925) 551-7899
 Samples Collected by G. Rojew

SAMPLE ID	Number of Containers Matrix	S = Soil A = Air W = Water C = Charcoal	Sample Preservation	Date/Time (2400 Hrs)	TPH-GAS/BTEX/MTBE EPA 8015/80215	TPH-DIESEL EPA 8015	TPH-DIESEL w/Silica gel EPA 8015	TPH-GAS EPA 8015	TPH-GAS/BTEX/MTBE EPA 8260	8 OXYGENATES EPA 8260	METHANOL EPA 8015	TOTAL OIL & GREASE EPA 5520	METALS Cd, Cr, Pb, Zn, Ni	NITRATE/SULFATE/ALKALINITY EPA 300 SERIES	HWOC'S (8010) EPA 80218	VOC'S (8240) EPA 8260	SWOC'S EPA 8270	Remarks
QA	1	W	HCL	1/24/03					✓									
U-1	4	W	HCL NP	1330		✓			✓	✓								Run Silica Gel Cleanup on Diesel hits.
U-2	4	W	HCL NP	1300		✓			✓	✓								
U-3	4	W	HCL NP	1120		✓			✓	✓								
MW-4	4	W	HCL NP	1230		✓			✓	✓								
MW-5	4	W	HCL NP	✓ 1155		✓			✓	✓								

- OXYGENATES 8260
- 1 - MTBE
 - 2 - TBA
 - 3 - TAME
 - 4 - DIPE
 - 5 - ETBE
 - 6 - 1,2-DCA
 - 7 - EDB
 - 8 - ETHANOL

Shipped By (Signature) 	Organization <u>Gettler</u>	Date/Time <u>1/24/03</u> <u>1355</u>	Received By (Signature) 	Organization	Date/Time	Lead Y/N	Turn Around Time (Circle Choice) 24 Hrs. 48 Hrs. 72 Hrs. 5 Days 10 Days <u>As Contracted</u>
Shipped By (Signature)	Organization	Date/Time	Received By (Signature)	Organization	Date/Time	Lead Y/N	
Shipped By (Signature)	Organization	Date/Time	Received For Laboratory By (Signature) 	Organization	Date/Time <u>1-24-03</u>	Lead Y/N <u>1610</u>	

February 17, 2003

Gettler Ryan

6747 Sierra Court Suite J
Dublin, CA 94568

Attn.: Deanna Harding

Project#: 180022.80

Project: Tosco #7176

Site: 7850 Amador Valley Blvd.
Dublin, CA

RECEIVED

FEB 17 2003

GETTLER RYAN INC

GENERAL CONTRACTOR

Dear Ms. Harding,

Attached is our report for your samples received on 01/24/2003 16:10
This report has been reviewed and approved for release. Reproduction of this report
is permitted only in its entirety.

Please note that any unused portion of the samples will be discarded after
03/10/2003 unless you have requested otherwise.

We appreciate the opportunity to be of service to you. If you have any questions,
please call me at (925) 484-1919.

You can also contact me via email. My email address is: tgranicher@stl-inc.com

Sincerely,



Tod Granicher
Project Manager

Severn Trent Laboratories, Inc.

STL San Francisco * 1220 Quarry Lane, Pleasanton, CA 94566

Tel 925 484 1919 Fax 925 484 1096 * www.stl-inc.com * CA DHS ELAP# 2496

Diesel

Gettler Ryan

Attn.: Deanna Harding

6747 Sierra Court Suite J

Dublin, CA 94568

Phone: (925) 551-7444 Fax: (925) 551-7899

Project: 180022.80

Tosco #7176

Received: 01/24/2003 16:10

Site: 7850 Amador Valley Blvd.
Dublin, CA**Samples Reported**

Sample Name	Date Sampled	Matrix	Lab #
U-1	01/24/2003 13:30	Water	2
U-2	01/24/2003 13:00	Water	3
U-3	01/24/2003 11:20	Water	4
MW-4	01/24/2003 12:30	Water	5
MW-5	01/24/2003 11:55	Water	6

Gas/BTEX Fuel Oxygenates by 8260B

Gettler Ryan

Attn.: Deanna Harding

6747 Sierra Court Suite J

Dublin, CA 94568

Phone: (925) 551-7444 Fax: (925) 551-7899

Project: 180022.80

Tosco #7176

Received: 01/24/2003 16:10

Site: 7850 Amador Valley Blvd.
Dublin, CA

Samples Reported

Sample Name	Date Sampled	Matrix	Lab #
QA	01/24/2003	Water	1
U-1	01/24/2003 13:30	Water	2
U-2	01/24/2003 13:00	Water	3
U-3	01/24/2003 11:20	Water	4
MW-4	01/24/2003 12:30	Water	5
MW-5	01/24/2003 11:55	Water	6

Gas/BTEX Fuel Oxygenates by 8260B

Gettler Ryan

Attn.: Deanna Harding

6747 Sierra Court Suite J

Dublin, CA 94568

Phone: (925) 551-7444 Fax: (925) 551-7899

Project: 180022.80

Tosco #7176

Received: 01/24/2003 16:10

Site: 7850 Amador Valley Blvd.

Dublin, CA

Prep(s):	5030B	Test(s):	8260FAB
Sample ID:	QA	Lab ID:	2003-01-0461 - 1
Sampled:	01/24/2003	Extracted:	2/2/2003 12:56
Matrix:	Water	QC Batch#:	2003/02/02-01.62

Compound	Conc.	RL	Unit	Dilution	Analyzed	Flag
Gasoline	ND	50	ug/L	1.00	02/02/2003 12:56	
Benzene	ND	0.50	ug/L	1.00	02/02/2003 12:56	
Toluene	ND	0.50	ug/L	1.00	02/02/2003 12:56	
Ethylbenzene	ND	0.50	ug/L	1.00	02/02/2003 12:56	
Total xylenes	ND	1.0	ug/L	1.00	02/02/2003 12:56	
Methyl tert-butyl ether (MTBE)	ND	2.0	ug/L	1.00	02/02/2003 12:56	
Surrogates(s)						
1,2-Dichloroethane-d4	102.8	76-114	%	1.00	02/02/2003 12:56	
Toluene-d8	94.6	88-110	%	1.00	02/02/2003 12:56	

Gas/BTEX Fuel Oxygenates by 8260B

Gettler Ryan

Attn.: Deanna Harding

6747 Sierra Court Suite J

Dublin, CA 94568

Phone: (925) 551-7444 Fax: (925) 551-7899

Project: 180022.80

Tosco #7176

Received: 01/24/2003 16:10

Site: 7850 Amador Valley Blvd.

Dublin, CA

Prep(s):	5030B	Test(s):	8260FAB
Sample ID:	U-1	Lab ID:	2003-01-0461 - 2
Sampled:	01/24/2003 13:30	Extracted:	2/3/2003 16:34
Matrix:	Water	QC Batch#:	2003/02/03-01.62
Analysis Flag: o (See Legend and Note Section)			

Compound	Conc.	RL	Unit	Dilution	Analyzed	Flag
Gasoline	3400	250	ug/L	5.00	02/03/2003 16:34	
Benzene	ND	2.5	ug/L	5.00	02/03/2003 16:34	
Toluene	ND	2.5	ug/L	5.00	02/03/2003 16:34	
Ethylbenzene	37	2.5	ug/L	5.00	02/03/2003 16:34	
Total xylenes	ND	5.0	ug/L	5.00	02/03/2003 16:34	
tert-Butyl alcohol (TBA)	ND	500	ug/L	5.00	02/03/2003 16:34	
Methyl tert-butyl ether (MTBE)	21	10	ug/L	5.00	02/03/2003 16:34	
Di-isopropyl Ether (DIPE)	ND	10	ug/L	5.00	02/03/2003 16:34	
Ethyl tert-butyl ether (ETBE)	ND	10	ug/L	5.00	02/03/2003 16:34	
tert-Amyl methyl ether (TAME)	ND	10	ug/L	5.00	02/03/2003 16:34	
1,2-DCA	ND	10	ug/L	5.00	02/03/2003 16:34	
EDB	ND	10	ug/L	5.00	02/03/2003 16:34	
Ethanol	ND	2500	ug/L	5.00	02/03/2003 16:34	
Surrogates(s)						
1,2-Dichloroethane-d4	119.9	76-114	%	5.00	02/03/2003 16:34	sh
Toluene-d8	98.9	88-110	%	5.00	02/03/2003 16:34	

Gas/BTEX Fuel Oxygenates by 8260B

Gettler Ryan

Attn.: Deanna Harding

6747 Sierra Court Suite J

Dublin, CA 94568

Phone: (925) 551-7444 Fax: (925) 551-7899

Project: 180022.80

Tosco #7176

Received: 01/24/2003 16:10

Site: 7850 Amador Valley Blvd.

Dublin, CA

Prep(s):	5030B	Test(s):	8260FAB
Sample ID:	U-2	Lab ID:	2003-01-0461-8
Sampled:	01/24/2003 13:00	Extracted:	2/6/2003 12:15
Matrix:	Water	QC Batch#:	2003/02/06-01.27
Analysis Flag: o (See Legend and Note Section)			

Compound	Conc.	RL	Unit	Dilution	Analyzed	Flag
Gasoline	2300	100	ug/L	2.00	02/06/2003 12:15	
Benzene	1.1	1.0	ug/L	2.00	02/06/2003 12:15	
Toluene	1.5	1.0	ug/L	2.00	02/06/2003 12:15	
Ethylbenzene	6.9	1.0	ug/L	2.00	02/06/2003 12:15	
Total xylenes	2.4	2.0	ug/L	2.00	02/06/2003 12:15	
tert-Butyl alcohol (TBA)	ND	200	ug/L	2.00	02/06/2003 12:15	
Methyl tert-butyl ether (MTBE)	5.9	4.0	ug/L	2.00	02/06/2003 12:15	
Di-isopropyl Ether (DIPE)	ND	4.0	ug/L	2.00	02/06/2003 12:15	
Ethyl tert-butyl ether (ETBE)	ND	4.0	ug/L	2.00	02/06/2003 12:15	
tert-Amyl methyl ether (TAME)	ND	4.0	ug/L	2.00	02/06/2003 12:15	
1,2-DCA	ND	4.0	ug/L	2.00	02/06/2003 12:15	
EDB	ND	4.0	ug/L	2.00	02/06/2003 12:15	
Ethanol	ND	1000	ug/L	2.00	02/06/2003 12:15	
Surrogates(s)						
1,2-Dichloroethane-d4	111.2	76-114	%	2.00	02/06/2003 12:15	
Toluene-d8	92.0	88-110	%	2.00	02/06/2003 12:15	

Severn Trent Laboratories, Inc.

STL San Francisco * 1220 Quarry Lane, Pleasanton, CA 94566

Tel 925 484 1919 Fax 925 484 1096 * www.stl-inc.com * CA DHS ELAP# 2496

02/07/2003 11:51

Gas/BTEX Fuel Oxygenates by 8260B

Gettler Ryan

Attn.: Deanna Harding

6747 Sierra Court Suite J

Dublin, CA 94568

Phone: (925) 551-7444 Fax: (925) 551-7899

Project: 180022.80

Tosco #7176

Received: 01/24/2003 16:10

Site: 7850 Amador Valley Blvd.

Dublin, CA

Prep(s):	5030B	Test(s):	8260FAB
Sample ID:	U-3	Lab ID:	2003-01-0461 - 4
Sampled:	01/24/2003 11:20	Extracted:	2/6/2003 12:36
Matrix:	Water	QC Batch#:	2003/02/06-01 27

Compound	Conc.	RL	Unit	Dilution	Analyzed	Flag
Gasoline	ND	50	ug/L	1.00	02/06/2003 12:36	
Benzene	ND	0.50	ug/L	1.00	02/06/2003 12:36	
Toluene	ND	0.50	ug/L	1.00	02/06/2003 12:36	
Ethylbenzene	ND	0.50	ug/L	1.00	02/06/2003 12:36	
Total xylenes	ND	1.0	ug/L	1.00	02/06/2003 12:36	
tert-Butyl alcohol (TBA)	ND	100	ug/L	1.00	02/06/2003 12:36	
Methyl tert-butyl ether (MTBE)	ND	2.0	ug/L	1.00	02/06/2003 12:36	
Di-isopropyl Ether (DIPE)	ND	2.0	ug/L	1.00	02/06/2003 12:36	
Ethyl tert-butyl ether (ETBE)	ND	2.0	ug/L	1.00	02/06/2003 12:36	
tert-Amyl methyl ether (TAME)	ND	2.0	ug/L	1.00	02/06/2003 12:36	
1,2-DCA	ND	2.0	ug/L	1.00	02/06/2003 12:36	
EDB	ND	2.0	ug/L	1.00	02/06/2003 12:36	
Ethanol	ND	500	ug/L	1.00	02/06/2003 12:36	
Surrogates(s)						
1,2-Dichloroethane-d4	105.3	76-114	%	1.00	02/06/2003 12:36	
Toluene-d8	98.5	88-110	%	1.00	02/06/2003 12:36	

Gas/BTEX Fuel Oxygenates by 8260B

Gettler Ryan

Attn.: Deanna Harding

6747 Sierra Court Suite J

Dublin, CA 94568

Phone: (925) 551-7444 Fax: (925) 551-7899

Project: 180022.80
Tosco #7176

Received: 01/24/2003 16:10

Site: 7850 Amador Valley Blvd.
Dublin, CA

Prep(s): 5030B	Test(s): 8260FAB
Sample ID: MW-4	Lab ID: 2003-01-0461 - 5
Sampled: 01/24/2003 12:30	Extracted: 2/6/2003 12:58
Matrix: Water	QC Batch#: 2003/02/06-01.27

Compound	Conc.	RL	Unit	Dilution	Analyzed	Flag
Gasoline	170	50	ug/L	1.00	02/06/2003 12:58	g
Benzene	ND	0.50	ug/L	1.00	02/06/2003 12:58	
Toluene	ND	0.50	ug/L	1.00	02/06/2003 12:58	
Ethylbenzene	ND	0.50	ug/L	1.00	02/06/2003 12:58	
Total xylenes	ND	1.0	ug/L	1.00	02/06/2003 12:58	
tert-Butyl alcohol (TBA)	ND	100	ug/L	1.00	02/06/2003 12:58	
Methyl tert-butyl ether (MTBE)	ND	2.0	ug/L	1.00	02/06/2003 12:58	
Di-isopropyl Ether (DIPE)	ND	2.0	ug/L	1.00	02/06/2003 12:58	
Ethyl tert-butyl ether (ETBE)	ND	2.0	ug/L	1.00	02/06/2003 12:58	
tert-Amyl methyl ether (TAME)	ND	2.0	ug/L	1.00	02/06/2003 12:58	
1,2-DCA	ND	2.0	ug/L	1.00	02/06/2003 12:58	
EDB	ND	2.0	ug/L	1.00	02/06/2003 12:58	
Ethanol	ND	500	ug/L	1.00	02/06/2003 12:58	
Surrogates(s)						
1,2-Dichloroethane-d4	106.5	76-114	%	1.00	02/06/2003 12:58	
Toluene-d8	97.8	88-110	%	1.00	02/06/2003 12:58	

Gas/BTEX Fuel Oxygenates by 8260B

Gettler Ryan

Attn.: Deanna Harding

6747 Sierra Court Suite J

Dublin, CA 94568

Phone: (925) 551-7444 Fax: (925) 551-7899

Project: 180022.80

Tosco #7176

Received: 01/24/2003 16:10

Site: 7850 Amador Valley Blvd.

Dublin, CA

Prep(s):	5030B	Test(s):	8260FAB
Sample ID:	MW-5	Lab ID:	2003-01-0461 - 6
Sampled:	01/24/2003 11:55	Extracted:	2/6/2003 13:19
Matrix:	Water	QC Batch#:	2003/02/06-01.27

Compound	Conc.	RL	Unit	Dilution	Analyzed	Flag
Gasoline	ND	50	ug/L	1.00	02/06/2003 13:19	
Benzene	ND	0.50	ug/L	1.00	02/06/2003 13:19	
Toluene	ND	0.50	ug/L	1.00	02/06/2003 13:19	
Ethylbenzene	ND	0.50	ug/L	1.00	02/06/2003 13:19	
Total xylenes	ND	1.0	ug/L	1.00	02/06/2003 13:19	
tert-Butyl alcohol (TBA)	ND	100	ug/L	1.00	02/06/2003 13:19	
Methyl tert-butyl ether (MTBE)	4.3	2.0	ug/L	1.00	02/06/2003 13:19	
Di-isopropyl Ether (DIPE)	ND	2.0	ug/L	1.00	02/06/2003 13:19	
Ethyl tert-butyl ether (ETBE)	ND	2.0	ug/L	1.00	02/06/2003 13:19	
tert-Amyl methyl ether (TAME)	ND	2.0	ug/L	1.00	02/06/2003 13:19	
1,2-DCA	ND	2.0	ug/L	1.00	02/06/2003 13:19	
EDB	ND	2.0	ug/L	1.00	02/06/2003 13:19	
Ethanol	ND	500	ug/L	1.00	02/06/2003 13:19	
Surrogates(s)						
1,2-Dichloroethane-d4	111.5	76-114	%	1.00	02/06/2003 13:19	
Toluene-d8	98.7	88-110	%	1.00	02/06/2003 13:19	

Gas/BTEX Fuel Oxygenates by 8260B

Gettler Ryan
Attn.: Deanna Harding

6747 Sierra Court Suite J
Dublin, CA 94568
Phone: (925) 551-7444 Fax: (925) 551-7899

Project: 180022.80
Tosco #7176

Received: 01/24/2003 16:10

Site: 7850 Amador Valley Blvd.
Dublin, CA

Batch QC Report					
Prep(s): 5030B				Test(s): 8260FAB	
Method Blank		Water		QC Batch # 2003/02/02-01.62	
MB: 2003/02/02-01.62-057				Date Extracted: 02/02/2003 11:57	

Compound	Conc.	RL	Unit	Analyzed	Flag
Gasoline	ND	50	ug/L	02/02/2003 11:57	
Benzene	ND	0.5	ug/L	02/02/2003 11:57	
Toluene	ND	0.5	ug/L	02/02/2003 11:57	
Ethylbenzene	ND	0.5	ug/L	02/02/2003 11:57	
Total xylenes	ND	1.0	ug/L	02/02/2003 11:57	
tert-Butyl alcohol (TBA)	ND	100	ug/L	02/02/2003 11:57	
Methyl tert-butyl ether (MTBE)	ND	2.0	ug/L	02/02/2003 11:57	
Di-isopropyl Ether (DIPE)	ND	2.0	ug/L	02/02/2003 11:57	
Ethyl tert-butyl ether (ETBE)	ND	2.0	ug/L	02/02/2003 11:57	
tert-Amyl methyl ether (TAME)	ND	2.0	ug/L	02/02/2003 11:57	
1,2-DCA	ND	2.0	ug/L	02/02/2003 11:57	
EDB	ND	2.0	ug/L	02/02/2003 11:57	
Ethanol	ND	500	ug/L	02/02/2003 11:57	
Surrogates(s)					
1,2-Dichloroethane-d4	110.4	76-114	%	02/02/2003 11:57	
Toluene-d8	96.0	88-110	%	02/02/2003 11:57	

Gas/BTEX Fuel Oxygenates by 8260B

Gettler Ryan

Attn.: Deanna Harding

6747 Sierra Court Suite J

Dublin, CA 94568

Phone: (925) 551-7444 Fax: (925) 551-7899

Project: 180022.80

Tosco #7176

Received: 01/24/2003 16:10

Site: 7850 Amador Valley Blvd.

Dublin, CA

Batch QC Report		
Prep(s): 5030B		Test(s): 8260FAB
Method Blank	Water	QC Batch # 2003/02/03-01.62
MB: 2003/02/03-01.62-003		Date Extracted: 02/03/2003 11:03

Compound	Conc.	RL	Unit	Analyzed	Flag
Gasoline	ND	50	ug/L	02/03/2003 11:03	
Benzene	ND	0.5	ug/L	02/03/2003 11:03	
Toluene	ND	0.5	ug/L	02/03/2003 11:03	
Ethylbenzene	ND	0.5	ug/L	02/03/2003 11:03	
Total xylenes	ND	1.0	ug/L	02/03/2003 11:03	
tert-Butyl alcohol (TBA)	ND	100	ug/L	02/03/2003 11:03	
Methyl tert-butyl ether (MTBE)	ND	1.0	ug/L	02/03/2003 11:03	
Di-isopropyl Ether (DIPE)	ND	2.0	ug/L	02/03/2003 11:03	
Ethyl tert-butyl ether (ETBE)	ND	2.0	ug/L	02/03/2003 11:03	
tert-Amyl methyl ether (TAME)	ND	2.0	ug/L	02/03/2003 11:03	
1,2-DCA	ND	2.0	ug/L	02/03/2003 11:03	
EDB	ND	2.0	ug/L	02/03/2003 11:03	
Ethanol	ND	500	ug/L	02/03/2003 11:03	
Surrogates(s)					
1,2-Dichloroethane-d4	106.5	76-114	%	02/03/2003 11:03	
Toluene-d8	95.0	88-110	%	02/03/2003 11:03	

Gas/BTEX Fuel Oxygenates by 8260B

Gettler Ryan
Attn.: Deanna Harding

6747 Sierra Court Suite J
Dublin, CA 94568
Phone: (925) 551-7444 Fax: (925) 551-7899

Project: 180022.80
Tosco #7176

Received: 01/24/2003 16:10

Site: 7850 Amador Valley Blvd.
Dublin, CA

Batch QC Report			
Prep(s): 5030B			Test(s): 8260FAB
Method Blank	Water		QC Batch # 2003/02/06-01.27
MB: 2003/02/06-01.27-005			Date Extracted: 02/06/2003 10:59

Compound	Conc.	RL	Unit	Analyzed	Flag
Gasoline	ND	50	ug/L	02/06/2003 10:59	
Benzene	ND	0.5	ug/L	02/06/2003 10:59	
Toluene	ND	0.5	ug/L	02/06/2003 10:59	
Ethylbenzene	ND	0.5	ug/L	02/06/2003 10:59	
Total xylenes	ND	1.0	ug/L	02/06/2003 10:59	
tert-Butyl alcohol (TBA)	ND	100	ug/L	02/06/2003 10:59	
Methyl tert-butyl ether (MTBE)	ND	2.0	ug/L	02/06/2003 10:59	
Di-isopropyl Ether (DIPE)	ND	2.0	ug/L	02/06/2003 10:59	
Ethyl tert-butyl ether (ETBE)	ND	2.0	ug/L	02/06/2003 10:59	
tert-Amyl methyl ether (TAME)	ND	2.0	ug/L	02/06/2003 10:59	
1,2-DCA	ND	2.0	ug/L	02/06/2003 10:59	
EDB	ND	2.0	ug/L	02/06/2003 10:59	
Ethanol	ND	500	ug/L	02/06/2003 10:59	
Surrogates(s)					
1,2-Dichloroethane-d4	104.9	76-114	%	02/06/2003 10:59	
Toluene-d8	94.6	88-110	%	02/06/2003 10:59	

Gas/BTEX Fuel Oxygenates by 8260B

Gettler Ryan

Attn.: Deanna Harding

6747 Sierra Court Suite J

Dublin, CA 94568

Phone: (925) 551-7444 Fax: (925) 551-7899

Project: 180022.80

Tosco #7176

Received: 01/24/2003 16:10

Site: 7850 Amador Valley Blvd.
Dublin, CA

Batch QC Report

Prep(s): 5030B

Test(s): 8260FAB

Laboratory Control Spike

Water

QC Batch # 2003/02/02-01.62

LCS 2003/02/02-01.62-012

Extracted: 02/02/2003

Analyzed: 02/02/2003 11:12

LCSD 2003/02/02-01.62-034

Extracted: 02/02/2003

Analyzed: 02/02/2003 11:34

Compound	Conc. ug/L		Exp.Conc.	Recovery		RPD	Ctrl.Limits %		Flags	
	LCS	LCSD		LCS	LCSD		%	Rec.	RPD	LCS
Benzene	22.0	22.6	25.0	88.0	90.4	2.7	69-129	20		
Toluene	22.3	22.7	25.0	89.2	90.8	1.8	70-130	20		
Methyl tert-butyl ether (MTBE)	22.9	23.4	25.0	91.6	93.6	2.2	65-165	20		
Surrogates(s)										
1,2-Dichloroethane-d4	564	565	500	112.8	113.0		76-114			
Toluene-d8	484	480	500	96.8	96.0		88-110			

Severn Trent Laboratories, Inc.

STL San Francisco * 1220 Quarry Lane, Pleasanton, CA 94566

Tel 925 484 1919 Fax 925 484 1096 * www.stl-inc.com * CA DHS ELAP# 2496

02/07/2003 11:51

Page 11 of 14

Gas/BTEX Fuel Oxygenates by 8260B

Gettler Ryan

Attn.: Deanna Harding

6747 Sierra Court Suite J

Dublin, CA 94568

Phone: (925) 551-7444 Fax: (925) 551-7899

Project: 180022.80

Tosco #7176

Received: 01/24/2003 16:10

Site: 7850 Amador Valley Blvd.
Dublin, CA

Batch QC Report

Prep(s): 5030B

Test(s): 8260FAB

Laboratory Control Spike

Water

QC Batch # 2003/02/03-01.62

LCS 2003/02/03-01.62-018

Extracted: 02/03/2003

Analyzed: 02/03/2003 10:18

LCSD 2003/02/03-01.62-041

Extracted: 02/03/2003

Analyzed: 02/03/2003 10:41

Compound	Conc. ug/L		Exp.Conc.	Recovery		RPD	Ctrl.Limits %		Flags	
	LCS	LCSD		LCS	LCSD		%	Rec.	RPD	LCS
Benzene	21.8	22.3	25.0	87.2	89.2	2.3	69-129	20		
Toluene	21.8	22.8	25.0	87.2	91.2	4.5	70-130	20		
Methyl tert-butyl ether (MTBE)	21.1	21.1	25.0	84.4	84.4	0.0	65-165	20		
Surrogates(s)										
1,2-Dichloroethane-d4	543	544	500	108.6	108.8		76-114			
Toluene-d8	484	483	500	96.8	96.6		88-110			

Gas/BTEX Fuel Oxygenates by 8260B

Gettler Ryan

Attn.: Deanna Harding

6747 Sierra Court Suite J
Dublin, CA 94568
Phone: (925) 551-7444 Fax: (925) 551-7899

Project: 180022.80
Tosco #7176

Received: 01/24/2003 16:10

Site: 7850 Amador Valley Blvd.
Dublin, CA

Batch QC Report										
Prep(s): 5030B							Test(s): 8260FAB			
Laboratory Control Spike				Water			QC Batch # 2003/02/06-01.27			
LCS	2003/02/06-01.27-003			Extracted: 02/06/2003			Analyzed: 02/06/2003 10:08			
LCSD	2003/02/06-01.27-004			Extracted: 02/06/2003			Analyzed: 02/06/2003 10:37			
Compound	Conc. ug/L		Exp.Conc.	Recovery		RPD	Ctrl.Limits %		Flags	
	LCS	LCSD		LCS	LCSD		%	Rec.	RPD	LCS
Benzene	20.6	20.3	25.0	82.4	81.2	1.5	69-129	20		
Toluene	22.0	22.0	25.0	88.0	88.0	0.0	70-130	20		
Methyl tert-butyl ether (MTBE)	24.3	24.7	25.0	97.2	98.8	1.6	65-165	20		
Surrogates(s)										
1,2-Dichloroethane-d4	514	525	500	102.8	105.0		76-114			
Toluene-d8	501	482	500	100.2	96.4		88-110			

Gas/BTEX Fuel Oxygenates by 8260B

Gettler Ryan

Attn.: Deanna Harding

6747 Sierra Court Suite J

Dublin, CA 94568

Phone: (925) 551-7444 Fax: (925) 551-7899

Project: 180022.80

Tosco #7176

Received: 01/24/2003 16:10

Site: 7850 Amador Valley Blvd.

Dublin, CA

Legend and Notes

Analysis Flag

o

Reporting limits were raised due to high level of analyte present in the sample.

Result Flag

g

Hydrocarbon reported in the gasoline range does not match our gasoline standard.

sh

Surrogate recovery was higher than QC limit due to matrix interference.

TEPH w/ Silica Gel Clean-up

Gettler Ryan

Attn.: Deanna Harding

6747 Sierra Court Suite J

Dublin, CA 94568

Phone: (925) 551-7444 Fax: (925) 551-7899

Project: 180022.80

Tosco #7176

Received: 01/24/2003 16:10

Site: 7850 Amador Valley Blvd.
Dublin, CA**Samples Reported**

Sample Name	Date Sampled	Matrix	Lab #
U-1	01/24/2003 13:30	Water	2
U-2	01/24/2003 13:00	Water	3
MW-4	01/24/2003 12:30	Water	5

Severn Trent Laboratories, Inc.

STL San Francisco * 1220 Quarry Lane, Pleasanton, CA 94566

Tel 925 484 1919 Fax 925 484 1096 * www.stl-inc.com * CA DHS ELAP# 2496

02/17/2003 10:34

Page 1 of 7

TEPH w/ Silica Gel Clean-up

Gettler Ryan

Attn.: Deanna Harding

6747 Sierra Court Suite J

Dublin, CA 94568

Phone: (925) 551-7444 Fax: (925) 551-7899

Project: 180022.80

Tosco #7176

Received: 01/24/2003 16:10

Site: 7850 Amador Valley Blvd.
Dublin, CA

Prep(s):	3510/8015M	Test(s):	8015M
Sample ID:	U-1	Lab ID:	2003-01-0461 - 2
Sampled:	01/24/2003 13:30	Extracted:	2/7/2003 17:21
Matrix:	Water	QC Batch#:	2003/02/07-05.10

Compound	Conc.	RL	Unit	Dilution	Analyzed	Flag
Diesel	1700	50	ug/L	1.00	02/10/2003 10:56	ndp
<i>Surrogates(s)</i>						
o-Terphenyl	74.2	60-130	%	1.00	02/10/2003 10:56	

TEPH w/ Silica Gel Clean-up

Gettler Ryan
Attn.: Deanna Harding

6747 Sierra Court Suite J
Dublin, CA 94568
Phone: (925) 551-7444 Fax: (925) 551-7899
Project: 180022.80
Tosco #7176

Received: 01/24/2003 16:10

Site: 7850 Amador Valley Blvd.
Dublin, CA

Prep(s):	3510/8015M	Test(s):	8015M
Sample ID:	U-2	Lab ID:	2003-01-0461-3
Sampled:	01/24/2003 13:00	Extracted:	2/7/2003 17:21
Matrix:	Water	QC Batch#:	2003/02/07-05.10

Compound	Conc.	RL	Unit	Dilution	Analyzed	Flag
Diesel	570	50	ug/L	1.00	02/10/2003 11:36	ndp
Surrogates(s) o-Terphenyl	100.1	60-130	%	1.00	02/10/2003 11:36	

TEPH w/ Silica Gel Clean-up

Gettler Ryan

Attn.: Deanna Harding

6747 Sierra Court Suite J

Dublin, CA 94568

Phone: (925) 551-7444 Fax: (925) 551-7899

Project: 180022.80

Tosco #7176

Received: 01/24/2003 16:10

Site: 7850 Amador Valley Blvd.
Dublin, CA

Prep(s): 3510/8015M	Test(s): 8015M
Sample ID: MW-4	Lab ID: 2003-01-0461 - 5
Sampled: 01/24/2003 12:30	Extracted: 2/7/2003 17:21
Matrix: Water	QC Batch#: 2003/02/07-05.10

Compound	Conc.	RL	Unit	Dilution	Analyzed	Flag
Diesel	ND	50	ug/L	1.00	02/10/2003 12:17	
<i>Surrogates(s)</i> o-Terphenyl	45.2	60-130	%	1.00	02/10/2003 12:17	sl

TEPH w/ Silica Gel Clean-up

Gettler Ryan

Attn.: Deanna Harding

6747 Sierra Court Suite J

Dublin, CA 94568

Phone: (925) 551-7444 Fax: (925) 551-7899

Project: 180022.80

Tosco #7176

Received: 01/24/2003 16:10

Site: 7850 Amador Valley Blvd.
Dublin, CA

Batch QC Report					
Prep(s): 3510/8015M				Test(s): 8015M	
Method Blank		Water		QC Batch # 2003/02/07-05.10	
MB: 2003/02/07-05.10-001				Date Extracted: 02/07/2003 17:21	
Compound	Conc.	RL	Unit	Analyzed	Flag
Diesel	ND	50	ug/L	02/10/2003 10:15	
<i>Surrogates(s)</i> o-Terphenyl	51.0	60-130	%	02/10/2003 10:15	,or

TEPH w/ Silica Gel Clean-up

Gettler Ryan

Attn.: Deanna Harding

6747 Sierra Court Suite J
Dublin, CA 94568
Phone: (925) 551-7444 Fax: (925) 551-7899

Project: 180022.80
Tosco #7176

Received: 01/24/2003 16:10

Site: 7850 Amador Valley Blvd.
Dublin, CA

Batch QC Report										
Prep(s): 3510/8015M						Test(s): 8015M				
Laboratory Control Spike				Water			QC Batch # 2003/02/07-05.10			
LCS	2003/02/07-05.10-002			Extracted: 02/07/2003			Analyzed: 02/10/2003 08:53			
LCSD	2003/02/07-05.10-003			Extracted: 02/07/2003			Analyzed: 02/10/2003 09:33			
Compound	Conc. ug/L		Exp.Conc.	Recovery		RPD %	Ctrl.Limits %		Flags	
	LCS	LCSD		LCS	LCSD		Rec.	RPD	LCS	LCSD
Diesel	681	716	1000	68.1	71.6	5.0	60-130	25		
<i>Surrogates(s)</i> o-Terphenyl	19.5	20.6	20.0	97.5	103.2		60-130	0		

TEPH w/ Silica Gel Clean-up

Gettler Ryan

Attn.: Deanna Harding

6747 Sierra Court Suite J

Dublin, CA 94568

Phone: (925) 551-7444 Fax: (925) 551-7899

Project: 180022.80

Tosco #7176

Received: 01/24/2003 16:10

Site: 7850 Amador Valley Blvd.
Dublin, CA

Legend and Notes

QC Sample Comment

Lab ID: MB 2003/02/07/05.10-1

or = Percent recovery outside of control limit.

Result Flag

ndp

Hydrocarbon reported does not match the pattern of our Diesel standard

sl

Surrogate recoveries were lower than QC limit due to matrix interference, confirmed by reanalysis.

Diesel

Gettler Ryan
Attn.: Deanna Harding

6747 Sierra Court Suite J
Dublin, CA 94568
Phone: (925) 551-7444 Fax: (925) 551-7899
Project: 180022.80
Tosco #7176

Received: 01/24/2003 16:10

Site: 7850 Amador Valley Blvd.
Dublin, CA

Prep(s): 3510/8015M	Test(s): 8015M
Sample ID: U-1	Lab ID: 2003-01-0461 - 2
Sampled: 01/24/2003 13:30	Extracted: 1/27/2003 12:24
Matrix: Water	QC Batch#: 2003/01/27-04.10

Compound	Conc.	RL	Unit	Dilution	Analyzed	Flag
Diesel	2100	50	ug/L	1.00	01/27/2003 18:45	ndp
<i>Surrogates(s)</i> o-Terphenyl	70.8	60-130	%	1.00	01/27/2003 18:45	

Diesel

Gettler Ryan
Attn.: Deanna Harding

6747 Sierra Court Suite J
Dublin, CA 94568
Phone: (925) 551-7444 Fax: (925) 551-7899

Project: 180022.80
Tosco #7176

Received: 01/24/2003 16:10

Site: 7850 Amador Valley Blvd.
Dublin, CA

Prep(s): 3510/8015M	Test(s): 8015M
Sample ID: U-2	Lab ID: 2003-01-0461 - 3
Sampled: 01/24/2003 13:00	Extracted: 1/27/2003 12:24
Matrix: Water	QC Batch#: 2003/01/27-04.10

Compound	Conc.	RL	Unit	Dilution	Analyzed	Flag
Diesel	860	50	ug/L	1.00	01/27/2003 19:25	ndp
<i>Surrogates(s)</i> o-Terphenyl	65.6	60-130	%	1.00	01/27/2003 19:25	

Diesel

Gettler Ryan
Attn.: Deanna Harding

6747 Sierra Court Suite J
Dublin, CA 94568
Phone: (925) 551-7444 Fax: (925) 551-7899
Project: 180022.80
Tosco #7176

Received: 01/24/2003 16:10

Site: 7850 Amador Valley Blvd.
Dublin, CA

Prep(s): 3510/8015M	Test(s): 8015M
Sample ID: U-3	Lab ID: 2003-01-0461 - 4
Sampled: 01/24/2003 11:20	Extracted: 1/27/2003 12:24
Matrix: Water	QC Batch#: 2003/01/27-04.10

Compound	Conc.	RL	Unit	Dilution	Analyzed	Flag
Diesel	ND	50	ug/L	1.00	01/27/2003 20:06	
Surrogates(s) o-Terphenyl	68.9	60-130	%	1.00	01/27/2003 20:06	

Diesel

Gettler Ryan

Attn.: Deanna Harding

6747 Sierra Court Suite J
Dublin, CA 94568
Phone: (925) 551-7444 Fax: (925) 551-7899

Project: 180022.80
Tosco #7176

Received: 01/24/2003 16:10

Site: 7850 Amador Valley Blvd.
Dublin, CA

Prep(s): 3510/8015M	Test(s): 8015M
Sample ID: MW-4	Lab ID: 2003-01-0461 - 5
Sampled: 01/24/2003 12:30	Extracted: 1/27/2003 12:24
Matrix: Water	QC Batch#: 2003/01/27-04 10

Compound	Conc.	RL	Unit	Dilution	Analyzed	Flag
Diesel	52	50	ug/L	1.00	01/27/2003 20:46	ndp
<i>Surrogates(s)</i> o-Terphenyl	35.4	60-130	%	1.00	01/27/2003 20:46	sl

Diesel

Gettler Ryan

Attn.: Deanna Harding

6747 Sierra Court Suite J

Dublin, CA 94568

Phone: (925) 551-7444 Fax: (925) 551-7899

Project: 180022.80

Tosco #7176

Received: 01/24/2003 16:10

Site: 7850 Amador Valley Blvd.

Dublin, CA

Prep(s): 3510/8015M	Test(s): 8015M
Sample ID: MW-5	Lab ID: 2003-01-0461-6
Sampled: 01/24/2003 11:55	Extracted: 1/27/2003 12:24
Matrix: Water	QC Batch#: 2003/01/27-04.10

Compound	Conc.	RL	Unit	Dilution	Analyzed	Flag
Diesel	ND	50	ug/L	1.00	01/27/2003 21:26	
<i>Surrogates(s)</i> o-Terphenyl	63.8	60-130	%	1.00	01/27/2003 21:26	

Diesel

Gettler Ryan

Attn.: Deanna Harding

6747 Sierra Court Suite J

Dublin, CA 94568

Phone: (925) 551-7444 Fax: (925) 551-7899

Project: 180022.80

Tosco #7176

Received: 01/24/2003 16:10

Site: 7850 Amador Valley Blvd.
Dublin, CA

Batch QC Report					
Prep(s): 3510/8015M			Test(s): 8015M		
Method Blank			Water		
MB: 2003/01/27-04 10-003			QC Batch # 2003/01/27-04.10		
			Date Extracted: 01/27/2003 12:24		
Compound	Conc.	RL	Unit	Analyzed	Flag
Diesel	ND	50	ug/L	01/27/2003 17:40	
<i>Surrogates(s)</i> o-Terphenyl	83.8	60-130	%	01/27/2003 17:40	

Diesel

Gettler Ryan

Attn.: Deanna Harding

6747 Sierra Court Suite J
Dublin, CA 94568
Phone: (925) 551-7444 Fax: (925) 551-7899

Project: 180022.80
Tosco #7176

Received: 01/24/2003 16:10

Site: 7850 Amador Valley Blvd.
Dublin, CA

Batch QC Report										
Prep(s): 3510/8015M							Test(s): 8015M			
Laboratory Control Spike				Water			QC Batch # 2003/01/27-04.10			
LCS	2003/01/27-04.10-001			Extracted: 01/27/2003			Analyzed: 01/27/2003 16:26			
LCSD	2003/01/27-04.10-002			Extracted: 01/27/2003			Analyzed: 01/27/2003 17:03			
Compound	Conc. ug/L		Exp.Conc.	Recovery		RPD	Ctrl.Limits %		Flags	
	LCS	LCSD		LCS	LCSD		%	Rec.	RPD	LCS
Diesel	702	615	1000	70.2	61.5	13.2	60-130	25		
<i>Surrogates(s)</i> o-Terphenyl	18.8	18.2	20.0	93.9	91.0		60-130	0		

Diesel

Gettler Ryan

Attn.: Deanna Harding

6747 Sierra Court Suite J

Dublin, CA 94568

Phone: (925) 551-7444 Fax: (925) 551-7899

Project: 180022.80

Tosco #7176

Received: 01/24/2003 16:10

Site: 7850 Amador Valley Blvd.
Dublin, CA

Legend and Notes

Result Flag

ndp

Hydrocarbon reported does not match the pattern of our Diesel standard

sl

Surrogate recoveries were lower than QC limit due to matrix interference, confirmed by reanalysis.