



GETTLER-RYAN INC.

AUG 28 2002

TRANSMITTAL

August 9, 2002
G-R #180022

Handwritten: VRO 482

Handwritten: 2/2/02 10/24/02

TO: Mr. David B. De Witt
Phillips 66 Company
2000 Crow Canyon Place, Suite 400
San Ramon, California 94583

CC: Mr. Paul Blank
ERI, Inc.
73 Digital Drive, Suite 100
Novato, California 94949

FROM: Deanna L. Harding
Project Coordinator
Gettler-Ryan Inc.
6747 Sierra Court, Suite J
Dublin, California 94568

RE: Tosco(Unocal) Service Station
#7176
7850 Amador Valley Boulevard
Dublin, California

WE HAVE ENCLOSED THE FOLLOWING:

COPIES	DATED	DESCRIPTION
1	August 8, 2002	Groundwater Monitoring and Sampling Report Second Semi-Annual - Event of July 1, 2002

COMMENTS:

This report is being sent to you for your review/comment, prior to being distributed on your behalf. If no comments are received by **August 23, 2002**, this report will be distributed to the following:

cc: Mr. Amir K. Gholami, REHS, Alameda County Health Care Services, 1131 Harbor Bay Pkwy., Alameda, CA 94502

Enclosure

trans/7176-DBD



GETTLER-RYAN INC.

August 8, 2002
G-R Job #180022

Mr. David B. De Witt
Phillips 66 Company
2000 Crow Canyon Place, Suite 400
San Ramon, California 94583

RE: Second Semi-Annual Event of July 1, 2002
Groundwater Monitoring & Sampling Report
Tosco (Unocal) Service Station #7176
7850 Amador Valley Boulevard
Dublin, California

Dear Mr. De Witt:

This report documents the most recent groundwater monitoring and sampling event performed by Gettler-Ryan Inc. (G-R) at the referenced site. All field work was conducted in accordance with G-R Standard Operating Procedure - Groundwater Sampling (attached).

Static groundwater levels were measured and all wells were checked for the presence of separate-phase hydrocarbons. Separate-phase hydrocarbons were not present in the wells. Static water level data and groundwater elevations are summarized in Table 1. Dissolved Oxygen Concentrations are summarized in Table 3. A Potentiometric Map is included as Figure 1.

Groundwater samples were collected from the monitoring wells and submitted to a state certified laboratory for analyses. The field data sheets for this event are attached. Analytical results are presented in the table(s) listed below. A Concentration Map is included as Figure 2. The chain of custody document and laboratory analytical reports are also attached.

Sincerely,

Deanna L. Harding
Project Coordinator

Hagop Kevork
P.E. No. C55734

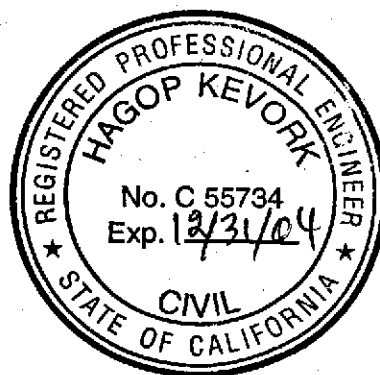

- Figure 1: Potentiometric Map
- Figure 2: Concentration Map
- Table 1: Groundwater Monitoring Data and Analytical Results
- Table 2: Groundwater Analytical Results - Oxygenate Compounds
- Table 3: Dissolved Oxygen Concentrations
- Attachments: Standard Operating Procedure - Groundwater Sampling
Field Data Sheets
Chain of Custody Document and Laboratory Analytical Reports

7176.qml

AMADOR VALLEY BOULEVARD

EXPLANATION

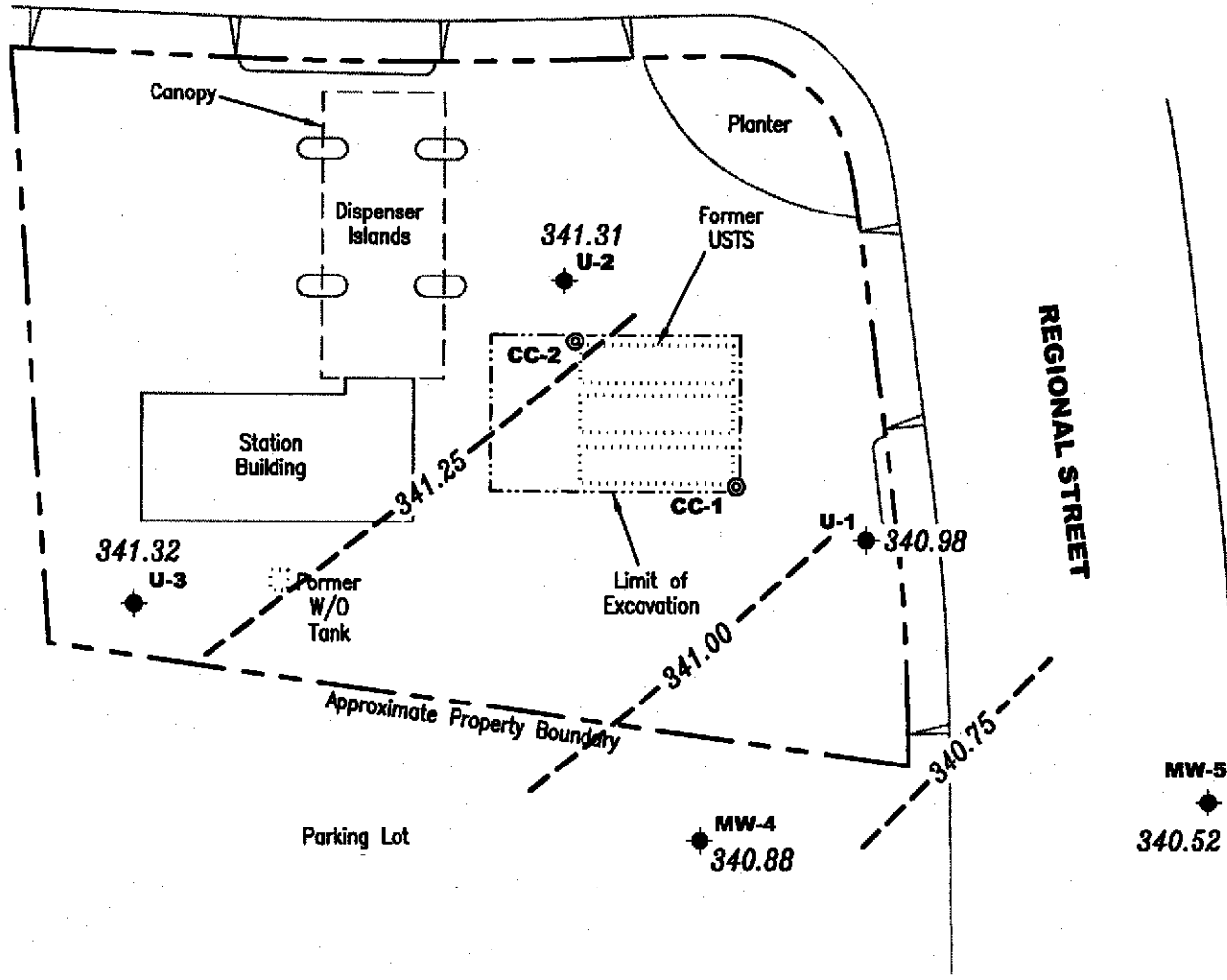

- ◆ Groundwater monitoring well
- ⊙ Conductor casing
- 99.99 Groundwater elevation in feet referenced to Mean Sea Level
- 99.99--- Groundwater elevation contour, dashed where inferred

Approximate groundwater flow direction at a gradient of 0.004 to 0.005 Ft./Ft.

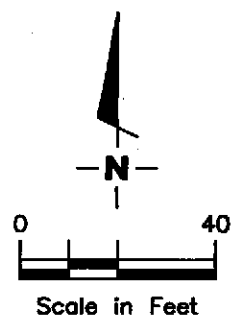

Source: Figure modified from drawing provided by MPDS Services, Inc.

GETTLER - RYAN INC.
 6747 Sierra Ct., Suite J
 Dublin, CA 94568 (925) 551-7555

POTENTIOMETRIC MAP
 Tosco (Unocal) Service Station #7176
 7850 Amador Valley Boulevard
 Dublin, California

FIGURE
1

PROJECT NUMBER 180022	REVIEWED BY	DATE July 1, 2002	REVISED DATE
--------------------------	-------------	----------------------	--------------

AMADOR VALLEY BOULEVARD

EXPLANATION

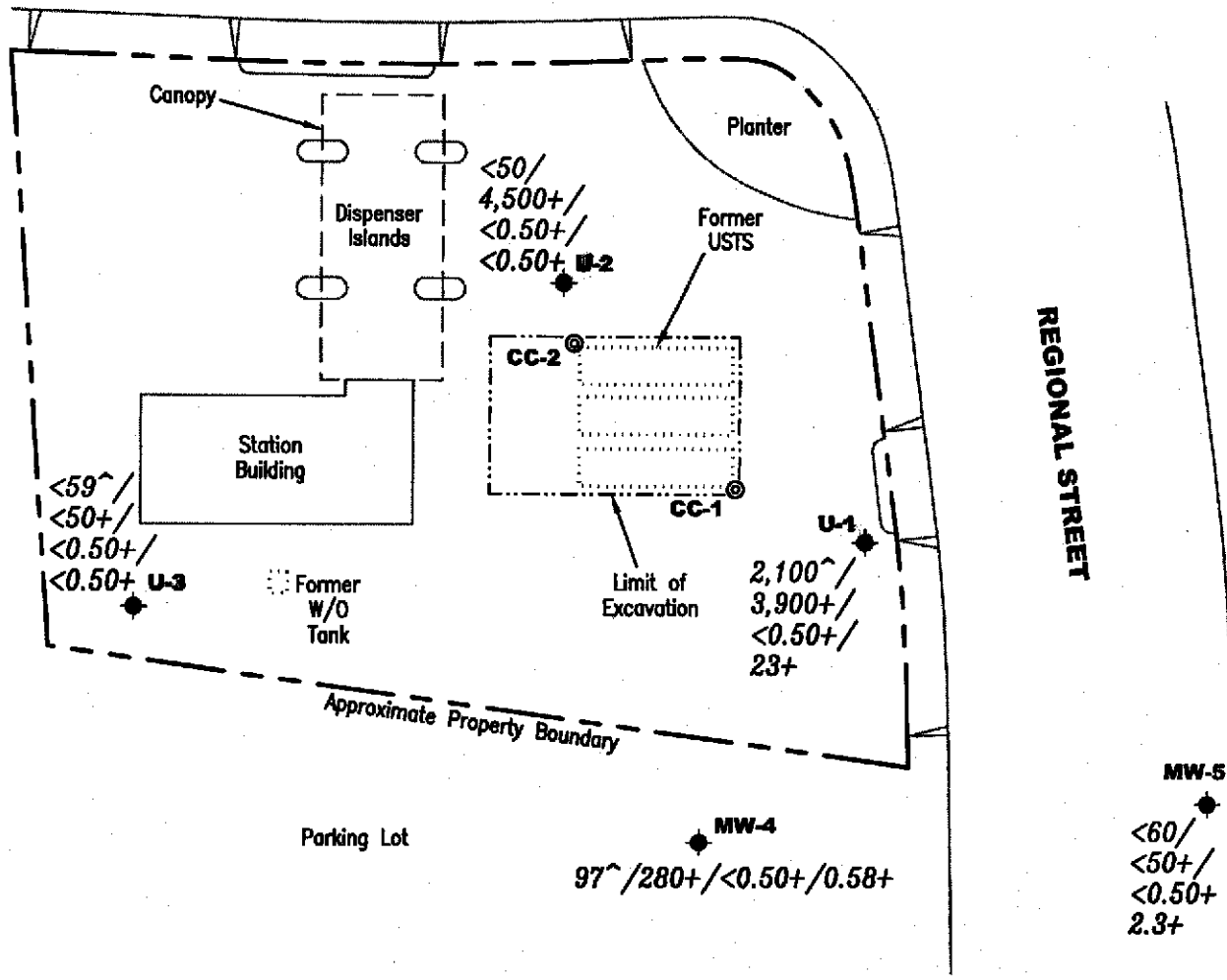

- ◆ Groundwater monitoring well
- ⊙ Conductor casing
- A/B/C/D Total Petroleum Hydrocarbons (TPH) as Diesel / TPH as Gasoline / Benzene / MTBE concentrations in ppb
- ~ w/silica gel cleanup
- + Analyses by EPA Method 8260

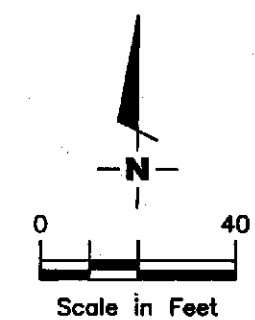

Source: Figure modified from drawing provided by MPDS Services, Inc.

GETTLER - RYAN INC.
 6747 Sierra Ct., Suite J
 Dublin, CA 94568 (925) 551-7555

CONCENTRATION MAP
 Tosco (Unocal) Service Station #7176
 7850 Amador Valley Boulevard
 Dublin, California

FIGURE
2

PROJECT NUMBER 180022	REVIEWED BY	DATE July 1, 2002	REVISED DATE
--------------------------	-------------	----------------------	--------------

Table 1
Groundwater Monitoring Data and Analytical Results
 Tosco (Unocal) Service Station #7176
 7850 Amador Valley Boulevard
 Dublin, California

WELL ID/ TOC*(ft.)	DATE	DTW (ft.)	S.I. (ft.bgs)	GWE (msl)	TPH-D* (ppb)	TPH-G (ppb)	B (ppb)	T (ppb)	E (ppb)	X (ppb)	MTBE (ppb)
U-1											
355.62	07/08/95	12.59	10.0-30.0	343.03	³ 9,400/--	39,000	1,500	19	1,600	5,200	--
	10/12/95	15.38		340.24	⁵ 4,200/--	33,000	1,400	ND	1,400	3,100	-- ⁷
	01/11/96 ¹	16.33		339.29	⁵ 8,200/--	8,300	690	11	680	1,500	-- ⁸
	04/11/96 ²	12.20		343.42	⁵ 630/--	3,200	110	ND	180	290	790
	07/10/96	13.84		341.78	⁵ 2,200/--	2,600	81	4.4	210	230	510
	10/30/96	15.85		339.77	⁵ 560/--	2,200	67	19	140	150	360
	01/27/97	12.20		343.42	⁵ 2,300/--	4,600	98	ND	360	290	150
	04/08/97	13.46		342.16	⁵ 1,300/--	2,800	50	ND	220	140	ND
	07/17/97	15.30		340.32	⁶ 460/--	2,300	30	4.5	140	94	190
	10/17/97	16.33		339.29	⁶ 510/--	1,500	31	6.7	110	88	220
	01/19/98	14.34		341.28	¹⁰ 1,900/1,300 ¹⁰	3,100	46	3.4	310	200	170
355.59	NP 04/23/98	11.16		344.43	--/1,700 ¹¹	3,400	72	3.8	470	350	280
	NP 07/08/98	12.67		342.92	¹⁴ 2,000/--	4,500	51	ND ¹²	590	430	190
	10/05/98	14.57		341.02	--/2,500 ¹⁰	7,500 ¹⁶	53	ND ¹²	680	350	190/180 ¹⁷
	01/04/99	15.35		340.24	¹¹ 2,700/2,500 ¹¹	10,000 ¹⁹	ND ¹²	ND ¹²	1,200	540	ND ¹²
	04/05/99	13.64		341.95	¹⁰ 920/570 ¹⁰	4,900	34	ND ¹²	350	150	150/55 ¹⁷
	07/01/99	14.39		341.20	¹⁰ 2,700/3,600 ²⁶	10,000	45	ND ¹²	850	420	260/110 ¹⁷
	09/30/99	15.32		340.27	¹⁰ 2,360/1,680 ¹⁰	7,150 ²⁷	ND ¹²	ND ¹²	415	84.4	¹² ND/195 ¹⁷
	01/03/00	16.51		339.08	²⁶ 2,000/1,700 ²⁶	5,400 ²⁷	28	8.4	180	33	160/120 ¹⁷
	04/04/00	12.89		342.70	²⁶ 990/1,400 ²⁶	4,800 ²⁷	30	ND ¹²	210	93	170/160 ¹⁷
	07/14/00	14.56		341.03	²⁶ 2,800/1,200 ²⁶	6,200 ²⁷	41	16	170	32	170/120 ¹⁷
	10/27/00	15.96		339.63	²⁶ 1,400/1,300 ²⁶	3,830 ¹⁶	16.8	ND ¹²	68.6	7.99	55.2/38 ¹⁷
	01/08/01	15.72		339.87	--/873 ²⁹	2,410 ¹⁶	14.7	4.30	30.5	5.04	34.5/9.33 ¹⁷
	04/03/01	14.46		341.13	²⁶ 1,500/830 ²⁶	3,330 ¹⁶	15.8	5.96	74.8	7.06	¹² ND/13.3 ¹⁷
	07/06/01	15.65		339.94	¹⁰ 1,600/1,200 ^{10,30}	4,300 ¹⁶	23	6.4	57	6.8	58/36 ¹⁷
	10/05/01	16.45		339.14	¹⁰ 2,500/2,300 ¹⁰	3,800 ¹⁶	19	<5.0	19	<5.0	64/36 ¹⁷
	01/03/02	14.18		341.41	³¹ 2,200/2,200 ³¹	4,500 ¹⁶	25	<10	24	<10	<100/23 ¹⁷
	04/01/02	13.72		341.87	³¹ 1,800/1,200 ³¹	5,300 ¹⁶	36	6.7	48	12	93/59 ¹⁷
	07/01/02 ³²	14.61		340.98	²⁹ 2,100/2,100 ²⁹	3,900	<0.50	<0.50	<0.50	3.9	23

Table 1
Groundwater Monitoring Data and Analytical Results
 Tosco (Unocal) Service Station #7176
 7850 Amador Valley Boulevard
 Dublin, California

WELL ID/ TOC*(ft.)	DATE	DTW (ft.)	S.I. (ft.bgs)	GWE (msl)	TPH-D [◆] (ppb)	TPH-G (ppb)	B (ppb)	T (ppb)	E (ppb)	X (ppb)	MTBE (ppb)
U-2											
356.59	07/08/95	12.68	10.0-30.0	343.91	³ 4,700/--	17,000	430	ND	2,200	590	--
	10/12/95	16.01		340.58	⁵ 3,600/--	24,000	310	60	1,900	190	-- ⁷
	01/11/96 ¹	17.06		339.53	⁵ 8,600/--	10,000	210	55	1,400	240	-- ⁸
	04/11/96 ²	12.75		343.84	⁵ 1,900/--	7,700	130	27	1,100	110	340
	07/10/96	14.42		342.17	⁵ 2,300/--	5,600	59	15	610	42	250
	10/30/96	16.82		339.77	⁵ 1,800/--	7,700	67	35	1,000	54	260
	01/27/97	12.91		343.68	⁵ 660/--	1,600	14	ND	130	7.0	100
	04/08/97	14.07		342.52	⁵ 2,000/--	4,300	35	ND	400	16	ND
	07/17/97	15.96		340.63	⁶ 1,300/--	6,200	17	22	410	ND	130
	10/17/97	17.03		339.56	⁶ 1,400/--	7,100	71	26	520	50	ND
	01/19/98	15.10		341.49	¹⁰ 2,100/1,500 ¹⁰	5,300	46	11	350	16	110
356.55	NP 04/23/98	11.74		344.81	--/1,200 ¹¹	3,200	23	11	210	38	160
	NP 07/08/98	13.27		343.28	¹⁴ 1,100/--	1,600	34	8.5	100	7.4	190
	10/05/98	14.90		341.65	--/1,300 ¹⁰	2,900 ¹⁸	37	8.4	110	7.3	78
	01/04/99	15.94		340.61	¹¹ 670/250 ²⁰	2,200 ²¹	35	ND ¹²	17	ND ¹²	86
	04/05/99	14.19		342.36	¹⁰ 660/490 ¹⁰	4,900	21	77	130	310	100/6.9 ¹⁷
	07/01/99	14.98		341.57	²⁴ 210/440 ²⁶	1,500 ²⁵	7.6	ND ¹²	ND ¹²	ND ¹²	¹² ND/35 ¹⁷
	09/30/99	16.00		340.55	¹⁰ 483/340 ¹⁰	256 ²⁷	1.85	ND ¹²	2.42	ND ¹²	26.3/29.8 ¹⁷
	01/03/00	17.20		339.35	²⁶ 2,400/1,900 ²⁶	3,400 ²⁷	23	13	ND ¹²	44	46/14 ¹⁷
	04/04/00	13.50		343.05	²⁶ 1,000/1,000 ²⁶	3,600 ²⁷	34	17	56	ND ¹²	59/25 ¹⁷
	07/14/00	15.23		341.32	²⁶ 1,000/350 ²⁶	3,100 ²⁷	16	13	15	10	100/19 ¹⁷
	10/27/00	16.74		339.81	²⁶ 2,000/1,900 ²⁶	4,180 ¹⁶	30.4	10.2	14.6	ND ¹²	55.5/15 ¹⁷
	01/08/01	16.68		339.87	--/624 ²⁹	3,300 ¹⁶	33.5	7.32	3.49	ND ¹²	66.7/7.49 ¹⁷
	04/03/01	15.12		341.43	²⁶ 1,500/830 ²⁶	4,290 ¹⁶	32.4	9.91	20.1	ND ¹²	66.6/18.1 ¹⁷
	07/06/01	16.32		340.23	¹⁰ 1,400/1,100 ^{10,30}	4,700 ¹⁶	35	11	12	5.3	62/19 ¹⁷
	10/05/01	17.15		339.40	¹⁰ 3,200/1,900 ¹⁰	3,600 ¹⁶	31	9.6	8.7	6.9	62/13 ¹⁷
	01/03/02	14.90		341.65	³¹ 2,300/2,100 ³¹	4,600 ¹⁶	34	11	15	5.8	62/7.5 ¹⁷
	04/01/02	14.38		342.17	³¹ 1,400/470 ³¹	3,500 ¹⁶	38	9.3	10	6.5	87/18 ¹⁷
	07/01/02 ³²	15.24		341.31	<50/--	4,500	<0.50	<0.50	5.0	1.7	<0.50

Table 1
Groundwater Monitoring Data and Analytical Results
 Tosco (Unocal) Service Station #7176
 7850 Amador Valley Boulevard
 Dublin, California

WELL ID/ TOC*(ft.)	DATE	DTW (ft.)	S.I. (ft.bgs)	GWE (msl)	TPH-D [◆] (ppb)	TPH-G (ppb)	B (ppb)	T (ppb)	E (ppb)	X (ppb)	MTBE (ppb)
U-3											
358.13	07/08/95	14.58	10.0-30.0	343.55	³ 710/--	1,100 ⁴	0.57	2.1	1.7	2.4	--
	10/12/95	17.60		340.53	⁶ 470/--	560	ND	0.87	0.7	1.1	--
	01/11/96 ¹	18.65		339.48	⁶ 260/--	230	0.62	0.91	0.97	1.9	--
	04/11/96	13.20		344.93	ND/--	68 ⁹	ND	ND	ND	ND	ND
	07/10/96	15.98		342.15	ND/--	ND	ND	ND	ND	ND	ND
	10/30/96	18.24		339.89	ND/--	70	ND	ND	ND	ND	ND
	01/27/97	14.41		343.72	ND/--	ND	ND	ND	ND	ND	ND
	04/08/97	15.73		342.40	ND/--	ND	ND	ND	ND	ND	ND
	07/17/97	17.54		340.59	ND/--	ND	ND	ND	ND	ND	ND
	10/17/97	18.64		339.49	⁶ 63/--	ND	ND	ND	ND	ND	ND
	01/19/98	16.67		341.46	¹⁰ 68/ND	ND	ND	ND	ND	ND	ND
358.09	NP 04/23/98	13.28		344.81	--/ND	ND	ND	ND	ND	ND	ND
	NP 07/08/98	14.90		343.19	¹⁵ 80/--	ND	ND	ND	ND	ND	ND
	10/05/98	16.50		341.59	--/ND	ND	ND	ND	ND	ND	ND
	01/04/99	17.70		340.39	ND/--	ND	ND	ND	ND	ND	ND
	04/05/99	15.67		342.42	ND/--	ND	ND	ND	ND	ND	ND/ND ¹⁷
	07/01/99	16.79		341.30	ND/--	ND	ND	ND	ND	ND	ND/ND ¹⁷
	09/30/99	17.60		340.49	ND/--	ND	ND	ND	ND	ND	ND/ND ¹⁷
	01/03/00	18.86		339.23	ND/--	ND	ND	ND	ND	ND	ND/ND ¹⁷
	04/04/00	15.10		342.99	ND/--	ND	ND	ND	ND	ND	ND/ND ¹⁷
	07/14/00	16.85		341.24	ND/--	ND	ND	ND	ND	ND	ND/ND ¹⁷
	10/27/00	18.35		339.74	ND/--	ND	ND	ND	ND	ND	ND/ND ¹⁷
	01/08/01	18.31		339.78	--/ND	ND	ND	ND	ND	ND	ND/ND ¹⁷
	04/03/01	16.70		341.39	ND/--	ND	ND	ND	ND	ND	ND/ND ¹⁷
	07/06/01	17.90		340.19	ND/--	ND	ND	ND	ND	ND	ND/ND ¹⁷
	10/05/01	18.71		339.38	<50/--	<50	<0.50	<0.50	<0.50	<0.50	<5.0/<2.0 ¹⁷
	01/03/02	16.41		341.68	<52/--	<50	<0.50	<0.50	<0.50	<0.50	<5.0/<1.0 ¹⁷
	04/01/02	15.87		342.22	<50/--	<50	<0.50	1.1	<0.50	1.2	<5.0/<2.0 ¹⁷
	07/01/02 ²¹	16.77		341.32	²⁹ 1,500/<59	<50	<0.50	<0.50	<0.50	<1.0	<0.50

Table 1
Groundwater Monitoring Data and Analytical Results
 Tosco (Unocal) Service Station #7176
 7850 Amador Valley Boulevard
 Dublin, California

WELL ID/ TOC*(ft.)	DATE	DTW (ft.)	S.I. (ft.bgs)	GWE (msl)	TPH-D♦ (ppb)	TPH-G (ppb)	B (ppb)	T (ppb)	E (ppb)	X (ppb)	MTBE (ppb)
MW-4											
356.41	04/23/98	12.11	10.0-25.0	344.30	--/1,400 ¹¹	2,500	5.9	6.4	16	31	ND ¹²
	07/08/98	13.70		342.71	¹¹ 1,400/--	1,000 ¹³	ND ¹²	ND ¹²	ND ¹²	ND ¹²	ND ¹²
	10/05/98	15.18		341.23	--/230 ¹⁰	890 ¹⁶	ND ¹²	ND ¹²	ND ¹²	14	ND ¹²
	01/04/99	16.39		340.02	¹⁰ 71/71 ¹⁰	230 ²²	0.56	1.3	1.4	1.8	10
	04/05/99	14.61		341.80	¹⁰ 340/210 ¹⁰	620 ²³	ND ¹²	1.8	2.1	ND ¹²	6.0/9.3 ¹⁷
	07/01/99	15.43		340.98	²⁴ 260/310 ²⁶	700 ¹⁹	2.1	ND ¹²	1.9	2.4	¹² ND/21 ¹⁷
	09/30/99	16.27		340.14	¹⁰ 420/220 ¹⁰	582 ²⁷	2.60	1.30	1.98	ND ¹²	23.1/22.5 ¹⁷
	01/03/00	17.50		338.91	²⁶ 250/260 ²⁶	800 ²⁷	4.2	4.6	3.3	11	31/17 ¹⁷
	04/04/00	13.91		342.50	^{10,15} 460/340 ²⁶	710 ²⁷	2.0	1.3	4.4	2.0	21/22 ¹⁷
	07/14/00	15.58		340.83	²⁶ 220/76 ²⁶	490 ²⁸	0.89	1.3	0.85	1.8	21/12 ¹⁷
	10/27/00	16.96		339.45	²⁶ 160/120 ²⁶	598 ²¹	ND	1.56	4.65	ND	15.4/14 ¹⁷
	01/08/01	16.64		339.77	--/202 ²⁹	522 ²⁷	4.09	1.69	2.53	1.26	17.2/14.3 ¹⁷
	04/03/01	15.46		340.95	²⁶ 180/ND	575 ²¹	ND ¹²	ND ¹²	ND ¹²	ND ¹²	14.0/11.6 ¹⁷
	07/06/01	16.63		339.78	¹⁰ 230/200 ^{10,30}	720 ¹⁶	4.7	1.5	2.5	0.74	10/7.1 ¹⁷
	10/05/01	17.38		339.03	¹⁰ 180/140 ¹⁰	650 ²⁷	4.3	1.2	1.1	1.8	5.9/5.4 ¹⁷
	01/03/02	15.10		341.31	³¹ 390/360 ³¹	340 ¹⁶	2.9	1.4	1.7	<1.0	<10/3.1 ¹⁷
	04/01/02	14.85		341.56	³¹ 160/100 ³¹	340 ²¹	<0.50	2.7	<0.50	0.66	<5.0/2.2 ¹⁷
	07/01/02 ³²	15.53		340.88	²⁹ 130/97 ²⁹	280	<0.50	<0.50	<0.50	<1.0	0.58
MW-5											
355.03	04/23/98	11.15	10.0-25.0	343.88	--/100 ¹¹	120	0.53	0.90	1.0	3.8	13
	07/08/98	12.63		342.40	¹⁰ 170/--	ND	ND	ND	ND	ND	12
	10/05/98	14.00		341.03	--/100 ¹⁰	ND	ND	ND	ND	ND	12
	01/04/99	15.21		339.82	ND/--	ND	ND	ND	ND	ND	ND
	04/05/99	13.76		341.27	ND/--	ND	ND	ND	ND	ND	ND/ND ¹⁷
	07/01/99	14.48		340.55	ND/--	ND	ND	ND	ND	ND	¹² ND/2.3 ¹⁷
	09/30/99	15.15		339.88	¹⁰ 60.4/ND	50.8 ²⁷	ND	ND	ND	ND	ND/ND ¹⁷
	01/03/00	16.34		338.69	ND/--	ND	ND	ND	ND	ND	ND/ND ¹⁷
	04/04/00	12.90		342.13	¹⁵ 69/ND	ND	ND	ND	ND	ND	ND/ND ¹⁷
	07/14/00	14.48		340.55	ND/--	ND	ND	ND	ND	ND	ND/ND ¹⁷

Table 1
Groundwater Monitoring Data and Analytical Results
 Tosco (Unocal) Service Station #7176
 7850 Amador Valley Boulevard
 Dublin, California

WELL ID/ TOC*(ft.)	DATE	DTW (ft.)	S.I. (ft.bgs)	GWE (msl)	TPH-D♦ (ppb)	TPH-G (ppb)	B (ppb)	T (ppb)	E (ppb)	X (ppb)	MTBE (ppb)
MW-5	10/27/00	15.75	10.0-25.0	339.28	ND/--	ND	ND	ND	ND	ND	ND/ND ¹⁷
(cont)	01/08/01	15.25		339.78	--/ND	ND	ND	ND	ND	ND	ND/ND ¹⁷
	04/03/01	14.41		340.62	ND/--	ND	ND	ND	ND	ND	ND/ND ¹⁷
	07/06/01	15.52		339.51	ND/--	ND	ND	ND	ND	ND	ND/ND ¹⁷
	10/05/01	16.28		338.75	<50/--	<50	<0.50	<0.50	<0.50	<0.50	<5.0/<2.0 ¹⁷
	01/03/02	14.01		341.02	<51/--	<50	<0.50	<0.50	<0.50	<0.50	<5.0/1.6 ¹⁷
	04/01/02	13.64		341.39	<50/--	<50	<0.50	<0.50	<0.50	<0.50	<5.0/3.5 ¹⁷
	07/01/02 ³²	14.51		340.52	<60/--	<50	<0.50	<0.50	<0.50	<1.0	2.3
Trip Blank											
TB-LB	01/19/98	--	--	--	--	ND	ND	ND	ND	ND	ND
	04/23/98	--	--	--	--	ND	ND	ND	ND	ND	ND
	07/08/98	--	--	--	--	ND	ND	ND	ND	ND	ND
	10/05/98	--	--	--	--	ND	ND	0.70	ND	0.71	ND
	01/04/99	--	--	--	--	ND	ND	0.74	ND	0.92	ND
	04/05/99	--	--	--	--	ND	ND	ND	ND	ND	ND
	07/01/99	--	--	--	--	ND	ND	ND	ND	ND	ND
	09/30/99	--	--	--	--	ND	ND	ND	ND	ND	ND
	01/03/00	--	--	--	--	ND	ND	ND	ND	ND	ND
	04/04/00	--	--	--	--	ND	ND	ND	ND	ND	ND
	07/14/00	--	--	--	--	ND	ND	ND	ND	ND	ND
	10/27/00	--	--	--	--	ND	ND	ND	ND	ND	ND
	01/08/01	--	--	--	--	ND	ND	ND	ND	ND	ND
	04/03/01	--	--	--	--	ND	ND	ND	ND	ND	ND
	07/06/01	--	--	--	--	ND	ND	ND	ND	ND	ND
	10/05/01	--	--	--	--	<50	<0.50	<0.50	<0.50	<0.50	<5.0
	01/03/02	--	--	--	--	<50	<0.50	<0.50	<0.50	<0.50	<5.0
	04/01/02	--	--	--	--	<50	<0.50	<0.50	<0.50	<0.50	<5.0
QA	07/01/02 ³²	--	--	--	--	<50	<0.50	<0.50	<0.50	<1.0	<0.50

Table 1
Groundwater Monitoring Data and Analytical Results
 Tosco (Unocal) Service Station #7176
 7850 Amador Valley Boulevard
 Dublin, California

EXPLANATIONS:

Groundwater monitoring data and laboratory analytical results prior to January 19, 1998, were compiled from reports prepared by MPDS Services, Inc.

TOC = Top of Casing	TPH-D = Total Petroleum Hydrocarbons as Diesel	(ppb) = Parts per billion
DTW = Depth to Water	TPH-G = Total Petroleum Hydrocarbons as Gasoline	ND = Not Detected
(ft.) = Feet	B = Benzene	-- = Not Measured/Not Analyzed
S.I. = Screen Interval	T = Toluene	NP = No purge
(ft.bgs) = Feet Below Ground Surface	E = Ethylbenzene	QA = Quality Assurance
GWE = Groundwater Elevation	X = Xylenes	
(msl) = Mean sea level	MTBE = Methyl tertiary butyl ether	

* TOC elevations were surveyed relative to msl, per the Benchmark AM-STW1977 located at the easterly return at the most easterly corner of intersection at Amador Valley Boulevard and Starward Street, (Elevation = 344.17 feet, msl).

◆ Analytical results reported as follows: TPH-D/TPH-D with silica gel cleanup.

- 1 Polynuclear Aromatic Hydrocarbons (PNAs) compound naphthalene was detected in well U-1 at a concentration of 320 ppb and at a concentration of 310 ppb in well U-2. All other PNAs compounds were ND in both wells.
- 2 PNAs compounds were ND.
- 3 Laboratory report indicates unidentified hydrocarbons C9-C26.
- 4 Laboratory report indicates gasoline and unidentified hydrocarbons >C12.
- 5 Laboratory report indicates the hydrocarbons detected appeared to be a diesel and non-diesel mixture.
- 6 Laboratory report indicates the hydrocarbons detected did not appear to be diesel.
- 7 Laboratory has potentially identified the presence of MTBE at reportable levels in the groundwater sample collected from this well.
- 8 Laboratory has identified the presence of MTBE at a level above or equal to the taste and odor threshold of 40 ppb in the sample collected from this well.
- 9 Laboratory report indicates the hydrocarbons detected did not appear to be gasoline.
- 10 Laboratory report indicates unidentified hydrocarbons C9-C24.
- 11 Laboratory report indicates diesel and unidentified hydrocarbons <C14.
- 12 Detection limit raised. Refer to analytical reports.
- 13 Laboratory report indicates unidentified hydrocarbons >C8.
- 14 Laboratory report indicates unidentified hydrocarbons <C14.
- 15 Laboratory report indicates discrete peaks.
- 16 Laboratory report indicates weathered gasoline C6-C12.
- 17 MTBE by EPA Method 8260.
- 18 Laboratory report indicates unidentified hydrocarbons <C8.
- 19 Laboratory report indicates gasoline and unidentified hydrocarbons C6-C12.
- 20 Laboratory report indicates diesel and unidentified hydrocarbons <C16.

Table 1
Groundwater Monitoring Data and Analytical Results
Tosco (Unocal) Service Station #7176
7850 Amador Valley Boulevard
Dublin, California

EXPLANATIONS: (cont)

- 21 Laboratory report indicates unidentified hydrocarbons C6-C12.
- 22 Laboratory report indicates gasoline and unidentified hydrocarbons >C10.
- 23 Laboratory report indicates gasoline and unidentified hydrocarbons <C7.
- 24 Laboratory report indicates unidentified hydrocarbons C10-C24.
- 25 Laboratory report indicates gasoline and unidentified hydrocarbons <C6.
- 26 Laboratory report indicates unidentified hydrocarbons <C16.
- 27 Laboratory report indicates gasoline C6-C12.
- 28 Laboratory report indicates gasoline C6-C12 + unidentified hydrocarbons C6-C12.
- 29 Laboratory report indicates hydrocarbon pattern is present in the requested fuel quantitation range but does not resemble the pattern of the requested fuel.
- 30 Laboratory report indicates sample was generated out of hold time. The sample was originally run within hold time, but needed to be re-analyzed.
- 31 Laboratory report indicates unidentified hydrocarbons C10-C28.
- 32 TPH-G, BTEX and MTBE by EPA Method 8260.

Table 2
Groundwater Analytical Results - Oxygenate Compounds
 Tosco (Unocal) Service Station #7176
 7850 Amador Valley Boulevard
 Dublin, California

WELL ID	DATE	ETHANOL (ppb)	TBA (ppb)	MTBE (ppb)	DIPE (ppb)	ETBE (ppb)	TAME (ppb)	1,2-DCA (ppb)	EDB (ppb)
U-1	04/05/99	ND ¹	ND ¹	55	ND ¹	ND ¹	ND ¹	ND ¹	ND ¹
	07/01/99	ND	ND	110	ND	ND	ND	ND	ND
	09/30/99	ND ¹	ND ¹	195	ND ¹	ND ¹	ND ¹	ND ¹	ND ¹
	01/03/00	ND	ND	120	ND	ND	ND	ND	ND
	04/04/00	ND ¹	ND ¹	160	ND ¹	ND ¹	ND ¹	ND ¹	ND ¹
	07/14/00	ND ¹	ND ¹	120	ND ¹	ND ¹	ND ¹	ND ¹	ND ¹
	10/27/00	ND	ND	38	ND	ND	ND	ND	ND
	01/08/01	ND ¹	ND ¹	9.33	ND ¹	ND ¹	ND ¹	ND ¹	ND ¹
	04/03/01	ND ¹	ND ¹	13.3	ND ¹	ND ¹	ND ¹	ND ¹	ND ¹
	07/06/01	ND	ND	36	ND	ND	ND	ND	ND
	10/05/01	<1,000	<100	36	<2.0	<2.0	<2.0	<2.0	<2.0
	01/03/02	<2,500	<100	23	<5.0	<5.0	<5.0	<5.0	<5.0
	04/01/02	<2,500	<500	59	<10	<10	<10	<10	<10
	07/01/02	<25	<5.0	23	<1.0	<0.50	<0.50	<0.50	<0.50
U-2	04/05/99	ND ¹	ND ¹	6.9	ND ¹	ND ¹	ND ¹	ND ¹	ND ¹
	07/01/99	ND	ND	35	ND	ND	ND	ND	ND
	09/30/99	ND	ND	29.8	ND	ND	ND	ND	ND
	01/03/00	ND	ND	14	ND	ND	ND	ND	ND
	04/04/00	ND ¹	ND ¹	25	ND ¹	ND ¹	ND ¹	ND ¹	ND ¹
	07/14/00	ND	ND	19	ND	ND	ND	ND	ND
	10/27/00	ND	ND	15	ND	ND	ND	ND	ND
	01/08/01	ND ¹	ND ¹	7.49	ND ¹	ND ¹	ND ¹	ND ¹	ND ¹
	04/03/01	ND	ND	18.1	ND	ND	ND	ND	ND
	07/06/01	ND	ND	19	ND	ND	ND	ND	ND
	10/05/01	<1,000	<100	13	<2.0	<2.0	<2.0	<2.0	<2.0
	01/03/02	<2,500	<100	7.5	<5.0	<5.0	<5.0	<5.0	<5.0
	04/01/02	<1,000	<200	18	<4.0	<4.0	<4.0	<4.0	<4.0
	07/01/02	<25	<5.0	<0.50	<1.0	<0.50	<0.50	<0.50	<0.50

Table 2
Groundwater Analytical Results - Oxygenate Compounds
 Tosco (Unocal) Service Station #7176
 7850 Amador Valley Boulevard
 Dublin, California

WELL ID	DATE	ETHANOL (ppb)	TBA (ppb)	MTBE (ppb)	DIPE (ppb)	ETBE (ppb)	TAME (ppb)	1,2-DCA (ppb)	EDB (ppb)
U-3	04/05/99	ND	ND	ND	ND	ND	ND	ND	ND
	07/01/99	ND	ND	ND	ND	ND	ND	ND	ND
	09/30/99	ND	ND	ND	ND	ND	ND	ND	ND
	01/03/00	ND	ND	ND	ND	ND	ND	ND	ND
	04/04/00	ND	ND	ND	ND	ND	ND	ND	ND
	07/14/00	ND	ND	ND	ND	ND	ND	ND	ND
	10/27/00	ND	ND	ND	ND	ND	ND	ND	ND
	01/08/01	ND	ND	ND	ND	ND	ND	ND	ND
	04/03/01	ND	ND	ND	ND	ND	ND	ND	ND
	07/06/01	ND	ND	ND	ND	ND	ND	ND	ND
	10/05/01	<1,000	<100	<2.0	<2.0	<2.0	<2.0	<2.0	<2.0
	01/03/02	<500	<20	<1.0	<1.0	<1.0	<1.0	<1.0	<1.0
	04/01/02	<500	<100	<2.0	<2.0	<2.0	<2.0	<2.0	<2.0
07/01/02	<25	<5.0	<0.50	<1.0	<0.50	<0.50	<0.50	<0.50	
MW-4	04/05/99	ND	ND	9.3	ND	ND	ND	ND	ND
	07/01/99	ND	ND	21	ND	ND	ND	ND	ND
	09/30/99	ND	ND	22.5	ND	ND	ND	ND	ND
	01/03/00	ND	ND	17	ND	ND	ND	ND	ND
	04/04/00	ND	ND	22	ND	ND	ND	ND	ND
	07/14/00	ND	ND	12	ND	ND	ND	ND	ND
	10/27/00	ND	ND	14	ND	ND	ND	ND	ND
	01/08/01	ND	ND	14.3	ND	ND	ND	ND	ND
	04/03/01	ND	ND	11.6	ND	ND	ND	ND	ND
	07/06/01	ND	ND	7.1	ND	ND	ND	ND	ND
	10/05/01	<1,000	<100	5.4	<2.0	<2.0	<2.0	<2.0	<2.0
	01/03/02	<500	<20	3.1	<1.0	<1.0	<1.0	<1.0	<1.0
	04/01/02	<500	<100	2.2	<2.0	<2.0	<2.0	<2.0	<2.0
07/01/02	<25	<5.0	0.58	<1.0	<0.50	<0.50	<0.50	<0.50	

Table 2
Groundwater Analytical Results - Oxygenate Compounds
 Tosco (Unocal) Service Station #7176
 7850 Amador Valley Boulevard
 Dublin, California

WELL ID	DATE	ETHANOL (ppb)	TBA (ppb)	MTBE (ppb)	DIPE (ppb)	ETBE (ppb)	TAME (ppb)	1,2-DCA (ppb)	EDB (ppb)
MW-5	04/05/99	ND	ND	ND	ND	ND	ND	ND	ND
	07/01/99	ND	ND	2.3	ND	ND	ND	ND	ND
	09/30/99	ND	ND	ND	ND	ND	ND	ND	ND
	01/03/00	ND	ND	ND	ND	ND	ND	ND	ND
	04/04/00	ND	ND	ND	ND	ND	ND	ND	ND
	07/14/00	ND	ND	ND	ND	ND	ND	ND	ND
	10/27/00	ND	ND	ND	ND	ND	ND	ND	ND
	01/08/01	ND	ND	ND	ND	ND	ND	ND	ND
	04/03/01	ND	ND	ND	ND	ND	ND	ND	ND
	07/06/01	ND	ND	ND	ND	ND	ND	ND	ND
	10/05/01	<1,000	<100	<2.0	<2.0	<2.0	<2.0	<2.0	<2.0
	01/03/02	<500	<20	1.6	<1.0	<1.0	<1.0	<1.0	<1.0
	04/01/02	<500	<100	3.5	<2.0	<2.0	<2.0	<2.0	<2.0
07/01/02	<25	<5.0	2.3	<1.0	<0.50	<0.50	<0.50	<0.50	
TRIP BLANK									
QA	07/01/02	--	--	<0.50	--	--	--	--	--

Table 2
Groundwater Analytical Results - Oxygenate Compounds
Tosco (Unocal) Service Station #7176
7850 Amador Valley Boulevard
Dublin, California

EXPLANATIONS:

TBA = Tertiary butyl alcohol
MTBE = Methyl tertiary butyl ether
DIPE = Di-isopropyl ether
ETBE = Ethyl tertiary butyl ether
TAME = Tertiary amyl methyl ether
1,2-DCA = 1,2-Dichloroethane
EDB = 1,2-Dibromomethane
(ppb) = Parts per billion
ND = Not Detected
QA = Quality Assurance
-- = Not Analyzed

¹ Detection limit raised. Refer to analytical reports.

ANALYTICAL METHOD:

EPA Method 8260 for Oxygenate Compounds

Table 3
Dissolved Oxygen Concentrations
 Tosco (Unocal) Service Station #7176
 7850 Amador Valley Boulevard
 Dublin, California

WELL ID	DATE	Before Purging (mg/L)	After Purging (mg/L)
U-1	01/11/96	--	3.41
	04/11/96	3.77	3.78
	07/10/96 ¹	1.22	--
	10/30/96 ¹	1.41	--
	01/27/97 ¹	1.34	--
	04/08/97 ¹	2.09	--
	07/17/97 ¹	2.00	--
	10/17/97 ¹	1.86	--
	01/19/98 ¹	2.91	--
	04/23/98 ¹	0.59	--
	07/08/98 ¹	1.10	--
U-2	01/11/96	--	3.99
	04/11/96	3.32	3.41
	07/10/96 ¹	1.01	--
	10/30/96 ¹	1.42	--
	01/27/97 ¹	1.29	--
	04/08/97 ¹	1.69	--
	07/17/97 ¹	2.08	--
	10/17/97 ¹	1.80	--
	01/19/98 ¹	2.95	--
	04/23/98 ¹	0.55	--
	07/08/98 ¹	1.36	--
U-3	01/11/96	--	5.05
	04/11/96	5.16	4.96
	07/10/96 ¹	3.44	--
	10/30/96 ¹	2.18	--
	01/27/97 ¹	2.61	--
	04/08/97 ¹	3.73	--
	07/17/97 ¹	2.65	--
	10/17/97 ¹	2.44	--
	01/19/98 ¹	6.51	--
	04/23/98 ¹	4.72	--
	07/08/98 ¹	4.35	--
CC-1	10/02/95	2.83	--

EXPLANATIONS:

Dissolved oxygen concentrations prior to January 19, 1998, were compiled from reports prepared by MPDS Services, Inc.

(mg/L) = Milligrams per liter

-- = Not Measured

CC-1 = Conductor casing in the underground storage tank backfill

¹ The wells were not purged on this date.

STANDARD OPERATING PROCEDURE - GROUNDWATER SAMPLING

Gettler-Ryan Inc. field personnel adhere to the following procedures for the collection and handling of groundwater samples prior to analysis by the analytical laboratory. Prior to sample collection, the type of analysis to be performed is determined. Loss prevention of volatile compounds is controlled and sample preservation for subsequent analysis is maintained.

Prior to sampling, the presence or absence of free-phase hydrocarbons is determined using an interface probe. Product thickness, if present, is measured to the nearest 0.01 foot and is noted in the field notes. In addition, static water level measurements are collected with the interface probe and are also recorded in the field notes.

After water levels are collected and prior to sampling, temperature, pH and electrical conductivity are measured. If purging is to occur, each well is purged a minimum of three well casing volumes of water using pre-cleaned pumps (stack, suction, Grundfos), or polyvinyl chloride bailers. The measurements are taken a minimum of three times during the purging. Purging continues until these parameters stabilize.

Groundwater samples are collected using disposable bailers. The water samples are transferred from the bailer into appropriate containers. Pre-preserved containers, supplied by analytical laboratories, are used when possible. When pre-preserved containers are not available, the laboratory is instructed to preserve the sample as appropriate. Duplicate samples are collected for the laboratory to use in maintaining quality assurance/quality control standards. The samples are labeled to include the job number, sample identification, collection date and time, analysis, preservation (if any), and the sample collector's initials. The water samples are placed in a cooler, maintained at 4°C for transport to the laboratory. Once collected in the field, all samples are maintained under chain of custody until delivered to the laboratory.

The chain of custody document includes the job number, type of preservation, if any, analysis requested, sample identification, date and time collected, and the sample collector's name. The chain of custody is signed and dated (including time of transfer) by each person who receives or surrenders the samples, beginning with the field personnel and ending with the laboratory personnel.

A laboratory supplied trip blank accompanies each sampling set. For sampling sets greater than 20 samples, 5% trip blanks are included. The trip blank is analyzed for some or all of the same compounds as the groundwater samples.

As requested by Phillips 66 Company, the purge water and decontamination water generated during sampling activities is transported to Phillips 66 - San Francisco Refinery, located in Rodeo, California.



GETTLER-RYAN INC.

WELL MONITORING/SAMPLING FIELD DATA SHEET

Client/Facility #: Tosco #7176 Job Number: 180022
 Site Address: 7850 Amador Valley Blvd. Event Date: 7/1/02
 City: Dublin, CA Sampler: UT

Well ID: U-1 Well Condition: OK
 Well Diameter: 2 in. Hydrocarbon Amount Bailed
 Total Depth: 27.75 ft. Thickness: 0.00 ft. (product/water): 0 gal.
 Depth to Water: 14.61 ft.

Volume Factor (VF)	3/4" = 0.02	1" = 0.04	2" = 0.17	3" = 0.38
	4" = 0.66	5" = 1.02	6" = 1.50	12" = 5.80

13.14 x VF 0.17 = 2.23 x 3 (case volume) = Estimated Purge Volume: 7 gal.

Purge Equipment: Disposable Bailer Stainless Steel Bailer _____ Stack Pump _____ Suction Pump _____ Grundfos _____ Other: _____

Sampling Equipment: Disposable Bailer Pressure Bailer _____ Discrete Bailer _____ Other: _____

Start Time (purge): 1530 Weather Conditions: clear
 Sample Time/Date: 1555 7/1/02 Water Color: grayish Odor: 4
 Purging Flow Rate: _____ gpm. Sediment Description: SS/T
 Did well de-water? no If yes, Time: _____ Volume: _____ gal.

Time (2400 hr.)	Volume (gal.)	pH	Conductivity (umhos/cm)	Temperature (°F)	D.O. (mg/L)	ORP (mV)
<u>1535</u>	<u>2</u>	<u>7.26</u>	<u>1087</u>	<u>72.3</u>		
<u>1541</u>	<u>4.5</u>	<u>7.12</u>	<u>1097</u>	<u>71.6</u>		
<u>1548</u>	<u>7</u>	<u>7.10</u>	<u>1104</u>	<u>71.3</u>		

LABORATORY INFORMATION

SAMPLE ID	(#) CONTAINER	REFRIG.	PRESERV. TYPE	LABORATORY	ANALYSES
<u>U-1</u>	<u>5</u> x vov vial	YES	HCL	STL Pleasanton	TPH-G, BTEX, MTBE & 8 Oxy's by 8260
<u>2</u>	<u>2</u> x Ambers	YES	NP	STL Pleasanton	TPH-D

COMMENTS: _____

Add/Replaced Lock: _____ Add/Replaced Plug: _____ Size: _____



GETTLER-RYAN INC.

WELL MONITORING/SAMPLING FIELD DATA SHEET

Client/Facility #: Tosco #7176 Job Number: 180022
 Site Address: 7850 Amador Valley Blvd. Event Date: 7/1/02
 City: Dublin, CA Sampler: VT

Well ID: U-2 Well Condition: OK
 Well Diameter: 2 in. Hydrocarbon Amount Bailed
 Total Depth: 26.45 ft. Thickness: 0.00 ft. (product/water): 0 gal.
 Depth to Water: 15.24 ft.

Volume	3/4"= 0.02	1"= 0.04	2"= 0.17	3"= 0.38
Factor (VF)	4"= 0.66	5"= 1.02	6"= 1.50	12"= 5.80

11.21 xVF 0.17 = 1.90 x3 (case volume) = Estimated Purge Volume: 6 gal.

Purge Equipment: Disposable Bailer
 Stainless Steel Bailer _____
 Stack Pump _____
 Suction Pump _____
 Grundfos _____
 Other: _____

Sampling Equipment: Disposable Bailer
 Pressure Bailer _____
 Discrete Bailer _____
 Other: _____

Start Time (purge): 1450 Weather Conditions: clear
 Sample Time/Date: 1520 7/1/02 Water Color: grayish Odor: 4
 Purging Flow Rate: _____ gpm. Sediment Description: slt
 Did well de-water? no If yes, Time: _____ Volume: _____ gal.

Time (2400 hr.)	Volume (gal.)	pH	Conductivity (umhos/cm)	Temperature (°F)	D.O. (mg/L)	ORP (mV)
<u>1455</u>	<u>2</u>	<u>7.34</u>	<u>1097</u>	<u>71.3</u>		
<u>1500</u>	<u>4</u>	<u>7.20</u>	<u>1109</u>	<u>70.7</u>		
<u>1505</u>	<u>6</u>	<u>7.16</u>	<u>1105</u>	<u>70.9</u>		

LABORATORY INFORMATION

SAMPLE ID	(#) CONTAINER	REFRIG.	PRESERV. TYPE	LABORATORY	ANALYSES
<u>U-2</u>	<u>5</u> x voa vial	<u>YES</u>	<u>HCL</u>	<u>STL Pleasanton</u>	<u>TPH-G, BTEX, MTBE & 8 Oxy's by 8260</u>
<u>2</u>	<u>2</u> x Ambers	<u>YES</u>	<u>NP</u>	<u>STL Pleasanton</u>	<u>TPH-D</u>

COMMENTS: _____

Add/Replaced Lock: _____ Add/Replaced Plug: _____ Size: _____



GETTLER-RYAN INC.

WELL MONITORING/SAMPLING FIELD DATA SHEET

Client/Facility #: Tosco #7176 Job Number: 180022
 Site Address: 7850 Amador Valley Blvd. Event Date: 7/1/02
 City: Dublin, CA Sampler: UT

Well ID: U-3 Well Condition: OK
 Well Diameter: 2 in. Hydrocarbon Amount Bailed
 Total Depth: 28.35 ft. Thickness: 0.00 ft. (product/water): 0 gal.
 Depth to Water: 16.77 ft.

Volume	3/4"= 0.02	1"= 0.04	2"= 0.17	3"= 0.38
Factor (VF)	4"= 0.66	5"= 1.02	6"= 1.50	12"= 5.80

11.58 xVF 0.17 = 1.96 x3 (case volume) = Estimated Purge Volume: 6 gal.

Purge Equipment: Disposable Bailer
 Stainless Steel Bailer _____
 Stack Pump _____
 Suction Pump _____
 Grundfos _____
 Other: _____
 Sampling Equipment: Disposable Bailer
 Pressure Bailer _____
 Discrete Bailer _____
 Other: _____

Start Time (purge): 1255 Weather Conditions: clear
 Sample Time/Date: 1315 7/1/02 Water Color: brn. Odor: no
 Purging Flow Rate: _____ gpm. Sediment Description: silt
 Did well de-water? If yes, Time: _____ Volume: _____ gal.

Time (2400 hr.)	Volume (gal.)	pH	Conductivity (umhos/cm)	Temperature (C/F)	D.O. (mg/L)	ORP (mV)
<u>1300</u>	<u>2</u>	<u>7.67</u>	<u>888</u>	<u>69.4</u>		
<u>1305</u>	<u>4</u>	<u>7.50</u>	<u>875</u>	<u>70.1</u>		
<u>1310</u>	<u>6</u>	<u>7.47</u>	<u>870</u>	<u>70.3</u>		

LABORATORY INFORMATION

SAMPLE ID	(#) CONTAINER	REFRIG.	PRESERV. TYPE	LABORATORY	ANALYSES
<u>U-3</u>	<u>5</u> x voa vial	<u>YES</u>	<u>HCL</u>	<u>STL Pleasanton</u>	<u>TPH-G, BTEX, MTBE & 8 Oxy's by 8260</u>
<u>"</u>	<u>2</u> x Ambers	<u>YES</u>	<u>NP</u>	<u>STL Pleasanton</u>	<u>TPH-D</u>

COMMENTS: _____

Add/Replaced Lock: _____ Add/Replaced Plug: _____ Size: _____



GETTLER-RYAN INC.

WELL MONITORING/SAMPLING FIELD DATA SHEET

Client/Facility #: Tosco #7176 Job Number: 180022
 Site Address: 7850 Amador Valley Blvd. Event Date: 7/1/02
 City: Dublin, CA Sampler: UT

Well ID: MW-4 Well Condition: OK
 Well Diameter: 2 in. Hydrocarbon Amount Bailed
 Total Depth: 25.45 ft. Thickness: 0.00 ft. (product/water): 0 gal.
 Depth to Water: 15.53 ft.

Volume Factor (VF)	3/4"= 0.02	1"= 0.04	2"= 0.17	3"= 0.38
	4"= 0.66	5"= 1.02	6"= 1.50	12"= 5.80

9.92 xVF 0.17 = 1.68 x3 (case volume) = Estimated Purge Volume: 5 gal.

Purge Equipment: Disposable Bailer
 Stainless Steel Bailer _____
 Stack Pump _____
 Suction Pump _____
 Grundfos _____
 Other: _____

Sampling Equipment: Disposable Bailer
 Pressure Bailer _____
 Discrete Bailer _____
 Other: _____

Start Time (purge): 1410 Weather Conditions: clear
 Sample Time/Date: 1430 7/1/02 Water Color: brn. Odor: mild
 Purging Flow Rate: _____ gpm. Sediment Description: slt
 Did well de-water? If yes, Time: _____ Volume: _____ gal.

Time (2400 hr.)	Volume (gal.)	pH	Conductivity (umhos/cm)	Temperature (°F)	D.O. (mg/L)	ORP (mV)
<u>1413</u>	<u>1.5</u>	<u>7.46</u>	<u>994</u>	<u>70.2</u>		
<u>1417</u>	<u>3</u>	<u>7.30</u>	<u>983</u>	<u>70.9</u>		
<u>1422</u>	<u>5</u>	<u>7.27</u>	<u>987</u>	<u>70.7</u>		

LABORATORY INFORMATION

SAMPLE ID	(#) CONTAINER	REFRIG.	PRESERV. TYPE	LABORATORY	ANALYSES
<u>MW-4</u>	<u>5</u> x voa vial	<u>YES</u>	<u>HCL</u>	<u>STL Pleasanton</u>	<u>TPH-G, BTEX, MTBE & 8 Oxy's by 8260</u>
<u>"</u>	<u>2</u> x Ambers	<u>YES</u>	<u>NP</u>	<u>STL Pleasanton</u>	<u>TPH-D</u>

COMMENTS: _____

Add/Replaced Lock: _____ Add/Replaced Plug: _____ Size: _____



GETTLER-RYAN INC.

WELL MONITORING/SAMPLING FIELD DATA SHEET

Client/Facility #: Tosco #7176 Job Number: 180022
 Site Address: 7850 Amador Valley Blvd. Event Date: 7/1/02
 City: Dublin, CA Sampler: VT

Well ID: MW-5 Well Condition: ON
 Well Diameter: 2 in. Hydrocarbon Amount Bailed
 Total Depth: 24.80 ft. Thickness: 0.00 ft. (product/water): 0 gal.
 Depth to Water: 14.51 ft.

Volume	3/4"= 0.02	1"= 0.04	2"= 0.17	3"= 0.38
Factor (VF)	4"= 0.66	5"= 1.02	6"= 1.50	12"= 5.80

10.29 xVF 0.17 = 1.74 x3 (case volume) = Estimated Purge Volume: 5.5 gal.

Purge Equipment: Disposable Bailer
 Stainless Steel Bailer _____
 Stack Pump _____
 Suction Pump _____
 Grundfos _____
 Other: _____

Sampling Equipment: Disposable Bailer
 Pressure Bailer _____
 Discrete Bailer _____
 Other: _____

Start Time (purge): 1335 Weather Conditions: clear
 Sample Time/Date: 1355 7/1/02 Water Color: brn. Odor: nd
 Purging Flow Rate: _____ gpm. Sediment Description: silt
 Did well de-water? no If yes, Time: _____ Volume: _____ gal.

Time (2400 hr.)	Volume (gal.)	pH	Conductivity (umhos/cm)	Temperature (C/F)	D.O. (mg/L)	ORP (mV)
<u>1340</u>	<u>2</u>	<u>7.60</u>	<u>789</u>	<u>70.6</u>		
<u>1345</u>	<u>4</u>	<u>7.47</u>	<u>796</u>	<u>70.1</u>		
<u>1349</u>	<u>5.5</u>	<u>7.45</u>	<u>803</u>	<u>69.8</u>		

LABORATORY INFORMATION

SAMPLE ID	(#) CONTAINER	REFRIG.	PRESERV. TYPE	LABORATORY	ANALYSES
<u>MW-5</u>	<u>5 x vov vial</u>	<u>YES</u>	<u>HCL</u>	<u>STL Pleasanton</u>	<u>TPH-G, BTEX, MTBE & 8 Oxy's by 8260</u>
<u>"</u>	<u>2 x Ambers</u>	<u>YES</u>	<u>NP</u>	<u>STL Pleasanton</u>	<u>TPH-D</u>

COMMENTS: _____

Add/Replaced Lock: _____ Add/Replaced Plug: _____ Size: _____

2002-07-0046

Gettler-Ryan Inc., Chain-of-Custody

61254

Tosco Corp./
Phillips 66 Co.
100 Crow Canyon Place
Suite 400
San Ramon, CA 94583

Facility Number #7176
Facility Address 7850 AMADOR VALLEY BLVD., DUBLIN, CA
Global ID T0600101883 Project 180022.80
Client Contact MR. DAVID B. DEWITT
Phone (925) 277-2384

Laboratory Name STL - PLEASANTON, CA
Consultant GETTLER-RYAN, INC. DEANNA L. HARDING
Address 6747 SIERRA CT., SUITE J, DUBLIN CA 94568
Phone (925) 551-7555 Fax (925) 551-7899
Samples Collected by Vartkes Tashjian

SAMPLE ID	Number of Containers Matrix	S = Soil W = Water A = Air C = Charcoal	Sample Preservation	Date/Time (2-400 Hrs)	TPH-GAS/BTEX/MTBE EPA 8015/8021B	TPH-DIESEL EPA 8015	TPH-DIESEL w/Silica gel EPA 8015	TPH-GAS EPA 8015	TPH-GAS/BTEX/MTBE EPA 8260	OXYGENATES EPA 8260	METHANOL EPA 8015	TOTAL OIL & GREASE EPA 8520	METALS Cd, Cr, Pb, Zn, Ni	NITRATE/SULFATE/ALKALINITY EPA 300 SERIES	HMOC'S (8010) EPA 8021B	VOC'S (8240) EPA 8260	SVOC'S EPA 8270	Remarks				
QA	1	W	HCl	7/1/02					X									Confirm all TPH-D hits by running TPH-D with Silica Gel Cleanup				
U-1	7	W		1555		X			X	X									20.7°C			
U-2	7	W		1520		X			X	X										20.7°C		
U-3	7	W		1315		X			X	X											20.7°C	
U-4	7	W		1430		X			X	X												20.7°C
U-5	7	W		1355		X			X	X												

- OXYGENATES 8260
- 1 - MTBE
 - 2 - TBA
 - 3 - TAME
 - 4 - DIPE
 - 5 - ETBE
 - 6 - 1,2-DCA
 - 7 - EDB
 - 8 - ETHANOL

Quished By (Signature) <i>[Signature]</i>	Organization G.R.	Date/Time 7/1/02	Received By (Signature) <i>[Signature]</i>	Organization	Date/Time	iced Y/N	Turn Around Time (Circle Choice) 24 Hrs. 48 Hrs. 72 Hrs. 5 Days 10 Days As Contracted
Quished By (Signature)	Organization	Date/Time 07/02/02 1240	Received By (Signature) <i>[Signature]</i>	Organization	Date/Time	iced Y/N	
Quished By (Signature)	Organization	Date/Time	Received For Laboratory By (Signature) <i>[Signature]</i>	Organization	Date/Time 7-2-02	iced Y/N	

Submission#: 2002-07-0046

July 19, 2002

SEVERN

TRENT

LABORATORY

Gettler Ryan

6747 Sierra Court Suite J
Dublin, CA 94568

Attn.: Deanna Harding

Project#: 1800022.80

Project: Tosco # 7176

Site: 7850 Amador Valley Blvd.
Dublin, CA

STL San Francisco
1220 Quarry Ln
Pleasanton CA 94566

Tel.: (925) 484-1919
Fax: (925) 484-1096
www.stl-inc.com
www.chromalab.com

CA DHS ELAP#:2496

Dear Ms. Harding,

Attached is our report for your samples received on 07/02/2002 12:40

This report has been reviewed and approved for release. Reproduction of this report is permitted only in its entirety.

Please note that any unused portion of the samples will be discarded after 08/16/2002 unless you have requested otherwise.

We appreciate the opportunity to be of service to you. If you have any questions, please call me at (925) 484-1919.

You can also contact me via email. My email address is: tgranicher@chromalab.com

Sincerely,

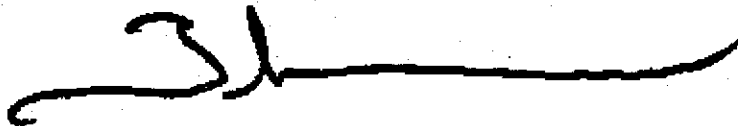

Tod Granicher
Project Manager

Submission #: 2002-07-0046

Diesel

Gettler Ryan

Attn.: Deanna Harding
6747 Sierra Court Suite J
Dublin, CA 94568
Phone: (925) 551-7444 Fax: (925) 551-7899

Project: 1800022.80
Tosco # 7176

Received: 07/02/2002 12:40

Site: 7850 Amador Valley Blvd.
Dublin, CA

SEVERN

TRENT

LABORATORY

STL San Francisco
1220 Quarry Lane
Pleasanton, CA 94566

Tel: (925) 484-1919
Fax: (925) 484-1096
www.stl-inc.com
www.chromalab.com

CA DHS ELAP# 2496

Samples Reported

Sample Name	Date Sampled	Matrix	Lab #
U-1	07/01/2002 15:55	Water	2
U-2	07/01/2002 15:20	Water	3
U-3	07/01/2002 13:15	Water	4
MW-4	07/01/2002 14:30	Water	5
MW-5	07/01/2002 13:55	Water	6

Diesel

Gettler Ryan

Attn.: Deanna Harding
6747 Sierra Court Suite J
Dublin, CA 94568
Phone: (925) 551-7444 Fax: (925) 551-7899

STL San Francisco
1220 Quarry Lane
Pleasanton, CA 94566

Tel: (925) 484-1919
Fax: (925) 484-1096
www.stl-inc.com
www.chromalab.com

Project: 1800022.80
Tosco # 7176

Received: 07/02/2002 12:40

Site: 7850 Amador Valley Blvd.
Dublin, CA

CA DHS ELAP# 2496

Prep(s): 3510/8015M	Test(s): 8015M
Sample ID: U-1	Lab ID: 2002-07-0046 - 2
Sampled: 07/01/2002 15:55	Extracted: 7/2/2002 09:05
Matrix: Water	QC Batch#: 2002/07/02-01_10

Compound	Conc.	RL	Unit	Dilution	Analyzed	Flag
Diesel	2100	50	ug/L	1.00	07/03/2002 12:01	ndp
<i>Surrogates(s)</i> o-Terphenyl	93.2	60-130	%	1.00	07/03/2002 12:01	

Submission #: 2002-07-0046

Diesel

Gettler Ryan

Attn.: Deanna Harding
6747 Sierra Court Suite J
Dublin, CA 94568
Phone: (925) 551-7444 Fax: (925) 551-7899

Project: 1800022.80
Tosco # 7176

Received: 07/02/2002 12:40

Site: 7850 Amador Valley Blvd.
Dublin, CA

SEVERN
TRENT
LABORATORY

STL San Francisco
1220 Quarry Lane
Pleasanton, CA 94566

Tel: (925) 484-1919
Fax: (925) 484-1096
www.stl-inc.com
www.chromalab.com

CA DHS ELAP# 2496

Prep(s):	3510/8015M	Test(s):	8015M
Sample ID:	U-2	Lab ID:	2002-07-0046 - 3
Sampled:	07/01/2002 15:20	Extracted:	7/2/2002 09:05
Matrix:	Water	QC Batch#:	2002/07/02-01.10

Compound	Conc.	RL	Unit	Dilution	Analyzed	Flag
Diesel	ND	50	ug/L	1.00	07/03/2002 13:46	
Surrogates(s) o-Terphenyl	94.9	60-130	%	1.00	07/03/2002 13:46	

Submission #: 2002-07-0046

SEVERN

TRENT

LABORATORY

Diesel

Gettler Ryan

Attn.: Deanna Harding
6747 Sierra Court Suite J
Dublin, CA 94568

Phone: (925) 551-7444 Fax: (925) 551-7899

Project: 1800022.80
Tosco # 7176

Received: 07/02/2002 12:40

Site: 7850 Amador Valley Blvd.
Dublin, CA

STL San Francisco
1220 Quarry Lane
Pleasanton, CA 94566

Tel: (925) 484-1919
Fax: (925) 484-1096
www.stl-inc.com
www.chromalab.com

CA DHS ELAP# 2496

Prep(s): 3510/8015M	Test(s): 8015M
Sample ID: U-3	Lab ID: 2002-07-0046 - 4
Sampled: 07/01/2002 13:15	Extracted: 7/2/2002 09:05
Matrix: Water	QC Batch#: 2002/07/02-01:10
Analysis Flag: rl (See Legent and Note Section)	

Compound	Conc.	RL	Unit	Dilution	Analyzed	Flag
Diesel	1500	59	ug/L	1.18	07/03/2002 13:09	ndp
<i>Surrogates(s)</i> o-Terphenyl	90.9	60-130	%	1.18	07/03/2002 13:09	

Diesel

Gettler Ryan

Attn.: Deanna Harding
6747 Sierra Court Suite J
Dublin, CA 94568
Phone: (925) 551-7444 Fax: (925) 551-7899

Project: 1800022.80
Tosco # 7176

Received: 07/02/2002 12:40

Site: 7850 Amador Valley Blvd.
Dublin, CA

STL San Francisco
1220 Quarry Lane
Pleasanton, CA 94566

Tel: (925) 484-1919
Fax: (925) 484-1096
www.stl-inc.com
www.chromalab.com

CA DHS ELAP# 2496

Prep(s): 3510/8015M	Test(s): 8015M
Sample ID: MW-4	Lab ID: 2002-07-0046 - 5
Sampled: 07/01/2002 14:30	Extracted: 7/2/2002 09:05
Matrix: Water	QC Batch#: 2002/07/02-01.10
Analysis Flag: n (See Legent and Note Section)	

Compound	Conc.	RL	Unit	Dilution	Analyzed	Flag
Diesel	130	63	ug/L	1.25	07/03/2002 13:46	ndp
Surrogates(s)						
o-Terphenyl	99.8	60-130	%	1.25	07/03/2002 13:46	

Submission #: 2002-07-0046

Diesel

Gettler Ryan

Attn.: Deanna Harding
6747 Sierra Court Suite J
Dublin, CA 94568
Phone: (925) 551-7444 Fax: (925) 551-7899

Project: 1800022.80
Tosco # 7176

Received: 07/02/2002 12:40

Site: 7850 Amador Valley Blvd.
Dublin, CA

SEVERN
TRENT
LABORATORY

STL San Francisco
1220 Quarry Lane
Pleasanton, CA 94566

Tel: (925) 484-1919
Fax: (925) 484-1096
www.stl-inc.com
www.chromalab.com

CA DHS ELAP# 2496

Prep(s): 3510/8015M	Test(s): 8015M
Sample ID: MW-5	Lab ID: 2002-07-0046 - 6
Sampled: 07/01/2002 13:55	Extracted: 7/2/2002 09:05
Matrix: Water	QC Batch#: 2002/07/02-01.10
Analysis Flag: rl (See Legent and Note Section)	

Compound	Conc.	RL	Unit	Dilution	Analyzed	Flag
Diesel	ND	60	ug/L	1.19	07/03/2002 13:09	
Surrogates(s) o-Terphenyl	95.1	60-130	%	1.19	07/03/2002 13:09	

Submission #: 2002-07-0046

Diesel

Gettler Ryan

Attn.: Deanna Harding
6747 Sierra Court Suite J
Dublin, CA 94568
Phone: (925) 551-7444 Fax: (925) 551-7899

Project: 1800022.80
Tosco # 7176

Received: 07/02/2002 12:40

Site: 7850 Amador Valley Blvd.
Dublin, CA

SEVERN

TRENT

LABORATORY

STL San Francisco
1220 Quarry Lane
Pleasanton, CA 94566

Tel: (925) 484-1919
Fax: (925) 484-1096
www.stl-inc.com
www.chromalab.com

CA DHS ELAP# 2496

Batch QC Report

Prep(s): 3510/8015M

Method Blank

MB: 2002/07/02-01.10-001

Water

Test(s): 8015M

QC Batch # 2002/07/02-01.10

Date Extracted: 07/02/2002 09:05

Compound	Conc.	RL	Unit	Analyzed	Flag
Diesel	ND	50	ug/L	07/02/2002 10:12	
Surrogates(s) o-Terphenyl	109.2	60-130	%	07/02/2002 10:12	

Diesel

Gettler Ryan

Attn.: Deanna Harding
6747 Sierra Court Suite J
Dublin, CA 94568

Phone: (925) 551-7444 Fax: (925) 551-7899

Project: 1800022.80
Tosco # 7176

STL San Francisco
1220 Quarry Lane
Pleasanton, CA 94566

Tel: (925) 484-1919
Fax: (925) 484-1096
www.stl-inc.com
www.chromalab.com

Received: 07/02/2002 12:40

Site: 7850 Amador Valley Blvd.
Dublin, CA

CA DHS ELAP# 2496

Batch QC Report

Prep(s): 3510/8015M

Test(s): 8015M

Laboratory Control Spike

Water

QC Batch # 2002/07/02-01.10

LCS 2002/07/02-01.10-002

Extracted: 07/02/2002

Analyzed: 07/02/2002 10:12

LCSD 2002/07/02-01.10-003

Extracted: 07/02/2002

Analyzed: 07/02/2002 10:49

Compound	Conc. ug/L		Exp.Conc.	Recovery		RPD	Ctrl.Limits %		Flags	
	LCS	LCSD		LCS	LCSD		%	Rec.	RPD	LCS
Diesel	987	930	1250	79.0	74.4	6.0	60-130	25		
Surrogates(s) o-Terphenyl	21.2	19.7	20.0	106.1	98.3		60-130	0		

Submission #: 2002-07-0046

Diesel

Gettler Ryan

Attn.: Deanna Harding
6747 Sierra Court Suite J
Dublin, CA 94568

Phone: (925) 551-7444 Fax: (925) 551-7899

Project: 1800022.80
Tosco # 7176

Received: 07/02/2002 12:40

Site: 7850 Amador Valley Blvd.
Dublin, CA

SEVERN

TRENT

LABORATORY

STL San Francisco
1220 Quarry Lane
Pleasanton, CA 94566

Tel: (925) 484-1919
Fax: (925) 484-1096
www.stl-inc.com
www.chromalab.com

CA DHS ELAP# 2496

Legend and Notes

Analysis Flag

rl

Reporting limits raised due to reduced sample size.

Result Flag

ndp

Hydrocarbon reported does not match the pattern of our Diesel standard

Submission #: 2002-07-0046

Gas/BTEXFuel Oxygenates by 8260B

Gettler Ryan

Attn.: Deanna Harding
6747 Sierra Court Suite J
Dublin, CA 94568

Phone: (925) 551-7444 Fax: (925) 551-7899

Project: 1800022.80
Tosco # 7176

Received: 07/02/2002 12:40

Site: 7850 Amador Valley Blvd.
Dublin, CA

SEVERN
TRENT
LABORATORY

STL San Francisco
1220 Quarry Lane
Pleasanton, CA 94566

Tel: (925) 484-1919
Fax: (925) 484-1096
www.stl-inc.com
www.chromalab.com

CA DHS ELAP# 2496

Samples Reported

Sample Name	Date Sampled	Matrix	Lab #
QA	07/01/2002	Water	1
U-1	07/01/2002 15:55	Water	2
U-2	07/01/2002 15:20	Water	3
U-3	07/01/2002 13:15	Water	4
MW-4	07/01/2002 14:30	Water	5
MW-5	07/01/2002 13:55	Water	6

Submission #: 2002-07-0046

Gas/BTEXFuel Oxygenates by 8260B

Gettler Ryan

Attn.: Deanna Harding
6747 Sierra Court Suite J
Dublin, CA 94568
Phone: (925) 551-7444 Fax: (925) 551-7899

Project: 1800022.80
Tosco # 7176

Received: 07/02/2002 12:40

Site: 7850 Amador Valley Blvd.
Dublin, CA

SEVERN
TRENT
LABORATORY

STL San Francisco
1220 Quarry Lane
Pleasanton, CA 94566

Tel: (925) 484-1919
Fax: (925) 484-1096
www.stl-inc.com
www.chromalab.com

CA DHS ELAP# 2496

Prep(s):	5030B	Test(s):	8260FAB
Sample ID:	QA	Lab ID:	2002-07-0046 - 1
Sampled:	07/01/2002	Extracted:	7/9/2002 18:45
Matrix:	Water	QC Batch#:	2002/07/09-01.27

Compound	Conc.	RL	Unit	Dilution	Analyzed	Flag
Gasoline	ND	50	ug/L	1.00	07/09/2002 18:45	
Benzene	ND	0.50	ug/L	1.00	07/09/2002 18:45	
Toluene	ND	0.50	ug/L	1.00	07/09/2002 18:45	
Ethylbenzene	ND	0.50	ug/L	1.00	07/09/2002 18:45	
Total xylenes	ND	1.0	ug/L	1.00	07/09/2002 18:45	
Methyl tert-butyl ether (MTBE)	ND	0.50	ug/L	1.00	07/09/2002 18:45	
Surrogates(s)						
1,2-Dichloroethane-d4	113.9	76-114	%	1.00	07/09/2002 18:45	
Toluene-d8	99.8	88-110	%	1.00	07/09/2002 18:45	

Gas/BTEXFuel Oxygenates by 8260B

Gettler Ryan

Attn.: Deanna Harding

6747 Sierra Court Suite J

Dublin, CA 94568

Phone: (925) 551-7444 Fax: (925) 551-7899

Project: 1800022.80

Tosco # 7176

Received: 07/02/2002 12:40

STL San Francisco
1220 Quarry Lane
Pleasanton, CA 94566Tel: (925) 484-1919
Fax: (925) 484-1096
www.stl-inc.com
www.chromalab.comSite: 7850 Amador Valley Blvd.
Dublin, CA

CA DHS ELAP# 2496

Prep(s):	5030B	Test(s):	8260FAB
Sample ID:	U-1	Lab ID:	2002-07-0046 - 2
Sampled:	07/01/2002 15:55	Extracted:	7/10/2002 13:30
Matrix:	Water	QC Batch#:	2002/07/10-01.27

Compound	Conc.	RL	Unit	Dilution	Analyzed	Flag
Gasoline	3900	50	ug/L	1.00	07/10/2002 13:30	
Benzene	ND	0.50	ug/L	1.00	07/10/2002 13:30	
Toluene	ND	0.50	ug/L	1.00	07/10/2002 13:30	
Ethylbenzene	ND	0.50	ug/L	1.00	07/10/2002 13:30	
Total xylenes	3.9	1.0	ug/L	1.00	07/10/2002 13:30	
tert-Butyl alcohol (TBA)	ND	5.0	ug/L	1.00	07/10/2002 13:30	
Methyl tert-butyl ether (MTBE)	23	0.50	ug/L	1.00	07/10/2002 13:30	
Di-isopropyl Ether (DIPE)	ND	1.0	ug/L	1.00	07/10/2002 13:30	
Ethyl tert-butyl ether (ETBE)	ND	0.50	ug/L	1.00	07/10/2002 13:30	
tert-Amyl methyl ether (TAME)	ND	0.50	ug/L	1.00	07/10/2002 13:30	
1,2-DCA	ND	0.50	ug/L	1.00	07/10/2002 13:30	
EDB	ND	0.50	ug/L	1.00	07/10/2002 13:30	
Ethanol	ND	25	ug/L	1.00	07/10/2002 13:30	
Surrogates(s)						
1,2-Dichloroethane-d4	103.9	76-114	%	1.00	07/10/2002 13:30	
Toluene-d8	108.1	88-110	%	1.00	07/10/2002 13:30	

Submission #: 2002-07-0046

Gas/BTEX Fuel Oxygenates by 8260B

Gettler Ryan

Attn.: Deanna Harding
6747 Sierra Court Suite J
Dublin, CA 94568

Phone: (925) 551-7444 Fax: (925) 551-7899

Project: 1800022.80
Tosco # 7176

Received: 07/02/2002 12:40

Site: 7850 Amador Valley Blvd.
Dublin, CA

SEVERN

TRENT

LABORATORY

STL San Francisco
1220 Quarry Lane
Pleasanton, CA 94566

Tel: (925) 484-1919
Fax: (925) 484-1096
www.stl-inc.com
www.chromalab.com

CA DHS ELAP# 2496

Prep(s):	5030B	Test(s):	8260FAB
Sample ID:	U-2	Lab ID:	2002-07-0046 - 3
Sampled:	07/01/2002 15:20	Extracted:	7/10/2002 14:43
Matrix:	Water	QC Batch#:	2002/07/10-01.27

Compound	Conc.	RL	Unit	Dilution	Analyzed	Flag
Gasoline	4500	50	ug/L	1.00	07/10/2002 14:43	
Benzene	ND	0.50	ug/L	1.00	07/10/2002 14:43	
Toluene	ND	0.50	ug/L	1.00	07/10/2002 14:43	
Ethylbenzene	5.0	0.50	ug/L	1.00	07/10/2002 14:43	
Total xylenes	1.7	1.0	ug/L	1.00	07/10/2002 14:43	
tert-Butyl alcohol (TBA)	ND	5.0	ug/L	1.00	07/10/2002 14:43	
Methyl tert-butyl ether (MTBE)	ND	0.50	ug/L	1.00	07/10/2002 14:43	
Di-isopropyl Ether (DIPE)	ND	1.0	ug/L	1.00	07/10/2002 14:43	
Ethyl tert-butyl ether (ETBE)	ND	0.50	ug/L	1.00	07/10/2002 14:43	
tert-Amyl methyl ether (TAME)	ND	0.50	ug/L	1.00	07/10/2002 14:43	
1,2-DCA	ND	0.50	ug/L	1.00	07/10/2002 14:43	
EDB	ND	0.50	ug/L	1.00	07/10/2002 14:43	
Ethanol	ND	25	ug/L	1.00	07/10/2002 14:43	
Surrogates(s)						
1,2-Dichloroethane-d4	101.3	76-114	%	1.00	07/10/2002 14:43	
Toluene-d8	103.1	88-110	%	1.00	07/10/2002 14:43	

Gas/BTEX Fuel Oxygenates by 8260B

Gettler Ryan

Attn.: Deanna Harding
 6747 Sierra Court Suite J
 Dublin, CA 94568
 Phone: (925) 551-7444 Fax: (925) 551-7899

Project: 1800022.80
 Tosco # 7176

Received: 07/02/2002 12:40

Site: 7850 Amador Valley Blvd.
 Dublin, CA

STL San Francisco
 1220 Quarry Lane
 Pleasanton, CA 94566

Tel: (925) 484-1919
 Fax: (925) 484-1096
 www.stl-inc.com
 www.chromalab.com

CA DHS ELAP# 2496

Prep(s):	5030B	Test(s):	8260FAB
Sample ID:	U-3	Lab ID:	2002-07-0046 - 4
Sampled:	07/01/2002 13:15	Extracted:	7/9/2002 19:52
Matrix:	Water	QC Batch#:	2002/07/09-01.27

Compound	Conc.	RL	Unit	Dilution	Analyzed	Flag
Gasoline	ND	50	ug/L	1.00	07/09/2002 19:52	
Benzene	ND	0.50	ug/L	1.00	07/09/2002 19:52	
Toluene	ND	0.50	ug/L	1.00	07/09/2002 19:52	
Ethylbenzene	ND	0.50	ug/L	1.00	07/09/2002 19:52	
Total xylenes	ND	1.0	ug/L	1.00	07/09/2002 19:52	
tert-Butyl alcohol (TBA)	ND	5.0	ug/L	1.00	07/09/2002 19:52	
Methyl tert-butyl ether (MTBE)	ND	0.50	ug/L	1.00	07/09/2002 19:52	
Di-isopropyl Ether (DIPE)	ND	1.0	ug/L	1.00	07/09/2002 19:52	
Ethyl tert-butyl ether (ETBE)	ND	0.50	ug/L	1.00	07/09/2002 19:52	
tert-Amyl methyl ether (TAME)	ND	0.50	ug/L	1.00	07/09/2002 19:52	
1,2-DCA	ND	0.50	ug/L	1.00	07/09/2002 19:52	
EDB	ND	0.50	ug/L	1.00	07/09/2002 19:52	
Ethanol	ND	25	ug/L	1.00	07/09/2002 19:52	
Surrogates(s)						
1,2-Dichloroethane-d4	110.2	76-114	%	1.00	07/09/2002 19:52	
Toluene-d8	103.4	88-110	%	1.00	07/09/2002 19:52	

Submission #: 2002-07-0046

Gas/BTEXFuel Oxygenates by 8260B

Gettler Ryan

Attn.: Deanna Harding
6747 Sierra Court Suite J
Dublin, CA 94568
Phone: (925) 551-7444 Fax: (925) 551-7899

Project: 1800022.80
Tosco # 7176

Received: 07/02/2002 12:40

Site: 7850 Amador Valley Blvd.
Dublin, CA

SEVERN
TRENT
LABORATORY

STL San Francisco
1220 Quarry Lane
Pleasanton, CA 94566

Tel: (925) 484-1919
Fax: (925) 484-1096
www.stl-inc.com
www.chromalab.com

CA DHS ELAP# 2496

Prep(s):	5030B	Test(s):	8260FAB
Sample ID:	MW-4	Lab ID:	2002-07-0046 - 5
Sampled:	07/01/2002 14:30	Extracted:	7/9/2002 20:15
Matrix:	Water	QC Batch#:	2002/07/09-01.27

Compound	Conc.	RL	Unit	Dilution	Analyzed	Flag
Gasoline	280	50	ug/L	1.00	07/09/2002 20:15	
Benzene	ND	0.50	ug/L	1.00	07/09/2002 20:15	
Toluene	ND	0.50	ug/L	1.00	07/09/2002 20:15	
Ethylbenzene	ND	0.50	ug/L	1.00	07/09/2002 20:15	
Total xylenes	ND	1.0	ug/L	1.00	07/09/2002 20:15	
tert-Butyl alcohol (TBA)	ND	5.0	ug/L	1.00	07/09/2002 20:15	
Methyl tert-butyl ether (MTBE)	0.58	0.50	ug/L	1.00	07/09/2002 20:15	
Di-isopropyl Ether (DIPE)	ND	1.0	ug/L	1.00	07/09/2002 20:15	
Ethyl tert-butyl ether (ETBE)	ND	0.50	ug/L	1.00	07/09/2002 20:15	
tert-Amyl methyl ether (TAME)	ND	0.50	ug/L	1.00	07/09/2002 20:15	
1,2-DCA	ND	0.50	ug/L	1.00	07/09/2002 20:15	
EDB	ND	0.50	ug/L	1.00	07/09/2002 20:15	
Ethanol	ND	25	ug/L	1.00	07/09/2002 20:15	
Surrogates(s)						
1,2-Dichloroethane-d4	117.9	76-114	%	1.00	07/09/2002 20:15	sh
Toluene-d8	101.4	88-110	%	1.00	07/09/2002 20:15	

Gas/BTEXFuel Oxygenates by 8260B

Gettler Ryan

Attn.: Deanna Harding
 6747 Sierra Court Suite J
 Dublin, CA 94568
 Phone: (925) 551-7444 Fax: (925) 551-7899

STL San Francisco
 1220 Quarry Lane
 Pleasanton, CA 94566

Tel: (925) 484-1919
 Fax: (925) 484-1096
 www.stl-inc.com
 www.chromalab.com

Project: 1800022.80
 Tosco # 7176

Received: 07/02/2002 12:40

Site: 7850 Amador Valley Blvd.
 Dublin, CA

CA DHS ELAP# 2496

Prep(s):	5030B	Test(s):	8260FAB
Sample ID:	MW-5	Lab ID:	2002-07-0046 - 6
Sampled:	07/01/2002 13:55	Extracted:	7/9/2002 20:37
Matrix:	Water	QC Batch#:	2002/07/09-01.27

Compound	Conc.	RL	Unit	Dilution	Analyzed	Flag
Gasoline	ND	50	ug/L	1.00	07/09/2002 20:37	
Benzene	ND	0.50	ug/L	1.00	07/09/2002 20:37	
Toluene	ND	0.50	ug/L	1.00	07/09/2002 20:37	
Ethylbenzene	ND	0.50	ug/L	1.00	07/09/2002 20:37	
Total xylenes	ND	1.0	ug/L	1.00	07/09/2002 20:37	
tert-Butyl alcohol (TBA)	ND	5.0	ug/L	1.00	07/09/2002 20:37	
Methyl tert-butyl ether (MTBE)	2.3	0.50	ug/L	1.00	07/09/2002 20:37	
Di-isopropyl Ether (DIPE)	ND	1.0	ug/L	1.00	07/09/2002 20:37	
Ethyl tert-butyl ether (ETBE)	ND	0.50	ug/L	1.00	07/09/2002 20:37	
tert-Amyl methyl ether (TAME)	ND	0.50	ug/L	1.00	07/09/2002 20:37	
1,2-DCA	ND	0.50	ug/L	1.00	07/09/2002 20:37	
EDB	ND	0.50	ug/L	1.00	07/09/2002 20:37	
Ethanol	ND	25	ug/L	1.00	07/09/2002 20:37	
Surrogates(s)						
1,2-Dichloroethane-d4	118.0	76-114	%	1.00	07/09/2002 20:37	sh
Toluene-d8	100.5	88-110	%	1.00	07/09/2002 20:37	

Gas/BTEX Fuel Oxygenates by 8260B

Gettler Ryan

Attn.: Deanna Harding
 6747 Sierra Court Suite J
 Dublin, CA 94568
 Phone: (925) 551-7444 Fax: (925) 551-7899

Project: 1800022.80
 Tosco # 7176

Received: 07/02/2002 12:40

Site: 7850 Amador Valley Blvd.
 Dublin, CA

SEVERN
TRENT
LABORATORY

STL San Francisco
 1220 Quarry Lane
 Pleasanton, CA 94566

Tel: (925) 484-1919
 Fax: (925) 484-1096
 www.stl-inc.com
 www.chromalab.com

CA DHS ELAP# 2496

Batch QC Report			
Prep(s): 5030B			Test(s): 8260FAB
Method Blank	Water		QC Batch # 2002/07/09-01.27
MB: 2002/07/09-01.27-007			Date Extracted: 07/09/2002 13:40

Compound	Conc.	RL	Unit	Analyzed	Flag
Gasoline	ND	50	ug/L	07/09/2002 13:40	
Benzene	ND	0.5	ug/L	07/09/2002 13:40	
Toluene	ND	0.5	ug/L	07/09/2002 13:40	
Ethylbenzene	ND	0.5	ug/L	07/09/2002 13:40	
Total xylenes	ND	1.0	ug/L	07/09/2002 13:40	
tert-Butyl alcohol (TBA)	ND	5.0	ug/L	07/09/2002 13:40	
Methyl tert-butyl ether (MTBE)	ND	0.5	ug/L	07/09/2002 13:40	
Di-isopropyl Ether (DIPE)	ND	1.0	ug/L	07/09/2002 13:40	
Ethyl tert-butyl ether (ETBE)	ND	0.5	ug/L	07/09/2002 13:40	
tert-Amyl methyl ether (TAME)	ND	0.5	ug/L	07/09/2002 13:40	
1,2-DCA	ND	0.5	ug/L	07/09/2002 13:40	
EDB	ND	0.5	ug/L	07/09/2002 13:40	
Ethanol	ND	25	ug/L	07/09/2002 13:40	
Surrogates(s)					
1,2-Dichloroethane-d4	114.0	76-114	%	07/09/2002 13:40	
Toluene-d8	105.0	88-110	%	07/09/2002 13:40	

Gas/BTEXFuel Oxygenates by 8260B

Gettler Ryan

Attn.: Deanna Harding
6747 Sierra Court Suite J
Dublin, CA 94568
Phone: (925) 551-7444 Fax: (925) 551-7899

STL San Francisco
1220 Quarry Lane
Pleasanton, CA 94566

Tel: (925) 484-1919
Fax: (925) 484-1096
www.stl-inc.com
www.chromalab.com

Project: 1800022.80
Tosco # 7176

Received: 07/02/2002 12:40

Site: 7850 Amador Valley Blvd.
Dublin, CA

CA DHS ELAP# 2496

Batch QC Report					
Prep(s): 5030B				Test(s): 8260FAB	
Method Blank		Water		QC Batch # 2002/07/10-01.27	
MB: 2002/07/10-01.27-007				Date Extracted: 07/10/2002 12:08	

Compound	Conc.	RL	Unit	Analyzed	Flag
Gasoline	ND	50	ug/L	07/10/2002 12:08	
Benzene	ND	0.5	ug/L	07/10/2002 12:08	
Toluene	ND	0.5	ug/L	07/10/2002 12:08	
Ethylbenzene	ND	0.5	ug/L	07/10/2002 12:08	
Total xylenes	ND	1.0	ug/L	07/10/2002 12:08	
tert-Butyl alcohol (TBA)	ND	5.0	ug/L	07/10/2002 12:08	
Methyl tert-butyl ether (MTBE)	ND	0.5	ug/L	07/10/2002 12:08	
Di-isopropyl Ether (DIPE)	ND	1.0	ug/L	07/10/2002 12:08	
Ethyl tert-butyl ether (ETBE)	ND	0.5	ug/L	07/10/2002 12:08	
tert-Amyl methyl ether (TAME)	ND	0.5	ug/L	07/10/2002 12:08	
1,2-DCA	ND	0.5	ug/L	07/10/2002 12:08	
EDB	ND	0.5	ug/L	07/10/2002 12:08	
Ethanol	ND	25	ug/L	07/10/2002 12:08	
Surrogates(s)					
1,2-Dichloroethane-d4	112.8	76-114	%	07/10/2002 12:08	
Toluene-d8	104.2	88-110	%	07/10/2002 12:08	

Submission #: 2002-07-0046

Gas/BTEXFuel Oxygenates by 8260B

Gettler Ryan

Attn.: Deanna Harding
6747 Sierra Court Suite J
Dublin, CA 94568

Phone: (925) 551-7444 Fax: (925) 551-7899

Project: 1800022.80
Tosco # 7176

Received: 07/02/2002 12:40

Site: 7850 Amador Valley Blvd.
Dublin, CA

SEVERN
TRENT
LABORATORY

STL San Francisco
1220 Quarry Lane
Pleasanton, CA 94566

Tel: (925) 484-1919
Fax: (925) 484-1096
www.stl-inc.com
www.chromalab.com

CA DHS ELAP# 2496

Batch QC Report

Prep(s): 5030B

Test(s): 8260FAB

Laboratory Control Spike

Water

QC Batch # 2002/07/09-01.27

LCS 2002/07/09-01.27-005

Extracted: 07/09/2002

Analyzed: 07/09/2002 12:51

LCSD 2002/07/09-01.27-028

Extracted: 07/09/2002

Analyzed: 07/09/2002 14:06

Compound	Conc. ug/L		Exp.Conc.	Recovery		RPD %	Ctrl.Limits %		Flags	
	LCS	LCSD		LCS	LCSD		Rec.	RPD	LCS	LCSD
Benzene	19.9	19.6	25.0	79.6	78.4	1.5	69-129	20		
Toluene	23.5	23.4	25.0	94.0	93.6	0.4	70-130	20		
Methyl tert-butyl ether (MTBE)	19.1	16.6	25.0	76.4	66.4	14.0	65-165	20		
Surrogates(s)										
1,2-Dichloroethane-d4	547	544	500	109.4	108.8		76-114			
Toluene-d8	524	526	500	104.8	105.2		88-110			

Submission #: 2002-07-0046

Gas/BTEXFuel Oxygenates by 8260B

Gettler Ryan

Attn.: Deanna Harding
6747 Sierra Court Suite J
Dublin, CA 94568
Phone: (925) 551-7444 Fax: (925) 551-7899

Project: 1800022.80
Tosco # 7176

Received: 07/02/2002 12:40

Site: 7850 Amador Valley Blvd.
Dublin, CA

SEVERN
TRENT
LABORATORY

STL San Francisco
1220 Quarry Lane
Pleasanton, CA 94566

Tel: (925) 484-1919
Fax: (925) 484-1096
www.stl-inc.com
www.chromalab.com

CA DHS ELAP# 2496

Batch QC Report					
Prep(s): 5030B			Test(s): 8260FAB		
Laboratory Control Spike		Water		QC Batch # 2002/07/10-01-27	
LCS	2002/07/10-01.27-008	Extracted:	07/10/2002	Analyzed:	07/10/2002 12:30
LCSD	2002/07/10-01.27-009	Extracted:	07/10/2002	Analyzed:	07/10/2002 12:53

Compound	Conc. ug/L		Exp.Conc.	Recovery		RPD %	Ctrl.Limits %		Flags	
	LCS	LCSD		LCS	LCSD		Rec.	RPD	LCS	LCSD
Benzene	24.3	24.9	25.0	97.2	99.6	2.4	69-129	20		
Toluene	25.7	25.8	25.0	102.8	103.2	0.4	70-130	20		
Methyl tert-butyl ether (MTBE)	18.6	20.0	25.0	74.4	80.0	7.3	65-165	20		
Surrogates(s)										
1,2-Dichloroethane-d4	541	559	500	108.2	111.8		76-114			
Toluene-d8	523	488	500	104.6	97.6		88-110			

Submission #: 2002-07-0046

Gas/BTEX Fuel Oxygenates by 8260B

Gettler Ryan

Attn.: Deanna Harding
6747 Sierra Court Suite J
Dublin, CA 94568

Phone: (925) 551-7444 Fax: (925) 551-7899

Project: 1800022.80
Tosco # 7176

Received: 07/02/2002 12:40

Site: 7850 Amador Valley Blvd.
Dublin, CA

SEVERN
TRENT
LABORATORY

STL San Francisco
1220 Quarry Lane
Pleasanton, CA 94566

Tel: (925) 484-1919
Fax: (925) 484-1096
www.stl-inc.com
www.chromalab.com

CA DHS ELAP# 2496

Legend and Notes

Result Flag

sh

Surrogate recovery was higher than QC limit due to matrix interference.

Submission #: 2002-07-0046

Diesel with Silica Gel Clean-up

Gettler Ryan

Attn.: Deanna Harding

6747 Sierra Court Suite J

Dublin, CA 94568

Phone: (925) 551-7444 Fax: (925) 551-7899

Project: 1800022.80

Tosco # 7176

Received: 07/02/2002 12:40

Site: 7850 Amador Valley Blvd.
Dublin, CA

SEVERN

TRENT

LABORATORY

STL San Francisco
1220 Quarry Lane
Pleasanton, CA 94566

Tel: (925) 484-1919
Fax: (925) 484-1096
www.stl-inc.com
www.chromalab.com

CA DHS ELAP# 2496

Samples Reported

Sample Name	Date Sampled	Matrix	Lab #
U-1	07/01/2002 15:55	Water	2
U-3	07/01/2002 13:15	Water	4
MW-4	07/01/2002 14:30	Water	5

Submission #: 2002-07-0046

Diesel with Silica Gel Clean-up

Gettler Ryan

Attn.: Deanna Harding
6747 Sierra Court Suite J
Dublin, CA 94568

Phone: (925) 551-7444 Fax: (925) 551-7899

Project: 1800022.80
Tosco # 7176

Received: 07/02/2002 12:40

Site: 7850 Amador Valley Blvd.
Dublin, CA

SEVERN

TRENT

LABORATORY

STL San Francisco
1220 Quarry Lane
Pleasanton, CA 94566

Tel: (925) 484-1919
Fax: (925) 484-1096
www.stl-inc.com
www.chromalab.com

CA DHS ELAP# 2496

Prep(s):	3510/8015M	Test(s):	8015M
Sample ID:	U-1	Lab ID:	2002-07-0046 - 2
Sampled:	07/01/2002 16:55	Extracted:	7/2/2002 09:11
Matrix:	Water	QC Batch#:	2002/07/02-02_10

Compound	Conc.	RL	Unit	Dilution	Analyzed	Flag
Diesel	2100	50	ug/L	1.00	07/22/2002 11:22	ndp
Surrogates(s)						
o-Terphenyl	109.4	60-130	%	1.00	07/22/2002 11:22	

Submission #: 2002-07-0046

SEVERN

Diesel with Silica Gel Clean-up

TRENT

LABORATORY

Gettler Ryan

STL San Francisco
1220 Quarry Lane
Pleasanton, CA 94566

Attn.: Deanna Harding

6747 Sierra Court Suite J

Dublin, CA 94568

Phone: (925) 551-7444 Fax: (925) 551-7899

Tel: (925) 484-1919
Fax: (925) 484-1096
www.stl-inc.com
www.chromalab.com

Project: 1800022.80
Tosco # 7176

Received: 07/02/2002 12:40

Site: 7850 Amador Valley Blvd.
Dublin, CA

CA DHS ELAP# 2496

Prep(s): 3510/8015M	Test(s): 8015M
Sample ID: U-3	Lab ID: 2002-07-0046 - 4
Sampled: 07/01/2002 13:15	Extracted: 7/2/2002 09:11
Matrix: Water	QC Batch#: 2002/07/02-02.10
Analysis Flag: rl (See Legend and Note Section)	

Compound	Conc.	RL	Unit	Dilution	Analyzed	Flag
Diesel	ND	59	ug/L	1.18	07/22/2002 10:45	
Surrogates(s) o-Terphenyl	124.0	60-130	%	1.18	07/22/2002 10:45	

Submission #: 2002-07-0046

Diesel with Silica Gel Clean-up

Gettler Ryan

Attn.: Deanna Harding
6747 Sierra Court Suite J
Dublin, CA 94568

Phone: (925) 551-7444 Fax: (925) 551-7899

Project: 1800022.80
Tosco # 7176

Received: 07/02/2002 12:40

Site: 7850 Amador Valley Blvd.
Dublin, CA

SEVERN
TRENT
LABORATORY

STL San Francisco
1220 Quarry Lane
Pleasanton, CA 94566

Tel: (925) 484-1919
Fax: (925) 484-1096
www.stl-inc.com
www.chromalab.com

CA DHS ELAP# 2496

Prep(s): 3510/8015M	Test(s): 8015M
Sample ID: MW-4	Lab ID: 2002-07-0046 - 5
Sampled: 07/01/2002 14:30	Extracted: 7/2/2002 09:11
Matrix: Water	QC Batch#: 2002/07/02-02.10
Analysis Flag: n (See Legend and Note Section)	

Compound	Conc.	RL	Unit	Dilution	Analyzed	Flag
Diesel	97	63	ug/L	1.25	07/22/2002 11:22	ndp
Surrogates(s) o-Terphenyl	80.8	60-130	%	1.25	07/22/2002 11:22	

Submission #: 2002-07-0046

Diesel with Silica Gel Clean-up

Gettler Ryan

Attn.: Deanna Harding
6747 Sierra Court Suite J
Dublin, CA 94568
Phone: (925) 551-7444 Fax: (925) 551-7899

Project: 1800022.80
Tosco # 7176

Received: 07/02/2002 12:40

Site: 7850 Amador Valley Blvd.
Dublin, CA

SEVERN

TRENT

LABORATORY

STL San Francisco
1220 Quarry Lane
Pleasanton, CA 94566

Tel: (925) 484-1919
Fax: (925) 484-1096
www.stl-inc.com
www.chromalab.com

CA DHS ELAP# 2496

Batch QC Report

Prep(s): 3510/8015M

Method Blank

MB: 2002/07/02-02.10-001

Water

Test(s): 8015M

QC Batch # 2002/07/02-02.10

Date Extracted: 07/02/2002 09:11

Compound	Conc.	RL	Unit	Analyzed	Flag
Diesel	ND	50	ug/L	07/02/2002 16:25	
Surrogates(s) o-Terphenyl	91.7	60-130	%	07/02/2002 16:25	

Submission #: 2002-07-0046

Diesel with Silica Gel Clean-up

Gettler Ryan

Attn.: Deanna Harding
6747 Sierra Court Suite J
Dublin, CA 94568
Phone: (925) 551-7444 Fax: (925) 551-7899

Project: 1800022.80
Tosco # 7176

Received: 07/02/2002 12:40

Site: 7850 Amador Valley Blvd.
Dublin, CA

SEVERN
TRENT
LABORATORY

STL San Francisco
1220 Quarry Lane
Pleasanton, CA 94566

Tel: (925) 484-1919
Fax: (925) 484-1096
www.stl-inc.com
www.chromalab.com

CA DHS ELAP# 2496

Batch QC Report										
Prep(s): 3510/8015M						Test(s): 8015M				
Laboratory Control Spike			Water			QC Batch # 2002/07/02-02.10				
LCS	2002/07/02-02.10-002		Extracted: 07/02/2002			Analyzed: 07/02/2002 15:11				
LCSD	2002/07/02-02.10-003		Extracted: 07/02/2002			Analyzed: 07/02/2002 15:48				
Compound	Conc. ug/L		Exp.Conc.	Recovery		RPD	Ctrl.Limits %		Flags	
	LCS	LCSD		LCS	LCSD		%	Rec.	RPD	LCS
Diesel	882	918	1250	70.6	73.4	3.9	60-130	25		
Surrogates(s) o-Terphenyl	17.7	18.2	20.0	88.5	91.1		60-130	0		

Submission #: 2002-07-0046

Diesel with Silica Gel Clean-up

Gettler Ryan

Attn.: Deanna Harding

6747 Sierra Court Suite J

Dublin, CA 94568

Phone: (925) 551-7444 Fax: (925) 551-7899

Project: 1800022.80

Tosco # 7176

Received: 07/02/2002 12:40

Site: 7850 Amador Valley Blvd,
Dublin, CA

SEVERN

TRENT

LABORATORY

STL San Francisco
1220 Quarry Lane
Pleasanton, CA 94566

Tel: (925) 484-1919
Fax: (925) 484-1096
www.stl-inc.com
www.chromalab.com

CA DHS ELAP# 2496

Legend and Notes

Analysis Flag

rl

Reporting limits raised due to reduced sample size.

Result Flag

ndp

Hydrocarbon reported does not match the pattern of our Diesel standard