

enviros.

# Facsimile

RECEIVED

9:12 am, May 18, 2009

Alameda County  
Environmental Health

Date: 3/31/95

To: Ed Ralston  
Unocal

From: Clyde Galantine

RE: Unocal # 7176 Overex data

Give me a call if any questions.

FILE #	<u>7176</u>	SS	<input checked="" type="checkbox"/>	BP	<input type="checkbox"/>
RPT	<u>QM</u>	TRANSMITTAL			
1	<u>2</u>	3	4	5	6 <input checked="" type="checkbox"/>

14 page(s) including cover

Unocal # 7176 Dublin Overexcavation

① Northeast dispenser — 11/9/94  
 9x9x10 fbg

② Southeast dispenser 11/9/94  
 Initial overexcavation 7x8x12 fbg

Final Overexcavation on 11/30/94 12x14x19 fbg  
 plus 6x8x11 fbg

See signed sheet

③ Main excavations: measured by Barry McCoy of G-R  
 & myself on 11/11/94. We agree  
 to 51x32' x <sup>5</sup> fbg minus  
 14x20x5 fbg area in NE corner.

main exc — NE corner  
 So 51x32x5 — 14x20x5

Steve of G-R told me that the <sup>main</sup> excavation  
 would be excavated down to 15 fbg for new  
 UST installation. Steve said Denny Gsn told him  
 15 fbg.

11/30/94

Unocal # 7176  
7850 Amador Valley Rd, Dublin

Excavation of area below southeast dispenser.  
(UT-4)

Main excavation measures 12 feet east-west by 14 feet north-south by 19 feet deep. In addition a 8 feet east-west by 6 feet north-south by 11 feet deep excavation extended north of the northeast corner of the main excavation.

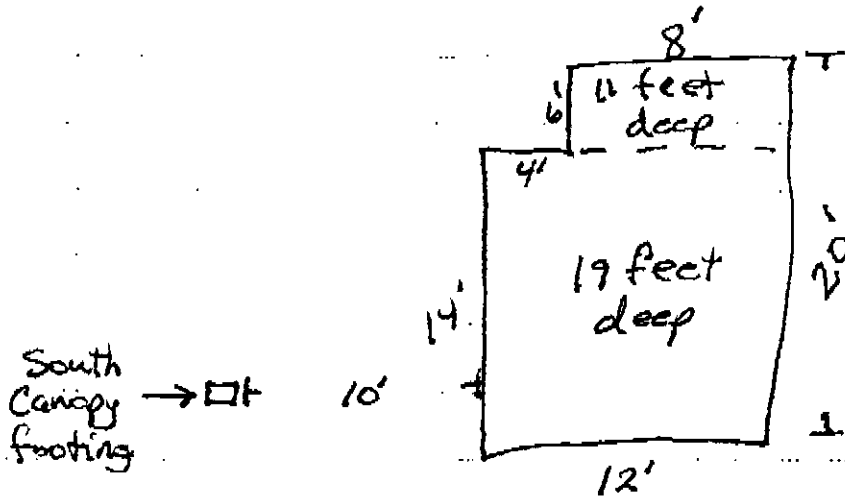

Project No.		94132			
RPT	PF	X	BF		
1	2	3	4	5	6

Janner Prid  
Gordon - Power  
Clyde Salantire

**enviros.**

**FIELD REPORT**

Client: Unocal # 7176 Project No. 94132.01

Date: 11/9/94 v Total Hours: 5

Site Name and Address: 7850 Amador Valley Rd  
Dublin CA

Contractors/Visitors on Site: G-R, Tank Excavators  
132060-

Field Work Description: Write up hours & billing in room @ 6:30. Arrive at  
site @ 7:10. Collect US-1A-D & US-2A-D from soil between  
Diesel & Gasoline tanks. G-R arrives @ 8 & get TF to get  
moving. Remove soil from WD excavation - ready for backfilling.  
Remove soil from Diesel tank area down to 15 fbg & 16' x 33'.  
Then go overexcavate UT-2 & UT-4 areas 9x9x10 fbg for UT-2  
& 7x8x12 fbg for UT-4. Stop due to canopy footing danger -  
agreed upon with Steve of G-R. Collect UWS-1A-D from 210yds<sup>3</sup>.  
Soil excavated from Diesel area moved to West of US-2A-D.  
Start to overexcavate south end of Diesel area. Go 12' north  
& 16' west of SE corner of excavation & down 20' to  
GLW. Gasoline in old 1st generation steel pipe runs into  
excavation ~ 1-2 gallons. It fell into soil that was removed.  
Leave site for San Ramon @ 11:35.

Verbals @ 5PM ND for UT-1, UX-2, UW-1 - UT-3 had 3.1 ppm  
gas

Equipment Use:  
 Sample Tubes (no.) 12 OVM (days) \_\_\_\_\_ 55 Gal Drums (no.) \_\_\_\_\_  
 Soil Samp Equip (days) 1 Water Samp Equip (days) \_\_\_\_\_ Hanby (no.) 1  
 Truck (hrs) \_\_\_\_\_ Bailers (no.) \_\_\_\_\_ DO Meter (days) \_\_\_\_\_  
 Mileage (miles) \_\_\_\_\_ Hand Auger (days) \_\_\_\_\_  
 Other: \_\_\_\_\_

Signature: Dyde Salanter Page No. \_\_\_\_\_

11/8/94. Tuesday  
941320. Unocal #776  
7850 Amador Valley Rd Dublin

- 1:15 Arrive @ site. - Gattler-Ryan ready to pull tanks. I set up
- 2:00 Barney Chan of ACHA arrives. Go into auger O/w separator
- 2:20 Dougherty, Regional Fire Dept. Reps arrive.
- 2:30 Remove 1 280-gallon single wall steel WO tank highly rusted & pitted ~8 pinhole to 1/2" size holes on bottom. Erickson takes tanks. Exc is ~8' x 8' with bottom of tank @ ~7-7 1/2'
- 2:50 Pull 1 10000-gallon single wall steel, fer wrapped Diesel tank aligned N-S. South end had fill port. Staining around N & south ends from over fill/leaks in piping. Some rust - very good shape. 276" x 8'

- 3:15 Collect UOW-1 @ 6'  
O/w box is 3.5' deep - middle bay
- 3:30 Collect UOW-1 @ 8'  
looks good - center of excavation.
- 3:45 Collect UT-1 @ 3.5'  
~3' W of north island post under Diesel dispenser
- 3:50 The 3 10000 gas tanks are too hot to pull - Dave Byron schedules them for 2pm tomorrow (11-9). I said OK - I will check schedule but should be good. Crew wraps ~~up~~ up site (Tank excavators) FD guys leave.
- 4:00 Collect UT-2 @ 3.5'  
under Gas dispenser near G/Diesel lines - hot? ~15' E of N canopy post on end disp. Rest of dispensers on north island smell OK.
- 4:10 Collect UT-3 @ 3.5' (Gas only)  
~3' West of South canopy post.
- 4:15 Collect UT-4 @ 3.5' ~15'  
East of South canopy footing - Straks

4:20 Collect UX-1 @ 14'  
below S end of Diesel  
UST - stinky  
4:50 Collect UX-2 @ 14'  
below N end of Diesel - OK?  
ACHA rep leaves. I call  
DV & fill him in - the  
San Ramon job is scheduled for  
1-1:30 tomorrow. He says  
OK to my analytical plans.  
Call Sequoia & tell them  
what to expect & tell  
Barry of G-R my plans.  
Pack up & leave @ 5:15  
for Sequoia Redwood City.  
Leave Sequoia @ 6:30

11/9/04 Wednesday

7:10 Arrive @ site - Tank Exc here  
@ 7:30. Measure in main Exc  
27' N-S x 53' E-W with  
E end 33' N-S x 13' E-W where  
Diesel UST was.  
Stack pile in SE corner ~ 100 yds from  
gap between Diesel & Gas USTs  
G-R guy arrives @ 8 AM - Tank Exc  
start working?  
8:05 Collect US-1A-D from East  
end Diesel wedge soil ~ 50 yds  
8:25 Collect US-2A-D from West  
end Diesel wedge ~ 50 yds  
G-R cleans WD Exc as I sample &  
move to Diesel UST area to dig  
down to 15' for new UST's  
8:45 Call office & get data for  
74156 San Ramon UT samples -  
call Ed & leave update for both  
sites. Call Walton Eng. & leave  
message for Mark about UT samples  
9:15 Collect UWS-1A-D ~ 10 yds<sup>3</sup> total  
w/ cleaned out exc.  
Fast 16' of Diesel/Gas Exc dug down  
to 15' fbg - clean in N end?

12/21/04

Max over & dig below UT-2  
NE dispenser - by 10:00 have  
a 9x9x10' dig excavation  
w/ west wall 'ull' east of  
North canopy footing - old gas.

Max to UT-4 overex. Dig  
down to 12' fbg x 7' N-S x  
8' E-W. Hanby @ 12'  
says ~105" Diesel or  
old Gas. Steve & of  
G-R agrees that we should not  
dig any further due to possible  
canopy failure.

10:45 Meet back to Diesel exc.  
& dig down @ South end  
Find Gula @ ~20' fbg.

Overexcavate from 15-20' fbg  
going 12' North & 16' West  
of SE corner. First  
generation steel pipe had  
~1-2 gallons gasoline? pour  
into excavation - all poured  
on soil that was removed.

11:35 Leave site for 94156 San Ramon.  
G-R almost has Diesel exc  
hogged out w/ puddle  
for H<sub>2</sub>O sample.

	G	D	B	OEG
UT-1	NO	NO	NO	—
UT-3	3.1	—	.017	—
UX-2	—	NO	NO	—
UW-1	NO	NO	NO	NO

Verbal received @ 4:55 11/9/94

11/10/94 Thursday

7:30 Work on paperwork in hotel room  
Leave for site  
8:15 Arrive @ site - it had rained  
hard here all day - Diesel excavation  
has GWD? @ 19' fbg.

Fill out of Gas UST's is East.

Product lines blown clean - not rinsed.

TE arrives ~ 8:45. Crank arrives

9:05

9:15 Collect US-3A-D ~ 60-70 yds

Soil from Diesel area beneath UST.

9:40 Collect US-4A-D ~ 40-70 yds

same as US-3A-D

Ed Ralston arrives @ 9:50  
Fire Dept here @ 10:00  
AKHA here @ 10:05 (Barney Chan)

- 10:10 Pull 1 10,000-gallon  
single-wall steel UST (center)  
87 octane gasoline - tank  
is rusty & pitted but OK <sup>no</sup> holes
- 10:35 Pull 1 10,000-gallon  
single-wall steel 87 octane  
UST (north tank). Tank  
is rusty & pitted - no holes
- 11:00 Pull 1 10,000 gallon  
single-wall steel 92 octane  
gasoline UST (south tank)  
Rusty & pitted
- 11:30 Fire Dept, crane & last  
load leaves.
- 11:35 Start digging in exc
- 11:45 Collect UX-3 @ 15.5'  
West end center UST.
- 11:50 Collect UX-4 @ 15.5' / 5' from west  
west end south UST - 5' from west  
wall

- 12:10 <sup>OK smell</sup> Collect UX-5 @ 15.5'  
~ 21' E of West wall under E end  
of South UST (4' from south wall)
- 12:15 Collect UX-6 @ 15'  
22' E of West wall under east  
end center tank
- 12:20 Collect UX-9 on Sidewall  
opposite S end of Diesel UST  
(a) 16' fbg stakes
- 12:25 Collect UX-10 on sidewall  
10' North of SE cor of excavator  
(a) 16' fbg stakes
- 12:30 Collect UX-7 @ 15'  
22' E of West wall under  
E end South UST - OK smell
- 12:35 Collect UX-8 @ 15'  
~ 5' South & East of NW cor  
of excavation some odor
- 12:40 Collect UT-5 @ 11'  
below UT-4
- 12:45 Collect UT-6 @ 11'  
below UT-2
- 12:55 Barney leaves



There were 1st generation steel product lines running along the South wall of the excavation that ran to an old island east of the SE corner of the excavation.

These lines had fuel in them - some did run into the exc.

2:00 Leave for San Ramon - Mark from Walton says WO exc is caving in - he wants to backfill ASAP.

3:25 (3:00) Return from San Ramon. Almost all of N  $\frac{1}{2}$  of exc is down to ~20' except for NE corner. Soil is being stockpiled East of canopy footings - both UT-8 & UT-4 excavation were backfilled w/ hot soil that will be removed later.

3:40 Collect US-SA-0 ~50yds material covering USTs - pile is NW of building.

3:50 Collect US-6A-D ~50yds N of US-SA-0 & same material.

4:25 Leave site for Sequoia. Soil left in hole goes 15' West of NE corner.

Arrive @ Sequoia & log in samples. Call DV & Ed about excavation needs.

Ed says we will not overex the SE corner & we'll backfill w/ p gravel entirely.

He wants 2-6" conductor casings  $\rightarrow$  1 in SE corner for Diesel area & 1 in TRH-Gas Area (south wall).

Both will be 20' long. He needs to talk to Dave Byron about overex billing ASAP (compaction costs).

I call Barry McCoy @ 6:45 & fell him in - they have some soil to remove still.

11/11/94 Friday  
 7:00 Leave room for Envirotech  
 to pick up supplies. Arrive  
 @ 8:30. No soil wedge  
 was left to wall off  
 Diesel South end deep hole.  
 Only wedge in NE corner left  
 Tank Exc here when I arrive.  
 Barry of GR arrives @ ~8:45

9:10 Collect UX-12 @ 17' ~  
 10' E of SW corner sidewall  
 extra

9:25 Collect UX-11 @ 17'  
 ~ 10' North of SW corner of  
 Exc.

Barry & I measure Excavation  
 Excavation Measures

20' by depth

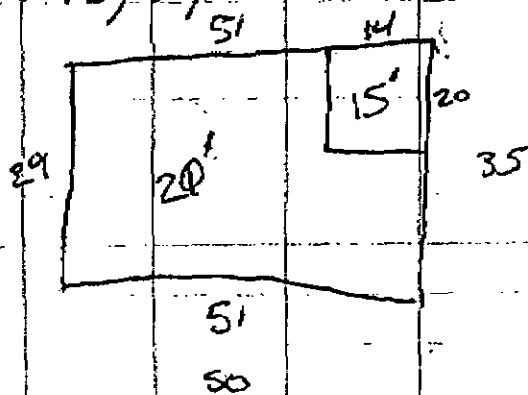

So agree to 51 X 32 X 20 fbg  
 minus 14 X 20 X 15 in NE corner.  
 ~ 250 yds overexcavation  
 Also 7 X 8 X 11 fbg for UT-4  
 overexcavation & 9 X 9 X 11 fbg  
 for UT-2 overexcavation

20 fbg X 32 X 51	=	1200 yds
- 4 tank X 50 yds	=	- 200
- wedge in NE	=	- 50
		<hr/>
		950

950 yds X 1.25 fluff = 1200 yds<sup>3</sup>

~ 9:30 1st load of pea gravel  
 delivered.

10:25 Collect UX-13 @ 15'  
 ~ 22' E of NW corner sidewall

10:30 Collect UX-14 @ 17'  
 ~ 10' E of NW corner - sidewall

11:00 Finish marking bag stockpile  
 for sampling ~ 7 samples

11:20 Collect US-7A-D NW corner

11:35 Collect US-8A-D S of US-7A-D

11:45 Collect US-9A-D SW corner

~ 11:30 GR/TE stops working  
 on cleaning exc / south sidewall

12:00 Collect US-10A-D SE corner

12:30 Collect US-11A-D Not US-10

12:45 Collect US-12A-D Not US-11

12:55 Collect US-13A-D NE corner

US-7A-D → US-13A-D are  
100 yd<sup>3</sup> composites - all  
others are ~50's

LIS Ed Ralston, Dave V, Jeff G  
& Brian Huseman arrive -  
big discussion about compacting  
W end of exc for "new island"  
(future?). We will run US-7 → 13  
on 1 day TAT for G, O, BTEX &  
TLC Pb & hold US-11 → 14 for  
Eva Chan. Huseman wants  
clean rock & compactable material  
for ~ west 16'

2:00 Leave site w/ Ed, Dave  
Jeff for San Ramon

3:00 Leave from San Ramon to Sequoia

4:45 Leave Sequoia

11/17/91 Thursday

6:20 Arrive @ site - Jim of  
B-R here. #1 Conrad  
truck loaded by 7:00.

8:00 #5 Conrad truck loaded  
- All with US-13 (sand) & US-10  
excavator is backfilled & stopped  
on west end - ready for  
new UST's

9:35 Truck #10 out - all  
Class III material in big pile  
gone → US-10, 11, 13. 180 yds<sup>3</sup>

WO exc is back filled.  
Loads #7-10 are sticking in  
trucks. May have to dumper.  
DV calls - no more excavating @

San Ramon.

11:35 Load #15 out

12:00 - 1 Lunch

Move US-3 to North side

3:00 leave site ~ 100 yds<sup>3</sup> of

Class II left - ~20 US-3

25 trucks out - 10 to Class III  
Excavation backfilled to 14 ft  
with #2 conductor casing ~14'  
East of NW corner of excavation.

Jim Reed - Gettler-Ryan

11/28/94  
10:30

Monday

Arrive @ site - UST's  
are set & being plumbed.  
~ 60-80 yds<sup>3</sup> of soil left  
on site. East of dispenser  
islands in 2 piles. SE  
excavation is open. No  
digging equipment on-site.  
O/W separator buried by  
new slab. NE trench  
excavation backfilled.

Measure lot - make mega-  
changes to map. Jim Reed  
arrives - he says the pile of  
soil closest to the islands is  
the leftover Class II from the  
SE exc & cleanup (~30-40 yds<sup>3</sup>).  
They had to widen the  
main exc ~ 2' North  
to get the new UST's in.  
This generated ~ 15-25 yds<sup>3</sup>  
of new material - east of Class II

12:20 Leave site after calling  
DV.

11/30/94 Wednesday

9:30 Arrive @ site late -  
TE & G-R are ready to go.  
I had stopped @ 2900 N Main  
Shell to pick up cones - truck  
broke down & I called AAA -  
lost ~ 20 minutes. Then stopped  
by # 6578 San Ramon & dropped  
off well plug - Baker tank is  
clean & dry. Dillard was  
hauling off soil. Drive  
to site.

Widen SE dispenser excavation  
to North & East ~ 5'.  
SE corner of hole is ~ 10'  
from NW corner of main  
excavation. → Stinky stuff  
Old steel product lines running from  
UST Exc to SE trench exc  
are full of product - catch  
~ 8 gallons in buckets - steel  
was mated to fiberglass in NE  
corner of SE trench excavation  
Looks like 3 generations of  
product lines - #1 is steel in H  
shape.

Final excavation 12E-W x  
14' N-S x 20 fbg

- 10:05 Eva Chu arrives  
10:20 Collect UT-7 @ 19.5' fbg  
Stink bottom of exc  
10:25 Collect UT-8 @ 12' fbg  
Center of east wall.  
10:35 Collect UT-9 @ 8' fbg  
on center of west wall.  
10:40 Collect UT-10 @ 8' fbg  
on center of South wall.  
11:00 Collect UT-11 @ 11' fbg.  
on bottom corner of  
North wall (dogleg)  
11:15 Eva leaves

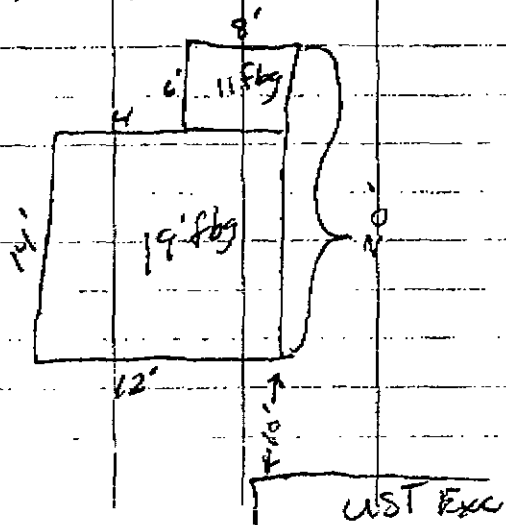

There is ~ 100-140 yds of soil from the SE excavation & scraps left on-site. The NE dispenser excavation has not been reexcavated & backfilled - so more potential Class II will be generated ~ 20 yds of soil from UST excavation stretching is piled in SE corner of site. Overexcavation (Class II?) soil is near intersection.

~ 6" will be removed from beneath the canopy & stockpiled along the west fence. The fuel found in the steel pipes will be put into a drum by G.R. Enviro/Unocal will have to handle it. NE excavation being redug as I leave - call DV & fill him in on voice mail.

12:15 Leave site for Sequoia

40890 - 40958  
41075

12-6-94 Tuesday

9:45 Arrived @ site after stopping  
@ Enviro Tech to swap bails.  
~ 150-200 yds. of hot material  
in NE corner - ~ 40 yds of  
trunk material along west fence  
& 2-10yd piles (west & <sup>east</sup> center)  
along south fence. One 10yd  
pile that may be hot is <sup>center</sup> east  
pile along south fence

10:30 Collect US-14A-D ~ 150  
yds<sup>3</sup> - tall part of hot  
stockpile along NE corner

10:50 Collect US-15A-D ~ 50 yds  
hot material, east of US-14  
& center pile along S fence

11:10 Collect US-16A-D ~ 70 yds<sup>3</sup>  
from along west fence &  
end piles along south fence -

~ 20-30 more will be generated - more grading.

11:10 Dave Byron arrives - says  
he billed Unocal ~ 578 (?) yds<sup>3</sup>  
of overex total. He leaves  
after I tell him to set up  
for Friday haul

11:30 Leave for Burlington after  
photos.