

Rs-477



**Chevron**

**Chevron Products Company**  
6001 Bollinger Canyon Rd, Bldg L  
PO Box 5004  
San Ramon, CA 94583-0804

May 28, 1997

Ms. Eva Chu  
Alameda County Environmental Health  
1131 Harbor Bay Parkway, 2nd Floor  
Alameda, California 94502

**Site Assessment & Remediation**  
Phone (510) 842-9500  
Fax (510) 842-8370

Re: Chevron Service Station #9-1924  
4904 Southfront Rd, Livermore CA

*Sampling was reduced -  
MBC still > 1000 ppb*

*4/10/97 Do one analysis for Pb -  
During tripping mod. all SS w/  
60-80ppm Pb.*

Dear Ms. Chu,

Please find attached the "2nd Quarter 1997 Monitoring at 9-1924" report dated May 21st, 1997. This report was prepared for Chevron by Blaine Tech Services Inc. and provides the results of the sampling event performed on April 10th, 1997.

The groundwater samples collected by Blaine Tech Services were analyzed for the presence of TPHG and BTEX constituents. The results obtained during this sampling event were consistent with historical data seen from previous sampling events for this site.

Thank-you, Chevron has received your letter dated January 6th, 1997 which permits the sampling reduction at this location. We have requested Blaine Tech Services to implement the new schedule as indicated in your letter. As of January 1st 1997 I now over see monitoring activities at this location and if you have any questions or I can provide any assistance with information regarding this site please call me. I can be reached by phone at (510) 842-9449 or by fax at (510) 842-8370.

Sincerely,

Tammy L Hodge  
Groundwater Coordinator  
Site Assessment and Remediation

01 JUN 03 1997  
RECEIVED  
ENVIRONMENTAL HEALTH  
DIVISION

cc:

- \* Mr. Gary Stumpf, Mobil Oil  
3225 Gallows Rd. Room 6W116, Fairfax Virginia 22037
- \* Mr. Scott Hooten, BP Oil NorthWest Div.,  
295 Southwest 41st St. Renton WA 98055
- \* Mr. Larry Silva, Tosco NW  
601 Union St. Suite 2500 Seattle WA 98101
- \* Mr. Eddy So, RQWCB-Bay Region  
2101 Webster St. Suite 500 Oakland, CA 94612
- \* Chevron File 9-1924



**BLAINE**  
TECH SERVICES INC.



1680 ROGERS AVENUE  
SAN JOSE, CALIFORNIA 95112  
(408) 573-7771 FAX  
(408) 573-0555 PHONE

May 21, 1997

Tammy Hodge  
Chevron U.S.A. Products Company  
P.O. Box 6004  
San Ramon, CA 94583-0904

### 2nd Quarter 1997 Monitoring at 9-1924

Second Quarter 1997 Groundwater Monitoring at  
Chevron Service Station Number 9-1924  
4904 Southfront Road  
Livermore, CA

Monitoring Performed on April 10, 1997

---

### Groundwater Sampling Report 970410-Z-1

This report covers the routine quarterly monitoring of groundwater wells at this Chevron facility. Blaine Tech Services, Inc.'s work at the site includes inspection, gauging, evacuation, purgewater containment, sample collection and sample handling in accordance with standard procedures that conform to Regional Water Quality Control Board requirements.

Routine field data collection includes depth to water, total well depth, thickness of any separate immiscible layer, water column volume, calculated volume of a three-case volume purge, elapsed evacuation time, total volume of water removed, and standard water parameter instrument readings. Sample material is collected, contained, stored, and transported to the laboratory in conformance with EPA standards. Purgewater is, likewise, collected and transported to McKittrick Waste Treatment Site for disposal.

Basic field information is presented alongside analytical values excerpted from the laboratory report in the cumulative table of **WELL DATA AND ANALYTICAL RESULTS**. The full analytical report for the most recent samples is located in the **Analytical Appendix**. The table

also contains new groundwater elevation calculations taken from the computer plotted gradient map which is located in the **Professional Engineering Appendix**.

At a minimum, Blaine Tech Services, Inc. field personnel are certified upon completion of a forty-hour Hazardous Materials and Emergency Response training course per 29 CFR 1910.120. Field personnel are also enrolled in annual eight hour refresher courses.

Blaine Tech Services, Inc. conducts sampling and documentation assignments of this type as an independent third party. In order to avoid compromising the objectivity necessary for the proper and disinterested performance of this work, Blaine Tech Services, Inc. concentrates on objective data collection and does not participate in the interpretation of analytical results, the definition of geological or hydrological conditions, the formulation of recommendations, or the marketing of remedial systems.

Please call if you have any questions.

Yours truly,

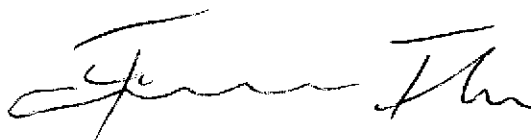
A handwritten signature in black ink, appearing to read "Francis Thie", written in a cursive style.





Francis Thie  
Vice President

FPT/cg

attachments: Professional Engineering Appendix  
Cumulative Table of Well Data and Analytical Results  
Analytical Appendix  
Field Data Sheets

# **Professional Engineering Appendix**

**EXPLANATION**

-  C-2 CHEVRON MONITORING WELL LOCATION AND WELL NUMBER
-  MW-5 UNOCAL MONITORING WELL LOCATION AND WELL NUMBER
- 508.49 GROUND-WATER ELEVATION IN FEET ABOVE MEAN SEA LEVEL
- NA DATA NOT AVAILABLE
-  507.0 GROUND-WATER ELEVATION CONTOUR IN FEET ABOVE MEAN SEA LEVEL
-  0.01 APPROXIMATE DIRECTION OF GROUND-WATER FLOW. GRADIENT INDICATED IN FEET / FEET

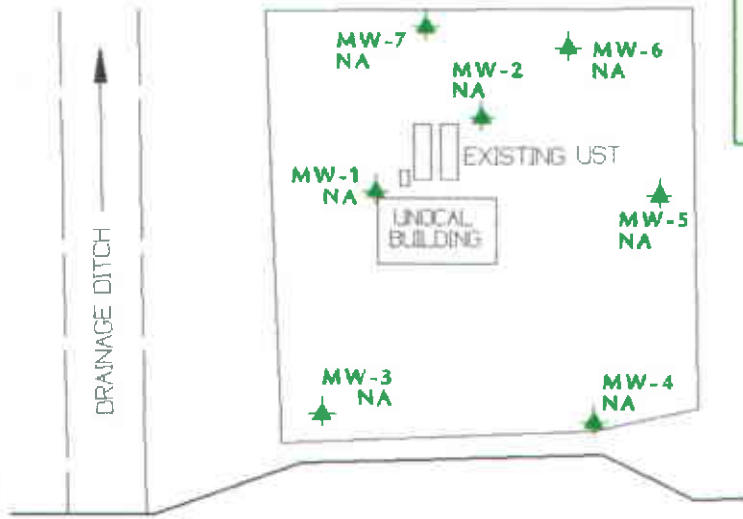

FIRST STREET

FIRST STREET

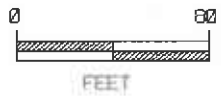
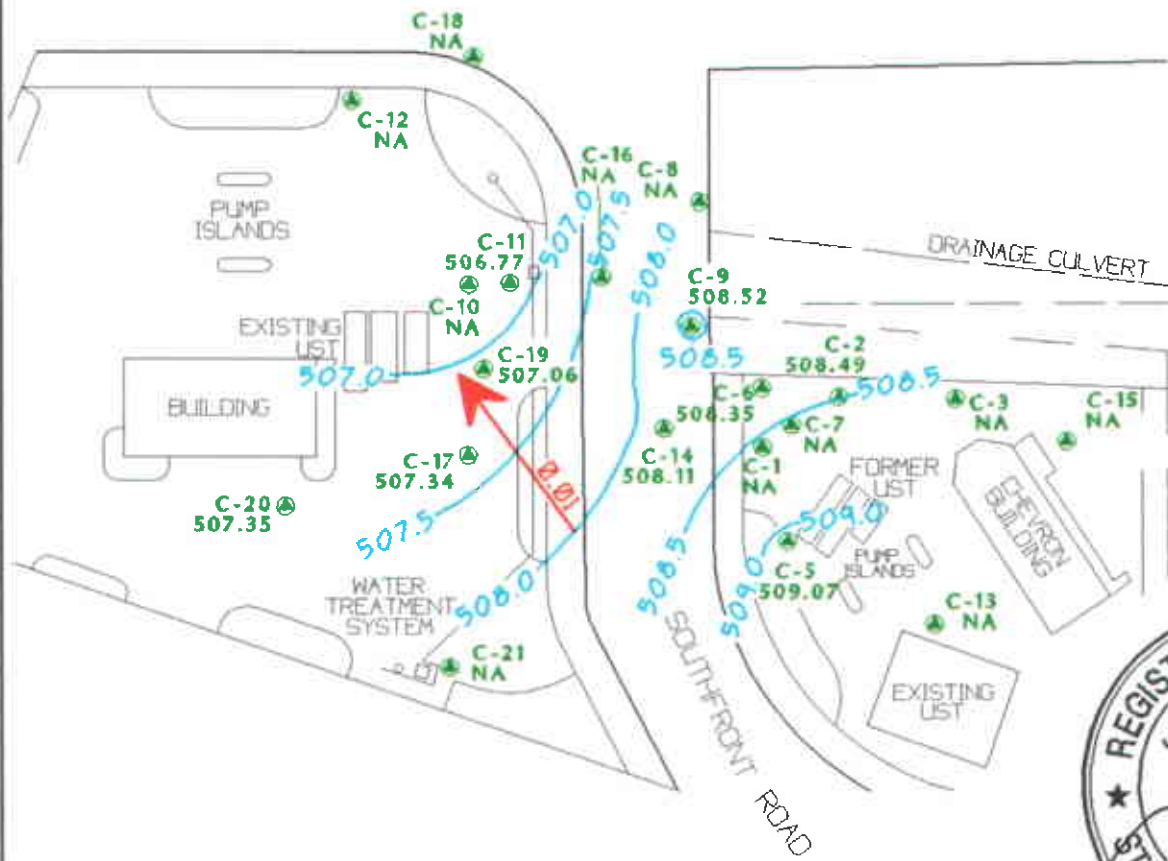





TITLE : GROUND-WATER ELEVATION CONTOUR MAP - APRIL 10, 1997  
 LOCATION : CHEVRON SERVICE STATION No.: 9-1924 4904 SOUTHFRONT ROAD, LIVERMORE, CALIFORNIA  
 SOURCE : CAMBRIA ENVIRONMENTAL TECHNOLOGY, INC



GEOCONSULTANTS, INC  
 SAN JOSE, CALIFORNIA  
 Project No. G758-00  
DRAWING NO. CHEVRON-CHESS4-148227

**EXPLANATION**

-  **C-2** CHEVRON MONITORING WELL LOCATION AND WELL NUMBER
-  **MW-5** UNOCAL MONITORING WELL LOCATION AND WELL NUMBER
- 508.49** GROUND-WATER ELEVATION IN FEET ABOVE MEAN SEA LEVEL
- NA** DATA NOT AVAILABLE
-  **507.0** GROUND-WATER ELEVATION CONTOUR IN FEET ABOVE MEAN SEA LEVEL
-  **0.01** APPROXIMATE DIRECTION OF GROUND-WATER FLOW. GRADIENT INDICATED IN FEET / FEET

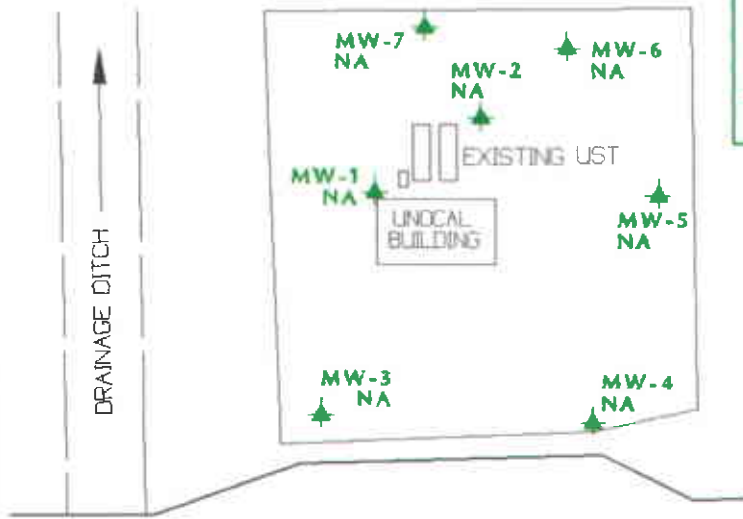

FIRST STREET

FIRST STREET

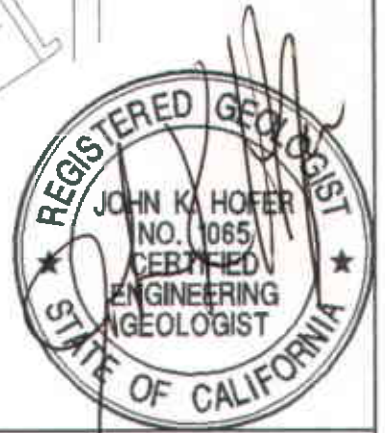
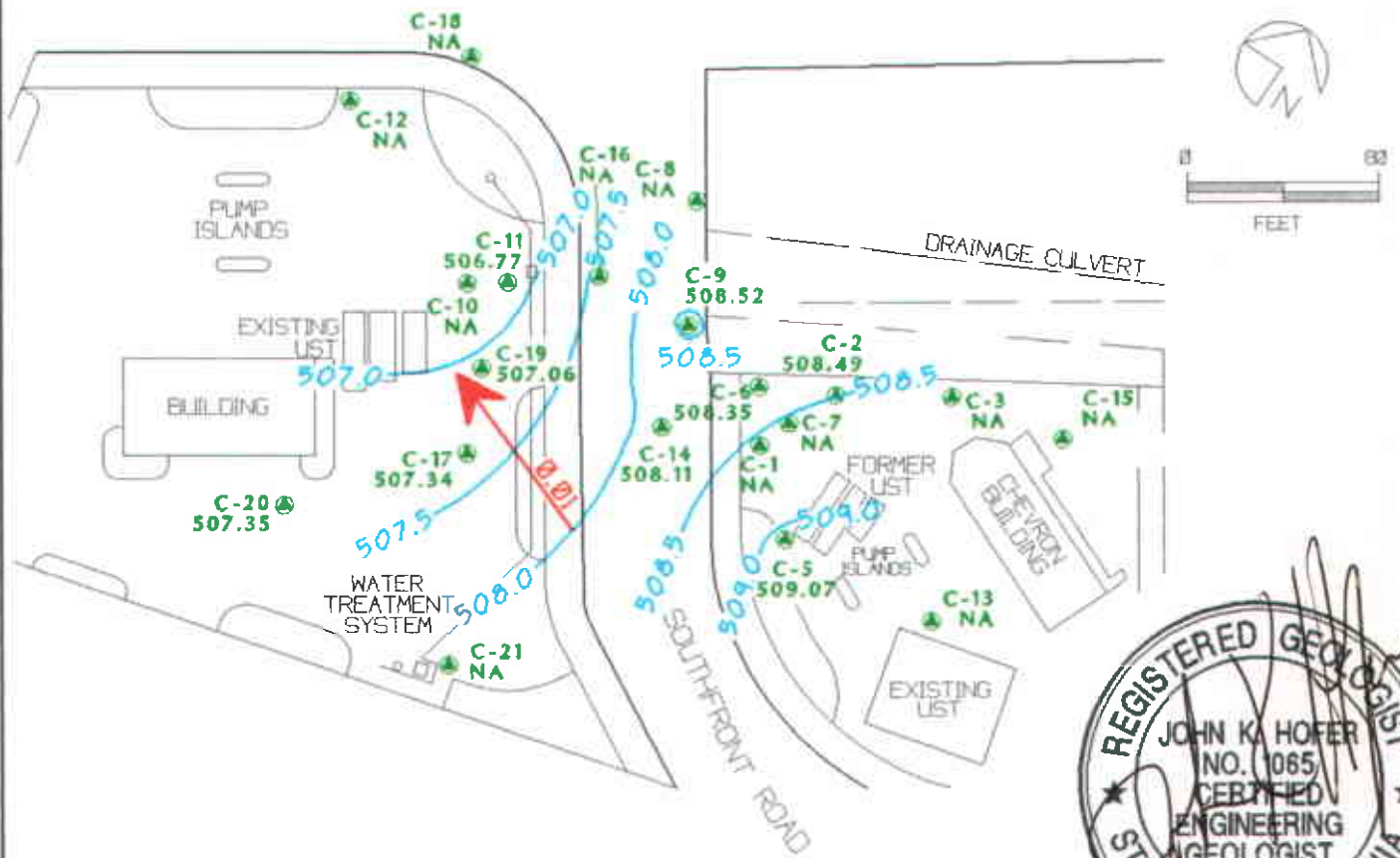

TITLE : GROUND-WATER ELEVATION CONTOUR MAP - APRIL 10, 1997  
 LOCATION : CHEVRON SERVICE STATION No.: 9-1924 4904 SOUTHFRONT ROAD, LIVERMORE, CALIFORNIA  
 SOURCE : CAMBRIA ENVIRONMENTAL TECHNOLOGY, INC.



**GEOCONSULTANTS, INC**  
 SAN JOSE, CALIFORNIA  
 Project No. 0750-09  
© 1998 GEOCONSULTANTS, INC. CHEVRON/CHESS/UNOCAL

**EXPLANATION**

- C-6 CHEVRON MONITORING WELL LOCATION AND WELL NUMBER
- ▲ MW-5 UNOCAL MONITORING WELL LOCATION AND WELL NUMBER
- 1300 TPH AS GASOLINE CONCENTRATION IN ug / L
- NA DATA NOT AVAILABLE
- 1150 TPH AS GASOLINE CONCENTRATION CONTOUR LINE IN ug / L

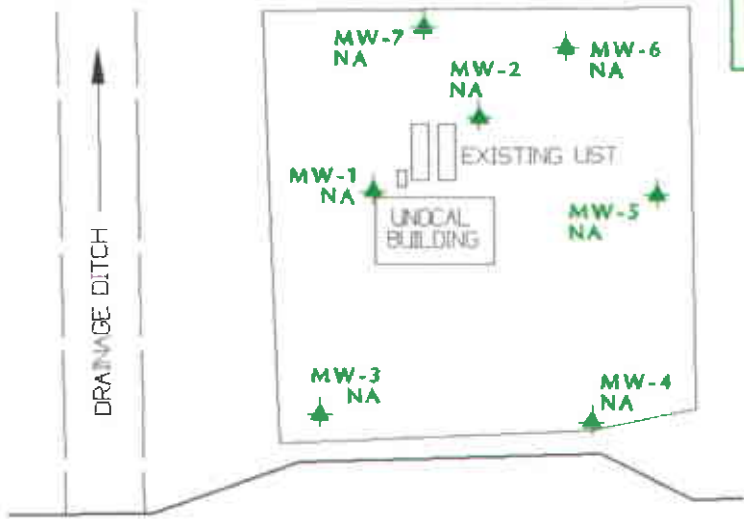

FIRST STREET

FIRST STREET

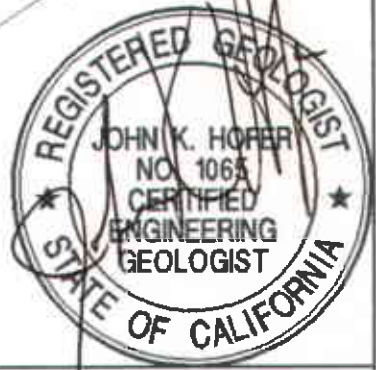
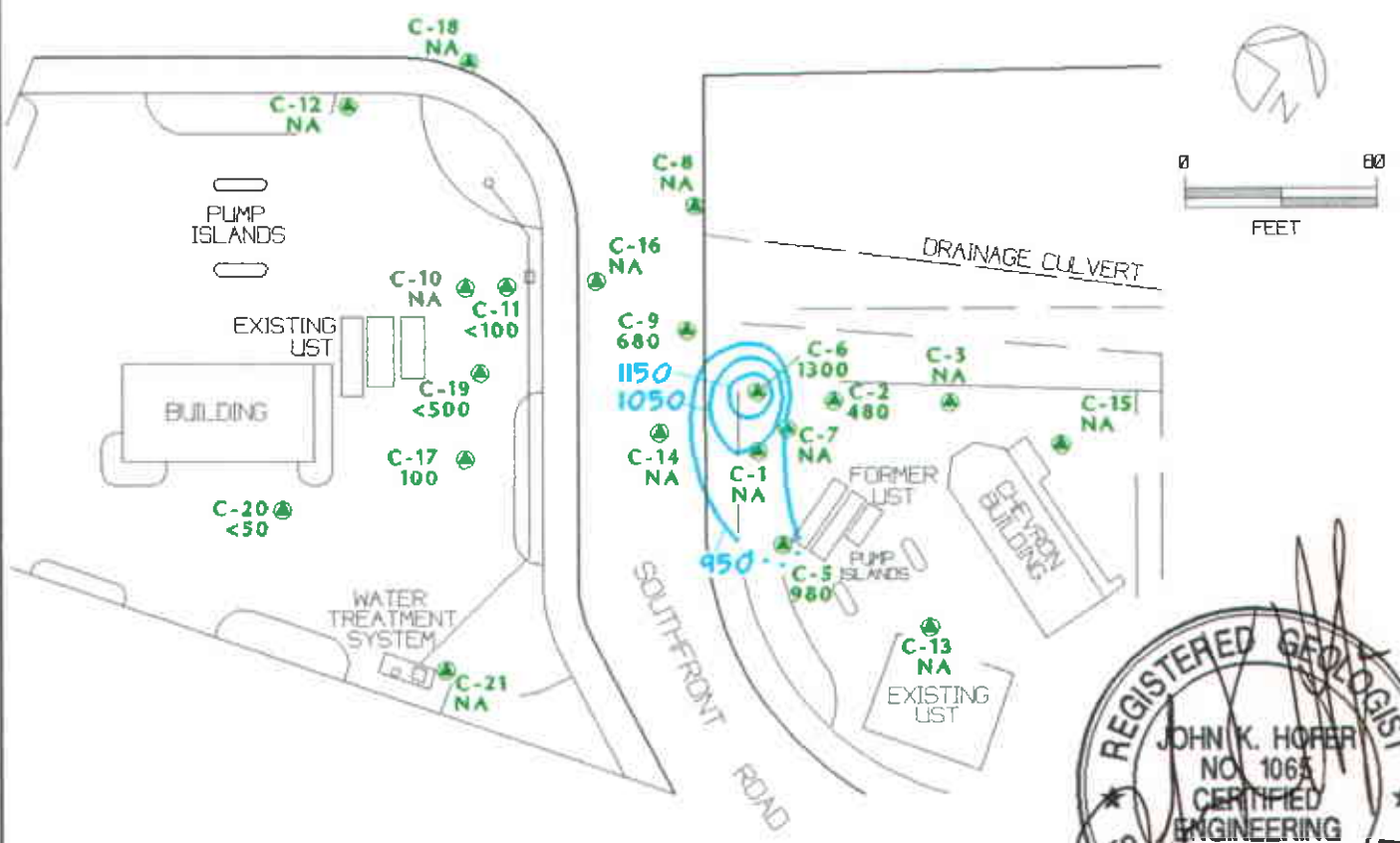

TITLE : TPH AS GASOLINE ISOCONCENTRATION MAP - APRIL 10, 1997  
 LOCATION : CHEVRON SERVICE STATION No: 9-1924 4904 SOUTHFRONT ROAD, LIVERMORE, CALIFORNIA  
 SOURCE : CAMBRIA ENVIRONMENTAL TECHNOLOGY, INC.

**GEOCONSULTANTS, INC**  
 SAN JOSE, CALIFORNIA  
 Project No. G758-09  
 DRAWING NO. CHEVRON-F00224-TM002P

**EXPLANATION**

- ⊙ C-6 CHEVRON MONITORING WELL LOCATION AND WELL NUMBER
- ▲ MW-5 UNOCAL MONITORING WELL LOCATION AND WELL NUMBER
- 1300 TPH AS GASOLINE CONCENTRATION IN ug / L
- NA DATA NOT AVAILABLE
- 1150 TPH AS GASOLINE CONCENTRATION CONTOUR LINE IN ug / L

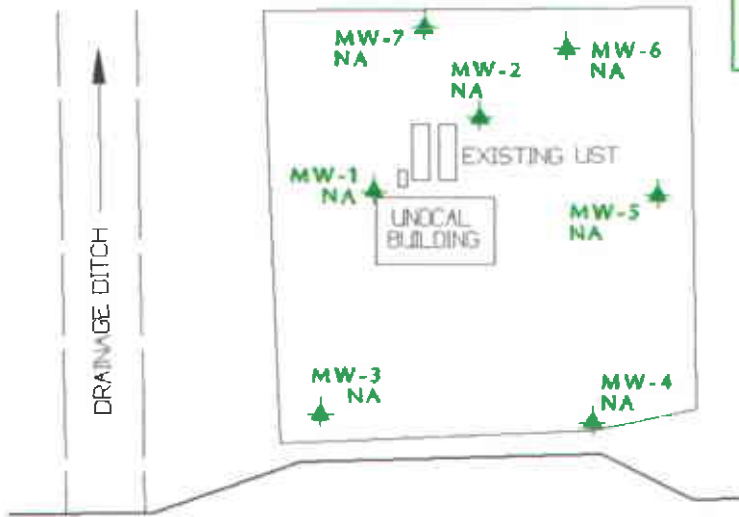

FIRST STREET

FIRST STREET

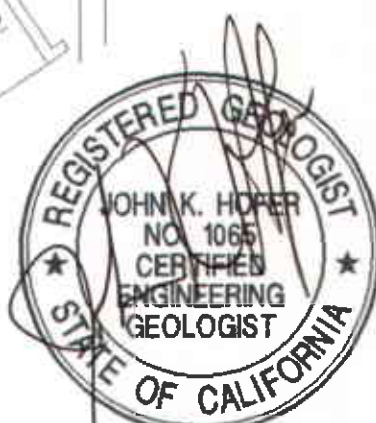
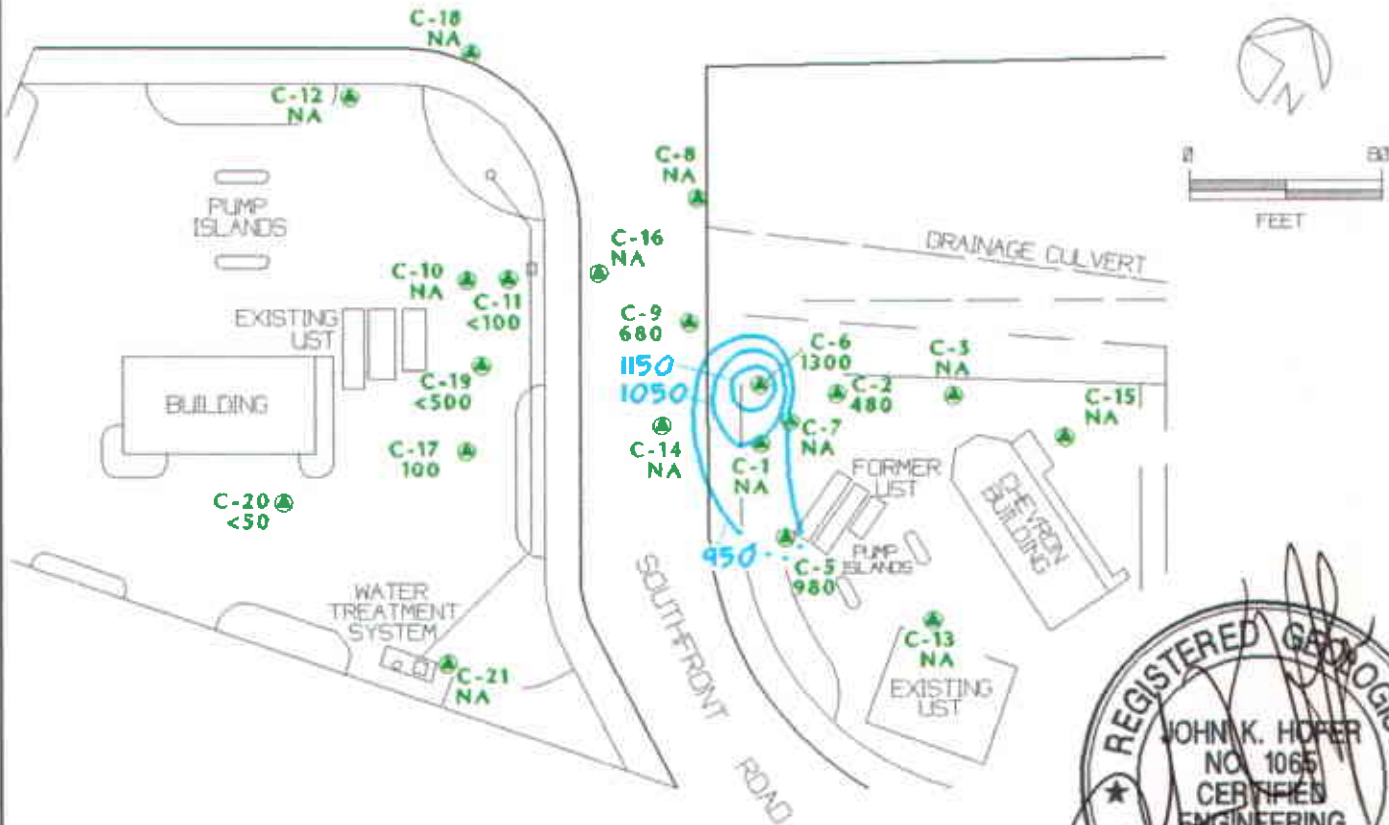

TITLE : TPH AS GASOLINE ISOCONCENTRATION MAP - APRIL 10, 1997  
 LOCATION : CHEVRON SERVICE STATION No. 9-1924 4904 SOUTHFRONT ROAD, LIVERMORE, CALIFORNIA  
 SOURCE : CAMBRIA ENVIRONMENTAL TECHNOLOGY, INC.



GEOCONSULTANTS, INC  
 SAN JOSE, CALIFORNIA  
 Project No. Q758-09  
 DRAWING NO. CHEVRON-08524-TM-0007



**EXPLANATION**

- C-5 CHEVRON MONITORING WELL LOCATION AND WELL NUMBER
- ▲ MW-5 UNOCAL MONITORING WELL LOCATION AND WELL NUMBER
- 12 BENZENE CONCENTRATION IN  $\mu\text{g} / \text{L}$
- NA DATA NOT AVAILABLE
- 10 BENZENE CONCENTRATION CONTOUR LINE IN  $\mu\text{g} / \text{L}$

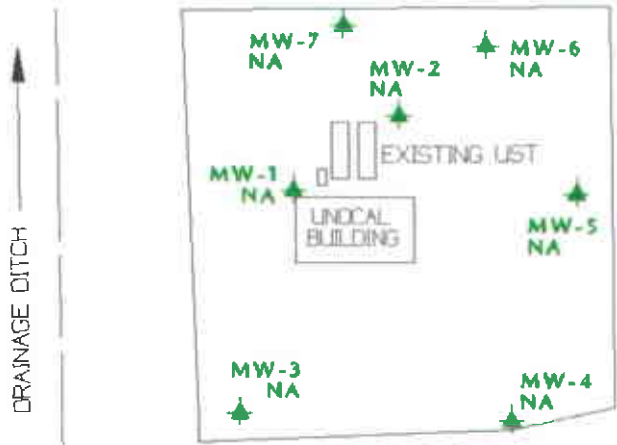

**FIRST STREET**

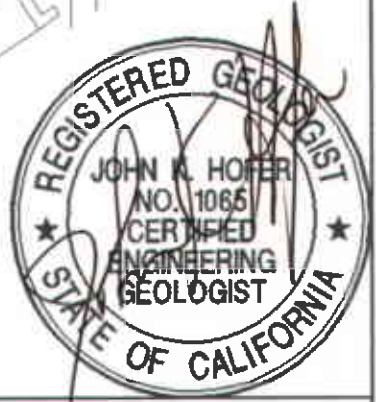
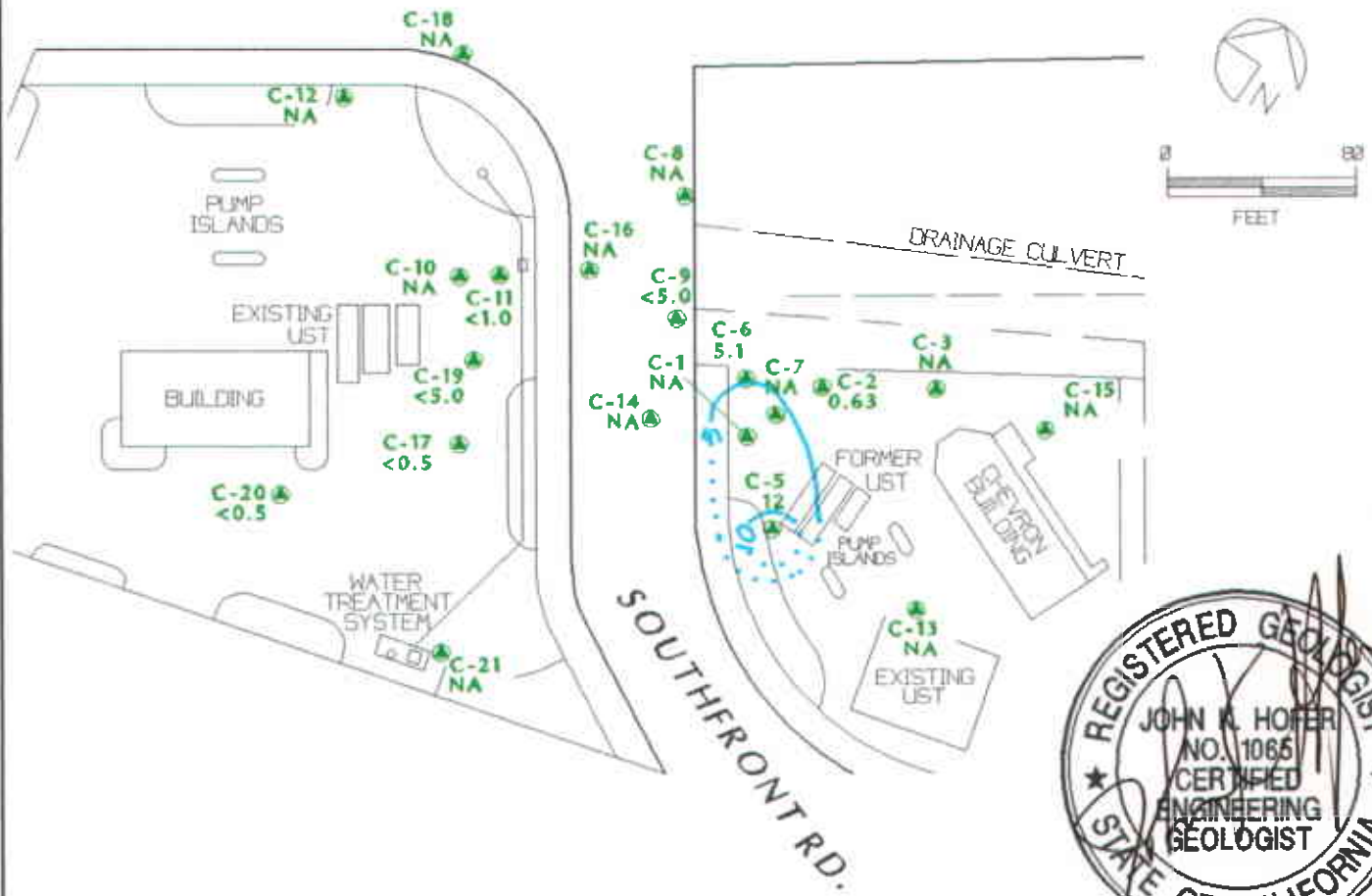

TITLE : BENZENE ISOCONCENTRATION MAP - APRIL 10, 1997  
 LOCATION : CHEVRON SERVICE STATION No.: 9-1924 4904 SOUTHERNFRONT ROAD, LIVERMORE, CALIFORNIA  
 SOURCE : CAMBRIA ENVIRONMENTAL TECHNOLOGY, INC.



**GEOCONSULTANTS, INC**  
 SAN JOSE, CALIFORNIA  
 Project No. G758-09  
Drawing No. CHEVRON-D49324-58425F

**EXPLANATION**

- ⊙ C-5 CHEVRON MONITORING WELL LOCATION AND WELL NUMBER
- ▲ MW-5 UNOCAL MONITORING WELL LOCATION AND WELL NUMBER
- 12 BENZENE CONCENTRATION IN  $\mu\text{g} / \text{L}$
- NA DATA NOT AVAILABLE
- 10 BENZENE CONCENTRATION CONTOUR LINE IN  $\mu\text{g} / \text{L}$

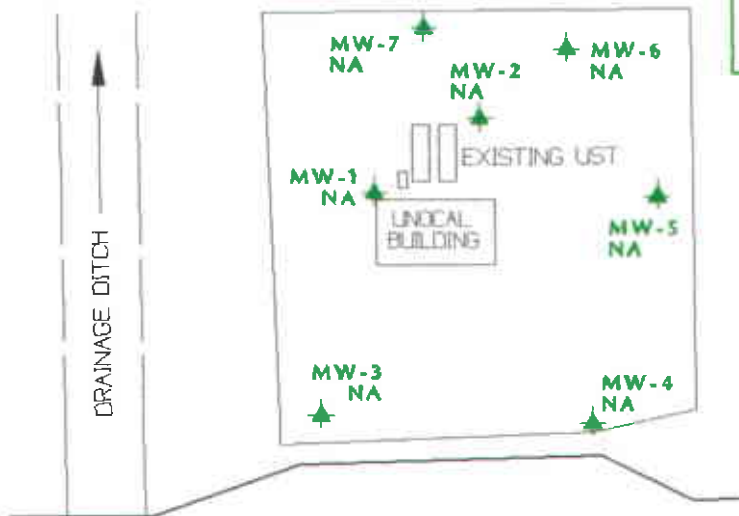

**FIRST STREET**

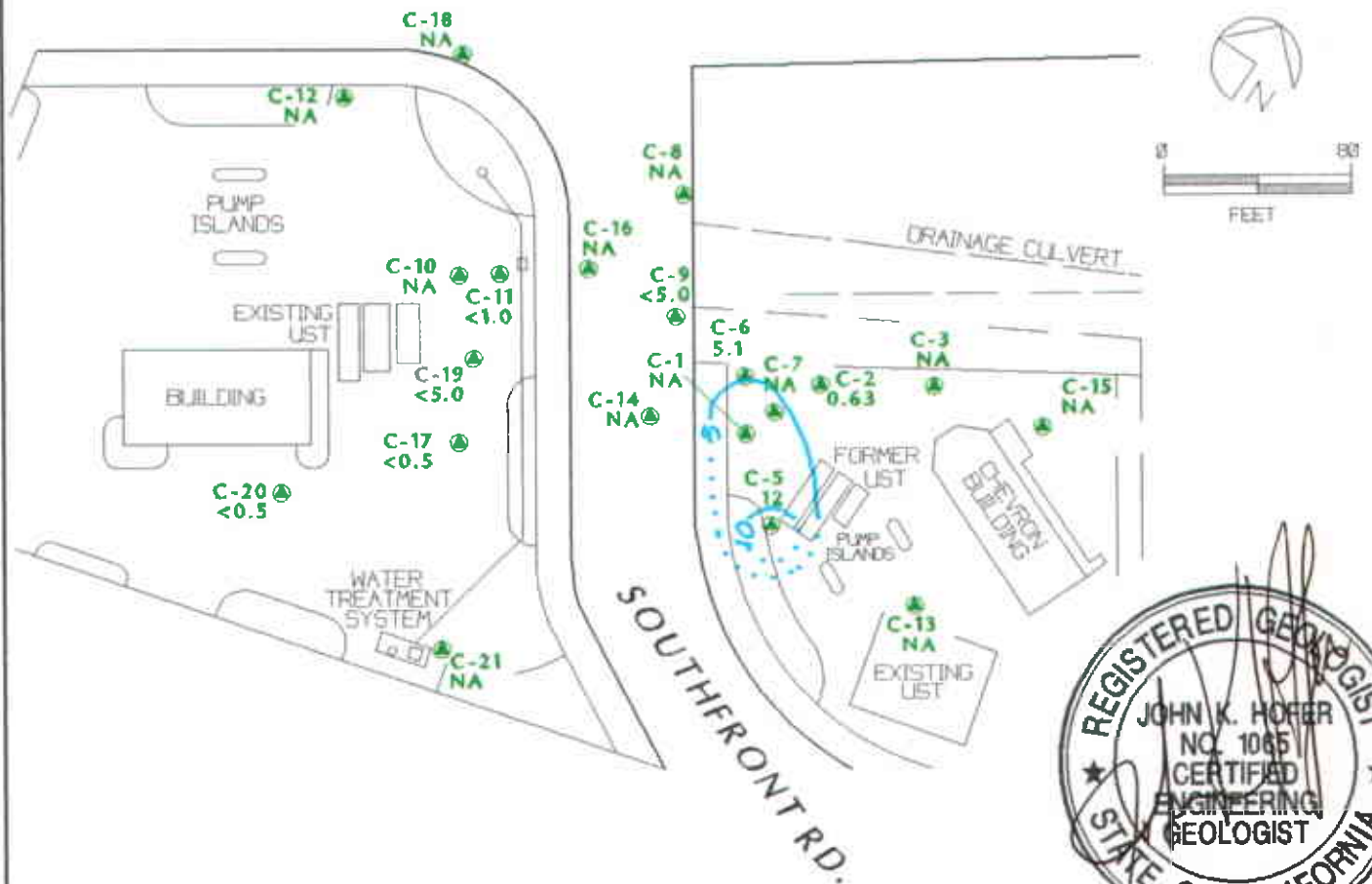

TITLE : BENZENE ISOCONCENTRATION MAP - APRIL 10, 1997  
 LOCATION : CHEVRON SERVICE STATION No. 9-1924 4904 SOUTHRONT ROAD LIVERMORE, CALIFORNIA  
 SOURCE : CAMBRIA ENVIRONMENTAL TECHNOLOGY, INC



GEOCONSULTANTS, INC  
 SAN JOSE, CALIFORNIA  
 Project No. Q758-09

DRAWING NO.: CHEVRON-0858-01-0100

# **Table of Well Data and Analytical Results**

## Cumulative Table of Well Data and Analytical Results

Vertical Measurements are in feet.

Analytical results are in parts per billion (ppb)

DATE	Well Head Elev.	Ground Water Elev.	Depth To Water	Notes	TPH- Gasoline	Benzene	Toluene	Ethyl- Benzene	Xylene	MTBE	TOG	1,2- DCA	VC	MC 1,1,1- TCA	1,1- DCA	PCE	Total Lead	CDS	
<b>C-1</b>																			
03/28/86	520.39	508.64	11.75	--	--	--	--	--	--	--	--	--	--	--	--	--	--	--	--
03/15/88	520.39	506.89	13.50	--	27,000	770	87	610	2100	--	--	--	--	--	--	--	--	--	--
05/10/88	520.39	506.74	13.65	--	--	--	--	--	--	--	--	--	--	--	--	--	--	--	--
06/10/88	520.39	505.67	14.72	--	--	--	--	--	--	--	--	--	--	--	--	--	--	--	--
07/25/88	520.39	506.89	13.50	--	--	--	--	--	--	--	--	--	--	--	--	--	--	--	--
10/13/88	520.39	507.50	12.89	--	3200	220	11	62	130	--	--	--	--	--	--	--	--	--	--
01/01/89	520.39	507.50	12.89	--	--	--	--	--	--	--	--	--	--	--	--	--	--	--	--
01/12/89	520.39	--	--	--	4000	820	43	490	260	--	--	--	--	--	--	--	--	--	--
04/10/89	520.39	506.74	13.65	--	4000	100	ND	70	50	--	ND	ND	--	--	--	--	--	--	--
04/10/89	520.39	506.74	13.65	--	4000	100	ND	60	50	--	--	ND	--	--	--	--	--	--	--
06/26/89	520.39	506.45	13.94	--	600	97	20	60	50	--	ND	3.0	--	--	--	--	--	--	--
06/26/89	520.39	506.45	13.94	--	570	86	15	44	35	--	--	1.7	--	--	--	--	--	--	--
10/13/89	520.39	506.47	13.92	--	1600	64	ND	51	48	--	ND	ND	--	--	--	--	--	--	5.0
01/03/90	520.39	506.59	13.80	--	1100	36	0.68	30	30	--	--	1.0	--	--	--	--	--	--	--
05/08/90	520.39	506.48	13.91	--	1300	37	9.2	40	32	--	--	1.2	--	ND	--	ND	--	--	--
09/29/90	520.39	506.46	13.93	--	350	19	1.2	32	31	--	--	ND	--	0.7	1.4	ND	--	--	--
01/03/91	520.39	506.54	13.85	--	400	12	ND	17	14	--	--	ND	--	ND	ND	ND	ND	--	--
04/12/91	520.39	506.88	13.51	--	--	--	--	--	--	--	--	--	--	--	--	--	--	--	--
09/04/91	520.39	506.29	14.10	--	--	--	--	--	--	--	--	--	--	--	--	--	--	--	--
04/06/92	520.39	507.33	13.06	--	1000	12	0.8	31	31	--	--	ND	--	ND	ND	ND	ND	--	--
07/28/92	520.39	506.46	13.93	--	4200	47	110	96	260	--	--	--	--	--	--	--	--	--	--
10/16/92	520.39	505.94	14.45	--	1800	11	ND	32	55	--	--	--	--	--	--	--	--	--	--
01/14/93	520.39	509.16	11.23	--	2000	24	ND	98	62	--	--	--	--	--	--	--	--	--	--
03/26/93	520.39	509.45	10.94	--	4400	21	12	120	100	--	--	--	--	--	--	--	--	--	--
04/22/93	520.39	504.14	16.25	Sheen	18000	26	44	580	330	--	--	--	--	--	--	--	--	--	--
07/20,21/93	520.39	505.10	15.29	--	7100	73	11	470	470	--	--	--	--	--	--	--	--	--	--
10/20/93	520.39	506.89	13.50	--	880	19	26	260	190	--	--	--	--	--	--	--	--	--	--
01/20/94	520.39	507.13	13.26	--	2900	13	10	130	60	--	--	--	--	--	--	--	--	--	--
04/21/94	520.39	506.93	13.46	--	1400	8.8	7.8	82	34	--	--	--	--	--	--	--	--	--	--
07/21,22/94	520.39	506.93	13.46	--	800	4.7	2.7	34	13	--	--	--	--	--	--	--	--	ND	--
01/18/95	520.39	508.67	11.72	--	2000	18	10	130	10	--	--	--	--	--	--	--	--	--	--
04/17/95	520.39	508.58	11.81	--	2500	13	1.9	33	4.3	--	--	--	--	--	--	--	--	--	--
07/18/95	520.39	508.27	12.12	--	1100	<10	<10	27	<10	--	--	--	--	--	--	--	--	--	--
10/17/95	520.39	507.81	12.58	--	2000	13	<5.0	24	<5.0	6400	--	--	--	--	--	--	--	--	--
01/18/96	520.39	509.07	11.32	--	<2000	35	30	<20	23	6600	--	--	--	--	--	--	--	--	--
04/17/96	520.39	509.52	10.87	--	<1000	31	<10	<10	<10	<50	--	--	--	--	--	--	--	--	--
07/16/96	520.39	509.01	11.38	--	830	15	<5.0	13	<5.0	9000	--	--	--	--	--	--	--	--	--
10/16/96	520.39	508.58	11.81	--	<5000	<50	<50	<50	<50	6300	--	--	--	--	--	--	--	--	--

NO LONGER MONITORED OR SAMPLED

### Cumulative Table of Well Data and Analytical Results

Vertical Measurements are in feet.

Analytical results are in parts per billion (ppb)

DATE	Well Head Elev.	Ground Water Elev.	Depth To Water	Notes	TPH- Gasoline	Benzene	Toluene	Ethyl- Benzene	Xylene	MTBE	TOG	1,2- DCA	VC	MC 1,1,1- TCA	1,1- DCA	PCE	Total Lead	CDS	
<b>C-2</b>																			
03/28/86	520.76	508.78	11.98	--	--	--	--	--	--	--	--	--	--	--	--	--	--	--	--
03/15/88	520.76	506.99	13.77	--	22,000	3900	1900	1200	1200	--	--	--	--	--	--	--	--	--	--
05/10/88	520.76	506.73	14.03	--	--	--	--	--	--	--	--	--	--	--	--	--	--	--	--
06/10/88	520.76	505.64	15.12	--	--	--	--	--	--	--	--	--	--	--	--	--	--	--	--
07/25/88	520.76	506.90	13.86	--	--	--	--	--	--	--	--	--	--	--	--	--	--	--	--
10/13/88	520.76	506.65	14.11	--	ND	ND	ND	ND	ND	--	--	--	--	--	--	--	--	--	--
01/01/89	520.76	507.93	12.83	--	--	--	--	--	--	--	--	--	--	--	--	--	--	--	--
01/12/89	520.76	--	--	--	1000	25	3.0	83	59	--	--	--	--	--	--	--	--	--	--
04/10/89	520.76	506.72	14.04	--	600	2.5	ND	15	12	--	ND	ND	--	--	--	--	--	--	--
04/10/89	520.76	506.72	14.04	--	ND	ND	ND	11	11	--	--	ND	--	--	--	--	--	--	--
06/26/89	520.76	506.42	14.34	--	640	5.3	8.0	18	14	--	ND	ND	--	--	--	--	--	--	--
06/26/89	520.76	506.42	14.34	--	750	3.7	0.6	13	8.2	--	--	2.0	--	--	--	--	--	--	--
10/13/89	520.76	506.84	13.92	--	630	ND	ND	17	10	--	--	ND	--	--	--	--	--	--	--
01/03/90	520.76	506.65	14.11	--	880	3	ND	19	17	--	--	1.0	--	--	--	--	--	--	--
05/08/90	520.76	506.48	14.28	--	340	1.3	2.7	8.4	11	--	--	1.1	--	ND	--	ND	--	--	--
09/29/90	520.76	506.51	14.25	--	74	ND	ND	4.6	1.8	--	--	ND	--	1.7	0.5	ND	--	--	--
01/03/91	520.76	506.61	14.15	--	2000	270	ND	79	93	--	--	ND	--	ND	ND	ND	ND	--	--
04/12/91	520.76	506.90	13.86	--	--	--	--	--	--	--	--	--	--	--	--	--	--	--	--
09/04/91	520.76	506.26	14.50	--	--	--	--	--	--	--	--	--	--	--	--	--	--	--	--
04/06/92	520.76	507.29	13.47	--	1200	ND	ND	54	6.1	--	--	ND	--	ND	ND	ND	ND	--	--
07/28/92	520.76	506.41	14.35	--	1000	5.2	2.9	26	16	--	--	--	--	--	--	--	--	--	--
10/16/92	520.76	505.92	14.84	--	2000	ND	2.2	20	10	--	--	--	--	--	--	--	--	--	--
01/14/93	520.76	509.54	11.22	--	1800	49	50	31	29	--	--	--	--	--	--	--	--	--	--
03/26/93	520.76	509.99	10.77	--	820	15	12	14	6.0	--	--	--	--	--	--	--	--	--	--
04/22/93	520.76	507.83	12.93	--	2000	12	12	28	29	--	--	--	--	--	--	--	--	--	--
07/20,21/93	520.76	504.74	16.02	--	1100	28	8.0	4.0	4.0	--	--	--	--	--	--	--	--	--	--
10/20/93	520.76	506.92	13.84	--	1600	140	18	22	27	--	--	--	--	--	--	--	--	--	--
01/20/94	520.76	507.16	13.60	--	760	36	3.0	7.0	3.0	--	--	--	--	--	--	--	--	--	--
04/21/94	520.76	506.66	14.10	--	430	23	2.8	6.8	6.8	--	--	--	--	--	--	--	--	--	--
07/21,22/94	520.76	506.93	13.83	--	1200	10	2.8	5.2	5.3	--	--	--	--	--	--	--	--	ND	--
01/18/95	520.76	508.94	11.82	--	640	1.0	<0.5	5.7	7.7	--	--	--	--	--	--	--	--	--	--
04/17/95	520.76	508.72	12.04	--	<50	<0.5	<0.5	<0.5	<0.5	--	--	--	--	--	--	--	--	--	--
07/18/95	520.76	508.34	12.42	--	81	<0.5	<0.5	<0.5	<0.5	--	--	--	--	--	--	--	--	--	--
10/17/95	520.76	507.97	12.79	--	390	<0.5	<0.5	1.2	1.2	14	--	--	--	--	--	--	--	--	--
01/18/96	520.76	509.18	11.58	--	<50	<0.5	<0.5	<0.5	<0.5	<2.5	--	--	--	--	--	--	--	--	--
04/17/96	520.76	509.49	11.27	--	62	<0.5	<0.5	<0.5	<0.5	<2.5	--	--	--	--	--	--	--	--	--
07/16/96	520.76	508.81	11.95	--	370	2.1	1.5	3.1	3.9	47	--	--	--	--	--	--	--	--	--
10/16/96	520.76	508.36	12.40	--	460	2.4	1.3	1.8	1.9	200	--	--	--	--	--	--	--	--	--
04/10/97	520.76	508.49	12.27	--	480	0.63	<0.5	<0.5	<0.5	15	--	--	--	--	--	--	--	--	--

## Cumulative Table of Well Data and Analytical Results

Vertical Measurements are in feet.

Analytical results are in parts per billion (ppb)

DATE	Well Head Elev.	Ground Water Elev.	Depth To Water	Notes	TPH- Gasoline	Benzene	Toluene	Ethyl- Benzene	Xylene	MTBE	TOG	1,2- DCA	VC	MC 1,1,1- TCA	1,1- DCA	PCE	Total Lead	CDS	
<b>C-3</b>																			
03/28/86	521.31	509.07	12.24	--	--	--	--	--	--	--	--	--	--	--	--	--	--	--	--
03/15/88	521.31	507.10	14.21	--	2100	86	8.0	30	36	--	--	--	--	--	--	--	--	--	--
05/10/88	521.31	506.88	14.43	--	--	--	--	--	--	--	--	--	--	--	--	--	--	--	--
06/10/88	521.31	505.78	15.53	--	--	--	--	--	--	--	--	--	--	--	--	--	--	--	--
07/25/88	521.31	507.09	14.22	--	--	--	--	--	--	--	--	--	--	--	--	--	--	--	--
10/13/88	521.31	507.21	14.10	--	ND	ND	ND	ND	ND	--	--	--	--	--	--	--	--	--	--
01/01/89	521.31	508.61	12.70	--	--	--	--	--	--	--	--	--	--	--	--	--	--	--	--
04/10/89	521.31	506.95	14.36	--	200	2.1	ND	4.4	2.6	--	ND	1.4	--	--	--	--	--	--	--
06/26/89	521.31	506.57	14.74	--	260	1.1	0.7	4.9	1.6	--	ND	1.5	--	--	--	--	--	--	--
10/13/89	521.31	506.61	14.70	--	ND	ND	ND	ND	ND	--	--	ND	--	--	--	--	--	--	--
01/03/90	521.31	506.89	14.42	--	ND	ND	ND	0.9	1.4	--	--	0.7	--	--	--	--	--	--	--
05/08/90	521.31	506.66	14.65	--	ND	ND	ND	ND	ND	--	--	0.7	--	ND	--	ND	--	--	--
09/27/90	521.31	506.64	14.67	--	71	ND	1.0	ND	ND	--	--	ND	--	1.1	1.6	ND	--	--	--
01/03/91	521.31	506.73	14.58	--	57	ND	ND	ND	ND	--	--	ND	--	ND	ND	ND	ND	--	--
04/12/91	521.31	507.08	14.23	--	98	ND	ND	1.6	ND	--	--	ND	--	ND	ND	ND	ND	--	--
09/04/91	521.31	506.43	14.88	--	64	ND	ND	ND	ND	--	--	ND	--	ND	ND	ND	ND	--	--
04/06/92	521.31	507.48	13.83	--	88	ND	ND	0.8	ND	--	--	ND	--	ND	ND	ND	ND	--	--
07/28/92	521.31	506.51	14.80	--	80	ND	ND	0.5	1.1	--	--	--	--	--	--	--	--	--	--
10/16/92	521.31	506.08	15.23	--	1400	ND	ND	6.6	11	--	--	--	--	--	--	--	--	--	--
01/14/93	521.31	509.86	11.45	--	100	ND	ND	ND	1.3	--	--	--	--	--	--	--	--	--	--
03/26/93	521.31	510.04	11.27	--	74	0.7	1.0	ND	ND	--	--	--	--	--	--	--	--	--	--
04/22/93	521.31	508.70	12.61	--	ND	ND	ND	ND	ND	--	--	--	--	--	--	--	--	--	--
07/20,21/93	521.31	505.14	16.17	--	ND	ND	ND	ND	ND	--	--	--	--	--	--	--	--	--	--
10/20/93	521.31	507.08	14.23	--	ND	ND	1.0	ND	0.8	--	--	--	--	--	--	--	--	--	--
01/20/94	521.31	507.30	14.01	--	ND	ND	ND	ND	ND	--	--	--	--	--	--	--	--	--	--
04/21/94	521.31	506.98	14.33	--	ND	ND	ND	ND	ND	--	--	--	--	--	--	--	--	--	--
07/21,22/94	521.31	507.00	14.31	--	ND	ND	ND	ND	ND	--	--	--	--	--	--	--	--	ND	--

NO LONGER MONITORED OR SAMPLED

## Cumulative Table of Well Data and Analytical Results

Vertical Measurements are in feet.

Analytical results are in parts per billion (ppb)

DATE	Well Head Elev.	Ground Water Elev.	Depth To Water	Notes	TPH- Gasoline	Benzene	Toluene	Ethyl- Benzene	Xylene	MTBE	TOG	1,2- DCA	VC	MC 1,1,1- TCA	1,1- DCA	PCE	Total Lead	CDS	
<b>C-5</b>																			
03/28/86	520.82	508.82	12.00	--	--	--	--	--	--	--	--	--	--	--	--	--	--	--	--
03/15/88	520.82	507.07	13.75	--	1600	82	7.0	77	95	--	--	--	--	--	--	--	--	--	--
05/10/88	520.82	506.90	13.92	--	--	--	--	--	--	--	--	--	--	--	--	--	--	--	--
07/10/88	520.82	507.10	13.72	--	--	--	--	--	--	--	--	--	--	--	--	--	--	--	--
07/25/88	520.82	507.10	13.72	--	--	--	--	--	--	--	--	--	--	--	--	--	--	--	--
10/13/88	520.82	506.98	13.84	--	2500	ND	ND	ND	ND	--	--	--	--	--	--	--	--	--	--
01/01/89	520.82	507.41	13.41	--	--	--	--	--	--	--	--	--	--	--	--	--	--	--	--
01/12/89	520.82	--	--	--	ND	42	3.0	44	52	--	--	--	--	--	--	--	--	--	--
04/10/89	520.82	--	13.88	--	180	2.6	ND	6.2	5.5	--	ND	1.4	--	--	--	--	--	--	--
06/26/89	520.82	506.68	14.14	--	420	7.6	0.8	40	56	--	ND	1.5	--	--	--	--	--	--	--
10/13/89	520.82	506.67	14.15	--	620	ND	ND	10	ND	--	ND	ND	--	--	--	--	--	--	--
01/03/90	520.82	506.72	14.10	--	ND	0.7	ND	8.0	6.0	--	--	ND	--	--	--	--	--	--	--
05/08/90	520.82	506.82	14.00	--	140	0.6	0.8	11	7.2	--	--	0.8	--	ND	--	ND	--	--	--
09/27/90	520.82	506.82	14.00	--	360	ND	3.2	5.2	6.4	--	--	ND	--	0.7	ND	ND	--	--	--
01/03/91	520.82	506.82	14.00	--	90	ND	ND	ND	3.0	--	--	ND	--	ND	ND	ND	ND	--	--
04/12/91	520.82	507.11	13.71	--	270	12	ND	19	7.0	--	--	0.5	--	ND	ND	ND	ND	--	--
09/04/91	520.82	506.52	14.30	--	ND	ND	ND	ND	ND	--	--	ND	--	ND	ND	ND	ND	--	--
04/06/92	520.82	507.53	13.29	--	670	12	ND	40	ND	--	--	ND	--	ND	ND	ND	ND	--	--
07/28/92	520.82	506.69	14.13	--	130	15	ND	1.8	0.5	--	--	--	--	--	--	--	--	--	--
10/16/92	520.82	506.14	14.68	--	ND	ND	ND	ND	1.2	--	--	--	--	--	--	--	--	--	--
01/14/93	520.82	508.95	11.87	--	2300	13	ND	110	10	--	--	--	--	--	--	--	--	--	--
03/26/93	520.82	--	--	--	--	--	--	--	--	--	--	--	--	--	--	--	--	--	--
04/22/93	520.82	508.70	12.12	--	2300	220	18	120	65	--	--	--	--	--	--	--	--	--	--
07/20,21/93	520.82	504.78	16.04	--	970	18	5.0	8.0	14	--	--	--	--	--	--	--	--	--	--
10/20/93	520.82	506.72	14.10	--	2200	7.0	5.0	3.0	15	--	--	--	--	--	--	--	--	--	--
01/20/94	520.82	507.22	13.60	--	440	2.0	1.0	11	0.6	--	--	--	--	--	--	--	--	--	--
04/21/94	520.82	507.01	13.81	--	490	2.7	2.6	21	1.5	--	--	--	--	--	--	--	--	--	--
07/21,22/94	520.82	507.00	13.82	--	370	0.9	ND	6.5	1.0	--	--	--	--	--	--	--	--	ND	--
01/18/95	520.82	508.55	12.27	--	940	37	22	14	7.3	--	--	--	--	--	--	--	--	--	--
04/17/95	520.82	508.65	12.17	--	14,000	1200	340	160	80	--	--	--	--	--	--	--	--	--	--
07/18/95	520.82	508.51	12.31	--	<2000	180	<20	<20	<20	--	--	--	--	--	--	--	--	--	--
10/17/95	520.82	508.36	12.46	--	92	4.9	<0.5	<0.5	<0.5	240	--	--	--	--	--	--	--	--	--
01/18/96	520.82	509.04	11.78	--	1300	180	<5.0	10	7.9	4300	--	--	--	--	--	--	--	--	--
04/17/96	520.82	509.71	11.11	--	2200	140	<10	<10	<10	5400	--	--	--	--	--	--	--	--	--
07/16/96	520.82	509.40	11.42	--	380	4.5	<0.5	3.4	3.1	1400	--	--	--	--	--	--	--	--	--
10/16/96	520.82	508.82	12.00	--	320	3.4	<1.0	<1.0	1.5	660	--	--	--	--	--	--	--	--	--
04/10/97	520.82	509.07	11.75	--	980	12	<2.5	3.0	<2.5	1700	--	--	--	--	--	--	--	--	--

## Cumulative Table of Well Data and Analytical Results

Vertical Measurements are in feet.

Analytical results are in parts per billion (ppb)

DATE	Well Head Elev.	Ground Water Elev.	Depth To Water	Notes	TPH- Gasoline	Benzene	Toluene	Ethyl- Benzene	Xylene	MTBE	TOG	1,2- DCA	VC	MC 1,1,1- TCA	1,1- DCA	PCE	Total Lead	CDS	
<b>C-6</b>																			
03/26/86	519.62	508.50	11.12	--	--	--	--	--	--	--	--	--	--	--	--	--	--	--	--
03/15/88	519.62	506.69	12.93	--	46,000	870	4600	1500	8200	--	--	--	--	--	--	--	--	--	--
05/10/88	519.62	506.59	13.03	--	86,000	1400	10,000	3000	19,000	--	--	--	--	--	--	--	--	--	--
06/10/88	519.62	505.51	14.11	--	--	--	--	--	--	--	--	--	--	--	--	--	--	--	--
07/25/88	519.62	506.67	12.95	--	--	--	--	--	--	--	--	--	--	--	--	--	--	--	--
10/13/88	519.62	506.48	13.14	--	5300	300	600	260	1,600	--	--	--	--	--	--	--	--	--	--
01/01/89	519.62	507.48	12.14	--	--	--	--	--	--	--	--	--	--	--	--	--	--	--	--
01/12/89	519.62	--	--	--	5000	260	110	270	720	--	--	--	--	--	--	--	--	--	--
04/12/89	519.62	506.64	12.98	--	5000	90	190	190	680	--	4.0	ND	--	--	--	--	--	--	--
06/26/89	519.62	506.23	13.39	--	3600	77	250	140	610	--	ND	ND	--	--	--	--	--	--	--
10/13/89	519.62	506.22	13.40	--	3500	32	81	100	530	--	ND	ND	--	--	--	--	--	--	--
01/03/90	519.62	506.44	13.18	--	3200	20	97	65	410	--	--	1.0	--	--	--	--	--	--	--
05/08/90	519.62	506.23	13.39	--	1800	17	140	ND	400	--	--	1.6	--	ND	--	ND	--	--	--
09/29/90	519.62	506.30	13.32	--	8000	58	210	260	2100	--	--	1.0	--	ND	2.4	1.6	--	--	--
01/03/91	519.62	506.43	13.19	--	2300	4.0	79	59	380	--	--	0.5	--	ND	ND	ND	ND	--	--
04/12/91	519.62	506.71	12.91	--	--	--	--	--	--	--	--	--	--	--	--	--	--	--	--
09/04/91	519.62	506.06	13.56	--	--	--	--	--	--	--	--	--	--	--	--	--	--	--	--
04/06/92	519.62	507.14	12.48	--	44,000	ND	120	740	3400	--	--	ND	--	ND	ND	ND	ND	--	--
07/28/92	519.62	506.15	13.47	--	120,000	220	1100	3000	13,000	--	--	--	--	--	--	--	--	--	--
10/16/92	519.62	505.67	13.95	--	570,000	ND	830	3300	9600	--	--	--	--	--	--	--	--	--	--
01/14/93	519.62	509.23	10.39	--	19,000	ND	25	460	980	--	--	--	--	--	--	--	--	--	--
03/26/93	519.62	509.79	9.83	--	11,000	30	90	290	1100	--	--	--	--	--	--	--	--	--	--
04/22/93	519.62	508.30	11.32	--	20,000	29	170	640	2400	--	--	--	--	--	--	--	--	--	--
07/20,21/93	519.62	504.70	14.92	--	32,000	130	490	1000	4900	--	--	--	--	--	--	--	--	--	--
10/20/93	519.62	506.71	12.91	--	77,000	290	790	2500	7600	--	--	--	--	--	--	--	--	--	--
01/20/94	519.62	506.94	12.68	--	22,000	10	86	510	29	--	--	--	--	--	--	--	--	--	--
04/21/94	519.62	506.74	12.88	--	6500	17	42	160	210	--	--	--	--	--	--	--	--	--	--
07/21,22/94	519.62	506.78	12.84	--	4500	ND	7.1	130	130	--	--	--	--	--	--	--	--	ND	--
01/18/95	519.62	508.61	11.01	--	3600	3.3	6.7	62	78	--	--	--	--	--	--	--	--	--	--
04/17/95	519.62	508.35	11.27	--	1500	1.6	2.2	14	12	--	--	--	--	--	--	--	--	--	--
07/18/95	519.62	508.16	11.46	--	4000	<10	<10	40	22	--	--	--	--	--	--	--	--	--	--
10/17/95	519.62	507.64	11.98	--	6000	<10	<10	100	58	5200	--	--	--	--	--	--	--	--	--
01/18/96	519.62	508.78	10.84	--	1200	<5.0	<5.0	10	<5.0	2600	--	--	--	--	--	--	--	--	--
04/17/96	519.62	509.15	10.47	--	510	<2.5	<2.5	10	3.0	490	--	--	--	--	--	--	--	--	--
07/16/96	519.62	508.65	10.97	--	1300	10	<10	51	<10	2700	--	--	--	--	--	--	--	--	--
10/16/96	519.62	508.12	11.50	--	2600	31	<10	12	11	5100	--	--	--	--	--	--	--	--	--
04/10/97	519.62	508.35	11.27	--	1300	5.1	<2.5	17	<2.5	1300	--	--	--	--	--	--	--	--	--



## Cumulative Table of Well Data and Analytical Results

Vertical Measurements are in feet.

Analytical results are in parts per billion (ppb)

DATE	Well Head Elev.	Ground Water Elev.	Depth To Water	Notes	TPH- Gasoline	Benzene	Toluene	Ethyl- Benzene	Xylene	MTBE	TOG	1,2- DCA	VC	MC 1,1,1- TCA	1,1- DCA	PCE	Total Lead	CDS	
<b>C-7</b>																			
03/28/86	520.30	508.63	11.67	--	--	--	--	--	--	--	--	--	--	--	--	--	--	--	--
03/15/88	520.30	506.82	13.48	--	8000	98	690	120	120	--	--	--	--	--	--	--	--	--	--
05/10/88	520.30	506.70	13.60	--	--	--	--	--	--	--	--	--	--	--	--	--	--	--	--
06/10/88	520.30	505.62	14.68	--	--	--	--	--	--	--	--	--	--	--	--	--	--	--	--
07/25/88	520.30	506.87	13.43	--	--	--	--	--	--	--	--	--	--	--	--	--	--	--	--
10/13/88	520.30	506.69	13.61	--	16,000	4400	220	1000	3000	--	--	--	--	--	--	--	--	--	--
01/01/89	520.30	507.64	12.66	--	--	--	--	--	--	--	--	--	--	--	--	--	--	--	--
01/12/89	520.30	--	--	--	8000	950	47	670	640	--	--	--	--	--	--	--	--	--	--
04/12/89	520.30	506.70	13.60	--	6000	1100	30	760	370	--	ND	ND	--	--	--	--	--	--	--
06/26/89	520.30	506.42	13.88	--	6000	1300	50	600	340	--	ND	ND	--	--	--	--	--	--	--
10/13/89	520.30	506.49	13.81	--	3900	1300	ND	160	150	--	--	ND	--	--	--	--	--	--	--
01/03/90	520.30	506.59	13.71	--	5600	1200	13	180	200	--	--	1.0	--	--	--	--	--	--	--
05/08/90	520.30	506.45	13.85	--	3500	1100	15	110	140	--	--	1.7	--	ND	--	ND	--	--	--
09/29/90	520.30	506.50	13.80	--	2400	580	ND	46	68	--	--	0.7	--	ND	ND	ND	ND	--	--
01/03/91	520.30	506.59	13.71	--	2500	300	2.0	110	120	--	--	0.7	--	ND	ND	ND	ND	--	--
04/12/91	520.30	506.84	13.46	--	2300	190	1.0	81	87	--	--	0.6	--	ND	ND	ND	ND	--	--
09/04/91	520.30	506.21	14.09	--	--	--	--	--	--	--	--	--	--	--	--	--	--	--	--
10/07/91	520.30	--	--	--	4700	170	1.9	97	59	--	--	ND	--	24	ND	ND	ND	--	--
04/06/92	520.30	507.28	13.02	--	2400	95	0.8	110	100	--	--	ND	--	ND	ND	ND	ND	--	--
07/28/92	520.30	506.54	13.76	--	2000	120	3.4	110	110	--	--	--	--	--	--	--	--	--	--
10/16/92	520.30	505.88	14.42	--	2700	130	4.2	68	74	--	--	--	--	--	--	--	--	--	--
01/14/93	520.30	509.32	10.98	--	7800	160	33	380	210	--	--	--	--	--	--	--	--	--	--
03/26/93	520.30	509.69	10.61	--	1400	39	9.0	28	15	--	--	--	--	--	--	--	--	--	--
04/22/93	520.30	508.46	11.84	--	3800	130	18	43	36	--	--	--	--	--	--	--	--	--	--
07/20,21/93	520.30	504.94	15.36	Sheen	1900	35	18	61	87	--	--	--	--	--	--	--	--	--	--
10/20/93	520.30	506.89	13.41	--	5500	72	26	250	160	--	--	--	--	--	--	--	--	--	--
01/20/94	520.30	507.11	13.19	Sheen	3600	12	12	150	69	--	--	--	--	--	--	--	--	--	--
04/21/94	520.30	506.97	13.33	--	2100	62	11	170	68	--	--	--	--	--	--	--	--	--	--
07/21,22/94	520.30	506.91	13.39	--	1700	50	4.4	110	22	--	--	--	--	--	--	--	--	ND	--
01/18/95	520.30	508.71	11.59	--	920	16	<0.5	30	12	--	--	--	--	--	--	--	--	--	--
04/17/95	520.30	508.56	11.74	--	730	4.3	1.6	12	1.8	--	--	--	--	--	--	--	--	--	--
07/18/95	520.30	508.32	11.98	--	1200	63	<5.0	12	<5.0	--	--	--	--	--	--	--	--	--	--
10/17/95	520.30	507.82	12.48	--	1100	45	<5.0	12	<5.0	8100	--	--	--	--	--	--	--	--	--
01/18/96	520.30	508.90	11.40	--	930	7.3	<5.0	<5.0	<5.0	1900	--	--	--	--	--	--	--	--	--
04/17/96	520.30	509.34	10.96	--	980	5.5	<1.0	7.4	1.1	340	--	--	--	--	--	--	--	--	--
07/16/96	520.30	508.79	11.51	--	1400	96	<5.0	11	9.9	3000	--	--	--	--	--	--	--	--	--
10/16/96	520.30	508.30	12.00	--	4100	40	<5.0	7.5	5.5	3800	--	--	--	--	--	--	--	--	--

NO LONGER MONITORED OR SAMPLED

## Cumulative Table of Well Data and Analytical Results

Vertical Measurements are in feet.

Analytical results are in parts per billion (ppb)

DATE	Well Head Elev.	Ground Water Elev.	Depth To Water	Notes	TPH-Gasoline	Benzene	Toluene	Ethyl-Benzene	Xylene	MTBE	TOG	1,2-DCA	VC	MC 1,1,1-TCA	1,1-DCA	PCE	Total Lead	CDS	
<b>C-8</b>																			
03/28/86	519.74	507.96	11.78	--	--	--	--	--	--	--	--	--	--	--	--	--	--	--	--
03/15/88	519.74	506.11	13.63	--	7500	360	25	10	ND	--	--	--	--	--	--	--	--	--	--
05/10/88	519.74	506.00	13.74	--	--	--	--	--	--	--	--	--	--	--	--	--	--	--	--
06/10/88	519.74	504.85	14.89	--	--	--	--	--	--	--	--	--	--	--	--	--	--	--	--
07/25/88	519.74	506.09	13.65	--	--	--	--	--	--	--	--	--	--	--	--	--	--	--	--
10/13/88	519.74	505.96	13.78	--	ND	6.0	5.3	ND	ND	--	--	--	--	--	--	--	--	--	--
01/01/89	519.74	507.06	12.68	--	--	--	--	--	--	--	--	--	--	--	--	--	--	--	--
01/12/89	519.74	--	--	--	ND	37	4.0	1.0	5.0	--	--	--	--	--	--	--	--	--	--
04/12/89	519.74	505.97	13.77	--	3000	13	ND	ND	ND	--	12	5.0	--	--	--	--	--	--	--
06/26/89	519.74	505.71	14.03	--	780	14	6.0	ND	6.0	--	ND	4.0	--	--	--	--	--	--	--
10/13/89	519.74	505.68	14.06	--	ND	ND	ND	ND	ND	--	ND	ND	--	--	--	--	--	--	--
01/03/90	519.74	506.00	13.74	--	910	ND	ND	1.0	1.0	--	--	1.5	--	--	--	--	--	--	--
05/07/90	519.74	505.64	14.10	--	620	3.9	6.0	0.5	3.4	--	--	1.9	--	ND	--	ND	--	--	--
09/29/90	519.74	505.77	13.97	--	77	ND	1.4	ND	ND	--	--	ND	--	0.6	ND	ND	--	--	--
01/03/91	519.74	505.93	13.81	--	67	2.0	2.0	ND	2.0	--	--	ND	--	0.7	ND	ND	ND	--	--
04/12/91	519.74	506.14	13.60	--	180	4.0	ND	ND	ND	--	--	0.6	--	ND	ND	ND	ND	--	--
09/04/91	519.74	505.60	14.14	--	140	1.8	4.7	0.8	4.8	--	--	ND	--	ND	ND	ND	ND	--	--
04/06/92	519.74	506.62	13.12	--	150	ND	ND	ND	ND	--	--	ND	--	ND	ND	ND	ND	--	--
07/28/92	519.74	505.64	14.10	--	90	ND	ND	ND	0.8	--	--	--	--	--	--	--	--	--	--
10/16/92	519.74	505.17	14.57	--	51	ND	ND	ND	ND	--	--	--	--	--	--	--	--	--	--
01/14/93	519.74	508.79	10.95	--	120	ND	1.6	1.0	3.5	--	--	--	--	--	--	--	--	--	--
03/26/93	519.74	--	--	--	--	--	--	--	--	--	--	--	--	--	--	--	--	--	--
04/22/93	519.74	507.67	12.07	--	68	ND	0.6	0.6	0.8	--	--	--	--	--	--	--	--	--	--
07/20,21/93	519.74	504.04	15.70	--	ND	ND	ND	ND	ND	--	--	--	--	--	--	--	--	--	--
10/20/93	519.74	506.23	13.51	--	ND	ND	ND	ND	ND	--	--	--	--	--	--	--	--	--	--
01/20/94	519.74	506.23	13.51	--	ND	ND	ND	ND	ND	--	--	--	--	--	--	--	--	--	--
04/21/94	519.74	506.06	13.68	--	ND	ND	ND	ND	ND	--	--	--	--	--	--	--	--	--	--
07/21,22/94	519.74	506.24	13.50	--	51	ND	ND	ND	ND	--	--	--	--	--	--	--	--	ND	--
01/18/95	519.74	--	--	Dry	--	--	--	--	--	--	--	--	--	--	--	--	--	--	--
04/17/95	519.74	--	--	Dry	--	--	--	--	--	--	--	--	--	--	--	--	--	--	--
07/18/95	519.74	--	--	Dry	--	--	--	--	--	--	--	--	--	--	--	--	--	--	--
10/17/95	519.74	507.54	12.20	Insufficient water	--	--	--	--	--	--	--	--	--	--	--	--	--	--	--
01/18/96	519.74	507.64	12.10	Insufficient water	--	--	--	--	--	--	--	--	--	--	--	--	--	--	--
04/17/96	519.74	508.87	10.87	Sampled biannually	--	--	--	--	--	--	--	--	--	--	--	--	--	--	--
07/16/96	519.74	508.26	11.48	Insufficient water	--	--	--	--	--	--	--	--	--	--	--	--	--	--	--
10/16/96	519.74	507.78	11.96	--	--	--	--	--	--	--	--	--	--	--	--	--	--	--	--

NO LONGER MONITORED OR SAMPLED

## Cumulative Table of Well Data and Analytical Results

Vertical Measurements are in feet.

Analytical results are in parts per billion (ppb)

DATE	Well Head Elev.	Ground Water Elev.	Depth To Water	Notes	TPH- Gasoline	Benzene	Toluene	Ethyl- Benzene	Xylene	MTBE	TOG	1,2- DCA	VC	MC 1,1,1- TCA	1,1- DCA	PCE	Total Lead	CDS	
<b>C-9</b>																			
03/28/86	519.52	508.28	11.24	--	--	--	--	--	--	--	--	--	--	--	--	--	--	--	--
03/15/88	519.52	506.60	12.92	--	29,000	540	560	580	3900	--	--	--	--	--	--	--	--	--	--
05/10/88	519.52	506.40	13.12	--	--	--	--	--	--	--	--	--	--	--	--	--	--	--	--
06/10/88	519.52	505.36	14.16	--	--	--	--	--	--	--	--	--	--	--	--	--	--	--	--
07/25/88	519.52	506.52	13.00	--	--	--	--	--	--	--	--	--	--	--	--	--	--	--	--
10/13/88	519.52	506.39	13.13	--	2200	57	8.0	20	150	--	--	--	--	--	--	--	--	--	--
01/01/89	519.52	507.33	12.19	--	--	--	--	--	--	--	--	--	--	--	--	--	--	--	--
01/12/89	519.52	--	--	--	2000	39	12	51	46	--	--	--	--	--	--	--	--	--	--
04/12/89	519.52	506.41	13.11	--	6000	16	20	55	240	--	ND	2.1	--	--	--	--	--	--	--
04/11/89	519.52	506.41	13.11	--	6000	14	25	45	290	--	--	ND	--	--	--	--	--	--	--
06/26/89	519.52	506.12	13.40	--	3900	37	63	140	690	--	ND	ND	--	--	--	--	--	--	--
10/13/89	519.52	506.06	13.46	--	1300	7.0	ND	26	50	--	ND	ND	--	--	--	--	--	--	--
01/03/90	519.52	506.22	13.30	--	1500	ND	0.7	202	37	--	--	1.5	--	--	--	--	--	--	--
05/07/90	519.52	506.04	13.48	--	7100	21	33	89	500	--	--	1.9	--	ND	--	ND	--	--	--
09/29/90	519.52	506.13	13.39	--	1000	21	3.9	31	110	--	--	1.0	--	0.7	1.8	1.0	--	--	--
01/03/91	519.72	506.44	13.28	--	3200	ND	ND	32	140	--	--	0.8	--	ND	ND	ND	ND	--	--
04/12/91	519.72	506.72	13.00	--	--	--	--	--	--	--	--	--	--	--	--	--	--	--	--
09/04/91	519.72	506.11	13.61	--	--	--	--	--	--	--	--	--	--	--	--	--	--	--	--
04/06/92	519.72	507.18	12.54	--	2800	ND	ND	33	130	--	--	ND	--	ND	ND	ND	ND	--	--
07/28/92	519.72	506.27	13.45	--	1000	6.5	2.4	17	37	--	--	--	--	--	--	--	--	--	--
10/16/92	519.72	505.74	13.98	--	190,000	ND	730	960	2000	--	--	--	--	--	--	--	--	--	--
01/14/93	519.72	509.28	10.44	--	2200	ND	ND	27	77	--	--	--	--	--	--	--	--	--	--
03/26/93	519.72	--	--	--	--	--	--	--	--	--	--	--	--	--	--	--	--	--	--
04/22/93	519.72	508.29	11.43	--	7300	60	40	68	98	--	--	--	--	--	--	--	--	--	--
07/20,21/93	519.72	504.52	15.20	--	30,000	160	130	450	1100	--	--	--	--	--	--	--	--	--	--
10/20/93	519.72	506.76	12.96	--	36,000	22	200	440	930	--	--	--	--	--	--	--	--	--	--
01/20/94	519.72	506.88	12.84	--	12000	55	57	27	210	--	--	--	--	--	--	--	--	--	--
04/21/94	519.72	506.58	13.14	--	2200	11	12	23	19	--	--	--	--	--	--	--	--	--	--
07/21,22/94	519.72	506.77	12.95	--	1100	ND	4.0	14	10	--	--	--	--	--	--	--	--	13	--
01/18/95	519.72	508.57	11.15	--	2100	9.2	13	19	13	--	--	--	--	--	--	--	--	--	--
04/17/95	519.72	508.41	11.31	--	3800	4.8	3.6	5.9	7.2	--	--	--	--	--	--	--	--	--	--
07/18/95	519.72	508.06	11.66	--	1700	<2.0	<2.0	9.6	8.3	--	--	--	--	--	--	--	--	--	--
10/17/95	519.72	507.99	11.73	--	1200	<1.2	<1.2	2.2	4.3	450	--	--	--	--	--	--	--	--	--
01/18/96	519.72	509.04	10.68	--	1400	3.1	<2.5	<2.5	<2.5	750	--	--	--	--	--	--	--	--	--
04/17/96	519.72	509.67	10.05	--	480	0.94	<0.5	1.7	1.1	380	--	--	--	--	--	--	--	--	--
07/16/96	519.72	508.80	10.92	--	290	2.7	<0.5	2.0	3.3	420	--	--	--	--	--	--	--	--	--
10/16/96	519.72	508.42	11.30	--	2200	13	<10	<10	<10	1300	--	--	--	--	--	--	--	--	--
04/10/97	519.72	508.52	11.20	--	680	<5.0	<5.0	<5.0	<5.0	630	--	<0.5	<1.0	<5.0	<0.5	<0.5	<0.5	--	--

## Cumulative Table of Well Data and Analytical Results

Vertical Measurements are in feet.

Analytical results are in parts per billion (ppb)

DATE	Well Head Elev.	Ground Water Elev.	Depth To Water	Notes	TPH- Benzene Gasoline	Toluene	Ethyl- Benzene	Xylene	MTBE	TOG	1,2- DCA	VC	MC 1,1,1- TCA	1,1- DCA	PCE	Total Lead	CDS	
<b>C-10</b>																		
03/28/86	520.41	--	--	--	--	--	--	--	--	--	--	--	--	--	--	--	--	--
03/15/88	520.41	505.55	14.86	--	90	7.0	ND	ND	ND	--	--	--	--	--	--	--	--	--
05/10/88	520.41	505.51	14.90	--	--	--	--	--	--	--	--	--	--	--	--	--	--	--
06/10/88	520.41	504.47	15.94	--	--	--	--	--	--	--	--	--	--	--	--	--	--	--
07/25/88	520.41	505.56	14.85	--	--	--	--	--	--	--	--	--	--	--	--	--	--	--
10/13/88	520.41	505.51	14.90	--	ND	ND	ND	ND	ND	--	--	--	--	--	--	--	--	--
01/01/89	520.41	505.58	14.83	--	--	--	--	--	--	--	--	--	--	--	--	--	--	--
01/12/89	520.41	--	--	--	ND	ND	ND	ND	ND	--	--	--	--	--	--	--	--	--
04/11/89	520.41	505.51	14.90	--	ND	4.8	ND	ND	ND	--	ND	6.1	--	--	--	--	--	--
06/26/89	520.41	505.29	15.12	--	ND	0.7	ND	ND	1.5	--	4.0	ND	--	--	--	--	--	--
10/13/89	520.41	505.30	15.11	--	ND	ND	ND	ND	ND	--	ND	ND	--	--	--	--	--	--
01/03/90	520.41	505.40	15.01	--	ND	ND	ND	ND	ND	--	ND	3.0	--	--	--	--	--	--
05/07/90	520.41	504.88	15.53	--	ND	ND	ND	ND	ND	--	ND	--	ND	--	ND	--	--	--
09/27/90	520.41	505.21	15.20	--	ND	ND	ND	ND	ND	--	ND	--	1.2	ND	ND	--	--	--
01/03/91	520.41	505.35	15.06	--	ND	ND	ND	ND	ND	--	ND	--	ND	ND	ND	ND	--	--
04/12/91	520.41	505.55	14.86	--	110	16	ND	2.9	2.7	--	1.0	--	ND	ND	ND	ND	--	--
09/04/91	520.41	505.19	15.22	--	ND	ND	ND	ND	ND	--	ND	--	ND	ND	ND	ND	--	--
04/06/92	520.41	506.20	14.21	--	57	ND	ND	ND	ND	--	1.1	--	ND	ND	ND	ND	--	--
07/28/92	520.41	505.63	14.78	--	ND	ND	ND	ND	ND	--	--	--	--	--	--	--	--	--
10/16/92	520.41	504.90	15.51	--	ND	ND	ND	ND	ND	--	--	--	--	--	--	--	--	--
01/14/93	520.41	506.97	13.44	--	88	4.7	ND	2.3	1.6	--	--	--	--	--	--	--	--	--
03/26/93	520.41	507.86	12.55	--	ND	ND	ND	ND	ND	--	--	--	--	--	--	--	--	--
04/22/93	520.41	506.67	13.74	--	ND	ND	ND	ND	ND	--	--	--	--	--	--	--	--	--
07/20,21/93	520.41	503.92	16.49	--	100	ND	ND	ND	ND	--	--	--	--	--	--	--	--	--
10/20/93	520.41	505.77	14.64	--	ND	ND	ND	ND	ND	--	--	--	--	--	--	--	--	--
01/20/94	520.41	506.02	14.39	--	ND	ND	ND	ND	ND	--	--	--	--	--	--	--	--	--
04/21/94	520.41	505.79	14.62	--	ND	0.8	ND	ND	ND	--	--	--	--	--	--	--	--	--
07/21,22/94	520.41	505.84	14.57	--	ND	ND	ND	ND	ND	--	--	--	--	--	--	--	ND	--
01/18/95	520.41	506.77	13.64	--	<50	1.2	<0.5	<0.5	<0.5	--	--	--	--	--	--	--	--	--
04/17/95	520.41	506.87	13.54	Sampled biannually	--	--	--	--	--	--	--	--	--	--	--	--	--	--
07/18/95	520.41	506.97	13.44	--	<50	<0.5	<0.5	<0.5	<0.5	--	--	--	--	--	--	--	--	--
10/17/95	520.41	506.63	13.78	--	--	--	--	--	--	--	--	--	--	--	--	--	--	--
01/18/96	520.41	506.81	13.60	--	<125	3.7	<1.2	<1.2	<1.2	1000	--	--	--	--	--	--	--	--
04/17/96	520.41	507.23	13.18	--	--	--	--	--	--	--	--	--	--	--	--	--	--	--
07/16/96	520.41	507.30	13.11	--	<200	<2.0	<2.0	<2.0	<2.0	1000	--	--	--	--	--	--	--	--
10/16/96	520.41	506.91	13.50	--	--	--	--	--	--	--	--	--	--	--	--	--	--	--

NO LONGER MONITORED OR SAMPLED

## Cumulative Table of Well Data and Analytical Results

Vertical Measurements are in feet.

Analytical results are in parts per billion (ppb)

DATE	Well Head Elev.	Ground Water Elev.	Depth To Water	Notes	TPH- Gasoline	Benzene	Toluene	Ethyl- Benzene	Xylene	MTBE	TOG	1,2- DCA	VC	MC 1,1,1- TCA	1,1- DCA	PCE	Total Lead	CDS	
<b>C-11</b>																			
03/28/86	520.04	506.22	13.82	--	--	--	--	--	--	--	--	--	--	--	--	--	--	--	--
03/15/88	520.04	505.55	14.49	--	--	--	--	--	--	--	--	--	--	--	--	--	--	--	--
05/10/88	520.04	505.73	14.31	--	--	--	--	--	--	--	--	--	--	--	--	--	--	--	--
06/10/88	520.04	504.57	15.47	--	--	--	--	--	--	--	--	--	--	--	--	--	--	--	--
07/25/88	520.04	506.44	13.60	--	--	--	--	--	--	--	--	--	--	--	--	--	--	--	--
10/14/88	520.04	505.51	14.53	--	2.0	240	33	4.7	67	--	--	--	--	--	--	--	--	--	--
01/01/89	520.04	505.94	14.10	--	--	--	--	--	--	--	--	--	--	--	--	--	--	--	--
01/12/89	520.04	--	--	--	ND	ND	0.8	ND	ND	--	--	--	--	--	--	--	--	--	--
04/12/89	520.04	505.68	14.36	--	ND	4.3	ND	ND	ND	--	ND	ND	--	--	--	--	--	--	--
06/26/89	520.04	505.46	14.58	--	ND	2.0	ND	ND	ND	--	4.0	ND	--	--	--	--	--	--	--
10/13/89	520.04	505.33	14.71	--	ND	ND	ND	ND	ND	--	ND	ND	--	--	--	--	--	--	--
01/03/90	520.04	505.43	14.61	--	ND	ND	ND	ND	0.7	--	--	ND	--	--	--	--	--	--	--
05/08/90	520.04	504.51	15.53	--	110	12	11	0.9	22	--	--	ND	--	ND	--	ND	--	--	--
09/28/90	520.04	504.53	15.51	--	ND	2.0	1.4	ND	3.3	--	--	ND	--	1.2	ND	ND	--	--	--
01/03/91	520.04	505.41	14.63	--	ND	2.0	ND	ND	2.0	--	--	ND	--	ND	ND	ND	1.0	--	--
04/12/91	520.04	505.74	14.30	--	--	--	--	--	--	--	--	--	--	--	--	--	--	--	--
09/04/91	520.04	505.20	14.84	--	--	--	--	--	--	--	--	--	--	--	--	--	--	--	--
04/06/92	520.04	506.48	13.56	--	ND	ND	ND	ND	ND	--	--	ND	--	ND	ND	ND	ND	--	--
07/28/92	520.04	505.65	14.39	--	ND	ND	ND	ND	ND	--	--	--	--	--	--	--	--	--	--
10/16/92	520.04	504.25	15.79	--	ND	ND	ND	ND	ND	--	--	--	--	--	--	--	--	--	--
01/14/93	520.04	507.90	12.14	--	94	ND	1.3	0.7	6.0	--	--	--	--	--	--	--	--	--	--
03/26/93	520.04	508.23	11.81	--	130	2.0	ND	0.6	1.0	--	--	--	--	--	--	--	--	--	--
04/22/93	520.04	507.10	12.94	--	ND	0.8	ND	ND	ND	--	--	--	--	--	--	--	--	--	--
07/20,21/93	520.04	503.56	16.48	--	1200	3.0	1.0	ND	1.0	--	--	--	--	--	--	--	--	--	--
10/20/93	520.04	505.58	14.46	--	ND	2.0	ND	ND	ND	--	--	--	--	--	--	--	--	--	--
01/20/94	520.04	505.92	14.12	--	140	5.0	0.6	3.0	4.0	--	--	--	--	--	--	--	--	--	--
04/21/94	520.04	505.80	14.24	--	86	1.7	0.6	1.2	1.6	--	--	--	--	--	--	--	--	--	--
07/21,22/94	520.04	505.83	14.21	--	ND	ND	ND	ND	ND	--	--	--	--	--	--	--	--	7.0	--
01/18/95	520.04	506.81	13.23	--	50	3.7	<0.5	0.9	1.9	--	--	--	--	--	--	--	--	--	--
04/17/95	520.04	507.03	13.01	--	89	1.4	1.3	0.69	0.79	--	--	--	--	--	--	--	--	--	--
07/18/95	520.04	507.04	13.00	--	89	0.95	<0.5	1.1	1.0	--	--	--	--	--	--	--	--	--	--
10/17/95	520.04	506.72	13.32	--	73	<0.5	<0.5	<0.5	<0.5	390	--	--	--	--	--	--	--	--	--
01/18/96	520.04	507.14	12.90	--	240	12	29	4.3	33	<2.5	--	--	--	--	--	--	--	--	--
04/17/96	519.95	507.47	12.48	--	<50	<0.5	<0.5	<0.5	<0.5	26	--	--	--	--	--	--	--	--	--
07/16/96	519.95	507.28	12.67	--	<500	17	<5.0	<5.0	20	5900	--	--	--	--	--	--	--	--	--
10/16/96	519.95	506.90	13.05	--	<125	<1.2	<1.2	<1.2	<1.2	910	--	--	--	--	--	--	--	--	--
04/10/97	519.95	506.77	13.18	--	<100	<1.0	<1.0	<1.0	<1.0	460	--	--	--	--	--	--	--	--	--

## Cumulative Table of Well Data and Analytical Results

Vertical Measurements are in feet.

Analytical results are in parts per billion (ppb)

DATE	Well Head Elev.	Ground Water Elev.	Depth To Water	Notes	TPH- Gasoline	Benzene	Toluene	Ethyl- Benzene	Xylene	MTBE	TOG	1,2- DCA	VC	MC 1,1,1- TCA	1,1- DCA	PCE	Total Lead	CDS	
<b>C-12</b>																			
03/28/86	519.82	506.21	13.61	--	--	--	--	--	--	--	--	--	--	--	--	--	--	--	--
03/15/88	519.82	505.27	14.55	--	ND	ND	ND	ND	ND	--	--	--	--	--	--	--	--	--	--
05/10/88	519.82	505.25	14.57	--	--	--	--	--	--	--	--	--	--	--	--	--	--	--	--
06/10/88	519.82	504.19	15.63	--	--	--	--	--	--	--	--	--	--	--	--	--	--	--	--
07/25/88	519.82	505.31	14.51	--	--	--	--	--	--	--	--	--	--	--	--	--	--	--	--
10/13/88	519.82	505.22	14.60	--	ND	ND	ND	ND	ND	--	--	--	--	--	--	--	--	--	--
01/12/89	519.82	505.20	14.62	--	ND	ND	ND	ND	ND	--	--	--	--	--	--	--	--	--	--
04/11/89	519.82	505.21	14.61	--	ND	ND	ND	ND	ND	--	ND	ND	--	--	--	--	--	--	--
06/26/89	519.82	505.07	14.75	--	ND	ND	ND	ND	ND	--	ND	ND	--	--	--	--	--	--	--
10/13/89	519.82	505.05	14.77	--	ND	ND	ND	ND	ND	--	ND	ND	--	--	--	--	--	--	--
01/03/90	519.82	504.97	14.85	--	ND	ND	ND	ND	0.6	--	--	ND	--	--	--	--	--	--	--
05/07/90	519.82	505.07	14.75	--	ND	ND	ND	ND	ND	--	--	ND	--	ND	--	ND	--	--	--
09/27/90	519.82	505.21	14.61	--	ND	ND	ND	ND	ND	--	--	ND	--	1.2	ND	ND	--	--	--
01/03/91	519.82	505.12	14.70	--	ND	ND	ND	ND	ND	--	--	ND	--	ND	ND	ND	ND	--	--
04/12/91	519.82	505.30	14.52	--	--	--	--	--	--	--	--	--	--	--	--	--	--	--	--
09/04/91	519.82	504.99	14.83	--	--	--	--	--	--	--	--	--	--	--	--	--	--	--	--
04/06/92	519.82	506.01	13.81	--	ND	ND	ND	ND	ND	--	--	ND	--	ND	ND	ND	ND	--	--
07/28/92	519.82	505.50	14.32	--	ND	ND	ND	ND	ND	--	--	--	--	--	--	--	--	--	--
10/16/92	519.82	504.70	15.12	--	ND	ND	ND	ND	ND	--	--	--	--	--	--	--	--	--	--
01/14/93	519.82	506.59	13.23	--	65	ND	ND	ND	1.7	--	--	--	--	--	--	--	--	--	--
03/26/93	519.82	507.62	12.20	--	ND	0.9	ND	ND	ND	--	--	--	--	--	--	--	--	--	--
04/22/93	519.82	506.61	13.21	--	ND	ND	ND	ND	ND	--	--	--	--	--	--	--	--	--	--
07/20,21/93	519.82	503.11	16.71	--	ND	ND	ND	ND	ND	--	--	--	--	--	--	--	--	--	--
10/20/93	519.82	505.63	14.19	--	ND	ND	ND	ND	ND	--	--	--	--	--	--	--	--	--	--
01/20/94	519.82	505.77	14.05	--	ND	ND	ND	ND	ND	--	--	--	--	--	--	--	--	--	--
04/21/94	519.82	505.76	14.06	--	ND	ND	ND	ND	ND	--	--	--	--	--	--	--	--	--	--
07/21,22/94	519.82	505.70	14.12	--	ND	ND	ND	ND	ND	--	--	--	--	--	--	--	--	ND	--

NO LONGER MONITORED OR SAMPLED

## Cumulative Table of Well Data and Analytical Results

Vertical Measurements are in feet.

Analytical results are in parts per billion (ppb)

DATE	Well Head Elev.	Ground Water Elev.	Depth To Water	Notes	TPH- Gasoline	Benzene	Toluene	Ethyl- Benzene	Xylene	MTBE	TOG	1,2- DCA	VC	MC 1,1,1- TCA	1,1- DCA	PCE	Total Lead	CDS	
<b>C-13</b>																			
03/28/86	522.24	509.29	12.95	--	--	--	--	--	--	--	--	--	--	--	--	--	--	--	--
03/15/88	522.24	507.42	14.82	--	250	2.0	ND	9.0	3.0	--	--	--	--	--	--	--	--	--	--
05/10/88	522.24	507.21	15.03	--	--	--	--	--	--	--	--	--	--	--	--	--	--	--	--
06/10/88	522.24	506.14	16.10	--	--	--	--	--	--	--	--	--	--	--	--	--	--	--	--
07/25/88	522.24	507.51	14.73	--	--	--	--	--	--	--	--	--	--	--	--	--	--	--	--
10/13/88	522.24	507.33	14.91	--	ND	1.9	ND	ND	ND	--	--	--	--	--	--	--	--	--	--
01/01/89	522.24	508.14	14.10	--	--	--	--	--	--	--	--	--	--	--	--	--	--	--	--
01/12/89	522.24	--	--	--	ND	ND	0.6	4.0	ND	--	--	--	--	--	--	--	--	--	--
04/10/89	522.24	507.25	14.99	--	ND	ND	ND	8.0	ND	--	ND	ND	--	--	--	--	--	--	--
06/26/89	522.24	507.08	15.16	--	ND	0.3	ND	ND	ND	--	ND	ND	--	--	--	--	--	--	--
10/13/89	522.24	507.01	15.23	--	ND	ND	ND	ND	ND	--	ND	ND	--	--	--	--	--	--	--
01/03/90	522.24	507.09	15.15	--	ND	ND	ND	0.5	0.6	--	--	ND	--	--	--	--	--	--	--
05/08/90	522.24	507.22	15.02	--	ND	ND	ND	ND	ND	--	--	ND	--	ND	--	ND	--	--	--
09/27/90	522.24	507.13	15.11	--	ND	ND	0.6	ND	ND	--	--	ND	--	1.7	ND	ND	--	--	--
01/03/91	522.24	507.16	15.08	--	ND	ND	ND	ND	0.6	--	--	ND	--	ND	ND	ND	ND	--	--
04/12/91	522.24	507.47	14.77	--	--	--	--	--	--	--	--	--	--	--	--	--	--	--	--
09/04/91	522.24	506.81	15.43	--	--	--	--	--	--	--	--	--	--	--	--	--	--	--	--
04/06/92	522.24	507.81	14.43	--	66	ND	ND	ND	ND	--	--	ND	--	ND	ND	ND	ND	--	--
07/28/92	522.24	506.87	15.37	--	60	8.2	ND	ND	1.1	--	--	--	--	--	--	--	--	--	--
10/16/92	522.24	506.37	15.87	--	ND	ND	ND	ND	ND	--	--	--	--	--	--	--	--	--	--
01/14/93	522.24	509.41	12.83	--	100	ND	ND	ND	1.3	--	--	--	--	--	--	--	--	--	--
03/26/93	522.24	509.65	12.59	--	ND	ND	ND	ND	ND	--	--	--	--	--	--	--	--	--	--
04/22/93	522.24	509.08	13.16	--	ND	ND	ND	ND	ND	--	--	--	--	--	--	--	--	--	--
07/20,21/93	522.24	505.72	16.52	--	99	4.0	13	2.0	7.0	--	--	--	--	--	--	--	--	--	--
10/20/93	522.24	507.11	15.13	--	ND	ND	ND	ND	ND	--	--	--	--	--	--	--	--	--	--
01/20/94	522.24	507.59	14.65	--	ND	ND	ND	ND	ND	--	--	--	--	--	--	--	--	--	--
04/21/94	522.24	507.36	14.88	--	ND	ND	ND	ND	ND	--	--	--	--	--	--	--	--	--	--
07/21,22/94	522.24	507.29	14.95	--	ND	ND	ND	ND	ND	--	--	--	--	--	--	--	--	ND	--

NO LONGER MONITORED OR SAMPLED

## Cumulative Table of Well Data and Analytical Results

Vertical Measurements are in feet.

Analytical results are in parts per billion (ppb)

DATE	Well Head Elev.	Ground Water Elev.	Depth To Water	Notes	TPH- Gasoline	Benzene	Toluene	Ethyl- Benzene	Xylene	MTBE	TOG	1,2- DCA	VC	MC 1,1,1- TCA	1,1- DCA	PCE	Total Lead	CDS	
<b>C-14</b>																			
03/28/86	520.08	--	--	--	--	--	--	--	--	--	--	--	--	--	--	--	--	--	--
03/15/88	520.08	--	--	--	--	--	--	--	--	--	--	--	--	--	--	--	--	--	--
05/10/88	520.08	506.69	13.39	--	120,000	13,000	29,000	2700	18	--	--	--	--	--	--	--	--	--	--
06/10/88	520.08	505.43	14.65	--	--	--	--	--	--	--	--	--	--	--	--	--	--	--	--
07/25/88	520.08	506.61	13.47	--	--	--	--	--	--	--	--	--	--	--	--	--	--	--	--
10/13/88	520.08	506.50	13.58	--	ND	ND	ND	ND	ND	--	--	--	--	--	--	--	--	--	--
01/01/89	520.08	507.08	13.00	--	--	--	--	--	--	--	--	--	--	--	--	--	--	--	--
01/12/89	520.08	--	--	--	NS	ND	ND	ND	ND	--	--	--	--	--	--	--	--	--	--
04/12/89	520.08	506.61	13.47	--	NS	ND	ND	ND	ND	--	ND	ND	--	--	--	--	--	--	--
06/26/89	520.08	506.28	13.80	--	140,000	14,000	25,000	3400	26,000	--	--	30	--	--	--	--	--	--	--
10/13/89	520.08	506.46	13.62	--	86,000	12,000	16,000	1600	13,000	--	--	--	--	--	--	--	--	--	--
01/03/90	520.08	506.17	13.91	--	120,000	9500	16,000	1800	13,000	--	--	25	3.0	--	--	--	--	--	--
01/04/90	520.08	506.17	13.91	--	76,000	3900	8100	1200	7700	--	--	18	1.0	--	--	--	--	--	--
05/08/90	520.08	506.19	13.89	--	62,000	7500	17,000	1400	14,000	--	--	13	--	ND	--	ND	--	--	--
09/27/90	520.08	506.30	13.78	--	--	--	--	--	--	--	--	--	--	--	--	--	--	--	--
01/03/91	520.08	506.36	13.72	--	--	--	--	--	--	--	--	--	--	--	--	--	--	--	--
04/12/91	520.08	507.11	12.97	--	60,000	750	3800	720	9200	--	--	ND	--	ND	ND	ND	ND	--	--
09/04/91	520.08	506.24	13.84	--	110,000	2800	11,000	1300	13,000	--	--	--	--	--	--	--	--	--	--
04/06/92	520.08	507.64	12.44	--	41,000	190	1800	440	5100	--	--	ND	--	ND	ND	ND	ND	--	--
07/28/92	520.08	506.38	13.70	--	130,000	2300	9700	1800	15,000	--	--	--	--	--	--	--	--	--	--
10/16/92	520.08	505.70	14.38	--	--	--	--	--	--	--	--	--	--	--	--	--	--	--	--
01/14/93	520.08	511.28	8.80	--	27,000	220	790	220	2700	--	--	--	--	--	--	--	--	--	--
03/26/93	520.08	510.96	9.12	--	23,000	330	1600	460	4000	--	--	--	--	--	--	--	--	--	--
04/22/93	520.08	507.98	12.10	Sheen	17,000	840	2300	130	3500	--	--	--	--	--	--	--	--	--	--
07/20,21/93	520.08	--	--	Inaccessible	--	--	--	--	--	--	--	--	--	--	--	--	--	--	--
10/20/93	520.08	505.77	14.31	Insufficient water	--	--	--	--	--	--	--	--	--	--	--	--	--	--	--
01/20/94	520.08	507.94	12.14	--	22,000	130	790	270	2400	--	--	--	--	--	--	--	--	--	--
04/21/94	520.08	508.15	11.93	--	9400	88	330	72	960	--	--	--	--	--	--	--	--	--	--
07/21,22/94	520.08	506.94	13.14	--	6200	92	180	30	530	--	--	--	--	--	--	--	--	330	--
01/18/95	520.08	--	--	Dry	--	--	--	--	--	--	--	--	--	--	--	--	--	--	--
04/17/95	520.08	--	--	Dry	--	--	--	--	--	--	--	--	--	--	--	--	--	--	--
07/18/95	520.08	--	--	Dry	--	--	--	--	--	--	--	--	--	--	--	--	--	--	--
10/17/95	520.08	507.64	12.44	Insufficient water	--	--	--	--	--	--	--	--	--	--	--	--	--	--	--
01/18/96	520.08	507.84	12.24	Insufficient water	--	--	--	--	--	--	--	--	--	--	--	--	--	--	--
04/17/96	520.08	507.91	12.17	Insufficient water	--	--	--	--	--	--	--	--	--	--	--	--	--	--	--
07/16/96	520.08	508.55	11.53	Insufficient water	--	--	--	--	--	--	--	--	--	--	--	--	--	--	--
10/16/96	520.08	507.98	12.10	Insufficient water	--	--	--	--	--	--	--	--	--	--	--	--	--	--	--
04/10/97	520.08	508.11	11.97	Insufficient water	--	--	--	--	--	--	--	--	--	--	--	--	--	--	--



## Cumulative Table of Well Data and Analytical Results

Vertical Measurements are in feet.

Analytical results are in parts per billion (ppb)

DATE	Well Head Elev.	Ground Water Elev.	Depth To Water	Notes	TPH- Gasoline	Benzene	Toluene	Ethyl- Benzene	Xylene	MTBE	TOG	1,2- DCA	VC	MC 1,1,1- TCA	1,1- DCA	PCE	Total Lead	CDS	
<b>C-15</b>																			
03/28/86	522.41	509.27	13.14	--	--	--	--	--	--	--	--	--	--	--	--	--	--	--	--
03/15/88	522.41	507.28	15.13	--	ND	ND	ND	ND	ND	--	--	--	--	--	--	--	--	--	--
05/10/88	522.41	507.01	15.40	--	--	--	--	--	--	--	--	--	--	--	--	--	--	--	--
06/10/88	522.41	505.92	16.49	--	--	--	--	--	--	--	--	--	--	--	--	--	--	--	--
07/25/88	522.41	507.24	15.17	--	--	--	--	--	--	--	--	--	--	--	--	--	--	--	--
10/13/88	522.41	507.08	15.33	--	ND	ND	ND	ND	ND	--	--	--	--	--	--	--	--	--	--
01/01/89	522.41	508.71	13.70	--	--	--	--	--	--	--	--	--	--	--	--	--	--	--	--
01/12/89	522.41	--	--	--	ND	ND	ND	ND	ND	--	--	--	--	--	--	--	--	--	--
04/12/89	522.41	507.07	15.34	--	ND	ND	ND	ND	ND	--	ND	ND	--	--	--	--	--	--	--
06/26/89	522.41	506.69	15.72	--	ND	ND	ND	ND	ND	--	ND	ND	--	--	--	--	--	--	--
10/13/89	522.41	506.45	15.96	--	ND	ND	ND	ND	ND	--	ND	ND	--	--	--	--	--	--	--
01/03/90	522.41	506.99	15.42	--	ND	ND	ND	ND	ND	--	--	ND	--	--	--	--	--	--	--
05/08/90	522.41	506.79	15.62	--	ND	ND	ND	ND	ND	--	--	ND	--	ND	--	ND	--	--	--
09/27/90	522.41	506.82	15.59	--	ND	ND	ND	ND	ND	--	--	ND	--	2.9	ND	ND	--	--	--
01/03/91	522.41	506.91	15.50	--	ND	ND	ND	ND	0.6	--	--	ND	--	ND	ND	ND	ND	--	--
04/12/91	522.41	507.20	15.21	--	--	--	--	--	--	--	--	--	--	--	--	--	--	--	--
09/04/91	522.41	506.51	15.90	--	--	--	--	--	--	--	--	--	--	--	--	--	--	--	--
04/06/92	522.41	507.53	14.88	--	ND	ND	ND	ND	ND	--	--	ND	--	ND	ND	ND	ND	--	--
07/28/92	522.41	506.59	15.82	--	ND	ND	ND	ND	ND	--	--	--	--	--	--	--	--	--	--
10/16/92	522.41	506.16	16.25	--	ND	ND	ND	ND	ND	--	--	--	--	--	--	--	--	--	--
01/14/93	522.41	509.93	12.48	--	61	ND	1.9	0.8	5.1	--	--	--	--	--	--	--	--	--	--
03/26/93	522.41	509.74	12.67	--	ND	ND	ND	ND	1.0	--	--	--	--	--	--	--	--	--	--
04/22/93	522.41	508.81	13.60	--	ND	ND	ND	ND	ND	--	--	--	--	--	--	--	--	--	--
07/20,21/93	522.41	505.54	16.87	--	ND	ND	ND	ND	ND	--	--	--	--	--	--	--	--	--	--
10/20/93	522.41	507.17	15.24	--	ND	ND	ND	ND	ND	--	--	--	--	--	--	--	--	--	--
01/20/94	522.41	507.40	15.01	--	ND	ND	ND	ND	ND	--	--	--	--	--	--	--	--	--	--
04/21/94	522.41	507.19	15.22	--	ND	ND	ND	ND	ND	--	--	--	--	--	--	--	--	--	--
07/21,22/94	522.41	507.06	15.35	--	ND	ND	ND	ND	ND	--	--	--	--	--	--	--	--	ND	--

NO LONGER MONITORED OR SAMPLED

## Cumulative Table of Well Data and Analytical Results

Vertical Measurements are in feet.

Analytical results are in parts per billion (ppb)

DATE	Well Head Elev.	Ground Water Elev.	Depth To Water	Notes	TPH- Gasoline	Benzene	Toluene	Ethyl- Benzene	Xylene	MTBE	TOG	1,2- DCA	VC	MC 1,1,1- TCA	1,1- DCA	PCE	Total Lead	CDS	
<b>C-16</b>																			
03/28/86	519.68	--	--	--	--	--	--	--	--	--	--	--	--	--	--	--	--	--	--
03/15/88	519.68	--	--	--	--	--	--	--	--	--	--	--	--	--	--	--	--	--	--
05/10/88	519.68	505.90	13.78	--	4500	1,000	73	140	180	--	--	--	--	--	--	--	--	--	--
06/10/88	519.68	504.80	14.88	--	--	--	--	--	--	--	--	--	--	--	--	--	--	--	--
07/25/88	519.68	505.99	13.69	--	--	--	--	--	--	--	--	--	--	--	--	--	--	--	--
10/13/88	519.68	505.88	13.80	--	1600	16	5.5	ND	16	--	--	--	--	--	--	--	--	--	--
01/01/89	519.68	506.23	13.45	--	--	--	--	--	--	--	--	--	--	--	--	--	--	--	--
01/12/89	519.68	--	--	--	1000	360	11	78	51	--	--	--	--	--	--	--	--	--	--
04/11/89	519.68	505.90	13.78	--	15,800	130	4.0	21	19	--	ND	8.0	--	--	--	--	--	--	--
06/26/89	519.68	505.66	14.02	--	1300	170	8.0	37	43	--	ND	ND	--	--	--	--	--	--	--
10/13/89	519.68	505.67	14.01	--	1000	20	ND	7.0	ND	--	ND	ND	--	--	--	--	--	--	--
01/03/90	519.68	505.71	13.97	--	1300	150	3.0	41	24	--	--	5.0	--	--	--	--	--	--	--
05/07/90	519.68	505.23	14.45	--	480	49	4.4	29	13	--	--	4.5	--	ND	--	ND	--	--	--
09/29/90	519.68	505.36	14.32	--	360	18	2.1	11	8.0	--	--	1.8	--	ND	ND	ND	--	--	--
01/03/91	519.68	505.72	13.96	--	230	12	ND	6.0	6.0	--	--	2.0	--	0.8	ND	ND	ND	--	--
04/12/91	519.68	505.94	13.74	--	--	--	--	--	--	--	--	--	--	--	--	--	--	--	--
09/04/91	519.68	505.46	14.22	--	--	--	--	--	--	--	--	--	--	--	--	--	--	--	--
04/06/92	519.68	506.50	13.18	--	360	30	ND	14	12	--	--	1.0	--	ND	ND	ND	ND	--	--
07/28/92	519.68	505.75	13.93	--	210	31	ND	6.8	16	--	--	--	--	--	--	--	--	--	--
10/16/92	519.68	504.76	14.92	--	140	11	ND	5.1	3.4	--	--	--	--	--	--	--	--	--	--
01/14/93	519.68	507.87	11.81	--	740	24	ND	36	21	--	--	--	--	--	--	--	--	--	--
03/26/93	519.68	508.32	11.36	--	730	22	2.0	16	10	--	--	--	--	--	--	--	--	--	--
04/22/93	519.68	507.38	12.30	--	850	46	ND	24	6.0	--	--	--	--	--	--	--	--	--	--
07/20,21/93	519.68	--	--	Inaccessible	--	--	--	--	--	--	--	--	--	--	--	--	--	--	--
10/20/93	519.68	505.68	14.00	--	290	18	2.0	16	17	--	--	--	--	--	--	--	--	--	--
01/20/94	519.68	506.20	13.48	--	360	10	1.0	12	9.0	--	--	--	--	--	--	--	--	--	--
04/21/94	519.68	505.76	13.92	--	220	15	ND	13	11	--	--	--	--	--	--	--	--	--	--
07/21,22/94	519.68	506.12	13.56	--	72	1.2	ND	ND	1.0	--	--	--	--	--	--	--	--	8.0	--
01/18/95	519.68	--	--	Inaccessible	--	--	--	--	--	--	--	--	--	--	--	--	--	--	--
04/17/95	519.68	--	--	Inaccessible	--	--	--	--	--	--	--	--	--	--	--	--	--	--	--
07/18/95	519.68	--	--	Inaccessible	--	--	--	--	--	--	--	--	--	--	--	--	--	--	--
10/17/95	519.68	--	--	Inaccessible	--	--	--	--	--	--	--	--	--	--	--	--	--	--	--
01/18/96	519.68	--	--	Inaccessible	--	--	--	--	--	--	--	--	--	--	--	--	--	--	--
04/17/96	519.68	--	--	Inaccessible	--	--	--	--	--	--	--	--	--	--	--	--	--	--	--
07/16/96	519.68	--	--	Inaccessible	--	--	--	--	--	--	--	--	--	--	--	--	--	--	--
10/16/96	519.68	--	--	Inaccessible	--	--	--	--	--	--	--	--	--	--	--	--	--	--	--

NO LONGER MONITORED OR SAMPLED

## Cumulative Table of Well Data and Analytical Results

Vertical Measurements are in feet.

Analytical results are in parts per billion (ppb)

DATE	Well Head Elev.	Ground Water Elev.	Depth To Water	Notes	TPH- Gasoline	Benzene	Toluene	Ethyl- Benzene	Xylene	MTBE	TOG	1,2- DCA	VC	MC 1,1,1- TCA	1,1- DCA	PCE	Total Lead	CDS	
<b>C-17</b>																			
03/28/86	520.82	507.34	13.48	--	--	--	--	--	--	--	--	--	--	--	--	--	--	--	--
03/15/88	520.82	506.06	14.76	--	--	--	--	--	--	--	--	--	--	--	--	--	--	--	--
05/10/88	520.82	506.05	14.77	--	--	--	--	--	--	--	--	--	--	--	--	--	--	--	--
06/10/88	520.82	504.98	15.84	--	--	--	--	--	--	--	--	--	--	--	--	--	--	--	--
07/25/88	520.82	506.19	14.63	--	--	--	--	--	--	--	--	--	--	--	--	--	--	--	--
10/13/88	520.82	505.99	14.83	--	270,000	18	900	760	5500	--	--	--	--	--	--	--	--	--	--
01/01/89	520.82	506.04	14.78	--	--	--	--	--	--	--	--	--	--	--	--	--	--	--	--
01/12/89	520.82	--	--	--	190,000	ND	490	2100	6700	--	--	--	--	--	--	--	--	--	--
04/11/89	520.82	505.99	14.83	--	27,000	30	150	320	1000	--	6.0	ND	--	--	--	--	--	--	--
06/26/89	520.82	505.79	15.03	--	20,000	50	390	660	2000	--	ND	ND	--	--	--	--	--	--	--
06/26/89	520.82	505.79	15.03	--	27,000	40	420	740	2200	--	--	ND	--	--	--	--	--	--	--
10/13/89	520.82	505.80	15.02	--	17,000	ND	48	230	480	--	ND	ND	--	--	--	--	--	--	--
01/03/90	520.82	505.72	15.10	--	14,000	ND	29	120	210	--	--	ND	--	--	--	--	--	--	--
05/08/90	520.82	505.70	15.12	--	9500	25	130	210	470	--	--	ND	--	ND	--	ND	--	--	--
09/29/90	520.82	505.83	14.99	--	ND	ND	ND	ND	ND	--	--	ND	--	ND	1.9	ND	--	--	--
09/29/90	520.82	505.83	14.99	--	ND	ND	3.4	ND	ND	--	--	ND	--	1.8	1.9	ND	--	--	--
01/03/91	520.82	505.90	14.92	--	3700	ND	28	56	140	--	--	ND	--	1.8	1.9	ND	ND	--	--
01/03/91	520.82	505.90	14.92	--	8600	ND	10	59	150	--	--	ND	--	ND	ND	ND	ND	--	--
04/12/91	520.82	506.11	14.71	--	8600	ND	5.0	47	120	--	--	ND	--	ND	ND	ND	ND	--	--
04/12/91	520.82	506.11	14.71	--	4400	ND	11	48	120	--	--	ND	--	ND	ND	ND	ND	--	--
09/04/91	520.82	505.65	15.17	--	5800	ND	27	49	79	--	--	ND	--	ND	ND	ND	ND	--	--
09/04/91	520.82	505.65	15.17	--	4100	ND	21	36	61	--	--	ND	--	ND	ND	ND	ND	--	--
04/06/92	520.82	506.68	14.14	--	2300	ND	5.8	27	29	--	--	ND	--	ND	ND	ND	ND	--	--
07/28/92	520.82	505.64	15.18	--	11,000	99	180	170	430	--	--	--	--	--	--	--	--	--	--
10/16/92	520.82	505.06	15.76	--	,200,000	ND	4800	3900	6600	--	--	--	--	--	--	--	--	--	--
01/14/93	520.82	507.38	13.44	--	3500	9.3	9.1	23	34	--	--	--	--	--	--	--	--	--	--
03/26/93	520.82	508.36	12.46	--	3700	ND	19	20	35	--	--	--	--	--	--	--	--	--	--
04/22/93	520.82	507.52	13.30	--	8900	16	68	44	97	--	--	--	--	--	--	--	--	--	--
07/20,21/93	520.82	503.61	17.21	--	4200	5.0	35	33	62	--	--	--	--	--	--	--	--	--	--
10/20/93	520.82	505.73	15.09	--	4500	5.0	12	43	64	--	--	--	--	--	--	--	--	--	--
01/20/94	520.82	506.35	14.47	--	1900	4.0	42	24	73	--	--	--	--	--	--	--	--	--	--
04/21/94	520.82	505.87	14.95	--	1100	5.0	20	23	42	--	--	--	--	--	--	--	--	--	--
07/21,22/94	520.82	506.22	14.60	--	72	ND	ND	ND	0.9	--	--	--	--	--	--	--	--	ND	--
01/18/95	520.82	507.12	13.70	--	530	1.7	<0.5	5.6	8.8	--	--	--	--	--	--	--	--	--	--
04/17/95	520.82	507.57	13.25	--	440	1.9	3.0	3.6	2.4	--	--	--	--	--	--	--	--	--	--
07/18/95	520.82	507.38	13.44	--	140	5.5	<0.5	<0.5	<0.5	--	--	--	--	--	--	--	--	--	--
10/17/95	520.82	507.32	13.50	--	110	<0.5	<0.5	<0.5	0.62	<2.5	--	--	--	--	--	--	--	--	--

CONTINUED ON NEXT PAGE

## Cumulative Table of Well Data and Analytical Results

Vertical Measurements are in feet.

Analytical results are in parts per billion (ppb)

DATE	Well Head Elev.	Ground Water Elev.	Depth To Water	Notes	TPH- Gasoline	Benzene	Toluene	Ethyl- Benzene	Xylene	MTBE	TOG	1,2- DCA	VC	MC 1,1,1- TCA	1,1- DCA	PCE	Total Lead	CDS	
<b>C-17 (CONT'D)</b>																			
01/18/96	520.82	507.80	13.02	--	310	19	30	5.6	40	28	--	--	--	--	--	--	--	--	--
04/17/96	520.53	507.83	12.70	--	<50	<0.5	<0.5	<0.5	<0.5	7.2	--	--	--	--	--	--	--	--	--
07/16/96	520.53	507.86	12.67	--	54	1.7	1.0	0.97	3.3	34	--	--	--	--	--	--	--	--	--
10/16/96	520.53	506.83	13.70	--	200	0.50	0.57	<0.5	2.2	15	--	--	--	--	--	--	--	--	--
04/10/97	520.53	507.34	13.19	--	100	<0.5	<0.5	<0.5	<0.5	66	--	--	--	--	--	--	--	--	--

## Cumulative Table of Well Data and Analytical Results

Vertical Measurements are in feet.

Analytical results are in parts per billion (ppb)

DATE	Well Head Elev.	Ground Water Elev.	Depth To Water	Notes	TPH- Gasoline	Benzene	Toluene	Ethyl- Benzene	Xylene	MTBE	TOG	1,2- DCA	VC	MC 1,1,1- TCA	1,1- DCA	PCE	Total Lead	CDS	
<b>C-18</b>																			
03/28/86	518.96	--	--	--	--	--	--	--	--	--	--	--	--	--	--	--	--	--	--
03/15/88	518.96	--	--	--	--	--	--	--	--	--	--	--	--	--	--	--	--	--	--
05/10/88	518.96	--	--	--	--	--	--	--	--	--	--	--	--	--	--	--	--	--	--
06/10/88	518.96	504.07	14.89	--	--	--	--	--	--	--	--	--	--	--	--	--	--	--	--
07/25/88	518.96	505.17	13.79	--	--	--	--	--	--	--	--	--	--	--	--	--	--	--	--
10/13/88	518.96	505.10	13.86	--	ND	ND	ND	ND	ND	--	--	--	--	--	--	--	--	--	--
01/01/89	518.96	505.02	13.94	--	--	--	--	--	--	--	--	--	--	--	--	--	--	--	--
01/12/89	518.96	--	--	--	ND	ND	ND	ND	ND	--	--	--	--	--	--	--	--	--	--
04/11/89	518.96	504.10	14.86	--	ND	ND	ND	ND	ND	--	ND	3.6	--	--	--	--	--	--	--
06/26/89	518.96	504.94	14.02	--	ND	ND	ND	ND	ND	--	ND	3.1	--	--	--	--	--	--	--
10/13/89	518.96	503.90	15.06	--	ND	ND	ND	ND	ND	--	ND	ND	--	--	--	--	--	--	--
01/03/90	518.96	504.89	14.07	--	ND	ND	ND	ND	ND	--	--	1.0	--	--	--	--	--	--	--
05/07/90	518.96	504.95	14.01	--	ND	ND	ND	ND	ND	--	--	ND	--	ND	--	ND	--	--	--
09/27/90	518.96	505.05	13.91	--	ND	ND	ND	ND	ND	--	--	ND	--	0.6	ND	ND	--	--	--
01/03/91	518.96	504.98	13.98	--	ND	ND	ND	ND	ND	--	--	ND	--	ND	ND	ND	ND	--	--
04/12/91	518.96	505.13	13.83	--	ND	ND	ND	ND	ND	--	--	ND	--	ND	ND	ND	ND	--	--
09/04/91	518.96	504.76	14.20	--	ND	ND	ND	ND	ND	--	--	ND	--	ND	ND	ND	ND	--	--
04/06/92	518.96	505.89	13.07	--	ND	ND	ND	ND	ND	--	--	ND	--	ND	ND	ND	ND	--	--
07/28/92	518.96	505.41	13.55	--	ND	ND	ND	ND	ND	--	--	--	--	--	--	--	--	--	--
10/16/92	518.96	504.58	14.38	--	ND	ND	ND	ND	ND	--	--	--	--	--	--	--	--	--	--
01/14/93	518.96	506.50	12.46	--	56	ND	ND	ND	1.8	--	--	--	--	--	--	--	--	--	--
03/26/93	518.96	507.50	11.46	--	ND	ND	ND	ND	ND	--	--	--	--	--	--	--	--	--	--
04/22/93	518.96	506.38	12.58	--	ND	ND	ND	ND	ND	--	--	--	--	--	--	--	--	--	--
07/20,21/93	518.96	503.32	15.64	--	92	ND	0.5	ND	ND	--	--	--	--	--	--	--	--	--	--
10/20/93	518.96	--	--	--	--	--	--	--	--	--	--	--	--	--	--	--	--	--	--
01/20/94	518.96	--	--	--	--	--	--	--	--	--	--	--	--	--	--	--	--	--	--
04/21/94	518.96	--	--	--	--	--	--	--	--	--	--	--	--	--	--	--	--	--	--
07/16/96	518.96	--	--	--	--	--	--	--	--	--	--	--	--	--	--	--	--	--	--

NO LONGER MONITORED OR SAMPLED

## Cumulative Table of Well Data and Analytical Results

Vertical Measurements are in feet.

Analytical results are in parts per billion (ppb)

DATE	Well Head Elev.	Ground Water Elev.	Depth To Water	Notes	TPH-Gasoline	Benzene	Toluene	Ethyl-Benzene	Xylene	MTBE	TOG	1,2-DCA	VC	MC 1,1,1-TCA	1,1-DCA	PCE	Total Lead	CDS	
<b>C-19</b>																			
03/28/86	520.99	--	--	--	--	--	--	--	--	--	--	--	--	--	--	--	--	--	--
03/15/88	520.99	--	--	--	--	--	--	--	--	--	--	--	--	--	--	--	--	--	--
05/10/88	520.99	505.76	15.23	--	18	1400	360	350	1300	--	--	--	--	--	--	--	--	--	--
06/10/88	520.99	504.41	16.58	--	--	--	--	--	--	--	--	--	--	--	--	--	--	--	--
07/25/88	520.99	505.80	15.19	--	--	--	--	--	--	--	--	--	--	--	--	--	--	--	--
10/13/88	520.99	505.72	15.27	--	ND	8.3	4.7	4.4	ND	--	--	--	--	--	--	--	--	--	--
01/01/89	520.99	505.79	15.20	--	--	--	--	--	--	--	--	--	--	--	--	--	--	--	--
01/12/89	520.99	--	--	--	ND	5.0	4.0	ND	ND	--	--	--	--	--	--	--	--	--	--
04/11/89	520.99	505.75	15.24	--	ND	1.8	ND	ND	ND	--	ND	13	--	--	--	--	--	--	--
04/11/89	520.99	505.75	15.24	--	500	1.2	ND	0.6	0.6	--	--	14	--	--	--	--	--	--	--
06/26/89	520.99	505.55	15.44	--	500	2.5	ND	ND	ND	--	ND	26	--	--	--	--	--	--	--
10/13/89	520.99	505.52	15.47	--	540	ND	ND	ND	ND	13	ND	13	--	--	--	--	--	--	13
01/03/90	520.99	505.54	15.45	--	ND	1.2	0.7	1.3	0.9	--	--	11	--	--	--	--	--	--	--
05/07/90	520.99	505.31	15.68	--	ND	ND	ND	ND	ND	--	--	4.6	--	ND	--	ND	--	--	--
09/28/90	520.99	505.47	15.52	--	ND	ND	ND	ND	ND	--	--	ND	--	1.2	ND	ND	--	--	--
01/03/91	520.99	505.43	15.56	--	66	ND	ND	ND	ND	--	--	1.0	--	ND	ND	ND	0.9	--	--
04/12/91	520.99	505.79	15.20	--	--	--	--	--	--	--	--	--	--	--	--	--	--	--	--
09/04/91	520.99	505.39	15.60	--	--	--	--	--	--	--	--	--	--	--	--	--	--	--	--
04/06/92	520.99	506.41	14.58	--	110	0.7	ND	1.0	ND	--	--	1.9	--	ND	ND	ND	ND	--	--
07/28/92	520.99	505.73	15.26	--	ND	1.4	ND	1.0	4.2	--	--	--	--	--	--	--	--	--	--
10/16/92	520.99	504.99	16.00	--	ND	ND	ND	ND	ND	--	--	--	--	--	--	--	--	--	--
01/14/93	520.99	507.30	13.69	--	100	1.1	ND	0.9	0.9	--	--	--	--	--	--	--	--	--	--
03/26/93	520.99	508.03	12.96	--	80	ND	ND	ND	ND	--	--	--	--	--	--	--	--	--	--
04/22/93	520.99	506.81	14.18	--	250	0.6	1.0	1.0	1.0	--	--	--	--	--	--	--	--	--	--
07/20,21/93	520.99	504.41	16.58	--	390	ND	ND	0.8	2.0	--	--	--	--	--	--	--	--	--	--
10/20/93	520.99	505.76	15.23	--	ND	ND	ND	ND	ND	--	--	--	--	--	--	--	--	--	--
01/20/94	520.99	506.15	14.84	--	ND	ND	ND	ND	ND	--	--	--	--	--	--	--	--	--	--
04/21/94	520.99	505.73	15.26	--	60	ND	ND	1.0	ND	--	--	--	--	--	--	--	--	--	--
07/21,22/94	520.99	506.09	14.90	--	ND	ND	ND	ND	ND	--	--	--	--	--	--	--	--	ND	--
01/18/95	520.99	506.97	14.02	--	<50	<0.5	<0.5	<0.5	<0.5	--	--	--	--	--	--	--	--	--	--
04/17/95	520.99	507.19	13.80	Sampled biannually	--	--	--	--	--	--	--	--	--	--	--	--	--	--	--
07/18/95	520.99	507.27	13.72	--	150	<0.5	<0.5	<0.5	<0.5	--	--	--	--	--	--	--	--	--	--
10/17/95	520.99	506.89	14.10	--	--	--	--	--	--	--	--	--	--	--	--	--	--	--	--
01/18/96	520.99	507.18	13.81	--	76	<0.5	<0.5	<0.5	<0.5	120	--	--	--	--	--	--	--	--	--
04/17/96	520.96	507.56	13.40	--	--	--	--	--	--	--	--	--	--	--	--	--	--	--	--
07/16/96	520.96	507.49	13.47	--	530	<2.5	<2.5	<2.5	<2.5	1200	--	--	--	--	--	--	--	--	--
10/16/96	520.96	507.13	13.83	--	--	--	--	--	--	--	--	--	--	--	--	--	--	--	--
04/10/97	520.96	507.06	13.90	--	<500	<5.0	<5.0	<5.0	<5.0	1600	--	--	--	--	--	--	--	--	--

## Cumulative Table of Well Data and Analytical Results

Vertical Measurements are in feet.

Analytical results are in parts per billion (ppb)

DATE	Well Head Elev.	Ground Water Elev.	Depth To Water	Notes	TPH- Gasoline	Benzene	Toluene	Ethyl- Benzene	Xylene	MTBE	TOG	1,2- DCA	VC	MC 1,1,1- TCA	1,1- DCA	PCE	Total Lead	CDS	
<b>C-20</b>																			
10/12/95	520.67	507.17	13.50	--	--	--	--	--	--	--	--	--	--	--	--	--	--	--	--
05/16/96	520.67	507.89	12.78	--	<50	<0.5	<0.5	<0.5	<0.5	<2.5	--	--	--	--	--	--	--	--	--
07/16/96	520.67	507.74	12.93	--	<50	2.5	1.5	0.82	2.4	4.1	--	--	--	--	--	--	--	--	--
10/16/96	520.67	507.43	13.24	--	<50	<0.5	<0.5	<0.5	<0.5	<2.5	--	--	--	--	--	--	--	--	--
04/10/97	520.67	507.35	13.32	--	<50	<0.5	<0.5	<0.5	<0.5	<2.5	--	--	--	--	--	--	--	--	--
<b>C-21</b>																			
10/12/95	519.64	507.49	12.15	--	--	--	--	--	--	--	--	--	--	--	--	--	--	--	--
05/16/96	519.64	508.36	11.28	--	<50	<0.5	<0.5	<0.5	<0.5	<2.5	--	--	--	--	--	--	--	--	--
07/16/96	519.64	508.24	11.40	--	<50	0.93	1.1	0.81	2.3	2.5	--	--	--	--	--	--	--	--	--
10/16/96	519.64	508.17	11.47	--	<50	<0.5	<0.5	<0.5	<0.5	<2.5	--	--	--	--	--	--	--	--	--

NO LONGER MONITORED OR SAMPLED

## Cumulative Table of Well Data and Analytical Results

Vertical Measurements are in feet.

Analytical results are in parts per billion (ppb)

DATE	Well Head Elev.	Ground Water Elev.	Depth To Water	Notes	TPH- Benzene Gasoline	Toluene	Ethyl- Xylene Benzene	MTBE	TOG	1,2- DCA	VC	MC 1,1,1- TCA	1,1- DCA	PCE	Total Lead	CDS	
<b>TRIP BLANK</b>																	
01/18/95	--	--	--	--	<50	<0.5	<0.5	<0.5	<0.5	--	--	--	--	--	--	--	--
04/17/95	--	--	--	--	<50	<0.5	<0.5	<0.5	<0.5	--	--	--	--	--	--	--	--
07/18/95	--	--	--	--	<50	<0.5	<0.5	<0.5	<0.5	--	--	--	--	--	--	--	--
10/17/95	--	--	--	--	<50	<0.5	<0.5	<0.5	<0.5	<2.5	--	--	--	--	--	--	--
01/18/96	--	--	--	--	<50	<0.5	<0.5	<0.5	<0.5	<2.5	--	--	--	--	--	--	--
04/17/96	--	--	--	--	<50	<0.5	<0.5	<0.5	<0.5	<2.5	--	--	--	--	--	--	--
07/16/96	--	--	--	--	<50	<0.5	<0.5	<0.5	<0.5	<2.5	--	--	--	--	--	--	--
10/16/96	--	--	--	--	<50	<0.5	<0.5	<0.5	<0.5	<2.5	--	--	--	--	--	--	--
04/10/97	--	--	--	--	<50	<0.5	<0.5	<0.5	<0.5	<2.5	--	--	--	--	--	--	--

Note: Blaine Tech Services, Inc. began routine monitoring of the groundwater wells at this site on November 1, 1994. Earlier field data and analytical results are drawn from the August 15, 1994 Groundwater Technology, Inc. report. The October 12, 1995 and the resurvey information was provided by Groundwater Technology, Inc.

**ABBREVIATIONS:**

TPH = Total Petroleum Hydrocarbons

MTBE = Methyl t-Butyl Ether

TOG = Total Oil & Grease

PCE = Tetrachloroethene

1,2-DCA = 1,2-Dichloroethane

VC = Vinyl chloride

MC = Methylene Chloride

TCA = 1,1,1-Trichloroethane

1,1-DCA = 1,1-Dichloroethane

CDS = Carbon Disulfide

ND = Not detected at or above the minimum quantitation limit. See laboratory reports for minimum quantitation limits.



# **Analytical Appendix**



Blaine Tech Services 1680 Rogers Avenue San Jose, CA 95112	Client Proj. ID: Chevron 9-1924/970410Z1 Sample Descript: C-2 Matrix: LIQUID Analysis Method: 8015Mod/8020 Lab Number: 9704746-01	Sampled: 04/10/97 Received: 04/11/97 Analyzed: 04/17/97 Reported: 04/21/97
Attention: Fran Thie		

QC Batch Number: GC041797BTEX07A  
Instrument ID: GCHP07

**Total Purgeable Petroleum Hydrocarbons (TPPH) with BTEX and MTBE**

Analyte	Detection Limit ug/L	Sample Results ug/L
TPPH as Gas	50	480
Methyl t-Butyl Ether	2.5	15
Benzene	0.50	0.63
Toluene	0.50	N.D.
Ethyl Benzene	0.50	N.D.
Xylenes (Total)	0.50	N.D.
Chromatogram Pattern:		Gas
<b>Surrogates</b>	<b>Control Limits %</b>	<b>% Recovery</b>
Trifluorotoluene	70                      130	92

Analytes reported as N.D. were not present above the stated limit of detection.

**SEQUOIA ANALYTICAL - ELAP #1210**

  
Peggy Penner  
Project Manager





Blaine Tech Services 1680 Rogers Avenue San Jose, CA 95112 Attention: Fran Thie	Client Proj. ID: Chevron 9-1924/970410Z1 Sample Descript: C-5 Matrix: LIQUID Analysis Method: 8015Mod/8020 Lab Number: 9704746-02	Sampled: 04/10/97 Received: 04/11/97 Analyzed: 04/17/97 Reported: 04/21/97
--	---	---

QC Batch Number: GC041797BTEX07A  
Instrument ID: GCHP07

**Total Purgeable Petroleum Hydrocarbons (TPPH) with BTEX and MTBE**

Analyte	Detection Limit ug/L	Sample Results ug/L
TPPH as Gas	250	980
Methyl t-Butyl Ether	12	1700
Benzene	2.5	12
Toluene	2.5	N.D.
Ethyl Benzene	2.5	3.0
Xylenes (Total)	2.5	N.D.
Chromatogram Pattern:		Gas

Surrogates	Control Limits %	% Recovery
Trifluorotoluene	70 130	85

Analytes reported as N.D. were not present above the stated limit of detection.

**SEQUOIA ANALYTICAL** - ELAP #1210

  
Peggy Penner  
Project Manager





Blaine Tech Services 1680 Rogers Avenue San Jose, CA 95112	Client Proj. ID: Chevron 9-1924/970410Z1 Sample Descript: C-6 Matrix: LIQUID Analysis Method: 8015Mod/8020 Lab Number: 9704746-03	Sampled: 04/10/97 Received: 04/11/97 Analyzed: 04/17/97 Reported: 04/21/97
--	---	---

QC Batch Number: GC041797BTEX07A  
Instrument ID: GCHP07

**Total Purgeable Petroleum Hydrocarbons (TPPH) with BTEX and MTBE**

Analyte	Detection Limit ug/L	Sample Results ug/L
TPPH as Gas	250	1300
Methyl t-Butyl Ether	12	1300
Benzene	2.5	5.1
Toluene	2.5	N.D.
Ethyl Benzene	2.5	17
Xylenes (Total)	2.5	N.D.
Chromatogram Pattern:		Gas

Surrogates	Control Limits %	% Recovery
Trifluorotoluene	70 130	86

Analytes reported as N.D. were not present above the stated limit of detection.

**SEQUOIA ANALYTICAL** - ELAP #1210

Peggy Penner  
Project Manager





Blaine Tech Services 1680 Rogers Avenue San Jose, CA 95112	Client Proj. ID: Chevron 9-1924/970410Z1 Sample Descript: C-9 Matrix: LIQUID Analysis Method: 8015Mod/8020 Lab Number: 9704746-04	Sampled: 04/10/97 Received: 04/11/97 Analyzed: 04/17/97 Reported: 04/21/97
--	---	---

QC Batch Number: GC041797BTEX07A  
Instrument ID: GCHP07

**Total Purgeable Petroleum Hydrocarbons (TPPH) with BTEX and MTBE**

Analyte	Detection Limit ug/L	Sample Results ug/L
TPPH as Gas	500	680
Methyl t-Butyl Ether	25	630
Benzene	5.0	N.D.
Toluene	5.0	N.D.
Ethyl Benzene	5.0	N.D.
Xylenes (Total)	5.0	N.D.
Chromatogram Pattern: Unidentified HC		C6-C12
<b>Surrogates</b>	<b>Control Limits %</b>	<b>% Recovery</b>
Trifluorotoluene	70 130	89

Analytes reported as N.D. were not present above the stated limit of detection.

**SEQUOIA ANALYTICAL - ELAP #1210**

  
Peggy Penney  
Project Manager





Blaine Tech Services  
1680 Rogers Avenue  
San Jose, CA 95112

Client Proj. ID: Chevron 9-1924/970410Z1  
Sample Descript: C-9  
Matrix: LIQUID  
Analysis Method: EPA 8010  
Lab Number: 9704746-04

Sampled: 04/10/97  
Received: 04/11/97  
Analyzed: 04/18/97  
Reported: 04/21/97

QC Batch Number: GC041797801009A  
Instrument ID: GCHP09

**Halogenated Volatile Organics (EPA 8010)**

Analyte	Detection Limit ug/L	Sample Results ug/L
Bromodichloromethane	0.50	N.D.
Bromoform	0.50	N.D.
Bromomethane	1.0	N.D.
Carbon Tetrachloride	0.50	N.D.
Chlorobenzene	0.50	N.D.
Chloroethane	1.0	N.D.
2-Chloroethylvinyl ether	1.0	N.D.
Chloroform	0.50	N.D.
Chloromethane	1.0	N.D.
Dibromochloromethane	0.50	N.D.
1,2-Dichlorobenzene	0.50	N.D.
1,3-Dichlorobenzene	0.50	N.D.
1,4-Dichlorobenzene	0.50	N.D.
1,1-Dichloroethane	0.50	N.D.
1,2-Dichloroethane	0.50	N.D.
1,1-Dichloroethene	0.50	N.D.
cis-1,2-Dichloroethene	0.50	N.D.
trans-1,2-Dichloroethene	0.50	N.D.
1,2-Dichloropropane	0.50	N.D.
cis-1,3-Dichloropropene	0.50	N.D.
trans-1,3-Dichloropropene	0.50	N.D.
Methylene chloride	5.0	N.D.
1,1,2,2-Tetrachloroethane	0.50	N.D.
Tetrachloroethene	0.50	N.D.
1,1,1-Trichloroethane	0.50	N.D.
1,1,2-Trichloroethane	0.50	N.D.
Trichloroethene	0.50	N.D.
Trichlorofluoromethane	0.50	N.D.
Vinyl chloride	1.0	N.D.
<b>Surrogates</b>	<b>Control Limits %</b>	<b>% Recovery</b>
1-Chloro-2-fluorobenzene	70                      130	70

Analytes reported as N.D. were not present above the stated limit of detection.

**SEQUOIA ANALYTICAL** - ELAP #1210

  
Peggy Palmer  
Project Manager





Blaine Tech Services 1680 Rogers Avenue San Jose, CA 95112 Attention: Fran Thie	Client Proj. ID: Chevron 9-1924/970410Z1 Sample Descript: C-11 Matrix: LIQUID Analysis Method: 8015Mod/8020 Lab Number: 9704746-05	Sampled: 04/10/97 Received: 04/11/97 Analyzed: 04/17/97 Reported: 04/21/97
--	--	---

QC Batch Number: GC041797BTEX07A  
Instrument ID: GCHP07

**Total Purgeable Petroleum Hydrocarbons (TPPH) with BTEX and MTBE**

Analyte	Detection Limit ug/L	Sample Results ug/L
TPPH as Gas	100	N.D.
<b>Methyl t-Butyl Ether</b>	<b>5.0</b>	<b>460</b>
Benzene	1.0	N.D.
Toluene	1.0	N.D.
Ethyl Benzene	1.0	N.D.
Xylenes (Total)	1.0	N.D.
Chromatogram Pattern:		
<b>Surrogates</b>	<b>Control Limits %</b>	<b>% Recovery</b>
Trifluorotoluene	70 130	96

Analytes reported as N.D. were not present above the stated limit of detection.

**SEQUOIA ANALYTICAL** - ELAP #1210

  
Peggy Permer  
Project Manager





Blaine Tech Services 1680 Rogers Avenue San Jose, CA 95112	Client Proj. ID: Chevron 9-1924/970410Z1 Sample Descript: C-17 Matrix: LIQUID Analysis Method: 8015Mod/8020 Lab Number: 9704746-06	Sampled: 04/10/97 Received: 04/11/97 Analyzed: 04/18/97 Reported: 04/21/97
--	--	---

QC Batch Number: GC041897BTEX07A  
Instrument ID: GCHP07

**Total Purgeable Petroleum Hydrocarbons (TPPH) with BTEX and MTBE**

Analyte	Detection Limit ug/L	Sample Results ug/L
TPPH as Gas	50	100
Methyl t-Butyl Ether	2.5	66
Benzene	0.50	N.D.
Toluene	0.50	N.D.
Ethyl Benzene	0.50	N.D.
Xylenes (Total)	0.50	N.D.
Chromatogram Pattern: Unidentified HC		C6-C12
<b>Surrogates</b>	<b>Control Limits %</b>	<b>% Recovery</b>
Trifluorotoluene	70 130	103

Analytes reported as N.D. were not present above the stated limit of detection.

**SEQUOIA ANALYTICAL** - ELAP #1210

  
Peggy Fenner  
Project Manager







Blaine Tech Services 1680 Rogers Avenue San Jose, CA 95112	Client Proj. ID: Chevron 9-1924/970410Z1 Sample Descript: C-19 Matrix: LIQUID Analysis Method: 8015Mod/8020 Lab Number: 9704746-07	Sampled: 04/10/97 Received: 04/11/97 Analyzed: 04/21/97 Reported: 04/21/97
Attention: Fran Thie		

QC Batch Number: GC042197BTEX06A  
Instrument ID: GCHP6

**Total Purgeable Petroleum Hydrocarbons (TPPH) with BTEX and MTBE**

Analyte	Detection Limit ug/L	Sample Results ug/L
TPPH as Gas	500	N.D.
Methyl t-Butyl Ether	25	1600
Benzene	5.0	N.D.
Toluene	5.0	N.D.
Ethyl Benzene	5.0	N.D.
Xylenes (Total)	5.0	N.D.
Chromatogram Pattern:		
<b>Surrogates</b>	<b>Control Limits %</b>	<b>% Recovery</b>
Trifluorotoluene	70 130	101

Analytes reported as N.D. were not present above the stated limit of detection.

**SEQUOIA ANALYTICAL** - ELAP #1210

  
Peggy Penner  
Project Manager





Blaine Tech Services 1680 Rogers Avenue San Jose, CA 95112	Client Proj. ID: Chevron 9-1924/970410Z1 Sample Descript: C-20 Matrix: LIQUID Analysis Method: 8015Mod/8020 Lab Number: 9704746-08	Sampled: 04/10/97 Received: 04/11/97 Analyzed: 04/17/97 Reported: 04/21/97
--	--	---

QC Batch Number: GC041797BTEX06A  
Instrument ID: GCHP06

**Total Purgeable Petroleum Hydrocarbons (TPPH) with BTEX and MTBE**

Analyte	Detection Limit ug/L	Sample Results ug/L
TPPH as Gas	50	N.D.
Methyl t-Butyl Ether	2.5	N.D.
Benzene	0.50	N.D.
Toluene	0.50	N.D.
Ethyl Benzene	0.50	N.D.
Xylenes (Total)	0.50	N.D.
Chromatogram Pattern:		
<b>Surrogates</b>	<b>Control Limits %</b>	<b>% Recovery</b>
Trifluorotoluene	70                      130	85

Analytes reported as N.D. were not present above the stated limit of detection.

**SEQUOIA ANALYTICAL** - ELAP #1210

  
Peggy Penner  
Project Manager





Blaine Tech Services 1680 Rogers Avenue San Jose, CA 95112	Client Proj. ID: Chevron 9-1924/970410Z1 Sample Descript: TB Matrix: LIQUID Analysis Method: 8015Mod/8020 Lab Number: 9704746-09	Sampled: 04/10/97 Received: 04/11/97 Analyzed: 04/17/97 Reported: 04/21/97
--	--	---

QC Batch Number: GC041797BTEX06A  
Instrument ID: GCHP06

**Total Purgeable Petroleum Hydrocarbons (TPPH) with BTEX and MTBE**

Analyte	Detection Limit ug/L	Sample Results ug/L
TPPH as Gas	50	N.D.
Methyl t-Butyl Ether	2.5	N.D.
Benzene	0.50	N.D.
Toluene	0.50	N.D.
Ethyl Benzene	0.50	N.D.
Xylenes (Total)	0.50	N.D.
Chromatogram Pattern:		
<b>Surrogates</b>	<b>Control Limits %</b>	<b>% Recovery</b>
Trifluorotoluene	70                      130	89

Analytes reported as N.D. were not present above the stated limit of detection.

**SEQUOIA ANALYTICAL** - ELAP #1210



---

Peggy Penner  
Project Manager





Sequoia  
Analytical

680 Chesapeake Drive  
404 N. Wiget Lane  
819 Striker Avenue, Suite 8

Redwood City, CA 94063  
Walnut Creek, CA 94598  
Sacramento, CA 95834

(415) 364-9600  
(510) 988-9600  
(916) 921-9600

FAX (415) 364-9233  
FAX (510) 988-9673  
FAX (916) 921-0100

Blaine Tech Services  
1680 Rogers Avenue  
San Jose, CA 95112  
Attention: Fran Thie

Client Proj. ID: Chevron 9-1924/970410Z1

Received: 04/11/97

Lab Proj. ID: 9704746

Reported: 04/21/97

### LABORATORY NARRATIVE

In order to properly interpret this report, it must be reproduced in its entirety. This report contains a total of 16 pages including the laboratory narrative, sample results, quality control, and related documents as required (cover page, COC, raw data, etc.).

TPPH Note: Sample 9704746-02 was diluted 5-fold.  
Sample 9704746-03 was diluted 5-fold.  
Sample 9704746-04 was diluted 10-fold.  
Sample 9704746-05 was diluted 2-fold.  
Sample 9704746-07 was diluted 10-fold.

SEQUOIA ANALYTICAL

  
Peggy Penner  
Project Manager





Blaine Tech Services, Inc.  
1680 Rogers Avenue  
San Jose, CA 95112  
Attention: Fran Thie

Client Project ID: Chevron 9-1924/ 970410Z1  
Matrix: Liquid

Work Order #: 9704746 -01 -05

Reported: Apr 25, 1997

**QUALITY CONTROL DATA REPORT**

Analyte:	Benzene	Toluene	Ethyl Benzene	Xylenes	Gas
QC Batch#:	GC041797BTEX07A	GC041797BTEX07A	GC041797BTEX07A	GC041797BTEX07A	GC041797BTEX07A
Analy. Method:	EPA 8020	EPA 8020	EPA 8020	EPA 8020	EPA 8015M
Prep. Method:	EPA 5030	EPA 5030	EPA 5030	EPA 5030	EPA 5030

Analyst:	A. Porter	A. Porter	A. Porter	A. Porter	A. Porter
MS/MSD #:	970451904	970451904	970451904	970451904	970451904
Sample Conc.:	N.D.	N.D.	N.D.	N.D.	N.D.
Prepared Date:	4/17/97	4/17/97	4/17/97	4/17/97	4/17/97
Analyzed Date:	4/17/97	4/17/97	4/17/97	4/17/97	4/17/97
Instrument I.D.#:	GCHP07	GCHP07	GCHP07	GCHP07	GCHP07
Conc. Spiked:	10 µg/L	10 µg/L	10 µg/L	30 µg/L	60 µg/L
Result:	10	9.9	9.8	29	64
MS % Recovery:	100	99	98	97	107
Dup. Result:	11	10	10	31	68
MSD % Recov.:	110	100	100	103	113
RPD:	9.5	1.0	2.0	6.7	6.1
RPD Limit:	0-50	0-50	0-50	0-50	0-50

LCS #:	BLK041797BSA	BLK041797BSA	LK041797BSA	BLK041797BSA	BLK041797BSA
Prepared Date:	4/17/97	4/17/97	4/17/97	4/17/97	4/17/97
Analyzed Date:	4/17/97	4/17/97	4/17/97	4/17/97	4/17/97
Instrument I.D.#:	GCHP07	GCHP07	GCHP07	GCHP07	GCHP07
Conc. Spiked:	10 µg/L	10 µg/L	10 µg/L	30 µg/L	60 µg/L
LCS Result:	10	10	9.9	30	64
LCS % Recov.:	100	100	99	100	107

MS/MSD	60-140	60-140	60-140	60-140	60-140
LCS	70-130	70-130	70-130	70-130	70-130
Control Limits					

**SEQUOIA ANALYTICAL**

Peggy Renner  
Project Manager

**Please Note:**  
The LCS is a control sample of known, interferent-free matrix that is analyzed using the same reagents, preparation, and analytical methods employed for the samples. The matrix spike is an aliquot of sample fortified with known quantities of specific compounds and subjected to the entire analytical procedure. If the recovery of analytes from the matrix spike does not fall within specified control limits due to matrix interference, the LCS recovery is to be used to validate the batch.

\*\* MS=Matrix Spike, MSD=MS Duplicate, RPD=Relative % Difference

9704746.BLA <1>





Blaine Tech Services, Inc.  
1680 Rogers Avenue  
San Jose, CA 95112  
Attention: Fran Thie

Client Project ID: **Chevron 9-1924/ 970410Z1**  
Matrix: **Liquid**

Work Order #: **9704746 -06**

Reported: **Apr 25, 1997**

**QUALITY CONTROL DATA REPORT**

Analyte:	Benzene	Toluene	Ethyl Benzene	Xylenes	Gas
<b>QC Batch#:</b>	GC041897BTEX07A	GC041897BTEX07A	GC041897BTEX07A	GC041897BTEX07A	GC041897BTEX07A
<b>Analy. Method:</b>	EPA 8020	EPA 8020	EPA 8020	EPA 8020	EPA 8015M
<b>Prep. Method:</b>	EPA 5030	EPA 5030	EPA 5030	EPA 5030	EPA 5030

<b>Analyst:</b>	A. Porter	A. Porter	A. Porter	A. Porter	A. Porter
<b>MS/MSD #:</b>	970451906	970451906	970451906	970451906	970451906
<b>Sample Conc.:</b>	N.D.	N.D.	N.D.	N.D.	N.D.
<b>Prepared Date:</b>	4/18/97	4/18/97	4/18/97	4/18/97	4/18/97
<b>Analyzed Date:</b>	4/18/97	4/18/97	4/18/97	4/18/97	4/18/97
<b>Instrument I.D.#:</b>	GCHP07	GCHP07	GCHP07	GCHP07	GCHP07
<b>Conc. Spiked:</b>	10 µg/L	10 µg/L	10 µg/L	30 µg/L	60 µg/L
<b>Result:</b>	9.9	11	11	34	71
<b>MS % Recovery:</b>	99	110	110	113	118
<b>Dup. Result:</b>	9.7	10	11	33	68
<b>MSD % Recov.:</b>	97	100	110	110	113
<b>RPD:</b>	2.0	9.5	0.0	3.0	4.3
<b>RPD Limit:</b>	0-50	0-50	0-50	0-50	0-50

LCS #:	BLK041897BSA	BLK041897BSA	LK041897BSA	BLK041897BSA	BLK041897BSA
<b>Prepared Date:</b>	4/18/97	4/18/97	4/18/97	4/18/97	4/18/97
<b>Analyzed Date:</b>	4/18/97	4/18/97	4/18/97	4/18/97	4/18/97
<b>Instrument I.D.#:</b>	GCHP07	GCHP07	GCHP07	GCHP07	GCHP07
<b>Conc. Spiked:</b>	10 µg/L	10 µg/L	10 µg/L	30 µg/L	60 µg/L
<b>LCS Result:</b>	11	11	12	37	74
<b>LCS % Recov.:</b>	110	110	120	123	123

<b>MS/MSD</b>	60-140	60-140	60-140	60-140	60-140
<b>LCS</b>	70-130	70-130	70-130	70-130	70-130
<b>Control Limits</b>					

**SEQUOIA ANALYTICAL**

Peggy Penner  
Project Manager

**Please Note:**

The LCS is a control sample of known, interferent-free matrix that is analyzed using the same reagents, preparation, and analytical methods employed for the samples. The matrix spike is an aliquot of sample fortified with known quantities of specific compounds and subjected to the entire analytical procedure. If the recovery of analytes from the matrix spike does not fall within specified control limits due to matrix interference, the LCS recovery is to be used to validate the batch.

\*\* MS=Matrix Spike, MSD=MS Duplicate, RPD=Relative % Difference

9704746.BLA <2>





Blaine Tech Services, Inc.  
 1680 Rogers Avenue  
 San Jose, CA 95112  
 Attention: Fran Thie

Client Project ID: Chevron 9-1924/ 970410Z1  
 Matrix: Liquid

Work Order #: 9704746 -07

Reported: Apr 25, 1997

**QUALITY CONTROL DATA REPORT**

Analyte:	Benzene	Toluene	Ethyl Benzene	Xylenes	Gas
<b>QC Batch#:</b>	GC042197BTEX06A	GC042197BTEX06A	GC042197BTEX06A	GC042197BTEX06A	GC042197BTEX06A
<b>Analy. Method:</b>	EPA 8020	EPA 8020	EPA 8020	EPA 8020	EPA 8015M
<b>Prep. Method:</b>	EPA 5030	EPA 5030	EPA 5030	EPA 5030	EPA 5030

<b>Analyst:</b>	A. Porter	A. Porter	A. Porter	A. Porter	A. Porter
<b>MS/MSD #:</b>	970487301	970487301	970487301	970487301	970487301
<b>Sample Conc.:</b>	N.D.	N.D.	N.D.	N.D.	N.D.
<b>Prepared Date:</b>	4/21/97	4/21/97	4/21/97	4/21/97	4/21/97
<b>Analyzed Date:</b>	4/21/97	4/21/97	4/21/97	4/21/97	4/21/97
<b>Instrument I.D.#:</b>	GCHP06	GCHP06	GCHP06	GCHP06	GCHP06
<b>Conc. Spiked:</b>	10 µg/L	10 µg/L	10 µg/L	30 µg/L	60 µg/L
<b>Result:</b>	9.7	9.1	9.1	27	79
<b>MS % Recovery:</b>	97	91	91	90	132
<b>Dup. Result:</b>	9.7	9.2	9.2	27	80
<b>MSD % Recov.:</b>	97	92	92	90	133
<b>RPD:</b>	0.0	1.1	1.1	0.0	1.3
<b>RPD Limit:</b>	0-50	0-50	0-50	0-50	0-50

LCS #:	BLK042197BSA	BLK042197BSA	LK042197BSA	BLK042197BSA	BLK042197BSA
<b>Prepared Date:</b>	4/21/97	4/21/97	4/21/97	4/21/97	4/21/97
<b>Analyzed Date:</b>	4/21/97	4/21/97	4/21/97	4/21/97	4/21/97
<b>Instrument I.D.#:</b>	GCHP06	GCHP06	GCHP06	GCHP06	GCHP06
<b>Conc. Spiked:</b>	10 µg/L	10 µg/L	10 µg/L	30 µg/L	60 µg/L
<b>LCS Result:</b>	9.4	9.3	9.3	27	74
<b>LCS % Recov.:</b>	94	93	93	90	123

<b>MS/MSD</b>	60-140	60-140	60-140	60-140	60-140
<b>LCS</b>	70-130	70-130	70-130	70-130	70-130
<b>Control Limits</b>					

**SEQUOIA ANALYTICAL**  
  
 Peggy Penner  
 Project Manager

**Please Note:**  
 The LCS is a control sample of known, interferent-free matrix that is analyzed using the same reagents, preparation, and analytical methods employed for the samples. The matrix spike is an aliquot of sample fortified with known quantities of specific compounds and subjected to the entire analytical procedure. If the recovery of analytes from the matrix spike does not fall within specified control limits due to matrix interference, the LCS recovery is to be used to validate the batch.

\*\* MS=Matrix Spike, MSD=MS Duplicate, RPD=Relative % Difference

9704746.BLA <3>





Blaine Tech Services, Inc.  
1680 Rogers Avenue  
San Jose, CA 95112  
Attention: Fran Thie

Client Project ID: Chevron 9-1924/ 970410Z1  
Matrix: Liquid

Work Order #: 9704746 -08 -09

Reported: Apr 25, 1997

**QUALITY CONTROL DATA REPORT**

Analyte:	Benzene	Toluene	Ethyl Benzene	Xylenes	Gas
QC Batch#:	GC041797BTEX06A	GC041797BTEX06A	GC041797BTEX06A	GC041797BTEX06A	GC041797BTEX06A
Analy. Method:	EPA 8020	EPA 8020	EPA 8020	EPA 8020	EPA 8015M
Prep. Method:	EPA 5030	EPA 5030	EPA 5030	EPA 5030	EPA 5030

Analyst:	A. Porter	A. Porter	A. Porter	A. Porter	A. Porter
MS/MSD #:	970451904	970451904	970451904	970451904	970451904
Sample Conc.:	N.D.	N.D.	N.D.	N.D.	N.D.
Prepared Date:	4/17/97	4/17/97	4/17/97	4/17/97	4/17/97
Analyzed Date:	4/17/97	4/17/97	4/17/97	4/17/97	4/17/97
Instrument I.D.#:	GCHP06	GCHP06	GCHP06	GCHP06	GCHP06
Conc. Spiked:	10 µg/L	10 µg/L	10 µg/L	30 µg/L	60 µg/L
Result:	9.0	9.0	9.0	27	73
MS % Recovery:	90	90	90	90	122
Dup. Result:	9.5	9.4	9.5	28	77
MSD % Recov.:	95	94	95	93	128
RPD:	5.4	4.3	5.4	3.6	5.3
RPD Limit:	0-50	0-50	0-50	0-50	0-50

LCS #:	BLK041797BSA	BLK041797BSA	LK041797BSA	BLK041797BSA	BLK041797BSA
Prepared Date:	4/17/97	4/17/97	4/17/97	4/17/97	4/17/97
Analyzed Date:	4/17/97	4/17/97	4/17/97	4/17/97	4/17/97
Instrument I.D.#:	GCHP06	GCHP06	GCHP06	GCHP06	GCHP06
Conc. Spiked:	10 µg/L	10 µg/L	10 µg/L	30 µg/L	60 µg/L
LCS Result:	9.4	9.3	9.4	28	75
LCS % Recov.:	94	93	94	93	125

MS/MSD	60-140	60-140	60-140	60-140	60-140
LCS	70-130	70-130	70-130	70-130	70-130
Control Limits					

**SEQUOIA ANALYTICAL**

Peggy Fenner  
Project Manager

**Please Note:**

The LCS is a control sample of known, interferent-free matrix that is analyzed using the same reagents, preparation, and analytical methods employed for the samples. The matrix spike is an aliquot of sample fortified with known quantities of specific compounds and subjected to the entire analytical procedure. If the recovery of analytes from the matrix spike does not fall within specified control limits due to matrix interference, the LCS recovery is to be used to validate the batch.

\*\* MS=Matrix Spike, MSD=MS Duplicate, RPD=Relative % Difference

9704746.BLA <4>







Blaine Tech Services, Inc.  
1680 Rogers Avenue  
San Jose, CA 95112  
Attention: Fran Thie

Client Project ID: Chevron 9-1924/ 970410Z1  
Matrix: Liquid

Work Order #: 9704746 -04

Reported: Apr 25, 1997

**QUALITY CONTROL DATA REPORT**

Analyte:	1,1-Dichloro-ethene	Trichloro-ethene	Chloro-Benzene
QC Batch#:	GC041797801009A	GC041797801009A	GC041797801009A
Analy. Method:	EPA 8010	EPA 8010	EPA 8010
Prep. Method:	EPA 5030	EPA 5030	EPA 5030

Analyst:	E. Cunanan	E. Cunanan	E. Cunanan
MS/MSD #:	970480301	970480301	970480301
Sample Conc.:	N.D.	N.D.	N.D.
Prepared Date:	4/17/97	4/17/97	4/17/97
Analyzed Date:	4/17/97	4/17/97	4/17/97
Instrument I.D.#:	GCHP09	GCHP09	GCHP09
Conc. Spiked:	25 µg/L	25 µg/L	25 µg/L
Dilution Factor:	1	1	1
Result:	27	26	23
MS % Recovery:	108	104	92
Dup. Result:	26	25	22
MSD % Recov.:	104	100	88
RPD:	3.8	3.9	4.4
RPD Limit:	0-20	0-20	0-20

LCS #:	VBLK041897BS	VBLK041897BS	VBLK041897BS
Prepared Date:	4/18/97	4/18/97	4/18/97
Analyzed Date:	4/18/97	4/18/97	4/18/97
Instrument I.D.#:	GCHP09	GCHP09	GCHP09
Conc. Spiked:	25 µg/L	25 µg/L	25 µg/L
LCS Result:	25	27	23
LCS % Recov.:	100	108	92

MS/MSD	60-140	60-140	60-140
LCS	65-135	70-130	70-130
Control Limits			

**SEQUOIA ANALYTICAL**  
  
Reggy Fenner  
Project Manager

Please Note:  
The LCS is a control sample of known, interferent-free matrix that is analyzed using the same reagents, preparation, and analytical methods employed for the samples. The matrix spike is an aliquot of sample fortified with known quantities of specific compounds and subjected to the entire analytical procedure. If the recovery of analytes from the matrix spike does not fall within specified control limits due to matrix interference, the LCS recovery is to be used to validate the batch.

MS=Matrix Spike, MSD=MS Duplicate, RPD=Relative % Difference



Chevron U.S.A. Inc.  
P.O. BOX 5004  
San Ramon, CA 94583  
FAX (415)842-9591

Chevron Facility Number 9-1924  
Facility Address 4904 Southfront St., Livermore, CA  
Consultant Project Number 970410-Z  
Consultant Name Blaine Tech Services, Inc.  
Address 1680 Rogers Ave., San Jose, CA 95112  
Project Contact (Name) Fran Thie  
(Phone) 408 573-0555 (Fax Number) 408 573-7771

Chevron Contact (Name) Brett Hunter  
(Phone) (510) 842-8953  
Laboratory Name Sequoia  
Laboratory Release Number 9033742  
Samples Collected by (Name) BRETT BLEAN  
Collection Date 4-10-97  
Signature [Signature]

Sample Number	Lab Sample Number	Number of Containers	Matrix S = Soil W = Water A = Air C = Charcoal	Type C = Grab C = Composite D = Discrete	Time	Sample Preservation	Iced (Yes or No)	Analyses To Be Performed														
								BTEX + TPH GAS + MTBE (8020 + 8015)	TPH Diesel (8015)	Oil and Grease (5520)	Purgeable Halocarbons (8010)	Purgeable Aromatics (8020)	Purgeable Organics (8240)	Extractable Organics (8270)	Metals Cd, Cr, Pb, Zn, Ni (ICAP or AA)							
C-2	1	3	E		1045		Y	X														
C-5	2	3	"		1030		"	X														
C-6	3	3	"		1125		"	X														
C-9	4	6	"		1100		"	X			X											
C-11	5	3	"		945		"	X														
C-17	6	3	"		1015		"	X														
C-19	7	3	"		1000		"	X														
C-20	8	3	"		925		"	X														
TB	9	2	"		-		"	X														

DO NOT BILL FOR TB-LB  
**9704746**  
Records 12 39

Relinquished By (Signature) <u>[Signature]</u>	Organization <u>ATS</u>	Date/Time <u>4/11/97</u>	Received By (Signature) <u>[Signature]</u>	Organization <u>SEB</u>	Date/Time <u>4/11/97</u>
Relinquished By (Signature) <u>[Signature]</u>	Organization <u>SEB</u>	Date/Time <u>4/11/97</u>	Received By (Signature) <u>[Signature]</u>	Organization <u>[Blank]</u>	Date/Time <u>[Blank]</u>
Relinquished By (Signature) <u>[Signature]</u>	Organization <u>[Blank]</u>	Date/Time <u>[Blank]</u>	Received For Laboratory By (Signature) <u>[Blank]</u>	Organization <u>[Blank]</u>	Date/Time <u>12:39</u>

Turn Around Time (Circle Choice)  
24 Hrs.  
48 Hrs.  
5 Days  
10 Days  
As Contracted

# **Field Data Sheets**



# CHEVRON WELL MONITORING DATA SHEET

Project #: 970410-Z1	Station #: 9-1724
Sampler: BB	Date: 4-10
Well I.D.: C-2	Well Diameter: 2 (3) 4 6 8 _____
Total Well Depth: 24.20	Depth to Water: 12.27
Depth to Free Product:	Thickness of Free Product (feet):
Referenced to: (PVC) Grade	D.O. Meter (if req'd): YSI HACH

Well Diameter	Multiplier	Well Diameter	Multiplier
2"	0.16	5"	1.02
3"	0.37	6"	1.47
4"	0.65	Other	radius <sup>2</sup> * 0.163

Purge Method:                      Bailer                      Sampling Method:                      Bailer.

Disposable Bailer                      Disposable Bailer x

Middleburg                                      Extraction Port

Electric Submersible                      Other: \_\_\_\_\_

Extraction Pump

Other: \_\_\_\_\_

4.4	X	3	=	13.2	Gals.
1 Case Volume (Gals.)		Specified Volumes		Calculated Volume	

Time	Temp (°F)	pH	Cond.	Gals. Removed	Observations
1035	68.00	7.1	1300	5	
1037	67.8	7.1	1300	10	
1038	68.0	7.1	1300	14	

Did well dewater?    Yes    (No)    Gallons actually evacuated: 14.0

Sampling Time: 1045                      Sampling Date: 4-10

Sample I.D.: C-2                      Laboratory: Sequoia GTEL N. Creek Assoc. Labs

Analyzed for: (TPH-G BTEX MTBE TPH-D) Other:

Duplicate I.D.:                      Analyzed for: TPH-G BTEX MTBE TPH-D Other:

D.O. (if req'd):	Pre-purge:	mg/L	Post-purge:	mg/L
O.R.P. (if req'd):	Pre-purge:	mV	Post-purge:	mV

## CHEVRON WELL MONITORING DATA SHEET

Project #: <u>91046-2</u>	Station #: <u>9-1924</u>
Sampler: <u>BB</u>	Date: <u>4-10</u>
Well I.D.: <u>C-5</u>	Well Diameter: 2 <u>3</u> 4 6 8 _____
Total Well Depth: <u>11.75</u>	Depth to Water: <u>11.75</u>
Depth to Free Product:	Thickness of Free Product (feet):
Referenced to: <u>(PVC)</u> Grade	D.O. Meter (if req'd):          YSI          HACH

Well Diameter	Multiplier	Well Diameter	Multiplier
2"	0.16	5"	1.02
3"	0.37	6"	1.47
4"	0.65	Other	radius <sup>2</sup> * 0.163

Purge Method:                      Bailer                                      Sampling Method:                      Bailer.  
     Disposable Bailer    Disposable Bailer \*  
     Middleburg    Extraction Port  
     Electric Submersible    Other: \_\_\_\_\_  
     Extraction Pump  
     Other: \_\_\_\_\_

$$\frac{2.7}{1 \text{ Case Volume (Gals.)}} \times \frac{3}{\text{Specified Volumes}} = \frac{8.1}{\text{Calculated Volume}} \text{ Gals.}$$

Time	Temp (°F)	pH	Cond.	Gals. Removed	Observations
1019	66.8	7.3	1100	3	
1021	67.2	7.2	1100	6	
1023	68.0	7.2	1100	9	

Did well dewater?    Yes                      (No)                      Gallons actually evacuated: 90

Sampling Time: 1030    Sampling Date: 4-10

Sample I.D.: C-5    Laboratory: Sequoia GTEL N. Creek Assoc. Labs

Analyzed for: TPH-G BTEX MTBE TPH-D Other:

Duplicate I.D.:    Analyzed for: TPH-G BTEX MTBE TPH-D Other:

D.O. (if req'd):	Pre-purge:	mg/L	Post-purge:	mg/L
O.R.P. (if req'd):	Pre-purge:	mV	Post-purge:	mV

# CHEVRON WELL MONITORING DATA SHEET

Project #: 970410-21	Station #: 9-1924
Sampler: BB	Date: 4-10
Well I.D.: C-6	Well Diameter: 2 (3) 4 6 8
Total Well Depth: 21.81	Depth to Water: 11.27
Depth to Free Product:	Thickness of Free Product (feet):
Referenced to: PVC Grade	D.O. Meter (if req'd): YSI HACH

Well Diameter	Multiplier	Well Diameter	Multiplier
2"	0.16	5"	1.02
3"	0.37	6"	1.47
4"	0.65	Other	radius <sup>2</sup> * 0.163

Purge Method: Bailer      Sampling Method: Bailer.  
 Disposable Bailer      Disposable Bailer \*  
 Middleburg      Extraction Port  
 Electric Submersible \*  
 Extraction Pump      Other: \_\_\_\_\_  
 Other: \_\_\_\_\_

3.9	X	3	=	11.7	Gals.
1 Case Volume (Gals.)		Specified Volumes		Calculated Volume	

Time	Temp (°F)	pH	Cond.	Gals. Removed	Observations
1115	68.0	7.2	1300	4	ODOR
1117	68.2	7.2	1300	8	"
1118	68.2	7.2	1300	12	"

Did well dewater? Yes  No  Gallons actually evacuated: 12.0

Sampling Time: 1125      Sampling Date: 4-10

Sample I.D.: C-6      Laboratory: Sequoia GTEL N. Creek Assoc. Labs

Analyzed for: TPH-G BTEX MTBE TPH-D Other:

Duplicate I.D.:      Analyzed for: TPH-G BTEX MTBE TPH-D Other:

D.O. (if req'd):	Pre-purge:	mg/L	Post-purge:	mg/L
	O.R.P. (if req'd):	Pre-purge:	mV	Post-purge:

# CHEVRON WELL MONITORING DATA SHEET

Project #: 970410-1	Station #: 9-1124
Sampler: <del>BB</del>	Date: 4-10
Well I.D.: C-1	Well Diameter: 2 (3) 4 6 8
Total Well Depth: 22.37	Depth to Water: 11.20
Depth to Free Product:	Thickness of Free Product (feet):
Referenced to: <u>PVC</u> Grade	D.O. Meter (if req'd): YSI HACH

Well Diameter	Multiplier	Well Diameter	Multiplier
2"	0.16	5"	1.02
3"	0.37	6"	1.47
4"	0.65	Other	radius <sup>2</sup> * 0.163

Purge Method: Bailer	Sampling Method: Bailer.
Disposable Bailer	Disposable Bailer <input checked="" type="checkbox"/>
Middleburg	Extraction Port
Electric Submersible <input checked="" type="checkbox"/>	Other: _____
Extraction Pump	
Other: _____	

$\frac{4.5}{1 \text{ Case Volume (Gals.)}}$	X	$\frac{3}{\text{Specified Volumes}}$	=	$\frac{13.5}{\text{Calculated Volume}}$ Gals.
---	---	--------------------------------------	---	---

Time	Temp (°F)	pH	Cond.	Gals. Removed	Observations
1049	67.9	7.1	1300	5	ODOR
1051	66.2	7.1	1100	10	"
1052	66.0	7.1	1100	14	"

Did well dewater? Yes <input type="checkbox"/> No <input checked="" type="checkbox"/>	Gallons actually evacuated: 4
Sampling Time: 1100	Sampling Date: 4-10
Sample I.D.: C-9	Laboratory: <u>Sequoia</u> GTEL N. Creek Assoc. Labs
Analyzed for: <u>TPH-G</u> BTEX MTBE TPH-D Other: <u>8010</u>	
Duplicate I.D.:	Analyzed for: TPH-G BTEX MTBE TPH-D Other:
D.O. (if req'd):	Pre-purge: <input type="text"/> mg/L Post-purge: <input type="text"/> mg/L
O.R.P. (if req'd):	Pre-purge: <input type="text"/> mV Post-purge: <input type="text"/> mV



# CHEVRON WELL MONITORING DATA SHEET

Project #: 710410-2	Station #: 1-1924
Sampler: BB	Date: 4-10
Well I.D.: C-11	Well Diameter: 2 (3) 4 6 8
Total Well Depth: 19.53	Depth to Water: 13.18
Depth to Free Product:	Thickness of Free Product (feet):
Referenced to: (PVC) Grade	D.O. Meter (if req'd): YSI HACH

Well Diameter	Multiplier	Well Diameter	Multiplier
2"	0.16	5"	1.02
3"	0.37	6"	1.47
4"	0.65	Other	radius <sup>2</sup> * 0.163

Purge Method:  Bailer      Sampling Method:  Bailer  
 Disposable Bailer       Disposable Bailer  
 Middleburg       Extraction Port  
 Electric Submersible      Other: \_\_\_\_\_  
 Extraction Pump  
 Other: \_\_\_\_\_

2.3	X	3	=	6.1	Gals.
1 Case Volume (Gals.)		Specified Volumes		Calculated Volume	

Time	Temp (°F)	pH	Cond.	Gals. Removed	Observations
933	57.0	7.3	1100	3	
935	56.0	7.3	1300	4	
937	55.2	7.3	1300	7	

Did well dewater?    Yes     No    Gallons actually evacuated: 7.0

Sampling Time: 945    Sampling Date: 4-10

Sample I.D.: C-11    Laboratory: Sequoia GTEL N. Creek Assoc. Labs

Analyzed for: TPH-G     BTEX    MTBE    TPH-D    Other:

Duplicate I.D.:    Analyzed for: TPH-G    BTEX    MTBE    TPH-D    Other:

D.O. (if req'd):	Pre-purge:	mg/L	Post-purge:	mg/L
O.R.P. (if req'd):	Pre-purge:	mV	Post-purge:	mV

# CHEVRON WELL MONITORING DATA SHEET

Project #: 970410-21	Station #: 9-1924
Sampler: BB	Date: 4-10
Well I.D.: C-14	Well Diameter: 2 (3) 4 6 8
Total Well Depth: 12.40	Depth to Water: 11.97
Depth to Free Product:	Thickness of Free Product (feet):
Referenced to: <u>FVS</u> Grade	D.O. Meter (if req'd): YSI HACH

Well Diameter	Multiplier	Well Diameter	Multiplier
2"	0.16	5"	1.02
3"	0.37	6"	1.47
4"	0.65	Other	radius <sup>2</sup> * 0.163

Purge Method:	Sampling Method:
<input type="checkbox"/> Bailer <input type="checkbox"/> Disposable Bailer <input type="checkbox"/> Middleburg <input type="checkbox"/> Electric Submersible <input type="checkbox"/> Extraction Pump Other: _____	<input type="checkbox"/> Bailer <input type="checkbox"/> Disposable Bailer <input type="checkbox"/> Extraction Port Other: _____

_____	X	_____	=	_____	Gals.
1 Case Volume (Gals.)		Specified Volumes		Calculated Volume	

Time	Temp (°F)	pH	Cond.	Gals. Removed	Observations

Did well dewater?	Yes	No	Gallons actually evacuated:
Sampling Time:	Sampling Date:		
Sample I.D.:	Laboratory: Sequoia GTEL N. Creek Assoc. Labs		
Analyzed for: TPH-G BTEX MTBE TPH-D	Other:		
Duplicate I.D.:	Analyzed for: TPH-G BTEX MTBE TPH-D		
D.O. (if req'd):		Pre-purge:	Post-purge:
		mV	mV
O.R.P. (if req'd):		Pre-purge:	Post-purge:
		mV	mV

# CHEVRON WELL MONITORING DATA SHEET

Project #: 970410-21	Station #: 9-1924
Sampler: BB	Date: 4-10
Well I.D.: C-17	Well Diameter: 2 <u>3</u> 4 6 8
Total Well Depth: 19.94	Depth to Water: 13.19
Depth to Free Product:	Thickness of Free Product (feet):
Referenced to: <u>PVC</u> Grade	D.O. Meter (if req'd): YSI HACH

Well Diameter	Multiplier	Well Diameter	Multiplier
2"	0.16	5"	1.02
3"	0.37	6"	1.47
4"	0.65	Other	radius <sup>2</sup> * 0.163

Purge Method: Bailer Disposable Bailer Middleburg Electric Submersible x Extraction Pump Other: _____	Sampling Method: Bailer Disposable Bailer x Extraction Port Other: _____
--	---

2.5	X	3	=	7.5	Gals.
1 Case Volume (Gals.)		Specified Volumes		Calculated Volume	

Time	Temp (°F)	pH	Cond.	Gals. Removed	Observations
1004	66.2	7.3	1000	3	
1006	66.2	7.3	900	6	
1008	66.4	7.3	100	8	

Did well dewater? Yes <u>No</u>	Gallons actually evacuated: 8.0
Sampling Time: 1015	Sampling Date: 4-10
Sample I.D.: C-17	Laboratory: <u>Sequoia</u> GTEL N. Creek Assoc. Labs
Analyzed for: <u>TPH-G</u> BTEX <u>MTBE</u> TPH-D Other:	
Duplicate I.D.:	Analyzed for: TPH-G BTEX MTBE TPH-D Other:
D.O. (if req'd):	Pre-purge: _____ mg/L      Post-purge: _____ mg/L
O.R.P. (if req'd):	Pre-purge: _____ mV      Post-purge: _____ mV

## CHEVRON WELL MONITORING DATA SHEET

Project #: 970410-21	Station #: 7-1924
Sampler: BB	Date: 4-10
Well I.D.: C-17	Well Diameter: (2) 3 4 6 8 _____
Total Well Depth: 24.05	Depth to Water: 13.75
Depth to Free Product:	Thickness of Free Product (feet):
Referenced to: (PVC) Grade	D.O. Meter (if req'd): YSI HACH

Well Diameter	Multiplier	Well Diameter	Multiplier
2"	0.16	5"	1.02
3"	0.37	6"	1.47
4"	0.65	Other	radius <sup>2</sup> * 0.163

Purge Method: Bailer Disposable Bailer ✕ Middleburg Electric Submersible Extraction Pump Other: _____	Sampling Method: Bailer Disposable Bailer ✕ Extraction Port Other: _____
--	---

1.6	X	3	=	4.8	Gals.
1 Case Volume (Gals.)		Specified Volumes		Calculated Volume	

Time	Temp (°F)	pH	Cond.	Gals. Removed	Observations
951	65.4	7.2	1430	1.75	
953	65.0	7.1	1400	3.50	
955	64.6	7.2	1400	5.0	

Did well dewater?	Yes	(No)	Gallons actually evacuated: 5.0
Sampling Time: 1000	Sampling Date: 4-10		
Sample I.D.: C-17	Laboratory: (Sequia) GTEL N. Creek Assoc. Labs		
Analyzed for: TPH-G BTEX MTBE TPH-D Other:			
Duplicate I.D.: Analyzed for: TPH-G BTEX MTBE TPH-D Other:			
D.O. (if req'd):	Pre-purge:	mg/L	Post-purge: mg/L
O.R.P. (if req'd):	Pre-purge:	mV	Post-purge: mV

## CHEVRON WELL MONITORING DATA SHEET

Project #: 970910-7	Station #: 7-1924
Sampler: BB	Date: 4-10
Well I.D.: # C-20	Well Diameter: (2) 3 4 6 8
Total Well Depth: 24.10	Depth to Water: 13.32
Depth to Free Product:	Thickness of Free Product (feet):
Referenced to: (PVC) Grade	D.O. Meter (if req'd): YSI HACH

Well Diameter	Multiplier	Well Diameter	Multiplier
2"	0.16	5"	1.02
3"	0.37	6"	1.47
4"	0.65	Other	radius <sup>2</sup> * 0.163

Purge Method:                  Bailer                          Sampling Method:                  Bailer  
 Disposable Bailer \*    Disposable Bailer \*  
 Middleburg    Extraction Port  
 Electric Submersible    Other: \_\_\_\_\_  
 Extraction Pump

Other: \_\_\_\_\_

<u>1.7</u>	<u>X</u>	<u>3</u>	<u>=</u>	<u>5.1</u>	Gals.
1 Case Volume (Gals.)		Specified Volumes		Calculated Volume	

Time	Temp (°F)	pH	Cond.	Gals. Removed	Observations
917	62.8	7.4	1400	1.75	
919	62.2	7.3	1400	3.50	
921	62.0	7.3	1400	5.25	

Did well dewater?    Yes                  **(No)**                  Gallons actually evacuated: 5.25

Sampling Time: 925                          Sampling Date: 4-10

Sample I.D.: C-20                          Laboratory: Sequoia - GTEL N. Creek Assoc. Labs

Analyzed for: **(TPH-G BTEX MTBE TPH-D)** Other:

Duplicate I.D.:                          Analyzed for: TPH-G BTEX MTBE TPH-D Other:

D.O. (if req'd):	Pre-purge:	mg/L	Post-purge:	mg/L
O.R.P. (if req'd):	Pre-purge:	mV	Post-purge:	mV