

BLAINE TECH SERVICES INC.

985 TIMOTHY DRIVE
SAN JOSE, CA 95133
(408) 995-5535
FAX (408) 293-8773

February 27, 1995

Brett Hunter
Chevron U.S.A. Products Company
2410 Camino Ramon
San Ramon, CA 94583-0804

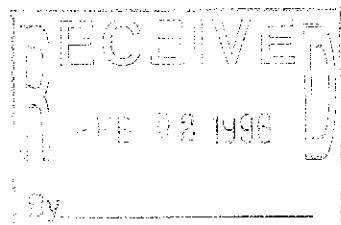

1st Quarter 1995 Monitoring at 9-1924

First Quarter 1995 Groundwater Monitoring at
Chevron Service Station Number 9-1924
4904 Southfront Road
Livermore, CA

Monitoring Performed on January 18, 1995

Groundwater Sampling Report 950118-L-1

This report covers the routine quarterly monitoring of groundwater wells at this Chevron facility. Blaine Tech Services, Inc.'s work at the site includes inspection, gauging, evacuation, purgewater containment, sample collection and sample handling in accordance with standard procedures that conform to Regional Water Quality Control Board requirements.

Routine field data collection includes depth to water, total well depth, thickness of any separate immiscible layer, water column volume, calculated volume of a three-case volume purge, elapsed evacuation time, total volume of water removed, and standard water parameter instrument readings. Sample material is collected, contained, stored, and transported to the laboratory in conformance with EPA standards. Purgewater is, likewise, collected and transported to Chevron's Richmond Refinery for disposal.

Basic field information is presented alongside analytical values excerpted from the laboratory report in the cumulative table of **WELL DATA AND ANALYTICAL RESULTS**. The full analytical report for the most recent samples is located in the **Analytical Appendix**. The table also contains new groundwater elevation calculations taken from the computer plotted gradient map which is located in the **Professional Engineering Appendix**.

At a minimum, Blaine Tech Services, Inc. field personnel are certified upon completion of a forty-hour Hazardous Materials and Emergency Response training course per 29 CFR 1910.120. Field personnel are also enrolled in annual eight hour refresher courses.

Blaine Tech Services, Inc. conducts sampling and documentation assignments of this type as an independent third party. In order to avoid compromising the objectivity necessary for the proper and disinterested performance of this work, Blaine Tech Services, Inc. concentrates on objective data collection and does not participate in the interpretation of analytical results, the definition of geological or hydrological conditions, the formulation of recommendations, or the marketing of remedial systems.

Please call if you have any questions.

Yours truly,

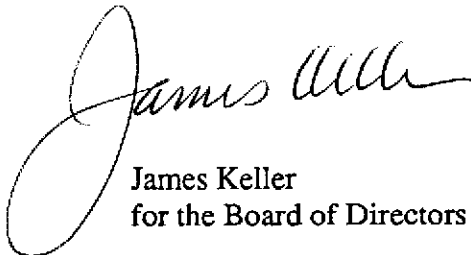

James Keller
for the Board of Directors

JPK/dk

attachments: Professional Engineering Appendix
Cumulative Table of Well Data and Analytical Results
Analytical Appendix
Field Data Sheets

Professional Engineering Appendix

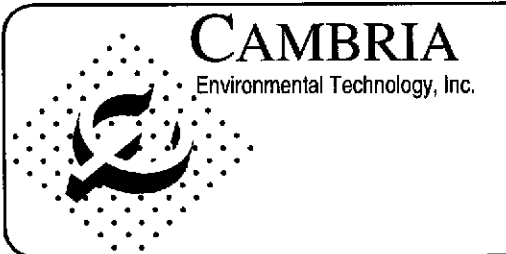
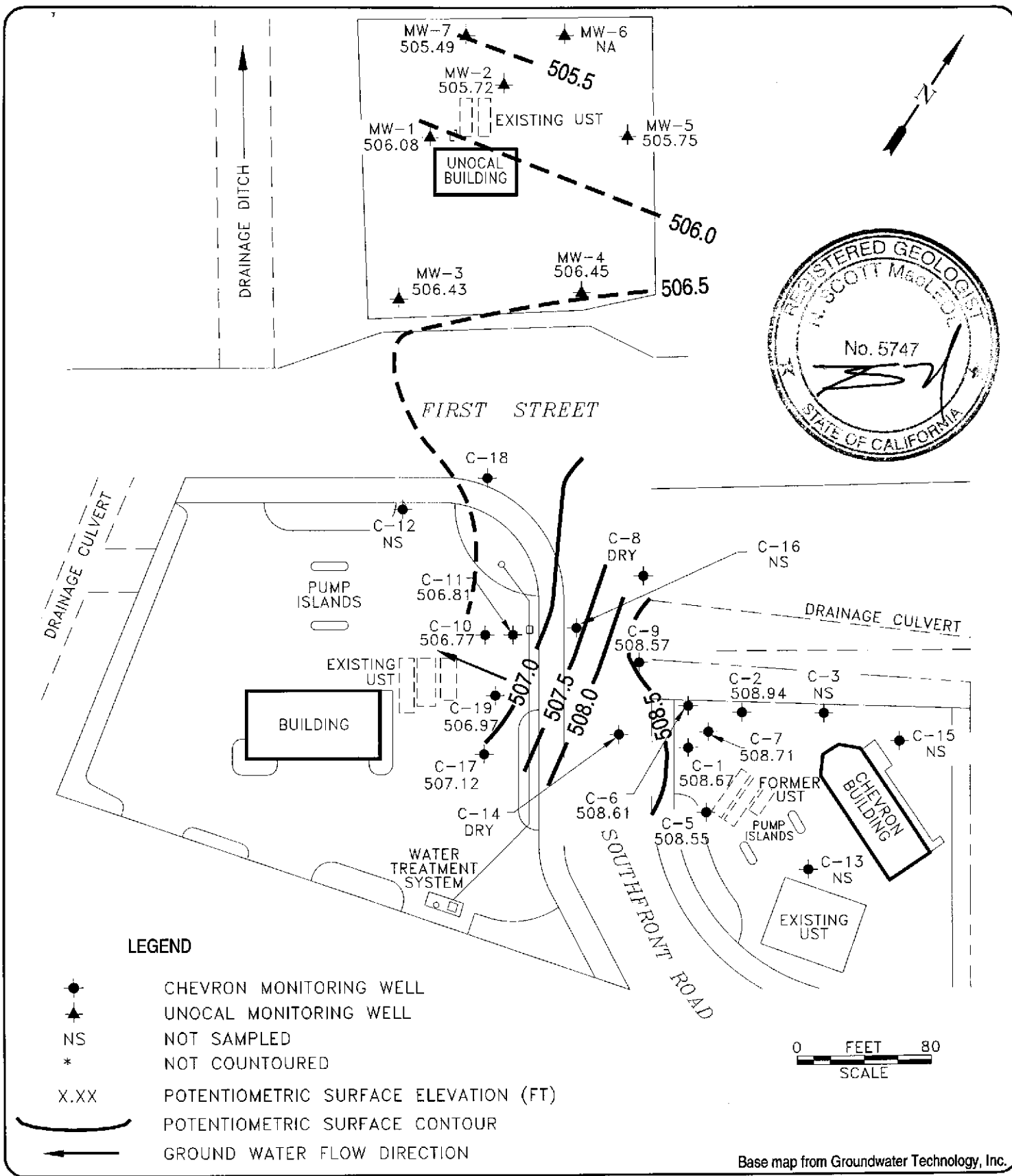

Chevron Station 9-1924
 4904 Southfront Road
 Livermore, California

Ground Water Elevation
 January 18, 1995

FIGURE
1

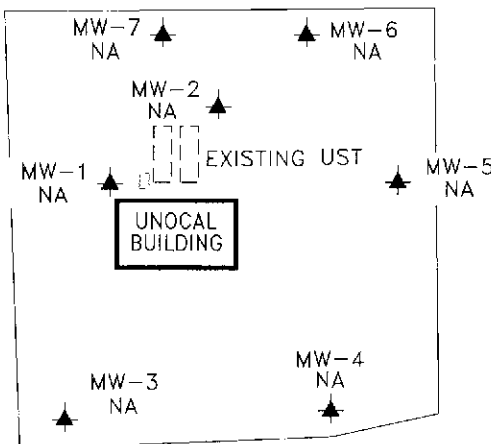

FIRST STREET

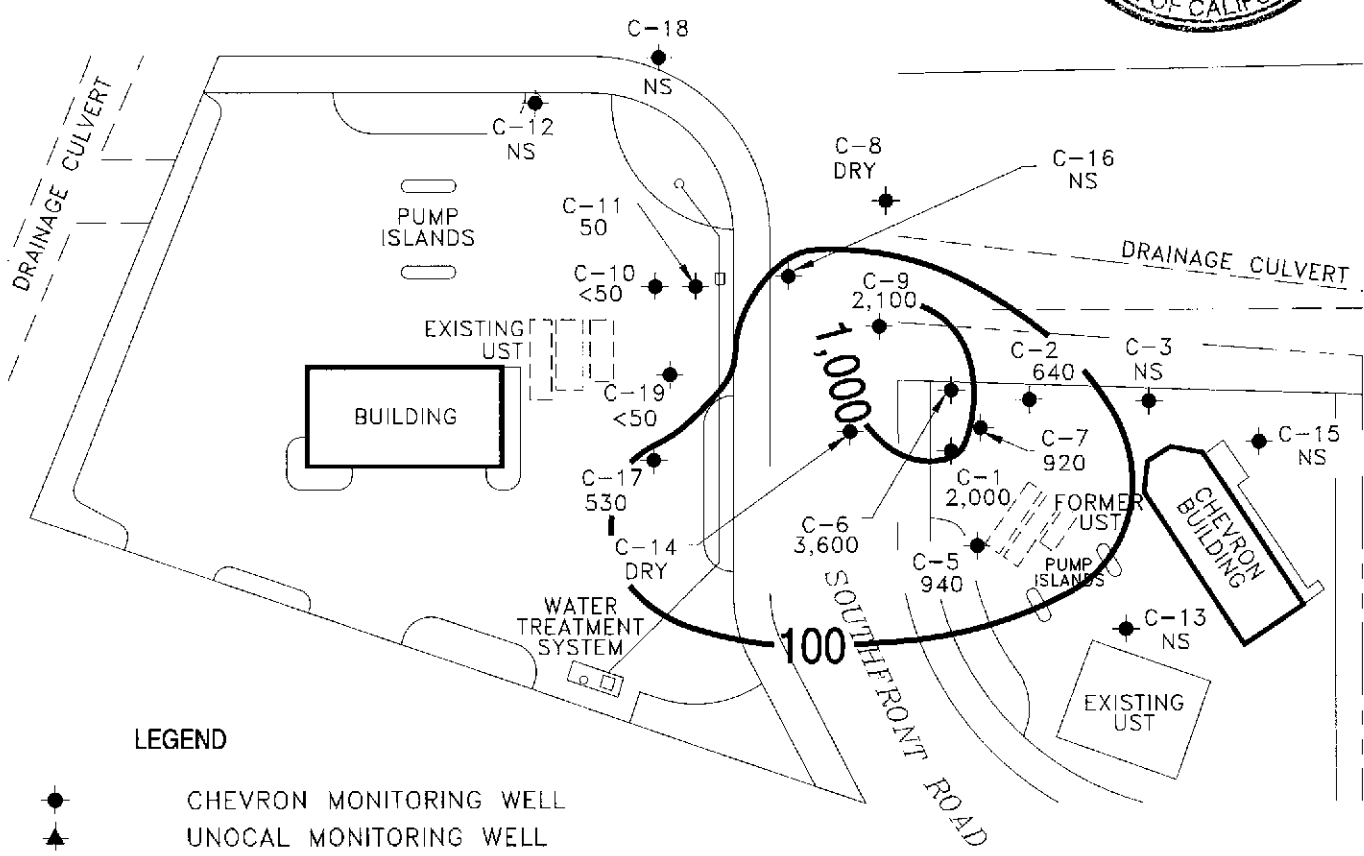

LEGEND

- ◆ CHEVRON MONITORING WELL
- ▲ UNOCAL MONITORING WELL
- NS NOT SAMPLED
- * NOT COUNTED
- X.XX ANALYTE CONCENTRATION (UG/L)
- CONCENTRATION CONTOUR



Base map from Groundwater Technology, Inc.

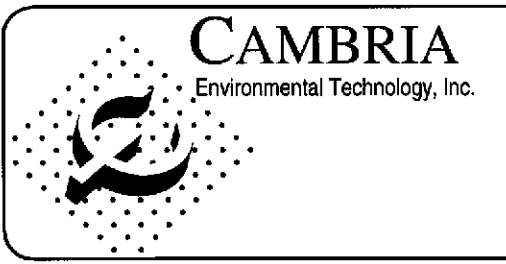

Chevron Station 9-1924
 4904 Southfront Road
 Livermore, California

TPHg Concentrations
 In Ground Water
 January 18, 1995

FIGURE
2

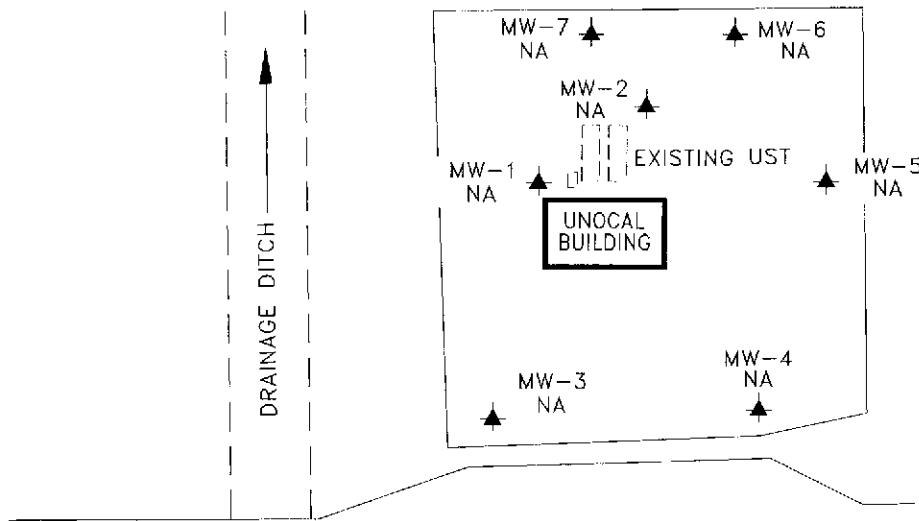

FIRST STREET

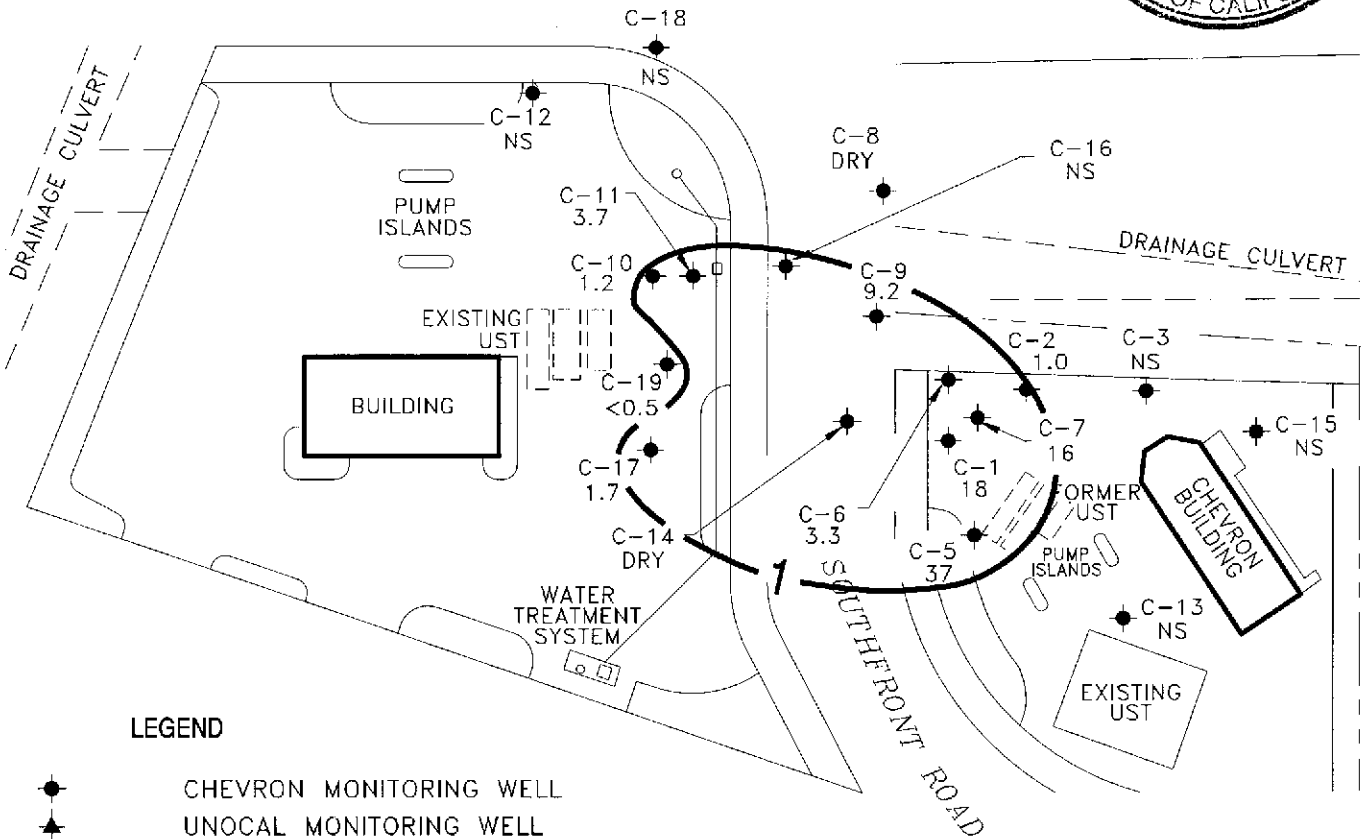

LEGEND

- ◆ CHEVRON MONITORING WELL
- ▲ UNOCAL MONITORING WELL
- NS NOT SAMPLED
- * NOT COUNTED
- X.XX ANALYTE CONCENTRATION (UG/L)
- CONCENTRATION CONTOUR



Base map from Groundwater Technology, Inc.

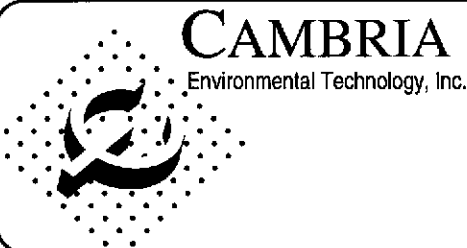

Chevron Station 9-1924
4904 Southfront Road
Livermore, California

Benzene Concentrations
In Ground Water
January 18, 1995

FIGURE
3

Table of Well Data and Analytical Results

Cumulative Table of Well Data and Analytical Results

Vertical Measurements are in feet.

Analytical results are in parts per billion (ppb)

DATE	Well Head Elev.	Ground Water Elev.	Depth To Water	Notes	TPH- Gasoline	Benzene	Toluene	Ethyl- Benzene	Xylene	TOG	1,2- DCA	VC	MC	1,1,1- TCA	1,1- DCA	PCE	Total Lead	CDS	
C-1																			
03/28/86	520.39	508.64	11.75	--	--	--	--	--	--	--	--	--	--	--	--	--	--	--	--
03/15/88	520.39	506.89	13.50	--	27,000	770	87	610	2100	--	--	--	--	--	--	--	--	--	--
05/10/88	520.39	506.74	13.65	--	--	--	--	--	--	--	--	--	--	--	--	--	--	--	--
06/10/88	520.39	505.67	14.72	--	--	--	--	--	--	--	--	--	--	--	--	--	--	--	--
07/25/88	520.39	506.89	13.50	--	--	--	--	--	--	--	--	--	--	--	--	--	--	--	--
10/13/88	520.39	507.50	12.89	--	3200	220	11	62	130	--	--	--	--	--	--	--	--	--	--
01/01/89	520.39	507.50	12.89	--	--	--	--	--	--	--	--	--	--	--	--	--	--	--	--
01/12/89	520.39	--	--	--	4000	820	43	490	260	--	--	--	--	--	--	--	--	--	--
04/10/89	520.39	506.74	13.65	--	4000	100	ND	70	50	ND	ND	--	--	--	--	--	--	--	--
04/10/89	520.39	506.74	13.65	--	4000	100	ND	60	50	--	ND	--	--	--	--	--	--	--	--
06/26/89	520.39	506.45	13.94	--	600	97	20	60	50	ND	3.0	--	--	--	--	--	--	--	--
06/26/89	520.39	506.45	13.94	--	570	86	15	44	35	--	1.7	--	--	--	--	--	--	--	--
10/13/89	520.39	506.47	13.92	--	1600	64	ND	51	48	ND	ND	--	--	--	--	--	--	--	5.0
01/03/90	520.39	506.59	13.80	--	1100	36	0.68	30	30	--	1.0	--	--	--	--	--	--	--	--
05/08/90	520.39	506.48	13.91	--	1300	37	9.2	40	32	--	1.2	--	ND	--	ND	--	--	--	--
09/29/90	520.39	506.46	13.93	--	350	19	1.2	32	31	--	ND	--	0.7	1.4	ND	ND	--	--	--
01/03/91	520.39	506.54	13.85	--	400	12	ND	17	14	--	ND	--	ND	ND	ND	ND	--	--	--
04/12/91	520.39	506.88	13.51	--	--	--	--	--	--	--	--	--	--	--	--	--	--	--	--
09/04/91	520.39	506.29	14.10	--	--	--	--	--	--	--	--	--	--	--	--	--	--	--	--
04/06/92	520.39	507.33	13.06	--	1000	12	0.8	31	31	--	ND	--	ND	ND	ND	ND	--	--	--
07/28/92	520.39	506.46	13.93	--	4200	47	110	96	260	--	--	--	--	--	--	--	--	--	--
10/16/92	520.39	505.94	14.45	--	1800	11	ND	32	55	--	--	--	--	--	--	--	--	--	--
01/14/93	520.39	509.16	11.23	--	2000	24	ND	98	62	--	--	--	--	--	--	--	--	--	--
03/26/93	520.39	509.45	10.94	--	4400	21	12	120	100	--	--	--	--	--	--	--	--	--	--
04/22/93	520.39	504.14	16.25	Sheen	18000	26	44	580	330	--	--	--	--	--	--	--	--	--	--
07/20,21/93	520.39	505.10	15.29	--	7100	73	11	470	470	--	--	--	--	--	--	--	--	--	--
10/20/93	520.39	506.89	13.50	--	880	19	26	260	190	--	--	--	--	--	--	--	--	--	--
01/20/94	520.39	507.13	13.26	--	2900	13	10	130	60	--	--	--	--	--	--	--	--	--	--
04/21/94	520.39	506.93	13.46	--	1400	8.8	7.8	82	34	--	--	--	--	--	--	--	--	--	--
07/21,22/94	520.39	506.93	13.46	--	800	4.7	2.7	34	13	--	--	--	--	--	--	--	--	ND	--
01/18/95	520.39	508.67	11.72	--	2000	18	10	130	10	--	--	--	--	--	--	--	--	--	--

Cumulative Table of Well Data and Analytical Results

Vertical Measurements are in feet.

Analytical results are in parts per billion (ppb)

DATE	Well Head Elev.	Ground Water Elev.	Depth To Water	Notes	TPH- Gasoline	Benzene	Toluene	Ethyl- Benzene	Xylene	TOG	1,2- DCA	VC	MC	1,1,1- TCA	1,1- DCA	PCE	Total Lead	CDS	
C-2																			
03/28/86	520.76	508.78	11.98	--	--	--	--	--	--	--	--	--	--	--	--	--	--	--	--
03/15/88	520.76	506.99	13.77	--	22,000	3900	1900	1200	1200	--	--	--	--	--	--	--	--	--	--
05/10/88	520.76	506.73	14.03	--	--	--	--	--	--	--	--	--	--	--	--	--	--	--	--
06/10/88	520.76	505.64	15.12	--	--	--	--	--	--	--	--	--	--	--	--	--	--	--	--
07/25/88	520.76	506.90	13.86	--	--	--	--	--	--	--	--	--	--	--	--	--	--	--	--
10/13/88	520.76	506.65	14.11	--	ND	ND	ND	ND	ND	--	--	--	--	--	--	--	--	--	--
01/01/89	520.76	507.93	12.83	--	--	--	--	--	--	--	--	--	--	--	--	--	--	--	--
01/12/89	520.76	--	--	--	1000	25	3.0	83	59	--	--	--	--	--	--	--	--	--	--
04/10/89	520.76	506.72	14.04	--	600	2.5	ND	15	12	ND	ND	--	--	--	--	--	--	--	--
04/10/89	520.76	506.72	14.04	--	ND	ND	ND	11	11	--	ND	--	--	--	--	--	--	--	--
06/26/89	520.76	506.42	14.34	--	640	5.3	8.0	18	14	ND	ND	--	--	--	--	--	--	--	--
06/26/89	520.76	506.42	14.34	--	750	3.7	0.6	13	8.2	--	2.0	--	--	--	--	--	--	--	--
10/13/89	520.76	506.84	13.92	--	630	ND	ND	17	10	--	ND	--	--	--	--	--	--	--	--
01/03/90	520.76	506.65	14.11	--	880	3	ND	19	17	--	1.0	--	--	--	--	--	--	--	--
05/08/90	520.76	506.48	14.28	--	340	1.3	2.7	8.4	11	--	1.1	--	ND	--	ND	--	--	--	--
09/29/90	520.76	506.51	14.25	--	74	ND	ND	4.6	1.8	--	ND	--	1.7	0.5	ND	--	--	--	--
01/03/91	520.76	506.61	14.15	--	2000	270	ND	79	93	--	ND	--	ND	ND	ND	ND	--	--	--
04/12/91	520.76	506.90	13.86	--	--	--	--	--	--	--	--	--	--	--	--	--	--	--	--
09/04/91	520.76	506.26	14.50	--	--	--	--	--	--	--	--	--	--	--	--	--	--	--	--
04/06/92	520.76	507.29	13.47	--	1200	ND	ND	54	6.1	--	ND	--	ND	ND	ND	ND	--	--	--
07/28/92	520.76	506.41	14.35	--	1000	5.2	2.9	26	16	--	--	--	--	--	--	--	--	--	--
10/16/92	520.76	505.92	14.84	--	2000	ND	2.2	20	10	--	ND	--	--	--	--	--	--	--	--
01/14/93	520.76	509.54	11.22	--	1800	49	50	31	29	--	--	--	--	--	--	--	--	--	--
03/26/93	520.76	509.99	10.77	--	820	15	12	14	6.0	--	--	--	--	--	--	--	--	--	--
04/22/93	520.76	507.83	12.93	--	2000	12	12	28	29	--	--	--	--	--	--	--	--	--	--
07/20,21/93	520.76	504.74	16.02	--	1100	28	8.0	4.0	4.0	--	--	--	--	--	--	--	--	--	--
10/20/93	520.76	506.92	13.84	--	1600	140	18	22	27	--	--	--	--	--	--	--	--	--	--
01/20/94	520.76	507.16	13.60	--	760	36	3.0	7.0	3.0	--	--	--	--	--	--	--	--	--	--
04/21/94	520.76	506.66	14.10	--	430	23	2.8	6.8	6.8	--	--	--	--	--	--	--	--	--	--
07/21,22/94	520.76	506.93	13.83	--	1200	10	2.8	5.2	53	--	--	--	--	--	--	--	--	ND	--
01/18/95	520.76	508.94	11.82	--	640	1.0	<0.5	5.7	7.7	--	--	--	--	--	--	--	--	--	--

Cumulative Table of Well Data and Analytical Results

Vertical Measurements are in feet.

Analytical results are in parts per billion (ppb)

DATE	Well Head Elev.	Ground Water Elev.	Depth To Water	Notes	TPH- Gasoline	Benzene	Toluene	Ethyl- Benzene	Xylene	TOG	1,2- DCA	VC	MC	1,1,1- TCA	1,1- DCA	PCE	Total Lead	CDS	
C-3																			
03/28/86	521.31	509.07	12.24	--	--	--	--	--	--	--	--	--	--	--	--	--	--	--	--
03/15/88	521.31	507.10	14.21	--	2100	86	8.0	30	36	--	--	--	--	--	--	--	--	--	--
05/10/88	521.31	506.88	14.43	--	--	--	--	--	--	--	--	--	--	--	--	--	--	--	--
06/10/88	521.31	505.78	15.53	--	--	--	--	--	--	--	--	--	--	--	--	--	--	--	--
07/25/88	521.31	507.09	14.22	--	--	--	--	--	--	--	--	--	--	--	--	--	--	--	--
10/13/88	521.31	507.21	14.10	--	ND	ND	ND	ND	ND	--	--	--	--	--	--	--	--	--	--
01/01/89	521.31	508.61	12.70	--	--	--	--	--	--	--	--	--	--	--	--	--	--	--	--
04/10/89	521.31	506.95	14.36	--	200	2.1	ND	4.4	2.6	ND	1.4	--	--	--	--	--	--	--	--
06/26/89	521.31	506.57	14.74	--	260	1.1	0.7	4.9	1.6	ND	1.5	--	--	--	--	--	--	--	--
10/13/89	521.31	506.61	14.70	--	ND	ND	ND	ND	ND	--	ND	--	--	--	--	--	--	--	--
01/03/90	521.31	506.89	14.42	--	ND	ND	ND	0.9	1.4	--	0.7	--	--	--	--	--	--	--	--
05/08/90	521.31	506.66	14.65	--	ND	ND	ND	ND	ND	--	0.7	--	ND	--	ND	--	--	--	--
09/27/90	521.31	506.64	14.67	--	71	ND	1.0	ND	ND	--	ND	--	1.1	1.6	ND	--	--	--	--
01/03/91	521.31	506.73	14.58	--	57	ND	ND	ND	ND	--	ND	--	ND	ND	ND	ND	--	--	--
04/12/91	521.31	507.08	14.23	--	98	ND	ND	1.6	ND	--	ND	--	ND	ND	ND	ND	--	--	--
09/04/91	521.31	506.43	14.88	--	64	ND	ND	ND	ND	--	ND	--	ND	ND	ND	ND	--	--	--
04/06/92	521.31	507.48	13.83	--	88	ND	ND	0.8	ND	--	ND	--	ND	ND	ND	ND	--	--	--
07/28/92	521.31	506.51	14.80	--	80	ND	ND	0.5	1.1	--	--	--	--	--	--	--	--	--	--
10/16/92	521.31	506.08	15.23	--	1400	ND	ND	6.6	11	--	--	--	--	--	--	--	--	--	--
01/14/93	521.31	509.86	11.45	--	100	ND	ND	ND	1.3	--	--	--	--	--	--	--	--	--	--
03/26/93	521.31	510.04	11.27	--	74	0.7	1.0	ND	ND	--	--	--	--	--	--	--	--	--	--
04/22/93	521.31	508.70	12.61	--	ND	ND	ND	ND	ND	--	--	--	--	--	--	--	--	--	--
07/20,21/93	521.31	505.14	16.17	--	ND	ND	ND	ND	ND	--	--	--	--	--	--	--	--	--	--
10/20/93	521.31	507.08	14.23	--	ND	ND	1.0	ND	0.8	--	--	--	--	--	--	--	--	--	--
01/20/94	521.31	507.30	14.01	--	ND	ND	ND	ND	ND	--	--	--	--	--	--	--	--	--	--
04/21/94	521.31	506.98	14.33	--	ND	ND	ND	ND	ND	--	--	--	--	--	--	--	--	--	--
07/21,22/94	521.31	507.00	14.31	--	ND	ND	ND	ND	ND	--	--	--	--	--	--	--	--	ND	--

WELL NO LONGER MONITORED OR SAMPLED

Cumulative Table of Well Data and Analytical Results

Vertical Measurements are in feet.

Analytical results are in parts per billion (ppb)

DATE	Well Head Elev.	Ground Water Elev.	Depth To Water	Notes	TPH- Gasoline	Benzene	Toluene	Ethyl- Benzene	Xylene	TOG	1,2- DCA	VC	MC	1,1,1- TCA	1,1- DCA	PCE	Total Lead	CDS
C-5																		
03/28/86	520.82	508.82	12.00	--		--	--	--	--	--	--	--	--	--	--	--	--	--
03/15/88	520.82	507.07	13.75	--	1600	82	7.0	77	95	--	--	--	--	--	--	--	--	--
05/10/88	520.82	506.90	13.92	--	--	--	--	--	--	--	--	--	--	--	--	--	--	--
07/10/88	520.82	507.10	13.72	--	--	--	--	--	--	--	--	--	--	--	--	--	--	--
07/25/88	520.82	507.10	13.72	--	--	--	--	--	--	--	--	--	--	--	--	--	--	--
10/13/88	520.82	506.98	13.84	--	2500	ND	ND	ND	ND	--	--	--	--	--	--	--	--	--
01/01/89	520.82	507.41	13.41	--	--	--	--	--	--	--	--	--	--	--	--	--	--	--
01/12/89	520.82	--	--	--	ND	42	3.0	44	52	--	--	--	--	--	--	--	--	--
04/10/89	520.82	--	13.88	--	180	2.6	ND	6.2	5.5	ND	1.4	--	--	--	--	--	--	--
06/26/89	520.82	506.68	14.14	--	420	7.6	0.8	40	56	ND	1.5	--	--	--	--	--	--	--
10/13/89	520.82	506.67	14.15	--	620	ND	ND	10	ND	ND	ND	--	--	--	--	--	--	--
01/03/90	520.82	506.72	14.10	--	ND	0.7	ND	8.0	6.0	--	ND	--	--	--	--	--	--	--
05/08/90	520.82	506.82	14.00	--	140	0.6	0.8	11	7.2	--	0.8	--	ND	--	ND	--	--	--
09/27/90	520.82	506.82	14.00	--	360	ND	3.2	5.2	6.4	--	ND	--	0.7	ND	ND	--	--	--
01/03/91	520.82	506.82	14.00	--	90	ND	ND	ND	3.0	--	ND	--	ND	ND	ND	ND	--	--
04/12/91	520.82	507.11	13.71	--	270	12	ND	19	7.0	--	0.5	--	ND	ND	ND	ND	--	--
09/04/91	520.82	506.52	14.30	--	ND	ND	ND	ND	ND	--	ND	--	ND	ND	ND	ND	--	--
04/06/92	520.82	507.53	13.29	--	670	12	ND	40	ND	--	ND	--	ND	ND	ND	ND	--	--
07/28/92	520.82	506.69	14.13	--	130	15	ND	1.8	0.5	--	--	--	--	--	--	--	--	--
10/16/92	520.82	506.14	14.68	--	ND	ND	ND	ND	1.2	--	--	--	--	--	--	--	--	--
01/14/93	520.82	508.95	11.87	--	2300	13	ND	110	10	--	--	--	--	--	--	--	--	--
03/26/93	520.82	--	--	--	--	--	--	--	--	--	--	--	--	--	--	--	--	--
04/22/93	520.82	508.70	12.12	--	2300	220	18	120	65	--	--	--	--	--	--	--	--	--
07/20,21/93	520.82	504.78	16.04	--	970	18	5.0	8.0	14	--	--	--	--	--	--	--	--	--
10/20/93	520.82	506.72	14.10	--	2200	7.0	5.0	3.0	15	--	--	--	--	--	--	--	--	--
01/20/94	520.82	507.22	13.60	--	440	2.0	1.0	11	0.6	--	--	--	--	--	--	--	--	--
04/21/94	520.82	507.01	13.81	--	490	2.7	2.6	21	1.5	--	--	--	--	--	--	--	--	--
07/21,22/94	520.82	507.00	13.82	--	370	0.9	ND	6.5	1.0	--	--	--	--	--	--	--	ND	--
01/18/95	520.82	508.55	12.27	--	940	37	22	14	7.3	--	--	--	--	--	--	--	--	--

Cumulative Table of Well Data and Analytical Results

Vertical Measurements are in feet.

Analytical results are in parts per billion (ppb)

DATE	Well Head Elev.	Ground Water Elev.	Depth To Water	Notes	TPH- Gasoline	Benzene	Toluene	Ethyl- Benzene	Xylene	TOG	1,2- DCA	VC	MC	1,1,1- TCA	1,1- DCA	PCE	Total Lead	CDS	
C-6																			
03/26/86	519.62	508.50	11.12	--	--	--	--	--	--	--	--	--	--	--	--	--	--	--	--
03/15/88	519.62	506.69	12.93	--	46,000	870	4600	1500	8200	--	--	--	--	--	--	--	--	--	--
05/10/88	519.62	506.59	13.03	--	86,000	1400	10,000	3000	19,000	--	--	--	--	--	--	--	--	--	--
06/10/88	519.62	505.51	14.11	--	--	--	--	--	--	--	--	--	--	--	--	--	--	--	--
07/25/88	519.62	506.67	12.95	--	--	--	--	--	--	--	--	--	--	--	--	--	--	--	--
10/13/88	519.62	506.48	13.14	--	5300	300	600	260	1,600	--	--	--	--	--	--	--	--	--	--
01/01/89	519.62	507.48	12.14	--	--	--	--	--	--	--	--	--	--	--	--	--	--	--	--
01/12/89	519.62	--	--	--	5000	260	110	270	720	--	--	--	--	--	--	--	--	--	--
04/12/89	519.62	506.64	12.98	--	5000	90	190	190	680	4.0	ND	--	--	--	--	--	--	--	--
06/26/89	519.62	506.23	13.39	--	3600	77	250	140	610	ND	ND	--	--	--	--	--	--	--	--
10/13/89	519.62	506.22	13.40	--	3500	32	81	100	530	ND	ND	--	--	--	--	--	--	--	--
01/03/90	519.62	506.44	13.18	--	3200	20	97	65	410	--	1.0	--	--	--	--	--	--	--	--
05/08/90	519.62	506.23	13.39	--	1800	17	140	ND	400	--	1.6	--	ND	--	ND	--	--	--	--
09/29/90	519.62	506.30	13.32	--	8000	58	210	260	2100	--	1.0	--	ND	2.4	1.6	--	--	--	--
01/03/91	519.62	506.43	13.19	--	2300	4.0	79	59	380	--	0.5	--	ND	ND	ND	ND	--	--	--
04/12/91	519.62	506.71	12.91	--	--	--	--	--	--	--	--	--	--	--	--	--	--	--	--
09/04/91	519.62	506.06	13.56	--	--	--	--	--	--	--	--	--	--	--	--	--	--	--	--
04/06/92	519.62	507.14	12.48	--	44,000	ND	120	740	3400	--	ND	--	ND	ND	ND	ND	--	--	--
07/28/92	519.62	506.15	13.47	--	120,000	220	1100	3000	13,000	--	--	--	--	--	--	--	--	--	--
10/16/92	519.62	505.67	13.95	--	570,000	ND	830	3300	9600	--	--	--	--	--	--	--	--	--	--
01/14/93	519.62	509.23	10.39	--	19,000	ND	25	460	980	--	--	--	--	--	--	--	--	--	--
03/26/93	519.62	509.79	9.83	--	11,000	30	90	290	1100	--	--	--	--	--	--	--	--	--	--
04/22/93	519.62	508.30	11.32	--	20,000	29	170	640	2400	--	--	--	--	--	--	--	--	--	--
07/20,21/93	519.62	504.70	14.92	--	32,000	130	490	1000	4900	--	--	--	--	--	--	--	--	--	--
10/20/93	519.62	506.71	12.91	--	77,000	290	790	2500	7600	--	--	--	--	--	--	--	--	--	--
01/20/94	519.62	506.94	12.68	--	22,000	10	86	510	29	--	--	--	--	--	--	--	--	--	--
04/21/94	519.62	506.74	12.88	--	6500	17	42	160	210	--	--	--	--	--	--	--	--	--	--
07/21,22/94	519.62	506.78	12.84	--	4500	ND	7.1	130	130	--	--	--	--	--	--	--	--	ND	--
01/18/95	519.62	508.61	11.01	--	3600	3.3	6.7	62	78	--	--	--	--	--	--	--	--	--	--

Cumulative Table of Well Data and Analytical Results

Vertical Measurements are in feet.

Analytical results are in parts per billion (ppb)

DATE	Well Head Elev.	Ground Water Elev.	Depth To Water	Notes	TPH- Gasoline	Benzene	Toluene	Ethyl- Benzene	Xylene	TOG	1,2- DCA	VC	MC	1,1,1- TCA	1,1- DCA	PCE	Total Lead	CDS
C-7																		
03/28/86	520.30	508.63	11.67	--	--	--	--	--	--	--	--	--	--	--	--	--	--	--
03/15/88	520.30	506.82	13.48	--	8000	98	690	120	120	--	--	--	--	--	--	--	--	--
05/10/88	520.30	506.70	13.60	--	--	--	--	--	--	--	--	--	--	--	--	--	--	--
06/10/88	520.30	505.62	14.68	--	--	--	--	--	--	--	--	--	--	--	--	--	--	--
07/25/88	520.30	506.87	13.43	--	--	--	--	--	--	--	--	--	--	--	--	--	--	--
10/13/88	520.30	506.69	13.61	--	16,000	4400	220	1000	3000	--	--	--	--	--	--	--	--	--
01/01/89	520.30	507.64	12.66	--	--	--	--	--	--	--	--	--	--	--	--	--	--	--
01/12/89	520.30	--	--	--	8000	950	47	670	640	--	--	--	--	--	--	--	--	--
04/12/89	520.30	506.70	13.60	--	6000	1100	30	760	370	ND	ND	--	--	--	--	--	--	--
06/26/89	520.30	506.42	13.88	--	6000	1300	50	600	340	ND	ND	--	--	--	--	--	--	--
10/13/89	520.30	506.49	13.81	--	3900	1300	ND	160	150	--	ND	--	--	--	--	--	--	--
01/03/90	520.30	506.59	13.71	--	5600	1200	13	180	200	--	1.0	--	--	--	--	--	--	--
05/08/90	520.30	506.45	13.85	--	3500	1100	15	110	140	--	1.7	--	ND	--	ND	--	--	--
09/29/90	520.30	506.50	13.80	--	2400	580	ND	46	68	--	0.7	--	ND	ND	ND	ND	--	--
01/03/91	520.30	506.59	13.71	--	2500	300	2.0	110	120	--	0.7	--	ND	ND	ND	ND	--	--
04/12/91	520.30	506.84	13.46	--	2300	190	1.0	81	87	--	0.6	--	ND	ND	ND	ND	--	--
09/04/91	520.30	506.21	14.09	--	--	--	--	--	--	--	--	--	--	--	--	--	--	--
10/07/91	520.30	--	--	--	4700	170	1.9	97	59	--	ND	--	24	ND	ND	ND	--	--
04/06/92	520.30	507.28	13.02	--	2400	95	0.8	110	100	--	ND	--	ND	ND	ND	ND	--	--
07/28/92	520.30	506.54	13.76	--	2000	120	3.4	110	110	--	--	--	--	--	--	--	--	--
10/16/92	520.30	505.88	14.42	--	2700	130	4.2	68	74	--	--	--	--	--	--	--	--	--
01/14/93	520.30	509.32	10.98	--	7800	160	33	380	210	--	--	--	--	--	--	--	--	--
03/26/93	520.30	509.69	10.61	--	1400	39	9.0	28	15	--	--	--	--	--	--	--	--	--
04/22/93	520.30	508.46	11.84	--	3800	130	18	43	36	--	--	--	--	--	--	--	--	--
07/20,21/93	520.30	504.94	15.36	Sheen	1900	35	18	61	87	--	--	--	--	--	--	--	--	--
10/20/93	520.30	506.89	13.41	--	5500	72	26	250	160	--	--	--	--	--	--	--	--	--
01/20/94	520.30	507.11	13.19	Sheen	3600	12	12	150	69	--	--	--	--	--	--	--	--	--
04/21/94	520.30	506.97	13.33	--	2100	62	11	170	68	--	--	--	--	--	--	--	--	--
07/21,22/94	520.30	506.91	13.39	--	1700	50	4.4	110	22	--	--	--	--	--	--	--	ND	--
01/18/95	520.30	508.71	11.59	--	920	16	<0.5	30	12	--	--	--	--	--	--	--	--	--

Cumulative Table of Well Data and Analytical Results

Vertical Measurements are in feet.

Analytical results are in parts per billion (ppb)

DATE	Well Head Elev.	Ground Water Elev.	Depth To Water	Notes	TPH- Gasoline	Benzene	Toluene	Ethyl- Benzene	Xylene	TOG	1,2- DCA	VC	MC	1,1,1- TCA	1,1- DCA	PCE	Total Lead	CDS	
C-8																			
03/28/86	519.74	507.96	11.78	--	--	--	--	--	--	--	--	--	--	--	--	--	--	--	--
03/15/88	519.74	506.11	13.63	--	7500	360	25	10	ND	--	--	--	--	--	--	--	--	--	--
05/10/88	519.74	506.00	13.74	--	--	--	--	--	--	--	--	--	--	--	--	--	--	--	--
06/10/88	519.74	504.85	14.89	--	--	--	--	--	--	--	--	--	--	--	--	--	--	--	--
07/25/88	519.74	506.09	13.65	--	--	--	--	--	--	--	--	--	--	--	--	--	--	--	--
10/13/88	519.74	505.96	13.78	--	ND	6.0	5.3	ND	ND	--	--	--	--	--	--	--	--	--	--
01/01/89	519.74	507.06	12.68	--	--	--	--	--	--	--	--	--	--	--	--	--	--	--	--
01/12/89	519.74	--	--	--	ND	37	4.0	1.0	5.0	--	--	--	--	--	--	--	--	--	--
04/12/89	519.74	505.97	13.77	--	3000	13	ND	ND	ND	12	5.0	--	--	--	--	--	--	--	--
06/26/89	519.74	505.71	14.03	--	780	14	6.0	ND	6.0	ND	4.0	--	--	--	--	--	--	--	--
10/13/89	519.74	505.68	14.06	--	ND	ND	ND	ND	ND	ND	ND	--	--	--	--	--	--	--	--
01/03/90	519.74	506.00	13.74	--	910	ND	ND	1.0	1.0	--	1.5	--	--	--	--	--	--	--	--
05/07/90	519.74	505.64	14.10	--	620	3.9	6.0	0.5	3.4	--	1.9	--	ND	--	ND	--	--	--	--
09/29/90	519.74	505.77	13.97	--	77	ND	1.4	ND	ND	--	ND	--	0.6	ND	ND	--	--	--	--
01/03/91	519.74	505.93	13.81	--	67	2.0	2.0	ND	2.0	--	ND	--	0.7	ND	ND	ND	--	--	--
04/12/91	519.74	506.14	13.60	--	180	4.0	ND	ND	ND	--	0.6	--	ND	ND	ND	ND	--	--	--
09/04/91	519.74	505.60	14.14	--	140	1.8	4.7	0.8	4.8	--	ND	--	ND	ND	ND	ND	--	--	--
04/06/92	519.74	506.62	13.12	--	150	ND	ND	ND	ND	--	ND	--	ND	ND	ND	ND	--	--	--
07/28/92	519.74	505.64	14.10	--	90	ND	ND	ND	0.8	--	--	--	--	--	--	--	--	--	--
10/16/92	519.74	505.17	14.57	--	51	ND	ND	ND	ND	--	--	--	--	--	--	--	--	--	--
01/14/93	519.74	508.79	10.95	--	120	ND	1.6	1.0	3.5	--	--	--	--	--	--	--	--	--	--
03/26/93	519.74	--	--	--	--	--	--	--	--	--	--	--	--	--	--	--	--	--	--
04/22/93	519.74	507.67	12.07	--	68	ND	0.6	0.6	0.8	--	--	--	--	--	--	--	--	--	--
07/20,21/93	519.74	504.04	15.70	--	ND	ND	ND	ND	ND	--	--	--	--	--	--	--	--	--	--
10/20/93	519.74	506.23	13.51	--	ND	ND	ND	ND	ND	--	--	--	--	--	--	--	--	--	--
01/20/94	519.74	506.23	13.51	--	ND	ND	ND	ND	ND	--	--	--	--	--	--	--	--	--	--
04/21/94	519.74	506.06	13.68	--	ND	ND	ND	ND	ND	--	--	--	--	--	--	--	--	--	--
07/21,22/94	519.74	506.24	13.50	--	51	ND	ND	ND	ND	--	--	--	--	--	--	--	--	ND	--
01/18/95	519.74	--	--	Dry	--	--	--	--	--	--	--	--	--	--	--	--	--	--	--

Cumulative Table of Well Data and Analytical Results

Vertical Measurements are in feet.

Analytical results are in parts per billion (ppb)

DATE	Well Head Elev.	Ground Water Elev.	Depth To Water	Notes	TPH- Gasoline	Benzene	Toluene	Ethyl- Benzene	Xylene	TOG	1,2- DCA	VC	MC	1,1,1- TCA	1,1- DCA	PCE	Total Lead	CDS
C-9																		
03/28/86	519.52	508.28	11.24	--	--	--	--	--	--	--	--	--	--	--	--	--	--	--
03/15/88	519.52	506.60	12.92	--	29,000	540	560	580	3900	--	--	--	--	--	--	--	--	--
05/10/88	519.52	506.40	13.12	--	--	--	--	--	--	--	--	--	--	--	--	--	--	--
06/10/88	519.52	505.36	14.16	--	--	--	--	--	--	--	--	--	--	--	--	--	--	--
07/25/88	519.52	506.52	13.00	--	--	--	--	--	--	--	--	--	--	--	--	--	--	--
10/13/88	519.52	506.39	13.13	--	2200	57	8.0	20	150	--	--	--	--	--	--	--	--	--
01/01/89	519.52	507.33	12.19	--	--	--	--	--	--	--	--	--	--	--	--	--	--	--
01/12/89	519.52	--	--	--	2000	39	12	51	46	--	--	--	--	--	--	--	--	--
04/12/89	519.52	506.41	13.11	--	6000	16	20	55	240	ND	2.1	--	--	--	--	--	--	--
04/11/89	519.52	506.41	13.11	--	6000	14	25	45	290	--	ND	--	--	--	--	--	--	--
06/26/89	519.52	506.12	13.40	--	3900	37	63	140	690	ND	ND	--	--	--	--	--	--	--
10/13/89	519.52	506.06	13.46	--	1300	7.0	ND	26	50	ND	ND	--	--	--	--	--	--	--
01/03/90	519.52	506.22	13.30	--	1500	ND	0.7	202	37	--	1.5	--	--	--	--	--	--	--
05/07/90	519.52	506.04	13.48	--	7100	21	33	89	500	--	1.9	--	ND	--	ND	--	--	--
09/29/90	519.52	506.13	13.39	--	1000	21	3.9	31	110	--	1.0	--	0.7	1.8	1.0	--	--	--
01/03/91	519.72	506.44	13.28	--	3200	ND	ND	32	140	--	0.8	--	ND	ND	ND	ND	--	--
04/12/91	519.72	506.72	13.00	--	--	--	--	--	--	--	--	--	--	--	--	--	--	--
09/04/91	519.72	506.11	13.61	--	--	--	--	--	--	--	--	--	--	--	--	--	--	--
04/06/92	519.72	507.18	12.54	--	2800	ND	ND	33	130	--	ND	--	ND	ND	ND	ND	--	--
07/28/92	519.72	506.27	13.45	--	1000	6.5	2.4	17	37	--	--	--	--	--	--	--	--	--
10/16/92	519.72	505.74	13.98	--	190,000	ND	730	960	2000	--	--	--	--	--	--	--	--	--
01/14/93	519.72	509.28	10.44	--	2200	ND	ND	27	77	--	--	--	--	--	--	--	--	--
03/26/93	519.72	--	--	--	--	--	--	--	--	--	--	--	--	--	--	--	--	--
04/22/93	519.72	508.29	11.43	--	7300	60	40	68	98	--	--	--	--	--	--	--	--	--
07/20,21/93	519.72	504.52	15.20	--	30,000	160	130	450	1100	--	--	--	--	--	--	--	--	--
10/20/93	519.72	506.76	12.96	--	36,000	22	200	440	930	--	--	--	--	--	--	--	--	--
01/20/94	519.72	506.88	12.84	--	12000	55	57	27	210	--	--	--	--	--	--	--	--	--
04/21/94	519.72	506.58	13.14	--	2200	11	12	23	19	--	--	--	--	--	--	--	--	--
07/21,22/94	519.72	506.77	12.95	--	1100	ND	4.0	14	10	--	--	--	--	--	--	--	13	--
01/18/95	519.72	508.57	11.15	--	2100	9.2	13	19	13	--	--	--	--	--	--	--	--	--

Cumulative Table of Well Data and Analytical Results

Vertical Measurements are in feet.

Analytical results are in parts per billion (ppb)

DATE	Well Head Elev.	Ground Water Elev.	Depth To Water	Notes	TPH- Gasoline	Benzene	Toluene	Ethyl- Benzene	Xylene	TOG	1,2- DCA	VC	MC	1,1,1- TCA	1,1- DCA	PCE	Total Lead	CDS	
C-10																			
03/28/86	520.41	--	--	--	--	--	--	--	--	--	--	--	--	--	--	--	--	--	--
03/15/88	520.41	505.55	14.86	--	90	7.0	ND	ND	ND	--	--	--	--	--	--	--	--	--	--
05/10/88	520.41	505.51	14.90	--	--	--	--	--	--	--	--	--	--	--	--	--	--	--	--
06/10/88	520.41	504.47	15.94	--	--	--	--	--	--	--	--	--	--	--	--	--	--	--	--
07/25/88	520.41	505.56	14.85	--	--	--	--	--	--	--	--	--	--	--	--	--	--	--	--
10/13/88	520.41	505.51	14.90	--	ND	ND	ND	ND	ND	--	--	--	--	--	--	--	--	--	--
01/01/89	520.41	505.58	14.83	--	--	--	--	--	--	--	--	--	--	--	--	--	--	--	--
01/12/89	520.41	--	--	--	ND	ND	ND	ND	ND	--	--	--	--	--	--	--	--	--	--
04/11/89	520.41	505.51	14.90	--	ND	4.8	ND	ND	ND	ND	6.1	--	--	--	--	--	--	--	--
06/26/89	520.41	505.29	15.12	--	ND	0.7	ND	ND	1.5	4.0	ND	--	--	--	--	--	--	--	--
10/13/89	520.41	505.30	15.11	--	ND	ND	ND	ND	ND	ND	ND	--	--	--	--	--	--	--	--
01/03/90	520.41	505.40	15.01	--	ND	ND	ND	ND	ND	--	3.0	--	--	--	--	--	--	--	--
05/07/90	520.41	504.88	15.53	--	ND	ND	ND	ND	ND	--	ND	--	ND	--	ND	--	--	--	--
09/27/90	520.41	505.21	15.20	--	ND	ND	ND	ND	ND	--	ND	--	1.2	ND	ND	--	--	--	--
01/03/91	520.41	505.35	15.06	--	ND	ND	ND	ND	ND	--	ND	--	ND	ND	ND	ND	--	--	--
04/12/91	520.41	505.55	14.86	--	110	16	ND	2.9	2.7	--	1.0	--	ND	ND	ND	ND	--	--	--
09/04/91	520.41	505.19	15.22	--	ND	ND	ND	ND	ND	--	ND	--	ND	ND	ND	ND	--	--	--
04/06/92	520.41	506.20	14.21	--	57	ND	ND	ND	ND	--	1.1	--	ND	ND	ND	ND	--	--	--
07/28/92	520.41	505.63	14.78	--	ND	ND	ND	ND	ND	--	--	--	--	--	--	--	--	--	--
10/16/92	520.41	504.90	15.51	--	ND	ND	ND	ND	ND	--	--	--	--	--	--	--	--	--	--
01/14/93	520.41	506.97	13.44	--	88	4.7	ND	2.3	1.6	--	--	--	--	--	--	--	--	--	--
03/26/93	520.41	507.86	12.55	--	ND	ND	ND	ND	ND	--	--	--	--	--	--	--	--	--	--
04/22/93	520.41	506.67	13.74	--	ND	ND	ND	ND	ND	--	--	--	--	--	--	--	--	--	--
07/20,21/93	520.41	503.92	16.49	--	100	ND	ND	ND	ND	--	--	--	--	--	--	--	--	--	--
10/20/93	520.41	505.77	14.64	--	ND	ND	ND	ND	ND	--	--	--	--	--	--	--	--	--	--
01/20/94	520.41	506.02	14.39	--	ND	ND	ND	ND	ND	--	--	--	--	--	--	--	--	--	--
04/21/94	520.41	505.79	14.62	--	ND	0.8	ND	ND	ND	--	--	--	--	--	--	--	--	--	--
07/21,22/94	520.41	505.84	14.57	--	ND	ND	ND	ND	ND	--	--	--	--	--	--	--	--	ND	--
01/18/95	520.41	506.77	13.64	--	<50	1.2	<0.5	<0.5	<0.5	--	--	--	--	--	--	--	--	--	--

Cumulative Table of Well Data and Analytical Results

Vertical Measurements are in feet.

Analytical results are in parts per billion (ppb)

DATE	Well Head Elev.	Ground Water Elev.	Depth To Water	Notes	TPH- Gasoline	Benzene	Toluene	Ethyl- Benzene	Xylene	TOG	1,2- DCA	VC	MC	1,1,1- TCA	1,1- DCA	PCE	Total Lead	CDS	
C-11																			
03/28/86	520.04	506.22	13.82	--	--	--	--	--	--	--	--	--	--	--	--	--	--	--	--
03/15/88	520.04	505.55	14.49	--	--	--	--	--	--	--	--	--	--	--	--	--	--	--	--
05/10/88	520.04	505.73	14.31	--	--	--	--	--	--	--	--	--	--	--	--	--	--	--	--
06/10/88	520.04	504.57	15.47	--	--	--	--	--	--	--	--	--	--	--	--	--	--	--	--
07/25/88	520.04	506.44	13.60	--	--	--	--	--	--	--	--	--	--	--	--	--	--	--	--
10/14/88	520.04	505.51	14.53	--	2.0	240	33	4.7	67	--	--	--	--	--	--	--	--	--	--
01/01/89	520.04	505.94	14.10	--	--	--	--	--	--	--	--	--	--	--	--	--	--	--	--
01/12/89	520.04	--	--	--	ND	ND	0.8	ND	ND	--	--	--	--	--	--	--	--	--	--
04/12/89	520.04	505.68	14.36	--	ND	4.3	ND	ND	ND	ND	ND	--	--	--	--	--	--	--	--
06/26/89	520.04	505.46	14.58	--	ND	2.0	ND	ND	ND	4.0	ND	--	--	--	--	--	--	--	--
10/13/89	520.04	505.33	14.71	--	ND	ND	ND	ND	ND	ND	ND	--	--	--	--	--	--	--	--
01/03/90	520.04	505.43	14.61	--	ND	ND	ND	ND	0.7	--	ND	--	--	--	--	--	--	--	--
05/08/90	520.04	504.51	15.53	--	110	12	11	0.9	22	--	ND	--	ND	--	ND	--	--	--	--
09/28/90	520.04	504.53	15.51	--	ND	2.0	1.4	ND	3.3	--	ND	--	1.2	ND	ND	--	--	--	--
01/03/91	520.04	505.41	14.63	--	ND	2.0	ND	ND	2.0	--	ND	--	ND	ND	ND	1.0	--	--	--
04/12/91	520.04	505.74	14.30	--	--	--	--	--	--	--	--	--	--	--	--	--	--	--	--
09/04/91	520.04	505.20	14.84	--	--	--	--	--	--	--	--	--	--	--	--	--	--	--	--
04/06/92	520.04	506.48	13.56	--	ND	ND	ND	ND	ND	--	ND	--	ND	ND	ND	ND	--	--	--
07/28/92	520.04	505.65	14.39	--	ND	ND	ND	ND	ND	--	--	--	--	--	--	--	--	--	--
10/16/92	520.04	504.25	15.79	--	ND	ND	ND	ND	ND	--	--	--	--	--	--	--	--	--	--
01/14/93	520.04	507.90	12.14	--	94	ND	1.3	0.7	6.0	--	--	--	--	--	--	--	--	--	--
03/26/93	520.04	508.23	11.81	--	130	2.0	ND	0.6	1.0	--	--	--	--	--	--	--	--	--	--
04/22/93	520.04	507.10	12.94	--	ND	0.8	ND	ND	ND	--	--	--	--	--	--	--	--	--	--
07/20,21/93	520.04	503.56	16.48	--	1200	3.0	1.0	ND	1.0	--	--	--	--	--	--	--	--	--	--
10/20/93	520.04	505.58	14.46	--	ND	2.0	ND	ND	ND	--	--	--	--	--	--	--	--	--	--
01/20/94	520.04	505.92	14.12	--	140	5.0	0.6	3.0	4.0	--	--	--	--	--	--	--	--	--	--
04/21/94	520.04	505.80	14.24	--	86	1.7	0.6	1.2	1.6	--	--	--	--	--	--	--	--	--	--
07/21,22/94	520.04	505.83	14.21	--	ND	ND	ND	ND	ND	--	--	--	--	--	--	--	--	7.0	--
01/18/95	520.04	506.81	13.23	--	50	3.7	<0.5	0.9	1.9	--	--	--	--	--	--	--	--	--	--

Cumulative Table of Well Data and Analytical Results

Vertical Measurements are in feet.

Analytical results are in parts per billion (ppb)

DATE	Well Head Elev.	Ground Water Elev.	Depth To Water	Notes	TPH- Gasoline	Benzene	Toluene	Ethyl- Benzene	Xylene	TOG	1,2- DCA	VC	MC	1,1,1- TCA	1,1- DCA	PCE	Total Lead	CDS	
C-12																			
03/28/86	519.82	506.21	13.61	--	--	--	--	--	--	--	--	--	--	--	--	--	--	--	--
03/15/88	519.82	505.27	14.55	--	ND	ND	ND	ND	ND	--	--	--	--	--	--	--	--	--	--
05/10/88	519.82	505.25	14.57	--	--	--	--	--	--	--	--	--	--	--	--	--	--	--	--
06/10/88	519.82	504.19	15.63	--	--	--	--	--	--	--	--	--	--	--	--	--	--	--	--
07/25/88	519.82	505.31	14.51	--	--	--	--	--	--	--	--	--	--	--	--	--	--	--	--
10/13/88	519.82	505.22	14.60	--	ND	ND	ND	ND	ND	--	--	--	--	--	--	--	--	--	--
01/12/89	519.82	505.20	14.62	--	ND	ND	ND	ND	ND	--	--	--	--	--	--	--	--	--	--
04/11/89	519.82	505.21	14.61	--	ND	ND	ND	ND	ND	ND	ND	--	--	--	--	--	--	--	--
06/26/89	519.82	505.07	14.75	--	ND	ND	ND	ND	ND	ND	ND	--	--	--	--	--	--	--	--
10/13/89	519.82	505.05	14.77	--	ND	ND	ND	ND	ND	ND	ND	--	--	--	--	--	--	--	--
01/03/90	519.82	504.97	14.85	--	ND	ND	ND	ND	0.6	--	ND	--	--	--	--	--	--	--	--
05/07/90	519.82	505.07	14.75	--	ND	ND	ND	ND	ND	--	ND	--	ND	--	ND	--	--	--	--
09/27/90	519.82	505.21	14.61	--	ND	ND	ND	ND	ND	--	ND	--	1.2	ND	ND	--	--	--	--
01/03/91	519.82	505.12	14.70	--	ND	ND	ND	ND	ND	--	ND	--	ND	ND	ND	ND	--	--	--
04/12/91	519.82	505.30	14.52	--	--	--	--	--	--	--	--	--	--	--	--	--	--	--	--
09/04/91	519.82	504.99	14.83	--	--	--	--	--	--	--	--	--	--	--	--	--	--	--	--
04/06/92	519.82	506.01	13.81	--	ND	ND	ND	ND	ND	--	ND	--	ND	ND	ND	ND	--	--	--
07/28/92	519.82	505.50	14.32	--	ND	ND	ND	ND	ND	--	--	--	--	--	--	--	--	--	--
10/16/92	519.82	504.70	15.12	--	ND	ND	ND	ND	ND	--	--	--	--	--	--	--	--	--	--
01/14/93	519.82	506.59	13.23	--	65	ND	ND	ND	1.7	--	--	--	--	--	--	--	--	--	--
03/26/93	519.82	507.62	12.20	--	ND	0.9	ND	ND	ND	--	--	--	--	--	--	--	--	--	--
04/22/93	519.82	506.61	13.21	--	ND	ND	ND	ND	ND	--	--	--	--	--	--	--	--	--	--
07/20,21/93	519.82	503.11	16.71	--	ND	ND	ND	ND	ND	--	--	--	--	--	--	--	--	--	--
10/20/93	519.82	505.63	14.19	--	ND	ND	ND	ND	ND	--	--	--	--	--	--	--	--	--	--
01/20/94	519.82	505.77	14.05	--	ND	ND	ND	ND	ND	--	--	--	--	--	--	--	--	--	--
04/21/94	519.82	505.76	14.06	--	ND	ND	ND	ND	ND	--	--	--	--	--	--	--	--	--	--
07/21,22/94	519.82	505.70	14.12	--	ND	ND	ND	ND	ND	--	--	--	--	--	--	--	--	ND	--

NO LONGER MONITORED OR SAMPLED

Cumulative Table of Well Data and Analytical Results

Vertical Measurements are in feet.

Analytical results are in parts per billion (ppb)

DATE	Well Head Elev.	Ground Water Elev.	Depth To Water	Notes	TPH- Gasoline	Benzene	Toluene	Ethyl- Benzene	Xylene	TOG	1,2- DCA	VC	MC	1,1,1- TCA	1,1- DCA	PCE	Total Lead	CDS	
C-13																			
03/28/86	522.24	509.29	12.95	--	--	--	--	--	--	--	--	--	--	--	--	--	--	--	--
03/15/88	522.24	507.42	14.82	--	250	2.0	ND	9.0	3.0	--	--	--	--	--	--	--	--	--	--
05/10/88	522.24	507.21	15.03	--	--	--	--	--	--	--	--	--	--	--	--	--	--	--	--
06/10/88	522.24	506.14	16.10	--	--	--	--	--	--	--	--	--	--	--	--	--	--	--	--
07/25/88	522.24	507.51	14.73	--	--	--	--	--	--	--	--	--	--	--	--	--	--	--	--
10/13/88	522.24	507.33	14.91	--	ND	1.9	ND	ND	ND	--	--	--	--	--	--	--	--	--	--
01/01/89	522.24	508.14	14.10	--	--	--	--	--	--	--	--	--	--	--	--	--	--	--	--
01/12/89	522.24	--	--	--	ND	ND	0.6	4.0	ND	--	--	--	--	--	--	--	--	--	--
04/10/89	522.24	507.25	14.99	--	ND	ND	ND	8.0	ND	ND	ND	--	--	--	--	--	--	--	--
06/26/89	522.24	507.08	15.16	--	ND	0.3	ND	ND	ND	ND	ND	--	--	--	--	--	--	--	--
10/13/89	522.24	507.01	15.23	--	ND	ND	ND	ND	ND	ND	ND	--	--	--	--	--	--	--	--
01/03/90	522.24	507.09	15.15	--	ND	ND	ND	0.5	0.6	--	ND	--	--	--	--	--	--	--	--
05/08/90	522.24	507.22	15.02	--	ND	ND	ND	ND	ND	--	ND	--	ND	--	ND	--	--	--	--
09/27/90	522.24	507.13	15.11	--	ND	ND	0.6	ND	ND	--	ND	--	1.7	ND	ND	--	--	--	--
01/03/91	522.24	507.16	15.08	--	ND	ND	ND	ND	0.6	--	ND	--	ND	ND	ND	ND	--	--	--
04/12/91	522.24	507.47	14.77	--	--	--	--	--	--	--	--	--	--	--	--	--	--	--	--
09/04/91	522.24	506.81	15.43	--	--	--	--	--	--	--	--	--	--	--	--	--	--	--	--
04/06/92	522.24	507.81	14.43	--	66	ND	ND	ND	ND	--	ND	--	ND	ND	ND	ND	--	--	--
07/28/92	522.24	506.87	15.37	--	60	8.2	ND	ND	1.1	--	--	--	--	--	--	--	--	--	--
10/16/92	522.24	506.37	15.87	--	ND	ND	ND	ND	ND	--	--	--	--	--	--	--	--	--	--
01/14/93	522.24	509.41	12.83	--	100	ND	ND	ND	1.3	--	--	--	--	--	--	--	--	--	--
03/26/93	522.24	509.65	12.59	--	ND	ND	ND	ND	ND	--	--	--	--	--	--	--	--	--	--
04/22/93	522.24	509.08	13.16	--	ND	ND	ND	ND	ND	--	--	--	--	--	--	--	--	--	--
07/20,21/93	522.24	505.72	16.52	--	99	4.0	13	2.0	7.0	--	--	--	--	--	--	--	--	--	--
10/20/93	522.24	507.11	15.13	--	ND	ND	ND	ND	ND	--	--	--	--	--	--	--	--	--	--
01/20/94	522.24	507.59	14.65	--	ND	ND	ND	ND	ND	--	--	--	--	--	--	--	--	--	--
04/21/94	522.24	507.36	14.88	--	ND	ND	ND	ND	ND	--	--	--	--	--	--	--	--	--	--
07/21,22/94	522.24	507.29	14.95	--	ND	ND	ND	ND	ND	--	--	--	--	--	--	--	--	ND	--

NO LONGER MONITORED OR SAMPLED

Cumulative Table of Well Data and Analytical Results

Vertical Measurements are in feet.

Analytical results are in parts per billion (ppb)

DATE	Well Head Elev.	Ground Water Elev.	Depth To Water	Notes	TPH- Gasoline	Benzene	Toluene	Ethyl- Benzene	Xylene	TOG	1,2- DCA	VC	MC	1,1,1- TCA	1,1- DCA	PCE	Total Lead	CDS	
C-14																			
03/28/86	520.08	--	--	--	--	--	--	--	--	--	--	--	--	--	--	--	--	--	--
03/15/88	520.08	--	--	--	--	--	--	--	--	--	--	--	--	--	--	--	--	--	--
05/10/88	520.08	506.69	13.39	--	120,000	13,000	29,000	2700	18	--	--	--	--	--	--	--	--	--	--
06/10/88	520.08	505.43	14.65	--	--	--	--	--	--	--	--	--	--	--	--	--	--	--	--
07/25/88	520.08	506.61	13.47	--	--	--	--	--	--	--	--	--	--	--	--	--	--	--	--
10/13/88	520.08	506.50	13.58	--	ND	ND	ND	ND	ND	--	--	--	--	--	--	--	--	--	--
01/01/89	520.08	507.08	13.00	--	--	--	--	--	--	--	--	--	--	--	--	--	--	--	--
01/12/89	520.08	--	--	--	NS	ND	ND	ND	ND	--	--	--	--	--	--	--	--	--	--
04/12/89	520.08	506.61	13.47	--	NS	ND	ND	ND	ND	ND	ND	--	--	--	--	--	--	--	--
06/26/89	520.08	506.28	13.80	--	140,000	14,000	25,000	3400	26,000	--	30	--	--	--	--	--	--	--	--
10/13/89	520.08	506.46	13.62	--	86,000	12,000	16,000	1600	13,000	--	--	--	--	--	--	--	--	--	--
01/03/90	520.08	506.17	13.91	--	120,000	9500	16,000	1800	13,000	--	25	3.0	--	--	--	--	--	--	--
01/04/90	520.08	506.17	13.91	--	76,000	3900	8100	1200	7700	--	18	1.0	--	--	--	--	--	--	--
05/08/90	520.08	506.19	13.89	--	62,000	7500	17,000	1400	14,000	--	13	--	ND	--	ND	--	--	--	--
09/27/90	520.08	506.30	13.78	--	--	--	--	--	--	--	--	--	--	--	--	--	--	--	--
01/03/91	520.08	506.36	13.72	--	--	--	--	--	--	--	--	--	--	--	--	--	--	--	--
04/12/91	520.08	507.11	12.97	--	60,000	750	3800	720	9200	--	ND	--	ND	ND	ND	ND	--	--	--
09/04/91	520.08	506.24	13.84	--	110,000	2800	11,000	1300	13,000	--	--	--	--	--	--	--	--	--	--
04/06/92	520.08	507.64	12.44	--	41,000	190	1800	440	5100	--	ND	--	ND	ND	ND	ND	--	--	--
07/28/92	520.08	506.38	13.70	--	130,000	2300	9700	1800	15,000	--	--	--	--	--	--	--	--	--	--
10/16/92	520.08	505.70	14.38	--	--	--	--	--	--	--	--	--	--	--	--	--	--	--	--
01/14/93	520.08	511.28	8.80	--	27,000	220	790	220	2700	--	--	--	--	--	--	--	--	--	--
03/26/93	520.08	510.96	9.12	--	23,000	330	1600	460	4000	--	--	--	--	--	--	--	--	--	--
04/22/93	520.08	507.98	12.10	Sheen	17,000	840	2300	130	3500	--	--	--	--	--	--	--	--	--	--
07/20,21/93	520.08	--	--	Inaccessible	--	--	--	--	--	--	--	--	--	--	--	--	--	--	--
10/20/93	520.08	505.77	14.31	Insufficient water	--	--	--	--	--	--	--	--	--	--	--	--	--	--	--
01/20/94	520.08	507.94	12.14	--	22,000	130	790	270	2400	--	--	--	--	--	--	--	--	--	--
04/21/94	520.08	508.15	11.93	--	9400	88	330	72	960	--	--	--	--	--	--	--	--	--	--
07/21,22/94	520.08	506.94	13.14	--	6200	92	180	30	530	--	--	--	--	--	--	--	--	330	--
01/18/95	520.08	--	--	Dry	--	--	--	--	--	--	--	--	--	--	--	--	--	--	--

Cumulative Table of Well Data and Analytical Results

Vertical Measurements are in feet.

Analytical results are in parts per billion (ppb)

DATE	Well Head Elev.	Ground Water Elev.	Depth To Water	Notes	TPH- Gasoline	Benzene	Toluene	Ethyl- Benzene	Xylene	TOG	1,2- DCA	VC	MC	1,1,1- TCA	1,1- DCA	PCE	Total Lead	CDS	
C-15																			
03/28/86	522.41	509.27	13.14	--	--	--	--	--	--	--	--	--	--	--	--	--	--	--	--
03/15/88	522.41	507.28	15.13	--	ND	ND	ND	ND	ND	--	--	--	--	--	--	--	--	--	--
05/10/88	522.41	507.01	15.40	--	--	--	--	--	--	--	--	--	--	--	--	--	--	--	--
06/10/88	522.41	505.92	16.49	--	--	--	--	--	--	--	--	--	--	--	--	--	--	--	--
07/25/88	522.41	507.24	15.17	--	--	--	--	--	--	--	--	--	--	--	--	--	--	--	--
10/13/88	522.41	507.08	15.33	--	ND	ND	ND	ND	ND	--	--	--	--	--	--	--	--	--	--
01/01/89	522.41	508.71	13.70	--	--	--	--	--	--	--	--	--	--	--	--	--	--	--	--
01/12/89	522.41	--	--	--	ND	ND	ND	ND	ND	--	--	--	--	--	--	--	--	--	--
04/12/89	522.41	507.07	15.34	--	ND	ND	ND	ND	ND	ND	ND	--	--	--	--	--	--	--	--
06/26/89	522.41	506.69	15.72	--	ND	ND	ND	ND	ND	ND	ND	--	--	--	--	--	--	--	--
10/13/89	522.41	506.45	15.96	--	ND	ND	ND	ND	ND	ND	ND	--	--	--	--	--	--	--	--
01/03/90	522.41	506.99	15.42	--	ND	ND	ND	ND	ND	--	ND	--	--	--	--	--	--	--	--
05/08/90	522.41	506.79	15.62	--	ND	ND	ND	ND	ND	--	ND	--	ND	--	ND	--	--	--	--
09/27/90	522.41	506.82	15.59	--	ND	ND	ND	ND	ND	--	ND	--	2.9	ND	ND	--	--	--	--
01/03/91	522.41	506.91	15.50	--	ND	ND	ND	ND	0.6	--	ND	--	ND	ND	ND	ND	--	--	--
04/12/91	522.41	507.20	15.21	--	--	--	--	--	--	--	--	--	--	--	--	--	--	--	--
09/04/91	522.41	506.51	15.90	--	--	--	--	--	--	--	--	--	--	--	--	--	--	--	--
04/06/92	522.41	507.53	14.88	--	ND	ND	ND	ND	ND	--	ND	--	ND	ND	ND	ND	--	--	--
07/28/92	522.41	506.59	15.82	--	ND	ND	ND	ND	ND	--	--	--	--	--	--	--	--	--	--
10/16/92	522.41	506.16	16.25	--	ND	ND	ND	ND	ND	--	--	--	--	--	--	--	--	--	--
01/14/93	522.41	509.93	12.48	--	61	ND	1.9	0.8	5.1	--	--	--	--	--	--	--	--	--	--
03/26/93	522.41	509.74	12.67	--	ND	ND	ND	ND	1.0	--	--	--	--	--	--	--	--	--	--
04/22/93	522.41	508.81	13.60	--	ND	ND	ND	ND	ND	--	--	--	--	--	--	--	--	--	--
07/20,21/93	522.41	505.54	16.87	--	ND	ND	ND	ND	ND	--	--	--	--	--	--	--	--	--	--
10/20/93	522.41	507.17	15.24	--	ND	ND	ND	ND	ND	--	--	--	--	--	--	--	--	--	--
01/20/94	522.41	507.40	15.01	--	ND	ND	ND	ND	ND	--	--	--	--	--	--	--	--	--	--
04/21/94	522.41	507.19	15.22	--	ND	ND	ND	ND	ND	--	--	--	--	--	--	--	--	--	--
07/21,22/94	522.41	507.06	15.35	--	ND	ND	ND	ND	ND	--	--	--	--	--	--	--	--	ND	--

NO LONGER MONITORED OR SAMPLED

Cumulative Table of Well Data and Analytical Results

Vertical Measurements are in feet.

Analytical results are in parts per billion (ppb)

DATE	Well Head Elev.	Ground Water Elev.	Depth To Water	Notes	TPH- Gasoline	Benzene	Toluene	Ethyl- Benzene	Xylene	TOG	1,2- DCA	VC	MC	1,1,1- TCA	1,1- DCA	PCE	Total Lead	CDS
C-16																		
03/28/86	519.68	--	--	--	--	--	--	--	--	--	--	--	--	--	--	--	--	--
03/15/88	519.68	--	--	--	--	--	--	--	--	--	--	--	--	--	--	--	--	--
05/10/88	519.68	505.90	13.78	--	4500	1,000	73	140	180	--	--	--	--	--	--	--	--	--
06/10/88	519.68	504.80	14.88	--	--	--	--	--	--	--	--	--	--	--	--	--	--	--
07/25/88	519.68	505.99	13.69	--	--	--	--	--	--	--	--	--	--	--	--	--	--	--
10/13/88	519.68	505.88	13.80	--	1600	16	5.5	ND	16	--	--	--	--	--	--	--	--	--
01/01/89	519.68	506.23	13.45	--	--	--	--	--	--	--	--	--	--	--	--	--	--	--
01/12/89	519.68	--	--	--	1000	360	11	78	51	--	--	--	--	--	--	--	--	--
04/11/89	519.68	505.90	13.78	--	15,800	130	4.0	21	19	ND	8.0	--	--	--	--	--	--	--
06/26/89	519.68	505.66	14.02	--	1300	170	8.0	37	43	ND	ND	--	--	--	--	--	--	--
10/13/89	519.68	505.67	14.01	--	1000	20	ND	7.0	ND	ND	ND	--	--	--	--	--	--	--
01/03/90	519.68	505.71	13.97	--	1300	150	3.0	41	24	--	5.0	--	--	--	--	--	--	--
05/07/90	519.68	505.23	14.45	--	480	49	4.4	29	13	--	4.5	--	ND	--	ND	--	--	--
09/29/90	519.68	505.36	14.32	--	360	18	2.1	11	8.0	--	1.8	--	ND	ND	ND	--	--	--
01/03/91	519.68	505.72	13.96	--	230	12	ND	6.0	6.0	--	2.0	--	0.8	ND	ND	ND	--	--
04/12/91	519.68	505.94	13.74	--	--	--	--	--	--	--	--	--	--	--	--	--	--	--
09/04/91	519.68	505.46	14.22	--	--	--	--	--	--	--	--	--	--	--	--	--	--	--
04/06/92	519.68	506.50	13.18	--	360	30	ND	14	12	--	1.0	--	ND	ND	ND	ND	--	--
07/28/92	519.68	505.75	13.93	--	210	31	ND	6.8	16	--	--	--	--	--	--	--	--	--
10/16/92	519.68	504.76	14.92	--	140	11	ND	5.1	3.4	--	--	--	--	--	--	--	--	--
01/14/93	519.68	507.87	11.81	--	740	24	ND	36	21	--	--	--	--	--	--	--	--	--
03/26/93	519.68	508.32	11.36	--	730	22	2.0	16	10	--	--	--	--	--	--	--	--	--
04/22/93	519.68	507.38	12.30	--	850	46	ND	24	6.0	--	--	--	--	--	--	--	--	--
07/20,21/93	519.68	--	--	Inaccessible	--	--	--	--	--	--	--	--	--	--	--	--	--	--
10/20/93	519.68	505.68	14.00	--	290	18	2.0	16	17	--	--	--	--	--	--	--	--	--
01/20/94	519.68	506.20	13.48	--	360	10	1.0	12	9.0	--	--	--	--	--	--	--	--	--
04/21/94	519.68	505.76	13.92	--	220	15	ND	13	11	--	--	--	--	--	--	--	--	--
07/21,22/94	519.68	506.12	13.56	--	72	1.2	ND	ND	1.0	--	--	--	--	--	--	--	8.0	--
01/18/95	519.68	--	--	Inaccessible	--	--	--	--	--	--	--	--	--	--	--	--	--	--

Cumulative Table of Well Data and Analytical Results

Vertical Measurements are in feet.

Analytical results are in parts per billion (ppb)

DATE	Well Head Elev.	Ground Water Elev.	Depth To Water	Notes	TPH- Gasoline	Benzene	Toluene	Ethyl- Benzene	Xylene	TOG	1,2- DCA	VC	MC	1,1,1- TCA	1,1- DCA	PCE	Total Lead	CDS	
C-17																			
03/28/86	520.82	507.34	13.48	--	--	--	--	--	--	--	--	--	--	--	--	--	--	--	--
03/15/88	520.82	506.06	14.76	--	--	--	--	--	--	--	--	--	--	--	--	--	--	--	--
05/10/88	520.82	506.05	14.77	--	--	--	--	--	--	--	--	--	--	--	--	--	--	--	--
06/10/88	520.82	504.98	15.84	--	--	--	--	--	--	--	--	--	--	--	--	--	--	--	--
07/25/88	520.82	506.19	14.63	--	--	--	--	--	--	--	--	--	--	--	--	--	--	--	--
10/13/88	520.82	505.99	14.83	--	270,000	18	900	760	5500	--	--	--	--	--	--	--	--	--	--
01/01/89	520.82	506.04	14.78	--	--	--	--	--	--	--	--	--	--	--	--	--	--	--	--
01/12/89	520.82	--	--	--	190,000	ND	490	2100	6700	--	--	--	--	--	--	--	--	--	--
04/11/89	520.82	505.99	14.83	--	27,000	30	150	320	1000	6.0	ND	--	--	--	--	--	--	--	--
06/26/89	520.82	505.79	15.03	--	20,000	50	390	660	2000	ND	ND	--	--	--	--	--	--	--	--
06/26/89	520.82	505.79	15.03	--	27,000	40	420	740	2200	--	ND	--	--	--	--	--	--	--	--
10/13/89	520.82	505.80	15.02	--	17,000	ND	48	230	480	ND	ND	--	--	--	--	--	--	--	--
01/03/90	520.82	505.72	15.10	--	14,000	ND	29	120	210	--	ND	--	--	--	--	--	--	--	--
05/08/90	520.82	505.70	15.12	--	9500	25	130	210	470	--	ND	--	ND	--	ND	--	--	--	--
09/29/90	520.82	505.83	14.99	--	ND	ND	ND	ND	ND	--	ND	--	ND	1.9	ND	--	--	--	--
09/29/90	520.82	505.83	14.99	--	ND	ND	3.4	ND	ND	--	ND	--	1.8	1.9	ND	--	--	--	--
01/03/91	520.82	505.90	14.92	--	3700	ND	28	56	140	--	ND	--	1.8	1.9	ND	ND	--	--	--
01/03/91	520.82	505.90	14.92	--	8600	ND	10	59	150	--	ND	--	ND	ND	ND	ND	--	--	--
04/12/91	520.82	506.11	14.71	--	8600	ND	5.0	47	120	--	ND	--	ND	ND	ND	ND	--	--	--
04/12/91	520.82	506.11	14.71	--	4400	ND	11	48	120	--	ND	--	ND	ND	ND	ND	--	--	--
09/04/91	520.82	505.65	15.17	--	5800	ND	27	49	79	--	ND	--	ND	ND	ND	ND	--	--	--
09/04/91	520.82	505.65	15.17	--	4100	ND	21	36	61	--	ND	--	ND	ND	ND	ND	--	--	--
04/06/92	520.82	506.68	14.14	--	2300	ND	5.8	27	29	--	ND	--	ND	ND	ND	ND	--	--	--
07/28/92	520.82	505.64	15.18	--	11,000	99	180	170	430	--	--	--	--	--	--	--	--	--	--
10/16/92	520.82	505.06	15.76	--	1,200,000	ND	4800	3900	6600	--	--	--	--	--	--	--	--	--	--
01/14/93	520.82	507.38	13.44	--	3500	9.3	9.1	23	34	--	--	--	--	--	--	--	--	--	--
03/26/93	520.82	508.36	12.46	--	3700	ND	19	20	35	--	--	--	--	--	--	--	--	--	--
04/22/93	520.82	507.52	13.30	--	8900	16	68	44	97	--	--	--	--	--	--	--	--	--	--
07/20,21/93	520.82	503.61	17.21	--	4200	5.0	35	33	62	--	--	--	--	--	--	--	--	--	--
10/20/93	520.82	505.73	15.09	--	4500	5.0	12	43	64	--	--	--	--	--	--	--	--	--	--
01/20/94	520.82	506.35	14.47	--	1900	4.0	42	24	73	--	--	--	--	--	--	--	--	--	--
04/21/94	520.82	505.87	14.95	--	1100	5.0	20	23	42	--	--	--	--	--	--	--	--	--	--
07/21,22/94	520.82	506.22	14.60	--	72	ND	ND	ND	0.9	--	--	--	--	--	--	--	--	ND	--
01/18/95	520.82	507.12	13.70	--	530	1.7	<0.5	5.6	8.8	--	--	--	--	--	--	--	--	--	--

Cumulative Table of Well Data and Analytical Results

Vertical Measurements are in feet.

Analytical results are in parts per billion (ppb)

DATE	Well Head Elev.	Ground Water Elev.	Depth To Water	Notes	TPH- Gasoline	Benzene	Toluene	Ethyl- Benzene	Xylene	TOG	1,2- DCA	VC	MC	1,1,1- TCA	1,1- DCA	PCE	Total Lead	CDS	
C-18																			
03/28/86	518.96	--	--	--	--	--	--	--	--	--	--	--	--	--	--	--	--	--	--
03/15/88	518.96	--	--	--	--	--	--	--	--	--	--	--	--	--	--	--	--	--	--
05/10/88	518.96	--	--	--	--	--	--	--	--	--	--	--	--	--	--	--	--	--	--
06/10/88	518.96	504.07	14.89	--	--	--	--	--	--	--	--	--	--	--	--	--	--	--	--
07/25/88	518.96	505.17	13.79	--	--	--	--	--	--	--	--	--	--	--	--	--	--	--	--
10/13/88	518.96	505.10	13.86	--	ND	ND	ND	ND	ND	--	--	--	--	--	--	--	--	--	--
01/01/89	518.96	505.02	13.94	--	--	--	--	--	--	--	--	--	--	--	--	--	--	--	--
01/12/89	518.96	--	--	--	ND	ND	ND	ND	ND	--	--	--	--	--	--	--	--	--	--
04/11/89	518.96	504.10	14.86	--	ND	ND	ND	ND	ND	ND	3.6	--	--	--	--	--	--	--	--
06/26/89	518.96	504.94	14.02	--	ND	ND	ND	ND	ND	ND	3.1	--	--	--	--	--	--	--	--
10/13/89	518.96	503.90	15.06	--	ND	ND	ND	ND	ND	ND	ND	--	--	--	--	--	--	--	--
01/03/90	518.96	504.89	14.07	--	ND	ND	ND	ND	ND	--	1.0	--	--	--	--	--	--	--	--
05/07/90	518.96	504.95	14.01	--	ND	ND	ND	ND	ND	--	ND	--	ND	--	ND	--	--	--	--
09/27/90	518.96	505.05	13.91	--	ND	ND	ND	ND	ND	--	ND	--	0.6	ND	ND	--	--	--	--
01/03/91	518.96	504.98	13.98	--	ND	ND	ND	ND	ND	--	ND	--	ND	ND	ND	ND	--	--	--
04/12/91	518.96	505.13	13.83	--	ND	ND	ND	ND	ND	--	ND	--	ND	ND	ND	ND	--	--	--
09/04/91	518.96	504.76	14.20	--	ND	ND	ND	ND	ND	--	ND	--	ND	ND	ND	ND	--	--	--
04/06/92	518.96	505.89	13.07	--	ND	ND	ND	ND	ND	--	ND	--	ND	ND	ND	ND	--	--	--
07/28/92	518.96	505.41	13.55	--	ND	ND	ND	ND	ND	--	--	--	--	--	--	--	--	--	--
10/16/92	518.96	504.58	14.38	--	ND	ND	ND	ND	ND	--	--	--	--	--	--	--	--	--	--
01/14/93	518.96	506.50	12.46	--	56	ND	ND	ND	ND	1.8	--	--	--	--	--	--	--	--	--
03/26/93	518.96	507.50	11.46	--	ND	ND	ND	ND	ND	--	--	--	--	--	--	--	--	--	--
04/22/93	518.96	506.38	12.58	--	ND	ND	ND	ND	ND	--	--	--	--	--	--	--	--	--	--
07/20,21/93	518.96	503.32	15.64	--	92	ND	0.5	ND	ND	--	--	--	--	--	--	--	--	--	--
10/20/93	518.96	--	--	--	--	--	--	--	--	--	--	--	--	--	--	--	--	--	--
01/20/94	518.96	--	--	--	--	--	--	--	--	--	--	--	--	--	--	--	--	--	--
04/21/94	518.96	--	--	--	--	--	--	--	--	--	--	--	--	--	--	--	--	--	--

Cumulative Table of Well Data and Analytical Results

Vertical Measurements are in feet.

Analytical results are in parts per billion (ppb)

DATE	Well Head Elev.	Ground Water Elev.	Depth To Water	Notes	TPH- Gasoline	Benzene	Toluene	Ethyl- Benzene	Xylene	TOG	1,2- DCA	VC	MC	1,1,1- TCA	1,1- DCA	PCE	Total Lead	CDS	
C-19																			
03/28/86	520.99	--	--	--	--	--	--	--	--	--	--	--	--	--	--	--	--	--	--
03/15/88	520.99	--	--	--	--	--	--	--	--	--	--	--	--	--	--	--	--	--	--
05/10/88	520.99	505.76	15.23	--	18	1400	360	350	1300	--	--	--	--	--	--	--	--	--	--
06/10/88	520.99	504.41	16.58	--	--	--	--	--	--	--	--	--	--	--	--	--	--	--	--
07/25/88	520.99	505.80	15.19	--	--	--	--	--	--	--	--	--	--	--	--	--	--	--	--
10/13/88	520.99	505.72	15.27	--	ND	8.3	4.7	4.4	ND	--	--	--	--	--	--	--	--	--	--
01/01/89	520.99	505.79	15.20	--	--	--	--	--	--	--	--	--	--	--	--	--	--	--	--
01/12/89	520.99	--	--	--	ND	5.0	4.0	ND	ND	--	--	--	--	--	--	--	--	--	--
04/11/89	520.99	505.75	15.24	--	ND	1.8	ND	ND	ND	ND	13	--	--	--	--	--	--	--	--
04/11/89	520.99	505.75	15.24	--	500	1.2	ND	0.6	0.6	--	14	--	--	--	--	--	--	--	--
06/26/89	520.99	505.55	15.44	--	500	2.5	ND	ND	ND	ND	26	--	--	--	--	--	--	--	--
10/13/89	520.99	505.52	15.47	--	540	ND	ND	ND	ND	ND	13	--	--	--	--	--	--	--	13
01/03/90	520.99	505.54	15.45	--	ND	1.2	0.7	1.3	0.9	--	11	--	--	--	--	--	--	--	--
05/07/90	520.99	505.31	15.68	--	ND	ND	ND	ND	ND	--	4.6	--	ND	--	ND	--	--	--	--
09/28/90	520.99	505.47	15.52	--	ND	ND	ND	ND	ND	--	ND	--	1.2	ND	ND	--	--	--	--
01/03/91	520.99	505.43	15.56	--	66	ND	ND	ND	ND	--	1.0	--	ND	ND	ND	0.9	--	--	--
04/12/91	520.99	505.79	15.20	--	--	--	--	--	--	--	--	--	--	--	--	--	--	--	--
09/04/91	520.99	505.39	15.60	--	--	--	--	--	--	--	--	--	--	--	--	--	--	--	--
04/06/92	520.99	506.41	14.58	--	110	0.7	ND	1.0	ND	--	1.9	--	ND	ND	ND	ND	--	--	--
07/28/92	520.99	505.73	15.26	--	ND	1.4	ND	1.0	4.2	--	--	--	--	--	--	--	--	--	--
10/16/92	520.99	504.99	16.00	--	ND	ND	ND	ND	ND	--	--	--	--	--	--	--	--	--	--
01/14/93	520.99	507.30	13.69	--	100	1.1	ND	0.9	0.9	--	--	--	--	--	--	--	--	--	--
03/26/93	520.99	508.03	12.96	--	80	ND	ND	ND	ND	--	--	--	--	--	--	--	--	--	--
04/22/93	520.99	506.81	14.18	--	250	0.6	1.0	1.0	1.0	--	--	--	--	--	--	--	--	--	--
07/20,21/93	520.99	504.41	16.58	--	390	ND	ND	0.8	2.0	--	--	--	--	--	--	--	--	--	--
10/20/93	520.99	505.76	15.23	--	ND	ND	ND	ND	ND	--	--	--	--	--	--	--	--	--	--
01/20/94	520.99	506.15	14.84	--	ND	ND	ND	ND	ND	--	--	--	--	--	--	--	--	--	--
04/21/94	520.99	505.73	15.26	--	60	ND	ND	1.0	ND	--	--	--	--	--	--	--	--	--	--
07/21,22/94	520.99	506.09	14.90	--	ND	ND	ND	ND	ND	--	--	--	--	--	--	--	--	ND	--
01/18/95	520.99	506.97	14.02	--	<50	<0.5	<0.5	<0.5	<0.5	--	--	--	--	--	--	--	--	--	--

Cumulative Table of Well Data and Analytical Results

Vertical Measurements are in feet.

Analytical results are in parts per billion (ppb)

DATE	Well Head Elev.	Ground Water Elev.	Depth To Water	Notes	TPH- Gasoline	Benzene	Toluene	Ethyl- Benzene	Xylene	TOG	1,2- DCA	VC	MC	1,1,1- TCA	1,1- DCA	PCE	Total Lead	CDS	
TRIP BLANK																			
01/18/95	--	--	--	--	<50	<0.5	<0.5	<0.5	<0.5	--	--	--	--	--	--	--	--	--	--

Note: Blaine Tech Services, Inc. began routine monitoring of the groundwater wells at this site on November 1, 1994.
Earlier field data and analytical results are drawn from the August 15, 1994 Groundwater Technology, Inc. report.

ABBREVIATIONS:

TPH = Total Petroleum Hydrocarbons

TOG = Total Oil & Grease

PCE = Tetrachloroethene

1,2-DCA = 1,2-Dichloroethane

VC = Vinyl chloride

MC = Methylene Chloride

TCA = 1,1,1-Trichloroethane

1,1-DCA = 1,1-Dichloroethane

CDS = Carbon Disulfide

ND = Not detected at or above the minimum quantitation limit. See laboratory reports for minimum quantitation limits.

Analytical Appendix



ENVIRONMENTAL
LABORATORIES, INC.

Northwest Region

4080-C Pike Lane
Concord, CA 94520
(510) 685-7852
(800) 544-3422 from inside California
(800) 423-7143 from outside California
(510) 825-0720 (FAX)

January 23, 1995

Jim Keller
Blaine Tech Services
985 Timothy Drive
San Jose, CA 95133

RE: GTEL Client ID: BLA01CHV08
Login Number: C5010224
Project ID (number): 950118-L1
Project ID (name): Chevron/#9-4924/4904 Southfront Rd., Livermore, CA

Dear Jim Keller:

Enclosed please find the analytical results for the samples received by GTEL Environmental Laboratories, Inc. on 01/20/95.

A formal Quality Assurance/Quality Control (QA/QC) program is maintained by GTEL, which is designed to meet or exceed the EPA requirements. Analytical work for this project met QA/QC criteria unless otherwise stated in the footnotes.

If you have any questions regarding this analysis, or if we can be of further assistance, please call our Customer Service Representative.

Sincerely,
GTEL Environmental Laboratories, Inc.

Rashmi Shah
Laboratory Director

GTEL Client ID: BLA01CHV08
 Login Number: C5010224
 Project ID (number): 950118-L1
 Project ID (name): Chevron/#9-4924/4904 Southfront Rd., Livermore, CA

ANALYTICAL RESULTS

Volatile Organics
 Method: EPA 8020
 Matrix: Aqueous

GTEL Sample Number	C5010224-01	C5010224-02	C5010224-03	C5010224-04
Client ID	C-1	C-2	C-5	C-6
Date Sampled	01/18/95	01/18/95	01/18/95	01/18/95
Date Analyzed	01/21/95	01/20/95	01/20/95	01/20/95
Dilution Factor	5.00	1.00	1.00	1.00

Analyte	Reporting		Concentration:			
	Limit	Units				
Benzene	0.5	ug/L	18.	1.0	37.	3.3
Toluene	0.5	ug/L	10.	< 0.5	22.	6.7
Ethylbenzene	0.5	ug/L	130	5.7	14.	62.
Xylenes (total)	0.5	ug/L	10.	7.7	7.3	78.
TPH as GAS	50.	ug/L	2000	640	940	3600
BFB (Surrogate)	--	%	100.	99.5	95.9	117.

Notes:

Dilution Factor:

Dilution factor indicates the adjustments made for sample dilution.

EPA 8020:

"Test Methods for Evaluating Solid Waste, Physical/Chemical Methods", SW-846, Third Edition including promulgated Update 1. Acceptability limits for recovery in the Bromofluorobenzene (BFB) surrogate is 62-129%. Modification for TPH as gasoline as per California State Water Resources Board LUFT Manual protocols, May 1988 revision.

C5010224-01:

Uncategorized compound is not included in gasoline concentration.

C5010224-02:

Uncategorized compound is not included in gasoline concentration.

C5010224-03:

Uncategorized compound is not included in gasoline concentration.

C5010224-04:

Uncategorized compound is not included in gasoline concentration.

GTEL Concord, CA
 C5010224:1



GTEL Client ID: BLA01CHV08
 Login Number: C5010224
 Project ID (number): 950118-L1
 Project ID (name): Chevron/#9-4924/4904 Southfront Rd., Livermore, CA

ANALYTICAL RESULTS

Volatile Organics
 Method: EPA 8020
 Matrix: Aqueous

GTEL Sample Number	C5010224-05	C5010224-06	C5010224-07	C5010224-08
Client ID	C-7	C-9	C-10	C-11
Date Sampled	01/18/95	01/18/95	01/18/95	01/18/95
Date Analyzed	01/20/95	01/20/95	01/20/95	01/20/95
Dilution Factor	1.00	1.00	1.00	1.00

Analyte	Reporting		Concentration:			
	Limit	Units				
Benzene	0.5	ug/L	16.	9.2	1.2	3.7
Toluene	0.5	ug/L	< 0.5	13.	< 0.5	< 0.5
Ethylbenzene	0.5	ug/L	30.	19.	< 0.5	0.9
Xylenes (total)	0.5	ug/L	12.	13.	< 0.5	1.9
TPH as GAS	50.	ug/L	920	2100	< 50	50
BFB (Surrogate)	--	%	104.	110.	89.9	91.3

Notes:

Dilution Factor:

Dilution factor indicates the adjustments made for sample dilution.

EPA 8020:

"Test Methods for Evaluating Solid Waste, Physical/Chemical Methods", SW-846, Third Edition including promulgated Update 1. Acceptability limits for recovery in the Bromofluorobenzene (BFB) surrogate is 62-129%. Modification for TPH as gasoline as per California State Water Resources Board LUFT Manual protocols, May 1988 revision.

C5010224-05:

Uncategorized compound is not included in gasoline concentration.

C5010224-06:

Uncategorized compound is not included in gasoline concentration.

C5010224-07:

Uncategorized compound is not included in gasoline concentration.

C5010224-08:

Uncategorized compound is not included in gasoline concentration.

GTEL Concord, CA
 C5010224:2



GTEL Client ID: BLA01CHV08
 Login Number: C5010224
 Project ID (number): 950118-L1
 Project ID (name): Chevron/#9-4924/4904 Southfront Rd., Livermore, CA

ANALYTICAL RESULTS

Volatile Organics
 Method: EPA 8020
 Matrix: Aqueous

GTEL Sample Number	C5010224-09	C5010224-10	C5010224-11	--
Client ID	C-17	C-19	TB	--
Date Sampled	01/18/95	01/18/95	01/18/95	--
Date Analyzed	01/20/95	01/20/95	01/20/95	--
Dilution Factor	1.00	1.00	1.00	--

Analyte	Reporting		Concentration:			
	Limit	Units				
Benzene	0.5	ug/L	1.7	< 0.5	< 0.5	--
Toluene	0.5	ug/L	< 0.5	< 0.5	< 0.5	--
Ethylbenzene	0.5	ug/L	5.6	< 0.5	< 0.5	--
Xylenes (total)	0.5	ug/L	8.8	< 0.5	< 0.5	--
TPH as GAS	50	ug/L	530	< 50	< 50	--
BFB (Surrogate)	--	%	100	90.2	99.6	--

Notes:

Dilution Factor:

Dilution factor indicates the adjustments made for sample dilution.

EPA 8020:

"Test Methods for Evaluating Solid Waste, Physical/Chemical Methods", SW-846, Third Edition including promulgated Update 1. Acceptability limits for recovery in the Bromofluorobenzene (BFB) surrogate is 62-129%. Modification for TPH as gasoline as per California State Water Resources Board LUFT Manual protocols, May 1988 revision.

GTEL Concord, CA
 C5010224:3

GTEL Client ID: BLA01CHV08
Login Number: C5010224
Project ID (number): 950118-L1
Project ID (name): Chevron/#9-4924/4904 Southfront Rd., Livermore, CA

QUALITY CONTROL RESULTS

Volatile Organics
Method: EPA 8020
Matrix: Aqueous

Method Blank Results

QC Batch No: Q012095-1
Date Analyzed: 20-JAN-95

Analyte	Method: EPA 8020	Concentration: ug/L
Benzene	< 0.30	
Toluene	< 0.30	
Ethylbenzene	< 0.30	
Xylenes (Total)	< 0.50	
TPH as Gasoline	< 10	

Notes:

GTEL Client ID: BLA01CHV08
 Login Number: C5010224
 Project ID (number): 950118-L1
 Project ID (name): Chevron/#9-4924/4904 Southfront Rd., Livermore, CA

QUALITY CONTROL RESULTS

Volatile Organics
 Method: EPA 8020
 Matrix: Aqueous

Matrix Spike and Matrix Spike Duplicate Results

Analyte	Original Concentration	Spike Amount	Matrix Spike	Matrix Spike	Matrix Spike Duplicate	Matrix Spike Duplicate	RPD, %	Acceptability Limits	
			Concentration	Recovery, %	Concentration	Recovery, %		RPD, %	RPD, %
EPA 8020	GTEL Sample ID: C5010160-08		Spike ID: Q012095-3		Dup. ID: Q012095-4				
Units: ug/L	Analysis Date: 16-JAN-95		20-JAN-95		21-JAN-95			Client ID: Batch QC	
Benzene	< 0.50	20.0	20.5	103.	20.6	103.	0	34	57.3-138%
Toluene	< 0.50	20.0	19.8	99.0	19.7	98.5	0.5	31	63-134%
Ethylbenzene	< 0.50	20.0	18.3	91.5	18.1	90.5	1.1	38	59.3-137%
Xylenes (Total)	< 0.50	60.0	53.4	89.0	51.8	86.3	3	31	59.3-144%

Notes:

Fax copy of Lab Report and COC to Chevron Contact: Yes No

Chain-of-Custody-Record

Chevron U.S.A. Inc. P.O. Box 5004 San Ramon, CA 94583 FAX (415) 842-9591	Chevron Facility Number <u>9-1924</u>	Chevron Contact (Name) <u>Brett Hunter</u>
	Facility Address <u>4904 Southfront Rd., Livermore, CA</u>	(Phone) <u>(510) 842-8695</u>
	Consultant Project Number <u>750118-41</u>	Laboratory Name <u>GTEL</u>
	Consultant Name <u>Blaine Tech Services, Inc.</u> Address <u>985 Timothy Dr., San Jose, CA 95133</u>	Laboratory Release Number <u>9033280</u>
Project Contact (Name) <u>Jim Keller</u>	Sample Collected by (Name) <u>LAD B OLVER</u>	Collection Date <u>1-18-95</u>
(Phone) <u>(408) 995-5535</u> (Fax Number) <u>(408) 293-8773</u>	Signature <u>[Signature]</u>	

Sample Number	Lab Sample Number	Number of Containers	Media S = Soil W = Water A = Air C = Chemical	Type G = Grab C = Composite D = Diurnal	Time	Sample Preservation	Iced (Yes or No)	Analyses To Be Performed											Remarks				
								STX + TPH GAS (8220 + 8015)	TPH Dist (8015)	Oil and Grease (5520)	Purgeable Hydrocarbons (8010)	Purgeable Aromatics (8220)	Purgeable Organics (8240)	Extractable Organics (8270)	Metals Cd, Cr, Pb, Zn, Ni (ICAP or AA)								
C-1	01	3	W		1220	HCL	YES	X															
C-2	02	3	W		1325			X															
C-5	03	3	W		1145			X															
C-6	04	3	W		1430			X															
C-7	05	3	W		1400			X															
C-8			W					*															
C-9	06	3	W		1250			X															
C-10	07	3	W		940			X															
C-11	08	3	W		1640			X															
C-14			W					*															
C-17	09	3	W		1100			X															
C-19	10	3	W		1010			X															
TB	11	2	W			↓	↓	X															

C5010224

Relinquished By (Signature) <u>[Signature]</u>	Organization <u>BTS</u>	Date/Time <u>1-19-95</u>	Received By (Signature) <u>[Signature]</u>	Organization <u>GTEL</u>	Date/Time <u>1/19/95</u>	Turn Around Time (Circle Choice) 4°C 24 Hrs. 48 Hrs. 5 Days 10 Days <u>As Contracted</u>
Relinquished By (Signature) <u>[Signature]</u>	Organization <u>GTEL</u>	Date/Time <u>1-19-95</u>	Received By (Signature) _____	Organization _____	Date/Time _____	
Relinquished By (Signature) _____	Organization _____	Date/Time _____	Received For Laboratory By (Signature) <u>[Signature]</u>	Date/Time <u>1/19/95</u>	<u>16:15</u>	

COC-ILDW/03 97/MSH

Field Data Sheets

WELL GAUGING DATA

Project # 950118-L1 Date 1-18-95 Client CHEV 9-1929

Site 4904 S. FRONT ST, LIVERMORE, CA

Well I.D.	Well Size (in.)	Sheen/Odor	Depth to Immiscible Liquid (feet)	Thickness of Immiscible Liquid (ft.)	Volume of Immiscibles Removed (ml)	Depth to Water (feet)	Depth to Well Bottom (feet)	Survey Point: TOB or TOC
C-1	3	ODOR SHEEN				11.72	18.81	TOC
C-2	3	ODOR				11.82	24.30	
C-5	3					12.27	19.38	
C-6	3	ODOR				11.01	21.95	
C-7	3	ODOR				11.59	21.71	
C-8	3					DRY	11.95	
C-9	3	ODOR SHEEN				11.15	22.72	
C-10	3	1				13.64	34.55	
C-11	3					13.23	19.64	
C-14	3					DRY	11.68	
C-16	UNABLE TO LOCATE, PAVED OVER							
C-17	3					13.70	20.35	
C-18	ABANDONED							
C-19	2					14.02	24.15	↓

CHEVRON WELL MONITORING DATA SHEET

Project #: 950118-41	Station # 9-1924
Sampler: LAD	Date Sampled: 1-18-95
Well I.D.: C-1	Well Diameter: (circle one) 2 (3) 4 6
Total Well Depth: Before 18.81 After	Depth to Water: Before 11.72 After
Depth to Free Product:	Thickness of Free Product (feet):
Measurements referenced to: PVC	Grade Other --

2.6	x	3	=	7.8
1 Case Volume		Specified Volumes		gallons

Furging: Bailer
 Middleburg
 Electric Submersible ~~x~~
 Suction Pump
 Type of Installed Pump _____

Sampling: Bailer x DISPOS.
 Middleburg
 Electric Submersible
 Suction Pump
 Installed Pump

TIME	TEMP. (F)	PH	COND.	TURBIDITY:	VOLUME REMOVED:	OBSERVATIONS:
1210	69.0	7.0	1200.	—	3.	ODOR
1212	69.4	6.9	1200.	—	6.	+ LIGHT SHEEN
1214	71.0	7.1	1200.	—	8.	

Did Well Dewater? NO If yes, gals.

Gallons Actually Evacuated: 8.

Sampling Time: 1220

Sample I.D.: C-1

Laboratory: B-TFL

Analyzed for: TPH6, BTEX

Duplicate I.D.:

Cleaning Blank I.D.:

Analyzed for:

Shipping Notations:

Additional Notations:

CHEVRON WELL MONITORING DATA SHEET

Project #: 950118-L1	Station # 9-1924
Sampler: LAD	Date Sampled: 1-18-95
Well I.D.: C-2	Well Diameter: (circle one) 2 <u>3</u> 4 6
Total Well Depth: Before 24.30 After	Depth to Water: Before 11.82 After
Depth to Free Product:	Thickness of Free Product (feet):
Measurements referenced to: <u>PVC</u>	Grade Other --

4.6	x	3	=	13.8
1 Case Volume		Specified Volumes		gallons

Purging: Bailer
Middleburg
Electric Submersible ~~x~~
Suction Pump
Type of Installed Pump _____

Sampling: Bailer x DISPOS
Middleburg
Electric Submersible
Suction Pump
Installed Pump

TIME	TEMP. (F)	pH	COND.	TURBIDITY:	VOLUME REMOVED:	OBSERVATIONS:
1316	70.0	7.0	1200.	—	5.	ODOR
1318	70.0	7.0	1200.	—	10.	
1320	70.4	7.0	1300.	—	14.	

Did Well Dewater? NO If yes, gals. Gallons Actually Evacuated: 14.

Sampling Time: 1325

Sample I.D.: C-2 Laboratory: G-TEL

Analyzed for: TPH6, BTEX

Duplicate I.D.: _____ Cleaning Blank I.D.: _____

Analyzed for:

Shipping Notations:

Additional Notations:

CHEVRON WELL MONITORING DATA SHEET

Project #: <u>950118-L1</u>		Station # <u>9-1924</u>	
Sampler: <u>LAD</u>		Date Sampled: <u>1-18-95</u>	
Well I.D.: <u>C-5</u>		Well Diameter: (circle one) 2 <u>3</u> 4 6	
Total Well Depth: Before <u>19.38</u> After		Depth to Water: Before <u>12.27</u> After	
Depth to Free Product:		Thickness of Free Product (feet):	
Measurements referenced to: <u>FVC</u> Grade Other --			

<u>2.6</u>	<u>x</u>	<u>3</u>	<u>=</u>	<u>7.8</u>
1 Case Volume		Specified Volumes		gallons

Purging: Bailer
 Middleburg
 Electric Submersible X
 Suction Pump
 Type of Installed Pump _____

Sampling: Bailer X DISPOS,
 Middleburg
 Electric Submersible
 Suction Pump
 Installed Pump

TIME	TEMP. (F)	pH	COND.	TURBIDITY:	VOLUME REMOVED:	OBSERVATIONS:
<u>1136</u>	<u>68.5</u>	<u>7.0</u>	<u>850</u>	<u>—</u>	<u>3</u>	
<u>1138</u>	<u>68.4</u>	<u>7.1</u>	<u>900</u>	<u>—</u>	<u>6</u>	
<u>1140</u>	<u>69.0</u>	<u>6.9</u>	<u>950</u>	<u>—</u>	<u>8</u>	

Did Well Dewater? NO If yes, gals. Gallons Actually Evacuated: 8

Sampling Time: 1145

Sample I.D.: C-5 Laboratory: G-TEL

Analyzed for: TPH6, BTEX

Duplicate I.D.: _____ Cleaning Blank I.D.: _____

Analyzed for:

Shipping Notations:

Additional Notations:

CHEVRON WELL MONITORING DATA SHEET

Project #: 950118-L1	Station # 9- 1924
Sampler: LAD	Date Sampled: 1-18-95
Well I.D.: C-6	Well Diameter: (circle one) 2 <u>3</u> 4 6
Total Well Depth: Before 21.95 After	Depth to Water: Before 11.01 After
Depth to Free Product:	Thickness of Free Product (feet):
Measurements referenced to: <u>PVC</u>	Grade Other --

<u>4.0</u>	x	<u>3</u>	=	<u>12.0</u>
1 Case Volume		Specified Volumes		gallons

Purging: Bailer Middleburg <u>X</u> Electric Submersible Suction Pump Type of Installed Pump _____	Sampling: Bailer <u>X</u> <u>DISPOS.</u> Middleburg Electric Submersible Suction Pump Installed Pump
--	--

TIME	TEMP. (F)	pH	COND.	TURBIDITY:	VOLUME REMOVED:	OBSERVATIONS:
1421	68.2	7.0	1200.	—	4.	ODOR
1423	68.0	7.1	1200.	—	8.	
1425	68.4	7.0	1200.	—	12.	

Did Well Dewater? NO If yes, gals. Gallons Actually Evacuated: 12

Sampling Time: 1430

Sample I.D.: C-6 Laboratory: G-TEL

Analyzed for: TPH6, BTEX

Duplicate I.D.: Cleaning Blank I.D.:

Analyzed for:

Shipping Notations:

Additional Notations:

CHEVRON WELL MONITORING DATA SHEET

Project #: 950118-4	Station # 9-1924
Sampler: LAD	Date Sampled: 1-18-95
Well I.D.: C-7	Well Diameter: (circle one) 2 <u>3</u> 4 6
Total Well Depth: Before 21.71 After	Depth to Water: Before 11.59 After
Depth to Free Product:	Thickness of Free Product (feet):
Measurements referenced to: <u>PVC</u>	Grade Other --

<u>3.7</u>	<u>x</u>	<u>3</u>	<u>=</u>	<u>11.1</u>
1 Case Volume		Specified Volumes		gallons

Purging: Bailer Middleburg <u>X</u> Electric Submersible Suction Pump Type of Installed Pump _____	Sampling: Bailer <u>X</u> DISPOS. Middleburg Electric Submersible Suction Pump Installed Pump
--	---

TIME	TEMP. (F)	pH	COND.	TURBIDITY:	VOLUME REMOVED:	OBSERVATIONS:
1352	71.0	7.3	1400.	—	4.	ODOR
1353	69.8	7.2	1300.	—	8.	
1355	69.6	7.2	1400	—	12.	

Did Well Dewater? NO If yes, gals. Gallons Actually Evacuated: 12.

Sampling Time: 1400

Sample I.D.: C-7 Laboratory: G-TEL

Analyzed for: TPH6, BTEX

Duplicate I.D.: _____ Cleaning Blank I.D.: _____

Analyzed for:

Shipping Notations:

Additional Notations:

CHEVRON WELL MONITORING DATA SHEET

Project #: <u>950118-41</u>	Station # <u>9-1924</u>
Sampler: <u>LAD</u>	Date Sampled: <u>1-18-94</u>
Well I.D.: <u>C-8</u>	Well Diameter: (circle one) 2 <u>(3)</u> 4 6
Total Well Depth: Before <u>11.95</u> After	Depth to Water: Before <u>DRY</u> After
Depth to Free Product:	Thickness of Free Product (feet):
Measurements referenced to: <u>PVC</u>	Grade Other --

_____ X _____	= _____	
1 Case Volume	Specified Volumes	gallons

Purging: Bailer
Middleburg
Electric Submersible
Suction Pump
Type of Installed Pump _____

Sampling: Bailer
Middleburg
Electric Submersible
Suction Pump
Installed Pump

TIME	TEMP. (F)	PH	COND.	TURBIDITY:	VOLUME REMOVED:	OBSERVATIONS:
						<u>- PVC AT TOP OF CASING IS DAMAGED</u>
						<u>- TID IS NOW (11.95') WAS</u>
						<u>- DTW WAS (13.50') 7-21, 22, 94</u>
						<u>- POSSIBLY FILLED WITH DIRT, SINCE WELL WAS FOUND WITHOUT CAP</u>

Did Well Dewater? If yes, gals. Gallons Actually Evacuated:

Sampling Time:

Sample I.D.:

Laboratory:

Analyzed for:

Duplicate I.D.:

Cleaning Blank I.D.:

Analyzed for:

Shipping Notations:

Additional Notations:

CHEVRON WELL MONITORING DATA SHEET

Project #: <u>950118-L1</u>	Station # <u>9-1924</u>
Sampler: <u>LAD</u>	Date Sampled: <u>1-18-95</u>
Well I.D.: <u>C-9</u>	Well Diameter: (circle one) 2 <u>(3)</u> 4 6
Total Well Depth: Before <u>22.72</u> After	Depth to Water: Before <u>11.15</u> After
Depth to Free Product:	Thickness of Free Product (feet):
Measurements referenced to: <u>EVC</u>	Grade Other --

<u>4.3</u>	<u>x</u>	<u>3</u>	<u>=</u>	<u>12.9</u>
1 Case Volume		Specified Volumes		gallons

Purging: Bailer
Middleburg
Electric Submersible X
Suction Pump
Type of Installed Pump _____

Sampling: Bailer X DISPOS.
Middleburg
Electric Submersible
Suction Pump
Installed Pump

TIME	TEMP. (F)	pH	COND.	TURBIDITY:	VOLUME REMOVED:	OBSERVATIONS:
<u>1244</u>	<u>67.6</u>	<u>7.5</u>	<u>1200.</u>	<u>—</u>	<u>5.</u>	<u>ODOR</u>
<u>1246</u>	<u>67.6</u>	<u>7.2</u>	<u>1100.</u>	<u>—</u>	<u>9.</u>	<u>LIGHT SHEEN</u>
<u>1248</u>	<u>66.0</u>	<u>7.2</u>	<u>1100.</u>	<u>—</u>	<u>13.</u>	

Did Well Dewater? 110 If yes, gals.

Gallons Actually Evacuated: 13.

Sampling Time: 1250

Sample I.D.: C-9

Laboratory: B-TEL

Analyzed for: TPH6, BTEX

Duplicate I.D.:

Cleaning Blank I.D.:

Analyzed for:

Shipping Notations:

Additional Notations:

CHEVRON WELL MONITORING DATA SHEET

Project #: <u>950118-21</u>	Station #: <u>9-1924</u>
Sampler: <u>LAD</u>	Date Sampled: <u>1-18-95</u>
Well I.D.: <u>C-10</u>	Well Diameter: (circle one) 2 <u>3</u> 4 6
Total Well Depth: Before <u>34.55</u> After	Depth to Water: Before <u>13.64</u> After
Depth to Free Product:	Thickness of Free Product (feet):
Measurements referenced to: <u>PVC</u>	Grade Other --

<u>7.7</u>	<u>x</u>	<u>3</u>	<u>=</u>	<u>23.1</u>
1 Case Volume		Specified Volumes		gallons

Purging: Bailer
 Middleburg
 Electric Submersible X
 Suction Pump
 Type of Installed Pump _____

Sampling: Bailer X DISPOS.
 Middleburg
 Electric Submersible
 Suction Pump
 Installed Pump

TIME	TEMP. (F)	pH	COND.	TURBIDITY:	VOLUME REMOVED:	OBSERVATIONS:
<u>928</u>	<u>59.0</u>	<u>6.9</u>	<u>1800.</u>	<u>—</u>	<u>8.</u>	
<u>930</u>	<u>60.2</u>	<u>7.0</u>	<u>1500.</u>	<u>—</u>	<u>16.</u>	
<u>932</u>	<u>61.6</u>	<u>7.0</u>	<u>1500.</u>	<u>—</u>	<u>24.</u>	

Did Well Dewater? NO If yes, gals.

Gallons Actually Evacuated: 24

Sampling Time: 940

Sample I.D.: C-10

Laboratory: G-TEL

Analyzed for: TPH6, BTEX

Duplicate I.D.:

Cleaning Blank I.D.:

Analyzed for:

Shipping Notations:

Additional Notations: C+L

CHEVRON WELL MONITORING DATA SHEET

Project #: <u>950118-41</u>	Station # <u>9-1924</u>
Sampler: <u>LAD</u>	Date Sampled: <u>1-18-95</u>
Well I.D.: <u>C-11</u>	Well Diameter: (circle one) 2 <u>(3)</u> 4 6
Total Well Depth: Before <u>19.64</u> After	Depth to Water: Before <u>13.23</u> After
Depth to Free Product:	Thickness of Free Product (feet):
Measurements referenced to: <u>PVC</u>	Grade Other --

<u>2.4</u>	<u>x</u>	<u>3</u>	<u>=</u>	<u>7.2</u>
1 Case Volume		Specified Volumes		gallons

Purging: Bailer Middleburg Electric Submersible <input checked="" type="checkbox"/> Suction Pump Type of Installed Pump _____	Sampling: Bailer <input checked="" type="checkbox"/> <u>DISPOS.</u> Middleburg Electric Submersible Suction Pump Installed Pump
---	---

TIME	TEMP. (F)	PH	COND.	TURBIDITY:	VOLUME REMOVED:	OBSERVATIONS:
<u>1020</u>	<u>57.4</u>	<u>7.4</u>	<u>880.</u>	<u>—</u>	<u>3.</u>	
<u>1028</u>	<u>58.2</u>	<u>7.5</u>	<u>870.</u>	<u>—</u>	<u>5.</u>	
<u>1038</u>	<u>58.0</u>	<u>7.6</u>	<u>850.</u>	<u>—</u>	<u>8.</u>	

Did Well Dewater? NO If yes, gals. Gallons Actually Evacuated: 8.

Sampling Time: 1040

Sample I.D.: C-11 Laboratory: G-TEL

Analyzed for: TPH6, BTEX

Duplicate I.D.: Cleaning Blank I.D.:

Analyzed for:

Shipping Notations:

Additional Notations:

CHEVRON WELL MONITORING DATA SHEET

Project #: 950118-L1	Station #: 9-1924
Sampler: LAD	Date Sampled: 1-18-95
Well I.D.: C-14	Well Diameter: (circle one) 2 <u>3</u> 4 6
Total Well Depth: Before 11.68 After	Depth to Water: Before DRY After
Depth to Free Product:	Thickness of Free Product (feet):
Measurements referenced to: <u>PVC</u>	Grade Other --

_____ X _____	Specified Volumes	=	_____ gallons
1 Case Volume			

Purging: Bailer Middleburg Electric Submersible Suction Pump Type of Installed Pump _____	Sampling: Bailer Middleburg Electric Submersible Suction Pump Installed Pump _____
---	--

TIME	TEMP. (F)	pH	COND.	TURBIDITY:	VOLUME REMOVED:	OBSERVATIONS:
						- DRY WELL NOT SAMPLED
						- THIS WELL SHOULD AT LEAST BE 13'
						- UPON ARRIVAL WELL HAD NO CAP
						- ROAD LOOKS LIKE IT WAS RECENTLY PAVED

Did Well Dewater? If yes, gals. Gallons Actually Evacuated:

Sampling Time:

Sample I.D.: Laboratory:

Analyzed for:

Duplicate I.D.: Cleaning Blank I.D.:

Analyzed for:

Shipping Notations:

Additional Notations:

CHEVRON WELL MONITORING DATA SHEET

Project #: 950118-L1		Station # 9-1924	
Sampler: LAD		Date Sampled:	
Well I.D.: C-16		Well Diameter: (circle one) 2 3 4 6	
Total Well Depth:		Depth to Water:	
Before	After	Before	After
Depth to Free Product:		Thickness of Free Product (feet):	
Measurements referenced to:		PVC	Grade Other --

_____ X _____	=	_____ gallons
1 Case Volume	Specified Volumes	

Purging: Bailer Middleburg Electric Submersible Suction Pump Type of Installed Pump _____	Sampling: Bailer Middleburg Electric Submersible Suction Pump Installed Pump
---	--

TIME	TEMP. (F)	pH	COND.	TURBIDITY:	VOLUME REMOVED:	OBSERVATIONS:
						(C-16) MUST BE PAVED OVER - ROAD LOOKS RECENTLY PAVED

Did Well Dewater? If yes, gals. Gallons Actually Evacuated:

Sampling Time:

Sample I.D.:

Laboratory:

Analyzed for:

Duplicate I.D.:

Cleaning Blank I.D.:

Analyzed for:

Shipping Notations:

Additional Notations:

CHEVRON WELL MONITORING DATA SHEET

Project #: 950118-L1	Station #: 9-1924
Sampler: LAD	Date Sampled: 1-18-95
Well I.D.: C-17	Well Diameter: (circle one) 2 <u>3</u> 4 6
Total Well Depth: Before 20.35 After	Depth to Water: Before 13.70 After
Depth to Free Product:	Thickness of Free Product (feet):
Measurements referenced to:	<u>PVC</u> Grade Other --

2.5	x	3	=	7.5
1 Case Volume		Specified Volumes		gallons

Purging: Bailer
 Middleburg
 Electric Submersible X
 Suction Pump
 Type of Installed Pump _____

Sampling: Bailer X DISPOS.
 Middleburg
 Electric Submersible
 Suction Pump
 Installed Pump _____

TIME	TEMP. (F)	pH	COND.	TURBIDITY:	VOLUME REMOVED:	OBSERVATIONS:
1050	68.0	7.3	1000.	—	3.	
1052	67.8	7.3	1100.	—	5.	
1054	69.6	7.1	1200.	—	8.	

Did Well Dewater? NO If yes, gals.

Gallons Actually Evacuated: 8.

Sampling Time: 1100

Sample I.D.: C-17

Laboratory: G-TEL

Analyzed for: TPH6, BTEX

Duplicate I.D.:

Cleaning Blank I.D.:

Analyzed for:

Shipping Notations:

Additional Notations:

CHEVRON WELL MONITORING DATA SHEET

Project #: <u>950118-L1</u>	Station #: <u>9-1924</u>
Sampler: <u>LAD</u>	Date Sampled: <u>1-18-95</u>
Well I.D.: <u>C-19</u>	Well Diameter: (circle one) <u>(2)</u> 3 4 6
Total Well Depth: Before <u>24.15</u> After	Depth to Water: Before <u>14.02</u> After
Depth to Free Product:	Thickness of Free Product (feet):
Measurements referenced to: <u>PVC</u>	Grade Other --

<u>1.6</u>	x	<u>3</u>	=	<u>4.8</u>
1 Case Volume		Specified Volumes		gallons

Purging: Bailer ~~X~~ DISPOS.
 Middleburg
 Electric Submersible
 Suction Pump
 Type of Installed Pump _____

Sampling: Bailer ~~X~~ DISPOS.
 Middleburg
 Electric Submersible
 Suction Pump
 Installed Pump _____

TIME	TEMP. (F)	pH	COND.	TURBIDITY:	VOLUME REMOVED:	OBSERVATIONS:
<u>954</u>	<u>65.4</u>	<u>7.0</u>	<u>1500.</u>	<u>—</u>	<u>2.</u>	
<u>958</u>	<u>66.4</u>	<u>7.0</u>	<u>1500.</u>	<u>—</u>	<u>4.</u>	
<u>1002</u>	<u>66.2</u>	<u>7.0</u>	<u>1600.</u>	<u>—</u>	<u>5.</u>	

Did Well Dewater? NO If yes, gals.

Gallons Actually Evacuated: 5.

Sampling Time: 1010

Sample I.D.: C-19

Laboratory: G-TEL

Analyzed for: TPH6, BTEX

Duplicate I.D.:

Cleaning Blank I.D.:

Analyzed for:

Shipping Notations:

Additional Notations: