



Chevron

93 OCT 21 PM 2:38

October 17, 1993

Mr. Scott Seery
Alameda County Environmental Health
80 Swan Way, Room 200
Oakland, CA 94621

Chevron U.S.A. Products Company

2410 Camino Ramon
San Ramon, CA 94583
P.O. Box 5004
San Ramon, CA 94583-0804

Marketing Department

Phone 510 842 9500

Re: Chevron Station # 9-1924, 4904 South Front Street, Livermore, CA
Attached groundwater monitoring report (GTI, 4/16/93)
Attached groundwater monitoring report (GTI, 6/7/93)

Dear Mr. Seery:

Attached you will find reports dated April 16, 1993 and June 7, 1993, which were prepared by Chevron's consultant, Groundwater Technology, Inc. (GTI), to describe the results of groundwater monitoring performed on March 26, 1993 and April 22, 1993.

The April report by GTI presents groundwater monitoring data that was collected during separate site visits in January and March. The measured direction of groundwater flow in January was toward the west-northwest. During the March groundwater monitoring event the measured direction of groundwater flow was toward the northwest. The analytical results reported for the January groundwater sampling were suspect due to sampling equipment contamination. All groundwater monitoring wells were resampled in March with the exception of wells C-5, C-8, and C-9. Wells C-8 and C-9 were inaccessible; gasoline from surface runoff was present in the wellbox at well C-5. The measured levels of dissolved hydrocarbons were consistent with data collected during previous site monitoring events.

During the April site monitoring event the measured direction of groundwater flow was towards the northwest. All site-related monitoring wells were sampled and analyzed for the presence of TPHGas and BTEX constituents. The detected concentrations of dissolved hydrocarbons in both, onsite and offsite wells, remained consistent to those detected during previous measurements.

If you have any questions or comments, I can be reached at (510) 842-8695.

Sincerely,

Brett L. Hunter
Environmental Engineer
Site Assessment and Remediation



Attachments

cc: Eddie So, San Francisco Bay RWQCB, Oakland, CA
Jeanne Price, 213 Del Mesa Carmel, Carmel, CA 93921
Dave Baker, Mobil Oil, 3225 Gallows Rd., Rm. 1W109, Fairfax, Virginia, 22037
Scott Hooton, BP Oil, Northwest Division, Southcenter Place Bldg., 16400 Southcenter
Parkway, Suite 301, Tukwila, Washington, 98188

APR 23 '93 J.M.M.

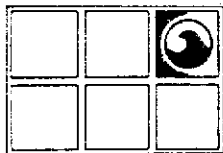

GROUNDWATER TECHNOLOGY, INC.

1401 Halyard Drive, Suite 140, West Sacramento, CA 95691, (916) 372-4700

FAX (916) 372-8781

April 16, 1993

Project No. 02020 2886

Mr. Brett L. Hunter
Chevron U.S.A. Products Company
2410 Camino Ramon
San Ramon, CA 94583-0804

**RE: QUARTERLY MONITORING AND SAMPLING ACTIVITIES
CHEVRON SERVICE STATION 9-1924
4904 SOUTHFRONT ROAD
LIVERMORE, CALIFORNIA**

Dear Mr. Hunter:

Groundwater Technology, Inc. submits this letter as a summary of quarterly groundwater monitoring and sampling data collected at the above-referenced site on **January 14 and March 26, 1993**. On January 14, 1993, the eighteen site-related groundwater monitoring wells were gauged to determine depth to groundwater (DTW) and to check for the presence of separate-phase petroleum hydrocarbons (SP). A potentiometric surface map (Figure 1) and a summary of groundwater monitoring data (Table 1) are included. The January 14, 1993 potentiometric surface map includes data collected on the same date by Kaprelian Engineering, Inc. for the Unocal station northwest of the Chevron site. After measuring DTW, each monitoring well was purged and sampled. The groundwater samples were analyzed for dissolved benzene, toluene, ethylbenzene and xylenes (BTEX), and total petroleum hydrocarbons-as-gasoline (TPH-G). Results of the chemical analyses are summarized in Table 1.

Because of the presence of dissolved petroleum hydrocarbons in the rinsate sample collected on January 14, 1993, the site was remonitored and resampled on March 26, 1993. A potentiometric surface map (Figure 2) and groundwater monitoring and sampling data (Table 1) are included. Three of the eighteen monitoring wells could not be gauged or sampled on March 26, 1993. Monitoring wells C-8 and C-9 were under water, and monitoring well C-5 contained SP in the well box. The groundwater samples were analyzed for dissolved BTEX and TPH-G. Results of the chemical analyses are summarized in Table 1. Toluene was detected in both the rinsate and trip blank samples and is believed to be the result of contaminated sampling containers (VOA's).

Laboratory reports and chain-of-custody manifests for the January 14, 1993 and March 26, 1993 sampling events are included in Attachment I. All purge water generated during sampling was collected in a Department of Transportation (DOT)-approved purge trailer and transported for recycling to the Chevron refinery in Richmond, California.

Groundwater Technology, Inc. is pleased to assist Chevron on this project. If you have any questions or comments please call our West Sacramento office.

Sincerely,
Groundwater Technology, Inc.
Written/Submitted by



BRUCE H. EPPLER
Environmental Geologist
Project Manager

PR DSB

DSB/BHE/EKS:rb
Attachments

2886QTR1.LTR

Groundwater Technology, Inc.
Reviewed/Approved by



E. K. SIMONIS, R.G.
Senior Environmental Geologist

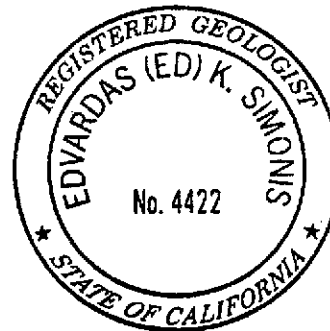

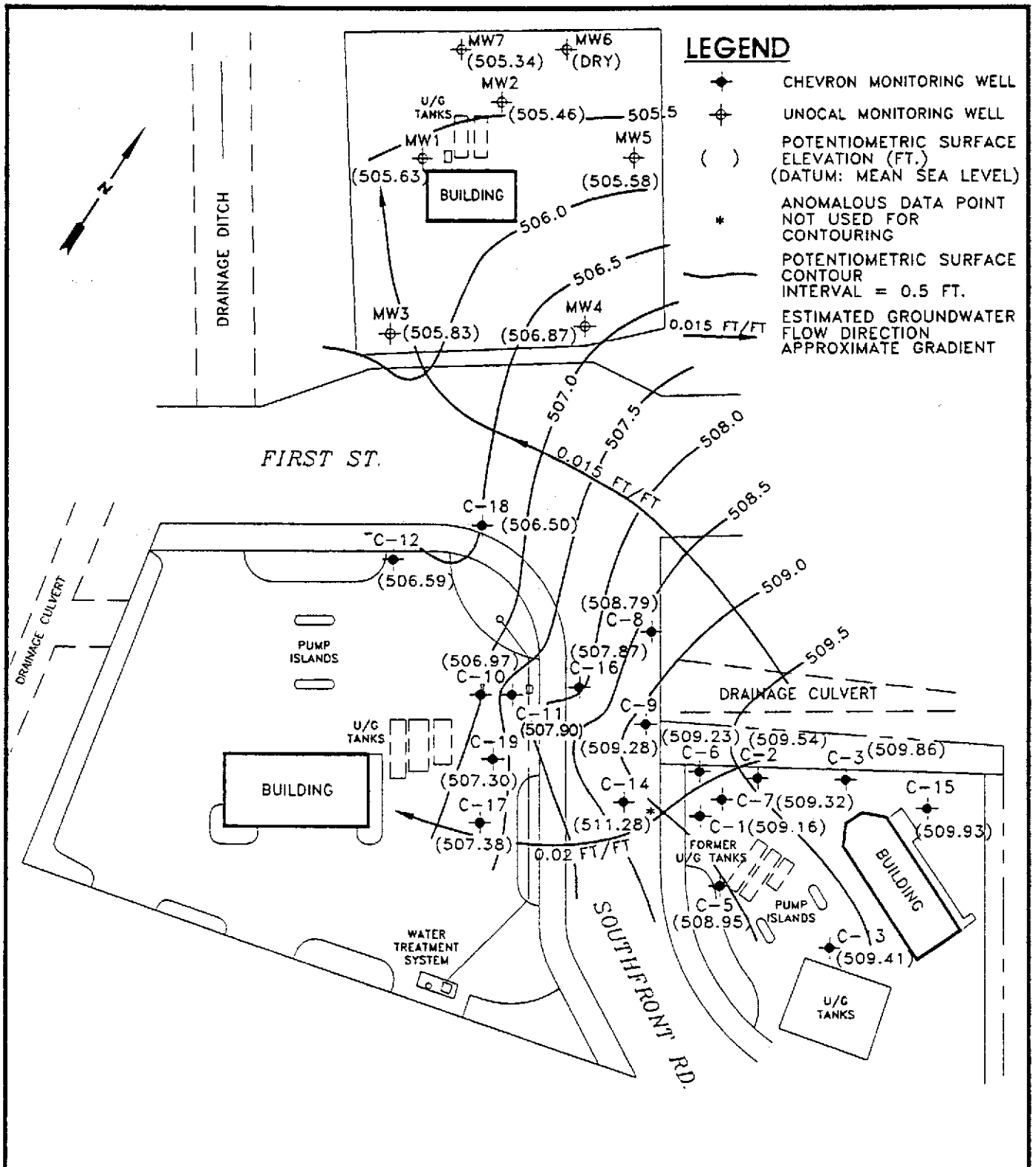

GROUNDWATER TECHNOLOGY



POTENTIOMETRIC SURFACE MAP
JANUARY 14, 1993

CLIENT: CHEVRON U.S.A. PRODUCTS CO.
SS #9-1924

LOCATION: 4904 SOUTHFRONT RD.
LIVERMORE, CALIFORNIA

REV. NO.: 1
DATE: 3/3/93

PM
BN

PE/RG
EL

DESIGNED
DSB

DETAILED
AJK

ACAD FILE:
POT3493/SP293

PROJECT NO.:
02020-2886

FIGURE:
1

**Table 1
HISTORICAL GROUNDWATER ANALYTICAL RESULTS AND MONITORING DATA**

CHEVRON SERVICE STATION #9-1924
4904 SOUTHFRONT ROAD, LIVERMORE, CALIFORNIA

WELL ID/ ELEVATION (TOC)	DATE	BENZENE (ppb)	TOLUENE (ppb)	ETHYL- BENZENE (ppb)	XYLENES (ppb)	TPH-G (ppb)	TOG (ppb)	1,2- DCA (ppb)	OTHER (ppb)	MC (ppb)	1,1,1- TCA (ppb)	1,1- DCA (ppb)	PCE (ppb)	DTW (feet)	SPT (feet)	WTE (feet)
C-1 520.39	03/28/86	--	--	--	--	--	--	--	--	--	--	--	--	11.75	0.00	508.64
	03/15/88	770	87	610	2,100	27,000	--	--	--	--	--	--	--	13.50	0.00	506.89
	05/10/88	--	--	--	--	--	--	--	--	--	--	--	--	13.65	0.00	506.74
	06/10/88	--	--	--	--	--	--	--	--	--	--	--	--	14.72	0.00	505.67
	07/25/88	--	--	--	--	--	--	--	--	--	--	--	--	13.50	0.00	506.89
	10/13/88	220	11	62	130	3,200	--	--	--	--	--	--	--	12.89	0.00	507.50
	01/01/89	--	--	--	--	--	--	--	--	--	--	--	--	12.89	0.00	507.50
	01/12/89	820	43	490	260	4,000	--	--	--	--	--	--	--	--	--	--
	04/10/89	100	ND	70	50	4,000	ND	ND	--	--	--	--	--	13.65	0.00	506.74
	04/10/89	100	ND	60	50	4,000	ND	ND	--	--	--	--	--	13.65	0.00	506.74
	06/26/89	97	20	60	50	600	ND	3	--	--	--	--	--	13.94	0.00	506.45
	06/26/89	86	15	44	35	570	ND	1.7	--	--	--	--	--	13.94	0.00	506.45
	10/13/89	64	ND	51	48	1,600	ND	ND	5	--	--	--	--	13.92	0.00	506.47
	01/03/90	36	0.68	30	30	1,100	--	--	1	--	--	--	--	13.80	0.00	506.59
	05/08/90	37	9.2	40	32	1,300	--	--	1.2	--	ND	ND	--	13.91	0.00	506.48
	09/29/90	19	1.2	32	31	350	--	--	ND	ND	0.7	1.4	ND	13.93	0.00	506.46
	01/03/91	12	ND	17	14	400	--	--	ND	ND	ND	ND	ND	13.85	0.00	506.54
	04/12/91	--	--	--	--	--	--	--	--	--	--	--	--	13.51	0.00	506.88
	09/04/91	--	--	--	--	--	--	--	--	--	--	--	--	14.10	0.00	506.29
	04/06/92	12	0.8	31	31	1,000	--	--	ND	ND	ND	ND	ND	13.06	0.00	507.33
07/28/92	47	110	96	260	4,200	--	--	--	--	--	--	--	13.93	0.00	506.46	
10/16/92	11	ND	32.0	55.0	1,800	--	--	--	--	--	--	--	14.45	0.00	505.94	
01/14/93*	24	ND	98	62	2,000	--	--	--	--	--	--	--	11.23	0.00	509.16	
03/26/93	21	12	120	100	4,400	--	--	--	--	--	--	--	10.94	0.00	509.45	
C-2 520.76	03/28/86	--	--	--	--	--	--	--	--	--	--	--	--	11.98	0.00	508.78
	03/15/88	3,900	1,900	1,200	1,200	22,000	--	--	--	--	--	--	--	13.77	0.00	506.99
	05/10/88	--	--	--	--	--	--	--	--	--	--	--	--	14.03	0.00	506.73
	06/10/88	--	--	--	--	--	--	--	--	--	--	--	--	15.12	0.00	505.64
	07/25/88	--	--	--	--	--	--	--	--	--	--	--	--	13.86	0.00	506.90
	10/13/88	ND	ND	ND	ND	ND	--	--	--	--	--	--	--	14.11	0.00	506.65
	01/01/89	--	--	--	--	--	--	--	--	--	--	--	--	12.83	0.00	507.93
	01/12/89	25	3	83	59	1,000	--	--	--	--	--	--	--	--	--	--
	04/10/89	2.5	ND	15	12	600	ND	ND	--	--	--	--	--	14.04	0.00	506.72
	04/10/89	ND	ND	11	11	ND	ND	ND	--	--	--	--	--	14.04	0.00	506.72
	06/26/89	5.3	8	18	14	640	ND	ND	--	--	--	--	--	14.34	0.00	506.42
	06/26/89	3.7	0.6	13	8.2	750	ND	2	--	--	--	--	--	14.34	0.00	506.42
	10/13/89	ND	ND	17	10	630	--	--	ND	--	--	--	--	13.92	0.00	506.84
	01/03/90	3	ND	19	17	880	--	--	1	--	--	--	--	14.11	0.00	506.65
	05/08/90	1.3	2.7	8.4	11	340	--	--	1.1	--	ND	ND	--	14.28	0.00	506.48
	09/29/90	ND	ND	4.6	1.8	74	--	--	ND	ND	1.7	0.5	ND	14.25	0.00	506.51
	01/03/91	270	ND	79	93	2,000	--	--	ND	ND	ND	ND	ND	14.15	0.00	506.61
	04/12/91	--	--	--	--	--	--	--	--	--	--	--	--	13.86	0.00	506.90
	09/04/91	--	--	--	--	--	--	--	--	--	--	--	--	14.50	0.00	506.26
	04/06/92	ND	ND	54.0	6.1	1,200	--	--	ND	ND	ND	ND	ND	13.47	0.00	507.29
07/28/92	5.2	2.9	26	16	1,000	--	--	--	--	--	--	--	14.35	0.00	506.41	
10/16/92	ND	2.2	20	10	2,000	--	--	--	--	--	--	--	14.84	0.00	505.92	
01/14/93*	49	50	31	29	1,800	--	--	--	--	--	--	--	11.22	0.00	509.54	
03/26/93	15	12	14	6	820**	--	--	--	--	--	--	--	10.77	0.00	509.99	

**Table 1
HISTORICAL GROUNDWATER ANALYTICAL RESULTS AND MONITORING DATA**

CHEVRON SERVICE STATION #9-1924
4904 SOUTHFRONT ROAD, LIVERMORE, CALIFORNIA

WELL ID/ ELEVATION (TOC)	DATE	BENZENE (ppb)	TOLUENE (ppb)	ETHYL- BENZENE (ppb)	XYLENES (ppb)	TPH-G (ppb)	TOG (ppb)	1,2- DCA (ppb)	OTHER (ppb)	MC (ppb)	1,1,1- TCA (ppb)	1,1- DCA (ppb)	PCE (ppb)	DTW (feet)	SPT (feet)	WTE (feet)
C-3 521.31	03/28/86	--	--	--	--	--	--	--	--	--	--	--	--	12.24	0.00	509.07
	03/15/88	86	8	30	36.0	2,100	--	--	--	--	--	--	--	14.21	0.00	507.10
	05/10/88	--	--	--	--	--	--	--	--	--	--	--	--	14.43	0.00	506.88
	06/10/88	--	--	--	--	--	--	--	--	--	--	--	--	15.53	0.00	505.78
	07/25/88	--	--	--	--	--	--	--	--	--	--	--	--	14.22	0.00	507.09
	10/13/88	ND	ND	ND	ND	ND	--	--	--	--	--	--	--	14.10	0.00	507.21
	01/01/89	--	--	--	--	--	--	--	--	--	--	--	--	12.70	0.00	508.61
	04/10/89	2.1	ND	4.4	2.6	200	ND	1.4	--	--	--	--	--	14.36	0.00	506.95
	06/26/89	1.1	0.7	4.9	1.6	260	ND	1.5	--	--	--	--	--	14.74	0.00	506.57
	10/13/89	ND	ND	ND	ND	ND	--	ND	--	--	--	--	--	14.70	0.00	506.61
	01/03/90	ND	ND	0.9	1.4	ND	--	0.7	--	--	--	--	--	14.42	0.00	506.89
	05/08/90	ND	ND	ND	ND	ND	--	0.7	--	ND	--	ND	--	14.65	0.00	506.66
	09/27/90	ND	1.0	ND	ND	71	--	ND	ND	1.1	1.6	ND	--	14.67	0.00	506.64
	01/03/91	ND	ND	ND	ND	57	--	ND	ND	ND	ND	ND	ND	14.58	0.00	506.73
	04/12/91	ND	ND	1.6	ND	98	--	ND	ND	ND	ND	ND	ND	14.23	0.00	507.08
	09/04/91	ND	ND	ND	ND	64	--	ND	ND	ND	ND	ND	ND	14.88	0.00	506.43
	04/06/92	ND	ND	0.8	ND	88	--	ND	ND	ND	ND	ND	ND	13.83	0.00	507.48
	07/28/92	ND	ND	0.5	1.1	80	--	--	--	--	--	--	--	14.80	0.00	506.51
10/16/92	ND	ND	6.6	11	1,400	--	--	--	--	--	--	--	15.23	0.00	506.08	
01/14/93*	ND	ND	ND	1.3	100	--	--	--	--	--	--	--	11.45	0.00	509.86	
03/26/93	0.7	1	ND	ND	74	--	--	--	--	--	--	--	11.27	0.00	510.04	
C-5 520.82	03/28/86	--	--	--	--	--	--	--	--	--	--	--	--	12.00	0.00	508.82
	03/15/88	82	7	77	95	1,600	--	--	--	--	--	--	--	13.75	0.00	507.07
	05/10/88	--	--	--	--	--	--	--	--	--	--	--	--	13.92	0.00	506.90
	07/10/88	--	--	--	--	--	--	--	--	--	--	--	--	13.72	0.00	507.10
	07/25/88	--	--	--	--	--	--	--	--	--	--	--	--	13.72	0.00	507.10
	10/13/88	ND	ND	ND	ND	2,500	--	--	--	--	--	--	--	13.84	0.00	506.98
	01/01/89	--	--	--	--	--	--	--	--	--	--	--	--	13.41	0.00	507.41
	01/12/89	42	3	44	52	ND	--	--	--	--	--	--	--	--	0.00	520.82
	04/10/89	2.6	ND	6.2	5.5	180	ND	1.4	--	--	--	--	--	13.88	--	--
	06/26/89	7.6	0.8	40	56	420	ND	1.5	--	--	--	--	--	14.14	0.00	506.68
	10/13/89	ND	ND	10	ND	620	ND	ND	--	--	--	--	--	14.15	0.00	506.67
	01/03/90	0.7	ND	8	6	ND	--	ND	--	--	--	--	--	14.10	0.00	506.72
	05/08/90	0.6	0.8	11	7.2	140	--	0.8	--	ND	--	ND	--	14.00	0.00	506.82
	09/27/90	ND	3.2	5.2	6.4	360	--	ND	ND	0.7	ND	ND	--	14.00	0.00	506.82
	01/03/91	ND	ND	ND	3	90	--	ND	ND	ND	ND	ND	ND	14.00	0.00	506.82
	04/12/91	12	ND	19	7	270	--	0.5	ND	ND	ND	ND	ND	13.71	0.00	507.11
	09/04/91	ND	ND	ND	ND	ND	--	ND	ND	ND	ND	ND	ND	14.30	0.00	506.52
	04/06/92	12	ND	40	ND	670	--	ND	ND	ND	ND	ND	ND	13.29	0.00	507.53
07/28/92	15	ND	1.8	0.5	130	--	--	--	--	--	--	--	14.13	0.00	506.69	
10/16/92	ND	ND	ND	1.2	ND	--	--	--	--	--	--	--	14.68	0.00	506.14	
01/14/93*	13	ND	110	10	2,300	--	--	--	--	--	--	--	11.87	0.00	508.95	
03/26/93	--	--	--	--	--	--	--	--	--	--	--	--	--	--	--	--

Table 1
HISTORICAL GROUNDWATER ANALYTICAL RESULTS AND MONITORING DATA

CHEVRON SERVICE STATION #9-1924
4904 SOUTHFRONT ROAD, LIVERMORE, CALIFORNIA

WELL ID/ ELEVATION (TOC)	DATE	BENZENE (ppb)	TOLUENE (ppb)	ETHYL- BENZENE (ppb)	XYLENES (ppb)	TPH-G (ppb)	TOG (ppb)	1,2- DCA (ppb)	OTHER (ppb)	MC (ppb)	1,1,1- TCA (ppb)	1,1- DCA (ppb)	PCE (ppb)	DTW (feet)	SPT (feet)	WTE (feet)
C-6 519.62	03/26/86	--	--	--	--	--	--	--	--	--	--	--	--	11.12	0.00	508.50
	03/15/88	870	4,600	1,500	8,200	46,000	--	--	--	--	--	--	--	12.93	0.00	506.69
	05/10/88	1,400	10,000	3,000	19,000	86,000	--	--	--	--	--	--	--	13.03	0.00	506.59
	06/10/88	--	--	--	--	--	--	--	--	--	--	--	--	14.11	0.00	505.51
	07/25/88	--	--	--	--	--	--	--	--	--	--	--	--	12.95	0.00	506.67
	10/13/88	300	600	260	1,600	5,300	--	--	--	--	--	--	--	13.14	0.00	506.48
	01/01/89	--	--	--	--	--	--	--	--	--	--	--	--	12.14	0.00	507.48
	01/12/89	260	110	270	720	5,000	--	--	--	--	--	--	--	--	--	--
	04/12/89	90	190	190	680	5,000	4.0	ND	--	--	--	--	--	12.98	0.00	506.64
	06/26/89	77	250	140	610	3,600	ND	ND	--	--	--	--	--	13.39	0.00	506.23
	10/13/89	32	81	100	530	3,500	ND	ND	--	--	--	--	--	13.40	0.00	506.22
	01/03/90	20	97	65	410	3,200	--	1	--	--	--	--	--	13.18	0.00	506.44
	05/08/90	17	140	ND	400	1,800	--	1.6	--	ND	--	ND	--	13.39	0.00	506.23
	09/29/90	58	210	260	2,100	8,000	--	1.0	ND	ND	2.4	1.6	--	13.32	0.00	506.30
	01/03/91	4	79	59	380	2,300	--	0.5	ND	ND	ND	ND	ND	13.19	0.00	506.43
	04/12/91	--	--	--	--	--	--	--	--	--	--	--	--	12.91	0.00	506.71
	09/04/91	--	--	--	--	--	--	--	--	--	--	--	--	13.56	0.00	506.06
	04/06/92	ND	120	740	3,400	44,000	--	ND	ND	ND	ND	ND	ND	12.48	0.00	507.14
	07/28/92	220	1,100	3,000	13,000	120,000	--	--	--	--	--	--	--	13.47	0.00	506.15
10/16/92	ND	830	3,300	9,600	570,000	--	--	--	--	--	--	--	13.95	0.00	505.67	
01/14/93*	ND	25	460	980	19,000	--	--	--	--	--	--	--	10.39	0.00	509.23	
03/26/93	30	90	290	1,100	11,000**	--	--	--	--	--	--	--	9.83	0.00	509.79	
C-7 520.30	03/28/86	--	--	--	--	--	--	--	--	--	--	--	--	11.67	0.00	508.63
	03/15/88	98	690	120	120	8,000	--	--	--	--	--	--	--	13.48	0.00	506.82
	05/10/88	--	--	--	--	--	--	--	--	--	--	--	--	13.60	0.00	506.70
	06/10/88	--	--	--	--	--	--	--	--	--	--	--	--	14.68	0.00	505.62
	07/25/88	--	--	--	--	--	--	--	--	--	--	--	--	13.43	0.00	506.87
	10/13/88	4,400	220	1,000	3,000	16,000	--	--	--	--	--	--	--	13.61	0.00	506.69
	01/01/89	--	--	--	--	--	--	--	--	--	--	--	--	12.66	0.00	507.64
	01/12/89	950	47	670	640	8,000	--	--	--	--	--	--	--	--	--	--
	04/12/89	1,100	30	760	370	6,000	ND	ND	--	--	--	--	--	13.60	0.00	506.70
	06/26/89	1,300	50	600	340	6,000	ND	ND	--	--	--	--	--	13.88	0.00	506.42
	10/13/89	1,300	ND	160	150	3,900	--	ND	--	--	--	--	--	13.81	0.00	506.49
	01/03/90	1,200	13	180	200	5,600	--	1	--	--	--	--	--	13.71	0.00	506.59
	05/08/90	1,100	15	110	140	3,500	--	1.7	--	ND	--	ND	--	13.85	0.00	506.45
	09/29/90	580	ND	46	68	2,400	--	0.7	ND	ND	ND	ND	ND	13.80	0.00	506.50
	01/03/91	300	2	110	120	2,500	--	0.7	ND	ND	ND	ND	ND	13.71	0.00	506.59
	04/12/91	190	1	81	87	2,300	--	0.6	ND	ND	ND	ND	ND	13.46	0.00	506.84
	09/04/91	--	--	--	--	--	--	--	--	--	--	--	--	14.09	0.00	506.21
	10/07/91	170	1.9	97	59	4,700	--	ND	ND	24	ND	ND	ND	--	--	--
	04/06/92	95	0.8	110	100	2,400	--	ND	ND	ND	ND	ND	ND	13.02	0.00	507.28
07/28/92	120	3.4	110	110	2,000	--	--	--	--	--	--	--	13.76	0.00	506.54	
10/16/92	130	4.2	68	74	2,700	--	--	--	--	--	--	--	14.42	0.00	505.88	
01/14/93*	160	33	380	210	7,800	--	--	--	--	--	--	--	10.98	0.00	509.32	
03/26/93	39	9	28	15	1,400	--	--	--	--	--	--	--	10.61	0.00	509.69	

Table 1
HISTORICAL GROUNDWATER ANALYTICAL RESULTS AND MONITORING DATA

CHEVRON SERVICE STATION #9-1924
4904 SOUTHFRONT ROAD, LIVERMORE, CALIFORNIA

WELL ID/ ELEVATION (TOC)	DATE	BENZENE (ppb)	TOLUENE (ppb)	ETHYL- BENZENE (ppb)	XYLENES (ppb)	TPH-G (ppb)	TOG (ppb)	1,2- DCA (ppb)	OTHER (ppb)	MC (ppb)	1,1,1- TCA (ppb)	1,1- DCA (ppb)	PCE (ppb)	DTW (feet)	SPT (feet)	WTE (feet)
C-8 519.74	03/28/86	--	--	--	--	--	--	--	--	--	--	--	--	11.78	0.00	507.96
	03/15/88	360	25	10	ND	7,500	--	--	--	--	--	--	--	13.63	0.00	506.11
	05/10/88	--	--	--	--	--	--	--	--	--	--	--	--	13.74	0.00	506.00
	06/10/88	--	--	--	--	--	--	--	--	--	--	--	--	14.89	0.00	504.85
	07/25/88	--	--	--	--	--	--	--	--	--	--	--	--	13.65	0.00	506.09
	10/13/88	6	5.3	ND	ND	ND	--	--	--	--	--	--	--	13.78	0.00	505.96
	01/01/89	--	--	--	--	--	--	--	--	--	--	--	--	12.68	0.00	507.06
	01/12/89	37	4	1	5	ND	--	--	--	--	--	--	--	--	--	--
	04/12/89	13	ND	ND	ND	3,000	12.0	5	--	--	--	--	--	13.77	0.00	505.97
	06/26/89	14	6	ND	6	780	ND	4	--	--	--	--	--	14.03	0.00	505.71
	10/13/89	ND	ND	ND	ND	ND	ND	ND	--	--	--	--	--	14.06	0.00	505.68
	01/03/90	ND	ND	1	1	910	--	1.5	--	--	--	--	--	13.74	0.00	506.00
	05/07/90	3.9	6	0.5	3.4	620	--	1.9	--	ND	--	ND	--	14.10	0.00	505.64
	09/29/90	ND	1.4	ND	ND	77	--	ND	ND	0.6	ND	ND	--	13.97	0.00	505.77
	01/03/91	2	2	ND	2	67	--	ND	ND	0.7	ND	ND	ND	13.81	0.00	505.93
	04/12/91	4	ND	ND	ND	180	--	0.6	ND	ND	ND	ND	ND	13.60	0.00	506.14
	09/04/91	1.8	4.7	0.8	4.8	140	--	ND	ND	ND	ND	ND	ND	14.14	0.00	505.60
	04/06/92	ND	ND	ND	ND	150	--	ND	ND	ND	ND	ND	ND	13.12	0.00	506.62
	07/28/92	ND	ND	ND	0.8	90	--	--	--	--	--	--	--	14.10	0.00	505.64
	10/16/92	ND	ND	ND	ND	51	--	--	--	--	--	--	--	14.57	0.00	505.17
01/14/93*	ND	1.6	1.0	3.5	120	--	--	--	--	--	--	--	10.95	0.00	508.79	
03/26/93	--	--	--	--	--	--	--	--	--	--	--	--	--	--	--	--
C-9 519.52	03/28/86	--	--	--	--	--	--	--	--	--	--	--	--	11.24	0.00	508.28
	03/15/88	540	560	580	3,900	29,000	--	--	--	--	--	--	--	12.92	0.00	506.60
	05/10/88	--	--	--	--	--	--	--	--	--	--	--	--	13.12	0.00	506.40
	06/10/88	--	--	--	--	--	--	--	--	--	--	--	--	14.16	0.00	505.36
	07/25/88	--	--	--	--	--	--	--	--	--	--	--	--	13.00	0.00	506.52
	10/13/88	57	8	20	150	2,200	--	--	--	--	--	--	--	13.13	0.00	506.39
	01/01/89	--	--	--	--	--	--	--	--	--	--	--	--	12.19	0.00	507.33
	01/12/89	39	12	51	46	2,000	--	--	--	--	--	--	--	--	--	--
	04/12/89	16	20	55	240	6,000	ND	2.1	--	--	--	--	--	13.11	0.00	506.41
	04/11/89	14	25	45	290	6,000	--	ND	--	--	--	--	--	13.11	0.00	506.41
	06/26/89	37	63	140	690	3,900	ND	ND	--	--	--	--	--	13.40	0.00	506.12
	10/13/89	7	ND	26	50	1,300	ND	ND	--	--	--	--	--	13.46	0.00	506.06
	01/03/90	ND	0.7	202	37	1,500	--	1.5	--	--	--	--	--	13.30	0.00	506.22
	05/07/90	21	33	89	500	7,100	--	1.9	--	ND	--	ND	--	13.48	0.00	506.04
	09/29/90	21	3.9	31	110	1,000	--	1.0	ND	0.7	1.8	1.0	--	13.39	0.00	506.13
	01/03/91	ND	ND	32	140	3,200	--	0.8	ND	ND	ND	ND	ND	13.28	0.00	506.44
	04/12/91	--	--	--	--	--	--	--	--	--	--	--	--	13.00	0.00	506.72
	09/04/91	--	--	--	--	--	--	--	--	--	--	--	--	13.61	0.00	506.11
	04/06/92	ND	ND	33	130	2,800	--	ND	ND	ND	ND	ND	ND	12.54	0.00	507.18
	07/28/92	6.5	2.4	17	37	1,000	--	--	--	--	--	--	--	13.45	0.00	506.27
10/16/92	ND	730	960	2,000	190,000	--	--	--	--	--	--	--	13.98	0.00	505.74	
01/14/93*	ND	ND	27	77	2,200	--	--	--	--	--	--	--	10.44	0.00	509.28	
03/26/93	--	--	--	--	--	--	--	--	--	--	--	--	--	--	--	--

**Table 1
HISTORICAL GROUNDWATER ANALYTICAL RESULTS AND MONITORING DATA**

CHEVRON SERVICE STATION #9-1924
4904 SOUTHFRONT ROAD, LIVERMORE, CALIFORNIA

WELL ID/ ELEVATION (TOC)	DATE	BENZENE (ppb)	TOLUENE (ppb)	ETHYL- BENZENE (ppb)	XYLENES (ppb)	TPH-G (ppb)	TOG (ppb)	1,2- DCA (ppb)	OTHER (ppb)	MC (ppb)	1,1,1- TCA (ppb)	1,1- DCA (ppb)	PCE (ppb)	DTW (feet)	SPT (feet)	WTE (feet)
C-10 520.41	03/28/86	--	--	--	--	--	--	--	--	--	--	--	--	--	--	--
	03/15/88	7	ND	ND	ND	90	--	--	--	--	--	--	--	14.86	0.00	505.55
	05/10/88	--	--	--	--	--	--	--	--	--	--	--	--	14.90	0.00	505.51
	06/10/88	--	--	--	--	--	--	--	--	--	--	--	--	15.94	0.00	504.47
	07/25/88	--	--	--	--	--	--	--	--	--	--	--	--	14.85	0.00	505.56
	10/13/88	ND	ND	ND	ND	ND	--	--	--	--	--	--	--	14.90	0.00	505.51
	01/01/89	--	--	--	--	--	--	--	--	--	--	--	--	14.83	0.00	505.58
	01/12/89	ND	ND	ND	ND	ND	--	--	--	--	--	--	--	--	--	--
	04/11/89	4.8	ND	ND	ND	ND	ND	ND	6.1	--	--	--	--	14.90	0.00	505.51
	06/26/89	0.7	ND	ND	ND	1.5	ND	4.0	ND	--	--	--	--	15.12	0.00	505.29
	10/13/89	ND	ND	ND	ND	ND	ND	ND	ND	--	--	--	--	15.11	0.00	505.30
	01/03/90	ND	ND	ND	ND	ND	ND	--	3	--	--	--	--	15.01	0.00	505.40
	05/07/90	ND	ND	ND	ND	ND	ND	--	ND	--	ND	ND	--	15.53	0.00	504.88
	09/27/90	ND	ND	ND	ND	ND	ND	--	ND	ND	1.2	ND	ND	15.20	0.00	505.21
	01/03/91	ND	ND	ND	ND	ND	ND	--	ND	ND	ND	ND	ND	15.06	0.00	505.35
	04/12/91	16	ND	2.9	2.7	110	--	--	1	ND	ND	ND	ND	14.86	0.00	505.55
	09/04/91	ND	ND	ND	ND	ND	ND	--	ND	ND	ND	ND	ND	15.22	0.00	505.19
	04/06/92	ND	ND	ND	ND	57	--	--	1.1	ND	ND	ND	ND	14.21	0.00	506.20
	07/28/92	ND	ND	ND	ND	ND	ND	--	--	--	--	--	--	14.78	0.00	505.63
10/16/92	ND	ND	ND	ND	ND	ND	--	--	--	--	--	--	15.51	0.00	504.90	
01/14/93*	4.7	ND	2.3	1.6	88	--	--	--	--	--	--	--	13.44	0.00	506.97	
03/26/93	ND	ND	ND	ND	ND	ND	--	--	--	--	--	--	12.55	0.00	507.86	
C-11 520.04	03/28/86	--	--	--	--	--	--	--	--	--	--	--	--	13.82	0.00	506.22
	03/15/88	--	--	--	--	--	--	--	--	--	--	--	--	14.49	0.00	505.55
	05/10/88	--	--	--	--	--	--	--	--	--	--	--	--	14.31	0.00	505.73
	06/10/88	--	--	--	--	--	--	--	--	--	--	--	--	15.47	0.00	504.57
	07/25/88	--	--	--	--	--	--	--	--	--	--	--	--	13.60	0.00	506.44
	10/14/88	240	33	4.7	67	2	--	--	--	--	--	--	--	14.53	0.00	505.51
	01/01/89	--	--	--	--	--	--	--	--	--	--	--	--	14.10	0.00	505.94
	01/12/89	ND	0.8	ND	ND	ND	ND	--	--	--	--	--	--	--	--	--
	04/12/89	4.3	ND	ND	ND	ND	ND	ND	ND	--	--	--	--	14.36	0.00	505.68
	06/26/89	2	ND	ND	ND	ND	ND	4.0	ND	--	--	--	--	14.58	0.00	505.46
	10/13/89	ND	ND	ND	ND	ND	ND	ND	ND	--	--	--	--	14.71	0.00	505.33
	01/03/90	ND	ND	ND	0.7	ND	ND	--	ND	--	--	--	--	14.61	0.00	505.43
	05/08/90	12	11	0.9	22	110	--	--	ND	--	ND	ND	--	15.53	0.00	504.51
	09/28/90	2.0	1.4	ND	3.3	ND	ND	--	ND	ND	1.2	ND	ND	15.51	0.00	504.53
	01/03/91	2	ND	ND	2	ND	ND	--	ND	ND	ND	ND	1	14.63	0.00	505.41
	04/12/91	--	--	--	--	--	--	--	--	--	--	--	--	14.30	0.00	505.74
	09/04/91	--	--	--	--	--	--	--	--	--	--	--	--	14.84	0.00	505.20
	04/06/92	ND	ND	ND	ND	ND	ND	--	ND	ND	ND	ND	ND	13.56	0.00	506.48
	07/28/92	ND	ND	ND	ND	ND	ND	--	--	--	--	--	--	14.39	0.00	505.65
10/16/92	ND	ND	ND	ND	ND	ND	--	--	--	--	--	--	15.79	0.00	504.25	
01/14/93*	ND	1.3	0.7	6	94	--	--	--	--	--	--	--	12.14	0.00	507.90	
03/26/93	2	ND	0.6	1	130	--	--	--	--	--	--	--	11.81	0.00	508.23	

**Table 1
HISTORICAL GROUNDWATER ANALYTICAL RESULTS AND MONITORING DATA**

CHEVRON SERVICE STATION #9-1924
4904 SOUTHFRONT ROAD, LIVERMORE, CALIFORNIA

WELL ID/ ELEVATION (TOC)	DATE	BENZENE (ppb)	TOLUENE (ppb)	ETHYL- BENZENE (ppb)	XYLENES (ppb)	TPH-G (ppb)	TOG (ppb)	1,2- DCA (ppb)	OTHER (ppb)	MC (ppb)	1,1,1- TCA (ppb)	1,1- DCA (ppb)	PCE (ppb)	DTW (feet)	SPT (feet)	WTE (feet)
C-12 519.82	03/28/86	--	--	--	--	--	--	--	--	--	--	--	--	13.81	0.00	506.21
	03/15/88	ND	ND	ND	ND	ND	--	--	--	--	--	--	--	14.55	0.00	505.27
	05/10/88	--	--	--	--	--	--	--	--	--	--	--	--	14.57	0.00	505.25
	06/10/88	--	--	--	--	--	--	--	--	--	--	--	--	15.63	0.00	504.19
	07/25/88	--	--	--	--	--	--	--	--	--	--	--	--	14.51	0.00	505.31
	10/13/88	ND	ND	ND	ND	ND	--	--	--	--	--	--	--	14.60	0.00	505.22
	01/12/89	ND	ND	ND	ND	ND	--	--	--	--	--	--	--	14.62	0.00	505.20
	04/11/89	ND	ND	ND	ND	ND	ND	ND	ND	--	--	--	--	14.61	0.00	505.21
	06/26/89	ND	ND	ND	ND	ND	ND	ND	ND	--	--	--	--	14.75	0.00	505.07
	10/13/89	ND	ND	ND	ND	ND	ND	ND	ND	--	--	--	--	14.77	0.00	505.05
	01/03/90	ND	ND	ND	ND	0.6	ND	ND	ND	--	--	--	--	14.85	0.00	504.97
	05/07/90	ND	ND	ND	ND	ND	ND	ND	ND	ND	ND	ND	--	14.75	0.00	505.07
	09/27/90	ND	ND	ND	ND	ND	ND	--	ND	ND	1.2	ND	ND	14.61	0.00	505.07
	01/03/91	ND	ND	ND	ND	ND	ND	--	ND	ND	ND	ND	ND	14.70	0.00	505.12
	04/12/91	--	--	--	--	--	--	--	--	--	--	--	--	14.52	0.00	505.30
	09/04/91	--	--	--	--	--	--	--	--	--	--	--	--	14.83	0.00	504.99
	04/06/92	ND	ND	ND	ND	ND	ND	--	ND	ND	ND	ND	ND	13.81	0.00	506.01
	07/28/92	ND	ND	ND	ND	ND	ND	--	--	--	--	--	--	14.32	0.00	505.50
	10/16/92	ND	ND	ND	ND	ND	ND	--	--	--	--	--	--	15.12	0.00	504.70
01/14/93*	ND	ND	ND	ND	ND	1.7	65	--	--	--	--	--	13.23	0.00	506.59	
03/26/93	0.9	ND	ND	ND	ND	ND	ND	--	--	--	--	--	12.20	0.00	507.62	
C-13 522.24	03/28/86	--	--	--	--	--	--	--	--	--	--	--	--	12.95	0.00	509.29
	03/15/88	2	ND	9	3	250	--	--	--	--	--	--	--	14.82	0.00	507.42
	05/10/88	--	--	--	--	--	--	--	--	--	--	--	--	15.03	0.00	507.21
	06/10/88	--	--	--	--	--	--	--	--	--	--	--	--	16.10	0.00	506.14
	07/25/88	--	--	--	--	--	--	--	--	--	--	--	--	14.73	0.00	507.51
	10/13/88	1.9	ND	ND	ND	ND	--	--	--	--	--	--	--	14.91	0.00	507.33
	01/01/89	--	--	--	--	--	--	--	--	--	--	--	--	14.10	0.00	508.14
	01/12/89	ND	0.6	4	ND	ND	ND	--	--	--	--	--	--	--	--	--
	04/10/89	ND	ND	8	ND	ND	ND	ND	ND	--	--	--	--	14.99	0.00	507.25
	06/26/89	0.3	ND	ND	ND	ND	ND	ND	ND	--	--	--	--	15.16	0.00	507.08
	10/13/89	ND	ND	ND	ND	ND	ND	ND	ND	--	--	--	--	15.23	0.00	507.01
	01/03/90	ND	ND	0.5	0.6	ND	ND	ND	ND	--	--	--	--	15.15	0.00	507.09
	05/08/90	ND	ND	ND	ND	ND	ND	--	ND	--	ND	ND	--	15.02	0.00	507.22
	09/27/90	ND	0.6	ND	ND	ND	ND	--	ND	ND	1.7	ND	ND	15.11	0.00	507.13
	01/03/91	ND	ND	ND	0.6	ND	ND	--	ND	ND	ND	ND	ND	15.08	0.00	507.16
	04/12/91	--	--	--	--	--	--	--	--	--	--	--	--	14.77	0.00	507.47
	09/04/91	--	--	--	--	--	--	--	--	--	--	--	--	15.43	0.00	506.81
	04/06/92	ND	ND	ND	ND	66	ND	ND	ND	ND	ND	ND	ND	14.43	0.00	507.81
	07/28/92	8.2	ND	ND	1.1	60	ND	--	--	--	--	--	--	15.37	0.00	506.87
10/16/92	ND	ND	ND	ND	ND	ND	--	--	--	--	--	--	15.87	0.00	506.37	
01/14/93*	ND	ND	ND	1.3	100	ND	--	--	--	--	--	--	12.83	0.00	509.41	
03/26/93	ND	ND	ND	ND	ND	ND	--	--	--	--	--	--	12.59	0.00	509.65	

Table 1
HISTORICAL GROUNDWATER ANALYTICAL RESULTS AND MONITORING DATA

CHEVRON SERVICE STATION #9-1924
4904 SOUTHFRONT ROAD, LIVERMORE, CALIFORNIA

WELL ID/ ELEVATION (TOC)	DATE	BENZENE (ppb)	TOLUENE (ppb)	ETHYL- BENZENE (ppb)	XYLENES (ppb)	TPH-G (ppb)	TOG (ppb)	1,2- DCA (ppb)	OTHER (ppb)	MC (ppb)	1,1,1- TCA (ppb)	1,1- DCA (ppb)	PCE (ppb)	DTW (feet)	SPT (feet)	WTE (feet)
C-14 520.08	03/28/86	--	--	--	--	--	--	--	--	--	--	--	--	--	--	--
	03/15/88	--	--	--	--	--	--	--	--	--	--	--	--	--	--	--
	05/10/88	13,000	29,000	2,700	18	120,000	--	--	--	--	--	--	--	13.39	0.00	506.69
	06/10/88	--	--	--	--	--	--	--	--	--	--	--	--	14.65	0.00	505.43
	07/25/88	--	--	--	--	--	--	--	--	--	--	--	--	13.47	0.00	506.61
	10/13/88	ND	ND	ND	ND	ND	--	--	--	--	--	--	--	13.58	0.00	506.50
	01/01/89	--	--	--	--	--	--	--	--	--	--	--	--	13.00	0.00	507.08
	01/12/89	ND	ND	ND	ND	NS	--	--	--	--	--	--	--	--	--	--
	04/12/89	ND	ND	ND	ND	NS	ND	ND	ND	ND	ND	ND	ND	13.47	0.00	506.61
	06/26/89	14,000	25,000	3,400	26,000	140,000	--	30	--	--	--	--	--	13.80	0.00	506.28
	10/13/89	12,000	16,000	1,600	13,000	86,000	--	--	--	--	--	--	--	13.62	0.00	506.46
	01/03/90	9,500	16,000	1,800	13,000	120,000	--	--	25	3	--	--	--	13.91	0.00	506.17
	01/04/90	3,900	8,100	1,200	7,700	76,000	--	--	18	1	--	--	--	13.91	0.00	506.17
	05/08/90	7,500	17,000	1,400	14,000	62,000	--	--	13	--	ND	ND	--	13.89	0.00	506.19
	09/27/90	--	--	--	--	--	--	--	--	--	--	--	--	13.78	0.00	506.30
	01/03/91	--	--	--	--	--	--	--	--	--	--	--	--	13.72	0.00	506.36
	04/12/91	750	3,800	720	9,200	60,000	--	--	ND	ND	ND	ND	ND	12.97	0.00	507.11
	09/04/91	2,800	11,000	1,300	13,000	110,000	--	--	--	--	--	--	--	13.84	0.00	506.24
	04/06/92	190	1,800	440	5,100	41,000	--	--	ND	ND	ND	ND	ND	12.44	0.00	507.64
	07/28/92	2,300	9,700	1,800	15,000	130,000	--	--	--	--	--	--	--	13.70	0.00	506.38
10/16/92	--	--	--	--	--	--	--	--	--	--	--	--	14.38	0.00	505.70	
01/14/93*	220	790	220	2,700	27,000	--	--	--	--	--	--	--	8.80	0.00	511.28	
03/26/93	330	1,600	460	4,000	23,000**	--	--	--	--	--	--	--	9.12	0.00	510.96	
C-15 522.41	03/28/86	--	--	--	--	--	--	--	--	--	--	--	--	13.14	0.00	509.27
	03/15/88	ND	ND	ND	ND	ND	--	--	--	--	--	--	--	15.13	0.00	507.28
	05/10/88	--	--	--	--	--	--	--	--	--	--	--	--	15.40	0.00	507.01
	06/10/88	--	--	--	--	--	--	--	--	--	--	--	--	16.49	0.00	505.92
	07/25/88	--	--	--	--	--	--	--	--	--	--	--	--	15.17	0.00	507.24
	10/13/88	ND	ND	ND	ND	ND	--	--	--	--	--	--	--	15.33	0.00	507.08
	01/01/89	--	--	--	--	--	--	--	--	--	--	--	--	13.70	0.00	508.71
	01/12/89	ND	ND	ND	ND	ND	--	--	--	--	--	--	--	--	--	--
	04/12/89	ND	ND	ND	ND	ND	ND	ND	ND	ND	ND	ND	ND	15.34	0.00	507.07
	06/26/89	ND	ND	ND	ND	ND	ND	ND	ND	ND	ND	ND	ND	15.72	0.00	506.69
	10/13/89	ND	ND	ND	ND	ND	ND	ND	ND	ND	ND	ND	ND	15.96	0.00	506.45
	01/03/90	ND	ND	ND	ND	ND	ND	ND	ND	ND	ND	ND	ND	15.42	0.00	506.99
	05/08/90	ND	ND	ND	ND	ND	ND	ND	ND	ND	ND	ND	ND	15.62	0.00	506.79
	09/27/90	ND	ND	ND	ND	ND	ND	ND	ND	2.9	ND	ND	ND	15.59	0.00	506.82
	01/03/91	ND	ND	ND	0.6	ND	--	--	ND	ND	ND	ND	ND	15.50	0.00	506.91
	04/12/91	--	--	--	--	--	--	--	--	--	--	--	--	15.21	0.00	507.20
	09/04/91	--	--	--	--	--	--	--	--	--	--	--	--	15.90	0.00	506.51
	04/06/92	ND	ND	ND	ND	ND	--	--	ND	ND	ND	ND	ND	14.88	0.00	507.53
	07/28/92	ND	ND	ND	ND	ND	--	--	--	--	--	--	--	15.82	0.00	506.59
	10/16/92	ND	ND	ND	ND	ND	--	--	--	--	--	--	--	16.25	0.00	506.16
01/14/93*	ND	1.9	0.8	5.1	61	--	--	--	--	--	--	--	12.48	0.00	509.93	
03/26/93	ND	ND	ND	1	ND	--	--	--	--	--	--	--	12.67	0.00	509.74	



**Table 1
HISTORICAL GROUNDWATER ANALYTICAL RESULTS AND MONITORING DATA**

CHEVRON SERVICE STATION #9-1924
4904 SOUTHFRONT ROAD, LIVERMORE, CALIFORNIA

WELL ID/ ELEVATION (TOC)	DATE	BENZENE (ppb)	TOLUENE (ppb)	ETHYL- BENZENE (ppb)	XYLENES (ppb)	TPH-G (ppb)	TOG (ppb)	1,2- DCA (ppb)	OTHER (ppb)	MC (ppb)	1,1,1- TCA (ppb)	1,1- DCA (ppb)	PCE (ppb)	DTW (feet)	SPT (feet)	WTE (feet)
C-16 519.68	03/28/86	--	--	--	--	--	--	--	--	--	--	--	--	--	--	--
	03/15/88	--	--	--	--	--	--	--	--	--	--	--	--	--	--	--
	05/10/88	1,000	73	140	180	4,500	--	--	--	--	--	--	--	13.78	0.00	505.90
	06/10/88	--	--	--	--	--	--	--	--	--	--	--	--	14.88	0.00	504.80
	07/25/88	--	--	--	--	--	--	--	--	--	--	--	--	13.69	0.00	505.99
	10/13/88	16	5.5	ND	16	1,600	--	--	--	--	--	--	--	13.80	0.00	505.88
	01/01/89	--	--	--	--	--	--	--	--	--	--	--	--	13.45	0.00	506.23
	01/12/89	360	11	78	51	1,000	--	--	--	--	--	--	--	--	--	--
	04/11/89	130	4	21	19	15,800	ND	8	--	--	--	--	--	13.78	0.00	505.90
	06/26/89	170	8	37	43	1,300	ND	ND	--	--	--	--	--	14.02	0.00	505.66
	10/13/89	20	ND	7	ND	1,000	ND	ND	--	--	--	--	--	14.01	0.00	505.67
	01/03/90	150	3	41	24	1,300	--	5	--	--	--	--	--	13.97	0.00	505.71
	05/07/90	49	4.4	29	13	480	--	4.5	--	ND	ND	ND	--	14.45	0.00	505.23
	09/29/90	18	2.1	11	8.0	360	--	1.8	ND	ND	ND	ND	--	14.32	0.00	505.36
	01/03/91	12	ND	6	6	230	--	2	ND	ND	ND	ND	--	13.96	0.00	505.72
	04/12/91	--	--	--	--	--	--	--	--	--	--	--	--	13.74	0.00	505.94
	09/04/91	--	--	--	--	--	--	--	--	--	--	--	--	14.22	0.00	505.46
	04/06/92	30	ND	14	12.0	360	--	1.0	ND	ND	ND	ND	ND	13.18	0.00	506.50
	07/28/92	31	ND	6.8	16	210	--	--	--	--	--	--	--	13.93	0.00	505.75
	10/16/92	11	ND	5.1	3.4	140	--	--	--	--	--	--	--	14.92	0.00	504.76
01/14/93*	24	ND	36	21	740	--	--	--	--	--	--	--	11.81	0.00	507.87	
03/26/93	22	2	16	10	730	--	--	--	--	--	--	--	11.36	0.00	508.32	
C-17 520.82	03/28/86	--	--	--	--	--	--	--	--	--	--	--	--	13.48	0.00	507.34
	03/15/88	--	--	--	--	--	--	--	--	--	--	--	--	14.76	0.00	506.06
	05/10/88	--	--	--	--	--	--	--	--	--	--	--	--	14.77	0.00	506.05
	06/10/88	--	--	--	--	--	--	--	--	--	--	--	--	15.84	0.00	504.98
	07/25/88	--	--	--	--	--	--	--	--	--	--	--	--	14.63	0.00	506.19
	10/13/88	18	900	760	5,500	270,000	--	--	--	--	--	--	--	14.83	0.00	505.99
	01/01/89	--	--	--	--	--	--	--	--	--	--	--	--	14.78	0.00	506.04
	01/12/89	ND	490	2,100	6,700	190,000	--	--	--	--	--	--	--	--	--	--
	04/11/89	30	150	320	1,000	27,000	6.0	ND	--	--	--	--	--	14.83	0.00	505.99
	06/26/89	50	390	660	2,000	20,000	ND	ND	--	--	--	--	--	15.03	0.00	505.79
	06/26/89	40	420	740	2,200	27,000	--	ND	--	--	--	--	--	15.03	0.00	505.79
	10/13/89	ND	48	230	480	17,000	ND	ND	--	--	--	--	--	15.02	0.00	505.80
	01/03/90	ND	29	120	210	14,000	--	ND	--	--	--	--	--	15.10	0.00	505.72
	05/08/90	25	130	210	470	9,500	--	ND	--	ND	ND	ND	--	15.12	0.00	505.70
	09/29/90	ND	ND	ND	ND	ND	--	ND	ND	ND	1.9	ND	--	14.99	0.00	505.83
	09/29/90	ND	3.4	ND	ND	ND	--	ND	ND	1.8	1.9	ND	--	14.99	0.00	505.83
	01/03/91	ND	28	56	140	3,700	--	ND	ND	1.8	1.9	ND	ND	14.92	0.00	505.90
	01/03/91	ND	10	59	150	8,600	--	ND	ND	ND	ND	ND	ND	14.92	0.00	505.90
	04/12/91	ND	5	47	120	8,600	--	ND	ND	ND	ND	ND	ND	14.71	0.00	506.11
	04/12/91	ND	11	48	120	4,400	--	ND	ND	ND	ND	ND	ND	14.71	0.00	506.11
	09/04/91	ND	27	49	79	5,800	--	ND	ND	ND	ND	ND	ND	15.17	0.00	505.65
	09/04/91	ND	21	36	61	4,100	--	ND	ND	ND	ND	ND	ND	15.17	0.00	505.65
	04/06/92	ND	5.8	27	29	2,300	--	ND	ND	ND	ND	ND	ND	14.14	0.00	506.68
07/28/92	99	180	170	430	11,000	--	--	--	--	--	--	--	15.18	0.00	505.64	
10/16/92	ND	4,800	3,900	6,600	1,200,000	--	--	--	--	--	--	--	15.76	0.00	505.06	
01/14/93*	9.3	9.1	23	34	3,500	--	--	--	--	--	--	--	13.44	0.00	507.38	
03/26/93	ND	19	20	35	3,700**	--	--	--	--	--	--	--	12.46	0.00	508.36	

Table 1
HISTORICAL GROUNDWATER ANALYTICAL RESULTS AND MONITORING DATA

CHEVRON SERVICE STATION #9-1924
4904 SOUTHFRONT ROAD, LIVERMORE, CALIFORNIA

WELL ID/ ELEVATION (TOC)	DATE	BENZENE (ppb)	TOLUENE (ppb)	ETHYL- BENZENE (ppb)	XYLENES (ppb)	TPH-G (ppb)	TOG (ppb)	1,2- DCA (ppb)	OTHER (ppb)	MC (ppb)	1,1,1- TCA (ppb)	1,1- DCA (ppb)	PCE (ppb)	DTW (feet)	SPT (feet)	WTE (feet)
C-18 518.96	03/28/86	---	---	---	---	---	---	---	---	---	---	---	---	---	---	---
	03/15/88	---	---	---	---	---	---	---	---	---	---	---	---	---	---	---
	05/10/88	---	---	---	---	---	---	---	---	---	---	---	---	---	---	---
	06/10/88	---	---	---	---	---	---	---	---	---	---	---	---	14.89	0.00	504.07
	07/25/88	---	---	---	---	---	---	---	---	---	---	---	---	13.79	0.00	505.17
	10/13/88	ND	ND	ND	ND	ND	---	---	---	---	---	---	---	13.86	0.00	505.10
	01/01/89	---	---	---	---	---	---	---	---	---	---	---	---	13.94	0.00	505.02
	01/12/89	ND	ND	ND	ND	ND	---	---	---	---	---	---	---	---	0.00	518.96
	04/11/89	ND	ND	ND	ND	ND	ND	3.6	---	---	---	---	---	14.86	0.00	504.10
	06/26/89	ND	ND	ND	ND	ND	ND	3.1	---	---	---	---	---	14.02	0.00	504.94
	10/13/89	ND	ND	ND	ND	ND	ND	ND	---	---	---	---	---	15.06	0.00	503.90
	01/03/90	ND	ND	ND	ND	ND	ND	1	---	---	---	---	---	14.07	0.00	504.89
	05/07/90	ND	ND	ND	ND	ND	ND	ND	---	ND	---	ND	---	14.01	0.00	504.95
	09/27/90	ND	ND	ND	ND	ND	ND	ND	ND	0.6	ND	ND	---	13.91	0.00	505.05
	01/03/91	ND	ND	ND	ND	ND	ND	---	---	ND	ND	ND	ND	13.98	0.00	504.98
	04/12/91	ND	ND	ND	ND	ND	ND	---	---	ND	ND	ND	ND	13.83	0.00	505.13
	09/04/91	ND	ND	ND	ND	ND	ND	---	---	ND	ND	ND	ND	14.20	0.00	504.76
	04/06/92	ND	ND	ND	ND	ND	ND	---	---	ND	ND	ND	ND	13.07	0.00	505.89
	07/28/92	ND	ND	ND	ND	ND	ND	---	---	---	---	---	---	13.55	0.00	505.41
	10/16/92	ND	ND	ND	ND	ND	ND	---	---	---	---	---	---	14.38	0.00	504.58
01/14/93*	ND	ND	ND	ND	1.8	56	---	---	---	---	---	---	12.46	0.00	506.50	
03/26/93	ND	ND	ND	ND	ND	ND	---	---	---	---	---	---	11.46	0.00	507.50	
C-19 520.99	03/28/86	---	---	---	---	---	---	---	---	---	---	---	---	---	---	---
	03/15/88	---	---	---	---	---	---	---	---	---	---	---	---	---	---	---
	05/10/88	1,400	360	350	1,300	18	---	---	---	---	---	---	---	15.23	0.00	505.76
	06/10/88	---	---	---	---	---	---	---	---	---	---	---	---	16.58	0.00	504.41
	07/25/88	---	---	---	---	---	---	---	---	---	---	---	---	15.19	0.00	505.80
	10/13/88	8.3	4.7	4.4	ND	ND	---	---	---	---	---	---	---	15.27	0.00	505.72
	01/01/89	---	---	---	---	---	---	---	---	---	---	---	---	15.20	0.00	505.79
	01/12/89	5	4	ND	ND	ND	---	---	---	---	---	---	---	---	---	---
	04/11/89	1.8	ND	ND	ND	ND	ND	13	---	---	---	---	---	15.24	0.00	505.75
	04/11/89	1.2	ND	0.6	0.6	500	---	14	---	---	---	---	---	15.24	0.00	505.75
	06/26/89	2.5	ND	ND	ND	500	ND	26	---	---	---	---	---	15.44	0.00	505.55
	10/13/89	ND	ND	ND	ND	540	ND	13	13	---	---	---	---	15.47	0.00	505.52
	01/03/90	1.2	0.7	1.3	0.9	ND	---	11	---	---	---	---	---	15.45	0.00	505.54
	05/07/90	ND	ND	ND	ND	ND	---	4.6	---	ND	---	ND	---	15.68	0.00	505.31
	09/28/90	ND	ND	ND	ND	ND	---	ND	ND	1.2	ND	ND	---	15.52	0.00	505.47
	01/03/91	ND	ND	ND	ND	66	---	1	ND	ND	ND	ND	0.9	15.56	0.00	505.43
	04/12/91	---	---	---	---	---	---	---	---	---	---	---	---	15.20	0.00	505.79
	09/04/91	---	---	---	---	---	---	---	---	---	---	---	---	15.60	0.00	505.39
	04/06/92	0.7	ND	1.0	ND	110	---	1.9	ND	ND	ND	ND	ND	14.58	0.00	506.41
	07/28/92	1.4	ND	1.0	4.2	ND	---	---	---	---	---	---	---	15.26	0.00	505.73
10/16/92	ND	ND	ND	ND	ND	---	---	---	---	---	---	---	16.00	0.00	504.99	
01/14/93*	1.1	ND	0.9	0.9	100	---	---	---	---	---	---	---	13.69	0.00	507.30	
03/26/93	ND	ND	ND	ND	ND	---	---	---	---	---	---	---	12.96	0.00	508.03	

GARTAB1.WK1

Explanation

TPH-G = Total Petroleum Hydrocarbons as Gasoline (ppb)
 TOG = Total Oil & Grease (EPA Method 503D & 503E)
 1,2-DCA = 1,2-Dichloroethane
 MC = Methylene Chloride
 TCA = 1,1,1-Trichloroethane
 1,1-DCA = 1,1-Dichloroethane
 PCE = Tetrachloroethene
 SPT = Separate-phase hydrocarbon thickness
 DTW = Depth to water

WTE = Water table elevation (well elevation - (DTW-(SPT x 0.8))

TOC = Top of casing

ND = Not detected at or above the minimum quantitation limit (MQL)

--- = Not sampled, not monitored, inaccessible

Elevations are expressed as feet above mean sea level (NGVD-1929).

OTHER = 5 ppb Carbon Disulfide detected in C-1 on 10-13-89

3 ppb Vinyl Chloride detected in C-14 on 1-3-90

1 ppb Vinyl Chloride detected in C-14 on 1-4-90

13 ppb Carbon Disulfide detected in C-19 on 10-13-89

* = Rinsate sample contaminated; resampled 03/26/93

** = Uncategorized compound is not included in gasoline hydrocarbon total

ATTACHMENT I

ANALYTICAL LABORATORY REPORTS

AND

CHAIN-OF-CUSTODY MANIFESTS



GTEL

ENVIRONMENTAL
LABORATORIES, INC.

Northwest Region

4080-C Pike Lane

Concord, CA 94520

(510) 685-7852

(800) 544-3422 from inside California

(800) 423-7143 from outside California

(510) 825-0720 (FAX)

Client Number: 020202886
Consultant Project Number: 9-1924
Project ID: Chevron, 4904 South Front Rd
Work Order Number: C3-03-0481

April 12, 1993

Bruce Eppler
Groundwater Technology, Inc.
1401 Halyard Drive, Suite 110
West Sacramento, CA 95691

Enclosed please find the analytical results for samples received by GTEL Environmental Laboratories, Inc. on 03/02/93.

A formal Quality Assurance/Quality Control (QA/QC) program is maintained by GTEL, which is designed to meet or exceed the EPA requirements. Analytical work for this project met QA/QC criteria, unless otherwise stated in the footnotes.

GTEL is certified by the California State Department of Health Services, Laboratory certificate numbers 194 and 1075; to perform analyses for drinking water, wastewater, and hazardous waste materials according to EPA protocols.

If you have any questions concerning this analysis or if we can be of further assistance, please call our Customer Service Representative.

Sincerely,

GTEL Environmental Laboratories, Inc.

Eileen F. Bullen
Laboratory Director

Client Number: 020202886
 Consultant Project Number: 9-1924
 Project ID: Chevron, 4904 South Front Rd
 Work Order Number: C3-03-0481

Table 1

ANALYTICAL RESULTS

Aromatic Volatile Organics and
 Total Petroleum Hydrocarbons as Gasoline in Water

EPA Methods 5030, 8020, and Modified 8015^a

GTEL Sample Number		01	02	03	04
Client Identification		TB-LB	RINSATE	C-11	C-12
Date Sampled		03/26/93	03/26/93	03/26/93	03/26/93
Date Analyzed		04/04/93	04/04/93	04/05/93	04/05/93
Analyte	Detection Limit, ug/L	Concentration, ug/L			
Benzene	0.5	<0.5	<0.5	2	0.9
Toluene	0.5	1	1	<0.5	<0.5
Ethylbenzene	0.5	<0.5	<0.5	0.6	<0.5
Xylene, total	0.5	<0.5	<0.5	1	<0.5
BTEX, total	--	--	--	4	1
TPH as Gasoline	50	<50	<50	130*	<50
Detection Limit Multiplier		1	1	1	1
BFB surrogate, % recovery		85.7	77.1	86.4	86.6

- a. Test Methods for Evaluating Solid Waste, SW-846, Third Edition, Revision 0, US EPA November 1986. Modification for TPH as gasoline as per California State Water Resources Control Board LUFT Manual protocols, May 1988 revision.
 * Uncategorized compound is not included in gasoline hydrocarbon total.

Client Number: 020202886
 Consultant Project Number: 9-1924
 Project ID: Chevron, 4904 South Front Rd
 Work Order Number: C3-03-0481

Table 1 (Continued)

ANALYTICAL RESULTS

**Aromatic Volatile Organics and
 Total Petroleum Hydrocarbons as Gasoline in Water**

EPA Methods 5030, 8020, and Modified 8015a

GTEL Sample Number		05	06	07	08
Client Identification		C-15	C-18	C-10	C-13
Date Sampled		03/26/93	03/26/93	03/26/93	03/26/93
Date Analyzed		04/05/93	04/05/93	04/05/93	04/05/93
Analyte	Detection Limit, ug/L	Concentration, ug/L			
Benzene	0.5	<0.5	<0.5	<0.5	<0.5
Toluene	0.5	<0.5	<0.5	<0.5	<0.5
Ethylbenzene	0.5	<0.5	<0.5	<0.5	<0.5
Xylene, total	0.5	1	<0.5	<0.5	<0.5
BTEX, total	--	1	--	--	--
TPH as Gasoline	50	<50	<50	<50	<50
Detection Limit Multiplier		1	1	1	1
BFB surrogate, % recovery		84.0	83.3	85.6	87.9

- a. Test Methods for Evaluating Solid Waste, SW-846, Third Edition, Revision 0, US EPA November 1986. Modification for TPH as gasoline as per California State Water Resources Control Board LUFT Manual protocols, May 1988 revision.

Client Number: 020202886
 Consultant Project Number: 9-1924
 Project ID: Chevron, 4904 South Front Rd
 Work Order Number: C3-03-0481

Table 1 (Continued)

ANALYTICAL RESULTS

**Aromatic Volatile Organics and
 Total Petroleum Hydrocarbons as Gasoline in Water**

EPA Methods 5030, 8020, and Modified 8015^a

GTEL Sample Number		09	10	11	12
Client Identification		C-3	C-19	RINSATE C-16	C-16
Date Sampled		03/26/93	03/26/93	03/26/93	03/26/93
Date Analyzed		04/05/93	04/05/93	04/04/93	04/05/93
Analyte	Detection Limit, ug/L	Concentration, ug/L			
Benzene	0.5	0.7	<0.5	<0.5	22
Toluene	0.5	1	<0.5	0.8	2
Ethylbenzene	0.5	<0.5	<0.5	<0.5	16
Xylene, total	0.5	<0.5	<0.5	<0.5	10
BTEX, total	–	2	--	1	50
TPH as Gasoline	50	74	80*	<50	730
Detection Limit Multiplier		1	1	1	1
BFB surrogate, % recovery		84.6	88.3	84.7	91.3

- a. Test Methods for Evaluating Solid Waste, SW-846, Third Edition, Revision 0, US EPA November 1986. Modification for TPH as gasoline as per California State Water Resources Control Board LUFT Manual protocols, May 1988 revision.
 * Uncategorized compound is not included in gasoline hydrocarbon total.

Client Number: 020202886
 Consultant Project Number: 9-1924
 Project ID: Chevron, 4904 South Front Rd
 Work Order Number: C3-03-0481

Table 1 (Continued)

ANALYTICAL RESULTS

Aromatic Volatile Organics and
 Total Petroleum Hydrocarbons as Gasoline in Water

EPA Methods 5030, 8020, and Modified 8015^a

GTEL Sample Number		13	14	15	16
Client Identification		C-1	C-2	C-17	C-7
Date Sampled		03/26/93	03/26/93	03/26/93	03/26/93
Date Analyzed		04/05/93	04/05/93	04/05/93	04/05/93
Analyte	Detection Limit, ug/L	Concentration, ug/L			
Benzene	0.5	21	15	<0.5	39
Toluene	0.5	12	12	19	9
Ethylbenzene	0.5	120	14	20	28
Xylene, total	0.5	100	6	35	15
BTEX, total	--	250	47	74	91
TPH as Gasoline	50	4400	820*	3700*	1400*
Detection Limit Multiplier		1	1	1	1
BFB surrogate, % recovery		117	107	117	115

- a. Test Methods for Evaluating Solid Waste, SW-846, Third Edition, Revision 0, US EPA November 1986. Modification for TPH as gasoline as per California State Water Resources Control Board LUFT Manual protocols, May 1988 revision.
 * Uncategorized compound is not included in gasoline hydrocarbon total.

Client Number: 020202886
 Consultant Project Number: 9-1924
 Project ID: Chevron, 4904 South Front Rd
 Work Order Number: C3-03-0481

Table 1 (Continued)

ANALYTICAL RESULTS

Aromatic Volatile Organics and
 Total Petroleum Hydrocarbons as Gasoline in Water

EPA Methods 5030, 8020, and Modified 8015a

GTEL Sample Number		17	18	040493GCQ	
Client Identification		C-14	C-6	METHOD BLANK	
Date Sampled		03/26/93	03/26/93	--	
Date Analyzed		04/06/93	04/06/93	04/04/93	
Analyte	Detection Limit, ug/L	Concentration, ug/L			
Benzene	0.5	330	30	<0.5	
Toluene	0.5	1600	90	<0.5	
Ethylbenzene	0.5	460	290	<0.5	
Xylene, total	0.5	4000	1100	<0.5	
BTEX, total	--	6400	1500	--	
TPH as Gasoline	50	23000*	11000*	<50	
Detection Limit Multiplier		10	5	1	
BFB surrogate, % recovery		104	114	111	

- a. Test Methods for Evaluating Solid Waste, SW-846, Third Edition, Revision 0, US EPA November 1986. Modification for TPH as gasoline as per California State Water Resources Control Board LUFT Manual protocols, May 1988 revision.
 * Uncategorized compound is not included in gasoline hydrocarbon total.

Client Number: 020202886
Consultant Project Number: 9-1924
Project ID: Chevron, 4904 South Front Rd
Work Order Number: C3-03-0481

QC Matrix Spike and Duplicate Spike Results

Matrix: Water

Analyte	Sample ID	Spike Amount	Units	Recovery, %	Duplicate Recovery, %	RPD, %	Control Limits
Modified EPA 8020:							
Benzene	Reagent Water	20.0	ug/L	96.0	97.5	1.60	70 - 147
Toluene	Reagent Water	20.0	ug/L	99.5	99.0	0.50	67 - 150
Ethylbenzene	Reagent Water	20.0	ug/L	96.5	95.5	1.00	69 - 145
Xylene, total	Reagent Water	60.0	ug/L	100	98.5	1.50	71 - 152

of Lab Report and COC to Chevron Contact: No

Chain-of-Custody-Record

Chevron U.S.A. Inc.
P.O. BOX 5004
San Ramon, CA 94583
FAX (115)842-9591

Chevron Facility Number 9-1924
Facility Address 4904 Southfront Rd
Consultant Project Number 02020-2886
Consultant Name Groundwater Technology
Address 1401 Halvard #140 W. Sacramento
Project Contact (Name) Bruce Eppler
(Phone) 916-372-4700 (Fax Number) 916-372-8781

Chevron Contact (Name) Brett Hunter
(Phone) 510-842-8695
Laboratory Name Superior Analytical GTCL
Laboratory Release Number 90332RD
Sample Collected by (Name) John McIntosh
Collection Date 3-26-93
Signature John McIntosh

Sample Number	Lab Sample Number	Number of Containers	Matrix S = Soil W = Water A = Air C = Charcoal	Type C = Grab C = Composite D = Discrete	Time	Sample Preservation	Iced (Yes or No)	Analysis To Be Performed														
								BTEX + TPH GAS (8020 + 8015)	TPH Diesel (8015)	Oil and Grease (5520)	Purgeable Hydrocarbons (5010)	Purgeable Aromatics (8020)	Purgeable Organics (8240)	Extractable Organics (8270)	Metals Cd, Cr, Pb, Zn, Ni (ICAP or AA)							
TB-LB	1	2	W	G	1200	HCL	Y	✓														
Rinsate	2	2			1210																	
C-11	3	3			1220																	
C-12	4	3			1230																	
C-15	5	3			1240																	
C-18	6	3			1250																	
C-10	7	3			1300																	
C-13	8	3			1310																	
C-3	9	3			1320																	
C-19	10	3			1330																	
Rinsate					1345																	
C-16	11	2			1345																	
C-16	12	3			1350																	
C-1	13	3			1410																	
C-2	14	3			1420																	

NOTE:
Do NOT BILL TB-LB SAMPLES
*
Z.B. ^{oc} _{sig} in fact
H.A. _{marks}
*
ATTN:
ELAINE KEW
DO NOT
BILL CHEVRON
BILL STI

Handwritten notes and signatures:
M/A
H/A
C/A

Relinquished By (Signature) <i>John McIntosh</i>	Organization 02320	Date/Time 3/26/93 1800	Received By (Signature) <i>[Signature]</i>	Organization CCS	Date/Time 3/29 953
Relinquished By (Signature) <i>[Signature]</i>	Organization CCS	Date/Time 3/29/93 1152	Received By (Signature)	Organization	Date/Time
Relinquished By (Signature)	Organization	Date/Time	Received For Laboratory By (Signature) <i>Jamie Davis</i>	Date/Time 3/29/93	Date/Time 2:00

Turn Around Time (Circle Choice)
24 hrs.
48 hrs.
6 Days
10 Days
As Contracted



GROUNDWATER TECHNOLOGY, INC.

1401 Halyard Drive, Suite 140, West Sacramento, CA 95691, (916) 372-4700

FAX (916) 372-8781

June 7, 1993

Project No. 02070 4233

Mr. Brett L. Hunter
Chevron U.S.A. Products Company
2410 Camino Ramon
San Ramon, CA 94583-0804

**RE: QUARTERLY MONITORING AND SAMPLING ACTIVITIES
CHEVRON SERVICE STATION 9-1924
4904 SOUTHFRONT ROAD
LIVERMORE, CALIFORNIA**

Dear Mr. Hunter:

Groundwater Technology, Inc. submits this letter as a summary of quarterly groundwater monitoring and sampling data collected at the above-referenced site on April 22, 1993. The eighteen site-related groundwater monitoring wells were gauged to determine depth to groundwater (DTW) and to check for the presence of separate-phase petroleum hydrocarbons (SP). A potentiometric surface map (Figure 1) and a summary of groundwater monitoring data (Table 1) are included. The April 22, 1993 potentiometric surface map includes data collected on the same date by Kaprelian Engineering, Inc. for the Unocal station northwest of the Chevron site. After measuring DTW, each monitoring well was purged and sampled. The groundwater samples were analyzed for dissolved benzene, toluene, ethylbenzene and xylenes (BTEX), and total petroleum hydrocarbons-as-gasoline (TPH-G). Results of the chemical analyses are summarized in Table 1. Laboratory reports and chain-of-custody manifests are included in Attachment I. All purge water generated during sampling was collected in a Department of Transportation (DOT)-approved purge trailer and transported for recycling to the Chevron refinery in Richmond, California.

Groundwater Technology, Inc. is pleased to assist Chevron on this project. If you have any questions or comments please call our West Sacramento office.

Sincerely,
Groundwater Technology, Inc.
Written/Submitted by

Groundwater Technology, Inc.
Reviewed/Approved by

BRUCE H. EPPLER
Environmental Geologist
Project Manager

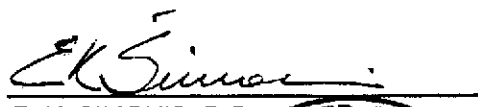
E. K. SIMONIS, R.G.
Senior Environmental Geologist

PR DSB
DSB/BHE/EKS:rb
Attachments
4233QTR2.LTR

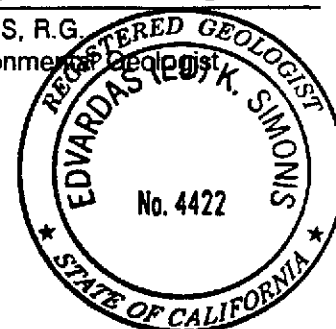

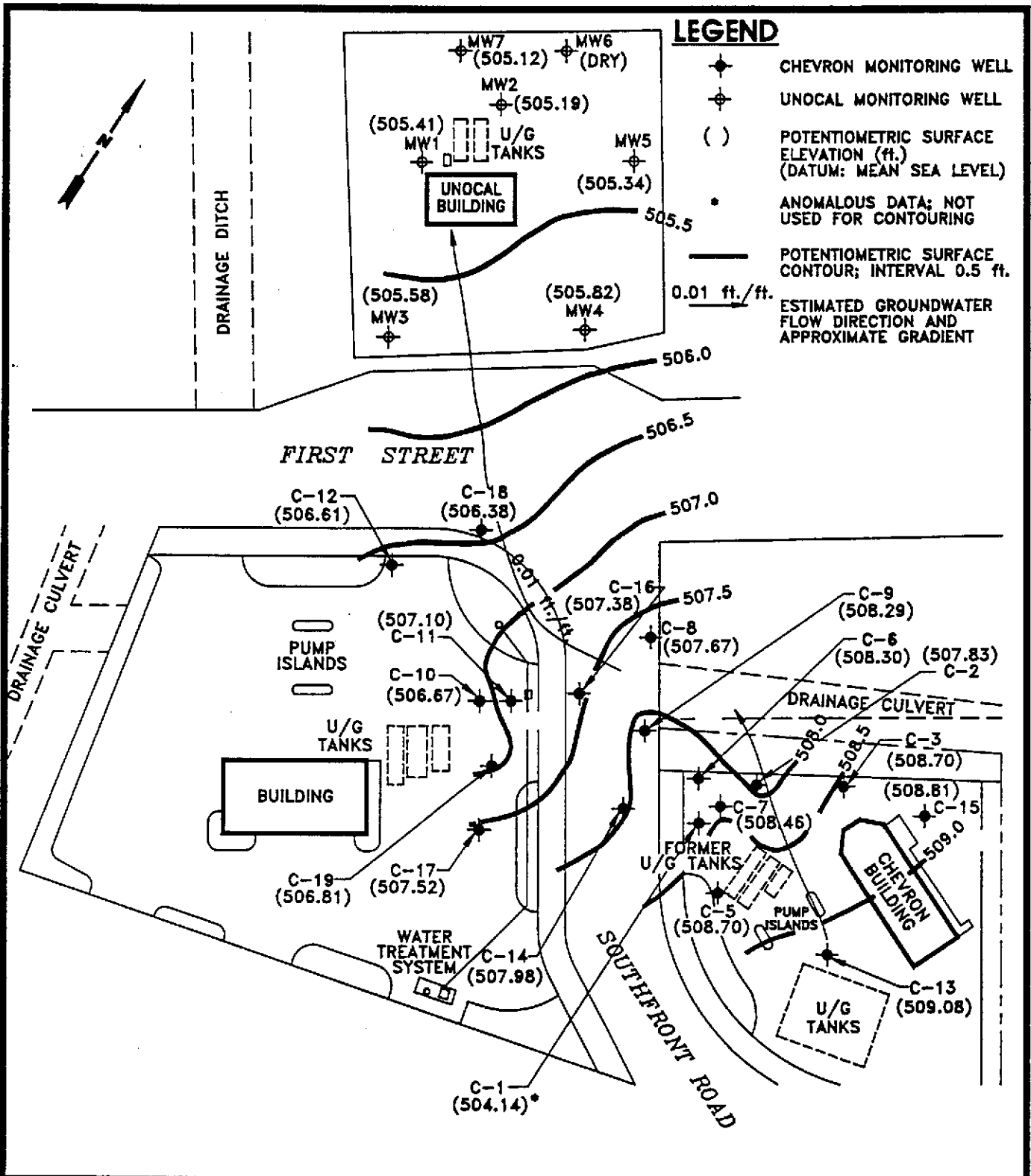

				POTENTIOMETRIC SURFACE MAP APRIL 22, 1993	
CLIENT: CHEVRON U.S.A. PRODUCTS CO. SERVICE STATION NO. 9-1924		LOCATION: 4904 SOUTHERNFRONT ROAD LIVERMORE, CALIFORNIA		REV. NO.:	DATE: 6/2/93
PM <i>BAL</i>	PE/RG <i>EW</i>	DESIGNED DSB	DETAILED S BRITO	ACAD FILE: 2886-POT/2886-STE	PROJECT NO.: 02070-4233
					FIGURE: 1

Table 1
HISTORICAL GROUNDWATER ANALYTICAL RESULTS AND MONITORING DATA

CHEVRON SERVICE STATION #9-1924
4904 SOUTHFRONT ROAD, LIVERMORE, CALIFORNIA

WELL ID/ ELEVATION (TOC)	DATE	BENZENE (ppb)	TOLUENE (ppb)	ETHYL- BENZENE (ppb)	XYLENES (ppb)	TPH-G (ppb)	TOG (ppb)	1,2- DCA (ppb)	OTHER (ppb)	MC (ppb)	1,1,1- TCA (ppb)	1,1- DCA (ppb)	PCE (ppb)	DTW (feet)	SPT (feet)	WTE (feet)
C-1 520.39	03/28/86	--	--	--	--	--	--	--	--	--	--	--	--	11.75	0.00	508.64
	03/15/88	770	87	610	2,100	27,000	--	--	--	--	--	--	--	13.50	0.00	506.89
	05/10/88	--	--	--	--	--	--	--	--	--	--	--	--	13.65	0.00	506.74
	06/10/88	--	--	--	--	--	--	--	--	--	--	--	--	14.72	0.00	505.67
	07/25/88	--	--	--	--	--	--	--	--	--	--	--	--	13.50	0.00	506.89
	10/13/88	220	11	62	130	3,200	--	--	--	--	--	--	--	12.89	0.00	507.50
	01/01/89	--	--	--	--	--	--	--	--	--	--	--	--	12.89	0.00	507.50
	01/12/89	820	43	490	260	4,000	--	--	--	--	--	--	--	--	--	--
	04/10/89	100	ND	70	50	4,000	ND	ND	--	--	--	--	--	13.65	0.00	506.74
	04/10/89	100	ND	60	50	4,000	ND	ND	--	--	--	--	--	13.65	0.00	506.74
	06/26/89	97	20	60	50	600	ND	3	--	--	--	--	--	13.94	0.00	506.45
	06/26/89	86	15	44	35	570	--	1.7	--	--	--	--	--	13.94	0.00	506.45
	10/13/89	64	ND	51	48	1,600	ND	ND	5	--	--	--	--	13.92	0.00	506.47
	01/03/90	36	0.68	30	30	1,100	--	1	--	--	--	--	--	13.80	0.00	506.59
	05/08/90	37	9.2	40	32	1,300	--	1.2	--	ND	--	ND	--	13.91	0.00	506.48
	09/29/90	19	1.2	32	31	350	--	ND	ND	0.7	1.4	ND	--	13.93	0.00	506.46
	01/03/91	12	ND	17	14	400	--	ND	ND	ND	ND	ND	ND	13.85	0.00	506.54
	04/12/91	--	--	--	--	--	--	--	--	--	--	--	--	13.51	0.00	506.88
	09/04/91	--	--	--	--	--	--	--	--	--	--	--	--	14.10	0.00	506.29
	04/06/92	12	0.8	31	31	1,000	--	ND	ND	ND	ND	ND	ND	13.06	0.00	507.33
	07/28/92	47	110	96	260	4,200	--	--	--	--	--	--	--	13.93	0.00	506.46
	10/16/92	11	ND	32.0	55.0	1,800	--	--	--	--	--	--	--	14.45	0.00	505.94
	01/14/93*	24	ND	98	62	2,000	--	--	--	--	--	--	--	11.23	0.00	509.16
03/26/93	21	12	120	100	4,400	--	--	--	--	--	--	--	10.94	0.00	509.45	
04/22/93	26	44	580	330	18,000	--	--	--	--	--	--	--	16.25	SHEEN	504.14	
C-2 520.76	03/28/86	--	--	--	--	--	--	--	--	--	--	--	--	11.98	0.00	508.78
	03/15/88	3,900	1,900	1,200	1,200	22,000	--	--	--	--	--	--	--	13.77	0.00	506.99
	05/10/88	--	--	--	--	--	--	--	--	--	--	--	--	14.03	0.00	506.73
	06/10/88	--	--	--	--	--	--	--	--	--	--	--	--	15.12	0.00	505.64
	07/25/88	--	--	--	--	--	--	--	--	--	--	--	--	13.86	0.00	506.90
	10/13/88	ND	ND	ND	ND	ND	--	--	--	--	--	--	--	14.11	0.00	506.65
	01/01/89	--	--	--	--	--	--	--	--	--	--	--	--	12.83	0.00	507.93
	01/12/89	25	3	83	59	1,000	--	--	--	--	--	--	--	--	--	--
	04/10/89	2.5	ND	15	12	600	ND	ND	--	--	--	--	--	14.04	0.00	506.72
	04/10/89	ND	ND	11	11	ND	--	ND	--	--	--	--	--	14.04	0.00	506.72
	06/26/89	5.3	8	18	14	640	ND	ND	--	--	--	--	--	14.34	0.00	506.42
	06/26/89	3.7	0.6	13	8.2	750	--	2	--	--	--	--	--	14.34	0.00	506.42
	10/13/89	ND	ND	17	10	630	--	ND	--	--	--	--	--	13.92	0.00	506.84
	01/03/90	3	ND	19	17	880	--	1	--	--	--	--	--	14.11	0.00	506.65
	05/08/90	1.3	2.7	8.4	11	340	--	1.1	--	ND	--	ND	--	14.28	0.00	506.48
	09/29/90	ND	ND	4.6	1.8	74	--	ND	ND	1.7	0.5	ND	--	14.25	0.00	506.51
	01/03/91	270	ND	79	93	2,000	--	ND	ND	ND	ND	ND	ND	14.15	0.00	506.61
	04/12/91	--	--	--	--	--	--	--	--	--	--	--	--	13.86	0.00	506.90
	09/04/91	--	--	--	--	--	--	--	--	--	--	--	--	14.50	0.00	506.26
	04/06/92	ND	ND	54.0	6.1	1,200	--	ND	ND	ND	ND	ND	ND	13.47	0.00	507.29
	07/28/92	5.2	2.9	26	16	1,000	--	--	--	--	--	--	--	14.35	0.00	506.41
	10/16/92	ND	2.2	20	10	2,000	--	--	--	--	--	--	--	14.84	0.00	505.92
	01/14/93*	49	50	31	29	1,800	--	--	--	--	--	--	--	11.22	0.00	509.54
03/26/93	15	12	14	6	820**	--	--	--	--	--	--	--	10.77	0.00	509.99	
04/22/93	12	12	28	29	2,000	--	--	--	--	--	--	--	12.93	0.00	507.83	

Table 1
HISTORICAL GROUNDWATER ANALYTICAL RESULTS AND MONITORING DATA

CHEVRON SERVICE STATION #9-1924
4904 SOUTHFRONT ROAD, LIVERMORE, CALIFORNIA

WELL ID/ ELEVATION (TOC)	DATE	BENZENE (ppb)	TOLUENE (ppb)	ETHYL- BENZENE (ppb)	XYLENES (ppb)	TPH-G (ppb)	TOG (ppb)	1,2- DCA (ppb)	OTHER (ppb)	MC (ppb)	1,1,1- TCA (ppb)	1,1- DCA (ppb)	PCE (ppb)	DTW (feet)	SPT (feet)	WTE (feet)
C-3 521.31	03/28/86	--	--	--	--	--	--	--	--	--	--	--	--	12.24	0.00	509.07
	03/15/88	86	8	30	36.0	2,100	--	--	--	--	--	--	--	14.21	0.00	507.10
	05/10/88	--	--	--	--	--	--	--	--	--	--	--	--	14.43	0.00	506.88
	06/10/88	--	--	--	--	--	--	--	--	--	--	--	--	15.53	0.00	505.78
	07/25/88	--	--	--	--	--	--	--	--	--	--	--	--	14.22	0.00	507.09
	10/13/88	ND	ND	ND	ND	ND	--	--	--	--	--	--	--	14.10	0.00	507.21
	01/01/89	--	--	--	--	--	--	--	--	--	--	--	--	12.70	0.00	508.61
	04/10/89	2.1	ND	4.4	2.6	200	ND	1.4	--	--	--	--	--	14.36	0.00	506.95
	06/26/89	1.1	0.7	4.9	1.6	260	ND	1.5	--	--	--	--	--	14.74	0.00	506.57
	10/13/89	ND	ND	ND	ND	ND	--	ND	--	--	--	--	--	14.70	0.00	506.81
	01/03/90	ND	ND	0.9	1.4	ND	--	0.7	--	--	--	--	--	14.42	0.00	506.89
	05/08/90	ND	ND	ND	ND	ND	--	0.7	--	ND	--	ND	--	14.65	0.00	506.66
	09/27/90	ND	1.0	ND	ND	71	--	ND	ND	1.1	1.6	ND	--	14.67	0.00	506.64
	01/03/91	ND	ND	ND	ND	57	--	ND	ND	ND	ND	ND	ND	14.58	0.00	506.73
	04/12/91	ND	ND	1.6	ND	98	--	ND	ND	ND	ND	ND	ND	14.23	0.00	507.08
	09/04/91	ND	ND	ND	ND	64	--	ND	ND	ND	ND	ND	ND	14.88	0.00	506.43
	04/06/92	ND	ND	0.8	ND	88	--	ND	ND	ND	ND	ND	ND	13.83	0.00	507.48
	07/28/92	ND	ND	0.5	1.1	80	--	--	--	--	--	--	--	14.80	0.00	506.51
	10/16/92	ND	ND	6.6	11	1,400	--	--	--	--	--	--	--	15.23	0.00	506.08
	01/14/93*	ND	ND	ND	1.3	100	--	--	--	--	--	--	--	11.45	0.00	509.86
03/26/93	0.7	1	ND	ND	74	--	--	--	--	--	--	--	11.27	0.00	510.04	
04/22/93	ND	ND	ND	ND	ND***	--	--	--	--	--	--	--	12.61	0.00	508.70	
C-5 520.82	03/28/86	--	--	--	--	--	--	--	--	--	--	--	--	12.00	0.00	508.82
	03/15/88	82	7	77	95	1,600	--	--	--	--	--	--	--	13.75	0.00	507.07
	05/10/88	--	--	--	--	--	--	--	--	--	--	--	--	13.92	0.00	506.90
	07/10/88	--	--	--	--	--	--	--	--	--	--	--	--	13.72	0.00	507.10
	07/25/88	--	--	--	--	--	--	--	--	--	--	--	--	13.72	0.00	507.10
	10/13/88	ND	ND	ND	ND	2,500	--	--	--	--	--	--	--	13.84	0.00	506.98
	01/01/89	--	--	--	--	--	--	--	--	--	--	--	--	13.41	0.00	507.41
	01/12/89	42	3	44	52	ND	--	--	--	--	--	--	--	--	0.00	520.82
	04/10/89	2.6	ND	6.2	5.5	180	ND	1.4	--	--	--	--	--	13.88	--	--
	06/26/89	7.6	0.8	40	56	420	ND	1.5	--	--	--	--	--	14.14	0.00	506.68
	10/13/89	ND	ND	10	ND	620	ND	ND	--	--	--	--	--	14.15	0.00	506.67
	01/03/90	0.7	ND	8	6	ND	--	ND	--	--	--	--	--	14.10	0.00	506.72
	05/08/90	0.6	0.8	11	7.2	140	--	0.8	--	ND	--	ND	--	14.00	0.00	506.82
	09/27/90	ND	3.2	5.2	6.4	360	--	ND	ND	0.7	ND	ND	--	14.00	0.00	506.82
	01/03/91	ND	ND	ND	3	90	--	ND	ND	ND	ND	ND	ND	14.00	0.00	506.82
	04/12/91	12	ND	19	7	270	--	0.5	ND	ND	ND	ND	ND	13.71	0.00	507.11
	09/04/91	ND	ND	ND	ND	ND	--	ND	ND	ND	ND	ND	ND	14.30	0.00	506.52
	04/06/92	12	ND	40	ND	670	--	ND	ND	ND	ND	ND	ND	13.29	0.00	507.53
	07/28/92	15	ND	1.8	0.5	130	--	--	--	--	--	--	--	14.13	0.00	506.69
	10/16/92	ND	ND	ND	1.2	ND	--	--	--	--	--	--	--	14.68	0.00	506.14
01/14/93*	13	ND	110	10	2,300	--	--	--	--	--	--	--	11.87	0.00	508.95	
03/26/93	--	--	--	--	--	--	--	--	--	--	--	--	--	--	--	--
04/22/93	220	18	120	65	2,300**	--	--	--	--	--	--	--	12.12	0.00	508.70	

**Table 1
HISTORICAL GROUNDWATER ANALYTICAL RESULTS AND MONITORING DATA**

CHEVRON SERVICE STATION #9-1924
4904 SOUTHFRONT ROAD, LIVERMORE, CALIFORNIA

WELL ID/ ELEVATION (TOC)	DATE	BENZENE (ppb)	TOLUENE (ppb)	ETHYL- BENZENE (ppb)	XYLENES (ppb)	TPH-G (ppb)	TOG (ppb)	1,2- DCA (ppb)	OTHER (ppb)	MC (ppb)	1,1,1- TCA (ppb)	1,1- DCA (ppb)	PCE (ppb)	DTW (feet)	SPT (feet)	WTE (feet)
C-6 519.62	03/26/86	---	---	---	---	---	---	---	---	---	---	---	---	11.12	0.00	508.50
	03/15/88	870	4,600	1,500	8,200	46,000	---	---	---	---	---	---	---	12.93	0.00	506.69
	05/10/88	1,400	10,000	3,000	19,000	86,000	---	---	---	---	---	---	---	13.03	0.00	506.59
	06/10/88	---	---	---	---	---	---	---	---	---	---	---	---	14.11	0.00	505.51
	07/25/88	---	---	---	---	---	---	---	---	---	---	---	---	12.95	0.00	506.67
	10/13/88	300	600	260	1,600	5,300	---	---	---	---	---	---	---	13.14	0.00	506.48
	01/01/89	---	---	---	---	---	---	---	---	---	---	---	---	12.14	0.00	507.48
	01/12/89	260	110	270	720	5,000	---	---	---	---	---	---	---	---	---	---
	04/12/89	90	190	190	680	5,000	4.0	ND	---	---	---	---	---	12.98	0.00	506.64
	06/26/89	77	250	140	610	3,600	ND	ND	---	---	---	---	---	13.39	0.00	506.23
	10/13/89	32	81	100	530	3,500	ND	ND	---	---	---	---	---	13.40	0.00	506.22
	01/03/90	20	97	65	410	3,200	---	1	---	---	---	---	---	13.18	0.00	506.44
	05/08/90	17	140	ND	400	1,800	---	1.6	ND	ND	---	ND	---	13.39	0.00	506.23
	09/29/90	58	210	260	2,100	8,000	---	1.6	ND	ND	2.4	1.6	---	13.32	0.00	506.30
	01/03/91	4	79	59	380	2,300	---	0.5	ND	ND	ND	ND	---	13.19	0.00	506.43
	04/12/91	---	---	---	---	---	---	---	---	---	---	---	---	12.91	0.00	506.71
	09/04/91	---	---	---	---	---	---	---	---	---	---	---	---	13.56	0.00	506.06
	04/06/92	ND	120	740	3,400	44,000	---	ND	ND	ND	ND	ND	---	12.48	0.00	507.14
	07/28/92	220	1,100	3,000	13,000	120,000	---	---	---	---	---	---	---	13.47	0.00	506.15
	10/16/92	ND	830	3,300	9,600	570,000	---	---	---	---	---	---	---	13.95	0.00	505.67
01/14/93*	ND	25	460	980	19,000	---	---	---	---	---	---	---	10.39	0.00	509.23	
03/26/93	30	90	290	1,100	11,000**	---	---	---	---	---	---	---	9.83	0.00	509.79	
04/22/93	29	170	640	2,400	20,000	---	---	---	---	---	---	---	11.32	0.00	508.30	
C-7 520.30	03/28/86	---	---	---	---	---	---	---	---	---	---	---	---	11.67	0.00	508.63
	03/15/88	98	690	120	120	8,000	---	---	---	---	---	---	---	13.48	0.00	506.82
	05/10/88	---	---	---	---	---	---	---	---	---	---	---	---	13.60	0.00	506.70
	06/10/88	---	---	---	---	---	---	---	---	---	---	---	---	14.68	0.00	505.62
	07/25/88	---	---	---	---	---	---	---	---	---	---	---	---	13.43	0.00	506.87
	10/13/88	4,400	220	1,000	3,000	16,000	---	---	---	---	---	---	---	13.61	0.00	506.69
	01/01/89	---	---	---	---	---	---	---	---	---	---	---	---	12.66	0.00	507.64
	01/12/89	950	47	670	640	8,000	---	---	---	---	---	---	---	---	---	---
	04/12/89	1,100	30	760	370	6,000	ND	ND	---	---	---	---	---	13.60	0.00	506.70
	06/26/89	1,300	50	600	340	6,000	ND	ND	---	---	---	---	---	13.88	0.00	506.42
	10/13/89	1,300	ND	160	150	3,900	---	ND	---	---	---	---	---	13.81	0.00	506.49
	01/03/90	1,200	13	180	200	5,600	---	1	---	---	---	---	---	13.71	0.00	506.59
	05/08/90	1,100	15	110	140	3,500	---	1.7	---	ND	---	ND	---	13.85	0.00	506.45
	09/29/90	580	ND	46	68	2,400	---	0.7	ND	ND	ND	ND	ND	13.80	0.00	506.50
	01/03/91	300	2	110	120	2,500	---	0.7	ND	ND	ND	ND	ND	13.71	0.00	506.59
	04/12/91	190	1	81	67	2,300	---	0.6	ND	ND	ND	ND	ND	13.46	0.00	506.84
	09/04/91	---	---	---	---	---	---	---	---	---	---	---	---	14.09	0.00	506.21
	10/07/91	170	1.9	97	59	4,700	---	ND	ND	24	ND	ND	ND	---	---	---
	04/06/92	95	0.8	110	100	2,400	---	ND	ND	ND	ND	ND	ND	13.02	0.00	507.28
	07/28/92	120	3.4	110	110	2,000	---	---	---	---	---	---	---	13.76	0.00	506.54
10/16/92	130	4.2	68	74	2,700	---	---	---	---	---	---	---	14.42	0.00	505.88	
01/14/93*	160	33	380	210	7,800	---	---	---	---	---	---	---	10.98	0.00	509.32	
03/26/93	39	9	28	15	1,400	---	---	---	---	---	---	---	10.61	0.00	509.69	
04/22/93	130	18	43	36	3,800	---	---	---	---	---	---	---	11.84	0.00	506.46	

Table 1
HISTORICAL GROUNDWATER ANALYTICAL RESULTS AND MONITORING DATA

CHEVRON SERVICE STATION #9-1924
4904 SOUTHFRONT ROAD, LIVERMORE, CALIFORNIA

WELL ID/ ELEVATION (TOC)	DATE	BENZENE (ppb)	TOLUENE (ppb)	ETHYL- BENZENE (ppb)	XYLENES (ppb)	TPH-G (ppb)	TOG (ppb)	1,2- DCA (ppb)	OTHER (ppb)	MC (ppb)	1,1,1- TCA (ppb)	1,1- DCA (ppb)	PCE (ppb)	DTW (feet)	SPT (feet)	WTE (feet)
C-8 519.74	03/28/86	---	---	---	---	---	---	---	---	---	---	---	---	11.78	0.00	507.96
	03/15/88	360	25	10	ND	7,500	---	---	---	---	---	---	---	13.63	0.00	506.11
	05/10/88	---	---	---	---	---	---	---	---	---	---	---	---	13.74	0.00	506.00
	06/10/88	---	---	---	---	---	---	---	---	---	---	---	---	14.89	0.00	504.85
	07/25/88	---	---	---	---	---	---	---	---	---	---	---	---	13.65	0.00	506.09
	10/13/88	6	5.3	ND	ND	ND	---	---	---	---	---	---	---	13.78	0.00	505.96
	01/01/89	---	---	---	---	---	---	---	---	---	---	---	---	12.68	0.00	507.06
	01/12/89	37	4	1	5	ND	---	---	---	---	---	---	---	---	---	---
	04/12/89	13	ND	ND	ND	3,000	12.0	5	---	---	---	---	---	13.77	0.00	505.97
	06/26/89	14	6	ND	8	780	ND	4	---	---	---	---	---	14.03	0.00	505.71
	10/13/89	ND	ND	ND	ND	ND	ND	ND	---	---	---	---	---	14.06	0.00	505.68
	01/03/90	ND	ND	1	1	910	---	1.5	---	---	---	---	---	13.74	0.00	506.00
	05/07/90	3.9	6	0.5	3.4	620	---	1.9	---	---	ND	ND	---	14.10	0.00	505.64
	09/29/90	ND	1.4	ND	ND	77	---	ND	ND	0.6	ND	ND	---	13.97	0.00	505.77
	01/03/91	2	2	ND	2	67	---	ND	ND	0.7	ND	ND	ND	13.81	0.00	505.93
	04/12/91	4	ND	ND	ND	180	---	0.6	ND	ND	ND	ND	ND	13.60	0.00	506.14
	09/04/91	1.8	4.7	0.8	4.8	140	---	ND	ND	ND	ND	ND	ND	14.14	0.00	505.60
	04/06/92	ND	ND	ND	ND	150	---	ND	ND	ND	ND	ND	ND	13.12	0.00	506.62
	07/28/92	ND	ND	ND	0.8	90	---	---	---	---	---	---	---	14.10	0.00	505.64
	10/16/92	ND	ND	ND	ND	51	---	---	---	---	---	---	---	14.57	0.00	505.17
01/14/93*	ND	1.6	1.0	3.5	120	---	---	---	---	---	---	---	10.95	0.00	508.79	
03/26/93	---	---	---	---	---	---	---	---	---	---	---	---	---	---	---	---
04/22/93	ND	0.6	0.6	0.8	68**	---	---	---	---	---	---	---	12.07	0.00	507.67	
C-9 519.52	03/28/86	---	---	---	---	---	---	---	---	---	---	---	---	11.24	0.00	508.28
	03/15/88	540	560	580	3,900	29,000	---	---	---	---	---	---	---	12.92	0.00	506.60
	05/10/88	---	---	---	---	---	---	---	---	---	---	---	---	13.12	0.00	506.40
	06/10/88	---	---	---	---	---	---	---	---	---	---	---	---	14.16	0.00	505.36
	07/25/88	---	---	---	---	---	---	---	---	---	---	---	---	13.00	0.00	506.52
	10/13/88	57	8	20	150	2,200	---	---	---	---	---	---	---	13.13	0.00	506.39
	01/01/89	---	---	---	---	---	---	---	---	---	---	---	---	12.19	0.00	507.33
	01/12/89	39	12	51	46	2,000	---	---	---	---	---	---	---	---	---	---
	04/12/89	16	20	55	240	6,000	ND	2.1	---	---	---	---	---	13.11	0.00	506.41
	04/11/89	14	25	45	290	6,000	---	ND	---	---	---	---	---	13.11	0.00	506.41
	06/26/89	37	63	140	690	3,900	ND	ND	---	---	---	---	---	13.40	0.00	506.12
	10/13/89	7	ND	26	50	1,300	ND	ND	---	---	---	---	---	13.46	0.00	506.06
	01/03/90	ND	0.7	202	37	1,500	---	1.5	---	---	---	---	---	13.30	0.00	506.22
	05/07/90	21	33	89	500	7,100	---	1.9	---	ND	---	ND	---	13.48	0.00	506.04
	09/29/90	21	3.9	31	110	1,000	---	1.0	ND	0.7	1.8	1.0	---	13.39	0.00	506.13
	01/03/91	ND	ND	32	140	3,200	---	0.8	ND	ND	ND	ND	ND	13.28	0.00	506.44
	04/12/91	---	---	---	---	---	---	---	---	---	---	---	---	13.00	0.00	506.72
	09/04/91	---	---	---	---	---	---	---	---	---	---	---	---	13.61	0.00	506.11
	04/06/92	ND	ND	33	130	2,800	---	ND	ND	ND	ND	ND	ND	12.54	0.00	507.18
	07/28/92	6.5	2.4	17	37	1,000	---	---	---	---	---	---	---	13.45	0.00	506.27
10/16/92	ND	730	960	2,000	190,000	---	---	---	---	---	---	---	13.98	0.00	505.74	
01/14/93*	ND	ND	27	77	2,200	---	---	---	---	---	---	---	10.44	0.00	509.28	
03/26/93	---	---	---	---	---	---	---	---	---	---	---	---	---	---	---	---
04/22/93	60	40	68	98	7,300	---	---	---	---	---	---	---	11.43	0.00	508.29	

**Table 1
HISTORICAL GROUNDWATER ANALYTICAL RESULTS AND MONITORING DATA**

CHEVRON SERVICE STATION #9-1924
4904 SOUTHFRONT ROAD, LIVERMORE, CALIFORNIA

WELL ID/ ELEVATION (TOC)	DATE	BENZENE (ppb)	TOLUENE (ppb)	ETHYL- BENZENE (ppb)	XYLENES (ppb)	TPH-G (ppb)	TOG (ppb)	1,2- DCA (ppb)	OTHER (ppb)	MC (ppb)	1,1,1- TCA (ppb)	1,1- DCA (ppb)	PCE (ppb)	DTW (feet)	SPT (feet)	WTE (feet)
C-10 520.41	03/28/86	--	--	--	--	--	--	--	--	--	--	--	--	--	--	--
	03/15/88	7	ND	ND	ND	90	--	--	--	--	--	--	--	14.86	0.00	505.55
	05/10/88	--	--	--	--	--	--	--	--	--	--	--	--	14.90	0.00	505.51
	06/10/88	--	--	--	--	--	--	--	--	--	--	--	--	15.94	0.00	504.47
	07/25/88	--	--	--	--	--	--	--	--	--	--	--	--	14.85	0.00	505.56
	10/13/88	ND	ND	ND	ND	ND	--	--	--	--	--	--	--	14.90	0.00	505.51
	01/01/89	--	--	--	--	--	--	--	--	--	--	--	--	14.83	0.00	505.58
	01/12/89	ND	ND	ND	ND	ND	--	--	--	--	--	--	--	--	--	--
	04/11/89	4.8	ND	ND	ND	ND	ND	ND	6.1	--	--	--	--	14.90	0.00	505.51
	06/26/89	0.7	ND	ND	ND	1.5	ND	4.0	ND	--	--	--	--	15.12	0.00	505.29
	10/13/89	ND	ND	ND	ND	ND	ND	ND	ND	--	--	--	--	15.11	0.00	505.30
	01/03/90	ND	ND	ND	ND	ND	ND	--	3	--	--	--	--	15.01	0.00	505.40
	05/07/90	ND	ND	ND	ND	ND	ND	--	ND	--	--	ND	--	15.53	0.00	504.88
	09/27/90	ND	ND	ND	ND	ND	ND	--	ND	ND	1.2	ND	ND	15.20	0.00	505.21
	01/03/91	ND	ND	ND	ND	ND	ND	--	ND	ND	ND	ND	ND	15.06	0.00	505.35
	04/12/91	16	ND	2.9	2.7	110	--	--	1	ND	ND	ND	ND	14.86	0.00	505.55
	09/04/91	ND	ND	ND	ND	ND	ND	--	ND	ND	ND	ND	ND	15.22	0.00	505.19
	04/06/92	ND	ND	ND	ND	ND	57	--	1.1	ND	ND	ND	ND	14.21	0.00	506.20
	07/28/92	ND	ND	ND	ND	ND	ND	--	--	--	--	--	--	14.78	0.00	505.63
	10/16/92	ND	ND	ND	ND	ND	ND	--	--	--	--	--	--	15.51	0.00	504.90
01/14/93*	4.7	ND	2.3	1.6	88	--	--	--	--	--	--	--	13.44	0.00	506.97	
03/26/93	ND	ND	ND	ND	ND	ND	--	--	--	--	--	--	12.55	0.00	507.86	
04/22/93	ND	ND	ND	ND	ND	ND	--	--	--	--	--	--	13.74	0.00	506.87	
C-11 520.04	03/28/86	--	--	--	--	--	--	--	--	--	--	--	--	13.82	0.00	506.22
	03/15/88	--	--	--	--	--	--	--	--	--	--	--	--	14.49	0.00	505.55
	05/10/88	--	--	--	--	--	--	--	--	--	--	--	--	14.31	0.00	505.73
	06/10/88	--	--	--	--	--	--	--	--	--	--	--	--	15.47	0.00	504.57
	07/25/88	--	--	--	--	--	--	--	--	--	--	--	--	13.60	0.00	506.44
	10/14/88	240	33	4.7	67	2	--	--	--	--	--	--	--	14.53	0.00	505.51
	01/01/89	--	--	--	--	--	--	--	--	--	--	--	--	14.10	0.00	505.94
	01/12/89	ND	0.8	ND	ND	ND	ND	--	--	--	--	--	--	--	--	--
	04/12/89	4.3	ND	ND	ND	ND	ND	ND	ND	--	--	--	--	14.36	0.00	505.68
	06/26/89	2	ND	ND	ND	ND	ND	4.0	ND	--	--	--	--	14.58	0.00	505.46
	10/13/89	ND	ND	ND	ND	ND	ND	ND	ND	--	--	--	--	14.71	0.00	505.33
	01/03/90	ND	ND	ND	0.7	ND	ND	--	ND	--	--	--	--	14.61	0.00	505.43
	05/08/90	12	11	0.9	22	110	--	--	ND	--	--	ND	--	15.53	0.00	504.51
	09/28/90	2.0	1.4	ND	3.3	ND	--	--	ND	ND	1.2	ND	ND	15.51	0.00	504.53
	01/03/91	2	ND	ND	2	ND	--	--	ND	ND	ND	ND	1	14.63	0.00	505.41
	04/12/91	--	--	--	--	--	--	--	--	--	--	--	--	14.30	0.00	505.74
	09/04/91	--	--	--	--	--	--	--	--	--	--	--	--	14.84	0.00	505.20
	04/06/92	ND	ND	ND	ND	ND	ND	--	ND	ND	ND	ND	ND	13.56	0.00	506.48
	07/28/92	ND	ND	ND	ND	ND	ND	--	--	--	--	--	--	14.39	0.00	505.65
	10/16/92	ND	ND	ND	ND	ND	ND	--	--	--	--	--	--	15.79	0.00	504.25
01/14/93*	ND	1.3	0.7	6	94	--	--	--	--	--	--	--	12.14	0.00	507.90	
03/26/93	2	ND	0.6	1	130	--	--	--	--	--	--	--	11.81	0.00	508.23	
04/22/93	0.8	ND	ND	ND	ND	ND	--	--	--	--	--	--	12.94	0.00	507.10	

**Table 1
HISTORICAL GROUNDWATER ANALYTICAL RESULTS AND MONITORING DATA**

CHEVRON SERVICE STATION #9-1924
4904 SOUTHFRONT ROAD, LIVERMORE, CALIFORNIA

WELL ID/ ELEVATION (TOC)	DATE	BENZENE (ppb)	TOLUENE (ppb)	ETHYL- BENZENE (ppb)	XYLENES (ppb)	TPH-G (ppb)	TOG (ppb)	1,2- DCA (ppb)	OTHER (ppb)	MC (ppb)	1,1,1- TCA (ppb)	1,1- DCA (ppb)	PCE (ppb)	DTW (feet)	SPT (feet)	WTE (feet)
C-12 519.82	03/28/86	--	--	--	--	--	--	--	--	--	--	--	--	13.61	0.00	506.21
	03/15/88	ND	ND	ND	ND	ND	ND	ND	ND	ND	ND	ND	ND	14.55	0.00	505.27
	05/10/88	--	--	--	--	--	--	--	--	--	--	--	--	14.57	0.00	505.25
	06/10/88	--	--	--	--	--	--	--	--	--	--	--	--	15.63	0.00	504.19
	07/25/88	--	--	--	--	--	--	--	--	--	--	--	--	14.51	0.00	505.31
	10/13/88	ND	ND	ND	ND	ND	ND	ND	ND	ND	ND	ND	ND	14.60	0.00	505.22
	01/12/89	ND	ND	ND	ND	ND	ND	ND	ND	ND	ND	ND	ND	14.62	0.00	505.20
	04/11/89	ND	ND	ND	ND	ND	ND	ND	ND	ND	ND	ND	ND	14.61	0.00	505.21
	06/26/89	ND	ND	ND	ND	ND	ND	ND	ND	ND	ND	ND	ND	14.75	0.00	505.07
	10/13/89	ND	ND	ND	ND	ND	ND	ND	ND	ND	ND	ND	ND	14.77	0.00	505.05
	01/03/90	ND	ND	ND	ND	0.6	ND	ND	ND	ND	ND	ND	ND	14.85	0.00	504.97
	05/07/90	ND	ND	ND	ND	ND	ND	ND	ND	ND	ND	ND	ND	14.75	0.00	505.07
	09/27/90	ND	ND	ND	ND	ND	ND	ND	ND	ND	1.2	ND	ND	14.61	0.00	505.21
	01/03/91	ND	ND	ND	ND	ND	ND	ND	ND	ND	ND	ND	ND	14.70	0.00	505.12
	04/12/91	--	--	--	--	--	--	--	--	--	--	--	--	14.52	0.00	505.30
	09/04/91	--	--	--	--	--	--	--	--	--	--	--	--	14.83	0.00	504.99
	04/06/92	ND	ND	ND	ND	ND	ND	ND	ND	ND	ND	ND	ND	13.81	0.00	506.01
	07/28/92	ND	ND	ND	ND	ND	ND	ND	ND	ND	ND	ND	ND	14.32	0.00	505.50
	10/16/92	ND	ND	ND	ND	ND	ND	ND	ND	ND	ND	ND	ND	15.12	0.00	504.70
	01/14/93*	ND	ND	ND	ND	1.7	65	ND	ND	ND	ND	ND	ND	13.23	0.00	506.59
03/26/93	0.9	ND	ND	ND	ND	ND	ND	ND	ND	ND	ND	ND	12.20	0.00	507.62	
04/22/93	ND	ND	ND	ND	ND	ND	ND	ND	ND	ND	ND	ND	13.21	0.00	506.61	
C-13 522.24	03/28/86	--	--	--	--	--	--	--	--	--	--	--	--	12.95	0.00	509.29
	03/15/88	2	ND	9	9	250	ND	ND	ND	ND	ND	ND	ND	14.82	0.00	507.42
	05/10/88	--	--	--	--	--	--	--	--	--	--	--	--	15.03	0.00	507.21
	06/10/88	--	--	--	--	--	--	--	--	--	--	--	--	16.10	0.00	506.14
	07/25/88	--	--	--	--	--	--	--	--	--	--	--	--	14.73	0.00	507.51
	10/13/88	1.9	ND	ND	ND	ND	ND	ND	ND	ND	ND	ND	ND	14.91	0.00	507.33
	01/01/89	--	--	--	--	--	--	--	--	--	--	--	--	14.10	0.00	508.14
	01/12/89	ND	0.6	4	ND	ND	ND	ND	ND	ND	ND	ND	ND	--	--	--
	04/10/89	ND	ND	8	ND	ND	ND	ND	ND	ND	ND	ND	ND	14.99	0.00	507.25
	06/26/89	0.3	ND	ND	ND	ND	ND	ND	ND	ND	ND	ND	ND	15.16	0.00	507.08
	10/13/89	ND	ND	ND	ND	ND	ND	ND	ND	ND	ND	ND	ND	15.23	0.00	507.01
	01/03/90	ND	ND	0.5	0.6	ND	ND	ND	ND	ND	ND	ND	ND	15.15	0.00	507.09
	05/08/90	ND	ND	ND	ND	ND	ND	ND	ND	ND	ND	ND	ND	15.02	0.00	507.22
	09/27/90	ND	0.6	ND	ND	ND	ND	ND	ND	1.7	ND	ND	ND	15.11	0.00	507.13
	01/03/91	ND	ND	ND	0.6	ND	ND	ND	ND	ND	ND	ND	ND	15.08	0.00	507.16
	04/12/91	--	--	--	--	--	--	--	--	--	--	--	--	14.77	0.00	507.47
	09/04/91	--	--	--	--	--	--	--	--	--	--	--	--	15.43	0.00	506.81
	04/06/92	ND	ND	ND	ND	66	ND	ND	ND	ND	ND	ND	ND	14.43	0.00	507.81
	07/28/92	6.2	ND	ND	1.1	60	ND	ND	ND	ND	ND	ND	ND	15.37	0.00	506.87
	10/16/92	ND	ND	ND	ND	ND	ND	ND	ND	ND	ND	ND	ND	15.87	0.00	506.37
01/14/93*	ND	ND	ND	1.3	100	ND	ND	ND	ND	ND	ND	ND	12.83	0.00	509.41	
03/26/93	ND	ND	ND	ND	ND	ND	ND	ND	ND	ND	ND	ND	12.59	0.00	509.65	
04/22/93	ND	ND	ND	ND	ND	ND	ND	ND	ND	ND	ND	ND	13.16	0.00	509.08	

**Table 1
HISTORICAL GROUNDWATER ANALYTICAL RESULTS AND MONITORING DATA**

CHEVRON SERVICE STATION #9-1924
4904 SOUTHFRONT ROAD, LIVERMORE, CALIFORNIA

WELL ID/ ELEVATION (TOC)	DATE	BENZENE (ppb)	TOLUENE (ppb)	ETHYL- BENZENE (ppb)	XYLENES (ppb)	TPH-G (ppb)	TOG (ppb)	1,2- DCA (ppb)	OTHER (ppb)	MC (ppb)	1,1,1- TCA (ppb)	1,1- DCA (ppb)	PCE (ppb)	DTW (feet)	SPT (feet)	WTE (feet)
C-14 520.08	03/28/86	---	---	---	---	---	---	---	---	---	---	---	---	---	---	---
	03/15/88	---	---	---	---	---	---	---	---	---	---	---	---	---	---	---
	05/10/88	13,000	29,000	2,700	18	120,000	---	---	---	---	---	---	---	13.39	0.00	506.69
	06/10/88	---	---	---	---	---	---	---	---	---	---	---	---	14.65	0.00	505.43
	07/25/88	---	---	---	---	---	---	---	---	---	---	---	---	13.47	0.00	506.61
	10/13/88	ND	ND	ND	ND	ND	---	---	---	---	---	---	---	13.58	0.00	506.50
	01/01/89	---	---	---	---	---	---	---	---	---	---	---	---	13.00	0.00	507.08
	01/12/89	ND	ND	ND	ND	NS	---	---	---	---	---	---	---	---	---	---
	04/12/89	ND	ND	ND	ND	NS	ND	ND	ND	ND	---	---	---	13.47	0.00	506.61
	06/26/89	14,000	25,000	3,400	26,000	140,000	---	30	---	---	---	---	---	13.80	0.00	506.28
	10/13/89	12,000	16,000	1,600	13,000	86,000	---	---	---	---	---	---	---	13.62	0.00	506.46
	01/03/90	9,500	16,000	1,800	19,000	120,000	---	25	3	---	---	---	---	13.91	0.00	506.17
	01/04/90	3,900	8,100	1,200	7,700	76,000	---	18	1	---	---	---	---	13.91	0.00	506.17
	05/08/90	7,500	17,000	1,400	14,000	62,000	---	13	---	ND	---	ND	---	13.89	0.00	506.19
	09/27/90	---	---	---	---	---	---	---	---	---	---	---	---	13.78	0.00	506.30
	01/03/91	---	---	---	---	---	---	---	---	---	---	---	---	13.72	0.00	506.36
	04/12/91	750	3,800	720	9,200	60,000	---	ND	ND	ND	ND	ND	ND	12.97	0.00	507.11
	09/04/91	2,800	11,000	1,300	13,000	110,000	---	---	---	---	---	---	---	13.84	0.00	506.24
	04/06/92	190	1,800	440	5,100	41,000	---	ND	ND	ND	ND	ND	ND	12.44	0.00	507.64
	07/28/92	2,300	9,700	1,800	15,000	130,000	---	---	---	---	---	---	---	13.70	0.00	506.38
10/16/92	---	---	---	---	---	---	---	---	---	---	---	---	14.38	0.00	505.70	
01/14/93*	220	790	220	2,700	27,000	---	---	---	---	---	---	---	8.80	0.00	511.28	
03/26/93	330	1,600	460	4,000	23,000**	---	---	---	---	---	---	---	9.12	0.00	510.96	
04/22/93	840	2,300	130	3,500	17,000	---	---	---	---	---	---	---	12.10	SHEEN	507.98	
C-15 522.41	03/28/86	---	---	---	---	---	---	---	---	---	---	---	---	13.14	0.00	509.27
	03/15/88	ND	ND	ND	ND	ND	---	---	---	---	---	---	---	15.13	0.00	507.28
	05/10/88	---	---	---	---	---	---	---	---	---	---	---	---	15.40	0.00	507.01
	06/10/88	---	---	---	---	---	---	---	---	---	---	---	---	16.49	0.00	505.92
	07/25/88	---	---	---	---	---	---	---	---	---	---	---	---	15.17	0.00	507.24
	10/13/88	ND	ND	ND	ND	ND	---	---	---	---	---	---	---	15.33	0.00	507.08
	01/01/89	---	---	---	---	---	---	---	---	---	---	---	---	13.70	0.00	508.71
	01/12/89	ND	ND	ND	ND	ND	---	---	---	---	---	---	---	---	---	---
	04/12/89	ND	ND	ND	ND	ND	ND	ND	ND	---	---	---	---	15.34	0.00	507.07
	06/26/89	ND	ND	ND	ND	ND	ND	ND	---	---	---	---	---	15.72	0.00	506.69
	10/13/89	ND	ND	ND	ND	ND	ND	ND	---	---	---	---	---	15.96	0.00	506.45
	01/03/90	ND	ND	ND	ND	ND	---	---	---	---	---	---	---	15.42	0.00	506.99
	05/08/90	ND	ND	ND	ND	ND	---	ND	---	ND	---	ND	---	15.62	0.00	506.79
	09/27/90	ND	ND	ND	ND	ND	---	ND	ND	2.9	ND	ND	---	15.59	0.00	506.82
	01/03/91	ND	ND	ND	0.6	ND	---	ND	ND	ND	ND	ND	ND	15.50	0.00	506.91
	04/12/91	---	---	---	---	---	---	---	---	---	---	---	---	15.21	0.00	507.20
	09/04/91	---	---	---	---	---	---	---	---	---	---	---	---	15.90	0.00	506.51
	04/06/92	ND	ND	ND	ND	ND	---	ND	ND	ND	ND	ND	ND	14.88	0.00	507.53
	07/28/92	ND	ND	ND	ND	ND	---	---	---	---	---	---	---	15.82	0.00	506.59
	10/16/92	ND	ND	ND	ND	ND	---	---	---	---	---	---	---	16.25	0.00	506.16
01/14/93*	ND	1.9	0.8	5.1	61	---	---	---	---	---	---	---	12.48	0.00	509.93	
03/26/93	ND	ND	ND	1	ND	---	---	---	---	---	---	---	12.67	0.00	509.74	
04/22/93	ND	ND	ND	ND	ND	---	---	---	---	---	---	---	13.60	0.00	508.81	

**Table 1
HISTORICAL GROUNDWATER ANALYTICAL RESULTS AND MONITORING DATA**

CHEVRON SERVICE STATION #9-1924
4904 SOUTHFRONT ROAD, LIVERMORE, CALIFORNIA

WELL ID/ ELEVATION (TOC)	DATE	BENZENE (ppb)	TOLUENE (ppb)	ETHYL- BENZENE (ppb)	XYLENES (ppb)	TPH-G (ppb)	TOG (ppb)	1,2- DCA (ppb)	OTHER (ppb)	MC (ppb)	1,1,1- TCA (ppb)	1,1- DCA (ppb)	PCE (ppb)	DTW (feet)	SPT (feet)	WTE (feet)
C-16 519.68	03/28/86	---	---	---	---	---	---	---	---	---	---	---	---	---	---	---
	03/15/88	---	---	---	---	---	---	---	---	---	---	---	---	---	---	---
	05/10/88	1,000	73	140	180	4,500	---	---	---	---	---	---	---	13.78	0.00	505.90
	06/10/88	---	---	---	---	---	---	---	---	---	---	---	---	14.88	0.00	504.80
	07/25/88	---	---	---	---	---	---	---	---	---	---	---	---	13.69	0.00	505.99
	10/13/88	16	5.5	ND	16	1,600	---	---	---	---	---	---	---	13.80	0.00	505.88
	01/01/89	---	---	---	---	---	---	---	---	---	---	---	---	13.45	0.00	506.23
	01/12/89	360	11	78	51	1,000	---	---	---	---	---	---	---	---	---	---
	04/11/89	130	4	21	19	15,800	ND	8	---	---	---	---	---	13.78	0.00	505.90
	06/26/89	170	8	37	43	1,300	ND	ND	---	---	---	---	---	14.02	0.00	505.66
	10/13/89	20	ND	7	ND	1,000	ND	ND	---	---	---	---	---	14.01	0.00	505.67
	01/03/90	150	3	41	24	1,300	---	5	---	---	---	---	---	13.97	0.00	505.71
	05/07/90	49	4.4	29	13	480	---	4.5	ND	ND	ND	ND	---	14.45	0.00	505.23
	09/29/90	18	2.1	11	8.0	360	---	1.8	ND	ND	ND	ND	---	14.32	0.00	505.36
	01/03/91	12	ND	6	6	230	---	2	ND	0.8	ND	ND	ND	13.96	0.00	505.72
	04/12/91	---	---	---	---	---	---	---	---	---	---	---	---	13.74	0.00	505.94
	09/04/91	---	---	---	---	---	---	---	---	---	---	---	---	14.22	0.00	505.46
	04/06/92	30	ND	14	12.0	360	---	1.0	ND	ND	ND	ND	ND	13.18	0.00	506.50
	07/28/92	31	ND	6.8	16	310	---	---	---	---	---	---	---	13.93	0.00	505.75
	10/16/92	11	ND	5.1	3.4	140	---	---	---	---	---	---	---	14.92	0.00	504.78
01/14/93*	24	ND	36	21	740	---	---	---	---	---	---	---	11.81	0.00	507.87	
03/26/93	22	2	16	10	730	---	---	---	---	---	---	---	11.36	0.00	508.32	
04/22/93	46	ND	24	6	850	---	---	---	---	---	---	---	12.30	0.00	507.38	
C-17 520.82	03/28/86	---	---	---	---	---	---	---	---	---	---	---	---	13.48	0.00	507.34
	03/15/88	---	---	---	---	---	---	---	---	---	---	---	---	14.76	0.00	506.06
	05/10/88	---	---	---	---	---	---	---	---	---	---	---	---	14.77	0.00	506.05
	06/10/88	---	---	---	---	---	---	---	---	---	---	---	---	15.84	0.00	504.98
	07/25/88	---	---	---	---	---	---	---	---	---	---	---	---	14.63	0.00	506.19
	10/13/88	18	900	760	5,500	270,000	---	---	---	---	---	---	---	14.83	0.00	505.99
	01/01/89	---	---	---	---	---	---	---	---	---	---	---	---	14.78	0.00	506.04
	01/12/89	ND	490	2,100	6,700	190,000	---	---	---	---	---	---	---	---	---	---
	04/11/89	30	150	320	1,000	27,000	6.0	ND	---	---	---	---	---	14.83	0.00	505.99
	06/26/89	50	390	660	2,000	20,000	ND	ND	---	---	---	---	---	15.03	0.00	505.79
	06/26/89	40	420	740	2,200	27,000	---	ND	---	---	---	---	---	15.03	0.00	505.79
	10/13/89	ND	48	230	480	17,000	ND	ND	---	---	---	---	---	15.02	0.00	505.80
	01/03/90	ND	29	120	210	14,000	---	ND	---	---	---	---	---	15.10	0.00	505.72
	05/08/90	25	130	210	470	9,500	---	ND	---	ND	ND	ND	---	15.12	0.00	505.70
	09/29/90	ND	ND	ND	ND	ND	---	ND	ND	ND	1.9	ND	---	14.99	0.00	505.83
	09/29/90	ND	3.4	ND	ND	ND	---	ND	ND	1.8	1.9	ND	---	14.99	0.00	505.83
	01/03/91	ND	28	56	140	3,700	---	ND	ND	1.8	1.9	ND	ND	14.92	0.00	505.90
	01/03/91	ND	10	59	150	8,600	---	ND	ND	ND	ND	ND	ND	14.92	0.00	505.90
	04/12/91	ND	5	47	120	8,600	---	ND	ND	ND	ND	ND	ND	14.71	0.00	506.11
	04/12/91	ND	11	48	120	4,400	---	ND	ND	ND	ND	ND	ND	14.71	0.00	506.11
09/04/91	ND	27	49	79	5,800	---	ND	ND	ND	ND	ND	ND	15.17	0.00	505.65	
09/04/91	ND	21	36	61	4,100	---	ND	ND	ND	ND	ND	ND	15.17	0.00	505.65	
04/06/92	ND	5.8	27	29	2,300	---	ND	ND	ND	ND	ND	ND	14.14	0.00	506.68	
07/28/92	99	180	170	430	11,000	---	---	---	---	---	---	---	15.18	0.00	505.64	
10/16/92	ND	4,800	3,900	6,600	1,200,000	---	---	---	---	---	---	---	15.76	0.00	505.06	
01/14/93*	9.3	9.1	23	34	3,500	---	---	---	---	---	---	---	13.44	0.00	507.38	
03/26/93	ND	19	20	35	3,700**	---	---	---	---	---	---	---	12.46	0.00	508.36	
04/22/93	16	68	44	97	8,900	---	---	---	---	---	---	---	13.30	0.00	507.52	

**Table 1
HISTORICAL GROUNDWATER ANALYTICAL RESULTS AND MONITORING DATA**

CHEVRON SERVICE STATION #9-1924
4904 SOUTHFRONT ROAD, LIVERMORE, CALIFORNIA

WELL ID/ ELEVATION (TOC)	DATE	BENZENE (ppb)	TOLUENE (ppb)	ETHYL- BENZENE (ppb)	XYLENES (ppb)	TPH-G (ppb)	TOG (ppb)	1,2- DCA (ppb)	OTHER (ppb)	MC (ppb)	1,1,1- TCA (ppb)	1,1- DCA (ppb)	PCE (ppb)	DTW (feet)	SPT (feet)	WTE (feet)
C-18 518.96	03/28/86	---	---	---	---	---	---	---	---	---	---	---	---	---	---	---
	03/15/88	---	---	---	---	---	---	---	---	---	---	---	---	---	---	---
	05/10/88	---	---	---	---	---	---	---	---	---	---	---	---	---	---	---
	06/10/88	---	---	---	---	---	---	---	---	---	---	---	---	14.89	0.00	504.07
	07/25/88	---	---	---	---	---	---	---	---	---	---	---	---	13.79	0.00	505.17
	10/13/88	ND	ND	ND	ND	ND	ND	---	---	---	---	---	---	13.86	0.00	505.10
	01/01/89	---	---	---	---	---	---	---	---	---	---	---	---	13.94	0.00	505.02
	01/12/89	ND	ND	ND	ND	ND	ND	---	---	---	---	---	---	---	0.00	518.96
	04/11/89	ND	ND	ND	ND	ND	ND	ND	3.6	---	---	---	---	14.86	0.00	504.10
	06/26/89	ND	ND	ND	ND	ND	ND	ND	3.1	---	---	---	---	14.02	0.00	504.94
	10/13/89	ND	ND	ND	ND	ND	ND	ND	ND	---	---	---	---	15.06	0.00	503.90
	01/03/90	ND	ND	ND	ND	ND	ND	---	1	---	---	---	---	14.07	0.00	504.89
	05/07/90	ND	ND	ND	ND	ND	ND	---	ND	ND	---	ND	---	14.01	0.00	504.95
	09/27/90	ND	ND	ND	ND	ND	ND	---	ND	ND	0.6	ND	ND	13.91	0.00	505.05
	01/03/91	ND	ND	ND	ND	ND	ND	---	ND	ND	ND	ND	ND	13.98	0.00	504.98
	04/12/91	ND	ND	ND	ND	ND	ND	---	ND	ND	ND	ND	ND	13.83	0.00	505.13
	09/04/91	ND	ND	ND	ND	ND	ND	---	ND	ND	ND	ND	ND	14.20	0.00	504.76
	04/06/92	ND	ND	ND	ND	ND	ND	---	ND	ND	ND	ND	ND	13.07	0.00	505.89
	07/28/92	ND	ND	ND	ND	ND	ND	---	---	---	---	---	---	13.55	0.00	505.41
	10/16/92	ND	ND	ND	ND	ND	ND	---	---	---	---	---	---	14.38	0.00	504.58
01/14/93*	ND	ND	ND	ND	1.8	56	---	---	---	---	---	---	12.46	0.00	506.50	
03/26/93	ND	ND	ND	ND	ND	ND	---	---	---	---	---	---	11.46	0.00	507.50	
04/22/93	ND	ND	ND	ND	ND	ND	---	---	---	---	---	---	12.58	0.00	506.38	

**Table 1
HISTORICAL GROUNDWATER ANALYTICAL RESULTS AND MONITORING DATA**

CHEVRON SERVICE STATION #9-1924
4904 SOUTHFRONT ROAD, LIVERMORE, CALIFORNIA

WELL ID/ ELEVATION (TOC)	DATE	BENZENE (ppb)	TOLUENE (ppb)	ETHYL- BENZENE (ppb)	XYLENES (ppb)	TPH-G (ppb)	TOG (ppb)	1,2- DCA (ppb)	OTHER (ppb)	MC (ppb)	1,1,1- TCA (ppb)	1,1- DCA (ppb)	PCE (ppb)	DTW (feet)	SPT (feet)	WTE (feet)
C-19 520.99	03/28/86	---	---	---	---	---	---	---	---	---	---	---	---	---	---	---
	03/15/88	---	---	---	---	---	---	---	---	---	---	---	---	---	---	---
	05/10/88	1,400	360	950	1,300	18	---	---	---	---	---	---	---	15.23	0.00	505.76
	06/10/88	---	---	---	---	---	---	---	---	---	---	---	---	16.56	0.00	504.41
	07/25/88	---	---	---	---	---	---	---	---	---	---	---	---	15.19	0.00	505.80
	10/13/88	8.3	4.7	4.4	ND	ND	---	---	---	---	---	---	---	15.27	0.00	505.72
	01/01/89	---	---	---	---	---	---	---	---	---	---	---	---	15.20	0.00	505.79
	01/12/89	5	4	ND	ND	ND	---	---	---	---	---	---	---	---	---	---
	04/11/89	1.8	ND	ND	ND	ND	13	---	---	---	---	---	---	15.24	0.00	505.75
	04/11/89	1.2	ND	0.6	0.6	500	14	---	---	---	---	---	---	15.24	0.00	505.75
	06/26/89	2.5	ND	ND	ND	500	26	---	---	---	---	---	---	15.44	0.00	505.55
	10/13/89	ND	ND	ND	ND	540	13	13	---	---	---	---	---	15.47	0.00	505.52
	01/03/90	1.2	0.7	1.3	0.9	ND	11	---	---	---	---	---	---	15.45	0.00	505.54
	05/07/90	ND	ND	ND	ND	ND	4.6	---	---	ND	---	ND	---	15.66	0.00	505.31
	09/28/90	ND	ND	ND	ND	ND	---	---	ND	1.2	---	ND	---	15.52	0.00	505.47
	01/03/91	ND	ND	ND	ND	66	1	---	---	ND	---	ND	0.9	15.56	0.00	505.43
	04/12/91	---	---	---	---	---	---	---	---	---	---	---	---	15.20	0.00	505.79
	09/04/91	---	---	---	---	---	---	---	---	---	---	---	---	15.60	0.00	505.39
	04/06/92	0.7	ND	1.0	ND	110	1.9	---	---	ND	---	ND	---	14.58	0.00	506.41
	07/28/92	1.4	ND	1.0	4.2	ND	---	---	---	---	---	---	---	15.26	0.00	505.73
10/16/92	ND	ND	ND	ND	ND	---	---	---	---	---	---	---	16.00	0.00	504.99	
01/14/93*	1.1	ND	0.9	0.9	100	---	---	---	---	---	---	---	13.69	0.00	507.30	
03/26/93	ND	ND	ND	ND	ND	---	---	---	---	---	---	---	12.96	0.00	508.03	
04/22/93	0.6	1	1	1	250**	---	---	---	---	---	---	---	14.18	0.00	506.81	

Explanation

Elevations are expressed as feet above mean sea level.

TOC = Top of casing

WTE = Water table elevation (well elevation - (DTW - (SPT x 0.8))

DTW = Depth to water

SPT = Separate-phase hydrocarbon thickness

TPH-G = Total Petroleum Hydrocarbons as Gasoline (ppb)

TOG = Total Oil & Grease (EPA Method 503D & 503E)

* = Rinsate sample contaminated; resampled 03/26/93

** = Uncategorized compound not included in gasoline hydrocarbon total

*** = Hydrocarbon pattern uncharacteristic of fresh gasoline

PCE = Tetrachloroethene

1,2-DCA = 1,2-Dichloroethane

MC = Methylene Chloride

TCA = 1,1,1-Trichloroethane

1,1-DCA = 1,1-Dichloroethane

ND = Not detected at or above the minimum quantitation limit (MQL)

--- = Not sampled, not monitored, inaccessible

OTHER = 5 ppb Carbon Disulfide detected in C-1 on 10/13/89

3 ppb Vinyl Chloride detected in C-14 on 1/3/90

1 ppb Vinyl Chloride detected in C-14 on 1/4/90

13 ppb Carbon Disulfide detected in C-19 on 10/13/89

ATTACHMENT I

ANALYTICAL LABORATORY REPORTS

AND

CHAIN-OF-CUSTODY MANIFESTS



GTEL

ENVIRONMENTAL
LABORATORIES, INC.

4080 Pike Lane
Concord, CA 94520
(510) 685-7852
(800) 544-3422 Inside CA
(800) 423-7143 Outside CA
(510) 825-0720 FAX

Client Number: 020704233
Facility Number: 8-1924
Project ID: 4904 Southfront Rd.
Livermore
Work Order Number: C3-04-0368

May 7, 1993

Bruce Eppler
Groundwater Technology, Inc.
1401 Halyard Drive, Suite 140
W. Sacramento, CA 95691

Enclosed please find the analytical results for samples received by GTEL Environmental Laboratories, Inc. on 04/23/93.

A formal Quality Assurance/Quality Control (QA/QC) program is maintained by GTEL, which is designed to meet or exceed the EPA requirements. Analytical work for this project met QA/QC criteria, unless otherwise stated in the footnotes.

GTEL is certified by the California State Department of Health Services, Laboratory certificate numbers 194 and 1075, to perform analyses for drinking water, wastewater, and hazardous waste materials according to EPA protocols.

If you have any questions concerning this analysis or if we can be of further assistance, please call our Customer Service Representative.

Sincerely,

GTEL Environmental Laboratories, Inc.

Eileen F. Bullen
Laboratory Director

Client Number: 020704233
 Facility Number: 9-1924
 Project ID: 4904 Southfront Rd.
 Livermore
 Work Order Number: C3-04-0368

Table 1

ANALYTICAL RESULTS

**Aromatic Volatile Organics and
 Total Petroleum Hydrocarbons as Gasoline in Water**

EPA Methods 5030, 8020, and Modified 8015^a

GTEL Sample Number		01	02	03	04
Client Identification		TB-LB	RINSATE	C-11	C-12
Date Sampled		04/22/93	04/22/93	04/22/93	04/22/93
Date Analyzed		05/04/93	05/04/93	05/05/93	05/05/93
Analyte	Detection Limit, ug/L	Concentration, ug/L			
Benzene	0.5	<0.5	<0.5	0.8	<0.5
Toluene	0.5	<0.5	<0.5	<0.5	<0.5
Ethylbenzene	0.5	<0.5	<0.5	<0.5	<0.5
Xylene, total	0.5	<0.5	<0.5	<0.5	<0.5
BTEX, total	--	--	--	0.8	--
TPH as Gasoline	50	<50	<50	<50	<50
Detection Limit Multiplier		1	1	1	1
BFB surrogate, % recovery		95.9	100	98.4	95.3

a. Test Methods for Evaluating Solid Waste, SW-846, Third Edition, Revision 0, US EPA November 1986. Modification for TPH as gasoline as per California State Water Resources Control Board LUFT Manual protocols, May 1988 revision. Bromofluorobenzene surrogate recovery acceptability limits are 70 - 130%.

Client Number: 020704233
 Facility Number: 9-1924
 Project ID: 4904 Southfront Rd.
 Livermore
 Work Order Number: C3-04-0368

Table 1 (Continued)

ANALYTICAL RESULTS

**Aromatic Volatile Organics and
 Total Petroleum Hydrocarbons as Gasoline in Water**

EPA Methods 5030, 8020, and Modified 8015^a

GTEL Sample Number		05	06	07	08
Client Identification		C-15	C-18	C-10	C-13
Date Sampled		04/22/93	04/22/93	04/22/93	04/22/93
Date Analyzed		05/05/93	05/05/93	05/05/93	05/05/93
Analyte	Detection Limit, ug/L	Concentration, ug/L			
Benzene	0.5	<0.5	<0.5	<0.5	<0.5
Toluene	0.5	<0.5	<0.5	<0.5	<0.5
Ethylbenzene	0.5	<0.5	<0.5	<0.5	<0.5
Xylene, total	0.5	<0.5	<0.5	<0.5	<0.5
BTEX, total	--	--	--	--	--
TPH as Gasoline	50	<50	<50	<50	<50
Detection Limit Multiplier		1	1	1	1
BFB surrogate, % recovery		97.3	93.6	96.5	98.5

a. Test Methods for Evaluating Solid Waste, SW-846, Third Edition, Revision 0, US EPA November 1986. Modification for TPH as gasoline as per California State Water Resources Control Board LUFT Manual protocols, May 1988 revision. Bromofluorobenzene surrogate recovery acceptability limits are 70 - 130%.

Client Number: 020704233
 Facility Number: 9-1924
 Project ID: 4904 Southfront Rd.
 Livermore
 Work Order Number: C3-04-0368

Table 1 (Continued)

ANALYTICAL RESULTS

**Aromatic Volatile Organics and
 Total Petroleum Hydrocarbons as Gasoline in Water**

EPA Methods 5030, 8020, and Modified 8015^a

GTEL Sample Number		09	10	11	12
Client Identification		C-3	C-19	C-8	C-16
Date Sampled		04/22/93	04/22/93	04/22/93	04/22/93
Date Analyzed		05/05/93	05/05/93	05/05/93	05/05/93
Analyte	Detection Limit, ug/L	Concentration, ug/L			
Benzene	0.5	<0.5	0.6	<0.5	46
Toluene	0.5	<0.5	1	0.6	<0.5
Ethylbenzene	0.5	<0.5	1	0.6	24
Xylene, total	0.5	<0.5	1	0.8	6
BTEX, total	--	--	4	2	76
TPH as Gasoline	50	<50**	250*	68*	850
Detection Limit Multiplier		1	1	1	1
BFB surrogate, % recovery		96.8	99.7	98.0	104

- a. Test Methods for Evaluating Solid Waste, SW-846, Third Edition, Revision 0, US EPA November 1986. Modification for TPH as gasoline as per California State Water Resources Control Board LUFT Manual protocols, May 1988 revision. Bromofluorobenzene surrogate recovery acceptability limits are 70 - 130%.
- * Uncategorized compounds not included in gasoline hydrocarbon concentration.
- ** Hydrocarbon pattern uncharacteristic of fresh gasoline.

Client Number: 020704233
 Facility Number: 9-1924
 Project ID: 4904 Southfront Rd.
 Livermore
 Work Order Number: C3-04-0368

Table 1 (Continued)

ANALYTICAL RESULTS

**Aromatic Volatile Organics and
 Total Petroleum Hydrocarbons as Gasoline in Water**

EPA Methods 5030, 8020, and Modified 8015^a

GTEL Sample Number		13	14	15	16
Client Identification		RINSATE C-5	C-5	C-1	C-2
Date Sampled		04/22/93	04/22/93	04/22/93	04/22/93
Date Analyzed		05/05/93	05/05/93	05/05/93	05/05/93
Analyte	Detection Limit, ug/L	Concentration, ug/L			
Benzene	0.5	<0.5	220	26	12
Toluene	0.5	<0.5	18	44	12
Ethylbenzene	0.5	<0.5	120	580	28
Xylene, total	0.5	<0.5	65	330	29
BTEX, total	--	--	420	980	81
TPH as Gasoline	50	<50	2300*	18000	2000
Detection Limit Multiplier		1	1	5	1
BFB surrogate, % recovery		101	140***	108	116

a. Test Methods for Evaluating Solid Waste, SW-846, Third Edition, Revision 0, US EPA November 1986. Modification for TPH as gasoline as per California State Water Resources Control Board LUFT Manual protocols, May 1988 revision. Bromofluorobenzene surrogate recovery acceptability limits are 70 - 130%.

* Uncategorized compounds not included in gasoline hydrocarbon concentration.

***BFB recovery high due to interference of the target compounds at the BFB peak.

Client Number: 020704233
 Facility Number: 9-1924
 Project ID: 4904 Southfront Rd.
 Livermore
 Work Order Number: C3-04-0368

Table 1 (Continued)

ANALYTICAL RESULTS

**Aromatic Volatile Organics and
 Total Petroleum Hydrocarbons as Gasoline in Water**

EPA Methods 5030, 8020, and Modified 8015^a

GTEL Sample Number		17	18	19	20
Client Identification		C-17	C-7	C-9	C-14
Date Sampled		04/22/93	04/22/93	04/22/93	04/22/93
Date Analyzed		05/06/93	05/06/93	05/05/93	05/06/93
Analyte	Detection Limit, ug/L	Concentration, ug/L			
Benzene	0.5	16	130	60	840
Toluene	0.5	68	18	40	2300
Ethylbenzene	0.5	44	43	68	130
Xylene, total	0.5	97	36	98	3500
BTEX, total	—	230	230	270	6800
TPH as Gasoline	50	8900	3800	7300	17000
Detection Limit Multiplier		1	1	1	10
BFB surrogate, % recovery		142***	139***	127	112

a. Test Methods for Evaluating Solid Waste, SW-846, Third Edition, Revision 0, US EPA November 1986. Modification for TPH as gasoline as per California State Water Resources Control Board LUFT Manual protocols, May 1988 revision. Bromofluorobenzene surrogate recovery acceptability limits are 70 - 130%.

***BFB recovery high due to interference of the target compounds at the BFB peak.

Client Number: 020704233
 Facility Number: 9-1924
 Project ID: 4904 Southfront Rd.
 Livermore
 Work Order Number: C3-04-0368

Table 1 (Continued)

ANALYTICAL RESULTS

**Aromatic Volatile Organics and
 Total Petroleum Hydrocarbons as Gasoline in Water**

EPA Methods 5030, 8020, and Modified 8015^a

GTEL Sample Number		21	050593GCCQ		
Client Identification		C-6	METHOD BLANK		
Date Sampled		04/22/93	--		
Date Analyzed		05/06/93	05/05/93		
Analyte	Detection Limit, ug/L	Concentration, ug/L			
Benzene	0.5	29	<0.5		
Toluene	0.5	170	<0.5		
Ethylbenzene	0.5	640	<0.5		
Xylene, total	0.5	2400	<0.5		
BTEX, total	--	3200	--		
TPH as Gasoline	50	20000	<50		
Detection Limit Multiplier		5	1		
BFB surrogate, % recovery		129	98.4		

a. Test Methods for Evaluating Solid Waste, SW-846, Third Edition, Revision 0, US EPA November 1986. Modification for TPH as gasoline as per California State Water Resources Control Board LUFT Manual protocols, May 1988 revision. Bromofluorobenzene surrogate recovery acceptability limits are 70 - 130%.

Client Number: 020704233
 Facility Number: 9-1924
 Project ID: 4904 Southfront Rd.
 Livermore
 Work Order Number: C3-04-0368

QC Matrix Spike and Duplicate Spike Results

Matrix: Water

Analyte	Sample ID	Spike Amount	Units	Recovery, %	Duplicate Recovery, %	RPD, %	Control Limits
Modified EPA 8020:							
Benzene	Reagent Water	20.0	ug/L	98.5	94.5	4.1	70 - 147
Toluene	Reagent Water	20.0	ug/L	101	97.5	3.5	67 - 150
Ethylbenzene	Reagent Water	20.0	ug/L	95.5	92.0	3.7	69 - 145
Xylene, total	Reagent Water	60.0	ug/L	97.8	94.2	3.8	71 - 152

