

ALAMEDA COUNTY
HEALTH CARE SERVICES



AGENCY
DAVID J. KEARS, Agency Director

RAFAT A. SHAHID, DIRECTOR

DEPARTMENT OF ENVIRONMENTAL HEALTH
1131 Harbor Bay Parkway
Alameda, CA 94502-6577
(510) 567-6777

STID 266

March 21, 1996

Shirley B. Howkins
Formerly Aervoe Pacific
1132 Carpentier Street #207
San Leandro, CA 94577

RE: 2528 ADELINE STREET, OAKLAND CA 94607

Dear Ms. Howkins,

This office recently completed a review of the case file for the above referenced Oakland site up to and including the February 5, 1996 letter from Carlo C. Mormorunni of Fitzgerald, Abbott & Beardsley (F, A & B).

In the October 27, 1995, F, A & B report, laboratory analysis of soil and groundwater samples collected from the three (3) on-site monitoring wells (MW1, MW2 and MW3) have detected elevated levels of total petroleum hydrocarbons as gasoline, kerosene and stoddard solvent (TPHg, TPHk and TPHss), oil and grease (O&G), benzene, toluene, ethyl benzene and total xylenes (BTEX). Additional contaminants detected in the soil and groundwater samples collected include barium, selenium, 1,1-dichloroethene (1,1-DCE), 1,1-dichloroethane (1,1-DCA) and 1,1,1-trichloroethane (1,1,1-TCA).

At this time please adhere to a **quarterly** schedule of well sampling, monitoring, and report submittal as referenced in Title 23, California Code of Regulations (CCR) section 2652(d). Please have these groundwater samples analyzed for total petroleum hydrocarbons as gasoline, kerosene and stoddard solvent (TPHg, TPHk and TPHss), the aromatic hydrocarbons benzene, toluene, ethyl benzene and total xylene isomers (BTEX), oil and grease (O&G), the heavy metals barium and selenium and volatile organic compounds (VOCs) as per EPA Method 8240. In addition, please have the groundwater samples filtered before performing metals analyses.

Please feel free to contact me directly at (510)567-6880 if you have any questions regarding the content of this letter.

Sincerely,

Dale Klettke, CHMM
Hazardous Materials Specialist

Shirley Howkins
RE: 2528 Adeline Street, Oakland
March 21, 1996
Page 2 of 2

c: Carlo Mormorunni, Fitzgerald, Abbott & Beardsley, 1221 Broadway, 21st Floor, Oakland
CA 94612-1837
Tom Peacock, LOP Manager--files

pc
0266smp.dkt

HOMES

HOMES

HOMES

near former
kerosene
UST.

SUSPECTED LOCATION
OF G.W. SOLVENT
FOURMERE

Former
1000-gallon
kerosene UST
in what
appears to
have been a
concrete
vault.

P.2/15

roll up
roll door

OCT 19 '95 11:51AM SCI

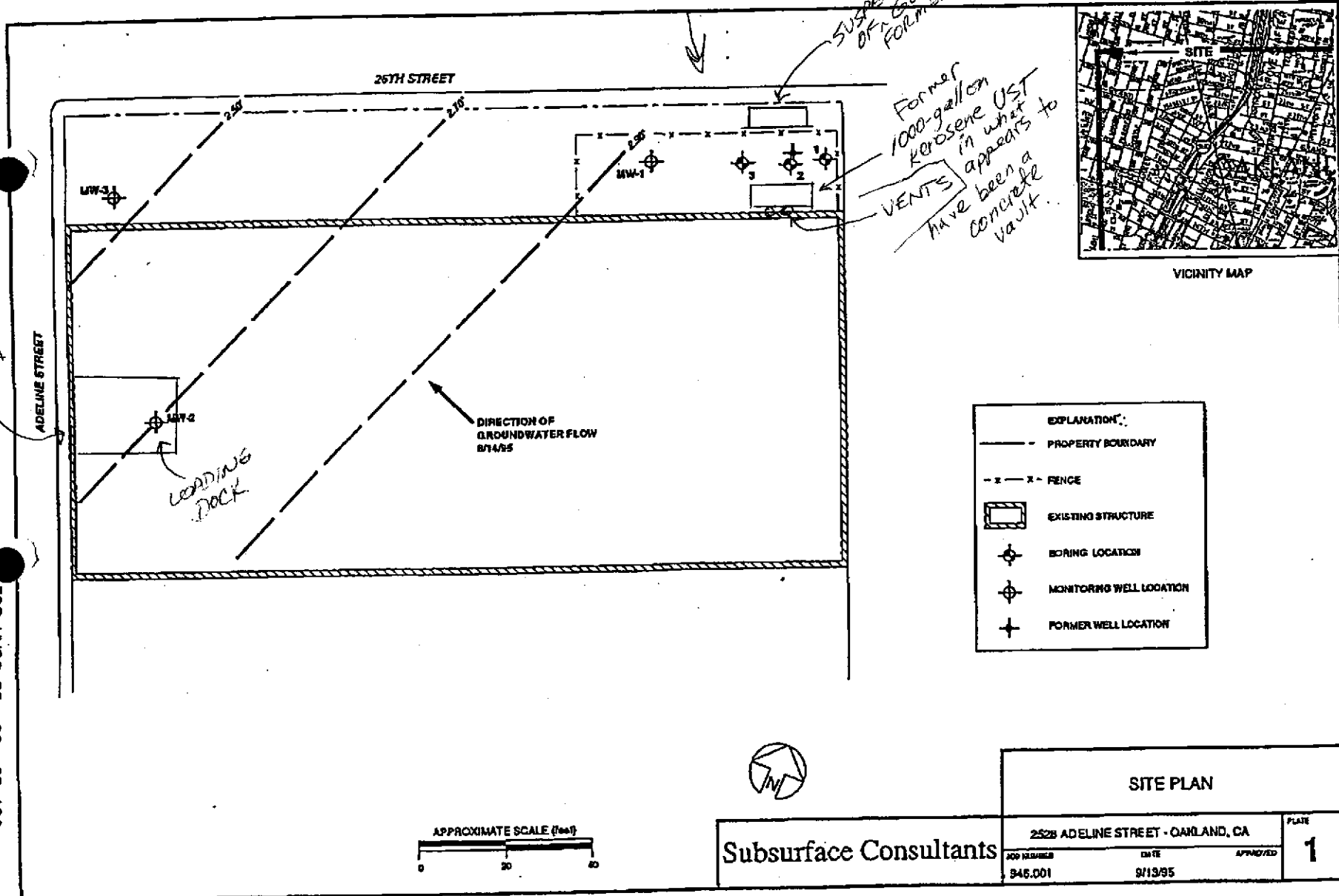

DOWN GRADIENT OF SITE (ACROSS ADELINE ST)
IS THE LIVE/WORK STUDIOS.



Subsurface Consultants

SITE PLAN		
2528 ADELINE STREET - OAKLAND, CA		PLATE
JOB NUMBER 946.001	DATE 9/13/95	APPROVED 1

ENVIRONMENTAL SERVICES, INC.
2528 Adeline, Oakland, CA
August 4, 1988 Job# 21788T1S

2nd UST

Site Map

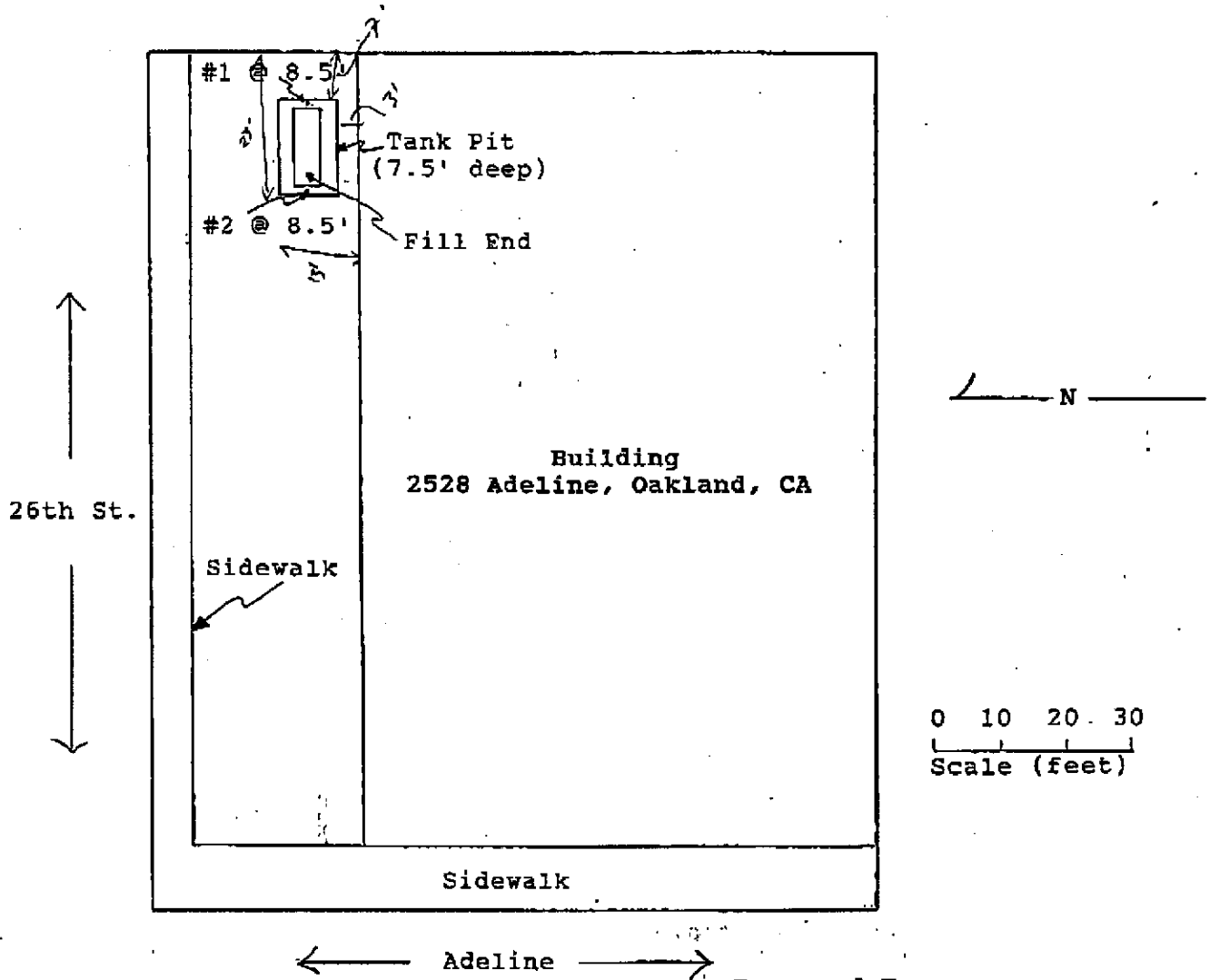

Prepared For:
Mr. Dan Heath
Toxic Industrial Environmental
Services
30028 Industrial Prkwy, S. W.
Hayward, CA 94544

TABLE 2
 BARIUM, PETROLEUM HYDROCARBON, AND VOLATILE ORGANIC COMPOUND
 CONCENTRATIONS IN SOIL
 2528 ADELINE STREET
 OAKLAND, CALIFORNIA

<u>Sample ID</u>	<u>Ba</u> <u>(mg/kg)</u>	<u>TEH</u> <u>(mg/kg)</u>	<u>TVH</u> <u>(mg/kg)</u>	<u>O&G</u> <u>(mg/kg)</u>	<u>4-Methyl-2-pentanone</u> <u>(ug/kg)</u>	<u>Other</u> <u>EPA 8240</u> <u>Compounds</u>
1 @ 2.0'	83	<1.0	<1.0	60	7.5	ND
1 @ 3.5'	91	--	--	--	--	--
1 @ 10.5'	--	<1.0	14	80	--	--
2 @ 4.0'	67,000	37	<1.0	140	9.1	ND
2 @ 5.5'	1,900	--	--	--	--	--
2 @ 10.5'	820	--	--	--	--	--
2 @ 11'	--	<1.0	24	110	--	--
3 @ 2.0'	14,000	41	<1.0	200	18	ND
3 @ 4.0'	2,100	--	--	--	--	--
3 @ 8.0'	2,900	--	--	--	--	--
MW-1 @ 3.0	220	<1.0	<1.0	140	60	ND
MW-1 @ 7.0'	--	<1.0	<1.0	150	--	--
MW-1 @ 8.0'	160	--	--	--	--	--
MW-2 @ 1.0'	37	--	--	--	--	--
MW-3 @ 2.5'	100	--	--	--	--	--

TVH = Total volatile hydrocarbons reported as gasoline, however the sample chromatogram does not resemble the gasoline standard.

TEH = Total extractable hydrocarbons reported as diesel, however the sample chromatogram does not resemble the diesel standard.

O&G = Oil and Grease

-- = Test not requested

Ba = Barium

Samples were collected on March 31, or August 9, 1995

mg/kg = milligrams per kilogram

ug/kg = micrograms per kilogram

<1.0 = None detected at or above the stated detection limit

TABLE 3
HEAVY METALS CONCENTRATIONS IN SOIL
2528 ADELIN STREET
OAKLAND, CALIFORNIA

	<u>1 @ 2.0'</u> <u>mg/kg</u>	<u>2 @ 4.0'</u> <u>mg/kg</u>	<u>3 @ 2.0'</u> <u>mg/kg</u>	<u>MW-1 @ 3.0'</u> <u>mg/kg</u>	<u>TTLIC</u> <u>mg/kg</u>
Antimony	<2.9	3.0	3.6	6.5	500
Arsenic	2.8	3.1	3.4	3.9	500
Barium	83	67,000	14,000	220	10,000
Beryllium	0.61	0.16	0.20	0.41	75
Cadmium	<0.25	<0.25	<0.25	<0.24	100
Chromium	35	19	21	35	500
Cobalt	8.5	19	6.1	6.4	8,000
Copper	38	63	42	20	2,500
Lead	3.8	21	49	4.4	1,000
Mercury	<0.10	<0.10	<0.10	<0.10	20
Molybdenum	<0.98	1.5	1.2	<0.97	3,500
Nickel	34	65	19	51	2,000
Selenium	<2.5	<2.5	<2.4	<2.5	100
Silver	<0.49	<0.50	<0.49	<0.49	500
Thallium	<2.5	<2.5	<2.4	<2.5	700
Vanadium	25	85	24	28	2,400
Zinc	61	190	250	63	5,000

<3.0 = None detected at or above the stated detection limit.

mg/kg = milligrams per kilogram

TTLIC = Total threshold limit concentration value for California regulated hazardous wastes.

Samples were collected on March 31, 1995.

TABLE 4
 PETROLEUM HYDROCARBON AND VOLATILE ORGANIC COMPOUND
 CONCENTRATIONS IN GROUNDWATER
 2528 ADELINE STREET
 OAKLAND, CALIFORNIA

SAMPLE ID	Date Sampled	TVH (ug/L)	TEH (ug/L)	O&G (mg/L)	Acetone (ug/L)	Carbon disulfide (ug/L)	1,1 DCA (ug/L)	1,1-DCE (ug/L)	2-Butanone (ug/L)	4-Methyl-2-pentanone (ug/L)	1,1,1 TCA (ug/L)	Benzene (ug/L)	Toluene (ug/L)	Ethyl benzene (ug/L)	Total xylenes (ug/L)	Cis-1,2-DCE (ug/L)	Other EPA 8240 Compounds
MW-1	4/3/95	730	310	5.8	<20	<5.0	<5.0	4.2	<10	<10	<5.0	3.1	39	13	75	<5.0	ND
Former Well ¹	3/31/95	2,800	1,600	37	24	4.1	<5.0	<5.0	7.7	57	<5.0	4.5	49	34	270	<5.0	ND
MW-2	8/15/95	83 ²	<50	<5	<50	<13	62	260	<25	<25	170	<13	<13	<13	<13	<13	ND
MW-3	8/15/95	<50	<50	<5	<20	<5.0	3.3	4.1	<10	<10	8.8	<5.0	<5.0	<5.0	<5.0	2.9	ND

¹ Well destroyed March 31, 1995

² Sample chromatogram does not resemble gasoline standard pattern

TVH = Total volatile hydrocarbons reported as gasoline

TEH = Total extractable hydrocarbons in the kerosene range, however the sample chromatogram does not resemble the kerosene standard.

O&G = Oil and grease

1,1-DCE = 1,1-Dichloroethene

1,1-DCA = 1,1-Dichloroethane

1,1,1-TCA = 1,1,1-Trichloroethane

Cis 1,2-DCE = Cis-1,2-Dichloroethene

<20 = None detected at or above the stated detection limit

ND = Not detected at or above analytical detection limits. See analytical test reports for individual detection limits.

ug/l = micrograms per liter

mg/l = milligrams per liter

TABLE 3
HEAVY METALS CONCENTRATIONS IN GROUNDWATER
2528 ADELIN STREET
OAKLAND, CALIFORNIA

	MW-1 (April 3, 1995)	Former Well (March 31, 1995)	MW-2 (August 15, 1995)	MW-3 (August 15, 1995)	MCL
	<u>ug/l</u>	<u>ug/l</u>	<u>ug/l</u>	<u>ug/l</u>	<u>ug/l</u>
Antimony	<60	<60	--	--	5
Arsenic	<5.0	<5.0	--	--	50
Barium	160	28,000	180*	62*	100
Beryllium	<2.0	<2.0	--	--	1
Cadmium	<1.0	<1.0	--	--	10
Chromium	<10	<10	--	--	50
Cobalt	<20	<20	--	--	NA
Copper	<10	<10	--	--	1300
Lead	<3.0	<3.0	--	--	50
Mercury	<0.20	<0.20	--	--	2
Molybdenum	<20	<20	--	--	NA
Nickel	<20	<20	--	--	100
Selenium	11	7.4	--	--	10
Silver	<10	<10	--	--	50
Thallium	<5.0	<5.0	--	--	1
Vanadium	<10	<10	--	--	NA
Zinc	<20	24	--	--	5000

ug/l = micrograms per liter

<3.0 = None detected at or above the stated detection limit

Samples were filtered prior to analysis

* = Samples not filtered prior to analyses

-- Test not requested

MCL = Maximum contaminant level

NA = not available

Table 6
Groundwater Elevation Data

<u>Well Number</u>	<u>Date</u>	<u>TOC¹ Elevation (feet)</u>	<u>Groundwater Depths² (feet)</u>	<u>Groundwater Elevation³ (feet)</u>
MW-1	4/3/95	10.99	5.78	5.21
	8/14/95		8.04	2.95
MW-2	8/14/95	9.12	6.42	2.7
MW-3	8/14/95	9.93	7.48	2.45

Notes:

1. TOC = Top of Casing
2. Measured below TOC
3. Reference Mean Sea Level