

**RANGE WEST
CONSULTANTS LLC**

Bill Borgh
Jenny Zimowski/Jeff Smith
Shelby Hathrop

RECEIVED
9:30 am, Mar 23, 2009
Alameda County
Environmental Health

March 15, 2005

Dick Mathews
Regional Real Estate Director
ConocoPhillips
76 Broadway
Sacramento, CA 95812

See attached.

Re: ConocoPhillips 2705748, 6401 Dublin Blvd., Dublin, CA.
Revised Taking, After Condition maps

Dear Dick,

Enclosed you will find the maps that outline the revised Legal Description given to us at the on-site meeting with the City. You will see that there is some overlap with the 8' dedication line, this may need to be addressed with the City but will require further review of the Legal Descriptions of the ConocoPhillips property.

I have also enclosed maps with cars on-site, after your review it may be necessary to place them in different places to depict scenarios that could potentially take place on-site in the after condition. Also you will find a standard After Condition map showing the layout of the site after project completion. Again, any changes you would like to see can be done to depict several curbing/parking layouts.

After your review please give me a call to discuss further issues concerning this case.

Sincerely,

Jeff Welch
Jeff Welch

W/Enclosures

WESTERN REGION BOX:

#9516

OIL COMPANY ACCESS ONLY
NO BUYER OR CONSULTANT

Store # 2705748 Date: 3-15-05
Unit # 1019 Code: GEN Color
Description: CITY OF DUBLIN

2109 S. Linmar Ct
Flagstaff, AZ 86001

phone: 928.773.4651
fax: 928.773.4652
jeffw@rangewestconsultants.com

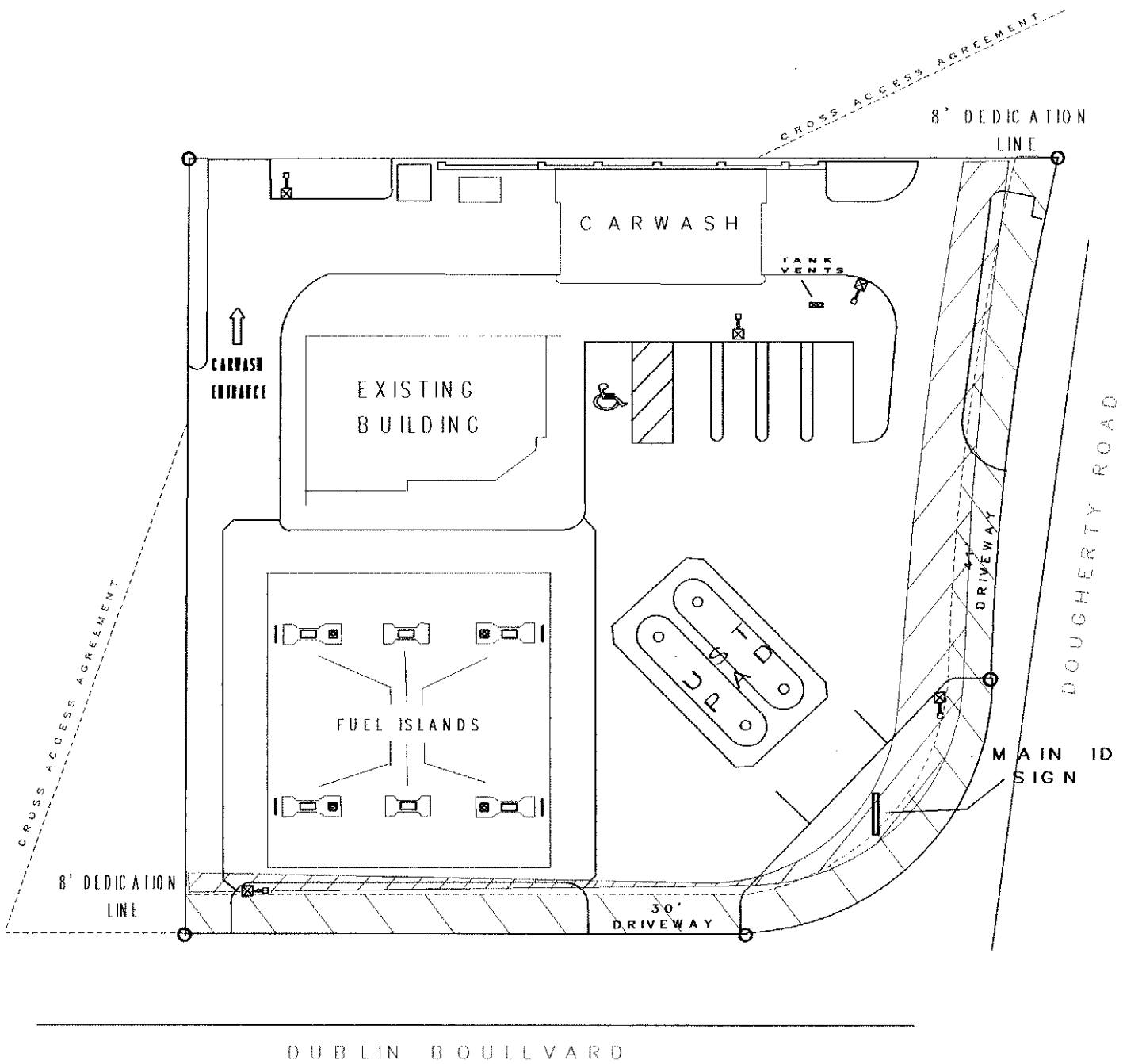

CAD WORKSHOP	
TAKE OVERLAY MAP	
2705748 DUBLIN, CA.	
SCALE: 1" = 30'	DATE: 02/08/05
PREPARED BY: JEFF WELCH	
AS PER LEGAL DESCRIPTION PROVIDED BY:	
CITY OF DUBLIN	



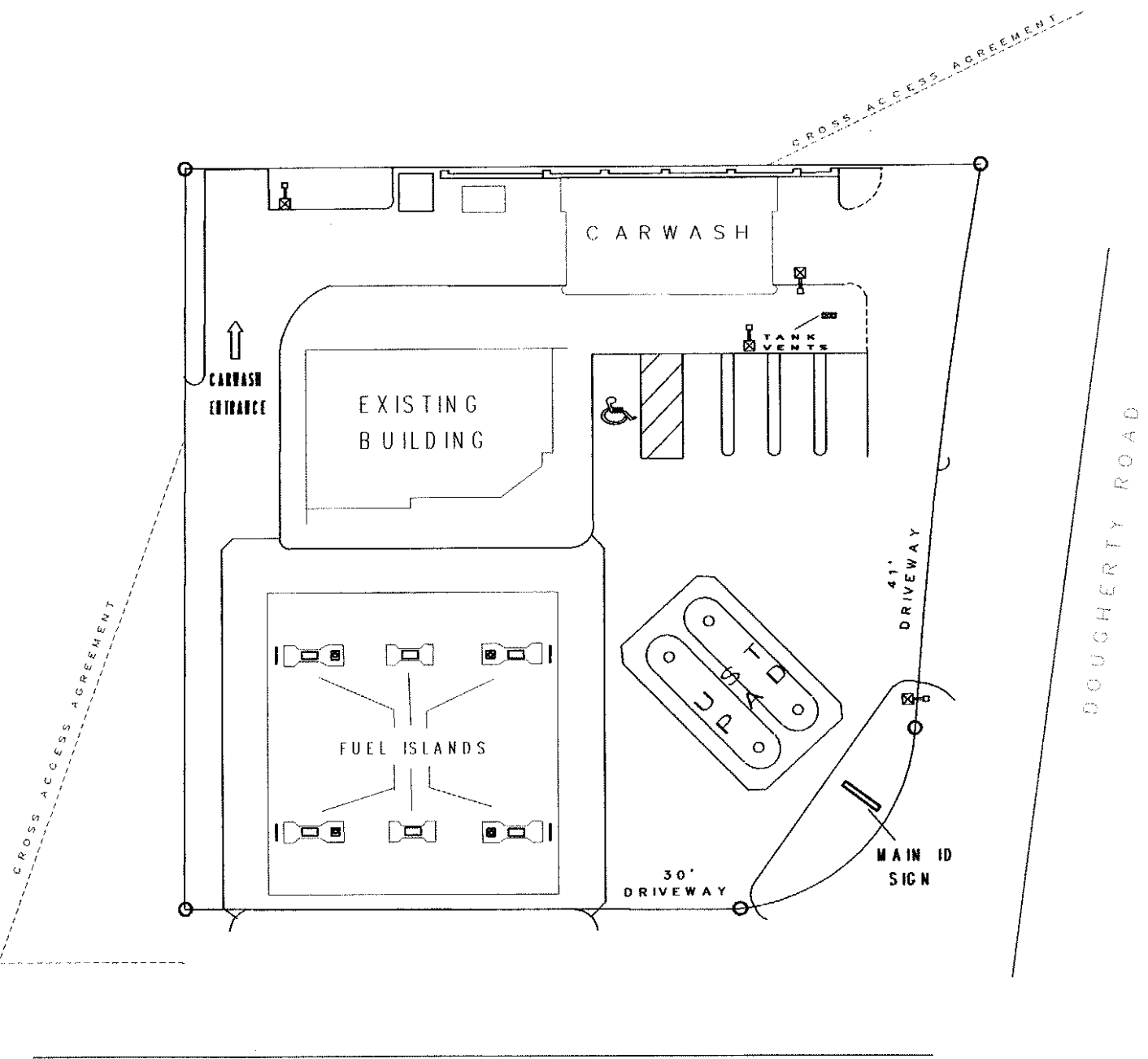

DURIN BOULEVARD

CAD WORKSHOP	
TAKE OVERLAY MAP	
2705748 DUBLIN, CA.	
SCALE: 1"=30'	DATE: 02/08/05
PREPARED BY: JEFF WEICH	
AS PER LEGAL DESCRIPTION PROVIDED BY:	
CITY OF DUBLIN	



2005 RELEASE AGREEMENT

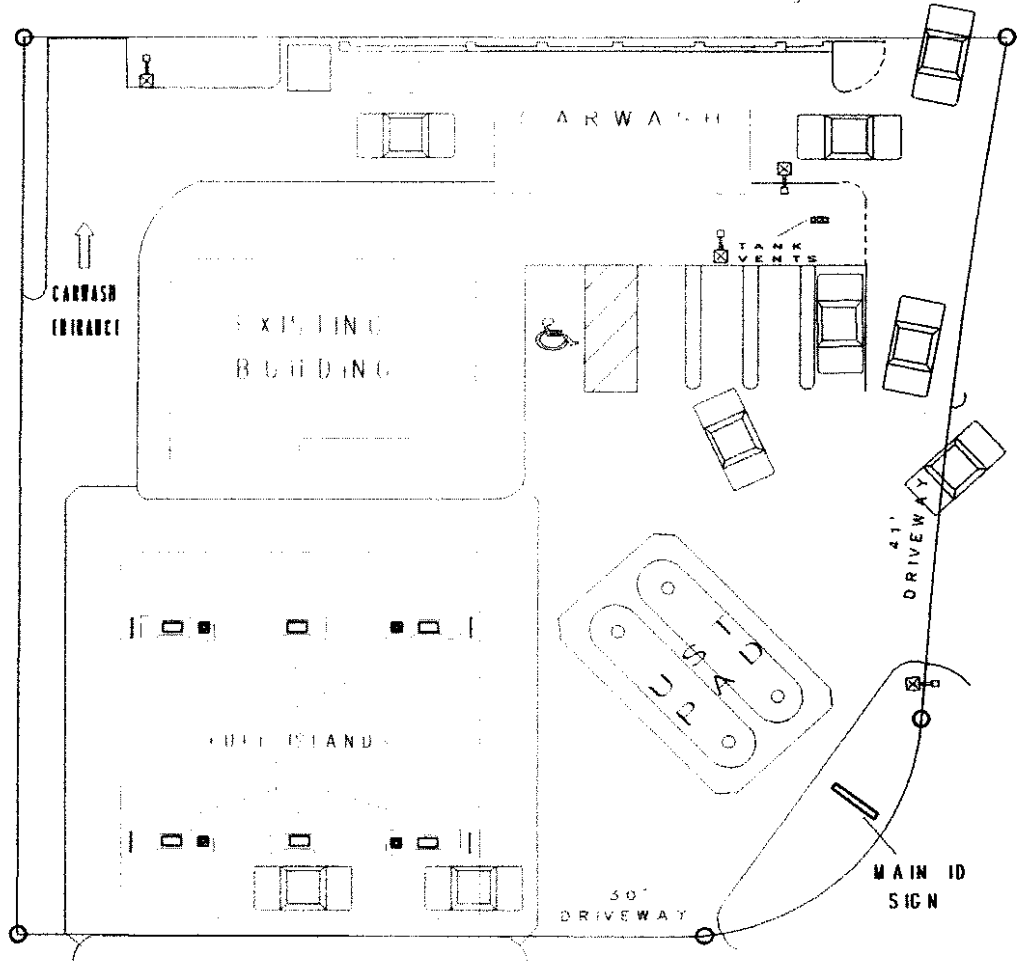

CROSS UTILITY AGREEMENT

CROSS UTILITY AGREEMENT

CAD WORKSHOP	
TAKE OVERLAY MAP	
2705748 DUBLIN, CA.	
SCALE: 1" = 30'	DATE: 02/08/05
PREPARED BY: JEFF WELCH	
AS PER LEGAL DESCRIPTION PROVIDED BY:	
CITY OF DUBLIN	

