



SEQUOIA ANALYTICAL

1900 Bates Avenue • Suite LM • Concord, California 94520
(510) 686-9600 • FAX (510) 686-9689

Kapreallan Engineering, Inc. 2401 Stanwell Dr., Ste. 400 Concord, CA 94520 Attention: Avo Avedassian	Client Project ID: Unocal #8419, 8401 Dublin Blvd., Dublin Sample Matrix: Soil Analysis Method: EPA 5030/8015/8020 First Sample #: 309-0255	Sampled: Sep 7, 1993 Received: Sep 7, 1993 Reported: Sep 9, 1993
---	--	--

TOTAL PURGEABLE PETROLEUM HYDROCARBONS with BTEX DISTINCTION

Analyte	Reporting Limit mg/kg	Sample I.D. 309-0255 P1	Sample I.D. 309-0256 P2	Sample I.D. 309-0257 P3	Sample I.D. 309-0258 P4	Sample I.D. 309-0259 P5	Sample I.D. 309-0260 P6
Purgeable Hydrocarbons	1.0	N.D.	N.D.	9.7	1.8	N.D.	N.D.
Benzene	0.005	N.D.	0.0073	0.15	0.0061	N.D.	N.D.
Toluene	0.005	0.0068	0.012	1.2	0.012	N.D.	0.011
Ethyl Benzene	0.005	N.D.	N.D.	0.36	0.066	N.D.	0.048
Total Xylenes	0.005	0.012	0.015	2.4	0.053	N.D.	0.032
Chromatogram Pattern:		--	--	Gasoline	Gasoline	--	--

Quality Control Data

Report Limit Multiplication Factor:	1.0	1.0	1.0	1.0	1.0	1.0
Date Analyzed:	9/7/93	9/7/93	9/7/93	9/7/93	9/8/93	9/7/93
Instrument Identification:	HP-2	HP-5	HP-5	HP-5	HP-4	HP-5
Surrogate Recovery, %: (QC Limits = 70-130%)	102	101	109	99	98	98

Purgeable Hydrocarbons are quantitated against a fresh gasoline standard.
Analytes reported as N.D. were not detected above the stated reporting limit.

SEQUOIA ANALYTICAL

Alan B. Kemp
Alan B. Kemp
Project Manager



SEQUOIA ANALYTICAL

1900 Bates Avenue • Suite LM • Concord, California 94520
(510) 686-9600 • FAX (510) 686-9689

Kapreallan Engineering, Inc. 2401 Stanwell Dr., Ste. 400 Concord, CA 94520 Attention: Avo Avedassian	Client Project ID: Unocal #6419, 6401 Dublin Blvd., Dublin Sample Matrix: Soil Analysis Method: EPA 5030/8015/8020 First Sample #: 309-0261	Sampled: Sep 7, 1993 Received: Sep 7, 1993 Reported: Sep 9, 1993
---	--	--

TOTAL PURGEABLE PETROLEUM HYDROCARBONS with BTEX DISTINCTION

Analyte	Reporting Limit mg/kg	Sample I.D. 309-0261 P7	Sample I.D. Matrix Blank
Purgeable Hydrocarbons	1.0	2.4	
Benzene	0.005	N.D.	
Toluene	0.005	0.011	
Ethyl Benzene	0.005	0.048	
Total Xylenes	0.005	0.032	

Chromatogram Pattern: Gasoline

Quality Control Data

Report Limit Multiplication Factor:	1.0	1.0
Date Analyzed:	9/7/93	9/7/93
Instrument Identification:	HP-5	HP-5
Surrogate Recovery, %: (QC Limits = 70-130%)	106	104

Purgeable Hydrocarbons are quantitated against a fresh gasoline standard.
Analytes reported as N.D. were not detected above the stated reporting limit.

SEQUOIA ANALYTICAL

Alan B. Kemp
for Alan B. Kemp
Project Manager



SEQUOIA ANALYTICAL

1900 Bates Avenue • Suite LM • Concord, California 94520
(510) 888-8600 • FAX (510) 888-9689

Kaprealian Engineering, Inc.
2401 Starwell Dr., Ste. 400
Concord, CA 94520
Attention: Avo Avedessian

Client Project ID: Unocal #6419, 6401 Dublin Blvd., Dublin
Sample Descript: Soil
Analysis for: Lead
First Sample #: 309-0255

Sampled: Sep 7, 1993
Received: Sep 7, 1993
Extracted: Sep 8, 1993
Analyzed: Sep 9, 1993
Reported: Sep 9, 1993

LABORATORY ANALYSIS FOR: Lead

Sample Number	Sample Description	Detection Limit mg/kg	Sample Result mg/kg
309-0255	P1	0.25	6.4
309-0256	P2	0.25	5.0
309-0257	P3	0.25	4.9
309-0258	P4	0.25	6.8
309-0259	P5	0.25	8.3
309-0260	P6	0.25	17
309-0261	P7	0.25	6.1

Analytes reported as N.D. were not present above the stated limit of detection.

SEQUOIA ANALYTICAL

Alan B. Kemp
Project Manager



SEQUOIA ANALYTICAL

1900 Bates Avenue • Suite LM • Concord, California 94520
(510) 686-9600 • FAX (510) 686-9689

Kaprelian Engineering, Inc. 2401 Stanwell Dr., Ste. 400 Concord, CA 94520 Attention: Avo Avedessian	Client Project ID: Unocal #6419, 6401 Dublin Blvd., Dublin Matrix: Soil QC Sample Group: 3090255-261	Reported: Sep 9, 1993
--	--	-----------------------

QUALITY CONTROL DATA REPORT

ANALYTE	Ethyl-				
	Benzene	Toluene	Benzene	Xylenes	Lead
Method:	EPA 8020	EPA 8020	EPA 8020	EPA 8020	EPA 7421
Analyst:	J.F.	J.F.	J.F.	J.F.	K.V.S.
Conc. Spiked:	0.40	0.40	0.40	1.2	50
Units:	mg/Kg	mg/Kg	mg/Kg	mg/Kg	mg/Kg
LCS Batch#:	1LCS090793	1LCS090793	1LCS090793	1LCS090793	BLK090893
Date Prepared:	9/7/93	9/7/93	9/7/93	9/7/93	9/8/93
Date Analyzed:	9/7/93	9/7/93	9/7/93	9/7/93	9/8/93
Instrument I.D.#:	HP-2	HP-2	HP-2	HP-2	SpectrAA-400
LCS % Recovery:	99	99	97	100	92
Control Limits:	70-130	70-130	70-130	70-130	75-125

MS/MSD	Batch #:				
Batch #:	3090248	3090248	3090248	3090248	3090261
Date Prepared:	9/7/93	9/7/93	9/7/93	9/7/93	9/8/93
Date Analyzed:	9/7/93	9/7/93	9/7/93	9/7/93	9/8/93
Instrument I.D.#:	HP-2	HP-2	HP-2	HP-2	SpectrAA-400
Matrix Spike % Recovery:	100	100	100	102	92
Matrix Spike Duplicate % Recovery:	97	97	97	99	94
Relative % Difference:	3.0	3.0	3.0	2.9	2.2

SEQUOIA ANALYTICAL

Alan B. Kemp
Project Manager

Please Note:
The LCS is a control sample of known, interferent free matrix that is analyzed using the same reagents, preparation and analytical methods employed for the samples. The LCS % recovery data is used for validation of sample batch results. Due to matrix effects, the QC limits for MS/MSD's are advisory only and are not used to accept or reject batch results.

CHAIN OF CUSTODY

SAMPLER		SITE NAME & ADDRESS							ANALYSES REQUESTED					TURN AROUND TIME:			
Haig		Unocal # 6419 - Dublin 6401 Dublin Blvd							PH-G	BTXE	Total Lead				24 Hrs		
WITNESSING AGENCY		SAMPLE ID NO.	DATE	TIME	SOIL	WATER	GRAB	COMP	NO. OF CONT.	SAMPLING LOCATION						REMARKS	
		P1	9/1/93		✓		✓		1	Product Pipe Trench	✓	✓	✓				3090255
		P2			✓		✓		1		✓	✓	✓				0256
		P3			✓		✓		1		✓	✓	✓				0257
		P4			✓		✓		1		✓	✓	✓				0258
		P5			✓		✓		1		✓	✓	✓				0259
		P6			✓		✓		1		✓	✓	✓				0260
		P7			✓		✓		1		✓	✓	✓				0261

Relinquished by: (Signature)	Date/Time	Received by: (Signature)
<i>[Signature]</i>	9/1/93 1850	<i>[Signature]</i>
Relinquished by: (Signature)	Date/Time	Received by: (Signature)
Relinquished by: (Signature)	Date/Time	Received by: (Signature)
Relinquished by: (Signature)	Date/Time	Received by: (Signature)

The following MUST BE completed by the laboratory accepting samples for analysis:		
1. Have all samples received for analysis been stored in ice?	<i>yes</i>	
2. Will samples remain refrigerated until analyzed?	<i>yes</i>	
3. Did any samples received for analysis have head space?	<i>no</i>	
4. Were samples in appropriate containers and properly packaged?	<i>yes</i>	
<i>[Signature]</i>	<i>analyst</i>	9/2/93
Signature	Title	Date



SEQUOIA ANALYTICAL

1900 Bates Avenue • Suite LM • Concord, California 94520
(510) 686-9600 • FAX (510) 686-9689

Kapreallan Engineering, Inc. 2401 Stanwell Dr., Ste. 400 Concord, CA 94520 Attention: Avo Avedessian	Client Project ID: Unocal #6419, 8401 Dublin Blvd., Dublin Sample Matrix: Soil Analysis Method: EPA 5030/8015/8020 First Sample #: 309-0247	Sampled: Sep 7, 1993 Received: Sep 7, 1993 Reported: Sep 9, 1993
---	--	--

TOTAL PURGEABLE PETROLEUM HYDROCARBONS with BTEX DISTINCTION

Analyte	Reporting Limit mg/kg	Sample I.D. 309-0247 D1	Sample I.D. 309-0248 D2	Sample I.D. 309-0249 D3	Sample I.D. 309-0250 D4	Sample I.D. 309-0251 D5	Sample I.D. 309-0252 D6
Purgeable Hydrocarbons	1.0	N.D.	N.D.	N.D.	N.D.	N.D.	N.D.
Benzene	0.005	N.D.	N.D.	N.D.	N.D.	N.D.	N.D.
Toluene	0.005	N.D.	N.D.	N.D.	N.D.	N.D.	N.D.
Ethyl Benzene	0.005	N.D.	N.D.	N.D.	N.D.	N.D.	N.D.
Total Xylenes	0.005	N.D.	N.D.	N.D.	N.D.	N.D.	N.D.
Chromatogram Pattern:		--	--	--	--	--	--

Quality Control Data

Report Limit Multiplication Factor:	1.0	1.0	1.0	1.0	1.0	1.0
Date Analyzed:	9/8/93	9/7/93	9/8/93	9/8/93	9/8/93	9/8/93
Instrument Identification:	ML #2	HP-4	ML #2	ML #2	ML #2	ML #2
Surrogate Recovery, %: (QC Limits = 70-130%)	95	90	94	97	102	87

Purgeable Hydrocarbons are quantitated against a fresh gasoline standard.
Analytes reported as N.D. were not detected above the stated reporting limit.

SEQUOIA ANALYTICAL

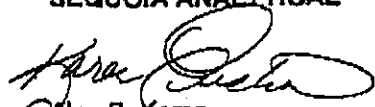
Alan B. Kamp
Project Manager



SEQUOIA ANALYTICAL

1900 Bates Avenue • Suite LM • Concord, California 94520
(510) 686-9600 • FAX (510) 686-9689

Kapreallan Engineering, Inc.
2401 Starwell Dr., Ste. 400
Concord, CA 94520
Attention: Avo Avedessian

Client Project ID: Unocal #8419, 6401 Dublin Blvd., Dublin
Sample Matrix: Soil
Analysis Method: EPA 5030/8015/8020
First Sample #: 309-0253

Sampled: Sep 7, 1993
Received: Sep 7, 1993
Reported: Sep 8, 1993

TOTAL PURGEABLE PETROLEUM HYDROCARBONS with BTEX DISTINCTION

Analyte	Reporting Limit mg/kg	Sample I.D. 309-0253 D7	Sample I.D. 309-0254 D8	Sample I.D. Matrix Blank
Purgeable Hydrocarbons	1.0	N.D.	N.D.	
Benzene	0.005	N.D.	N.D.	
Toluene	0.005	N.D.	N.D.	
Ethyl Benzene	0.005	N.D.	N.D.	
Total Xylenes	0.005	N.D.	0.030	
Chromatogram Pattern:		--	--	

Quality Control Data

Report Limit Multiplication Factor:	1.0	1.0	1.0
Date Analyzed:	9/8/93	9/8/93	9/8/93
Instrument Identification:	ML #2	ML #2	ML #2
Surrogate Recovery, %: (QC Limits = 70-130%)	87	84	116

Purgeable Hydrocarbons are quantitated against a fresh gasoline standard.
Analytes reported as N.D. were not detected above the stated reporting limit.

SEQUOIA ANALYTICAL

Alan B. Kemp
Project Manager



SEQUOIA ANALYTICAL

1900 Bates Avenue • Suite LM • Concord, California 94520
(510) 886-9600 • FAX (510) 886-9689

Kapreallan Engineering, Inc.
2401 Stanwell Dr., Ste. 400
Concord, CA 94520
Attention: Avo Avedessian

Client Project ID: Unocal #5416, 8401 Dublin Blvd., Dublin
Sample Descript: Soil
Analysis for: Lead
First Sample #: 309-0247

Sampled: Sep 7, 1993
Received: Sep 7, 1993
Extracted: Sep 8, 1993
Analyzed: Sep 8, 1993
Reported: Sep 9, 1993

LABORATORY ANALYSIS FOR: Lead

Sample Number	Sample Description	Detection Limit mg/kg	Sample Result mg/kg
309-0247	D1	0.25	14
309-0248	D2	0.25	6.4
309-0249	D3	0.25	6.2
309-0250	D4	0.25	6.2
309-0251	D6	0.25	6.3
309-0252	D6	0.25	9.8
309-0253	D7	0.25	6.1
309-0254	D8	0.25	4.8

Analytes reported as N.D. were not present above the stated limit of detection.

SEQUOIA ANALYTICAL

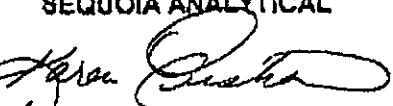
Alan B. Kemp
Project Manager

3090247.KEI <3>



SEQUOIA ANALYTICAL

1900 Bates Avenue • Suite LM • Concord, California 94520
(510) 686-9600 • FAX (510) 686-9689

Kapreallan Engineering, Inc.
2401 Stanwell Dr., Ste. 400
Concord, CA 94520
Attention: Avo Avedessian

Client Project ID: Unocal #6419, 6401 Dublin Blvd., Dublin
Matrix: Soil

QC Sample Group: 3090247-254

Reported: Sep 9, 1993

QUALITY CONTROL DATA REPORT

ANALYTE	Benzene	Toluene	Ethyl-Benzene	Xylenes	Lead
Method:	EPA 8020	EPA 8020	EPA 8020	EPA 8020	EPA 7421
Analyst:	J.Dinsay	J.Dinsay	J.Dinsay	J.Dinsay	K.V.S.
Conc. Spiked:	0.20	0.20	0.20	0.60	50
Units:	mg/Kg	mg/Kg	mg/Kg	mg/Kg	mg/Kg
LCS Batch#:	GBLK090893	GBLK090893	GBLK090893	GBLK090893	BLK090893
Date Prepared:	9/8/93	9/8/93	9/8/93	9/8/93	9/8/93
Date Analyzed:	9/8/93	9/8/93	9/8/93	9/8/93	9/9/93
Instrument I.D.#:	ML #2	ML #2	ML #2	ML #2	SpectrAA-400
LCS % Recovery:	78	87	86	87	92
Control Limits:	80-120	80-120	80-120	80-120	75-125

MS/MSD	Batch #:	GBLK090893	GBLK090893	GBLK090893	GBLK090893	3090261
Date Prepared:		9/8/93	9/8/93	9/8/93	9/8/93	9/8/93
Date Analyzed:		9/8/93	9/8/93	9/8/93	9/8/93	9/9/93
Instrument I.D.#:		ML #2	ML #2	ML #2	ML #2	SpectrAA-400
Matrix Spike % Recovery:		75	83	85	85	92
Matrix Spike Duplicate % Recovery:		76	88	83	83	94
Relative % Difference:		1.3	27	2.4	2.4	2.2

SEQUOIA ANALYTICAL

Alan B. Kemp
Project Manager

Please Note:

The LCS is a control sample of known, interferent free matrix that is analyzed using the same reagents, preparation and analytical methods employed for the samples. The LCS % recovery data is used for validation of sample batch results. Due to matrix effects, the QC limits for MS/MSD's are advisory only and are not used to accept or reject batch results.

CHAIN OF CUSTODY

SAMPLER		SITE NAME & ADDRESS							ANALYSES REQUESTED						TURN AROUND TIME:	
Haig		Unocal # 6419 - Dublin 6401 Dublin Blvd							TPH-G	BTXE	Total Lead					24 Hrs
WITNESSING AGENCY		SAMPLE ID NO.	DATE	TIME	SOIL	WATER	GRAB	COMP	NO. OF CONT.	SAMPLING LOCATION						REMARKS
		D1	3/1/93		✓		✓		1	Beneath Dispenser	✓	✓	✓			3090247
		D2			✓		✓		1		✓	✓	✓			0248
		D3			✓		✓		1		✓	✓	✓			0249
		D4			✓		✓		1		✓	✓	✓			0250
		D5			✓		✓		1		✓	✓	✓			0251
		D6			✓		✓		1		✓	✓	✓			0252
		D7			✓		✓		1		✓	✓	✓			0253
		D8			✓		✓		1		✓	✓	✓			0254

Relinquished by: (Signature)	Date/Time	Received by: (Signature)	The following MUST BE completed by the laboratory accepting samples for analysis: 1. Have all samples received for analysis been stored in ice? 2. Will samples remain refrigerated until analyzed? 3. Did any samples received for analysis have head space? 4. Were samples in appropriate containers and properly packaged?
Relinquished by: (Signature)	Date/Time	Received by: (Signature)	
Relinquished by: (Signature)	Date/Time	Received by: (Signature)	
Relinquished by: (Signature)	Date/Time	Received by: (Signature)	

Signature: *[Signature]* Date: 3/1/93
 Signature: *[Signature]* Date: 3/1/93
 Signature: *[Signature]* Date: 3/1/93
 Signature: *[Signature]* Date: 3/1/93

Signature: *[Signature]* Title: *[Title]* Date: 3/1/93



SEQUOIA ANALYTICAL

1900 Bates Avenue • Suite LM • Concord, California 94520
(510) 886-9600 • FAX (510) 886-9689

Kaprealian Engineering, Inc. 2401 Starwell Dr., Ste. 400 Concord, CA 94520 Attention: Avo Avedessian	Client Project ID: Unocal #6418, 6401 Dublin Blvd., Dublin Sample Matrix: Soil Analysis Method: EPA 5030/8015/8020 First Sample #: 309-0302	Sampled: Sep 8, 1993 Received: Sep 8, 1993 Reported: Sep 9, 1993
---	--	--

TOTAL PURGEABLE PETROLEUM HYDROCARBONS with BTEX DISTINCTION

Analyte	Reporting Limit mg/kg	Sample I.D. 309-0302 B1	Sample I.D. 309-0303 B2	Sample I.D. 309-0304 SW1	Sample I.D. 309-0305 SW2	Sample I.D. 309-0306 SW3	Sample I.D. 309-0307 SW4
Purgeable Hydrocarbons	1.0	N.D.	1.2	N.D.	N.D.	N.D.	2.6
Benzene	0.005	0.0071	0.017	N.D.	0.0054	0.0050	0.11
Toluene	0.005	0.014	0.010	0.013	0.011	0.011	0.28
Ethyl Benzene	0.005	0.0072	0.13	N.D.	N.D.	0.0085	0.067
Total Xylenes	0.005	0.026	0.017	0.019	0.012	0.013	0.34
Chromatogram Pattern:		--	Gasoline	--	--	--	Gasoline

Quality Control Data

Report Limit Multiplication Factor:	1.0	1.0	1.0	1.0	1.0	1.0
Date Analyzed:	9/8/93	9/8/93	9/8/93	9/8/93	9/8/93	9/8/93
Instrument Identification:	HP-5	HP-5	HP-5	HP-5	HP-5	HP-5
Surrogate Recovery, %: (QC Limits = 70-130%)	99	96	107	99	96	97

Purgeable Hydrocarbons are quantitated against a fresh gasoline standard.
Analytes reported as N.D. were not detected above the stated reporting limit.

SEQUOIA ANALYTICAL

Alan B. Kemp
Project Manager



SEQUOIA ANALYTICAL

1900 Bates Avenue • Suite LM • Concord, California 94520
(510) 686-9600 • FAX (510) 686-9689

Kaprelian Engineering, Inc. 2401 Stanwell Dr., Ste. 400 Concord, CA 94520 Attention: Avo Avedessian	Client Project ID: Unocal #6418, 6401 Dublin Blvd., Dublin Sample Matrix: Soil Analysis Method: EPA 5030/8015/8020 First Sample #: 309-0308	Sampled: Sep 8, 1993 Received: Sep 8, 1993 Reported: Sep 9, 1993
--	--	--

TOTAL PURGEABLE PETROLEUM HYDROCARBONS with BTEX DISTINCTION

Analyte	Reporting Limit mg/kg	Sample I.D. 309-0308 SW5	Sample I.D. Matrix Blank
Purgeable Hydrocarbons	1.0	N.D.	N.D.
Benzene	0.005	0.0084	N.D.
Toluene	0.005	0.011	N.D.
Ethyl Benzene	0.005	N.D.	N.D.
Total Xylenes	0.005	0.021	N.D.

Chromatogram Pattern: -- --

Quality Control Data

Report Limit Multiplication Factor:	1.0	1.0
Date Analyzed:	9/8/93	9/8/93
Instrument Identification:	HP-5	HP-5
Surrogate Recovery, %: (QC Limits = 70-130%)	106	109

Purgeable Hydrocarbons are quantitated against a fresh gasoline standard.
Analytes reported as N.D. were not detected above the stated reporting limit.

SEQUOIA ANALYTICAL

Alan B. Kemp
Project Manager

CHAIN OF CUSTODY

SAMPLER Haid		SITE NAME & ADDRESS Unocal # 6419 - Dublin 6401 Dublin Blvd						ANALYSES REQUESTED TPH-G BTXE Total Pb				TURN AROUND TIME: 24 Hrs	
WITNESSING AGENCY												REMARKS	
SAMPLE ID NO.	DATE	TIME	SOIL	WATER	GRAB	COMP	NO. OF CONT.	SAMPLING LOCATION	TPH-G	BTXE	Total Pb		
B1	9/8/93		✓		✓		1	Fuel Tank Pit	✓	✓	✓	3090302 ↓ 0303 0304 0305 0306 0307 ↓ 0308	
B2			✓		✓		1		✓	✓	✓		
SW1			✓		✓		1		✓	✓	✓		
SW2			✓		✓		1		✓	✓	✓		
SW3			✓		✓		1		✓	✓	✓		
SW4			✓		✓		1		✓	✓	✓		
SW5			✓		✓		1		✓	✓	✓		
Relinquished by: (Signature)	Date/Time		Received by: (Signature)						The following MUST BE completed by the laboratory accepting samples for analysis: 1. Have all samples received for analysis been stored in ice? <u>yes</u> 2. Will samples <u>yes</u> remain refrigerated until analyzed? 3. Did any samples <u>yes</u> received for analysis have head space? 4. Were samples in appropriate containers and properly packaged? <u>yes</u> Signature: <u>Melissa Crease</u> Title: <u>Sample Control</u> Date: <u>9/8/93</u>				
Relinquished by: (Signature)	Date/Time		Received by: (Signature)										
Relinquished by: (Signature)	Date/Time		Received by: (Signature)										
Relinquished by: (Signature)	Date/Time		Received by: (Signature)										

01000000097
 9-3-93 11:24
 01000000097
 01000000097

Wno # 6419 - 6401 Dublin Blvd

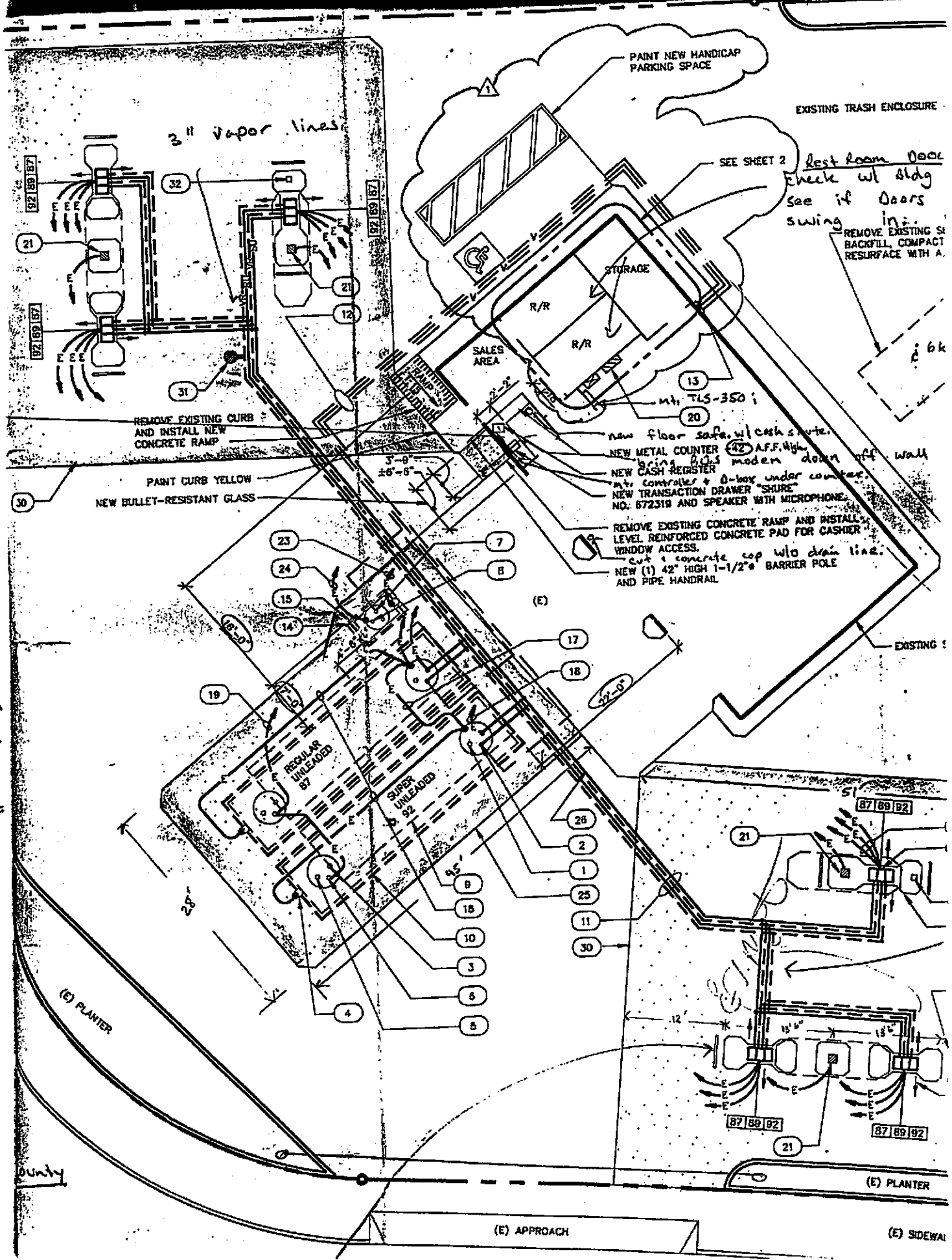

3" vapor lines

PAINT NEW HANDICAP PARKING SPACE

EXISTING TRASH ENCLOSURE

SEE SHEET 2 Rest Room Door
Check w/ Bldg
See if Doors
swing in.

REMOVE EXISTING SI
BACKFILL, COMPACT
RESURFACE WITH A.

STORAGE

SALES AREA

REMOVE EXISTING CURB
AND INSTALL NEW
CONCRETE RAMP

PAINT CURB YELLOW
NEW BULLET-RESISTANT GLASS

new floor safe w/ cash chute.

NEW METAL COUNTER 42" AFF. High

NEW CASH REGISTER

new controller & 0-box under counter.

NEW TRANSACTION DRAWER "SHURE"
NO. 672319 AND SPEAKER WITH MICROPHONE.

REMOVE EXISTING CONCRETE RAMP AND INSTALL
LEVEL REINFORCED CONCRETE PAD FOR CASHIER
WINDOW ACCESS.

cut & concrete cap w/lo drain line.
NEW (1) 42" HIGH 1-1/2" BARRIER POLE
AND PIPE HANDRAIL

EXISTING

REGULAR UNLEADED 87

SUPER UNLEADED 92

87 89 92

87 89 92

87 89 92

(E) PLANTER

(E) PLANTER

(E) APPROACH

(E) SIDEWALK

County