

Bruce W. Page Consulting

ENVIRONMENTAL CHEMICAL ENGINEERING

March 25, 2002

Mr. Scott Seery, CHMM
Hazardous Materials Specialist
Alameda County Health Care Services Agency
Department of Environmental Health
1131 Harbor Bay Parkway, 2nd Floor
Alameda, California 94502

MAR 28 2002

Subject: Additional Investigation Work – Former Glovatorium – Oakland, California

Dear Mr. Seery:

As you recall, during your visit to the Site on February 25, 2002, Cruz Brothers Locators of Scotts Valley attempted to trace a vent pipe that emerges from the concrete floor just South of the Geosolve boring E-25. Because that area of the Site is extremely crowded with metal equipment and piping, they could only trace the line to an elbow where it turned to the South. On February 28 and March 7, Cruz Brothers and SOMA Environmental Engineering (SOMA) personnel returned to the Site and completed the job of following that vent line. They used a concrete saw and a jackhammer to break through two layers of concrete flooring and expose the vent pipe. They then cut an opening in the pipe and inserted a camera. The vent pipe runs 16.5 feet south of the elbow and ends there. It is not connected to a tank. I will return to this vent pipe later in this letter.

Also during your February 25 visit to the Site we discussed the fact that there is a document entitled "The Glovatorium/ Equipment Schedule/ November 13, 1970" that appears as Exhibit 22 to Stuart Depper's deposition in the litigation concerning this site. That document is represented to be a list of the equipment included in the purchase of the facility by the Deppers. In the part of the list concerned with tanks, we find 5 Solvent Tanks (two 1,500 gallon, two 1,000 gallon and one 2,500 gallon) and 2 Fuel Tanks (one 5,000 gallon oil tank and one 3,500 gallon gas tank). Six of these tanks have been accounted for and closed with the approval of your agency. The 3,500 gallon "gas" tank has not been accounted for, and all three of the Depper brothers have said that they know nothing about an underground gasoline tank.

The historical soil data from the Site shows the wide-spread presence of Stoddard Solvent and diesel-range TPH in E-21 and E-22, but no clearly identified gasoline-range TPH, until SOMA-3 and SOMA-5 were installed last fall. SOMA-3 reportedly had TPH-g present at 2, 8, 10, 12, 14, 18, 20 and 22 feet below ground surface (bgs), with the highest concentrations between 8 and 14 feet bgs. Similarly, SOMA-5 reportedly had TPH-g present down to 22 feet bgs, with the highest concentrations between 8 and 18 feet bgs. Based on these facts, you expressed concern that there might be an underground tank between SOMA-5 and SOMA-3, in the area just West of SOMA-4.

I discussed the possibility of using a Geoprobe to explore that area for a tank with Dr. Sepehr of SOMA and he suggested that we use this opportunity to simultaneously delineate the extent of the floating product in the vicinity of SOMA-4 and B-8, the two locations with the highest level

of floating product so far observed at the Site. On March 22 I visited the Site with Dr. Naser Pakrou of SOMA and Stuart Depper to plan the Geoprobe work. Mr. Depper was also very helpful in showing us the location of equipment and piping and explaining events discussed in his deposition.

First, the vent pipe that emerges from the floor just South of E-25 that Cruz Brothers traced for 16.5 feet was part of the by-pass system on the pre-coat filter in the laundry room. That is why we didn't find a tank associated with that line.

The fact that Freidman & Bruya identified the Stoddard Solvent in well B-8 as older than the Stoddard Solvent in SOMA-4 was also explained by Mr. Depper. B-8 is just to the North of the laundry room. The large Washex machine that is along that wall in the laundry room was a "bad leaker". There are two rectangular sumps and several pipes emerging from the floor next to that machine, on its East side. Mr. Depper said that you could see solvent in the ground when that machine was operating. That system was installed in 1956. The Stoddard Solvent in B-8 is from that older Washex system. SOMA-4, on the other hand, is next to the underground tanks that were not closed until 1997.

On March 22, while we were at the Site, we agreed to the following additional investigation work.

- 4 • SOMA will supervise the installation of about 4 geoprobes in the area mostly to the West of SOMA-4. They will extend the probes to the water table, unless they encounter an obstruction, such as a tank.
- 2 • SOMA will supervise the installation of about 2 geoprobes in the corridor to the South of B-9. They will extend the probes to the water table, unless they encounter an obstruction, such as a tank.
- 2 • SOMA will supervise the installation of about 2 geoprobes in the vicinity of B-8. They will extend the probes to the water table, unless they encounter an obstruction. These probes are intended to provide information on the extent of the floating product near that location.
- 1 • SOMA will supervise the installation of a geoprobe just West of the Valore dry cleaning machine in the room just West of E-15. That machine used perchloroethylene from 1988 until it was discontinued in the early- to mid-1990s. The purpose of this probe will be to obtain a grab ground water sample to be analyzed for VOCs.
- 1 • SOMA will supervise the installation of a geoprobe just West of the Bowe dry cleaning machine which is located just Southwest of B-10. That machine also used perchloroethylene. The purpose of this probe will be to obtain a grab ground water sample to be analyzed for VOCs.
- SOMA will schedule Cruz Brothers to return to the Site to check for underground utilities before installing the proposed geoprobes. While they are on-site, SOMA will have them

Bruce W. Page Consulting

ENVIRONMENTAL CHEMICAL ENGINEERING

do a magnetometer survey. A particular area of interest is the parking lot just North of the Site.

The attached figure shows the approximate locations of the geoprobes discussed above. The Geoprobe work is scheduled for March 28 and March 29.

If you have any questions on this additional investigation work at the Site, please call either Dr. Sepehr or Dr. Pakrou at SOMA, since I will be out of town from March 27 until April 2.

Sincerely,

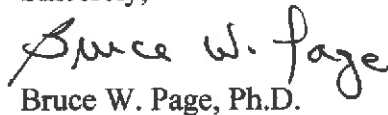
Bruce W. Page, Ph.D.

cc: Albert M. Cohen, Esq., Smiland & Khachigian
Ms. Betty Graham, RWQCB
Dr. Mansour Sepehr, SOMA Environmental Engineering
Mr. Stuart Depper, Clean Tech Equipment

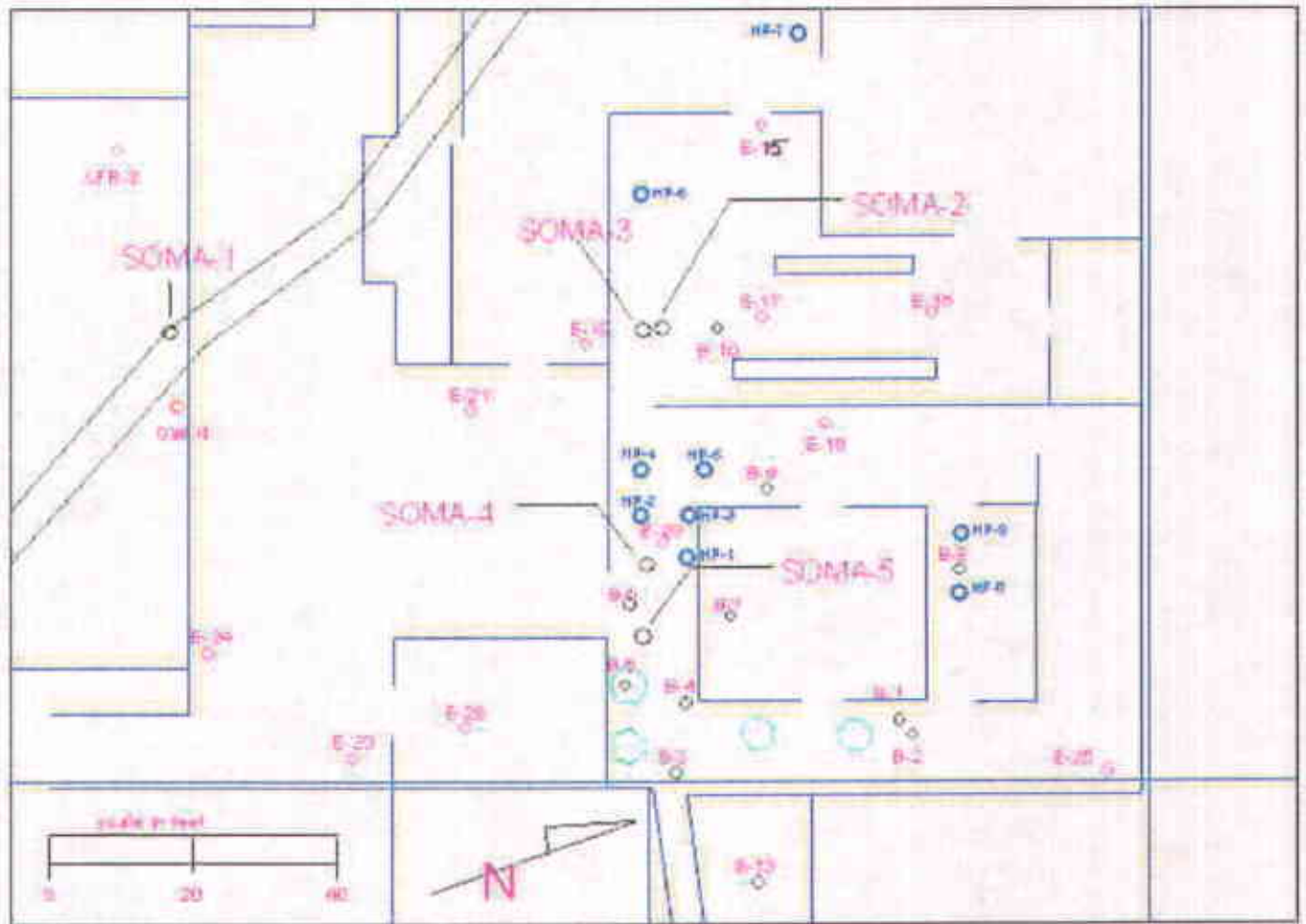

Figure 1 Location of Proposed Borings