

**Virgil Chavez Land Surveying**  
312 Georgia Street  
Vallejo, California 94590  
(707) 553-2476

April 17, 1997  
Project No. 1420-05

Frank Goldman  
Geosolv, Inc.  
643 Oregon Street  
Sonoma, Ca. 94576

Subject: Underground Tank Survey  
3815 Broadway  
Oakland, Ca.

Dear Frank:

This is to confirm that we have proceeded at your request with the tank survey at the above referenced site. The survey was performed on April 14, 1997. Measurements were taken as per your directions. Elevations are shown in the table below. The benchmark for the survey was a USGS bronze disk located near the north end of the curb return at the northwest corner of 38th Street and Broadway.  
Benchmark Elev. = 85.41' USGS Datum (NAVD 29).

<u>STATION No.</u>	<u>RIM Elevation</u>
Tank - 1	81.82'
Tank - 2	82.39'
Tank - 3	82.63'
Tank - 4	82.08'
Tank - 5	81.94'
Tank - 5A	81.49'
Tank - 6	81.85'

Sincerely,



*Virgil D. Chavez*  
Virgil D. Chavez, PLS 5323

BROADWAY

# 3815  
BROADWAY

# 320  
38th Street

38th St.

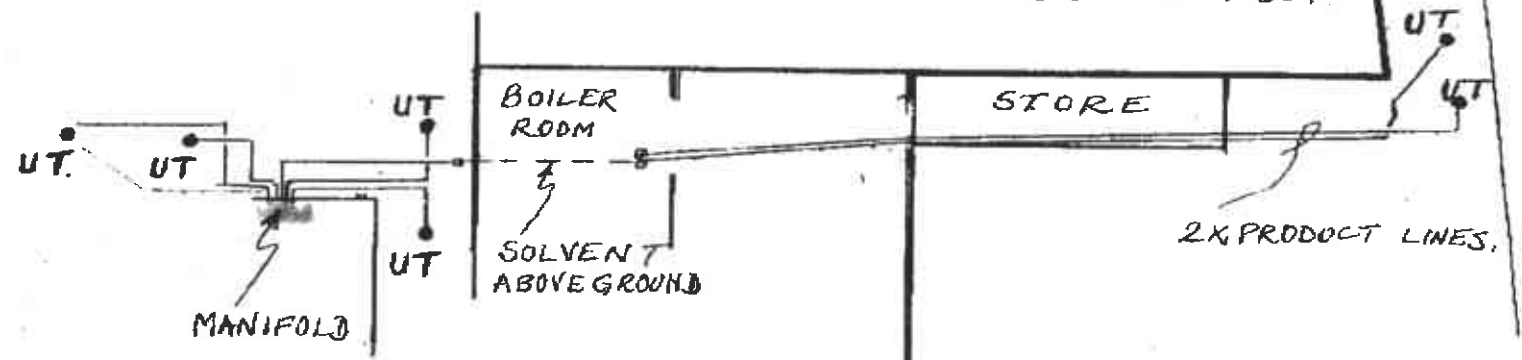

U.T. = U'GROUND TANK  
 — = U'GROUND PIPE  
 - - - = ABOVE GROUND PIPE



UNDERGROUND PIPING FROM U.S.T.'S  
 AT 3815 BROADWAY, OAKLAND, CA.

SCALE: N/A.	APPROVED BY:	DRAWN BY JI.
DATE: 4-21-97		REVISED

CLIENT : GEO SOLVE, SONOMA, CA.

LOCATED BY: SUBTRONIC CORP. CA.	DRAWING NUMBER SK 01
---------------------------------	-------------------------

ENVIRONMENTAL  
PROTECTION  
97 APR 29 PM 4:45

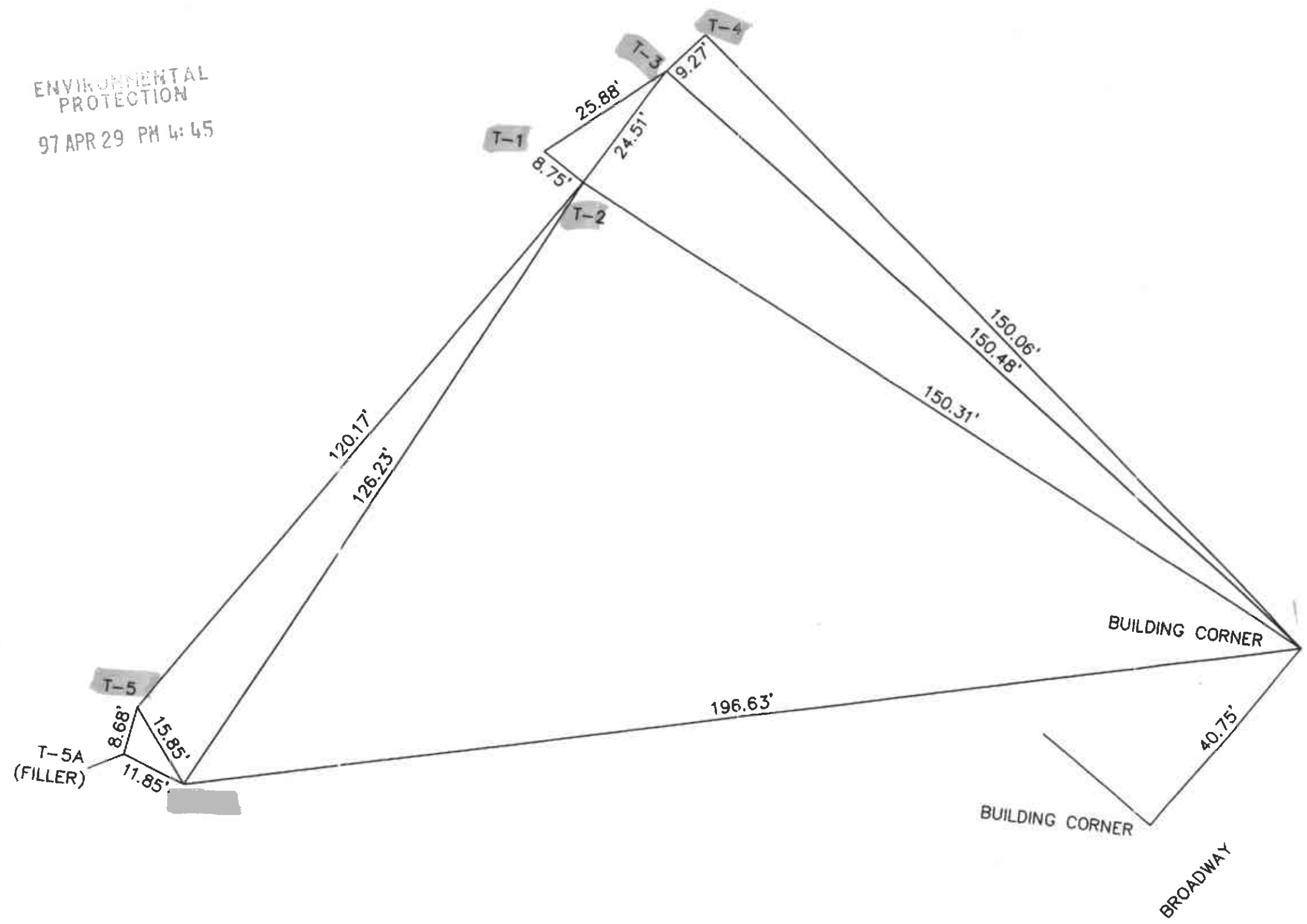

Sidewalk

38TH STREET

dilled 4 boris  
installed 1 casing - no casing expected  
taken to 15' bgs. for other 3'  
no water yet



dilled slotted casing in place

dilled

dilled

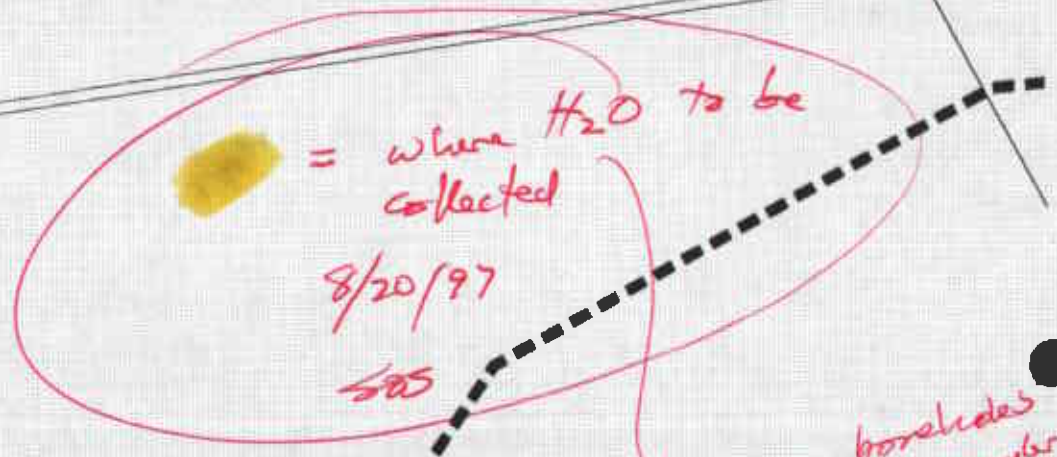

8/20/97

SS

These are same boreholes  
in which the 1" OD. sampler  
was to be advanced minus  
the 2.5" OD outer casing

(?) location of boris

MANILA STREET

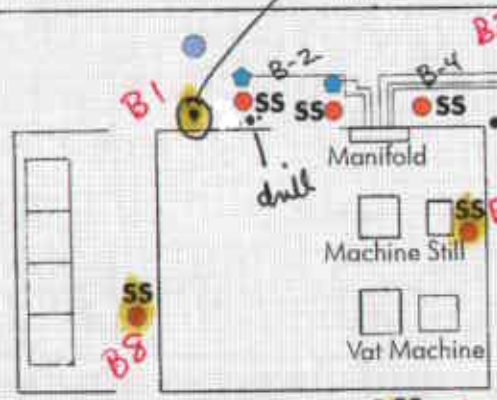

Approximate Scale  
1 Inch = 20 Feet

BROADWAY

BUILDING FRONT

Concrete Walkway

38TH STREET



### LEGEND

UNDERGROUND PIPE	———
ABOVEGROUND PIPE	.....
TANK (UST)	●
STORM DRAIN	.....
PROPERTY LINE	▬▬▬▬
MANIFOLD	▭
2-1 PIPE JUNCTION	⬢

Note: The UST locations were located by Virgil Chavez Land Surveying of Vallejo and the pipe locating was performed by Subtronic Corporation. The pipe locating was based on the certified land survey and field tape measurements. The orientation of the stormdrain is correct; however, the location will have to be re-verified in the field. The property line along 38th Street will also have to be reconfirmed in the field. UST location T-5 may actually be the fill port for that tank instead of the the UST riser. Each UST location is based on the location of its associated riser pipe.

0 10' 20'

Approximate Scale  
1 Inch = 20 Feet

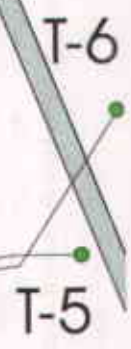
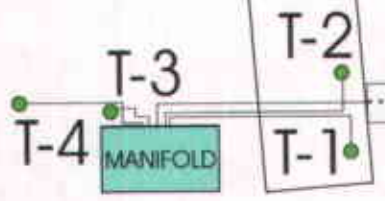

**GeoSolv, LLC**  
643 Oregon Street, Sonoma, California 95476

**Map of Existing  
Underground Storage Tanks**  
Digger/Finder (Subtronic)  
3813 Broadway  
Oakland, California  
April 28, 1997

**FIGURE 2**