



RECEIVED

8:56 am, Mar 11, 2010

Alameda County
Environmental Health

ARCADIS
2033 North Main Street
Suite 340
Walnut Creek, California
94596
Tel 925.274.1100
Fax 925.274.1103
www.arcadis-us.com

Mr. Paresh C. Khatri
Environmental Health Services- Environmental Protection
1131 Harbor Bay Parkway Suite 250
Alameda, California 94502-6577

Subject:

Rider to the Addendum to Soil and Groundwater Investigation Work Plan
Former BP Service Station No. 11102
100 MacArthur Boulevard
Oakland, California
ACEH Case #RO0000456

ENVIRONMENT

Dear Mr. Khatri:

Date:
March 9, 2010

ARCADIS has prepared this rider to the *Addendum to Soil and Groundwater Investigation Work Plan* submitted by Broadbent and Associates, Inc. (BAI) dated June 1, 2009 for the former BP Service Station No. 11102 located at 100 MacArthur Boulevard in Oakland, California (site). The original work plan was submitted on April 9, 2009 and proposed the following would be completed:

Contact:
Hollis Phillips

Phone:
415.374.2744 ext.13

- Three soil borings advanced to 30 feet below ground surface
- Collect soil samples for analysis from each of the three soil borings at 5-foot intervals starting at 6.5 feet below ground surface until groundwater is encountered
- Construct three 2-inch diameter wells in the soil borings with Schedule 40 poly-vinyl chloride (PVC) with 0.010-inch machine-cut slot screen from 10 to 30 feet below ground surface
- Develop wells at least 48 hours after completion
- Collect groundwater samples for analysis after well development
- Prepare a Soil and Groundwater Investigation Report with the field and laboratory results of the proposed work

Email:
Hollis.Phillips@
arcadis-us.com

Our ref #:
GP09BPNA.C111.

An addendum was requested by Alameda County Environmental Health Department (ACEH) in a letter dated April 24, 2009 citing the proposed twenty feet of screen in the well design to be excessive, and requested additional maps and table modifications to the information submitted in the original work plan. On June 1, 2009, BAI submitted the Addendum to Soil and Groundwater Investigation Work Plan. The addendum to the work plan was approved by ACEH in a letter dated August 21, 2009. ARCADIS will implement the Work Plan with changes outlined in this rider and per the request of California Department of Transportation (Caltrans).

The approved work plan initially proposed installing a monitoring well (MW-6) on the edge of the on-ramp to Interstate 580 east bound. ARCADIS believes that the location of the proposed MW-6 groundwater monitoring well is beyond the limits of the plume and are proposing to advance a soil boring and collect a grab groundwater sample (SB-9) at that location as an alternative. Soil samples will be collected at the SB-9 location as described in the approved work plan. Based on the sample results, ARCADIS will review the need for any additional characterization in this area.

The locations for proposed monitoring wells MW-4 and MW-5 were moved out of the planted area by Interstate 580 per Caltrans' request due to safety concerns. The soil borings and associated wells will be installed in the approximate location depicted on the attached Figure 1. All other activities will be conducted in accordance with the approved Work Plan.

ARCADIS has obtained an encroachment permit from the California Department of Transportation (Caltrans) for work that will be performed at the site and is currently working with the City of Oakland's Building Services Department and Traffic Department to obtain the necessary permits. After the City of Oakland permitting is complete, ARCADIS will submit drilling permit applications to the Alameda County Environmental Health Department.

If you have any questions or comments regarding the content of this letter, please feel free to contact me by telephone at 415.374.2744, ext.13 or by e-mail at Hollis.Phillips@arcadis-us.com.

Sincerely,

ARCADIS



Hollis E. Phillips, RG
Project Manager

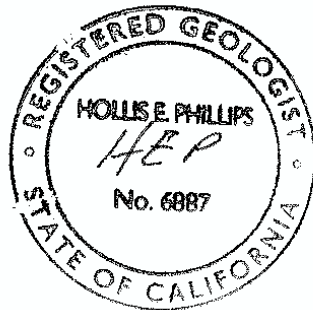



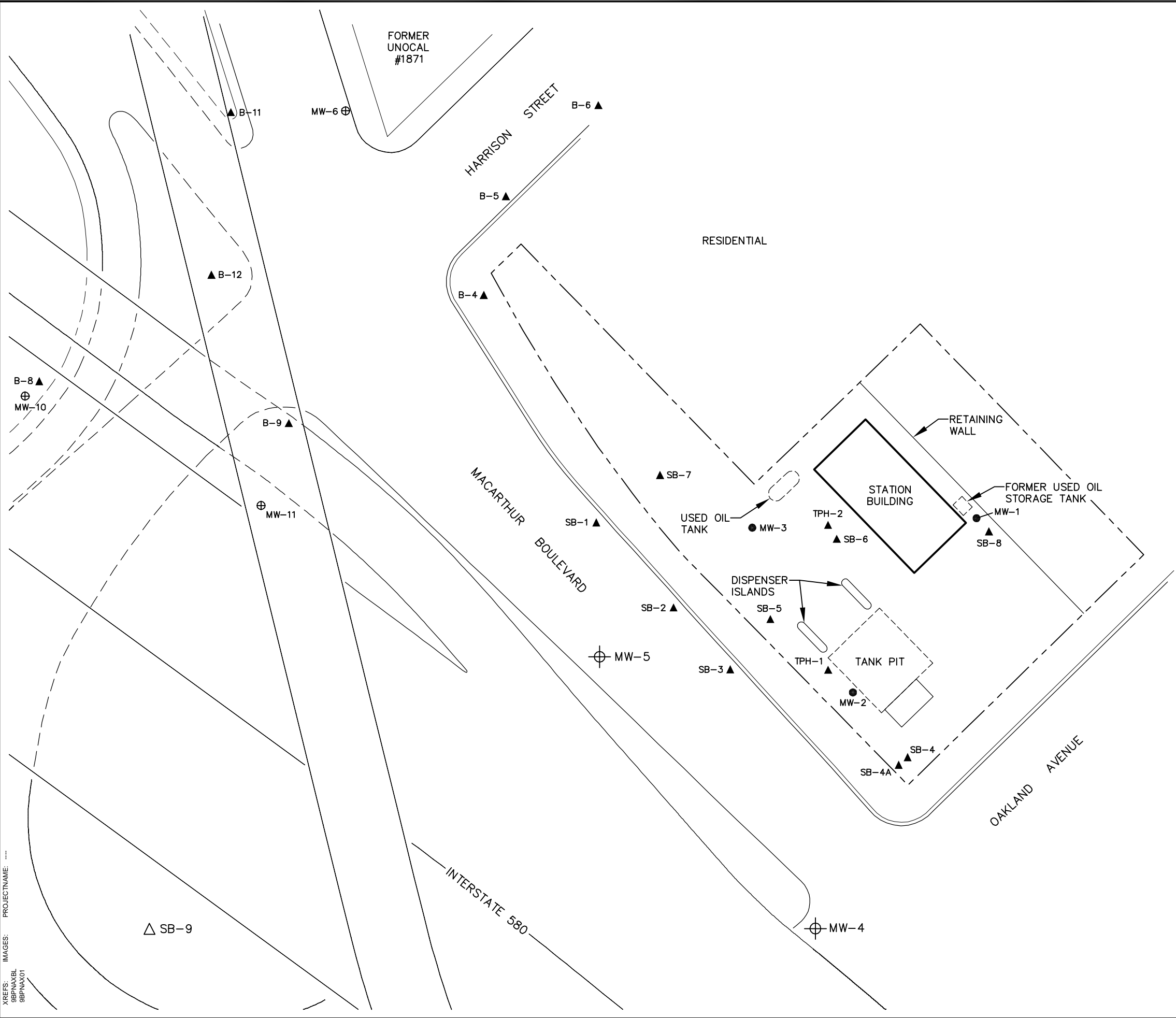

cc: Cal Trans District 4 Office, 111 Grand Avenue, Oakland, CA 94623

Attachments: Figure 1- Site Map

CITY:SYRACUSE, N.Y. DIV:GROUP:ENV:CAD-141 DBR:ALLEN, LD:OPR PIC:OPR PMP:HOLLIS, TM:CMAYER LVR:OPR:OFF-REF-
 G:\ENV\CAD\SYRACUSE\ACT\GP\BP\NA\C111\02000\DWG\BP\NA\B01.dwg LAYOUT: 1_SAVED: 1/14/2010 8:15 AM ACADVER: 17.05 (LMS TECH) PAGES: 17
 XREFS: 99BPNA\BL 99BPNA\OT
 IMAGES: PROJECTNAME: ---
 PLOTSTYLETABLE: PLT\FULLCTB PLOTTED: 1/14/2010 8:15 AM BY: ALLEN, ROYCE





LEGEND:

-  PROPOSED MONITORING WELL LOCATION
-  PROPOSED GRAB GROUNDWATER LOCATION
-  BP MONITORING WELL LOCATION
-  UNOCAL MONITORING WELL LOCATION
-  FORMER SOIL BORING LOCATION

NOTES:

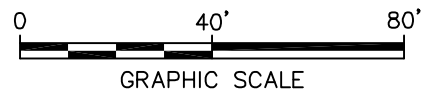
1. BASE MAP PREPARED BY DIGITIZING A HARD COPY OF A DRAWING BY "BROADBENT AND ASSOCIATES, INC.", TITLED "SITE LAYOUT PLAN WITH PROPOSED SOIL BORING AND WELL LOCATIONS", DATED 3/9/09, AT A SCALE OF 1"=40'.
2. ALL LOCATIONS ARE APPROXIMATE.



FORMER STATION # 11102 100 MACARTHUR BOULEVARD OAKLAND, CALIFORNIA	
SITE MAP	
	FIGURE 1