

ENVIRONMENTAL CONSULTING & MANAGEMENT  
**ROUX ASSOCIATES**



1855 GATEWAY BOULEVARD  
SUITE 770  
CONCORD, CALIFORNIA 94520 510 602-2333 FAX # 510 687-1258

**RECEIVED**

1:16 pm, Apr 13, 2009

Alameda County  
Environmental Health

September 3, 1992

Mr. Dave Hoover  
Manager, Retail Business Unit  
2000 Crow Canyon Place, Suite 400  
P.O. Box 5155  
San Ramon, California 94583

FILE #	1871	SS	<input checked="" type="checkbox"/>	BP		
RPT		QM		TRANSMITTAL		
1	2	3	4	<input checked="" type="checkbox"/>	5	6

**SUBJECT: UPCOMING SITE ENVIRONMENTAL ACTIVITIES  
UNOCAL SERVICE STATION NO. 1871  
96 MACARTHUR BOULEVARD, OAKLAND, CALIFORNIA**

Dear Mr. Hoover:

Roux Associates has been retained by UNOCAL to install and sample three ground water monitoring wells at the subject Site. The proposed locations of the three monitoring wells are shown on the attached Figure. The schedule start date is October 5, 1992. The Site work will take between two to four days to complete.

Please notify the dealer of the above start date. Make him aware that he will not be closed down and that we will work with him to minimize any inconvenience. He should also be aware that soil cuttings from well installations (approximately 1-2 cu. yds.), and purge water stored in drums will remain on-site approximately three weeks. Should there be any changes, I will notify you as soon as possible. In addition, we will apprise the dealer of the above start date at least 48 hours prior to our arrival.

Should you require further information about this scheduled work, please do not hesitate to call me at (510) 602-2333.

Sincerely,  
ROUX ASSOCIATES

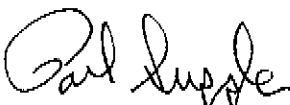
  
Paul Supple  
Senior Geologist



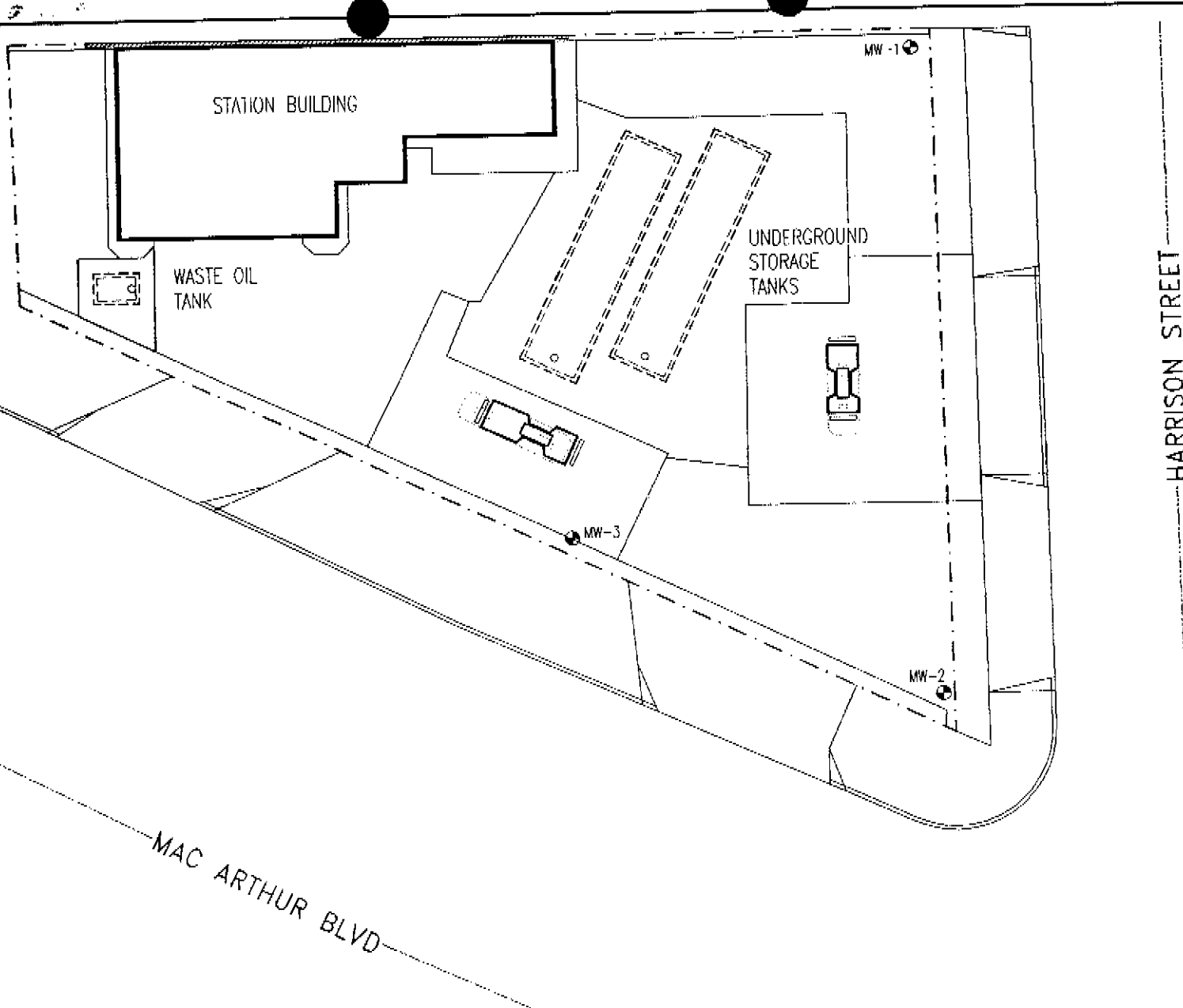

cc: Mr. Robert Boust, UNOCAL



HARRISON STREET

MAC ARTHUR BLVD

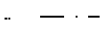
**EXPLANATION:**

-  MW-1 PROPOSED MONITORING WELL LOCATION AND DESIGNATION
-  UNDERGROUND STORAGE TANK
-  PROPERTY BOUNDARY LINE
-  FORMER PUMP ISLAND
-  NEW PUMP ISLAND

**SOURCE:**

MAP MODIFIED FROM BLUEPRINT PROVIDED BY, UNOCAL 76, 04/92.

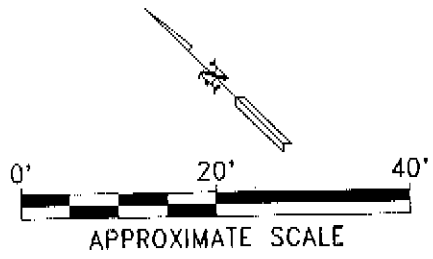

 <b>ROUX</b> ROUX ASSOCIATES ENVIRONMENTAL CONSULTING & MANAGEMENT	COMPILED BY: P.S.	PREPARED FOR: UNOCAL	FIGURE  <h1 style="text-align: center;">4</h1>
	PREPARED BY: R.P.		
	PROJECT MNGR. P.S.	TITLE:	
	DATE: 05/92	LOCATION OF PROPOSED MONITORING WELLS	
	SCALE: AS SHOWN	UNOCAL SERVICE STATION NO. 1871	
PROJECT NO. 27001W			
FILE NAME: UN1871XX			