

ALAMEDA COUNTY
HEALTH CARE SERVICES

AGENCY
DAVID J. KEARS, Agency Director



05/14/01

20455

ENVIRONMENTAL HEALTH SERVICES
ENVIRONMENTAL PROTECTION
1131 Harbor Bay Parkway, Suite 250
Alameda, CA 94502-6577
(510) 567-6700
FAX (510) 337-9335

May 11, 2001

Thomas J. Franklin, District Branch Chief
State of California-Business, Transportation, and Housing Agency
Dept. of Transportation
Office of Permits
Box 23660
Oakland, CA 94623-0660

Subject: Encroachment Permit Application – File No. 00-0643
State Highway 04-Ala-580, Post Mile 44.5
Harrison St. and Santa Clara St., Oakland, CA

As suggested in your letter of December 26, 2000 to Clyde Galantine of Gettler-Ryan, Inc., we are acknowledging our support of "Encroachment Permit Application – File No. 00-0643". The installation of the proposed monitoring wells will aid in the investigation of the leak from the underground tanks from the site at the Former Tosco/76 Products Service Station No. 1871, 96 MacArthur Blvd., Oakland, CA. Our office had requested the installation of groundwater monitoring wells at the CalTrans right of way to determine if the groundwater flow direction off site is similar to the onsite flow direction or if it is skewed due to potential barriers constructed for the I-580 Freeway.

This office appreciates your cooperation in this matter. If you have any questions, you may call me at 510/567-6746.

Sincerely,

Don Hwang
Hazardous Materials Specialist

er
C: Clyde Galantine, Gettler-Ryan, Inc., 1364 N. McDowell Blvd., Suite B2, Petaluma, CA
94954-1116

file

LOP - RECORD CHANGE REQUEST FORM

printed:
12/28/1999

Mark Out What Needs Changing and Hand to LOP Data Entry
(Name/Address changes go to Annual Programs Data Entry)

Insp: DH

AGENCY # : 10000	SOURCE OF FUNDS: F	SUBSTANCE: 8006619
StID : 1120	LOC: -0-	
SITE NAME: Unocal SS#1871		DATE REPORTED : 05/14/1992
ADDRESS : 96 -0 MacArthur Blvd		DATE CONFIRMED: 05/14/1992
CITY/ZIP : Oakland 94610		MULTIPLE RPs : N

SITE STATUS

CASE TYPE: S	CONTRACT STATUS: 4	PRIOR CODE:1C3	EMERGENCY RESP: -0-
RP SEARCH: S			DATE COMPLETED: 07/08/1992
PRELIMINARY ASMNT: -	DATE UNDERWAY: -0-		DATE COMPLETED: -0-
REM INVESTIGATION: -	DATE UNDERWAY: -0-		DATE COMPLETED: -0-
REMEDIAL ACTION: -	DATE UNDERWAY: -0-		DATE COMPLETED: -0-
POST REMED ACT MON:-	DATE UNDERWAY: -0-		DATE COMPLETED: -0-

ENFORCEMENT ACTION TYPE: 1	DATE ENFORCEMENT ACTION TAKEN: 07/08/1992
LUFT FIELD MANUAL CONSID: -0-	
CASE CLOSED: -	DATE CASE CLOSED: -0-
DATE EXCAVATION STARTED : -0-	REMEDIAL ACTIONS TAKEN: -0-

RESPONSIBLE PARTY INFORMATION

RP#1-CONTACT NAME: Robert Boust
COMPANY NAME: Unocal
ADDRESS: P O Box 5155
CITY/STATE: San Ramon C A 94583

INSPECTOR VERIFICATION:

NAME _____	SIGNATURE _____	DATE _____
------------	-----------------	------------

DATA ENTRY INPUT:

Name/Address Changes Only			Case Progress Changes	
ANPPGMS _____	LOP _____	DATE _____	LOP _____	DATE _____

ALAMEDA COUNTY
HEALTH CARE SERVICES

AGENCY
DAVID J. KEARS, Agency Director



ENVIRONMENTAL HEALTH SERVICES

1131 Harbor Bay Parkway, Suite 250
Alameda, CA 94502-6577
(510) 567-6700
(510) 337-9335 (FAX)

November 04, 1999

Dave DeWitt
Tosco Marketing Co.
2000 Crow Canyon Place, Ste 400
San Ramon, CA 94583

STID: 1120

Re: Workplan for additional investigations at the Former Tosco Service Station No. 1871,
located at 96 MacArthur Blvd., Oakland, CA

Dear Mr. DeWitt,

This office has reviewed the November 01, 1999 Workplan for Subsurface Investigations, prepared by Gettler-Ryan, Inc. for the above site. This workplan is acceptable to this office, with the following additional requirements:

- The 20-foot long well screens proposed for the three wells are too long and should be reduced to 15 feet in length; and
- You are required to wait a minimum of 48 hours after developing the three proposed wells before purging and sampling these wells.

Additionally, this office sent you a letter on September 10, 1999 requiring that a residential scenario risk assessment be submitted by November 05, 1999. This office has not yet received this risk assessment, so TOSCO is currently delinquent in the submittal of this assessment. If the risk assessment cannot be submitted within 20 days of the date of this letter, you are required to submit a letter providing the reason for the late submittal of this report and a time schedule for when this report can be submitted.

The November 01, 1999 workplan should be implemented within 60 days of the date of this letter. A report documenting the work should be submitted within 45 days after completing field activities. Please notify this office at least one week in advance of field work.

If you have any questions or comments, please contact me at (510) 567-6763.

Sincerely,

Juliet Shin, R.G.
Hazardous Materials Specialist

Dave DeWitt
Re: 96 MacArthur Blvd.
November 04, 1999
Page 2 of 2

Cc: Dave Vossler
Gettler-Ryan, Inc.
6747 Sierra Court, Ste J
Dublin, CA 94568

Barbara Bee
17 Sotelo Ave.
Piedmont, CA 94611

Leroy Griffin
City of Oakland Fire Dept., OES
1605 Martin Luther King Jr. Way
Oakland, CA 94612-1393

1999, 11-04 18:27
 510 337 9335
 ALAMEDA CO EHS HAZ-OPS

COM No.	REMOTE STATION	START TIME	DURATION	PAGES	RESULT	USER ID	REMARKS
427	5102772361	11-04 18:26	00' 52	02/02	OK		

7499402046

ALAMEDA COUNTY
HEALTH CARE SERVICES

AGENCY
 DAVID J. KEARS, Agency Director



Post-It™ brand fax transmittal memo 7671		# of pages > 2
To <i>Dave DeWitt</i>	From <i>Juliet Shin</i>	
Co. <i>TOSCO</i>	Co. <i>Alameda Cty</i>	
Dept.	Phone # <i>510-567-6763</i>	
Fax # <i>925-277-2362</i>	Fax # <i>510-337-9335</i>	

1131 Harbor Bay Parkway, Suite 250
 Alameda, CA 94502-6877
 (510) 567-6700
 (510) 337-9335 (FAX)

November 04, 1999

Dave DeWitt
 Tosco Marketing Co.
 2000 Crow Canyon Place, Ste 400
 San Ramon, CA 94583

STID: 1120

Re: Workplan for additional investigations at the Former Tosco Service Station No. 1871,
 located at 96 MacArthur Blvd., Oakland, CA

Dear Mr. DeWitt,

This office has reviewed the November 01, 1999 Workplan for Subsurface Investigations, prepared by Gettler-Ryan, Inc. for the above site. This workplan is acceptable to this office, with the following additional requirements:

- The 20-foot long well screens proposed for the three wells are too long and should be reduced to 15 feet in length; and
- You are required to wait a minimum of 48 hours after developing the three proposed wells before purging and sampling these wells.

Additionally, this office sent you a letter on September 10, 1999 requiring that a residential scenario risk assessment be submitted by November 05, 1999. This office has not yet received this risk assessment, so TOSCO is currently delinquent in the submittal of this assessment. If the risk assessment cannot be submitted within 20 days of the date of this letter, you are required to submit a letter providing the reason for the late submittal of this report and a time schedule for when this report can be submitted.

The November 01, 1999 workplan should be implemented within 60 days of the date of this

ALAMEDA COUNTY
HEALTH CARE SERVICES

AGENCY

DAVID J. KEARS, Agency Director



ENVIRONMENTAL HEALTH SERVICES

1131 Harbor Bay Parkway, Suite 250
Alameda, CA 94502-6577
(510) 567-6700
(510) 337-9335 (FAX)

September 10, 1999

Dave DeWitt
Tosco Marketing Co.
2000 Crow Canyon Place, Ste 400
San Ramon, CA 94583

STID: 1120

Re: Investigations at Former Tosco/76 Products Service Station No. 1871, located at 96
MacArthur Blvd, Oakland, CA

Dear Mr. DeWitt,

This office has reviewed Gettler-Ryan Inc.'s (Gettler) August 6, 1999 Limited Subsurface Investigation Report, addressing recently conducted investigations at the above site. Elevated levels of Methyl Tertiary Butyl Ether (MTBE) were identified in off-site, downgradient borings B-7 and B-11 at 3,000 parts per billion (ppb) and 15,000 ppb. Based on these concentrations, this office is requiring that a permanent monitoring well be placed in this area to monitor and delineate these MTBE concentrations. Additionally, a well located in this area will allow for the needed triangulation to confirm that the groundwater flow direction off site is similar to the on-site flow direction, and that it is not skewed due to potential barriers constructed for the I-580 Freeway. Subsequent to the installation of a permanent well in this area, and the confirmation of off-site groundwater flow directions, the MTBE contaminant plume may need to be further delineated if elevated levels of MTBE continue to be identified from this area.

Very elevated levels of benzene (10,000ppb) and MTBE (270,000ppb) were identified in the "grab" groundwater sample collected from Boring B-10. These levels are commensurate to the concentrations that have consistently been identified in Well MW-1. Based on this information, this office is assuming that the contaminant levels existing in groundwater below the residence immediately adjacent to Boring B-10 are similar to the concentrations identified in Boring B-10 and Well MW-1. Currently, benzene concentrations in both Boring B-10 and Well MW-1 are greatly exceeding the residential threshold value of 250ppb in ASTM RBCA's Tier 1 table for a 10-5 risk. Additionally, the site is exceeding the residential threshold value of 2,600ppb that was obtained by inputting some site specific parameters into the Oakland Risk Assessment Spreadsheet. Based on this information, this office is requiring that a Site-Specific Tier 2 Risk Assessment be conducted to address any potential human-health impacts to the neighboring residence.

The risk assessment, along with a workplan addressing the installation of an additional off-site permanent monitoring well, should be submitted to this office within 60 days of the date of this letter (i.e, by November 5, 1999).

Dave DeWitt
Re: Station 1871; 96 MacArthur Blvd.
September 10, 1999
Page 2 of 2

The next groundwater monitoring event is due to take place in October 1999. No additional analysis for Method 8010 and 8270 constituents will be required, based on the NonDetect analytical results from this last sampling event.

Lastly, please submit the following additional information to supplement Gettler's Subsurface Report:

- Information on the screened intervals that were used to collect "grab" groundwater samples from the Geoprobe borings; and
- Information on the presence and locations of potential barriers created by the adjacent I-580 Freeway.

Thank you for your cooperation. If you have any questions or comments, please contact me at (510) 567-6763.

Sincerely,

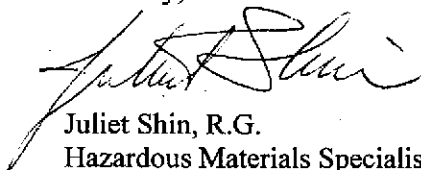

Juliet Shin, R.G.
Hazardous Materials Specialist

Cc: Dave Vossler
Gettler-Ryan, Inc.
6747 Sierra Court, Ste J
Dublin, CA 94568

Barbara Bee
17 Sotelo Ave.
Piedmont, CA 94611

Leroy Griffin
Oakland Hazardous Materials
505 14th St., Ste 702
Oakland, CA 94612

1999.09-10 17:59
 510 337 9335
 ALAMEDA CO EHS HAZ-OPS

COM No.	REMOTE STATION	START TIME	DURATION	PAGES	RESULT	USER ID	REMARKS
155	5102772361	09-10 17:58	01'06	02/02	OK		

7499402046

ALAMEDA COUNTY
HEALTH CARE SERVICES

AGENCY
 DAVID J. KEARS, Agency Director



Post-It™ brand fax transmittal memo 7671		# of pages ▶ 2
To David DeWitt	From Juliet Shin	
Co. Tosco	Co. Alameda Cty	
Dept.	Phone # 570-567-6763	
Fax # 925-277-2361	Fax # 570-337-9335	

1101 Harbor Bay Parkway, Suite 250
 Alameda, CA 94502-6577
 (510) 567-6700
 (510) 337-9335 (FAX)

September 10, 1999

Dave DeWitt
 Tosco Marketing Co.
 2000 Crow Canyon Place, Ste 400
 San Ramon, CA 94583

STID: 1120

Re: Investigations at Former Tosco/76 Products Service Station No. 1871, located at 96 MacArthur Blvd, Oakland, CA

Dear Mr. DeWitt,

This office has reviewed Gettler-Ryan Inc.'s (Gettler) August 6, 1999 Limited Subsurface Investigation Report, addressing recently conducted investigations at the above site. Elevated levels of Methyl Tertiary Butyl Ether (MTBE) were identified in off-site, downgradient borings B-7 and B-11 at 3,000 parts per billion (ppb) and 15,000 ppb. Based on these concentrations, this office is requiring that a permanent monitoring well be placed in this area to monitor and delineate these MTBE concentrations. Additionally, a well located in this area will allow for the needed triangulation to confirm that the groundwater flow direction off site is similar to the on-site flow direction, and that it is not skewed due to potential barriers constructed for the I-580 Freeway. Subsequent to the installation of a permanent well in this area, and the confirmation of off-site groundwater flow directions, the MTBE contaminant plume may need to be further delineated if elevated levels of MTBE continue to be identified from this area.

Very elevated levels of benzene (10,000ppb) and MTBE (270,000ppb) were identified in the "grab" groundwater sample collected from Boring B-10. These levels are commensurate to the concentrations that have consistently been identified in Well MW-1. Based on this information, this office is assuming that the contaminant levels existing in groundwater below the residence immediately adjacent to Boring B-10 are similar to the concentrations identified in Boring B-10 and Well MW-1. Currently, benzene concentrations in both Boring B-10 and Well MW-1 are greatly exceeding the residential threshold value of 250ppb in ASTM RBCA's Tier 1 table for a 10-5 risk. Additionally, the site is exceeding the residential threshold value of 2,600ppb that was obtained by inputting some site specific parameters into the Oakland Risk Assessment Spreadsheet. Based on this information, this office is requiring that a Site-Specific Tier 2 Risk Assessment be conducted to address any potential human-health impacts to the neighboring residence.

The risk assessment, along with a workplan addressing the installation of an additional off-site permanent monitoring well, should be submitted to this office within 60 days of the date of this letter (i.e. by November 5, 1999).



GETTLER-RYAN INC.

May 20, 1999

Ms. Juliet Shin
Alameda County Health Agency
Division of Environmental Protection
1131 Harbor Bay Parkway, 2nd Floor
Alameda, California 94502

Subject: Site Status for the Former Tosco Service Station located 96 MacArthur
Boulevard, Oakland, California

Ms. Shin:

Gettler-Ryan Inc. (GR) has prepared this letter to update the Alameda County Health Care Services (ACHCS) on the status of the planned environmental work to be performed at the site. The site was demolished and all of the underground facilities removed. The over-excavation of impacted soil was conducted to the maximum feasible limits. Four on-site wells were abandoned to allow future development of the site. Three replacement wells along with an off-site investigation to delineate the impacted groundwater has been submitted to ACHCS and approved. In addition to the off-site investigation, Tosco has completed the evaluation of site risk parameters using the ASTM E-1739 "Standard for Risk-Based Corrective Action at Petroleum Release Sites" (RBCA). Tosco received an approval letter dated May 4, 1999 from the ACHCS concurring that the residual petroleum hydrocarbons at the site do not appear to pose a risk to human-health for a commercial use.

Project Schedule

The off-site investigation which includes three replacement wells located west of the site along MacArthur Boulevard, two soil borings and up to eight GeoProbes is scheduled for June 1 through 4, 1999. A well and utility survey has also been completed and will be presented in the forthcoming off-site investigation report.

If you have any questions or would like to discuss the content of this letter, please call me at (415) 893-1515.

Sincerely,
Gettler-Ryan Inc.

David J. Vossler
Project Manager

Cc: Mr. David B. DeWitt, Tosco Marketing Company, San Ramon, California
Ms. Barbara Bee, Property Owner

ENVIRONMENTAL
PROTECTION
99 MAY 21 PM 3:57

ALAMEDA COUNTY
HEALTH CARE SERVICES

AGENCY
DAVID J. KEARS, Agency Director



ENVIRONMENTAL HEALTH SERVICES
ENVIRONMENTAL PROTECTION (LOP)
1131 Harbor Bay Parkway, Suite 250
Alameda, CA 94502-6577
(510) 567-6700
FAX (510) 337-9335

May 04, 1999

Dave DeWitt
Tosco Marketing Co.
2000 Crow Canyon Place, Ste 400
San Ramon, CA 94583

STID: 1120

Re: Approval of the risk assessment for evaluating on-site risks for commercial use for the Former Tosco/76 Products Service Station No. 1871, located at 96 MacArthur Blvd., Oakland, CA

Dear Mr. DeWitt,

This office has completed our review of Gettler-Ryan Inc.'s risk assessment, dated February 25, 1999, and the subsequent revisions to the risk assessment, dated April 6, 19, and 20, 1999. It has been determined by our review of the risk assessment, along with the revisions, that the soil and groundwater contamination on site does not appear to pose a risk to human-health at a 10^{-6} risk for commercial purposes.

The off-site soil and groundwater investigations must be initiated immediately after obtaining an encroachment permit from the City of Oakland. Please notify this office as soon as this encroachment permit has been obtained.

If you have any questions or comments, please contact me at (510) 567-6763.

Sincerely,

Juliet Shin
Hazardous Materials Specialist

Cc: David Vossler
Gettler-Ryan, Inc.
6747 Sierra Court, Ste J
Dublin, CA 94568

Barbara Bee
17 Sotelo Ave.
Piedmont, CA 94611

Files-JMS

ALAMEDA COUNTY
HEALTH CARE SERVICES

AGENCY

DAVID J. KEARS, Agency Director



ENVIRONMENTAL HEALTH SERVICES

1131 Harbor Bay Parkway, Suite 250
Alameda, CA 94502-6577
(510) 567-6700
(510) 337-9335 (FAX)

February 02, 1999

Dave DeWitt
Tosco Marketing Co.
2000 Crow Canyon Place, Ste 400
San Ramon, CA 94583

STID: 1120

Re: Revised Schedule of Work for the Former Tosco/76 Products Service Station No. 1871,
located at 96 MacArthur Blvd., Oakland, CA

Dear Mr. DeWitt,

This office has received the January 28, 1999 revised Schedule-Of-Work from Gettler-Ryan Inc., and determined that this schedule is acceptable. It is our understanding that the proposed risk assessment will be submitted to this office by February 26, 1999, and that reports documenting sampling within areas under the City of Oakland's jurisdiction and Caltrans' jurisdiction will be submitted by March 31, 1999 and April 30, 1999.

Please notify this office at least one week in advance of field work, so that a County inspector may be present to observe the work. Additionally, please copy the property owner, Barbara Bee, on all future correspondences.

If you have any questions or comments, please contact me at (510) 567-6763.

Sincerely,

A handwritten signature in cursive script, appearing to read 'Juliet Shin', written in dark ink.

Juliet Shin
Hazardous Materials Specialist

Cc: David Vossler
Gettler-Ryan, Inc.
6747 Sierra Court, Ste J
Dublin, CA 94568

Barbara Bee
17 Sotelo Ave.
Piedmont, CA 94611

Files-JMS

ALAMEDA COUNTY
HEALTH CARE SERVICES

AGENCY

DAVID J. KEARS, Agency Director



ENVIRONMENTAL HEALTH SERVICES

.1131 Harbor Bay Parkway, Suite 250
Alameda, CA 94502-6577
(510) 567-6700
(510) 337-9335 (FAX)

November 10, 1998

Tina Berry
TOSCO Marketing Co.
2000 Crow Canyon Place, Ste 400
San Ramon, CA 94583

STID 1120

Re: Work plan for additional investigations at TOSCO (Unocal) Service Station #1871,
located at 96 MacArthur Blvd., Oakland, CA

Dear Ms. Berry,

This office has reviewed Gettler-Ryan, Inc.'s workplan, dated October 30, 1998, and their addendum to the workplan, dated November 9, 1998. This workplan is acceptable to this office with the following additional requirements:

- Groundwater samples collected from the three newly installed groundwater monitoring wells, along with the existing on-site monitoring well, MW-1, shall be analyzed for TAME, DIPE, ETBE, TBA, EDB, and EDC, in addition to MTBE and TPHG and BTEX, as stipulated in the County's September 11, 1998 letter to you. Analyses for all the oxygenates shall be conducted using Method 8260 and analysis for the lead scavengers shall be conducted using Method 8010. Additionally, groundwater samples collected from the wells nearest to the former waste oil underground storage tank shall also be analyzed for Semi-Volatile Organic Compounds using Method 8270.
- The Geoprobe advancement proposed at the eastern corner of the intersection of Harrison Street and MacArthur Boulevard shall be continuously logged down to the same depth as the newly installed groundwater monitoring wells so that it can be adequately tied into the proposed cross section A-A'.
- After the three groundwater monitoring wells are installed, there must be a minimum of 72 hours waiting period before developing these wells. Additionally, you must wait a minimum of 24 hours after developing the wells before purging and sampling the wells.
- If samples collected from near the adjacent residences identify benzene concentrations in soil or groundwater that exceed the Tier 1 human-health protective values given in ASTM's Risk Based Corrective Action guidelines (RBCA), then a site specific risk assessment for these sensitive receptors will be required, in addition to the required on-site risk assessment for commercial purposes.

Ms. Tina Berry
Re: 96 MacArthur Blvd.
November 10, 1998
Page 2 of 2

The sanitary and sewer line map provided in the workplan addendum appears to be showing the elevations of these utility lines in reference to Mean Sea Level. If this is the case, then some of the sanitary and sewer utility lines in the vicinity of the site appear to lie within the range of fluctuating groundwater elevations. Details of these utility lines must be examined more closely, and if it is confirmed that these utility lines lie in the range of groundwater elevations, then measures must be taken to determine whether these utility lines are consistently or intermittently intercepting portions of the contaminant plume.

Per my conversation with Mr. Douglas Lee, Gettler-Ryan, Inc., on November 10, 1998, the depths and locations of the other utility lines, such as the gas, electric, and water lines, are sufficiently shallower than the groundwater level so as not to intercept the contaminant plume. A clear and detailed map showing the locations and depths of all the utility lines in the immediate area of the site will need to be submitted with the final report to clarify and document utility line information.

The workplan shall be implemented within 60 days of the date of this letter. If delays occur due to weather, permitting difficulties, etc., requests for extensions shall be submitted for approval in writing. A report documenting the work shall be submitted to this office within 45 days after completing field activities.

Please contact me at least one week in advance of initiating field work so that I may be present to oversee some of the field work. If you have any questions or comments, please contact me at (510)567-6763.

Sincerely,

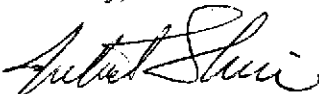

Juliet Shin
Hazardous Materials Specialist

Cc: Barbara Bee
17 Sotelo Ave., Piedmont, CA 94611

Douglas Lee, Gettler-Ryan, Inc.
6747 Sierra Ct., Ste J, Dublin, CA 94568

Joel Greger, Gettler-Ryan, Inc.
6747 Sierra Ct., Ste J, Dublin, CA 94568



TOSCO
Marketing
Company

ENVIRONMENTAL
PROTECTION

98 OCT 22 PM 4: 23

2000 Crow Canyon Place
Suite 400
San Ramon, CA 94583
925.277.2305
fax: 925.277.2361

**Environmental
Compliance
Department**

October 21, 1998

Ms Juliet Shin
Alameda County Health Agency
1131 Harbor Bay Parkway, 2nd Floor
Alameda, CA 94502

SUBJECT: Former 76 SS# 1871
96 MacArthur Blvd. @ Harrison, Oakland, CA

Dear Ms. Shin:

Thank you for meeting with Doug Lee and me yesterday at the referenced site. As you are aware, a work plan for additional plume characterization is due to your office on Friday, October 23, 1998. Per our discussion, Tosco is requesting extension of the work plan to Friday October 30, 1998 to incorporate our discussions and placement of proposed exploratory soil borings and groundwater monitoring wells.

Our work plan will address and consider the requested conduit study in the site area . The plan will be modified, as and if necessary, to include additional characterization and borings should underground utilities be noted that could intercept the groundwater plume. The work plan will propose additional soil and groundwater characterization as discussed yesterday (including depth discrete sampling below the water table in designated areas) and will propose a risk assessment to determine potential threats based on future property uses (as Tosco understands them) and threats to other potential sensitive receptors.

Should you have any questions or concerns regarding this letter, please do not hesitate to contact me at 925-277-2321.

Sincerely,

Tina R. Berry

Tina R. Berry
Project Manager

c: File (5995:5)
Doug Lee, Gettler-Ryan
Dick Mathews, Tosco Marketing Co.

1131 Harbor Bay Pkwy.
Suite 250
Alameda, CA 94502-6577
(510) 567-6700

ALAMEDA COUNTY, DEPARTMENT OF
ENVIRONMENTAL HEALTH
Hazardous Materials Inspection Form

II, III

white -env.health
yellow -facility
pink -files

Site ID # 1120 Site Name Tosco Today's Date 09/16/98

II.A BUSINESS PLANS (Title 19)

- 1. Immediate Reporting 2703
- 2. Bus. Plan Stds. 25503(b)

Site Address 96 MacArthur
Oakland Zip 94 Phone _____

MAX AMT stored > 500 lbs, 55 gal., 200 cft.?



BARBARA SIEMINSKI, R.G.
Project Geologist

Inspection Categories:

- I. Haz. Mat/Waste GENERATOR/TRANSPORTER
- II. Business Plans, Acute Hazardous Materials
- III. Underground Tanks

6747 Sierra Ct., Suite J
Dublin, CA 94568
Direct (925) 551-7444 ext. 188
Business (925) 551-7555
Fax (925) 551-7888

Administration Code (CAC) or the Health & Safety Code (HS&C)

III. UNDERGROUND TANKS (Title 23)

- 1. Permit Application 25284 (H&S)
- 2. Pipeline Leak Detection 25292 (H&S)
- 3. Records Maintenance 2712
- 4. Release Report 2651
- 5. Closure Plans 2670

- 6. Method
 - 1) Monthly Test
 - 2) Daily Vadose
Semi-annual groundwater
One time soils
 - 3) Daily Vadose
One time soils
Annual tank test
 - 4) Monthly Gndwater
One time soils
 - 5) Daily Inventory
Annual tank testing
Cont pipe leak det
Vadose/gndwater mon.
 - 6) Daily Inventory
Annual tank testing
Cont pipe leak det
 - 7) Weekly Tank Gauge
Annual tank testing
 - 8) Annual Tank Testing
Daily Inventory
 - 9) Other _____

- 7. Precs Tank Test 2643
Date: _____
- 8. Inventory Rec. 2644
- 9. Soil Testing 2646
- 10. Ground Water 2647

- 11. Monitor Plan 2632
- 12. Access. Secure 2634
- 13. Plans Submlt 2711
Date: _____
- 14. As Built 2635
Date: _____

Rev 6/88

is: ^{at SAM}
 Came out to site. Re-inspected all wells on site. Took depths of wells. Based on re-inspection, it was determined that Well MW-1 was structurally sound and that Wells MW-3 and MW-2 could remain on site w/ repairs to their well heads. The casing on Wells MW-5 and MW-4 were obviously damaged, so these wells will be destroyed today and need to be replaced w/ wells immediately downgradient. Per Barbara Sieminski, Gettler-Ryan, one boring will be drilled at the northwest corner of the site for geophysical sampling & contaminant sampling for the risk assessment. When the site is eventually re-paved the casings for the wells remaining in-place will be raised. Observed destruction of Well MW-5.

Contact: Barbara Sieminski, Gettler Ryan
 Title: Project Geologist
 Signature: [Signature]

Inspector: Sylvia Shin
 Signature: [Signature]
 (510) 567-6763

II, III

1131 Harbor Bay Pkwy.
Suite 250
Alameda, CA 94502-6577
(510) 567-6700

ALAMEDA COUNTY, DEPARTMENT OF
ENVIRONMENTAL HEALTH
Hazardous Materials Inspection Form

II, III

white -env.health
yellow -facility
pink -files

Site ID #1120 Site Name Tosco Today's Date 09/16/98

II.A BUSINESS PLANS (Title 19)

- 1. Immediate Reporting 2703
- 2. Bus. Plan Stds. 25503(b)
- 3. RR Cars > 30 days 25503.7
- 4. Inventory Information 25504(a)
- 5. Inventory Complete 2730
- 6. Emergency Response 25504(b)
- 7. Training 25504(c)
- 8. Deficiency 25505(a)
- 9. Modification 25505(b)

Site Address 96 MacArthur
City Oakland Zip 94 Phone _____

MAX AMT stored > 500 lbs, 55 gal., 200 cft.?

Inspection Categories:

- I. Haz. Mat/Waste GENERATOR/TRANSPORTER
- II. Business Plans, Acute Hazardous Materials
- III. Underground Tanks

* Calif. Administration Code (CAC) or the Health & Safety Code (HS&C)

II.B ACUTELY HAZ. MATLS

- 10. Registration Form Filed 25533(a)
- 11. Form Complete 25533(b)
- 12. RMPP Contents 25534(c)
- 13. Implement Sch. Req'd? (Y/N)
- 14. OffSite Conseq. Assess. 25524(c)
- 15. Probable Risk Assessment 25534(d)
- 16. Persons Responsible 25534(g)
- 17. Certification 25534(f)
- 18. Exemption Request? (Y/N) 25536(b)
- 19. Trade Secret Requested? 25538

III. UNDERGROUND TANKS (Title 23)

- | | |
|--|---|
| General | <input type="checkbox"/> 1. Permit Application 25284 (H&S) |
| | <input type="checkbox"/> 2. Pipeline Leak Detection 25292 (H&S) |
| | <input type="checkbox"/> 3. Records Maintenance 2712 |
| | <input type="checkbox"/> 4. Release Report 2651 |
| | <input type="checkbox"/> 5. Closure Plans 2670 |
| Monitoring for Existing Tanks | 6. Method |
| | 1) Monthly Test |
| | 2) Daily Vadose
Semi-annual groundwater
One time soils |
| | 3) Daily Vadose
One time soils
Annual tank test |
| | 4) Monthly Gndwater
One time soils |
| | 5) Daily Inventory
Annual tank testing
Cont pipe leak det
Vadose/gndwater mon. |
| | 6) Daily Inventory
Annual tank testing
Cont pipe leak det |
| | 7) Weekly Tank Gauge
Annual tank testing |
| | 8) Annual Tank Testing
Daily Inventory |
| | 9) Other _____ |
| New Tanks | <input type="checkbox"/> 7. Precls Tank Test 2643 |
| | Date: _____ |
| | <input type="checkbox"/> 8. Inventory Rec. 2644 |
| | <input type="checkbox"/> 9. Soil Testing. 2646 |
| | <input type="checkbox"/> 10. Ground Water. 2647 |
| <input type="checkbox"/> 11. Monitor Plan 2632 | |
| <input type="checkbox"/> 12. Access. Secure 2634 | |
| <input type="checkbox"/> 13. Plans Submt 2711 | |
| Date: _____ | |
| <input type="checkbox"/> 14. As Built 2635 | |
| Date: _____ | |

Comments:

Came out to site ^{at 8AM}. Re-inspected all wells on site. Took depths of wells. Based on re-inspection, it was determined that Well MW-1 was structurally sound and that Wells MW-3 and MW-2 could remain on site w/ repairs to their well heads. The casing on Wells MW-5 and MW-4 were obviously damaged, so these wells will be destroyed today and need to be replaced w/ wells immediately downgradient. Per Barbara Sieminski, Bettler-Ryan, one boring will be drilled at the northwest corner of the site for geophysical sampling & contaminated sampling for the risk assessment. When the site is eventually re-paved the casings for the wells remaining in-place will be raised. Observed destruction of Well MW-5.

Rev 6/88

Contact: Barbara Sieminski, Bettler Ryan
 Title: Project geologist
 Signature: [Signature]

Inspector: Sylvia Ship
 Signature: [Signature]
 (510) 567-6763

II, III

1131 Harbor Bay Pkwy
Suite 250
Alameda, CA 94502-6577
(510) 567-6700

ALAMEDA COUNTY, DEPARTMENT OF ENVIRONMENTAL HEALTH
Hazardous Materials Inspection Form

II, III

white -env.health
yellow -facility
pink -files

Site ID # 1120 Site Name Tosco Today's Date 09/16/98

Site Address 96 Mae Arthur
City Oakland Zip 94 Phone _____

MAX AMT stored > 500 lbs, 55 gal., 200 cft.?

Inspection Categories:

- ___ I. Haz. Mat/Waste GENERATOR/TRANSPORTER
- ___ II. Business Plans, Acute Hazardous Materials
- ___ III. Underground Tanks

* Calif. Administration Code (CAC) or the Health & Safety Code (HS&C)

II.A BUSINESS PLANS (Title 19)

- ___ 1. Immediate Reporting 2703
- ___ 2. Bus. Plan Stds. 25503(b)
- ___ 3. RR Cars > 30 days 25503.7
- ___ 4. Inventory Information 25504(a)
- ___ 5. Inventory Complete 2730
- ___ 6. Emergency Response 25504(b)
- ___ 7. Training 25504(c)
- ___ 8. Deficiency 25505(a)
- ___ 9. Modification 25505(b)

II.B ACUTELY HAZ. MATLS

- ___ 10. Registration Form Filed 25533(a)
- ___ 11. Form Complete 25533(b)
- ___ 12. RMPP Contents 25534(c)
- ___ 13. Implement Sch. Req'd? (Y/N)
- ___ 14. OffSite Conseq. Assess. 25524(c)
- ___ 15. Probable Risk Assessment 25534(d)
- ___ 16. Persons Responsible 25534(g)
- ___ 17. Certification 25534(i)
- ___ 18. Exemption Request? (Y/N) 25536(b)
- ___ 19. Trade Secret Requested? 25538

III. UNDERGROUND TANKS (Title 23)

- | | |
|-------------------------------|---|
| General | ___ 1. Permit Application 25284 (H&S) |
| | ___ 2. Pipeline Leak Detection 25292 (H&S) |
| | ___ 3. Records Maintenance 2712 |
| | ___ 4. Release Report 2651 |
| | ___ 5. Closure Plans 2670 |
| Monitoring for Existing Tanks | ___ 6. Method |
| | 1) Monthly Test |
| | 2) Daily Vadose
Semi-annual groundwater
One time soils |
| | 3) Daily Vadose
One time soils
Annual tank test |
| | 4) Monthly Groundwater
One time soils |
| | 5) Daily Inventory
Annual tank testing
Cont pipe leak det
Vadose/gndwater mon. |
| | 6) Daily Inventory
Annual tank testing
Cont pipe leak det |
| | 7) Weekly Tank Gauge
Annual tank testing |
| | 8) Annual Tank Testing
Daily Inventory |
| | 9) Other _____ |
| | ___ 7. Precs Tank Test 2643
Date: _____ |
| | ___ 8. Inventory Rec. 2644 |
| | ___ 9. Soil Testing 2646 |
| | ___ 10. Ground Water 2647 |
| New Tanks | ___ 11. Monitor Plan 2632 |
| | ___ 12. Access. Secure 2634 |
| | ___ 13. Plans Submit 2711
Date: _____ |
| | ___ 14. As Built 2635
Date: _____ |

Comments:
 Bentonite in Well MW-5 was encountered at ~3' below current ground surface. The soil cuttings/stoolpile will be sampled. Cuttings put aside on veg. Soil will be covered until disposal. Bentonite will be grouted w/ cement. Augers were pushed between different well closures Bentonite down at ~2 1/2' before Well MW-4 during well closure. Per Barbara Sieminski, TOSCO wants to move Wells MW-3 and MW-2 anyway, even though they can be repaired, so that they won't risk getting in the way of future development at the site. Left site at 9:45 AM. Will come back out at 12:30P to witness some of grouting. Came back out at 12:15 PM to observe grouting. Requested that Mrs. Sieminski look into identification of PVC pipe coming up from ground at southwest corner of site.

Rev 8/88

Contact: Barbara Sieminski, Gertler Ryan Inspector: Juliet Shin
 Title: Projed geologist Signature: [Signature]
 Signature: [Signature] Signature: [Signature]
 (510) 567-6763

II, III

1131 Harbor Bay Pkwy
Suite 250
Alameda, CA 94502-6577
(510) 567-6700

ALAMEDA COUNTY, DEPARTMENT OF ENVIRONMENTAL HEALTH
Hazardous Materials Inspection Form

II, III

white -env. health
yellow -facility
pink -files

Site ID # 1120 Site Name TOSCO Today's Date 09/16/98

II.A BUSINESS PLANS (Title 19)

- 1. Immediate Reporting 2703
- 2. Bus. Plan Stds. 25503(b)
- 3. RR Cars > 30 days 25503.7
- 4. Inventory Information 25504(a)
- 5. Inventory Complete 2730
- 6. Emergency Response 25504(b)
- 7. Training 25504(c)
- 8. Deficiency 25505(a)
- 9. Modification 25505(b)

Site Address 96 MacArthur
City Oakland Zip 94 Phone _____

II.B ACUTELY HAZ. MATLS

- 10. Registration Form Filed 25533(a)
- 11. Form Complete 25533(b)
- 12. RMPP Contents 25534(c)
- 13. Implement Sch. Req'd? (Y/N)
- 14. OHSite Conseq. Assess. 25524(c)
- 15. Probable Risk Assessment 25534(d)
- 16. Persons Responsible 25534(g)
- 17. Certification 25534(f)
- 18. Exemption Request? (Y/N)
- 19. Trade Secret Requested? 25538

MAX AMT stored > 500 lbs, 55 gal., 200 cft.?

Inspection Categories:

- I. Haz. Mat/Waste GENERATOR/TRANSPORTER
- II. Business Plans, Acute Hazardous Materials
- III. Underground Tanks

* Calif. Administration Code (CAC) or the Health & Safety Code (HS&C)

III. UNDERGROUND TANKS (Title 23)

- | | | |
|-------------------------------|--|--|
| General | <input type="checkbox"/> 1. Permit Application 25284 (H&S) | |
| | <input type="checkbox"/> 2. Pipeline Leak Detection 25292 (H&S) | |
| | <input type="checkbox"/> 3. Records Maintenance 2712 | |
| | <input type="checkbox"/> 4. Release Report 2651 | |
| | <input type="checkbox"/> 5. Closure Plans 2670 | |
| <hr/> | | |
| Monitoring for Existing Tanks | <input type="checkbox"/> 6. Method | |
| | 1) Monthly Test | |
| | 2) Daily Vadose
Semi-annual groundwater
One time soils | |
| | 3) Daily Vadose
One time soils
Annual tank test | |
| | 4) Monthly Groundwater
One time soils | |
| | 5) Daily Inventory
Annual tank testing
Cont pipe leak det
Vadose/groundwater mon. | |
| | 6) Daily Inventory
Annual tank testing
Cont pipe leak det | |
| | 7) Weekly Cont. Release
Annual tank testing | |
| | 8) Annual Tank Testing
Daily Inventory | |
| | 9) Other _____ | |
| <hr/> | | |
| New Tanks | <input type="checkbox"/> 7. Precip Tank Test 2643
Date: _____ | |
| | <input type="checkbox"/> 8. Inventory Rec. 2644 | |
| | <input type="checkbox"/> 9. Soil Testing 2646 | |
| | <input type="checkbox"/> 10. Ground Water. 2647 | |
| | <hr/> | |
| | <input type="checkbox"/> 11. Monitor Plan 2632 | |
| | <input type="checkbox"/> 12. Access. Secure 2634 | |
| | <input type="checkbox"/> 13. Plans Submt 2711
Date: _____ | |
| | <input type="checkbox"/> 14. As Built 2635
Date: _____ | |

Comments:
 Bantolite in Well MW-5 was encountered at ~3' below current ground surface. The soil cuttings/stockpiles will be sampled. Cuttings set aside on vacuum. Soil will be covered until disposal. Bantolite will be grouted w/ cement. Mergers high pressure washed between different well closures. Bantolite down at ~2 1/2' before Well MW-4 during well closure. Per Barbara Sieminski, TOSCO wants to move Wells MW-3 and MW-2 anyway, even though they can be repaired, so that they won't risk getting in the way of future development at the site. Left site at 9:45 AM. Will come back out at 12:30P to witness some of grouting. Came back out at 12:15 PM to observe grouting. Requested that Ms. Sieminski look into identification of PVC pipe coming up from ground at southwest corner of site.

Rev 6/88

Contact: Barbara Sieminski, Gertler Ryan Inspector: Juliet Shin
 Title: Pop'd geologist Signature: Juliet Shin
 Signature: [Signature] Signature: [Signature]
 (510) 567-6763

II, III

Alameda County Environmental Health

1131 Harbor Bay Pkwy., #250
Alameda CA 94502-6577
Telephone (510) 567-6700 FAX (510) 337-9335

FACSIMILE COVER SHEET

TO: Joel Gregor, 510-787-1457

FROM: Juliet Shin

DATE: 09/15/98

Total number of pages including cover sheet 2

-NOTES- Per your request, here is a signed copy
of your Inspection Request.

Juliet Shin

State of California
Department of Water Resources
Central District
3261 6 Street
Sacramento, CA 95810-7017

WELL DRILLER'S REPORTS
INSPECTION REQUEST AND AGREEMENT

Project: Tosco 76 Branded Station # 1871
Location: 96 MacArthur Blvd, Oakland
County: Alameda Contract Number: _____

Request is made pursuant to Section 13751 of the California Water Code for permission to inspect or copy Water Well Driller's Reports which are on file in your office.

In accordance with the requirements of Section 13752 of the Water Code, it is stipulated and agreed that such reports, or any copy or copies made thereof, will not be made available for inspection by the public but will be used solely by this governmental agency for making studies. If copies are made or taken, each copy will be stamped "CONFIDENTIAL" or "FOR OFFICIAL USE ONLY" and will be kept in a restricted file, access to which is limited to the staff of this governmental agency or to its contracted agents. Any copies furnished to contracted agents must be returned to the Department of Water Resources, Central District upon completion of work by the contracted agent.

No information contained in these reports can be disseminated or published without the written permission of the owner of the well.

<u>Becker Ryan Inc.</u> Contracted Agent	<u>Alameda County Health Care Services Agency - Environmental Health Svcs.</u> Governmental Agency
<u>6747 Sierra Court</u> Address: <u>Suite J</u>	<u>1131 Harbor Bay Parkway, 2nd Floor</u> Address
<u>Dublin CA 94568</u> City, State, & Zip Code	<u>Alameda, CA 94502</u> City, State, & Zip Code
By <u>Joel Greger</u> Officer	By <u>Julliette Chen</u> Officer
<u>Certified Engineering Geologist</u> Title	<u>Hazardous Mater Spec / Geologist</u> Title
<u>510 7876867</u> Telephone	<u>510 5676763</u> Telephone
<u>9/8/98</u> Date	<u>09/15/98</u> Date

(For Departmental Information: _____ copies sent _____)

Post-it Fax Note 7671 Date 9/15/98 # of 1

Alameda County Environmental Health

1131 Harbor Bay Pkwy., #250
Alameda CA 94502-6577
Telephone (510) 567-6700 FAX (510) 337-9335

FACSIMILE COVER SHEET

TO: Tina Berry, 925-277-2361
FROM: Juliet Shin, Alameda County
Hazardous Materials Div.
DATE: 09/11/98

Total number of pages including cover sheet 4

-NOTES- Here's the promised letter. The
original is in the mail. Thy
- Juliet

ALAMEDA COUNTY
HEALTH CARE SERVICES



AGENCY

DAVID J. KEARS, Agency Director

ENVIRONMENTAL HEALTH SERVICES

1131 Harbor Bay Parkway, Suite 250
Alameda, CA 94502-6577
(510) 567-6700
(510) 337-9335 (FAX)

September 11, 1998

Tina Berry
TOSCO Marketing Co.
2000 Crow Canyon Place, Ste 400
San Ramon, Ca 94583

STID 1120

Re: Investigations at Tosco (Unocal) Service Station #1871, located at 96 MacArthur Blvd., Oakland, CA

Dear Ms. Berry,

Per our meeting at and reconnaissance of the above site on September 11, 1998, all five on-site wells appear to have been damaged during the recent demolition activities at the site. Inadequately protected well heads, cracked piping, and any other damages to these wells is a concern to this office due to the potential for these damaged wells to act as a conduit for potentially contaminated surface water infiltration into groundwater; and is a concern to all parties due to the potential for inaccurate site assessment. One well in particular, Well MW-4, was left with the PVC piping cut and totally open and exposed, while some of the other wells were obviously tilted and agitated during the demolition. Therefore, all the on-site wells must be closed immediately, through permit from the Alameda County Flood Control District-Zone 7, and replaced. Per our discussions, Wells MW-2 thru MW-5 may be placed in the sidewalk areas immediately downgradient of their former well locations. In the interim, Well MW-4 must be adequately covered to prevent any vandalism and surface water infiltration.

Elevated concentrations of Total Petroleum Hydrocarbons as gasoline (TPHG), and benzene, toluene, ethylbenzene, and xylenes (BTEX) have consistently been identified in groundwater samples collected from the site since 1992. Additionally, elevated levels of methyl-tertiary-butyl-ether (MTBE), up to 160,000 parts per billion (ppb), have consistently been identified in groundwater samples collected from the site since analyses for this constituent began in 1995. This contaminant is of particular concern since it does not degrade readily and appears to migrate at roughly the same rate as groundwater flow. Per Section 2725, Article 11, Title 23 of the California Code of Regulations, and the Regional Water Quality Control Board's (RWQCB) guidelines, you are required to delineate the lateral and vertical extent of this contaminant plume. Delineation of this plume needs to include any potential radial movement, in addition to the downgradient movement, of the plume and must include the assessment of any potential migration along utility line trenches along the streets. Utility line location, depth, and width information must be provided to this office for the adjacent streets.

Per RWQCB's guidelines, future MTBE analysis must be conducted using Method 8260. Additionally, all groundwater samples must also be analyzed for other potential oxygenates, other than MTBE, and potential lead scavengers: Tertiary Amyl Methyl Ether (TAME); Diisopropyl

Summary

Tina Berry
RE: 96 MacArthur Blvd.
Page 2 of 3
September 11, 1998

ether (DIPE); Ethyl Tertiary Butyl Ether (ETBE); Tertiary Butyl Alcohol (TBA); Ethylene DiBromide (EDB); and Ethylene DiChloride (EDC). All of these constituents can be identified using Method 8260. For the lead scavengers, Method 8010 may be used as well since it yields a lower detection limit. Additionally, the analysis for Semi-Volatile Organic Compounds must continue for the next phase of investigations in the area of the former waste oil tank (previously from Well MW-4). Since no Halogenated Volatile Organic compounds have been identified from groundwater samples collected from Well MW-4 in the last two years, no additional analyses for these constituents will be required.

After or in conjunction with the delineation of the contaminant plume, efforts must be made to contain any further migration of the MTBE plume. Efforts must be made to delineate the TPHG and BTEX plumes as well, unless you can show that these plumes have stabilized through the analysis of bioattenuation parameters (dissolved oxygen; oxidation-reduction potential; pH; conductivity, temperature, alkalinity, nitrates, sulfates, ferrous iron, methane, carbon dioxide, etc).

Per the RWQCB's guidelines, risk assessments are an essential tool in characterizing a site for closure and various land uses. This office is requesting that a risk assessment be conducted for the anticipated land use, which is a Quik Stop Market and Service Station. The risk assessment must show that there is no risk posed for this anticipated use prior to operations at the site. Additionally, if the contaminant plume has migrated beneath any of the adjacent residential homes, a risk assessment will most likely be needed for these potentially sensitive receptors.

The last groundwater monitoring report this office received was for the January 14, 1998 sampling event. The detection limits used in the analyses of these samples were unacceptably high (up to 20,000 ppb for TPHG). These high detection limits were due to dilutions in response to interference from the high MTBE concentrations. Per my conversation with Sequoia Analytical on September 11, 1998, there is a way of getting an accurate reading of the TPHG and BTEX concentrations and avoiding the dilutions if it is specifically requested with the submittal of the samples. All future groundwater samples must be analyzed in this way so that we can accurately characterize the plume.

A work plan addressing the above work must be submitted to this office within 45 days of the date of this letter. Field work must be implemented within 45 days after approval of the work plan. A report documenting the field work must be submitted to this office within 45 days after completing field activities. The report must include, but not be limited to, the following:

- o Details and results of all work performed during the designated period of time: records of field observations and data, boring and well construction logs, water level data, chain-of-custody forms, laboratory results for all samples collected and analyzed, tabulations of free product thicknesses and dissolved fractions, etc.

Tina Berry
Re: 96 MacArthur Blvd.
Page 3 of 3
September 11, 1998

- o Interpretations of results: water level contour maps showing gradients, free and dissolved product, plume definition maps for each target component, geologic cross sections, etc.
- o Recommendations or plans for additional investigative work or remediation.

Lastly, this office is currently unable to locate our files on the recent removal of the two 12,000-gallon underground storage tanks (USTs) and the one waste oil UST. Please submit copies of any documents/information you have on these recent tank removals, including the signed Tank Closure Plans, manifests, sample results, etc. Additionally, please submit a copy of the manifest for the waste oil tank that was removed from the site in 1992.

If you have any questions or comments, please contact me at (510) 567-6763.

Sincerely,

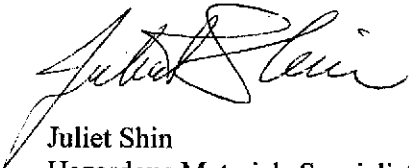

Juliet Shin
Hazardous Materials Specialist

Cc: Barbara Bee
17 Sotelo Avenue
Piedmont, CA 94611

Dick Mathews
TOSCO Marketing Co.
2000 Crow Canyon Place, Ste 400
San Ramon, CA 94583

Alameda County Environmental Health

1131 Harbor Bay Pkwy., #250
Alameda CA 94502-6577
Telephone (510) 567-6700 FAX (510) 337-9335

FACSIMILE COVER SHEET

TO: Tina Berry, 925-277-2361

FROM: Suliet Shin, Alameda County

DATE: 09/08/98

Total number of pages including cover sheet 4

-NOTES- Tina, here's a copy of my rough notes.
If possible, please bring a copy w/ you of all recent
tank removal analysis results & sampling locations -
I cannot find our tank removal files and neither
can Rob Weston, who oversaw removal. Thx.
See you on Sept 11. - Suliet

Notes

96 MacArthur

Specific yield $\cong n_e$ in an unconfined aquifer

$$S_{y \text{ sand}} \cong 10\% \cong n_e$$

$$K_{\text{silty sand}} \cong 10$$

$$\text{hydraulic grad.} = i \cong 0.04$$

$$\text{Seepage velocity} = v_s = \frac{K i}{n_e} = \frac{10 \text{ gpd/ft}^2 (0.04)}{.10} = 4 \text{ gpd/ft}^2$$

$$4 \text{ gpd/ft}^2 \left(\frac{0.134 \text{ ft/day}}{1 \text{ gpd/ft}^2} \right) = 0.54 \text{ ft/day} = \text{g.w. flow rate}$$

MTBE is thought to migrate at almost same rate as g.w.

Just my
best
estimate
of
potential
g.w. flow
rate.

1) Need to do site recon to determine ^{any} sensitive receptors in vicinity of site. (No apparent drinking water wells w/in 1,000 feet of the site. However, there is a ^{Glen Echo Creek} creek 1,000 feet west of the site).

2)
Per RWQCB guidelines → All groundwater wells will need to be analyzed for oxygenates, other than MTBE (tertiary amyl methyl ether (TAME); diisopropyl ether (DIPE); ethyl tertiary butyl ether (ETBE); and tertiary butyl alcohol (TBA)). All wells must also be analyzed for the lead scavengers EDB + EDC.
methyl tertian Butyl ether

- 3) Find out detailed history of site & whether gas tanks may have been located in different areas of the site in the past. How long has the site been a gas station? Since 1946. Before that, it was residential.
- 4) Were the two 12,000-gallon gas tanks removed? Yes
Call & talk to City of Oakland. It was apparent that these tanks were leaking. Even though they passed tank tightness tests, equipment is only good down to 0.1-0.2 gallons per hour detection. (Need to get copies of tank removal info for recent removals. Can't find file in our office).
- 5) Where is the waste oil tank manifest? For initial waste oil tank removal in 1992.
- * 6) Containment measures will most likely be required for both benzene & MTBE. GLE extraction can be used on MTBE and oxygen barriers promoting aerobic degradation or vapor extraction for benzene.
- 7) If plume has reached potentially sensitive receptors, a risk assessment will most likely be necessary.
- 8) Faculty will most likely need to assess stability of BTEX plume by analyzing for bioindicator parameters.
- 9) Monitoring for SVOCs must continue. Naphthalene level in Tier 1 is 27.
Continue SVOC analysis?

- 9) MTBE analysis must be conducted using 8260 analysis per guidelines
- 10) Utility line trench surveys must be conducted to guarantee that these trenches along MacArthur & Harrison are not acting as preferential flow paths.
- 11) It is fairly certain that plume has not yet stabilized due to increasing conc of benzene.
- 12) Discuss w/ Tosco the sudden anomalous drop in contaminant conc. in the 7/29/97 + 01/14/98 sampling events.
- 13) Plume will need to be completely delineated.

Note: According to Rob Weston, two gas tanks and a waste oil tank were recently removed from the site. The waste oil tank was ~~was~~ placed old waste oil tank which was removed in '92.

- 14) Get copies of tank removal info + all tank upgrade info.
- 15) Were VSTs '98 upgraded prior to removal
- Ask that Dick Matthews come out.



Tosco Marketing Company
2000 Crow Canyon Place, Ste. 400
San Ramon, California 94583
Telephone: 510-277-2305
Facsimile: 510-277-2361

Environmental Compliance
Department

December 31, 1997

Ms. Pamela Evans
Alameda County Health Care Services Agency
Environmental Health Services
1131 Harbor Bay Parkway, Suite 250
Alameda, California 94502-6577

RE: UNOCAL SS #1871
96 MacArthur Blvd.
Oakland, California
(Your Site #1120)

Dear Ms. Evans:

Thank you for your letter of December 23, 1997 regarding the subject location. Due to rising TPHg and MTBE concentrations in site wells, you have requested a work plan that proposes to investigate and correct releases of hydrocarbon contamination at the site.

Please be advised that Tosco is in the process of terminating our lease with the property owner and will subsequently be removing facility improvements. This will allow for possible coordination of remedial activities, such as source excavation and groundwater purging efforts, if necessary and if feasible. Standard sampling activities will take place during removal of the tanks, product lines and dispensers. A report documenting the results of these activities and the corresponding laboratory analytical testing will be submitted to your office approximately six weeks after completion of field activities. Following submittal of our tank closure report, we will evaluate the need for additional assessment and/or remedial actions. A work plan proposing a determined scope of work will be submitted to your office by March 31, 1998.

While I do not yet have a schedule for demolition activities, I understand the station will be closing by the end of 1997 (today) and construction work may likely be initiated by the end of January 1998 or early February 1998, pending contractor award and permit approvals.

I will be happy to meet with you to discuss this site and will keep you posted about the schedule of our anticipated activities. If you have any questions regarding this letter, please call me at 510-277-2321.

Sincerely,

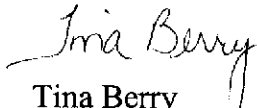
Tina Berry
Project Manager

cc: File (1871:3)
David Camille, TMC
David Vossler, Gettler-Ryan

ALAMEDA COUNTY
HEALTH CARE SERVICES

AGENCY

DAVID J. KEARS, Agency Director



December 23, 1997

ENVIRONMENTAL HEALTH SERVICES

ENVIRONMENTAL PROTECTION
1131 Harbor Bay Parkway, Suite 250
Alameda, CA 94502-6577
(510) 567-6700

Tina Berry
TOSCO
2000 Crow Canyon Place, Suite 400
San Ramon CA 94583

RE: Unocal Service Station #1871, 96 MacArthur Blvd., Oakland CA 94610 (Our site #1120)

Dear Ms. Berry:

Recently I assumed case review responsibility for the above referenced site from Jennifer Eberle. I have reviewed reports of groundwater monitoring as well as of tank system monitoring. The tank system monitoring reports do not indicate a leak in the tanks or piping. Nonetheless, groundwater monitoring data show that in the past year concentrations of methyl tertiary butyl ether (MTBE) have increased in three wells (MW-1, MW-2 and MW-5). Also, total petroleum hydrocarbons as gasoline (TPHg) have increased in MW-1 and MW-3. **This letter serves to notify TOSCO that further investigation is required to determine the source of the increasing MTBE and TPHg in groundwater.**

Please submit a work plan to investigate and correct releases of hydrocarbon contamination at the site. Please submit your **work plan to this Office by January 30, 1997**. Groundwater monitoring should continue and **should take place during the first and third quarters of the year**, at a minimum.

You may contact me with any questions about this letter at (510)567-5770.

Sincerely,

Pamela J. Evans
Senior Hazardous Materials Specialist



TOSCO MARKETING COMPANY

*Tina R. Berry
Project Manager
North Coast Region*

April 23, 1997

Distribution

SUBJECT: Project Transfers
Tosco - UNOCAL Asset Sale

Dear Agency Representative:

Due to the sale of UNOCAL operating assets to Tosco Corporation, there have been recent changes in project management assignments for fuel leak cases. Please be advised that I, as project manager, will be responsible for the handling of soil and groundwater investigation and reporting relating to petroleum releases on behalf of Tosco Marketing Company for the following California areas:

Alameda County
Santa Clara County
Santa Cruz County

San Benito County
Monterey County
San Luis Obispo County

This responsibility pertains to fuel releases primarily at *operating service station properties*. For most non-operating stations these responsibilities will continue to be managed by UNOCAL Corporation. The sale of assets is effective April 1, 1997 with the undersigned reporting to Mr. David J. Camille, Regional Director, Environmental Compliance in San Ramon, California.

Should you have any questions concerning this letter or cases involving fuel leak reporting and investigation at operating UNOCAL stations, please feel free to contact me at 510-277-2321. Additionally, I will be pleased to schedule a meeting to discuss the status and priority of existing fuel leak cases under your jurisdiction, as well as other relevant issues regarding the asset sale agreement discussed above. If you wish to meet with me, please call.

I look forward to working with you on my assigned projects.

Sincerely,
Tina Berry
Tina Berry
Project Manager

c: David Camille, Tosco Marketing Company

Distribution

Kevin Graves
California Regional Water Quality
Control Board-SF Bay Region
2101 Webster Street, Suite 500
Oakland, CA 94612

Harvey Packard
Frank DeMarco
California Regional Water Quality
Control Board-Central Coast
81 Higuera Street, Suite 200
San Luis Obispo, CA 93401-5427

Tom Peacock
Scott Seery
Juliet Shin
Eva Chu
Barney Chan
Jennifer Eberle
Madhulla Logan
Amy Leach
Alameda County Health Care
Services Agency
1131 Harbor Bay Parkway, 2nd floor
Alameda, CA 94502

Ted Tredhelme
Alameda County Water District
43885 S. Grimmer Blvd.
Fremont, CA 94537

Lorenzo Perez
City of Berkeley, Toxics Division
2065 Kittredge Street, Suite K
Berkeley, CA 94704

Hugh Murphy
Hayward Fire Department
25151 Clawiter Road
Hayward, CA 94545-2759

Clare E. Owen
San Jose Fire Department
4 N. Second Street, Suite 1100
San Jose, CA 95113-1305

Mark Holt
Cory Welch
Monterey County Health Dept.
1270 Natividad Road
Salinas, CA 93906

Stephen Baiocchi
Tim Epperson
Santa Cruz Health Services Agency
701 Ocean Street, Room 312
Santa Cruz, CA 95060

Michael McGee
San Luis Obispo County Health Agency
2191 Johnson Avenue
San Luis Obispo, CA 93401

Watsonville Fire Department
115 Second Street
Watsonville, CA 95076

Bay Area Air Quality Management District
939 Ellis Street
San Francisco, CA 94109

Eva Goodman
Monterey Bay Unified Air Pollution
Control District
24580 Silver Cloud Court
Monterey, CA 93490

Lane Davis (Camden Building)
Santa Clara Valley Water District
5750 Almaden Expressway
San Jose, CA 95118-3686

ALAMEDA COUNTY
HEALTH CARE SERVICES

AGENCY
DAVID J. KEARS, Agency Director



February 7, 1997
STID 1120
page 1 of 2

ENVIRONMENTAL HEALTH SERVICES
ENVIRONMENTAL PROTECTION (LOP)
1131 Harbor Bay Parkway, Suite 250
Alameda, CA 94502-6577
(510) 567-6700
FAX (510) 337-9385

Attn: Bob Boust
Unocal Corp.
PO Box 5155
San Ramon CA 94583

RE: Unocal SS#1871, 96 MacArthur Blvd., Oakland CA 94610

Dear Mr. Boust,

Since my last letter to you, dated 2/7/96, the following documents have been received in this office:

- 1) "Quarterly Data Report," prepared by MPDS, dated 2/12/96;
- 2) "Continuing Soil and Ground Water Investigation," prepared by MPDS, dated 5/17/96;
- 3) "Quarterly Data Report," prepared by MPDS, dated 5/16/96;
- 4) "Quarterly Data Report," prepared by MPDS, dated 8/27/96; and
- 5) "Quarterly Data Report," prepared by MPDS, dated 12/2/96.

It is interesting to note that the TPHg and benzene concentrations in MW3 and MW5 are an order of magnitude different, even though these wells are located approximately 20' away from each other. It is also noted that **MTBE concentrations are significant: up to 120,000 ppb on 7/24/96, and up to 84,000 ppb on 10/24/96. Please account for the MTBE in future reports.**

Lastly, it would be acceptable to decrease the sampling frequency from quarterly to bi-annually, due to the fairly consistent concentrations over 17 quarters of sampling. Please sample in the first and third quarters, for the same constituents.

If you have any questions, please contact me directly at 510-567-6761. You are encouraged to submit reports on double-sided paper in order to save trees.

February 7, 1997
STID 1120
page 2 of 2
Attn: Bob Boust

Sincerely,

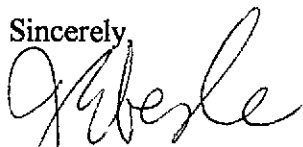

Jennifer Eberle
Hazardous Materials Specialist

cc: Haig Tejirian, Kaprealian Engineering, Inc., 2401 Stanwell Drive, Suite 400, Concord CA
94520
J. Eberle/file

je.1120-A

ALAMEDA COUNTY
HEALTH CARE SERVICES



AGENCY
DAVID J. KEARS, Agency Director

ARNOLD PERKINS, DIRECTOR

February 7, 1996
STID 1120

ALAMEDA COUNTY CC4580
ENVIRONMENTAL HEALTH SERVICES
1131 HARBOR BAY PKWY., #250
ALAMEDA CA 94502-6577

Attn: Bob Boust
Unocal Corp.
PO Box 5155
San Ramon CA 94583

RE: Unocal SS#1871, 96 MacArthur Blvd., Oakland CA 94610

Dear Mr. Boust,

I am in receipt of the "Work Plan/Proposal," prepared by Kaprealian Engineering, Inc., dated 12/7/95. As you know, this workplan involves the installation of two soil borings and two additional monitoring wells. As we discussed via telecon today, **the workplan is acceptable on the condition that MW5 be moved to a location approximately 25' Northwest of MW3.** In addition, the well sampling and monitoring frequency may be changed from quarterly to semi-annually (first and third quarters).

Field work should begin within 45 days, and a report should be submitted to this office within an additional 30 days. If you have any questions, please contact me at 510-567-6700, ext 6761; our fax number is 510-337-9335. You are encouraged to submit reports on double-sided paper in order to save trees.

Sincerely,

Jennifer Eberle
Hazardous Materials Specialist

cc: Tom Berkins, Kaprealian Engineering, Inc., 2401 Stanwell Drive, Suite 400, Concord CA
94520
Acting Chief/file

je.1120



DEPARTMENT OF ENVIRONMENTAL HEALTH
1131 Harbor Bay Parkway
Alameda, CA 94502-6577
(510) 567-6777

STID 1120

November 2, 1995

Mr. Robert A. Boust
UNOCAL
P. O. Box 5155
San Ramon, CA 94583

RE: UNOCAL SS#1871, 96 MACARTHUR BLVD., OAKLAND, CA 94610

Dear Mr. Boust:

This office is in receipt of and has completed review of the case file for this site, up to and including the August 15, 1995 MPDS Services, Inc., (MPDS) "Quarterly Data Report". Data collected during and since the May 1992 removal and replacement of two pump islands and the August 1994 removal and replacement of one 280-gallon waste oil underground storage tank (UST) has clearly identified that an unauthorized release of petroleum and fuel hydrocarbons has occurred at this site.

Groundwater monitoring data generated since November 3, 1992 has shown ground water gradient and flow direction to be in a southwesterly direction. Ground water samples collected from monitoring wells MW-1, MW-2 and MW-3 have consistently shown elevated concentrations of fuel hydrocarbons. The extent of the contamination has not yet been defined.

As referenced in the Kaprelian Engineering, Inc. (KEI) "Soil Sampling Report" dated September 13, 1994, sidewall soil sample WOSW2 documented concentrations of petroleum hydrocarbons left in place in the vicinity of the former 280-gallon underground waste oil tank. The concentrations detected in soil sample WOSW2 were 17,000 ppm-total oil & grease (TOG), 1,400 ppm-total petroleum hydrocarbons as diesel (TPHd), 960 ppm-total petroleum hydrocarbons as gasoline (TPHg), 2.2 ppm-benzene, 2.6 ppm-toluene, 9.5 ppm-ethyl benzene and 22 ppm-total xylenes. In addition, elevated levels of chlorinated hydrocarbons (EPA Method 8010) and polynuclear aromatics (EPA Method 8270) were detected in the sidewall soil sample WOSW2 collected approximately 9' below grade from beneath the former waste oil tank.

As referenced in the MPDS Services, Inc. "Quarterly Data Report" dated August 15, 1995, groundwater samples collected from monitoring well MW-1 have documented the highest levels of TPHg and BTEX fractions of the three on-site groundwater monitoring wells. The water sample collected from MW-1 for the July 24, 1995 sampling event detected 48,000 ppb-TPHg, 1,500 ppb-benzene, 420 ppb-toluene, 2,700 ppb-ethyl benzene and 9,700 ppb-total xylenes. In addition, a hydrocarbon sheen was noted for the groundwater sample collected from monitoring well MW-1 during the July 24, 1995 sampling event.

Mr. Robert Boust
RE: 96 MacArthur Boulevard, Oakland
November 2, 1995
Page 2 of 3

Pursuant to provisions of Article 11, Title 23, California Code of Regulations (CCR), you are required to perform an additional soil and water investigation (SWI) to define the extent of both soil and ground water contamination in the areas of the waste oil tank and the underground fuel tanks. Such work will likely entail the installation of additional soil borings and monitoring wells.

However, in order to pursue the pending SWI in a more cost-effective fashion, this office has requested that you first employ rapid site assessment tools (e.g. CPT, Geo Probe, Hydropunch, etc.) to qualitatively assess impacts before proposing final well locations. In addition, the removal of petroleum hydrocarbon contaminated soils to non-detect levels in the vicinity of the waste oil tank (sidewall soil sample WOSW2), would not require the installation of a groundwater monitoring well, if it could be determined that groundwater was not adversely impacted.

A SWI work plan must be submitted for review. This work plan is due 45 days of the date of this letter or by December 18, 1995. Work should commence no later than 30 days following receipt of an approved work plan.

A report must be submitted with 45 days of the completion of field activities associated with this phase of work at the site. Subsequent reports are to be submitted quarterly until this site qualifies for final RWQCB "sign off". The referenced reports must describe the status of the investigation and include, among other elements, the following.

- Details and results of all work performed during the designated reporting period: records of field observations and data boring and well construction logs, water level data, chain-of-custody forms, laboratory results for all samples collected and analyzed (including QA/QC data), tabulations of free product thicknesses and dissolved fractions, etc.
- Status of soil and ground water contamination and characterization
- Interpretation of results: water level contour maps showing gradients, free and dissolved product plume definition maps for each target compound, geologic cross sections, etc.
- Recommendations for additional work

All reports and proposals must be submitted under seal of a California-registered geologist or civil engineer with the appropriate environmental background. Please include a statement of qualifications for each lead professional involved with this project.

Please be advised that this is a formal request for technical reports pursuant to California Water Code Section 13267(b). Failure to respond may result in the referral of this case to the RWQCB for enforcement action.

Mr. Robert Boust
RE: 96 MacArthur Boulevard, Oakland
November 2, 1995
Page 3 of 3

Please also bear in mind that, in order to maintain SB2004 UST clean-up fund eligibility, specific bidding requirements and contracting criteria must be met. You are encouraged to contact the SWRCB fund representative (916/227-4529) for more case-specific information, or if you have not, as of yet, applied for financial assistance.

I have temporarily taken over management of this project from Jennifer Eberle of this office. Please feel free to call me at 510/567-6880, should you have any questions.

Sincerely,



Dale Klettke, CHMM
Hazardous Materials Specialist

c: Jun Makishima, Interim Director--files
Gil Jensen, Alameda County District Attorney's Office
Tom Berkins, Kaprelian Engineering, Inc., 2401 Stanwell Drive, Suite 400, Concord, CA
94520

1120swil.jet

HAZMAT
94 NOV 17 PM 2:48

UNOCAL 

*to Ken Oweant
Jim JE
11-18*

November 11, 1994

Alameda County Health Agency
1131 Harbor Bay Parkway
Alameda, CA 94502

RE: MONITOR IN ALARM
UNOCAL SERVICE STATION # 1871
96 MacArthur Blvd.
Oakland, CA 94610

Dear Inspector:

The Veeder Root TLS-350 monitor at the above referenced facility went into alarm on October 19, 1994. Enclosed, please find a completed work order from Unocal contractor Central Petroleum Maintenance, detailing corrective actions taken at this facility.

The monitor at this facility is now functioning properly. The operator of the facility has been advised to contact Unocal if any further problems arise.

Your cooperation and assistance regarding this matter is appreciated.

Should you have any questions, please call me at (714) 572-7653.

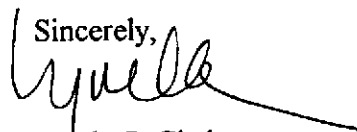
Sincerely,

Lynda S. Chalom
Leak Reporting Coordinator

LSC/sc

Enclosures

cc: Dealer
Territory Manager
RBU Manager
J.M. Tyson
D.M. Sobieski
J.W. Hayes
File

MEMORANDUM

DATE: October 20, 1994

TO: LOP staff

FROM: Scott Seery ⁴⁰⁷

SUBJ: BP Oil Company site review meetings

Attached please find a copy of the revised BP Oil bimonthly site review meeting schedule. Such meetings are a stipulation of the settlement between BP and the Alameda County District Attorney's Office. Please note that an additional site (highlighted) will be discussed at the November 16, 1994 meeting.

Please mark your calendars for the date upon which your sites will be discussed. Please be prepared to attend each meeting and be present an in-depth discussion regarding case status, such as:

- o whether BP is adhering to the respective "timeline-to-closure"
- o direction in which the project should proceed
- o appropriateness of target analytes and monitoring/sampling schedules (i.e., should they occur more or less frequently?)
- o whether BP is adhering to agency requests for specific tasks
- o what's needed to close case, etc., etc.

Please note that each meeting is scheduled to begin at 9:00 AM.

white -env.health
 yellow -facility
 pink -files

ALAMEDA COUNTY, DEPARTMENT OF ENVIRONMENTAL HEALTH

80 Swan Way, #200
 Oakland, CA 94621
 (415) 271-4320

Hazardous Materials Inspection Form

II, III

Site ID # _____ Site Name Unocal Today's Date 8/3/94

- II.A BUSINESS PLANS (Title 19)
- ___ 1. Immediate Reporting 2703
 - ___ 2. Bus. Plan Stds. 25503(b)
 - ___ 3. RR Cars > 30 days 25503.7
 - ___ 4. Inventory Information 25504(a)
 - ___ 5. Inventory Complete 2730
 - ___ 6. Emergency Response 25504(b)
 - ___ 7. Training 25504(c)
 - ___ 8. Deficiency 25505(a)
 - ___ 9. Modification 25505(b)

Site Address 96 MacArthur Blvd.
 City Oakland Zip 94610 Phone _____

- II.B ACUTELY HAZ. MATLS
- ___ 10. Registration Form Filed 25533(a)
 - ___ 11. Form Complete 25533(b)
 - ___ 12. RMPP Contents 25534(c)
 - ___ 13. Implement Sch. Req'd? (Y/N) _____
 - ___ 14. OffSite Conseq. Assess. 25524(c)
 - ___ 15. Probable Risk Assessment 25534(d)
 - ___ 16. Persons Responsible 25534(g)
 - ___ 17. Certification 25534(f)
 - ___ 18. Exemption Request? (Y/N) 25536(b)
 - ___ 19. Trade Secret Requested? 25538

- Inspection Categories:
- ___ I. Haz. Mat/Waste GENERATOR/TRANSPORTER
 - ___ II. Business Plans, Acute Hazardous Materials
 - III. Underground Tanks removal of waste oil UST

MAX AMT stored > 500 lbs, 55 gal., 200 cft.?

* Calif. Administration Code (CAC) or the Health & Safety Code (HS&C)

III. UNDERGROUND TANKS (Title 23)

- General
- ___ 1. Permit Application 25284 (H&S)
 - ___ 2. Pipeline Leak Detection 25292 (H&S)
 - ___ 3. Records Maintenance 2712
 - ___ 4. Release Report 2651
 - ___ 5. Closure Plans 2670

- Monitoring for Existing Tanks
- ___ 6. Method
 - 1) Monthly Test
 - 2) Daily Vadose Semi-annual groundwater One time soils
 - 3) Daily Vadose One time soils Annual tank test
 - 4) Monthly Gndwater One time soils
 - 5) Daily Inventory Annual tank testing Cont pipe leak det Vadose/gndwater mon.
 - 6) Daily Inventory Annual tank testing Cont pipe leak det
 - 7) Weekly Tank Gauge Annual tank testing
 - 8) Annual Tank Testing Daily Inventory
 - 9) Other _____
 - ___ 7. Precs Tank Test Date: _____ 2643
 - ___ 8. Inventory Rec. 2644
 - ___ 9. Soil Testing 2646
 - ___ 10. Ground Water. 2647

- New Tanks
- ___ 11. Monitor Plan 2632
 - ___ 12. Access. Secure 2634
 - ___ 13. Plans Submit Date: _____ 2711
 - ___ 14. As Built Date: _____ 2635

Comments:

11:10 arrived onsite.
 Larry James of OFD onsite.
 11:25 Removal of UST: tar wrapped, no obvious holes. Soil in pit is stained. ~80 gal waste oil was removed recently fm UST. UST hauled by Erickson under manifest # 93238754 Tank invert at 7' bgs. Excavated the green, odorous soil to 9' bgs. 12:25 Took bottom sample at ~9' bgs. Sample is clayey silt, green, w/slight HC odor.
 12:30 Continued excavating bottom + sides; they plan to install a new UST in same pit. The soil's odor is like gasoline; ^{does} not waste oil. 1:00 Took bottom sample at 14' bgs. This is the capillary fringe. Sample is moist, sandy silt w/gravel. 1:05 Began sampling the 4 walls at 9' bgs, which are also stained green + have gasoline odor. We don't want to disrupt the business any more by chasing the plume laterally; another well may be necessary. Stockpile is ~50 yd³ + will be properly sampled + disposed.

Rev 8/88
 12:25 left site

Contact: ROBERT FOUST
 Title: ST. ENV. ENG.
 Signature: Robert Foust

Inspector: Jennifer Eberle
 Signature: J Eberle

II, III

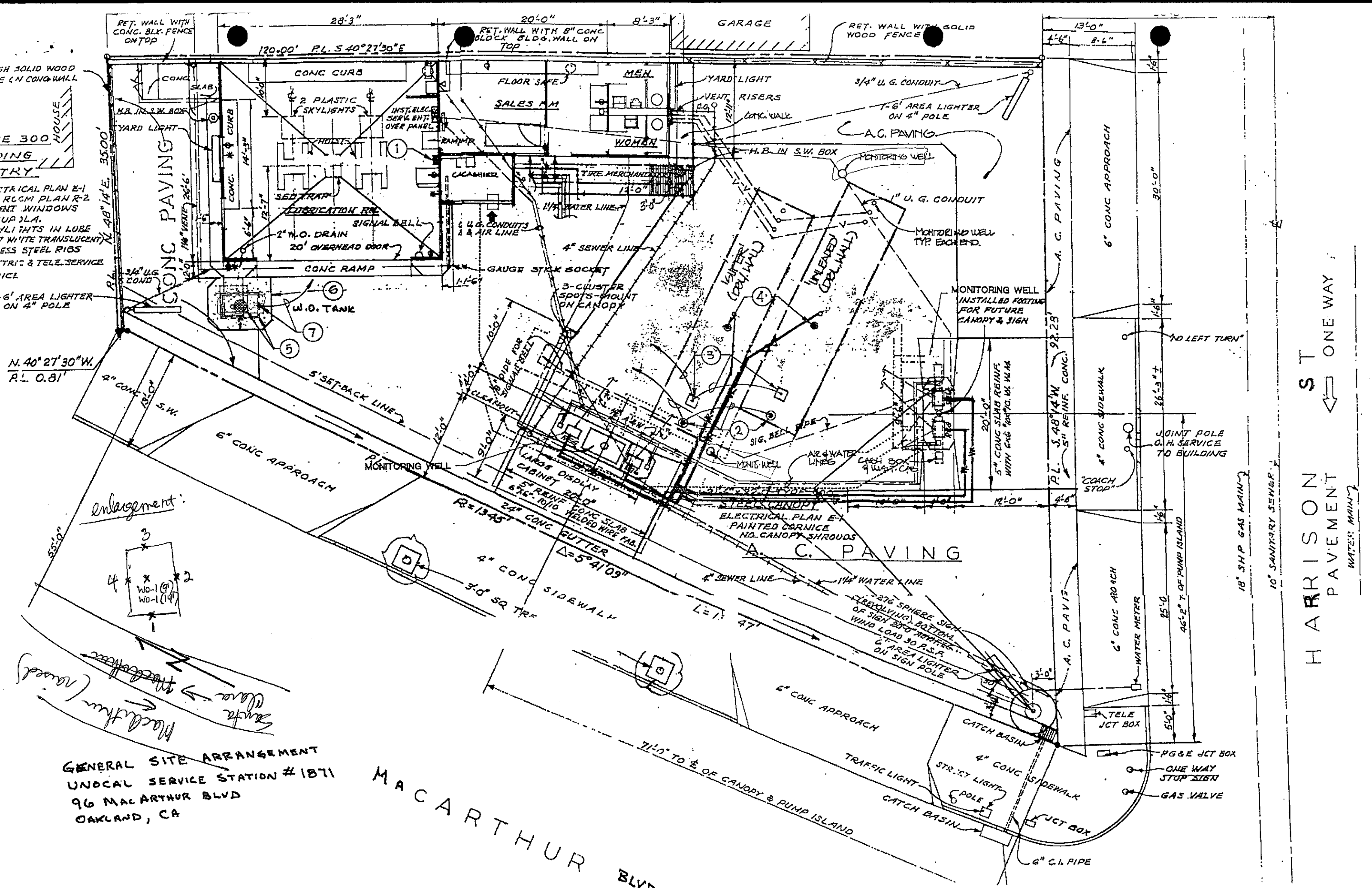

GENERAL SITE ARRANGEMENT
 UNOCAL SERVICE STATION # 1871
 96 MACARTHUR BLVD
 OAKLAND, CA

MACARTHUR BLVD

HARRISON ST
 ONE WAY

WATER MAIN

10" SANITARY SEWER

18" SH.P. GAS MAIN

WATER METER

TELE JCT BOX

PG&E JCT BOX

ONE WAY STOP SIGN

GAS VALVE

JCT BOX

CATCH BASIN

6" CL PIPE

TRAFFIC LIGHT

4" CONC SIDEWALK

6" CONC APPROACH

46'± T. OF PUMP ISLAND

25'-0"

5'-0"

1'-6"

1'-9"

1'-6"

1'-9"

1'-6"

1'-9"

1'-6"

1'-9"

1'-6"

1'-9"

1'-6"

1'-9"

1'-6"

1'-9"

1'-6"

1'-9"

1'-6"

1'-9"

1'-6"

1'-9"

1'-6"

1'-9"

1'-6"

1'-9"

1'-6"

1'-9"

1'-6"

TAIT & ASSOC. INC.
 2280 SUNRISE BOULEVARD, SUITE 208
 RANCHO CORDOVA, CA 95742
 (916) 635-2444

LETTER OF TRANSMITTAL

TO ALAMEDA CO HEALTH
1131 HARBOR BAY PARKWAY
ALAMEDA, CA 94501

DATE <u>JUNE 22</u>	JOB NO. <u>UN 1563</u>
ATTENTION <u>JENNIFER EBERLE</u>	
RE: <u>UNOCAL # 1871</u>	
<u>96 MAC ARTHUR BLVD</u>	
<u>OAKLAND</u>	
<u>Requested additional info</u>	

GENTLEMEN:

WE ARE SENDING YOU Attached Under separate cover via _____ the following items:

- Shop drawings Prints Plans Samples Specifications
 Copy of letter Change order _____

COPIES	DATE	NO.	DESCRIPTION
1	6-22		FORM A
1	6-21		FORM B WASTE OIL REMOVAL
1	6-21		FORM B WASTE OIL INSTALL

THESE ARE TRANSMITTED as checked below:

- For approval Approved as submitted Resubmit _____ copies for approval
 For your use Approved as noted Submit _____ copies for distribution
 As requested Returned for corrections Return _____ corrected prints
 For review and comment _____
 FOR BIDS DUE _____ 19____ PRINTS RETURNED AFTER LOAN TO US

REMARKS AS REQUESTED FROM STAN IVERSON, FORMS A+B
REFLECTING THE WASTE OIL TANK REPLACEMENT.

THE EPA NUMBER FOR THIS SITE IS CAD 982054413

COPY TO _____

SIGNED: [Signature]

If enclosures are not as noted, kindly notify us at once.

STATE OF CALIFORNIA
STATE WATER RESOURCES CONTROL BOARD
UNDERGROUND STORAGE TANK PERMIT APPLICATION - FORM A



COMPLETE THIS FORM FOR EACH FACILITY/SITE

MARK ONLY ONE ITEM	<input type="checkbox"/> 1 NEW PERMIT	<input type="checkbox"/> 3 RENEWAL PERMIT	<input checked="" type="checkbox"/> 5 CHANGE OF INFORMATION	<input type="checkbox"/> 7 PERMANENTLY CLOSED SITE
	<input type="checkbox"/> 2 INTERIM PERMIT	<input type="checkbox"/> 4 AMENDED PERMIT	<input type="checkbox"/> 6 TEMPORARY SITE CLOSURE	

I. FACILITY/SITE INFORMATION & ADDRESS - (MUST BE COMPLETED)

DBA OR FACILITY NAME UNOCAL SS # 1871		NAME OF OPERATOR DAVID KVOK			
ADDRESS 96 MACARTHUR BLVD		NEAREST CROSS STREET HARRISON ST	PARCEL # (OPTIONAL)		
CITY NAME OAKLAND		STATE CA	ZIP CODE 94610	SITE PHONE # WITH AREA CODE 510-655-3670	
<input checked="" type="checkbox"/> BOX TO INDICATE <input checked="" type="checkbox"/> CORPORATION <input type="checkbox"/> INDIVIDUAL <input type="checkbox"/> PARTNERSHIP <input type="checkbox"/> LOCAL-AGENCY DISTRICTS <input type="checkbox"/> COUNTY-AGENCY <input type="checkbox"/> STATE-AGENCY <input type="checkbox"/> FEDERAL-AGENCY					
TYPE OF BUSINESS <input checked="" type="checkbox"/> 1 GAS STATION <input type="checkbox"/> 2 DISTRIBUTOR <input type="checkbox"/> 3 FARM <input type="checkbox"/> 4 PROCESSOR <input type="checkbox"/> 5 OTHER		<input type="checkbox"/> IF INDIAN RESERVATION OR TRUST LANDS	# OF TANKS AT SITE 3	E. P. A. I. D. # (optional) CAD 982054413	

EMERGENCY CONTACT PERSON (PRIMARY)

EMERGENCY CONTACT PERSON (SECONDARY) - optional

DAYS: NAME (LAST, FIRST) KVOK DAVID		PHONE # WITH AREA CODE 510-655-3670		DAYS: NAME (LAST, FIRST)		PHONE # WITH AREA CODE	
NIGHTS: NAME (LAST, FIRST) CHOI CHU		PHONE # WITH AREA CODE 510 655-3670		NIGHTS: NAME (LAST, FIRST)		PHONE # WITH AREA CODE	

II. PROPERTY OWNER INFORMATION - (MUST BE COMPLETED)

NAME UNOCAL Corporation		CARE OF ADDRESS INFORMATION TONY QUIJALVO			
MAILING OR STREET ADDRESS 2000 CROW CANYON PLACE # 400		<input checked="" type="checkbox"/> box to indicate <input type="checkbox"/> INDIVIDUAL <input type="checkbox"/> LOCAL-AGENCY <input type="checkbox"/> STATE-AGENCY		<input type="checkbox"/> CORPORATION <input type="checkbox"/> PARTNERSHIP <input type="checkbox"/> COUNTY-AGENCY <input type="checkbox"/> FEDERAL-AGENCY	
CITY NAME SAN RAMON		STATE CA	ZIP CODE 94583	PHONE # WITH AREA CODE 510 277-2753	

III. TANK OWNER INFORMATION - (MUST BE COMPLETED)

NAME OF OWNER UNOCAL		CARE OF ADDRESS INFORMATION TONY QUIJALVO			
MAILING OR STREET ADDRESS 2000 CROW CANYON PLACE # 400		<input checked="" type="checkbox"/> box to indicate <input type="checkbox"/> INDIVIDUAL <input type="checkbox"/> LOCAL-AGENCY <input type="checkbox"/> STATE-AGENCY		<input type="checkbox"/> CORPORATION <input type="checkbox"/> PARTNERSHIP <input type="checkbox"/> COUNTY-AGENCY <input type="checkbox"/> FEDERAL-AGENCY	
CITY NAME SAN RAMON		STATE CA	ZIP CODE 94583	PHONE # WITH AREA CODE 510-277-2353	

IV. BOARD OF EQUALIZATION UST STORAGE FEE ACCOUNT NUMBER - Call (916) 323-9555 if questions arise.

TY (TK) HQ 44 - 000051

V. PETROLEUM UST FINANCIAL RESPONSIBILITY - (MUST BE COMPLETED) - IDENTIFY THE METHOD(S) USED

<input checked="" type="checkbox"/> box to indicate	<input type="checkbox"/> 1 SELF-INSURED	<input type="checkbox"/> 2 GUARANTEE	<input checked="" type="checkbox"/> 3 INSURANCE	<input type="checkbox"/> 4 SURETY BOND
	<input type="checkbox"/> 5 LETTER OF CREDIT	<input type="checkbox"/> 6 EXEMPTION	<input type="checkbox"/> 99 OTHER	

VI. LEGAL NOTIFICATION AND BILLING ADDRESS Legal notification and billing will be sent to the tank owner unless box I or II is checked.

CHECK ONE BOX INDICATING WHICH ABOVE ADDRESS SHOULD BE USED FOR LEGAL NOTIFICATIONS AND BILLING: I. II. III.

THIS FORM HAS BEEN COMPLETED UNDER PENALTY OF PERJURY, AND TO THE BEST OF MY KNOWLEDGE, IS TRUE AND CORRECT

APPLICANT'S NAME (PRINTED & SIGNATURE) CHESTER BENNETT	APPLICANT'S TITLE proj. mgr.	DATE MONTH/DAY/YEAR June 21, 94
--	--	---

LOCAL AGENCY USE ONLY

COUNTY # <input type="text"/>	JURISDICTION # <input type="text"/>	FACILITY # <input type="text"/>
LOCATION CODE - OPTIONAL	CENSUS TRACT # - OPTIONAL	SUPVISOR - DISTRICT CODE - OPTIONAL

STATE OF CALIFORNIA
STATE WATER RESOURCES CONTROL BOARD
UNDERGROUND STORAGE TANK PERMIT APPLICATION - FORM B



COMPLETE A SEPARATE FORM FOR EACH TANK SYSTEM.

MARK ONLY ONE ITEM	<input type="checkbox"/> 1 NEW PERMIT	<input type="checkbox"/> 3 RENEWAL PERMIT	<input checked="" type="checkbox"/> 5 CHANGE OF INFORMATION	<input type="checkbox"/> 7 PERMANENTLY CLOSED ON SITE
	<input type="checkbox"/> 2 INTERIM PERMIT	<input type="checkbox"/> 4 AMENDED PERMIT	<input type="checkbox"/> 6 TEMPORARY TANK CLOSURE	<input type="checkbox"/> 8 TANK REMOVED

DBA OR FACILITY NAME WHERE TANK IS INSTALLED: UNOCAL # 1871

I. TANK DESCRIPTION COMPLETE ALL ITEMS - SPECIFY IF UNKNOWN

A. OWNER'S TANK I.D. #	B. MANUFACTURED BY: <u>MODERN WELDING</u>
C. DATE INSTALLED (MO/DAY/YEAR) <u>JULY 1994</u>	D. TANK CAPACITY IN GALLONS: <u>520</u>

II. TANK CONTENTS IF A-1 IS MARKED, COMPLETE ITEM C.

A. <input type="checkbox"/> 1 MOTOR VEHICLE FUEL	<input checked="" type="checkbox"/> 4 OIL	B. <input type="checkbox"/> 1 PRODUCT	C. <input type="checkbox"/> 1a REGULAR UNLEADED	<input type="checkbox"/> 3 DIESEL	<input type="checkbox"/> 6 AVIATION GAS
<input type="checkbox"/> 2 PETROLEUM	<input type="checkbox"/> 80 EMPTY	<input checked="" type="checkbox"/> 2 WASTE	<input type="checkbox"/> 1b PREMIUM UNLEADED	<input type="checkbox"/> 4 GASAHOL	<input type="checkbox"/> 7 METHANOL
<input type="checkbox"/> 3 CHEMICAL PRODUCT	<input type="checkbox"/> 95 UNKNOWN		<input type="checkbox"/> 2 LEADED	<input type="checkbox"/> 5 JET FUEL	<input type="checkbox"/> 99 OTHER (DESCRIBE IN ITEM D. BELOW)

D. IF (A.1) IS NOT MARKED, ENTER NAME OF SUBSTANCE STORED WASTE OIL C. A. S. #:

III. TANK CONSTRUCTION MARK ONE ITEM ONLY IN BOXES A, B, AND C, AND ALL THAT APPLIES IN BOX D AND E

A. TYPE OF SYSTEM	<input checked="" type="checkbox"/> 1 DOUBLE WALL	<input type="checkbox"/> 3 SINGLE WALL WITH EXTERIOR LINER	<input type="checkbox"/> 95 UNKNOWN
	<input type="checkbox"/> 2 SINGLE WALL	<input type="checkbox"/> 4 SECONDARY CONTAINMENT (VAULTED TANK)	<input type="checkbox"/> 99 OTHER
B. TANK MATERIAL (Primary Tank)	<input checked="" type="checkbox"/> BARE STEEL	<input type="checkbox"/> 2 STAINLESS STEEL	<input type="checkbox"/> 3 FIBERGLASS
	<input type="checkbox"/> 5 CONCRETE	<input type="checkbox"/> 6 POLYVINYL CHLORIDE	<input checked="" type="checkbox"/> 4 STEEL CLAD W/ FIBERGLASS REINFORCED PLASTIC
	<input type="checkbox"/> 8 BRONZE	<input type="checkbox"/> 10 GALVANIZED STEEL	<input type="checkbox"/> 7 ALUMINUM
			<input type="checkbox"/> 8 100% METHANOL COMPATIBLE W/FRP
			<input type="checkbox"/> 99 OTHER
C. INTERIOR LINING	<input type="checkbox"/> 1 RUBBER LINED	<input type="checkbox"/> 2 ALKYD LINING	<input type="checkbox"/> 3 EPOXY LINING
	<input type="checkbox"/> 5 GLASS LINING	<input checked="" type="checkbox"/> 8 UNLINED	<input type="checkbox"/> 4 PHENOLIC LINING
	IS LINING MATERIAL COMPATIBLE WITH 100% METHANOL ? YES ___ NO ___		<input type="checkbox"/> 95 UNKNOWN
			<input type="checkbox"/> 99 OTHER
D. CORROSION PROTECTION	<input type="checkbox"/> 1 POLYETHYLENE WRAP	<input type="checkbox"/> 2 COATING	<input type="checkbox"/> 3 VINYL WRAP
	<input type="checkbox"/> 5 CATHODIC PROTECTION	<input type="checkbox"/> 91 NONE	<input type="checkbox"/> 4 FIBERGLASS REINFORCED PLASTIC
			<input checked="" type="checkbox"/> 95 UNKNOWN
			<input type="checkbox"/> 99 OTHER
E. SPILL AND OVERFILL	SPILL CONTAINMENT INSTALLED (YEAR) <u>94</u>		OVERFILL PREVENTION EQUIPMENT INSTALLED (YEAR) <u>94</u>

IV. PIPING INFORMATION CIRCLE A IF ABOVE GROUND OR U IF UNDERGROUND, BOTH IF APPLICABLE

A. SYSTEM TYPE	A U 1 SUCTION	A U 2 PRESSURE	A <u>U</u> 3 GRAVITY	A U 99 OTHER
B. CONSTRUCTION	A U 1 SINGLE WALL	A <u>U</u> 2 DOUBLE WALL	A U 3 LINED TRENCH	A U 95 UNKNOWN A U 99 OTHER
C. MATERIAL AND CORROSION PROTECTION	A U 1 BARE STEEL	A U 2 STAINLESS STEEL	A U 3 POLYVINYL CHLORIDE (PVC)	A <u>U</u> 4 FIBERGLASS PIPE
	A U 5 ALUMINUM	A U 6 CONCRETE	A U 7 STEEL W/ COATING	A U 8 100% METHANOL COMPATIBLE W/FRP
	A U 9 GALVANIZED STEEL	A U 10 CATHODIC PROTECTION	A U 95 UNKNOWN	A U 99 OTHER
D. LEAK DETECTION	<input type="checkbox"/> 1 AUTOMATIC LINE LEAK DETECTOR	<input type="checkbox"/> 2 LINE TIGHTNESS TESTING	<input checked="" type="checkbox"/> 3 INTERSTITIAL MONITORING	<input type="checkbox"/> 99 OTHER

V. TANK LEAK DETECTION

<input type="checkbox"/> 1 VISUAL CHECK	<input type="checkbox"/> 2 INVENTORY RECONCILIATION	<input type="checkbox"/> 3 VADOZE MONITORING	<input type="checkbox"/> 4 AUTOMATIC TANK GAUGING	<input type="checkbox"/> 5 GROUND WATER MONITORING
<input type="checkbox"/> 6 TANK TESTING	<input checked="" type="checkbox"/> 7 INTERSTITIAL MONITORING	<input type="checkbox"/> 91 NONE	<input type="checkbox"/> 95 UNKNOWN	<input type="checkbox"/> 99 OTHER

VI. TANK CLOSURE INFORMATION

1. ESTIMATED DATE LAST USED (MO/DAY/YR)	2. ESTIMATED QUANTITY OF SUBSTANCE REMAINING _____ GALLONS	3. WAS TANK FILLED WITH INERT MATERIAL ? YES <input type="checkbox"/> NO <input type="checkbox"/>
---	--	---

THIS FORM HAS BEEN COMPLETED UNDER PENALTY OF PERJURY, AND TO THE BEST OF MY KNOWLEDGE, IS TRUE AND CORRECT

APPLICANT'S NAME (PRINTED & SIGNATURE) <u>CHESTER BENNETT</u>	DATE <u>6-21-94</u>
--	------------------------

LOCAL AGENCY USE ONLY THE STATE I.D. NUMBER IS COMPOSED OF THE FOUR NUMBERS BELOW

STATE I.D.#	COUNTY #	JURISDICTION #	FACILITY #	TANK #
PERMIT NUMBER	PERMIT APPROVED BY/DATE	PERMIT EXPIRATION DATE		

STATE OF CALIFORNIA
STATE WATER RESOURCES CONTROL BOARD
UNDERGROUND STORAGE TANK PERMIT APPLICATION - FORM B



COMPLETE A SEPARATE FORM FOR EACH TANK SYSTEM.

MARK ONLY ONE ITEM	<input type="checkbox"/> 1 NEW PERMIT	<input type="checkbox"/> 3 RENEWAL PERMIT	<input type="checkbox"/> 5 CHANGE OF INFORMATION	<input type="checkbox"/> 7 PERMANENTLY CLOSED ON SITE
	<input type="checkbox"/> 2 INTERIM PERMIT	<input type="checkbox"/> 4 AMENDED PERMIT	<input type="checkbox"/> 6 TEMPORARY TANK CLOSURE	<input checked="" type="checkbox"/> 8 TANK REMOVED

DBA OR FACILITY NAME WHERE TANK IS INSTALLED: **UNOCAL 44 # 1871**

I. TANK DESCRIPTION COMPLETE ALL ITEMS - SPECIFY IF UNKNOWN

A. OWNER'S TANK I.D. # UNKNOWN	B. MANUFACTURED BY: UNKNOWN
C. DATE INSTALLED (MO/DAY/YEAR) UNKNOWN	D. TANK CAPACITY IN GALLONS: 280

II. TANK CONTENTS IF A-1 IS MARKED, COMPLETE ITEM C.

A. <input type="checkbox"/> 1 MOTOR VEHICLE FUEL	<input checked="" type="checkbox"/> 4 OIL	B. <input type="checkbox"/> 1 PRODUCT	C. <input type="checkbox"/> 1a REGULAR UNLEADED	<input type="checkbox"/> 3 DIESEL	<input type="checkbox"/> 6 AVIATION GAS
<input type="checkbox"/> 2 PETROLEUM	<input type="checkbox"/> 80 EMPTY	<input checked="" type="checkbox"/> 2 WASTE	<input type="checkbox"/> 1b PREMIUM UNLEADED	<input type="checkbox"/> 4 GASAHOL	<input type="checkbox"/> 7 METHANOL
<input type="checkbox"/> 3 CHEMICAL PRODUCT	<input type="checkbox"/> 95 UNKNOWN		<input type="checkbox"/> 2 LEADED	<input type="checkbox"/> 5 JET FUEL	<input type="checkbox"/> 99 OTHER (DESCRIBE IN ITEM D. BELOW)

D. IF (A.1) IS NOT MARKED, ENTER NAME OF SUBSTANCE STORED **WASTE OIL** C. A. S. #:

III. TANK CONSTRUCTION MARK ONE ITEM ONLY IN BOXES A, B, AND C, AND ALL THAT APPLIES IN BOX D AND E

A. TYPE OF SYSTEM	B. TANK MATERIAL (Primary Tank)	C. INTERIOR LINING	
<input type="checkbox"/> 1 DOUBLE WALL	<input type="checkbox"/> 1 BARE STEEL	<input type="checkbox"/> 1 RUBBER LINED	
<input checked="" type="checkbox"/> 2 SINGLE WALL	<input type="checkbox"/> 2 STAINLESS STEEL	<input type="checkbox"/> 2 ALKYD LINING	
<input type="checkbox"/> 3 SINGLE WALL WITH EXTERIOR LINER	<input checked="" type="checkbox"/> 3 FIBERGLASS	<input type="checkbox"/> 3 EPOXY LINING	
<input type="checkbox"/> 4 SECONDARY CONTAINMENT (VAULTED TANK)	<input type="checkbox"/> 4 STEEL CLAD W/ FIBERGLASS REINFORCED PLASTIC	<input type="checkbox"/> 4 PHENOLIC LINING	
<input type="checkbox"/> 5 CONCRETE	<input type="checkbox"/> 6 POLYVINYL CHLORIDE	<input type="checkbox"/> 5 GLASS LINING	
<input type="checkbox"/> 6 POLYVINYL CHLORIDE	<input type="checkbox"/> 7 ALUMINUM	<input type="checkbox"/> 6 UNLINED	
<input type="checkbox"/> 7 ALUMINUM	<input type="checkbox"/> 8 100% METHANOL COMPATIBLE W/FRP	<input checked="" type="checkbox"/> 95 UNKNOWN	
<input type="checkbox"/> 8 100% METHANOL COMPATIBLE W/FRP	<input type="checkbox"/> 99 OTHER	<input type="checkbox"/> 99 OTHER	
<input type="checkbox"/> 9 BRONZE	<input type="checkbox"/> 99 OTHER	IS LINING MATERIAL COMPATIBLE WITH 100% METHANOL? YES ___ NO ___	

D. CORROSION PROTECTION	E. SPILL AND OVERFILL	OVERFILL PREVENTION EQUIPMENT INSTALLED (YEAR) _____
<input type="checkbox"/> 1 POLYETHYLENE WRAP	SPILL CONTAINMENT INSTALLED (YEAR) _____	
<input type="checkbox"/> 2 COATING		
<input type="checkbox"/> 3 VINYL WRAP		
<input type="checkbox"/> 4 FIBERGLASS REINFORCED PLASTIC		
<input type="checkbox"/> 5 CATHODIC PROTECTION		
<input type="checkbox"/> 91 NONE		
<input checked="" type="checkbox"/> 95 UNKNOWN		
<input type="checkbox"/> 99 OTHER		

IV. PIPING INFORMATION CIRCLE A IF ABOVE GROUND OR U IF UNDERGROUND, BOTH IF APPLICABLE

A. SYSTEM TYPE	B. CONSTRUCTION	C. MATERIAL AND CORROSION PROTECTION	D. LEAK DETECTION
A U 1 SUCTION	A U 1 SINGLE WALL	A U 1 BARE STEEL	<input type="checkbox"/> 1 AUTOMATIC LINE LEAK DETECTOR
A U 2 PRESSURE	A U 2 DOUBLE WALL	A U 2 STAINLESS STEEL	<input type="checkbox"/> 2 LINE TIGHTNESS TESTING
A U 3 GRAVITY	A U 3 LINED TRENCH	A U 3 POLYVINYL CHLORIDE (PVC)	<input type="checkbox"/> 3 INTERSTITIAL MONITORING
A U 99 OTHER	A U 95 UNKNOWN	A U 4 FIBERGLASS PIPE	<input type="checkbox"/> 99 OTHER
	A U 99 OTHER	A U 5 ALUMINUM	
		A U 6 CONCRETE	
		A U 7 STEEL W/ COATING	
		A U 8 100% METHANOL COMPATIBLE W/FRP	
		A U 9 GALVANIZED STEEL	
		A U 10 CATHODIC PROTECTION	
		A U 95 UNKNOWN	
		A U 99 OTHER	

V. TANK LEAK DETECTION

<input type="checkbox"/> 1 VISUAL CHECK	<input type="checkbox"/> 2 INVENTORY RECONCILIATION	<input type="checkbox"/> 3 VADOZE MONITORING	<input type="checkbox"/> 4 AUTOMATIC TANK GAUGING	<input type="checkbox"/> 5 GROUND WATER MONITORING
<input type="checkbox"/> 6 TANK TESTING	<input type="checkbox"/> 7 INTERSTITIAL MONITORING	<input checked="" type="checkbox"/> 91 NONE	<input type="checkbox"/> 95 UNKNOWN	<input type="checkbox"/> 99 OTHER

VI. TANK CLOSURE INFORMATION

1. ESTIMATED DATE LAST USED (MO/DAY/YR)	2. ESTIMATED QUANTITY OF SUBSTANCE REMAINING _____ GALLONS	3. WAS TANK FILLED WITH INERT MATERIAL? YES <input type="checkbox"/> NO <input type="checkbox"/>
---	--	--

THIS FORM HAS BEEN COMPLETED UNDER PENALTY OF PERJURY, AND TO THE BEST OF MY KNOWLEDGE, IS TRUE AND CORRECT

APPLICANT'S NAME (PRINTED & SIGNATURE) CHESTER BENNETT	DATE 6-21-94
--	------------------------

LOCAL AGENCY USE ONLY THE STATE I.D. NUMBER IS COMPOSED OF THE FOUR NUMBERS BELOW

STATE I.D.#	COUNTY #	JURISDICTION #	FACILITY #	TANK #
PERMIT NUMBER	PERMIT APPROVED BY/DATE		PERMIT EXPIRATION DATE	

THIS FORM MUST BE ACCOMPANIED BY A PERMIT APPLICATION - FORM A, UNLESS A CURRENT FORM A HAS BEEN FILED.
FILE THIS FORM WITH THE LOCAL AGENCY IMPLEMENTING THE UNDERGROUND STORAGE TANK REGULATIONS

6. Contractor GETTLER- RYAN INC checked 6-22-94:
current + active
exp. 5-31-95
Address 6747 SIERRA CT, STE J
City DUBLIN - 94568 Phone (510) 551-7555
License Type* HAZ A ID# 220 793

*Effective January 1, 1992, Business and Professional Code Section 7058.7 requires prime contractors to also hold Hazardous Waste Certification issued by the State Contractors License Board. Indicate that the certificate has been received, in addition, to holding the appropriate contractors license type.

7. Consultant GEQUODIA ANALYTICAL
Address 1900 BATES AVE, ste L.M
City Concord Phone 510-686 9600

8. Contact Person for Investigation
Name _____ Title _____
Phone 510-686-9600

9. Number of tanks being closed under this plan ONE
Length of piping being removed under this plan NONE
Total number of tanks at facility 3

10. State Registered Hazardous Waste Transporters/Facilities (see instructions).

** Underground tanks are hazardous waste and must be handled **
as hazardous waste

a) Product/Residual Sludge/Rinsate Transporter
Name ERICKSON, INC EPA I.D. No. CAD 009446392
Hauler License No. 0019 License Exp. Date 5-95
Address 255 PARR Ave
City Richmond State CA Zip 94801

Erickson

b) Product/Residual Sludge/Rinsate Disposal Site
Name ERICKSON, INC EPA I.D. No. CAD 009446392
Address 255 PARR Ave
City Richmond State CA Zip 94801

Erickson

c) Tank and Piping Transporter

Name ERICKSON, INC EPA I.D. No. CAD 009466392
Hauler License No. ~~1271 ELAB~~ 0019 License Exp. Date 5-95
Address 255 PARR BLVD
City CONCORD State CA Zip 94520

d) Tank and Piping Disposal Site

Name ERICKSON, INC EPA I.D. No. CAD 009466392
Address 255 PARR BLVD
City CONCORD State CA Zip 94520

11. Experienced Sample Collector

Name KAPREALIAN ENGINEERING HAIG KEZORK
Company _____
Address 2401 STANWELL DRIVE Ste 400
City CONCORD State CA Zip 94520 Phone 510-602-5104

12. Laboratory

Name SEQUOIA ANALYTICAL
Address 1900 BATES AVE Ste LM
City CONCORD State CA Zip 94520
State Certification No. DOHS # 1271 ELAB

13. Have tanks or pipes leaked in the past? Yes [] No [X]

If yes, describe. _____

14. Describe methods to be used for rendering tank inert

TRIPLE Rinse WASH

CO₂ 1.5 lb dry ice per 100 gal

UST

Before tanks are pumped out and inerted, all associated piping must be flushed out into the tanks. All accessible associated piping must then be removed. Inaccessible piping must be plugged.

The Bay Area Air Quality Management District (771-6000), along with local Fire and Building Departments, must also be contacted for tank removal permits. Fire departments typically require the use of explosion proof combustible gas meters to verify tank inertness. It is the contractor's responsibility to bring a working combustible gas meter on site to verify tank inertness.

15. Tank History and Sampling Information

Tank		Material to be sampled (tank contents, soil, ground-water, etc.)	Location and Depth of Samples
Capacity	Use History (see instructions)		
200 GAL	WASTE OIL	SOIL	2 ft Below tank Bottom

One soil sample must be collected for every 20 feet of piping that is removed. A ground water sample must be collected should any ground water be present in the excavation.

Excavated/Stockpiled Soil	
Stockpiled Soil Volume (Estimated) 30 yds	Sampling Plan 1 Composite Sample

Stockpiled soil must be placed on bermed plastic and must be completely covered by plastic sheeting.

16. Chemical methods and associated detection limits to be used for analyzing samples

The Tri-Regional Board recommended minimum verification analyses and practical quantitation reporting limits should be followed. See attached Table 2.

Contaminant Sought	EPA, DHS, or Other Sample Preparation Method Number	EPA, DHS, or Other Analysis Method Number	Method Detection Limit
WASTE OIL	TPH G TPH D TPH A BTXE O+G CLHC ICAP METALS Cd, Cr, Pb, Zn, Ni semi VOCs	8260 5520 ✓ 8010 ✓ 8270 ✓	

17. Submit Site Health and Safety Plan (See Instructions)

18. Submit Worker's Compensation Certificate copy ON FILE

Name of Insurer TRANS AMERICA

19. Submit Plot Plan (See Instructions) with Installation PERMIT

20. Enclose Deposit (See Instructions)-

21. Report any leaks or contamination to this office within 5 days of discovery. The report shall be made on an Underground Storage Tank Unauthorized Leak/Contamination Site Report form. (see Instructions)

22. Submit a closure report to this office within 60 days of the tank removal. This report must contain all the information listed in item 22 of the instructions.

I declare that to the best of my knowledge and belief the statements and information provided above are correct and true.

I understand that information in addition to that provided above may be needed in order to obtain an approval from the Department of Environmental Health and that no work is to begin on this project until this plan is approved.

I understand that any changes in design, materials or equipment will void this plan if prior approval is not obtained.

I understand that all work performed during this project will be done in compliance with all applicable OSHA (Occupational Safety and Health Administration) requirements concerning personnel health and safety. I understand that site and worker safety are solely the responsibility of the property owner or his agent and that this responsibility is not shared nor assumed by the County of Alameda.

Once I have received my stamped, accepted closure plan, I will contact the project Hazardous Materials Specialist at least three working days in advance of site work to schedule the required inspections.

Signature of Contractor

Name (please type) BARRY E. MC COY , GETTLER-RYAN INC

Signature *Barry E. McCoy*

Date 6-15-94

Signature of Site Owner or Operator

Name (please type) CHESTER BENNETT w/Tait Assoc.

Signature *CHESTER BENNETT*

Date June 2nd 94

Tait is Unocal's consulting engineer



GETTLER - RYAN INC.

SITE SAFETY PLAN, JOB

SITE: Company: UNOCAL Corporation #1871
 Location: 96 MacArthur Boulevard
 City: Oakland, CA

PLAN PREPARED BY: Gettler-Ryan Inc. DATE: 6/15/94

OBJECTIVES: To provide a plan for the safe completion of the site work.

PROPOSED DATE OF SITE
WORK: 6/27/94

DOCUMENTATION/
SUMMARY: Hazardous material may be present, caution is advised.
 Site work includes removal/installation of one waste oil tank
 and installation of a Veeder Root TLS-350 gasoline
 monitoring system.

SITE/WASTE CHARACTERISTICS:

WASTE TYPE(S):	Liquid	Solid	Gas
CHARACTERISTIC(S):	Volatile	Flammable	Toxic
FACILITY DESCRIPTION:	Gasoline service station with underground utilities		
STATUS:	Active		

HAZARD EVALUATION

PARAMETER: TLV 300 ppm THC

HEALTH: ingestion, inhalation, absorption

LEL 10% Gastehtor max.

SPECIAL PRECAUTIONS
AND COMMENTS: Correct safety procedures must be followed, per Gettler-
 Ryan Inc. Health and Safety Plan. UGST to be inerted per
 BAAQMD guidelines (Reg.8, Section 30) 30 lbs. of dry ice
 to be placed in tank prior to removal.

SITE SAFETY WORKPLAN

PERIMETER ESTABLISHMENT:

Use barricades and flagging to restrict access to tank removal area and gasoline UGST work area. Tank excavation to be fenced while hole is open.

PERSONAL PROTECTION:

Level of Protection EPA Level D
Modifications: Rubber gloves, hard hats and red vests.
Surveillance Equipment and Material: Gastech

SITE ENTRY PROCEDURES:

None

DECONTAMINATION PROCEDURES:

Personnel: Wash thoroughly with detergent solution and water

Equipment: Steam clean if necessary

FIRST AID:

As applicable

WORK LIMITATIONS

(Time of day, weather, heat/cold stress): none.

INVESTIGATION-DERIVED MATERIAL DISPOSAL:

Tank and lines to be manifested and hauled by Erickson, Inc. All materials removed from tank hole to be sampled, placed on visqueen on site and covered until classified for proper disposal.

TEAM COMPOSITION:

Jim Reed - Job Foreman, Site Safety Officer
1 Laborers
1 Operator
1 Field Technician from GeoTech Co.

EMERGENCY INFORMATION

LOCAL RESOURCES:

Ambulance/Hospital	Dial 911
Police/Sheriff/Hwy Patrol	Dial 911
Fire Department	Dial 911

SITE RESOURCES:

Water Supply
Telephone
Visqueen
Fire Extinguisher
First Aid Kit
Sorbant Pads

EMERGENCY CONTACT:

Gettler-Ryan Inc. (510) 551-7555

EMERGENCY ROUTES:

Nearest emergency hospital is:

Kaiser Medical Center
280 W. MacArthur Boulevard
Oakland, CA
(510) 596-7600

MAP ATTACHED

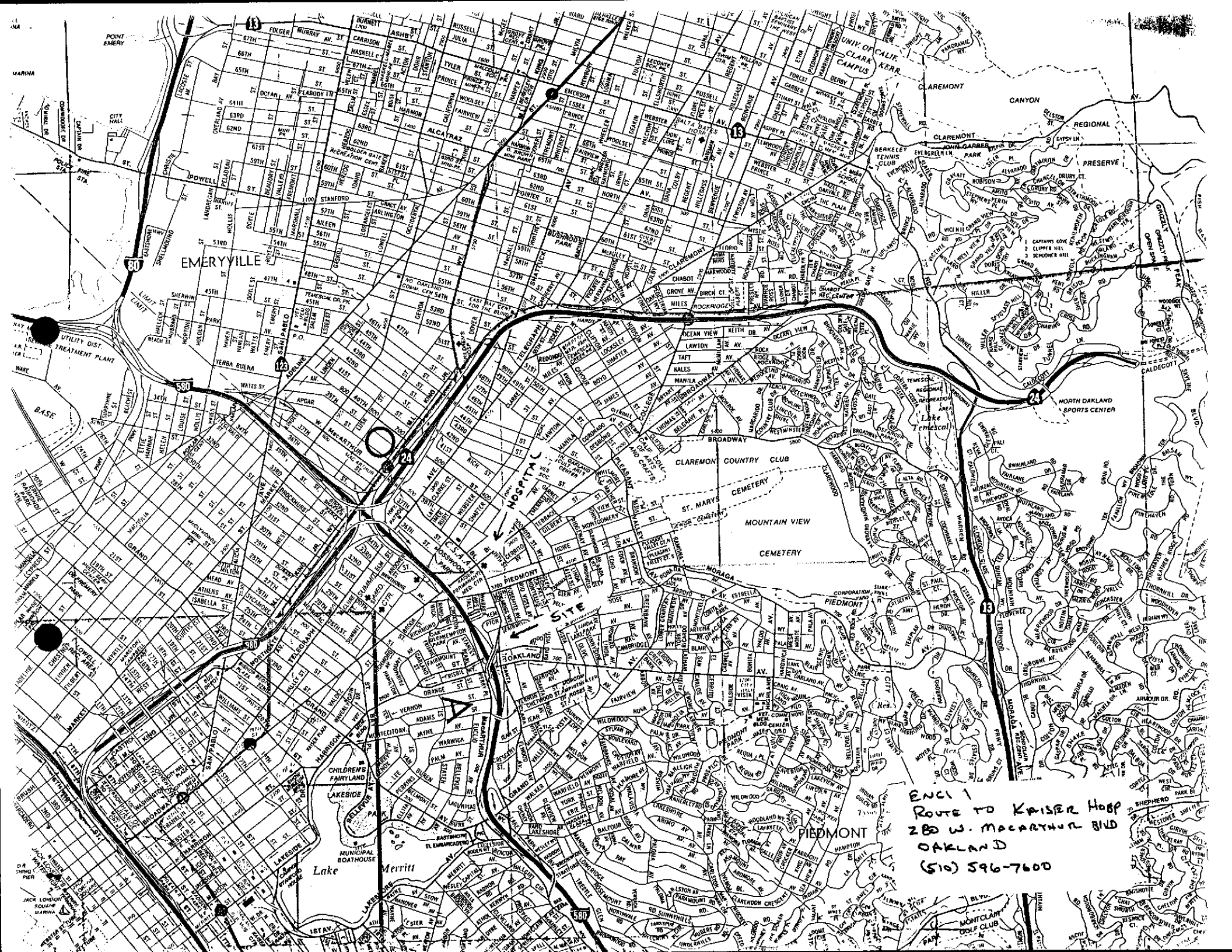

EMERYVILLE

ENC 1
Route to Kaiser Hopp
280 W. MacArthur Blvd
OAKLAND
(510) 596-7600

SITE

OAKLAND

PIEDMONT

Lake Merritt

Lake Temescal

CLAREMONT COUNTRY CLUB

ST. MARYS CEMETERY

GRACE CEMETERY

MOUNTAIN VIEW CEMETERY

PIEDMONT

PIEDMONT

PIEDMONT

PIEDMONT

PIEDMONT

PIEDMONT

PIEDMONT

PIEDMONT

PIEDMONT

PIEDMONT

PIEDMONT

PIEDMONT

PIEDMONT

POINT EMERY
MARINA
CITY HALL
UTILITY DIST.
TREATMENT PLANT
BASE

UNIVERSITY OF CALIF. CLARK KERR CAMPUS

CLAREMONT
CANYON
REGIONAL PRESERVE

CLAREMONT
EVERGREEN PARK
BERKELEY TENNIS CLUB

CLAREMONT
MOUNTAIN VIEW
CEMETERY

CLAREMONT
MOUNTAIN VIEW
CEMETERY

CLAREMONT
MOUNTAIN VIEW
CEMETERY

CLAREMONT
MOUNTAIN VIEW
CEMETERY

CLAREMONT
MOUNTAIN VIEW
CEMETERY

CLAREMONT
MOUNTAIN VIEW
CEMETERY

LOP - RECORD CHANGE REQUEST FORM

printed:
06/21/93

Mark Out What Needs Changing and Hand to LOP Data Entry
(Name/Address changes go to Annual Programs Data Entry)

AGENCY # : 10000 SOURCE OF FUNDS: F
StID : 1120
SITE NAME: Unocal SS#1871
ADDRESS : 96 MacArthur Blvd.
CITY/ZIP : Oakland 94610

SUBSTANCE: 8006619
DATE REPORTED : 05/14/92
DATE CONFIRMED: 05/14/92
MULTIPLE RPs : N

SITE STATUS

CASE TYPE: S	CONTRACT STATUS: 4	EMERGENCY RESP:
RP SEARCH: S		DATE COMPLETED: 07/08/92
PRELIMINARY ASMNT:	DATE UNDERWAY:	DATE COMPLETED:
REM INVESTIGATION:	DATE UNDERWAY:	DATE COMPLETED:
REMEDIAL ACTION:	DATE UNDERWAY:	DATE COMPLETED:
POST REMED ACT MON:	DATE UNDERWAY:	DATE COMPLETED:
ENFORCEMENT ACTION TYPE: 1	DATE ENFORCEMENT ACTION TAKEN: 07/08/92	
LUFT FIELD MANUAL CONSID:		DATE CASE CLOSED:
CASE CLOSED:	REMEDIAL ACTIONS TAKEN:	
DATE EXCAVATION STARTED :		

RESPONSIBLE PARTY INFORMATION

RP#1-CONTACT NAME: Robert Boust
COMPANY NAME: Unocal
ADDRESS: P O Box 5155
CITY/STATE: San Ramon C A 94583

INSPECTOR VERIFICATION:

NAME _____	SIGNATURE _____	DATE _____
------------	-----------------	------------

DATA ENTRY INPUT:

Name/Address Changes Only

Case Progress Changes

ANPPGMS _____ LOP _____ DATE _____

LOP _____ DATE _____

FILE OR ENVELOPE
 PER NO. No. of
 OWNER Unocal #1871
 Address 96 MacArthur Blvd
 Oak 94610 Phone
 Contractor Bob Boust - Unocal
 Address 277-2334
 Phone
 OTHER (Specify) Rowx Assoc.
 Address Paul Supple
 Phone 602-2333
 CONTACT FOR INVESTIGATION

PLAN REVIEW	By	Date	By	Date	By	Date
\$ Rec'd.						
No. Plans Rec'd.						
Plans Approved						
Layout Made						
Rejected						
Applicant Notified						
Plans Returned						
Permit Issued						
CONSTRUCTION PROGRESS ACCEPTANCE						
Pre-Plaster/drywall						
Pre-Final						
Final						
Pre-Complete/Unit						
Pre-Plaster						
Final						
Septic Tank						
Absorption Field						
Absorption Bed						
Other						

LOP 1120 C →

ROOM 455

XR KEI 602-5100 Hagop
 602-5112 Tom Berkins

REMARKS

Date	By	REMARKS
3-22-93	JE	Rev'd QR by GSI dated 3-8-93. Gw flows W. Gw samples collected on 1-25-93 have up to 120,000 ppb TPH-g + 2100 ppb benz (MW1). These levels represent a ↓. UG well (MW1) still has highest levels. Strange.

REMARKS

Date	By	REMARKS
		Up to 100,000 ppb TPH-g (MW1) + 1700 ppb benz (MW3) on 4-29-93. Again, UG well MW1 has highest []s of TPH-g. MW3 had a substantial ↑ in []s.
10-6	JE	Reviewed 8-27-93 QR by GSI. gw flowed SW on 7-16. Up to 29,000 ppb TPHg (MW1) + 1100 ppb benz (MW3) on 7-16. TPHg + benz levels ↓ in all 3 MWs.

2-22-94 Reviewed 12-16-93 QR by MPDS. gw flowed SW on 10-19-93. Concs. in MW1 + 2 increased, while MW3 dec. UG MW1 has highest hits (67,000 ppb TPHg + 1400 ppb benz).

See inside notes

6-78 JE Reviewed 6-17-93 QR by GSI. Gw flows SW.

ALAMEDA COUNTY, DEPARTMENT OF ENVIRONMENTAL HEALTH

80 Swan Way, #200
Oakland, CA 94621
(415) 271-4320

TB1026
Exp. 12/28/87

Hazardous Materials Division Inspection Form

Site ID# 1120 Site Name David Chu Unocal Today's Date 12/16/92
 Site Address 96 Mac Arthur Blvd EPA ID# _____
 City Oakland Zip 94611 Phone 655-3677

MAX Amt. Stored > 500lbs/55g/200cf? Y N
 Hazardous Waste generated per month? _____

Inspection Categories:

- I. Haz. Mat/Waste GENERATOR/TRANSPORTER
- II. Business Plans, Acute Hazardous Materials
- III. Underground Tanks

The marked items represent violations of the Calif. Administration Code (CAC) or the Health & Safety Code (HS&C)

LA GENERATOR (Title 22)

- | | | |
|-------------------|-----------------------------|---------|
| Manifest | 1. Waste ID | * 66471 |
| | 2. EPA ID | 66472 |
| | 3. > 90 days | 66508 |
| | 4. Label dates | 66508 |
| | 5. Biennial | 66493 |
| Manifest | 6. Records | 66492 |
| | 7. Correct | 66484 |
| | 8. Copy sent | 66492 |
| | 9. Exception | 66484 |
| | 10. Copies Rec'd | 66492 |
| Misc. | 11. Treatment | 66371 |
| | 12. On-site Disp. (H.S.&C.) | 26189.5 |
| | 13. Ex Haz. Waste | 66570 |
| Prevention | 14. Communications | 67121 |
| | 15. Aisle Space | 67124 |
| | 16. Local Authority | 67126 |
| | 17. Maintenance | 67120 |
| | 18. Training | 67105 |
| Contingency | 19. Prepared | 67140 |
| | 20. Name List | 67141 |
| | 21. Copies | 67141 |
| | 22. Emg. Coord. Trng. | 67144 |
| Containers, Tanks | 23. Condition | 67241 |
| | 24. Compatibility | 67242 |
| | 25. Maintenance | 67243 |
| | 26. Inspection | 67244 |
| | 27. Buffer Zone | 67246 |
| | 28. Tank Inspection | 67259 |
| | 29. Containment | 67245 |
| | 30. Safe Storage | 67261 |
| | 31. Freeboard | 67257 |

Comments:

Underground Tank inspection with Unocal's Representative Bruce Hutter. Purpose of visit is to assess leak monitoring method(s) for compliance to Title 23 C.C.R.. Observed three monitoring wells which indicate site may be contaminated from fuel storage / sales (in past). It looks like two single walled fuel tanks and a single-walled waste oil tank are on site. Piping and dispensers are new. Piping appears to be run inside of a liner from dispensers' bravo box to an unknown point. There are 2 sensors at the ends of the pump islands. Plans are needed to determine how piping is constructed. Test of sensors conducted demonstrating alarm is working. Four sensors total wired to a Leak Alert (AOR) Box. Flow restrictors tested to be operational. However the unleaded tank restrictor may not identify small leaks, it should be replaced. You must conduct inventory reconciliation and yearly integrity testing as your monitoring method.

LB TRANSPORTER (Title 22)

- | | | |
|----------|---------------------------|-------|
| Manifest | 32. Applic./Insurance | 66428 |
| | 33. Comp. Cert./CHP Insp. | 66448 |
| | 34. Containers | 66465 |
| Manifest | 35. Vehicles | 66465 |
| | 36. EPA ID #s | 66531 |
| | 37. Correct | 66541 |
| | 38. HW Delivery | 66543 |
| | 39. Records | 66544 |
| Cont'n's | 40. Name/ Covers | 66545 |
| | 41. Recyclables | 66800 |

Rev 6/88

Contact: _____
 Title: _____
 Signature: [Signature]

Inspector: _____
 Signature: Kevin Trasley

92 DEC 1 12:30

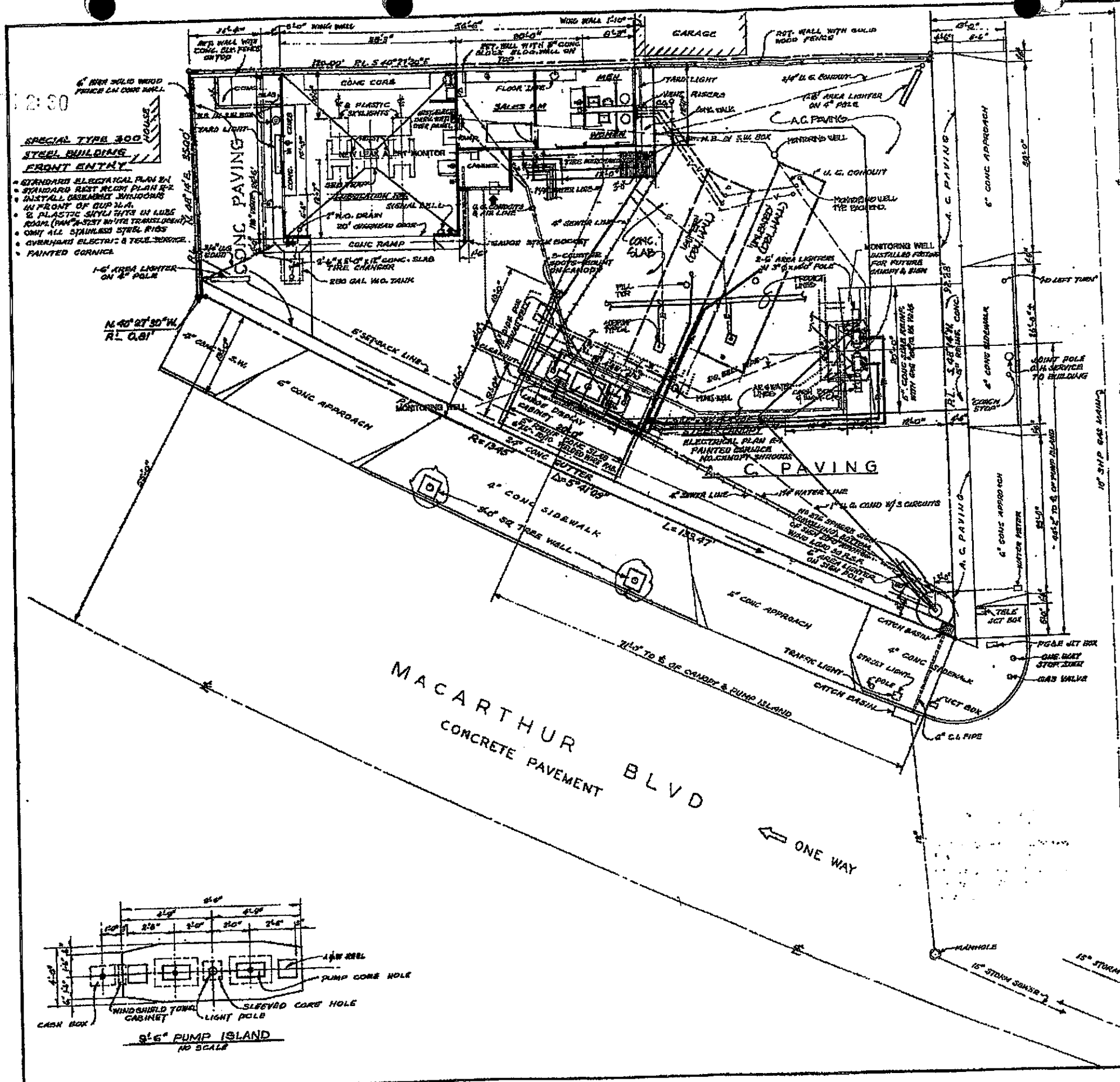

- SPECIAL TYPE 300 STEEL BUILDING FRONT ENTRY**
- STANDARD ELECTRICAL PLAN EX
 - STANDARD REST ROOM PLAN EX
 - INSTALL CASHEMOUNT WINDOWS IN FRONT OF SUPPLY
 - 2 PLASTIC SHUTTERS IN LUBE ROOM (1/2" x 1/2" WHITE TRANSPARENT)
 - OMIT ALL STAINLESS STEEL FIBS
 - OVERHEAD ELECTRIC & TELE SERVICE
 - PAINTED CORNICE

- LEGEND**
- ELECTRICAL LINES
 - PRODUCT LINES
 - VAPOR LINES
 - WATER LINES
 - PRICE SIGN

DATE	REVISED	BY	CHKD
6-29-63	RECONSTRUCTION UNDERGROUND FACILITIES		
6-29-63	INSTALLED AS SHOWN		
6-29-63	ADDED 12" WIDE FLOOR OPENINGS TO TANKS		
6-29-63	TANK INSTALLATION (2-1/2" DIA) CONC. CLAD		
5-2-60	ADDED CASHIER RM + EXTEND EXIST. CONC. WALK		
7-22-62	UNDERGROUND UTILITY PROVD AS BUILT		

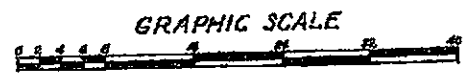

PROPERTY LEASED BY UNION OIL COMPANY BOUNDED THUS

SEE GA 1871 FOR PREVIOUS REVISION

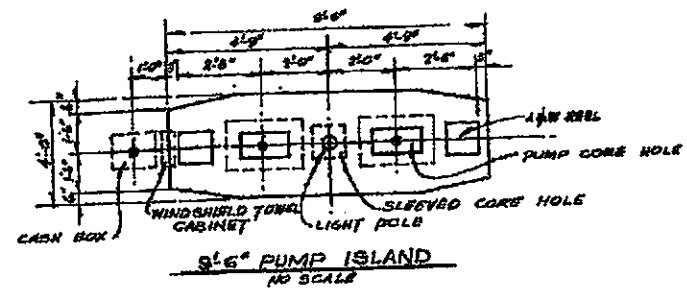

COMPLETION DATE JUNE 30, 1963

PROJECT ENGINEER	JOB NO.
FARKER ENGINEERING & CONSTRUCTION COMPANY	6665
GENERAL ARRANGEMENT SERVICE STATION NO 1871 MAC ARTHUR BLVD & HARRISON ST OAKLAND, CALIFORNIA.	
UNION OIL COMPANY OF CALIFORNIA LOS ANGELES, CALIFORNIA	SS1871-1

ALAMEDA COUNTY
HEALTH CARE SERVICES

AGENCY

DAVID J. KEARS, Agency Director



State Water Resources Control Board
Division of Clean Water Programs
UST Local Oversight Program

RAFAT A. SHAHID, Assistant Agency Director

July 29, 1992

STID 1120

Bob Boust
Unocal
2000 Crow Canyon Pl, Ste 400
San Ramon CA 94583

RE: Unocal Service Station 1871
96 MacArthur Blvd.
Oakland CA 94610

DEPARTMENT OF ENVIRONMENTAL HEALTH
Hazardous Materials Division
80 Swan Way, Rm. 200
Oakland, CA 94621
(510) 271-4320

Dear Mr. Boust,

We have received the Site Assessment Work Plan for the above referenced site, prepared by Roux Associates, dated 7/28/92. This work plan has been reviewed and is hereby approved for implementation, on the condition that purge water from the monitoring wells will be sampled and disposed accordingly. Please submit documentation of disposal of purge water as well as drill cuttings upon submittal of the final report.

All reports and proposals must be submitted **under seal** of a California-Registered Geologist, -Certified Engineering Geologist, or -Registered Civil Engineer. All proposals, reports, and analytical results pertaining to this investigation and remediation must be sent both to our office and to:

Rich Hiatt
RWQCB, San Francisco Bay Region
2101 Webster St., Suite 500
Oakland CA 94612

If you have any questions, please contact Jennifer Eberle at 510-271-4320.

Sincerely,

Susan Hugo
Senior Hazardous Materials Specialist

cc: Paul Supple, Roux Associates, 1855 Gateway Blvd., Ste 770,
Concord CA 94520
Rich Hiatt, RWQCB
~~Edgar Howell/File~~

je

ENVIRONMENTAL CONSULTING & MANAGEMENT
ROUX ASSOCIATES

52 JUL 17 1992 CH



1855 GATEWAY BOULEVARD
SUITE 770
CONCORD, CALIFORNIA 94520 510 602-2333 FAX # 510 687-1258

Transmittal/Memorandum

To: Ms. Jennifer Eberle
Alameda County Health Agency
80 Swan Way, Room 350
Oakland, CA 94621

STID 1120

From: Paul Supple PS

Date: July 17, 1992

Subject: Underground Storage Tank Unauthorized Release (Leak)/
Contamination Site Report
UNOCAL Service Station No. 1871
96 MacArthur Boulevard, Oakland, California

94610

Job No.: 27001W

Remarks: Enclosed is the subject report for distribution

→ ULR

cc: Mr. Robert Boust, UNOCAL

UNDERGROUND STORAGE TANK UNAUTHORIZED RELEASE (LEAK) / CONTAMINATION SITE REPORT

EMERGENCY <input type="checkbox"/> YES <input checked="" type="checkbox"/> NO	HAS STATE OFFICE OF EMERGENCY SERVICES REPORT BEEN FILED? <input type="checkbox"/> YES <input checked="" type="checkbox"/> NO	FOR LOCAL AGENCY USE ONLY I HEREBY CERTIFY THAT I HAVE DISTRIBUTED THIS INFORMATION ACCORDING TO THE DISTRIBUTION SHOWN ON THE INSTRUCTION SHEET ON THE BACK PAGE OF THIS FORM.
--	--	--

REPORT DATE 0 M 7 M 1 D 6 D 9 Y 2 Y	CASE #
--	--------

REPORTED BY	NAME OF INDIVIDUAL FILING REPORT Paul Supple	PHONE (510) 602-2333	SIGNATURE <i>Paul Supple</i>
	REPRESENTING <input type="checkbox"/> OWNER/OPERATOR <input type="checkbox"/> REGIONAL BOARD <input type="checkbox"/> LOCAL AGENCY <input checked="" type="checkbox"/> OTHER Consultant	COMPANY OR AGENCY NAME Roux Associates	
	ADDRESS		

1855 Gateway Blvd. Suite 770 **Concord** **CA** **94520**

RESPONSIBLE PARTY	NAME UNOCAL <input type="checkbox"/> UNKNOWN	CONTACT PERSON Robert Boust	PHONE (510) 277-2300
	ADDRESS 2000 Crow Canyon Place, Suite 400 San Ramon CA 94583		

SITE LOCATION	FACILITY NAME (IF APPLICABLE) UNOCAL Service Station No. 1871	OPERATOR	PHONE (510) 655-3670
	ADDRESS 96 MacArthur Blvd Oakland Alameda 94611		
	CROSS STREET Harrison Street		

IMPLEMENTING AGENCIES	LOCAL AGENCY AGENCY NAME Alameda Co, Dept. of Env. Health	CONTACT PERSON Jennifer Eberle	PHONE (510) 271-4530
	REGIONAL BOARD San Francisco Bay Region		PHONE (510) 464-1255

SUBSTANCES INVOLVED	(1) NAME Low/medium Boiling Point Hydrocarbons (gasoline)	QUANTITY LOST (GALLONS)	<input checked="" type="checkbox"/> UNKNOWN
	(2) <input type="checkbox"/> UNKNOWN		

DISCOVERY/ABATEMENT	DATE DISCOVERED 0 M 5 M 1 D 4 D 9 Y 2 Y	HOW DISCOVERED <input type="checkbox"/> TANK TEST <input type="checkbox"/> TANK REMOVAL <input checked="" type="checkbox"/> OTHER Soil Sample	INVENTORY CONTROL <input type="checkbox"/> SUBSURFACE MONITORING <input type="checkbox"/> NUISANCE CONDITIONS
	DATE DISCHARGE BEGAN <input checked="" type="checkbox"/> UNKNOWN		METHOD USED TO STOP DISCHARGE (CHECK ALL THAT APPLY)
	HAS DISCHARGE BEEN STOPPED? <input checked="" type="checkbox"/> YES <input type="checkbox"/> NO IF YES, DATE 0 M 5 M 1 D 3 D 9 Y 2 Y		<input type="checkbox"/> REMOVE CONTENTS <input type="checkbox"/> CLOSE TANK & REMOVE <input type="checkbox"/> REPAIR PIPING <input type="checkbox"/> REPAIR TANK <input type="checkbox"/> CLOSE TANK & FILL IN PLACE <input type="checkbox"/> CHANGE PROCEDURE <input type="checkbox"/> REPLACE TANK <input checked="" type="checkbox"/> OTHER Replace line & dispenser

SOURCE/CAUSE	SOURCE OF DISCHARGE <input type="checkbox"/> TANK LEAK <input checked="" type="checkbox"/> UNKNOWN <input type="checkbox"/> PIPING LEAK <input type="checkbox"/> OTHER	CAUSE(S) <input type="checkbox"/> OVERFILL <input type="checkbox"/> RUPTURE/FAILURE <input type="checkbox"/> SPILL <input type="checkbox"/> CORROSION <input checked="" type="checkbox"/> UNKNOWN <input type="checkbox"/> OTHER
--------------	---	--

CASE TYPE	CHECK ONE ONLY <input checked="" type="checkbox"/> UNDETERMINED <input type="checkbox"/> SOIL ONLY <input type="checkbox"/> GROUNDWATER <input type="checkbox"/> DRINKING WATER - (CHECK ONLY IF WATER WELLS HAVE ACTUALLY BEEN AFFECTED)
-----------	--

CURRENT STATUS	CHECK ONE ONLY <input type="checkbox"/> NO ACTION TAKEN <input checked="" type="checkbox"/> PRELIMINARY SITE ASSESSMENT WORKPLAN SUBMITTED <input type="checkbox"/> POLLUTION CHARACTERIZATION
	<input type="checkbox"/> LEAK BEING CONFIRMED <input type="checkbox"/> PRELIMINARY SITE ASSESSMENT UNDERWAY <input type="checkbox"/> POST CLEANUP MONITORING IN PROGRESS
	<input type="checkbox"/> REMEDIATION PLAN <input type="checkbox"/> CASE CLOSED (CLEANUP COMPLETED OR UNNECESSARY) <input type="checkbox"/> CLEANUP UNDERWAY

REMEDIAL ACTION	CHECK APPROPRIATE ACTION(S) <small>(SEE BACK FOR DETAILS)</small>	<input type="checkbox"/> EXCAVATE & DISPOSE (ED)	<input type="checkbox"/> REMOVE FREE PRODUCT (FP)	<input type="checkbox"/> ENHANCED BIO DEGRADATION (IT)
	<input type="checkbox"/> CAP SITE (CD)	<input type="checkbox"/> EXCAVATE & TREAT (ET)	<input type="checkbox"/> PUMP & TREAT GROUNDWATER (GT)	<input type="checkbox"/> REPLACE SUPPLY (RS)
	<input type="checkbox"/> CONTAINMENT BARRIER (CB)	<input type="checkbox"/> NO ACTION REQUIRED (NA)	<input type="checkbox"/> TREATMENT AT HOOKUP (HL)	<input type="checkbox"/> VENT SOIL (VS)
	<input type="checkbox"/> VACUUM EXTRACT (VE)	<input type="checkbox"/> OTHER (OT)		

Up to 1,700 ppm TPH-g below dispenser D3. - JF

white -env.health
 yellow -facility
 pink -files

ALAMEDA COUNTY, DEPARTMENT OF ENVIRONMENTAL HEALTH
 Hazardous Materials Inspection Form

80 Swan Way, #200
 Oakland, CA 94621
 (415) 271-4320

II, III

Site ID # _____ Site Name UPVOCAL Today's Date 5/27/92

II.A BUSINESS PLANS (Title 19)

- ___ 1. Immediate Reporting 2703
- ___ 2. Bus. Plan Stds. 25503(b)
- ___ 3. RR Cars > 30 days 25503.7
- ___ 4. Inventory Information 25504(a)
- ___ 5. Inventory Complete 2730
- ___ 6. Emergency Response 25504(b)
- ___ 7. Training 25504(c)
- ___ 8. Deficiency 25505(a)
- ___ 9. Modification 25505(b)

Site Address 96 MacArthur Blvd

City Oakland Zip 94610 Phone _____

___ MAX AMT stored > 500 lbs, 55 gal., 200 cft.?

Inspection Categories:

- ___ I. Haz. Mat/Waste GENERATOR/TRANSPORTER
- ___ II. Business Plans, Acute Hazardous Materials
- III. Underground Tanks primary line test

II.B ACUTELY HAZ. MATLS

- ___ 10. Registration Form Filed 25533(a)
- ___ 11. Form Complete 25533(b)
- ___ 12. RMPP Contents 25534(c)
- ___ 13. Implement Sch. Req'd? (Y/N) _____
- ___ 14. OnSite Conseq. Assess. 25524(c)
- ___ 15. Probable Risk Assessment 25534(d)
- ___ 16. Persons Responsible 25534(g)
- ___ 17. Certification 25534(f)
- ___ 18. Exemption Request? (Y/N) _____
- ___ 19. Trade Secret Requested? 25538

* Calif. Administration Code (CAC) or the Health & Safety Code (HS&C)

III. UNDERGROUND TANKS (Title 23)

- | | |
|--|---|
| General | ___ 1. Permit Application 25284 (H&S) |
| | ___ 2. Pipeline Leak Detection 25292 (H&S) |
| | ___ 3. Records Maintenance 2712 |
| | ___ 4. Release Report 2651 |
| | ___ 5. Closure Plans 2670 |
| Monitoring for Existing Tanks | ___ 6. Method |
| | 1) Monthly Test |
| | 2) Daily Vadose
Semi-annual groundwater
One time soils |
| | 3) Daily Vadose
One time soils
Annual tank test |
| | 4) Monthly Gndwater
One time soils |
| | 5) Daily Inventory
Annual tank testing
Cont pipe leak det
Vadose/gndwater mon. |
| | 6) Daily Inventory
Annual tank testing
Cont pipe leak det |
| | 7) Weekly Tank Gauge
Annual tank testing |
| | 8) Annual Tank Testing
Daily Inventory |
| | 9) Other _____ |
| New Tanks | ___ 7. Precs Tank Test 2643
Date: _____ |
| | ___ 8. Inventory Rec. 2644 |
| | ___ 9. Soil Testing 2646 |
| | ___ 10. Ground Water. 2647 |
| ___ 11. Monitor Plan 2632 | |
| ___ 12. Access. Secure 2634 | |
| ___ 13. Plans Submit 2711
Date: _____ | |
| ___ 14. As Built 2635
Date: _____ | |

Comments:

This is a primary piping pressure test for new dispensers witnessed by Brian Oliva and Steve Halpert of Oakland Fire Dept. Soap test passed with 60 psi pressure on system. Stained soil was noted at excavations. All points at joints were checked with no leakage. Secondary piping test set up for 1:30 pm tomorrow. G

Observed stained soil with no apparent color at west side of excavation. Will refer to Jennifer Eberle of our LDP program. One photograph taken of this.

General contractor for job: Dan Breton Court. (408) 226-1920

II, III

Contact: John Cardoso
 Title: Foreman
 Signature: John Cardoso

Inspector: Ron Owcatz
 Signature: Ron Owcatz
Bruce Oliva



5/27/92 - UNOCAL 96 MacArthur
Stained soil noted @ primary line test
Ron Ewcaiz + Brian Oliva



ENVIRONMENTAL CONSULTING
AND MANAGEMENT

Number of pages including cover sheet:

3

ROUX ASSOCIATES

1855 Gateway Boulevard
Suite 770
Concord, California 94520

FAX TRANSMITTAL

Date: 5-22-92

To: Jennifer Eberle

Company: Alameda County Dept. of Environmental Health

FAX No: 510-569-4757

From: Paul Supple

Project No. 27001W

Roux Associates, Inc.
Fax No: (510) 687-1258
Phone No: (510) 602-2333

Comments: UNOCAL SS# 1871, 96 MacArthur Blvd, Oakland, California letter
original letter will be mailed.



1855 GATEWAY BOULEVARD
SUITE 770
CONCORD, CALIFORNIA 94520 510 602-2333 FAX # 510 687-1258

92 MAY 25 11 31 10

May 22, 1992

Ms. Jennifer Eberle
Alameda County Health Agency
Department of Environmental Health
Division of Hazardous Materials
80 Swan Way, Room 350
Oakland, California 94621

**SUBJECT: UNOCAL SERVICE STATION NO. 1871
96 MACARTHUR BOULEVARD
OAKLAND, CALIFORNIA**

Dear Ms. Eberle:

On behalf of UNOCAL, Roux Associates (Roux) has prepared this letter to present proposed work at UNOCAL Service Station No. 1871, located at 96 MacArthur Boulevard, Oakland, California (Site). The purpose of this letter is to summarize findings from work performed to date and present UNOCAL's plans to assess and remediate the Site.

Currently, a pump island reconstruction project is underway at the Site. The two former pump islands were demolished and removed on May 12 and 13, 1992. On May 13 and 18, 1992, Roux collected soil samples from beneath the removed pump islands. The samples were analyzed for total petroleum fuel hydrocarbons as low to medium boiling point hydrocarbons (TPH-G), for total lead, and for benzene, toluene, ethylbenzene, and xylenes (BTEX). Laboratory analyses of the soil samples indicate elevated concentrations of TPH-G and BTEX in samples collected from beneath the pump island nearer Harrison Street.

As discussed in a May 20, 1992 telephone conversation between Mr. Robert Boust of UNOCAL and yourself, following completion of the pump island reconstruction project, UNOCAL will investigate the extent of hydrocarbons at the Site. The investigation, at a minimum, will consist of the installation of three monitoring wells, and soil and ground water analysis. Based on the data collected during the Site investigation, an appropriate remedial system(s) will be designed and implemented at the Site. **A Work Plan describing the initial phase of the Site investigation will be submitted to you by July 1, 1992.**

Construction activities at the Site are on hold pending your inspection of the new pump island piping. We appreciate your prompt review of this letter and wish to schedule inspection of the new pump island piping as soon as possible.

Respectfully submitted,
ROUX ASSOCIATES

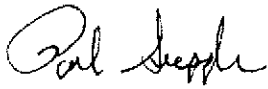

Paul Supple
Senior Hydrogeologist



Dean A. Richesin, C.E.G.
Principal-in-Charge

cc: Mr. Robert Boust, UNOCAL

4:20 - 4:45

white -env.health
yellow -facility
pink -files

ALAMEDA COUNTY, DEPARTMENT OF ENVIRONMENTAL HEALTH

Hazardous Materials Inspection Form

80 Swan Way, #200
Oakland, CA 94621
(415) 271-4320

II, III

Site ID # _____ Site Name Unocal Today's Date 5/18/92

II.A BUSINESS PLANS (Title 19)

- 1. Immediate Reporting 2703
- 2. Bus. Plan Stds. 25503(b)
- 3. RR Cars > 30 days 25503.7
- 4. Inventory Information 25504(a)
- 5. Inventory Complete 2730
- 6. Emergency Response 25504(b)
- 7. Training 25504(c)
- 8. Deficiency 25505(a)
- 9. Modification 25505(b)

Site Address 96 MacArthur Blvd
City Oakland Zip 94610 Phone _____

II.B ACUTELY HAZ. MATLS

- 10. Registration Form Filed 25533(a)
- 11. Form Complete 25533(b)
- 12. RMPP Contents 25534(c)
- 13. Implement Sch. Req'd? (Y/N)
- 14. OnSite Conseq. Assess. 25524(c)
- 15. Probable Risk Assessment 25534(d)
- 16. Persons Responsible 25534(g)
- 17. Certification 25534(f)
- 18. Exemption Request? (Y/N) 25536(b)
- 19. Trade Secret Requested? 25538

MAX AMT stored > 500 lbs, 55 gal., 200 cft.?

Inspection Categories:

- I. Haz. Mat/Waste GENERATOR/TRANSPORTER
- II. Business Plans, Acute Hazardous Materials
- III. Underground Tanks

* Calif. Administration Code (CAC) or the Health & Safety Code (HS&C)

III. UNDERGROUND TANKS (Title 23)

- | | |
|--|---|
| General | <input type="checkbox"/> 1. Permit Application 25284 (H&S) |
| | <input type="checkbox"/> 2. Pipeline Leak Detection 25292 (H&S) |
| | <input type="checkbox"/> 3. Records Maintenance 2712 |
| | <input type="checkbox"/> 4. Release Report 2651 |
| | <input type="checkbox"/> 5. Closure Plans 2670 |
| <hr/> | |
| Monitoring for Existing Tanks | <input type="checkbox"/> 6. Method |
| | 1) Monthly Test |
| | 2) Daily Vadose |
| | Semi-annual groundwater |
| | One time soils |
| | 3) Daily Vadose |
| | One time soils |
| | Annual tank test |
| | 4) Monthly Gndwater |
| | One time soils |
| 5) Daily Inventory | |
| Annual tank testing | |
| Cont pipe leak det | |
| Vadose/gndwater mon. | |
| 6) Daily Inventory | |
| Annual tank testing | |
| Cont pipe leak det | |
| 7) Weekly Tank Gauge | |
| Annual tank testing | |
| 8) Annual Tank Testing | |
| Daily Inventory | |
| 9) Other _____ | |
| <hr/> | |
| New Tanks | <input type="checkbox"/> 7. Precs Tank Test 2643 |
| | Date: _____ |
| | <input type="checkbox"/> 8. Inventory Rec. 2644 |
| | <input type="checkbox"/> 9. Soil Testing 2646 |
| <hr/> | |
| <input type="checkbox"/> 10. Ground Water. 2647 | |
| <hr/> | |
| <input type="checkbox"/> 11. Monitor Plan 2632 | |
| <input type="checkbox"/> 12. Access. Secure 2634 | |
| <input type="checkbox"/> 13. Plans Submit 2711 | |
| Date: _____ | |
| <input type="checkbox"/> 14. As Built 2635 | |
| Date: _____ | |

Comments:
Further excavation under Dispenser #3 (D3). Sample DBA taken at 7 1/2" bgs. to determine extent of contamination. 24 in. turnaround on sample. TPH-g, BTEX, + total Pb. Composite of stockpile (from 5-13 and today's excavations) taken also.

Rev 6/88

Contact: Todd L. Ramsden
Title: Consultant - Geologist
Signature: Todd Ramsden

Inspector: Jennifer Eberle
Signature: J Eberle

II, III

white -env.health
 yellow -facility
 pink -files

ALAMEDA COUNTY, DEPARTMENT OF ENVIRONMENTAL HEALTH

80 Swan Way, #200
 Oakland, CA 94621
 (415) 271-4320

Hazardous Materials Inspection Form

II, III

II.A BUSINESS PLANS (Title 19)
 1. Immediate Reporting 2703
 2. Bus. Plan Stds. 25503(b)

Site ID # _____ Site Name Unocal # 1871 Today's Date 5/13/92

Site Address 96 MacArthur Blvd

Oakland Zip 94607 Phone _____

Unocal Refining & Marketing Division
 Unocal Corporation
 2000 Crow Canyon Place, Suite 400
 P.O. Box 5155
 San Ramon, California 94583
 Telephone (510) 277-2334

MAX AMT stored > 500 lbs, 55 gal., 200 cft.?

Inspection Categories:

- I. Haz. Mat/Waste GENERATOR/TRANSPORTER
- II. Business Plans, Acute Hazardous Materials
- III. Underground Tanks

Page 1 of 2



Robert A. Boust
 Senior Environmental Engineer
 Marketing Engineering & Construction

Administration Code (CAC) or the Health & Safety Code (HS&C)

III. UNDERGROUND TANKS (Title 23)

- General
- 1. Permit Application 25284 (H&S)
 - 2. Pipeline Leak Detection 25292 (H&S)
 - 3. Records Maintenance 2712
 - 4. Release Report 2651
 - 5. Closure Plans 2670

- Monitoring for Existing Tanks
- 6. Method
 - 1) Monthly Test
 - 2) Daily Vadose Semi-annual groundwater One time soils
 - 3) Daily Vadose One time soils Annual tank test
 - 4) Monthly Groundwater One time soils
 - 5) Daily Inventory Annual tank testing Cont pipe leak det Vadose/gndwater mon.
 - 6) Daily Inventory Annual tank testing Cont pipe leak det
 - 7) Weekly Tank Gauge Annual tank testing
 - 8) Annual Tank Testing Daily Inventory
 - 9) Other _____

- 7. Precip Tank Test Date: _____ 2643
- 8. Inventory Rec. 2644
- 9. Soil Testing 2646
- 10. Ground Water. 2647

- New Tanks
- 11. Monitor Plan 2632
 - 12. Access, Secure 2634
 - 13. Plans Submit Date: _____ 2711
 - 14. As Built Date: _____ 2635

Is:
 2 Pump islands are to be expanded.
 Old dispensers were removed.
 <20' of piping was removed.

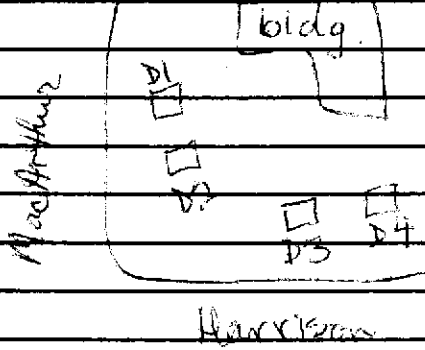

D2: Sampled 2' bgs into native soil. Obvious contamination* above sample depth. Water encountered, but it appears to be from water/air line at end of dispenser.

D1: Sampled 2' bgs into native soil (clayey). Possible contamination above sample depth. No water encountered.

* gas odor & soil discoloration

Contact: Tom Ramsden
 Title: Staff Geologist
 Signature: Tom Ramsden

Inspector: Jennifer Oberle
 Signature: J Oberle

II, III

white -env.health
 yellow -facility
 pink -files

ALAMEDA COUNTY, DEPARTMENT OF ENVIRONMENTAL HEALTH
 Hazardous Materials Inspection Form

80 Swan Way, #200
 Oakland, CA 94621
 (415) 271-4320

II, III

- II.A BUSINESS PLANS (Title 19)
- 1. Immediate Reporting 2703
 - 2. Bus. Plan Stds. 25503(b)
 - 3. RR Cars > 30 days 25503.7
 - 4. Inventory Information 25504(a)
 - 5. Inventory Complete 2730

Site ID # _____ Site Name Unocal Today's Date 5/13/92
 Site Address 96 Mac Arthur Blvd.
 City Oakland Zip 94607 Phone _____

ROUX
ROUX ASSOCIATES
 Environmental Consulting & Management

Todd Ramsden
 Staff Geologist

1855 Gateway Boulevard
 Suite 770
 Concord, California 94520

Tel: (510) 602-2333
 Fax: (510) 687-1258

MAX AMT stored > 500 lbs, 55 gal., 200 cft.?

- Inspection Categories:**
- I. Haz. Mat/Waste GENERATOR/TRANSPORTER
 - I. Business Plans, Acute Hazardous Materials
 - II. Underground Tanks

Page 2 of 2

Administration Code (CAC) or the Health & Safety Code (HS&C)

- III. UNDERGROUND TANKS (Title 23)
- General**
 - 1. Permit Application 25284 (H&S)
 - 2. Pipeline Leak Detection 25292 (H&S)
 - 3. Records Maintenance 2712
 - 4. Release Report 2451
 - 5. Closure Plans 2670
 - Monitoring for Existing Tanks**
 - 6. Method
 - 1) Monthly Test
 - 2) Daily Vadose Semi-annual groundwater One time soils
 - 3) Daily Vadose One time soils Annual tank test
 - 4) Monthly Groundwater One time soils
 - 5) Daily Inventory Annual tank testing Cont pipe leak def Vadose/gndwater mon.
 - 6) Daily Inventory Annual tank testing Cont pipe leak def
 - 7) Weekly Tank Gauge Annual tank testing
 - 8) Annual Tank Testing Daily inventory
 - 9) Other _____
 - 7. Precs Tank Test Date: _____ 2643
 - 8. Inventory Rec. 2644
 - 9. Soil Testing 2646
 - 10. Ground Water. 2647
 - New Tanks**
 - 11. Monitor Plan 2632
 - 12. Access. Secure 2634
 - 13. Plans Submit Date: _____ 2711
 - 14. As Built Date: _____ 2635

D4- sampled at 4' bgs. Soil contained wood, asphalt, & concrete debris. Soil above sample depth had gas odor & was discolored.

D3- sampled at 5' bgs. Soil above sample had some odor (gas) & was discolored not only the typical green, but also black.

The other County contact is Ron Owcarz

Excavated soil to be stockpiled on site until lab results come in.

Rev 6/88

Contact: Todd Ramsden
 Title: STAFF GEOLOGIST
 Signature: Todd Ramsden

Inspector: Jennifer Eberle
 Signature: J Eberle

II, III

ALAMEDA COUNTY HEALTH CARE SERVICES AGENCY
DEPARTMENT OF ENVIRONMENTAL HEALTH
HAZARDOUS MATERIALS DIVISION
80 SWAN WAY, ROOM 200
OAKLAND, CA 94621
PHONE NO. 510/271-4320

UNDERGROUND TANK CLOSURE PLAN

* * * Complete according to attached instructions * * *

1. Business Name UNOCAL SS#1871
Business Owner _____
 2. Site Address 96 MacArthur Blvd.
City OAKLAND Zip 94610 Phone _____
 3. Mailing Address 2000 CROW CANYON PLACE
City SAN RAMON Zip _____ Phone 510-277-2353
 4. Land Owner UNOCAL
Address 2000 Crow Canyon Pl ^{San Ramon} City, State CA Zip _____
 5. Generator name under which tank will be manifested _____
UNOCAL
- EPA I.D. No. under which tank will be manifested CA 604771168

6. Contractor DAN Brenton COAST INC.
Address 2634 PACER LN
City SAN JOSE CA Phone 408-226-1920
License Type* A+B+HAZ ID# 396115

*Effective January 1, 1992, Business and Professional Code Section 7058.7 requires prime contractors to also hold Hazardous Waste Certification issued by the State Contractors License Board. Indicate that the certificate has been received, in addition, to holding the appropriate contractors license type.

7. Consultant KAPPRILLIAN Eng.
Address P.O. Box 996
City BENICIA 94510 Phone 707-746-6915

8. Contact Person for Investigation
Name TONY QUIJANO Title UNOCAL Engenieer
Phone 510-277-2353 867-0760 867-2353
Ron back 277-2353

9. Number of tanks being closed under this plan 1
Length of piping being removed under this plan 0
Total number of tanks at facility 3

10. State Registered Hazardous Waste Transporters/Facilities (see instructions).

** Underground tanks are hazardous waste and must be handled **
as hazardous waste

a) Product/Residual Sludge/Rinsate Transporter

Name H+H SHIPPING EPA I.D. No. CAD004771168
Hauler License No. 1220 License Exp. Date 1993
Address 220 CHINA BASIN
City SAN FRANCISCO state CA zip 94107

b) Product/Residual Sludge/Rinsate Disposal Site

Name H+H SHIPPING EPA I.D. No. CAD004771168
Address 220 CHINA BASIN
City SAN FRANCISCO state CA zip 94107

c) Tank and Piping Transporter

Name H+H SHIPPING EPA I.D. No. CAD004771168
Hauler License No. 1220 License Exp. Date 1993
Address 220 CHINA BASIN
city SAN FRANCISCO state CA zip 94107

d) Tank and Piping Disposal Site

Name H+H SHIPPING EPA I.D. No. CAD004771168
Address 220 CHINA BASIN
city SAN FRANCISCO state CA zip 94107

11. Experienced Sample Collector

Name Tim Ross
Company Kapprillius Eng.
Address P.O. Box 996
city Benicia state CA zip 94510 Phone 707-746-6915

12. Laboratory

Name Sequoia Analytical
Address 680 CHESAPEAKE DR
city Redwood City state CA zip 94063
State Certification No. 1277 1210

13. Have tanks or pipes leaked in the past? Yes [] No [✓]

If yes, describe. _____

14. Describe methods to be used for rendering tank inert

Insert 30 lbs of Dry ICE per 100 gal TANK
Size

Before tanks are pumped out and inerted, all associated piping must be flushed out into the tanks. All accessible associated piping must then be removed. Inaccessible piping must be plugged.

The Bay Area Air Quality Management District (771-6000), along with local Fire and Building Departments, must also be contacted for tank removal permits. Fire departments typically require the use of explosion proof combustible gas meters to verify tank inertness. It is the contractor's responsibility to bring a working combustible gas meter on site to verify tank inertness.

15. Tank History and Sampling Information

Tank		Material to be sampled (tank contents, soil, ground-water, etc.)	Location and Depth of Samples
Capacity	Use History (see instructions)		
550	WASTE OIL	WASTE OIL	ONE EA END OF TANK AT APPROX 6' depth 1-2' below tank bottom

One soil sample must be collected for every 20 feet of piping that is removed. A ground water sample must be collected should any ground water be present in the excavation.

Excavated/Stockpiled Soil

<p>Stockpiled Soil Volume (Estimated)</p>	<p align="center">Sampling Plan 4 samples will be collected per ea. 20 yds² of Stockpiled Soil</p>
--	---

Stockpiled soil must be placed on bermed plastic and must be completely covered by plastic sheeting.

16. Chemical methods and associated detection limits to be used for analyzing samples

The Tri-Regional Board recommended minimum verification analyses and practical quantitation reporting limits should be followed. See attached Table 2.

Contaminant Sought	EPA, DHS, or Other Sample Preparation Method Number	EPA, DHS, or Other Analysis Method Number	Method Detection Limit
1. TPH _g	5030	GCFID	1.0 ppm
2. BTK+E	3550.?	8020 or 8240	.005 ppm
3. Total oil grease	8240-8620	5520 D+F	50ppm
4. TPH-d	3550	GCFID	10ppm
5. CLHC		8010 or 8240	
6. Cd, Cr, Pb, Zn, Ni		ICAP or AA	
7. PCB, PCP, PNA, Cresote		3270	

17. Submit Site Health and Safety Plan (See Instructions)

18. Submit Worker's Compensation Certificate copy

Name of Insurer Golden Eagle Ins. Co. ✓

19. Submit Plot Plan (See Instructions)

20. Enclose Deposit (See Instructions) ✓

21. Report any leaks or contamination to this office within 5 days of discovery. The report shall be made on an Underground Storage Tank Unauthorized Leak/Contamination Site Report form. (see Instructions)

22. Submit a closure report to this office within 60 days of the tank removal. This report must contain all the information listed in item 22 of the instructions.

I declare that to the best of my knowledge and belief the statements and information provided above are correct and true.

I understand that information in addition to that provided above may be needed in order to obtain an approval from the Department of Environmental Health and that no work is to begin on this project until this plan is approved.

I understand that any changes in design, materials or equipment will void this plan if prior approval is not obtained.

I understand that all work performed during this project will be done in compliance with all applicable OSHA (Occupational Safety and Health Administration) requirements concerning personnel health and safety. I understand that site and worker safety are solely the responsibility of the property owner or his agent and that this responsibility is not shared nor assumed by the County of Alameda.

Once I have received my stamped, accepted closure plan, I will contact the project Hazardous Materials Specialist at least three working days in advance of site work to schedule the required inspections.

Signature of Contractor

Name (please type) Kerry Brenton

Signature *Kerry Brenton*

Date 4-27-92

Signature of Site Owner or Operator

Name (please type) _____

Signature _____

Date _____

INSTRUCTIONS

General Instructions

- * Three (3) copies of this plan plus attachments and deposit must be submitted to this Department.
- * Any cutting into tanks requires local fire department approval.
- * One complete copy of your approved plan must be at the construction site at all times; a copy of your approved plan must also be sent to the landowner.

Item Specific Instructions

2. SITE ADDRESS
Address at which closure is taking place.
5. EPA I.D. NO. under which the tanks will be manifested
EPA I.D. numbers may be obtained from the State Department of Health Services, 916/324-1781.
6. CONTRACTOR
Prime contractor for the project.
10. STATE REGISTERED HAZARDOUS WASTE TRANSPORTERS/FACILITIES
 - a) All residual liquids and sludges are to be removed from tanks before tanks are inerted.
 - c) Tanks must be hauled as hazardous waste.
 - d) This is the place where tanks will be taken for cleaning.
15. TANK HISTORY AND SAMPLING INFORMATION
Use History - This information is essential and must be accurate. Include tank installation date, products stored in the tank, and the date when the tank was last used.

Material to be sampled - e.g. water, oil, sludge, soil, etc.

Location and depth of samples - e.g. beneath the tank a maximum of two feet below the native soil/backfill interface, side wall at the high water mark, etc.

16. CHEMICAL METHODS AND ASSOCIATED DETECTION LIMITS
See attached Table 2.

17. SITE HEALTH AND SAFETY PLAN

A site specific Health and Safety plan must be submitted. We advocate the site health and safety plan include the following items, at a minimum:

- a) The name and responsibilities of the site health and safety officer;
- b) An outline of briefings to be held before work each day to appraise employees of site health and safety hazards;
- c) Identification of health and safety hazards of each work task. Include potential fire, explosion, physical, and chemical hazards;
- d) For each hazard, identify the action levels (contaminant concentrations in air) or physical conditions which will trigger changes in work habits to ensure workers are not exposed to unsafe chemical levels or physical conditions;
- e) Description of the work habit changes triggered by the above action levels or physical conditions;
- f) Frequency and types of air and personnel monitoring - along with the environmental sampling techniques and instrumentation - to be used to detect the above action levels. Include instrumentation maintenance and calibration methods and frequencies;
- g) Confined space entry procedures (if applicable);
- h) Decontamination procedures;
- i) Measures to be taken to secure the site, excavation and stockpiled soil during and after work hours (e.g. barricades, caution tape, fencing, trench plates, plastic sheeting, security guards, etc.);
- j) Spill containment/emergency/contingency plan. Be sure to include emergency phone numbers, the location of the phone nearest the site, and directions to the hospital nearest the site;
- k) Documentation that all site workers have received the appropriate OSHA approved trainings and participate in appropriate medical surveillance per 29 CFR 1910.120; and
- l) Page for employees to sign indicating they have read and will comply with the site health and safety plan.

The safety plan must be distributed to all employees and contractors working in hazardous waste operations on site. A complete copy of the site health and safety plan along with any standard operating procedures shall be on site and accessible at all times.

NOTE: These requirements are excerpts from 29 CFR Part 1910.120(b)(4), Hazardous Waste Operations and Emergency Response; Final Rule, March 6, 1989. Safety plans of certain underground tank sites may need to meet the complete requirements of this Rule.

19. PLOT PLAN

The plan should consist of a scaled view of the facility at which the tank(s) are located and should include the following information:

- a) Scale;
- b) North Arrow;
- c) Property Lines;
- d) Location of all Structures;
- e) Location of all relevant existing equipment including tanks and piping to be removed and dispensers;
- f) Streets;
- g) Underground conduits, sewers, water lines, utilities;
- h) Existing wells (drinking, monitoring, etc.);
- i) Depth to ground water; and
- j) All existing tanks and piping in addition to the ones being pulled.

20. DEPOSIT

A deposit, payable to Alameda County for the amount indicated on the Alameda County Underground Storage Tank Fee Schedule, must accompany the plans.

21. Blank Unauthorized Leak/Contamination Site Report forms may be obtained in limited quantities from our office and from the San Francisco Bay Regional Water Quality Control Board (415/464-1255). Larger quantities may be obtained directly from the State Water Resources Control Board at (916) 739-2421.

22. TANK CLOSURE REPORT

The tank closure report should contain the following information:

- a) General description of the closure activities;
- b) Description of tank, fittings and piping conditions. Indicate tank size and former contents; note any corrosion, pitting, holes, etc.;

- c) Description of the excavation itself. Include the tank and excavation depth, a log of the stratigraphic units encountered within the excavation, a description of root holes or other potential contaminant pathways, the depth to any observed ground water, descriptions and locations of stained or odor-bearing soil, and descriptions of any observed free product or sheen;
- d) Description of sampling methods;
- e) Description of any remedial measures conducted at the time of tank removal;
- f) To-scale figures showing the excavation size and depth, nearby buildings, sample locations and depths, and tank and piping locations. Include a copy of the plot plan prepared for the Tank Closure Plan under item 19;
- g) Chain of custody records;
- h) Copies of signed laboratory reports;
- i) Copies of "TSDF to Generator" Manifests for all hazardous wastes hauled offsite (sludge, rinsate, tanks and piping, contaminated soil, etc.); and
- j) Tabulation of the volume and final destination of all non-manifested contaminated soil hauled offsite.

TABLE #2
RECOMMENDED MINIMUM VERIFICATION ANALYSES FOR
UNDERGROUND TANK LEAKS

<u>HYDROCARBON LEAK</u>	<u>SOIL ANALYSIS</u>		<u>WATER ANALYSIS</u>	
Unknown Fuel	TPH G	GCFID(5030)	TPH G	GCFID(5030)
	TPH D	GCFID(3550)	TPH D	GCFID(3510)
	BTX&E	8020 or 8240	BTX&E	602, 624 or 8260
	TPH AND BTX&E	8260		
Leaded Gas	TPH G	GCFID(5030)	TPH G	GCFID(5030)
	BTX&E	8020 OR 8240	BTX&E	602 or 624
	TPH AND BTX&E	8260	TOTAL LEAD AA	
	TOTAL LEAD AA			
	-----Optional-----			
	TEL	DHS-LUFT	TEL	DHS-LUFT
EDB	DHS-AB1803	EDB	DHS-AB1803	
Unleaded Gas	TPH G	GCFID(5030)	TPH G	GCFID(5030)
	BTX&E	8020 or 8240	BTX&E	602, 624 or 8260
	TPH AND BTX&E	8260		
Diesel, Jet Fuel and Kerosene	TPH D	GCFID(3550)	TPH D	GCFID(3510)
	BTX&E	8020 or 8240	BTX&E	602, 624 or 8260
	TPH AND BTX&E	8260		
Fuel/Heating Oil	TPH D	GCFID(3550)	TPH D	GCFID(3510)
	BTX&E	8020 or 8240	BTX&E	602, 624 or 8260
	TPH AND BTX&E	8260		
Chlorinated Solvents	CL HC	8010 or 8240	CL HC	601 or 624
	BTX&E	8020 or 8240	BTX&E	602 or 624
	CL HC AND BTX&E	8260	CL HC AND BTX&E	8260
Non-chlorinated Solvents	TPH D	GCFID(3550)	TPH D	GCFID(3510)
	BTX&E	8020 or 8240	BTX&E	602 or 624
	TPH AND BTX&E	8260	TPH and BTX&E	8260
Waste and Used Oil or Unknown (All analyses must be completed and submitted)	TPH G	GCFID(5030)	TPH G	GCFID(5030)
	TPH D	GCFID(3550)	TPH D	GCFID(3510)
	TPH AND BTX&E	8260		
	O & G	5520 D & F	O & G	5520 C & F
	BTX&E	8020 or 8240	BTX&E	602, 624 or 8260
	CL HC	8010 or 8240	CL HC	601 or 624
ICAP or AA TO DETECT METALS: Cd, Cr, Pb, Zn, Ni				
METHOD 8270 FOR SOIL OR WATER TO DETECT:				
	PCB*		PCB	
	PCP*		PCP	
	PNA		PNA	
	CREOSOTE		CREOSOTE	

* If found, analyze for dibenzofurans (PCBs) or dioxins (PCP)

Reference: Tri-Regional Board Staff Recommendations for Preliminary Evaluation and Investigation of Underground Tank Sites, 10 August 1990

EXPLANATION FOR TABLE #2: MINIMUM VERIFICATION ANALYSIS

1. OTHER METHODOLOGIES are continually being developed and as methods are accepted by EPA or DHS, they also can be used.
2. For DRINKING WATER SOURCES, EPA recommends that the 500 series for volatile organics be used in preference to the 600 series because the detection limits are lower and the QA/QC is better.
3. APPROPRIATE STANDARDS for the materials stored in the tank are to be used for all analyses on Table #2. For instance, seasonally, there may be five different jet fuel mixtures to be considered.
4. To AVOID FALSE POSITIVE detection of benzene, benzene-free solvents are to be used.
5. TOTAL PETROLEUM HYDROCARBONS (TPH) as gasoline (G) and diesel (D) ranges (volatile and extractible, respectively) are to be analyzed and characterized by GCFID with a fused capillary column and prepared by EPA method 5030 (purge and trap) for volatile hydrocarbons, or extracted by sonication using 3550 methodology for extractable hydrocarbons. Fused capillary columns are preferred to packed columns; a packed column may be used as a "first cut" with "dirty" samples or once the hydrocarbons have been characterized and proper QA/QC is followed.
6. TETRAETHYL LEAD (TEL) analysis may be required if total lead is detected unless the determination is made that the total lead concentration is geogenic (naturally occurring).
7. CHLORINATED HYDROCARBONS (CL HC) AND BENZENE, TOLUENE, XYLENE AND ETHYLBENZENE (BTX&E) are analyzed in soil by EPA methods 8010 and 8020 respectively, (or 8240) and in water, 601 and 602, respectively (or 624).
8. OIL AND GREASE (O & G) may be used when heavy, straight chain hydrocarbons may be present. Infrared analysis by method 418.1 may also be acceptable for O & G if proper standards are used. Standard Methods" 17th Edition, 1989, has changed the 503 series to 5520.
9. PRACTICAL QUANTITATION REPORTING LIMITS are influenced by matrix problems and laboratory QA/QC procedures. Following are the Practical Quantitation Reporting Limits:

	<u>SOIL PPM</u>	<u>WATER PPB</u>
TPH G	1.0	50.0
TPH D	1.0	50.0
BTX&E	0.005	0.5
O & G	50.0	5,000.0

Based upon a Regional Board survey of Department of Health Services Certified Laboratories, the Practical Quantitation Reporting Limits are attainable by a majority of laboratories with the exception of diesel fuel in soils. The Diesel Practical Quantitation Reporting Limits, shown by the survey, are:

ROUTINE	MODIFIED PROTOCOL
≤ 10 ppm (42%)	≤ 10 ppm (10%)
≤ 5 ppm (19%)	≤ 5 ppm (21%)
≤ 1 ppm (35%)	≤ 1 ppm (60%)

When the Practical Quantitation Reporting Limits are not achievable, an explanation of the problem is to be submitted on the laboratory data sheets.

- LABORATORY DATA SHEETS are to be signed and submitted and include the laboratory's assessment of the condition of the samples on receipt including temperature, suitable container type, air bubbles present/absent in VOA bottles, proper preservation, etc. The sheets are to include the dates sampled, submitted, prepared for analysis, and analyzed.
- IF PEAKS ARE FOUND, when running samples, that do not conform to the standard, laboratories are to report the peaks, including any unknown complex mixtures that elute at times varying from the standards. Recognizing that these mixtures may be contrary to the standard, they may not be readily identified; however, they are to be reported. At the discretion of the LIA or Regional Board the following information is to be contained in the laboratory report:

The relative retention time for the unknown peak(s) relative to the reference peak in the standard, copies of the chromatogram(s), the type of column used, initial temperature, temperature program is C/minute, and the final temperature.

- REPORTING LIMITS FOR TPH are: gasoline standard ≤ 20 carbon atoms, diesel and jet fuel (kerosene) standard ≤ 50 carbon atoms. It is not necessary to continue the chromatography beyond the limit, standard, or EPA/DHS method protocol (whichever time is greater).

EPILOGUE

ADDITIVES: Major oil companies are being encouraged or required by the federal government to reformulate gasoline as cleaner burning fuels to reduce air emissions. MTBE (Methyl-tertiary butyl ether), ETHANOL (ethyl alcohol), and other chemicals may be added to reformulate gasolines to increase the oxygen content in the fuel and thereby decrease undesirable emissions (about four percent with MTBE). MTBE and ethanol are, for practical purposes, soluble in water. The removal from the water column will be difficult. Other compounds are being added by the oil companies for various purposes. The refinements for detection and analysis for all of these additives are still being worked out. If you have any questions about the methodology, please call your Regional Board representative.

96 MacArthur

CERTIFICATE OF INSURANCE

01/17/92

PRODUCER
INB Insurance Services Corp.
P.O. Box 699
Los Gatos, CA
95031-
PHONE 408-395-7900

THIS CERTIFICATE IS ISSUED AS A MATTER OF COURTESY AND DOES NOT CONFER ANY RIGHTS UPON THE CERTIFICATE HOLDER. THIS CERTIFICATE DOES NOT AMEND, EXTEND OR ALTER THE COVERAGE AFFORDED BY THE POLICIES BELOW.

COMPANIES AFFORDING COVERAGE

INSURED
Dan Brenton Construction
Dan Brenton
2634 Pacer Lane
San Jose, CA
95111-

- COMPANY LETTER A General Star Indemnity
- COMPANY LETTER B Sequoia
- COMPANY LETTER C Golden Eagle Insurance Co.
- COMPANY LETTER D
- COMPANY LETTER E

COVERAGES
THIS IS TO CERTIFY THAT POLICIES OF INSURANCE LISTED BELOW HAVE BEEN ISSUED TO THE INSURED NAMED ABOVE FOR THE POLICY PERIOD INDICATED. NOTWITHSTANDING ANY REQUIREMENT, TERM OR CONDITION OF ANY CONTRACT OR OTHER DOCUMENT WITH RESPECT TO WHICH THIS CERTIFICATE MAY BE ISSUED OR MAY PERTAIN, THE INSURANCE AFFORDED BY THE POLICIES DESCRIBED HEREIN IS SUBJECT TO ALL TERMS, EXCLUSIONS, AND CONDITIONS OF SUCH POLICIES. LIMITS SHOWN MAY HAVE BEEN REDUCED BY PAID CLAIMS.

COI LETTER	TYPE OF INSURANCE	POLICY NUMBER	POLICY EFF DATE	POLICY EXP DATE	ALL LIMITS IN THOUSANDS	
A	GENERAL LIABILITY	IYG306519	01/15/92	01/15/93	GENERAL-AGGREGATE	1000
	IXI COMMERCIAL GEN LIABILITY				PRODS-COMP/OPS AGG.	1000
	[] IXI CLAIMS MADE [] OCC.				PERS. & ADVG. INJURY	1000
	[] OWNER'S & CONTRACTORS PROTECTIVE				EACH OCCURRENCE	1000
	[]				FIRE DAMAGE (ANY ONE FIRE)	50
A	AUTOMOBILE LIAB	BAP4000108	08/20/91	08/20/92	OSL	1000
	[] ANY AUTO				BODILY INJURY (PER PERSON)	
	[] ALL OWNED AUTOS				BODILY INJURY (PER ACCIDENT)	
	IXI SCHEDULED AUTOS				PROPERTY	
	IXI HIRED AUTOS					
C	EXCESS LIABILITY	PWC10988301	10/01/91	10/01/92	EACH OCC	AGGREGATE
	[] UMBRELLA FORM					
C	WORKERS' COMP AND EMPLOYERS' LIAB	PWC10988301	10/01/91	10/01/92	STATUTORY	
					1000	EACH ACC
					1000	DISEASE-POLICY LIMIT
					1000	DISEASE-EACH EMPLOYEE
	OTHER					

DESCRIPTION OF OPERATIONS/LOCATIONS/VEHICLES/SPECIAL ITEMS

CERTIFICATE HOLDER
ALAMEDA COUNTY ENVIRONMENTAL HEALTH DEPT.
80 SWAN WAY RM. 200
OAKLAND, CA
94621

CANCELLATION
= SHOULD ANY OF THE ABOVE DESCRIBED POLICIES BE CANCELLED BEFORE THE EXPIRATION DATE THEREOF, THE ISSUING COMPANY WILL endeavor to MAIL 10 DAYS WRITTEN NOTICE TO THE CERTIFICATE HOLDER NAMED TO THE LEFT, AND FAILURE TO MAIL SUCH NOTICE SHALL IMPROSE NO OBLIGATION OR LIABILITY OF ANY KIND TO THE COMPANY, ITS AGENTS OR REPRESENTATIVES.

ACORD 25-5 (2/88)

Charles A. ...

SITE SAFETY PLAN

Unocal 96 MacArthur, Oakland

1.0 The Unocal Station is located on the Southwest
corner of MacArthur at Harrison. It is primarily
a Full Service Facility, conducting business between the hour of
24 Hours.

The surrounding area is primarily commerical and
residential. The local Fire Station is located
on the Northeast corner of Gilbert Street & John St..

The project scope for this Facility is to do a Dispenser Island
Modification with as little alteration to the existing Storage Tanks
and Product Piping as possible.

The installation of New Steel Island Forms and 6 Hose Multi Pro-
duct Dispensers is the sole intent of this Scope.

SITE SAFETY AUTHORITY

2.0 The Site Safety Officer for this project will be Russell Thompson. He can be reached by way of his pager# 408-989-0168 or contacting Kerry Brenton at our office # 408-226-1920.

The Site Safety Officer for this project will be responsible for:

1. Daily Site Safety Meeting and Inspections.
2. Determining what levels of safety equipment will be required for that days tasks.
3. Keep a daily log of illness or injury on the job.
4. Contacting any local jurisdictions regarding Safety Issues.
5. Making sure everyone entering Job Site abides by Safety Rules and Procedures.
6. That everyone who enters Job Site has appropriate Safety Equip. I.E. Hard Hats, Safety Shoes, Safety Glasses, min. requirement).

The Assistant Site Safety Officer will be Victor Vasques and he has the same responsibilities and authority as Site Officer in Site Officers Absense.

JOB HAZARD ANALYSIS

3.0 The Chemical Hazards relating to this project are but not limited to as follows:

1. Gasoline	uel 6.0%	lev 1.3%	F.P. -50 F
2. Benzene	uel 7.9%	lev 1.3%	F.P. 12 F
3. Toluene	uel 7.1%	lev 1.2%	F.P. 40 F
4. Xylene	uel 7.3%	lev 1.3%	F.P. 81 F

The Physical Hazards at the Site are open trenches, areas of excavation of concrete and asphalt which would constitute Tripping Hazards as well as Slipping and Falling.

4.0 RISK ASSESSMENT SUMMARY

1. All workers on this site shall minimize the potential for hazards which could cause illness or injury to fellow workers and or visitors to the Site. They will ALL BEFORE!!! entering the site, check and don the appropriate safety equipment.
2. All workers will prevent in the appropriate manner any discharge of Hazardous Material into the environment.
 - A. cover all contaminated soil with 6 mil. visqueen
 - B. containe and dispose of all Hazardous Material in the appropriate containers for disposal at an approved facility
3. The Site shall be maintained and scured by means of a 6' high security fence and proper placarding of same to protect the public from hazards, related to this Site.

5.0 EXPOSURE MONITORING

1. Onsite will be a Drager C31 sampler for sampling airborne contaminants. *w/ benzene tubes.*
2. A gastec lel meter for Detection of the Lower Explosive limits of airborne contaminants.
3. Monitoring will take place in designated areas of the work Site as indicated on the attached Site Plan. Areas will be designated m1, m2, m3 etc.
4. Frequency of sampling will be atleast 2 times per 5 day work week or is deemed necessary by the Site Safety Officer

6.0 PERSONAL PROTECTIVE EQUIPMENT

1. All workers and vistors to the Site will have:

- 1. Hard Hat (OSHA)
- 2. Safety Glasses (OSHA)
- 3. Safety Shoes (OSHA)

No exceptions to these 3 items will be made, anyone visiting the Site for any reason. Material deliveries, Site Inspection by local authorities (Enviromental Health, Fire Dept. Bldg.Dept. or Oil Company Eengeeners must have these items before entering the work zone. (OSHA and CAL OSHA LAW)

2. Level of resperator and cartridges will be determined by Site Safety Officer and airborne sampling. Anytime the airborne PPM exceeds 275 PPM'S total Hydrocarbons Cartridge type resperator is manditory. *Respiratory protection is available onsite for each employee*

7.0 WORK ZONE

Exclusion Zone (EZ)

1. Exclusion zones at Site shall be designated by barriers encompassed with 3 rows of Red Flag Tape. These are areas defined as "Contaminated Areas"
2. Contamination Reduction Zone (CRZ) shall be encompassed by barriers with 3 Rows of Blue Flag Tape. This is a buffer zone between contaminated and non-contaminated zones. The zone is classified as having low or trace of contamination. Protective clothing shall be worn in this zone.
3. Support Zone (SZ)
Shall be encompassed by 6' high chain link fence and shall be marked with 3 rows of Green Flag Tape. This location is for storage of all materials and supplies required for the project. This Zone is accessible by all personnel without requiring the use of protective clothing or resperators. It is classified as being non contaminated.

SEE ATTACHED PLOT PLAN FOR THESE DESIGNATIONS.

8.0 DECON PROTOCOL'S

Equipment and Personnel will be decontaminated before leaving the CRZ. All protective clothing will be disposed of in an approved container in the CRZ for disposal. All Boots, tools and equipment will be washed and rinsed free of contaminants before entering the SZ or leaving the Site.

9.0 GENERAL SAFE WORK PRACTICES

1. The rules for the Site are as follows:
 - A. no drugs or alcohol
 - B. no smoking once inside the SZ
 - C. no fire works, no fire arms
 - D. no horse play of any kind
 - E. a min. of 2 - 20bc fire extinguishers to be posted inside th EZ.

All employees assigned to work at this Site will arrive promptly for daily safety meeting.

10.0 SANITATION

1. There will be on Site during work hours a min of 15 gals fresh drinking water for employee & vistor use.
2. There will be Onsite at start of construction a portable lavatory for use by employees until end of job.

11.0 STANDARD SAFE OPERATING PROCEDURES

1. All product lines shall be purged free of all product and vapors with the use of nitrogen before lines are cut.
2. In the event "confined space entry" is required all guidelines of such shall be followed in the strictest accordance of the law!!

12.0 TRAINING REQUIREMENTS

1. All persons entering the SZ, CRZ or EZ shall have met the required training program as set forth by OSHA 29 CFR1910, 120. That is 40 hrs initial training. Anyone not meeting these requirements shall cause an immediate halt to all work activities and it will not resume until they have left.

13.0 EMERGENCY RESPONSE PLAN

1. Site emergency ph. # 408-226-1920
2. Local Fire, Police and Ambulance 911
3. Peralta Hospital 450, 30th St. Oakland
From Job Site proceed North on MacArthur
to Broadway, South on Broadway to 30th
East on 30th to Hospital

4. Emergency equipment on Site
 1. First Aid Kits
 2. Fire Extinguisher

15.0

SIGNITURE

By signing below I Acknowledge I have read the Site Safety
Plan An agree to abide by it's contents.

1. _____
2. _____
3. _____
4. _____
5. _____
6. _____
7. _____
8. _____
9. _____
10. _____
11. _____
12. _____
13. _____
14. _____
15. _____
16. _____
17. _____
18. _____
19. _____
20. _____
21. _____